

# Capital Oil and Gas Corporation

214 - 983-2081

February 17, 1983

214 - 983-2082

Mr. Joe Ramey  
Energy and Minerals Department  
Oil Conservation Commission  
P. O. Box 2088  
Santa Fe, New Mexico 87501

NSL  
3 wells  
see C-102 for  
loc from  
3-14-83

Re: Commission Order R-4875

Dear Mr. Ramey:

Enclosed is information needed for request of administrative approval for a nonstandard location for our SFPRR Nos. 79, 80 and 83 wells. The information enclosed is in compliance with the Operating Rules for the Waterflood Project, Miguel Creek Field, Gallup Pool, in McKinley County, New Mexico, Case No. 5321. As requested in Paragraph 6 of the Commission Order No. R-4875, we seek approval for a nonstandard location for SFPRR Nos. 79, 80 and 83.

- A. A plat marked "Exhibit A" for each well is enclosed, showing new location and the particle of acreage dedicated to the well.
- B. Enclosure for each well marked "Exhibit B" is an aerial map of each location and offset wells. At the present time, there are no offset producers except for Capital Oil and Gas Corporation in the area.
- C. "Exhibit C" is a downhole schematic of each well.
- D. "Exhibit D" is a Sundry Notice and Report on Well (Form C-103) for each well.
- E. A nonstandard location is needed for these wells to be in a line drive sequence for a proposed waterflood in this section of the field.
- F. To our knowledge, there are no water, oil and gas strata zones of the Gallup Hospah pay zone in this area.

This information should be satisfactory with the rules set forth in the Commission Order R-4875. If you need further information, please do not hesitate to contact me.

Yours very truly,

CAPITAL OIL AND GAS CORPORATION

By Gary Blanks  
Gary Blanks, Vice President

GB:jh

Post Office Box 2130 Suite 202, Pioneer Building Kilgore, Texas 75662

# U.S. CONSERVATION DIVISION

P. O. BOX 2088

SANTA FE, NEW MEXICO 87501

All distances must be from the outer boundaries of the Section.

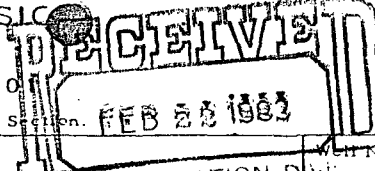

Form C-102  
Revised 10-1-78

Operator <b>Capital Oil and Gas Corporation</b>			Lease <b>S.F.P.R.R.</b>		Well No. <b>S.F.P.R.R. #79</b>
Unit Letter <b>L</b>	Section <b>21</b>	Township <b>16N.</b>	Range <b>6W.</b>	County <b>SANTA FE</b>	
Actual Footage Location of Well: <b>1330'</b> feet from the <b>South</b> line and <b>10'</b> feet from the <b>West</b> line					
Ground Level Elev. <b>6428.79'</b>	Producing Formation <b>Hospah-Gallup</b>		Pool <b>Miguel Creek Gallup Extension</b>		Dedicated Acreage: <b>40</b> Acres

1. Outline the acreage dedicated to the subject well by colored pencil or hatchure marks on the plat below.
2. If more than one lease is dedicated to the well, outline each and identify the ownership thereof (both as to working interest and royalty).
3. If more than one lease of different ownership is dedicated to the well, have the interests of all owners been consolidated by communitization, unitization, force-pooling, etc?

☐ Yes ☒ No If answer is "yes," type of consolidation \_\_\_\_\_

If answer is "no," list the owners and tract descriptions which have actually been consolidated. (Use reverse side of this form if necessary.) Capital Oil and Gas Corporation and Zenith Energy Corporation own 100% working interest in the lease  
No allowable will be assigned to the well until all interests have been consolidated (by communitization, unitization, forced-pooling, or otherwise) or until a non-standard unit, eliminating such interests, has been approved by the Commission.

	<b>CERTIFICATION</b>  I hereby certify that the information contained herein is true and complete to the best of my knowledge and belief.	
	Name <u>Jean Houston</u> Position <u>Agent</u> Company <u>Capital Oil and Gas Corporation</u> Date <u>4/22/82</u>	
	I hereby certify that the well location shown on this plat was plotted from field notes of actual surveys made by me or under my supervision, and that the same is true and correct to the best of my knowledge and belief.	
	Date Surveyed <u>March 12, 1982</u> Registered Professional Engineer and/or Land Surveyor <u>Fred D. Marmon</u> Certificate No. <u>2031</u>	

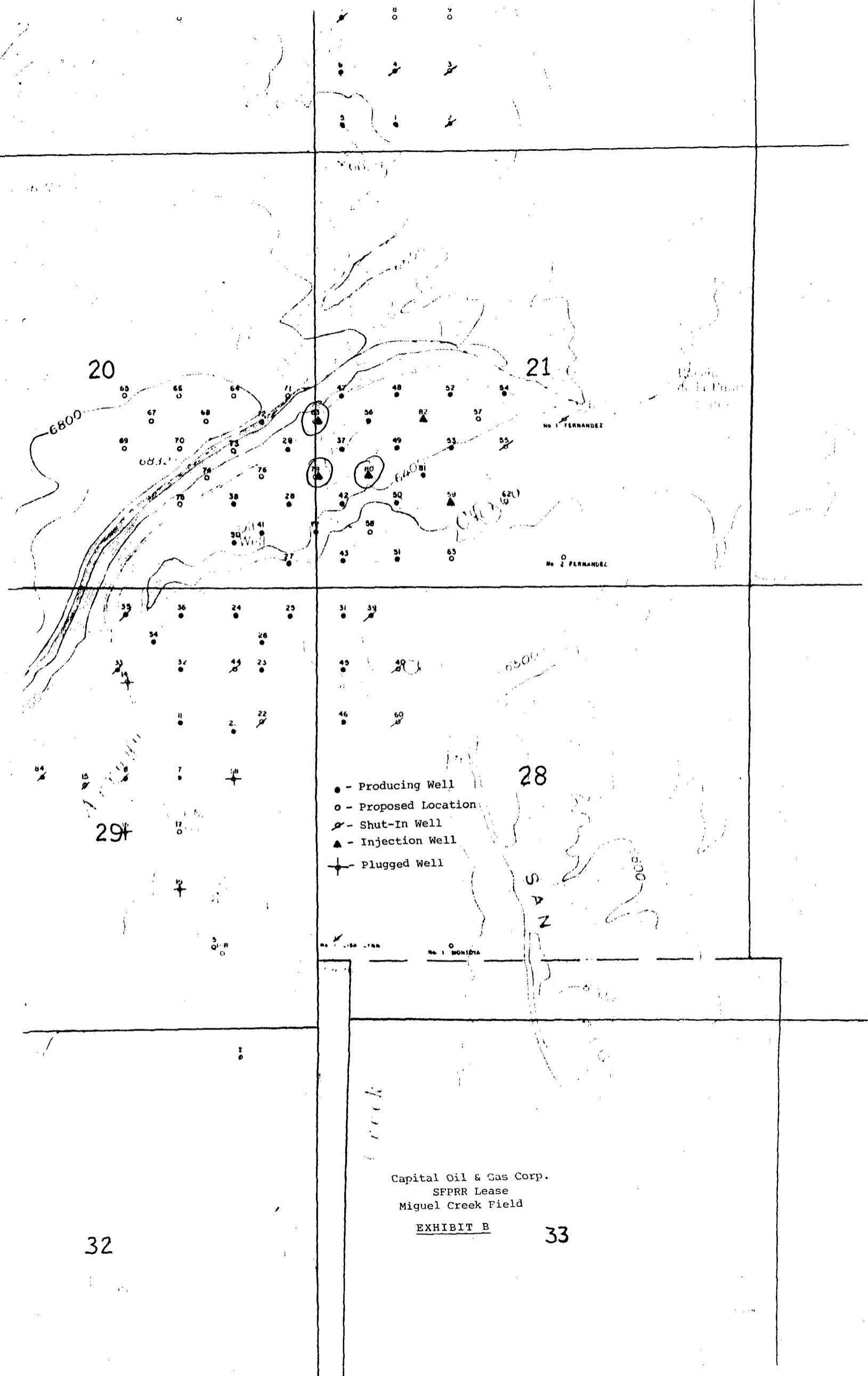

86  
O

7  
O  
8  
O  
9  
O  
6  
O  
4  
O  
3  
O  
5  
O  
1  
O  
2  
O

20

21

Rancho  
de la Piedad  
Pate

No. 1 FERNANDEZ

No. 2 FERNANDEZ

- - Producing Well
- - Proposed Location
- ⊗ - Shut-In Well
- ▲ - Injection Well
- ⊕ - Plugged Well

28

29

No. 1  
O  
O

No. 1  
O  
O

No. 1  
O  
O

Capital Oil & Gas Corp.  
SFPRR Lease  
Miguel Creek Field

EXHIBIT B

33

32



STATE OF NEW MEXICO  
ENERGY AND MINERALS DEPARTMENT

OIL CONSERVATION DIVISION  
AZTEC DISTRICT OFFICE

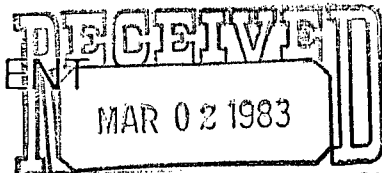

OIL CONSERVATION DIVISION

SANTA FE  
1000 RIO BRAZOS ROAD  
AZTEC, NEW MEXICO 87410  
(505) 334-6178

OIL CONSERVATION DIVISION  
BOX 2088  
SANTA FE, NEW MEXICO 87501

DATE 2-25-83

RE: Proposed MC \_\_\_\_\_  
Proposed DHC \_\_\_\_\_  
Proposed NSL ✓ \_\_\_\_\_  
Proposed SWD \_\_\_\_\_  
Proposed WFX \_\_\_\_\_  
Proposed PMX \_\_\_\_\_

Gentlemen:

I have examined the application dated 2-25-83  
for the Capital O & G Corp. SFPRR #80 L-21-16N-6W  
Operator Lease and Well No. Unit, S-T-R

and my recommendations are as follows:

Approve

Yours truly,

Jeff A. Edmister