

NSL 1749
Swells
Rule 104F
No Offsets
Immediate

Shell Oil Company



P.O. Box 991
Houston, Texas 77001

September 27, 1983

State of New Mexico
Energy and Minerals Department
Oil Conservation Division
P. O. Box 2088
Santa Fe, NM 87501

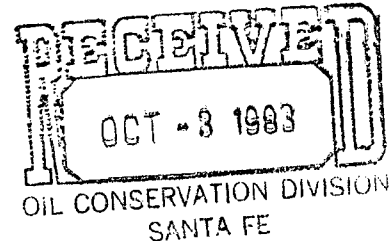

Gentlemen:

SUBJECT: UNORTHODOX LOCATIONS
PROPOSED INFILL PRODUCERS
SHELL - NORTH HOBBS (GB/SA) UNIT
LEA COUNTY, NEW MEXICO

Attached for your approval are NMOCD forms C-101 and C-102 for five infill producers at unorthodox locations within the Shell - North Hobbs (GB/SA) Unit. These producers, whose locations are shown below, will be located less than the minimum 330 feet from 40-acre proration unit boundaries, but are orthodox in all other respects.

WELL NAME & NUMBER	LOCATION	S.T.R.
North Hobbs (G/SA) Unit 24 No. 413	1200' FNL & 160' FEL	24-18S-37E
29 No. 242	100' FSL & 1400' FWL	29-18S-38E
30 No. 312	1392' FNL & 2477' FEL	30-18S-38E
33 No. 142	1250' FSL & 185' FWL	33-18S-38E
33 No. 233	2380' FSL & 2530' FWL	33-18S-38E

Lea County, New Mexico.

The North Hobbs (G/SA) Unit and pressure maintenance project which was authorized by Division Order No. R-6198 and R-6199, became effective February 1, 1980. Currently the Unit is developed by 187 producers and 60 injectors, utilizing a modified 9-spot flood pattern (Figure No. 1). Average daily production amounted to 8900 barrels of oil and 51,700 barrels of water for the month of July 1983. For the same period, water injection averaged 54,800 barrels per day. The Unit development plans as originally proposed, have essentially been completed.

Shell is now investigating the feasibility of developing the central portion of the Unit with a line drive flood pattern. About 85 percent of the wells drilled in the central portion of the Unit are located off-center, usually 330± feet from the lease line. We have reviewed the sweep efficiencies with this off center well configuration and have identified 48± potential infill well locations as shown on Figure No. 2. Our analysis indicates these additional wells will be necessary to recover reserves that cannot be recovered with the existing well pattern. If all 48 locations are drilled, about 20 would be converted to in-

jectors after observing production for one to two years, creating a line drive pattern as illustrated in Figure No. 3.

In order to test the infill potential, five of the 48 locations, as shown on Figure No. 4, have been selected to evaluate:

- 1) potential of individual zones at infill locations
- 2) the existence of permeability trends
- 3) relationship between net pay and productivity.

In our opinion, the location of these wells is necessary to

- 1) achieve optimum waterflood sweep and oil recovery
- 2) provide data to be used in evaluating flood efficiency
- 3) provide drainage and/or injection points at locations with flexibility to adapt to possible future flood plan revisions.

We anticipate the successful completion of the five proposed infill producers will result in the recovery of 780,000 additional barrels of oil.

In our opinion, approval of Shell's proposal is in the interest of conservation and prevention of waste. Amoco Production Company operates the south offsetting proration unit to Well No. 33-142. We have advised Amoco of our plans by copy of this application. Shell operates all other offsetting proration units in this unitized waterflood project. Therefore, there will be no detrimental effects to correlative rights.

Based on the foregoing, we recommend your approval of Shell's proposal to drill five infill producers at unorthodox locations within the boundaries of the North Hobbs (GB/SA) Unit.

Yours very truly,

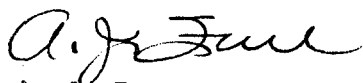

A. J. Fore
Supervisor Regulatory and Permitting
Mid-Continent Division

AJF:dmu

Attachments

cc: State of New Mexico ✓
Energy and Minerals Department
Oil Conservation Division
P. O. Box 1980
Hobbs, NM 88240

Amoco Production Company (USA)
Houston Region-West
501 Westlake Park Boulevard
P. O. Box 3092
Houston, TX 77253

NO. OF COPIES RECEIVED	
DISTRIBUTION	
SANTA FE	
FILE	
U.S.G.S.	
LAND OFFICE	
OPERATOR	

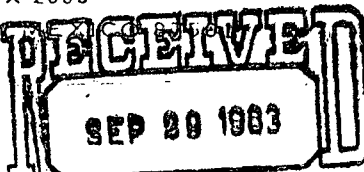

5A. Indicate Type of Lease
STATE ☒ FEE ☐
5. State Oil & Gas Lease No.

APPLICATION FOR PERMIT TO DRILL, DEEPEN, OR PLUG BACK

1a. Type of Work SANTA FE		7. Unit Agreement Name N. HOBBS (G/SA) UNIT	
b. Type of Well DRILL <input checked="" type="checkbox"/> DEEPEN <input type="checkbox"/> PLUG BACK <input type="checkbox"/> OIL WELL <input checked="" type="checkbox"/> GAS WELL <input type="checkbox"/> OTHER <input type="checkbox"/> SINGLE ZONE <input checked="" type="checkbox"/> MULTIPLE ZONE <input type="checkbox"/>		8. Farm or Lease Name SECTION 24	
2. Name of Operator SHELL OIL COMPANY		9. Well No. 413	
3. Address of Operator P. O. BOX 991, HOUSTON, TEXAS 77001		10. Field and Pool, or Wildcat HOBBS (G/SA)	
4. Location of Well UNIT LETTER A LOCATED 1200 FEET FROM THE NORTH LINE AND 160 FEET FROM THE EAST LINE OF SEC. 24 TWP. 18-S RCE. 37-E NMDP		12. County LEA	
11. Elevations (show whether DF, KT, etc.) 3667.24' GL		19. Proposed Depth 4350'	19A. Formation GRAYBURG/ SAN ANDRES
21A. Kind & Status Plug. Bond BLANKET	21B. Drilling Contractor UNKNOWN	20. Rotary or C.T. ROTARY	
		22. Approx. Date Work will start NOVEMBER 1, 1983	

23. PROPOSED CASING AND CEMENT PROGRAM

SIZE OF HOLE	SIZE OF CASING	WEIGHT PER FOOT	SETTING DEPTH	SACKS OF CEMENT	EST. TOP
17-1/2"	13-3/8"	54.5#	40'	50 SX	SURFACE
12-1/4"	8-5/8"	24#	1710'	850 SX	SURFACE
7-7/8"	5-1/2"	14#	4350'	500 SX	1500'

BOP PROGRAM: 3000# REGULAR SERVICE, 3,000# 10" DOUBLE RAM PREVENTER.

IN ABOVE SPACE DESCRIBE PROPOSED PROGRAM; IF PROPOSAL IS TO DEEPEN OR PLUG BACK, GIVE DATA ON PRESENT PRODUCTIVE ZONE AND PROPOSED NEW PRODUCTIVE ZONE. GIVE BLOWOUT PREVENTER PROGRAM, IF ANY.

I hereby certify that the information above is true and complete to the best of my knowledge and belief.

Signed A. J. Fore A. J. FORE Title SUPERVISOR REGULATORY & PERMITS Date SEPTEMBER 27, 1983

(This space for State Use)

APPROVED BY _____ TITLE _____ DATE _____

CONDITIONS OF APPROVAL, IF ANY:

NEW MEXICO OIL CONSERVATION COMMISSION
WELL LOCATION AND ACREAGE DEDICATION PLAT

Form C-102
Supersedes C-128
Effective 1-1-65

All distances must be from the outer boundaries of the Section.

Operator SHELL OIL CO.			Lease N H U		Well No. 24-413
Plot Letter A	Section 24	Township 18 SOUTH	Range 37 EAST	County LEA	
Actual Portage Location of Well: 1200 feet from the NORTH line and 160 feet from the EAST line					
Land Elev. 3667.24	Producing Formation GRAYBURG/SAN ANDRES		Pool HOBBS (GRAYBURG/SAN ANDRES)		Dedicated Acreage 40

- Outline the acreage dedicated to the subject well by colored pencil or hachure marks on the plat below.
- If more than one lease is dedicated to the well, outline each and identify the ownership thereof (both as to working interest and royalty).
- If more than one lease of different ownership is dedicated to the well, have the interests of all owners been consolidated by communitization, unitization, force-pooling, etc?

☒ Yes ☐ No If answer is "yes," type of consolidation UNITIZATION

If answer is "no," list the owners and tract descriptions which have actually been consolidated. (Use reverse side of this form if necessary.)

No allowable will be assigned to the well until all interests have been consolidated (by communitization, unitization, forced-pooling, or otherwise) or until a non-standard unit, eliminating such interests, has been approved by the Commission.

CERTIFICATION

I hereby certify that the information contained herein is true and complete to the best of my knowledge and belief.

Name A. J. FORE
Position SUPERVISOR REG. & PERMITTING
Company SHELL OIL COMPANY
Date SEPTEMBER 27, 1983

I hereby certify that the well location shown on this plat was plotted from field notes of actual surveys made by me or under my supervision, and that the same is true and correct to the best of my knowledge and belief.

Date Surveyed 9-22-83

Registered Professional Engineer and/or Land Surveyor

John W. West

Certificate No. JOHN W. WEST, 676
RONALD J. EIDSON, 3239

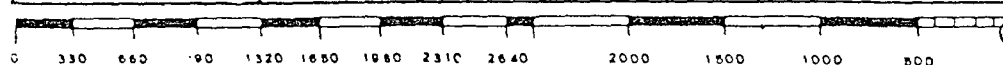

NO. OF COPIES RECEIVED	
DISTRIBUTION	
SANTA FE	
FILE	
U.S.G.S.	
LAND OFFICE	
OPERATOR	

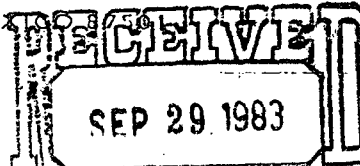

5A. Indicate Type of Lease
STATE ☒ REC ☐
6. State Oil & Gas Lease No.

APPLICATION FOR PERMIT TO DRILL, DEEPEN, OR PLUG BACK

1a. Type of Work DRILL <input checked="" type="checkbox"/> DEEPEN <input type="checkbox"/> PLUG BACK <input type="checkbox"/>		7. Unit Agreement Name N. HOBBS (G/SA) UNIT	
b. Type of Well OIL WELL <input checked="" type="checkbox"/> GAS WELL <input type="checkbox"/> OTHER <input type="checkbox"/>		8. Farm or Lease Name SECTION 29	
2. Name of Operator SHELL OIL COMPANY		9. Well No. 242	
3. Address of Operator P. O. BOX 991, HOUSTON, TEXAS 77001		10. Field and Pool, or Wildcat HOBBS (G/SA)	
4. Location of Well UNIT LETTER N LOCATED 100 FEET FROM THE SOUTH LINE AND 1400 FEET FROM THE WEST LINE OF SEC. 29 TWP. 18-S REC. 38-E NMPA		12. County LEA	
19. Proposed Depth 4350'		19A. Formation GRAYBURG/ SAN ANDRES	
21. Elevations (Show whether DF, RT, etc.) 3638.0' GL		20. Rotary or C.T. ROTARY	
21A. Kind & Status Plug. Bond BLANKET		22. Approx. Date Work will start NOVEMBER 1, 1983	

PROPOSED CASING AND CEMENT PROGRAM

SIZE OF HOLE	SIZE OF CASING	WEIGHT PER FOOT	SETTING DEPTH	SACKS OF CEMENT	EST. TOP
17-1/2"	13-3/8"	54.5#	40'	50 SX	SURFACE
12-1/4"	8-5/8"	24#	1710'	850 SX	SURFACE
7-7/8"	5-1/2"	14#	4350'	500 SX	1500'

BOP PROGRAM: 3,000# REGULAR SERVICE, 3,000# 10" DOUBLE RAM PREVENTER.

IN ABOVE SPACE DESCRIBE PROPOSED PROGRAM; IF PROPOSAL IS TO DEEPEN OR PLUG BACK, GIVE DATA ON PRESENT PRODUCTIVE ZONE AND PROPOSED NEW PRODUCTIVE ZONE. GIVE BLOWOUT PREVENTER PROGRAM, IF ANY.

I hereby certify that the information above is true and complete to the best of my knowledge and belief.

Signed A. J. Fore A. J. FORE Title SUPERVISOR REGULATORY & PERMITS Date SEPTEMBER 27, 1983

(This space for State Use)

APPROVED BY _____ TITLE _____ DATE _____

CONDITIONS OF APPROVAL, IF ANY:

NEW MEXICO OIL CONSERVATION COMMISSION
WELL LOCATION AND ACREAGE DEDICATION PLAT

Form C-102
Supersedes C-128
Effective 1-1-65

All distances must be from the outer boundaries of the Section

Operator SHELL OIL CO.			Lease N H U		Well No. 29-242
Tract Letter N	Section 29	Township 18 SOUTH	Range 38 EAST	County LEA	
Actual Footage Location of Well:					
100 feet from the SOUTH line and		1400 feet from the WEST line			
Ground Level Elev. 3638.0	Producing Formation GRAYBURG/SAN ANDRES	Pool HOBBS (GRAYBURG/SAN ANDRES)		Dedicated Acreage: 40 Acres	

1. Outline the acreage dedicated to the subject well by colored pencil or hatchure marks on the plat below.
2. If more than one lease is dedicated to the well, outline each and identify the ownership thereof (both as to working interest and royalty).
3. If more than one lease of different ownership is dedicated to the well, have the interests of all owners been consolidated by communitization, unitization, force-pooling, etc?

☒ Yes ☐ No If answer is "yes," type of consolidation UNITIZATION

If answer is "no," list the owners and tract descriptions which have actually been consolidated. (Use reverse side of this form if necessary.)

No allowable will be assigned to the well until all interests have been consolidated (by communitization, unitization, forced-pooling, or otherwise) or until a non-standard unit, eliminating such interests, has been approved by the Commission.

CERTIFICATION

I hereby certify that the information contained herein is true and complete to the best of my knowledge and belief.

Name
A. J. Fore **A. J. FORE**
Position

SUPERVISOR REG. & PERMITTING

Company
SHELL OIL COMPANY

Date
SEPTEMBER 27, 1983

I hereby certify that the well location shown on this plat was plotted from field notes of actual surveys made by me or under my supervision, and that the same is true and correct to the best of my knowledge and belief.

Date Surveyed
9-13-83

Registered Professional Engineer and/or Land Surveyor

John W. West

Certificate No. **JOHN W. WEST, 676**
RONALD J. EIDSON, 3239

NO. OF COPIES RECEIVED	
DISTRIBUTION	
SANTA FE	
FILE	
U.S.G.S.	
LAND OFFICE	
OPERATOR	

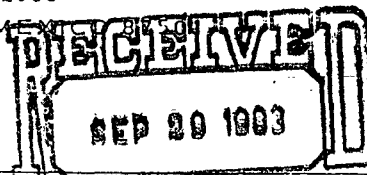

5A. Indicate Type of Lease
STATE ☐ FEE ☒

5. State Oil & Gas Lease No.

APPLICATION FOR PERMIT TO DRILL, DEEPEN, OR PLUG BACK

1a. Type of Work SANTA FE		7. Unit Agreement Name N. HOBBS (G/SA) UNIT
b. Type of Well DRILL <input checked="" type="checkbox"/> DEEPEN <input type="checkbox"/> PLUG BACK <input type="checkbox"/> OIL WELL <input checked="" type="checkbox"/> GAS WELL <input type="checkbox"/> OTHER <input type="checkbox"/> SINGLE ZONE <input checked="" type="checkbox"/> MULTIPLE ZONE <input type="checkbox"/>		8. Farm or Lease Name SECTION 30
2. Name of Operator SHELL OIL COMPANY		9. Well No. 312
3. Address of Operator P. O. BOX 991, HOUSTON, TEXAS 77001		10. Field and Pool, or Wildcat HOBBS (G/SA)
4. Location of Well UNIT LETTER G LOCATED 1392 FEET FROM THE NORTH LINE AND 2477 FEET FROM THE EAST LINE OF SEC. 30 TWP. 18-S RCE. 38-E NMPM		12. County LEA
19. Proposed Depth 4350'		19A. Formation GRAYBURG/ SAN ANDRES
20. Rotary or C.T. ROTARY		
21. Elevations (Show whether DF, RT, etc.) 3652.9' GL	21A. Kind & Status Plug. Bond BLANKET	21B. Drilling Contractor UNKNOWN
22. Approx. Date Work will start NOVEMBER 1, 1983		

PROPOSED CASING AND CEMENT PROGRAM

SIZE OF HOLE	SIZE OF CASING	WEIGHT PER FOOT	SETTING DEPTH	SACKS OF CEMENT	EST. TOP
17-1/2"	13-3/8"	54.5#	40'	50 SX	SURFACE
12-1/4"	8-5/8"	24#	1710'	850 SX	SURFACE
7-7/8"	5-1/2"	14#	4350'	500 SX	SURFACE

BOP PROGRAM: 3,000# REGULAR SERVICE, 3,000# 10" DOUBLE RAM PREVENTER.

IN ABOVE SPACE DESCRIBE PROPOSED PROGRAM; IF PROPOSAL IS TO DEEPEN OR PLUG BACK, GIVE DATA ON PRESENT PRODUCTIVE ZONE AND PROPOSED NEW PRODUCTIVE ZONE. GIVE BLOWOUT PREVENTER PROGRAM, IF ANY.

I hereby certify that the information above is true and complete to the best of my knowledge and belief.

Signed A. J. Fore A. J. FORE Title SUPERVISOR REGULATORY & PERMITS Date SEPTEMBER 27, 1983

(This space for State Use)

APPROVED BY _____ TITLE _____ DATE _____

CONDITIONS OF APPROVAL, IF ANY:

**NEW MEXICO OIL CONSERVATION COMMISSION
WELL LOCATION AND ACREAGE DEDICATION PLAT**

Form C-102
Supersedes C-128
Effective 1-1-65

All distances must be from the outer boundaries of the Section

Operator SHELL OIL CO.			Lessee N H U		Well No. 30-312
Tract Letter G	Section 30	Township 18 SOUTH	Range 38 EAST	County LEA	
Actual Portage Location of Well: 1392 feet from the NORTH line and 2477 feet from the EAST line					
Ground Level Elev. 3652.9	Producing Formation GRAYBURG/SAN ANDRES		Pool HOBBS (GRAYBURG/SAN ANDRES)	Desired Acreage 40 Acres	

- Outline the acreage dedicated to the subject well by colored pencil or hatchure marks on the plat below.
- If more than one lease is dedicated to the well, outline each and identify the ownership thereof (both as to working interest and royalty).
- If more than one lease of different ownership is dedicated to the well, have the interests of all owners been consolidated by communitization, unitization, force-pooling, etc?

☒ Yes ☐ No If answer is "yes," type of consolidation **UNITIZATION**

If answer is "no," list the owners and tract descriptions which have actually been consolidated. (Use reverse side of this form if necessary.) _____

No allowable will be assigned to the well until all interests have been consolidated (by communitization, unitization, forced-pooling, or otherwise) or until a non-standard unit, eliminating such interests, has been approved by the Commission.

CERTIFICATION

I hereby certify that the information contained herein is true and complete to the best of my knowledge and belief.

Name *A. J. Fore* **A. J. FORE**
 Position _____
SUPERVISOR REG. & PERMITTING
 Company _____
SHELL OIL COMPANY
 Date _____
SEPTEMBER 27, 1983

I hereby certify that the well location shown on this plat was plotted from field notes of actual surveys made by me or under my supervision, and that the same is true and correct to the best of my knowledge and belief.

Date Surveyed _____
9-22-83
 Registered Professional Engineer and or Land Surveyor _____

John W. West
 Certificate No **JOHN W. WEST, 676**
RONALD J. EIDSON, 3239



OIL CONSERVATION DIVISION

P. O. BOX 2088

SANTA FE, NEW MEXICO 87501

Form C-101
Revised 10-1-78

NO. OF COPIES RECEIVED	
DISTRIBUTION	
SANTA FE	
FILE	
U.S.G.S.	
LAND OFFICE	
OPERATOR	

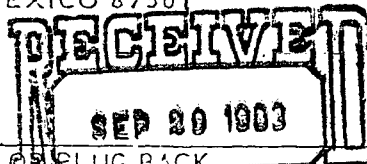

APPLICATION FOR PERMIT TO DRILL, DEEPEN, OR PLUG BACK

1a. Type of Work DRILL <input checked="" type="checkbox"/> DEEPEN <input type="checkbox"/>		OIL CONSERVATION DIVISION SANTA FE PLUG BACK <input type="checkbox"/>		7. Unit Agreement Name N. HOBBS (G/SA) UNIT
b. Type of Well OIL WELL <input checked="" type="checkbox"/> GAS WELL <input type="checkbox"/> OTHER <input type="checkbox"/>		SINGLE ZONE <input checked="" type="checkbox"/> MULTIPLE ZONE <input type="checkbox"/>		8. Farm or Lease Name SECTION 33
2. Name of Operator SHELL OIL COMPANY				9. Well No. 142
3. Address of Operator P. O. BOX 991, HOUSTON, TEXAS 77001				10. Field and Pool, or Wildcat HOBBS (G/SA)
4. Location of Well UNIT LETTER <u>L</u> LOCATED <u>1250</u> FEET FROM THE <u>SOUTH</u> LINE AND <u>185</u> FEET FROM THE <u>WEST</u> LINE OF SEC. <u>33</u> TWP. <u>18-S</u> R. <u>38-E</u> N.M.P.M.				12. County LEA
19. Proposed Depth 4350'		19A. Formation GRAYBURG/ SAN ANDRES		20. Rotary or C.T. ROTARY
21. Elevations (show whether Dr, RT, etc.) 3635.1' GL	21A. Kind & Status Plug. Bond BLANKET	21B. Drilling Contractor UNKNOWN	22. Approx. Date Work will start NOVEMBER 1, 1983	

PROPOSED CASING AND CEMENT PROGRAM

SIZE OF HOLE	SIZE OF CASING	WEIGHT PER FOOT	SETTING DEPTH	SACKS OF CEMENT	EST. TOP
17-1/2"	13-3/8"	54.5#	40'	50 SX	SURFACE
12-1/4"	8-5/8"	24#	1710'	850 SX	SURFACE
7-7/8"	5-1/2"	14#	4350'	500 SX	1500'

BOP PROGRAM: 3,000# REGULAR SERVICE, 3,000# 10" DOUBLE RAM PREVENTER.

IN ABOVE SPACE DESCRIBE PROPOSED PROGRAM; IF PROPOSAL IS TO DEEPEN OR PLUG BACK, GIVE DATA ON PRESENT PRODUCTIVE ZONE AND PROPOSED NEW PRODUCTIVE ZONE. GIVE BLOWOUT PREVENTER PROGRAM, IF ANY.

I hereby certify that the information above is true and complete to the best of my knowledge and belief.

Signed A. J. FORE A. J. FORE Title SUPERVISOR REGULATORY & PERMITS Date SEPTEMBER 27, 1983

(This space for State Use)

APPROVED BY _____ TITLE _____ DATE _____

CONDITIONS OF APPROVAL, IF ANY:

**NEW MEXICO OIL CONSERVATION COMMISSION
WELL LOCATION AND ACREAGE DEDICATION PLAT**

Form C-102
Supersedes C-128
Effective 1-1-85

All distances must be from the outer boundaries of the Section.

Operator SHELL OIL CO.			Lease N H U		Well No. 33-142
Tract Letter L	Section 33	Township 18 SOUTH	Range 38 EAST	County LEA	
Actual Footage Location of Well:					
1250 feet from the		SOUTH	185 feet from the		WEST
Ground Level Elev. 3635.1	Producing Formation GRAYBURG/SAN ANDRES		Pool HOBBS (GRAYBURG/SAN ANDRES)		Dedicated Acreage 40 Acres

1. Outline the acreage dedicated to the subject well by colored pencil or hatchure marks on the plat below.
2. If more than one lease is dedicated to the well, outline each and identify the ownership thereof (both as to working interest and royalty).
3. If more than one lease of different ownership is dedicated to the well, have the interests of all owners been consolidated by communitization, unitization, force-pooling, etc?

☒ Yes ☐ No If answer is "yes:" type of consolidation UNITIZATION

If answer is "no," list the owners and tract descriptions which have actually been consolidated. (Use reverse side of this form if necessary.) _____

No allowable will be assigned to the well until all interests have been consolidated (by communitization, unitization, forced-pooling, or otherwise) or until a non-standard unit, eliminating such interests, has been approved by the Commission.

RECEIVED
SEP 29 1983
OIL CONSERVATION DIVISION
SANTA FE

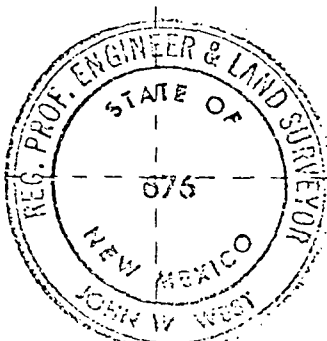

1250' ——— 185'

CERTIFICATION	
I hereby certify that the information contained herein is true and complete to the best of my knowledge and belief.	
Name <i>A. J. Fore</i>	A. J. FORE
Position SUPERVISOR REG. & PERMITTING	
Company SHELL OIL COMPANY	
Date SEPTEMBER 27, 1983	
I hereby certify that the well location shown on this plat was plotted from field notes of actual surveys made by me or under my supervision, and that the same is true and correct to the best of my knowledge and belief.	
Date Surveyed 9-22-83	
Registered Professional Engineer and/or Land Surveyor <i>John W. West</i>	
Certificate No.	676
RONALD J. EIDSON, 3239	

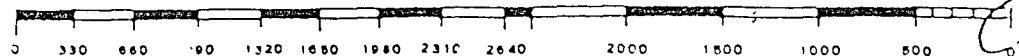

OIL CONSERVATION DIVISION

P. O. BOX 2088

SANTA FE, NEW MEXICO 87501

Form C-101
Revised 10-1-78

NO. OF COPIES RECEIVED	
DISTRIBUTION	
SANTA FE	
FILE	
U.S.G.S.	
LAND OFFICE	
OPERATOR	

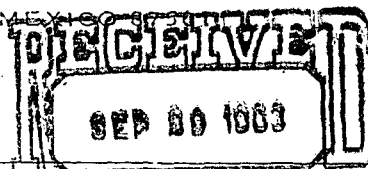

5A. Indicate Type of Lease
STATE ☒ FEE ☐
5. State Oil & Gas Lease No.

APPLICATION FOR PERMIT TO DRILL, DEEPEN OR PLUG BACK
OIL CONSERVATION DIVISION

1A. Type of Work DRILL <input checked="" type="checkbox"/> DEEPEN <input type="checkbox"/> PLUG BACK <input type="checkbox"/>		7. Unit Agreement Name N. HOBBS (G/SA) UNIT
b. Type of Well OIL WELL <input checked="" type="checkbox"/> GAS WELL <input type="checkbox"/> OTHER <input type="checkbox"/>		8. Form or Lease Name SECTION 33
2. Name of Operator SHELL OIL COMPANY		9. Well No. 233
3. Address of Operator P. O. BOX 991, HOUSTON, TEXAS 77001		10. Field and Pool, or Wildcat HOBBS (G/SA)
4. Location of Well UNIT LETTER K LOCATED 2380 FEET FROM THE SOUTH LINE AND 2530 FEET FROM THE WEST LINE OF SEC. 33 TWP. 18-S REC. 38-E NMPW		12. County LEA
19. Proposed Depth 4350'		19A. Formation GRAYBURG/ SAN ANDRES
20. Rotary or C.T. ROTARY		21. Approx. Date Work will start NOVEMBER 1, 1983
1. Elevation (show whether DF, RT, etc.) 3638.8' GL	21A. Kind & Status Plug. Bond BLANKET	21B. Drilling Contractor UNKNOWN

PROPOSED CASING AND CEMENT PROGRAM

SIZE OF HOLE	SIZE OF CASING	WEIGHT PER FOOT	SETTING DEPTH	SACKS OF CEMENT	EST. TOP
17-1/2"	13-3/8"	54.5#	40'	50 SX	SURFACE
12-1/4"	8-5/8"	24#	1710'	850 SX	SURFACE
7-7/8"	5-1/2"	14#	4350'	500 SX	1500'

BOP PROGRAM: 3,000# REGULAR SERVICE, 3,000# 10" DOUBLE RAM PREVENTER.

IN ABOVE SPACE DESCRIBE PROPOSED PROGRAM: IF PROPOSAL IS TO DEEPEN OR PLUG BACK, GIVE DATA ON PRESENT PRODUCTIVE ZONE AND PROPOSED NEW PRODUCTIVE ZONE. GIVE BLOWOUT PREVENTER PROGRAM, IF ANY.

I hereby certify that the information above is true and complete to the best of my knowledge and belief.

Signed A. J. Fore A. J. FORE Title SUPERVISOR REGULATORY & PERMITS Date SEPTEMBER 27, 1983

(This space for State Use)

APPROVED BY _____ TITLE _____ DATE _____

CONDITIONS OF APPROVAL, IF ANY:

NEW MEXICO OIL CONSERVATION COMMISSION
WELL LOCATION AND ACREAGE DEDICATION PLAT

Form C-102
Supersedes C-128
Effective 1-1-65

All distances must be from the outer boundaries of the Section

Operator SHELL OIL CO.		Lease N H U		Well No. 33-233
Tract Letter K	Section 33	Township 18 SOUTH	Range 38 EAST	County LEA
Actual Footage Location of Well: 2380 feet from the SOUTH line and 2530 feet from the WEST line				
Ground Level Elev. 3638.8	Producing Formation GRAYBURG/SAN ANDRES	Pool HOBBS (GRAHBURG/SAN ANDRES)	Designated Acreage: 40 Acres	

1. Outline the acreage dedicated to the subject well by colored pencil or hachure marks on the plat below.
2. If more than one lease is dedicated to the well, outline each and identify the ownership thereof (both as to working interest and royalty).
3. If more than one lease of different ownership is dedicated to the well, have the interests of all owners been consolidated by communitization, unitization, force-pooling, etc?

☒ Yes ☐ No If answer is "yes," type of consolidation UNITIZATION

If answer is "no," list the owners and tract descriptions which have actually been consolidated. (Use reverse side of this form if necessary.) _____

No allowable will be assigned to the well until all interests have been consolidated (by communitization, unitization, forced-pooling, or otherwise) or until a non-standard unit, eliminating such interests, has been approved by the Commission.

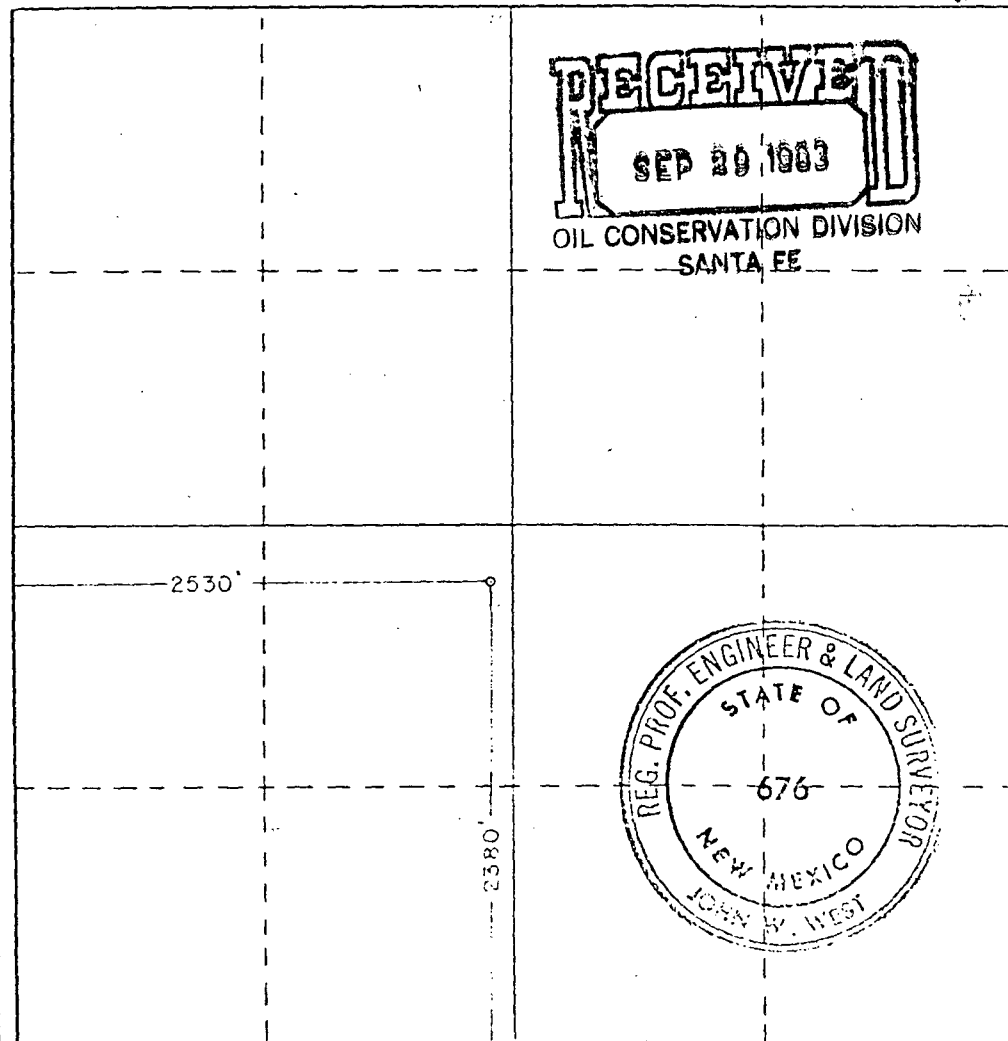

CERTIFICATION

I hereby certify that the information contained herein is true and complete to the best of my knowledge and belief.

Name A. J. FORE
 Position SUPERVISOR REG. & PERMITTING
 Company SHELL OIL COMPANY
 Date SEPTEMBER 27, 1983

I hereby certify that the well location shown on this plat was plotted from field notes of actual surveys made by me or under my supervision, and that the same is true and correct to the best of my knowledge and belief.

Date Surveyed 9-22-83
 Registered Professional Engineer and/or Land Surveyor John W. West
 Certificate No. JOHN W. WEST, 676
RONALD J. EIDSON, 3239

0 330 660 990 1320 1650 1980 2310 2640 2000 1500 1000 500 0

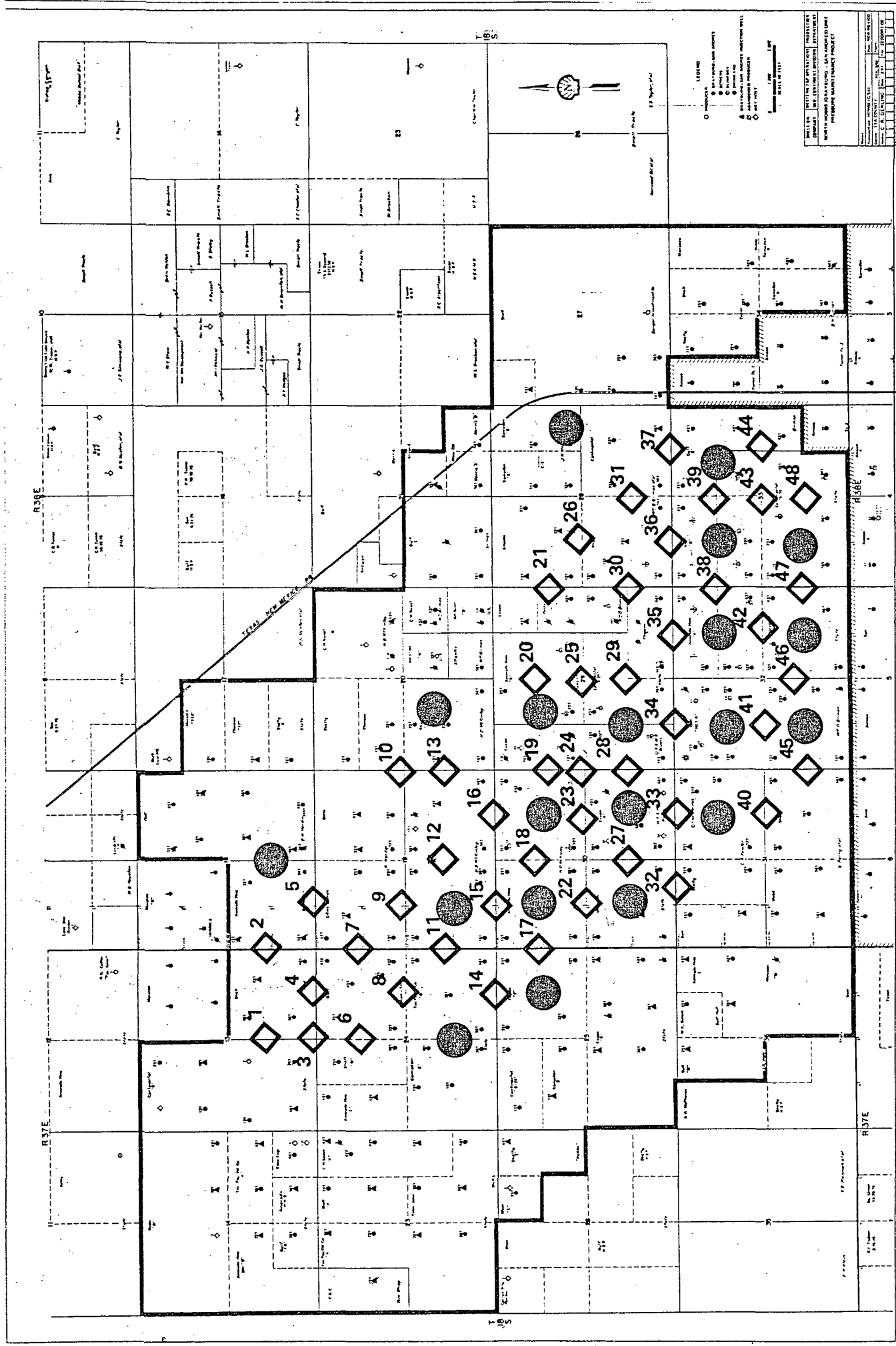
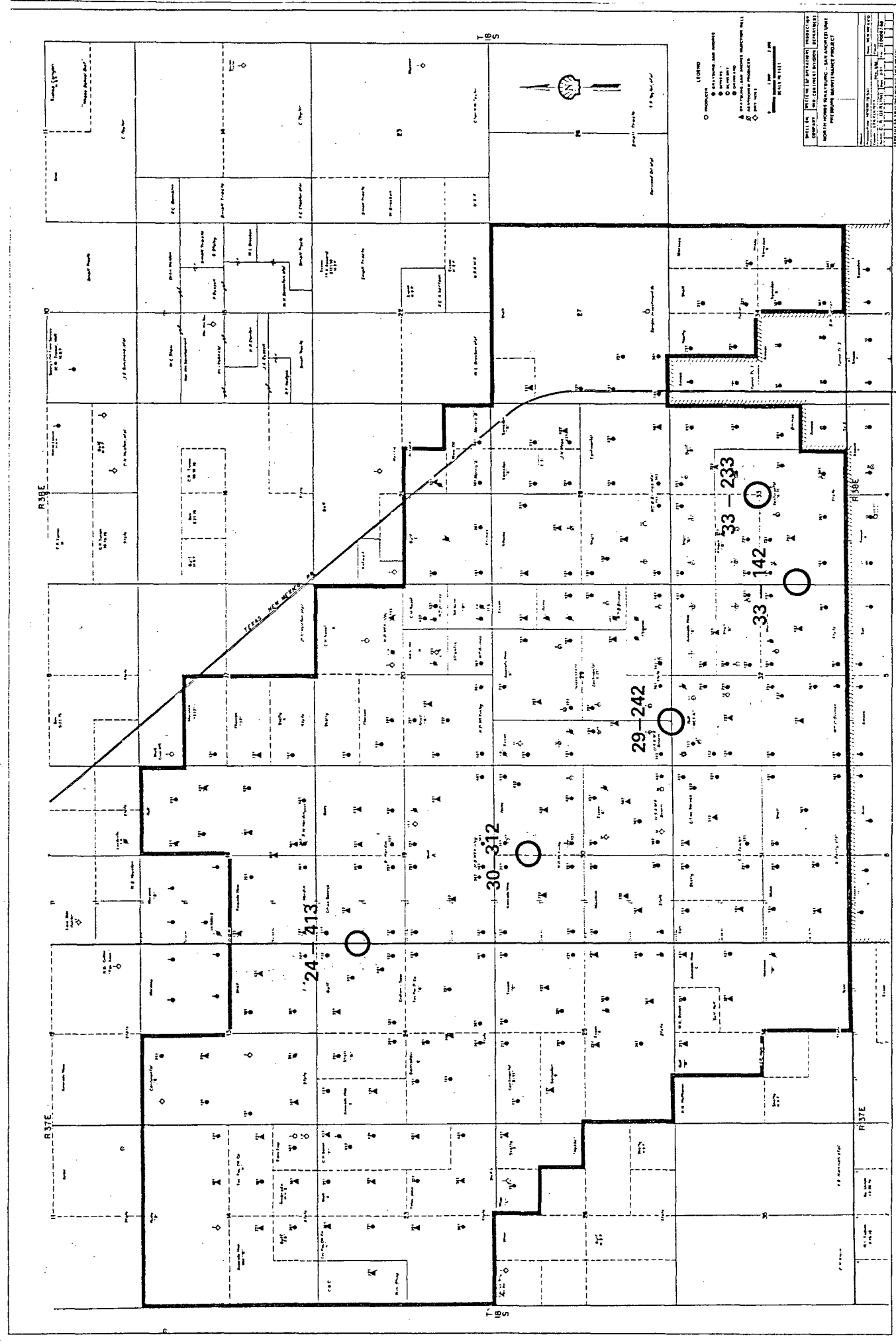

FIGURE 2



PROPOSED 1983 INFILL PRODUCER

Shell Oil Company



November 17, 1983

P.O. Box 991
Houston, Texas 77001

State of New Mexico
Energy and Minerals Department
Oil Conservation Division
P. O. Box 2088
Santa Fe, NM 87501

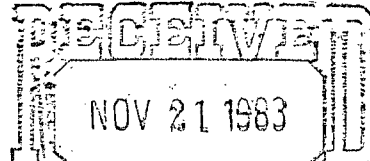

OIL CONSERVATION DIVISION
SANTA FE

Gentlemen:

SUBJECT: ADMINISTRATIVE ORDER NSL-1749
AUTHORIZING UNORTHODOX LOCATIONS FOR
FIVE PROPOSED INFILL PRODUCERS
SHELL - NORTH HOBBS (GB/SA) UNIT
LEA COUNTY, NEW MEXICO

In reference to Administrative Order NSL-1749 dated October 4, 1983, this is to advise you that due to surface use restrictions, well number 30-312 has been moved and the well number changed to 30-223. The present location for well number 30-223 is shown below.

WELL NAME & NUMBER	NEW LOCATION	S.T.R.
North Hobbs (G/SA) Unit No. 223	1770' FNL & 2405' FWL	30-18S-38E.

As stated in our original application dated September 27, 1983, these producers will be located less than the minimum 330 feet from 40-acre proration unit boundaries, but are orthodox in all other respects. We have attached a complete list of all five wells and their present locations.

In as much as the basis of our original application remains unchanged, we recommend your approval of Shell's proposal to drill this infill producer at the amended unorthodox location as show above.

We apologize for any inconvenience caused by these changes.

Yours very truly,

A. J. Fore
Supervisor Regulatory and Permitting
Mid-Continent Division

DMU

Attachments

cc: State of New Mexico
Energy and Minerals Department
Oil Conservation Division
P. O. Box 1980
Hobbs, NM 88240

Amoco Production Company (USA)
Houston Region-West
501 Westlake Park Boulevard
P. O. Box 3092
Houston, TX 77253

SHELL ET AL NORTH HOBBS (G/SA) UNIT
PROPOSED LOCATIONS
NEWLY DRILLED PRODUCERS
LEA COUNTY, NEW MEXICO

TOWNSHIP 18 SOUTH, RANGE 37 EAST, NMPM

<u>SECTION</u>	<u>UNIT WELL NO.</u>	<u>UNIT LETTER</u>	<u>PROPOSED LOCATION</u>
24	413	A	1200' FNL & 206' FEL

TOWNSHIP 18 SOUTH, RANGE 38 EAST, NMPM

<u>SECTION</u>	<u>UNIT WELL NO.</u>	<u>UNIT LETTER</u>	<u>PROPOSED LOCATION</u>
29	242	N	100' FSL & 1400' FWL
30	223	F	1770' FNL & 2405' FWL
33	142	L	1250' FSL & 185' FWL
33	233	K	2380' FSL & 2472' FWL

NO. OF COPIES RECEIVED	
DISTRIBUTION	
SANTA FE	
FILE	
U.S.G.S.	
LAND OFFICE	
OPERATOR	

5A. Indicate Type of Lease
STATE ☐ FEE ☒

5. State Oil & Gas Lease No.

APPLICATION FOR PERMIT TO DRILL, DEEPEN, OR PLUG BACK

1a. Type of Work DRILL <input checked="" type="checkbox"/> DEEPEN <input type="checkbox"/> PLUG BACK <input type="checkbox"/>		7. Unit Agreement Name N. HOBBS (G/SA) UNIT
b. Type of Well OIL WELL <input checked="" type="checkbox"/> GAS WELL <input type="checkbox"/> OTHER <input type="checkbox"/> SINGLE ZONE <input checked="" type="checkbox"/> MULTIPLE ZONE <input type="checkbox"/>		8. Form or Lease Name SECTION 30
2. Name of Operator SHELL OIL COMPANY		9. Well No. 223
3. Address of Operator P. O. BOX 991, HOUSTON, TEXAS 77001		10. Field and Pool, or Wildcat HOBBS (G/SA)
4. Location of Well UNIT LETTER F LOCATED 1770 FEET FROM THE NORTH LINE AND 2405 FEET FROM THE WEST LINE OF SEC. 30 TWP. 18S RGE. 38E NMPM		12. County LEA
19. Proposed Depth 4350'		19A. Formation GRAYBURG/ SAN ANDRES
20. Rotary or C.T. ROTARY		
21. Elevations (Show whether DF, RT, etc.) 3653.4' GL	21A. Kind & Status Plug. Bond BLANKET	21B. Drilling Contractor UNKNOWN
22. Approx. Date Work will start UPON APPROVAL		

PROPOSED CASING AND CEMENT PROGRAM

SIZE OF HOLE	SIZE OF CASING	WEIGHT PER FOOT	SETTING DEPTH	SACKS OF CEMENT	EST. TOP
17-1/2"	13-3/8"	54.5#	40'	50 SX	SURFACE
12-1/4"	8-5/8"	24#	1710'	850 SX	SURFACE
7-7/8"	5-1/2"	14#	4350'	500 SX	1500'

BOP PROGRAM: 3,000# REGULAR SERVICE, 3,000# 10" DOUBLE RAM PREVENTER.

IN ABOVE SPACE DESCRIBE PROPOSED PROGRAM; IF PROPOSAL IS TO DEEPEN OR PLUG BACK, GIVE DATA ON PRESENT PRODUCTIVE ZONE AND PROPOSED NEW PRODUCTIVE ZONE. GIVE BLOWOUT PREVENTER PROGRAM, IF ANY.

I hereby certify that the information above is true and complete to the best of my knowledge and belief.

Signed A. J. FORE Title SUPERVISOR REGULATORY & PERMITS Date NOVEMBER 16, 1983
(This space for State Use)

APPROVED BY _____ TITLE _____ DATE _____
CONDITIONS OF APPROVAL, IF ANY:

**NEW MEXICO OIL CONSERVATION COMMISSION
WELL LOCATION AND ACREAGE DEDICATION PLAT**

Form C-102
Supersedes C-128
Effective 1-1-65

All distances must be from the outer boundaries of the Section.

Operator SHELL OIL COMPANY			Lease NORTH HOBBS UNIT		Well No. 30-223
Unit Letter F	Section 30	Township 18 SOUTH	Range 38 EAST	County LEA	
Actual Footage Location of Well: <div style="display: flex; justify-content: space-between;"> 1770 feet from the NORTH line and 2405 feet from the WEST line </div>					
Ground Level Elev. 3653.4	Producing Formation GRAYBURG/SAN ANDRES	Pool HOBBS (GRAYBURG/SAN ANDRES)	Dedicated Acreage: 40 Acres		

1. Outline the acreage dedicated to the subject well by colored pencil or hachure marks on the plat below.
2. If more than one lease is dedicated to the well, outline each and identify the ownership thereof (both as to working interest and royalty).
3. If more than one lease of different ownership is dedicated to the well, have the interests of all owners been consolidated by communitization, unitization, force-pooling, etc?

☒ Yes ☐ No If answer is "yes," type of consolidation UNITIZATION

If answer is "no," list the owners and tract descriptions which have actually been consolidated. (Use reverse side of this form if necessary.) _____

No allowable will be assigned to the well until all interests have been consolidated (by communitization, unitization, forced-pooling, or otherwise) or until a non-standard unit, eliminating such interests, has been approved by the Commission.

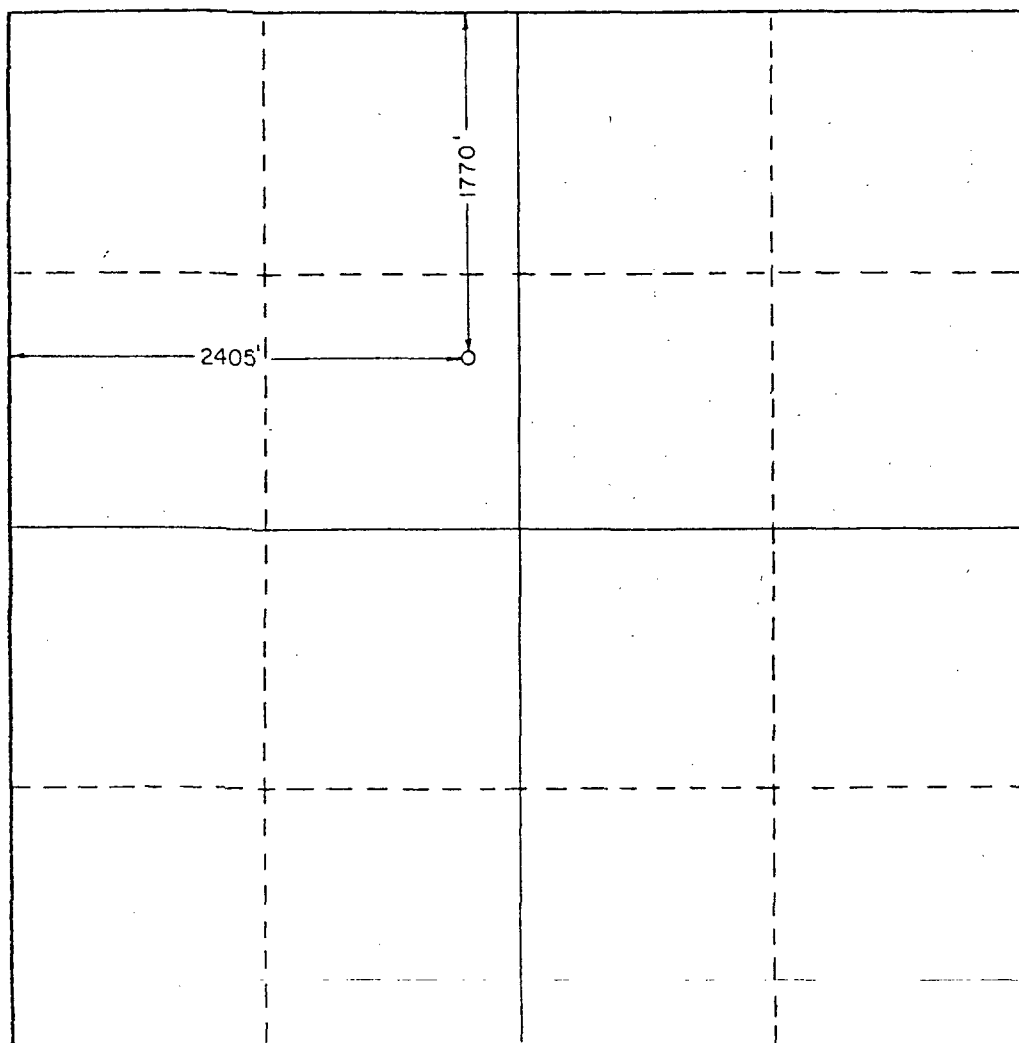

CERTIFICATION

I hereby certify that the information contained herein is true and complete to the best of my knowledge and belief.

[Signature]

Name	FORE
Position	SUPERVISOR REG. & PERMITTING
Company	SHELL OIL COMPANY
Date	NOVEMBER 16, 1983

I hereby certify that the well location shown on this plat was plotted from field notes of actual surveys made by me or under my supervision, and that the same is true and correct to the best of my knowledge and belief.

Date Surveyed
NOVEMBER 7, 1983

Registered Professional Engineer
and/or Land Surveyor

[Signature]

Certificate No. **JOHN W. WEST, 676**
RONALD J. EIDSON, 3239

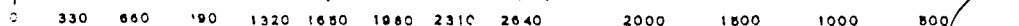

Shell Oil Company



P.O. Box 991
Houston, Texas 77001

October 27, 1983

City of Hobbs
ATTN: Mr. Ken Martin, City Manager
300 North Turner
Hobbs, NM 88240

Dear Ken:

SUBJECT: PROPOSED INFILL PRODUCERS
SHELL - NORTH HOBBS (GB/SA) UNIT
HOBBS (GB/SA) FIELD
LEA COUNTY, NEW MEXICO

In reference to our previous correspondence dated October 11, 1983 regarding the subject unit, this is to advise you that two of the proposed locations have been moved due to surface use restrictions. The remaining three locations remain unchanged. The well number and their new locations are shown below.

<u>WELL NAME & NUMBER</u>	<u>NEW LOCATION</u>	<u>S.T.R.</u>
North Hobbs (GB/SA) Unit 24 No. 413	1200' FNL & 206' FEL Moved 56' West	24-18S-37E
33 No. 233 *	2380' FSL & 2472' FWL Moved 58' West	33-18S-38E

(* denotes well located within the City of Hobbs)
Lea County, New Mexico.

We apologize for any inconvenience caused by these changes.

Yours very truly,

A handwritten signature in dark ink, appearing to read "A. J. Fore".

A. J. Fore
Supervisor Regulatory and Permitting
Mid-Continent Division

DMU

cc: State of New Mexico ✓
Energy and Minerals Department
Oil Conservation Division
P. O. Box 2088
Santa Fe, NM 87501

State of New Mexico
Energy and Minerals Department
Oil Conservation Division
P. O. Box 1980
Hobbs, NM 88240

Shell Oil Company



October 27, 1983

P.O. Box 991
Houston, Texas 77001

State of New Mexico
Energy and Minerals Department
Oil Conservation Division
P. O. Box 2088
Santa Fe, NM 87501

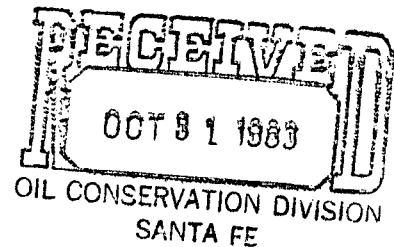

Gentlemen:

SUBJECT: ADMINISTRATIVE ORDER NSL-1749
AUTHORIZING UNORTHODOX LOCATIONS FOR
FIVE PROPOSED INFILL PRODUCERS
SHELL - NORTH HOBBS (GB/SA) UNIT
LEA COUNTY, NEW MEXICO

In reference to Administrative Order NSL-1749 dated October 4, 1983, this is to advise you that due to surface use restrictions, two of the locations have been moved. The remaining three locations remain unchanged. As stated in our original application dated September 27, 1983, these producers will be located less than the minimum 330 feet from 40-acre proration unit boundaries, but are orthodox in all other respects. The locations of the wells are shown below.

<u>WELL NAME & NUMBER</u>	<u>NEW LOCATION</u>	<u>S.T.R.</u>
North Hobbs (G/SA) Unit 24 No. 413	1200' FNL & <u>206'</u> FEL Moved 56' West	24-18S-37E
33 No. 233	2380' FSL & <u>2472'</u> FWL Moved 58' West	33-18S-38E

Lea County, New Mexico.

In as much as the basis of our original application remains unchanged, we recommend your approval of Shell's proposal to drill these two infill producers at the amended unorthodox locations as shown above.

We apologize for any inconvenience caused by these changes.

Yours very truly,

for/A. J. Fore
Supervisor Regulatory and Permitting
Mid-Continent Division

DMU

Attachments

P. O. BOX 2083
SANTA FE, NEW MEXICO 87501

Form C-101
Revised 10-1-78

NO. OF COPIES RECEIVED	
DISTRIBUTION	
SANTA FE	
FILE	
U.S.G.S.	
LAND OFFICE	
OPERATOR	

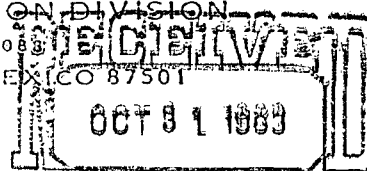

OIL CONSERVATION DIVISION
SANTA FE

5A. Indicate Type of Lease

STATE ☒ FEE ☐

5. State Oil & Gas Lease No.

APPLICATION FOR PERMIT TO DRILL, DEEPEN, OR PLUG BACK

1a. Type of Work DRILL <input checked="" type="checkbox"/> DEEPEN <input type="checkbox"/> PLUG BACK <input type="checkbox"/>		7. Unit Agreement Name N. HOBBS (G/SA) UNIT
b. Type of Well OIL WELL <input checked="" type="checkbox"/> GAS WELL <input type="checkbox"/> OTHER <input type="checkbox"/>		8. Farm or Lease Name SECTION 24
2. Name of Operator SHELL OIL COMPANY		9. Well No. 413
3. Address of Operator P. O. BOX 991, HOUSTON, TEXAS 77001		10. Field and Pool, or Wildcat HOBBS (G/SA)
4. Location of Well UNIT LETTER <u>A</u> LOCATED <u>1200</u> FEET FROM THE <u>NORTH</u> LINE AND <u>206</u> FEET FROM THE <u>EAST</u> LINE OF SEC. <u>24</u> TWP. <u>18-S</u> RGE. <u>37-E</u> NMPM		12. County LEA
19. Proposed Depth 4350'		19A. Formation GRAYBURG/ SAN ANDRES
20. Rotary or C.T. ROTARY		
21. Elevations (Show whether DF, RT, etc.) 3667.24' GL	21A. Kind & Status Plug, Bond BLANKET	21B. Drilling Contractor UNKNOWN
22. Approx. Date Work will start UPON APPROVAL		

PROPOSED CASING AND CEMENT PROGRAM

SIZE OF HOLE	SIZE OF CASING	WEIGHT PER FOOT	SETTING DEPTH	SACKS OF CEMENT	EST. TOP
17-1/2"	13-3/8"	54.5#	40'	50 SX	SURFACE
12-1/4"	8-5/8"	24#	1710'	850 SX	SURFACE
7-7/8"	5-1/2"	14#	4350'	500 SX	1500'

BOP PROGRAM: 3000# REGULAR SERVICE, 3,000# 10" DOUBLE RAM PREVENTER.

IN ABOVE SPACE DESCRIBE PROPOSED PROGRAM; IF PROPOSAL IS TO DEEPEN OR PLUG BACK, GIVE DATA ON PRESENT PRODUCTIVE ZONE AND PROPOSED NEW PRODUCTIVE ZONE. GIVE BLOWOUT PREVENTER PROGRAM, IF ANY.

I hereby certify that the information above is true and complete to the best of my knowledge and belief.

Signed A. J. FORE Title SUPERVISOR REG. & PERMITTING Date OCTOBER 27, 1983
(This space for State Use)

APPROVED BY _____ TITLE _____ DATE _____
CONDITIONS OF APPROVAL, IF ANY:

**NEW MEXICO OIL CONSERVATION COMMISSION
WELL LOCATION AND ACREAGE DEDICATION PLAT**

Form C-102
Supersedes C-128
Effective 1-1-65

All distances must be from the outer boundaries of the Section.

Operator SHELL OIL CO.			Lease NHU			Well No. 24-413		
Tract Letter A	Section 24	Township 18 SOUTH	Range 37 EAST	County LEA				
Actual Footage Location of Well: 1200 feet from the NORTH line and 206 feet from the EAST line								
Ground Level Elev. 3667.24	Producing Formation GRAYBURG/SAN ANDRES		Pool HOBBS (GRAYBURG/SAN ANDRES)			Dedicated Acreage: 40 Acres		

1. Outline the acreage dedicated to the subject well by colored pencil or hatchure marks on the plat below.
2. If more than one lease is dedicated to the well, outline each and identify the ownership thereof (both as to working interest and royalty).
3. If more than one lease of different ownership is dedicated to the well, have the interests of all owners been consolidated by communitization, unitization, force-pooling, etc?

☒ Yes ☐ No If answer is "yes," type of consolidation UNITIZATION

If answer is "no," list the owners and tract descriptions which have actually been consolidated. (Use reverse side of this form if necessary.) _____

No allowable will be assigned to the well until all interests have been consolidated (by communitization, unitization, forced-pooling, or otherwise) or until a non-standard unit, eliminating such interests, has been approved by the Commission.

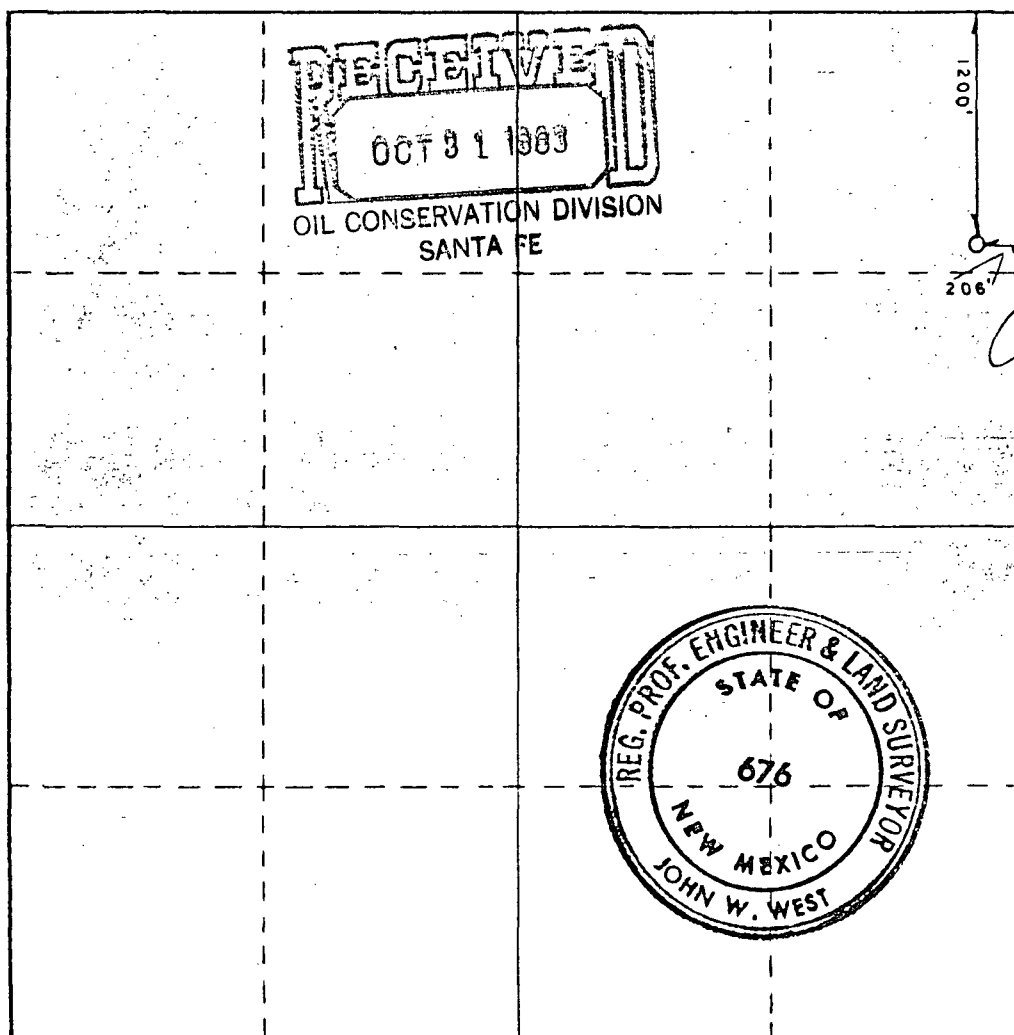

CERTIFICATION

I hereby certify that the information contained herein is true and complete to the best of my knowledge and belief.

Name A. J. FORE
 Position SUPERVISOR REG. & PERMITTING
 Company SHELL OIL COMPANY
 Date OCTOBER 27, 1983

I hereby certify that the well location shown on this plat was plotted from field notes of actual surveys made by me or under my supervision, and that the same is true and correct to the best of my knowledge and belief.

Date Surveyed
OCTOBER 21, 1983

Registered Professional Engineer and/or Land Surveyor

Certificate No. JOHN W. WEST, 676
RONALD J. EIDSON, 3239

NO. OF COPIES RECEIVED	
DISTRIBUTION	
SANTA FE	
FILE	
U.S.G.S.	
LAND OFFICE	
OPERATOR	

P. O. BOX 208
SANTA FE, NEW MEXICO 87501

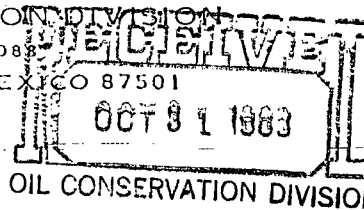

5A. Indicate Type of Lease
STATE ☒ FCC ☐
6. State Oil & Gas Lease No.

OIL CONSERVATION DIVISION
SANTA FE

APPLICATION FOR PERMIT TO DRILL, DEEPEN, OR PLUG BACK

1a. Type of Work b. Type of Well OIL WELL <input checked="" type="checkbox"/> GAS WELL <input type="checkbox"/> OTHER <input type="checkbox"/> SINGLE ZONE <input checked="" type="checkbox"/> MULTIPLE ZONE <input type="checkbox"/>		7. Unit Agreement Name N. HOBBS (G/SA) UNIT 8. Farm or Lease Name SECTION 29 9. Well No. 242 10. Field and Pool, or Wildcat HOBBS (G/SA) 12. County LEA	
2. Name of Operator SHELL OIL COMPANY 3. Address of Operator P. O. BOX 991, HOUSTON, TEXAS 77001 4. Location of Well UNIT LETTER N LOCATED 100 FEET FROM THE SOUTH LINE AND 1400 FEET FROM THE WEST LINE OF SEC. 29 TWP. 18-S RCE. 38-E NMPM			
19. Proposed Depth 4350'		19A. Formation GRAYBURG/ SAN ANDRES 20. Rotary or C.T. ROTARY	
21. Elevations (Show whether DF, RT, etc.) 3638.0' GI		21A. Kind & Status Plug. Bond BLANKET 21B. Drilling Contractor UNKNOWN 22. Approx. Date Work will start UPON APPROVAL	

23. PROPOSED CASING AND CEMENT PROGRAM

SIZE OF HOLE	SIZE OF CASING	WEIGHT PER FOOT	SETTING DEPTH	SACKS OF CEMENT	EST. TOP
17-1/2"	13-3/8"	54.5#	40'	50 SX	SURFACE
12-1/4"	8-5/8"	24#	1710'	850 SX	SURFACE
7-7/8"	5-1/2"	14#	4350'	500 SX	1500'

BOP PROGRAM: 3,000# REGULAR SERVICE, 3,000# 10" DOUBLE RAM PREVENTER.

IN ABOVE SPACE DESCRIBE PROPOSED PROGRAM; IF PROPOSAL IS TO DEEPEN OR PLUG BACK, GIVE DATA ON PRESENT PRODUCTIVE ZONE AND PROPOSED NEW PRODUCTIVE ZONE, GIVE BLOWOUT PREVENTER PROGRAM, IF ANY.

I hereby certify that the information above is true and complete to the best of my knowledge and belief.

Signed A. J. FORE Title SUPERVISOR REGULATORY & PERMITS Date OCTOBER 27, 1983

(This space for State Use)

APPROVED BY _____ TITLE _____ DATE _____

CONDITIONS OF APPROVAL, IF ANY:

**NEW MEXICO OIL CONSERVATION COMMISSION
WELL LOCATION AND ACREAGE DEDICATION PLAT**

Form C-102
Supersedes C-128
Effective 1-1-65

All distances must be from the outer boundaries of the Section.

Operator SHELL - OIL CO.		Lease N H U		Well No. 29-242
Tract Letter N	Section 29	Township 18 SOUTH	Range 38 EAST	County LEA

Actual Footage Location of Well:

100 feet from the **SOUTH** line and **1400** feet from the **WEST** line

Ground Level Elev. 3638.0	Producing Formation GRAYBURG/SAN ANDRES	Pool HOBBS (GRAYBURG/SAN ANDRES)	Dedicated Acreage 40 Acres
-------------------------------------	---	--	--------------------------------------

1. Outline the acreage dedicated to the subject well by colored pencil or hachure marks on the plat below.
2. If more than one lease is dedicated to the well, outline each and identify the ownership thereof (both as to working interest and royalty).
3. If more than one lease of different ownership is dedicated to the well, have the interests of all owners been consolidated by communitization, unitization, force-pooling, etc?

☒ Yes ☐ No If answer is "yes," type of consolidation **UNITIZATION**

If answer is "no," list the owners and tract descriptions which have actually been consolidated. (Use reverse side of this form if necessary.) _____

No allowable will be assigned to the well until all interests have been consolidated (by communitization, unitization, forced-pooling, or otherwise) or until a non-standard unit, eliminating such interests, has been approved by the Commission.

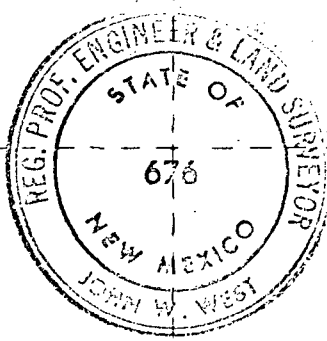
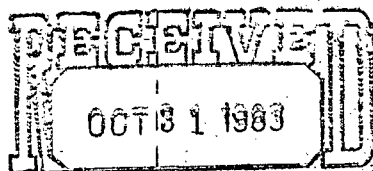

CERTIFICATION

I hereby certify that the information contained herein is true and complete to the best of my knowledge and belief.

Signature: *A. J. Fore*
Position: **SUPERVISOR REG. & PERMITTING**
Company: **SHELL OIL COMPANY**
Date: **OCTOBER 27, 1983**

I hereby certify that the well location shown on this plat was plotted from field notes of actual surveys made by me or under my supervision, and that the same is true and correct to the best of my knowledge and belief.

Date Surveyed: **9-13-83**
Registered Professional Engineer and/or Land Surveyor:
Signature: *John W. West*
Certificate No. **JOHN W. WEST, 676**
RONALD J. EIDSON, 3239

OIL CONSERVATION DIVISION

P. O. BOX 2088
SANTA FE, NEW MEXICO 87501

Form C-101
Revised 10-1-78

NO. OF COPIES RECEIVED	
DISTRIBUTION	
SANTA FE	
FILE	
U.S.C.S.	
LAND OFFICE	
OPERATOR	

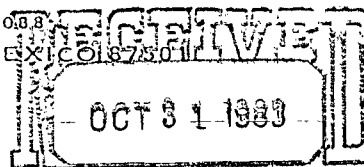

OIL CONSERVATION DIVISION

APPLICATION FOR PERMIT TO DRILL, DEEPEN, OR PLUG SANTA FE

1a. Type of Work DRILL <input checked="" type="checkbox"/> DEEPEN <input type="checkbox"/> PLUG BACK <input type="checkbox"/>		7. Unit Agreement Name N. HOBBS (G/SA) UNIT
b. Type of Well OIL WELL <input checked="" type="checkbox"/> GAS WELL <input type="checkbox"/> OTHER <input type="checkbox"/> SINGLE ZONE <input checked="" type="checkbox"/> MULTIPLE ZONE <input type="checkbox"/>		8. Farm or Lease Name SECTION 30
2. Name of Operator SHELL OIL COMPANY		9. Well No. 312
3. Address of Operator P. O. BOX 991, HOUSTON, TEXAS 77001		10. Field and Pool, or Wildcat HOBBS (G/SA)
4. Location of Well UNIT LETTER G LOCATED 1392 FEET FROM THE NORTH LINE AND 2477 FEET FROM THE EAST LINE OF SEC. 30 TWP. 18-S RGE. 38-E NMDM		12. County LEA
19. Proposed Depth 4350'		19A. Formation GRAYBURG/ SAN ANDRES
20. Rotary or C.T. ROTARY		
21. Elevations (Show whether DF, RT, etc.) 3652.9' GL	21A. Kind & Status Plug. Bond BLANKET	21B. Drilling Contractor UNKNOWN
22. Approx. Date Work will start UPON APPROVAL		

PROPOSED CASING AND CEMENT PROGRAM

SIZE OF HOLE	SIZE OF CASING	WEIGHT PER FOOT	SETTING DEPTH	SACKS OF CEMENT	EST. TOP
17-1/2"	13-3/8"	54.5#	40'	50 SX	SURFACE
12-1/4"	8-5/8"	24#	1710'	850 SX	SURFACE
7-7/8"	5-1/2"	14#	4350'	500 SX	1500'

BOP PROGRAM: 3,000# REGULAR SERVICE, 3,000# 10" DOUBLE RAM PREVENTER.

IN ABOVE SPACE DESCRIBE PROPOSED PROGRAM: IF PROPOSAL IS TO DEEPEN OR PLUG BACK, GIVE DATA ON PRESENT PRODUCTIVE ZONE AND PROPOSED NEW PRODUCTIVE ZONE. GIVE BLOWOUT PREVENTER PROGRAM, IF ANY.

I hereby certify that the information above is true and complete to the best of my knowledge and belief.

Signed A. J. FORE Title SUPERVISOR REG. & PERMITS Date OCTOBER 27, 1983

(This space for State Use)

APPROVED BY _____ TITLE _____ DATE _____

CONDITIONS OF APPROVAL, IF ANY:

**NEW MEXICO OIL CONSERVATION COMMISSION
WELL LOCATION AND ACREAGE DEDICATION PLAT**

Form C-102
Supersedes C-128
Effective 1-1-65

All distances must be from the outer boundaries of the Section

Operator SHELL OIL CO.			Lease N H U		Well No. 30-312
Tract Letter G	Section 30	Township 18 SOUTH	Range 38 EAST	County LEA	
Actual Footage Location of Well:					
1392		NORTH		2477	
feet from the		line and		feet from the	
3652.9		GRAYBURG/SAN ANDRES		40	
Ground Level Elev.		Producing Formation		Dedicated Acreage	
3652.9		GRAYBURG/SAN ANDRES		40	
		Pool		Area	
		HOBBS (GRAYBURG/SAN ANDRES)			

1. Outline the acreage dedicated to the subject well by colored pencil or hatchure marks on the plat below.
2. If more than one lease is dedicated to the well, outline each and identify the ownership thereof (both as to working interest and royalty).
3. If more than one lease of different ownership is dedicated to the well, have the interests of all owners been consolidated by communitization, unitization, force-pooling, etc?

☒ Yes ☐ No If answer is "yes," type of consolidation UNITIZATION

If answer is "no," list the owners and tract descriptions which have actually been consolidated. (Use reverse side of this form if necessary.) _____

No allowable will be assigned to the well until all interests have been consolidated (by communitization, unitization, forced-pooling, or otherwise) or until a non-standard unit, eliminating such interests, has been approved by the Commission.

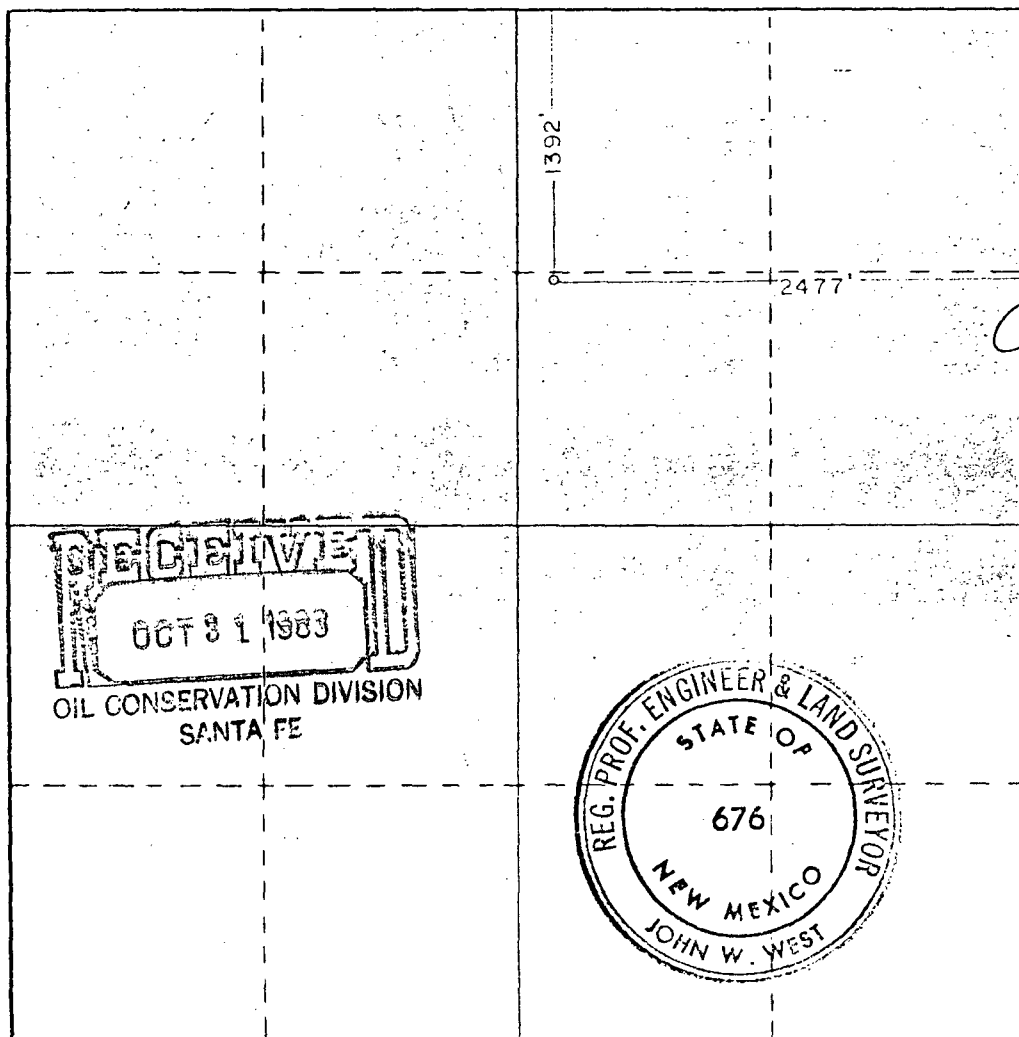

NO. OF COPIES RECEIVED	
DISTRIBUTION	
SANTA FE	
FILE	
U.S.G.S.	
LAND OFFICE	
OPERATOR	

5A. Indicate Type of Lease
STATE ☒ REC ☐
5. State Oil & Gas Lease No.

APPLICATION FOR PERMIT TO DRILL, DEEPEN, OR PLUG BACK

7. Unit Agreement Name
N. HOBBS (G/SA) UNIT

8. Farm or Lease Name
SECTION 33

9. Well No.
142

10. Field and Pool, or Wildcat
HOBBS (G/SA)

12. County
LEA

19. Proposed Depth
4350'

19A. Formation
GRAYBURG/
SAN ANDRES

20. Rotary or C.T.
ROTARY

21. Elevations (show whether DF, RT, etc.)
3635.1' GL

21A. Kind & Sictus Plug. Bond
BLANKET

21B. Drilling Contractor
UNKNOWN

22. Approx. Date Work will start
UPON APPROVAL

23. PROPOSED CASING AND CEMENT PROGRAM

SIZE OF HOLE	SIZE OF CASING	WEIGHT PER FOOT	SETTING DEPTH	SACKS OF CEMENT	EST. TOP
17-1/2"	13-3/8"	54.5#	40'	50 SX	SURFACE
12-1/4"	8-5/8"	24#	1710'	850 SX	SURFACE
7-7/8"	5-1/2"	14#	4350'	500 SX	1500'

BOP PROGRAM: 3,000# REGULAR SERVICE, 3,000# DOUBLE RAM PREVENTER

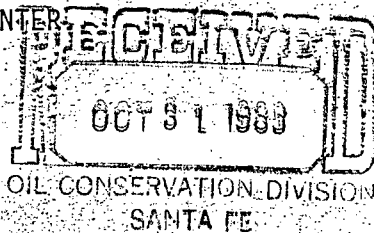

IN ABOVE SPACE DESCRIBE PROPOSED PROGRAM; IF PROPOSAL IS TO DEEPEN OR PLUG BACK, GIVE DATA ON PRESENT PRODUCTIVE ZONE AND PROPOSED NEW PRODUCTIVE ZONE. GIVE BLOWOUT PREVENTER PROGRAM, IF ANY.

I hereby certify that the information above is true and complete to the best of my knowledge and belief.

Signed A. J. FORE Title SUPERVISOR REG. & PERMITTING Date OCTOBER 27, 1983
(This space for State Use)

APPROVED BY _____ TITLE _____ DATE _____
CONDITIONS OF APPROVAL, IF ANY:

**NEW MEXICO OIL CONSERVATION COMMISSION
WELL LOCATION AND ACREAGE DEDICATION PLAT**

Form C-102
Supersedes C-128
Effective 1-1-65

All distances must be from the outer boundaries of the Section

Operator SHELL OIL CO.		Lease N H U		Well No. 33-142
Unit Letter L	Section 33	Township 18 SOUTH	Range 38 EAST	County LEA
Actual Footage Location of Well: 1250 feet from the SOUTH line and 185 feet from the WEST line				
Ground Level Elev. 3635.1	Producing Formation GRAYBURG/SAN ANDRES		Pool HOBBS (GRAYBURG/SAN ANDRES)	Dedicated Acreage: 40 Acres

1. Outline the acreage dedicated to the subject well by colored pencil or hachure marks on the plat below.
2. If more than one lease is dedicated to the well, outline each and identify the ownership thereof (both as to working interest and royalty).
3. If more than one lease of different ownership is dedicated to the well, have the interests of all owners been consolidated by communitization, unitization, force-pooling, etc?

☒ Yes ☐ No If answer is "yes," type of consolidation **UNITIZATION**

If answer is "no," list the owners and tract descriptions which have actually been consolidated. (Use reverse side of this form if necessary.) _____

No allowable will be assigned to the well until all interests have been consolidated (by communitization, unitization, forced-pooling, or otherwise) or until a non-standard unit, eliminating such interests, has been approved by the Commission.

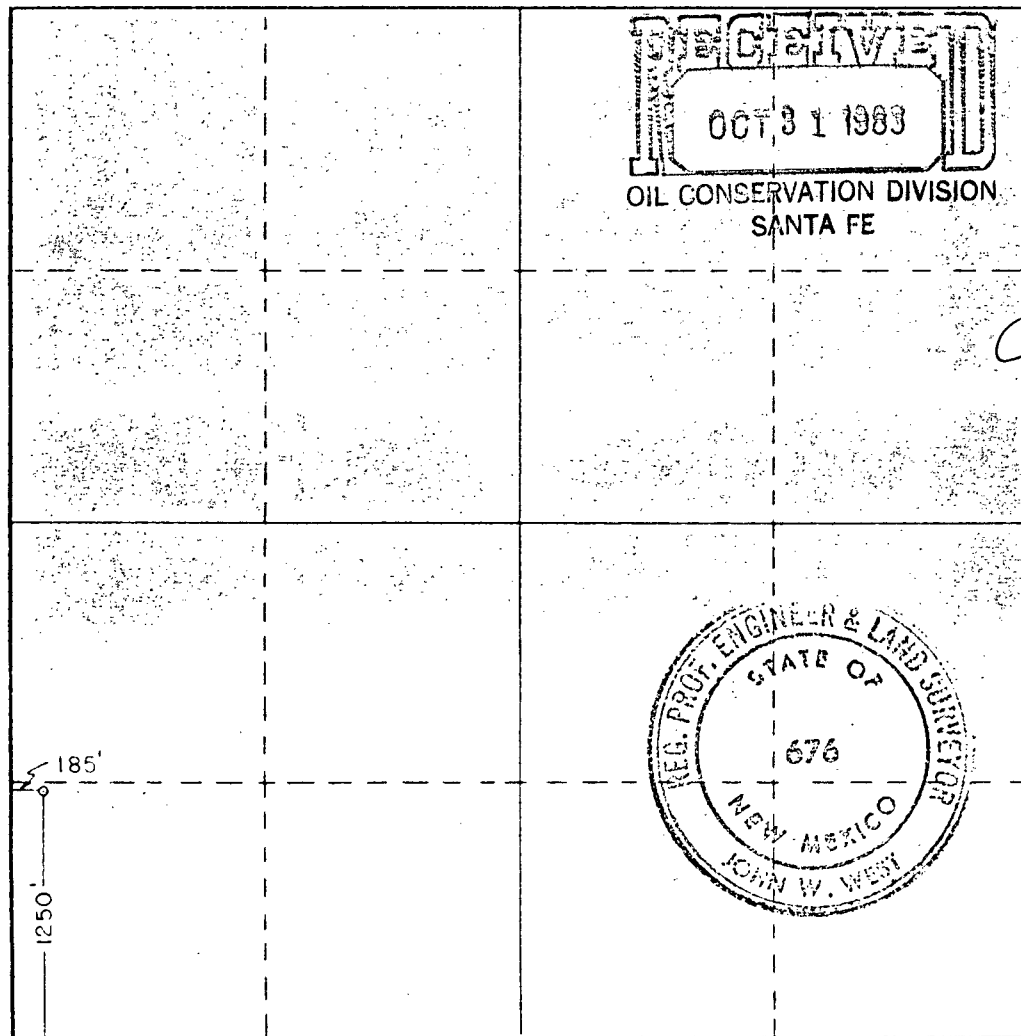

CERTIFICATION

I hereby certify that the information contained herein is true and complete to the best of my knowledge and belief.

Name **A. J. FORE**
Position **SUPERVISOR REG. & PERMITTING**

Company
SHELL OIL COMPANY

Date
OCTOBER 27, 1983

I hereby certify that the well location shown on this plat was plotted from field notes of actual surveys made by me or under my supervision, and that the same is true and correct to the best of my knowledge and belief.

Date Surveyed
9-22-83

Registered Professional Engineer and/or Land Surveyor

John W. West
Certificate No. **JOHN W. WEST, 676**
RONALD J. EIDSON, 3239



NO. OF COPIES RECEIVED	
DISTRIBUTION	
SANTA FE	
FILE	
U.S.G.S.	
LAND OFFICE	
OPERATOR	

5A. Indicate Type of Lease
STATE ☒ FEDERAL ☐
5. State Oil & Gas Lease No.

APPLICATION FOR PERMIT TO DRILL, DEEPEN, OR PLUG BACK

1a. Type of Work DRILL <input checked="" type="checkbox"/> DEEPEN <input type="checkbox"/> PLUG BACK <input type="checkbox"/>		7. Unit Agreement Name N. HOBBS (G/SA) UNIT
b. Type of Well OIL WELL <input checked="" type="checkbox"/> GAS WELL <input type="checkbox"/> OTHER <input type="checkbox"/> SINGLE ZONE <input checked="" type="checkbox"/> MULTIPLE ZONE <input type="checkbox"/>		8. Form or Lease Name SECTION 33
2. Name of Operator SHELL OIL COMPANY		9. Well No. 233
3. Address of Operator P. O. BOX 991, HOUSTON, TEXAS 77001		10. Field and Pool, or Wildcat HOBBS (G/SA)
4. Location of Well UNIT LETTER K LOCATED 2380 FEET FROM THE SOUTH LINE AND 2472 FEET FROM THE WEST LINE OF SEC. 33 TWP. 18-S RGC. 38-E NMPM		12. County LEA
19. Proposed Depth 4350'		19A. Formation GRAYBURG/ SAN ANDRES
20. Rotary or C.T. ROTARY		21. Elevations (Show whether D.F., K.T., etc.) 3638.8' GL
21A. Kind & Status Plug. Bond BLANKET		21B. Drilling Contractor UNKNOWN
22. Approx. Date Work will start UPON APPROVAL		

PROPOSED CASING AND CEMENT PROGRAM

SIZE OF HOLE	SIZE OF CASING	WEIGHT PER FOOT	SETTING DEPTH	SACKS OF CEMENT	EST. TOP
17-1/2"	13-3/8"	54.5#	40'	50 SX	SURFACE
12-1/4"	8-5/8"	24#	1710'	850 SX	SURFACE
7-7/8"	5-1/2"	14#	4350'	500 SX	1500'

BOP PROGRAM: 3,000# REGULAR SERVICE, 3,000# 10" DOUBLE RAM PREVENTER.

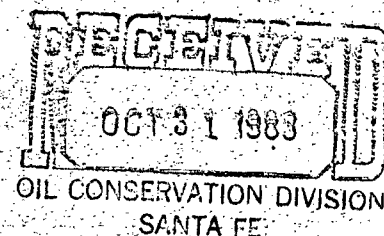

IN ABOVE SPACE DESCRIBE PROPOSED PROGRAM; IF PROPOSAL IS TO DEEPEN OR PLUG BACK, GIVE DATA ON PRESENT PRODUCTIVE ZONE AND PROPOSED NEW PRODUCTIVE ZONE. GIVE BLOWOUT PREVENTER PROGRAM, IF ANY.

I hereby certify that the information above is true and complete to the best of my knowledge and belief.

Signed A. J. FORE Title SUPERVISOR REG. & PERMITTING Date OCTOBER 27, 1983
(This space for State Use)

APPROVED BY _____ TITLE _____ DATE _____
CONDITIONS OF APPROVAL, IF ANY:

NEW MEXICO OIL CONSERVATION COMMISSION
WELL LOCATION AND ACREAGE DEDICATION PLAT

Form C-102
Supersedes C-128
Effective 1-1-65

All distances must be from the outer boundaries of the Section.

Operator SHELL OIL CO.			Lease NHU		Well No. 33-233
Unit Letter K	Section 33	Township 18 SOUTH	Range 38 EAST	County LEA	
Actual Footage Location of Well: 2380 feet from the SOUTH line and 2472 feet from the WEST line					
Ground Level Elev. 3638.8	Producing Formation GRAYBURG/SAN ANDRES		Pool HOBBS (GRAYBURG/SAN ANDRES)		Dedicated Acreage: 40 Acres

1. Outline the acreage dedicated to the subject well by colored pencil or hachure marks on the plat below.
2. If more than one lease is dedicated to the well, outline each and identify the ownership thereof (both as to working interest and royalty).
3. If more than one lease of different ownership is dedicated to the well, have the interests of all owners been consolidated by communitization, unitization, force-pooling, etc?

☒ Yes ☐ No If answer is "yes," type of consolidation unitization

If answer is "no," list the owners and tract descriptions which have actually been consolidated. (Use reverse side of this form if necessary.)

No allowable will be assigned to the well until all interests have been consolidated (by communitization, unitization, forced-pooling, or otherwise) or until a non-standard unit, eliminating such interests, has been approved by the Commission.

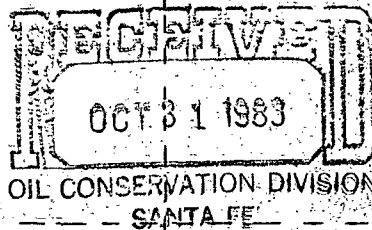

CERTIFICATION

I hereby certify that the information contained herein is true and complete to the best of my knowledge and belief.

Name A. J. FORE
Position SUPERVISOR REG. & PERMITTING

Company
SHELL OIL COMPANY

Date
OCTOBER 27, 1983

I hereby certify that the well location shown on this plat was plotted from field notes of actual surveys made by me or under my supervision, and that the same is true and correct to the best of my knowledge and belief.

Date Surveyed
OCTOBER 21, 1983

Registered Professional Engineer and/or Land Surveyor

John W. West
Certificate No. JOHN W. WEST, 676
RONALD J. EIDSON, 3239

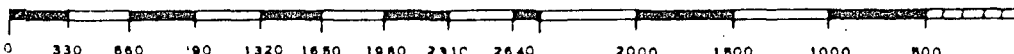
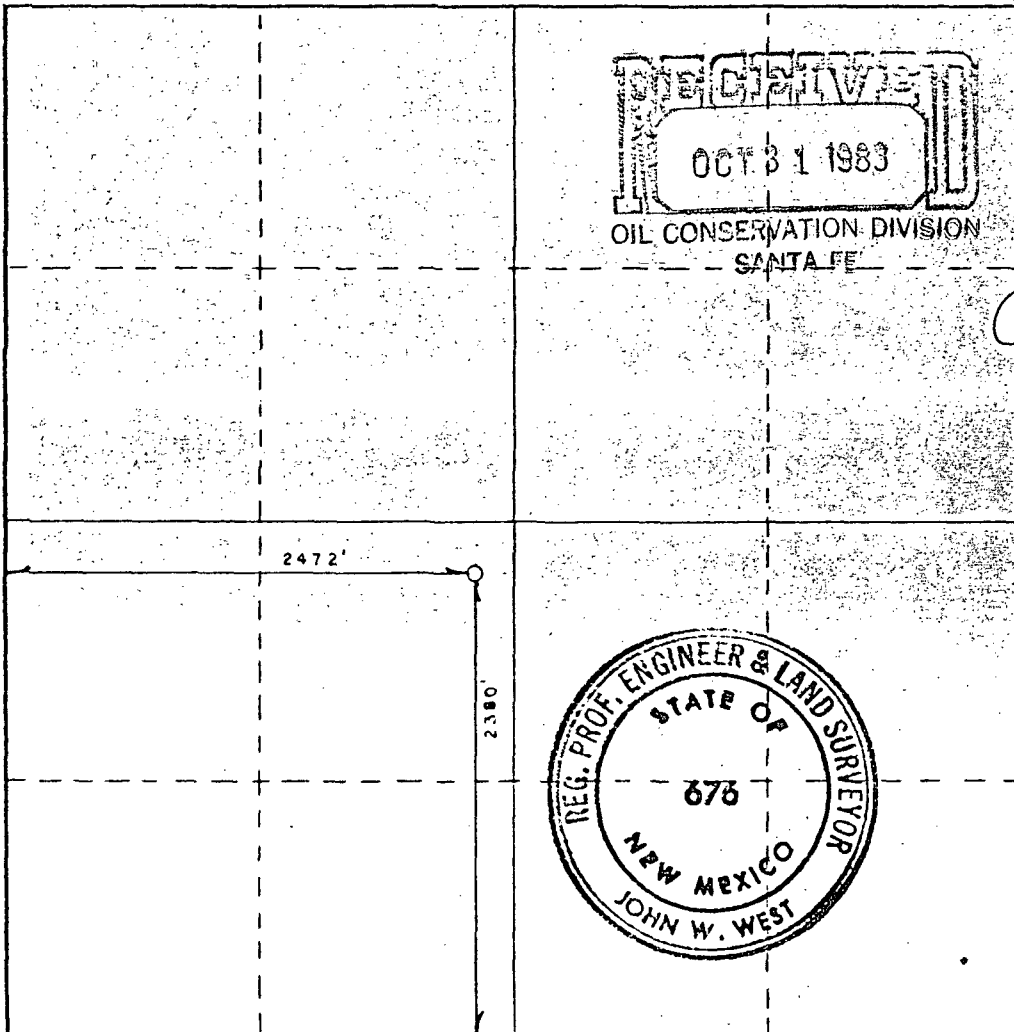
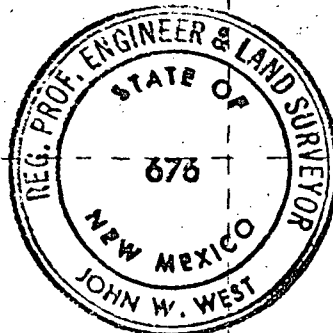

OIL CONSERVATION DIVISION
DISTRICT 1

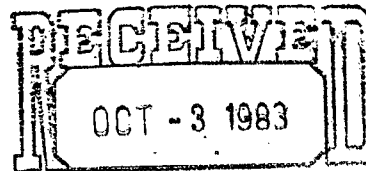

OIL CONSERVATION DIVISION
SANTA FE

OIL CONSERVATION DIVISION
P. O. BOX 2088
SANTA FE, NEW MEXICO 87501

hsl
1249

DATE Sept. 30, 1983

RE: Proposed MC
Proposed DHC
Proposed NSL xx
Proposed NSP
Proposed SMD
Proposed WFX
Proposed PMX

Gentlemen:

I have examined the application for the:

Shell Oil Company North Hobbs G/SA Ut

Operator

Lease and Well No.

Sec. 24 #412-A 24-18-37

Sec. 29 #242-N 29-18-38

Sec. 30 #312-G 30-18-38

Sec. 33 #142-L 33-18-38

Sec. 33 #233-K 33-18-38

Unit, S-1-R

and my recommendations are as follows:

Shell's application for unorthodox locations of the above wells in the

North Hobbs G/SA Unit meets with my approval.

Yours very truly,

/mc