

September 25, 1984

Oil Conservation Division  
P. O. Box 2088  
Santa Fe, New Mexico 87501

Attention: Mr. R. L. Stamets

Dear Sir:

Burk Royalty Co., operator of the Double "L" Queen Unit in Chaves County, New Mexico recently filed a C-101 with your Hobbs office to drill an infill producing well in the middle of the Double "L" Queen Unit. This Unit has been under waterflood since 1979 and was unitized in 1977. I understand from the Hobbs Office, that I need approval to drill an unorthodox location in this flood. As you can see by the map, there are no offset operators as the well is being drilled within the unit boundaries. This well should help us evaluate the movement of fluids in the flood and should also increase our oil production.

We request administrative approval to drill this well and would like to secure approval as soon as possible.

Sincerely yours,

BURK ROYALTY CO.

*Fred M. Lynch*  
Fred M. Lynch

FML/ks  
Enc.

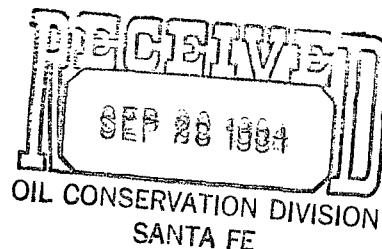

NSL #1918  
Rule 104 F (I)  
Dedicated Acreage 40 acres  
SE 1/4 NW 1/4  
Approve immediately  
Fee land  
Double L Queen Unit  
well No. 2405  
F-6-155-30E  
1330 FNL, 1710 FWL  
Chaves Co. N.M.

NO. OF COPIES RECEIVED	
DISTRIBUTION	
SANTA FE	
FILE	
U.S.G.S.	
LAND OFFICE	
OPERATOR	

3A. Indicate Type of Lease  
STATE ☐ FEE ☒

5. State Oil & Gas Lease No.  
16496

APPLICATION FOR PERMIT TO DRILL, DEEPEN, OR PLUG BACK

1a. Type of Work DRILL <input checked="" type="checkbox"/> DEEPEN <input type="checkbox"/> PLUG BACK <input type="checkbox"/>		7. Unit Agreement Name Double "L" Qn. Uni
b. Type of Well OIL WELL <input checked="" type="checkbox"/> GAS WELL <input type="checkbox"/> OTHER <input type="checkbox"/>		8. Farm or Lease Name Double "L" Qn. Uni
2. Name of Operator Burk Royalty Co.		9. Well No. 2405
3. Address of Operator P. O. Box BRC, Wichita Falls, TX 76307		10. Field and Pool, or Wildcat Double "L" Qn. Ass
4. Location of Well UNIT LETTER <u>F</u> LOCATED <u>1710</u> FEET FROM THE <u>West</u> LINE AND <u>1330</u> FEET FROM THE <u>North</u> LINE OF SEC. <u>6</u> TWP. <u>T15S</u> RGE. <u>R30E</u> NMPM		12. County Chaves
19. Proposed Depth 2050'		19A. Formation Queen Sand
20. History or C.T. C.T.		
21. Elevations (show whether DF, KT, etc.) 3877' G.L.	21A. Kind & Status Plug. Bond Blanket-Active	21B. Drilling Contractor Cortez Drilling Co.
22. Approx. Date Work will start October 1, 1984		

PROPOSED CASING AND CEMENT PROGRAM

SIZE OF HOLE	SIZE OF CASING	WEIGHT PER FOOT	SETTING DEPTH	SACKS OF CEMENT	EST. TOP
10"	8 5/8"	24#	400'	100	Circ.
8"	4 1/2"	9.5#	2000'	475	Circ.

\*This well is to be drilled as an in fill producing well. The original lease had 4 wells on it, but it is now unitized with the Double "L" Queen Unit. The well will be drilled with cable tools and upon completion it will probably be fraced. Productive zone is the Queen Sand. This well will not require a blowout prevention program but the cable tool rig will have a control head.

\*Exception to Spacing Rules as this well is in a waterflood.

IN ABOVE SPACE DESCRIBE PROPOSED PROGRAM; IF PROPOSAL IS TO DEEPEN OR PLUG BACK, GIVE DATA ON PRESENT PRODUCTIVE ZONE AND PROPOSED NEW PRODUCTIVE ZONE. GIVE BLOWOUT PREVENTER PROGRAM, IF ANY.

I hereby certify that the information above is true and complete to the best of my knowledge and belief.

Signed Fred M. Lynch Title Engineer

Date 9-17-84

(This space for State Use)

APPROVED BY \_\_\_\_\_ TITLE \_\_\_\_\_ DATE \_\_\_\_\_

CONDITIONS OF APPROVAL, IF ANY:

All distances must be from the outer boundaries of the Section.

Operator <b>Burk Royalty Co.</b>		Lease <b>Double "L" Queen Unit</b>		Well No. <b>2405</b>
Unit Letter <b>F</b>	Section <b>6</b>	Township <b>15 South</b>	Range <b>30 East</b>	County <b>Chaves</b>
Actual Wellbore Location of Well <b>1710</b> feet from the <b>West</b> line and <b>1330</b> feet from the <b>North</b> line				
Ground Level Elev. <b>3877</b>	Producing Formation <b>Queen Sand</b>	Pool <b>Double "L" Queen Assoc.</b>	Dedicated Acreage <b>Waterflood Except</b>	

1. Outline the acreage dedicated to the subject well by colored pencil or hatchure marks on the plat below.
2. If more than one lease is dedicated to the well, outline each and identify the ownership thereof (both as to working interest and royalty).
3. If more than one lease of different ownership is dedicated to the well, have the interests of all owners been consolidated by communitization, unitization, force-pooling, etc?

☐ Yes ☐ No If answer is "yes," type of consolidation \_\_\_\_\_

If answer is "no," list the owners and tract descriptions which have actually been consolidated. (Use reverse side of this form if necessary.) \_\_\_\_\_

No allowable will be assigned to the well until all interests have been consolidated (by communitization, unitization, force-pooling, or otherwise) or until a non-standard unit, eliminating such interests, has been approved by the Division

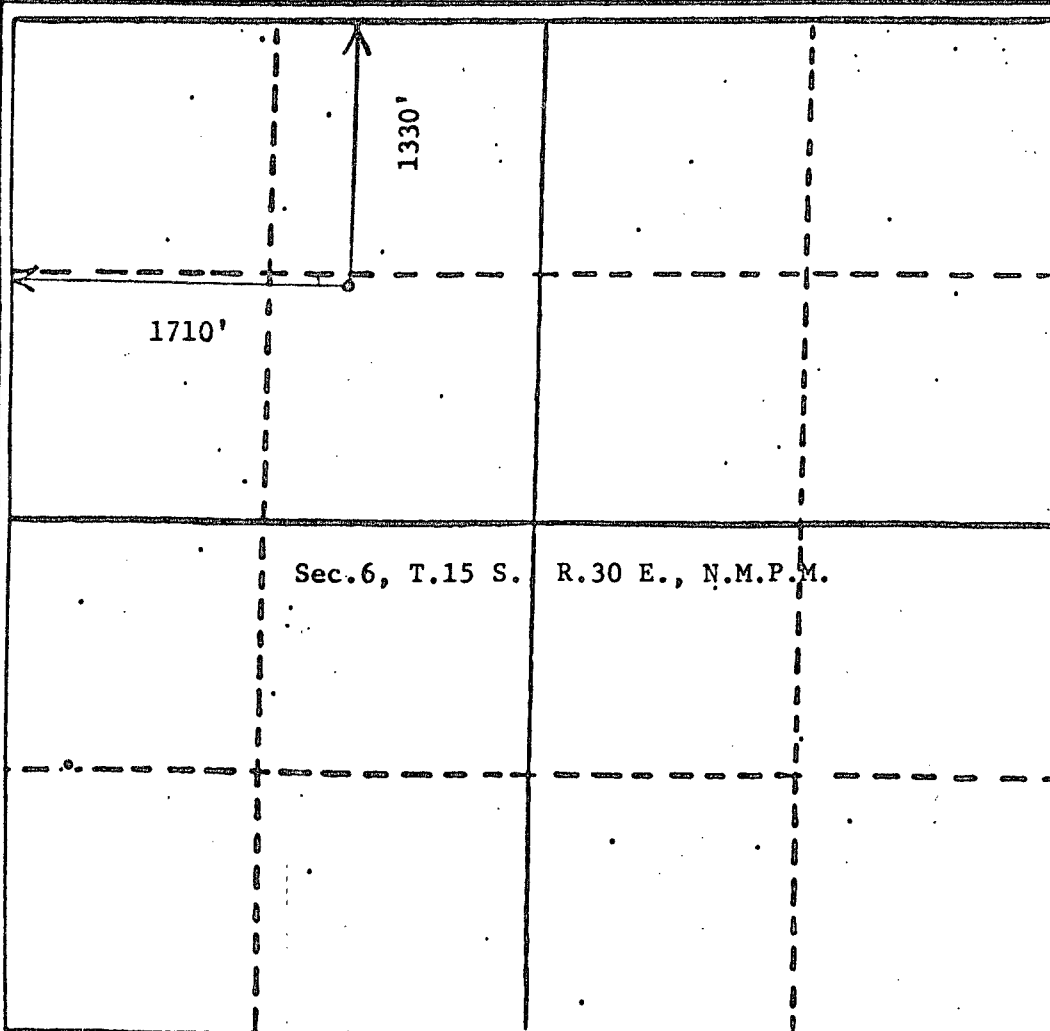

### CERTIFICATION

I hereby certify that the information contained herein is true and complete to the best of my knowledge and belief.

*Fred M. Lynch*

Name

Fred M. Lynch

Position

Engineer

Company

Burk Royalty Co.

Date

September 17, 1984

I hereby certify that the well location shown on this plat was plotted from field notes of actual surveys made by me or under my supervision, and that the same is true and correct to the best of my knowledge and belief.

Date Surveyed

August 28, 1984

Registered Professional Engineer and State Land Surveyor

*Fred M. Lynch*  
Fred M. Lynch, P.E. & L.S.

License No.

6280 PROFESSIONAL ENGINEER



**DINERO**  
P. O. DRAWER 10505  
MIDLAND, TEXAS 79702

September 7, 1984

OIL CONSERVATION DIVISION

SEP 10 1984

RECEIVED

State of New Mexico  
Oil Conservation Division  
P. O. Box 2088  
Santa Fe, New Mexico 87501

Attention: Mr. Gilbert Quintana

RE: Request for Non-Standard  
location, Section 16,  
T-22-S, R-28-E, Eddy County,  
New Mexico

Gentlemen:

Dinero Operating Company proposes to drill in the South half of Section 16, T-22-S, R-28-E, 660' FSL and 990' FEL, Eddy County, New Mexico. We have requested Administrative Approval for a Non-standard location for this well.

This well will aid in the continuing development program of the Big Chief Unit Area as we covered in our letter to Mr. Ray Graham on January 12, 1982. In this letter we agreed to continue our drilling in the Big Chief Unit Area in the South half of Section 16. With the approval of this Non-standard location, Dinero Operating Company will be able to honor its continuing development program to the State of New Mexico. This location will be in the best interest of the State of New Mexico and all other concerned parties.

If anything further is needed for this request, please do not hesitate to let us know.

Very truly yours,

DINERO OPERATING COMPANY

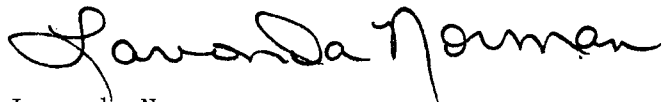

Lavonda Norman  
Production Supervisor

/ln