

Release June 12, 1985

By DRC

DANIEL S. NUTTER

REGISTERED PETROLEUM ENGINEER

PETROLEUM CONSULTATION AND STATE AND FEDERAL REGULATORY SERVICES

105 EAST ALICANTE

SANTA FE, NEW MEXICO 87501

PHONE (505) 982-0757

May 21, 1985

USC-2063
RULE-104 (I)

Mr. Richard L. Stamets
Division Director
Oil Conservation Division
Energy and Minerals Department
Post Office Box 2088
Santa Fe, New Mexico 87501

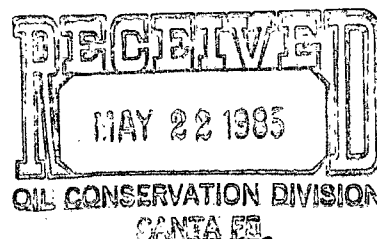

40 Accreditation
SE14 SE14

Re: My letter dated May 20, 1985,
concerning:

Application For Administrative
Approval, Unorthodox Oil Well
Location, Eddy Co., New Mexico

Dear Mr. Stamets:

Reference is made to my letter dated May 20, 1985, which is the application of Perry R. Bass for administrative approval for an exception to the provisions of Division Rule 104 C I for the unorthodox location of his Bass Federal 3 Well No. 1, a proposed oil well which would be drilled at a point 230 feet from the South line and 1090 feet from the East line of Section 3, Township 22 South, Range 28 East, NMPM, Indian Draw Field, Eddy County, New Mexico.

Throughout my letter, I erroneously referred to the location of the well as being 1090 feet from the West line of Section 3, rather than 1090 feet from the East line. The plats which were attached to the application were correct, showing the well to be located 290 feet from the South line and 1090 feet from the East line.

It is respectfully requested that the application be corrected to reflect the proper location of this proposed well, and please accept my apologies for any inconvenience which this error may have caused you.

Richard L. Stamets
May 21, 1985
Page 2

Copies of this letter are this day being mailed to all parties who were sent a copy of the original application.

Very truly yours,

A handwritten signature in dark ink, appearing to read "Daniel S. Nutter", with a stylized flourish at the end.

Daniel S. Nutter, P.E., and
Agent, Perry R. Bass

DSN:ms

cc: Mr. Charles S. Dahlen
Area Manager
U. S. Bureau of Land Management
P.O. Box 1778
Carlsbad, NM 88220

Gulf Oil Exploration & Production Co.
Gulf Building
306 West Wall
Midland, TX 79702

MYCO Industries, Inc.
207 South 4th Street
Artesia, NM 88210

Mr. John D. Rodgers
Bass Enterprises Production Co.
P.O. Box 2760
Midland, TX 79702

DANIEL S. NUTTER

REGISTERED PETROLEUM ENGINEER

PETROLEUM CONSULTATION AND STATE AND FEDERAL REGULATORY SERVICES

105 EAST ALICANTE

SANTA FE, NEW MEXICO 87501

PHONE (505) 982-0757

May 20, 1985



Mr. Richard L. Stamets
Division Director
Oil Conservation Division
Energy and Minerals Department
Post Office Box 2088
Santa Fe, New Mexico 87501

Re: Application For Administrative
Approval, Unorthodox Oil Well
Location, Eddy Co., New Mexico

Dear Mr. Stamets:

This is the application of Perry R. Bass for administrative approval for an exception to the provisions of Division Rule 104 C I for the unorthodox location of his Bass Federal 3 Well No. 1, a proposed oil well which would be drilled at a point 230 feet from the South line and 1090 feet from the West line of Section 3, Township 22 South, Range 28 East, NMPM, Indian Draw Field, Eddy County, New Mexico. 40 acres, being the SE/4 SE/4 of Section 3 will be dedicated to the well.

This well is projected to the Delaware formation in the Indian Draw-Delaware Pool and was originally staked at a standard location 330 feet from the South line and 990 feet from the West line of Section 3, but after inspection of the location, the BLM has recommended that the location be moved 100 feet south and 100 feet west into a flatter area where erosion of Indian Draw would be minimized.

Because of these topographical conditions, it is respectfully requested that administrative approval for this unorthodox location be give pursuant to the provisions of Division Rule 104 F I upon expiration of the required waiting period, or upon receipt of waivers of objection from all offset operators.

Richard L. Stamets
May 20, 1985
Page 2

Copies of this application are this day being mailed to the only offset operators, Gulf Oil Exploration & Production Co. and MYCO Industries, Inc., by certified mail.

Very truly yours,



Daniel S. Nutter, P.E., and
Agent, Perry R. Bass

DSN:ms

cc: Mr. Charles S. Dahlen
Area Manager
U. S. Bureau of Land Management
P.O. Box 1778
Carlsbad, NM 88220

Gulf Oil Exploration & Production Co.
Gulf Building
306 West Wall
Midland, TX 79702

MYCO Industries, Inc.
207 South 4th Street
Artesia, NM 88210

Mr. John D. Rodgers
Bass Enterprises Production Co.
P.O. Box 2760
Midland, TX 79702

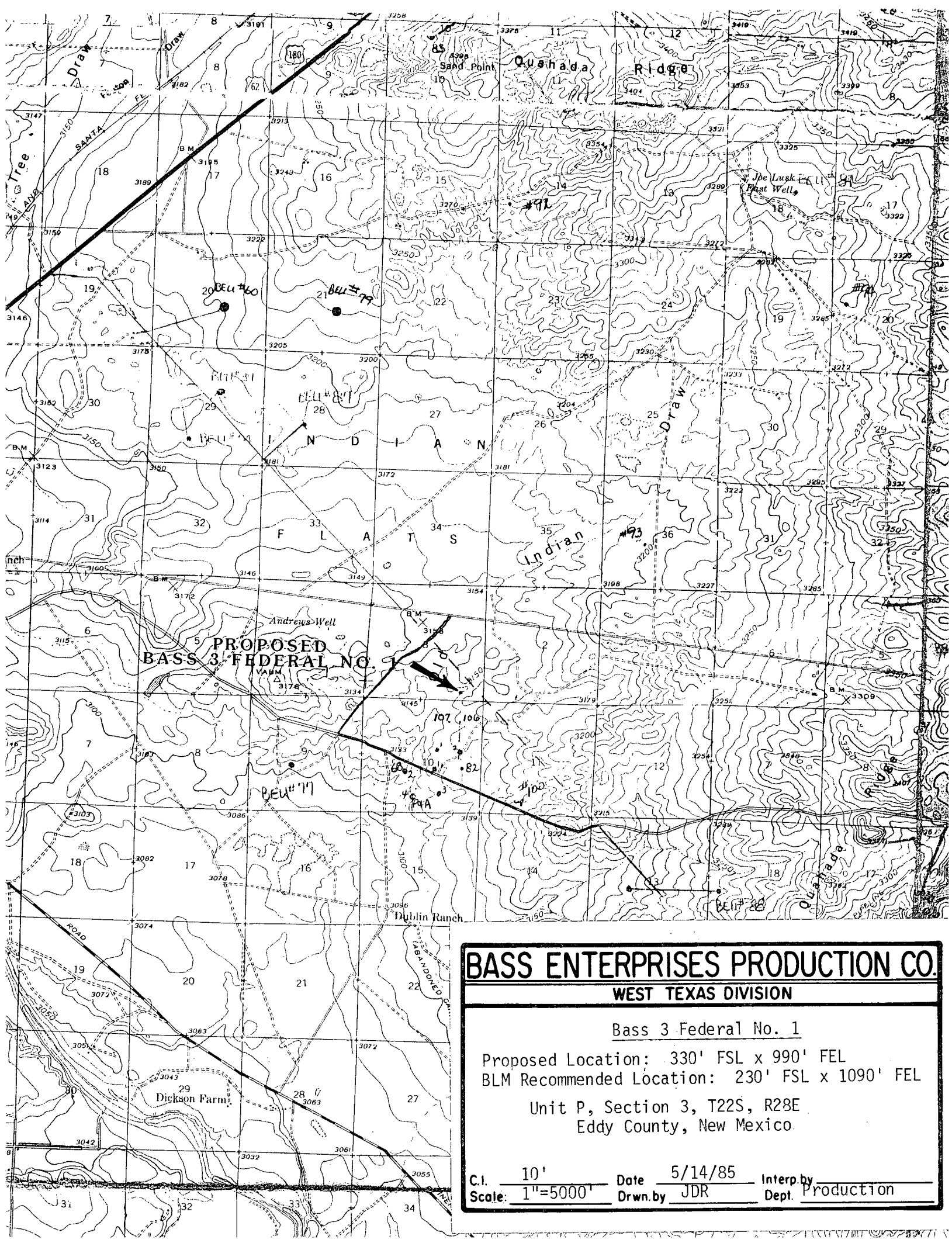

BASS ENTERPRISES PRODUCTION CO.

WEST TEXAS DIVISION

Bass 3 Federal No. 1

Proposed Location: 330' FSL x 990' FEL
BLM Recommended Location: 230' FSL x 1090' FEL

Unit P, Section 3, T22S, R28E
Eddy County, New Mexico.

C.I. 10' Date 5/14/85
Scale: 1"=5000' Drwn. by JDR Interp. by Dept. Production

**NEW MEXICO OIL CONSERVATION COMMISSION
WELL LOCATION AND ACREAGE DEDICATION PLAT**

Form C-102
Supersedes C-128
Effective 1-1-65

All distances must be from the outer boundaries of the Section.

Operator PERRY R. BASS			Lease BASS "3" FED			Well No. 1		
Unit Letter P	Section 3	Township 22S	Range 28E	County EDDY				
Actual Footage Location of Well: <div style="display: flex; justify-content: space-between;"> 330 feet from the SOUTH line and 990 feet from the EAST line </div>								
Ground Level Elev. 3139.7	Producing Formation Delaware		Pool Indian Draw, East			Dedicated Acreage: 40 Acres		

1. Outline the acreage dedicated to the subject well by colored pencil or hatchure marks on the plat below.
2. If more than one lease is dedicated to the well, outline each and identify the ownership thereof (both as to working interest and royalty).
3. If more than one lease of different ownership is dedicated to the well, have the interests of all owners been consolidated by communitization, unitization, force-pooling, etc?

☐ Yes ☐ No If answer is "yes," type of consolidation _____

If answer is "no," list the owners and tract descriptions which have actually been consolidated. (Use reverse side of this form if necessary.) _____

No allowable will be assigned to the well until all interests have been consolidated (by communitization, unitization, forced-pooling, or otherwise) or until a non-standard unit, eliminating such interests, has been approved by the Commission.

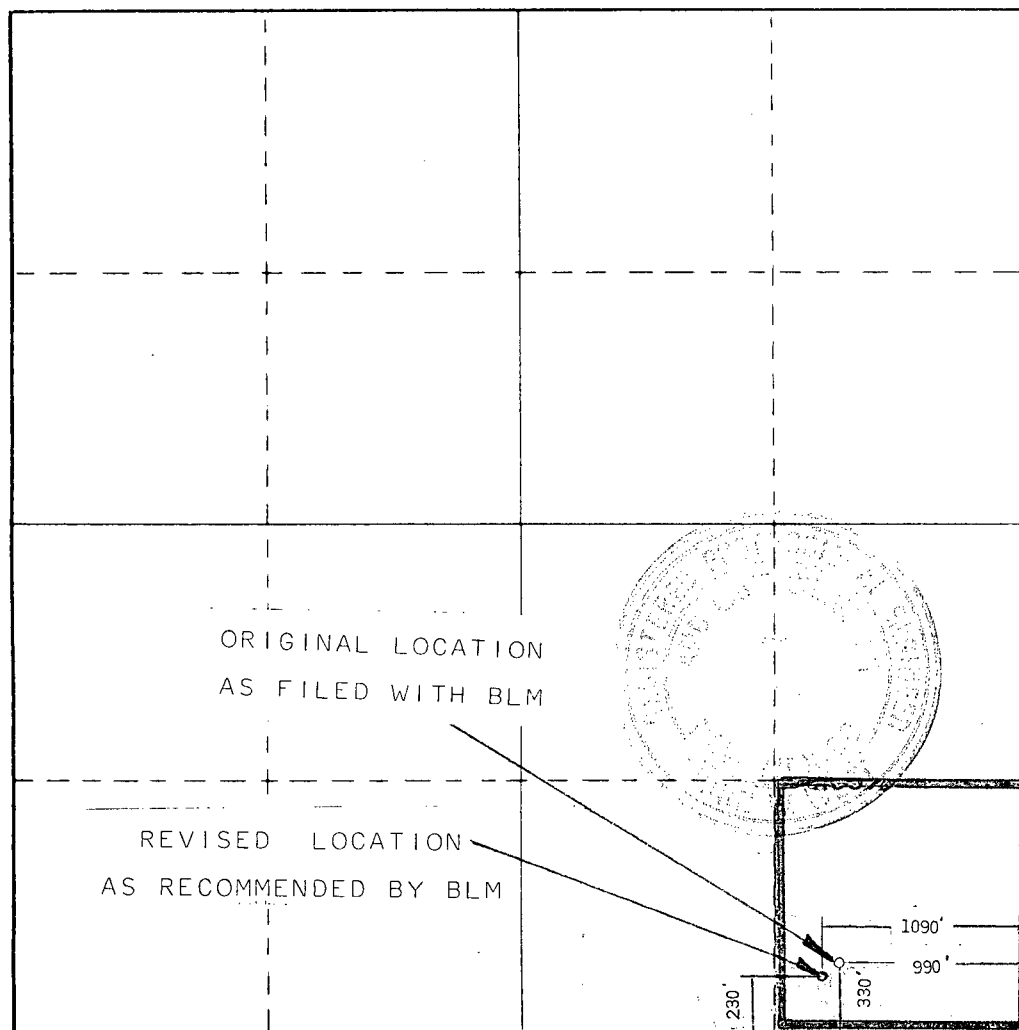

CERTIFICATION

I hereby certify that the information contained herein is true and complete to the best of my knowledge and belief.

Stephen D. Smith

Name
Stephen D. Smith
Position
Asst. Drilling Engineer
Company
Perry R. Bass

Date
April 22, 1985

I hereby certify that the well location shown on this plat was plotted from field notes of actual surveys made by me or under my supervision, and that the same is true and correct to the best of my knowledge and belief.

Date Surveyed
4/18/85

Registered Professional Engineer
and/or Land Surveyor

John W. West

Certificate No. **JOHN W. WEST, 676**
RONALD J. EIDSON, 3239

DANIEL S. NUTTER

REGISTERED PETROLEUM ENGINEER

PETROLEUM CONSULTATION AND STATE AND FEDERAL REGULATORY SERVICES

105 EAST ALICANTE

SANTA FE, NEW MEXICO 87501

PHONE (505) 982-0757

May 20, 1985

Gulf Oil Exploraton & Production Co.
Gulf Building
306 West Wall
Midland, TX 79702

Re: Perry R. Bass Unorthodox Location
230' FSL and 1090' FWL Section 3,
Township 22 South, Range 28 East,
Indian Draw-Delaware Pool, Eddy
County, New Mexico

Gentlemen:

Enclosed herewith is copy of application filed this day with the New Mexico Oil Conservation Division seeking administrative approval for the above-described unorthodox location.

The Perry R. Bass 3 Federal Well No. 1 was originally staked at a standard location 330 feet from the South line and 990 feet from the West line of Section 3, but upon the recommendation of the United States BLM is being moved to the aforesaid unorthodox location.

If you have no objection to this proposed location, please sign the attached waiver and return it to the undersigned at your earliest convenience.

Very truly yours,



Daniel S. Nutter, P.E., and
Agent, Perry R. Bass

DSN:ms

W A I V E R O F O B J E C T I O N

To Whom It May Concern:

This is to acknowledge receipt of the application of Perry R. Bass for administrative approval by the New Mexico Oil Conservation Division for the unorthodox location of applicant's proposed 3 Federal Well No. 1 at a point 230 feet from the South line and 1090 feet from the West line of Section 3, Township 22 South, Range 28 West, Indian Draw-Delaware Pool, Eddy County, New Mexico, and further to waive objection to the drilling of the aforesaid well at said location.

Gulf Oil Exploration & Production Co.

By: _____

Date _____

DANIEL S. NUTTER

REGISTERED PETROLEUM ENGINEER

PETROLEUM CONSULTATION AND STATE AND FEDERAL REGULATORY SERVICES

105 EAST ALICANTE

SANTA FE, NEW MEXICO 87501

PHONE (505) 982-0757

May 20, 1985

MYCO Industries, Inc.
207 Suth 4th Street
Artesia, New Mexico 88210

Attn: Mr. Frank H. Yates, Jr., or Mr. Randy Patterson

Re: Perry R. Bass Unorthodox Location
230' FSL and 1090' FWL Section 3,
Township 22 South, Range 28 East,
Indian Draw-Delaware Pool, Eddy
County, New Mexico

Gentlemen:

Enclosed herewith is copy of application filed this day with the New Mexico Oil Conservation Division seeking administrative approval for the above-described unorthodox location.

The Perry R. Bass 3 Federal Well No. 1 was originally staked at a standard location 330 feet from the South line and 990 feet from the West line of Section 3, but upon the recommendation of the United States BLM is being moved to the aforesaid unorthodox location.

If you have no objection to this proposed location, please sign the attached waiver and return it to the undersigned at your earliest convenience.

Very truly yours,

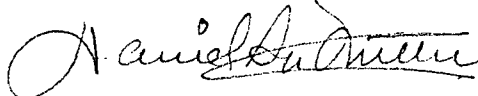

Daniel S. Nutter, P.E., and
Agent, Perry R. Bass

DSN:ms

W A I V E R O F O B J E C T I O N

To Whom It May Concern:

This is to acknowledge receipt of the application of Perry R. Bass for administrative approval by the New Mexico Oil Conservation Division for the unorthodox location of applicant's proposed 3 Federal Well No. 1 at a point 230 feet from the South line and 1090 feet from the West line of Section 3, Township 22 South, Range 28 West, Indian Draw-Delaware Pool, Eddy County, New Mexico, and further to waive objection to the drilling of the aforesaid well at said location.

MYCO Industries, Inc.

By: _____

Date _____

DANIEL S. NUTTER

REGISTERED PETROLEUM ENGINEER

PETROLEUM CONSULTATION AND STATE AND FEDERAL REGULATORY SERVICES

105 EAST ALICANTE

SANTA FE, NEW MEXICO 87501

PHONE (505) 982-0757

May 20, 1985

MYCO Industries, Inc.
207 Suth 4th Street
Artesia, New Mexico 88210

Attn: Mr. Frank H. Yates, Jr., or Mr. Randy Patterson

Re: Perry R. Bass Unorthodox Location
230' FSL and 1090' FWL Section 3,
Township 22 South, Range 28 East,
Indian Draw-Delaware Pool, Eddy
County, New Mexico

Gentlemen:

Enclosed herewith is copy of application filed this day with the New Mexico Oil Conservation Division seeking administrative approval for the above-described unorthodox location.

The Perry R. Bass 3 Federal Well No. 1 was originally staked at a standard location 330 feet from the South line and 990 feet from the West line of Section 3, but upon the recommendation of the United States BLM is being moved to the aforesaid unorthodox location.

If you have no objection to this proposed location, please sign the attached waiver and return it to the undersigned at your earliest convenience.

Very truly yours,

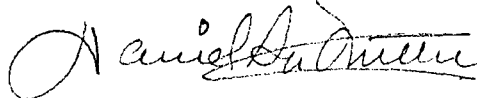

Daniel S. Nutter, P.E., and
Agent, Perry R. Bass

DSN:ms

W A I V E R O F O B J E C T I O N

To Whom It May Concern:

This is to acknowledge receipt of the application of Perry R. Bass for administrative approval by the New Mexico Oil Conservation Division for the unorthodox location of applicant's proposed 3 Federal Well No. 1 at a point 230 feet from the South line and 1090 feet from the West line of Section 3, Township 22 South, Range 28 West, Indian Draw-Delaware Pool, Eddy County, New Mexico, and further to waive objection to the drilling of the aforesaid well at said location.

MYCO Industries, Inc.

By: _____

Date _____

DANIEL S. NUTTER

REGISTERED PETROLEUM ENGINEER

PETROLEUM CONSULTATION AND STATE AND FEDERAL REGULATORY SERVICES

105 EAST ALICANTE

SANTA FE, NEW MEXICO 87501

PHONE (505) 982-0757

May 20, 1985

Gulf Oil Exploraton & Production Co.
Gulf Building
306 West Wall
Midland, TX 79702

Re: Perry R. Bass Unorthodox Location
230' FSL and 1090' FWL Section 3,
Township 22 South, Range 28 East,
Indian Draw-Delaware Pool, Eddy
County, New Mexico

Gentlemen:

Enclosed herewith is copy of application filed this day with the New Mexico Oil Conservation Division seeking administrative approval for the above-described unorthodox location.

The Perry R. Bass 3 Federal Well No. 1 was originally staked at a standard location 330 feet from the South line and 990 feet from the West line of Section 3, but upon the recommendation of the United States BLM is being moved to the aforesaid unorthodox location.

If you have no objection to this proposed location, please sign the attached waiver and return it to the undersigned at your earliest convenience.

Very truly yours,



Daniel S. Nutter, P.E., and
Agent, Perry R. Bass

DSN:ms

W A I V E R O F O B J E C T I O N

To Whom It May Concern:

This is to acknowledge receipt of the application of Perry R. Bass for administrative approval by the New Mexico Oil Conservation Division for the unorthodox location of applicant's proposed 3 Federal Well No. 1 at a point 230 feet from the South line and 1090 feet from the West line of Section 3, Township 22 South, Range 28 West, Indian Draw-Delaware Pool, Eddy County, New Mexico, and further to waive objection to the drilling of the aforesaid well at said location.

Gulf Oil Exploration & Production Co.

By: _____

Date _____