

DATE IN 3/4/98	SUSPENSE 3/24/98	ENGINEER MS	LOGGED KW	TYPE NSL
-------------------	---------------------	----------------	--------------	-------------

ABOVE THIS LINE FOR DIVISION USE ONLY

NEW MEXICO OIL CONSERVATION DIVISION

- Engineering Bureau -

ADMINISTRATIVE APPLICATION COVERSHEET

THIS COVERSHEET IS MANDATORY FOR ALL ADMINISTRATIVE APPLICATIONS FOR EXCEPTIONS TO DIVISION RULES AND REGULATIONS

Application Acronyms:

[NSP-Non-Standard Proration Unit] [NSL-Non-Standard Location]
 [DD-Directional Drilling] [SD-Simultaneous Dedication]
 [DHC-Downhole Commingling] [CTB-Lease Commingling] [PLC-Pool/Lease Commingling]
 [PC-Pool Commingling] [OLS - Off-Lease Storage] [OLM-Off-Lease Measurement]
 [WFX-Waterflood Expansion] [PMX-Pressure Maintenance Expansion]
 [SWD-Salt Water Disposal] [IPI-Injection Pressure Increase]
 [EOR-Qualified Enhanced Oil Recovery Certification] [PPR-Positive Production Response]

[1] TYPE OF APPLICATION - Check Those Which Apply for [A]

- [A] Location - Spacing Unit - Directional Drilling
☒ NSL ☐ NSP ☐ DD ☐ SD

Check One Only for [B] and [C]

- [B] Commingling - Storage - Measurement

☐ DHC ☐ CTB ☐ PLC ☐ PC ☐ OLS ☐ OLM

- [C] Injection - Disposal - Pressure Increase - Enhanced Oil Recovery

☐ WFX ☐ PMX ☐ SWD ☐ IPI ☐ EOR ☐ PPR

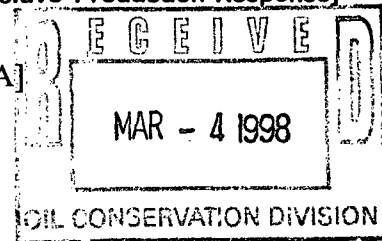

[2] NOTIFICATION REQUIRED TO: - Check Those Which Apply, or ☐ Does Not Apply

- [A] ☐ Working, Royalty or Overriding Royalty Interest Owners
 [B] ☒ Offset Operators, Leaseholders or Surface Owner
 [C] ☐ Application is One Which Requires Published Legal Notice
 [D] ☒ Notification and/or Concurrent Approval by BLM or SLO
 U.S. Bureau of Land Management - Commissioner of Public Lands, State Land Office
 [E] ☐ For all of the above, Proof of Notification or Publication is Attached, and/or,
 [F] ☐ Waivers are Attached

[3] INFORMATION / DATA SUBMITTED IS COMPLETE - Statement of Understanding

I hereby certify that I, or personnel under my supervision, have read and complied with all applicable Rules and Regulations of the Oil Conservation Division. Further, I assert that the attached application for administrative approval is accurate and complete to the best of my knowledge and where applicable, verify that all interest (WI, RI, ORRI) is common. I understand that any omission of data, information or notification is cause to have the application package returned with no action taken.

Note: Statement must be completed by an individual with supervisory capacity.

Peggy Bradford

Print or Type Name

Signature

Regulatory/Compliance Administrator

Title

Date

BURLINGTON RESOURCES

SAN JUAN DIVISION

March 2, 1998

Federal Express

Mr. Michael Stogner
New Mexico Oil Conservation Division
2040 South Pacheco Street
Santa Fe, New Mexico 87505

Re: Harrington #6
2090'FSL, 2295'FWL Section 31, T-27-N, R-7-W, San Juan County, NM
API #30-039-23871

Dear Mr. Stogner:

This is a request for administrative approval for a non-standard gas well location in the Otero Chacra pool. Order NSL-2147 was issued for the drilling of this well in the Mesa Verde pool.

Burlington Resources Oil & Gas Company intends to recomplete the Harrington #6 in the Otero Chacra pool. Application has been made to then commingle the Chacra and Blanco Mesa Verde formations. Production from the Otero Chacra is to be included in a 161 acre gas spacing and proration unit ("GPU") comprising of the southwest quarter (SW/4) of Section 31, T-27-N, R-7-W, Rio Arriba County, New Mexico. To comply with the New Mexico Oil Conservation Division rules, Burlington is submitting the following for your approval of this non-standard location:

1. C-102 plat showing location of the well;
2. Plat showing offset owners/operators;
3. Copy of Well Completion Log for original completion;
4. Affidavit of notification of offset owners/operators.

Three copies of this application are being submitted to all offset owners/operators by certified mail with a request that they furnish your Santa Fe office with a copy of Waiver of Objection, return one copy to this office, and retain one copy for their files.

Sincerely yours,



Peggy Bradfield
Regulatory/Compliance Administrator

WAIVER

_____ hereby waives objection to Burlington Resource's application for non-standard location for the Harrington #6 as proposed above.

By: _____ Date: _____

xc: Conoco Inc.
Louis Dreyfus Gas Holdings Inc.
Depco Inc.

District II
PO Drawer 00, Artesia, NM 88211-0719

District III
1000 Rio Brazos Rd., Aztec, NM 87410

OIL CONSERVATION DIVISION
PO Box 2088
Santa Fe, NM 87504-2088

Submit to Appropriate District Office
State Lease - 4 Copies
Fee Lease - 3 Copies

District IV
PO Box 2088, Santa Fe, NM 87504-2088

☐ AMENDED REPORT

WELL LOCATION AND ACREAGE DEDICATION PLAT

'API Number	'Pool Code	'Pool Name
30-039-23871	82329/72319	Otero Chacra/Blanco Mesaverde
'Property Code	'Property Name	'Well Number
7094	HARRINGTON	6
'OGRID No.	'Operator Name	'Elevation
14538	BURLINGTON RESOURCES OIL & GAS COMPANY	6001

¹⁰ Surface Location

UL or lot no.	Section	Township	Range	Lot Idn	Feet from the	North/South line	Feet from the	East/West line	County
K	31	27N	7W		2090	South	2295	West	RIO ARRIBA

¹¹Bottom Hole Location If Different From Surface

UL or lot no.	Section	Township	Range	Lot Idn	Feet from the	North/South line	Feet from the	East/West line	County
---------------	---------	----------	-------	---------	---------------	------------------	---------------	----------------	--------

¹² Dedicated Acres Cha- 161 MV-W/321.60	¹³ Joint or Infill	¹⁴ Consolidation Code	¹⁵ Order No.
--	-------------------------------	----------------------------------	-------------------------

NO ALLOWABLE WILL BE ASSIGNED TO THIS COMPLETION UNTIL ALL INTERESTS HAVE BEEN CONSOLIDATED
OR A NON-STANDARD UNIT HAS BEEN APPROVED BY THE DIVISION

<p>① 40.25</p> <p>*Not re-surveyed: Prepared from plat By: Fred B. Kerr Jr. Dated: August 9, 1985</p>	<p>17 OPERATOR CERTIFICATION</p> <p>I hereby certify that the information contained herein is true and complete to the best of my knowledge and belief.</p>
<p>② 40.35</p>	<p>Signature <u>Peggy Bradfield</u> Printed Name <u>Regulatory Administrator</u> Title <u>2-12-98</u> Date</p>
<p>③ 40.45</p> <p>2295'</p>	<p>18 SURVEYOR CERTIFICATION</p> <p>I hereby certify that the well location shown on this plat was plotted from field notes of actual surveys made by me or under my supervision, and that the same is true and correct to the best of my belief.</p> <p>JANUARY 29, 1998</p> <p>Date of Survey</p>
<p>④ 40.55</p> <p>2090'</p>	<p>Signature and Seal of Professional Surveyor</p> <p></p> <p>6857</p> <p>Certificate Number</p>

UNITED STATES
DEPARTMENT OF THE INTERIOR
BUREAU OF LAND MANAGEMENT

SUBMIT IN DATE*

Use other In-
structions on
reverse side

Form approved.
Budget Bureau No. 1004-013
Expires August 31, 1985

WELL COMPLETION OR RECOMPLETION REPORT AND LOG *

LEASE DESIGNATION AND SERIAL NO.

SF 080511

IF INDIAN, ALLOTTEE OR TRIBE NAME

UNIT AGREEMENT NAME

FARM OR LEASE NAME

Harrington

WELL NO.

6

FIELD AND POOL, OR WILDCAT,
Blanco Mesa Verde

SEC. T., R., M., OR BLOCK AND SURVEY
OR AREA

Sec. 31, T-27-N, R-7-
NMPM

COUNTY OR
PARISH

Rio Arriba

STATE

NM

BUREAU OF LAND MANAGEMENT

FARMINGTON RESOURCE AREA

1a. TYPE OF WELL: OIL WELL ☐ GAS WELL ☒ DRY ☐ Other

b. TYPE OF COMPLETION:

NEW WELL ☒ WORK OVER ☐ DEEP EN ☐ PLUG BACK ☐ DIFF. RESER. ☐ Other

2. NAME OF OPERATOR

El Paso Natural Gas Company

3. ADDRESS OF OPERATOR

P. O. Box 4289, Farmington, NM 87499

4. LOCATION OF WELL (Report location clearly and in accordance with BLM Form 3160-4)

At surface 2090'S, 2295'W

At top prod. interval reported below

At total depth

NOV 05 1985

BUREAU OF LAND MANAGEMENT

FARMINGTON RESOURCE AREA

13. DATE SPUDDED 10-9-85 16. DATE T.D. REACHED 10-16-85 17. DATE COMPL. (Ready to prod.) 10-28-85 18. ELEVATIONS (OF RNB, RT, GB, ETC.)* 6001' GL 19. ELEV. CASING HEAD 6001'

20. TOTAL DEPTH, MD & TVD 4941' 21. PLUG BACK T.D., MD & TVD 4908' 22. IF MULTIPLE COMPL., HOW MANY* One 23. INTERVALS DRILLED BY Rotary TOOLS Rotary CABLE TOOLS No

24. PRODUCING INTERVAL(S), OF THIS COMPLETION—TOP, BOTTOM, NAME (MD AND TVD)* 4459-4817' (Blanco Mesa Verde) 25. WAS DIRECTIONAL SURVEY MADE No

26. TYPE ELECTRIC AND OTHER LOGS RUN Correlation GR-L; Ind. Elec. L; Temp. ; Comp. Density Sidewall NL; Temp S. 27. WAS WELL CORED No

28. CASING RECORD (Report all strings set in well)

CASING SIZE	WEIGHT, LB./FT.	DEPTH SET (MD)	HOLE SIZE	CEMENTING RECORD	AMOUNT PULLED
9 5/8"	32.3#	223'	12 1/4"	325 cu ft	
7"	20.0#	2436'	8 3/4"	504 cu ft	

29. LINER RECORD				30. TUBING RECORD			
SIZE	TOP (MD)	BOTTOM (MD)	SACKS CEMENT*	SCREEN (MD)	SIZE	DEPTH SET (MD)	PACKER SET (MD)
4 1/2"	2279'	4940'	510 cu ft		2 3/8"	4792'	

31. PERFORATION RECORD (Interval, size and number) Pressure test to 3500 psi-ok. Perf'd 4564, 4575, 4584, 4598, 4611, 4629, 4648, 4655, 4688, 4696, 4704, 4711, 4728, 4750, 4765, 4786, 4817, w/17 SPZ. 2nd stage 4459, 4462, 4465, 4468, 4471, 4474, 4477, 4482, 4485, 4488, 4499, 4502, 4518, 4522, 33.* 4526, 4530 w/16 SPZ. 32. ACID, SHOT, FRACTURE, CEMENT SQUEEZE, ETC. DEPTH INTERVAL (MD) AMOUNT AND KIND OF MATERIAL USED 4564-4817' 71,000# 20/40 sand & 104,668 g slickwater 4459-4530' 23,000# 20/40 sand & 57,718 ga slickwater

33.* 4526, 4530 w/16 SPZ. PRODUCTION DATE FIRST PRODUCTION 10-28-85 PRODUCTION METHOD (Flowing, gas lift, pumping—size and type of pump) Flowing - Capable of Comm. HC to be tested WELL STATUS (Producing or shut-in) Shut in DATE OF TEST 10-28-85 HOURS TESTED SI 7 Days CHOKE SIZE 0 PROD'N. FOR TEST PERIOD No Flow OIL—BBL. 0 GAS—MCF. 0 WATER—BBL. 0 GAS-OIL RATIO 0 FLOW, TUBING PRESS. SI 320 CASING PRESSURE SI 1120 CALCULATED 24-HOUR RATE No Flow OIL—BBL. No Flow GAS—MCF. No Flow WATER—BBL. 0 OIL GRAVITY-API (CORR.) 0

34. DISPOSITION OF GAS (Sold, used for fuel, vented, etc.) Shut in to be Sold TEST WITNESSED BY Ernie Minert

35. LIST OF ATTACHMENTS Temp Survey

36. I hereby certify that the foregoing and attached information is complete and correct as determined from all available records

SIGNED [Signature] TITLE Drilling Clerk DATE 11-4-85

*(See Instructions and Spaces for Additional Data on Reverse Side)

OPERATOR

BURLINGTON RESOURCES OIL AND GAS COMPANY

Harrington #6

OFFSET OPERATOR/OWNER PLAT

Non Standard Location

Chacra Formation Well

Township 27 North, Range 7 West

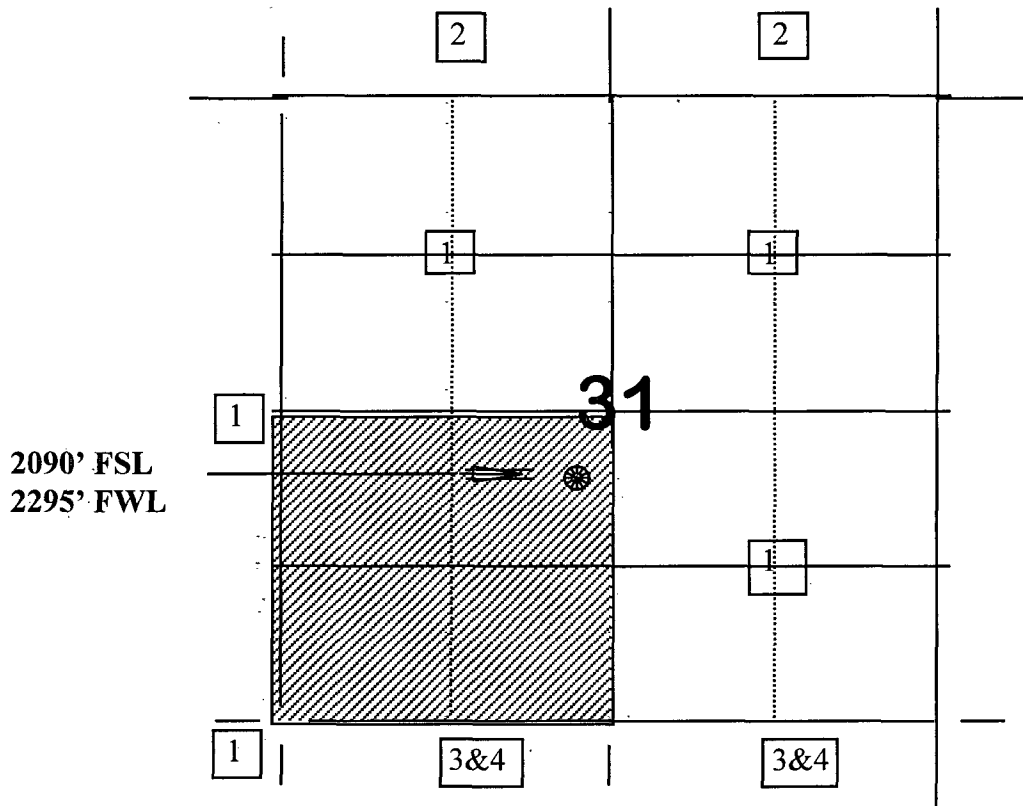

1) Burlington Resources
2) Conoco Inc.
10 Desta Drive, Ste. 100W
Midland, TX 79705

3) Louis Dreyfus Gas Holdings Inc.
14000 Quail Springs Pkwy., Ste. 600
Oklahoma City, OK 73134
4) Depco, Inc.
10000 Petroleum Bldg.
Denver, CO 80202

Re: Harrington #6
2090'FSL, 2295'FWL Section 31, T-27-N, R-7-W, San Juan County, NM
API #30-039-23871

Conoco Inc.
10 Desta Drive, Suite 100W
Midland, TXL 79705

Louis Dreyfus Gas Holdings Inc.
14000 Quail Springs Parkway, Suite 600
Oklahoma City, OK 73134

Depco Inc.
10000 Petroleum Building
Denver, CO 80202

I hereby certify that the following offset owners/operators have been notified by certified mail of our application for administrative approval for non-standard well location of the above well.

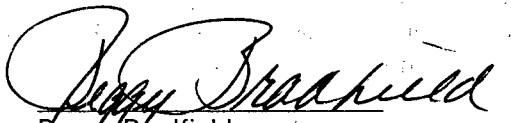

Peggy Bradfield
Regulatory/Compliance Administrator



TONEY ANAYA
GOVERNOR

STATE OF NEW MEXICO
ENERGY AND MINERALS DEPARTMENT
OIL CONSERVATION DIVISION

September 17, 1985



1935 - 1985

POST OFFICE BOX 2088
STATE LAND OFFICE BUILDING
SANTA FE, NEW MEXICO 87501
(505) 827-5800

El Paso Natural Gas Co.
P. O. Box 4289
Farmington, New Mexico 87499

Attention: G. W. Brink

Administrative Order NSL-2147

Gentlemen:

Reference is made to your application for a non-standard location for your Harrington #6 well to be located 2090 feet from the South line and 2295 feet from the West line of Section 31, Township 27 North, Range 7 West, NMPM, Blanco Mesaverde Pool, Rio Arriba County, New Mexico. The W/2 of said Section 31 shall be dedicated to the well.

By authority granted me under the provisions of Rule 104 F(I), the above-described unorthodox location is hereby approved.

Sincerely,

R. L. STAMETS, DIRECTOR

RLS/DC/dr

cc: Oil Conservation Division - Aztec
Bureau of Land Management - Farmington