

Release January 2, 1986

By DEC

~~MERIDIAN OIL~~

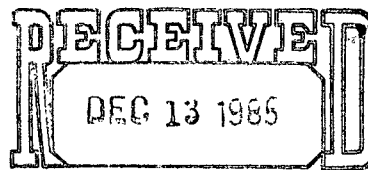

OIL CONSERVATION DIVISION
SANTA FE

December 10, 1985

Mr. Richard Stamets
New Mexico Oil Conservation Division
Post Office Box 2088
Santa Fe, New Mexico 87501

NSC- 2215
RULE-104A(1)

320 Acres ded.
w/2 Section 36

Dear Mr. Stamets:

This is a revised request for administrative approval for an unorthodox gas well location in the Blanco Mesa Verde Pool.

It is intended to locate the El Paso Natural Gas Company's Brookhaven Com #18 at 2510' from the South line and 1330' from the West line of Section 36, T-27-N, R-8-W, San Juan County, New Mexico.

Extremely rough terrain in the form of steep cliffs makes it impossible to build an orthodox location in the southwest quarter of this section.

A copy of this application is being submitted to all offset operators by certified mail with a request that they furnish your Santa Fe office with a Waiver of Objection, and return one copy to this office.

Plats showing the proposed well location and the terrain in Section 36, along with an ownership plat, are attached.

Sincerely yours,

G. W. Brink

Project Drilling Engineer

encl.

WAIVER

_____ hereby waives objection to El Paso Natural Gas Company's application for an unorthodox location for their Brookhaven Com #18 as proposed above.

By: _____

Date: _____

cc: Great Lakes Chemical Corp.
R. C. Wynn
W. C. Russell
Arco Oil & Gas Co

Remarks: Due to the irregular size of this section, the well shall be classified as being in Unit better 1 of Section 36.

EL PASO NATURAL GAS COMPANY

Well Name Brookhaven Com #18, Blanco MV

Footage----- 2510' FSL, 1330' FWL

APPLICATION FOR NON-STANDARD LOCATION

County San Juan State New Mexico Section 36 Township 27N Range 8W

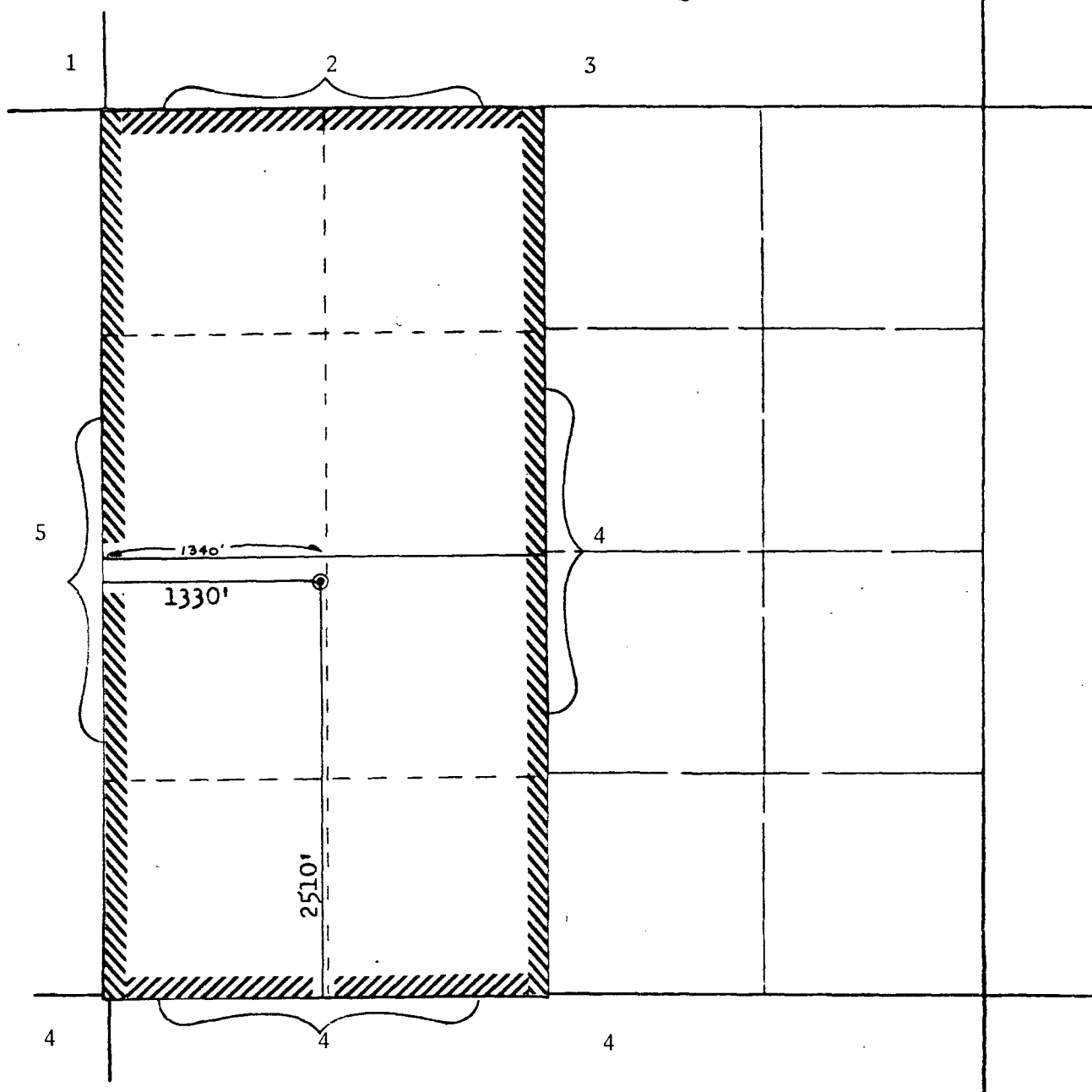

REMARKS:

(1) Great Lakes Chemical Corporation

(2) R. C. Wynn

(3) Wm. C. Russell

(4) El Paso Natural Gas Company

(5) Arco Oil & Gas Company

123

NEW MEXICO OIL CONSERVATION COMMISSION
WELL LOCATION AND ACREAGE DEDICATION PLAT

Form C-102
Supersedes C-128
Effective 1-1-65

All distances must be from the outer boundaries of the Section.

Operator EL PASO NATURAL GAS COMPANY			Lease BROOKHAVEN COM		Well No. 18
Unit Letter L	Section 36	Township 27N	Range 8W	County San Juan	
Actual Footage Location of Well: 2510 feet from the South line and 1330 feet from the West line					
Ground Level Elev. 6133	Producing Formation Mesa Verde		Pool Blanco		Dedicated Acreage: 320 Acres

1. Outline the acreage dedicated to the subject well by colored pencil or hachure marks on the plat below.
2. If more than one lease is dedicated to the well, outline each and identify the ownership thereof (both as to working interest and royalty).
3. If more than one lease of different ownership is dedicated to the well, have the interests of all owners been consolidated by communitization, unitization, force-pooling, etc?

☒ Yes ☐ No If answer is "yes," type of consolidation Communitization

If answer is "no," list the owners and tract descriptions which have actually been consolidated. (Use reverse side of this form if necessary.) _____

No allowable will be assigned to the well until all interests have been consolidated (by communitization, unitization, forced-pooling, or otherwise) or until a non-standard unit, eliminating such interests, has been approved by the Commission. Note: Location moved at request of NMOCD

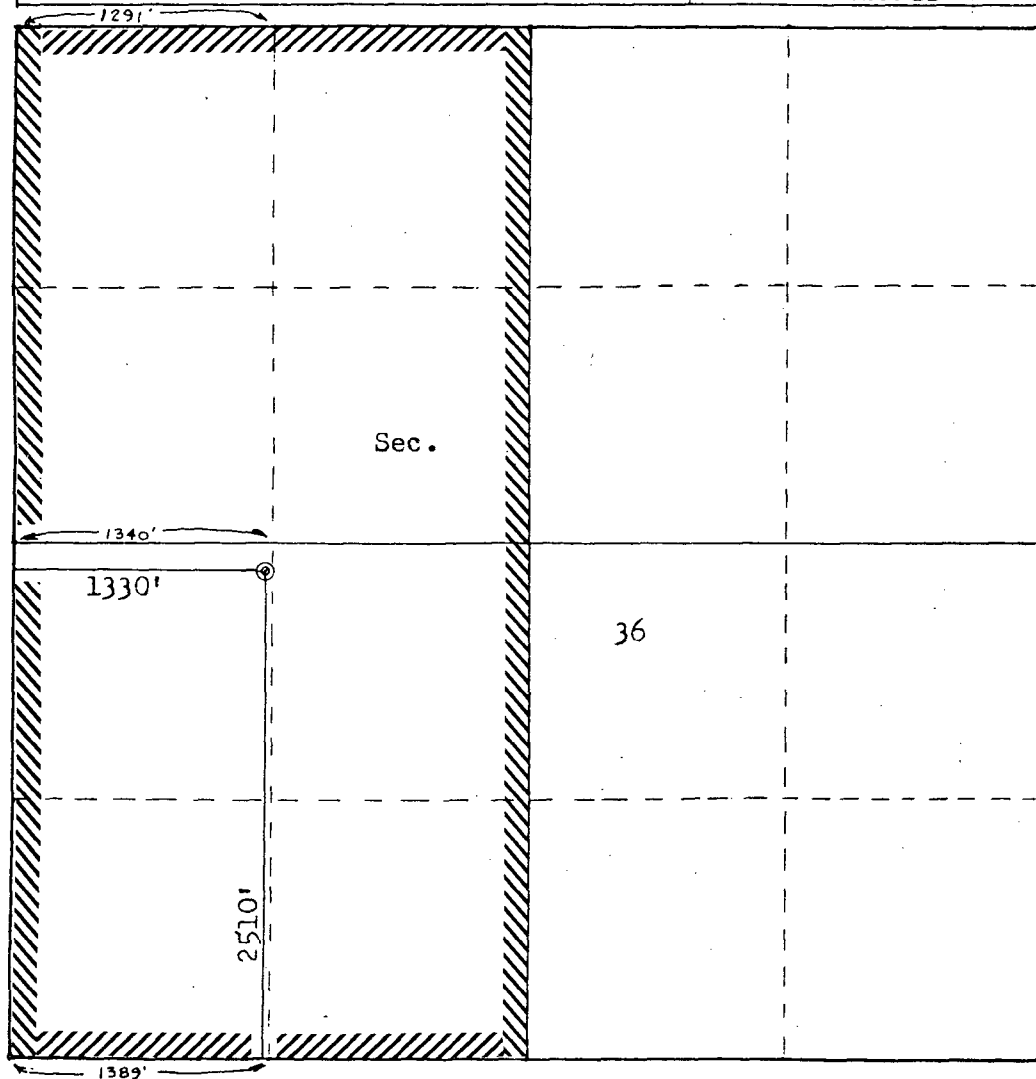

Scale: 1"=1000'

CERTIFICATION

I hereby certify that the information contained herein is true and complete to the best of my knowledge and belief.

Name

Drilling Clerk

Position

El Paso Natural Gas

Company

Date

I hereby certify that the well location shown on this plat was plotted from field notes of actual surveys made by me or under my supervision, and that the same is true and correct to the best of my knowledge and belief.

Date Surveyed

December 10, 1985

Registered Professional Engineer
and Land Surveyor

Fred B. Kerr Jr.
Fred B. Kerr Jr.

Certificate No.

3950



Published by the Geological Survey
USGS

Topographic methods from aerial
field checked 1959
North American datum
New Mexico coordinate system.
Inverse Mercator grid ticks.

APPROXIMATE MEAN
DECLINATION, 1959

Vicinity Map for
EL PASO NATURAL GAS CO. #18 BROOKHAVEN COM
2510' FSL 1330' FWL Sec. 36-T27N-R8W
SAN JUAN COUNTY, NEW MEXICO

THIS MAP COMPLIES WITH NATIONAL MAP SECURITY STANDARDS
FOR SALE BY U.S. GEOLOGICAL SURVEY, DENVER 25, COLORADO OR WASHINGTON 25, D.C.
A FOLDER DESCRIBING TOPOGRAPHIC MAPS AND SYMBOLS IS AVAILABLE ON REQUEST

SCALE 1:62 500

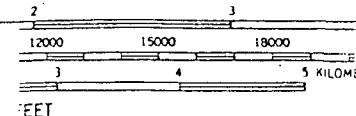

Telephone (214) 748-3545
Telecopier (214) 748-3558

R. C. Wynn

Suite 3545
Inter First Trust
Dallas, Texas 75270

December 18, 1985

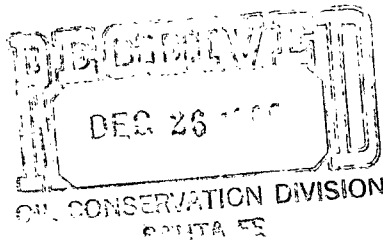

Mr. Richard Stamets
New Mexico Oil Conservation Division
P. O. Box 2088
Santa Fe, New Mexico 87501

Dear Mr. Stamets:

Enclosed herewith is a revised Waiver for an unorthodox location which was forwarded to our office by G. W. Brink, Project Drilling Engineer, Meridian Oil, Inc. This revised Waiver has been fully executed by R. C. Wynn accordingly. Please note that an executed original has also been forwarded to Meridian Oil, Inc. pursuant to their request.

Please advise if we may be of further assistance.

Very truly yours,

R. C. WYNN

Deborah C. Garnett

Deborah C. Garnett

/dgc

Enclosure

MERIDIAN OIL

December 10, 1985

Mr. Richard Stamets
New Mexico Oil Conservation Division
Post Office Box 2088
Santa Fe, New Mexico 87501

Dear Mr. Stamets:

This is a revised request for administrative approval for an unorthodox gas well location in the Blanco Mesa Verde Pool.

It is intended to locate the El Paso Natural Gas Company's Brookhaven Com #18 at 2510' from the South line and 1330' from the West line of Section 36, T-27-N, R-8-W, San Juan County, New Mexico.

Extremely rough terrain in the form of steep cliffs makes it impossible to build an orthodox location in the southwest quarter of this section.

A copy of this application is being submitted to all offset operators by certified mail with a request that they furnish your Santa Fe office with a Waiver of Objection, and return one copy to this office.

Plats showing the proposed well location and the terrain in Section 36, along with an ownership plat, are attached.

Sincerely yours,

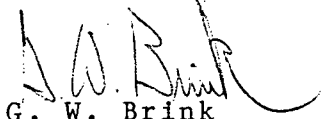

G. W. Brink

Project Drilling Engineer

encl.

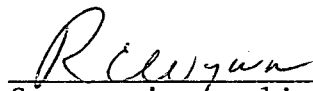
WAIVER

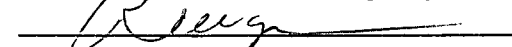
 hereby waives objection to El Paso Natural Gas Company's application for an unorthodox location for their Brookhaven Com #18 as proposed above.

By: 

Date: 12/18/85

cc: Great Lakes Chemical Corp.
R. C. Wynn
W. C. Russell
Arco Oil & Gas Co

MERIDIAN OIL

NSC 2215
RECEIVED

DEC 16 1985

L.G. Vaughan
R.B. McDONALD

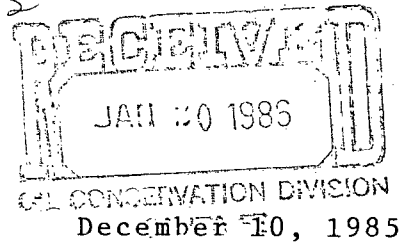

Mr. Richard Stamets
New Mexico Oil Conservation Division
Post Office Box 2088
Santa Fe, New Mexico 87501

Dear Mr. Stamets:

This is a revised request for administrative approval for an unorthodox gas well location in the Blanco Mesa Verde Pool.

It is intended to locate the El Paso Natural Gas Company's Brookhaven Com #18 at 2510' from the South line and 1330' from the West line of Section 36, T-27-N, R-8-W, San Juan County, New Mexico.

Extremely rough terrain in the form of steep cliffs makes it impossible to build an orthodox location in the southwest quarter of this section.

A copy of this application is being submitted to all offset operators by certified mail with a request that they furnish your Santa Fe office with a Waiver of Objection, and return one copy to this office.

Plats showing the proposed well location and the terrain in Section 36, along with an ownership plat, are attached.

Sincerely yours,

G. W. Brink

Project Drilling Engineer

enci.

WAIVER

Great Lakes Chemical Corp. hereby waives objection to El Paso Natural Gas Company's application for an unorthodox location for their Brookhaven Com #18 as proposed above.

By: Lawrence A. Vaughan

Date: Jan 14, 1986

cc: Great Lakes Chemical Corp.
R. C. Wynn
W. C. Russell
Arco Oil & Gas Co

MERIDIAN OIL

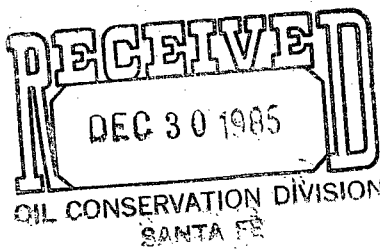

December 10, 1985

RECEIVED

DEC 16 1985

Mr. Richard Stamets
New Mexico Oil Conservation Division
Post Office Box 2088
Santa Fe, New Mexico 87501

Dear Mr. Stamets:

This is a revised request for administrative approval for an unorthodox gas well location in the Blanco Mesa Verde Pool.

It is intended to locate the El Paso Natural Gas Company's Brookhaven Com #18 at 2510' from the South line and 1330' from the West line of Section 36, T-27-N, R-8-W, San Juan County, New Mexico.

Extremely rough terrain in the form of steep cliffs makes it impossible to build an orthodox location in the southwest quarter of this section.

A copy of this application is being submitted to all offset operators by certified mail with a request that they furnish your Santa Fe office with a Waiver of Objection, and return one copy to this office.

Plats showing the proposed well location and the terrain in Section 36, along with an ownership plat, are attached.

Sincerely yours,

G. W. Brink

Project Drilling Engineer

encl.

WAIVER

ARCO Oil and Gas hereby waives objection to El Paso Natural Gas Company's application for an unorthodox location for their Brookhaven Com #18 as proposed above.

By: G. Stewart

Date: 12/23/85

cc: Great Lakes Chemical Corp.
R. C. Wynn
W. C. Russell
Arco Oil & Gas Co