

*Return 3-24-87*

*By DCC*

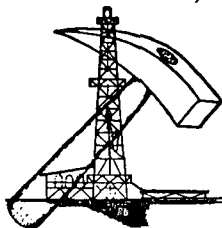

**HARVARD PETROLEUM CORPORATION**

TELEPHONE 505 623-1581

P. O. BOX 936

ROSWell, NEW MEXICO 88201

March 20, 1987

*NSL-2330  
RULE-104 F(I)*

New Mexico State Oil Conservation Division  
P.O. Box 1148  
Santa Fe, NM 87501

*Undesignated West Pecos  
Slope Abo Gas Pool*

Attention: Mr. David Catanack

*160 Acres dec'd  
SE 1/4 Sect 34*

RE: Queso State #3  
Township 5 South, Range 22 East, NMPM  
Section 34: NW/4 SE/4  
Chaves County, NM  
Pecos Slope Abo Prospect

Gentlemen:

Enclosed please find a copy of Harvard Petroleum Corporation's Application For Permit to Drill, Deepen, or Plug Back which was filed on March 17, 1987, in your Artesia District Office, concerning the captioned well.

The location for the captioned well is a non-standard location due to the presence of a deep gully which restricts Harvard's access to a standard location thereby requiring the location for the captioned well to be staked 1980' from the East line and 1372' from the South line.

Harvard hereby requests your approval of the proposed location for the captioned well based on the terrain features and problems described above.

Thank you for your immediate attention to this matter.

Very truly yours,

HARVARD PETROLEUM CORPORATION

*Bill J. Milstead*

Bill J. Milstead  
Land Manager

BJM/cn

Enclosure

*Notes: Petroleum  
Corp. is offset to  
South, called by Jim  
Shultz 3-24-87 giving verbal  
approval. DCC.*

NO. OF COPIES RECEIVED	
DISTRIBUTION	
SANTA FE	
FILE	
U.S.G.S.	
LAND OFFICE	
OPERATOR	

# NEW MEXICO OIL CONSERVATION COMMISSION

Form C-101  
Revised 1-4-65

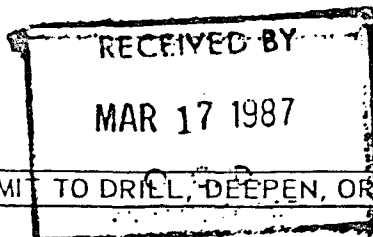

5A. Indicate Type of Lease
STATE <input checked="" type="checkbox"/> FEE <input type="checkbox"/>
5. State Oil & Gas Lease No.
LG - 5564

## APPLICATION FOR PERMIT TO DRILL, DEEPEN, OR PLUG BACK

1a. Type of Work	7. Unit Agreement Name
b. Type of Well DRILL <input checked="" type="checkbox"/> DEEPEN <input type="checkbox"/> PLUG BACK <input type="checkbox"/> OIL WELL <input type="checkbox"/> GAS WELL <input checked="" type="checkbox"/> OTHER <input type="checkbox"/> SINGLE ZONE <input checked="" type="checkbox"/> MULTIPLE ZONE <input type="checkbox"/>	8. Farm or Lease Name
2. Name of Operator	9. Well No.
Harvard Petroleum Corporation	#3
3. Address of Operator	10. Field and Pool, or Wildcat
P.O. Box 936 Roswell, New Mexico 88201	Indesignated
4. Location of Well	West Pecos Abo Slope
UNIT LETTER J LOCATED 1980 FEET FROM THE East LINE	
AND 1372 FEET FROM THE South LINE OF SEC. 34 TWP. 5S RGE. 22E NMPM	
12. County	
Chaves	
19. Proposed Depth	19A. Formation
3800'	Abo
20. Rotary or C.T.	
Rotary	
21. Elevation (show whether DF, RT, etc.)	21A. Kind & Status Plug. Bond
GL. - 4063	Blanket
21B. Drilling Contractor	22. Approx. Date Work will start
Rio Grand Drilling	March 30, 1987

23.

## PROPOSED CASING AND CEMENT PROGRAM

SIZE OF HOLE	SIZE OF CASING	WEIGHT PER FOOT	SETTING DEPTH	SACKS OF CEMENT	EST. TOP
12 1/4	8 5/8	24#	900'	850 sx	Surface
7 7/8	4 1/2	10.5#	3600'	1250 sx	

Mud Program - Fresh Water to 900'. Gelled water to TD.  
BOP installed on 8 5/8 casing.

IN ABOVE SPACE DESCRIBE PROPOSED PROGRAM: IF PROPOSAL IS TO DEEPEN OR PLUG BACK, GIVE DATA ON PRESENT PRODUCTIVE ZONE AND PROPOSED NEW PRODUCTIVE ZONE. GIVE BLOWOUT PREVENTER PROGRAM, IF ANY.

I hereby certify that the information above is true and complete to the best of my knowledge and belief.

Signed Jeff Harvard Title Vice Pres. Operations Date March 16, 1987

(This space for State Use)

APPROVED BY \_\_\_\_\_ TITLE \_\_\_\_\_ DATE \_\_\_\_\_

CONDITIONS OF APPROVAL, IF ANY:

All distances must be from the outer boundaries of the Section.

Operator Harvard Petroleum Corporation			Lease Queso State			Well No. #3		
Grid Letter J	Section 34	Township 5 South	Range 22 East	County Chaves				
Actual Footage Location of Well: 1372 feet from the South line and 1980 feet from the East line								
Ground Level Elev. 4063	Producing Formation Abo		Pool Und. W. Pecos Slope Abo			Dedicated Acres 160		Acres

1. Outline the acreage dedicated to the subject well by colored pencil or hatchure marks on the plat below.
  2. If more than one lease is dedicated to the well, outline and identify the ownership thereof (both as to working interest and royalty).
  3. If more than one lease of different ownership is dedicated to the well, have the interests of all owners been consolidated by communitization, unitization, force-pooling, etc? **O. C. D.**

RECEIVED BY  
MAR 17 1987
- ☐ Yes ☒ No If answer is "yes," type of consolidation \_\_\_\_\_

If answer is "no," list the owners and tract descriptions which have actually been consolidated. (Use reverse side of this form if necessary.) \_\_\_\_\_

No allowable will be assigned to the well until all interests have been consolidated (by communitization, unitization, forced-pooling, or otherwise) or until a non-standard unit, eliminating such interests, has been approved by the Division.

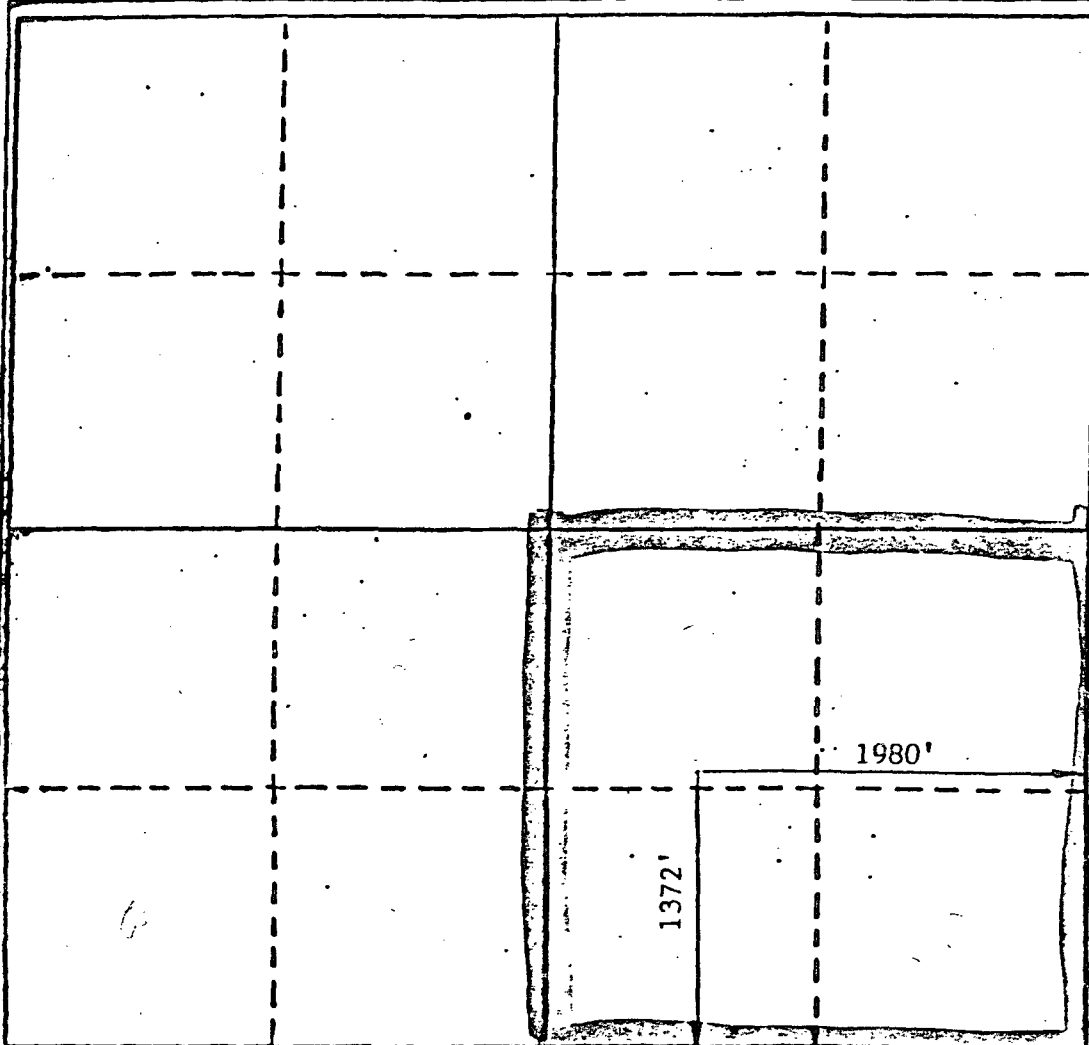

#### CERTIFICATION

I hereby certify that the information contained herein is true and complete to the best of my knowledge and belief.

Name \_\_\_\_\_

Position \_\_\_\_\_

Vice - Pres. Operations

Company \_\_\_\_\_

Harvard Petroleum Corp.

Date \_\_\_\_\_

March 16, 1987

I hereby certify that the well location shown on this plat was plotted from field notes of actual surveys made by me or under my supervision, and that the same is true and correct to the best of my knowledge and belief.

Date Surveyed \_\_\_\_\_

Registered Professional Engineer and/or Land Surveyor

John D. Jaouets P.E. & L.S.

Certificate No. \_\_\_\_\_

6290

330 660 990 1320 1650 1980 2310 2640 2970 3300 3630 3960 4290

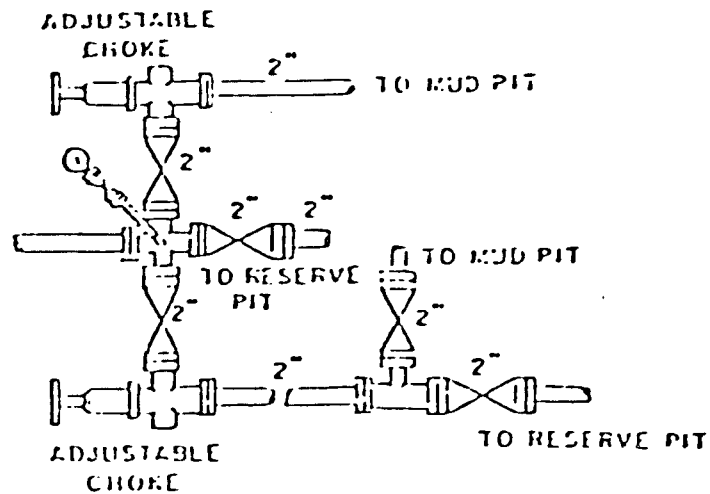
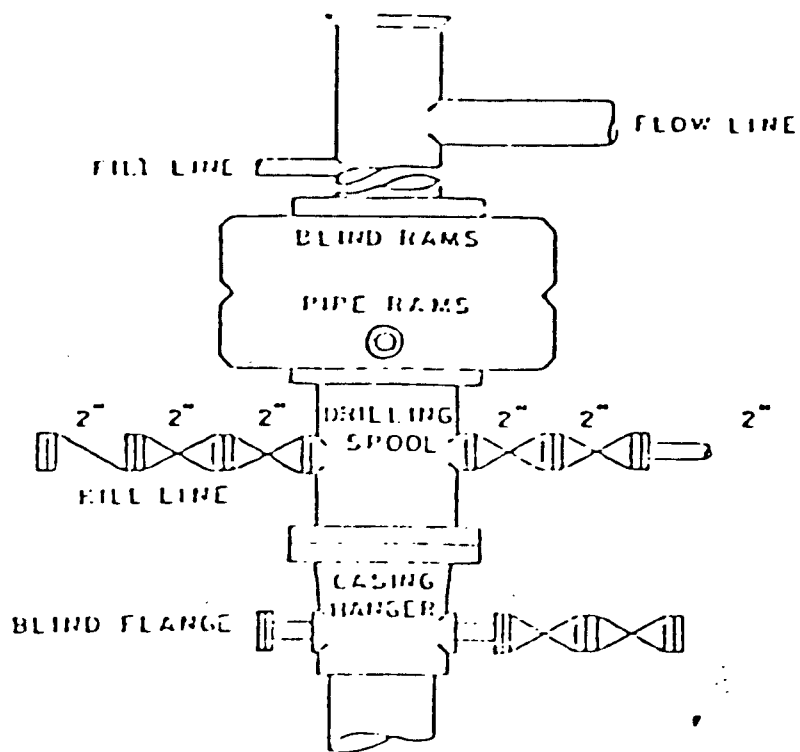

### BOP DIAGRAM

3000# Working Pressure  
Rams Operated Daily

EXHIBIT B