

dugan production corp.

RECEIVED  
BLM MAIL ROOM

87 AUG -5 AM 9:56

CERTIFIED MAIL - RETURN RECEIPT REQUESTED

FARMINGTON RESOURCE AREA  
FARMINGTON, NEW MEXICO

*Dave Catanach*

August 3, 1987

Bureau of Land Management  
Attn: John Keller  
Caller Service 4104  
Farmington, NM 87499

RECEIVED  
AUG 10 1987  
OIL CON. DIV.  
DIST. 3

Re: Application for Administrative Approval of  
Unorthodox Location for Dugan Production Corp's  
Sears Roebuck No. 2  
1650' FNL & 330' FEL  
Section 5, T24N, R10W, NMPM  
San Juan County, New Mexico

Dear Mr. Keller:

Enclosed are copies of the instruments filed with the New Mexico Oil Conservation Division regarding the Application for Administrative Approval of the Unorthodox Location for the subject well.

If you do not have any objection to this unorthodox location, please sign all three copies of this waiver. Please send one executed copy to David Catanach, New Mexico Oil Conservation Division, P O Box 2088, Santa Fe, New Mexico 87504-2088; and return one executed copy to our office. Stamped envelopes are enclosed for your convenience. The remaining copy is for your records.

Thank you in advance for your assistance and cooperation in this matter.

Sincerely,

*Jim L. Jacobs*  
Jim L. Jacobs  
Geologist

cg

encs.

RECEIVED  
AUG 25 1987  
OIL CONSERVATION DIVISION  
SANTA FE

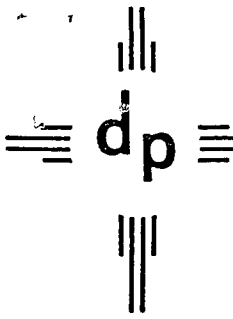

dugan production corp.

RECEIVED  
BLM MAIL ROOM

87 AUG -5 AM 9:56

August 3, 1987  
FARMINGTON RESOURCE AREA  
FARMINGTON, NEW MEXICO

David Catanach  
New Mexico Oil Conservation Division  
P O Box 2088  
Santa Fe, NM 87504-2088

Re: Application for Administrative Approval of  
Unorthodox Location for Dugan Production Corp's  
Sears Roebuck No. 2  
1650' FNL & 330' FEL  
Section 5, T24N, R10W, NMPM  
San Juan County, New Mexico

RECEIVED  
AUG 10 1987  
OIL CON. DIV.  
DIST. 3

Dear Mr. Catanach:

We hereby request approval of an unorthodox location for the subject well.  
Copies of the well location plat, topographic map and a production map  
showing offsetting operators are attached for your reference.

The unorthodox location is necessary due to plugging back the Gallup formation  
and recompleting in the Fruitland/PC formation.

A copy of this application is being submitted to all offsetting operators by  
certified mail with a request that they furnish your office with a waiver of  
objection.

We request your approval of this location under the provisions of NMOCD  
Rule 104-F.

Sincerely,

Jim L. Jacobs  
Geologist

cg

cc: NMOCD, Aztec  
Bureau of Land Management

Coleman Oil & Gas, Inc.  
Mobil Oil Corp.

NM State Land Office

WAIVER

BUREAU OF LAND MANAGEMENT hereby waives objection to the above  
application for unorthodox location.

8/7/87

Date

By:

SIGN & RETURN

THIS COPY

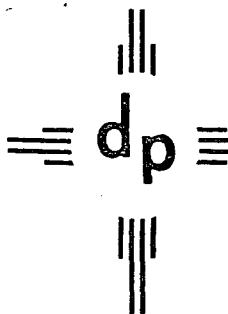

# dugan production corp.

August 3, 1987

David Catanach  
New Mexico Oil Conservation Division  
P O Box 2088  
Santa Fe, NM 87504-2088

Re: Application for Administrative Approval of  
Unorthodox Location for Dugan Production Corp's  
Sears Roebuck No. 2  
1650' FNL & 330' FEL  
Section 5, T24N, R10W, NMPM  
San Juan County, New Mexico

Dear Mr. Catanach:

We hereby request approval of an unorthodox location for the subject well.  
Copies of the well location plat, topographic map and a production map  
showing offsetting operators are attached for your reference.

The unorthodox location is necessary due to plugging back the Gallup formation  
and recompleting in the Fruitland/PC formation.

A copy of this application is being submitted to all offsetting operators by  
certified mail with a request that they furnish your office with a waiver of  
objection.

We request your approval of this location under the provisions of NMOCD  
Rule 104-F.

Sincerely,

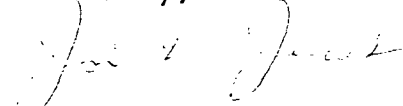
  
Jim L. Jacobs  
Geologist

cg

cc: NMOCD, Aztec  
Bureau of Land Managment

Coleman Oil & Gas, Inc.  
Mobil Oil Corp.

NM State Land Office

## WAIVER

NEW MEXICO STATE LAND OFFICE hereby waives objection to the above  
application for unorthodox location.

8-11-87

Date

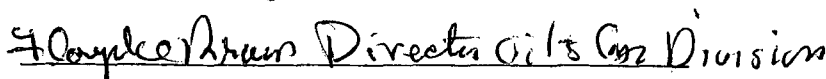
  
By:

**SIGN & RETURN**

**THIS COPY**

to nmocd

dugan production corp.

August 3, 1987

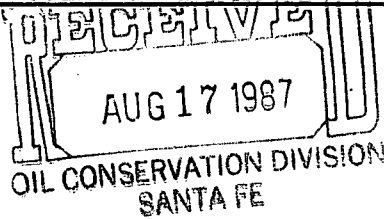

David Catanach  
New Mexico Oil Conservation Division  
P O Box 2088  
Santa Fe, NM 87504-2088

Re: Application for Administrative Approval of  
Unorthodox Location for Dugan Production Corp's  
Sears Roebuck No. 2  
1650' FNL & 330' FEL  
Section 5, T24N, R10W, NMPM  
San Juan County, New Mexico

Dear Mr. Catanach:

We hereby request approval of an unorthodox location for the subject well. Copies of the well location plat, topographic map and a production map showing offsetting operators are attached for your reference.

The unorthodox location is necessary due to plugging back the Gallup formation and recompleting in the Fruitland/PC formation.

A copy of this application is being submitted to all offsetting operators by certified mail with a request that they furnish your office with a waiver of objection.

We request your approval of this location under the provisions of NMOCD Rule 104-F.

Sincerely,

Jim L. Jacobs  
Geologist

cg

cc: NMOCD, Aztec  
Bureau of Land Managment

Coleman Oil & Gas, Inc.  
Mobil Oil Corp.

NM State Land Office

WAIVER

GEORGE COLEMAN hereby waives objection to the above  
application for unorthodox location.

8-12-1987

Date

By:

**SIGN & RETURN  
THIS COPY**

Release Date  
Aug 25, 1987

Be DEC

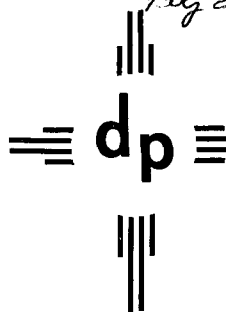

# dugan production corp.

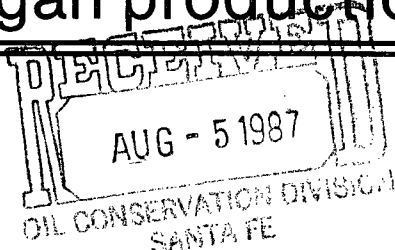

August 3, 1987

NSL-2389  
RULE-104F(L)

David Catanach  
New Mexico Oil Conservation Division  
P O Box 2088  
Santa Fe, NM 87504-2088

Re: Application for Administrative Approval of  
Unorthodox Location for Dugan Production Corp's  
Sears Roebuck No. 2  
1650' FNL & 330' FEL  
Section 5, T24N, R10W, NMPM  
San Juan County, New Mexico

Undesignated Fruitland  
& Undesignated Pictured Cliffs  
Pools  
160 Acre dedication  
NE 1/4 Section 5

Dear Mr. Catanach:

We hereby request approval of an unorthodox location for the subject well.  
Copies of the well location plat, topographic map and a production map  
showing offsetting operators are attached for your reference.

The unorthodox location is necessary due to plugging back the Gallup formation  
and recompleting in the Fruitland/PC formation.

A copy of this application is being submitted to all offsetting operators by  
certified mail with a request that they furnish your office with a waiver of  
objection.

We request your approval of this location under the provisions of NMOCD  
Rule 104-F.

Sincerely,

Jim L. Jacobs  
Geologist

cg

cc: NMOCD, Aztec  
Bureau of Land Management

Coleman Oil & Gas, Inc.  
Mobil Oil Corp.

NM State Land Office

## WAIVER

hereby waives objection to the above  
application for unorthodox location.

Date

By:

NEW MEXICO OIL CONSERVATION COMMISSION  
WELL LOCATION AND ACREAGE DEDICATION PLAT

Form C-102  
Supersedes C-128  
Effective 1-1-65

All distances must be from the outer boundaries of the Section.

Operator <b>Dugan Production Corporation</b>		Lease <b>Sears Roebuck</b>		Well No. <b>2</b>
Unit Letter <b>H</b>	Section <b>5</b>	Township <b>24 North</b>	Range <b>10 West</b>	County <b>San Juan</b>
Actual Footage Location of Well: <b>1650</b> feet from the <b>North</b> line and <b>330</b> feet from the <b>East</b> line				
Ground Level Elev. <b>6895</b>	Producing Formation <b>Fruitland/PC</b>	Pool <b>Undesignated FR PC</b>	Dedicated Acreage: <b>160</b> Acres	

1. Outline the acreage dedicated to the subject well by colored pencil or hachure marks on the plat below.
2. If more than one lease is dedicated to the well, outline each and identify the ownership thereof (both as to working interest and royalty).
3. If more than one lease of different ownership is dedicated to the well, have the interests of all owners been consolidated by communitization, unitization, force-pooling, etc?

☐ Yes ☐ No If answer is "yes," type of consolidation \_\_\_\_\_

If answer is "no," list the owners and tract descriptions which have actually been consolidated. (Use reverse side of this form if necessary.) \_\_\_\_\_

No allowable will be assigned to the well until all interests have been consolidated (by communitization, unitization, forced-pooling, or otherwise) or until a non-standard unit, eliminating such interests, has been approved by the Commission.

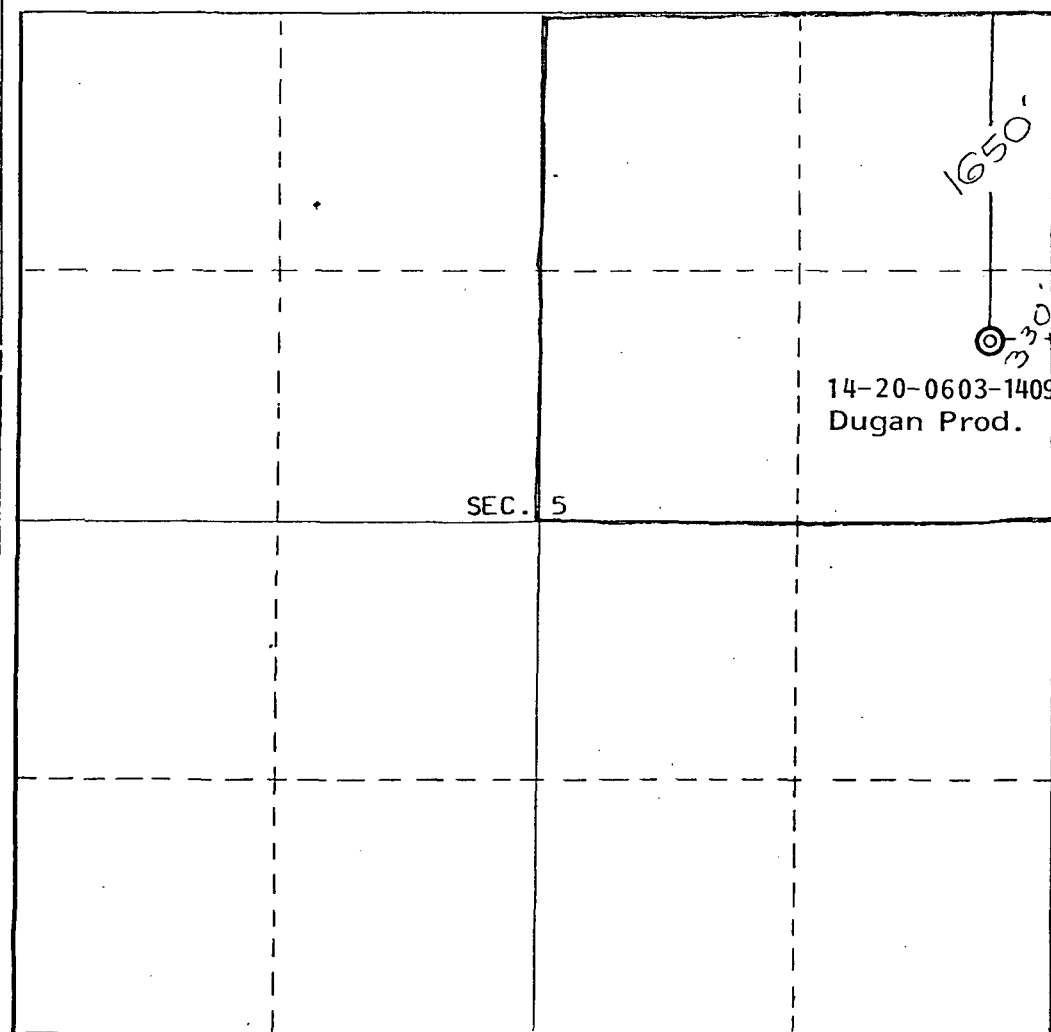

CERTIFICATION

I hereby certify that the information contained herein is true and complete to the best of my knowledge and belief.

Name  
**Jim L. Jacobs**  
Position  
**Geologist**  
Company  
**Dugan Production Corp.**  
Date  
**7-2-87**

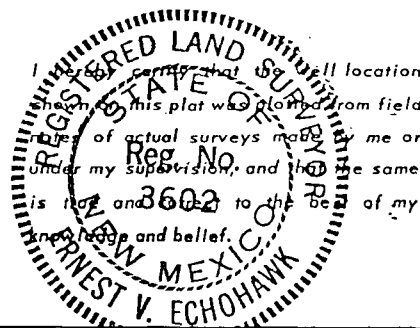

Date Surveyed  
**August 9, 1978**  
Registered Professional Engineer  
and/or Land Surveyor  
**E. V. Echohawk**  
Certificate No. **3602**  
**E.V. Echohawk LS**





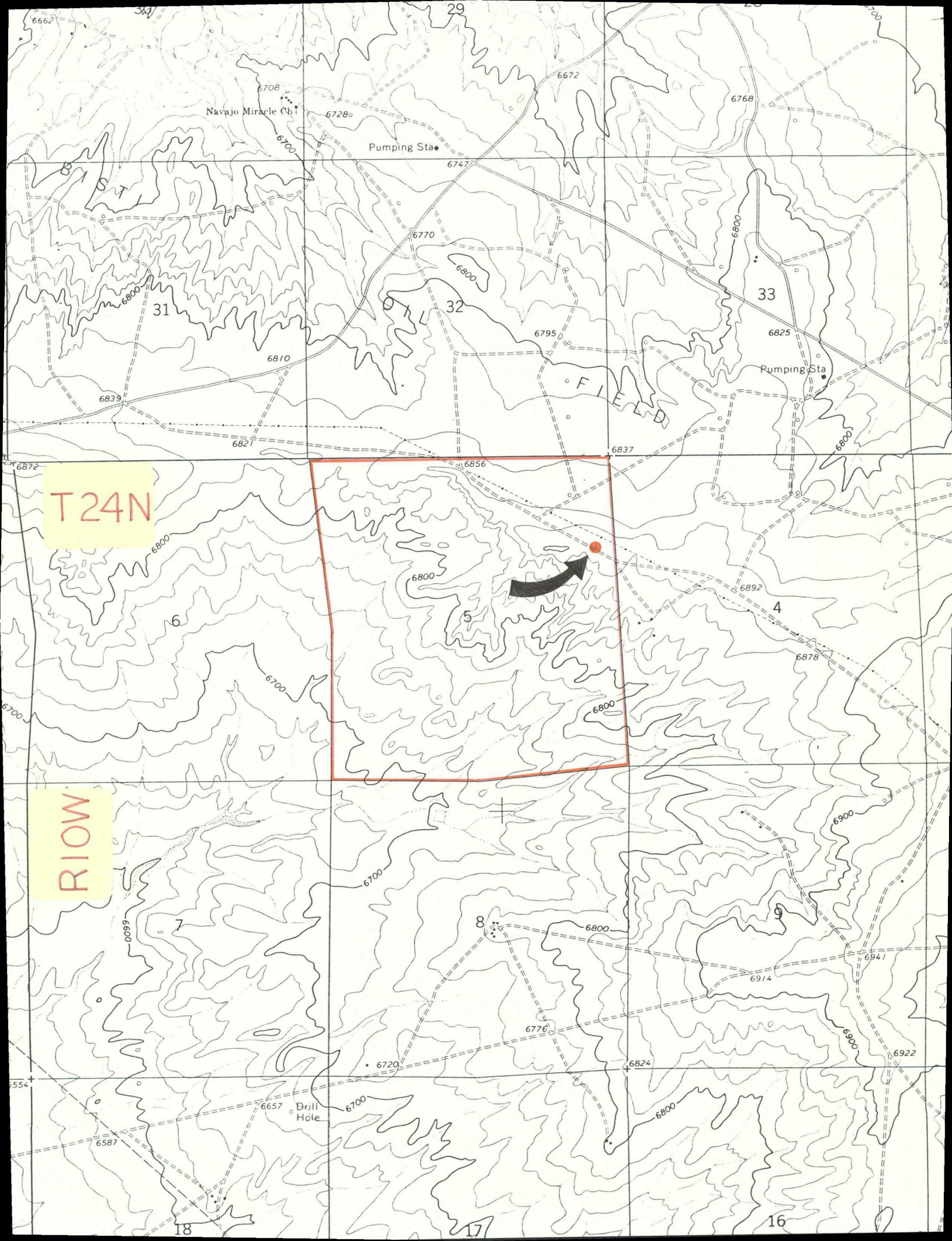



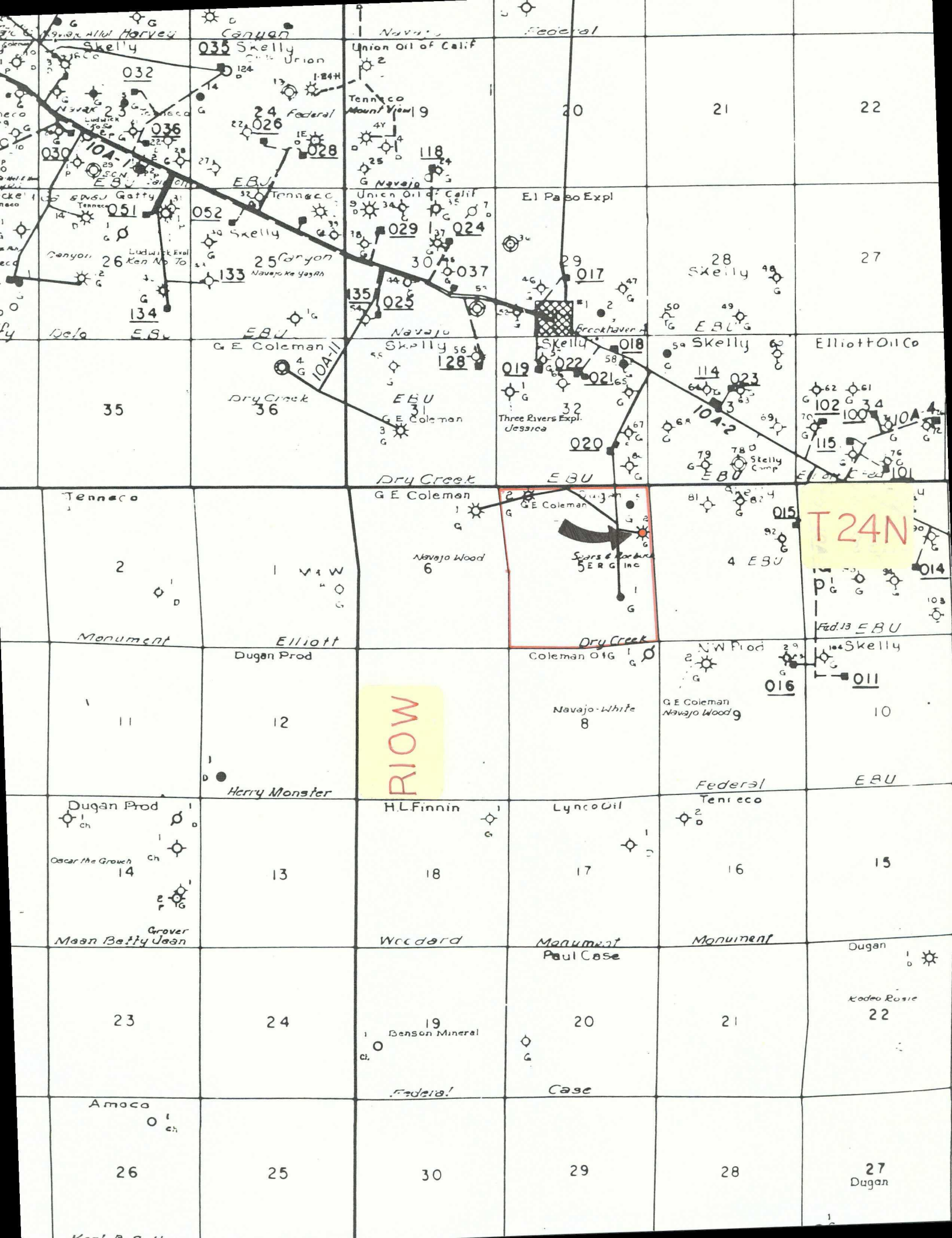



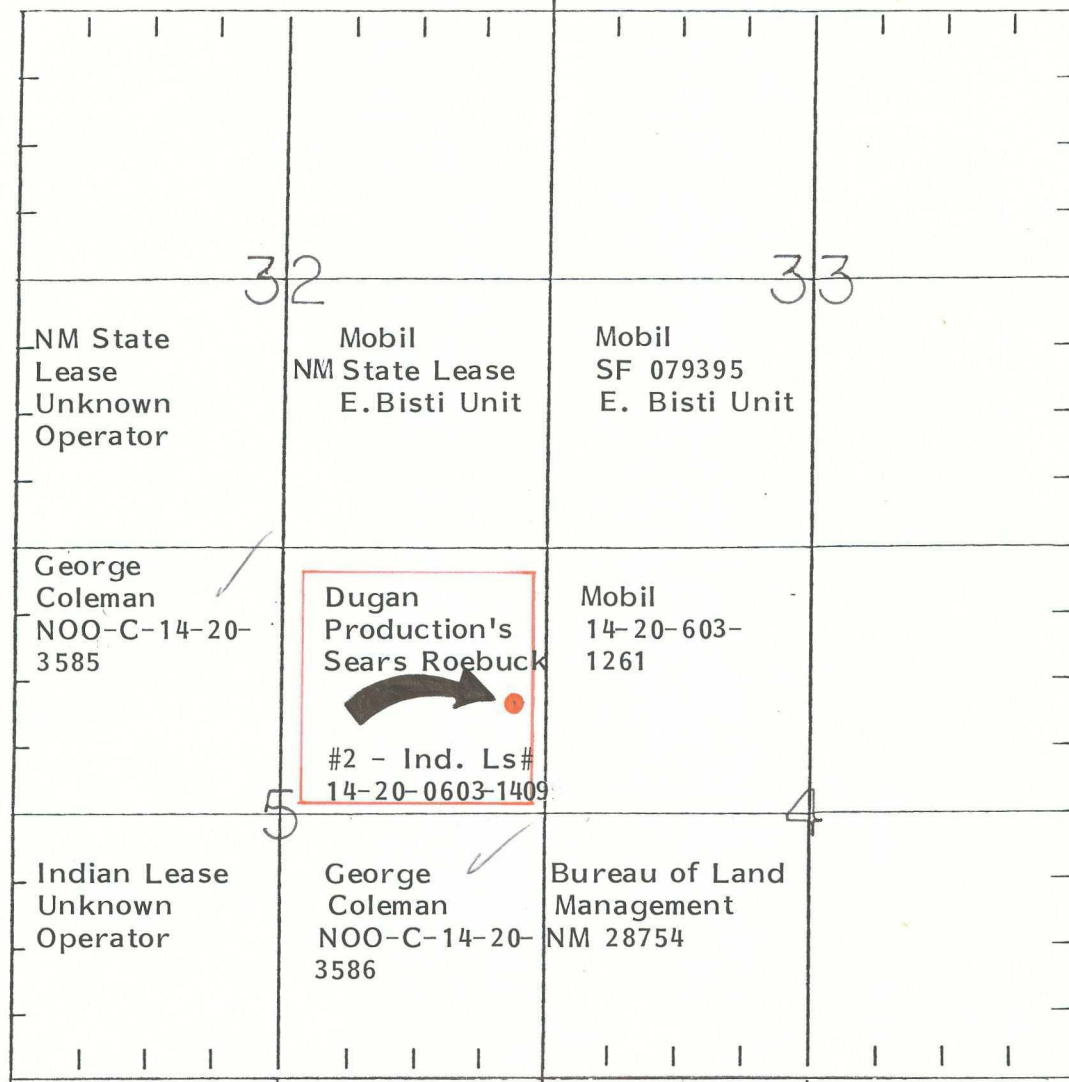

R-10W



STATE OF NEW MEXICO  
ENERGY AND MINERALS DEPARTMENT

RECEIVED  
AUG 11 1987  
OIL CONSERVATION DIVISION  
AZTEC DISTRICT OFFICE

1000 RIO BRAZOS ROAD  
AZTEC, NEW MEXICO 87410  
(505) 334-6178

OIL CONSERVATION DIVISION  
BOX 2088  
SANTA FE, NEW MEXICO 87501

DATE 8-6-87

RE: Proposed MC \_\_\_\_\_  
Proposed DHC \_\_\_\_\_  
Proposed NSL X \_\_\_\_\_  
Proposed SWD \_\_\_\_\_  
Proposed WFX \_\_\_\_\_  
Proposed PMX \_\_\_\_\_

Gentlemen:

I have examined the application dated 8-5-87  
for the Dugan Production Corp. Series Bachel #2 H-5-24N-10W  
Operator Lease and Well No. Unit, S-T-R

and my recommendations are as follows:

Approve  
\_\_\_\_\_  
\_\_\_\_\_  
\_\_\_\_\_  
\_\_\_\_\_

Yours truly,

E. J. Burch