

Mallon Oil Company

Denver/Colorado ♦ Carlsbad/New Mexico

NSL

10/20/97

a Mallon Resources subsidiary

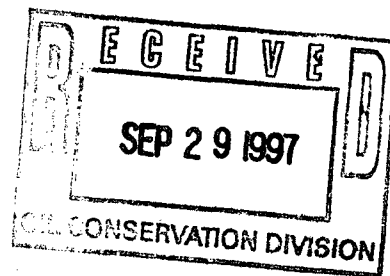

September 26, 1997

State of New Mexico
Oil Conservation Division
2040 South Pacheco
Santa Fe, NM 87505

Attn: Mr. Mike Stogner

Re: Jicarilla 459 No. 3
Sec. 18, T30N-R03W
Rio Arriba County, New Mexico

Dear Mr. Stogner:

Mallon Oil Company became the designated operator of the above referenced well effective January 1, 1997. There is Non Standard Location approval (no. 2575) for the Pictured Cliffs formation.

In August 1997, Mallon Oil Company temporarily abandoned the Pictured Cliffs formation and recompleted the well into the Ojo Alamo formation which is also a non standard location.

Mallon Oil Company would like to apply for Non Standard Location approval for the Ojo Alamo at the existing wellbore location. Mallon Oil Company is the sole operator within a half mile radius of this location.

Please find enclosed a copy of Mallon Oil Company's C-102 which was sent August 27, 1997 and an approved copy of the completion report (3160-4).

Should you need any further information, please contact the undersigned at 505-885-4596.

Sincerely,

MALLON OIL COMPANY

A handwritten signature in cursive script, appearing to read "Duane C. Winkler". The signature is fluid and extends across the line.

Duane C. Winkler
Operations Manager

Enclosures

District I
PO Box 1980, Hobbs, NM 88241-1980
District II
PO Drawer DD, Artesia, NM 88211-0719
District III
1000 Rio Brazos Rd., Aztec, NM 87410
District IV
PO Box 2088, Santa Fe, NM 87504-2088

State of New Mexico
Energy, Minerals & Natural Resources Department

OIL CONSERVATION DIVISION
PO Box 2088
Santa Fe, NM 87504-2088

Form C-102
Revised February 10, 1994
Instructions on back
Submit to Appropriate District Office
State Lease - 4 Copies
Fee Lease - 3 Copies

☐ AMENDED REPORT

WELL LOCATION AND ACREAGE DEDICATION PLAT

API Number 30-039-24306		Pool Code 96538	Pool Name Ojo Alamo
Property Code 20465	Property Name Jicarilla 459		Well Number 3
OCRID No. 013925	Operator Name Mallon Oil Company		Elevation 7074' GL

¹⁰ Surface Location

LL or lot no.	Section	Township	Range	Lot Ida	Feet from the	North/South line	Feet from the	East/West line	County
G	18	30N	03W		1658	North	1901	East	Rio Arriba

¹¹ Bottom Hole Location If Different From Surface

LL or lot no.	Section	Township	Range	Lot Ida	Feet from the	North/South line	Feet from the	East/West line	County

¹² Dedicated Acres 160	¹³ Joint or Infill N	¹⁴ Consolidation Code N/A	¹⁵ Order No. N/A
--------------------------------------	------------------------------------	---	--------------------------------

NO ALLOWABLE WILL BE ASSIGNED TO THIS COMPLETION UNTIL ALL INTERESTS HAVE BEEN CONSOLIDATED
OR A NON-STANDARD UNIT HAS BEEN APPROVED BY THE DIVISION

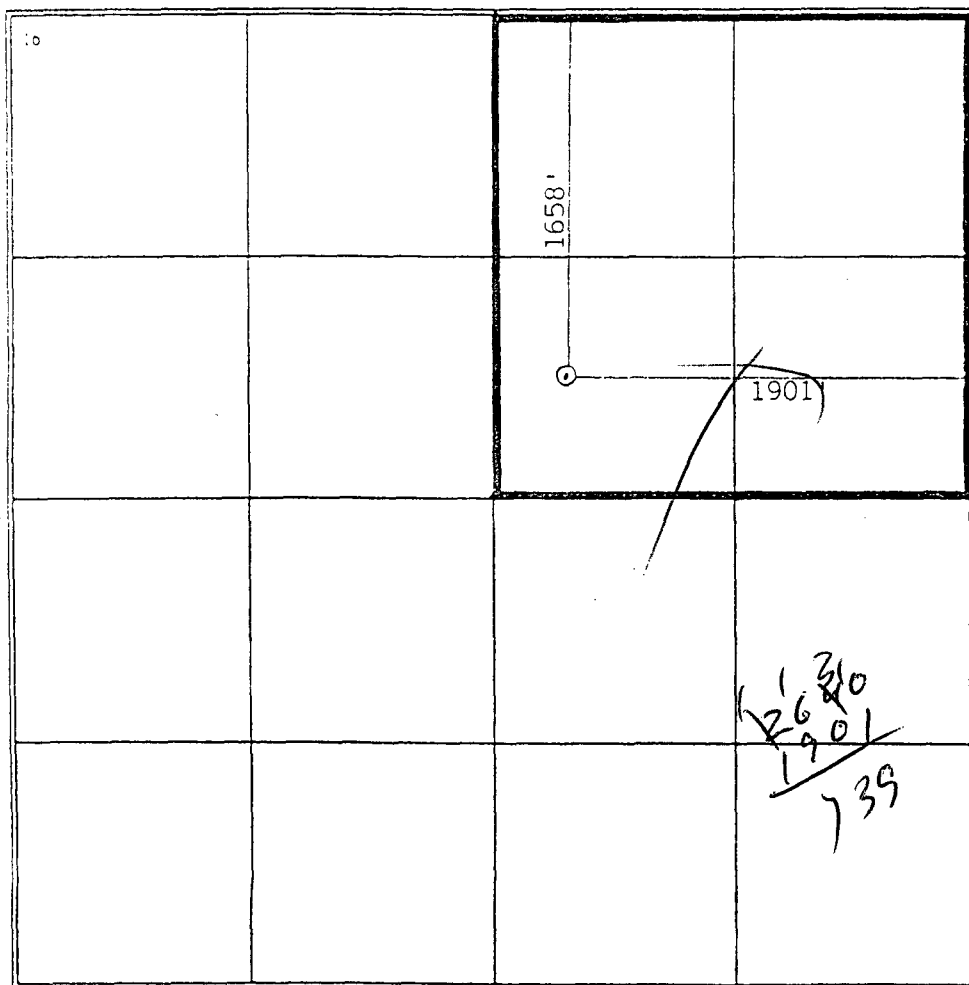
	¹⁷ OPERATOR CERTIFICATION I hereby certify that the information contained herein is true and complete to the best of my knowledge and belief. <u>Theresa A. McAndrews</u> Signature Theresa A. McAndrews Printed Name Office Manager Title 08/27/97 Date
	¹⁸ SURVEYOR CERTIFICATION I hereby certify that the well location shown on this plat was plotted from field notes of actual surveys made by me or under my supervision, and that the same is true and correct to the best of my belief. Date of Survey Signature and Seal of Professional Surveyor: (790) Certificate Number

UNITED STATES
DEPARTMENT OF THE INTERIOR
BUREAU OF LAND MANAGEMENTSUBMIT IN DUPLICATE*
(See other instructions
on reverse side)

CONFIDENTIAL

FORM APPROVED
OMB NO 1004-0137

Expires: February 28, 1995

WELL COMPLETION OR RECOMPLETION REPORT AND LOG *

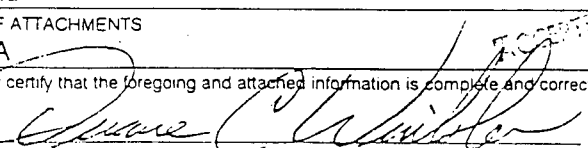
1a. TYPE OF WELL OIL <input type="checkbox"/> GAS <input type="checkbox"/> WELL <input type="checkbox"/> WELL <input checked="" type="checkbox"/> DRY <input type="checkbox"/> OTHER <input type="checkbox"/>		5. LEASE DESIGNATION AND SERIAL NO JIC459	
b. TYPE OF COMPLETION NEW <input type="checkbox"/> WORK <input type="checkbox"/> DEEP- <input type="checkbox"/> PLUG <input type="checkbox"/> DIFF <input type="checkbox"/> WELL <input type="checkbox"/> OVER <input checked="" type="checkbox"/> EN <input type="checkbox"/> BACK <input type="checkbox"/> RESVR <input type="checkbox"/> OTHER <input type="checkbox"/>		6. IF INDIAN, ALLOTTEE OR TRIBE NAME Jicarilla Apache	
2. NAME OF OPERATOR Mallon Oil Company		7. UNIT AGREEMENT NAME N/A	
3. ADDRESS AND TELEPHONE NO P.O. Box 3256, Carlsbad, NM 88220 (505) 885-4596		8. FARM OR LEASE NAME, WELL NO Jicarilla 459 No. 3	
4. LOCATION OF WELL (Report location clearly and in accordance with any State requirements *) At surface 1658' FNL and 1901' FEL (SW NE) Unit G At top prod. interval reported below 1658' FNL and 1901' FEL (SW NE) Unit G At total depth 1658' FNL and 1901' FEL (SW NE) Unit G		9. API WELL NO. 30-039-24306	
14. PERMIT NO. N/A		10. FIELD AND POOL, OR WILDCAT E. Blanco, Ojo Alamo	
DATE ISSUED N/A		11. SEC., T., R., M., OR BLOCK AND SURVEY CR AREA Sec. 18, T30N-R3W	
15. DATE SPUDDED 10/17/88		12. COUNTY OR PARISH Rio Arriba	
16. DATE TD REACHED 10/21/88		13. STATE New Mexico	
17. DATE COMP. (Ready to Prod.) 08/16/97		18. ELEVATION (DF, RKB, RT, GR, ETC*) 7074' GL	
19. ELEV. CASINGHEAD 7075'		20. TOTAL DEPTH, MD & TVD 4040' KB	
21. PLUGBACK TD, MD & TVD 3942' KB		22. IF MULTIPLE COMP., HOW MANY* N/A	
23. INTERVALS DRILLED BY →		ROTARY TOOLS Yes	
24. PRODUCING INTERVAL (S), OF THIS COMPLETION - TOP BOTTOM NAME (MD AND TVD*) 3124'-3160' Ojo Alamo		CABLE TOOLS No	
25. TYPE ELECTRIC AND OTHER LOGS RUN N/A		26. WAS DIRECTIONAL SURVEY MADE No	
27. WAS WELL CORED No			
28. CASING RECORD (Report all strings set in well)			
CASING SIZE/GRADE	WEIGHT LB/FT	DEPTH SET (MD)	HOLE SIZE
8-5/8"	24#	137'	12-1/4"
4-1/2"	10.5#	4012' KB	6-3/4"
29. LINER RECORD		30. TUBING RECORD	
SIZE	TOP (MD)	BOTTOM (MD)	SACKS CEMENT *
N/A	N/A	N/A	N/A
31. PERFORATION RECORD (Interval, size, and number)		32. ACID, SHOT, FRACTURE, CEMENT, SQUEEZE, ETC.	
3124'-3128'	5 holes	DEPTH INTERVAL (MD)	
3137'-3141'	5 holes	AMOUNT AND KIND OF MATERIAL USED	
3145'-3153'	9 holes	3124'-3160'	
3156'-3160'	5 holes	500 gls 7-1/2% acid	
33. PRODUCTION			
DATE FIRST PRODUCTION 08/19/97		PRODUCTION METHOD (Flowing, gas lift, pumping - size and type of pump) Flowing	
DATE OF TEST 08/15/97		WELL STATUS (Producing or Shut In) Producing	
HOURS TESTED 24	CHOKE SIZE 1/2"	PROD'N FOR TEST PERIOD →	OIL - BBL 0
GAS - MCF 953		WATER - BBL 0	
GAS-OIL RATIO N/A		OIL GRAVITY - API (CORR.) N/A	
FLOW TBG PRESS 155	CASING PRESSURE 0	CALCULATED 24-HOUR RATE →	OIL - BBL 0
GAS - MCF 953		WATER - BBL 0	
GAS-OIL RATIO N/A		OIL GRAVITY - API (CORR.) N/A	
34. DISPOSITION OF GAS (Sold, used for fuel, vented, etc.) Sold		TEST WITNESSED BY T. Lindeman	
35. LIST OF ATTACHMENTS N/A			
36. I hereby certify that the foregoing and attached information is complete and correct as determined from all available records			
SIGNED 		TITLE Operations Manager	
DATE		DATE	

*(See Instructions and Spaces for Additional Data on Reverse Side)



STATE OF NEW MEXICO

ENERGY, MINERALS AND NATURAL RESOURCES DEPARTMENT

OIL CONSERVATION DIVISION

September 14, 1988

GARREY CARRUTHERS
GOVERNOR

POST OFFICE BOX 2088
STATE LAND OFFICE BUILDING
SANTA FE, NEW MEXICO 87504
(505) 827-5800

Robert L. Bayless
P.O. Box 168
Farmington, NM 87499

Attention: Price M. Bayless

Administrative Order NSL-2575

Dear Mr. Bayless:

Reference is made to your application of July 20, 1988 for a non-standard well location for your Jicarilla 459 Well No. 3 to be located 1658 feet from the North line and 1901 feet from the East line of Section 18, Township 30 North, Range 3 West, NMPM, East Blanco Pictured Cliffs Pool, Rio Arriba County, New Mexico. The NE/4 of said Section 18 shall be dedicated to the well.

By the authority granted me under the provisions of General Rule 104 F(I), the above-described unorthodox location is hereby approved.

Sincerely,

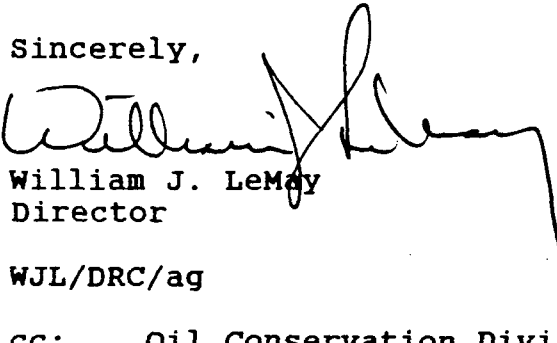

William J. LeMay
Director

WJL/DRC/ag

cc: Oil Conservation Division - Aztec
New Mexico Oil & Gas Engineering Committee - Hobbs
US Bureau of Land Management - Farmington

Mallon Oil Company

Denver/Colorado ♦ Carlsbad/New Mexico

a Mallon Resources subsidiary

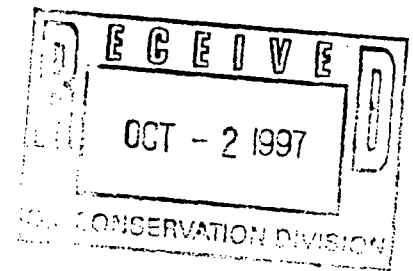

October 1, 1997

State of New Mexico
Oil Conservation Division
2040 South Pacheco
Santa Fe, NM 87505

Attn: Mr. Mike Stogner

Re: Additional information to process an exception to Rule 104.

Dear Mr. Stogner:

Enclosed please find the additional information required to process an exception to Rule 104 under the guidelines of Section (F), Paragraph (1). We are requesting the exception for the following wells:

Jicarilla 459 No. 5
Sec. 19, T30N-R3W
Rio Arriba County, New Mexico
NSL: 2518

Present exception for Picture Cliff Formation.
Requested exception for Ojo Alamo Formation.

Jicarilla 459 No. 8
Sec. 20, T30N-R3W
Rio Arriba County, New Mexico
NSL: 2576

Present exception for Picture Cliff Formation.
Requested exception for Ojo Alamo Formation.

Mr. Mike Stogner
State of New Mexico
Oil Conservation Division
Page 2.

Jicarilla 459 No. 3
Sec. 18, T30N-R3W
Rio Arriba County, New Mexico
NSL: 2575

Present exception for Picture Cliff Formation.
Requested exception for Ojo Alamo Formation.

Attached is a map showing the Leases held by Mallon Oil Company and how they offset the wells in question. I appreciate the assistance you have given us on this matter should you require additional information please contact me at (505) 885-4596.

Sincerely,

MALLON OIL COMPANY

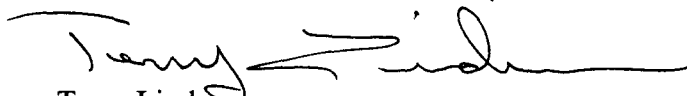

Terry Lindeman
Exploration/Production Superintendent

Enclosures

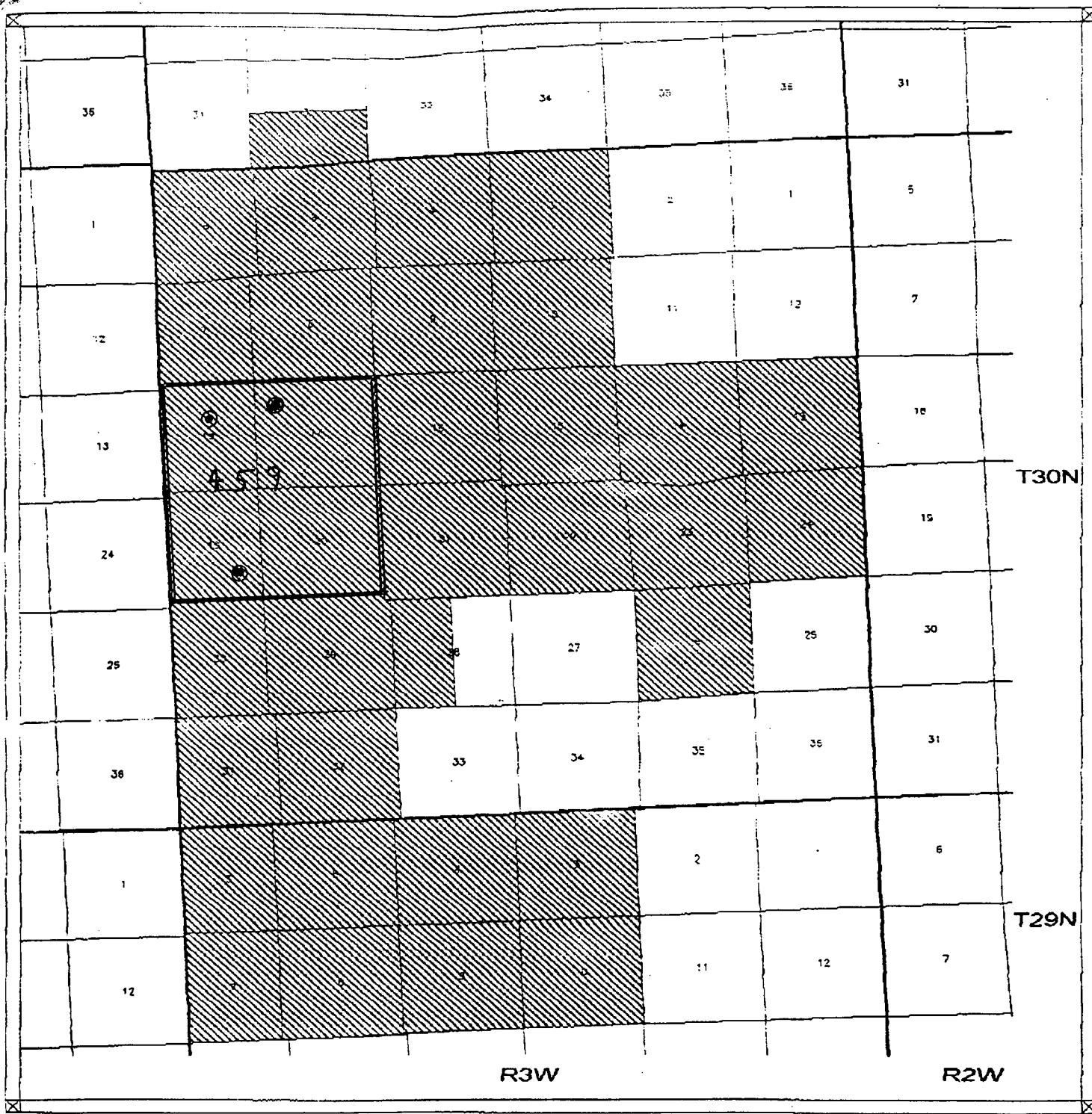

Scale 1:76000

0.2 0.4 0.6 0.8 1 miles



LEGEND

Diagonal hatchures=Mallon's leasehold

MALLON OIL COMPANY

San Juan Basin - E. Blanco
Mallon's Leasehold
Rio Arriba, New Mexico

10/1/87

District I
PO Box 1980, Hobbs, NM 88241-1980
District II
PO Drawer DD, Artesia, NM 88211-0719
District III
1000 Rio Brazos Rd., Aztec, NM 87410
District IV
PO Box 2088, Santa Fe, NM 87504-2088

State of New Mexico
Energy, Minerals & Natural Resources Department

OIL CONSERVATION DIVISION
PO Box 2088
Santa Fe, NM 87504-2088

Hold C-101
For NSV@
Form C-10:
Revised February 10, 199.
Instructions on back
Submit to Appropriate District Office
State Lease - 4 Copies
Fee Lease - 3 Copies

☐ AMENDED REPORT

WELL LOCATION AND ACREAGE DEDICATION PLAT

1 APT Number 30-039-24306		2 Pool Code 96538		3 Pool Name WILDCAT 30N3W18E Ojo Alamo	
4 Property Code 20465		5 Property Name Jicarilla 459			6 Well Number 3
7 OGRID No. 013925		8 Operator Name Mallon Oil Company			9 Elevation 7074' GL

10 Surface Location

UL or lot no.	Section	Township	Range	Lot Idn	Feet from the	North/South line	Feet from the	East/West line	County
G	18	30N	03W		1658	North	1901	East	Rio Arriba

11 Bottom Hole Location If Different From Surface

UL or lot no.	Section	Township	Range	Lot Idn	Feet from the	North/South line	Feet from the	East/West line	County

12 Dedicated Acres 160	13 Joint or Infill N	14 Consolidation Code N/A	15 Order No. N/A
---------------------------	-------------------------	------------------------------	---------------------

NO ALLOWABLE WILL BE ASSIGNED TO THIS COMPLETION UNTIL ALL INTERESTS HAVE BEEN CONSOLIDATED
OR A NON-STANDARD UNIT HAS BEEN APPROVED BY THE DIVISION

16		17 OPERATOR CERTIFICATION I hereby certify that the information contained herein is true and complete to the best of my knowledge and belief.	
		<p>Signature: <u>Theresa A. McAndrews</u></p> <p>Printed Name: Theresa A. McAndrews</p> <p>Title: Office Manager</p> <p>Date: 08/27/97</p>	
		18 SURVEYOR CERTIFICATION I hereby certify that the well location shown on this plat was plotted from field notes of actual surveys made by me or under my supervision, and that the same is true and correct to the best of my belief.	
		<p>Date of Survey: _____</p> <p>Signature and Seal of Professional Surveyor: _____</p> <p>Certificate Number: _____</p>	

OIL CONSERVATION DIVISION
PO Box 2088
Santa Fe, NM 87504-2088

☐ **AMENDED REPORT**

REQUEST FOR ALLOWABLE AND AUTHORIZATION TO TRANSPORT			
1. Operator Name and Address		2. OGRD Number	
Mallon Oil Company P.O. Box 3256 Carlsbad, NM 88220 (505) 885-4596		013925	
		3. Reason for Filing Code	
		CH Effective 1/1/97	
4. API Number	5. Pool Name	6. Pool Code	
30-039-24306	Undes. Ojo Alamo		
7. Property Code	8. Property Name	9. Well Number	
001849	Jicarilla 459	3	

U/I or lot no.	Section	Township	Range	Lot Idn.	Feet From the	North/South Line	Feet From the	East/West Line	County
G	18	30N	3W	N/A	1658	North	1901	East	Rio Arriba County

UL or lot no.	Section	Township	Range	Lot Idn.	Feet From the	North/South Line	Feet From the	East/West Line	County
G	18	30N	3W	N/A	1658	North	1901	East	Rio Arriba County
12. Use Code	13. Producing Method Code	14. Gas Connection Date			15. C-129 Permit Number		16. C-129 Effective Date		17. C-129 Expiration Date
F	F	01/19/89							

18. Transporter OGRD	19. Transporter Name and Address	20. POD	21. O/G	22. POD ULSTR Location and Description
37193	Mallon Oil Company P.O. Box 16 Gunsbad, NM 88220		G	B-18-30N-3W

RECEIVED

23. POD	24. POD ULSTR Location and Description
	<p>B-18-30N-3W</p> <p>COUL COUL 15W 15N</p>

25. Spud Date	26. Ready Date	27. TD	28. PBTD	29. Perforations
30. Hole Size	31. Casing & Tubing Size		32. Depth Set	33. Sacks Cement

34. Date New Oil	35. Gas Delivery Date	36. Test Date	37. Test Length	38. Tbg. Pressure	39. Csg. Pressure
40. Choke Size	41. Oil	42. Water	43. Gas	44. AOF	45. Test Method

Signature: <i>Theresa A. McAndrews</i>		Approved By: <i>[Signature]</i>	
Printed Name: Theresa A. McAndrews		Title: SUPERVISOR DISTRICT #3	
Title: Office Manager		Approval Date: MAR 10 1997	
Date: 02/27/97	Phone: (505) 885-4596		

 Previous Operator Signature		Printed Name Robert L. Bayless	Title OGRID 019418	Date
--	--	--	------------------------------	------

District I
PO Box 1980, Hobbs, NM 88241-1980
District II
PO Drawer DD, Artesia, NM 88211-0719
District III
1000 Rio Brazos Rd., Aztec, NM 87410
District IV
PO Box 2088, Santa Fe, NM 87504-2088

State of New Mexico
Energy, Minerals & Natural Resources Department
OIL CONSERVATION DIVISION
PO Box 2088
Santa Fe, NM 87504-2088

Form C-104
Revised February 10, 1994
Instructions on back
Submit to Appropriate District Office
5 Copies

☐ AMENDED REPORT

REQUEST FOR ALLOWABLE AND AUTHORIZATION TO TRANSPORT

1. Operator Name and Address Mallon Oil Company P.O. Box 3256 Carlsbad, NM 88220 (505) 885-4596		2. OGRID Number 013925
		3. Reason for Filing Code CH Effective 1/1/97
4. API Number 30-039-24306	5. Pool Name E. Blanco, Pictured Cliffs	6. Pool Code 72400
7. Property Code 001849	8. Property Name Jicarilla 459	9. Well Number 3

10. Surface Location									
UL or lot no. B	Section 18	Township 30N	Range 3W	Lot Idn. N/A	Feet From the 1000	North/South Line North	Feet From the 1785	East/West Line East	County Rio Arriba County

11. Bottom Hole Location									
UL or lot no. B	Section 18	Township 30N	Range 3W	Lot Idn. N/A	Feet From the 1000	North/South Line North	Feet From the 1785	East/West Line East	County Rio Arriba County
12. Lse Code F	13. Producing Method Code F	14. Gas Connection Date 01/19/89		15. C-129 Permit Number		16. C-129 Effective Date		17. C-129 Expiration Date	

III. Oil and Gas Transporters					
18. Transporter OGRID 37193	19. Transporter Name and Address Mallon Oil Company P.O. Box 3256 Carlsbad, NM 88220		20. POD 521530	21. O/G G	22. POD ULSTR Location and Description B-18-30N-3W

IV. Produced Water	
23. POD	24. POD ULSTR Location and Description B-18-30N-3W

V. Well Completion Data				
25. Spud Date	26. Ready Date	27. TD	28. PBTD	29. Perforations
30. Hole Size		31. Casing & Tubing Size	32. Depth Set	33. Sacks Cement

VI. Well Test Data					
34. Date New Oil	35. Gas Delivery Date	36. Test Date	37. Test Length	38. Tbg. Pressure	39. Csg. Pressure
40. Choke Size	41. Oil	42. Water	43. Gas	44. ACF	45. Test Method

46. I hereby certify that the rules of the Oil Conservation Division have been complied with and that the information given above is true and complete to the best of my knowledge and belief. Signature: Theresa A. McAndrews Printed Name: Theresa A. McAndrews Title: Office Manager Date: 02/10/97 Phone: (505) 885-4596		OIL CONSERVATION DIVISION Approved By: [Signature] Title: SUPERVISOR DISTRICT #3 Approval Date: MAR 10 1997	
---	--	--	--

47. If this is a change of operator fill in OGRID number and name of the previous operator.			
Previous Operator Signature Robert L. Bayless	OGRID 019418	Printed Name Kevin A. McConl	Title Pet Engineer
		Date 2/13/97	

District I
PO Box 1989, Hobbs, NM 88241-1989
District II
811 South First, Artesia, NM 88210
District III
1800 Rio Brazos Rd., Aztec, NM 87410
District IV
2040 South Pacheco, Santa Fe, NM 87505

State of New Mexico
Energy, Minerals & Natural Resources Department

OIL CONSERVATION DIVISION
2040 South Pacheco
Santa Fe, NM 87505

Form O-102
Revised October 18, 1994
Instructions on back
Submit to Appropriate District Office
State Lease - 4 Copies
Fee Lease - 3 Copies

☐ AMENDED REPORT

96 MAR 24 AM 8 52
WELL LOCATION AND ACREAGE DEDICATION PLAT

1 API Number 30-039-24306		2 Pool Code 96538		3 Pool Name WILDCAT 30N3W18G, 030 ALAMO (G)	
4 Property Code		5 Property Name JICARILLA 459			6 Well Number 3
7 OGRID No.		8 Operator Name ROBERT L BAYLESS			9 Elevation 70.34

10 Surface Location

UL or lot no.	Section	Township	Range	Lot Ida	Feet from the	North/South line	Feet from the	East/West line	County
G	18	30N	03W		1658	NORTH	1901	EAST	RA

11 Bottom Hole Location If Different From Surface

UL or lot no.	Section	Township	Range	Lot Ida	Feet from the	North/South line	Feet from the	East/West line	County

12 Dedicated Acres 160	13 Joint or Infill	14 Consolidation Code	15 Order No.
---------------------------	--------------------	-----------------------	--------------

NO ALLOWABLE WILL BE ASSIGNED TO THIS COMPLETION UNTIL ALL INTERESTS HAVE BEEN CONSOLIDATED
OR A NON-STANDARD UNIT HAS BEEN APPROVED BY THE DIVISION

16				
				17 OPERATOR CERTIFICATION I hereby certify that the information contained herein is true and complete to the best of my knowledge and belief. Signature: <u>Robert L. Bayless</u> Printed Name: <u>Robert L. Bayless</u> Title: <u>Operator</u> Date: <u>April 23, 1996</u>
				18 SURVEYOR CERTIFICATION I hereby certify that the well location shown on this plat was plotted from field notes of actual surveys made by me or under my supervision, and that the same is true and correct to the best of my belief. Date of Survey: Signature and Seal of Professional Surveyer: Certificate Number:

UNITED STATES
DEPARTMENT OF THE INTERIOR
BUREAU OF LAND MANAGEMENT

SUBMIT IN TRIPPLICATE
(Other instructions on re-
verse side)

Form approved by
Budget Bureau No. 1004-1
Expires August 31, 1985
5. LEASE DESIGNATION AND SERIAL
Jicarilla Contract 459
6. IF INDIAN, ALLOTTEE OR TRIBE NAME

SUNDRY NOTICES AND REPORTS ON WELLS

(Do not use this form for proposals to drill or to deepen or plug back to a different reservoir.
Use "APPLICATION FOR PERMIT" for such proposals.)

1. OIL WELL ☐ GAS WELL ☒ OTHER ☐
2. NAME OF OPERATOR Robert L. Bayless
3. ADDRESS OF OPERATOR P.O. Box 168, Farmington, NM 87499
4. LOCATION OF WELL (Report location clearly and in accordance with any State requirements.*
See also space 17 below.)
At surface 1658' FNL & 1901' FEL
14. PERMIT NO. 15. ELEVATIONS (Show whether DF, RT, CR, etc.)
7074' GL; 7086' RKB

7. UNIT AGREEMENT NAME Jicarilla Apache Tribe
8. FARM OR LEASE NAME Jicarilla 459
9. WELL NO. 3
10. FIELD AND POOL OR WILDCAT East Blanco P.C.
11. SEC., T., R., M., OR B.L.E. AND SURVEY OR AREA Sec. 18, T30N, R3W
12. COUNTY OR PARISH Rio Arriba
13. STATE NM

16. Check Appropriate Box To Indicate Nature of Notice, Report, or Other Data

NOTICE OF INTENTION TO:

TEST WATER SHUT-OFF ☐ PULL OR ALTER CASING ☐
FRACTURE TREAT ☐ MULTIPLE COMPLETE ☐
SHOOT OR ACIDIZE ☐ ABANDON* ☐
REPAIR WELL ☒ CHANGE PLANS ☐
(Other) ☐

SUBSEQUENT REPORT OF:

WATER SHUT-OFF ☐ REPAIRING WELL ☒
FRACTURE TREATMENT ☐ ALTERING CASING ☐
SHOOTING OR ACIDIZING ☐ ABANDONMENT* ☐
(Other) ☐

(NOTE: Report results of multiple completion on Well Completion or Recompletion Report and Log form.)

17. DESCRIBE PROPOSED OR COMPLETED OPERATIONS (Clearly state all pertinent details, and give pertinent dates, including estimated date of starting any proposed work. If well is directionally drilled, give subsurface locations and measured and true vertical depths for all markers and zones pertinent to this work.)*

7-11-90 Rigged up Huskey Wireline and Cementers, Inc. Pumped 250 sx (295 ft3) of Class B cement containing 5 mc radioactive tracer down the bradenhead. Ran gamma ray tracer log and found bottom of cement at 505 ft. Cement from 505 ft. to surface. End of job. (gamma ray tracer log enclosed)

Please refer to your letter dated September 12, 1989 to Robert L. Bayless.

RECEIVED
AUG 3 1990
OIL CON. DIV
DIST. 2

18. I hereby certify that the foregoing is true and correct

SIGNED Kevin H. McCord TITLE Petroleum Engineer DATE 7-19-90
Kevin H. McCord

(This space for Federal or State office use)

APPROVED BY _____
CONDITIONS OF APPROVAL, IF ANY:

TITLE _____

ACCEPTED FOR RECORD
DATE _____

NMOCD

JUL 26 1990

*See Instructions on Reverse Side

FARMINGTON RESOURCE AREA

BY MT

All distances must be from the outer boundaries of the Section.

Operator Robert L. Bayless		Lease Jicarilla 459		Well No. 3	
Unit Letter G	Section 18	Township 33 N	Range 3 W	County Rio Arriba	
Actual Footage Location of Well: 1658 feet from the North line and 1901 feet from the East line					
Ground Level Elev. 7034	Producing Formation Ojo Alamo		Pool Undesignated Ojo Alamo		Dedicated Acreage: 160 Acres

1. Outline the acreage dedicated to the subject well by colored pencil or hatchure marks on the plat below.
2. If more than one lease is dedicated to the well, outline each and identify the ownership thereof (both as to working interest and royalty).
3. If more than one lease of different ownership is dedicated to the well, have the interests of all owners been consolidated by communitization, unitization, force-pooling, etc?

☐ Yes ☐ No If answer is "yes," type of consolidation _____

If answer is "no," list the owners and tract descriptions which have actually been consolidated. (Use reverse side of this form if necessary.) _____

No allowable will be assigned to the well until all interests have been consolidated (by communitization, unitization, forced-pooling, or otherwise) or until a non-standard unit, eliminating such interests, has been approved by the Division.

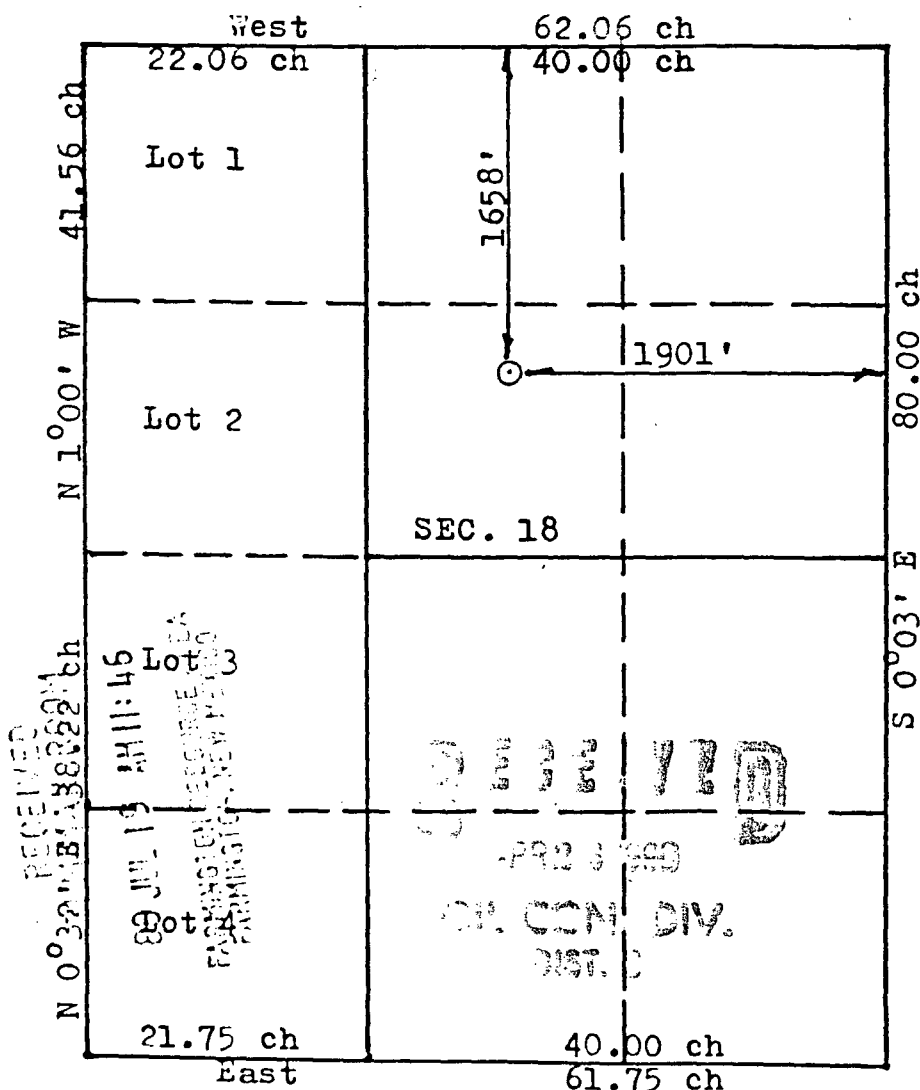

CERTIFICATION

I hereby certify that the information contained herein is true and complete to the best of my knowledge and belief.

Price M. Bayless
Name

Price M. Bayless

Position
Engineer

Company
Robert L. Bayless

Date
April 25, 1990

I hereby certify that the well location shown on this plat was plotted from field notes of actual surveys made by me or under my supervision, and that the same is true and correct to the best of my knowledge and belief.

7/12/88

Date Surveyed
Roy A. Rush
Registered Professional Engineer
and/or Land Surveyor

8894

Certificate No.

UNITED STATES
DEPARTMENT OF THE INTERIOR
BUREAU OF LAND MANAGEMENT

SUBMIT IN TRIPLICATE
(Other instructions on reverse side)

Form approved
Budget Bureau No. 1004-0135
Expires August 31, 1985

SUNDRY NOTICES AND REPORTS ON WELLS

(This form is to be used for proposals to drill or to deepen or plug back to a different reservoir.
Use "APPLICATION FOR PERMIT" for such proposals.)

1. NAME OF OPERATOR
Robert L. Bayless

2. ADDRESS OF OPERATOR
P.O. Box 168, Farmington, NM 87499

3. LOCATION OF WELL (Report location clearly and in accordance with any State requirements.
See also space 17 below.)
At surface 1658' FNL & 1901' FEL

14. PERMIT NO.

15. ELEVATIONS (Show whether OF, RT, GR, etc.)

7074' GL 7086' RKB

5. LEASE DESIGNATION AND SERIAL NO.

Jicarilla Contract 459

6. IF INDIAN, ALLOTTEE OR TRIBE NAME

Jicarilla Apache Tribe

7. UNIT AGREEMENT NAME

8. FARM OR LEASE NAME

Jicarilla 459

9. WELL NO.

3

10. FIELD AND POOL, OR WILDCAT

East Blanco Pictured Cliffs

11. SEC., T., R., M., OR BLK. AND
SURVEY OR AREA

Section 18, T30N, R3W

12. COUNTY OR PARISH 13. STATE

Rio Arriba

NM

16. Check Appropriate Box To Indicate Nature of Notice, Report, or Other Data

NOTICE OF INTENTION TO:

TEST WATER SHUT-OFF

FRACTURE TREAT

SHOOT OR ACIDIZE

REPAIR WELL

(Other)

PULL OR ALTER CASING

MULTIPLE COMPLETE

ABANDON*

CHANGE PLANS

SUBSEQUENT REPORT OF:

WATER SHUT-OFF

FRACTURE TREATMENT

SHOOTING OR ACIDIZING

(Other) Cement bond log

REPAIRING WELL

ALTERING CASING

ABANDONMENT*

(NOTE: Report results of multiple completion on Well Completion or Recompletion Report and Log form.)

17. DESCRIBE PROMISED OR COMPLETED OPERATIONS (Clearly state all pertinent details, and give pertinent dates, including estimated date of starting any proposed work. If well is directionally drilled, give subsurface locations and measured and true vertical depths for all markers and zones pertinent to this work.)

Cement bond log performed on 12/30/88 showing top of cement at 1000'.
(Log attached)

RECEIVED

APR 03 1990

OIL CON. DIV.
DIST. 3

18. I hereby certify that the foregoing is true and correct

SIGNED Price M. Bayless

TITLE Engineer

DATE 10/23/89

(This space for Federal or State office use)

APPROVED BY
CONDITIONS OF APPROVAL, IF ANY:

TITLE

DATE APR 04 1990

ACCEPTED FOR RECORD

NMCOO

*See Instructions on Reverse Side

FARMINGTON RESOURCE AREA
BY

UNITED STATES
DEPARTMENT OF THE INTERIOR
BUREAU OF LAND MANAGEMENT

SUBMIT IN TRIPLICATE*
(Other instructions on re-
verse side)

Form approved.
Budget Bureau No. 1004-0135
Expires August 31, 1985

SUNDRY NOTICES AND REPORTS ON WELLS

(Do not use this form for proposals to drill or to deepen or plug back to a different reservoir.
Use "APPLICATION FOR PERMIT" for such proposals.)

1. WELL TYPE OIL <input type="checkbox"/> GAS <input type="checkbox"/> WELL <input checked="" type="checkbox"/> OTHER <input type="checkbox"/>	5. LEASE DESIGNATION AND SERIAL NO. Jicarilla Contract 459
2. NAME OF OPERATOR Robert L. Bayless	6. IF INDIAN, ALLOTTEE OR TRIBE NAME Jicarilla Apache Tribe
3. ADDRESS OF OPERATOR P.O. Box 168, Farmington, NM 87499	7. UNIT AGREEMENT NAME
4. LOCATION OF WELL (Report location clearly and in accordance with any State requirements. See also space 17 below.) At surface 1658' FNL & 1901' FEL	8. FARM OR LEASE NAME Jicarilla 459
14. PERMIT NO.	9. WELL NO. 3
15. ELEVATIONS (Show whether DF, RT, GR, etc.) 7074' GL 7086' RKB	10. FIELD AND POOL, OR WILDCAT Undes. Ojo Alamo
	11. SEC., T., R., M., OR BLK. AND SURVEY OR AREA Section 18, T30N, R3W
	12. COUNTY OR PARISH Rio Arriba
	13. STATE NM

16. Check Appropriate Box To Indicate Nature of Notice, Report, or Other Data

NOTICE OF INTENTION TO:

TEST WATER SHUT-OFF <input type="checkbox"/>	PULL OR ALTER CASING <input type="checkbox"/>
FRACTURE TREAT <input type="checkbox"/>	MULTIPLE COMPLETE <input type="checkbox"/>
SHOOT OR ACIDIZE <input type="checkbox"/>	ABANDON* <input type="checkbox"/>
REPAIR WELL <input type="checkbox"/>	CHANGE PLANS <input type="checkbox"/>
(Other) <input type="checkbox"/>	

SUBSEQUENT REPORT OF:

WATER SHUT-OFF <input type="checkbox"/>	REPAIRING WELL <input type="checkbox"/>
FRACTURE TREATMENT <input type="checkbox"/>	ALTERING CASING <input type="checkbox"/>
SHOOTING OR ACIDIZING <input type="checkbox"/>	ABANDONMENT* <input type="checkbox"/>
(Other) <input type="checkbox"/> production info	X

(NOTE: Report results of multiple completion on Well Completion or Recompletion Report and Log form.)

17. DESCRIBE PROPOSED OR COMPLETED OPERATIONS (Clearly state all pertinent details, and give pertinent dates, including estimated date of starting any proposed work. If well is directionally drilled, give subsurface locations and measured and true vertical depths for all markers and zones pertinent to this work.)

To provide additional production information for Item 33 on Well Completion Report submitted 4/21/89:

Date of Test - 4/19/89 to 4/26/89
Hours Tested - 7 days
Choke size - 1/2"
Tubing Pressure - 92
Casing Pressure - 695
Gas (calc. 24-hr. rate) - 553 MCFD

7-16417ED
JUL 2 5 1989
OIL CON. DIV.
DIST. 2

CONFIDENTIAL

18. I hereby certify that the foregoing is true and correct

SIGNED Kevin H. McCord TITLE Petroleum Engineer DATE 7/13/89
(This space for Federal or State office use)

APPROVED BY _____ TITLE _____ ACCEPTED FOR RECORD

CONDITIONS OF APPROVAL, IF ANY:

NMOCD

*See Instructions on Reverse Side

JUL 20 1989

FARMINGTON RESOURCE AREA

UNITED STATES
DEPARTMENT OF THE INTERIOR
BUREAU OF LAND MANAGEMENT

SUBMIT IN TRIPLICATE*
(Other instructions on re-
verse side)

Form approved.
Budget Bureau No. 1004-0135
Expires August 31, 1985

SUNDRY NOTICES AND REPORTS ON WELLS

(Do not use this form for proposals to drill or to deepen or plug back to a different reservoir.
Use "APPLICATION FOR PERMIT" for such proposals.)

1. <input type="checkbox"/> OIL WELL <input type="checkbox"/> GAS WELL <input checked="" type="checkbox"/> OTHER		RECEIVED	
2. NAME OF OPERATOR Robert L. Bayless		JUN 13 1989	
3. ADDRESS OF OPERATOR P.O. Box 168, Farmington, NM 87499		BUREAU OF LAND MANAGEMENT FARMINGTON RESOURCE AREA	
4. LOCATION OF WELL (Report location clearly and in accordance with any State requirements.* See also space 17 below.) At surface 1658' FNL & 1901' FEL			
14. PERMIT NO.		15. ELEVATIONS (Show whether OF, RT, GR, etc.) 7074' GL 7086' RKB	
5. LEASE DESIGNATION AND SERIAL NO. Jicarilla Contract 459		6. IF INDIAN, ALLOTTEE OR TRIBE NAME Jicarilla Apache Tribe	
7. UNIT AGREEMENT NAME		8. FARM OR LEASE NAME Jicarilla 459	
9. WELL NO. 3		10. FIELD AND POOL, OR WILDCAT Undes. Ojo Alamo	
11. SEC., T., R., M., OR BLK. AND SURVEY OR AREA Section 18, T30N, R3W		12. COUNTY OR PARISH Rio Arriba	
13. STATE NM			

16. Check Appropriate Box To Indicate Nature of Notice, Report, or Other Data

NOTICE OF INTENTION TO:

TEST WATER SHUT-OFF <input type="checkbox"/>	PULL OR ALTER CASING <input type="checkbox"/>
FRACTURE TREAT <input type="checkbox"/>	MULTIPLE COMPLETE <input type="checkbox"/>
SHOOT OR ACIDIZE <input type="checkbox"/>	ABANDON* <input type="checkbox"/>
REPAIR WELL <input type="checkbox"/>	CHANGE PLANE <input type="checkbox"/>
(Other) Gas venting extension	X

SUBSEQUENT REPORT OF:

WATER SHUT-OFF <input type="checkbox"/>	REPAIRING WELL <input type="checkbox"/>
FRACTURE TREATMENT <input type="checkbox"/>	ALTERING CASING <input type="checkbox"/>
SHOOTING OR ACIDIZING <input type="checkbox"/>	ABANDONMENT* <input type="checkbox"/>
(Other) _____	

(NOTE: Report results of multiple completion on Well Completion or Recompletion Report and Log form.)

17. DESCRIBE PROPOSED OR COMPLETED OPERATIONS (Clearly state all pertinent details, and give pertinent dates, including estimated date of starting any proposed work. If well is directionally drilled, give subsurface locations and measured and true vertical depths for all markers and zones pertinent to this work.)*

Request 10-day extension to vent gas from the Ojo Alamo formation in this well. (Verbal approval was received from Errol Becher on 6/12/89). We wish to change out bottomhole assemblies in this well which will require more flaring of Ojo Alamo gas. We anticipate this work will be completed by June 22, 1989.

18. I hereby certify that the foregoing is true and correct

SIGNED

Keyin H. McCord

TITLE

Petroleum Engineer

DATE

6/12/89

(This space for Federal or State office use)

APPROVED BY

TITLE

DATE

CONDITIONS OF APPROVAL, IF ANY:

CONFIDENTIAL

*See Instructions on Reverse Side

NMCCO

UNITED STATES
DEPARTMENT OF THE INTERIOR
BUREAU OF LAND MANAGEMENT

SUBMIT IN TRIPLICATE*
(Other instructions on re-
verse side)

Form approved
Budget Bureau No. 1004-0135
Expires August 31, 1985

SUNDRY NOTICES AND REPORTS ON WELLS

(Do not use this form for proposals to drill or to deepen or plug back to a different reservoir.
Use "APPLICATION FOR PERMIT" for such proposals.)

30 APR 25 AM 9 27

1. WELL ☐ GAS WELL ☒ OTHER

2. NAME OF OPERATOR

Robert L. Bayless

3. ADDRESS OF OPERATOR

P.O. Box 168, Farmington, NM 87499

4. LOCATION OF WELL (Report location clearly and in accordance with any State requirements.*
See also space 17 below.)

At surface 1658' FNL & 1901' FEL

14. PERMIT NO.

15. ELEVATIONS (Show whether OF, RT, OR, etc.)

7074' GL 7086' RKB

3. LEASE DESIGNATION AND SERIAL NO.

Jicarilla Contract 459

6. IF INDIAN, ALLOTTEE OR TRIBE NAME

Jicarilla Apache Tribe

7. UNIT ASSIGNMENT NAME

8. FARM OR LEASE NAME

Jicarilla 459

9. WELL NO.

3

10. FIELD AND POOL, OR WILDCAT

Undes. Ojo Alamo

11. SEC., T., R., M., OR BLK. AND
SURVEY OR AREA

Section 18, T30N, R3W

12. COUNTY OR PARISH 13. STATE

Rio Arriba NM

16. Check Appropriate Box To Indicate Nature of Notice, Report, or Other Data

NOTICE OF INTENTION TO:

TEST WATER SHUT-OFF ☐

PULL OR ALTER CASING ☐

FRACTURE TREAT ☐

MULTIPLE COMPLETE ☐

SHOOT OR ACIDIZE ☐

ABANDON* ☐

REPAIR WELL ☐

CHANGE PLANT ☐

(Other) ☐

SUBSEQUENT REPORT OF:

WATER SHUT-OFF ☐

REPAIRING WELL ☐

FRACTURE TREATMENT ☐

ALTERING CASING ☐

SHOOTING OR ACIDIZING ☐

ABANDONMENT* ☐

(Other) Multiple completion ☒

(NOTE: Report results of multiple completion on Well
Completion or Recompletion Report and Log form.)

17. DESCRIBE PROMISED OR COMPLETED OPERATIONS (Clearly state all pertinent details, and give pertinent dates, including estimated date of starting any
proposed work. If well is directionally drilled, give subsurface locations and measured and true vertical depths for all markers and zones perti-
nent to this work;*)

Well was completed in the Ojo Alamo formation and tested. Gas analysis confirms presence of hydrogen sulfide in concentrations varying from 0 to 1400 ppm (see attached gas analysis sheets). Run tubing as shown in Attachment "A" with Ojo Alamo open, Pictured Cliffs closed. Clean up Ojo Alamo. Close sliding sleeve to shut off Ojo Alamo perforations. Open Pictured Cliffs. Clean zone to pit. Put Pictured Cliffs back on pipeline. Leave Ojo Alamo shut in for further evaluation.

RECEIVED

JUL 13 1989

OIL CON. DIV.
DIST. 3

CONFIDENTIAL

18. I hereby certify that the foregoing is true and correct

SIGNED

Price M. Bayless

TITLE

Engineer

DATE

6/30/89

(This space for Federal or State office use)

APPROVED BY

TITLE

CONDITIONS OF APPROVAL, IF ANY:

ACCEPTED FOR RECORD -
DATE

JUL 06 1989

FARMINGTON RESOURCE AREA

BY KK

*See Instructions on Reverse Side

104000

Description	Length	Depth
KB to landing point	10.00	0-10
96 lbs 2 3/8" 4.7# L-80 EUE tubing	3051.84	10-3062
AR-1 Snap Set packer	5.52	3062-3067
2 lbs 2 3/8" 4.7# L-80 EUE tubing	64.06	3067-3131
"T" sliding sleeve (1.87" ID)	3.42	3131-3135
2 lbs 2 3/8" 4.7# L-80 EUE tubing	60.60	3135-3195
R3 double grip packer	6.90	3195-3202
16 lbs 2 3/8" 4.7# L-80 EUE tubing	508.58	3202-3711
FN nipple (1.780" ID)	.93	3711-3712
	3711.85	

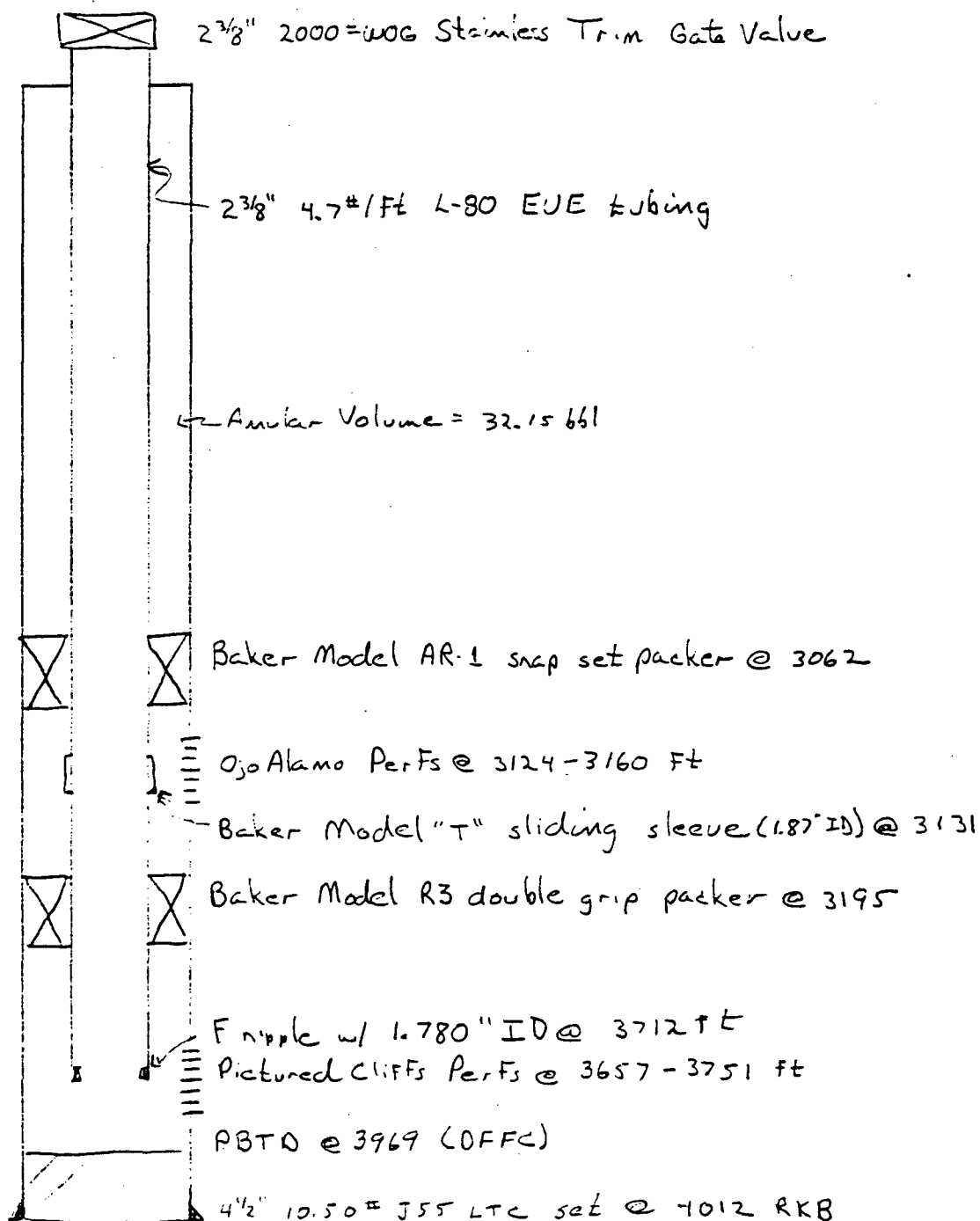

Note: Only undersize cups will go through sliding sleeve.

TECH INC.

333 E. Main St.

Farmington, NM 87401

DATE: 3-31-89

**** GAS ANALYSIS ****

Company name: R.L. Bayless Production

Well Name: JIC. 459 #3

Well Location :

Lease No. :

Submitted by :

Date sampled: 3-30-89

Depth (ft):

Est. Production Rate (MCFD):

Analysis date: 3-31-89

Formation:

County, state :RIO ARriba/NM

Sample Source:

Flow:

Cylinder No.:

Sample temp. (deg F):

Sample Pressure (PSIG):

Sampled by:

Gas	Mole %	B.T.U.	G.P.M.	Sp. Gr.
1. Oxygen	0.000	0.000	0.000	0.0000
2. Nitrogen	0.000	0.000	0.000	0.0000
3. Methane	93.252	941.360	0.000	0.5165
4. CO2	0.023	0.000	0.000	0.0003
5. Ethane	5.647	99.870	0.000	0.0586
6. Propane	0.376	9.460	0.193	0.0057
7. Isobutane	0.291	9.460	0.095	0.0058
8. Butane	0.136	4.420	0.006	0.0027
9. i-Pentane	0.089	3.550	0.033	0.0022
10. Pentane	0.027	1.080	0.010	0.0006
11. Hexanes	0.159	7.560	0.065	0.0047
12. H2S	0.000	0.000	0.000	0.0000
Totals	100.000	1076.970	0.348	0.5971

Net (dry) heating value per cu. ft. @ 14.696 PSIA.

Note: B.T.U., G.P.M., and Sp. Gr. are calculated values based on ideal gas constants in the Engineering Data Book of the GPA, 1981. Saturated gross heating value @ 14.696 PSIA may be determined by multiplying by 0.9826.

Tech. Serv.
177 E. Main St.
Farmington, NM 87401

DATE: April 4 1989

Gas Analysis

Company name: R. L. Bayless

Well Name: Jicarilla 459-3	Formation:
Well Location :	County/state : Rio Arriba NM
Lease No. :	Sample Source: Well head
Submitted by : Kevin McCord	Field:
Date sampled: 3-31-1989	Cylinder No.:
Depth (ft):	Sample temp. (deg F):
Est. Production Rate (MCFD):	Sample Pressure (PSIG):
Analysis date: 3-03-1989	Sampled by:

Gas	Mole %	B.T.U.	G.P.M.	Sp. Gr.
1. Oxygen	0.000	0.000	0.000	0.0000
2. Nitrogen	0.075	0.000	0.000	0.0007
3. Methane	92.210	931.040	0.000	0.5107
4. CO2	0.073	0.000	0.000	0.0011
5. Ethane	5.928	104.840	0.000	0.0615
6. Propane	0.838	21.030	0.230	0.0127
7. Isobutane	0.316	10.270	0.103	0.0063
8. Butane	0.137	4.460	0.043	0.0027
9. i-Pentane	0.094	3.750	0.034	0.0023
10. Pentane	0.029	1.160	0.010	0.0007
11. Hexanes	0.160	7.600	0.066	0.0047
12. H2S	0.140	0.080	0.000	0.0016
Totals	100.000	1034.290	0.487	0.6050

Net (dry) heating value per cu. ft. @ 14.696 PSIA.

Note: B.T.U., G.P.M., and Sp. Gr. are calculated values based on ideal gas constants in the Engineering Data Book of the GPSA, 1981. Saturated gross heating value @ 14.696 PSIA may be determined by multiplying by 0.9226.

TECH INC.

333 E. Main St.

Farmington, NM 87401

DATE: 4-26-89

**** GAS ANALYSIS ****

Company name: R.L. Bayless Production

Well Name: JICARILLA 459 #3

Formation: OJO ALAMO

Well Location : SW4 NE4 SEC 18 T30N R3W County/state : RIO ARriba/NEW MEXICO

Lease No. :

Sample Source:

Submitted by : T. JONES

Field:

Date sampled: 4-25-89

Cylinder No.:

Depth (ft):

Sample temp. (deg F):

Est. Production Rate (MCFD):

Sample Pressure (PSIG): 660

Analysis date: 4-26-89

Sampled by: T.JONES

Gas	Mole %	B.T.U.	G.P.M.	Sp. Gr.
1. Oxygen	0.000	0.000	0.000	0.0000
2. Nitrogen	0.000	0.000	0.000	0.0000
3. Methane	93.811	947.200	0.000	0.5196
4. CO2	0.064	0.000	0.000	0.0009
5. Ethane	4.839	85.580	0.000	0.0502
6. Propane	0.672	16.910	0.185	0.0102
7. Isobutane	0.249	8.090	0.081	0.0049
8. Butane	0.108	3.520	0.005	0.0021
9. i-Pentane	0.078	3.110	0.028	0.0019
10. Pentane	0.019	0.760	0.007	0.0004
11. Hexanes	0.130	6.180	0.053	0.0038
12. H2S	0.030	0.010	0.000	0.0003
Totals	100.000	1071.360	0.388	0.5943

Net (dry) heating value per cu. ft. @ 14.696 PSIA.

Note: B.T.U, G.P.M., and Sp. Gr. are calculated values based on ideal gas constants in the Engineering Data Book of the GPSA, 1981. Saturated gross heating value @ 14.696 PSIA may be determined by multiplying by 0.9826.

DATE: 5-11-89

GAS ANALYSIS



Company name: R.L. Bayless Production

TECH, Inc

Well Name: JICARILLA 459 #

Formation:

333 East Main

Well Location : SW4 NE4 SEC18 T30N R3W County/state : RIO ARRIBA/NM

Farmington

New Mexico

87401

Lease No. :

Sample Source:

505.327 3311

Submitted by : KEVIN MCCORD

Field:

Date sampled: 5-10-89

Cylinder No.:

Depth (ft):

Sample temp. (deg F):

Est. Production Rate (MCFD):

Sample Pressure (PSIG):

Analysis date: 5-10-89

Sampled by: KEVIN MCCORD

Gas	Mole %	B.T.U.	G.P.M.	Sp. Gr.
1. Oxygen	0.000	0.000	0.000	0.0000
2. Nitrogen	0.000	0.000	0.000	0.0000
3. Methane	92.396	932.920	0.000	0.5117
4. CO2	0.104	0.000	0.000	0.0015
5. Ethane	6.023	106.520	0.000	0.0625
6. Propane	0.833	20.960	0.229	0.0126
7. Isobutane	0.304	9.880	0.099	0.0061
8. Butane	0.133	4.330	0.006	0.0026
9. i-Pentane	0.091	3.630	0.033	0.0022
10. Pentane	0.023	0.920	0.008	0.0005
11. Hexanes	0.093	4.420	0.038	0.0027
12. H2S	0.000	0.000	0.000	0.0000
Totals	100.000	1083.580	0.449	0.6024

Net (dry) heating value per cu. ft. @ 14.696 PSIA.

NOTE: B.T.U., G.P.M., and Sp. Gr. are calculated values based on ideal gas constants in the Engineering Data Book of the GPSA, 1981. Saturated gross heating value @ 14.696 PSIA may be determined by multiplying by 0.9826.

DATE: 12 MAY 1989



GAS ANALYSIS

TECH, Inc.
333 East Main
Farmington
New Mexico
87401

Company name: R.L. Bayless Production

Well Name: JICARILLA 459 #3

Formation:

505/327-3311

Well Location :

County/state :

Lease No. :

Sample Source:

Submitted by :

Field:

Date sampled: 5-12-89

Cylinder No.:

Depth (ft):

Sample temp. (deg F):

Est. Production Rate (MCFD):

Sample Pressure (PSIG):

Analysis date: 5-12-89

Sampled by:

Gas	Mole %	B.T.U.	G.P.M.	Sp. Gr.
1. Oxygen	0.000	0.000	0.000	0.0000
2. Nitrogen	0.000	0.000	0.000	0.0000
3. Methane	92.275	931.700	0.000	0.5111
4. CO2	0.085	0.000	0.000	0.0012
5. Ethane	5.892	104.210	0.000	0.0611
6. Propane	0.827	20.810	0.227	0.0125
7. Isobutane	0.309	10.050	0.101	0.0062
8. Butane	0.138	4.500	0.006	0.0027
9. i-Pentane	0.094	3.750	0.034	0.0023
10. Pentane	0.031	1.240	0.011	0.0007
11. Hexanes	0.207	9.840	0.085	0.0061
12. H2S	0.142	0.090	0.000	0.0016
Totals	100.000	1086.190	0.502	0.6055

Net (dry) heating value per cu. ft. @ 14.696 PSIA.

NOTE: B.T.U., G.P.M., and Sp. Gr. are calculated values based on ideal gas constants in the Engineering Data Book of the GPSA, 1981. Saturated gross heating value @ 14.696 PSIA may be determined by multiplying by 0.9826.

H2S Public Protection Plan

ROBERT L. BAYLESS
P.O. BOX 168
Farmington, New Mexico 87499

ACTION PLAN FOR ACCIDENTAL RELEASE OF H2S
from a Producing Well

Jicarilla 459 #3
1658' FNL & 1901' FEL
Section 18-T30N-R3W
Rio Arriba County, New Mexico

I. PURPOSE:

The purpose of this plan is to safeguard the lives of the public, contract personnel, and company personnel in the event of equipment failures or disaster while producing gas from formations which may contain Hydrogen Sulfide Gas (H₂S).

ROBERT L. BAYLESS has specified materials and practices for producing this well to protect the safety of all concerned. However, as a precautionary measure this contingency and evacuation plan has been prepared to further assist the safety of all concerned.

II. DESCRIPTION OF HYDROGEN SULFIDE GAS:

H₂S is a colorless gas which smells similar to rotten eggs in low concentrations. In large concentrations however, the sense of smell may be paralyzed rapidly. H₂S is an extremely toxic gas that must be treated with extreme care to prevent injury to people. H₂S is heavier than air (specific gravity = 1.19) and on still days tends to accumulate in low places. This accumulation could build up and lead to dangerous concentrations. However, if the H₂S gas is warmer than air, it will tend to rise until cooled off and could affect workers above the escaping source.

The toxicity of H₂S is as follows:

Period of Exposure:

<i>Prolonged exposure - no adverse effects</i>	<i>10 PPM</i>
<i>Over 1 hour could be hazardous</i>	<i>150 PPM</i>
<i>Possibly fatal in less than 1/2 hour</i>	<i>300 PPM</i>
<i>Fatal in a few minutes</i>	<i>700 PPM</i>

III. TREATMENT OF HYDROGEN SULFIDE POISONING:

- A. Remove the patient to fresh air, call physician or ambulance if possible.*
- B. If breathing is labored or has ceased, give artificial resuscitation immediately. Continue until physician is available, even if person appears to be not breathing. Should disaster conditions make it impossible to move to fresh air, keep on your mask and use resuscitator on patient.*

Condition: Red - EXTREME DANGER

Cause for Condition:

1. Uncontrolled Well
2. Poison gas present above threshold levels

Emergency Procedures:

Condition Yellow:

1. Check safety equipment and keep it with you
2. Be alert for a change in condition warning sign
3. Follow instructions

Condition Red:

Upon release of potentially hazardous volume of hydrogen sulfide gas, this program shall be initiated immediately.

1. Evacuate all persons off location to "safe briefing area" that is crosswind. Check that all persons are present. If not, proceed with evacuation from hazardous area in the following manner:
 - a. Two persons, re-enter hazardous area with air packs and each attached to an assistant via safety line. The assistant shall also be wearing respiratory equipment but outside of the hazard area.
 - b. Locate and evacuate all other persons in hazardous area to safety briefing area.
 - c. Proceed with emergency first aid to all injured. Call for ambulance and alert hospital that victim is being transported, giving estimated time of arrival.

MEDICAL PERSONNEL

Hospital, San Juan Regional Medical Center
Farmington, New Mexico-----505-325-5011

AMBULANCE-----505-325-3501

Public Health Service, Dulce, New Mexico-----505-759-3291

2. Locate, define problem, and proceed with emergency shut-in procedures at wellhead.
3. Stay in "Safe Briefing Area" unless instructed to do otherwise. Continuously monitor air quality in briefing area.
4. Only enter hazardous area with adequate air supply and attended by someone with a safety rope.
5. Call Company personnel in the following order, until one is contacted. Inform him of the problem and what actions have been taken.

<u>NAME</u>	<u>OFFICE</u>	<u>RESIDENCE</u>
David E. Ball	505-326-2659	505-632-2025
Kevin H. McCord	505-325-6900	505-327-3162
Tucker Bayless	505-327-7214	505-325-8154
A. V. (Sonny) Green	505-327-7214	505-632-2861
Robert L. Bayless	505-326-2659	505-325-8985

NOTE: Radio Number for all above is 505-327-0880

6. Notify the appropriate agencies and law officers that an emergency situation exists and help is needed.

LAW ENFORCEMENT AGENCIES

Dulce Police-----505-334-6107

POLICE:

Jicarilla Apache Tribal Police-----505-325-0422

New Mexico State Police-----505-325-7547

OIL & GAS CONSERVATION COMMISSION

New Mexico Oil & Gas Conservation Commission
Aztec, New Mexico----- (505) 334-6178

BUREAU OF LAND MANAGEMENT

BLM (Oil & Gas Operations)
Farmington, New Mexico-----505-327-5344

FIRE DEPARTMENT

Bloomfield, New Mexico-----505-632-8011
Dulce, New Mexico-----505-759-3463

JICARILLA APACHE TRIBE

Realty Division
Dulce, New Mexico-----505-759-3485

BUREAU OF INDIAN AFFAIRS

Jicarilla Agency
Dulce, New Mexico-----505-759-3676

7. If warranted, roads with 100 PPM radius will be closed to general traffic.
8. In the event that a blowout should occur, the decision regarding ignition of the escaping gas will be made by the RLB representative on location after consultation.
9. Meet with appropriate agencies and law officers as soon as practical to brief them on the situation and coordinate evacuation efforts.

UNITED STATES
DEPARTMENT OF THE INTERIOR
BUREAU OF LAND MANAGEMENT

SUBMIT IN TRIPPLICATE*
(Other instructions on re-
verse side)

Budget Bureau No. 1004-0135
Expires August 31, 1985

SUNDRY NOTICES AND REPORTS ON WELLS

(Do not use this form for proposals to drill or to deepen or plug back to a different reservoir.
Use "APPLICATION FOR PERMIT" for such proposals.)

1. WELL TYPE
WELL ☐ OIL ☒ GAS ☐ OTHER ☐

2. NAME OF OPERATOR

Robert L. Bayless

3. ADDRESS OF OPERATOR

P.O. Box 168, Farmington, NM 87499

4. LOCATION OF WELL (Report location clearly and in accordance with any State requirements.)

See also space 17 below.)

At surface 1658' FNL & 1901' FEL

14. PERMIT NO.

15. ELEVATIONS (Show whether DF, RT, GR, etc.)

7074' GL 7086' RKB

5. LEASE DESIGNATION AND SERIAL NO.

Jicarilla Contract 459

6. IF INDIAN, ALLOTTEE OR TRIBE NAME

Jicarilla Apache Tribe

7. UNIT AGREEMENT NAME

8. FARM OR LEASE NAME

Jicarilla 459

9. WELL NO.

3

10. FIELD AND POOL, OR WILDCAT

Undesignated Ojo Alamo

11. SEC., T., R., M., OR BLK. AND
SURVEY OR AREA

Section 18, T30N, R3W

12. COUNTY OR PARISH 13. STATE

Rio Arriba NM

16. Check Appropriate Box To Indicate Nature of Notice, Report, or Other Data

NOTICE OF INTENTION TO:

TEST WATER SHUT-OFF ☐

PULL OR ALTER CASING ☐

FRACTURE TREAT ☐

MULTIPLE COMPLETE ☐

SHOOT OR ACIDIZE ☐

ABANDON ☐

REPAIR WELL ☐

CHANGE PLAN ☐

(Other) ☐

SUBSEQUENT REPORT OF:

WATER SHUT-OFF ☐

REPAIRING WELL ☐

FRACTURE TREATMENT ☐

ALTERING CASING ☐

SHOOTING OR ACIDIZING ☐

ABANDONMENT ☐

(Other) Swab; land tubing ☒

(Note: Report results of multiple completion on Well
Completion or Recompletion Report and Log form.)

17. DESCRIBE PROPOSED OR COMPLETED OPERATIONS (Clearly state all pertinent details, and give pertinent dates, including estimated date of starting any proposed work. If well is directionally drilled, give subsurface locations and measured and true vertical depths for all markers and zones pertinent to this work.)

SEE ATTACHED DAILY REPORTS 3/29/89 thru 4/29/89.

RECEIVED

JUL 17 1989

OIL CONSERVATION DIV.
SANTA FE

RECEIVED

MAY 19 1989

OIL CON. DIV.
DIST. 9

NOTE: Tight hole information.

CONFIDENTIAL

18. I hereby certify that the foregoing is true and correct

SIGNED

Kevin H. McCord

TITLE Petroleum Engineer

(This space for Federal or State office use)

APPROVED BY

TITLE

CONDITIONS OF APPROVAL, IF ANY:

DATE MAY 15 1989

ACCEPTED FOR RECORD

NMOCC

*See Instructions on Reverse Side

FARMINGTON RESOURCE AREA

BY SM

ROBERT L. BAYLESS

PETROLEUM PLAZA BUILDING
P. O. BOX 168
FARMINGTON, NEW MEXICO 87499
(505) 326-2659

Jicarilla 459 #3

DAILY REPORT

Page 4

3/29/89 Tubing pressure = 0. Casing pressure = 30 psi. Make 5 swab runs. Well began flowing (see Swab Report). At 3:30 PM tubing pressure = 100 psi through 3/4" choke, casing pressure = 390 psi. Total fluid recovery today = 63 bbls. Remaining fluid = 51 bbls.

3/30/89 Tubing pressure = 50 psi. Casing pressure = 290 psi. Well flowed 36 bbls. water overnight. Rig up recording orifice meter and fluid to frac tank. Catch gas sample and water sample. Leave well flowing to tank. Total remaining load water = 15 bbls.

3/31/89 Tubing pressure = 28 psi. Casing pressure = 300 psi. Well produced 34 bbls. water from 10:00 AM on 3/30 to 8:00 AM on 3/31. Well flowing to test.

4/01/89 Well flowing to test. Run 24 hr. BHP bomb in hole. Flow well for 4 hours. Shut in well for buildup.

4/02/89 Well shut in for buildup. Wireline broken while pulling BHP bombs (operator error). Fish for BHP bombs. Latched onto wire. Fishing tool hung up in hole. Shut in well. Shut down for night.

4/03/89 Well shut in. Wait on orders.

4/04/89 Well shut in. Wait on orders.

4/05/89 Blow down well. Kill well with 184 bbls. of water. Pull 5 stands of tubing and strip out wireline. Recover BHP bombs. Land tubing in wellhead as follows:

<u>Description</u>	<u>Length</u>	<u>Depth</u>
KB to landing point	11.00	0- 11
95 jts. 1 1/2" 2.9#/ft J-55 EUE tubing	3133.72	11-3145
1 seating nipple	.85	3145-3146
1 jt. 1 1/2" 2.9#/ft J-55 EUE tubing	<u>32.19</u>	3146-3178
	3177.76	

Rigged to swab. Made 6 swab runs. Well kicked off flowing. Well died. Kicked well off. Well flowed until 10:00 PM. Shut well in. Shut down for night.

4/06/89 Overnight pressures: tubing = 850 psi, annulus = 800 psi. Opened well to flow. Flow testing well.

4/07/89 Flow testing well.

~~CONFIDENTIAL~~

ROBERT L. BAYLESS

PETROLEUM PLAZA BUILDING
P. O. BOX 168
FARMINGTON, NEW MEXICO 87499
(505) 326-2659

Jicarilla 459 #3

DAILY REPORT

Page 5

4/08/89 Flow testing well. Shut in well for 9-day buildup.
4/09/89 to 4/16/89 Well shut in for buildup.
4/17/89 Pulled bottomhole pressure bombs from well. Wait on orders.
4/18/89 Wait on orders.
4/19/89 Run bottomhole pressure bomb to 3278' RKB. Start 7-day flow test.
4/20/89 to 4/25/89 Well flowing - 7-day flow test.
4/26/89 Well flowing. End of 7-day flow test. Pull bottomhole pressure bomb. Run in bottomhole pressure bomb for buildup test.
4/27/89 to 4/28/89 Well shut in. Pressure bomb in hole for pressure buildup.
4/29/89 Pull bottomhole pressure bomb. Leave well shut in. Wait on orders.

~~CONFIDENTIAL~~

UNITED STATES
DEPARTMENT OF THE INTERIOR
BUREAU OF LAND MANAGEMENT

SUBMIT IN DUPLICATE*

(See other instructions on reverse side)

Form approved,
Budget Bureau No. 1004-0137
Expires August 31, 1985

WELL COMPLETION OR RECOMPLETION REPORT AND LOG *

5. LEASE DESIGNATION AND SERIAL NO.

Jicarilla Contract 459

6. IF INDIAN, ALLOTTEE OR TRIBE NAME

Jicarilla Apache Tribe

7. UNIT AGREEMENT NAME

8. FARM OR LEASE NAME

Jicarilla 459

9. WELL NO.

3

10. FIELD AND POOL, OR WILDCAT

Ojo Alamo

11. SEC. T., R., M., OR BLOCK AND SURVEY OR AREA

Section 18, T30N, R3W

12. COUNTY OR PARISH

Rio Arriba

13. STATE

NM

1a. TYPE OF WELL: 90 APR 25 WELL 9 2 AS WELL X DRY ☐ Other Testing zone

b. TYPE OF COMPLETION:

NEW WELL ☐ WORK OVER ☒ DEEP-EN ☐ PLUG BACK ☐ DIFF. REVR. ☒ Other Testing zone

2. NAME OF OPERATOR

Robert L. Bayless

3. ADDRESS OF OPERATOR

P.O. Box 168, Farmington, NM 87499

4. LOCATION OF WELL (Report location clearly and in accordance with any State requirements)*

At surface 1658' FNL & 1901' FEL

At top prod. interval reported below same

At total depth same

14. PERMIT NO.

DATE ISSUED

15. DATE SPURRED

10/17/88

16. DATE T.D. REACHED

10/21/88

17. DATE COMPL. (Ready to prod.)

4/5/89

18. ELEVATIONS (DF, RKB, RT, GR, ETC.)*

7074' GL 7086' RKB

19. ELEV. CASINGHEAD

20. TOTAL DEPTH, MD & TVD

4040' KB

21. PLUG, BACK T.D., MD & TVD

3942' KB

22. IF MULTIPLE COMPL., HOW MANY*

23. INTERVALS DRILLED BY

ROTARY TOOLS

CABLE TOOLS

0 - TD

24. PRODUCING INTERVAL(S), OF THIS COMPLETION—TOP, BOTTOM, NAME (MD AND TVD)*

Ojo Alamo 3124' - 3160'

25. WAS DIRECTIONAL SURVEY MADE

No

26. TYPE ELECTRIC AND OTHER LOGS RUN

27. WAS WELL CORED

No

28. CASING RECORD (Report all strings set in well)

CASING SIZE	WEIGHT, LB./FT.	DEPTH SET (MD)	HOLE SIZE	CEMENTING RECORD	AMOUNT PULLED
8-5/8"	24.0#/ft	137' KB	12-1/4"	150 sx (177 ft ³) Class B w/2% CaCl ₂	
4-1/2"	10.5#/ft	4012' KB	6-3/4"	550 sx (1133 ft ³) Class B w/2% Econolite, 1/4# flocele/sx; 175 sx (221 ft ³) 50/50 pozmix w/2% gel, 10% salt, 1/4# flocele/s;	

29. LINER RECORD

SIZE	TOP (MD)	BOTTOM (MD)	SACKS CEMENT*	SCREEN (MD)	SIZE	DEPTH SET (MD)	PACKER SET (MD)
					1-1/2"	3178' KB	none

31. PERFORATION RECORD (Interval, size and number)

Ojo Alamo w/3-1/8" gun - 1 JSPF
3124-3128 - 5 holes
3137-3141 - 5 holes
3145-3153 - 9 holes (.34" diameter)
3156-3160 - 5 holes

32. ACID, SHOT, FRACTURE, CEMENT SQUEEZE, ETC.

DEPTH INTERVAL (MD)	AMOUNT AND KIND OF MATERIAL USED
3124-3160	500 gal. 7 1/2% weighted HCL acid w/36 l.l s.g. RCN ball sealers

33.* PRODUCTION

DATE FIRST PRODUCTION	PRODUCTION METHOD (Flowing, gas lift, pumping—size and type of pump)	WELL STATUS (Producing or shut-in)
None - testing	flowing	testing

DATE OF TEST	HOURS TESTED	CHOKE SIZE	PROD'N. FOR TEST PERIOD	OIL—BBL.	GAS—MCF.	WATER—BBL.	GAS-OIL RATIO
4-19-89 - 4-26-89	24 7 days	1/2					

FLOW. TUBING PRESS.	CASING PRESSURE	CALCULATED 24-HOUR RATE	OIL—BBL.	GAS—MCF.	WATER—BBL.	OIL GRAVITY-API (CORR.)
92	695			*725 553		

34. DISPOSITION OF GAS (Sold, used for fuel, vented, etc.)

vented

TEST WITNESSED BY

APR 26 1989

35. LIST OF ATTACHMENTS

Well is capable of producing this gas production rate over short periods of time. Well is currently being flow tested to determine AOF. This value will be provided at a later date.

36. I hereby certify that the foregoing and attached information is complete and correct as determined from all available records.

SIGNED

Kevin H. McCord

TITLE

Petroleum Engineer

BY

DATE

4-21-89

*(See Instructions and Spaces for Additional Data on Reverse Side)

CONFIDENTIAL

37. SUMMARY OF POROUS ZONES: (Show all important zones of porosity and contents thereof; cored intervals; and all drill-stem, tests, including depth interval tested, cushion used, time tool open, flowing and shut-in pressures, and recoveries):

38. GEOLOGIC MARKERS

FORMATION	TOP	BOTTOM	DESCRIPTION, CONTENTS, ETC.	NAME	TOP	
					MEAS. DEPTH	TRUE VERT. DEPTH
Ojo Alamo	3086	3336	natural gas	Ojo Alamo	3086	same
Kirtland	3336	3605	water	Kirtland	3336	same
Fruitland Coal	3605	3654	natural gas, water	Fruitland Coal	3605	same
Pictured Cliffs	3654	4040	natural gas	Pictured Cliffs	3654	same

UNITED STATES
DEPARTMENT OF THE INTERIOR
BUREAU OF LAND MANAGEMENT

SUBMIT IN TRIPLICATE*
(Other instructions on re-
verse side)

Form approved
Budget Bureau No. 1004-0135
Expires August 31, 1985

SUNDRY NOTICES AND REPORTS ON WELLS

(Do not use this form for proposals to drill or to deepen or plug back to a different reservoir.
Use "APPLICATION FOR PERMIT—" for such proposals.)

1. OIL WELL <input type="checkbox"/> GAS WELL <input checked="" type="checkbox"/> OTHER	5. LEASE DESIGNATION AND SERIAL NO. Jicarilla Contract 459
2. NAME OF OPERATOR Robert L. Bayless	6. IF INDIAN, ALLOTTEE OR TRIBE NAME Jicarilla Apache Tribe
3. ADDRESS OF OPERATOR P.O. Box 168 Farmington, NM 87499	7. UNIT AGREEMENT NAME
4. LOCATION OF WELL (Report location clearly and in accordance with any State requirements.* See also space 17 below.) At surface 1658' FNL & 1901' FEL	8. FARM OR LEASE NAME Jicarilla 459
14. PERMIT NO.	9. WELL NO. 3
15. ELEVATIONS (Show whether DF, RT, GR, etc.) 7074' GL 7086' RKB	10. FIELD AND POOL, OR WILDCAT Undesignated Ojo Alamo
	11. SEC., T., R., M., OR BLK. AND SURVEY OR AREA Section 18, T30N, R3W
	12. COUNTY OR PARISH Rio Arriba
	13. STATE NM

16. Check Appropriate Box To Indicate Nature of Notice, Report, or Other Data

NOTICE OF INTENTION TO:

SUBSEQUENT REPORT OF:

TEST WATER SHUT-OFF <input type="checkbox"/>	PULL OR ALTER CASING <input type="checkbox"/>
FRACTURE TREAT <input type="checkbox"/>	MULTIPLE COMPLETE <input type="checkbox"/>
SHOOT OR ACIDIZE <input type="checkbox"/>	ABANDON* <input type="checkbox"/>
REPAIR WELL <input type="checkbox"/>	CHANGE PLANS <input type="checkbox"/>
(Other) <input type="checkbox"/>	

WATER SHUT-OFF <input type="checkbox"/>	REPAIRING WELL <input type="checkbox"/>
FRACTURE TREATMENT <input type="checkbox"/>	ALTERING CASING <input type="checkbox"/>
SHOOTING OR ACIDIZING <input checked="" type="checkbox"/>	ABANDONMENT* <input type="checkbox"/>
(Other) <input type="checkbox"/>	

(NOTE: Report results of multiple completion on Well Completion or Recompletion Report and Log form.)

17. DESCRIBE PROPOSED OR COMPLETED OPERATIONS (Clearly state all pertinent details, and give pertinent dates, including estimated date of starting any proposed work. If well is directionally drilled, give subsurface locations and measured and true vertical depths for all markers and zones pertinent to this work.) *

This well was perforated and acidized in the Ojo Alamo Formation as follows:

SEE ATTACHED DAILY REPORTS 03/27/89 and 03/28/89.

RECEIVED

JUL 17 1989

OIL CONSERVATION DIV.
SANTA FE

~~CONFIDENTIAL~~

TIGHT HOLE INFORMATION

18. I hereby certify that the foregoing is true and correct

SIGNED

Kevin H. McCord

TITLE Petroleum Engineer

DATE 4/04/89

(This space for Federal or State office use)

APPROVED BY

TITLE

DATE

CONDITIONS OF APPROVAL, IF ANY:

ACCEPTED FOR RECORD

APR 05 1989

*See Instructions on Reverse Side

OPERATOR

FARMINGTON RESOURCE AREA

Title 18 U.S.C. Section 1001, makes it a crime for any person knowingly and willfully to make to any department or agency of the United States any false, fictitious or fraudulent statements or representations as to any matter within its jurisdiction.

ROBERT L. BAYLESS

PETROLEUM PLAZA BUILDING
P. O. BOX 168
FARMINGTON, NEW MEXICO 87499
(505) 326-2659

JICARILLA 459 #3
Section 18, T30N, R3W
1658' FNL & 1901' FEL
Rio Arriba County, New Mexico

DAILY REPORT

03/27/89 Move in completion rig and pump. Rig up equipment. Mix 100 bbl of 2% KCL water.

03/28/89 ~~Show well~~ down and kill w/ KCL water. Nipple up BOP. Trip out of hole with tubing. Set wireline bridge plug at 3500 ft KB. Dump 15 gallons of sand on retrievable plug. Trip tubing in hole to 3460 ft. Roll hole. Move tubing to 3170 ft and spot 150 gallons of 7 1/2% HCL acid. Trip tubing out of hole. Pressure test casing to 3000 PSI for 3 minutes. Perforate Ojo Alamo with 1 JSPF (.340" diameter) as follows:

3124 - 3128	4	5 holes
3137 - 3141	4	5 holes
3145 - 3153	8	9 holes
3156 - 3160	4	5 holes
	<u>20'</u>	<u>24 holes</u>

Break down perfs at 1350 PSI. Pump into zone at 5.0 BPM with 1200 PSI. ISIP = 900 PSI. Acidize perfs with 500 gallons 7 1/2% HCL weighted acid. Drop 36 1.1 sq RCN ball sealers. Pump 3.5 BPM @ 1010 PSI while dropping balls. Increase rate to 5.2 BPM @ 1100 PSI. ISIP = 900 PSI, 1 min = 350 PSI, 2 min = 180 PSI, 3 min = 90 PSI, 4 min = 40 PSI, 5 min = 0. Casing on vacuum. Total fluid to recover = 137.5 bbls. Run 1 1/2" tubing, land at 3178 ft. Make 8 swab runs, recover 23.5 bbls. Remaining load = 114 bbls. Shut well in over night.

03/29/89 Currently swabbing and testing on Ojo Alamo formation in this well.

RECEIVED
177-1-1039
MAR 29 1989
MAR 29 1989

UNITED STATES
DEPARTMENT OF THE INTERIOR
BUREAU OF LAND MANAGEMENT

SUBMIT IN TRIPLICATE*
(Other instructions on re-
verse side)

Check Bureau NO. 1004-1113
Expires August 31, 1985

SUNDRY NOTICES AND REPORTS ON WELLS

(Do not use this form for proposals to drill or to deepen or plug back to a different reservoir.
Use "APPLICATION FOR PERMIT" for such proposals.)

5. LEASE DESIGNATION AND SERIAL NO.

Jicarilla Contract 459

6. IF INDIAN, ALLOTTEE OR TRIBE NAME

Jicarilla Apache Tribe

7. UNIT AGREEMENT NAME

8. FARM OR LEASE NAME

Jicarilla 459

9. WELL NO.

3

10. FIELD AND POOL, OR WILDCAT

East Blanco P.C.

11. SEC., T., R., M., OR BLK. AND
SURVEY OR AREA

Section 18, T30N, R3W

12. COUNTY OR PARISH 13. STATE

Rio Arriba

NM

OIL WELL ☐ GAS WELL ☒ OTHER ☐

1. NAME OF OPERATOR

Robert L. Bayless

2. ADDRESS OF OPERATOR

P.O. Box 168, Farmington, NM 87499

3. LOCATION OF WELL (Report location clearly and in accordance with any State requirements.*
See also space 17 below)

At surface 1658' FNL & 1901' FEL

14. PERMIT NO.

15. ELEVATIONS (Show whether DF, RT, CR, etc.)

7074' GL 7086' RKB

16. Check Appropriate Box To Indicate Nature of Notice, Report, or Other Data

NOTICE OF INTENTION TO:

TEST WATER SHUT-OFF ☐

PULL OR ALTER CASING ☐

FRAC TREAT ☐

MULTIPLE COMPLETE ☐

SHOOT OR ACIDIZE ☒

ABANDON* ☐

REPAIR WELL ☐

CHANGE PLAN* ☐

Other: Swab test

X

SUBSEQUENT REPORT OF:

WATER SHUT-OFF ☐

REPAIRING WELL ☐

FRAC TREATMENT ☐

ALTERING CASING ☐

SHOOTING OR ACIDIZING ☐

ABANDONMENT* ☐

(Other) ☐

(Note: Report results of multiple completion on Well
Completion or Recompletion Report and Log form.)

17. DESCRIBE PROPOSED OR COMPLETED OPERATION. Clearly state all pertinent details, and give pertinent dates, including estimated date of starting any proposed work. If well is directionally drilled, give subsurface locations and measured and true vertical depths for all markers and zones pertinent to this work.*

We propose setting a bridge plug above Pictured Cliffs perforations and perforating the Ojo Alamo from 3124 ft. to 3160 ft. We will then acidize perforations with 500 gallons 7 1/2% HCL acid and swab test for evaluation.

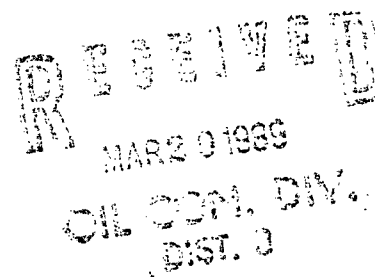
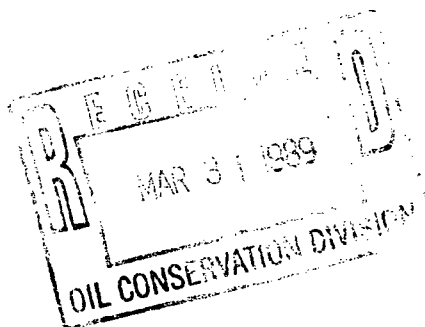

18. I hereby certify that the foregoing is true and correct

SIGNED Price M. Bayless

TITLE Engineer

DATE 3/15/89

(This space for Federal or State office use)

APPROVED BY _____
CONDITIONS OF APPROVAL, IF ANY:

TITLE _____

APPROVED

*See Instructions on Reverse Side

Title 18 U.S.C. Section 1001, makes it a crime for any person knowingly and willfully to make to any department or agency of the United States any false, fictitious or fraudulent statements or representations as to any matter within its jurisdiction.

NMOCC

OIL CONSERVATION DIVISION

Hobbs
P.O. Box 1980
Hobbs, NM 88240

Artesia
P.O. Drawer DD
Artesia, NM 88210

Aztec
1000 Rio Brazos
Aztec, NM 87410

NOTICE OF GAS WELL - CONNECTION / RECONNECTION / DISCONNECTION

This is to notify the Oil Conservation Division of the following:

Connection	<u>X</u>	First Delivery	<u>1/19/89</u>	<u>1500 MCED</u>
			Date	Initial Potential
Reconnection	<u> </u>	First Delivery	<u> </u>	<u> </u>
			Date	Initial Potential
Disconnection	<u> </u>			

for delivery of gas from the Robert L. Bayless
Operator

Jicarilla 459
Lease

Meter Code	Site Code	<u>3</u>	<u>G</u>	<u>Sec. 18-T30N-R3W</u>
		Well No.	Unit Letter	S-T-R

East Blanco Pictured Cliffs
Pool

was made on 1/19/89
date

3184 MCED
AOF

3/4"
Choke

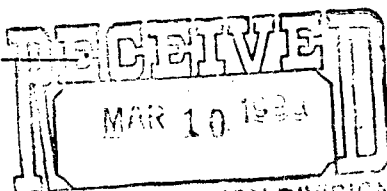

OIL CONSERVATION DIVISION
SANTA FE

Robert L. Bayless
Transporter

MAR 10 1989
OIL CON. DIV
SANTA FE, N.M.

OCD use only

County RA

Land Type J

Liq. Transporter e

Kevin H. McCord, Petroleum Engineer
Representative Name/Title
(Please type or print)

Kevin H. McCord
Representative Signature

Submit in duplicate to the appropriate district office.

Submit 5 Copies
Appropriate District Office
DISTRICT I
P.O. Box 1980, Hobbs, NM 88240

DISTRICT II
P.O. Drawer DD, Artesia, NM 88210

DISTRICT III
1000 Rio Brazos Rd., Aztec, NM 87410

State of New Mexico
Energy, Minerals and Natural Resources Department

OIL CONSERVATION DIVISION

P.O. Box 2088
Santa Fe, New Mexico 87504-2088

Form C-104
Revised 1-1-89
See Instructions
at Bottom of Page

REQUEST FOR ALLOWABLE AND AUTHORIZATION TO TRANSPORT OIL AND NATURAL GAS

Operator Robert L. Bayless	Well API No. 30-039-24306
Address P.O. Box 168, Farmington, NM 87499	
Reason(s) for Filing (Check proper box) New Well <input checked="" type="checkbox"/> Change in Transporter of: Recompletion <input type="checkbox"/> Oil <input type="checkbox"/> Dry Gas <input type="checkbox"/> Change in Operator <input type="checkbox"/> Casinghead Gas <input type="checkbox"/> Condensate <input type="checkbox"/>	
If change of operator give name and address of previous operator	

II. DESCRIPTION OF WELL AND LEASE

Lease Name Jicarilla 459	Well No. 3	Pool Name, Including Formation East Blanco Pictured Cliffs	Kind of Lease State, Federal or Fee	Lease No. Jic. Cont. 459
Location Unit Letter G : 1658 Feet From The north Line and 1901 Feet From The east Line Section 18 Township 30N Range 3W, NMPM, Rio Arriba County				

III. DESIGNATION OF TRANSPORTER OF OIL AND NATURAL GAS

Name of Authorized Transporter of Oil <input type="checkbox"/> or Condensate <input type="checkbox"/>	Address (Give address to which approved copy of this form is to be sent)					
Name of Authorized Transporter of Casinghead Gas <input type="checkbox"/> or Dry Gas <input checked="" type="checkbox"/>	Address (Give address to which approved copy of this form is to be sent)					
Robert L. Bayless	P.O. Box 168, Farmington, NM 87499					
If well produces oil or liquids, give location of tanks.	Unit	Sec.	Twsp.	Rge.	Is gas actually connected?	When ?
					yes	1/19/89

If this production is commingled with that from any other lease or pool, give commingling order number:

IV. COMPLETION DATA

Designate Type of Completion - (X)	Oil Well	Gas Well	New Well	Workover	Deepen	Plug Back	Same Res'v	Diff Res'v
		X	X					
Date Spudded 10/17/88	Date Compl. Ready to Prod. 1/7/89	Total Depth 4040'	P.B.T.D. 3942'					
Elevations (DF, RKB, RT, GR, etc.) 7074' GL; 7086' RKB	Name of Producing Formation Pictured Cliffs	Top Oil/Gas Pay 3657'	Tubing Depth 3700'					
Perforations			Depth Casing Shoe					

TUBING, CASING AND CEMENTING RECORD			
HOLE SIZE	CASING & TUBING SIZE	DEPTH SET	SACKS CEMENT
12 1/4"	8 5/8"	137' KB	150 sx Class B (177 ft)
6 3/4"	4 1/2"	4012' KB	550 sx Class B (1133 ft)

V. TEST DATA AND REQUEST FOR ALLOWABLE

OIL WELL (Test must be after recovery of total volume of load oil and must be equal to or exceed top allowable for this depth or be for full 24 hours)			
Date First New Oil Run To Tank	Date of Test	Producing Method (Flow, pump, gas lift, etc.)	
Length of Test	Tubing Pressure	Casing Pressure	Choke Size
Actual Prod. During Test	Oil - Bbls.	Water - Bbls.	Gas - MCF

GAS WELL

Actual Prod. Test - MCF/D 2539	Length of Test 3 hrs.	Bbls. Condensate/MMCF -0-	Gravity of Condensate -0-
Testing Method (pilot, back pr.) Back Pressure Test	Tubing Pressure (Shut-in) 890	Casing Pressure (Shut-in) 890	Choke Size 3/4"

VI. OPERATOR CERTIFICATE OF COMPLIANCE

I hereby certify that the rules and regulations of the Oil Conservation Division have been complied with and that the information given above is true and complete to the best of my knowledge and belief.

Signature
Kevin H. McCord
Printed Name
Kevin H. McCord
Date
1/24/89
Title
Petroleum Engineer
Telephone No.
505/326-2659

OIL CONSERVATION DIVISION

1-30-89
Date Approved
By
Title
SUPERVISOR DISTRICT #1

INSTRUCTIONS: This form is to be filed in compliance with Rule 1104

- Request for allowable for newly drilled or deepened well must be accompanied by tabulation of deviation tests taken in accordance with Rule 111.
- All sections of this form must be filled out for allowable on new and recompleted wells.
- Fill out only Sections I, II, III, and VI for changes of operator, well name or number, transporter, or other such changes.
- Separate Form C-104 must be filed for each pool in multiply completed wells.

UNITED STATES
DEPARTMENT OF THE INTERIOR
BUREAU OF LAND MANAGEMENT

SUBMIT IN DUPLICATE*

(See other in-
structions on
reverse side)

Form approved.
Budget Bureau No. 1004-0137
Expires August 31, 1985

LEASE DESIGNATION AND SERIAL NO.

Jicarilla Contract 459

IF INDIAN ALLOTTEE OR TRIBE NAME

Jicarilla Apache Tribe

UNIT AGREEMENT NAME

OWN OR LEASE NAME

Jicarilla 459

WELL NO.

3

FIELD AND POOL OR WILDCAT

East Blanco Pictured Cliffs

SEC. T. R. M. OR BLOCK AND SURVEY
OR AREA

Section 18, T30N, R3W

COUNTY OR
PARISH

Rio Arriba

STATE

NM

1a. TYPE OF WELL:

OIL WELL ☐

GAS WELL ☒

DRY ☐

Other 92 JAN 24 AM 9:45

b. TYPE OF COMPLETION:

NEW WELL ☒

WORK OVER ☐

DEEP EN ☐

PLUG BACK ☐

DIFF REPAIR ☐

Other FARMINGTON RESOURCE AREA

2. NAME OF OPERATOR

Robert L. Bayless

3. ADDRESS OF OPERATOR

P.O. Box 168, Farmington, NM 87499

4. LOCATION OF WELL (Report location clearly and in accordance with any State requirements)*

At surface

1658' FNL & 1901' FEL

At top prod. interval reported below

same

At total depth

same

FEB 15 1989

14. PERMIT NO.

DATE ISSUED

15. DATE SPUDDED

10/17/88

16. DATE T.D. REACHED

10/21/88

17. DATE COMPL. (Ready to prod.)

1/7/89

18. ELEVATIONS (OF RKB, RT, GR, ETC.)*

7074' GL 7086' RKB

19. ELEV. CASINGHEAD

20. TOTAL DEPTH, MD & TVD

4040' KB

21. PLUG BACK T.D., MD & TVD

3942' KB

22. IF MULTIPLE COMPL., HOW MANY*

23. INTERVALS DRILLED BY

ROTARY TOOLS

CABLE TOOLS

24. PRODUCING INTERVAL(S), OF THIS COMPLETION—TOP, BOTTOM, NAME (MD AND TVD)

Pictured Cliffs 3657' - 3751'

JAN 3 1989

25. WAS DIRECTIONAL SURVEY MADE

No

26. TYPE ELECTRIC AND OTHER LOGS RUN

IEL-GR-CLL-CBL-CNL-FDC

27. WAS WELL CORED

No

28. CASING RECORD (Report all strings set in well)*

CASING SIZE	WEIGHT, LB./FT.	DEPTH SET (MD)	HOLE SIZE	CEMENTING RECORD	AMOUNT PULLED
8-5/8"	24.0#/ft	137' KB	12-1/4"	150 sx (177 ft ³) Class B w/2% CaCl ₂	
4-1/2"	10.5#/ft	4012' KB	6-3/4"	550 sx (1133 ft ³) Class B w/2% Econolite, 1/4# flocele/sx; 175 sx (221 ft ³) 50/50 pozmix w/2% gel, 10% salt, 1/4# flocele/sx	

29. LINER RECORD

SIZE	TOP (MD)	BOTTOM (MD)	SACKS CEMENT*	SCREEN (MD)

30. TUBING RECORD

SIZE	DEPTH SET (MD)	PACKER SET (MD)
1-1/2"	3700' KB	none

31. PERFORATION RECORD (Interval, size and number)

Pic. Cliffs w/3 1/8" gun - 2 JSPF
3657-3667 - 21 holes
3674-3679 - 11 holes
3684-3688 - 9 holes (.34" diameter)
3695-3705 - 21 holes
3729-3736 - 15 holes
3747-3751 - 9 holes

32. ACID, SHOT, FRACTURE, CEMENT SQUEEZE, ETC.

DEPTH INTERVAL (MD)	AMOUNT AND KIND OF MATERIAL USED
3657 - 3751	500 gal. 7 1/2% weighted HCL acid w/129 l.l.s.g. RCN ball sealers; 150,000 gal. 70 quality foam w/200,000# 20-40 mesh sand

33.* PRODUCTION

DATE FIRST PRODUCTION		PRODUCTION METHOD (Flowing, gas lift, pumping—size and type of pump)				WELL STATUS (Producing or shut-in)	
1/19/89		flowing				producing	
DATE OF TEST	HOURS TESTED	CHOKE SIZE	PROD'N. FOR TEST PERIOD	OIL—BBL.	GAS—MCF.	WATER—BBL.	GAS-OIL RATIO
1/16/89	3	3/4"	→	-0-	317	-0-	N/A
FLOW. TUBING PRESS.	CASING PRESSURE	CALCULATED 24-HOUR RATE	OIL—BBL.	GAS—MCF.	WATER—BBL.	OIL GRAVITY-API (CORR.)	
151	890	→	-0-	2539	-0-	N/A	

34. DISPOSITION OF GAS (Sold, used for fuel, vented, etc.)

vented

TEST WITNESSED BY

David Ball

35. LIST OF ATTACHMENTS

ACCEPTED FOR RECORD

36. I hereby certify that the foregoing and attached information is complete and correct as determined from all available records

SIGNED

Kevin H. McCord

TITLE

Petroleum Engineer

DATE

1/23/89

*(See Instructions and Spaces for Additional Data on Reverse Side)

FARMINGTON RESOURCE AREA

37. SUMMARY OF POROUS ZONES: (Show all important zones of porosity and contents thereof; cored intervals; and all drill-stem, tests, including depth interval tested, cushion used, time tool open, flowing and shut-in pressures, and recoveries):

38. GEOLOGIC MARKERS

FORMATION	TOP	BOTTOM	DESCRIPTION, CONTENTS, ETC.	NAME	TOP	
					MEAS. DEPTH	TRUE VERT. DEPTH
Ojo Alamo	3086	3336	water	Ojo Alamo	3086	same
Kirtland	3336	3605	water	Kirtland	3336	same
Fruitland Coal	3605	3654	natural gas, water	Fruitland Coal	3605	same
Pictured Cliffs	3654	4040	natural gas	Pictured Cliffs	3654	same

MULTIPOINT AND ONE POINT BACK PRESSURE TEST FOR GAS WELL

Type Test <input checked="" type="checkbox"/> Initial <input type="checkbox"/> Annual <input type="checkbox"/> Special				Test Date 1/16/89							
Company Robert L. Bayless				Connection Robert L. Bayless							
Pool East Blanco Pictured Cliffs				Formation Pictured Cliffs		Unit					
Completion Date 1/7/89		Total Depth 4040'		Plug back TD 3942'		Elevation 7046' RKB					
Farm or Lease Name Jicarilla 459		Well No. 3									
Csg. Size 4 1/2"	Wt. 10.5#	d 4.052"	Set At 4012'	Perforations: From 3657' To 3751'							
Trg. Size 1 1/2"	Wt. 2.9#	d 1.610"	Set At 3700'	Perforations: From To		Unit Sec. Twp. Rye. G 18 30N. 3W					
Type Well - Single - Blindhead - G.G. or G.O. Multiple single				Packer Set At none		County Rio Arriba					
Producing Thru tubing		Reservoir Temp. °F #		Mean Annual Temp. °F		Baro. Press. - P _a 12.0 (est.)					
State New Mexico											
L	H	Cg .65 (est)	% CO ₂	% N ₂	% H ₂ S	Prover	Meter Run Taps				
FLOW DATA				TUBING DATA		CASING DATA					
NO.	Prover Line Size	X	Orifice Size	Press. p.s.i.g.	Diff. h _w	Temp. °F	Press. p.s.i.g.	Temp. °F	Press. p.s.i.g.	Temp. °F	Duration of Flow
SI	9 days						890		890		
1.	2 inch x .750						151	60°	424		3 hrs.
2.											
3.											
4.											
5.											
RATE OF FLOW CALCULATIONS											
NO.	Coefficient (24 Hour)	$\sqrt{h_w P_m}$	Pressure P _m	Flow Temp. Factor Ft.	Gravity Factor F _g	Super Compress. Factor, F _{pv}	Rate of Flow Q, Mcfd				
1	12.365		163	1.000	1.240	1.016	2539				
2.											
3.											
4.											
5.											
NO.	P _r	Temp. °R	T _r	Z	Gas Liquid Hydrocarbon Ratio _____ Mcf/bbl.						
1	.243		1.39	.969	A.P.I. Gravity of Liquid Hydrocarbons _____ Deg.						
2.					Specific Gravity Separator Gas _____ X X X X X X X X						
3.					Specific Gravity Flowing Fluid _____ X X X X X						
4.					Critical Pressure _____ P.S.I.A. _____ P.S.I.A.						
5.					Critical Temperature _____ R _____ R						
P _c 902 P _c ² 813,604											
NO.	P _i ²	P _w	P _w ²	P _c ² - P _w ²	(1) $\frac{P_c^2}{P_c^2 - P_w^2} = 1.3049$ (2) $\left[\frac{P_c^2}{P_c^2 - P_w^2} \right]^n = 1.2538$						
1		436	190,096	623,508							
2											
3											
4											
5											
AOF = Q $\left[\frac{P_c^2}{P_c^2 - P_w^2} \right]^n = 3184$											
Absolute Open Flow 3184 Mcfd @ 15.025 Angle of Slope @ _____ Slope, n .85											
Remarks: Light mist of water throughout test.											
Approved By Division _____ Conducted By: David Ball _____ Calculated By: Kevin McCord _____ Checked By: _____											

Form 5000-10
November 1983)
Formerly 9-331)

UNITED STATES
DEPARTMENT OF THE INTERIOR
BUREAU OF LAND MANAGEMENT

SUBMIT IN TRIPLICATE
(Other instructions on re-
verse side)

Expires August 31, 1985

SUNDRY NOTICES AND REPORTS ON WELLS

(Do not use this form for proposals to drill or to deepen or plug back to a different reservoir.
Use "APPLICATION FOR PERMIT" for such proposals.)

OIL WELL ☐ GAS WELL ☐ OTHER ☒

2. NAME OF OPERATOR

Robert L. Bayless

3. ADDRESS OF OPERATOR

P.O. Box 168, Farmington, NM 87499

4. LOCATION OF WELL (Report location clearly and in accordance with any State requirements.*

See also space 17 below.)

At surface 1658' FNL & 1901' FEL

14. PERMIT NO.

15. ELEVATIONS (Show whether DF, RT, GR, etc.)

7074' GL 7086' RKB

5. LEASE DESIGNATION AND SERIAL NO.

Jicarilla Contract 459

6. IF INDIAN, ALLOTTEE OR TRIBE NAME

Jicarilla Apache Tribe

7. UNIT AGREEMENT NAME

8. FARM OR LEASE NAME

Jicarilla 459

9. WELL NO.

3

10. FIELD AND POOL, OR WILDCAT

East Blanco P.C.

11. SEC., T., R., M., OR BLK. AND SURVEY OR AREA

Section 18, T30N, R3W

12. COUNTY OR PARISH 13. STATE

Rio Arriba

NM

16.

Check Appropriate Box To Indicate Nature of Notice, Report, or Other Data

NOTICE OF INTENTION TO:

SUBSEQUENT REPORT OF:

TEST WATER SHUT-OFF ☐

PULL OR ALTER CASING ☐

WATER SHUT-OFF ☐

REPAIRING WELL ☐

FRACTURE TREAT ☐

MULTIPLE COMPLETE ☐

FRACTURE TREATMENT ☐

ALTERING CASING ☐

SHOOT OR ACIDIZE ☐

ABANDON* ☐

SHOOTING OR ACIDIZING ☐

ABANDONMENT* ☐

REPAIR WELL ☐

CHANGE PLANT ☐

(Other) Cement longstring

X

(NOTE: Report results of multiple completion on Well Completion or Recompletion Report and Log form.)

17. DESCRIBE PROPOSED OR COMPLETED OPERATIONS (Clearly state all pertinent details, and give pertinent dates, including estimated date of starting any proposed work. If well is directionally drilled, give subsurface locations and measured and true vertical depths for all markers and zones pertinent to this work.)*

SEE ATTACHED DAILY REPORTS 10/18/88 thru 10/22/88.

18. I hereby certify that the foregoing is true and correct

SIGNED

Kevin H. McCord

TITLE

Petroleum Engineer

DATE

10/25/88

(This space for Federal or State office use)

APPROVED BY

TITLE

CONDITIONS OF APPROVAL, IF ANY:

ACCEPTED FOR RECORD

OCT 27 1988

FARMINGTON RESOURCE AREA

BY KH

*See Instructions on Reverse Side

NMCCC

Title 18 U.S.C. Section 1001, makes it a crime for any person knowingly and willfully to make to any department or agency of the United States any false, fictitious or fraudulent statements or representations as to any matter within its jurisdiction.

ROBERT L. BAYLESS

PETROLEUM PLAZA BUILDING
P. O. BOX 168
FARMINGTON, NEW MEXICO 87499
(505) 326-2659

RECEIVED
MAIL ROOM
80 OCT 26 PM 1:55

JICARILLA 459 #3
Section 18, T30N, R3W
1658' FNL & 1901' FEL
Rio Arriba County, New Mexico

DAILY REPORT

- 10/17/88 Spud well at 12:30 AM on 10/17/88. Drilled 140' of 12 1/4" surface hole. Ran 3 jts. of 8 5/8" 24#/ft J-55 casing (124.04 ft.) and set at 137' RKB. Rig up Cementers, Inc. Cemented surface with 150 sx of Class B cement with 2% CaCl₂. Good circulation throughout job. Circulated cement to surface. Plug down at 5:15 AM on 10/17/88. Wait on cement.
- 10/18/88 Drilling ahead at 1452'.
- 10/19/88 Drilling ahead at 2555'.
- 10/20/88 Drilling ahead at 3400'.
- 10/21/88 Drilling ahead at 3975'.
- 10/22/88 TD well at 4040' RKB at 9:30 AM on 10/21/88. Circulate bottoms up. Short trip. Trip out of hole for logs. Rigged up Welex. Ran IEL, CNL, FDC logs from TD of 4025 ft. (fill). Trip in hole with drillpipe. Lay down drillpipe and collars. Ran 94 jts. of 4 1/2" 10.5#/ft J-55 new casing as follows:

<u>Description</u>	<u>Length</u>	<u>Depth</u>
KB to landing point	11.00	0- 11
93 jts. 4 1/2" 10.5#/ft J-55 new casing (Domestic-Maverick)	3957.69	11-3969
1 DFFC	1.65	3969-3970
1 jt. 4 1/2" 10.5#/ft csg. for shoe jt.	40.53	3970-4011
1 cement filled guide shoe	.85	4011-4012
	4011.72	

Centralizers at 3992, 3756, 3713, 3671, 3628 and 3594. Rigged up Halliburton. Cemented longstring with 550 sx Class B cement with 2% Econolite and 1/4# flocele/sx, tailed by 175 sx of 50/50 pozmix with 2% gel, 10% salt and 1/4# flocele/sx. Lost circulation 34 bbls. into flush. Lost 29 bbls. of cement into formation. Pressure climbing to 900 psi at end of job. Acting like lifting cement. Bumped plug--held OK. Plug down at 3:30 AM 10/22/88. Set slips. Released rig. Wait on completion.

UNITED STATES
DEPARTMENT OF THE INTERIOR
BUREAU OF LAND MANAGEMENT

SUBMIT IN TRIPLICATE*
(Other instructions on re-
verse side)

Expires August 31, 1985

SUNDRY NOTICES AND REPORTS ON WELLS

(Do not use this form for proposals to drill or to deepen or plug back to a different reservoir.
Use "APPLICATION FOR PERMIT" for such proposals.)

WELL ☐ OIL WELL ☒ OTHER

1. NAME OF OPERATOR

Robert L. Bayless

2. ADDRESS OF OPERATOR

P.O. Box 168, Farmington, NM 87499

3. LOCATION OF WELL (Report location clearly and in accordance with any State requirements.*
See also space 17 below.)

At surface 1658' FNL & 1901' FEL

14. PERMIT NO.

15. ELEVATIONS (Show whether OF, RT, GR, etc.)

7074' GL 7086' RKB

3. LEASE DESIGNATION AND SERIAL NO.

Jicarilla Contract 459

6. IF INDIAN, ALLOTTEE OR TRIBE NAME

Jicarilla Apache Tribe

7. UNIT AGREEMENT NAME

8. FARM OR LEASE NAME

Jicarilla 459

9. WELL NO.

3

10. FIELD AND POOL, OR WILDCAT

East Blanco P.C.

11. SEC., T., R., M., OR BLK. AND
SURVEY OR AREA

Section 18, T30N, R3W

12. COUNTY OR PARISH 13. STATE

Rio Arriba

NM

16. Check Appropriate Box To Indicate Nature of Notice, Report, or Other Data

NOTICE OF INTENTION TO:

SUBSEQUENT REPORT OF:

TEST WATER SHUT-OFF ☐

PULL OR ALTER CASING ☐

WATER SHUT-OFF ☐

REPAIRING WELL ☐

FRACTURE TREAT ☐

MULTIPLE COMPLETE ☐

FRACTURE TREATMENT ☐

ALTERING CASING ☐

SHOOT OR ACIDIZE ☐

ABANDON* ☐

SHOOTING OR ACIDIZING ☐

ABANDONMENT* ☐

REPAIR WELL ☐

CHANGE PLAN ☐

(Other) Spud notice; surface casing ☒

(NOTE: Report results of multiple completion on Well
Completion or Recompletion Report and Log form.)

17. DESCRIBE PROPOSED OR COMPLETED OPERATIONS. Clearly state all pertinent details, and give pertinent dates, including estimated date of starting any
proposed work. If well is directionally drilled, give subsurface locations and measured and true vertical depths for all markers and zones perti-
nent to this work.*

SEE ATTACHED DAILY REPORT OF 10/17/88.

RECEIVED
OCT 18 PM 1:29
FARMINGTON RESOURCE AREA
FARMINGTON, NEW MEXICO

RECEIVED
OCT 21 1988
OIL CON. DIV
DIST. 3

18. I hereby certify that the foregoing is true and correct

SIGNED

Kevin H. McCord

TITLE

Petroleum Engineer

DATE

10/17/88

(This space for Federal or State office use)

APPROVED BY

TITLE

DATE

CONDITIONS OF APPROVAL, IF ANY:

NMDC

*See Instructions on Reverse Side

ROBERT L. BAYLESS

PETROLEUM PLAZA BUILDING
P. O. BOX 168
FARMINGTON, NEW MEXICO 87499
(505) 326-2659

JICARILLA 459 #3
Section 18, T30N, R3W
1658' FNL & 1901' FEL
Rio Arriba County, New Mexico

DAILY REPORT

10/17/88 Spud well at 12:30 AM on 10/17/88. Drilled 140' of 12 1/4" surface hole. Ran 3 jts. of 8 5/8" 24#/ft J-55 casing (124.04 ft.) and set at 137' RKB. Rig up Cementers, Inc. Cemented surface with 150 sx of Class B cement with 2% CaCl₂. Good circulation throughout job. Circulated cement to surface. Plug down at 5:15 AM on 10/17/88. Wait on cement.

RECEIVED
OCT 21 1988
OIL CON. DIV.
DIST. 3

UNITED STATES
DEPARTMENT OF THE INTERIOR
BUREAU OF LAND MANAGEMENT

RECEIVED
BLM MAIL ROOM

APPLICATION FOR PERMIT TO DRILL, DEEPEN, OR PLUG BACK

1a. TYPE OF WORK DRILL <input checked="" type="checkbox"/> DEEPEN <input type="checkbox"/> PLUG BACK <input type="checkbox"/>				5. LEASE DESIGNATION AND SERIAL NO. Jicarilla Contract 459	
b. TYPE OF WELL OIL WELL <input type="checkbox"/> GAS WELL <input checked="" type="checkbox"/> OTHER <input type="checkbox"/>				6. IF INDIAN, ALLOTTEE OR TRIBE NAME Jicarilla Apache Tribe	
2. NAME OF OPERATOR Robert L. Bayless				7. UNIT AGREEMENT NAME AREA	
3. ADDRESS OF OPERATOR P.O. Box 168, Farmington, NM 87499				8. FARM OR LEASE NAME Jicarilla 459	
4. LOCATION OF WELL (Report location clearly and in accordance with any State requirements.) At surface 1658' FNL & 1901' FEL At proposed prod. zone same				9. WELL NO. 3	
14. DISTANCE IN MILES AND DIRECTION FROM NEAREST TOWN OR POST OFFICE*				10. FIELD AND POOL, OR WILDCAT EAST BLANCO PC Wildcat	
15. DISTANCE FROM PROPOSED* LOCATION TO NEAREST PROPERTY OR LEASE LINE, FT. (Also to nearest drlg. unit line, if any)		16. NO. OF ACRES IN LEASE Approx. 2267 irregular sections		17. NO. OF ACRES ASSIGNED TO THIS WELL 160	
18. DISTANCE FROM PROPOSED LOCATION* TO NEAREST WELL, DRILLING, COMPLETED, OR APPLIED FOR, ON THIS LEASE, FT.		19. PROPOSED DEPTH 4015'		20. ROTARY OR CABLE TOOLS 0 - TD	
21. ELEVATIONS (Show whether DF, RT, GR, etc.) 7034' GL 7046' RKB				22. APPROX. DATE WORK WILL START* ASAP	
23. PROPOSED CASING AND CEMENTING PROGRAM					
SIZE OF HOLE	SIZE OF CASING	WEIGHT PER FOOT	SETTING DEPTH	QUANTITY OF CEMENT	
9-7/8"	7-5/8"	26.4#	125'	60 sx Class B - 71 ft	
6-3/4"	4-1/2"	11.6#	4015'	200 sx 50/50 pozmix - 252 ft	

Will drill hole to 125' and set 125 ft. of 7-5/8" 26.4#/ft J-55 casing, cementing with 71 ft Class B cement, circulated to surface. Will drill 6-3/4" hole to 4015' and run 4015' of 4-1/2" 11.6#/ft J-55 casing and cement with 252 ft 50/50 pozmix with 2% gel and 10% salt. Circulating medium will be clear water, natural mud and water loss control additives. No abnormal pressures or temperatures are anticipated. Will run Induction and Density Logs. Blowout preventer schematic is attached. The gas from this formation is not dedicated to a gas contract.

ESTIMATED TOPS: Ojo Alamo - 3071'
Kirtland - 3299'
Fruitland - 3319'
Pictured Cliffs - 3609'
Lower P.C. - 3858'
Total Depth - 4015'

IN ABOVE SPACE DESCRIBE PROPOSED PROGRAM: If proposal is to deepen or plug back, give data on present productive zone and proposed new productive zone. If proposal is to drill or deepen directionally, give pertinent data on subsurface locations and measured and true vertical depths. Give blowout preventer program, if any.

24. SIGNED Price M. Bayless TITLE Engineer DATE 7/18/88

(This space for Federal or State office use)

PERMIT NO. _____ APPROVAL DATE _____

APPROVED BY _____ TITLE _____ DATE _____
CONDITIONS OF APPROVAL, IF ANY:

NSL-2575

NMOCC

*See Instructions On Reverse Side

All distances must be from the outer boundaries of the Section.

Operator Robert L. Bayless		Lease Jicarilla 459		Well No. 3
Unit Letter G	Section 18	Township 30 N	Range 3 W	County Rio Arriba
Actual Footage Location of Well: 1658 feet from the North line and 1901 feet from the East line				
Ground Level Elev. 7034	Producing Formation Pictured Cliffs	Pool EAST BLANCO Undesignated Pictured Cliffs		Dedicated Acreage: 160 Acres

1. Outline the acreage dedicated to the subject well by colored pencil or hachure marks on the plat below.
2. If more than one lease is dedicated to the well, outline each and identify the ownership thereof (both as to working interest and royalty).
3. If more than one lease of different ownership is dedicated to the well, have the interests of all owners been consolidated by communitization, unitization, force-pooling, etc?

☐ Yes ☐ No If answer is "yes," type of consolidation _____

If answer is "no," list the owners and tract descriptions which have actually been consolidated. (Use reverse side of this form if necessary.) _____

No allowable will be assigned to the well until all interests have been consolidated (by communitization, unitization, forced-pooling, or otherwise) or until a non-standard unit, eliminating such interests, has been approved by the Division

CERTIFICATION

I hereby certify that the information contained herein is true and complete to the best of my knowledge and belief.

Name

Price M. Bayless

Position

Engineer

Company

Robert L. Bayless

Date

7/18/88

I hereby certify that the well location shown on this plat was plotted from field notes of actual surveys made by me or under my supervision, and that the same is true and correct to the best of my knowledge and belief.

7/12/88

Date Surveyed

Roy A. Rush

Registered Professional Engineer
and/or Land Surveyor

8894

Certificate No.

