



**Chevron U.S.A. Inc.**  
P.O. Box 670, Hobbs, NM 88240

R. C. Anderson  
Division Manager  
Production Department  
Hobbs Division

November 17, 1988

PROPOSED INFILL WELLS  
EUNICE MONUMENT SOUTH UNIT  
WELL NO.S 620 AND 643  
LEA COUNTY, NEW MEXICO

New Mexico Oil Conservation Division  
310 Old Santa Fe Trail, Room 206  
Santa Fe, New Mexico 87503

Attention: William J. LeMay, Director

Gentlemen:

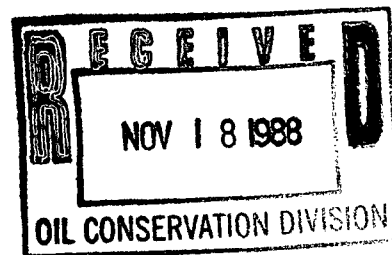

The Hobbs Division of Chevron U.S.A. Inc. respectfully requests your administrative approval for unorthodox locations for the subject proposed infill producing wells. We further request that you waive the 20 day waiting period requirement of Rule 104 (F)(IV) since the subject proration units of the unorthodox locations are surrounded by proration units operated by Chevron.

The proposed locations for these Eunice Monument South Unit infill producing wells, as shown on the attached map and plats, will be in an existing approved waterflood project, Order No. R-7766 (copy enclosed). These locations will also meet the spacing requirements of Rule 104 (F)(I) which states that a well will be no closer than 330 feet to the outer boundary of the unitized area, and no closer than 10 feet to any quarter-quarter section line. The basis for these two unorthodox infill producing locations is a test to determine if the currently established pattern in this portion of the Eunice Monument South Unit is the most efficient production and injection pattern.

Chevron has notified all Working Interest Owners in the Eunice Monument South Unit and to date has received 79% WIO approval on AFE's for these proposed infill wells thereby satisfying Unit Operating Agreement requirements. Also, all directly offsetting Unit and non-Unit wells and their respective proration units to the proposed infill wells are operated by Chevron.

Based upon the foregoing information, Chevron requests your administrative approval of the attached applications for permits to drill these two subject infill wells at their unorthodox

locations to test the efficiency of the present producing and injection pattern. To enable Chevron to drill these proposed infill wells this year, we are further requesting that the Oil Conservation Division waive the 20 day waiting requirement in granting these administrative applications.

For further information regarding this matter, please contact A. W. Bohling or J. D. Crawford at (505) 393-4121. Your prompt consideration will be greatly appreciated.

Yours very truly,



R. C. ANDERSON

JDC/AWB/cjw

Attachments

cc: Oil Conservation Division  
District 1  
P.O. Box 1980  
Hobbs, New Mexico 88240  
Attn: Mr. Jerry T. Sexton

Kellahin, Kellahin and Aubrey  
Attorneys at Law  
P.O. Box 2265  
Santa Fe, New Mexico 87504-2265  
Attn: Mr. Tom Kellahin

WELL HISTORY FOR EMSU # 253, CLOSEST UNIT OFFSET TO EMSU # 643.

LOCATION: 660' FSL, 660' FEL, SEC 6, T 21 S, R 36 E, LEA CTY, NM.

SPUD DATE: 10-9-35.

SFC CSG: 10 3/4" 40# @ 318' W/ 250 SX. CALC TOC @ SFC.

INT CSG: 7 5/8" 26# @ 2753' W/ 550 SX. CALC TOC @ SFC.

PROD CSG: 5 1/2" 17# @ 3761' W/ 25 SX. CALC TOC @ 3300'.

TD: 3895' PBTD: 3895'

COMPLETION: 3761'~ 3895', GRAYBURG.

PRODUCTION: INITIAL-F 511 BOPD, 0 BWPD, 1500 MCFGPD.  
PRIOR TO INJ-P 55 BOPD, 4 BWPD, 2 MCFGPD.

INJECTION: STARTED INJ 711 BWPD @ VAC 8-8-88 INTO GRAYBURG 3761'~ 4043'.

WELL HISTORY FOR EMSU # 247, CLOSEST UNIT OFFSET TO PROPOSED EMSU # 620.

LOCATION: 1980' FSL, 2120' FEL, SEC 6, T 21 S, R 36 E, LEA CTY, NM.

SPUD DATE: 2-13-86.

SFC CSG: 11 3/4" 42# @ 348' W/ 325 SX. CIRC'D TO SFC.

INT CSG: 8 5/8" 24/32# @ 2632' W/ 625 SX. CIRC'D TO SFC.

PROD CSG: 5 1/2" 15.5# @ 4155' W/ 525 SX. CIRC'D TO SFC.

TD: 4171' PBTD: 4103'

COMPLETION: 44 PERFS, 1 JHPF, BETWEEN 3700'~ 3966', PENROSE AND GRAYBURG.

PRODUCTION: INITIAL- P 12 BOPD, 16 BWPD, 135 MCFGPD.  
PRIOR TO INJ- P 11 BOPD, 120 BWPD, 109 MCFGPD.

INJECTION: STARTED INJ 720 BWPD @ VAC 9-23-87 INTO PENROSE/GRAYBURG  
3700'~3966'.

WELL HISTORY FOR GRAHAM STATE NCT-E # 2, OFFSET TO PROPOSED EMSU # 620  
AND EMSU # 643, PRODUCING FROM EUMONT YATES SEVEN RIVERS QUEEN GAS.

LOCATION: 1980' FSL, 1980' FEL, SEC 6, T 21 S, R 36 E, LEA CTY, NM.

SPUD DATE: 8-12-36.

SFC CSG: 16" 70# @ 31' W/ 60 SX. TOC @ SFC.

INT CSG: 7 5/8" 22# @ 1213' W/ 650 SX. CIRC'D TO SFC.

PROD CSG: 5 1/2" 17# @ 3749' W/ 300 SX. CALC TOC @ SFC.

TD: 3885' PBTD: 3650'

COMPLETION: 3405'-3595', YATES SEVEN RIVERS QUEEN.

PRODUCTION: INITIAL- F CAO 6500 MCFGPD.  
CURRENT- F 475 MCFGPD.

STATE OF NEW MEXICO  
DEPARTMENT OF ENERGY AND MINERALS  
OIL CONSERVATION COMMISSION

IN THE MATTER OF THE HEARING  
CALLED BY THE OIL CONSERVATION  
COMMISSION FOR THE PURPOSE OF  
CONSIDERING:

CASE No. 8398  
Order No. R-7766

APPLICATION OF GULF OIL CORPORATION  
FOR A WATERFLOOD PROJECT, LEA  
COUNTY, NEW MEXICO.

ORDER OF THE COMMISSION

BY THE COMMISSION:

This case came on for hearing at 9:00 A.M. on November 7, 1984, at Santa Fe, New Mexico, before the Oil Conservation Commission of New Mexico, hereinafter referred to as the "Commission".

NOW, on this 27th day of December, 1984, the Commission, a quorum having been present, having considered the testimony and the record and being otherwise fully advised in the premises,

FINDS THAT:

(1) Due public notice has been given as required by law, the Commission has jurisdiction of this cause and the subject matter thereof.

(2) The applicant, Gulf Oil Corporation, in Commission Case 8398, seeks authority to institute a waterflood project in its Eunice Monument South Unit, by the injection of water into the unitized interval which shall include the formations which extend from an upper limit of 100 feet below mean sea level or the top of the Grayburg formation, whichever is higher, to a lower limit being the base of the San Andres formation in the proposed unitized area, all as shown on Exhibit "A" attached to this order.

(3) The subject Commission Case 8398 was consolidated for hearing with Commission Cases 8397 and 8399.

(4) Gulf proposes to utilize an 80-acre five spot injection pattern using a well number system and proposed

Unit injection wells all as shown and identified on Exhibit "B" attached hereto.

(5) Said injection wells shall be conversions of existing wells or newly drilled wells as noted on said Exhibit "B".

(6) The proposed waterflood project should result in the recovery of otherwise unrecoverable oil, thereby preventing waste.

(7) The producing formations in the proposed project area are in an advanced stage of depletion and the area is suitable for waterflooding.

(8) There are five wells within or adjacent to the proposed project which may not have been completed or plugged in a manner which will assure that their wellbores will not serve as a conduit for movement of injected fluid out of the injection interval.

(9) The five possible problem wells are identified and described on Exhibit "C" attached hereto.

(10) Prior to instituting injection within one-half mile of any of the five possible "problem wells" Gulf shall first contact the Oil Conservation Division's District Supervisor at Hobbs to develop a plan acceptable to the Director of said Division for repairing or replugging such wells, for monitoring for determination of fluid movement from the injected interval, or for the drilling of replacement producing wells to lower reservoir pressure and fluid levels in order to protect neighboring properties and to protect other oil or gas zones or fresh water.

(11) The operator should otherwise take all steps necessary to ensure that the injected water enters only the proposed injection interval and is not permitted to escape to other formations or onto the surface from injection, production, or plugged and abandoned wells.

(12) The injection wells or injection pressurization system should be so equipped as to limit injection pressure at the wellhead to no more than 0.2 psi per foot of depth from the surface to the top injection perforation in any injection well, but the Division Director should have authority to increase said pressure limitation, should circumstances warrant.

(13) The subject application should be approved and the project should be governed by the provisions of Rule 701 through 708 of the Commission Rules and Regulations.

IT IS THEREFORE ORDERED THAT:

(1) The applicant, Gulf Oil Corporation, is hereby authorized to institute a waterflood project in the Eunice Monument South Unit Area for the acreage described on Exhibit "A" attached hereto and made a part hereof, by the injection of water into the unitized interval which shall include the formations which extend from an upper limit described as 100 feet below mean sea level or at the top of the Grayburg formation, whichever is higher, to a lower limit being the base of the San Andres formation said geologic markers having been as found to occur at 3,666 feet to 5,283 feet, respectively, in the Continental Oil Company's Meyer B-4 Well No. 23 located 660 feet from the South line and 1980 feet from the East line of Section 4, Township 21 South, Range 36 East, Lea County, New Mexico.

(2) Applicant, Gulf Oil Corporation, is hereby authorized to utilize for injection purposes the wells identified and described on Exhibit "B" attached hereto and made a part hereof.

(3) The injection wells herein authorized and/or the injection pressurization system shall be so equipped as to limit injection pressure at the wellhead to no more than 0.2 psi per foot of depth from the surface to the top injection perforation, provided however, the Division Director may authorize a higher surface injection pressure upon satisfactory showing that such pressure will not result in fracturing of the confining strata.

(4) Injection into each of said wells shall be through plastic or cement-lined tubing, set in a packer which shall be located as near as practicable to the uppermost perforations, or, in the case of open-hole completions, as near as practicable to the casing-shoe; that the casing-tubing annulus shall be loaded with an inert fluid and equipped with an approved pressure gauge or attention attracting leak detection device.

(5) Prior to injection into any well located within one-half mile of any of the five wells listed on Exhibit "C" attached to this order, the applicant shall consult with the supervisor of the Oil Conservation Division's district office at Hobbs to develop a plan acceptable to

the Director of said Division, for the repairing, plugging, or replugging of said wells or for the monitoring for determination of fluid movement from the injected interval or for the drilling of producing wells to lower reservoir pressure and fluid levels in the vicinity of said wells in order to protect neighboring properties and to protect other oil or gas zones or fresh water.

(6) The operator shall immediately notify the supervisor of the Division's Hobbs District Office of the failure of the tubing or packer in any of said injection wells, the leakage of water or oil from around any producing well, or the leakage of water or oil from any plugged and abandoned well within the project area, and shall take such timely steps as may be necessary or required to correct such failure or leakage.

(7) The authorized subject waterflood project is hereby designated the Eunice Monument South Unit Waterflood Project and shall be governed by the provisions of Rules 701 through 708 of the Commission Rules and Regulations.

(8) Monthly progress reports of the waterflood projects herein authorized shall be submitted to the Commission in accordance with Rules 704 and 1120 of the Commission Rules and Regulations.

(9) Jurisdiction of this cause is retained for the entry of such further orders as the Commission may deem necessary.



-5-

Case No. 8398

Order No. R-7766

DONE at Santa Fe, New Mexico, on the day and year  
hereinabove designated.

STATE OF NEW MEXICO  
OIL CONSERVATION DIVISION

JIM BACA, Member

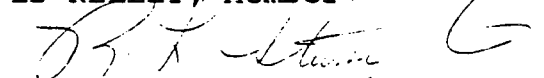
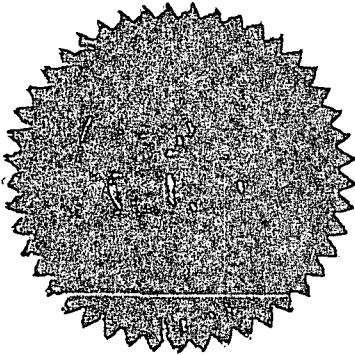

ED KELLEY, Member

  
R. L. STAMETS, Chairman and  
Secretary

S E A L

LEA COUNTY, NEW MEXICO

TOWNSHIP 20 SOUTH, RANGE 36 EAST, NMPM

Section 25: All

Section 36: All

TOWNSHIP 20 SOUTH, RANGE 37 EAST, NMPM

Section 30: S/2, S/2 N/2, NE/4 NW/4 and NW/4 NE/4

Section 31: All

Section 32: All

TOWNSHIP 21 SOUTH, RANGE 36 EAST, NMPM

Section 2: S/2 S/2

Section 3: Lots 3, 4, 5, 6, 11, 12, 13, and 14  
and S/2

Sections 4 through 11: All

Section 12: W/2 SW/4

Section 13: NW/4 NW/4

Sections 14 through 18: All

Section 21: N/2 and N/2 S/2

Section 22: N/2 and N/2 S/2

CASE NO. 8398  
ORDER NO. R-7766  
EXHIBIT "A"

LEA COUNTY, NEW MEXICO

UNIT WELL NO.	UNIT LETTER	SECTION-TOWNSHIP-RANGE		NEW WELL
			SOUTH EAST	
101	C	30	20 37	N
102	A	25	20 36	
104	C	25	20 36	
106	E	25	20 36	
108	G	25	20 36	
110	E	30	20 37	
112	G	30	20 37	
114	I	30	20 37	
116	K	30	20 37	
118	I	25	20 36	
120	K	25	20 36	
122	M	25	20 36	
124	O	25	20 36	
126	M	30	20 37	
128	O	30	20 37	
130	A	32	20 37	N
132	C	32	20 37	
134	A	31	20 37	
136	C	31	20 37	
138	A	36	20 36	
140	C	36	20 36	
142	E	36	20 36	
144	G	36	20 36	
146	E	31	20 37	
148	G	31	20 37	
150	E	32	20 37	
152	G	32	20 37	
154	I	32	20 37	N
156	K	32	20 37	
158	I	31	20 37	
160	K	31	20 37	
162	I	36	20 36	
164	K	36	20 36	
166	M	36	20 36	
168	O	36	20 36	
170	M	31	20 37	
172	O	31	20 37	
174	M	32	20 37	
176	O	32	20 37	

CASE NO. 8398  
ORDER NO. R-7766  
EXHIBIT "B"

LEA COUNTY, NEW MEXICO

179	D	3	21	36
181	B	4	21	36
183	D	4	21	36
185	B	5	21	36
187	D	5	21	36
189	B	6	21	36
191	D	6	21	36
193	F	6	21	36
195	H	6	21	36
197	F	5	21	36
199	H	5	21	36
201	F	4	21	36
203	H	4	21	36
205	F	3	21	36
207	L	3	21	36
209	J	4	21	36
211	L	4	21	36
213	J	5	21	36
215	L	5	21	36
217	J	6	21	36
219	L	6	21	36
221	N	6	21	36
223	P	6	21	36
225	N	5	21	36
227	P	5	21	36
229	N	4	21	36
231	P	4	21	36
233	N	3	21	36
235	R	3	21	36
237	T	3	21	36
239	R	4	21	36
241	T	4	21	36
→ 243	R	5	21	36
245	T	5	21	36
247	R	6	21	36

N

N

N

CASE NO. 8398  
ORDER NO. R-7766  
EXHIBIT "B"

LEA COUNTY, NEW MEXICO

249	T	6	21	36
251	V	6	21	36
253	X	6	21	36
255	V	5	21	36
257	X	5	21	36
259	V	4	21	36
261	X	4	21	36
263	V	3	21	36
265	X	3	21	36
267	V	2	21	36
269	X	2	21	36
271	B	11	21	36
273	D	11	21	36
275	B	10	21	36
277	D	10	21	36
279	B	9	21	36
281	D	9	21	36
283	B	8	21	36
285	D	8	21	36
287	B	7	21	36
289	D	7	21	36
291	F	7	21	36
293	H	7	21	36
295	F	8	21	36
297	H	8	21	36
299	F	9	21	36
301	H	9	21	36
303	F	10	21	36
305	H	10	21	36
307	F	11	21	36
309	H	11	21	36
310	L	12	21	36
312	J	11	21	36
314	L	11	21	36
316	J	10	21	36
318	L	10	21	36
320	J	9	21	36
322	L	9	21	36
324	J	8	21	36

CASE NO. 8398  
ORDER NO. R-7766  
EXHIBIT "B"

LEA COUNTY, NEW MEXICO

325	L	8	21	36
328	J	7	21	36
330	L	7	21	36
332	N	7	21	36
334	P	7	21	36
336	N	8	21	36
338	P	8	21	36
340	N	9	21	36
342	P	9	21	36
344	N	10	21	36
346	P	10	21	36
348	N	11	21	36
350	P	11	21	36
352	D	13	21	36
354	B	14	21	36
356	D	14	21	36
358	B	15	21	36
360	D	15	21	36
362	B	16	21	36
364	D	16	21	36
366	B	17	21	36
368	D	17	21	36
370	B	18	21	36
372	D	18	21	36
374	F	18	21	36
376	H	18	21	36
378	F	17	21	36
380	H	17	21	36
382	F	16	21	36
384	H	16	21	36
386	F	15	21	36
388	H	15	21	36
390	F	14	21	36
392	H	14	21	36
394	J	14	21	36
396	L	14	21	36
398	J	15	21	36
400	L	15	21	36
402	J	16	21	36
404	L	16	21	36

CASE NO. 8398  
ORDER NO. R-7766  
EXHIBIT "B"

N

LEA COUNTY, NEW MEXICO

406	J	17	21	36
408	L	17	21	36
410	J	18	21	36
412	L	18	21	36
414	N	18	21	36
416	P	18	21	36
418	N	17	21	36
420	P	17	21	36
422	N	16	21	36
424	P	16	21	36
426	N	15	21	36
428	P	15	21	36
430	N	14	21	36
432	P	14	21	36
434	B	22	21	36
436	D	22	21	36
438	B	21	21	36
440	D	21	21	36
442	F	21	21	36
444	H	21	21	36
446	F	22	21	36
448	H	22	21	36
450	J	22	21	36
454	J	21	21	36
456	L	21	21	36
452	L	22	21	36

CASE 8398  
ORDER NO. R-8398  
EXHIBIT "B"

- (1) Amoco Production Co. State "C" Tr. 11 Well No. 3  
located 1980 feet from the South line and 1980 feet from  
the East line of Section 2, Township 21 South, Range 36  
East;
- (2) Amoco Production Co. State "C" Tr. 11 Well No. 4  
located 3300 feet from the South line and 1980 feet from  
the East line of Section 2, Township 21 South, Range 36  
East;
- (3) Texas Crude Oil Co. Kincheloe 2 State Well No. 1  
located 1980 feet from the South line and 1980 feet from  
the West line of Section 2, Township 21 South, Range 36  
East;
- (4) El Paso Natural Gas Co. Coleman Well No. 1  
located 2310 feet from the South line and 2310 feet from  
the East line of Section 17, Township 21 South, Range 36  
East;
- (5) Texaco Inc. New Mexico "H" NCT-1 Well No. 28, a dry  
hole, located 990 feet from the South line and 660  
feet from the East line of Section 31, Township 20 South,  
Range 37 East;

all in Lea County, New Mexico. in Lea County, New Mexico.

CASE NO. 8398  
Order No. R-7766  
EXHIBIT "C"



NO. OF COPIES RECEIVED		
DISTRIBUTION		
SANTA FE		
FILE		
U.S.G.S.		
LAND OFFICE		
OPERATOR		

# NEW MEXICO OIL CONSERVATION COMMISSION

Form C-101  
Revised 1-1-65

5A. Indicate Type of Lease	
STATE <input checked="" type="checkbox"/>	FEE <input type="checkbox"/>
5. State Oil & Gas Lease No.	

## APPLICATION FOR PERMIT TO DRILL, DEEPEN, OR PLUG BACK

1a. Type of Work		7. Unit Agreement Name	
b. Type of Well OIL WELL <input checked="" type="checkbox"/> GAS WELL <input type="checkbox"/> OTHER <input type="checkbox"/>		Eunice Monument South Un	
DRILL <input checked="" type="checkbox"/> DEEPEN <input type="checkbox"/> PLUG BACK <input type="checkbox"/>		8. Farm or Lease Name	
2. Name of Operator Chevron U.S.A. Inc.		9. Well No. 620	
3. Address of Operator P.O. Box 670, Hobbs, NM 88240		10. Field and Pool, or Wildcat Grayburg	
4. Location of Well UNIT LETTER <u>R</u> LOCATED <u>2630</u> FEET FROM THE <u>South</u> LINE AND <u>1330</u> FEET FROM THE <u>East</u> LINE OF SEC. <u>6</u> TWP. <u>21S</u> RGE. <u>36E</u> NMPM		12. County Lea	
19. Proposed Depth 4050		19A. Formation Grayburg	
20. Rotary or C.T. rotary		21. Elevations (Show whether DF, RT, etc.) 3569.4	
21A. Kind & Status Plug. Bond Blanket		21B. Drilling Contractor NYK	
22. Approx. Date Work will start ASAP			

23.

## PROPOSED CASING AND CEMENT PROGRAM

SIZE OF HOLE	SIZE OF CASING	WEIGHT PER FOOT	SETTING DEPTH	SACKS OF CEMENT	EST. TOP
12 1/4"	8 5/8"	24#	1165	750	circ.
7 7/8"	5 1/2"	15.5#	4050	700	circ

## MUD PROGRAM:

0' - 1165' FW Spud  
1165' - 4050' BW, Starch, 10ppg, 3lvis, 9ph.

See attached BOP drawing for 3000psi working pressure.

IN ABOVE SPACE DESCRIBE PROPOSED PROGRAM: IF PROPOSAL IS TO DEEPEN OR PLUG BACK, GIVE DATA ON PRESENT PRODUCTIVE ZONE AND PROPOSED NEW PRODUCTIVE ZONE. GIVE BLOWOUT PREVENTER PROGRAM, IF ANY.

I hereby certify that the information above is true and complete to the best of my knowledge and belief.

Signed J. H. Smith for MEA Title Staff Drilling Engineer Date Nov. 17, 1988

(This space for State Use)

APPROVED BY \_\_\_\_\_ TITLE \_\_\_\_\_ DATE \_\_\_\_\_

CONDITIONS OF APPROVAL, IF ANY:

**NEW MEXICO OIL CONSERVATION COMMISSION  
WELL LOCATION AND ACREAGE DEDICATION PLAT**

Form C-102  
Supersedes C-128  
Effective 1-1-65

All distances must be from the outer boundaries of the Section

Operator <b>Chevron U.S.A., Inc.</b>			Lease <b>EMSU</b>		Well No. <b>620</b>
Unit Letter <b>R</b>	Section <b>6</b>	Township <b>21 South</b>	Range <b>36 East</b>	County <b>Lea</b>	
Actual Footage Location of Well: <b>2530</b> feet from the <b>south</b> line and <b>1330</b> feet from the <b>east</b> line					
Ground Level Elev. <b>3569.4</b>	Producing Formation <b>Grayburg</b>		Pool <b>Grayburg</b>	Dedicated Acreage: <b>20</b> Acres	

1. Outline the acreage dedicated to the subject well by colored pencil or hatchure marks on the plat below.
2. If more than one lease is dedicated to the well, outline each and identify the ownership thereof (both as to working interest and royalty).
3. If more than one lease of different ownership is dedicated to the well, have the interests of all owners been consolidated by communitization, unitization, force-pooling, etc?

☒ Yes    ☐ No    If answer is "yes," type of consolidation Unitization

If answer is "no," list the owners and tract descriptions which have actually been consolidated. (Use reverse side of this form if necessary.) \_\_\_\_\_

No allowable will be assigned to the well until all interests have been consolidated (by communitization, unitization, forced-pooling, or otherwise) or until a non-standard unit, eliminating such interests, has been approved by the Commission.

	<p align="center"><b>CERTIFICATION</b></p> <p>I hereby certify that the information contained herein is true and complete to the best of my knowledge and belief.</p> <p><i>L. K. Elmore</i> Name <b>L.K. Elmore</b> Position <b>Drilling Technical Asst.</b> Company <b>Chevron U.S.A. Inc.</b> Date <b>11-17-88</b></p> <p>as <b>REGISTERED PROFESSIONAL ENGINEER AND LAND SURVEYOR</b> I hereby certify that the well location shown on this plat was plotted from field notes of actual surveys made by me or under my supervision, and that the same is true and correct to the best of my knowledge and belief.</p> <p>Date Surveyed <b>November 15, 1988</b></p> <p>Registered Professional Engineer and/or Land Surveyor <i>John W. West</i></p> <p>Certificate No. <b>JOHN W. WEST 376</b></p> <p align="right"><b>Ronald J. Eidson 3239</b></p>
--	---



LEASE EMSII #620

**JOHN WEST ENGINEERING  
HOBBS, NEW MEXICO  
(505) 393-3117**



# LOCATION VERIFICATION MAP

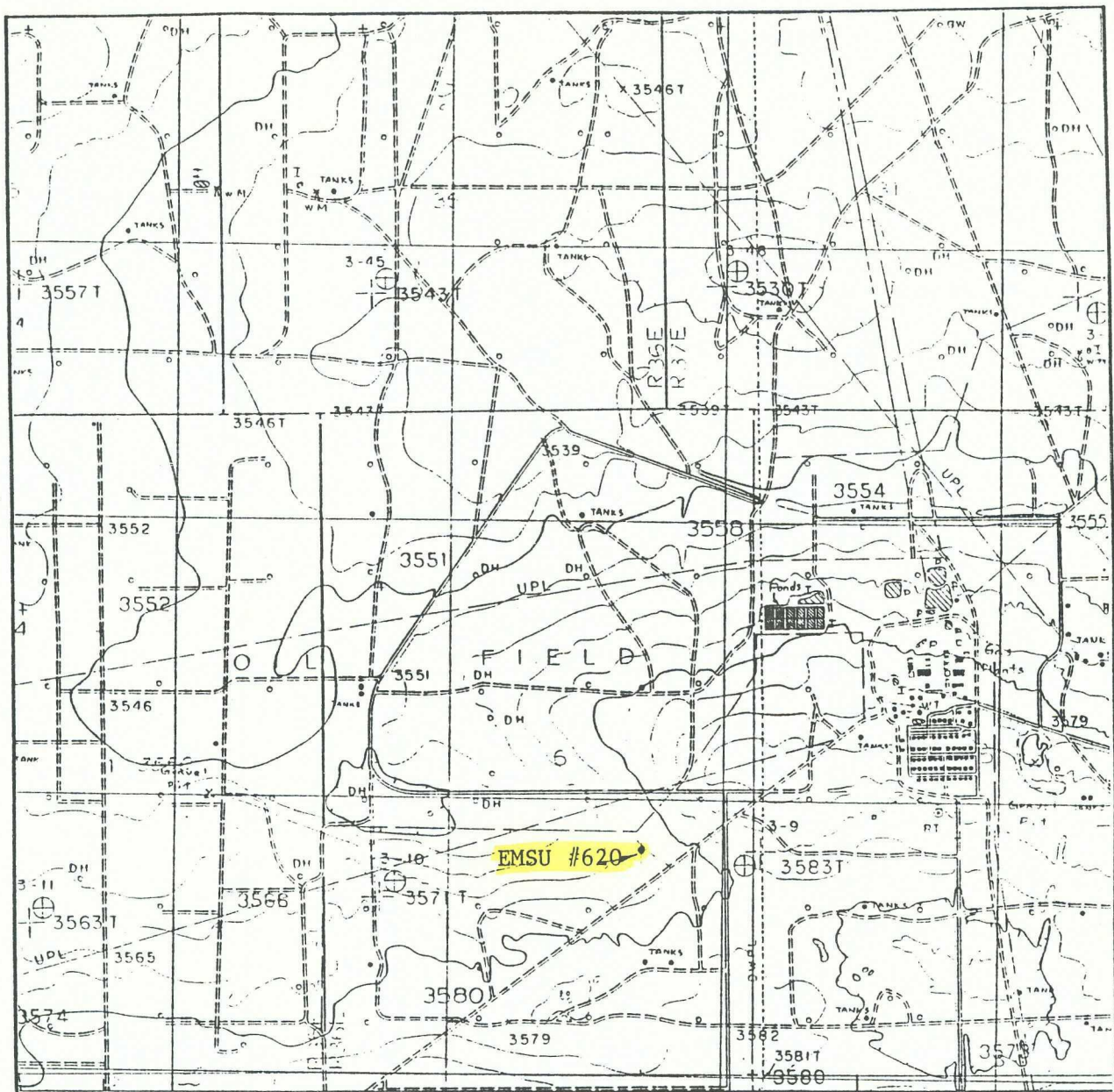

SCALE: 1" = 2000'

CONTOUR INTERVAL 5'

SEC. 6 TWP. 21S RGE. 36E

SURVEY N.M.P.M.

COUNTY Lea STATE NM

DESCRIPTION 2630' FSL & 1330' FEL

ELEVATION 3569.4

OPERATOR Chevron USA, Inc.

LEASE EMSU #620

U.S.G.S. TOPOGRAPHIC MAP  
Monument South, NM

JOHN WEST ENGINEERING  
HOBBS, NEW MEXICO  
(505) 393-3117

# HOBBBS DIVISION CLASS III PREVENTER

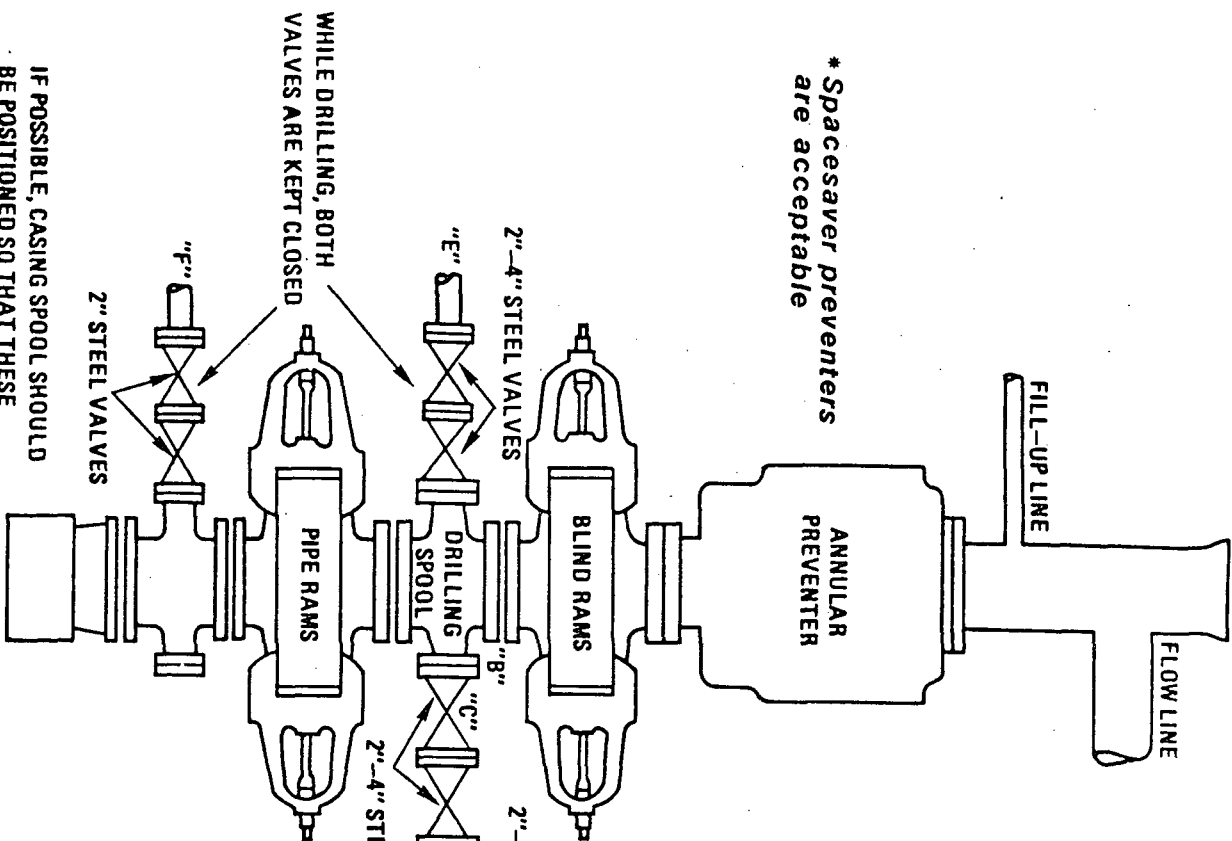
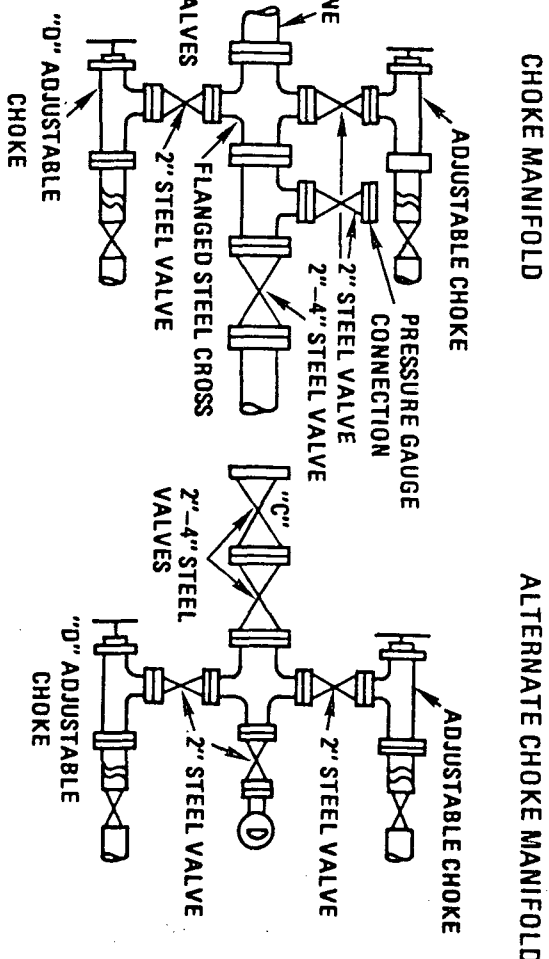

FIGURE III-4  
THREE PREVENTER HOOKUP  
CLASS III

\* Spacesaver preventers  
are acceptable



GENERAL INSTRUCTIONS ON PAGE FOLLOWING FIGURE III-7

— OVER —

The blowout preventer shall be nipped up as needed and a spare set of drill pipe rams shall be on location. The ram preventers may be two singles or a double type. If full opening flanged outlets are on the side of the rams, then they may be used for connecting the choke line (4") and the kill line (2"). A set of spare flange bolts and nuts will be on location at all times for all flanges used.

The substructure height shall be sufficient to install a rotating blowout preventer.

The accumulator shall be equipped with two pumps. One shall be powered with air, the other will be powered with electricity. Each pump shall be capable of fluid charging the total accumulator from precharge pressure to rated pressure within 2 minutes. The minimum nitrogen precharge pressure shall be 750 psi. The pressurized fluid volume stored in the accumulators shall be sufficient to close all pressure operated devices simultaneously within 19 seconds, after closure, the remaining accumulator pressure shall be not less than 1500 psi with the remaining accumulator fluid volume at least 50 percent of the original.

A remote closing manifold located on the rig floor shall be operational. The closing manifold and remote shall have a separate control for each pressure-operated device. Controls are to be labeled as to device and opened or closed. All controls are to be left in the open position when not in use. A pressure reducer and regulator will be provided for operating the annular preventer. All lines from the accumulator to the preventer will be rated to the same pressure rating of the preventer. The accumulator shall be placed away from the rig floor, the distance is specified in MRDC. Hydraulic fluid must meet RP-53 specifications.

The choke manifold and all lines are to be supported by metal stands and securely anchored. The choke flow line, relief lines and choke lines shall be as straight as possible and without sharp turns.

The choke flow line valves and kill line valves and all ram preventers must be equipped with stem extension, universal joints if needed, and hand wheels which extend beyond the edge of the substructure constructed to facilitate easy operation from outside the substructure. All other valves shall be equipped with handles.

