

MERIDIAN OIL

June 5, 1990

Certified Mail

Mr. William LeMay
New Mexico Oil Conservation Division
Post Office Box 2088
Santa Fe, New Mexico 87503

RE: Huerfano Unit #70
890'FNL, 1600'FWL
Section 08, T-26-N, R-10-W
San Juan County, New Mexico

Dear Mr. LeMay:

This is a request for administrative approval for a non-standard gas well location in the Basin Fruitland Pool.

Meridian Oil intends to plugback and recomplete the Huerfano Unit #70 well from the Pictured Cliffs pool to the Basin Fruitland Coal Pool. The current location of this well is 890'FNL, 1600'FWL, Section 08, T-26-N, R-10-W, San Juan County, New Mexico. The well is considered non-standard due to the NE-SW dedicated pattern established for the Basin Fruitland Coal Pool. To comply with the New Mexico Oil Conservation Division rules, Meridian is submitting the following for your approval of this non-standard location:

1. C-102 plat showing location of the well;
2. Plat showing offset owners/operators;
3. Copy of Well Completion Log for original completion.

All surrounding lands are located within the Huerfano Unit boundaries - El Paso Natural Gas Company is the operator of this unit.

Sincerely yours,



Peggy Bradfield
encl.

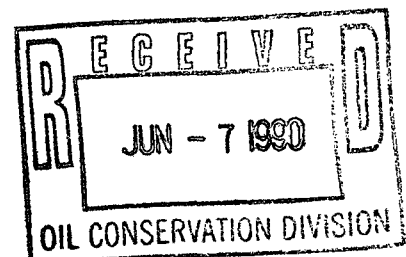

Submit to Appropriate
District Office
State Lease - 4 copies
Fee Lease - 3 copies

State of New Mexico
Energy, Minerals and Natural Resources Department

Form C-102
Revised 1-1-89

OIL CONSERVATION DIVISION

P.O. Box 2088
Santa Fe, New Mexico 87504-2088

DISTRICT I
P.O. Box 1980, Hobbs, NM 88240

DISTRICT II
P.O. Drawer DD, Artesia, NM 88210

DISTRICT III
1000 Rio Brazos Rd., Aztec, NM 87410

WELL LOCATION AND ACREAGE DEDICATION PLAT

All Distances must be from the outer boundaries of the section

Operator El Paso Natural Gas			Lease Huerfano (NM-0433)		Well No. 70
Unit Letter C	Section 8	Township 26 North	Range 10 West	County NMNM	San Juan
Actual Footage Location of Well: 890 feet from the North line and 1600 feet from the West line					
Ground level Elev. 6563'	Producing Formation Fruitland Coal		Pool Basin	Dedicated Acreage: 320 Acres	

- Outline the acreage dedicated to the subject well by colored pencil or hatchure marks on the plat below.
- If more than one lease is dedicated to the well, outline each and identify the ownership thereof (both as to working interest and royalty).
- If more than one lease of different ownership is dedicated to the well, have the interest of all owners been consolidated by communitization, unitization, force-pooling, etc.?
☒ Yes ☐ No If answer is "yes" type of consolidation: unitization
If answer is "no" list the owners and tract descriptions which have actually been consolidated. (Use reverse side of this form if necessary.)
No allowable will be assigned to the well until all interests have been consolidated (by communitization, unitization, force-pooling, or otherwise) or until a non-standard unit, eliminating such interest, has been approved by the Division.

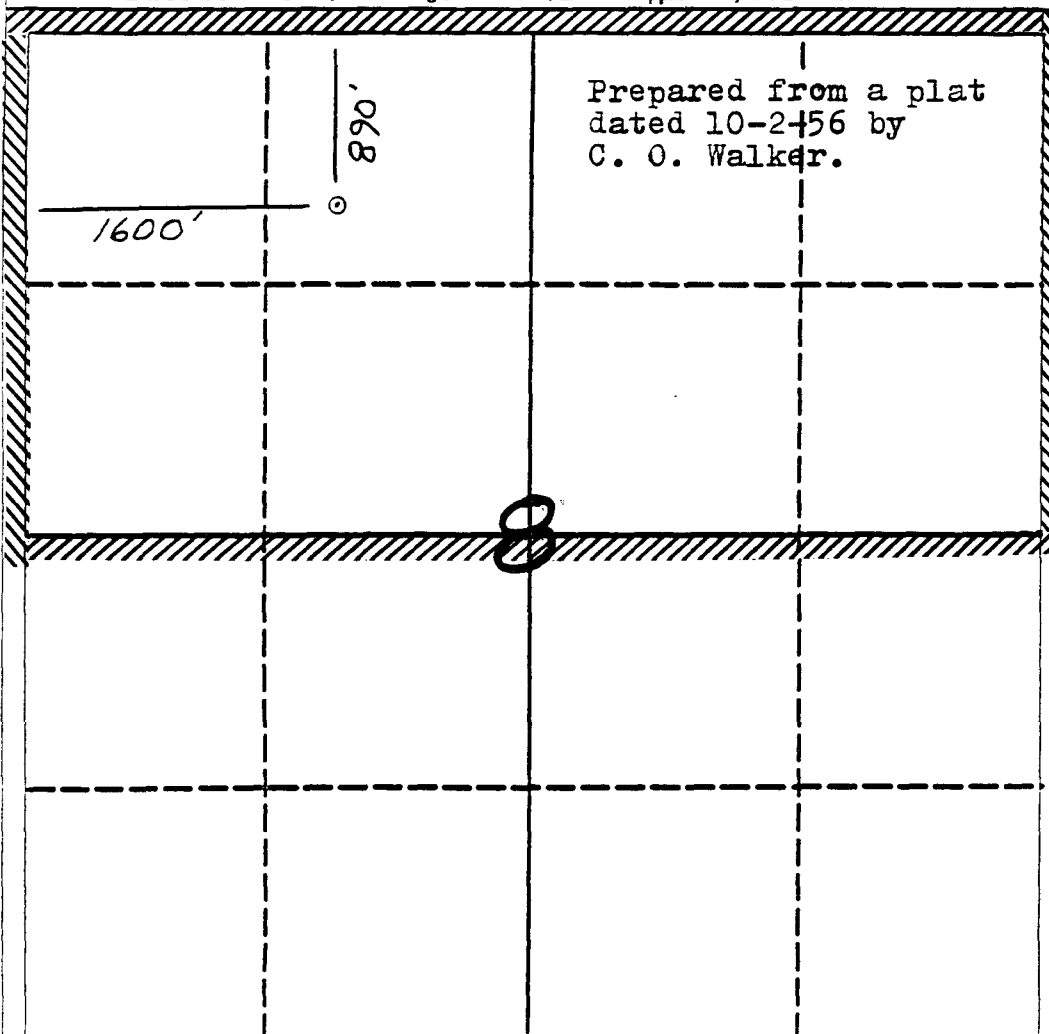

OPERATOR CERTIFICATION

I hereby certify that the information contained herein is true and complete to the best of my knowledge and belief.

Signature
Peggy Bradfield
Printed Name
Regulatory Affairs
Position
El Paso Natural Gas
Company

Date

SURVEYOR CERTIFICATION

I hereby certify that the well location shown on this plat was plotted from field notes of actual surveys made by me or under my supervision, and that the same is true and correct to the best of my knowledge and belief. 5-23-90

Date Surveyed

Signature
Professional Surveyor
NEALE C. EDWARDS
6857
REGISTERED LAND SURVEYOR
Certificate No. 6857
Neale C. Edwards

0 330 660 990 1320 1650 1980 2310 2640 2000 1500 1000 500 0

MERIDIAN OIL INC

Well Name Huerfano #70

Footage 890' FNL; 1600 FWL

APPLICATION FOR NON-STANDARD PRORATION UNIT

County San Juan State New Mexico Section 8 Township 26N Range 10W

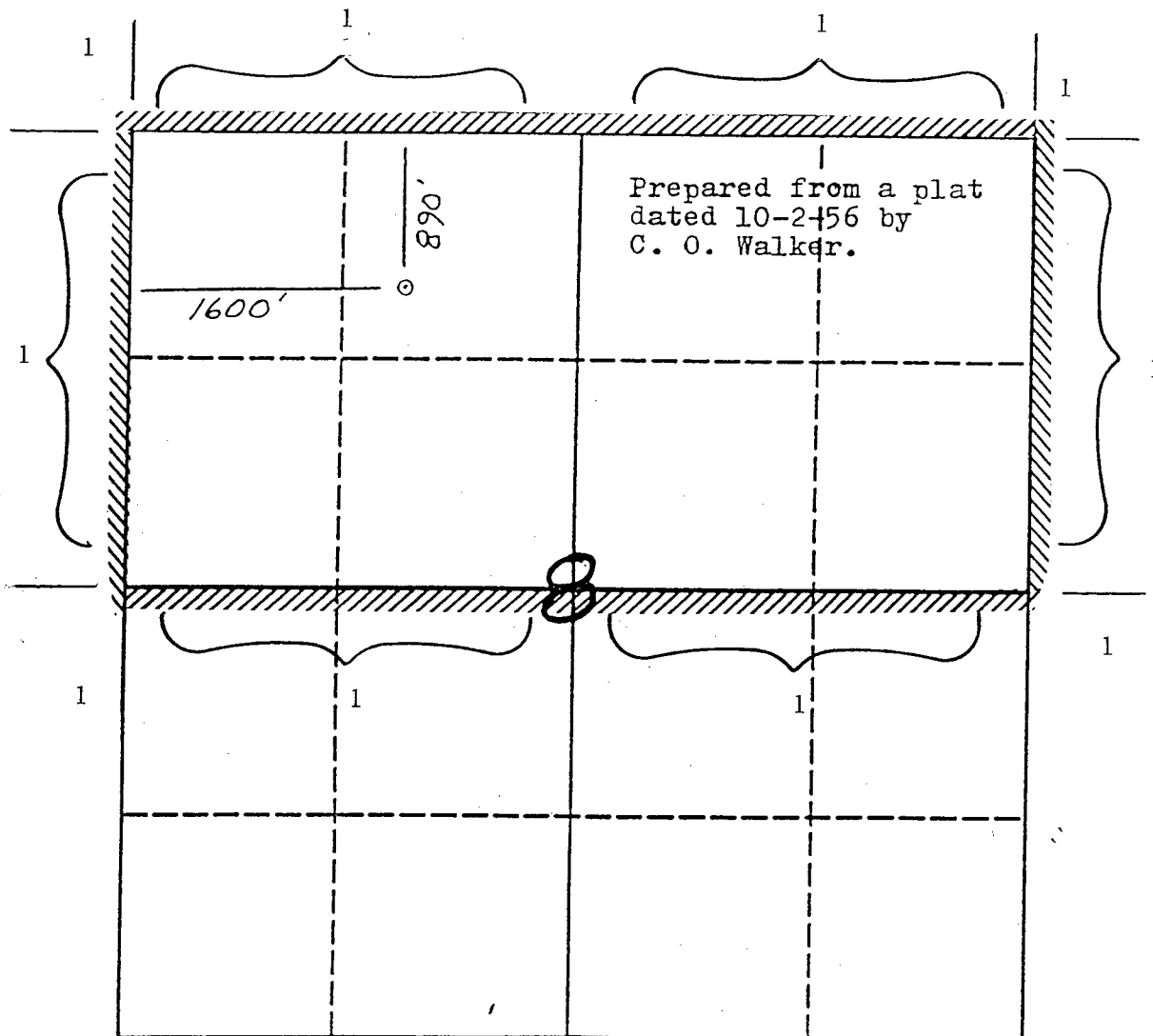

Remarks 1) El Paso Natural Gas Company

U. S. LAND OFFICE New Mexico
 SERIAL NUMBER 0433
 LEASE OR PERMIT TO PROSPECT

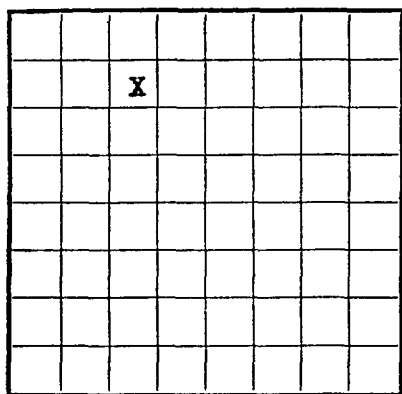

LOCATE WELL CORRECTLY

UNITED STATES
 DEPARTMENT OF THE INTERIOR
 GEOLOGICAL SURVEY

LOG OF OIL OR GAS WELL

Company El Paso Natural Gas Company Address Box 997, Farmington, New Mexico
 Lessor or Tract Huerfano Unit Field W. Kutz State New Mexico
 Well No. 70 Sec. 8 T. 26N R. 10W Meridian NMPM County San Juan
 Location 890 ft. S. of N. Line and 1600 ft. E. of W. Line of Section 8 Elevation 6573'
 (Derrick floor relative to sea level)

The information given herewith is a complete and correct record of the well and all work done thereon so far as can be determined from all available records.

Signed ORIGINAL SIGNED F. W. BOYDDate December 7, 1956Title Petroleum Engineer

The summary on this page is for the condition of the well at above date.

Commenced drilling 11-4-56, 19..... Finished drilling 11-8-56, 19.....

OIL OR GAS SANDS OR ZONES

(Denote gas by G)

No. 1, from 2110 to 2210 (G) No. 4, from to
 No. 2, from to No. 5, from to
 No. 3, from to No. 6, from to

IMPORTANT WATER SANDS

No. 1, from to No. 3, from to
 No. 2, from to No. 4, from to

CASING RECORD									
Size of casing	Weight per foot	Threads per inch	Make	Amount	Kind of shoe	Cut and pulled from	Perforated	Purpose	
							From	To	
8 5/8"	28.50	8 RD	J-55	125'	Howco				Surface
5 1/2"	18.50	8 RD	J-55	225'	Howco				Production
1 3/4"	2.35	8 RD	Grade 5	243'	Howco				Production

MUDDING AND CEMENTING RECORD

Size casing	Where set	Number sacks of cement	Method used	Mud gravity	Amount of mud used
8 5/8"	135'	100	Circulated		
5 1/2"	2215'	150	Single Stage		

PLUGS AND ADAPTERS

Heaving plug—Material Length Depth set
 Adapters—Material Size

SHOOTING RECORD

Size	Shell used	Explosive used	Quantity	Date	Depth shot	Depth cleaned out
------	------------	----------------	----------	------	------------	-------------------

FOLD | MARK