

MERIDIAN OIL

OIL CONSERVATION DIVISION
RECEIVED

August 8, 1990 AUG 9 AM 11 25

Federal Express

Mr. William LeMay
New Mexico Oil Conservation Division
Post Office Box 2088
Santa Fe, New Mexico 87503

RE: Huerfano Unit #238
1840'FSL, 890'FEL
Section 18, T-26-N, R-09-W
San Juan, New Mexico

Dear Mr. LeMay:

This is a request for administrative approval for a non-standard gas well location in the Basin Fruitland Pool.

Meridian Oil intends to plugback and recomplete the Huerfano Unit #238 well from the Pictured Cliffs pool to the Basin Fruitland Coal Pool. The current location of this well is 1840'FSL, 890'FEL, Section 18, T-26-N, R-09-W, San Juan, New Mexico. The well is considered non-standard due to the NE-SW dedicated pattern established for the Basin Fruitland Coal Pool. To comply with the New Mexico Oil Conservation Division rules, Meridian is submitting the following for your approval of this non-standard location:

1. C-102 plat showing location of the well;
2. Plat showing offset owners/operators;
3. Copy of Well Completion Log for original completion.

All surrounding lands are located within the Huerfano Unit boundaries - El Paso Natural Gas Co. is the operator.

Sincerely yours,



Peggy Bradfield
encl.

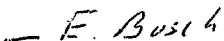

(See other instructions on reverse side)

WELL COMPLETION OR RECOMPLETION REPORT AND LOG *

1a. TYPE OF WELL:		OIL WELL <input type="checkbox"/>		GAS WELL <input checked="" type="checkbox"/>		DRY <input type="checkbox"/>		Other <input type="checkbox"/>		7. UNIT AGREEMENT NAME					
b. TYPE OF COMPLETION:		NEW WELL <input checked="" type="checkbox"/>		WORK OVER <input type="checkbox"/>		DEEP-EN <input type="checkbox"/>		PLUG BACK <input type="checkbox"/>		DIFF. RESVR. <input type="checkbox"/>		Other <input type="checkbox"/>		Huerfano Unit	
2. NAME OF OPERATOR										9. WELL NO.		8. FARM OR LEASE NAME			
El Paso Natural Gas Company										238		Huerfano Unit			
3. ADDRESS OF OPERATOR										10. FIELD AND POOL, OR WILDCAT		11. SEC., T., R., M., OR BLOCK AND SURVEY OR AREA			
PO Box 990, Farmington, NM 87401										Angel Peak Gallup Ext.		Sec. 18, T-26-N, R-9-W			
4. LOCATION OF WELL (Report location clearly and in accordance with any State requirements)*										12. COUNTY OR PARISH		13. STATE			
At surface										San Juan		New Mexico			
1840'S, 890'E															
At top prod. interval reported below															
At total depth															
14. PERMIT NO.										DATE ISSUED					
15. DATE SPUDDED		16. DATE T.D. REACHED		17. DATE COMPL. (Ready to prod.)		18. ELEVATIONS (DF, REB, RT, GR, ETC.)*		19. ELEV. CASINGHEAD							
4-5-73		4-15-73		6-13-73		6469'GL									
20. TOTAL DEPTH, MD & TVD		21. PLUG. BACK T.D., MD & TVD		22. IF MULTIPLE COMPL., HOW MANY*		23. INTERVALS, DRILLED BY		ROTARY TOOLS		CABLE TOOLS					
5995'		5978'				→		0-5995'							
24. PRODUCING INTERVAL(S), OF THIS COMPLETION—TOP, BOTTOM, NAME (MD AND TVD)*										25. WAS DIRECTIONAL SURVEY MADE					
5638-5928'(Gallup)										no					
26. TYPE ELECTRIC AND OTHER LOGS RUN										27. WAS WELL CORED					
IEL; CDL-GR; Temp. Survey										no					
28. CASING RECORD (Report all strings set in well)															
CASING SIZE		WEIGHT, LB./FT.		DEPTH SET (MD)		HOLE SIZE		CEMENTING RECORD		AMOUNT PULLED					
8 5/8"		24.0#		232'		12 1/4"		182 cu. ft.							
4 1/2"		10.5#		5995'		7 7/8"		1146 cu. ft.							
29. LINER RECORD															
SIZE		TOP (MD)		BOTTOM (MD)		SACKS CEMENT*		SCREEN (MD)							
30. TUBING RECORD															
SIZE		DEPTH SET (MD)		PACKER SET (MD)											
2 3/8"		5936'													
31. PERFORATION RECORD (Interval, size and number)															
5638-50', 5702-14', 5752-64', 5816-28', 5846-54', 5920-28' with 2 shots per zone.															
32. ACID, SHOT, FRACTURE, CEMENT SQUEEZE, ETC.															
DEPTH INTERVAL (MD)						AMOUNT AND KIND OF MATERIAL USED									
5638-5928'						64,000#sand; 33,800 gal. water									
33.* PRODUCTION															
DATE FIRST PRODUCTION		PRODUCTION METHOD (Flowing, gas lift, pumping—size and type of pump)						WELL STATUS (Producing or shut-in)							
		flowing						shut in							
DATE OF TEST		HOURS TESTED		CHOKE SIZE		PROD'N. FOR TEST PERIOD		OIL—BBL.		GAS—MCF.		WATER—BBL.		GAS-OIL RATIO	
6-13-73		3		3/4"		→		8							
FLOW. TUBING PRESS.		CASING PRESSURE		CALCULATED 24-HOUR RATE		OIL—BBL.		GAS—MCF.		WATER—BBL.		OIL GRAVITY-API (CORR.)			
SI 726		SI 834		→				306 MCF/D-ΔOF				34.2°			
34. DISPOSITION OF GAS (Sold, used for fuel, vented, etc.)										TEST WITNESSED BY					
										B. J. Broughton					
35. LIST OF ATTACHMENTS															
36. I hereby certify that the foregoing and attached information is complete and correct as determined from all available records															
SIGNED <u>H. B. Duceo</u>				TITLE <u>Drilling Clerk</u>				DATE <u>June 21, 1973</u>							

***(See Instructions and Spaces for Additional Data on Reverse Side)**

EL PASO NATURAL GAS COMPANY

Well Name Huerfano Unit #238

Footage 1840' FSL; 890' FEL

APPLICATION FOR NON-STANDARD LOCATION

County San Juan State New Mexico Section 18 Township 26N Range 9W

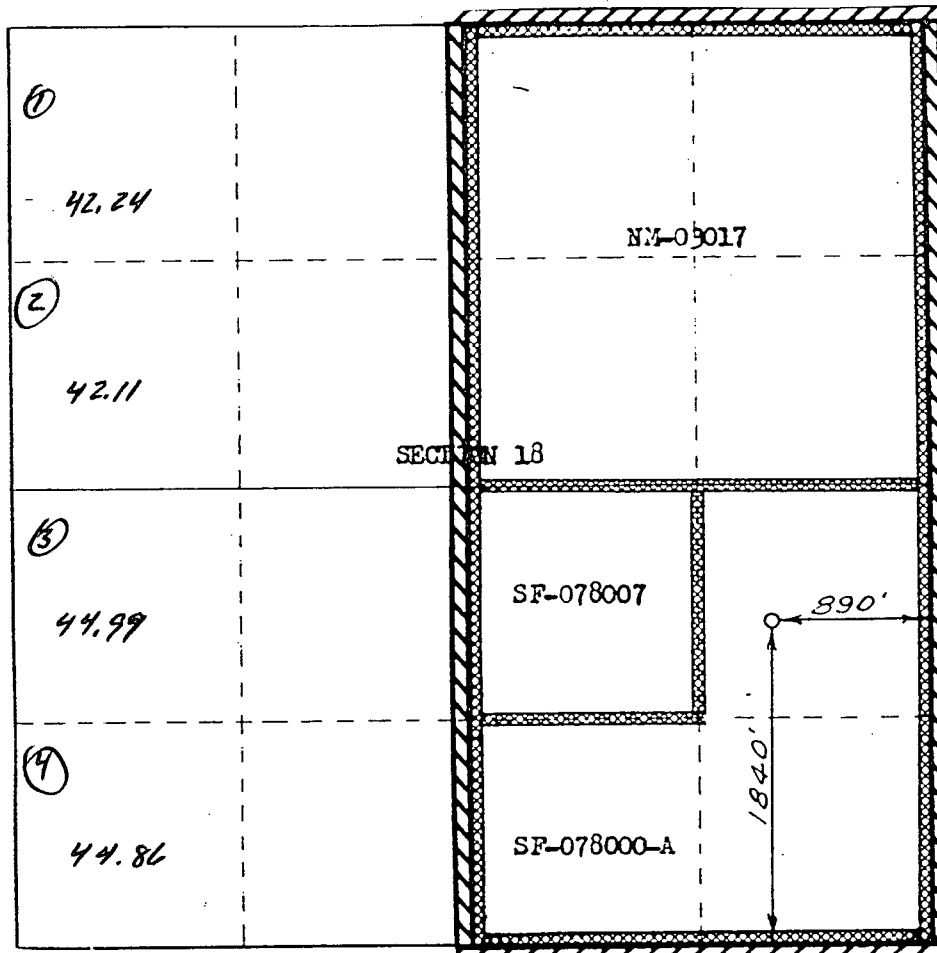

Remarks All surrounding land are located within the Huerfano Unit
Boundries

El Paso Natural Gas Co., Operator

N M EXICO OIL CONSERVATION COMMISSION
WELL LOCATION AND ACREAGE DEDICATION PLAT

Form C-128
Supersedes C-128
Effective 1-1-65

All distances must be from the outer boundaries of the Section

EL PASO NATURAL GAS COMPANY			HUERFANO UNIT		(SF-078000-A)	Well No. 238
Section I	18	26-N	9-W	SAN JUAN		
Section 18 SOUTH 390 EAST 1840 feet from the south line 390 feet from the east line						
Acres 6469	Fruitland Coal		Basin		320.00 Acres	

1. Outline the acreage dedicated to the subject well by colored pencil or hatchure marks on the plat below.
2. If more than one lease is dedicated to the well, outline each and identify the ownership thereof (both as to working interest and royalty).
3. If more than one lease of different ownership is dedicated to the well, have the interests of all owners been consolidated by communitization, unitization, force-pooling, etc?

☒ Yes ☐ No If answer is "yes," type of consolidation Unitization

If answer is "no," list the owners and tract descriptions which have actually been consolidated. (Use reverse side of this form if necessary.) _____

No allowable will be assigned to the well until all interests have been consolidated (by communitization, unitization, forced-pooling, or otherwise) or until a non-standard unit, eliminating such interests, has been approved by the Commission. **NOTE: THIS PLAT REISSUED TO SHOW PROPER POOL DESIGNATION. 1-30-73**

	CERTIFICATION
	I hereby certify that the information contained herein is true and complete to the best of my knowledge and belief.
	Name <u>Regulatory Affairs</u> Location <u>El Paso Natural Gas Co.</u> Company _____ Date _____
	I hereby certify that the well location shown on this plat was plotted from field notes of actual surveys made by me or under my supervision, and that the same is true and correct to the best of my knowledge and belief.
	Date Surveyed <u>JANUARY 19, 1973</u> Registered Professional Engineer and Land Surveyor Certificate No. <u>1760</u>