

26-N-9W

MERIDIAN OIL

OIL CONSERVATION DIVISION
RECEIVED

August 8, 1990

'90 AUG 9 AM 11 25

Federal Express

Mr. William LeMay
New Mexico Oil Conservation Division
Post Office Box 2088
Santa Fe, New Mexico 87503

RE: Huerfano Unit #237
1090'FNL, 1550'FWL
Section 17, T-26-N, R-09-W
San Juan, New Mexico

Dear Mr. LeMay:

This is a request for administrative approval for a non-standard gas well location in the Basin Fruitland Pool.

Meridian Oil intends to plugback and recomplete the Huerfano Unit #237 well from the Pictured Cliffs pool to the Basin Fruitland Coal Pool. The current location of this well is 1090'FNL, 1550'FWL, Section 17, T-26-N, R-09-W, San Juan, New Mexico. The well is considered non-standard due to the NE-SW dedicated pattern established for the Basin Fruitland Coal Pool. To comply with the New Mexico Oil Conservation Division rules, Meridian is submitting the following for your approval of this non-standard location:

1. C-102 plat showing location of the well;
2. Plat showing offset owners/operators;
3. Copy of Well Completion Log for original completion.

All surrounding lands are located within the Huerfano Unit boundaries - El Paso Natural Gas Co. is the operator.

Sincerely yours,



Peggy Bradfield
encl.

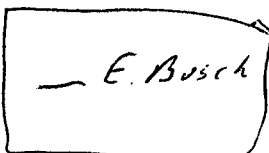

EL PASO NATURAL GAS COMPANY

Well Name Huerfano Unit #237

Footage 1090' FNL; 1550' FWL

APPLICATION FOR NON-STANDARD LOCATION

County San Juan State New Mexico Section 17 Township 26N Range 9W

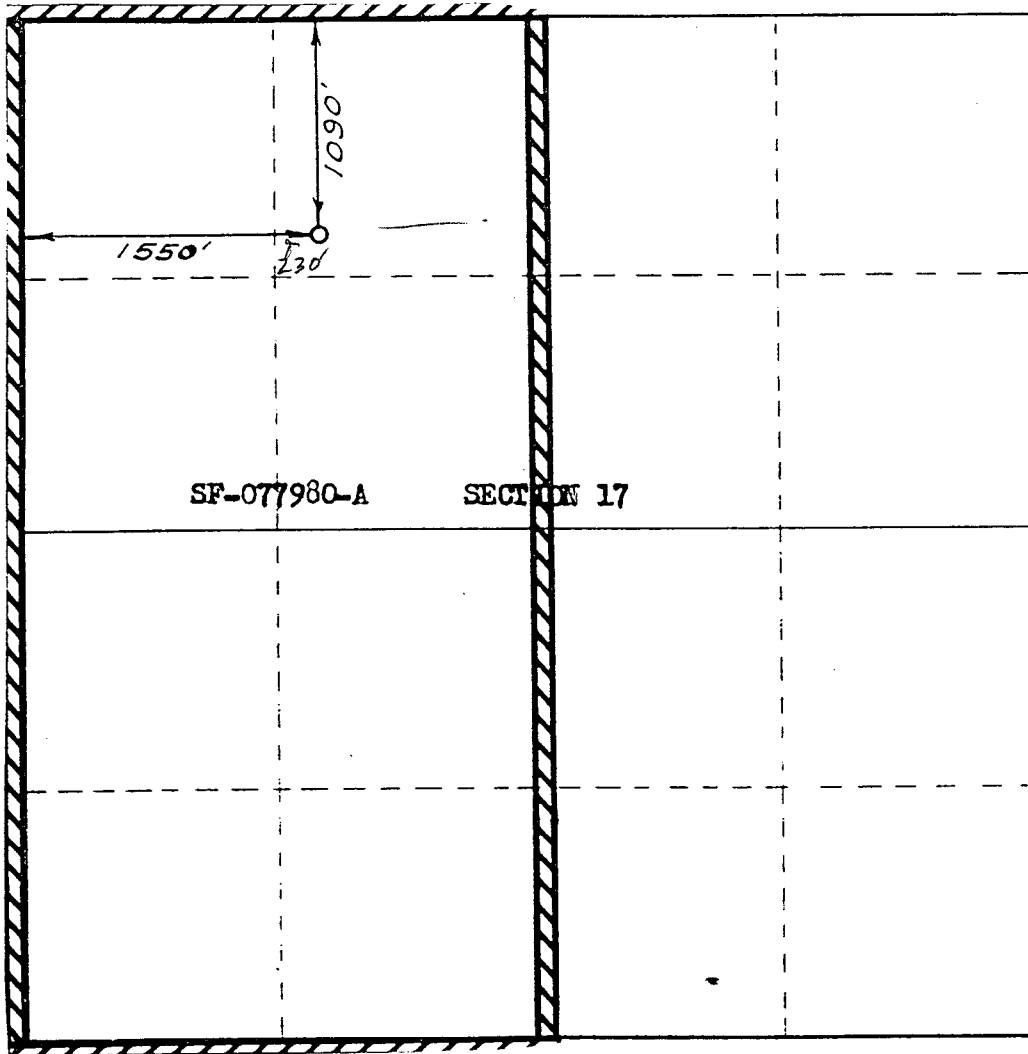

*Standard
360 acre
Section*

*1550
1320
230*

Remarks All surrounding lands are located within the Huerfano
Unit Boundries
El Paso Natural Gas Co., Operator

UNITED STATES
DEPARTMENT OF THE INTERIOR
GEOLOGICAL SURVEY

SUBMIT IN DUPLICATE*

(See other in-
structions on
reverse side)Form approved.
Budget Bureau No. 42-R355.5.5. LEASE DESIGNATION AND SERIAL NO.
SF 077980-A

6. IF INDIAN, ALLOTTEE OR TRIBE NAME

7. UNIT AGREEMENT NAME

Huerfano Unit

8. FARM OR LEASE NAME
Huerfano Unit9. WELL NO.
237

10. FIELD AND POOL, OR WILDCAT

Angel Peak Gallup

11. SEC., T., R., M., OR BLOCK AND SURVEY
OR AREASec. 17, T-26-N, R-9-W
NMPM12. COUNTY OR
PARISH
San Juan13. STATE
NM

WELL COMPLETION OR RECOMPLETION REPORT AND LOG *

1a. TYPE OF WELL: OIL WELL ☐ GAS WELL ☒ DRY ☐ Other _____

b. TYPE OF COMPLETION:

NEW WELL ☒ WORK OVER ☐ DEEP-EN ☐ PLUG BACK ☐ DIFF. RESVR. ☐ Other _____

2. NAME OF OPERATOR

El Paso Natural Gas Company

3. ADDRESS OF OPERATOR

PO Box 990, Farmington, NM 87401

4. LOCATION OF WELL (Report location clearly and in accordance with any State requirements)*

At surface

1090'N, 1550'W

At top prod. interval reported below

At total depth

14. PERMIT NO.

DATE ISSUED

15. DATE SPUDDED 3-24-73 16. DATE T.D. REACHED 4-3-73 17. DATE COMPL. (Ready to prod.) 9-20-73 18. ELEVATIONS (DF, RKB, RT, GR, ETC.)* 6476'GL 19. ELEV. CASINGHEAD

20. TOTAL DEPTH, MD & TVD 6037' 21. PLUG, BACK T.D., MD & TVD 6020' 22. IF MULTIPLE COMPL., HOW MANY* 23. INTERVALS DRILLED BY 0-6037' ROTARY TOOLS CABLE TOOLS

24. PRODUCING INTERVAL(S), OF THIS COMPLETION—TOP, BOTTOM, NAME (MD AND TVD)*

5688-5978'(Gallup)

25. WAS DIRECTIONAL
SURVEY MADE
no

26. TYPE ELECTRIC AND OTHER LOGS RUN

CDL-GR; IEL; Temp. Survey

27. WAS WELL CORED
no

28. CASING RECORD (Report all strings set in well)

CASING SIZE	WEIGHT, LB./FT.	DEPTH SET (MD)	HOLE SIZE	CEMENTING RECORD	AMOUNT PULLED
8 5/8"	24#	232'	12 1/4"	182 cu. ft.	
4 1/2"	10.5#	6037'	7 7/8"	1146 cu. ft.	

29. LINER RECORD

SIZE	TOP (MD)	BOTTOM (MD)	SACKS CEMENT*	SCREEN (MD)	SIZE	DEPTH SET (MD)	PACKER SET (MD)
					2 3/8"	5978'	

31. PERFORATION RECORD (Interval, size and number)

5688-5704', 5716-24', 5750-66', 5802-14',
5868-76', 5892-5900', 5922-30', 5962-78'

32. ACID, SHOT, FRACTURE, CEMENT SQUEEZE, ETC.

DEPTH INTERVAL (MD)	AMOUNT AND KIND OF MATERIAL USED
5688-5814'	24,000#sand; 24,000 gal. water
5868-5978'	40,000#sand; 39,942 gal. water

33.* PRODUCTION

DATE FIRST PRODUCTION		PRODUCTION METHOD (Flowing, gas lift, pumping—size and type of pump)				WELL STATUS (Producing or shut-in)	
		flowing				shut in	
DATE OF TEST	HOURS TESTED	CHOKE SIZE	PROD'N. FOR TEST PERIOD	OIL—BBL.	GAS—MCF.	WATER—BBL.	GAS-OIL RATIO
9-20-73	3	3/4"	→	8			
FLOW. TUBING PRESS.	CASING PRESSURE	CALCULATED 24-HOUR RATE	OIL—BBL.	GAS—MCF.	WATER—BBL.	OIL GRAVITY-API (CORR.)	
SI 459	SI 649	→		263 AOF		37°	

34. DISPOSITION OF GAS (Sold, used for fuel, vented, etc.)

TEST WITNESSED BY

R. Hardy & C.R. Wagner

35. LIST OF ATTACHMENTS

36. I hereby certify that the foregoing and attached information is complete and correct as determined from all available records

SIGNED

M. H. Diano

TITLE

Drilling Clerk

DATE October 4, 1973

*(See Instructions and Spaces for Additional Data on Reverse Side)

N MEXICO OIL CONSERVATION COMMISSION
WELL LOCATION AND ACREAGE DEDICATION PLAT

Form C-102
Supersedes C-128
Effective 1-1-65

All distances must be from the outer boundaries of the Section

Operator EL PASO NATURAL GAS COMPANY		Lease HUERFANO UNIT (SF-077980-A)		Well No. 237
Unit Letter C	Section 17	Township 26-N	Range 9-W	County SAN JUAN
Actual Footage Location of Well: 1090 feet from the NORTH line and 1550 feet from the WEST line.				
Ground Level Elev. 6476	Forming Permitted Fruitland Coal	Pool Basin	Permitted Acreage 320.00 Acres	

1. Outline the acreage dedicated to the subject well by colored pencil or hatchure marks on the plat below.
2. If more than one lease is dedicated to the well, outline each and identify the ownership thereof (both as to working interest and royalty).
3. If more than one lease of different ownership is dedicated to the well, have the interests of all owners been consolidated by communitization, unitization, force-pooling, etc?

☒ Yes ☐ No If answer is "yes" type of consolidation Unitization

If answer is "no" list the owners and tract descriptions which have actually been consolidated. (Use reverse side of this form if necessary.) _____

No allowable will be assigned to the well until all interests have been consolidated (by communitization, unitization, forced-pooling, or otherwise) or until a non-standard unit, eliminating such interests, has been approved by the Commission. **NOTE: THIS PLAT REISSUED TO SHOW PROPER POOL DESIGNATION. 1-30-73**

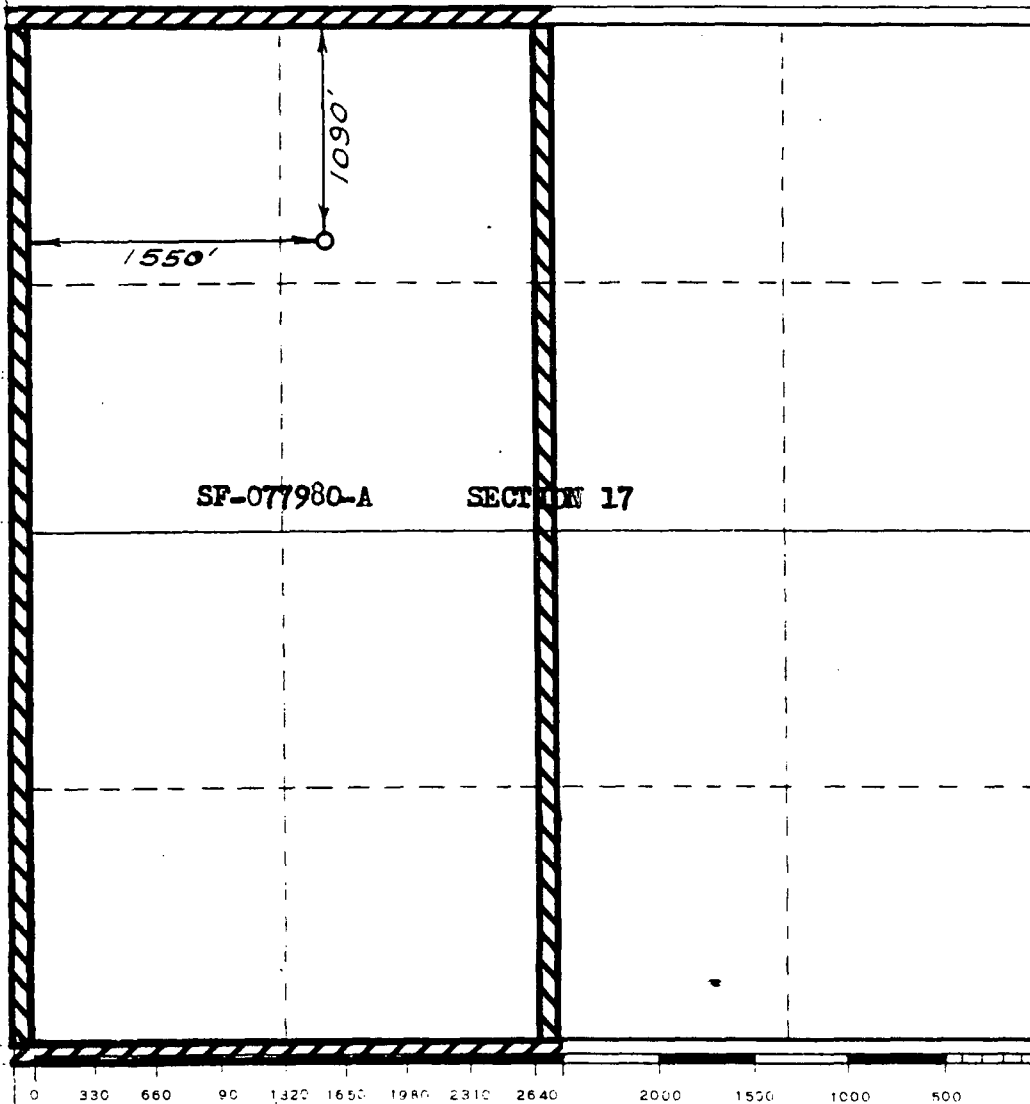

CERTIFICATION	
I hereby certify that the information contained herein is true and complete to the best of my knowledge and belief.	
Name:	Regulatory Affairs
Position:	El Paso Natural Gas Co.
Company:	
Date:	July 26, 1990
I hereby certify that the well location shown on this plat was plotted from field notes of actual surveys made by me or under my supervision, and that the same is true and correct to the best of my knowledge and belief.	
Date Surveyed:	JANUARY 15, 1973
Registered Professional Engineer and/or Land Surveyor:	<i>Paul Wilman</i>
Certificate No.:	1760