

*Cannon Forest*

KELLAHIN, KELLAHIN AND AUBREY

ATTORNEYS AT LAW

EL PATIO BUILDING

117 NORTH GUADALUPE

POST OFFICE BOX 2265

SANTA FE, NEW MEXICO 87504-2265

W. THOMAS KELLAHIN  
KAREN AUBREY

CANDACE HAMANN CALLAHAN

JASON KELLAHIN  
OF COUNSEL

TELEPHONE (505) 982-4285  
TELEFAX (505) 982-2047

July 31, 1990

**RECEIVED**

JUL 31 1990

OIL CONSERVATION DIV.  
SANTA FE

HAND DELIVERED

Mr. William J. LeMay  
Oil Conservation Division  
P.O. Box 2088  
Santa Fe, New Mexico 87501

Re: Meridian Oil Inc., on behalf of  
El Paso Natural Gas Company  
for Unorthodox Location,  
Rosa Unit 305, Basin  
Fruitland Coal Gas Pool,  
Rio Arriba County, New Mexico

Dear Mr. LeMay:

Enclosed please find the original and one copy of Meridian Oil Inc.'s application on behalf of El Paso Natural Gas Company, for approval of an unorthodox location in the Basin Fruitland Coal Gas Pool, Rio Arriba County, New Mexico. Please set this application for hearing on the examiner docket on August 22, 1990.

By copy of this letter and Application to all parties, we are notifying them by certified mail, return-receipt requested, that they have the right to appear at the hearing, to make a statement to the Division, to present evidence and corss-examine witnesses either in support of in opposition to the Application.

Sincerely,

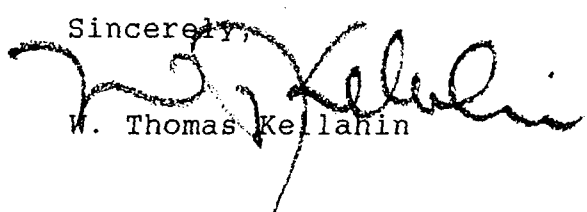
  
W. Thomas Kellahin

WTK/tic  
Encl.

xc: Mr. Alan Alexander  
Meridian Oil Inc.  
P.O. Box 4289  
Farmington, New Mexico 87499-4289

Certified mail return-receipt  
All parties listed on Exhibit "A"  
of application

STATE OF NEW MEXICO  
ENERGY, MINERALS AND NATURAL RESOURCES DEPARTMENT  
OIL CONSERVATION DIVISION

IN THE MATTER OF THE APPLICATION  
OF MERIDIAN OIL INC, FOR APPROVAL  
OF AN UNORTHODOX LOCATION, BASIN  
FRUITLAND COAL GAS POOL, RIO ARRIBA  
COUNTY, NEW MEXICO

Case No. \_\_\_\_\_

A P P L I C A T I O N

COMES NOW Meridian Oil Inc., by and through it  
attorneys, KELLAHIN, KELLAHIN & AUBREY, and applies to the  
New Mexico Oil Conservation Division for approval of an  
unorthodox Basin Fruitland Coal gas well location for its  
Rosa Unit No. 305 well, 375 feet FSL and 1125 feet FWL (SW/4  
SW/4) of Section 22, T31N, R4W, Rio Arriba County, New  
Mexico.

1. Meridian is the operator of the above-described  
proration and spacing unit which is part of the Rosa Unit.
2. Applicant proposes to form a standard proration  
and spacing unit consisting of all of Section 22, in  
accordance with the rules governing the Basin Fruitland Coal  
Pool.

3. Due to Carson National Forest considerations, Applicant proposes to drill its Rosa Unit No. 305 well at an unorthodox gas well location 375 feet FSL and 1125 feet FWL (SW/4 SW/4) of Section 22, T31N, R4W, Rio Arriba County, New Mexico.

4. Attached as Exhibit A is a plat showing the described acreage and the proposed well location.

5. The offsetting owners or operators to be notified are shown on Exhibit "A".

WHEREFORE, Applicant requests that after notice and hearing, the application be granted.

KELLAHIN, KELLAHIN & AUBREY

A handwritten signature in dark ink, appearing to read 'W. Thomas Kellahin', is written over a horizontal line.

W. Thomas Kellahin  
Post Office Box 2265  
Santa Fe, New Mexico 87504  
(505) 982-4285

Attorneys for Meridian Oil Inc.

MERIDIAN OIL INC

Well Name Rosa Unit #305

Footage 375' FSL; 1125' FWL

APPLICATION FOR NON-STANDARD LOCATION

County Rio Arriba State New Mexico Section 22 Township 31N Range 4W

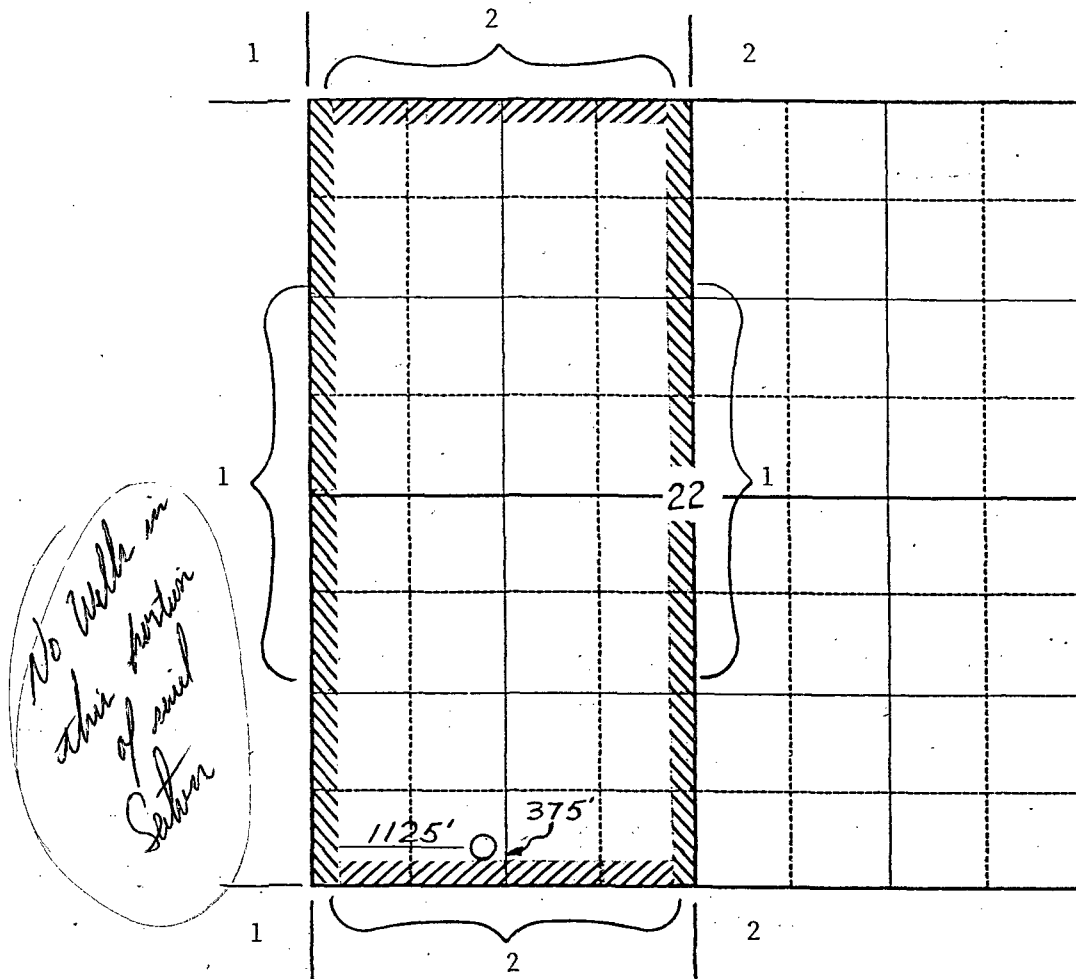

*Standard  
640 ac. Section*

*No Wells in  
this portion  
of well  
Section*

Remarks 1) Meridian Oil Inc  
2) Mitchell Energy Corp  
  
  
  
  
Exhibit A