

GREENHILL PETROLEUM CORPORATION

Incorporated in Delaware, U.S.A.

OIL CONSERVATION DIVISION
11490 WESTHEIMER ROAD, SUITE 200
HOUSTON, TEXAS 77077-6841
TELEPHONE (713) 589-8484
FAX (713) 589-7892
'92 APR 2 AM 8 42

March 24, 1992

Oil Conservation Division
State of New Mexico
Energy, Minerals and Natural Resources Department
P. O. Box 2088
Santa Fe, New Mexico 87504-2088

Attention: Mr. Mike Stogner

RE: Unorthodox Location and Drilling Permit
Proposed Well Number 125
Lovington Paddock Unit
Lea County, New Mexico

Dear Mr. Stogner:

Greenhill Petroleum Corporation respectfully requests the State of New Mexico Oil Conservation Division grant approval of the proposed unorthodox location and the attached permit to drill Well Number 125 in the Lovington Paddock Unit, located in Lea County, New Mexico.

The Lovington Paddock Unit is presently developed and being waterflooded utilizing a forty (40) acre well density. It is believed that infill development using a twenty (20) acre well density will improve waterflood sweep efficiency and will increase secondary oil recovery. The proposed location for Well Number 125 is located in the interior of the unit and is not competitive with offset wells outside the unit. Information gathered as a result of drilling this infill well will be utilized in evaluating additional infill development potential in the unit and ultimately may be used to evaluate the feasibility of tertiary recovery.

Greenhill Petroleum Corporation wishes to commence drilling operations on the proposed well as soon as possible and would appreciate a response to this request at your earliest convenience.

Respectfully yours,

Michael J. Newport
Land Manager - Permian Basin

MJN:sjs
92.204
Enclosures

Submit to Appropriate
District Office
State Lease - 6 copies
Fee Lease - 5 copies

State of New Mexico
Energy, Minerals and Natural Resources Department

Form C-101
Revised 1-1-89

OIL CONSERVATION DIVISION

P.O. Box 2088
Santa Fe, New Mexico 87504-2088

DISTRICT I
P.O. Box 1980, Hobbs, NM 88240

DISTRICT II
P.O. Drawer DD, Artesia, NM 88210

DISTRICT III
1000 Rio Brazos Rd., Aztec, NM 87410

API NO. (assigned by OCD on New Wells)

5. Indicate Type of Lease

STATE ☒

FEE ☐

6. State Oil & Gas Lease No.
B 9077

APPLICATION FOR PERMIT TO DRILL, DEEPEN, OR PLUG BACK

1a. Type of Work:

DRILL ☒

RE-ENTER ☐

DEEPEN ☐

PLUG BACK ☐

b. Type of Well:

OIL
WELL ☒

GAS
WELL ☐

OTHER ☐

SINGLE
ZONE ☐

MULTIPLE
ZONE ☐

7. Lease Name or Unit Agreement Name

Lovington Paddock Unit

2. Name of Operator

GREENHILL PETROLEUM CORPORATION

8. Well No.

125

3. Address of Operator

11490 Westheimer, Suite 200, Houston, Texas 77077

9. Pool name or Wildcat

Lovington Paddock

4. Well Location

Unit Letter P

: 1015

Feet From The

South

Line and 1185

Feet From The

East

Line

Section 25

Township

16 South

Range

36 East

NMPM

Lea

County

10. Proposed Depth
6450'

11. Formation
Paddock

12. Rotary or C.T.
Rotary

13. Elevations (Show whether DF, RT, GR, etc.)
3831 GR

14. Kind & Status Plug. Bond
on file

15. Drilling Contractor
TBD

16. Approx. Date Work will start
4-1-92

17.

PROPOSED CASING AND CEMENT PROGRAM

SIZE OF HOLE	SIZE OF CASING	WEIGHT PER FOOT	SETTING DEPTH	SACKS OF CEMENT	EST. TOP
12 1/4 "	8 5/8 "	24	1300'	550	surface
7 7/8 "	5 1/2 "	15.5	6450'	1100	surface

IN ABOVE SPACE DESCRIBE PROPOSED PROGRAM: IF PROPOSAL IS TO DEEPEN OR PLUG BACK, GIVE DATA ON PRESENT PRODUCTIVE ZONE AND PROPOSED NEW PRODUCTIVE ZONE. GIVE BLOWOUT PREVENTER PROGRAM, IF ANY.

I hereby certify that the information above is true and complete to the best of my knowledge and belief.

SIGNATURE

Michael J. Newport

TITLE Land Manager-Permian Basin DATE 3-24-92

TYPE OR PRINT NAME

Michael J. Newport

(713)

TELEPHONE NO. 589-8484

(This space for State Use)

APPROVED BY

TITLE

DATE

CONDITIONS OF APPROVAL, IF ANY:

OIL CONSERVATION DIVISION

P.O. Box 2088
Santa Fe, New Mexico 87504-2088

DISTRICT I

P.O. Box 1980, Hobbs, NM 88240

DISTRICT II

P.O. Drawer DD, Artesia, NM 88210

DISTRICT III

1000 Rio Brazos Rd., Artec, NM 87410

WELL LOCATION AND ACREAGE DEDICATION PLAT

All Distances must be from the outer boundaries of the section

Operator Greenhill Petroleum Corp.		Lease Lovington Paddock Unit		Well No. 125
Unit Letter P	Section 25	Township 16 South	Range 36 East NMPM	County Lea

Actual Footage Location of Well:

1015 feet from the south line and 1185 feet from the east line	Ground Level Elev. 3831.7'	Producing Formation Lovington Paddock	Pool Lovington Paddock Unit	Dedicated Acreage: 40 Acres
--	-------------------------------	--	--------------------------------	--------------------------------

- Outline the acreage dedicated to the subject well by colored pencil or hatchure marks on the plat below.
- If more than one lease is dedicated to the well, outline each and identify the ownership thereof (both as to working interest and royalty).
- If more than one lease of different ownership is dedicated to the well, have the interest of all owners been consolidated by communitization, unitization, force-pooling, etc?
☒ Yes ☐ No If answer is "yes" type of consolidation unitized

If answer is "no" list of owners and tract descriptions which have actually been consolidated. (Use reverse side of this form necessary.)

No allowable will be assigned to the well unit all interests have been consolidated (by communitization, unitization, forced-pooling, otherwise) or until a non-standard unit, eliminating such interest, has been approved by the Division.

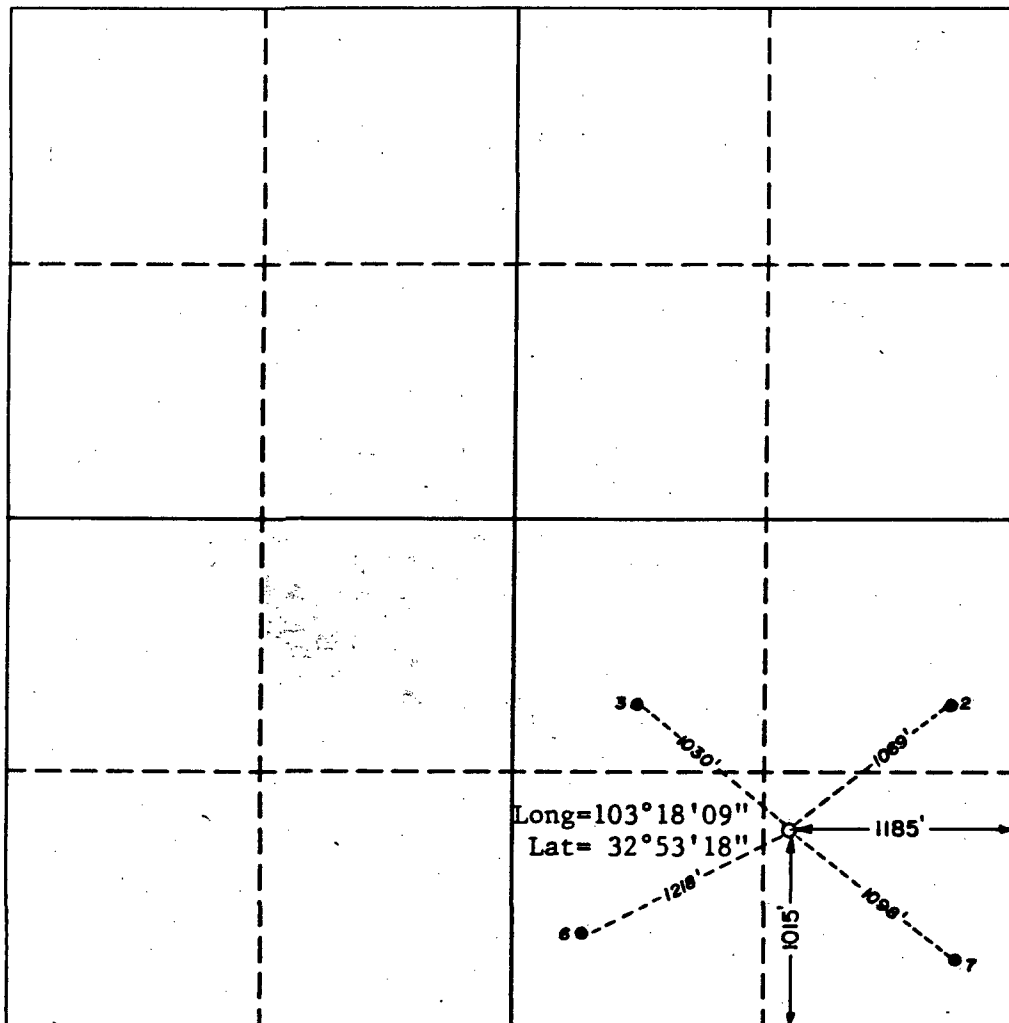

OPERATOR CERTIFICATION

I hereby certify the the information contained herein to true and complete to the best of my knowledge and belief.

Signature

Michael J. Newport

Printed Name

Land Manager-Permian Basin

Position

GREENHILL PETROLEUM CORPORATI

Company

3-24-92

Date

SURVEYOR CERTIFICATION

I hereby certify that the well location shown on this plat was plotted from field notes of actual surveys made by me or under my supervision, and that the same is true and correct to the best of my knowledge and belief.

Date Surveyed

February 6, 1992

Signature & Seal of
Professional Surveyor

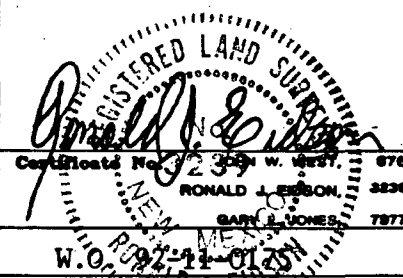

GREENHILL PETROLEUM CORPORATION
BOP PROGRAM FOR
LOVINGTON PADDOCK UNIT #125

Casing Program

BOP Program

Size	Depth	Wt.	Grade	Configuration	Test Pressure
8-5/8"	1300'	24	H40, STC	RA*	200 psi
5-1/2"	6450'	15.5	K55, STC	RR*	250/1500 psi

* = RR-Ram Ram
* = RA-Ram Annular

Diverter-Hydrill may be substituted for a diverter.

sjs:s
92.215

03/24/92

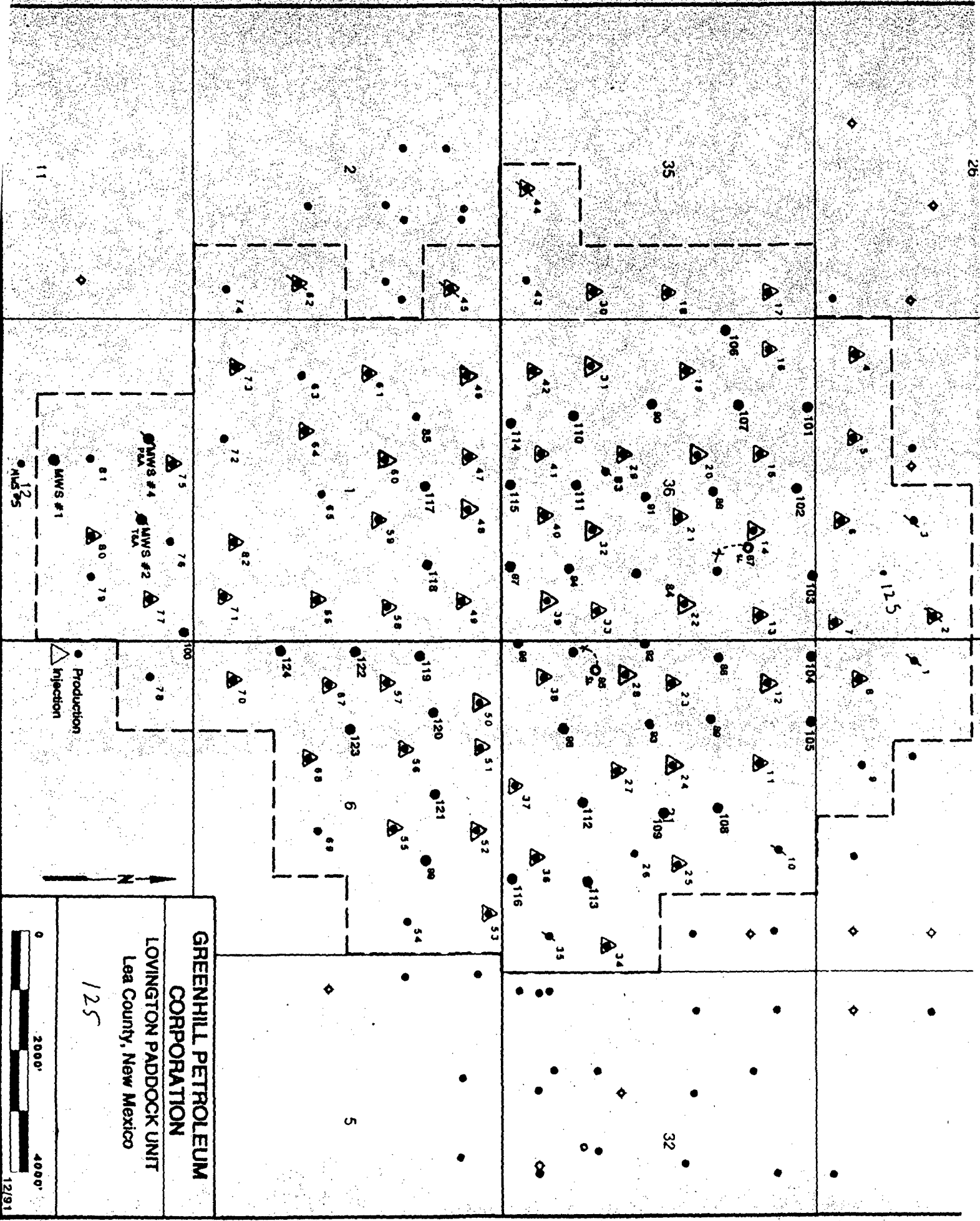



GREENHILL PETROLEUM CORPORATION

11490 WESTHEIMER ROAD, SUITE 200
HOUSTON, TEXAS 77077-6841
TELEPHONE (713) 589-8484
FAX. (713) 589-7892

Incorporated in Delaware, U.S.A.

March 24, 1992

Oil Conservation Division
State of New Mexico
Energy, Minerals and Natural Resources Department
P. O. Box 2088
Santa Fe, New Mexico 87504-2088

Attention: Mr. Mike Stogner

RE: Unorthodox Location and Drilling Permit
Proposed Well Number 127
Lovington Paddock Unit
Lea County, New Mexico

Dear Mr. Stogner:

Greenhill Petroleum Corporation respectfully requests the State of New Mexico Oil Conservation Division grant approval of the proposed unorthodox location and the attached permit to drill Well Number 127 in the Lovington Paddock Unit, located in Lea County, New Mexico.

The Lovington Paddock Unit is presently developed and being waterflooded utilizing a forty (40) acre well density. It is believed that infill development using a twenty (20) acre well density will improve waterflood sweep efficiency and will increase secondary oil recovery. The proposed location for Well Number 127 is located in the interior of the unit and is not competitive with offset wells outside the unit. Information gathered as a result of drilling this infill well will be utilized in evaluating additional infill development potential in the unit and ultimately may be used to evaluate the feasibility of tertiary recovery.

Greenhill Petroleum Corporation wishes to commence drilling operations on the proposed well as soon as possible and would appreciate a response to this request at your earliest convenience.

Respectfully yours,

Michael J. Newport
Land Manager - Permian Basin

MJN:sjs
92.204
Enclosures

OIL CONSERVATION DIVISION

DISTRICT I
P.O. Box 1980, Hobbs, NM 88240

P.O. Box 2088
Santa Fe, New Mexico 87504-2088

DISTRICT II
P.O. Drawer DD, Artesia, NM 88210

DISTRICT III
1000 Rio Brazos Rd., Aztec, NM 87410

WELL LOCATION AND ACREAGE DEDICATION PLAT

All Distances must be from the outer boundaries of the section

Operator Greenhill Petroleum Corp.			Lease Lovington Paddock Unit		Well No. 127
Unit Letter C	Section 31	Township 16 South	Range 37 East	County Lea	

Actual Footage Location of Well:

150 feet from the north line and		2500 feet from the west line	
Ground Level Elev. 3825.7'	Producing Formation Lovington Paddock	Pool Lovington Paddock	Dedicated Acreage: 40 Acres

1. Outline the acreage dedicated to the subject well by colored pencil or hatchure marks on the plat below.
2. If more than one lease is dedicated to the well, outline each and identify the ownership thereof (both as to working interest and royalty).
3. If more than one lease of different ownership is dedicated to the well, have the interest of all owners been consolidated by communitization, unitization, force-pooling, etc.?
☒ Yes ☐ No If answer is "yes" type of consolidation unitized

If answer is "no" list of owners and tract descriptions which have actually been consolidated. (Use reverse side of this form necessary.)

No allowable will be assigned to the well unit all interests have been consolidated (by communitization, unitization, forced-pooling, otherwise) or until a non-standard unit, eliminating such interest, has been approved by the Division.

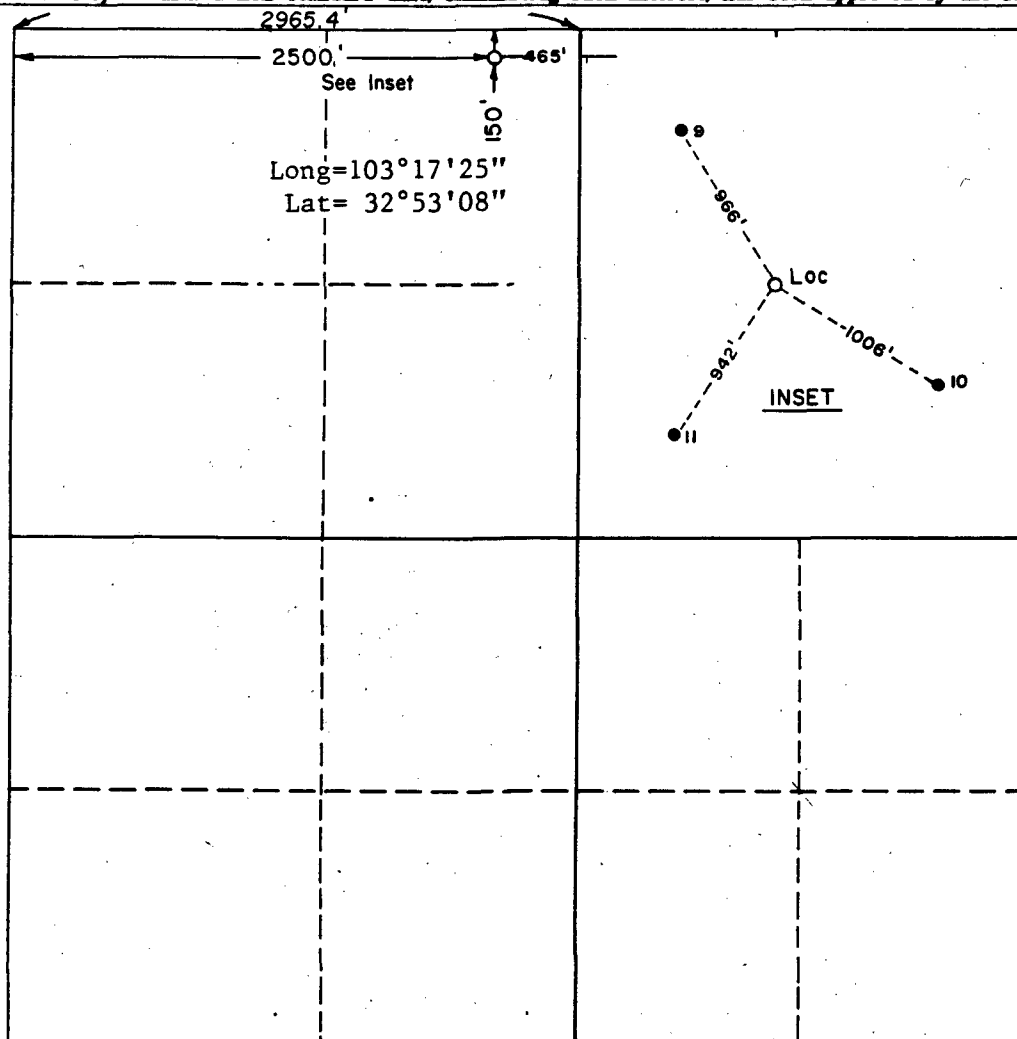

OPERATOR CERTIFICATION

I hereby certify that the information contained herein is true and complete to the best of my knowledge and belief.

Signature Michael J. Newport
Printed Name **Michael J. Newport**
Position **Land Manager/Permian Basin**
Company **Greenhill Petroleum Corp.**
Date **3/27/92**

SURVEYOR CERTIFICATION

I hereby certify that the well location shown on this plat was plotted from field notes of actual surveys made by me or under my supervision, and that the same is true and correct to the best of my knowledge and belief.

Date Surveyed
February 6, 1992

Signature & Seal of
Professional Surveyor

REGISTERED LAND SURVEYOR
RONALD S. EDSON
Certificate No. **1000 W. WEST** 676
RONALD S. EDSON 2838
RONALD S. EDSON 7877
W. O. 11-0076

Submit to Appropriate
District Office
State Lease - 6 copies
Fee Lease - 5 copies

State of New Mexico
Energy, Minerals and Natural Resources Department

Form C-101
Revised 1-1-89

OIL CONSERVATION DIVISION

P.O. Box 2088
Santa Fe, New Mexico 87504-2088

DISTRICT I
P.O. Box 1980, Hobbs, NM 88240

DISTRICT II
P.O. Drawer DD, Artesia, NM 88210

DISTRICT III
1000 Rio Brazos Rd., Aztec, NM 87410

API NO. (assigned by OCD on New Wells)

5. Indicate Type of Lease

STATE ☐

FEE ☒

6. State Oil & Gas Lease No.

APPLICATION FOR PERMIT TO DRILL, DEEPEN, OR PLUG BACK

1a. Type of Work:

DRILL ☒

RE-ENTER ☐

DEEPEN ☐

PLUG BACK ☐

b. Type of Well:

OIL
WELL ☒

GAS
WELL ☐

OTHER ☐

SINGLE
ZONE ☐

MULTIPLE
ZONE ☐

7. Lease Name or Unit Agreement Name

Lovington Paddock Unit

2. Name of Operator

GREENHILL PETROLEUM CORPORATION

8. Well No.

127

3. Address of Operator

11490 Westheimer, Suite 200, Houston, Texas 77077

9. Pool name or Wildcat

Lovington Paddock

4. Well Location

Unit Letter C : 150 Feet From The North Line and 2500 Feet From The West Line

Section 31 Township 16 South Range 37 East NMPM Lea County

10. Proposed Depth
6450'

11. Formation
Paddock

12. Rotary or C.T.
Rotary

13. Elevations (Show whether DF, RT, GR, etc.)

3825 GR

14. Kind & Status Plug. Bond

on file

15. Drilling Contractor

TBD

16. Approx. Date Work will start

4-1-92

17.

PROPOSED CASING AND CEMENT PROGRAM

SIZE OF HOLE	SIZE OF CASING	WEIGHT PER FOOT	SETTING DEPTH	SACKS OF CEMENT	EST. TOP
12 1/4 "	8 5/8 "	24	1300'	550	surface
7 7/8 "	5 1/2 "	15.5	6450'	1100	surface

IN ABOVE SPACE DESCRIBE PROPOSED PROGRAM: IF PROPOSAL IS TO DEEPEN OR PLUG BACK, GIVE DATA ON PRESENT PRODUCTIVE ZONE AND PROPOSED NEW PRODUCTIVE ZONE. GIVE BLOWOUT PREVENTER PROGRAM, IF ANY.

I hereby certify that the information above is true and complete to the best of my knowledge and belief.

SIGNATURE

Michael J. Newport

TITLE Land Manager-Permian Basin DATE 3-24-92

TYPE OR PRINT NAME

Michael J. Newport

(713)

TELEPHONE NO. 589-8484

(This space for State Use)

APPROVED BY

TITLE

DATE

CONDITIONS OF APPROVAL, IF ANY:

GREENHILL PETROLEUM CORPORATION
BOP PROGRAM FOR
LOVINGTON PADDOCK UNIT #127

Casing Program				BOP Program	
Size	Depth	Wt.	Grade	Configuration	Test Pressure
8-5/8"	1300'	24	H40, STC	RA*	200 psi
5-1/2"	6450'	15.5	K55, STC	RR*	250/1500 psi

* = RR-Ram Ram
* = RA-Ram Annular

Diverter-Hydrill may be substituted for a diverter.

sjs:s
92.215

03/24/92

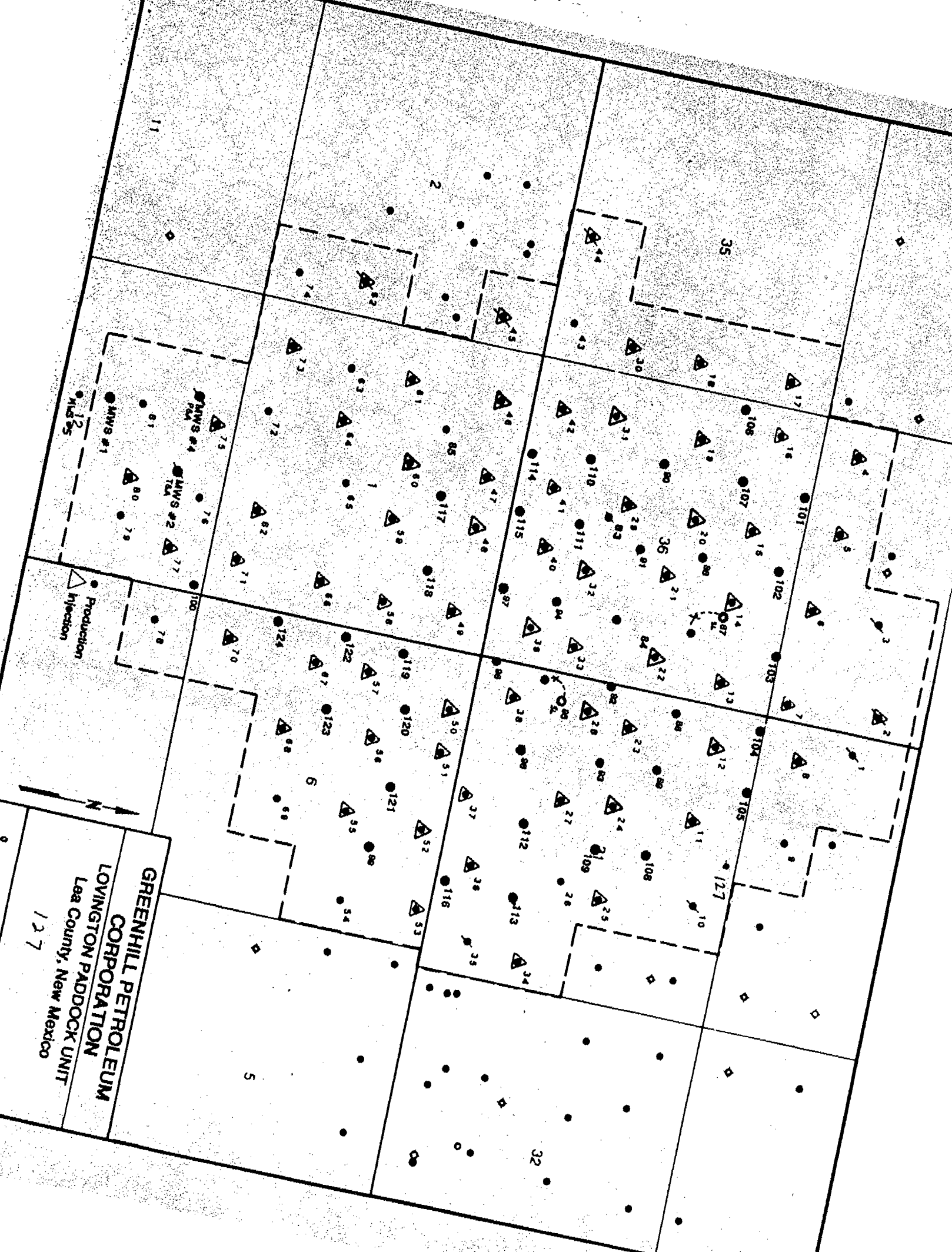

11

35

2

MWS #4
MWS #2
MWS #1
MWS #5

Production
Injection

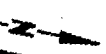

GREENHILL PETROLEUM
CORPORATION
LOVINGTON PADDOCK UNIT
Lea County, New Mexico
127



GREENHILL PETROLEUM CORPORATION

11490 WESTHEIMER ROAD, SUITE 200
HOUSTON, TEXAS 77077-6841
TELEPHONE (713) 589-8484
FAX. (713) 589-7892

Incorporated in Delaware, U.S.A.

March 24, 1992

Oil Conservation Division
State of New Mexico
Energy, Minerals and Natural Resources Department
P. O. Box 2088
Santa Fe, New Mexico 87504-2088

Attention: Mr. Mike Stogner

RE: Unorthodox Location and Drilling Permit
Proposed Well Number 129
Lovington Paddock Unit
Lea County, New Mexico

Dear Mr. Stogner:

Greenhill Petroleum Corporation respectfully requests the State of New Mexico Oil Conservation Division grant approval of the proposed unorthodox location and the attached permit to drill Well Number 129 in the Lovington Paddock Unit, located in Lea County, New Mexico.

The Lovington Paddock Unit is presently developed and being waterflooded utilizing a forty (40) acre well density. It is believed that infill development using a twenty (20) acre well density will improve waterflood sweep efficiency and will increase secondary oil recovery. The proposed location for Well Number 129 is located in the interior of the unit and is not competitive with offset wells outside the unit. Information gathered as a result of drilling this infill well will be utilized in evaluating additional infill development potential in the unit and ultimately may be used to evaluate the feasibility of tertiary recovery.

Greenhill Petroleum Corporation wishes to commence drilling operations on the proposed well as soon as possible and would appreciate a response to this request at your earliest convenience.

Respectfully yours,

Michael J. Newport
Michael J. Newport
Land Manager - Permian Basin

MJN:sjs
92.204
Enclosures

Submit to Appropriate
District Office
State Lease - 6 copies
Fee Lease - 3 copies

State of New Mexico
Energy, Minerals and Natural Resources Department

Form C-101
Revised 1-1-89

OIL CONSERVATION DIVISION

P.O. Box 2088
Santa Fe, New Mexico 87504-2088

DISTRICT I
P.O. Box 1980, Hobbs, NM 88240

DISTRICT II
P.O. Drawer DD, Artesia, NM 88210

DISTRICT III
1000 Rio Brazos Rd., Aztec, NM 87410

API NO. (assigned by OCD on New Wells)

5. Indicate Type of Lease

STATE ☒

FEE ☐

6. State Oil & Gas Lease No.
B7766

APPLICATION FOR PERMIT TO DRILL, DEEPEN, OR PLUG BACK

1a. Type of Work:

DRILL ☒

RE-ENTER ☐

DEEPEN ☐

PLUG BACK ☐

b. Type of Well:

OIL
WELL ☒

GAS
WELL ☐

OTHER ☐

SINGLE
ZONE ☐

MULTIPLE
ZONE ☐

7. Lease Name or Unit Agreement Name

Lovington Paddock Unit

2. Name of Operator

GREENHILL PETROLEUM CORPORATION

8. Well No.

129

3. Address of Operator

11490 Westheimer, Suite 200, Houston, Texas 77077

9. Pool name or Wildcat

Lovington Paddock

4. Well Location

Unit Letter

L

: 2420

Feet From The

South

Line and

395

Feet From The

West

Line

Section

36

Township

16 South

Range

36 East NMPM

Lea

County

10. Proposed Depth

6450'

11. Formation

Paddock

12. Rotary or C.T.

Rotary

13. Elevations (Show whether DF, RT, GR, etc.)

3838GR

14. Kind & Status Plug Bond

on file

15. Drilling Contractor

TBD

16. Approx. Date Work will start

4-1-92

17.

PROPOSED CASING AND CEMENT PROGRAM

SIZE OF HOLE	SIZE OF CASING	WEIGHT PER FOOT	SETTING DEPTH	SACKS OF CEMENT	EST. TOP
12 1/4 "	8 5/8 "	24	1300'	550	surface
7 7/8 "	5 1/2 "	15.5	6450'	1100	surface

IN ABOVE SPACE DESCRIBE PROPOSED PROGRAM: IF PROPOSAL IS TO DEEPEN OR PLUG BACK, GIVE DATA ON PRESENT PRODUCTIVE ZONE AND PROPOSED NEW PRODUCTIVE ZONE. GIVE BLOWOUT PREVENTER PROGRAM, IF ANY.

I hereby certify that the information above is true and complete to the best of my knowledge and belief.

SIGNATURE

Michael J. Newport

TITLE Land Manager-Permian Basin DATE 3-24-92

TYPE OR PRINT NAME

Michael J. Newport

(713)

TELEPHONE NO. 589-8484

(This space for State Use)

APPROVED BY

TITLE

DATE

CONDITIONS OF APPROVAL, IF ANY:

OIL CONSERVATION DIVISION

P.O. Box 2088
Santa Fe, New Mexico 87504-2088

DISTRICT I

P.O. Box 1980, Hobbs, NM 88240

DISTRICT II

P.O. Drawer DD, Artesia, NM 88210

DISTRICT III

1000 Rio Brazos Rd., Artec, NM 87410

WELL LOCATION AND ACREAGE DEDICATION PLAT

All Distances must be from the outer boundaries of the section

Operator Greenhill Petroleum Corp.			Lease Lovington Paddock Unit		Well No. 129
Unit Letter L	Section 36	Township 16 South	Range 36 East	County Lea	
Actual Footage Location of Well: 2420 feet from the south line and 395 feet from the west line					
Ground Level Elev. 3838.3'	Producing Formation Lovington Paddock		Pool Lovington Paddock Unit		Dedicated Acreage: 40 Acres

1. Outline the acreage dedicated to the subject well by colored pencil or hatchure marks on the plat below.
2. If more than one lease is dedicated to the well, outline each and identify the ownership thereof (both as to working interest and royalty).
3. If more than one lease of different ownership is dedicated to the well, have the interest of all owners been consolidated by communitization, unitization, force-pooling, etc.?

☒ Yes ☐ No If answer is "yes" type of consolidation unitized

If answer is "no" list of owners and tract descriptions which have actually been consolidated. (Use reverse side of this form necessary.)

No allowable will be assigned to the well unit all interests have been consolidated (by communitization, unitization, forced-pooling, otherwise) or until a non-standard unit, eliminating such interest, has been approved by the Division.

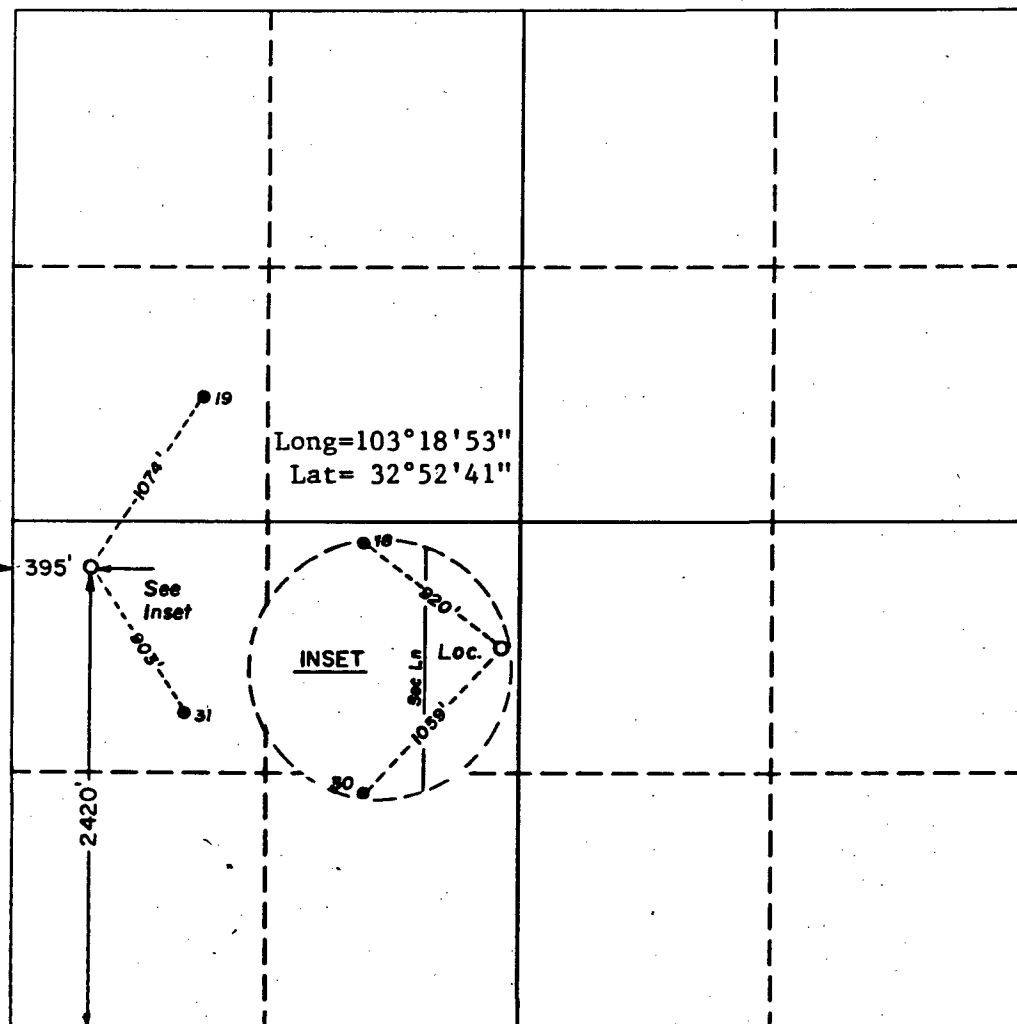

OPERATOR CERTIFICATION

I hereby certify that the information contained herein is true and complete to the best of my knowledge and belief.

Michael J. Newport
Signature

Michael J. Newport
Printed Name

Land Manager-Permian Basin
Position
Greenhill Petroleum Corp.
Company

3-24-92
Date

SURVEYOR CERTIFICATION

I hereby certify that the well location shown on this plat was plotted from field notes of actual surveys made by me or under my supervision, and that the same is true and correct to the best of my knowledge and belief.

Date Surveyed
February 7, 1992

Signature & Seal of
Professional Surveyor

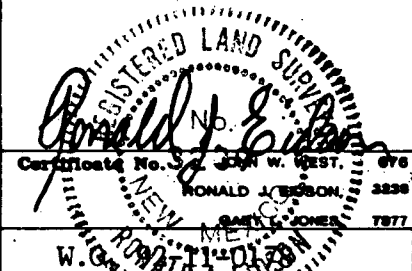

GREENHILL PETROLEUM CORPORATION
BOP PROGRAM FOR
LOVINGTON PADDOCK UNIT #129

Casing Program

BOP Program

Size	Depth	Wt.	Grade	Configuration	Test Pressure
8-5/8"	1300'	24	H40, STC	RA*	200 psi
5-1/2"	6450'	15.5	K55, STC	RR*	250/1500 psi

* = RR-Ram Ram
* = RA-Ram Annular

Diverter-Hydrill may be substituted for a diverter.

sjs:s
92.215

03/24/92

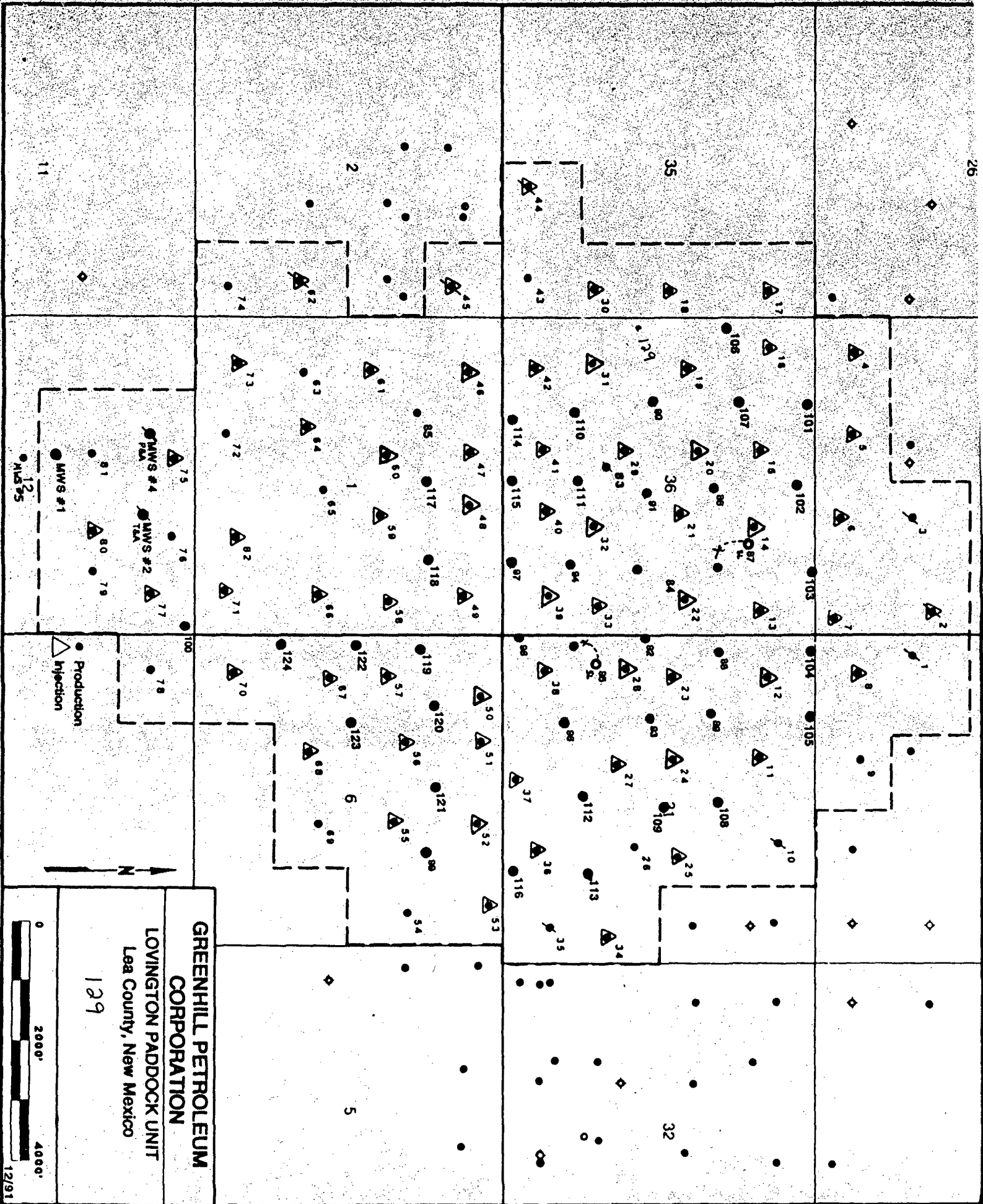



GREENHILL PETROLEUM CORPORATION

11490 WESTHEIMER ROAD, SUITE 200
HOUSTON, TEXAS 77077-6841
TELEPHONE (713) 589-8484
FAX. (713) 589-7892

Incorporated in Delaware, U.S.A.

March 24, 1992

Oil Conservation Division
State of New Mexico
Energy, Minerals and Natural Resources Department
P. O. Box 2088
Santa Fe, New Mexico 87504-2088

Attention: Mr. Mike Stogner

RE: Unorthodox Location and Drilling Permit
Proposed Well Number 130
Lovington Paddock Unit
Lea County, New Mexico

Dear Mr. Stogner:

Greenhill Petroleum Corporation respectfully requests the State of New Mexico Oil Conservation Division grant approval of the proposed unorthodox location and the attached permit to drill Well Number 130 in the Lovington Paddock Unit, located in Lea County, New Mexico.

The Lovington Paddock Unit is presently developed and being waterflooded utilizing a forty (40) acre well density. It is believed that infill development using a twenty (20) acre well density will improve waterflood sweep efficiency and will increase secondary oil recovery. The proposed location for Well Number 130 is located in the interior of the unit and is not competitive with offset wells outside the unit. Information gathered as a result of drilling this infill well will be utilized in evaluating additional infill development potential in the unit and ultimately may be used to evaluate the feasibility of tertiary recovery.

Greenhill Petroleum Corporation wishes to commence drilling operations on the proposed well as soon as possible and would appreciate a response to this request at your earliest convenience.

Respectfully yours,

Michael J. Newport
Land Manager - Permian Basin

MJN:sjs
92.204
Enclosures

Submit to Appropriate
District Office
State Lease - 6 copies
Fee Lease - 5 copies

State of New Mexico
Energy, Minerals and Natural Resources Department

Form C-101
Revised 1-1-89

OIL CONSERVATION DIVISION

P.O. Box 2088
Santa Fe, New Mexico 87504-2088

DISTRICT I
P.O. Box 1980, Hobbs, NM 88240

DISTRICT II
P.O. Drawer DD, Artesia, NM 88210

DISTRICT III
1000 Rio Brazos Rd., Aztec, NM 87410

API NO. (assigned by OCD on New Wells)

5. Indicate Type of Lease

STATE ☒

FEE ☐

6. State Oil & Gas Lease No.

B 7896

APPLICATION FOR PERMIT TO DRILL, DEEPEN, OR PLUG BACK

1a. Type of Work:

DRILL ☒

RE-ENTER ☐

DEEPEN ☐

PLUG BACK ☐

b. Type of Well:

OIL

WELL ☒

GAS

WELL ☐

OTHER ☐

SINGLE

ZONE ☐

MULTIPLE

ZONE ☐

7. Lease Name or Unit Agreement Name

Lovington Paddock Unit

2. Name of Operator

GREENHILL PETROLEUM CORPORATION

8. Well No.

130

3. Address of Operator

11490 Westheimer, Suite 200, Houston, Texas 77077

9. Pool name or Wildcat

Lovington Paddock

4. Well Location

Unit Letter

J

2300

Feet From The

South

Line and

1460

Feet From The

East

Line

Section

31

Township

16 South

Range

37 East

NMPM

Lea

County

10. Proposed Depth

6450'

11. Formation

Paddock

12. Rotary or C.T.

Rotary

13. Elevations (Show whether DF, RT, GR, etc.)

3820 GR

14. Kind & Status Plug. Bond

on file

15. Drilling Contractor

TBD

16. Approx. Date Work will start

4-1-92

17.

PROPOSED CASING AND CEMENT PROGRAM

SIZE OF HOLE	SIZE OF CASING	WEIGHT PER FOOT	SETTING DEPTH	SACKS OF CEMENT	EST. TOP
12 1/4 "	8 5/8 "	24	1300'	550	surface
7 7/8 "	5 1/2 "	15.5	6450'	1100	surface

IN ABOVE SPACE DESCRIBE PROPOSED PROGRAM: IF PROPOSAL IS TO DEEPEN OR PLUG BACK, GIVE DATA ON PRESENT PRODUCTIVE ZONE AND PROPOSED NEW PRODUCTIVE ZONE. GIVE BLOWOUT PREVENTER PROGRAM, IF ANY.

I hereby certify that the information above is true and complete to the best of my knowledge and belief.

SIGNATURE

Michael J. Newport

TITLE Land Manager-Permian Basin

DATE 3-24-92

TYPE OR PRINT NAME

Michael J. Newport

(713)

TELEPHONE NO. 589-8484

(This space for State Use)

APPROVED BY

TITLE

DATE

CONDITIONS OF APPROVAL, IF ANY:

OIL CONSERVATION DIVISION

P.O. Box 2088

Santa Fe, New Mexico 87504-2088

DISTRICT I

P.O. Box 1980, Hobbs, NM 88240

DISTRICT II

P.O. Drawer DD, Artesia, NM 88210

DISTRICT III

1000 Rio Brazos Rd., Artec, NM 87410

WELL LOCATION AND ACREAGE DEDICATION PLAT

All Distances must be from the outer boundaries of the section

Operator Greenhill Petroleum Corp.			Lease Lovington Paddock Unit		Well No. 130
Unit Letter J	Section 31	Township 16 South	Range 37 East	NMPM	County Lea

Actual Footage Location of Well:

2300	feet from the south	Mine and	1460	feet from the east	line
Ground Level Elev. 3820.4'	Producing Formation Lovington Paddock		Pool Lovington Paddock		Dedicated Acreage: 40 Acres

1. Outline the acreage dedicated to the subject well by colored pencil or hatchure marks on the plat below.
2. If more than one lease is dedicated to the well, outline each and identify the ownership thereof (both as to working interest and royalty).
3. If more than one lease of different ownership is dedicated to the well, have the interest of all owners been consolidated by communitization, unitization, force-pooling, etc?
☒ Yes ☐ No If answer is "yes" type of consolidation unitized

If answer is "no" list of owners and tract descriptions which have actually been consolidated. (Use reverse side of this form necessary.)

No allowable will be assigned to the well unit all interests have been consolidated (by communitization, unitization, forced-pooling, otherwise) or until a non-standard unit, eliminating such interest, has been approved by the Division.

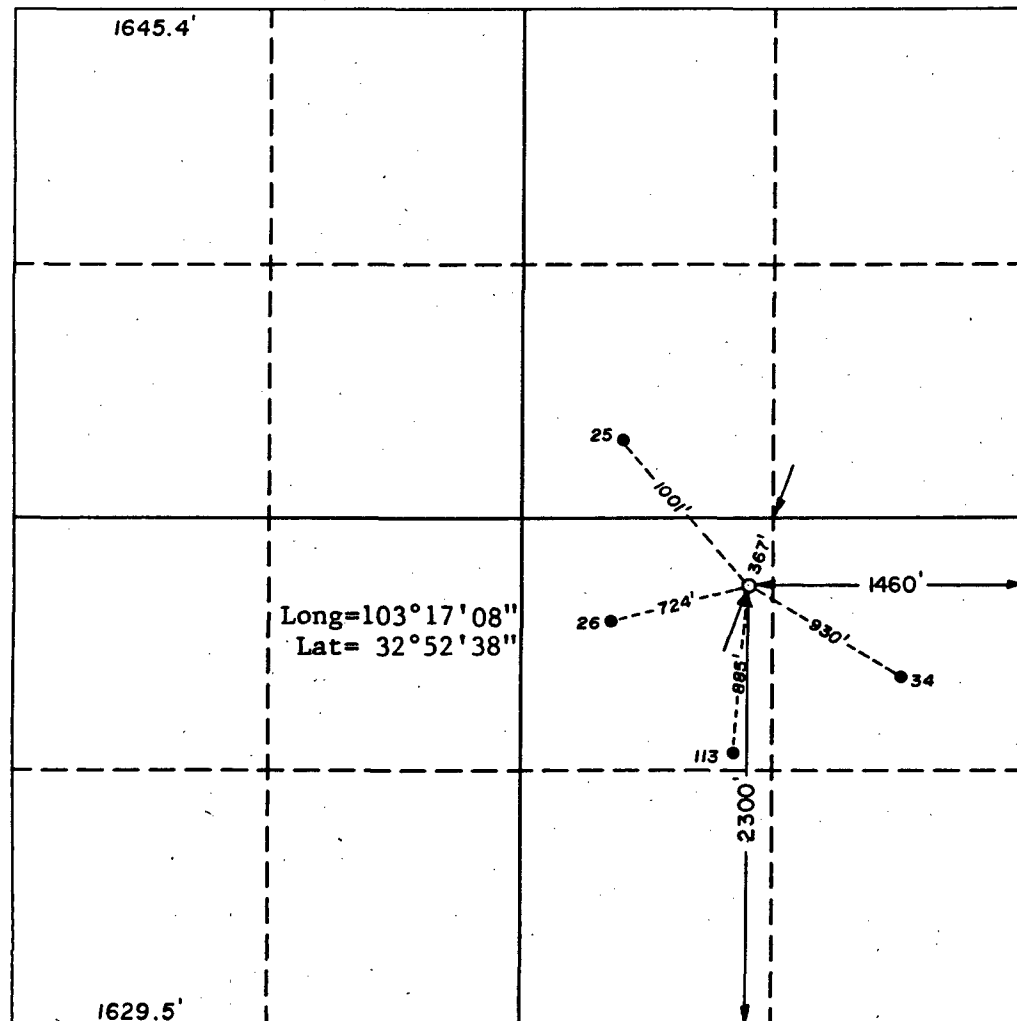

OPERATOR CERTIFICATION

I hereby certify the the information contained herein to true and complete to the best of my knowledge and belief.

Signature Michael J. Newport
Printed Name Michael J. Newport
Position Land Manager / Permian Busin
Company Greenhill Petroleum Corp
Date 3/27/92

SURVEYOR CERTIFICATION

I hereby certify that the well location shown on this plat was plotted from field notes of actual surveys made by me or under my supervision, and that the same is true and correct to the best of my knowledge and belief.

Date Surveyed
February 7, 1992
Signature & Seal of
Professional Surveyor

Certificate No. JOHN W. WEST 878
RONALD J. EDSON 8838
DAVE L. JONES 7877
92-100179

GREENHILL PETROLEUM CORPORATION
BOP PROGRAM FOR
LOVINGTON PADDOCK UNIT #130

Casing Program

BOP Program

Size	Depth	Wt.	Grade	Configuration	Test Pressure
8-5/8"	1300'	24	H40, STC	RA*	200 psi
5-1/2"	6450'	15.5	K55, STC	RR*	250/1500 psi

* = RR-Ram Ram
* = RA-Ram Annular

Diverter-Hydrill may be substituted for a diverter.

sjs:s
92.215

03/24/92

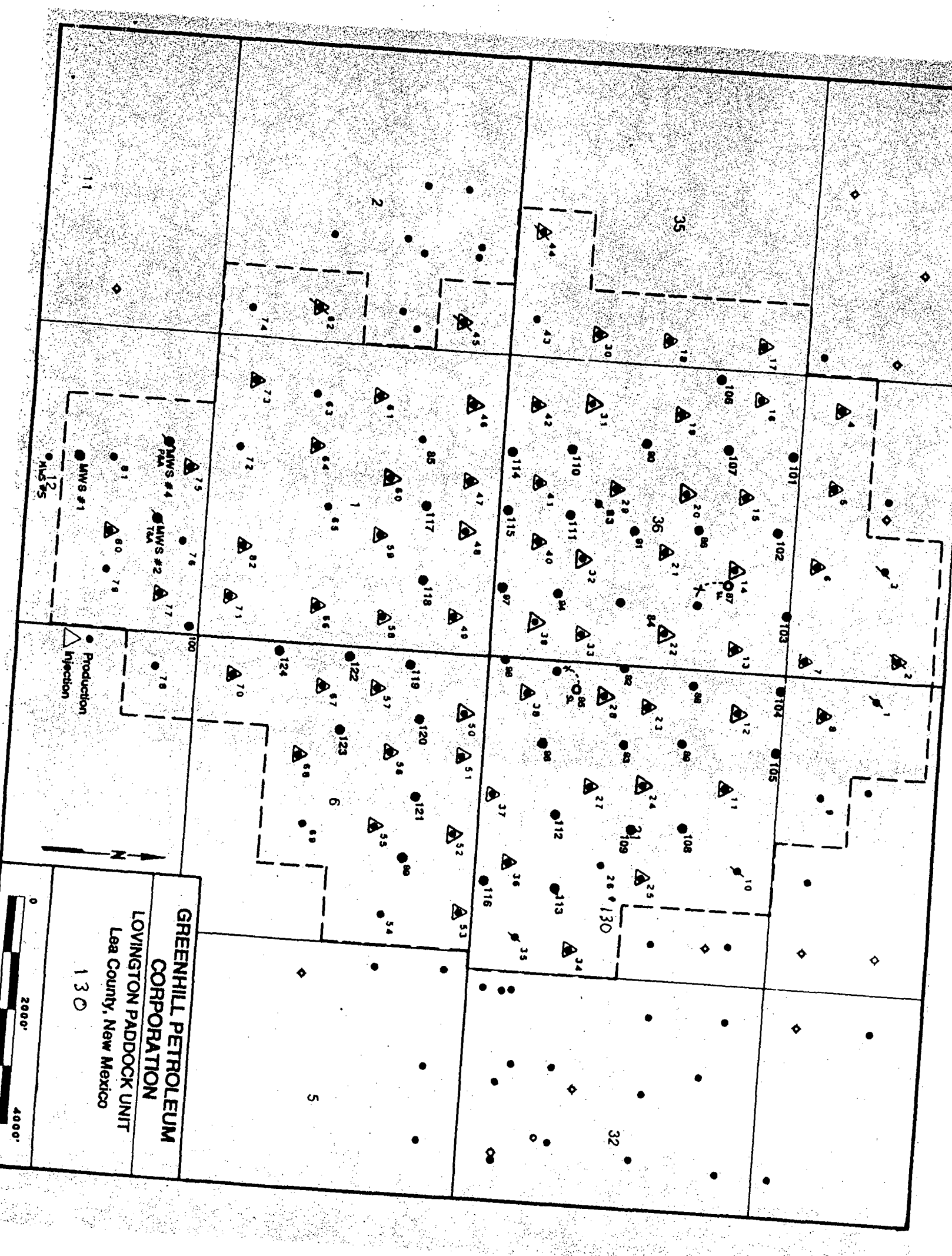



GREENHILL PETROLEUM CORPORATION

11490 WESTHEIMER ROAD, SUITE 200
HOUSTON, TEXAS 77077-6841
TELEPHONE (713) 589-8484
FAX. (713) 589-7892

Incorporated in Delaware, U.S.A.

March 24, 1992

Oil Conservation Division
State of New Mexico
Energy, Minerals and Natural Resources Department
P. O. Box 2088
Santa Fe, New Mexico 87504-2088

Attention: Mr. Mike Stogner

RE: Unorthodox Location and Drilling Permit
Proposed Well Number 131
Lovington Paddock Unit
Lea County, New Mexico

Dear Mr. Stogner:

Greenhill Petroleum Corporation respectfully requests the State of New Mexico Oil Conservation Division grant approval of the proposed unorthodox location and the attached permit to drill Well Number 131 in the Lovington Paddock Unit, located in Lea County, New Mexico.

The Lovington Paddock Unit is presently developed and being waterflooded utilizing a forty (40) acre well density. It is believed that infill development using a twenty (20) acre well density will improve waterflood sweep efficiency and will increase secondary oil recovery. The proposed location for Well Number 131 is located in the interior of the unit and is not competitive with offset wells outside the unit. Information gathered as a result of drilling this infill well will be utilized in evaluating additional infill development potential in the unit and ultimately may be used to evaluate the feasibility of tertiary recovery.

Greenhill Petroleum Corporation wishes to commence drilling operations on the proposed well as soon as possible and would appreciate a response to this request at your earliest convenience.

Respectfully yours,

Michael J. Newport
Land Manager - Permian Basin

MJN:sjs
92.204
Enclosures

Submit to Appropriate
District Office
State Lease - 6 copies
Fee Lease - 5 copies

State of New Mexico
Energy, Minerals and Natural Resources Department

Form C-101
Revised 1-1-89

OIL CONSERVATION DIVISION

P.O. Box 2088
Santa Fe, New Mexico 87504-2088

DISTRICT I
P.O. Box 1980, Hobbs, NM 88240

DISTRICT II
P.O. Drawer DD, Artesia, NM 88210

DISTRICT III
1000 Rio Brazos Rd., Aztec, NM 87410

API NO. (assigned by OCD on New Wells)

5. Indicate Type of Lease

STATE ☒

FEE ☐

6. State Oil & Gas Lease No.

B 7845

APPLICATION FOR PERMIT TO DRILL, DEEPEN, OR PLUG BACK

1a. Type of Work:

DRILL ☒

RE-ENTER ☐

DEEPEN ☐

PLUG BACK ☐

b. Type of Well:

OIL
WELL ☒

GAS
WELL ☐

OTHER ☐

SINGLE
ZONE ☐

MULTIPLE
ZONE ☐

7. Lease Name or Unit Agreement Name

Lovington Paddock Unit

2. Name of Operator

GREENHILL PETROLEUM CORPORATION

8. Well No.

131

3. Address of Operator

11490 Westheimer, Suite 200, Houston, Texas 77077

9. Pool name or Wildcat

Lovington Paddock

4. Well Location

Unit Letter M : 1028 Feet From The South Line and 230 Feet From The West Line

Section 36 Township 16 South Range 36 East NMPM Lea County

10. Proposed Depth

6450'

11. Formation

Paddock

12. Rotary or C.T.

Rotary

13. Elevations (Show whether DF, RT, GR, etc.)

3843 GR

14. Kind & Status Plug. Bond

on file

15. Drilling Contractor

TBD

16. Approx. Date Work will start

4-1-92

17.

PROPOSED CASING AND CEMENT PROGRAM

SIZE OF HOLE	SIZE OF CASING	WEIGHT PER FOOT	SETTING DEPTH	SACKS OF CEMENT	EST. TOP
12 1/4 "	8 5/8 "	24	1300'	550	surface
7 7/8 "	5 1/2 "	15.5	6450'	1100	surface

IN ABOVE SPACE DESCRIBE PROPOSED PROGRAM: IF PROPOSAL IS TO DEEPEN OR PLUG BACK, GIVE DATA ON PRESENT PRODUCTIVE ZONE AND PROPOSED NEW PRODUCTIVE ZONE. GIVE BLOWOUT PREVENTER PROGRAM, IF ANY.

I hereby certify that the information above is true and complete to the best of my knowledge and belief.

SIGNATURE

Michael J. Newport

TITLE Land Manager-Permian Basin DATE 3-24-92

TYPE OR PRINT NAME

Michael J. Newport

(713)

TELEPHONE NO. 589-8484

(This space for State Use)

APPROVED BY

TITLE

DATE

CONDITIONS OF APPROVAL, IF ANY:

OIL CONSERVATION DIVISION

P.O. Box 2088

Santa Fe, New Mexico 87504-2088

DISTRICT I

P.O. Box 1980, Hobbs, NM 88240

DISTRICT II

P.O. Drawer DD, Artesia, NM 88210

DISTRICT III

1000 Rio Brasos Rd., Artesia, NM 87410

WELL LOCATION AND ACREAGE DEDICATION PLAT

All Distances must be from the outer boundaries of the section

Operator Greenhill Petroleum Corp.			Lease Lovington Paddock Unit		Well No. 131
Unit Letter M M	Section 36	Township 16 South	Range 36 East	County Lea	

Actual Footage Location of Well:

1028 feet from the south line and	230 feet from the west line		
Ground Level Elev. 3843.2'	Producing Formation Lovington Paddock	Pool Lovington Paddock Unit	Dedicated Acreage: 40 Acres

1. Outline the acreage dedicated to the subject well by colored pencil or hatchure marks on the plat below.
2. If more than one lease is dedicated to the well, outline each and identify the ownership thereof (both as to working interest and royalty).
3. If more than one lease of different ownership is dedicated to the well, have the interest of all owners been consolidated by communitization, unitization, force-pooling, etc.?
☒ Yes ☐ No If answer is "yes" type of consolidation unitized

If answer is "no" list of owners and tract descriptions which have actually been consolidated. (Use reverse side of this form necessary.)

No allowable will be assigned to the well unit all interests have been consolidated (by communitization, unitization, forced-pooling, otherwise) or until a non-standard unit, eliminating such interest, has been approved by the Division.

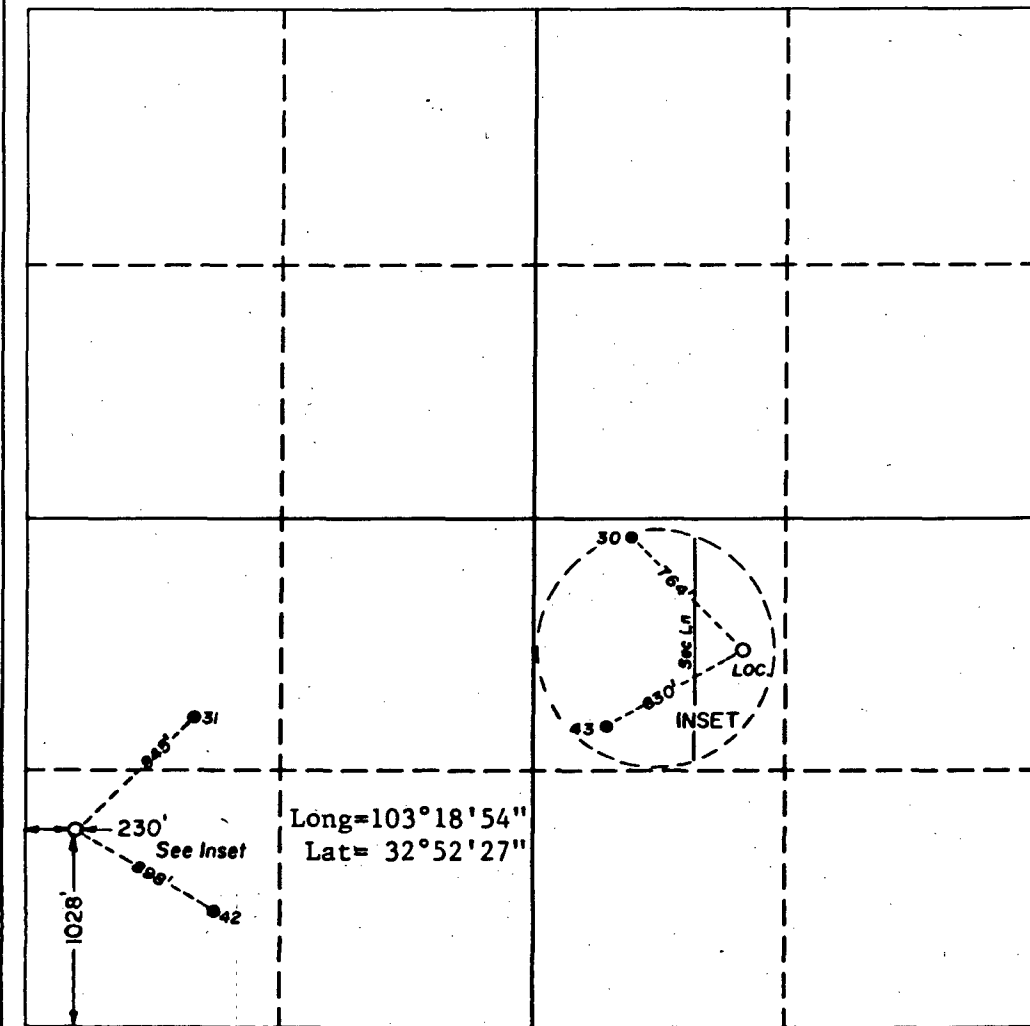

OPERATOR CERTIFICATION

I hereby certify the the information contained herein to true and complete to the best of my knowledge and belief.

Signature
Michael J. Newport

Printed Name
Land Manger-Permian Basin
Position

Greenhill Petroleum Corp.
Company
3-24-92

Date

SURVEYOR CERTIFICATION

I hereby certify that the well location shown on this plat was plotted from field notes of actual surveys made by me or under my supervision, and that the same is true and correct to the best of my knowledge and belief.

Date Surveyed
February 8, 1992

Signature & Seal of
Professional Surveyor

REGISTERED LAND SURVEYOR
Certificate No. 1 JOHN W. MEYER 676
RONALD E. EDSON 3239
GARY L. JONES 7977
NEW MEXICO
1992-11-0180

GREENHILL PETROLEUM CORPORATION
BOP PROGRAM FOR
LOVINGTON PADDOCK UNIT #131

Casing Program

BOP Program

Size	Depth	Wt.	Grade	Configuration	Test Pressure
8-5/8"	1300'	24	H40, STC	RA*	200 psi
5-1/2"	6450'	15.5	K55, STC	RR*	250/1500 psi

* = RR-Ram Ram
* = RA-Ram Annular

Diverter-Hydrill may be substituted for a diverter.

sjs:s
92.215

03/24/92



GREENHILL PETROLEUM CORPORATION

11490 WESTHEIMER ROAD, SUITE 200
HOUSTON, TEXAS 77077-6841
TELEPHONE (713) 589-8484
FAX. (713) 589-7892

Incorporated in Delaware, U.S.A.

March 24, 1992

Oil Conservation Division
State of New Mexico
Energy, Minerals and Natural Resources Department
P. O. Box 2088
Santa Fe, New Mexico 87504-2088

Attention: Mr. Mike Stogner

RE: Unorthodox Location and Drilling Permit
Proposed Well Number 133
Lovington Paddock Unit
Lea County, New Mexico

Dear Mr. Stogner:

Greenhill Petroleum Corporation respectfully requests the State of New Mexico Oil Conservation Division grant approval of the proposed unorthodox location and the attached permit to drill Well Number 133 in the Lovington Paddock Unit, located in Lea County, New Mexico.

The Lovington Paddock Unit is presently developed and being waterflooded utilizing a forty (40) acre well density. It is believed that infill development using a twenty (20) acre well density will improve waterflood sweep efficiency and will increase secondary oil recovery. The proposed location for Well Number 133 is located in the interior of the unit and is not competitive with offset wells outside the unit. Information gathered as a result of drilling this infill well will be utilized in evaluating additional infill development potential in the unit and ultimately may be used to evaluate the feasibility of tertiary recovery.

Greenhill Petroleum Corporation wishes to commence drilling operations on the proposed well as soon as possible and would appreciate a response to this request at your earliest convenience.

Respectfully yours,

Michael J. Newport
Michael J. Newport
Land Manager - Permian Basin

MJN:sjs
92.204
Enclosures

Submit to Appropriate
District Office
State Lease - 6 copies
Fee Lease - 5 copies

State of New Mexico
Energy, Minerals and Natural Resources Department

Form C-101
Revised 1-1-89

OIL CONSERVATION DIVISION

P.O. Box 2088
Santa Fe, New Mexico 87504-2088

DISTRICT I
P.O. Box 1980, Hobbs, NM 88240

DISTRICT II
P.O. Drawer DD, Artesia, NM 88210

DISTRICT III
1000 Rio Brazos Rd., Aztec, NM 87410

API NO. (assigned by OCD on New Wells)

5. Indicate Type of Lease

STATE ☒

FEE ☐

6. State Oil & Gas Lease No.

B 7766

APPLICATION FOR PERMIT TO DRILL, DEEPEN, OR PLUG BACK

1a. Type of Work:

DRILL ☒

RE-ENTER ☐

DEEPEN ☐

PLUG BACK ☐

b. Type of Well:

OIL
WELL ☒

GAS
WELL ☐

OTHER ☐

SINGLE
ZONE ☐

MULTIPLE
ZONE ☐

7. Lease Name or Unit Agreement Name

Lovington Paddock Unit

2. Name of Operator

GREENHILL PETROLEUM CORPORATION

8. Well No.

133

3. Address of Operator

11490 Westheimer, Suite 200, Houston, Texas 77077

9. Pool name or Wildcat

Lovington Paddock

4. Well Location

Unit Letter M : 100 Feet From The South Line and 260 Feet From The West Line

Section 36 Township 16 South Range 36 East NMMPM Lea County

10. Proposed Depth
6450'

11. Formation
Paddock

12. Rotary or C.T.
Rotary

13. Elevations (Show whether DF, RT, GR, etc.)

3838 GR

14. Kind & Status Plug. Bond

on file

15. Drilling Contractor

TBD

16. Approx. Date Work will start

4-1-92

17.

PROPOSED CASING AND CEMENT PROGRAM

SIZE OF HOLE	SIZE OF CASING	WEIGHT PER FOOT	SETTING DEPTH	SACKS OF CEMENT	EST. TOP
12 1/4 "	8 5/8 "	24	1300'	550	surface
7 7/8 "	5 1/2 "	15.5	6450'	1100	surface

IN ABOVE SPACE DESCRIBE PROPOSED PROGRAM: IF PROPOSAL IS TO DEEPEN OR PLUG BACK, GIVE DATA ON PRESENT PRODUCTIVE ZONE AND PROPOSED NEW PRODUCTIVE ZONE. GIVE BLOWOUT PREVENTER PROGRAM, IF ANY.

I hereby certify that the information above is true and complete to the best of my knowledge and belief.

SIGNATURE

Michael J. Newport

TITLE Land Manager-Permian Basin DATE 3-24-92

TYPE OR PRINT NAME

Michael J. Newport

(713)

TELEPHONE NO. 589-8484

(This space for State Use)

APPROVED BY

TITLE

DATE

CONDITIONS OF APPROVAL, IF ANY:

OIL CONSERVATION DIVISION

P.O. Box 2088

Santa Fe, New Mexico 87504-2088

DISTRICT I

P.O. Box 1900, Hobbs, NM 88240

DISTRICT II

P.O. Drawer DD, Artesia, NM 88210

DISTRICT III

1000 Rio Brazos Rd., Aztec, NM 87410

WELL LOCATION AND ACREAGE DEDICATION PLAT

All Distances must be from the outer boundaries of the section

Operator Greenhill Petroleum Corp.			Lease Lovington Paddock Unit		Well No. 133
Unit Letter M	Section 36	Township 16 South	Range 36 East	County Lea	
Actual Footage Location of Well: 100 feet from the south line and 260 feet from the west line					
Ground Level Elev. 3838.5'	Producing Formation Lovington Paddock		Pool Lovington Paddock Unit		Dedicated Acreage: 40 Acres

1. Outline the acreage dedicated to the subject well by colored pencil or hachure marks on the plat below.
2. If more than one lease is dedicated to the well, outline each and identify the ownership thereof (both as to working interest and royalty).
3. If more than one lease of different ownership is dedicated to the well, have the interest of all owners been consolidated by communitization, unitization, force-pooling, etc.?
☒ Yes ☐ No If answer is "yes" type of consolidation unitized

If answer is "no" list of owners and tract descriptions which have actually been consolidated. (Use reverse side of this form necessary.)

No allowable will be assigned to the well unit all interests have been consolidated (by communitization, unitization, forced-pooling, otherwise) or until a non-standard unit, eliminating such interest, has been approved by the Division.

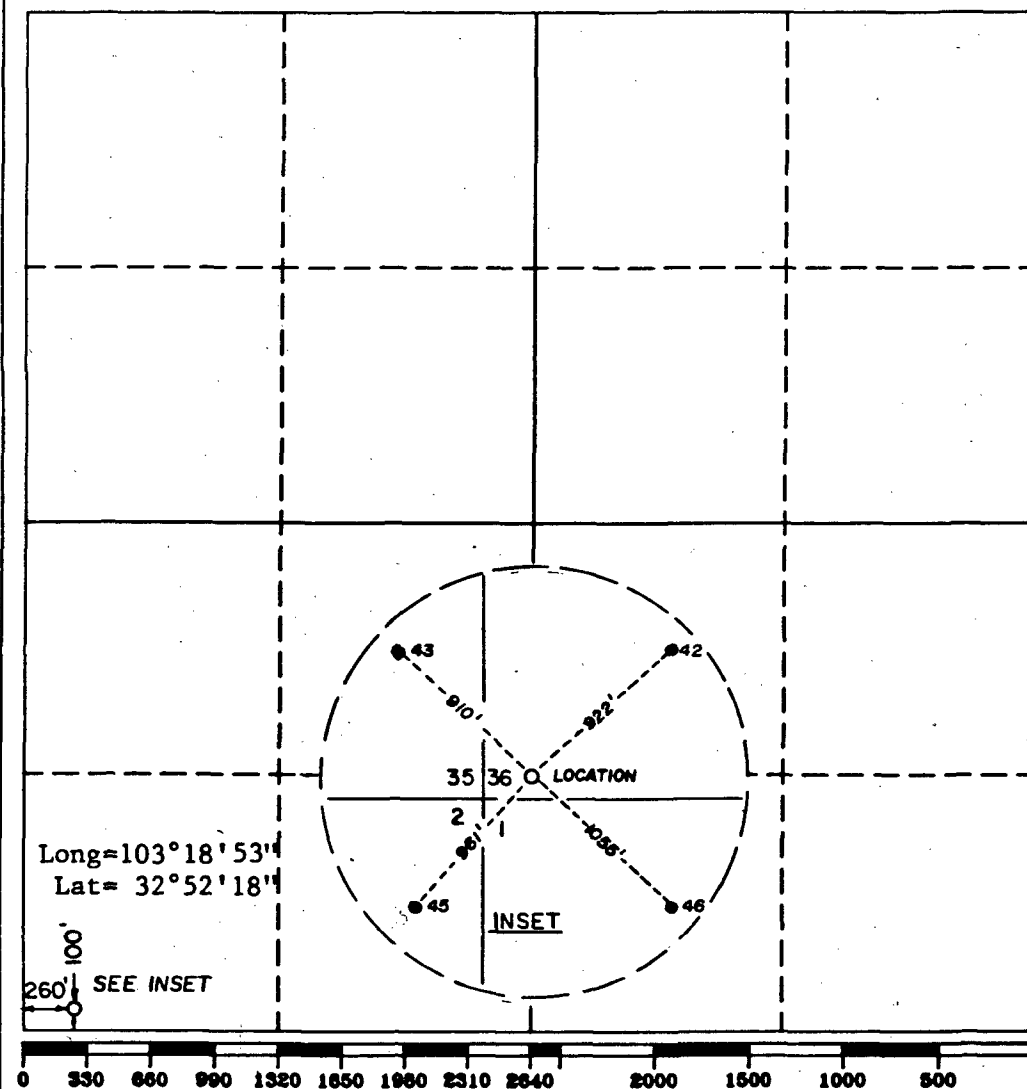

OPERATOR CERTIFICATION

I hereby certify the the information contained herein is true and complete to the best of my knowledge and belief.

Signature
Michael J. Newport
Printed Name
Land Manager-Permian Basin
Position
Greenhill Petroleum Corp.
Company
3-24-92
Date

SURVEYOR CERTIFICATION

I hereby certify that the well location shown on this plat was plotted from field notes of actual surveys made by me or under my supervision, and that the same is true and correct to the best of my knowledge and belief.

Date Surveyed
February 8, 1992

Signature & Seal of
Professional Surveyor

REGISTERED LAND SURVEYOR
Certificate No. 876
RONALD J. EIDSON, 3839
NEW MEXICO
GARY L. JONES, 7977
481-0182

GREENHILL PETROLEUM CORPORATION
BOP PROGRAM FOR
LOVINGTON PADDOCK UNIT #133

Casing Program

BOP Program

Size	Depth	Wt.	Grade	Configuration	Test Pressure
8-5/8"	1300'	24	H40, STC	RA*	200 psi
5-1/2"	6450'	15.5	K55, STC	RR*	250/1500 psi

* = RR-Ram Ram
* = RA-Ram Annular

Diverter-Hydrill may be substituted for a diverter.

sjs:s
92.215

03/24/92

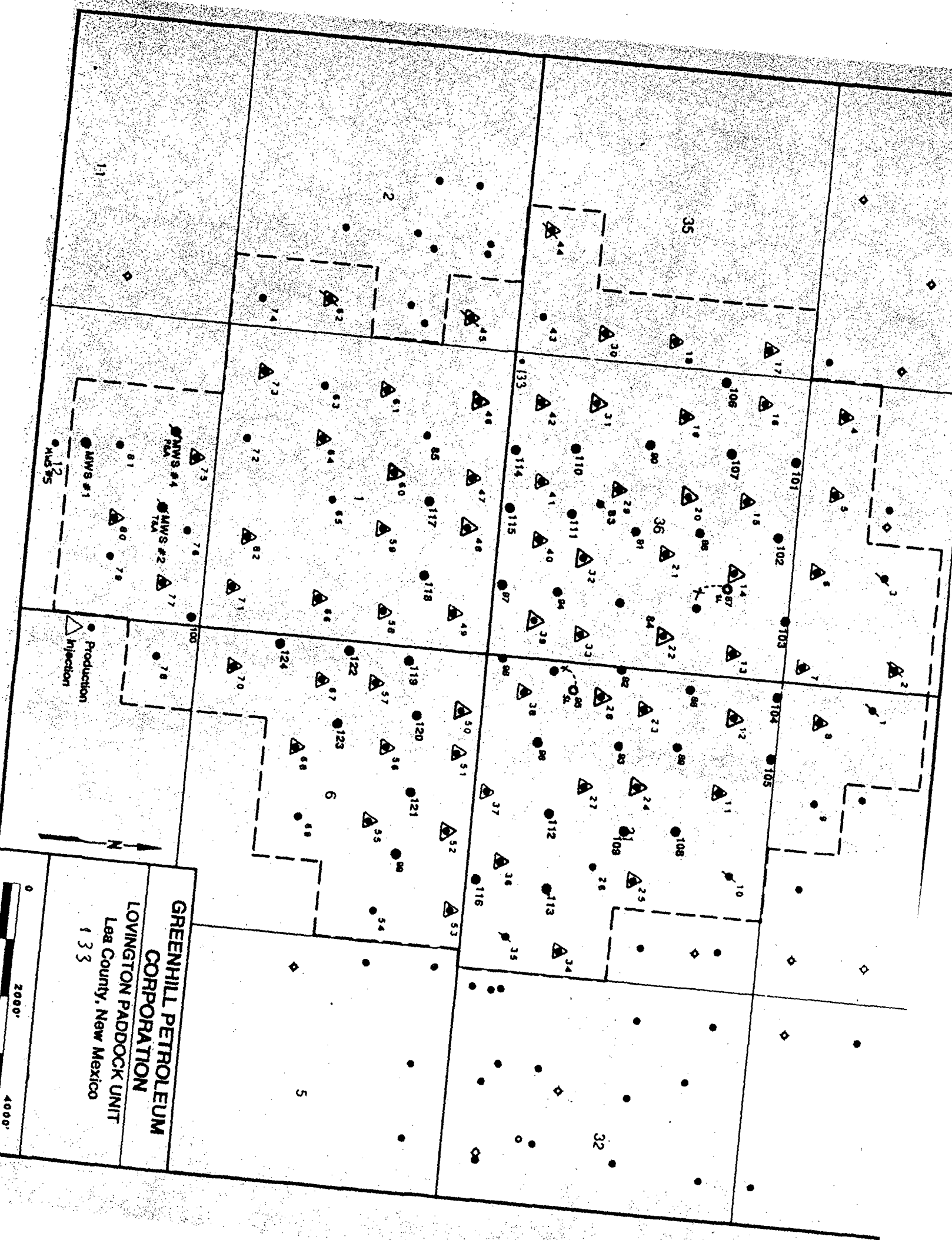



GREENHILL PETROLEUM CORPORATION

11490 WESTHEIMER ROAD, SUITE 200
HOUSTON, TEXAS 77077-6841
TELEPHONE (713) 589-8484
FAX. (713) 589-7892

Incorporated in Delaware, U.S.A.

March 24, 1992

Oil Conservation Division
State of New Mexico
Energy, Minerals and Natural Resources Department
P. O. Box 2088
Santa Fe, New Mexico 87504-2088

Attention: Mr. Mike Stogner

RE: Unorthodox Location and Drilling Permit
Proposed Well Number 135
Lovington Paddock Unit
Lea County, New Mexico

Dear Mr. Stogner:

Greenhill Petroleum Corporation respectfully requests the State of New Mexico Oil Conservation Division grant approval of the proposed unorthodox location and the attached permit to drill Well Number 135 in the Lovington Paddock Unit, located in Lea County, New Mexico.

The Lovington Paddock Unit is presently developed and being waterflooded utilizing a forty (40) acre well density. It is believed that infill development using a twenty (20) acre well density will improve waterflood sweep efficiency and will increase secondary oil recovery. The proposed location for Well Number 135 is located in the interior of the unit and is not competitive with offset wells outside the unit. Information gathered as a result of drilling this infill well will be utilized in evaluating additional infill development potential in the unit and ultimately may be used to evaluate the feasibility of tertiary recovery.

Greenhill Petroleum Corporation wishes to commence drilling operations on the proposed well as soon as possible and would appreciate a response to this request at your earliest convenience.

Respectfully yours,

Michael J. Newport
Land Manager - Permian Basin

MJN:sjs
92.204
Enclosures

Submit to Appropriate
District Office
State Lease - 6 copies
Fee Lease - 5 copies

State of New Mexico
Energy, Minerals and Natural Resources Department

Form C-101
Revised 1-1-89

OIL CONSERVATION DIVISION

P.O. Box 2088
Santa Fe, New Mexico 87504-2088

DISTRICT I
P.O. Box 1980, Hobbs, NM 88240

DISTRICT II
P.O. Drawer DD, Artesia, NM 88210

DISTRICT III
1000 Rio Brazos Rd., Aztec, NM 87410

API NO. (assigned by OCD on New Wells)

5. Indicate Type of Lease

STATE ☐

FEE ☒

6. State Oil & Gas Lease No.

APPLICATION FOR PERMIT TO DRILL, DEEPEN, OR PLUG BACK

1a. Type of Work:

DRILL ☒

RE-ENTER ☐

DEEPEN ☐

PLUG BACK ☐

b. Type of Well:

OIL
WELL ☒

GAS
WELL ☐

OTHER ☐

SINGLE
ZONE ☐

MULTIPLE
ZONE ☐

7. Lease Name or Unit Agreement Name

Lovington Paddock Unit

2. Name of Operator

GREENHILL PETROLEUM CORPORATION

8. Well No.

135

3. Address of Operator

11490 Westheimer, Suite 200, Houston, Texas 77077

9. Pool name or Wildcat

Lovington Paddock

4. Well Location

Unit Letter

B

: 137

Feet From The

North

Line and

2485

Feet From The

East

Line

Section

6

Township

17 South

Range

37 East

NMPM

Lea

County

10. Proposed Depth

6450'

11. Formation

Paddock

12. Rotary or C.T.

Rotary

13. Elevations (Show whether DF, RT, GR, etc.)

3807 GR

14. Kind & Status Plug. Bond

on file

15. Drilling Contractor

TBD

16. Approx. Date Work will start

4-1-92

17.

PROPOSED CASING AND CEMENT PROGRAM

SIZE OF HOLE	SIZE OF CASING	WEIGHT PER FOOT	SETTING DEPTH	SACKS OF CEMENT	EST. TOP
12 1/4 "	8 5/8 "	24	1300'	550	surface
7 7/8 "	5 1/2 "	15.5	6450'	1100	surface

IN ABOVE SPACE DESCRIBE PROPOSED PROGRAM: IF PROPOSAL IS TO DEEPEN OR PLUG BACK, GIVE DATA ON PRESENT PRODUCTIVE ZONE AND PROPOSED NEW PRODUCTIVE ZONE. GIVE BLOWOUT PREVENTER PROGRAM, IF ANY.

I hereby certify that the information above is true and complete to the best of my knowledge and belief.

SIGNATURE

Michael J. Newport

TITLE Land Manager-Permian Basin

DATE 3-24-92

TYPE OR PRINT NAME

Michael J. Newport

(713)

TELEPHONE NO. 589-8484

(This space for State Use)

APPROVED BY

TITLE

DATE

CONDITIONS OF APPROVAL, IF ANY:

OIL CONSERVATION DIVISION

P.O. Box 2088

Santa Fe, New Mexico 87504-2088

DISTRICT I

P.O. Box 1960, Hobbs, NM 88240

DISTRICT II

P.O. Drawer DD, Artesia, NM 88210

DISTRICT III

1000 Rio Brazos Rd., Artesia, NM 87410

WELL LOCATION AND ACREAGE DEDICATION PLAT

All Distances must be from the outer boundaries of the section

Operator Greenhill Petroleum Corp.			Lease Lovington Paddock Unit		Well No. 135
Unit Letter B	Section 6	Township 17 South	Range 37 East	NMPM	County Lea

Actual Footage Location of Well:

137	feet from the north line and	2485	feet from the east line
Ground Level Elev. 3807.8'	Producing Formation Lovington Paddock	Pool Lovington Paddock Unit	Dedicated Acreage: 40 Acres

- Outline the acreage dedicated to the subject well by colored pencil or hatchure marks on the plat below.
- If more than one lease is dedicated to the well, outline each and identify the ownership thereof (both as to working interest and royalty).
- If more than one lease of different ownership is dedicated to the well, have the interest of all owners been consolidated by communitization, unitization, force-pooling, etc.?
☒ Yes ☐ No If answer is "yes" type of consolidation unitized

If answer is "no" list of owners and tract descriptions which have actually been consolidated. (Use reverse side of this form necessary.)

No allowable will be assigned to the well unit all interests have been consolidated (by communitization, unitization, forced-pooling, otherwise) or until a non-standard unit, eliminating such interest, has been approved by the Division.

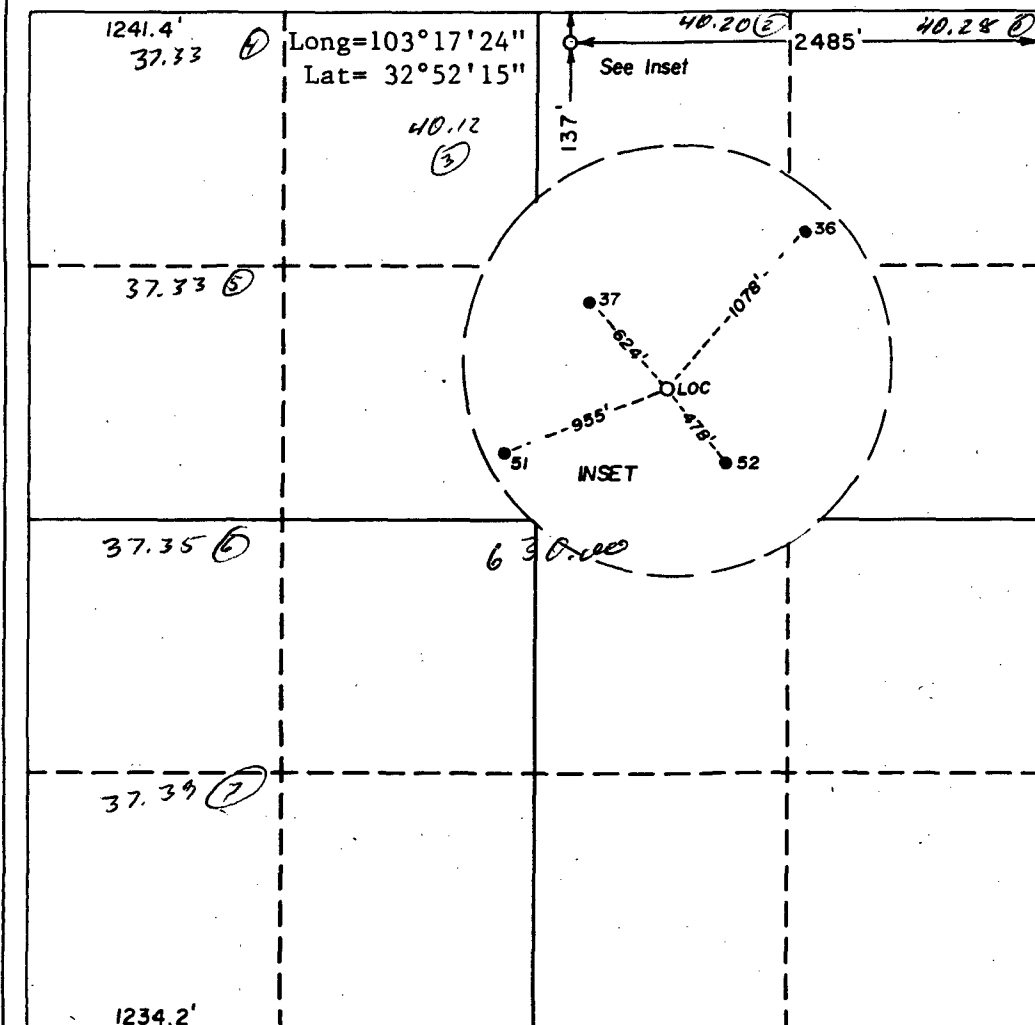

OPERATOR CERTIFICATION

I hereby certify the the information contained herein to true and complete to the best of my knowledge and belief.

Michael J. Newport

Signature
Michael J. Newport

Printed Name
Land Manager-Permian Basin
Position
GREENHILL PETROLEUM CORP.

Company
3-24-92

Date

SURVEYOR CERTIFICATION

I hereby certify that the well location shown on this plat was plotted from field notes of actual surveys made by me or under my supervision, and that the same is true and correct to the best of my knowledge and belief.

Date Surveyed
February 10, 1992

Signature & Seal of
Professional Surveyor

Ronald J. Edson
REGISTERED LAND SURVEYOR
Certificate No. JOHN W. WEST 678
RONALD J. EDSON 3239
GARY A. JONES 7977
W.O. 92-11-0184

GREENHILL PETROLEUM CORPORATION
BOP PROGRAM FOR
LOVINGTON PADDOCK UNIT #135

Casing Program

BOP Program

Size	Depth	Wt.	Grade	Configuration	Test Pressure
8-5/8"	1300'	24	H40, STC	RA*	200 psi
5-1/2"	6450'	15.5	K55, STC	RR*	250/1500 psi

* = RR-Ram Ram

* = RA-Ram Annular

Diverter-Hydrill may be substituted for a diverter.

sjs:s
92.215

03/24/92

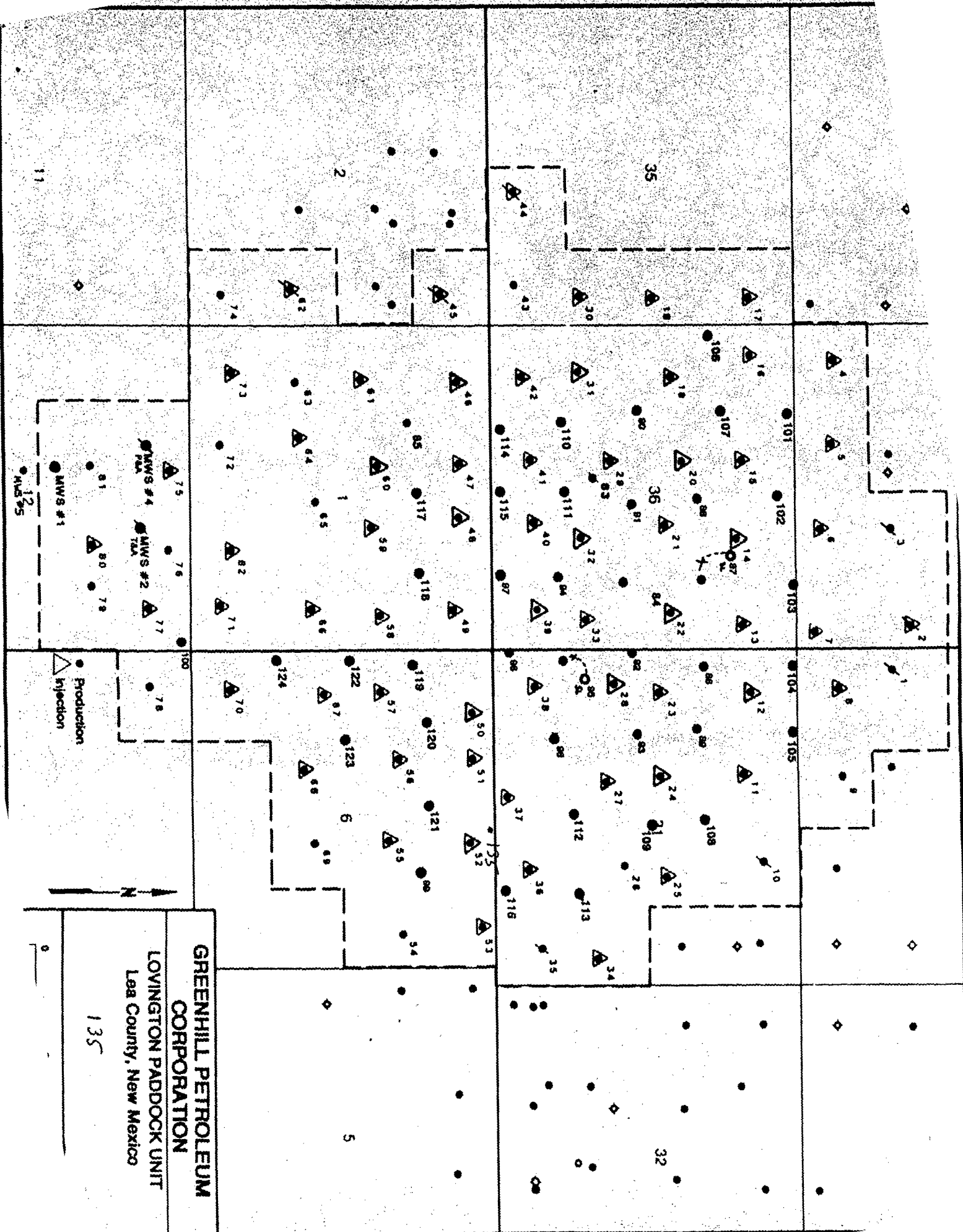

GREENHILL PETROLEUM CORPORATION
LOVINGTON PADDOCK UNIT
 Lea County, New Mexico

135



GREENHILL PETROLEUM CORPORATION

11490 WESTHEIMER ROAD, SUITE 200
HOUSTON, TEXAS 77077-6841
TELEPHONE (713) 589-8484
FAX (713) 589-7892

Incorporated in Delaware, U.S.A.

March 24, 1992

Oil Conservation Division
State of New Mexico
Energy, Minerals and Natural Resources Department
P. O. Box 2088
Santa Fe, New Mexico 87504-2088

Attention: Mr. Mike Stogner

RE: Unorthodox Location and Drilling Permit
Proposed Well Number 136
Lovington Paddock Unit
Lea County, New Mexico

Dear Mr. Stogner:

Greenhill Petroleum Corporation respectfully requests the State of New Mexico Oil Conservation Division grant approval of the proposed unorthodox location and the attached permit to drill Well Number 136 in the Lovington Paddock Unit, located in Lea County, New Mexico.

The Lovington Paddock Unit is presently developed and being waterflooded utilizing a forty (40) acre well density. It is believed that infill development using a twenty (20) acre well density will improve waterflood sweep efficiency and will increase secondary oil recovery. The proposed location for Well Number 136 is located in the interior of the unit and is not competitive with offset wells outside the unit. Information gathered as a result of drilling this infill well will be utilized in evaluating additional infill development potential in the unit and ultimately may be used to evaluate the feasibility of tertiary recovery.

Greenhill Petroleum Corporation wishes to commence drilling operations on the proposed well as soon as possible and would appreciate a response to this request at your earliest convenience.

Respectfully yours,

Michael J. Newport
Michael J. Newport
Land Manager - Permian Basin

MJN:sjs
92.204
Enclosures

Submit to Appropriate
District Office
State Lease - 6 copies
Fee Lease - 5 copies

State of New Mexico
Energy, Minerals and Natural Resources Department

Form C-101
Revised 1-1-89

OIL CONSERVATION DIVISION

P.O. Box 2088
Santa Fe, New Mexico 87504-2088

DISTRICT I
P.O. Box 1980, Hobbs, NM 88240

DISTRICT II
P.O. Drawer DD, Artesia, NM 88210

DISTRICT III
1000 Rio Brazos Rd., Aztec, NM 87410

API NO. (assigned by OCD on New Wells)

5. Indicate Type of Lease

STATE ☒

FEE ☐

6. State Oil & Gas Lease No.

B 1553

APPLICATION FOR PERMIT TO DRILL, DEEPEN, OR PLUG BACK

1a. Type of Work:

DRILL ☒

RE-ENTER ☐

DEEPEN ☐

PLUG BACK ☐

b. Type of Well:

OIL

WELL ☒

GAS

WELL ☐

OTHER ☐

SINGLE

ZONE ☐

MULTIPLE

ZONE ☐

7. Lease Name or Unit Agreement Name

Lovington Paddock Unit

2. Name of Operator

GREENHILL PETROLEUM CORPORATION

3. Address of Operator

11490 Westheimer, Suite 200, Houston, Texas 77077

8. Well No.

136

9. Pool name or Wildcat

Lovington Paddock

4. Well Location

Unit Letter E : 1380 Feet From The North Line and 400 Feet From The West Line

Section 1 Township 17 South Range 36 East NMPM Lea County

10. Proposed Depth
6450'

11. Formation
Paddock

12. Rotary or C.T.
Rotary

13. Elevations (Show whether DF, RT, GR, etc.)

3837GR

14. Kind & Status Plug. Bond
on file

15. Drilling Contractor
TBD

16. Approx. Date Work will start
4-1-92

17.

PROPOSED CASING AND CEMENT PROGRAM

SIZE OF HOLE	SIZE OF CASING	WEIGHT PER FOOT	SETTING DEPTH	SACKS OF CEMENT	EST. TOP
12 1/4 "	8 5/8 "	24	1300'	550	surface
7 7/8 "	5 1/2 "	15.5	6450'	1100	surface

IN ABOVE SPACE DESCRIBE PROPOSED PROGRAM: IF PROPOSAL IS TO DEEPEN OR PLUG BACK, GIVE DATA ON PRESENT PRODUCTIVE ZONE AND PROPOSED NEW PRODUCTIVE ZONE. GIVE BLOWOUT PREVENTER PROGRAM, IF ANY.

I hereby certify that the information above is true and complete to the best of my knowledge and belief.

SIGNATURE Michael J. Newport TITLE Land Manager-Permian Basin DATE 3-24-92

TYPE OR PRINT NAME Michael J. Newport (713) TELEPHONE NO. 589-8484

(This space for State Use)

APPROVED BY _____ TITLE _____ DATE _____

CONDITIONS OF APPROVAL, IF ANY:

OIL CONSERVATION DIVISION

P.O. Box 2088
Santa Fe, New Mexico 87504-2088

DISTRICT I

P.O. Box 1980, Hobbs, NM 88240

DISTRICT II

P.O. Drawer DD, Artesia, NM 88210

DISTRICT III

1000 Rio Brazos Rd., Artesia, NM 87410

WELL LOCATION AND ACREAGE DEDICATION PLAT

All Distances must be from the outer boundaries of the section

Operator Greenhill Petroleum Corp.			Lease Lovington Paddock Unit		Well No. 136
Unit Letter E	Section 1	Township 17 South	Range 36 East	County Lea	

Actual Footage Location of Well:

1380 feet from the north line and		400 feet from the west line	
Ground Level Elev. 3837.5'	Producing Formation Lovington Paddock	Pool Lovington Paddock	Dedicated Acreage: 46 Acres

1. Outline the acreage dedicated to the subject well by colored pencil or hatchure marks on the plat below.
2. If more than one lease is dedicated to the well, outline each and identify the ownership thereof (both as to working interest and royalty).
3. If more than one lease of different ownership is dedicated to the well, have the interest of all owners been consolidated by communitization, unitization, force-pooling, etc.?
☒ Yes ☐ No If answer is "yes" type of consolidation unitized

If answer is "no" list of owners and tract descriptions which have actually been consolidated. (Use reverse side of this form necessary.)

No allowable will be assigned to the well unit all interests have been consolidated (by communitization, unitization, forced-pooling, otherwise) or until a non-standard unit, eliminating such interest, has been approved by the Division.

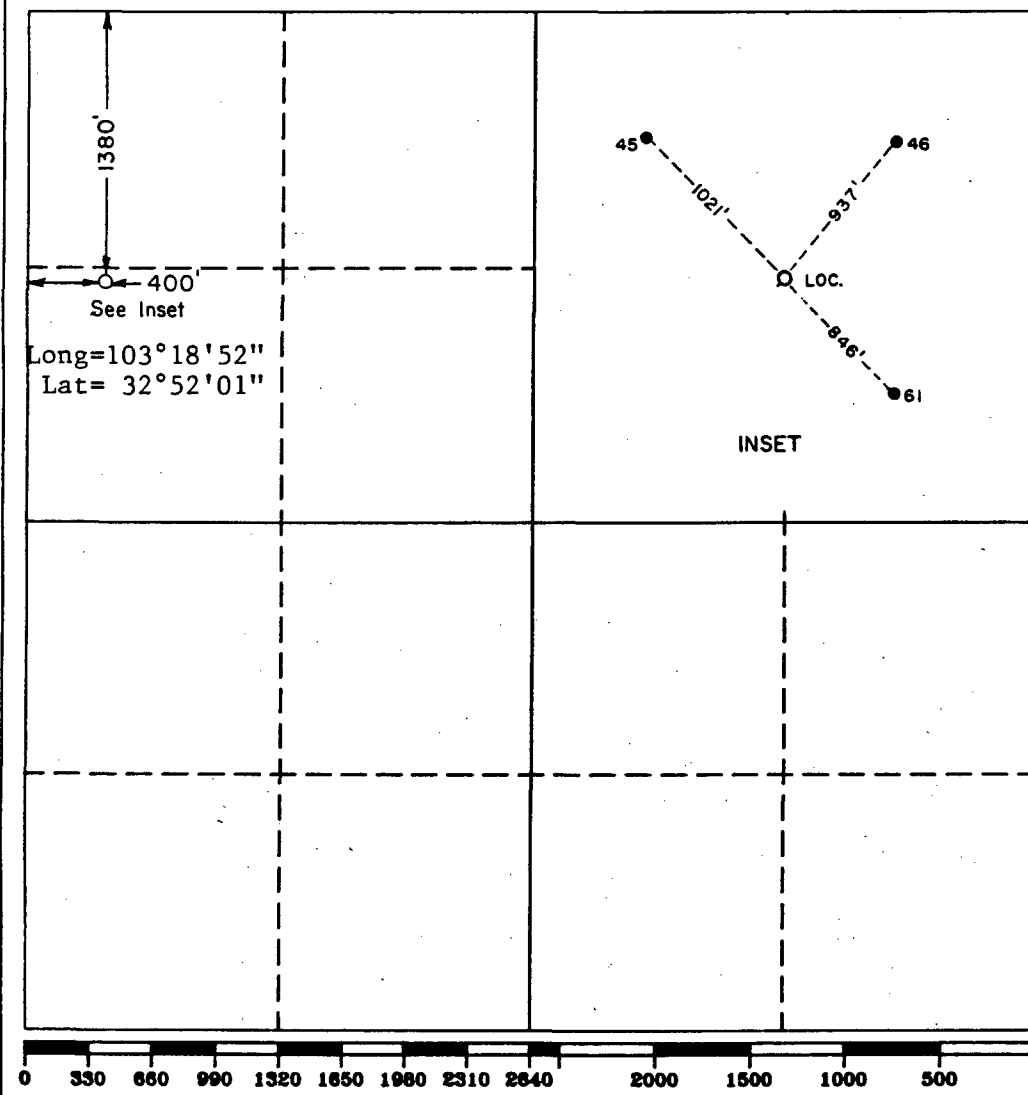

OPERATOR CERTIFICATION

I hereby certify the the information contained herein is true and complete to the best of my knowledge and belief.

Signature
Michael J. Newport
Printed Name
Michael J. Newport
Position
Land Manager
Company
Greenhill Petroleum Corp
Date
3/27/92

SURVEYOR CERTIFICATION

I hereby certify that the well location shown on this plat was plotted from field notes of actual surveys made by me or under my supervision, and that the same is true and correct to the best of my knowledge and belief.

Date Surveyed
February 11, 1992

Signature & Seal of
Professional Surveyor

Donald J. Eidson
Certificate No. JOHN W. WEST 476
RONALD J. EIDSON 2838
GARY L. JONES 1977
W.O. 32-4146185
DONALD J. EIDSON

GREENHILL PETROLEUM CORPORATION
BOP PROGRAM FOR
LOVINGTON PADDOCK UNIT #136

Casing Program

BOP Program

Size	Depth	Wt.	Grade	Configuration	Test Pressure
8-5/8"	1300'	24	H40, STC	RA*	200 psi
5-1/2"	6450'	15.5	K55, STC	RR*	250/1500 psi

* = RR-Ram Ram
* = RA-Ram Annular

Diverter-Hydrill may be substituted for a diverter.

sjs:s
92.215

03/24/92



GREENHILL PETROLEUM CORPORATION

11490 WESTHEIMER ROAD, SUITE 200
HOUSTON, TEXAS 77077-6841
TELEPHONE (713) 589-8484
FAX. (713) 589-7892

Incorporated in Delaware, U.S.A.

March 24, 1992

Oil Conservation Division
State of New Mexico
Energy, Minerals and Natural Resources Department
P. O. Box 2088
Santa Fe, New Mexico 87504-2088

Attention: Mr. Mike Stogner

RE: Unorthodox Location and Drilling Permit
Proposed Well Number 139
Lovington Paddock Unit
Lea County, New Mexico

Dear Mr. Stogner:

Greenhill Petroleum Corporation respectfully requests the State of New Mexico Oil Conservation Division grant approval of the proposed unorthodox location and the attached permit to drill Well Number 139 in the Lovington Paddock Unit, located in Lea County, New Mexico.

The Lovington Paddock Unit is presently developed and being waterflooded utilizing a forty (40) acre well density. It is believed that infill development using a twenty (20) acre well density will improve waterflood sweep efficiency and will increase secondary oil recovery. The proposed location for Well Number 139 is located in the interior of the unit and is not competitive with offset wells outside the unit. Information gathered as a result of drilling this infill well will be utilized in evaluating additional infill development potential in the unit and ultimately may be used to evaluate the feasibility of tertiary recovery.

Greenhill Petroleum Corporation wishes to commence drilling operations on the proposed well as soon as possible and would appreciate a response to this request at your earliest convenience.

Respectfully yours,

Michael J. Newport
Land Manager - Permian Basin

MJN:sjs
92.204
Enclosures

Submit to Appropriate
District Office
State Lease - 6 copies
Fee Lease - 5 copies

State of New Mexico
Energy, Minerals and Natural Resources Department

Form C-101
Revised 1-1-89

OIL CONSERVATION DIVISION

P.O. Box 2088
Santa Fe, New Mexico 87504-2088

DISTRICT I
P.O. Box 1980, Hobbs, NM 88240

DISTRICT II
P.O. Drawer DD, Artesia, NM 88210

DISTRICT III
1000 Rio Brazos Rd., Aztec, NM 87410

API NO. (assigned by OCD on New Wells)

5. Indicate Type of Lease

STATE ☒

FEE ☐

6. State Oil & Gas Lease No.

B 1553

APPLICATION FOR PERMIT TO DRILL, DEEPEN, OR PLUG BACK

1a. Type of Work:

DRILL ☒

RE-ENTER ☐

DEEPEN ☐

PLUG BACK ☐

b. Type of Well:

OIL
WELL ☒

GAS
WELL ☐

OTHER ☐

SINGLE
ZONE ☐

MULTIPLE
ZONE ☐

7. Lease Name or Unit Agreement Name

Lovington Paddock Unit

2. Name of Operator

GREENHILL PETROLEUM CORPORATION

8. Well No.

139

3. Address of Operator

11490 Westheimer, Suite 200, Houston, Texas 77077

9. Pool name or Wildcat

Lovington Paddock

4. Well Location

Unit Letter

F

: 2527

Feet From The

North

Line and

1550

Feet From The

West

Line

Section

1

Township

17 South

Range

36 East

NMPM

Lea

County

10. Proposed Depth

6450'

11. Formation

Paddock

12. Rotary or C.T.

Rotary

13. Elevations (Show whether DF, RT, GR, etc.)

3829 GR

14. Kind & Status Plug. Bond

on file

15. Drilling Contractor

TBD

16. Approx. Date Work will start

4-1-92

17.

PROPOSED CASING AND CEMENT PROGRAM

SIZE OF HOLE	SIZE OF CASING	WEIGHT PER FOOT	SETTING DEPTH	SACKS OF CEMENT	EST. TOP
12 1/4 "	8 5/8 "	24	1300'	550	surface
7 7/8 "	5 1/2 "	15.5	6450'	1100	surface

IN ABOVE SPACE DESCRIBE PROPOSED PROGRAM: IF PROPOSAL IS TO DEEPEN OR PLUG BACK, GIVE DATA ON PRESENT PRODUCTIVE ZONE AND PROPOSED NEW PRODUCTIVE ZONE. GIVE BLOWOUT PREVENTER PROGRAM, IF ANY.

I hereby certify that the information above is true and complete to the best of my knowledge and belief.

SIGNATURE

Michael J. Newport

TITLE Land Manager-Permian Basin DATE 3-24-92

TYPE OR PRINT NAME

Michael J. Newport

(713)

TELEPHONE NO. 589-8484

(This space for State Use)

APPROVED BY

TITLE

DATE

CONDITIONS OF APPROVAL, IF ANY:

OIL CONSERVATION DIVISION

P.O. Box 2088
Santa Fe, New Mexico 87504-2088

DISTRICT I

P.O. Box 1980, Hobbs, NM 88240

DISTRICT II

P.O. Drawer DD, Artesia, NM 88210

DISTRICT III

1000 Rio Brazos Rd., Artesia, NM 87410

WELL LOCATION AND ACREAGE DEDICATION PLAT

All Distances must be from the outer boundaries of the section

Operator Greenhill Petroleum Corp.			Lease Lovington Paddock Unit		Well No. 139
Unit Letter F	Section 1	Township 17 South	Range 36 East	County Lea	

Actual Footage Location of Well:

2527 feet from the north line and	1550 feet from the west line
Ground Level Elev. 3829.8'	Producing Formation Lovington Paddock
Pool Lovington Paddock Unit	
Dedicated Acreage: 40 Acres	

- Outline the acreage dedicated to the subject well by colored pencil or hatchure marks on the plat below.
- If more than one lease is dedicated to the well, outline each and identify the ownership thereof (both as to working interest and royalty).
- If more than one lease of different ownership is dedicated to the well, have the interest of all owners been consolidated by communitization, unitization, force-pooling, etc.?
☒ Yes ☐ No If answer is "yes" type of consolidation unitized

If answer is "no" list of owners and tract descriptions which have actually been consolidated. (Use reverse side of this form necessary.)

No allowable will be assigned to the well unit all interests have been consolidated (by communitization, unitization, forced-pooling, otherwise) or until a non-standard unit, eliminating such interest, has been approved by the Division.

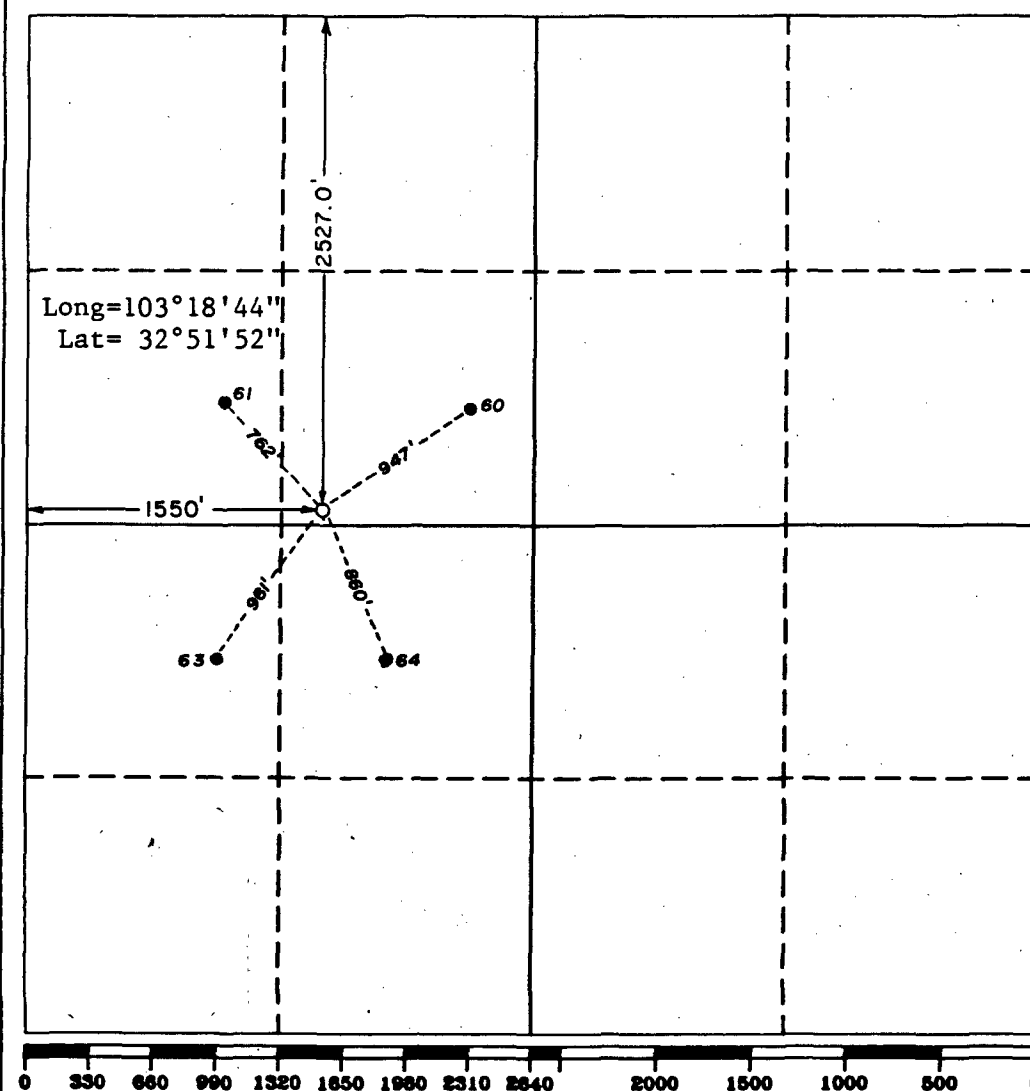

OPERATOR CERTIFICATION

I hereby certify that the information contained herein is true and complete to the best of my knowledge and belief.

Michael J. Newport
Signature

Michael J. Newport
Printed Name

Land Manager-Permian Basin
Position

GREENHILL PETROLEUM CORP.
Company
3-24-92
Date

SURVEYOR CERTIFICATION

I hereby certify that the well location shown on this plat was plotted from field notes of actual surveys made by me or under my supervision, and that the same is true and correct to the best of my knowledge and belief.

Date Surveyed
February 12, 1992

Signature & Seal of
Professional Surveyor

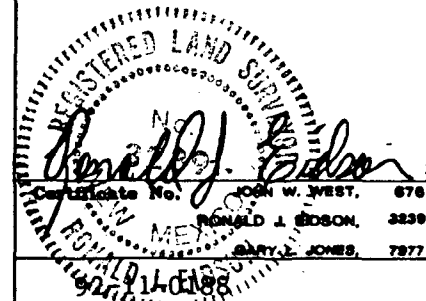

GREENHILL PETROLEUM CORPORATION
BOP PROGRAM FOR
LOVINGTON PADDOCK UNIT #139

Casing Program

BOP Program

Size	Depth	Wt.	Grade	Configuration	Test Pressure
8-5/8"	1300'	24	H40, STC	RA*	200 psi
5-1/2"	6450'	15.5	K55, STC	RR*	250/1500 psi

* = RR-Ram Ram
* = RA-Ram Annular

Diverter-Hydrill may be substituted for a diverter.

sjs:s
92.215

03/24/92

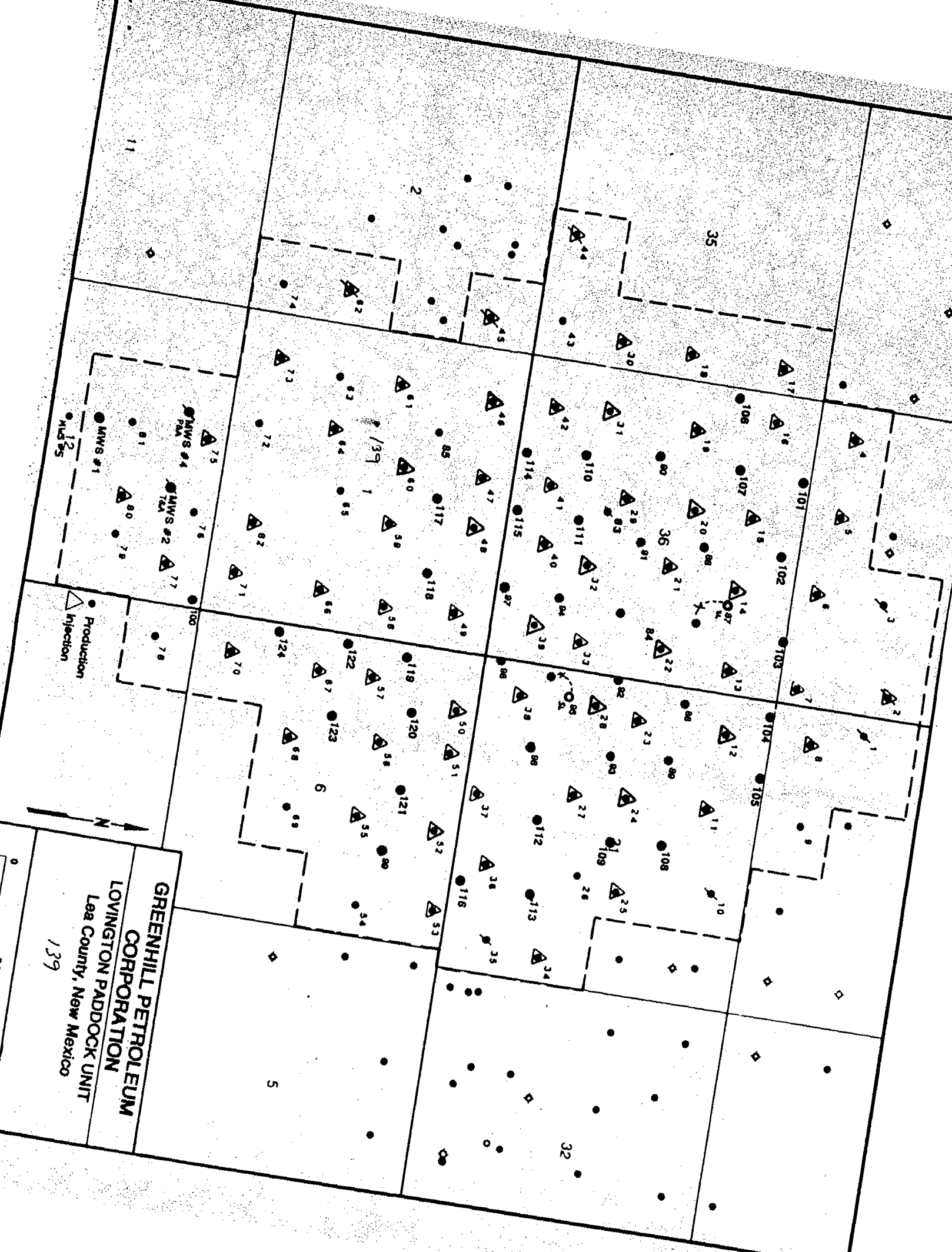

GREENHILL PETROLEUM

CORPORATION

LOVINGTON PADDOCK UNIT

Lea County, New Mexico

139



GREENHILL PETROLEUM CORPORATION

11490 WESTHEIMER ROAD, SUITE 200
HOUSTON, TEXAS 77077-6841
TELEPHONE (713) 589-8484
FAX. (713) 589-7892

Incorporated in Delaware, U.S.A.

March 24, 1992

Oil Conservation Division
State of New Mexico
Energy, Minerals and Natural Resources Department
P. O. Box 2088
Santa Fe, New Mexico 87504-2088

Attention: Mr. Mike Stogner

RE: Unorthodox Location and Drilling Permit
Proposed Well Number 142
Lovington Paddock Unit
Lea County, New Mexico

Dear Mr. Stogner:

Greenhill Petroleum Corporation respectfully requests the State of New Mexico Oil Conservation Division grant approval of the proposed unorthodox location and the attached permit to drill Well Number 142 in the Lovington Paddock Unit, located in Lea County, New Mexico.

The Lovington Paddock Unit is presently developed and being waterflooded utilizing a forty (40) acre well density. It is believed that infill development using a twenty (20) acre well density will improve waterflood sweep efficiency and will increase secondary oil recovery. The proposed location for Well Number 142 is located in the interior of the unit and is not competitive with offset wells outside the unit. Information gathered as a result of drilling this infill well will be utilized in evaluating additional infill development potential in the unit and ultimately may be used to evaluate the feasibility of tertiary recovery.

Greenhill Petroleum Corporation wishes to commence drilling operations on the proposed well as soon as possible and would appreciate a response to this request at your earliest convenience.

Respectfully yours,

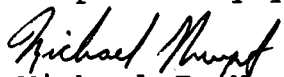
Michael J. Newport
Land Manager - Permian Basin

MJN:sjs
92.204
Enclosures

Submit to Appropriate
District Office
State Lease - 6 copies
Fee Lease - 5 copies

State of New Mexico
Energy, Minerals and Natural Resources Department

Form C-101
Revised 1-1-89

OIL CONSERVATION DIVISION

P.O. Box 2088
Santa Fe, New Mexico 87504-2088

DISTRICT I
P.O. Box 1980, Hobbs, NM 88240

DISTRICT II
P.O. Drawer DD, Artesia, NM 88210

DISTRICT III
1000 Rio Brazos Rd., Aztec, NM 87410

API NO. (assigned by OCD on New Wells)

5. Indicate Type of Lease

STATE ☐

FEE ☒

6. State Oil & Gas Lease No.

APPLICATION FOR PERMIT TO DRILL, DEEPEN, OR PLUG BACK

1a. Type of Work:

DRILL ☒

RE-ENTER ☐

DEEPEN ☐

PLUG BACK ☐

b. Type of Well:

OIL
WELL ☒

GAS
WELL ☐

OTHER ☐

SINGLE
ZONE ☐

MULTIPLE
ZONE ☐

7. Lease Name or Unit Agreement Name

Lovington Paddock Unit

2. Name of Operator

GREENHILL PETROLEUM CORPORATION

8. Well No.

142

3. Address of Operator

11490 Westheimer, Suite 200, Houston, Texas 77077

9. Pool name or Wildcat

Lovington Paddock

4. Well Location

Unit Letter F : 2490 Feet From The North Line and 2190 Feet From The West Line

Section 6 Township 17 South Range 37 East NMPM Lea County

10. Proposed Depth
6450'

11. Formation
Paddock

12. Rotary or C.T.
Rotary

13. Elevations (Show whether DF, RT, GR, etc.)

3807 GR

14. Kind & Status Plug. Bond
on file

15. Drilling Contractor
TBD

16. Approx. Date Work will start
4-1-92

17.

PROPOSED CASING AND CEMENT PROGRAM

SIZE OF HOLE	SIZE OF CASING	WEIGHT PER FOOT	SETTING DEPTH	SACKS OF CEMENT	EST. TOP
12 1/4 "	8 5/8 "	24	1300'	550	surface
7 7/8 "	5 1/2 "	15.5	6450'	1100	surface

IN ABOVE SPACE DESCRIBE PROPOSED PROGRAM: IF PROPOSAL IS TO DEEPEN OR PLUG BACK, GIVE DATA ON PRESENT PRODUCTIVE ZONE AND PROPOSED NEW PRODUCTIVE ZONE. GIVE BLOWOUT PREVENTER PROGRAM, IF ANY.

I hereby certify that the information above is true and complete to the best of my knowledge and belief.

SIGNATURE

Michael Newport

TITLE Land Manager-Permian Basin DATE 3-24-92

TYPE OR PRINT NAME

Michael J. Newport

(713)

TELEPHONE NO. 589-8484

(This space for State Use)

APPROVED BY

TITLE

DATE

CONDITIONS OF APPROVAL, IF ANY:

OIL CONSERVATION DIVISION

P.O. Box 2088
Santa Fe, New Mexico 87504-2088

DISTRICT I

P.O. Box 1980, Hobbs, NM 88240

DISTRICT II

P.O. Drawer DD, Artesia, NM 88210

DISTRICT III

1000 Rio Brazos Rd., Artec, NM 87410

WELL LOCATION AND ACREAGE DEDICATION PLAT

All Distances must be from the outer boundaries of the section

Operator Greenhill Petroleum Corp.			Lease Lovington Paddock Unit		Well No. 142
Unit Letter F	Section 6	Township 17 South	Range 37 East	County Lea	
Actual Footage Location of Well: 2490 feet from the north line and 2190 feet from the west line					
Ground Level Elev. 3807.9'	Producing Formation Lovington Paddock		Pool Lovington Paddock Unit		Dedicated Acreage: 40 Acres

- Outline the acreage dedicated to the subject well by colored pencil or hatchure marks on the plat below.
- If more than one lease is dedicated to the well, outline each and identify the ownership thereof (both as to working interest and royalty).
- If more than one lease of different ownership is dedicated to the well, have the interest of all owners been consolidated by communitization, unitization, force-pooling, etc.?
☒ Yes ☐ No If answer is "yes" type of consolidation unitized

If answer is "no" list of owners and tract descriptions which have actually been consolidated. (Use reverse side of this form necessary.)

No allowable will be assigned to the well unit all interests have been consolidated (by communitization, unitization, forced-pooling, otherwise) or until a non-standard unit, eliminating such interest, has been approved by the Division.

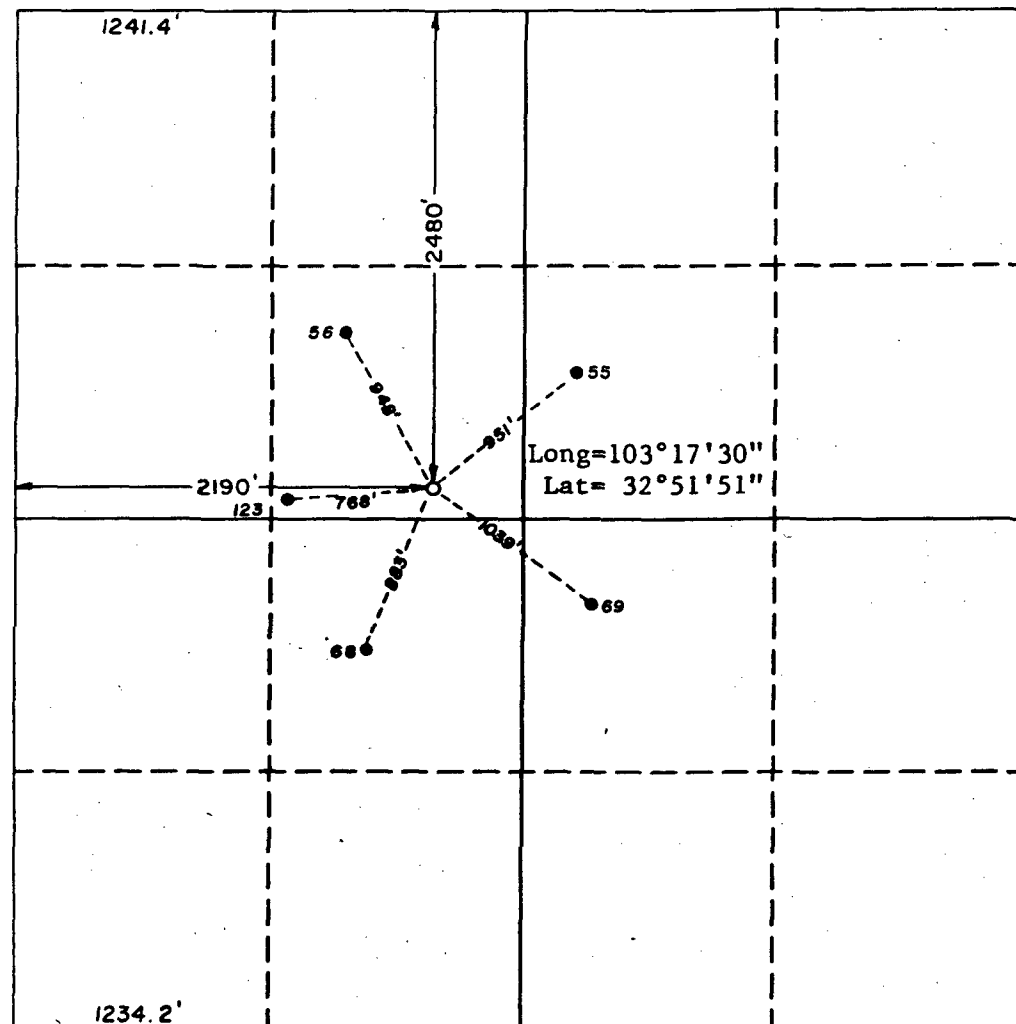

OPERATOR CERTIFICATION

I hereby certify that the information contained herein is true and complete to the best of my knowledge and belief.

Michael J. Newport
Signature

Michael J. Newport
Printed Name

Land Manager-Permian Basin

Position
GREENHILL PETROLEUM CORP.

Company
3-24-92

Date

SURVEYOR CERTIFICATION

I hereby certify that the well location shown on this plat was plotted from field notes of actual surveys made by me or under my supervision, and that the same is true and correct to the best of my knowledge and belief.

Date Surveyed
February 13, 1992

Signature & Seal of
Professional Surveyor

Ronald J. Edson
REGISTERED LAND SURVEYOR
Certificate No. JOHN W. WEST 676
RONALD J. EDSON 3239
DAVE L. JONES 7977
W.O. 92-118-0197

GREENHILL PETROLEUM CORPORATION
BOP PROGRAM FOR
LOVINGTON PADDOCK UNIT #142

Casing Program

BOP Program

Size	Depth	Wt.	Grade	Configuration	Test Pressure
8-5/8"	1300'	24	H40, STC	RA*	200 psi
5-1/2"	6450'	15.5	K55, STC	RR*	250/1500 psi

* = RR-Ram Ram
* = RA-Ram Annular

Diverter-Hydrill may be substituted for a diverter.

sj:s
92.215

03/24/92

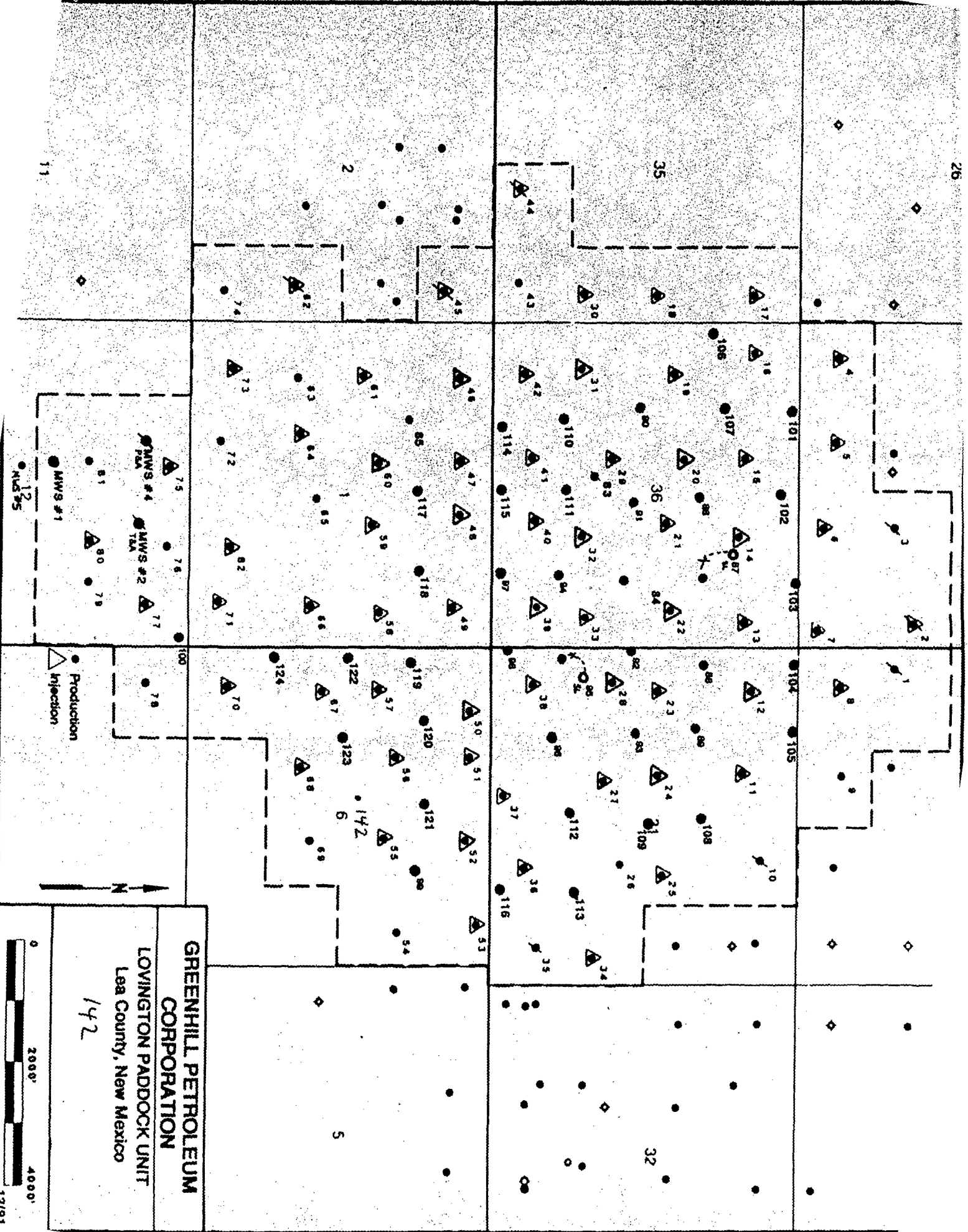



GREENHILL PETROLEUM CORPORATION

11490 WESTHEIMER ROAD, SUITE 200
HOUSTON, TEXAS 77077-6841
TELEPHONE (713) 589-8484
FAX. (713) 589-7892

Incorporated in Delaware, U.S.A.

March 24, 1992

Oil Conservation Division
State of New Mexico
Energy, Minerals and Natural Resources Department
P. O. Box 2088
Santa Fe, New Mexico 87504-2088

Attention: Mr. Mike Stogner

RE: Unorthodox Location and Drilling Permit
Proposed Well Number 143
Lovington Paddock Unit
Lea County, New Mexico

Dear Mr. Stogner:

Greenhill Petroleum Corporation respectfully requests the State of New Mexico Oil Conservation Division grant approval of the proposed unorthodox location and the attached permit to drill Well Number 143 in the Lovington Paddock Unit, located in Lea County, New Mexico.

The Lovington Paddock Unit is presently developed and being waterflooded utilizing a forty (40) acre well density. It is believed that infill development using a twenty (20) acre well density will improve waterflood sweep efficiency and will increase secondary oil recovery. The proposed location for Well Number 143 is located in the interior of the unit and is not competitive with offset wells outside the unit. Information gathered as a result of drilling this infill well will be utilized in evaluating additional infill development potential in the unit and ultimately may be used to evaluate the feasibility of tertiary recovery.

Greenhill Petroleum Corporation wishes to commence drilling operations on the proposed well as soon as possible and would appreciate a response to this request at your earliest convenience.

Respectfully yours,

Michael J. Newport
Land Manager - Permian Basin

MJN:sjs
92.204
Enclosures

Submit to Appropriate
District Office
State Lease - 6 copies
Fee Lease - 5 copies

State of New Mexico
Energy, Minerals and Natural Resources Department

Form C-101
Revised 1-1-89

OIL CONSERVATION DIVISION

P.O. Box 2088
Santa Fe, New Mexico 87504-2088

DISTRICT I
P.O. Box 1980, Hobbs, NM 88240

DISTRICT II
P.O. Drawer DD, Artesia, NM 88210

DISTRICT III
1000 Rio Brazos Rd., Aztec, NM 87410

API NO. (assigned by OCD on New Wells)

5. Indicate Type of Lease

STATE ☐

FEE ☒

6. State Oil & Gas Lease No.

APPLICATION FOR PERMIT TO DRILL, DEEPEN, OR PLUG BACK

1a. Type of Work:

DRILL ☒

RE-ENTER ☐

DEEPEN ☐

PLUG BACK ☐

b. Type of Well:

OIL
WELL ☒

GAS
WELL ☐

OTHER ☐

SINGLE
ZONE ☐

MULTIPLE
ZONE ☐

7. Lease Name or Unit Agreement Name

Lovington Paddock Unit

2. Name of Operator

GREENHILL PETROLEUM CORPORATION

8. Well No.
143

3. Address of Operator

11490 Westheimer, Suite 200, Houston, Texas 77077

9. Pool name or Wildcat

Lovington Paddock

4. Well Location

Unit Letter G : 2250 Feet From The North Line and 1370 Feet From The East Line

Section 6 Township 17 South Range 37 East NMPM Lea County

10. Proposed Depth
6450'

11. Formation
Paddock

12. Rotary or C.T.
Rotary

13. Elevations (Show whether DF, RT, GR, etc.)
3803 GR

14. Kind & Status Plug. Bond
on file

15. Drilling Contractor
TBD

16. Approx. Date Work will start
4-1-92

17.

PROPOSED CASING AND CEMENT PROGRAM

SIZE OF HOLE	SIZE OF CASING	WEIGHT PER FOOT	SETTING DEPTH	SACKS OF CEMENT	EST. TOP
12 1/4 "	8 5/8 "	24	1300'	550	surface
7 7/8 "	5 1/2 "	15.5	6450'	1100	surface

IN ABOVE SPACE DESCRIBE PROPOSED PROGRAM: IF PROPOSAL IS TO DEEPEN OR PLUG BACK, GIVE DATA ON PRESENT PRODUCTIVE ZONE AND PROPOSED NEW PRODUCTIVE ZONE. GIVE BLOWOUT PREVENTER PROGRAM, IF ANY.

I hereby certify that the information above is true and complete to the best of my knowledge and belief.

SIGNATURE

Michael J. Newport

TITLE Land Manager-Permian Basin DATE 3-24-92

TYPE OR PRINT NAME

Michael J. Newport

(713)
TELEPHONE NO. 589-8484

(This space for State Use)

APPROVED BY

TITLE

DATE

CONDITIONS OF APPROVAL, IF ANY:

OIL CONSERVATION DIVISION

P.O. Box 2088

Santa Fe, New Mexico 87504-2088

DISTRICT I

P.O. Box 1980, Hobbs, NM 88240

DISTRICT II

P.O. Drawer DD, Artesia, NM 88210

DISTRICT III

1000 Rio Brazos Rd., Artec, NM 87410

WELL LOCATION AND ACREAGE DEDICATION PLAT

All Distances must be from the outer boundaries of the section

Operator Greenhill Petroleum Corp.			Lease Lovington Paddock Unit		Well No. 143
Unit Letter G	Section 6	Township 17 South	Range 37 East	County Lea	
Actual Footage Location of Well: 2250 feet from the north line and 1370 feet from the east line					
Ground Level Elev. 3803.1'	Producing Formation Lovington Paddock		Pool Lovington Paddock		Dedicated Acreage: 40 Acres

1. Outline the acreage dedicated to the subject well by colored pencil or hachure marks on the plat below.
2. If more than one lease is dedicated to the well, outline each and identify the ownership thereof (both as to working interest and royalty).
3. If more than one lease of different ownership is dedicated to the well, have the interest of all owners been consolidated by communitization, unitization, force-pooling, etc.?
☒ Yes ☐ No If answer is "yes" type of consolidation unitized

If answer is "no" list of owners and tract descriptions which have actually been consolidated. (Use reverse side of this form necessary.)

No allowable will be assigned to the well unit all interests have been consolidated (by communitization, unitization, forced-pooling, otherwise) or until a non-standard unit, eliminating such interest, has been approved by the Division.

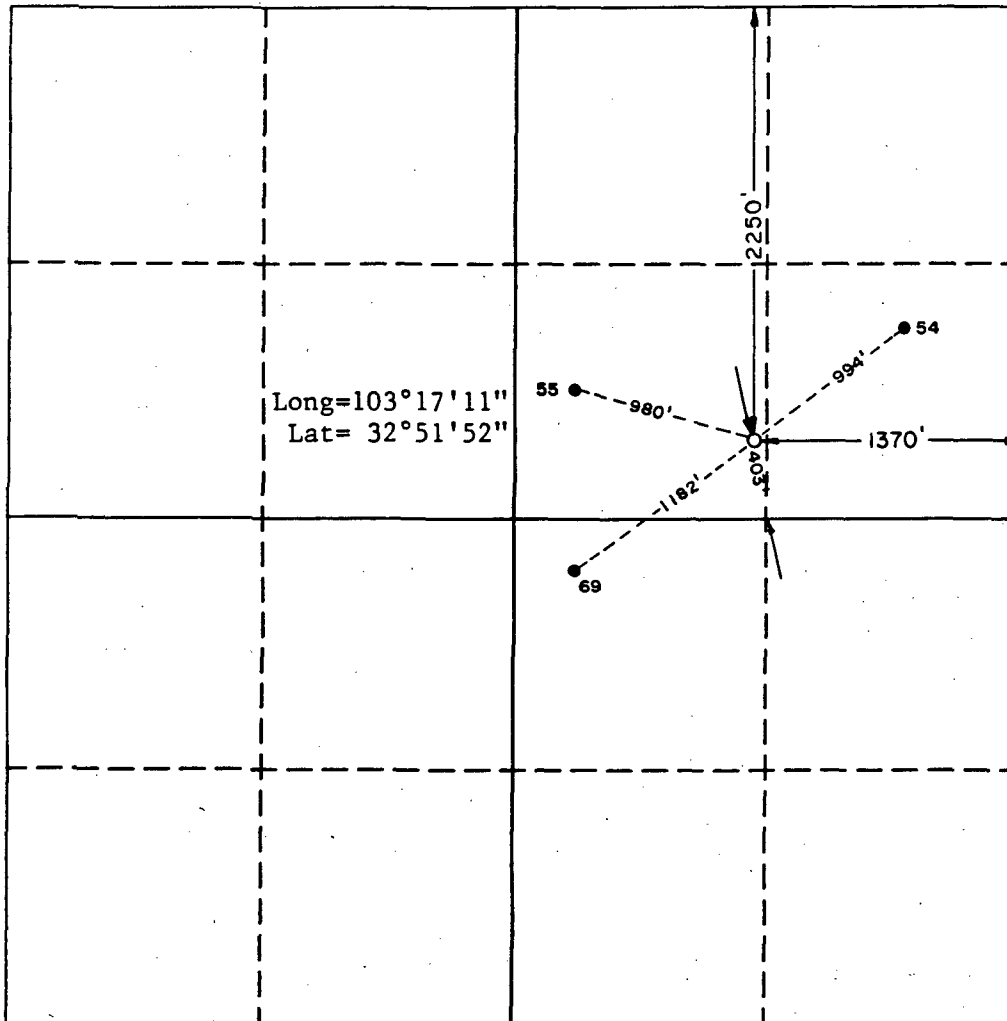

OPERATOR CERTIFICATION

I hereby certify the the information contained herein is true and complete to the best of my knowledge and belief.

Signature
Richard J. Newport
Printed Name
Richard J. Newport
Position
Land manager
Company
Greenhill Petroleum Corp.
Date
3/27/92

SURVEYOR CERTIFICATION

I hereby certify that the well location shown on this plat was plotted from field notes of actual surveys made by me or under my supervision, and that the same is true and correct to the best of my knowledge and belief.

Date Surveyed
February 13, 1992

Signature & Seal of
Professional Surveyor

Ronald J. Edson
Certificate No. JOHN W. WEST, 678
RONALD J. EDSON, 3838
GARY L. JONES, 7977
W.O. 92-140-192

GREENHILL PETROLEUM CORPORATION
BOP PROGRAM FOR
LOVINGTON PADDOCK UNIT #143

Casing Program

BOP Program

Size	Depth	Wt.	Grade	Configuration	Test Pressure
8-5/8"	1300'	24	H40, STC	RA*	200 psi
5-1/2"	6450'	15.5	K55, STC	RR*	250/1500 psi

* = RR-Ram Ram
* = RA-Ram Annular

Diverter-Hydrill may be substituted for a diverter.

sjs:s
92.215

03/24/92

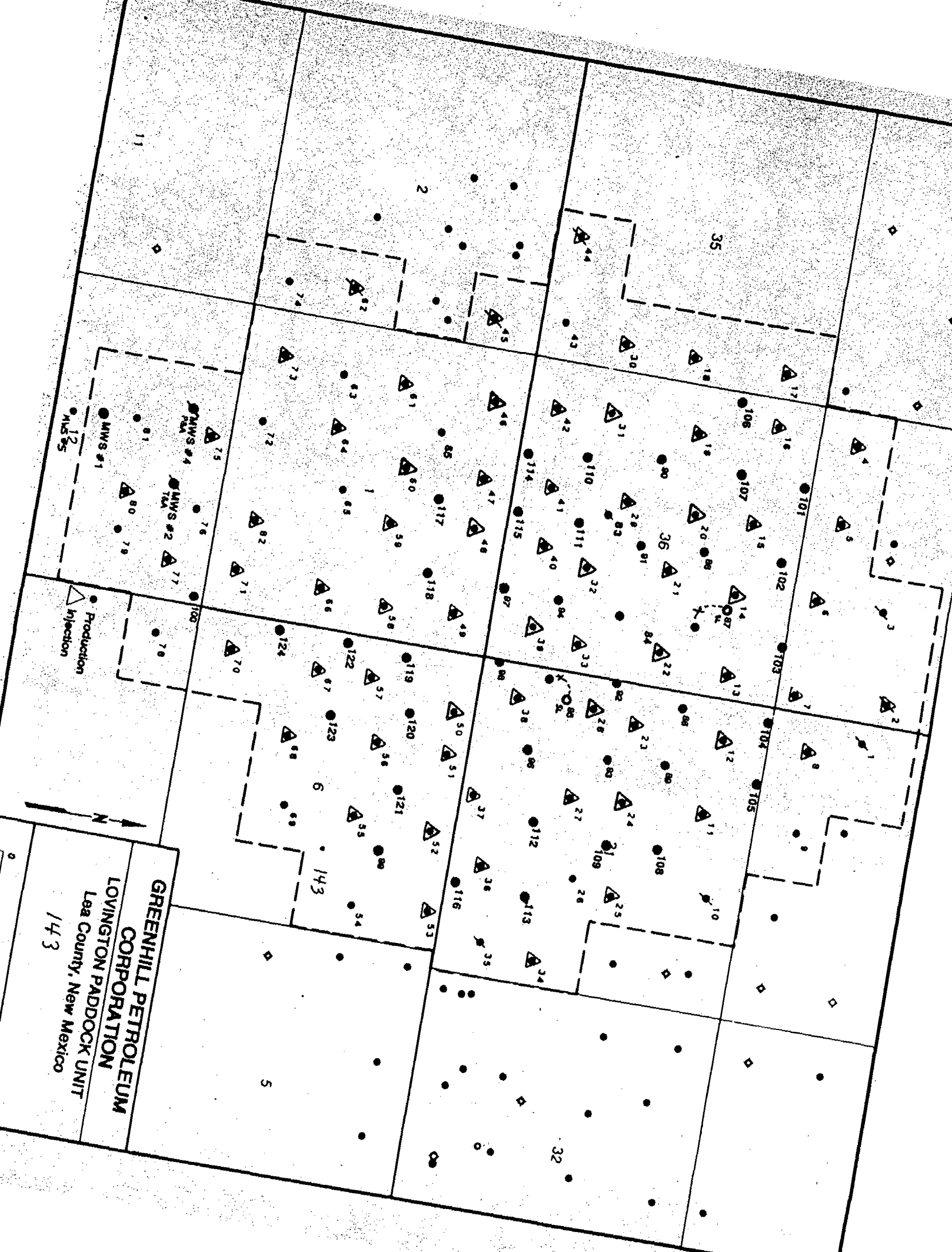



GREENHILL PETROLEUM CORPORATION

11490 WESTHEIMER ROAD, SUITE 200
HOUSTON, TEXAS 77077-6841
TELEPHONE (713) 589-8484
FAX: (713) 589-7892

Incorporated in Delaware, U.S.A.

March 24, 1992

Oil Conservation Division
State of New Mexico
Energy, Minerals and Natural Resources Department
P. O. Box 2088
Santa Fe, New Mexico 87504-2088

Attention: Mr. Mike Stogner

RE: Unorthodox Location and Drilling Permit
Proposed Well Number 148
Lovington Paddock Unit
Lea County, New Mexico

Dear Mr. Stogner:

Greenhill Petroleum Corporation respectfully requests the State of New Mexico Oil Conservation Division grant approval of the proposed unorthodox location and the attached permit to drill Well Number 148 in the Lovington Paddock Unit, located in Lea County, New Mexico.

The Lovington Paddock Unit is presently developed and being waterflooded utilizing a forty (40) acre well density. It is believed that infill development using a twenty (20) acre well density will improve waterflood sweep efficiency and will increase secondary oil recovery. The proposed location for Well Number 148 is located in the interior of the unit and is not competitive with offset wells outside the unit. Information gathered as a result of drilling this infill well will be utilized in evaluating additional infill development potential in the unit and ultimately may be used to evaluate the feasibility of tertiary recovery.

Greenhill Petroleum Corporation wishes to commence drilling operations on the proposed well as soon as possible and would appreciate a response to this request at your earliest convenience.

Respectfully yours,

Michael J. Newport
Land Manager - Permian Basin

MJN:sjs
92.204
Enclosures

Submit to Appropriate
District Office
State Lease - 6 copies
Fee Lease - 5 copies

State of New Mexico
Energy, Minerals and Natural Resources Department

Form C-101
Revised 1-1-89

OIL CONSERVATION DIVISION

P.O. Box 2088
Santa Fe, New Mexico 87504-2088

DISTRICT I
P.O. Box 1980, Hobbs, NM 88240

DISTRICT II
P.O. Drawer DD, Artesia, NM 88210

DISTRICT III
1000 Rio Brazos Rd., Aztec, NM 87410

API NO. (assigned by OCD on New Wells)

5. Indicate Type of Lease

STATE ☐

FEE ☒

6. State Oil & Gas Lease No.

APPLICATION FOR PERMIT TO DRILL, DEEPEN, OR PLUG BACK

1a. Type of Work:

DRILL ☒

RE-ENTER ☐

DEEPEN ☐

PLUG BACK ☐

b. Type of Well:

OIL

WELL ☒

GAS

WELL ☐

OTHER ☐

SINGLE

ZONE ☐

MULTIPLE

ZONE ☐

7. Lease Name or Unit Agreement Name

Lovington Paddock Unit

2. Name of Operator

GREENHILL PETROLEUM CORPORATION

8. Well No.

148

3. Address of Operator

11490 Westheimer, Suite 200, Houston, Texas 77077

9. Pool name or Wildcat

Lovington Paddock

4. Well Location

Unit Letter

L

: 1480 Feet From The

South

Line and

900

Feet From The

West

Line

Section

6

Township

17 South

Range

37 East

NMPM

Lea

County

10. Proposed Depth

6450'

11. Formation

Paddock

12. Rotary or C.T.

Rotary

13. Elevations (Show whether DF, RT, GR, etc.)

3807 GR

14. Kind & Status Plug. Bond

on file

15. Drilling Contractor

TBD

16. Approx. Date Work will start

4-1-92

17.

PROPOSED CASING AND CEMENT PROGRAM

SIZE OF HOLE	SIZE OF CASING	WEIGHT PER FOOT	SETTING DEPTH	SACKS OF CEMENT	EST. TOP
12 1/4 "	8 5/8 "	24	1300'	550	surface
7 7/8 "	5 1/2 "	15.5	6450'	1100	surface

IN ABOVE SPACE DESCRIBE PROPOSED PROGRAM: IF PROPOSAL IS TO DEEPEN OR PLUG BACK, GIVE DATA ON PRESENT PRODUCTIVE ZONE AND PROPOSED NEW PRODUCTIVE ZONE. GIVE BLOWOUT PREVENTER PROGRAM, IF ANY.

I hereby certify that the information above is true and complete to the best of my knowledge and belief.

SIGNATURE

Michael J. Newport

TITLE Land Manager-Permian Basin

DATE 3-24-92

TYPE OR PRINT NAME

Michael J. Newport

(713)

TELEPHONE NO. 589-8484

(This space for State Use)

APPROVED BY

TITLE

DATE

CONDITIONS OF APPROVAL, IF ANY:

Santa Fe, New Mexico 87504-2088

P.O. Drawer DD, Artesia, NM 86210

1000 Rio Brazos Rd., Artec, NM 87410

All Distances must be from the outer boundaries of the section

Actual Footage Location of Well:

1480 feet from the south line and 900 feet from the west line

1. Outline the acreage dedicated to the subject well by colored pencil or hachure marks on the plat below.

2. If more than one lease is dedicated to the well, outline each and identify the ownership thereof (both as to working interest and royalty).

3. If more than one lease of different ownership is dedicated to the well, have the interest of all owners been consolidated by communitization, unitization, force-pooling, etc.?

☒ Yes ☐ No If answer is "yes" type of consolidation Unitized

If answer is "no" list of owners and tract descriptions which have actually been consolidated. (Use reverse side of this form necessary.

No allowable will be assigned to the well unit all interests have been consolidated (by communization, unitization, forced-pooling, otherwise) or until a non-standard unit, eliminating such interest, has been approved by the Division.

OPERATOR CERTIFICATION

I hereby certify the the information
contained herein is true and complete to the
best of my knowledge and belief.

Signature

Printed Name: Michael Murphy

Printed Name

Michael J. Newport

Position

Land Manager / Permian Basin
Company

Company

Greenhill Petroleum Corp.

Date

3/27/92

SURVEYOR CERTIFICATION

I hereby certify that the well location shown on this plat was plotted from field notes of actual surveys made by me or under my supervision, and that the same is true and correct to the best of my knowledge and belief.

Date Surveyed

February 13, 1992

**Signature & Seal of
Professional Surveyor**

REGISTERED LAND SURVEYOR
No. 3239
STATE OF NEW YORK

Donald J. Edison

Certificate No. 10198

JOHN W. WEST

DONALD J. EDISON

RAY L. COOPER

7977

W.O. 927-10198

GREENHILL PETROLEUM CORPORATION
BOP PROGRAM FOR
LOVINGTON PADDOCK UNIT #148

Casing Program

BOP Program

Size	Depth	Wt.	Grade	Configuration	Test Pressure
8-5/8"	1300'	24	H40, STC	RA*	200 psi
5-1/2"	6450'	15.5	K55, STC	RR*	250/1500 psi

* = RR-Ram Ram
* = RA-Ram Annular

Diverter-Hydrill may be substituted for a diverter.

sjs:s
92.215

03/24/92

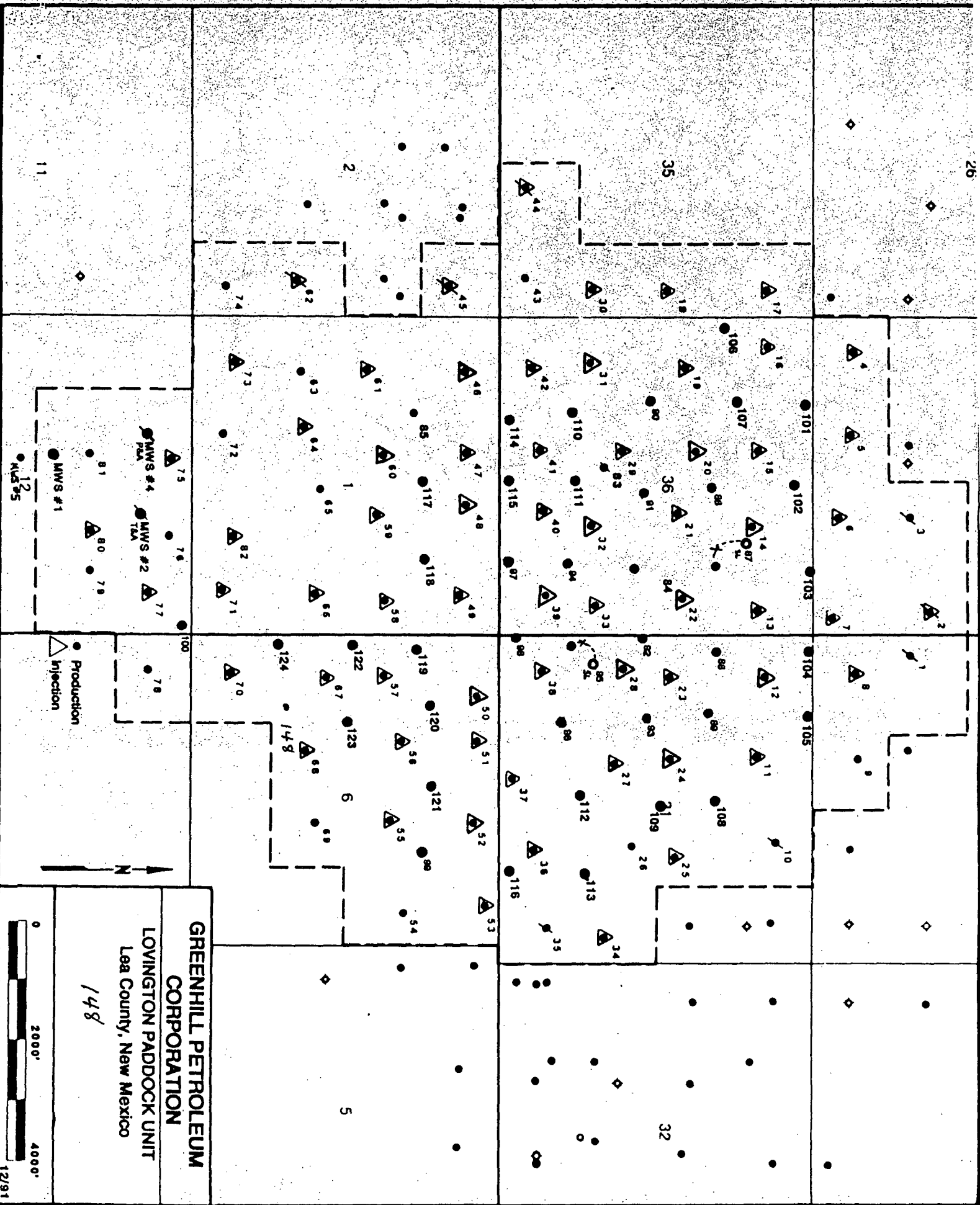

GREENHILL PETROLEUM
CORPORATION
LOVINGTON PADDOCK UNIT
Lea County, New Mexico

148



12/91



STATE OF NEW MEXICO

ENERGY, MINERALS AND NATURAL RESOURCES DEPARTMENT
RECEIVED

OIL CONSERVATION DIVISION

HOBBS DISTRICT OFFICE

'92 APR 10 AM 8 54

4-6-92

BRUCE KING
GOVERNOR

POST OFFICE BOX 1980
HOBBS, NEW MEXICO 88241-1980
(505) 393-6161

OIL CONSERVATION DIVISION
P. O. BOX 2088
SANTA FE, NEW MEXICO 87501

RE: Proposed:

MC _____
DHC _____
NSL X _____
NSP _____
SWD _____
WFX _____
PMX _____

Gentlemen:

I have examined the application for the:

Greenhill Petroleum Corp. Lovington Paddock Unit
Operator Lease & Well No. Unit S-T-R

and my recommendations are as follows:

OK

#125-P 25-16-36
★ #127-C 31-16-37
#129-L 36-16-36
★ #130-J 31-16-37
#131-m 36-16-36
#133-m 36-16-36
#135-B 6-17-37
★ #136-E 1-17-36
#139-F 1-17-36

#142-F 6-17-37

★ #143-G 6-17-37

★ #148-L 6-17-37

Yours very truly,

Jerry Sexton

Jerry Sexton
Supervisor, District 1

/ed

★ Indicates need for ratification of offset operators.

Exhibit "A"
Division Administrative Order NSL-3109
Greenhill Petroleum Corporation
Lovington Paddock Unit
Lea County, New Mexico

<i>Well No.</i>	<i>Footage Location</i>	<i>Unit</i>	<i>Section</i>	<i>Township-Range</i>	<i>Dedicated 40-Acre Tract</i>	<i>Acreage</i>
125	1015' FSL - 1185' FEL	P	25	16S-36E	SE/4 SE/4	40
127	150' FNL - 2500' FWL	C	31	16S-37E	NE/4 NW/4	40
129	2420' FSL - 395' FWL	L	36	16S-36E	NW/4 SW/4	40
130	2300' FSL - 1460' FEL	J	31	16S-37E	NW/4 SE/4	40
131	1028' FSL - 230' FWL	M	36	16S-36E	SW/4 SW/4	40
133	100' FSL - 260' FWL	M	36	16S-36E	SW/4 SW/4	40
135	137' FNL - 2485' FEL	B	6	17S-37E	Lot 2	40.20
136	1380' FNL - 400' FWL	E	1	17S-36E	SW/4 NW/4	40
139	2527' FNL - 1550' FWL	F	1	17S-36E	SE/4 NW/4	40
142	2490' FNL - 2190' FWL	F	6	17S-37E	SE/4 NW/4	40
143	2250' FNL - 1370' FEL	G	6	17S-37E	SW/4 NE/4	40
148	1480' FSL - 900' FWL	L	6	17S-37E	Lot 6	37.35



GREENHILL PETROLEUM CORPORATION

Incorporated in Delaware, U.S.A.

OIL CONSERVATION DIVISION
RECEIVED
1480 WESTHEIMER ROAD, SUITE 200
HOUSTON, TEXAS 77077-6841
TELEPHONE (713) 589-8484
FAX (713) 589-7892

'92 APR 9 AM 8 54

April 6, 1992

CERTIFIED MAIL/RETURN RECEIPT REQUESTED

Tipperary Corporation
633 - 17th Street, Suite 1550
Denver, Colorado 80202

RE: Lovington Paddock Well #127
Lea County, New Mexico

Gentlemen:

This letter is to hereby notify you that Greenhill Petroleum Corporation will be drilling Well #127 to a depth of 6,450 feet to test the Lovington Paddock Formation 150 FNL and 2,500 FNL in Section 31, T16S-R37E, Lea County, New Mexico. We are obligated by the New Mexico Oil Commission to notify all offset operators that we are applying for an unorthodox location within our Lovington San Andres Unit.

Please sign and return to the above address in the event you do not object to our proposed well.

Sincerely,

Michael J. Newport
Land Manager/Permian Basin

MJN/jem
92.242

cc: Mr. Mike Stogner
Oil Conservation Division/State of New Mexico
Energy, Minerals and Natural Resources Department
P. O. Box 2088
Santa Fe, New Mexico 87504-2088

AGREED TO AND ACCEPTED ON THIS THE
____ DAY OF _____, 1992.

TIPPERARY CORPORATION

BY: _____



GREENHILL PETROLEUM CORPORATION

Incorporated in Delaware, U.S.A.

11490 WESTHEIMER ROAD, SUITE 200
HOUSTON, TEXAS 77077-6841
TELEPHONE (713) 589-8484
FAX (713) 589-7892

'92 APR 9 AM 8 42

March 30, 1992
CERTIFIED MAIL/RETURN RECEIPT REQUESTED

Tipperary Corporation
633 - 17th Street, Suite 1550
Denver, Colorado 80202

RE: Lovington San Andres Well #127
Lea County, New Mexico

Gentlemen:

This letter is to hereby notify you that Greenhill Petroleum Corporation will be drilling Well #127 to a depth of 6,450 feet to test the Lovington Paddock Formation 150 FNL and 2,500 FNL in Section 31, T16S-R37E, Lea County, New Mexico. We are obligated by the New Mexico Oil Commission to notify all offset operators that we are applying for an unorthodox location within our Lovington San Andres Unit.

Please sign and return to the above address in the event you do not object to our proposed well.

Sincerely,

Michael J. Newport
Land Manager/Permian Basin

MJN/jem
92.242

cc: Mr. Mike Stogner
Oil Conservation Division/State of New Mexico
Energy, Minerals and Natural Resources Department
P. O. Box 2088
Santa Fe, New Mexico 87504-2088

AGREED TO AND ACCEPTED ON THIS THE
____ DAY OF _____, 1992.

TIPPERARY CORPORATION

BY: _____



GREENHILL PETROLEUM CORPORATION

Incorporated in Delaware, U.S.A.

OIL CONSERVATION
RECEIVED
11490 WESTHEIMER ROAD, SUITE 200
HOUSTON, TEXAS 77077-6841
TELEPHONE (713) 589-8484
FAX (713) 589-7892

'92 APR 6 AM 9 23

March 31, 1992
CERTIFIED MAIL/RETURN RECEIPT REQUESTED

Amoco Production Company
P. O. Box 3092
Houston, Texas 77251-3092

RE: Lovington Paddock Well #136
Lea County, New Mexico

Gentlemen:

This letter is to hereby notify you that Greenhill Petroleum Corporation will be drilling Well #136 to a depth of 6,450 feet to test the Lovington Paddock Formation 1,380 FNL and 400 FWL in Section 1, T17S-R36E, in Lea County, New Mexico. We are obligated by the New Mexico Oil Commission to notify all offset operators that we are applying for an unorthodox location within our Lovington San Andres Unit.

Please sign and return to the above address in the event you do not object to our proposed well.

Sincerely,

Michael J. Newport
Land Manager/Permian Basin

MJN/jem
92.243

cc: Mr. Mike Stogner
Oil Conservation Division/State of New Mexico
Energy, Minerals and Natural Resources Department
P. O. Box 2088
Santa Fe, New Mexico 87504-2088

AGREED TO AND ACCEPTED ON THIS THE _____ DAY OF APRIL, 1992.

AMOCO PRODUCTION COMPANY

BY: _____



GREENHILL PETROLEUM CORPORATION

11490 WESTHEIMER ROAD, SUITE 200
HOUSTON, TEXAS 77077-6841
TELEPHONE (713) 589-8484
FAX (713) 589-7892

RECEIVED

'92 APR 6 AM 9 14

Incorporated in Delaware, U.S.A.

March 30, 1992
CERTIFIED MAIL/RETURN RECEIPT REQUESTED

Amoco Production Company
P. O. Box 3092
Houston, Texas 77251-3092

RE: Lovington San Andres Well #136
Lea County, New Mexico

Gentlemen:

This letter is to hereby notify you that Greenhill Petroleum Corporation will be drilling Well #136 to a depth of 6,450 feet to test the Lovington Paddock Formation 1,380 FNL and 400 FWL in Section 1, T17S-R36E, Lea County, New Mexico. We are obligated by the New Mexico Oil Commission to notify all offset operators that we are applying for an unorthodox location within our Lovington San Andres Unit.

Please sign and return to the above address in the event you do not object to our proposed well.

Sincerely,

Michael J. Newport
Land Manager/Permian Basin

MJN/jem
92.243

cc: Mr. Mike Stogner
Oil Conservation Division/State of New Mexico
Energy, Minerals and Natural Resources Department
P. O. Box 2088
Santa Fe, New Mexico 87504-2088

AGREED TO AND ACCEPTED ON THIS THE
____ DAY OF _____, 1992.

AMOCO PRODUCTION COMPANY

BY: _____



GREENHILL PETROLEUM CORPORATION

Incorporated in Delaware, U.S.A.

OIL CONSERVATION DIVISION
RECEIVED

1490 WESTHEIMER ROAD, SUITE 200
HOUSTON, TEXAS 77077-6841
TELEPHONE (713) 589-8484
FAX (713) 589-7892

'92 APR 6 AM 9 14

March 30, 1992
CERTIFIED MAIL/RETURN RECEIPT REQUESTED

Texaco, U. S. A.
P. O. Box 3109
Midland, Texas 79702

Attention: Mr. Keith Williams

RE: Lovington Paddock Wells #130, #143, & #148
Lea County, New Mexico

Gentlemen:

This letter is to hereby notify you that Greenhill Petroleum Corporation will be drilling the following Wells #140, #143, and #148 to a depth of 6,450 feet to test the Paddock Formation. The wells will be located as follows in Lea County, New Mexico:

Well #130 - 2,300 FSL & 1,460 FEL; Section 31, T16S-R37E
Well #143 - 2,250 FNL & 1,370 FEL; Section 6, T17S-R37E
Well #148 - 1,480 FSL & 900 FWL; Section 6, T17S-R37E

We are obligated by the New Mexico Oil Commission to notify all offset operators that we are applying for an unorthodox location within our Lovington San Andres Unit.

Please sign and return to the above address in the event you do not object to our proposed well.

Sincerely,

Michael J. Newport
Land Manager/Permian Basin

MJN/jem [92.243]

cc: Mr. Mike Stogner
Oil Conservation Division/State of New Mexico
Energy, Minerals and Natural Resources Department
P. O. Box 2088
Santa Fe, New Mexico 87504-2088

AGREED TO AND ACCEPTED ON THIS THE _____ DAY OF APRIL, 1992.

TEXACO, U. S. A.

BY: _____