



JERRY W. LONG  
CONSULTANT

December 10, 1992

STATE OF NEW MEXICO  
Energy and Minerals Department  
Oil Conservation Division  
P.O. Box 2088  
Santa Fe, New Mexico 87501-2088

Re: Application for Unorthodox Oil Location  
SOCORRO PETROLEUM COMPANY  
Keel-West Waterflood Project  
Federal Lease LC 029426-B  
Eddy County, New Mexico

Gentlemen:

You are respectfully requested to grant administrative approval under Rule 104 F.(I) for an unorthodox location for the following infill producing well within the Keel-West Waterflood Project:

No.49 H.E. West "B" - 1305'FSL, 1305'FWL, Sec. 3, T.17S., R.31E.

The above location does not conform to Rule 104.C.I. because it is located closer than 330' to the governmental quarter-quarter section boundaries. This well will be drilled to about 4900' to produce from the Grayburg-San Andres formation. The well will be drilled at the unorthodox location, in order to prevent waste by developing an efficient production and injection pattern within the Keel-West Waterflood Project, which was approved under Order R-2268, as amended. A royalty owner agreement for the affected leases has previously been filed with your office.

Enclosed are copies of the well location plat, Application to Drill, and a map indicating lease ownership and locations of off-set Grayburg wells. The information in this request is accurate to the best of my knowledge.

A copy of this application has been mailed to the Bureau of Land Management. Please send the approval to SOCORRO PETROLEUM COMPANY at the address below and a copy to me at the letterhead address.

Sincerely yours,

JERRY W. LONG  
Permit Agent for:  
SOCORRO PETROLEUM COMPANY

1c: SOCORRO PETROLEUM COMPANY  
410 17th Street, Ste.430  
Denver, CO 80202  
Attn: Mr. Keeton Barker

JWL/bl1

UNITED STATES  
DEPARTMENT OF THE INTERIOR  
BUREAU OF LAND MANAGEMENT

## APPLICATION FOR PERMIT TO DRILL, DEEPEN, OR PLUG BACK

## 1a. TYPE OF WORK

DRILL ☒DEEPEN ☐PLUG BACK ☐

## b. TYPE OF WELL

OIL  
WELL ☒GAS  
WELL ☐OTHER ☐SINGLE  
ZONE ☒MULTIPLE  
ZONE ☐

## 2. NAME OF OPERATOR

Socorro Petroleum Company

3a. Area Code & Phone No.  
505/677-2360

## 3. ADDRESS OF OPERATOR

Loco Hills, NM 88255

4. LOCATION OF WELL (Report location clearly and in accordance with any State requirements.)\*  
At surface

1305' FSL &amp; 1305' FWL

At proposed prod. zone

1305' FSL &amp; 1305' FWL

## 14. DISTANCE IN MILES AND DIRECTION FROM NEAREST TOWN OR POST OFFICE\*

11 mi. NE of Loco Hills, New Mexico

## 15. DISTANCE FROM PROPOSED\*

LOCATION TO NEAREST  
PROPERTY OR LEASE LINE, FT.  
(Also to nearest drlg. unit line, if any)

1305'

## 16. NO. OF ACRES IN LEASE

640

17. NO. OF ACRES ASSIGNED  
TO THIS WELL

20

## 18. DISTANCE FROM PROPOSED LOCATION\*

TO NEAREST WELL, DRILLING, COMPLETED,  
OR APPLIED FOR, ON THIS LEASE, FT.

912'

## 19. PROPOSED DEPTH

4000'

## 20. ROTARY OR CABLE TOOLS

Rotary

## 21. ELEVATIONS (Show whether DF, RT, GR, etc.)

3838' GL

## 22. APPROX. DATE WORK WILL START\*

6/1/91

## 23.

## PROPOSED CASING AND CEMENTING PROGRAM

HOLE SIZE	CASING SIZE	WEIGHT/FOOT	GRADE	THREAD TYPE	SETTING DEPTH	QUANTITY OF CEMENT
12-1/4"	8-5/8"	24 #	J-55 CIRCULATE 8 Rd.		625'	300 sx. Cl. "C"
7-7/8"	5-1/2"	17 #	J-55 (see slips) 8 Rd.		4000'	200 sx. Cl. "C"
					500'	+ 600 sx. LW

## Mud Program

0 - 625' Drill with Fresh water  
625 - TO Drill with brine water

## BOP Program

Will install on the 8-5/8" surface casing a 10" Series 900 Type "E".  
Shaffer double hydraulic BOP & will test before drilling into Queen  
formation.

IN ABOVE SPACE DESCRIBE PROPOSED PROGRAM: If proposal is to deepen or plug back, give data on present productive zone and proposed new productive zone. If proposal is to drill or deepen directionally, give pertinent data on subsurface locations and measured and true vertical depths. Give blowout preventer program, if any.

## 24.

SIGNED

John Gould, Jr.

TITLE Manager

DATE 5/15/91

(This space for Federal or State office use)

PERMIT NO.

APPROVAL DATE

AREA MANAGER

CARISBAND RESOURCE AND

APPROVED BY

Richard E. Mannus

TITLE

DATE

7-10-91

CONSTRUCTION SUBJECT TO:

GENERAL REQUIREMENTS AND  
SPECIAL STIPULATIONS

ATTACHED

APPROVAL EXTENDED TO 7/10/93  
DEPTH REVISED TO 4900'

\*See Instructions On Reverse Side

Submit to Appropriate  
District Office  
State Lease - 4 copies  
Fee Lease - 3 copies

State of New Mexico  
Energy, Minerals and Natural Resources Department

Form C-102  
Revised 1-1-89

OIL CONSERVATION DIVISION

DISTRICT I  
P.O. Box 1980, Hobbs, NM 88240

DISTRICT II  
P.O. Drawer DD, Artesia, NM 88210

DISTRICT III  
1000 Rio Brazos Rd., Aztec, NM 87410

P.O. Box 2088  
Santa Fe, New Mexico 87504-2088

WELL LOCATION AND ACREAGE DEDICATION PLAT

All Distances must be from the outer boundaries of the section

Operator <b>Socorro Petroleum Company</b>			Lease <b>H.E. West "B"</b>		Well No. <b>49</b>
Unit Letter <b>M</b>	Section <b>3</b>	Township <b>17 South</b>	Range <b>31 East</b>	County <b>Eddy</b>	
Actual Footage Location of Well: <b>1305</b> feet from the <b>South</b> line and <b>1305</b> feet from the <b>West</b> line					
Ground level Elev. <b>3838</b>	Producing Formation <b>Grayburg</b>		Pool <b>Grayburg Jackson</b>	Dedicated Acreage: <b>20</b> Acres	

1. Outline the acreage dedicated to the subject well by colored pencil or hatchure marks on the plat below.

2. If more than one lease is dedicated to the well, outline each and identify the ownership thereof (both as to working interest and royalty).

3. If more than one lease of different ownership is dedicated to the well, have the interest of all owners been consolidated by communitization, unitization, force-pooling, etc.?

☐ Yes ☐ No If answer is "yes" type of consolidation \_\_\_\_\_

If answer is "no" list the owners and tract descriptions which have actually been consolidated. (Use reverse side of this form if necessary.) \_\_\_\_\_

No allowable will be assigned to the well until all interests have been consolidated (by communitization, unitization, forced-pooling, or otherwise) or until a non-standard unit, eliminating such interest, has been approved by the Division.

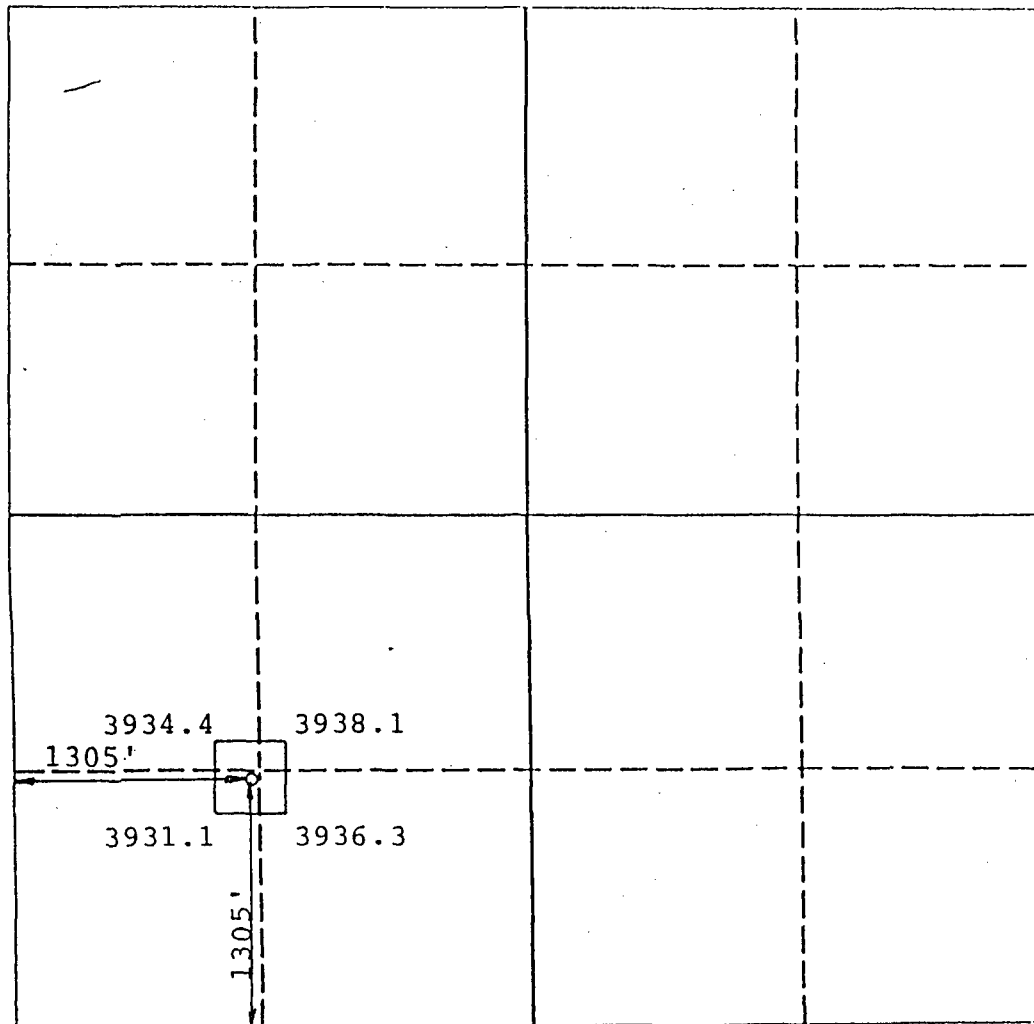

OPERATOR CERTIFICATION

I hereby certify that the information contained herein is true and complete to the best of my knowledge and belief.

*Ben D. Gould*  
Signature

**Ben D. Gould**  
Printed Name

**Manager**  
Position

**Socorro Petroleum Co.**  
Company

**5/15/91**  
Date

SURVEYOR CERTIFICATION

I hereby certify that the well location shown on this plat was plotted from field notes of actual surveys made by me or under my supervision, and that the same is true and correct to the best of my knowledge and belief.

Date Surveyed

**February 22, 1991**

Signature & Seal of  
Professional Surveyor

**P.R. Patton**

Certificate No.

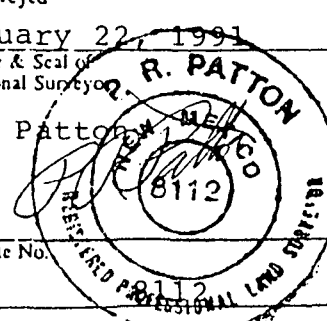

SOCORRO PETROLEUM COMPANY  
KEEL-WEST WATERFLOOD PROJECT  
Eddy County, New Mexico

T.17S., R.31E.

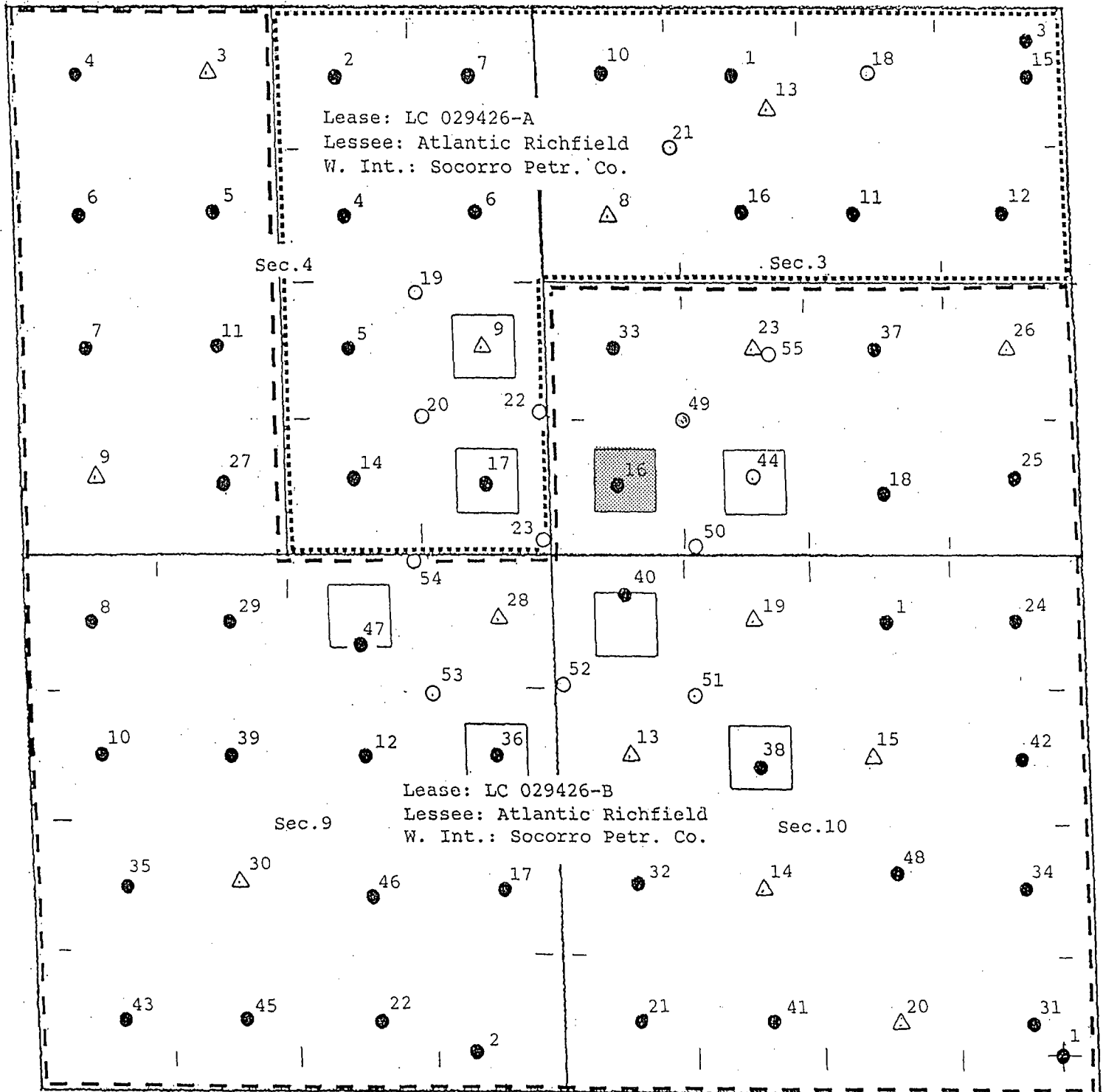

Standard Location



Proposed Location

OWNERSHIP MAP

(Grayburg)