

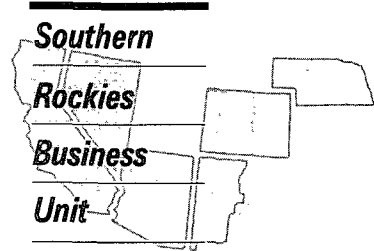

OIL CONSERVATION DIVISION  
RECEIVED

'94 AUG 16 AM 8 50



August 12, 1994

Mr. William J. LeMay, Director  
New Mexico Oil Conservation Division  
P.O. Box 2088  
Santa Fe, New Mexico 87504

Application for Unorthodox Location  
Garcia Gas Com B#1 Well  
SE/4 Section 21-T29N-R10W  
Blanco Mesaverde Pool  
San Juan County, New Mexico

Amoco Production Company hereby requests administrative approval for an unorthodox location in the Blanco Mesaverde Pool. The Garcia Gas Com B #1 Well was drilled in 1965 at a location 1805' FNL and 2350' FEL of Section 21. The well has produced from the Basin Dakota formation since 1965. Amoco now wishes to abandon the Basin Dakota and recompleate to the Blanco Mesaverde. There is no record of an unorthodox location order for this well. Since this well is located 500' toward the interior of the spacing unit, no offset owners will be adversely affected. This spacing unit is in the S/2 Section 21-T29N-R10W. The offset operators will receive a copy of the application by certified mail with a request that they furnish your Santa Fe office with a waiver of objection and return one copy to Amoco.

Sincerely,

J. W. Hawkins

JWH/ewb

cc: Mr. Frank Chavez, Supervisor  
NMOC District III  
1000 Rio Brazos Rd.  
Aztec, NM 87410

Meridian Oil Inc.  
P.O. Box 4289  
Farmington, NM 87499

Arco Oil and Gas  
P.O. Box 1610  
Midland, TX 79710

WAIVER

\_\_\_\_\_ hereby waives objection to Amoco's application for unorthodox well location for the Garcia Gas Com B #1 Well in the Blanco Mesaverde Pool as proposed above.

By: \_\_\_\_\_

Date: \_\_\_\_\_

**VERIFICATION AND AFFIDAVIT**

STATE OF COLORADO       )  
CITY AND COUNTY        :  
OF DENVER                )

SS

J. W. Hawkins, of lawful age, being first duly sworn on his oath, deposes and says:

That he is employed in an engineering capacity by Amoco Production Company in its Denver, Colorado office; that he has been qualified as an expert engineering witness by the New Mexico Oil Conservation Division and his qualifications have been made of record; that Amoco's application for administrative approval for unorthodox location for the Garcia Gas Com B #1 Well in the Blanco Mesaverde Pool, San Juan County, New Mexico was prepared under his direction and supervision; that the matter and things therein set forth are true and correct to the best of his knowledge and beliefs. Copies of the application have been mailed by certified mail to the affected operators.

  
\_\_\_\_\_  
J. W. Hawkins

Subscribed and sworn to before me this 12th day of August, 1994.

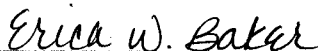
  
\_\_\_\_\_  
Erica W. Baker

**My Commission Expires**  
**AUGUST 20, 1997**

3,342,003.02 FT. N  
36° 43' 57" N

R10W

13,342,003.02 FT. N  
36° 43' 57" N

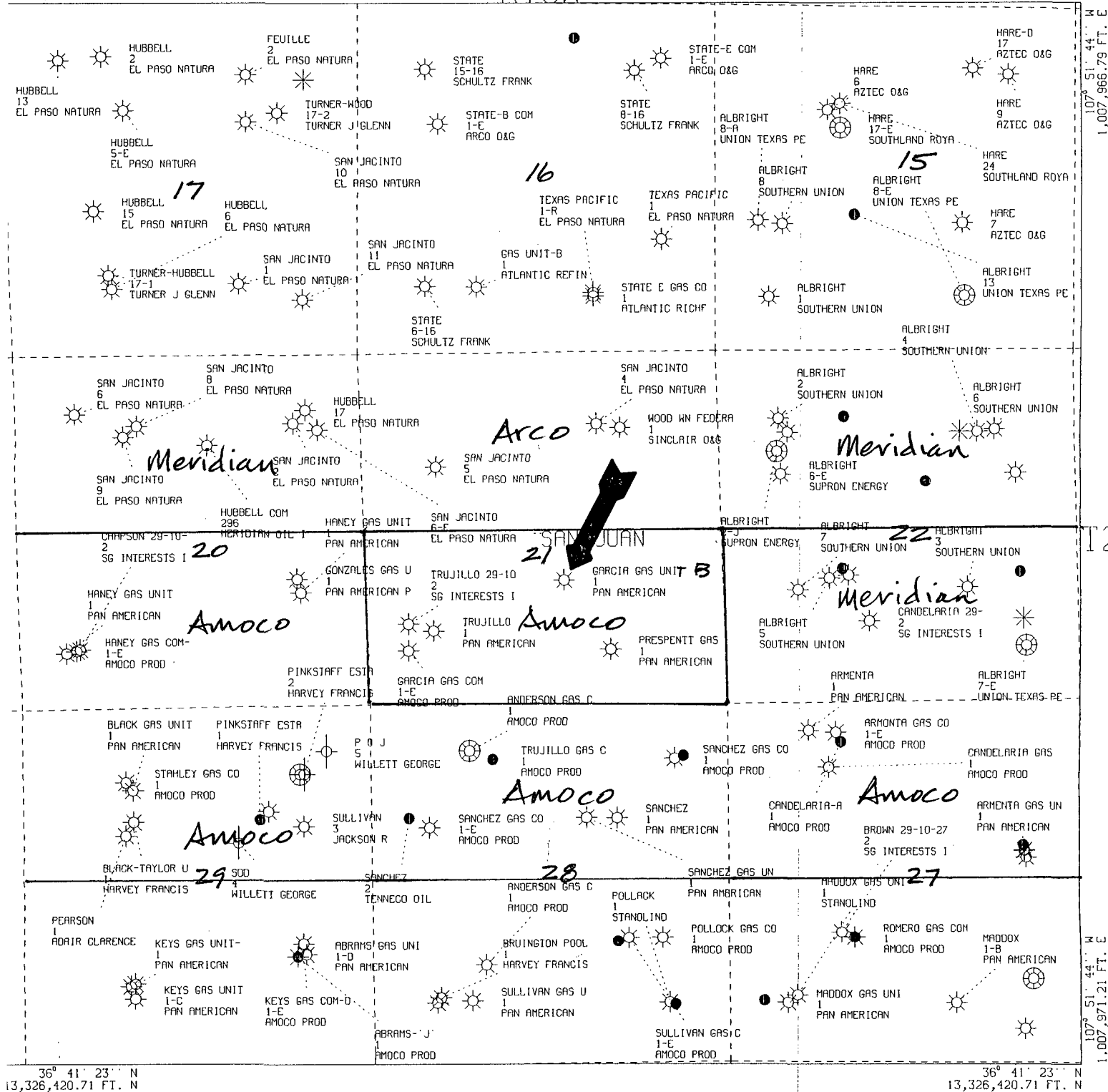

All geological and geophysical data, including the interpretation hereof, appearing on this map is the private and confidential property of Amoco Production Company. The publication or reproduction thereof without the written permission of said Company is strictly prohibited.



POLYCONIC CENTRAL MERIDIAN - 107° 53' 22" W LON  
SPHEROID - 6

AMOCO PRODUCTION COMPANY  
GARCIA GAS COM B 1  
SEC. J21-T29N-R10W  
ALL OFFSET WELLS

SCALE 1 IN. = 2,000 FT. MAY 2, 1994.

HORIZONTAL DATUM NAD27

228A--RUN-94122091350

NO. OF COPIES RECEIVED	
DISTRIBUTION	
SANTA FE	1
FILE	1
U.S.G.S.	2
LAND OFFICE	
OPERATOR	1

# NEW MEXICO OIL CONSERVATION COMMISSION



Form C-101  
Revised 1-1-65

5A. Indicate Type of Lease STATE <input type="checkbox"/> FEE <input checked="" type="checkbox"/>
5. State Oil & Gas Lease No.
7. Unit Agreement Name
8. Farm or Lease Name <b>Garcia Gas Unit "B"</b>
9. Well No. <b>1</b>
10. Field and Pool, or Wildcat <b>Basin Dakota</b>
12. County <b>San Juan</b>
19. Proposed Depth <b>6350</b>
19A. Formation <b>Dakota</b>
20. Rotary or C.T. <b>Rotary</b>
21. Elevations (Show whether DF, RT, etc.) <b>Will report later.</b>
21A. Kind & Status Plug. Bond <b>Statewide</b>
21B. Drilling Contractor <b>JCM Drilling Company</b>
22. Approx. Date Work will start <b>May 21, 1965</b>

## APPLICATION FOR PERMIT TO DRILL, DEEPEN, OR PLUG BACK

1a. Type of Work b. Type of Well OIL WELL <input type="checkbox"/> GAS WELL <input checked="" type="checkbox"/> OTHER <input type="checkbox"/> DEEPEN <input type="checkbox"/> PLUG BACK <input type="checkbox"/>	2. Name of Operator <b>PAN AMERICAN PETROLEUM CORPORATION</b>	3. Address of Operator <b>P. O. Box 400, Farmington, New Mexico</b>	4. Location of Well UNIT LETTER <b>J</b> LOCATED <b>1805</b> FEET FROM THE <b>South</b> LINE AND <b>2350</b> FEET FROM THE <b>East</b> LINE OF SEC. <b>21</b> TWP. <b>29-N</b> RGE. <b>10-W</b> NMPM
23.			

## PROPOSED CASING AND CEMENT PROGRAM

SIZE OF HOLE	SIZE OF CASING	WEIGHT PER FOOT	SETTING DEPTH	SACKS OF CEMENT	EST. TOP
12-1/4"	8-5/8"	26.5	350	225	Surface
7-7/8"	4-1/2"	10.54	6350	1400*	Surface

\*2 Stage tool to be set 100' below base of Mesaverde.

Copies of Location Plat are attached.

Copies of any logs run will be furnished upon completion of well.



Verbal approval received May 13, 1965, E. C. Arnold to J. C. Glover.

IN ABOVE SPACE DESCRIBE PROPOSED PROGRAM: IF PROPOSAL IS TO DEEPEN OR PLUG BACK, GIVE DATA ON PROPOSED PRODUCTIVE ZONE AND PROPOSED NEW PRODUCTIVE ZONE. GIVE BLOWOUT PREVENTER PROGRAM, IF ANY.

I hereby certify that the information above is true and complete to the best of my knowledge and belief.

**F. L. Nabors, District Engineer**

Signed ORIGINAL SIGNED BY Title

**F. H. HOLLINGSWORTH**  
(This space for State Use)

APPROVED BY Emergency TITLE

CONDITIONS OF APPROVAL, IF ANY:

FARMINGTON DISTRICT	DS	
	DE	
	DSS	
	AS	
	AC	
	EE	
	OE	
	KE	
	1. R. L. R. L.	
	2. R. L. R. L.	

Date **May 13, 1965**

## Well Location and Acreage Dedication Plat

Section A.

Date May 12, 1965

Operator PAN AMERICAN PETROLEUM CORPORATION Lease GARCIA GAS UNIT "B"  
 Well No. 1 Unit Letter J Section 21 Township 29 NORTH Range 10 WEST NMPM  
 Located 1805 Feet From SOUTH Line, 2350 Feet From EAST Line  
 County SAN JUAN G. L. Elevation REPORT LATER Dedicated Acreage 320 Acres  
 Name of Producing Formation DAKOTA Pool BASIN DAKOTA

1. Is the Operator the only owner in the dedicated acreage outlined on the plat below?

Yes \_\_\_\_\_ No X2. If the answer to question one is "no", have the interests of all the owners been consolidated by communitization agreement or otherwise? Yes X No \_\_\_\_\_. If answer is "yes", Type of Consolidation.

Declaration of Unit completed.

3. If the answer to question two is "no", list all the owners and their respective interests below:

Owner

Land Description

Section B.

This is to certify that the information  
 in Section A above is true and complete  
 to the best of my knowledge and belief.

PAN AMERICAN PETROLEUM CORP.F. H. Hollingsworth (Operator)(Representative)P. O. Box 480(Address)Farmington, New Mexico

Note: All distances must be from outer boundaries of section.

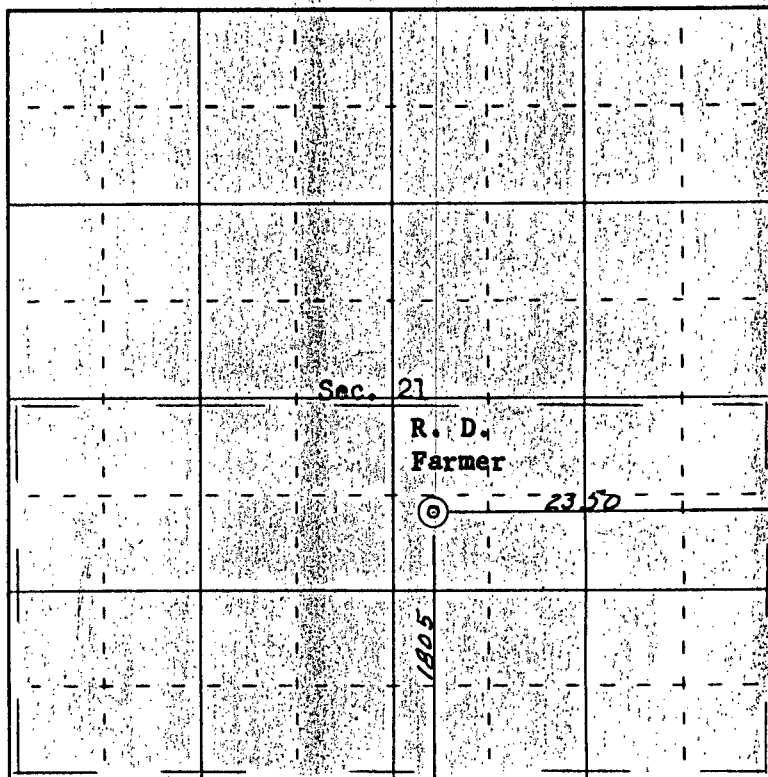

Ref: GLO plat dated 19 April 1881

0 330 660 990 1320 1650 1980 2310 2640 2000 1500 1000 500 0

Scale 4 inches equal 1 mile

This is to certify that the above plat was prepared from field notes of actual surveys  
 made by me or under my supervision and that the same are true and correct to the best  
 of my knowledge and belief.

(Seal)

Date Surveyed November 4, 1964

Farmington, New Mexico

James P. Leese  
 Registered Professional Engineer and/or Land Surveyor  
 James P. Leese, N. Mex. Reg. No. 1463  
 San Juan Engineering Company

NO. OF COPIES RECEIVED		
DISTRIBUTION		
SANTA FE		
FILE		
U.S.G.S.		
LAND OFFICE		
OPERATOR		

# NEW MEXICO OIL CONSERVATION COMMISSION

Form C-103  
Supersedes Old  
C-102 and C-103  
Effective 1-1-65

5a. Indicate Type of Lease	
State <input type="checkbox"/>	Fee <input checked="" type="checkbox"/>
5. State Oil & Gas Lease No.	

## SUNDRY NOTICES AND REPORTS ON WELLS (DO NOT USE THIS FORM FOR PROPOSALS TO DRILL OR TO DEEPEN OR PLUG BACK TO A DIFFERENT RESERVOIR. USE "APPLICATION FOR PERMIT" (FORM C-101) FOR SUCH PROPOSALS.)

1. OIL WELL <input type="checkbox"/> GAS WELL <input checked="" type="checkbox"/> OTHER <input type="checkbox"/>		7. Unit Agreement Name
2. Name of Operator Pan American Petroleum Corporation		8. Farm or Lease Name Garcia Gas Unit B
3. Address of Operator Security Life Building, Denver, Colorado 80202		9. Well No. 1
4. Location of Well UNIT LETTER <u>J</u> <u>1805</u> FEET FROM THE <u>South</u> LINE AND <u>2350</u> FEET FROM THE <u>East</u> LINE, SECTION <u>21</u> TOWNSHIP <u>29-N</u> RANGE <u>10-W</u> NMPM.		10. Field and Pool, or Wildcat Basin Dakota
15. Elevation (Show whether DF, RT, GR, etc.) 5609 (RDB)		12. County San Juan

## Check Appropriate Box To Indicate Nature of Notice, Report or Other Data NOTICE OF INTENTION TO: SUBSEQUENT REPORT OF:

PERFORM REMEDIAL WORK <input type="checkbox"/>	PLUG AND ABANDON <input type="checkbox"/>	REMEDIAL WORK <input type="checkbox"/>	ALTERING CASING <input type="checkbox"/>
TEMPORARILY ABANDON <input type="checkbox"/>	CHANGE PLANS <input type="checkbox"/>	COMMENCE DRILLING OPNS. <input type="checkbox"/>	PLUG AND ABANDONMENT <input type="checkbox"/>
PULL OR ALTER CASING <input type="checkbox"/>	OTHER <input type="checkbox"/>	CASING TEST AND CEMENT JOB <input type="checkbox"/>	Well History <input checked="" type="checkbox"/>

## 17. Describe Proposed or Completed Operations (Clearly state all pertinent details, and give pertinent dates, including estimated date of starting any proposed work) SEE RULE 1103.

The above well was spudded on 6-23-65 and drilled to a depth of 932'. 8 5/8" casing was set at that depth with 750 sacks cement containing 2 pounds Tuf Plug per sack, 1/2 pound Celo-Flake per sack followed by 50 sacks neat cement. Cement circulated to surface. After waiting on cement tested casing with 800 psi. Test O.K. Reduced hole size to 7 7/8" and resumed drilling

Well was drilled to a total depth of 6518'. 4 1/2" casing was set at that depth with stage collar set at 4558. Cemented first stage with 400 sacks cement containing 6% gel, 2 pounds Tuf Plug per sack followed by 100 sacks neat. Cemented second stage with 1100 sacks cement containing 6% gel, 2 pounds Tuf Plug per sack and followed by 25 sacks neat cement. After waiting on cement tested casing with 3500 psi. Test O.K.

Cemented the 4 1/2" - 8 5/8" casing annulus with 400 sacks cement containing 6% gel, 1 pound Tuf Plug and 1/2 pound Flo Ceal per sack.

Perforated 6360-82 with 3 shots per foot. Fracked these perforations with 45,108 gallons water containing 0.8% potassium chloride, 2 1/2 pounds J-100 per 1000 gallons and 40,000 pounds sand. Breakdown pressure 3400 psi. Average treating pressure 3200 psi. Average injection rate 45 BPM. Flowed well to clean up. (over)

## 18. I hereby certify that the information above is true and complete to the best of my knowledge and belief.

SIGNED R. H. Beers R. H. Beers TITLE Administrative Assistant DATE 8-26-65

APPROVED BY \_\_\_\_\_ TITLE \_\_\_\_\_ DATE \_\_\_\_\_  
CONDITIONS OF APPROVAL, IF ANY:

2 3/8" tubing landed at 6367 and well completed 7-22-65 as shut in Basin Dakota field development well. Potential Test 3-3-65. Flowed 5058 MCFPD through 3/4" choke after 3 hours flow. Absolute open flow potential 5957 MCFPD. Shut in casing pressure after 12 days 2063 psig.

**Mike Stogner**

---

**From:** Ernie Busch  
**To:** Mike Stogner  
**Subject:** AMOCO (NSL)  
**Date:** Thu, Sep 15, 1994 7:58AM  
**Priority:** High

GARCIA GAS COM B#1  
1805' FNL; 2350" FEL  
J-21-29N-10W  
RECOMMEND: APPROVAL