

HINKLE, COX, EATON, COFFIELD & HENSLEY
P.L.L.C.*

ATTORNEYS AT LAW

218 MONTEZUMA POST OFFICE BOX 2068
SANTA FE, NEW MEXICO 87504-2068
(505) 982-4554 FAX (505) 982-8623

LEWIS C. COX, JR. (1924-1993)
CLARENCE E. HINKLE (1904-1985)

OF COUNSEL
O. M. CALHOUN* JOE W. WOOD
RICHARD L. CAZZELL* RAY W. RICHARDS*
L. A. WHITE*

AUSTIN AFFILIATION
HOFFMAN & STEPHENS, P.C.
KENNETH R. HOFFMAN*
TOM D. STEPHENS*
RONALD C. SCHULTZ, JR.*
JOSE CANO*

JEFFREY S. BAIRD*
THOMAS E. HOOD*
REBECCA NICHOLS JOHNSON
STANLEY K. KOTOVSKY, JR.
H. R. THOMAS
ELLEN S. CASEY
MARGARET CARTER LUDEWIG
S. BARRY PAISNER
MARTIN MEYERS
WYATT L. BROOKS*
DAVID M. RUSSELL*
ANDREW J. CLOUTIER
STEPHANIE LANDRY
KIRT E. MOELLING*
DIANE FISHER
JULIE P. NEERKEN
WILLIAM P. SLATTERY
CHRISTOPHER M. MOODY

JAMES A. GILLESPIE
MARGARET R. MCNETT
LISA K. SMITH*
NORMAN D. EWART
DARREN T. GROCE*
MOLLY MCINTOSH
MARCIA B. LINCOLN
SCOTT A. SHUART*
PAUL G. NASON
R. TREV ARVIZU, III
AMY C. WRIGHT*
BRADLEY G. BISHOP*
KAROLYN KING NELSON
ELLEN T. LOUDERBOUGH
BARBARA GREGG GLENN
JAMES H. WOOD*

PAUL W. EATON
CONRAD E. COFFIELD
HAROLD L. HENSLEY, JR.
STUART D. SHANOR
ERIC D. LANPHERE
C. D. MARTIN
ROBERT P. TINNIN, JR.
MARSHALL G. MARTIN
MASTON C. COURTNEY**
DON L. PATTERSON**
DOUGLAS L. LUNSFORD
NICHOLAS J. NOEDING
T. CALDER EZZELL, JR.
WILLIAM B. BURFORD*
RICHARD E. OLSON
RICHARD R. WILFONG*
THOMAS J. MCBRIDE
NANCY S. CUSACK

JEFFREY L. FORNACIARI
JEFFREY D. HEWETT
JAMES BRUCE
JERRY F. SHACKELFORD*
JEFFREY W. HELLBERG*
WILLIAM F. COUNTISS**
ALBERT L. PITTS
THOMAS M. HNASKO
JOHN C. CHAMBERS*
GARY D. COMPTON*
W. H. BRIAN, JR.**
RUSSELL J. BAILEY**
CHARLES R. WATSON, JR.**
THOMAS D. HAINES, JR.
GREGORY J. NIBERT
MARK C. DOW
FRED W. SCHWENDIMANN
JAMES M. HUDSON

*REGISTERED IN NEW MEXICO
AS HINKLE, COX, EATON,
COFFIELD & HENSLEY, P.L.L.C., LTD., CO.

*NOT LICENSED IN NEW MEXICO
*FORMERLY COMPRISING THE FIRM OF
CULTON, MORGAN, BRITAIN & WHITE, P.C.

November 9, 1995

VIA HAND DELIVERY

Michael E. Stogner
Oil Conservation Division
2040 So. Pacheco Street
Santa Fe, New Mexico 87501

Dear Mr. Stogner:

Pursuant to Division Rule 104(F)(1) and Division Memorandum 1-90, Devon Energy Corporation (Nevada) hereby applies for administrative approval of an unorthodox oil well location for the following well:

Cactus State Well No. 12; 990 feet FNL and 1190 feet FEL (Unit A) of Section 16, Township 21 South, Range 26 East, N.M.P.M., Eddy County, New Mexico; Undesignated East Catclaw Draw-Delaware Pool. (A Form C-102 for the well is attached as Exhibit A.)

The East Catclaw Draw-Delaware Pool is subject to statewide spacing rules, with 40-acre spacing and wells to be located no closer than 330 feet to the boundary of the well unit.

The unorthodox location is necessary primarily due to topographic reasons. Referring to Exhibit B, existing oil wells are marked by black dots, and the proposed well is circled in red. The proposed well was moved west from an orthodox location due to a drainage ditch at approximately 990 feet FEL.

Geology is a factor in this application. Attached as Exhibit C is a structure map on top of the Delaware "B" zone. As you move further East in the NE $\frac{1}{4}$ NE $\frac{1}{4}$ of Section 16, the acreage becomes less prospective.

Exhibit C also indicates offset leasehold ownership. The information on the plat is current and correct. Devon is the operator of Section 16, and owns the leases on the S $\frac{1}{2}$ SE $\frac{1}{4}$ of Section 9, SW $\frac{1}{4}$ SW $\frac{1}{4}$ of Section 10, and Section 15. Thus, it is the only offset lessee.

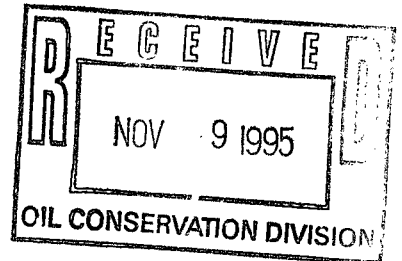

POST OFFICE BOX 10
ROSWELL, NEW MEXICO 88202
(505) 622-6510
FAX (505) 623-9332

POST OFFICE BOX 3580
MIDLAND, TEXAS 79702
(915) 683-4691
FAX (915) 683-6518

POST OFFICE BOX 9238
AMARILLO, TEXAS 79105
(806) 372-5569
FAX (806) 372-9761

POST OFFICE BOX 2043
ALBUQUERQUE, NEW MEXICO 87103
(505) 768-1500
FAX (505) 768-1529

401 W. 15TH STREET, SUITE 800
AUSTIN, TEXAS 78701
(512) 476-7137
FAX (512) 476-5431

Michael E. Stogner
November 9, 1995
Page 2

Directional drilling to reach a standard bottom-hole location would increase the cost of the well by approximately \$30,000, and lead to substantially higher operating costs. Other operators who have drilled directional wells in the Delaware have experienced substantial cost overruns and operational difficulties. As a result, Devon does not desire to directionally drill the well.

Based on all these factors, Devon requests approval of the proposed location.

This application is submitted in triplicate. Your attention to this matter is appreciated. If this matter cannot be processed administratively, please set it for the first available hearing. Thank you.

Very truly yours,

HINKLE, COX, EATON, COFFIELD
& HENSLEY, P.L.L.C., Ltd., Co.

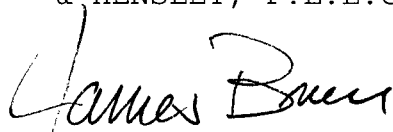
A handwritten signature in cursive script that reads "James Bruce".

James Bruce
Attorneys for Devon Energy
Corporation (Nevada)

Enclosures
cc: Ken Gray (w/o encl.)

devon7.1tr

DISTRICT I
P. O. Box 1980
Hobbs, NM 88241-1980

State of New Mexico
Energy, Minerals, and Natural Resources Department

Form C-102
Revised 02-10-94
Instructions on back

DISTRICT II
P. O. Drawer DD
Artesia, NM 88211-0719

OIL CONSERVATION DIVISION

P. O. Box 2088
Santa Fe, New Mexico 87504-2088

Submit to the Appropriate
District Office
State Lease - 4 copies
Fee Lease - 3 copies

☐ AMENDED REPORT

DISTRICT IV
P. O. Box 2088
Santa Fe, NM 87507-2088

WELL LOCATION AND ACREAGE DEDICATION PLAT

1 API Number		2 Pool Code		3 Pool Name					
4 Property Code		5 Property Name CACTUS STATE						6 Well Number 12	
7 OGRID No.		8 Operator Name DEVON ENERGY CORPORATION						9 Elevation 3233'	
10 SURFACE LOCATION									
UL or lot no. A	Section 16	Township 21 SOUTH	Range 28 EAST, N.M.P.M.	Lot Ida	Feet from the 990'	North/South line NORTH	Feet from the 1190'	East/West line EAST	County EDDY
11 BOTTOM HOLE LOCATION IF DIFFERENT FROM SURFACE									
UL or lot no.	Section	Township	Range	Lot Ida	Feet from the	North/South line	Feet from the	East/West line	County
12 Dedicated Acres		13 Joint or Infill		14 Consolidation Code		15 Order No.			

NO ALLOWABLE WELL BE ASSIGNED TO THIS COMPLETION UNTIL ALL INTERESTS HAVE BEEN
CONSOLIDATED OR A NON-STANDARD UNIT HAS BEEN APPROVED BY THE DIVISION

				990'	
				1190'	

EXHIBIT
A

OPERATOR CERTIFICATION

I hereby certify that the information
contained herein is true and complete
to the best of my knowledge and belief.

Signature

Printed Name

Title

Date

SURVEYOR CERTIFICATION

I hereby certify that the well
location shown on this plat was
plotted from field notes of actual
surveys made by me or under
my supervision, and that the
same is true and correct to the
best of my belief.

Date of Survey

OCTOBER 23, 1995

Signature and Seal of
Professional Surveyor

STATE OF NEW MEXICO
V. LYNN
BEZNER
NO. 7920
V. L. BEZNER LAND SURVEYOR #7920
JOB #42088-50 NE / V.H.B.

VICINITY MAP

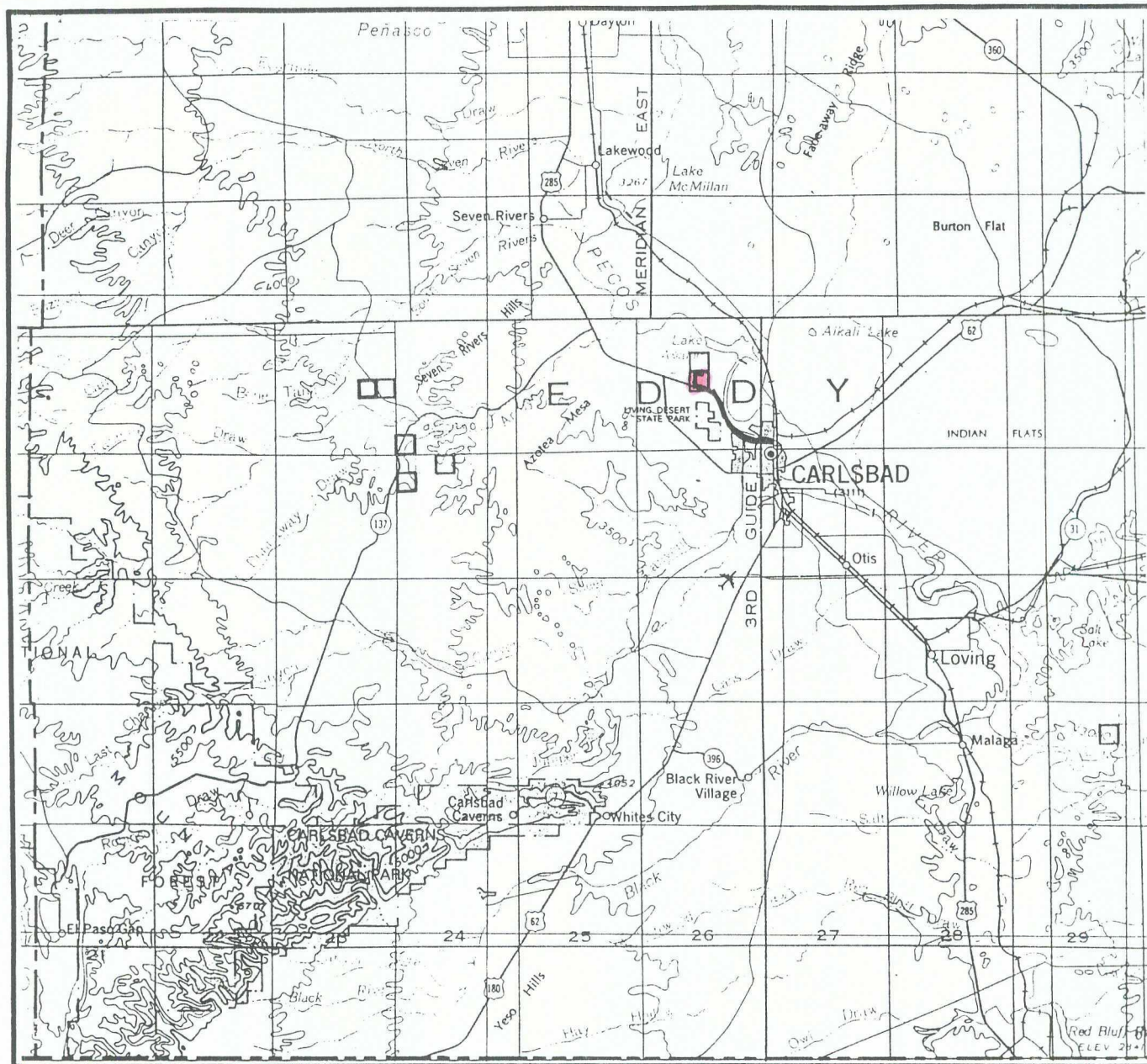

SECTION 16 TWP 21-S RGE 26-E
 SURVEY NEW MEXICO PRINCIPAL MERIDIAN
 COUNTY EDDY STATE NM
 DESCRIPTION 990' FNL & 1190' FEL

OPERATOR DEVON ENERGY CORPORATION
 LEASE CACTUS STATE #12

DISTANCE & DIRECTION FROM CARLSBAD, GO WEST 3.4
MILES ON U.S. HWY. 285, THENCE NORTH 0.7 MILE ON
LEASE ROAD, THENCE EAST 0.5 MILE ON LEASE ROAD
TO A POINT ±500' NORTH OF THE LOCATION.



This location has been very carefully staked on the ground according to the best official survey records, maps, and other data available to us.
 Review this plat and notify us immediately of any possible discrepancy.

TOPOGRAPHIC LAND SURVEYORS

Surveying & Mapping for the Oil & Gas Industry

1307 N. HOBART
 PAMPA, TX. 79065
 (800) 658-6382

6709 N. CLASSEN BLVD.
 OKLAHOMA CITY, OK. 73116
 (800) 654-3219

2903 N. BIG SPRING
 MIDLAND, TX. 79705
 (800) 767-1653

11/13

[illegible]

CONTOUR INTERVAL 20'

LONG. W 104°17'34"



This location has been very carefully staked on the ground according to the best official survey records, maps, and other data available to us.

Review this plat and notify us immediately of any possible discrepancy.

Surveying & Mapping for the Oil & Gas Industry

2903 N. BIG SPRING
MIDLAND, TX. 79705
(800) 767-1653

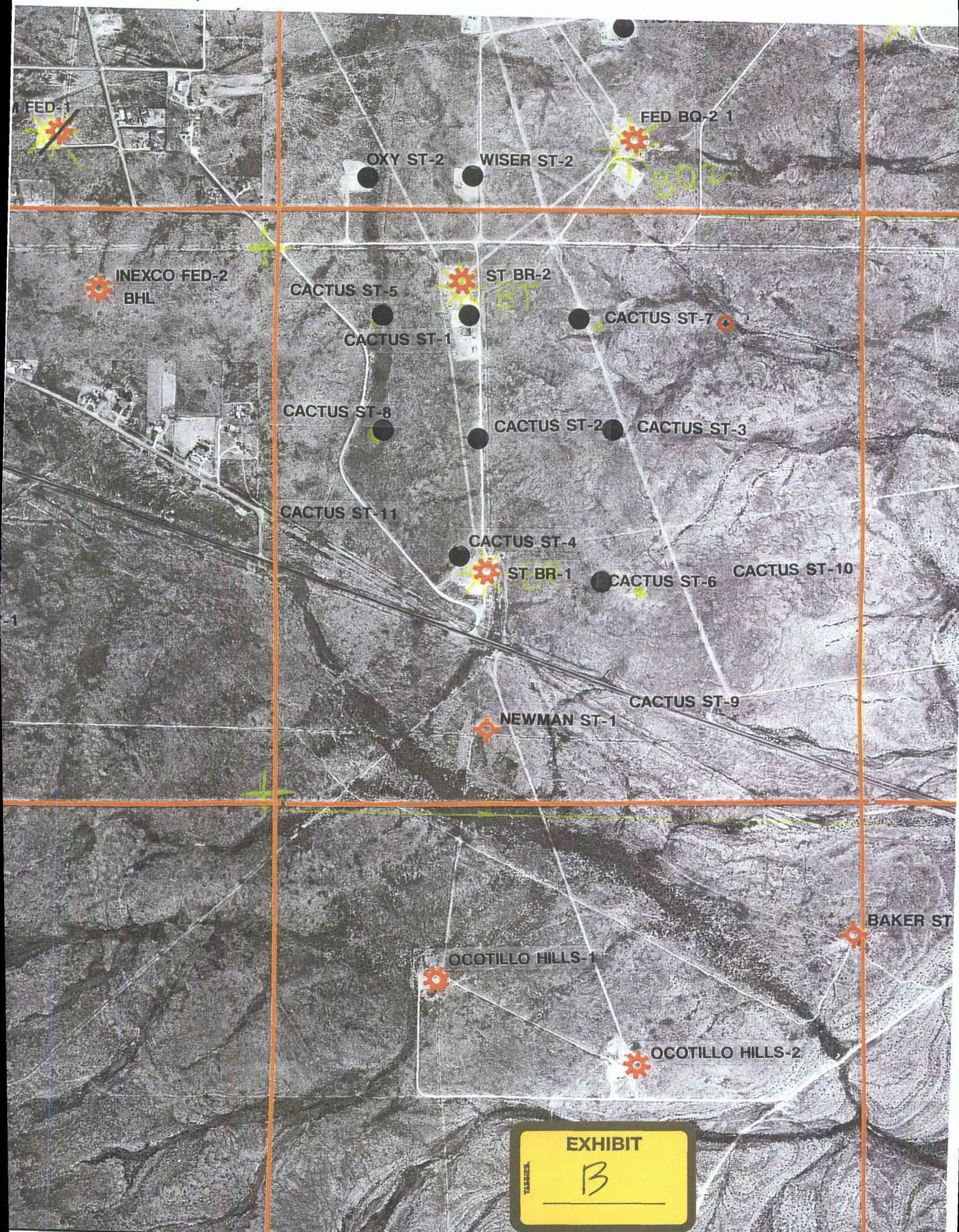

ANTWELL MORRIS R
ROC FED 1
10963
-81

11212
-216

COQUINA
ARCO FED
11287
+82

K-F
1
10973
-80

INEXCO
ST 1
11100
?

Devon

• LOWEST GOOD SHOW +104 IN
WISER #3
• LOWEST SHOW DRILLED WAS +74
IN HONDO #2; HOWEVER, SHOW WAS
POOR 107 FWD TR GAS.

CACTUS ST. No. 12

Devon

T 21 S
R 26 E

OIL WELL DRILLING CO
BAKER-STATE-1
1155

HANAGAN
OH 1
11158
TA
-84

HANAGAN
OH 2
11148
-158



E. CATCLAW DRAW
EDDY Co., NM
STRUCTURE MAP T/"B" ZONE
CT: 25'

