

6666

NEW MEXICO OIL CONSERVATION DIVISION
RECEIVED

OCT 17 1995 8 52

October 17, 1995

New Mexico Oil Conservation Division
Attn: Mr. Mike Stogner
2040 S. Pacheco
Santa Fe, New Mexico 87504

Re: Unorthodox location
Jackson B 37
567'FEL, 2400'FSL,
Sec. 24, T17S, R30E
Eddy County, New Mexico

Dear Mr. Stogner:

Burnett Oil Co., Inc. requests a exception without notice or hearing to Rule 104 for the referenced development well at the location shown due to topographical considerations. We are prevented from moving to the south because of U.S. Highway 82 and the required roadway easement.

Attached for your reference is a copy of our BLM approved APD which includes a John West Engineering location map and vicinity map for the area. We have also included our plat showing the wells in and around the proposed location. Burnett Oil Co., Inc. is the operator of all wells in the areas to the North, South and West. Mack Energy Corporation and Devon Energy Corporation are the only offset operators to our proposed location. You will find their signed waiver letter as evidence of notice about this well.

Please advise if further information is needed.

Yours truly,

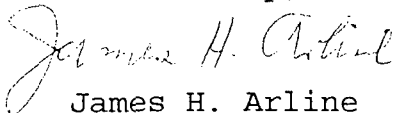

James H. Arline
Materials Coordinator

attachments

CCCC

September 29, 1995

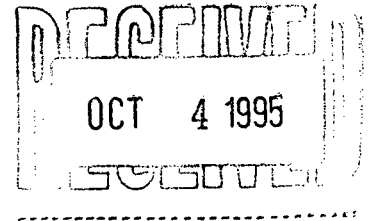

Mack Energy Corporation
P.O. Drawer 1359
Artesia, New Mexico 88211

Gentlemen:

According to ours records, you are the operator of the leases located in the NW/4 of the SW/4 of Section 19, Township 17S, Range 30 E, Eddy County, New Mexico.

Burnett Oil Co., Inc. hereby notifies you, as offset operator, of its application for its Jackson B #37 well with a projected total depth of approximately 3200' (Grayburg) to be located 567' FEL and 2400' FSL (Unit I) of Section 24, Township 17S, Range 30E, Eddy County, New Mexico. This unorthodox location is necessitated by topographical considerations and the Road and Right of Way of State Highway 82 which runs East and West, 158' south of the proposed well location. If you have no objection, we would appreciate your execution of the waiver below and returning it to us as soon as possible. We are in line for a rig so a very prompt return would be appreciated.

If you need further information, please let us know.

Yours truly,

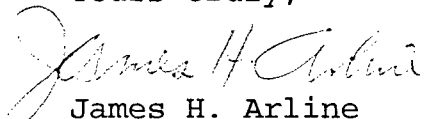
James H. Arline
Materials Coordinator

Attachment

Mack Energy Corporation has no objection to Burnett Oil Co., Inc. unorthodox location of its proposed Jackson B 37 well to be located 567' FEL and 2400' FSL (Unit I) of Section 24, Township 17S, Range 30e, Eddy County, New Mexico.

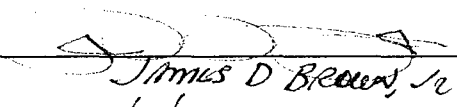
By:  Title: Manager
Date: 10/5/95

KL

CCCC

September 29, 1995

Devon Energy Corporation
1500 Mid America Tower
20 North Broadway
Oklahoma City, Ok 73102-8260

Gentlemen:

According to ours records, you are the operator of the leases located in the SW/4 of the NW/4 of Section 19, Township 17S, Range 30 E, Eddy County, New Mexico.

Burnett Oil Co., Inc. hereby notifies you, as offset operator, of its application for its Jackson B #37 well with a projected total depth of approximately 3200' (Grayburg) to be located 567' FEL and 2400' FSL (Unit I) of Section 24, Township 17S, Range 30E, Eddy County, New Mexico. This unorthodox location is necessitated by topographical considerations and the Road and Right of Way of State Highway 82 which runs East and West, 158' south of the proposed well location. If you have no objection, we would appreciate your execution of the waiver below and returning it to us as soon as possible. We are in line for a rig so a very prompt return would be appreciated.

If you need further information, please let us know.

Yours truly,

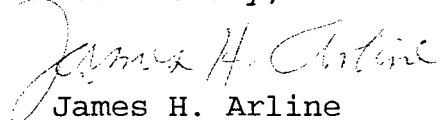
James H. Arline
Materials Coordinator

Attachment

Devon Energy Corporation has no objection to Burnett Oil Co., Inc. unorthodox location of its proposed Jackson B 37 well to be located 567' FEL and 2400' FSL (Unit I) of Section 24, Township 17S, Range 30E, Eddy County, New Mexico.

By:  Title: J.M. LACEY
Vice President

Date: 10-10-95

RECEIVED

6666

BLM INTERVIEW DIVISION
RECEIVED

OCT 17 1995

October 17, 1995

New Mexico Oil Conservation Division
Attn: Mr. Mike Stogner
2040 S. Pacheco
Santa Fe, New Mexico 87504

Re: Unorthodox location
Jackson B 37
567'FEL, 2400'FSL,
Sec. 24, T17S, R30E
Eddy County, New Mexico

Dear Mr. Stogner:

Burnett Oil Co., Inc. requests a exception without notice or hearing to Rule 104 for the referenced development well at the location shown due to topographical considerations. We are prevented from moving to the south because of U.S. Highway 82 and the required roadway easement.

Attached for your reference is a copy of our BLM approved APD which includes a John West Engineering location map and vicinity map for the area. We have also included our plat showing the wells in and around the proposed location. Burnett Oil Co., Inc. is the operator of all wells in the areas to the North, South and West. Mack Energy Corporation and Devon Energy Corporation are the only offset operators to our proposed location. You will find their signed waiver letter as evidence of notice about this well.

Please advise if further information is needed.

Yours truly,

James H. Arline

James H. Arline
Materials Coordinator

NSL-GB5K

attachments

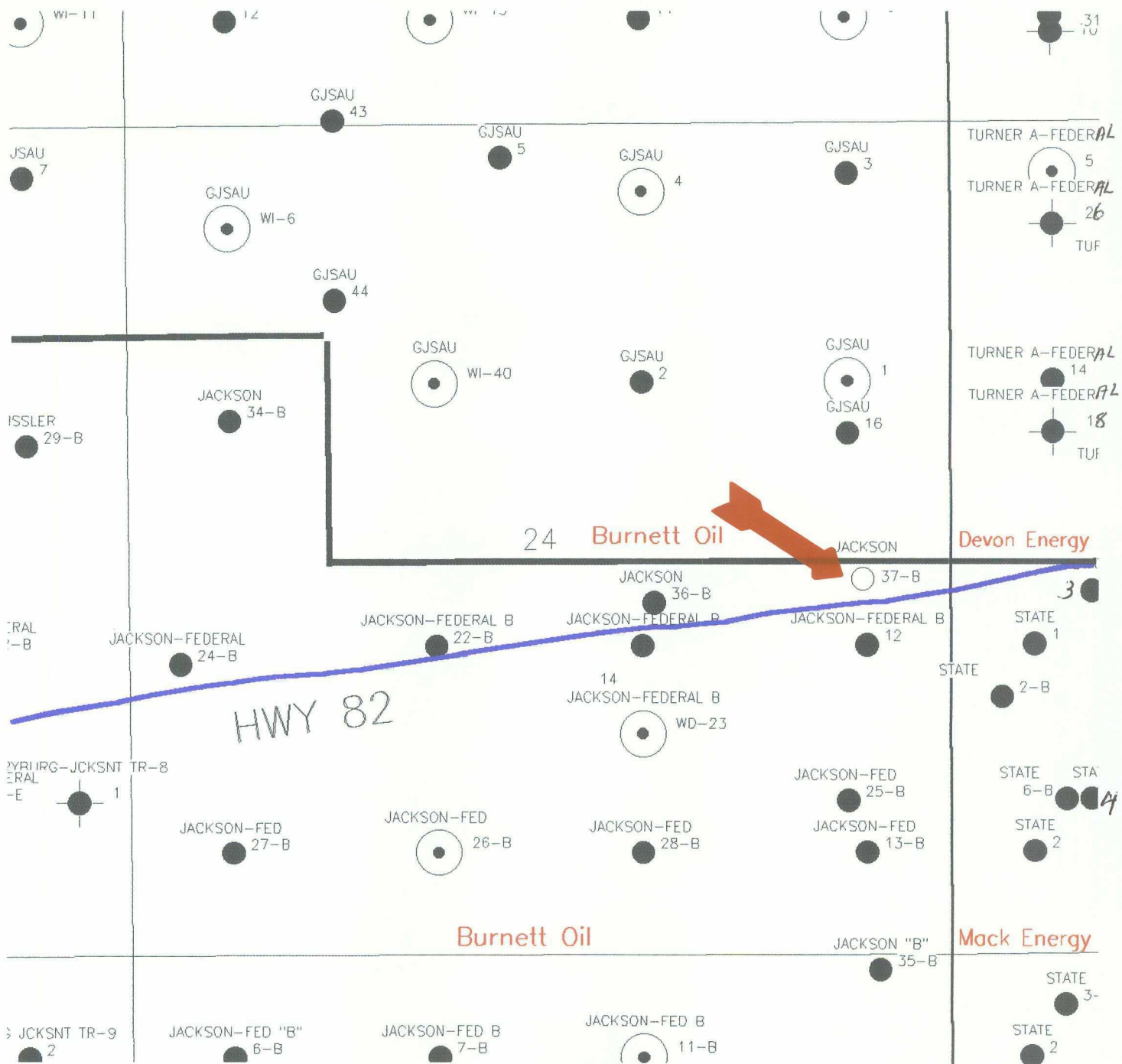

DISTRICT I
P.O. Box 1980, Hobbs, NM 88240

DISTRICT II
P.O. Drawer DD, Artesia, NM 88210

DISTRICT III
1000 Rio Brazos Rd., Aztec, NM 87410

State of New Mexico
Energy, Minerals and Natural Resources Department

Form C-102
Revised February 10, 1984
Instruction on back
Submit to Appropriate District Office
State Lease - 4 Copies
Fee Lease - 3 Copies

OIL CONSERVATION DIVISION

P.O. Box 2088
Santa Fe, New Mexico 87504-2088

☐ AMENDED REPORT

WELL LOCATION AND ACREAGE DEDICATION PLAT

API Number	Pool Code 28509	Pool Name GRAYBURG JACKSON 7RVS-QN-GB-SA
Property Code 002392	Property Name JACKSON "B"	Well Number 37
OGRID No. 003080	Operator Name BURNETT OIL COMPANY	Elevation 3651

Surface Location

UL or lot No.	Section	Township	Range	Lot Idn	Feet from the	North/South line	Feet from the	East/West line	County
I	24	17 S	30 E		2400	SOUTH	567	EAST	EDDY

Bottom Hole Location If Different From Surface

UL or lot No.	Section	Township	Range	Lot Idn	Feet from the	North/South line	Feet from the	East/West line	County
Dedicated Acres	Joint or Infill	Consolidation Code	Order No.						

NO ALLOWABLE WILL BE ASSIGNED TO THIS COMPLETION UNTIL ALL INTERESTS HAVE BEEN CONSOLIDATED
OR A NON-STANDARD UNIT HAS BEEN APPROVED BY THE DIVISION

				OPERATOR CERTIFICATION <i>I hereby certify the the information contained herein is true and complete to the best of my knowledge and belief.</i> Signature James B. McPeters Printed Name Engineer Title May 10, 1995 Date	
				SURVEYOR CERTIFICATION <i>I hereby certify that the well location shown on this plat was plotted from field notes of actual surveys made by me or under my supervision and that the same is true and correct to the best of my belief.</i> MARCH 3, 1995 Date Surveyed Signature & Seal of Professional Surveyor W.Q. Num. 95-1169289 Certificate No. JOHN W. WEST, 676 RONALD J. EIDSON, 3239	

LOCATION VERIFICATION MAP

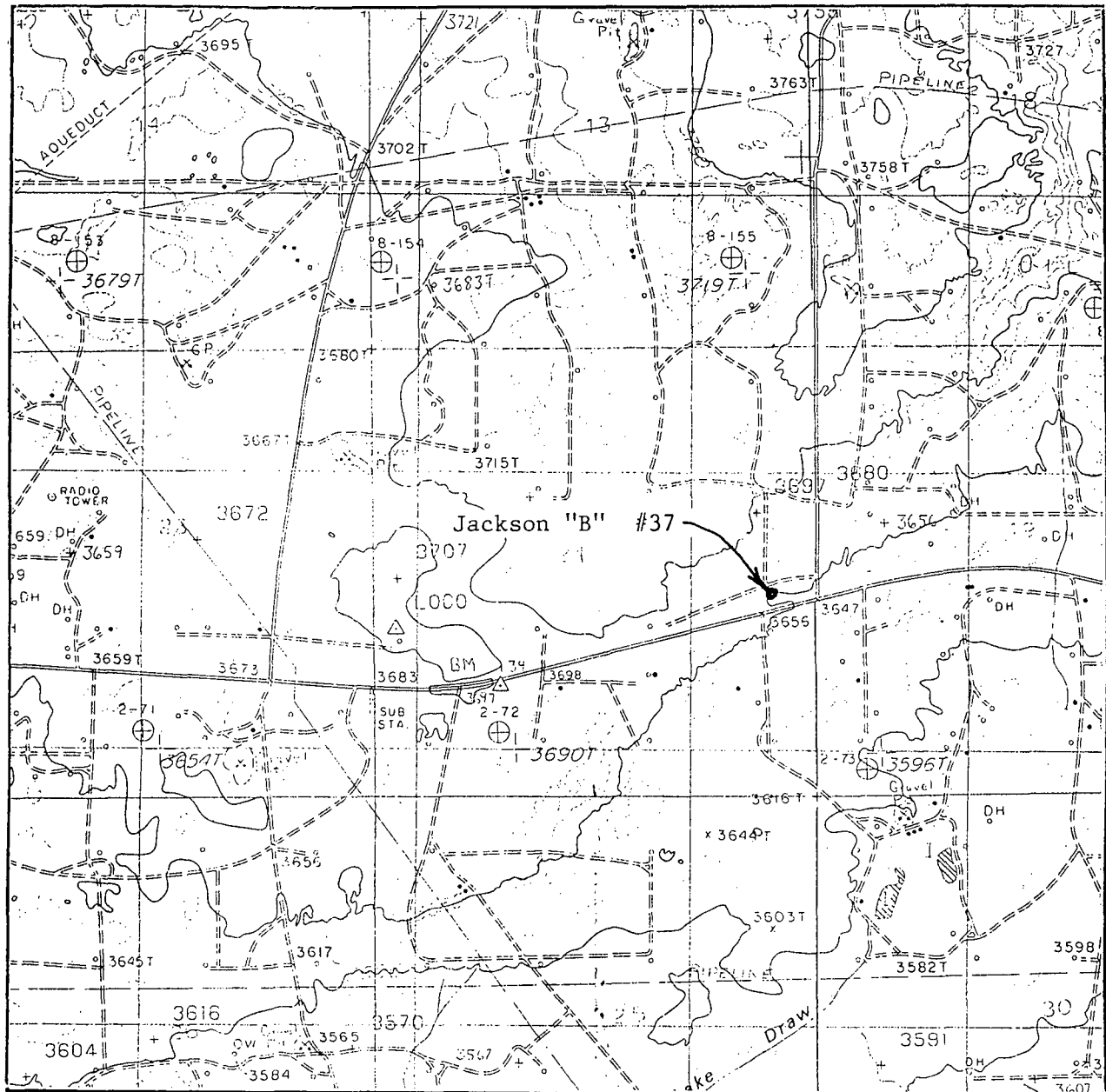

SCALE: 1" = 2000'

CONTOUR INTERVAL 10'

SEC. 24 TWP. 17-S RGE. 30-E

SURVEY N.M.P.M.

COUNTY Eddy STATE N.M.

DESCRIPTION 2400' FSL. & 567' FEL.

ELEVATION 3651

OPERATOR Burnett Oil Company

LEASE Jackson "B" #37

U.S.G.S. TOPOGRAPHIC MAP

Loco Hills, New Mexico

JOHN WEST ENGINEERING
HOBBS, NEW MEXICO
(505) 393-3117

VICINITY MAP

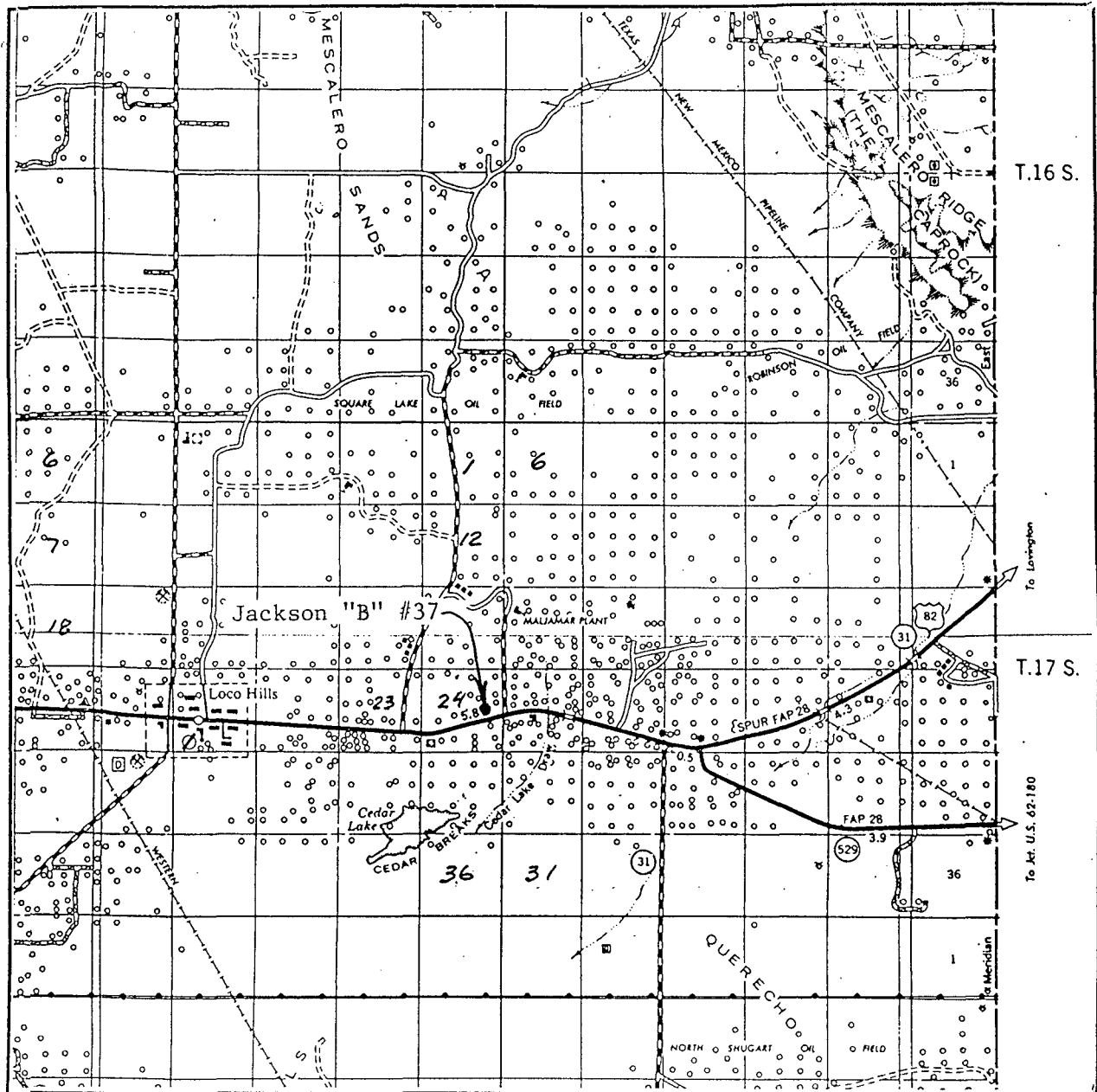

SCALE: 1" = 2 MILES

SEC. 24 TWP. 17-S RGE. 30-E

SURVEY N.M.P.M.,

COUNTY Eddy STATE N.M.

DESCRIPTION 2400' FSL. & 567' FEL.

ELEVATION 3651

OPERATOR Burnett Oil Company

LEASE Jackson "B" #37

JOHN WEST ENGINEERING
HOBBS, NEW MEXICO
(505) 393-3117

Form 3160-3
(November 1983)
(formerly 9-331C)

SUBMIT IN TRIPLICATE*
(Other instructions on
reverse side)

Form approved.
Budget Bureau No. 1004-0136
Expires August 31, 1985

**UNITED STATES
DEPARTMENT OF THE INTERIOR
BUREAU OF LAND MANAGEMENT**

APPLICATION FOR PERMIT TO DRILL, DEEPEN, OR PLUG BACK

1a. TYPE OF WORK

DRILL ☒

DEEPEN ☐

PLUG BACK ☐

b. TYPE OF WELL

**OIL
WELL** ☒

**GAS
WELL** ☐

OTHER

**SINGLE
ZONE** ☒

**MULTIPLE
ZONE** ☐

2. NAME OF OPERATOR

Burnett Oil Co., Inc.

3. ADDRESS OF OPERATOR

801 Cherry Street, Suite 1500, Fort Worth, Tx. 76102

4. LOCATION OF WELL (Report location clearly and in accordance with any State requirements.)*

At surface

Unit I, 567' FEL, 2400 FSL, Sec. 24, 17S, R30E

At proposed prod. zone

Same

UNORTHODOX

LOCATION:

**Subject to
Like Approval**

14. DISTANCE IN MILES AND DIRECTION FROM NEAREST TOWN OR POST OFFICE*

3.9 Miles East of Loco Hills, N.M.

15. DISTANCE FROM PROPOSED*

LOCATION TO NEAREST

PROPERTY OR LEASE LINE, FT.

(Also to nearest drilg. unit line, if any)

567'

18. DISTANCE FROM PROPOSED LOCATION*

TO NEAREST WELL, DRILLING, COMPLETED,

OR APPLIED FOR, ON THIS LEASE, FT.

430'

16. NO. OF ACRES IN LEASE

720(Contiguous)

19. PROPOSED DEPTH

3200'

**17. NO. OF ACRES ASSIGNED
TO THIS WELL**

40

20. ROTARY OR CABLE TOOLS

Rotary

21. ELEVATIONS (Show whether DF, RT, GR, etc.)

3656' GR

22. APPROX. DATE WORK WILL START*

June 1, 1995

23.

PROPOSED CASING AND CEMENTING PROGRAM

SIZE OF HOLE	SIZE OF CASING	WEIGHT PER FOOT	SETTING DEPTH	QUANTITY OF CEMENT
12 1/4"	8 5/8"	24#	475'	+/- 300 Sks. Cl. C (To Surface)
7 7/8"	5 1/2"	15.50#	3200'	+/- 1000 Sks. Cl. H(See Drill Plan)

A 12 1/4" surface hole will be drilled to approximately 475'. 8 5/8" casing will be run to this depth and cemented back to surface. WOC 12 hrs., then test casing and BOP. A 7 7/8" hole will be drilled to a depth of approximately 3200'. 5 1/2" casing will be run and cemented back to the base of the salt at approximately 1300'. If no water flows are encountered, open hole logs will be run. If we have water flows, cased hole logs will be run. This well will be conventionally completed in the Grayburg intervals.

*Approval Subject to
General Requirements and
Special Situations
Attached*

IN ABOVE SPACE DESCRIBE PROPOSED PROGRAM: If proposal is to deepen or plug back, give data on present productive zone and proposed new productive zone. If proposal is to drill or deepen directionally, give pertinent data on subsurface locations and measured and true vertical depths. Give blowout preventer program, if any.

24.

SIGNED

James S. M. [Signature]

TITLE

P. E. Eng.

DATE

May 10, 1995

(This space for Federal or State office use)

PERMIT NO.

APPROVAL DATE

APPROVED BY

Anthony J. Burke

TITLE

Acty AREA MANAGER

DATE

8/18/85

CONDITIONS OF APPROVAL, IF ANY:

***See Instructions On Reverse Side**

DRILLING PLAN
COVERING
BURNETT OIL CO., INC.
LEASE NO. NM 2747
JACKSON B LEASE, WELL NO. 37
UNIT LETTER I
567' FEL, 2400' FSL
SECTION 24, TOWNSHIP 17 SOUTH, RANGE 30 EAST
EDDY COUNTY, NEW MEXICO

(A) DRILLING PROGRAM

(1) Estimated tops of geologic markers:

Alluvium.....Surface
Anhydrite.....252'
Salt.....530'
Base Salt.....1322'
Yates.....1398'
Seven Rivers.....1696'
Red Sand.....2339'
Grayburg.....2749'
San Andres.....3126'

(2) Estimated depths of producing formations:

Fresh water.....None
Saltwater flows..(?)*
Oil and Gas.....1850'**, 2850'**

* As waterflows, if any, are encountered, their depth will be recorded, and drilling will continue to total depth. Multiple stage cementers will be placed in the production casing string to enable us to confine the waterflows to their respective depths by cementing.

** Oil and gas bearing zones, if any, will be determined by log analysis, and will be confined by cementing; subsequently perforated, stimulated and produced in a conventional manner.

(3) Blowout Preventer Specifications:

3000 psi Double Ram unit with hydraulic closing equipment. (See Exhibit E schematic). The preventer will be tested before drilling out below surface pipe setting depth. The exact description of the preventer and related equipment will depend on the successful contractor, who has not yet been selected. No high pressure hydrocarbon zones are anticipated.

(4) Supplementary drilling equipment information:

Not available at this time.

RECEIVED

SEP 7 10 43 AM '95

CAR.
AREA

Supplementary casing program information:

a. **Surface casing:** Surface casing will consist of new 8-5/8" OD 24# K-55 ST&C R3 pipe and will be run into a 12-1/4" hole with notched Texas Pattern shoe on bottom, insert float valve in first collar, 2 centralizers around shoe joint and first collar. Bottom 3 joints will be thread locked. Setting depth will be +/- 475' in the Rustler Anhydrite, depending on where a suitable casing seat can be found. Cement will be circulated back to the surface. Initial cement volume will be calculated to be 100% excess of the calculated annular volume between the 8-5/8" casing and the hole. If circulation of cement is not achieved due to lost circulation zone(s), annular space will be cemented via 1" from the surface as per BLM specifications. Twelve(12) hours WOC will be allowed. Casing will be tested to 800 psi before drilling out.

b. **Production casing:** Production casing will consist of new 5-1/2" OD 15.50# K55 R3 8rd LT&C pipe being run to total depth with float shoe on bottom, float collar in first collar, centralizers throughout pay intervals and above and below any multiple stage cementers, and being cemented with sufficient volume to bring top of cement 600' above the top of the highest potential producing horizon. If water flow is encountered, we will cement from TD back to the stage cementer, open stage cementer, cement from stage center with sufficient volume of Class C or equivalent to bring cement up to at least 600' above the highest potential producing horizon, then balancing hydrostatic weight of the cement by adjusting the flow of water to surface through the 5-1/2" casing, enabling the 2nd stage of cement to set up. Casing will be shut in after twelve(12) hours. If there is no flow of water to surface around the 5-1/2" casing, we will cement the water flow proper through the stage cementer with +/- 300 sacks. In case the 2nd stage is not successful in shutting off any annular flow, we will repeat the 2nd stage until successful. After drilling out and testing the casing to 2000 psi, a cement bond log will be run to evaluate the cement job.

- (5) **Mud program:** Native mud (red beds and shale) will be used to total depth. The surface hole will be drilled with fresh water and lost circulation materials as needed. The remaining hole will be drilled with brine water with necessary additives.

- (6) Logging program: If no water flow(s) are encountered, we will run GR/CN-D-DLL logs. If water flow(s) are encountered, no open hole logging will be attempted, and after casing is set, cased hole GR/CN logs will be run. No other testing or coring is anticipated.
- (7) Abnormal pressures or hazards: No abnormal pressures or potential hazards are anticipated. The maximum anticipated bottom hole pressure is 1000#. The maximum anticipated bottom hole temperature is 91°F.
- (8) Other facets of the operation to be pointed out:
None.

(B) HYDROGEN SULFIDE DRILLING PROGRAM

1. Hydrogen Sulfide Training

All personnel, whether regularly assigned, contracted, or employed on an unscheduled basis, will receive training from a qualified instructor in the following areas prior to commencing drilling operations on this well:

- a. The hazards and characteristics of Hydrogen Sulfide (H₂S).
- b. The proper use and maintenance of personal protective equipment and life support systems.
- c. The proper use of H₂S detectors, alarms, warning systems, briefing areas, evacuation procedures and prevailing winds.
- d. The proper techniques for first aid and rescue procedures.

In addition, supervisory personnel will be trained in the following areas:

- a. The effects of H₂S on metal components. If high tensile tubulars are to be used, personnel will be trained in their special maintenance requirements.
- b. Corrective action and shut-in procedures when drilling or reworking a well, blowout prevention and well control procedures.

- c. The contents and requirements of the H2S Drilling Operations Plan and the Public Protection Plan (if applicable.)

There will be an initial training session just prior to encountering a known or probable H2S zone (within 3 days or 500 feet) and weekly H2S and well control drills for all personnel in each crew. The initial training session shall include a review of the site specific H2S Drilling Operations Plan and the Public Protection Plan (if applicable). This plan shall be available at the wellsite. All personnel will be required to carry documentation that they have received the proper training.

2. H2S SAFETY EQUIPMENT AND SYSTEMS

Note: all H2S safety equipment and systems will be installed, tested and operational when drilling reaches a depth of 500 feet above, or three days prior to penetrating the first zone containing or reasonably expected to contain H2S.

a. Well Control Equipment:

- 1. Choke manifold with a minimum of one remote-controlled choke.
- 2. Blind rams and pipe rams to accommodate all pipe sizes with a properly sized closing unit.

b. Protective equipment for essential personnel:

- 1. Mark II Surviveair (or equivalent) 30 minute units located in the dog house and at briefing areas, as indicated on the well site diagram (EXHIBIT C-REVISED).

c. H2S detection and monitoring equipment:

- 1. 3 portable H2S monitors positioned on location for best coverage and response. These units have warning lights and audible sirens when H2S levels of 20 PPM are reached.

d. Visual warning systems:

- 1. Wind direction indicators as shown on wellsite diagram.

2. Caution/Danger signs shall be posted on roads providing direct access to location. Signs will be painted a high visibility yellow with black lettering of sufficient size to be readable at a reasonable distance from the immediate location. Bilingual signs will be used when appropriate.

e. Mud program:

1. The mud program has been designed to minimize the volume of H₂S circulated to the surface. Proper mud weight, safe drilling practices and the use of H₂S scavengers will minimize hazards when penetrating H₂S bearing zones.

f. Metallurgy:

1. All drill strings, casings, tubing, wellheads, BOPS, drilling spools, kill lines, choke manifold, valves and lines will be suitable for H₂S service.
2. All elastomers used for packing and seals shall be H₂S trim.

g. Communication:

1. Telephone and/or 2-way radio will be provided at wellsite.
2. Land line telephone is located in field office.

h. Well testing:

1. No drill stem testing is anticipated. Completion testing, if required, will be conducted under the same applicable H₂S guidelines that were used in drilling.

(C) SURFACE USE PROGRAM

- (1) Existing roads: Exhibits A and B show maps of the general area. From Loco Hills, New Mexico, go east on U.S. Highway 82 approximately 3.9 miles. Turn north through cattle guard on paved road and go approximately .05 mile. Turn back west on caliche road and go about 567' to location.

- (2) Access roads to be constructed: No new access roads will need to be constructed for this well.
- (3) Location of existing wells: See Exhibit A.
- (4) Location of existing or proposed production facilities: See Exhibit D for location of existing facilities. No new facilities are anticipated, with the exception of approximately 200' of flowline to be connected to an existing flowline. See Exhibit D.
- (5) Location and type of water supply: All water to be used in drilling the well will be brine or fresh water trucked from Loco Hills, New Mexico or fresh or produced water furnished by our waterflood facilities.
- (6) Construction materials: Construction material will be caliche which may be available at the proposed location. If not available on location or road, caliche will be hauled from nearest approved caliche pit.
- (7) Methods of handling waste disposal: Drill cuttings will be disposed of in the lined reserve drilling pit. Auxiliary emergency water containment pits may be necessitated by large volume water flows and these pits, which will hold only water, will not be lined. All drilling fluids will be allowed to evaporate after drilling is completed, at which time pits will be backfilled, leveled and reseeded. Trash, waste paper, garbage and junk will be placed in a portable screened trash container on location. All trash and debris will be transported to an authorized disposal station within 30 days following completion activities. Oil and/or water produced during testing operations will be stored in steel tanks until either sold or disposed of through one of our approved disposal methods.
- (8) Ancillary Facilities: There are no planned ancillary facilities.
- (9) Well site layout: Exhibit C (Options 1 and 2) show the relative location and dimensions of the drilling pad and related components. Only minor differences, if any, in length and/or width of the drilling pad are anticipated, depending on which drilling contractor is selected to drill the well. Only minor leveling of the drilling site is anticipated.

(10) Plans for restoration of the surface:

(a) After drilling and successful completion operations are finished, all equipment and other materials not required for normal production operations will be removed. Pits will be backfilled, leveled and reseeded. Wellsite will be left in a neat condition.

(b) Any unguarded pits containing fluid will be fenced until backfilled.

(c) After abandonment of the well, surface restoration will be in accordance with regulations of the SMA. Pits will be backfilled and location will be cleaned. The pit area, well pad and all unneeded access roads will be ripped to promote revegetation. Rehabilitation should be accomplished within 90 days after abandonment.

(11) Surface ownership: All lands are Federal.

(12) Other information: The topography of the area is relatively flat, with small hills and sand dunes. The soil is fine, deep sand underlain by caliche. Vegetation cover is generally sparse and consists of mesquite, yucca, oak shinners and sparse native grasses. Wildlife in the area is typical of that of semi-arid lands and includes coyotes, rabbits, rodents, reptiles, dove and quail. There are no ponds, streams or residences in the area. There is intermittent cattle grazing and hunting in the area; however, the principal land use is for oil and gas production. An archaeological clearance report will be sent to you by a BLM approved archaeological service.

(13) Operator's representative: Our field representative responsible for compliance with the approved surface use and operations plan is:

Mr. Rayford Starkey, District Supt.
P.O. Box 188
Loco Hills, New Mexico 88255
Office phone: 505-677-2313
Home phone: 505-746-4619

JACKSON B 37
DRILLING PLAN
PAGE 8 OF 8

I hereby certify that I, or persons under my direct supervision have inspected the drill site and access route; that I am familiar with the conditions that currently exist; that the statements made in this plan are to the best of my knowledge, true and correct; and that the work associated with operations proposed herein will be performed by Burnett Oil Co., Inc. and its contractors and subcontractors in conformity with this plan and the terms and conditions under which it is approved. This statement is subject to the provisions of 18 U.S.C. 1001 for the filing of a false statement.

Date: May 10, 1995 By: James B. McPeters

James B. McPeters
Engineer

JACKSON B # 37

EXHIBIT A

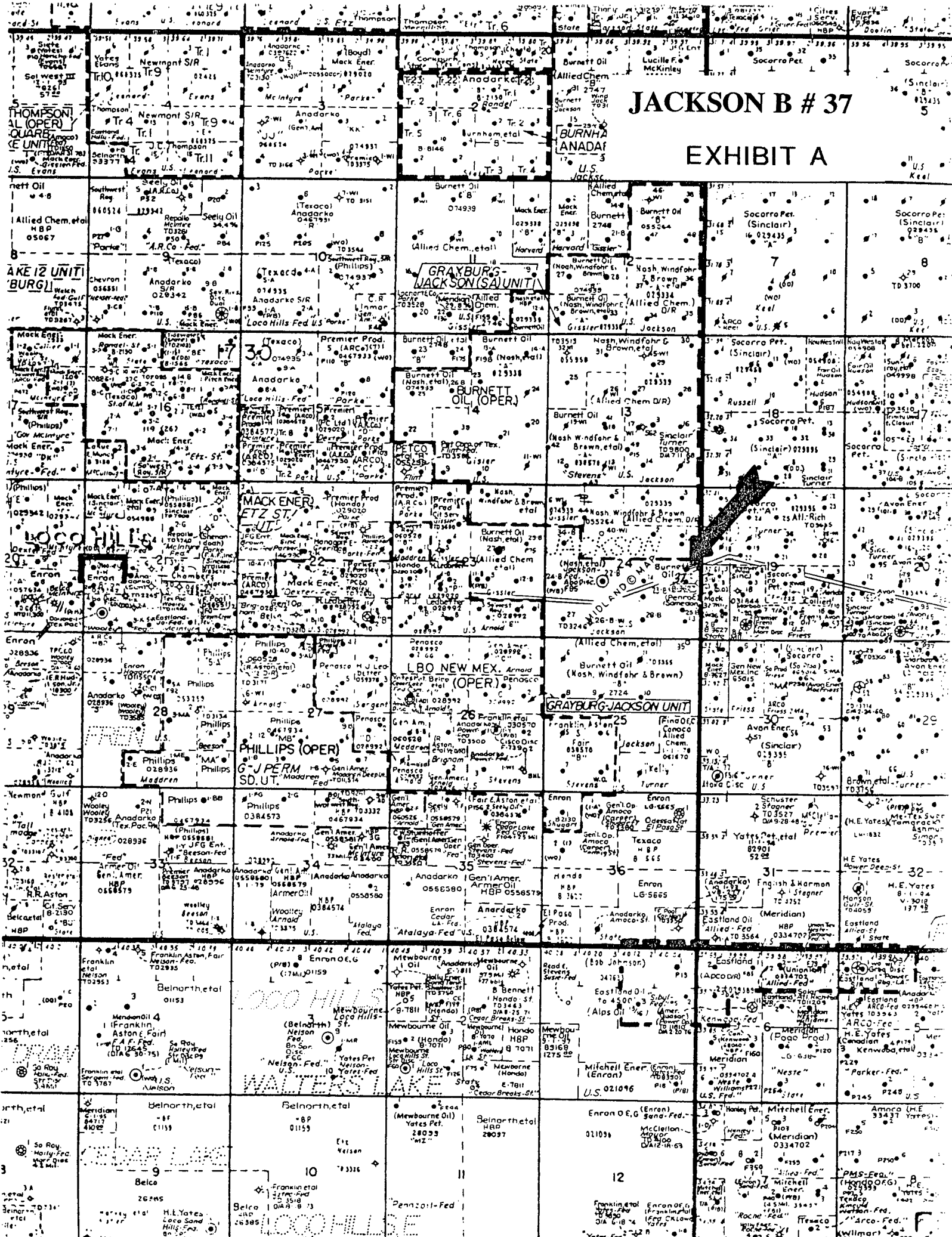

JACKSON B # 37

EXHIBIT B

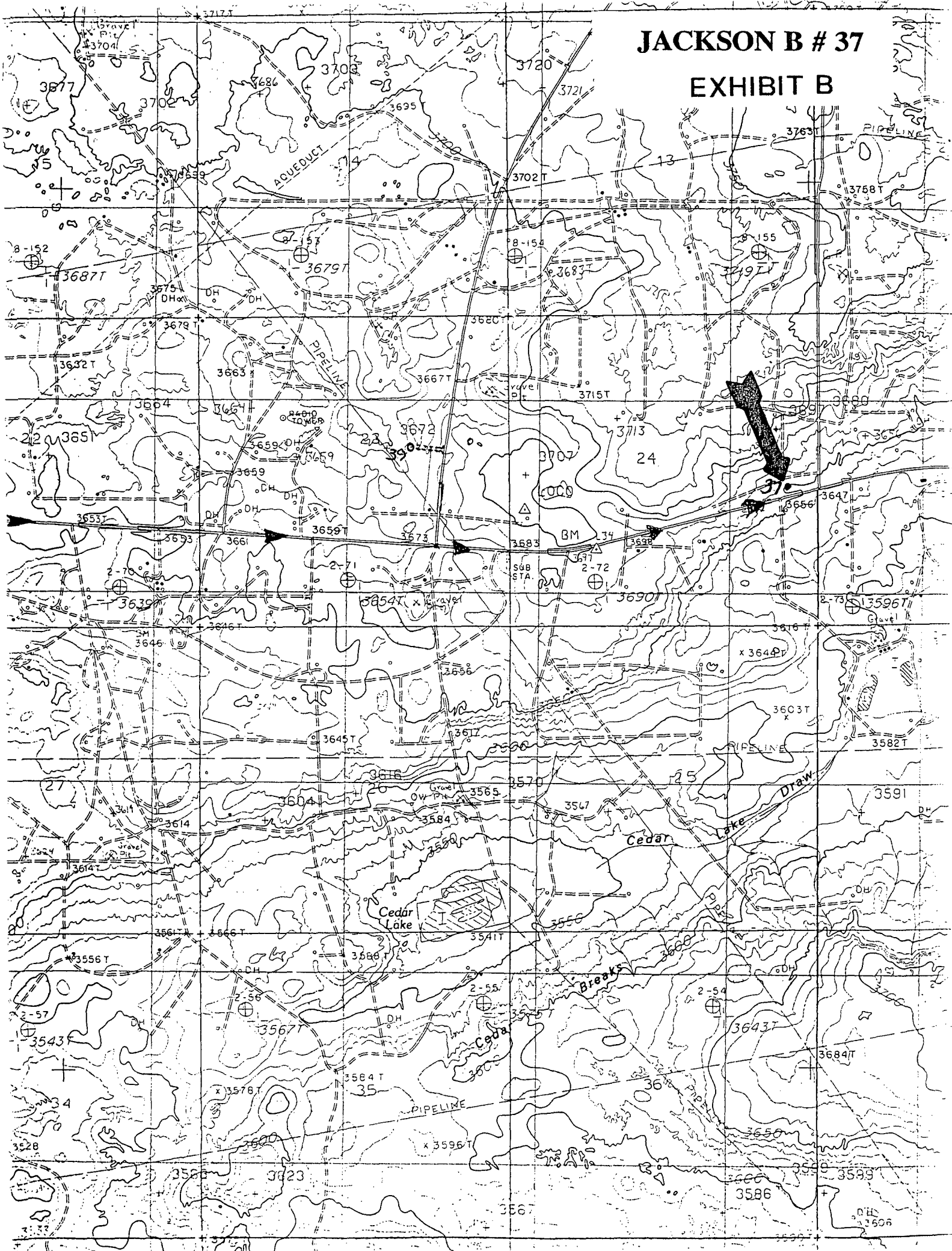
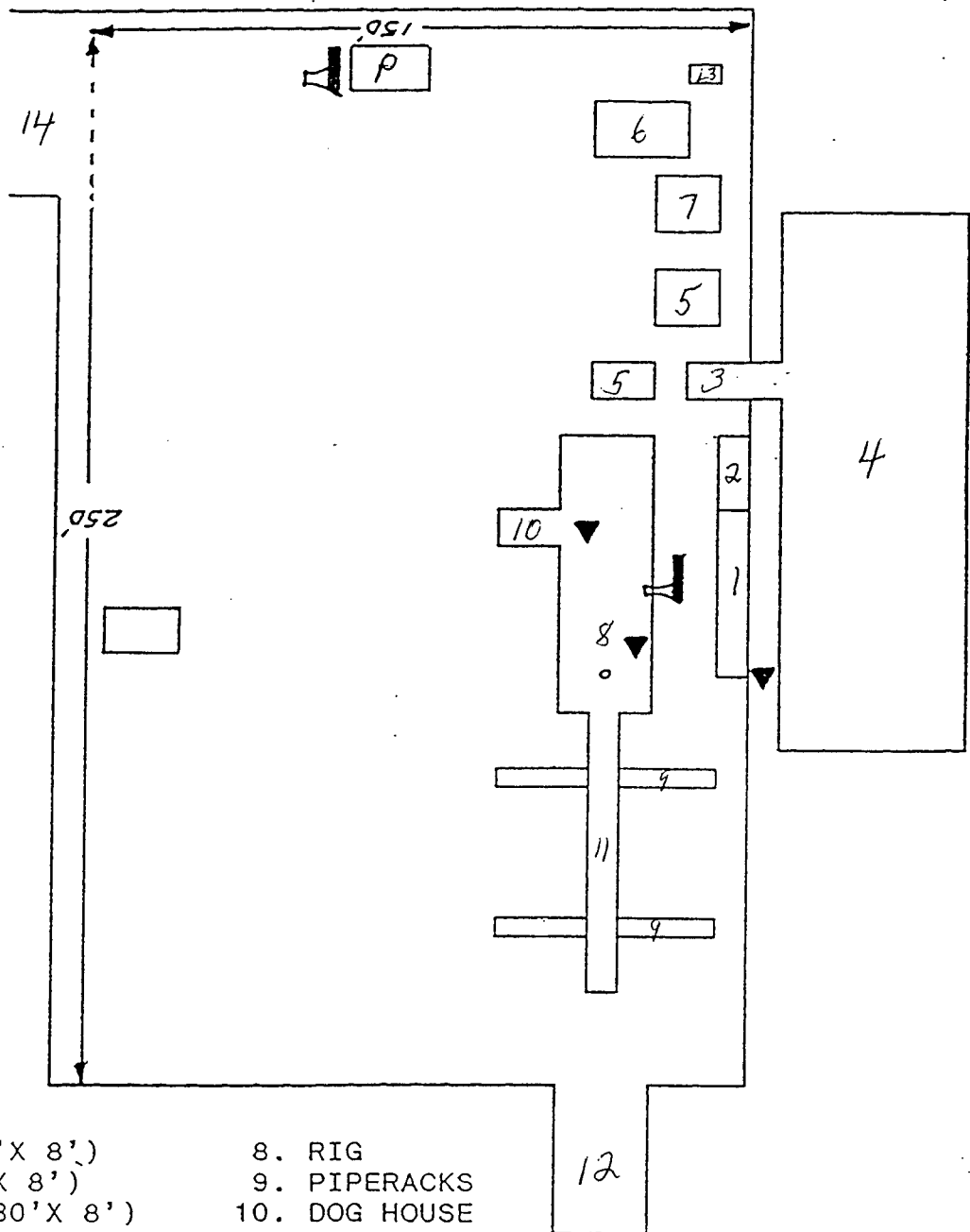
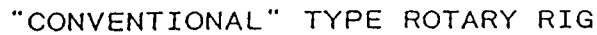

EXHIBIT C (OPTION 1)



- | | |
|-----------------------------|-------------------|
| 1. SHALE PIT (30'X 8') | 8. RIG |
| 2. MUD PIT (20' X 8') | 9. PIPERACKS |
| 3. SUCTION PIT (30'X 8') | 10. DOG HOUSE |
| 4. RESERVE PIT (100' X 50') | 11. CAT WALK |
| 5. PUMPS | 12. STINGER |
| 6. WATER TANK | 13. TRASH TRAILER |
| 7. FUEL TANK | 14. ROAD INLET |

WIND SOCKS

P

POSTED SAFE BRIEFING AREAS WITH BREATHING EQUIPMENT. "P" DESIGNATES PRIMARY AREA.

OIL CONSERVATION DIVISION

P. O. BOX 1000

SANTA FE, NEW MEXICO 87501

Form O-101
Revised 10-1-79

RECEIVED

JUN 2 1980

O. C. D.
ARTESIA, OFFICEREQUEST FOR ALLOWABLE
AUTHORIZATION TO TRANSPORT OIL AND NATURAL GAS

Burnett Oil Co., Inc.

Address

1214 First National Bank Building, Fort Worth, Texas 76102

Reason(s) for filing: (Check proper box)

New Well ☐Recompletion ☐Change in Ownership ☒

Change in Transporter of:

Oil ☐Crude/Gas ☐Dry Gas ☐Condensate ☐

Other (Please explain)

Not actual change in ownership,
but change in operator name.If change of ownership give name
and address of previous owner

Windfohr Oil Company, Box #198, Artesia, New Mexico 88210

DESCRIPTION OF WELL AND LEASE

Lease Name Jackson "B"	Well No. 12	Section, Township, Range Seven Rivers	Kind of Lease State, Federal or Free Fed.	Lease No. NM-2747
Location Unit Letter I : 1980 Feet From The south Line and 539 Feet From The east Line of Section 24 Township 17S Range 30E NM274 Eddy County				

DESIGNATION OF TRANSPORTER OF OIL AND NATURAL GAS

Kind of Authorized Transporter of Oil <input checked="" type="checkbox"/> or Condensate <input type="checkbox"/>	Address (Please address to which a proved copy of this form is to be sent)
Texas New Mexico Pipe Line Co. Box of Addressee's Transporter of Condensate Oil <input checked="" type="checkbox"/> or Dry Gas <input type="checkbox"/>	Box 2528, Hobbs, N. Mex. 82240
Conoco, Inc.	Ponca City, Okla.
Will producer oil or liquid gas be transported by truck?	When
P 24 17 30	yes

If this production is commingled with that from any other lease or pool, give name and lease or pool number. **PC No. 162**

COMPLETION DATA

Designate Type of Completion - (C)	Perforation	Stimulation	Deepen	Plug Back	Change Depth	Oil, Gas, or Both
Completed						
Perforation						
Stimulation						
Deepen						
Plug Back						
Change Depth						

Perforation	Stimulation	Deepen	Plug Back	Change Depth

TEST DATA AND REQUEST FOR ALLOWABLE	Perforation	Stimulation	Deepen	Plug Back	Change Depth
Length of Test	Perforation	Stimulation	Deepen	Plug Back	Change Depth
Actual Prod. During Test	Perforation	Stimulation	Deepen	Plug Back	Change Depth

Length of Test	Perforation	Stimulation	Deepen	Plug Back	Change Depth
Actual Prod. During Test	Perforation	Stimulation	Deepen	Plug Back	Change Depth

GAS WELL	Perforation	Stimulation	Deepen	Plug Back	Change Depth
Actual Prod. Test-MCF/D	Perforation	Stimulation	Deepen	Plug Back	Change Depth
Testing Method (pump, back prod)	Perforation	Stimulation	Deepen	Plug Back	Change Depth

CERTIFICATE OF COMPLIANCE	OIL CONSERVATION DIVISION
I hereby certify that the rules and regulations of the Oil Conservation Division have been complied with and that the information given above is true and complete to the best of my knowledge and belief.	APPROVED BY JUN 9 1980
Ralph L. Gray (Signature) Consulting Engineer (Title) June 1, 1980 (Date)	BY L. A. Gressett SUPERVISOR, DISTRICT 3

This form is to be filed in compliance with RULE 1104.

If this is a request for allowable for a newly drilled or deepened well, this form may be accompanied by a calculation of the deviation from the vertical in accordance with RULE 111.

This form must be filled out completely for all wells, including recompleted wells.

This form is not required for changes of ownership, leasehold, or transportation other than change of condition.

NO. OF COPIES RECEIVED

DISTRIBUTION	
SANTA FE	
FILE	
U.S.G.S.	
LAND OFFICE	
TRANSPORTER	OIL GAS
OPERATOR	
PRODUCTION OFFICE	

NEW MEXICO OIL CONSERVATION COMMISSION
REQUEST FOR ALLOWABLE
AND
AUTHORIZATION TO TRANSPORT OIL AND NATURAL GAS RECEIVED

Form C-104
Supersedes Form C-104 and C-110
Effective 1-1-64

29 JUL 1969

I. PRODUCTION OFFICE

Operator
WINDFOHR OIL COMPANY
Address
1202 First National Bldg., Fort Worth, Texas
Reason(s) for filing (Check proper box)
New Well ☐ Change in Transporter of: Oil ☐ Dry Gas ☐
Recompletion ☐ Oil ☐ Gas ☒ Condensate ☐
Change in Ownership ☐ Casinghead Gas ☒ Condensate ☐ from Shelly oil co

If change of ownership give name and address of previous owner

II. DESCRIPTION OF WELL AND LEASE

Lease Name Jackson B	Well No. 12	Pool Name, including Formation Fren (7-Rivers)	Kind of Lease State, Federal or Fee Federal	Lease No. NM 2747
Location Unit Letter <u>I</u> 1980 Feet From The <u>S</u> Line and <u>539</u> Feet From The <u>E</u> Line of Section <u>24 24</u> Township <u>17S</u> Range <u>30E</u> Eddy County				

III. DESIGNATION OF TRANSPORTER OF OIL AND NATURAL GAS

Name of Authorized Transporter of Oil <input checked="" type="checkbox"/> or Condensate <input type="checkbox"/> Texas New Mexico Pipeline Co. Address (Give address to which approved copy of this form is to be sent) P. O. Box 1510, Midland, Texas	Name of Authorized Transporter of Casinghead Gas <input checked="" type="checkbox"/> or Dry Gas <input type="checkbox"/> Continental Oil Company Address (Give address to which approved copy of this form is to be sent) P. O. Box 2197, Houston, Texas
If well produces oil or liquids, give location of tanks. Unit <u>I</u> Sec. <u>24</u> Twp. <u>17</u> Rng. <u>30</u>	Is gas actually transported? <u>Yes</u> When <u>See 54</u>

If this production is commingled with that from any other lease or pool, give commingling order number:

IV. COMPLETION DATA

Designate Type of Completion - (X)	Oil Well	Gas Well	New Well	Workover	Deepen	Plug Back	Same Res'y.	Diff. Res'y.
Date Spudded	Date Compl. Ready to Prod.		Total Depth		P.B.T.D.			
Elevations (DF, RAB, RT, GR, etc.)	Name of Producing Formation		Top of Gas Layer		Tubing Depth			
Perforations					Depth Casing Shoe			
TUBING, CASING, AND CEMENTING RECORD								
HOLE SIZE	CASING & TUBING SIZE		DEPTH SET		SACKS CEMENT			

V. TEST DATA AND REQUEST FOR ALLOWABLE OIL WELL

(Test must be after recovery of total volume of load oil and must be equal to or exceed top allowable for this depth or be for full 24 hours)

Date First New Oil Run To Tanks	Date of Test	Producing Method (Flow, pump, gas lift, etc.)	
Length of Test	Tubing Pressure	Casing Pressure	Choke Size
Actual Prod. During Test	Oil-Bbls.	Water-Bbls.	Gas-MCF

GAS WELL

Actual Prod. Test-MCF/D	Length of Test	Bbls. Condensate/MMCF	Gravity of Condensate
Testing Method (pilot, back pr.)	Tubing Pressure (Shut-in)	Casing Pressure (Shut-in)	Choke Size

VI. CERTIFICATE OF COMPLIANCE

I hereby certify that the rules and regulations of the Oil Conservation Commission have been complied with and that the information given above is true and complete to the best of my knowledge and belief.

J. R. Vann
(Signature)
Engineer
(Title)

1-15-69

OIL CONSERVATION COMMISSION

APPROVED JUL 17 1969
BY W. A. Gressett
TITLE OIL AND GAS INSPECTOR

This form is to be filed in compliance with RULE 1104.

If this is a request for allowable for a newly drilled or deepened well, this form must be accompanied by a tabulation of the deviation tests taken on the well in accordance with RULE 111.

All sections of this form must be filled out completely for allowable on new and recompleted wells.

Fill out only Sections I, II, III, and VI for changes of owner, name of transporter or other such change of condition.

Separate Forms C-104 must be filed for each pool in multiply completed wells.

SANTA FE	
FILE	
LAND OFFICE	
TRANSPORTED	OIL
TRANSPORTED	GAS
PRODUCTION OFFICE	
OPERATION	

NEW MEXICO OIL CONSERVATION COMMISSION
SANTA FE, NEW MEXICO

**CERTIFICATE OF COMPLIANCE AND AUTHORIZATION
TO TRANSPORT OIL AND NATURAL GAS**

FORM C-110

CHANGE
OK *lee*

FILE THE ORIGINAL AND 4 COPIES WITH THE APPROPRIATE OFFICE

Company of Operator Nash, Windfohr and Brown				Lessor Las Cruces 055264		Well No. 12
Unit Letter I	Section 24	Township 17 South	Range 30 East	County Eddy		
Pool From Fredn (SR)				Kind of Lease (State, Fed, Fee) Federal		
If well produces oil or condensate give location of tanks			Unit Letter I	Section 24	Township 17 South	Range 30 East
Authorized transporter of oil <input checked="" type="checkbox"/> or condensate <input type="checkbox"/>				Address (give address to which approved copy of this form is to be sent)		
Texas New Mexico Pipe Line Company				P. O. Box 1510, Midland, Texas		
Is Gas Actually Connected? Yes <input checked="" type="checkbox"/> No <input type="checkbox"/>						
Authorized transporter of casing head gas <input checked="" type="checkbox"/> or dry gas <input type="checkbox"/>			Date Connected Dec. '59	Address (give address to which approved copy of this form is to be sent)		
Skelly Oil Company				P. O. Box 1135, Eunice, New Mexico		
If gas is not being sold, give reasons and also explain its present disposition:						

REASON(S) FOR FILING (please check proper box)

New Well ☐
Change in Transporter (check one)
Oil ☐ Dry Gas ☐
Casing head gas ☐ Condensate ☐

Change in Ownership ☐
Other (explain below) **EFFECTIVE 5/1/66 NAME OF
NASH, WINDFOHR & BROWN
CHANGED TO WINDFOHR OIL COMPANY**

While we advised formal casinghead gas contract had been executed with Skelly Oil Company to take the casinghead gas from this well, Form C-110 was not filed.

Remarks

RECEIVED

The undersigned certifies that the Rules and Regulations of the Oil Conservation Commission have been complied with.

Executed this the 19th day of December, 19 63

OIL CONSERVATION COMMISSION

By *A. R. DeGrazier*
A. R. DeGrazier, Accountant

Approved by

Title
Nash, Windfohr and Brown
Company

Title

1212 First National Bank Building

Date

Address

Fort Worth, Texas 76102

JAN 2 1964

OIL AND GAS INSPECTOR

NEW MEXICO OIL CONSERVATION COMMISSION
SANTA FE, NEW MEXICO

Form C-110
Revised 7/1/55

(File the original and 4 copies with the appropriate district office)

DEC 21 1959

CERTIFICATE OF COMPLIANCE AND AUTHORIZATION
TO TRANSPORT OIL AND NATURAL GAS

ARTESIA, OFFICE

Company or Operator Nash, Windfohr & Brown Lease Jackson B
10-055264
Well No. 12 Unit Letter I S 24 T 17S R 30E Pool Prod. Unit Nos 3803
Fren Seven Blowers
County Eddy Kind of Lease (State, Fed. or Patented) Federal
If well produces oil or condensate, give location of tanks: Unit I S 24 T 17S R 30E
Authorized Transporter of Oil or Condensate Texas New Mexico Pipe Line Company

Address P. O. Box 1510, Midland, Texas
(Give address to which approved copy of this form is to be sent)

Authorized Transporter of Gas _____

Address _____
(Give address to which approved copy of this form is to be sent)

If Gas is not being sold, give reasons and also explain its present disposition:

Casinghead Gas Contract has been executed with Skelly Oil Company to take gas when
plant is built.

Reasons for Filing: (Please check proper box) New Well _____ ()
Change in Transporter of (Check One): Oil () Dry Gas () C'head () Condensate ()

Change in Ownership _____ () Other _____ ()

Remarks: _____ (Give explanation below)

To correct error in reporting unit letter for Jackson 12-B located 1980 feet from South
and 539 feet from East line. (NE/4SE/4)

The undersigned certifies that the Rules and Regulations of the Oil Conservation Com-
mission have been complied with.

Executed this the 16th day of December 19 59.

Approved DEC 21 1959 19 _____

By W. R. Dwyer
Title Accountant

OIL CONSERVATION COMMISSION
By M. L. Armstrong
Title OIL AND GAS INSPECTOR

Company Nash, Windfohr & Brown
Address 1107 Continental Life Building,
Fort Worth, Texas

OIL CONSERVATION COMMISSION
STATE OF NEW MEXICO

CERTIFICATE of COMPLIANCE and AUTHORIZATION to TRANSPORT OIL

Company or Operator Nash, Windfohr and Bro. Lease Jackson "B" L.C. 055264Address P. O. Box 366, Loco Hills, New Mexico Fort Worth, Texas
(Local or Field Office) (Principal Place of Business)Unit L Wells No. 12 Sec. 24 T. 17S. R. 30E Field Eren County EddyKind of Lease Federal Oil/Gas Location of Tanks 24-17-30Transporter Texas New Mexico Pipe Line Co. Address of Transporter P. O. Box 1510, Midland, Texas
(Local or Field Office)Houston, Texas Percent of oil to be transported 100 Other transporters author-
(Principal Place of Business) ized to transport oil from this unit are none %

REMARKS: In compliance with Rule 1114 dated June 1, 1950 to denote back change in transporter. Former transporter New Mexico Pipe Line Company, Artesia, New Mexico.

The undersigned certifies that the rules and regulations of the Oil Conservation Commission have been complied with except as noted above and that gathering agent is authorized to transport the percentages of oil produced from the above described property and that this authorization will be valid until further notice to the transporter named herein or until cancelled by the Oil Conservation Commission of New Mexico.

Executed this the 12th day of July, 1950NASH, WINDFOHR AND BROWN
(Company or Operator)By [Signature]Title B. F. Windfohr, PartnerState of Texas
County of Tarrant ss.

Before me, the undersigned authority, on this day personally appeared B. F. Windfohr known to me to be the person whose name is subscribed to the above instrument, who being by me duly sworn on oath states that he is authorized to make this report and has knowledge of the facts stated herein and that said report is true and correct.

Subscribed and sworn to before me, this the 12th day of July, 1950Annette Russell D. HagillNotary Public in and for Tarrant County, My commission expires June 1, 1951Approved: [Signature] 1950

OIL CONSERVATION COMMISSION

By [Signature]

(See Instructions on Reverse Side)

EDDY		NEW MEXICO	17S-30E	Company NASH-WINDEHR &
County	State	Field, Area or Prospect	BROWN	
Distance from Town or Well	Survey	Sec. 24-17S-30E	Well No.	12-B
Location	1980' fr. S., 539' fr. E/L Sec.		Farm	Jackson
			CASING RECORD	
			2"	1995'
			7"	1826'
Dates	Spudded 6-15-44 comp. 8-5-44			
T/Pay 1954'			FORMATION RECORD	
1997'			Elev. 3647'	
			T/S 520'; B/S 1220'	
Potential	IP flo. 110 BOPD thru op. 2"			
Pressures: TP	CP			
Gravity				
G-O Ratio				
Water				
Remarks	S/O 1920', 1954, 1993-97'.			
<i>Oil Report</i> OIL REPORT CARD #5 - NM - 8-31-44.				

OGRID Identifier : 3080 BURNETT OIL CO INC
Prop Identifier : 2391 JACKSON B
API Well Identifier : 30 15 28641 Well No : 37
Surface Locn - UL : I Sec : 24 Twp : 17S Range : 30E Lot Idn :
Multiple comp (S/M/C): N TVD Depth (Feet) : MVD Depth (Feet):
Spud Date : P/A Date :
Casing/Linear Record:

S Size Grade Weight Depth(ft) Depth(ft) Hole Size Cement ---- TOC ----
(inches) (lb/ft) Top-Liner Bot-Liner (inches) (Sacks) (feet) Code

E0004: No matching record found. Enter data to create.

PF01 HELP PF02 PF03 EXIT PF04 GoTo PF05 PF06 CONFIRM
PF07 PF08 PF09 COMMENT PF10 TLOG PF11 PF12