

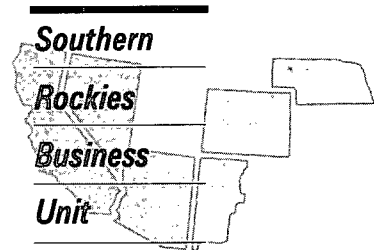

OIL CONSERVATION DIVISION
RECEIVED

November 13, 1995

95 NOV 16 AM 8 52



Mr. William J. LeMay, Director
New Mexico Oil Conservation Division
2040 S. Pacheco Street
P.O. Box 6429
Santa Fe, NM 87505

Application For Unorthodox Location
Armenta Gas Com F #1 Well
2120' FNL, 835' FEL, Section 27-T29N-R10W
Blanco Mesaverde Pool
San Juan County, New Mexico

Amoco Production Company hereby requests administrative approval for an unorthodox well location for the Armenta Gas Com F #1 well in the Blanco Mesaverde Pool. Amoco plans to recomplete this well from the Gallup formation to the Mesaverde. The spacing unit for this existing well is the SENE of Section 27 for the Armenta Gallup. This well was drilled at a legal location for the Gallup, however it is an unorthodox location for the Mesaverde recompletion as it is 520 feet from the quarter section line as opposed to the required 790 foot setback. This well encroaches 270 feet to the southern boundary of the spacing unit and is located in Unit H. The Mesaverde wells located in the spacing unit to the south are the Amoco operated Romero Gas Com A #1 located in Unit K and the Romero Gas Com A #1A located in Unit P.

A copy of this application will be submitted to the offset operators by certified mail with a request that they furnish your Santa Fe office with a Waiver of Objection, and return one copy to this office. Attached are plats showing the location of the well, offset operators, and all wells drilled in the area.

Pamela W. Staley

Attachments

cc: Frank Chavez, Supervisor
NMOCD District III
1000 Rio Brazos Road
Aztec, NM 87410

Steve Webb, Amoco
Gail Jefferson, Amoco

WAIVER

_____ hereby waives objection to Amoco's application for an unorthodox well location for the Armenta Gas Com F #1 well described above.

By: _____

Date: _____

APPLICATION FOR APPROVAL OF UNORTHODOX LOCATION UNDER RULE 104-F

**Armenta Gas Com F #1 Well
2120' FNL, 835' FEL, Section 27-T29N-R10W
Blanco Mesaverde Pool**

ATTACHMENTS:

- 9-SECTION PLAT SHOWING LOCATION OF ALL OFFSET WELLS
- FORM C-102 FOR MESAVERDE FORMATION
- FORM C-102 FOR GALLUP FORMATION
- OFFSET OPERATORS PLAT
- LIST OF ALL OFFSET OPERATORS AND THEIR ADDRESSES

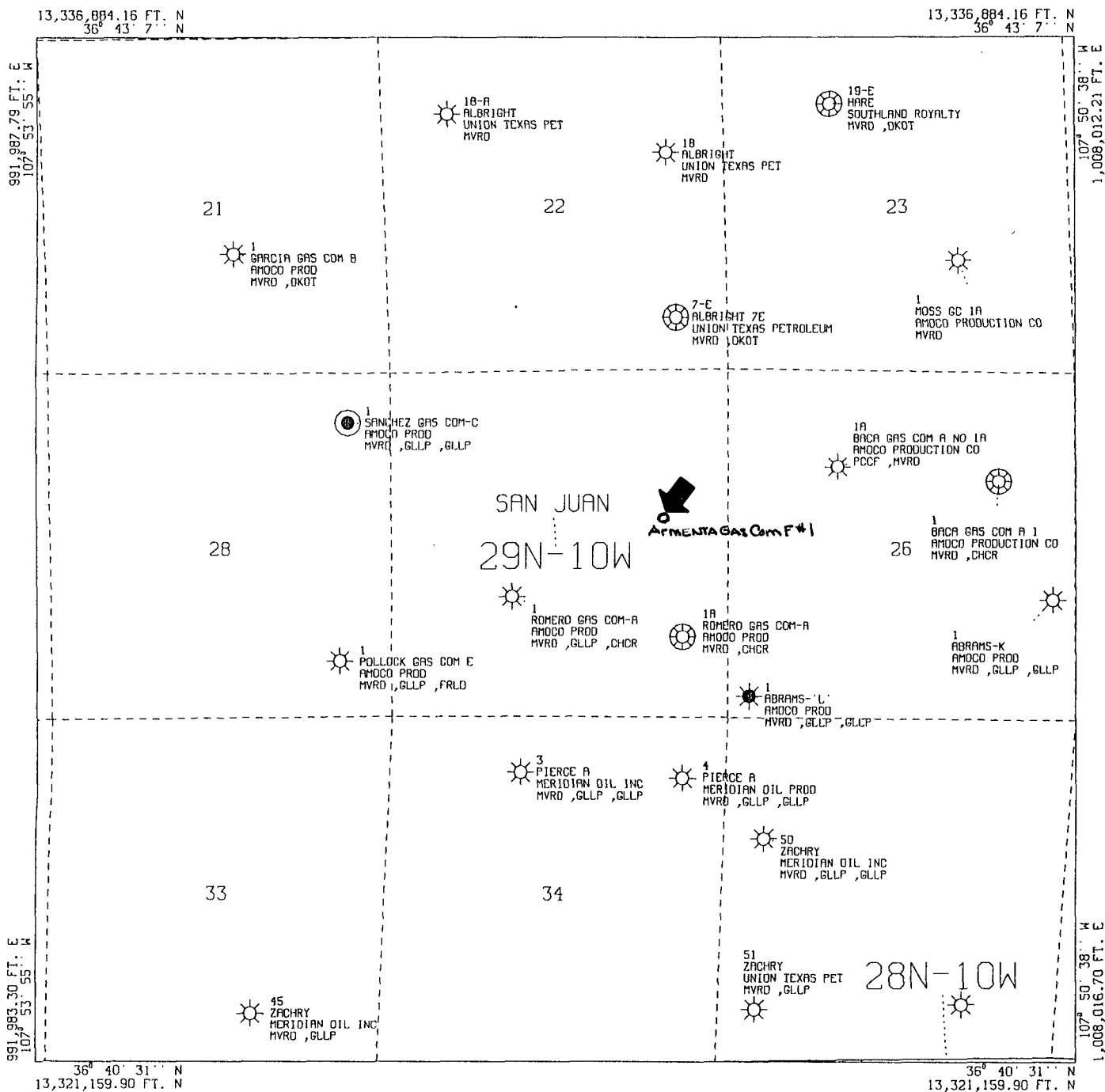

All geological and geophysical data, including the interpretation thereof, appearing on this map is the private and confidential property of Amoco Production Company. The publication or reproduction thereof without the written permission of said Company is strictly prohibited.

AMOCO PRODUCTION COMPANY
PLAT MAP
Armenta Gas Com F 1
Mesaverde Formation
SCALE 1 IN. = 2,000 FT. OCT 25, 1995

POLYCONIC CENTRAL MERIDIAN - 107° 52' 17" W LONG
SPHEROID - 6

HORIZONTAL DATUM NAD27

DWS14435--RUN#95298065211

District I
PO Box 1980, Hobbs, NM 88241-1980
District II
PO Drawer DD, Artesia, NM 88211-0719
District III
1000 Rio Brazos Rd., Aztec, NM 87410
District IV
PO Box 2088, Santa Fe, NM 87504-2088

State of New Mexico
Energy, Minerals & Natural Resources Department

OIL CONSERVATION DIVISION
PO Box 2088
Santa Fe, NM 87504-2088

Form C-102
Revised February 21, 1994

Instructions on back
Submit to Appropriate District Office
State Lease - 4 Copies
Fee Lease - 3 Copies

☐ AMENDED REPORT

WELL LOCATION AND ACREAGE DEDICATION PLAT

AP Number 3004525671		Pool Code 72319		Pool Name Blanco Mesaverde	
Property Code 000272		Property Name Armenta Gas Com F			Well Number #1
OGRID No. 000778		Operator Name Amoco Production Company			Elevation 5508 GL

10 Surface Location

UL or lot no. H	Section 27	Township 29N	Range 10W	Lot Idn	Feet from the 2120	North/South line North	Feet from the 835	East/West line East	County San Juan
--------------------	---------------	-----------------	--------------	---------	-----------------------	---------------------------	----------------------	------------------------	--------------------

11 Bottom Hole Location If Different From Surface

UL or lot no.	Section	Township	Range	Lot Idn	Feet from the	North/South line	Feet from the	East/West line	County
Dedicated Acres 320.00		Joint or Infill		Consolidation Code		Order No.			

NO ALLOWABLE WILL BE ASSIGNED TO THIS COMPLETION UNTIL ALL INTERESTS HAVE BEEN CONSOLIDATED
OR A NON-STANDARD UNIT HAS BEEN APPROVED BY THE DIVISION

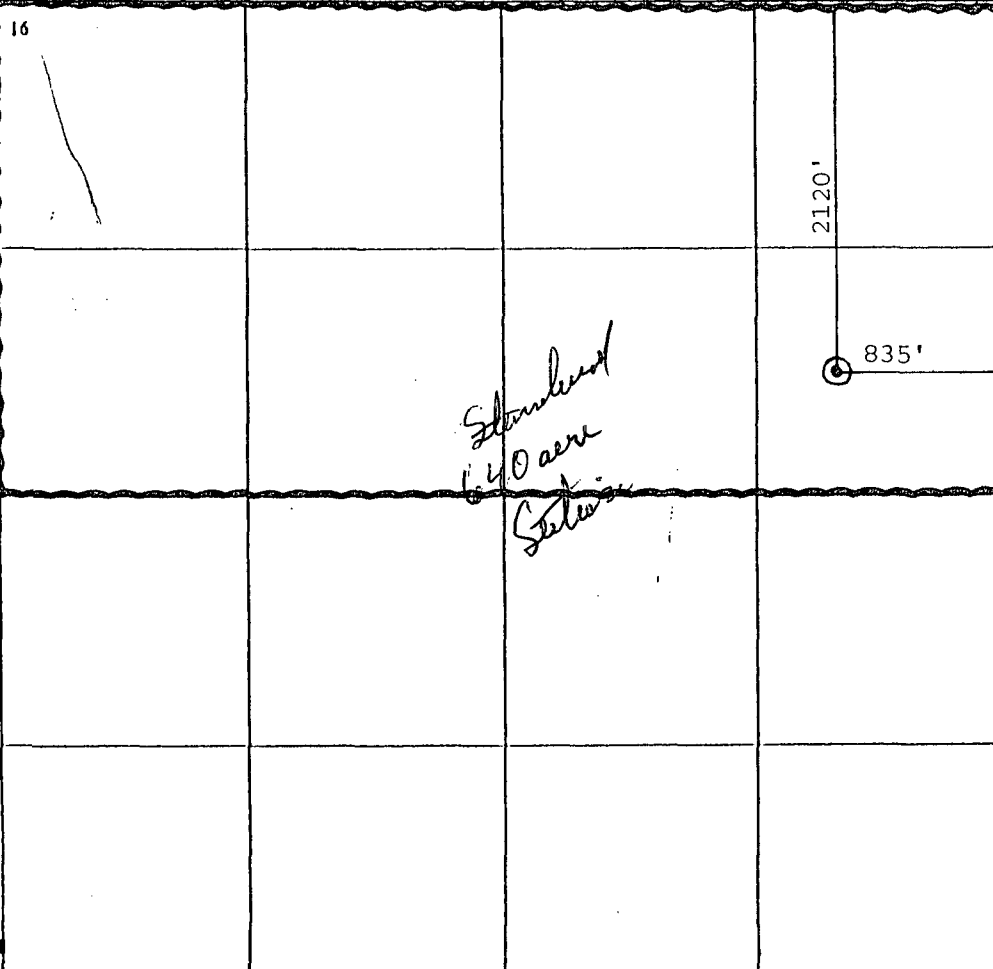
<div>16</div> 	<div>17 OPERATOR CERTIFICATION</div> <p>I hereby certify that the information contained herein is true and complete to the best of my knowledge and belief.</p> <p><i>Gail M. Jefferson</i> Signature</p> <p>Gail M. Jefferson Printed Name</p> <p>Sr. Admin. Staff Asst. Title</p> <p>10/25/95 Date</p>
	<div>18 SURVEYOR CERTIFICATION</div> <p>I hereby certify that the well location shown on this plat was plotted from field notes of actual surveys made by me or under my supervision, and that the same is true and correct to the best of my belief.</p> <p>April 5, 1983 Date of Survey</p> <p>Signature and Seal of Professional Surveyor:</p> <p>3950 Certificate Number</p>

OIL CONSERVATION DIVISION

STATE OF NEW MEXICO
ENERGY AND MINERALS DEPARTMENT

P. O. BOX 2048

SANTA FE, NEW MEXICO 87501

Form C-107
Revised 10-1-77

All distances must be from the outer boundaries of the Section.

Operator: AMOCO PRODUCTION COMPANY			Lease ARMENTA COM "FW"			Well No. 1		
Unit Letter H	Section 27	Township 29N	Range 10W	County San Juan				
Actual Footage Location of Well: 2120 feet from the North line and 835 feet from the East line								
Ground Level Elev: 5508		Producing Formation Gallup		Pool Armenta Gallup			Dedicated Acreage: 40 Acres	

1. Outline the acreage dedicated to the subject well by colored pencil or hachure marks on the plat below.
2. If more than one lease is dedicated to the well, outline each and identify the ownership thereof (both as to working interest and royalty).
3. If more than one lease of different ownership is dedicated to the well, have the interests of all owners been consolidated by communitization, unitization, force-pooling, etc?

☐ Yes ☐ No If answer is "yes," type of consolidation _____

If answer is "no," list the owners and tract descriptions which have actually been consolidated. (Use reverse side of this form if necessary.) _____

No allowable will be assigned to the well until all interests have been consolidated (by communitization, unitization, forced-pooling, or otherwise) or until a non-standard unit, eliminating such interests, has been approved by the Commission.

<div style="position: relative; height: 100px;"> <div style="position: absolute; right: 0; top: 0; transform: rotate(90deg);">2120'</div> <div style="position: absolute; bottom: 0; right: 0;">835'</div> <div style="position: absolute; bottom: 0; left: 50%;">Sec.</div> </div>		27	

CERTIFICATION

I hereby certify that the information contained herein is true and complete to the best of my knowledge and belief.

Name

Dale H. Shoemaker

Position

District Engineer

Company

Amoco Production Company

Date

April 14, 1983

I hereby certify that the well location shown on this plat was plotted from field notes of actual surveys made by me or under my supervision, and that the same is true and correct to the best of my knowledge and belief.

Date Surveyed

April 5, 1983

Registered Professional Engineer
and Land Surveyor

Fred B. Kerr Jr.

Certificate No.

AMOCO PRODUCTION COMPANY OFFSET OPERATOR PLAT

Armenta Gas Com F #1 Well
2120' FNL, 835' FEL, Section 27-T29N-R10W
Blanco Mesaverde Pool
San Juan County, New Mexico

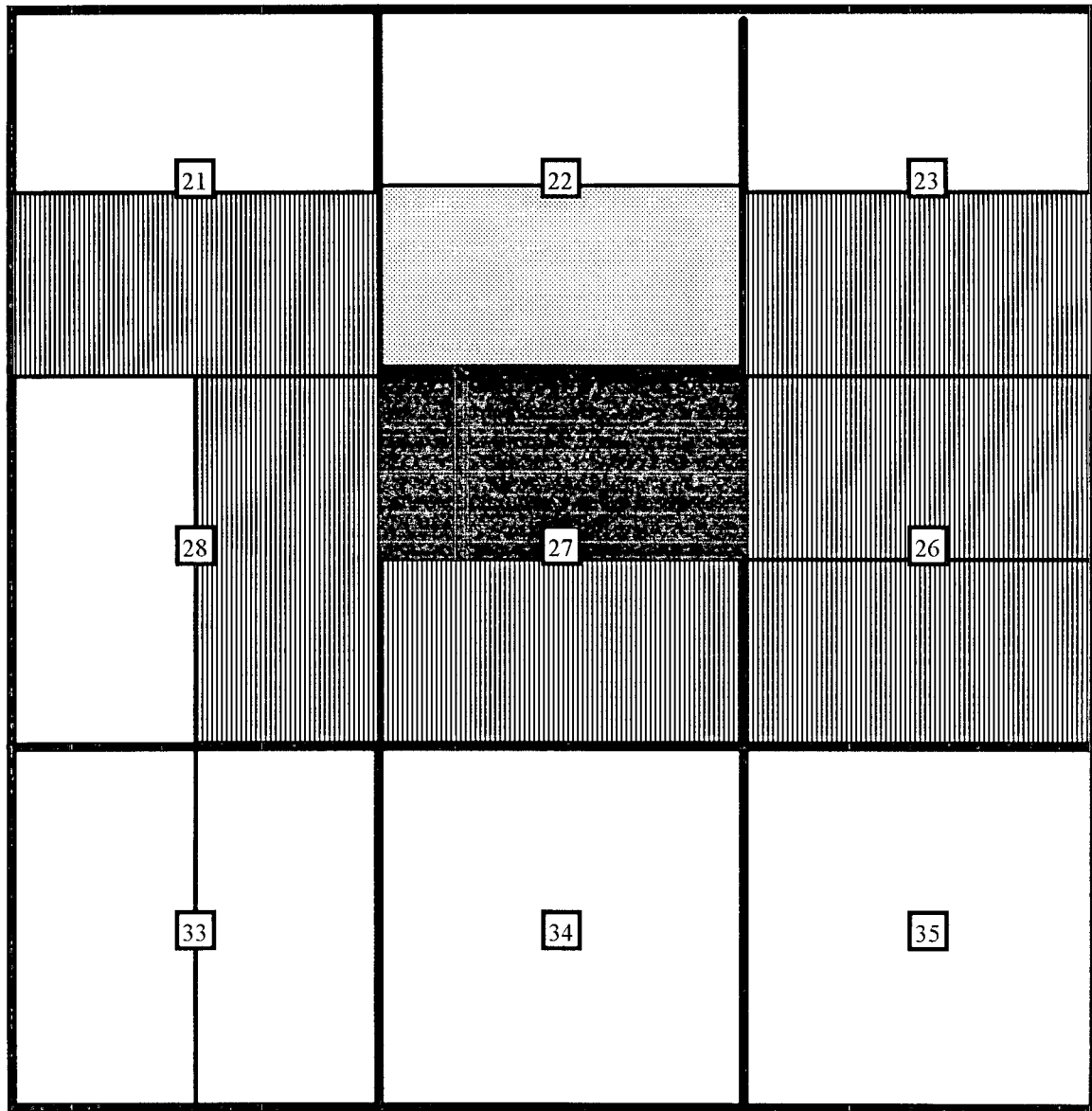

SPACING UNIT TO BE DOWNHOLE COMMINGLED



AMOCO PRODUCTION COMPANY



MERIDIAN OIL INC.

LIST OF ADDRESSES FOR OFFSET OPERATORS

Armenta Gas Com F #1

1 Meridian Oil, Inc.
P.O. Box 4289
Farmington, NM 87499

CMD :
OG6IWCM

ONGARD
INQUIRE WELL COMPLETIONS

11/27/95 09:02:56
OGOMES -EMFD

API Well No : 30 45 23856 Eff Date : 08-14-1995 WC Status : A
Pool Idn : 72319 BLANCO-MESAVERDE (G)
OGRID Idn : 778 AMOCO PRODUCTION CO
Prop Idn : 274 ARMENTA GAS COM C

Well No : 001E
GL Elevation: 5506

	U/L	Sec	Township	Range	North/South	East/West	Prop/Act (P/A)
	---	---	-----	-----	-----	-----	-----
B.H. Locn : C	27	29N	10W	FTG	435 F N	FTG 1590 F W	P
Lot Identifier:							
Dedicated Acre: 320.00							
Lease Type : P							
Type of consolidation (Comm, Unit, Forced Pooling - C/U/F/O) :							

PF01 HELP	PF02	PF03 EXIT	PF04 GoTo	PF05	PF06
PF07	PF08	PF09	PF10 NEXT-WC	PF11 HISTORY	PF12 NXTREC