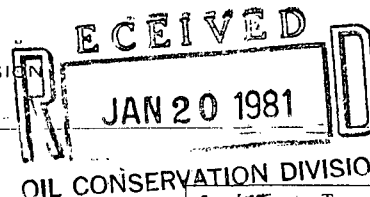

**GTLT - \_\_\_\_\_12\_\_\_\_\_**

**Occidental Geothermal, Inc.  
(7&30)-20S-10W  
Luna County**

**Well No. 4-N & 2-K**

NO. OF COPIES RECEIVED	
DISTRIBUTION	
File	1
N. M. B. M.	1
U. S. G. S.	1
Operator	1
Land Office	BLM

NEW MEXICO OIL CONSERVATION COMMISSION  
P. O. Box 2088, Santa Fe 87501SUNDRY NOTICES AND REPORTS  
ON  
GEOTHERMAL RESOURCES WELLS

Indicate Type of Lease

State ☐Fee ☒

S.a State Lease No.

Do Not Use This Form for Proposals to Drill or to Deepen or Plug Back to a Different Reservoir. Use "Application For Permit" (Form G-101) for Such Proposals.

1. Type of well Geothermal Producer ☐ Temp. Observation ☒  
Low-Temp Thermal ☐ Injection/Disposal ☐

7. Unit Agreement Name

2. Name of Operator

Occidental Geothermal, Inc.

8. Farm or Lease Name

Cerro Mesa Ranch

3. Address of Operator

5000 Stockdale Highway, Bakersfield, California 93309

9. Well No.

4

4. Location of Well

Unit Letter N, 1,325 Feet From The West Line and 1,315 Feet From

10. Field and Pool, or Wildcat

Faywood

The South Line, Section 7 Township 20S Range 10W NMPM.

15. Elevation (Show whether DF, RT, GR, etc.)

5,040' Ground

12. County

Luna

16. Check Appropriate Box To Indicate Nature of Notice, Report or Other Data

## NOTICE OF INTENTION TO:

PERFORM REMEDIAL WORK ☐PLUG AND ABANDON ☐TEMPORARILY ABANDON ☐PULL OR ALTER CASING ☐CHANGE PLANS ☐OTHER ☐

## SUBSEQUENT REPORT OF:

REMEDIAL WORK ☐COMMENCE DRILLING OPNS. ☒CASING TEST AND CEMENT JOB ☐OTHER ☐ALTERING CASING ☐PLUG & ABANDONMENT ☒

17. Describe Proposed or completed Operations (Clearly state all pertinent details, and give pertinent dates, including estimated date of starting any proposed work) SEE RULE 203.

## Completed Operations:

Well plugged and abandoned on December 17, 1980 by cutting off pipe 6 inches below ground level and subsequently filling the pipe with 10 feet of cement to top of pipe.

18. I hereby certify that the information above is true and complete to the best of my knowledge and belief.

SIGNED George F. Stenfa TITLE Geologist DATE January 13, 1981APPROVED BY Carl Ulvog TITLE SENIOR PETROLEUM GEOLOGIST DATE 1-22-81

CONDITIONS OF APPROVAL, IF ANY:

NO. OF COPIES RECEIVED	
DISTRIBUTION	
File	
N.M.B.M.	
U.S.	
Operator	
Land Office	

## NEW MEXICO OIL CONSERVATION COMMISSION

P. O. Box 2088, Santa Fe 87501

APPLICATION FOR PERMIT TO DRILL, DEEPEN,  
OR PLUG BACK--GEOTHERMAL RESOURCES WELL

5. Indicate Type of Lease

STATE ☐FEE ☒

5.a State Lease No.

--

1a. Type of Work Drill ☒ Deepen ☐ Plug Back ☐b. Type of Well Geothermal Producer ☐  
Low-Temp Thermal ☐Temp Observation ☒  
Injection/Disposal ☐

7. Unit Agreement Name

--

8. Farm or Lease Name

Cerro Mesa Ranch

9. Well No.

4

2. Name of Operator  
Occidental Geothermal, Inc.

3. Address of Operator

5000 Stockdale Highway, Bakersfield, California 93309

10. Field and Pool, or Wildcat

Faywood

4. Location of Well UNIT LETTER N LOCATED 1,320 FEET FROM THE South LINE  
1325 west 1315  
AND 3,960 FEET FROM THE East LINE OF SEC. 7 TWP. 20 S RGE. 10 W NMPM12. County  
Luna

19. Proposed Depth

500'

19A. Formation

20. Rotary or C.T.

Rotary

21. Elevations (Show whether DF, RT, etc.)  
5,040 Ground21A. Kind & Status Plug. Bond  
\$10,000 Multi Well

21B. Drilling Contractor

Kachina Drilling, Inc.

22. Approx. Date Work will start  
August 28, 1979

## PROPOSED CASING AND CEMENT PROGRAM

SIZE OF HOLE	SIZE OF CASING	WEIGHT PER FOOT	SETTING DEPTH	SACKS OF CEMENT	EST. TOP
6"+	1 1/4" line pipe	--	500'	two	2' from surface

1. Drill 6"+ hole to 500' using air if possible and mud if necessary.
2. Run 1 1/4" bull plugged line pipe to within 5'+ of bottom. If the hole is drilled with air, fill the annulus with mud.
3. Cement the 1 1/4" x 6" annulus from 10'+ below ground level to within 2' of the surface.
4. Fill the 1 1/4" pipe with water and install well head cap.
5. Clean up the location.
6. Run temperature logs ten days or more after drilling.
7. Abandon the hole by placing cement from 10'+ below ground level to within 2' of the surface. Cut off the pipe below ground level. Hole abandoned.

Quad 79  
± 25 mi NW of Daning

± 15 mi SE of Hurley

11-1-79: Pipe in place and locked. Location rough.

4/13/80 " " " "

6/6/80 " " " "

APPROVAL VALID FOR 90 DAYS  
PERMIT EXPIRES 11-24-79  
UNLESS DRILLING UNDERWAY

P&amp;A 12/17/80

IN ABOVE SPACE DESCRIBE PROPOSED PROGRAM: If proposal is to deepen or plug back, give data on present productive zone and proposed new productive zone. Give blowout preventer program, if any.

I hereby certify that the information above is true and complete to the best of my knowledge and belief.

Sign

B.D. Ryan

Title Petroleum Engineer

Date August 23, 1979

(This space for State Use)

APPROVED BY

Carl Ulrey

TITLE

SENIOR PETROLEUM GEOLOGIST

DATE

8/27/79

CONDITIONS OF APPROVAL, IF ANY:

Operator advised to send comp. G-103 - at well site.



STATE OF NEW MEXICO  
ENERGY AND MINERALS DEPARTMENT  
OIL CONSERVATION DIVISION

BRUCE KING  
GOVERNOR  
LARRY KEHOE  
SECRETARY

POST OFFICE BOX 2088  
STATE LAND OFFICE BUILDING  
SANTA FE, NEW MEXICO 87501  
(505) 827-2434

July 21, 1980

Occidental Geothermal, Inc.  
5000 Stockdale Highway  
Bakersfield, California 93309

*File - #4*

Attention: Mr. B. J. Wyant

Subject: Temperature Observation Wells,  
Luna and Grant Counties,  
New Mexico, all Cerro Mesa Ranch  
Lease, #1 - Section 27, Township  
20 South, Range 11 West;  
#2 - Section 30, Township 20 South,  
Range 10 West; #3 Section 1,  
Township 21 South, Range 11 West;  
#4 Section 7, Township 20 South,  
Range 10 West.

Dear Sir:

This agency's files contain only the Forms C-101 and C-102 pertaining to the above referenced wells. We are aware that the wells drilled in latter 1979, however there are no reports here to suggest that fact, nor indications (other than telephone conversations) that you have completed your bore-hole studies.

In conversations with your well-site representative, I advised of the need for this agency to be notified of plugging for abandonment. To date no such notice has been received. As you know, our regulations do not put a time limit on the duration of temperature measurements, but do specify the maximum time for which a well may be abandoned without plugging. (See Rules 301, 302 and 303).

If you have need of the subject wells for further logging or other purposes but are not now utilizing them, I suggest you apply for temporary abandonment permits in accordance with the rules.

Very truly yours,

*Carl Ulvog*

CARL ULVOG  
Geothermal Supervisor

NO. OF COPIES RECEIVED		
DISTRIBUTION		
File	1	✓
N.M.B.M.	1	
U.S.G.S.	1	
Operator	1	
Land Office		

## NEW MEXICO OIL CONSERVATION COMMISSION

P. O. Box 2088, Santa Fe 87501

APPLICATION FOR PERMIT TO DRILL, DEEPEN,  
OR PLUG BACK--GEOTHERMAL RESOURCES WELL

5. Indicate Type of Lease
STATE <input type="checkbox"/> FEE <input checked="" type="checkbox"/>
5.a State Lease No.
--

1a. Type of Work	Drill <input checked="" type="checkbox"/>	Deepen <input type="checkbox"/>	Plug Back <input type="checkbox"/>
b. Type of Well	Geothermal Producer <input type="checkbox"/>	Temp Observation <input checked="" type="checkbox"/>	Low-Temp Thermal <input type="checkbox"/>
Injection/Disposal <input type="checkbox"/>			
2. Name of Operator			
Occidental Geothermal, Inc.			
3. Address of Operator			
5000 Stockdale Highway, Bakersfield, California 93309			
4. Location of Well			
UNIT LETTER <u>N</u> LOCATED <u>1,320</u> FEET FROM THE <u>South</u> LINE			
<u>1325</u> <u>west</u> <u>1315</u>			
AND <u>3,960</u> FEET FROM THE <u>east</u> LINE OF SEC. 7 TWP. 20 S RGE. 10 W NMPM			

7. Unit Agreement Name
--
8. Farm or Lease Name
Cerro Mesa Ranch
9. Well No.
4
10. Field and Pool, or Wildcat
Faywood

12. County			
Luna			
19. Proposed Depth	19A. Formation	20. Rotary or C.T.	
500'		Rotary	
21. Elevations (Show whether DF, RT, etc.)	21A. Kind & Status Plug. Bond	21B. Drilling Contractor	22. Approx. Date Work will start
5,040 Ground	\$10,000 Multi Well	Kachina Drilling, Inc.	August 28, 1979

## PROPOSED CASING AND CEMENT PROGRAM

SIZE OF HOLE	SIZE OF CASING	WEIGHT PER FOOT	SETTING DEPTH	SACKS OF CEMENT	EST. TOP
6"±	1½" line pipe	--	500'	two	2' from surface

1. Drill 6"± hole to 500' using air if possible and mud if necessary.
2. Run 1½" bull plugged line pipe to within 5'± of bottom. If the hole is drilled with air, fill the annulus with mud.
3. Cement the 1½" x 6" annulus from 10'+ below ground level to within 2' of the surface.
4. Fill the 1½" pipe with water and install well head cap.
5. Clean up the location.
6. Run temperature logs ten days or more after drilling.
7. Abandon the hole by placing cement from 10'+ below ground level to within 2' of the surface. Cut off the pipe below ground level. Hole abandoned.

APPROVAL VALID FOR 90 DAYS  
PERMIT EXPIRES 11-26-79  
UNLESS DRILLING UNDERWAY

IN ABOVE SPACE DESCRIBE PROPOSED PROGRAM: If proposal is to deepen or plug back, give data on present productive zone and proposed new productive zone. Give blowout preventer program, if any.

I hereby certify that the information above is true and complete to the best of my knowledge and belief.

Signed B. J. Ryan Title Petroleum Engineer Date August 23, 1979  
(This space for State Use)

APPROVED BY Carl W. Woz TITLE SENIOR PETROLEUM GEOLOGIST DATE 8/28/79  
CONDITIONS OF APPROVAL, IF ANY:

GEOTHERMAL RESOURCES WELL LOCATION AND ACREAGE DEDICATION PLAT

All distances must be from the outer boundaries of the Section.

Operator <b>Occidental Geothermal, Inc.</b>			Lease <b>Cerro Mesa Ranch, Inc.</b>		Well No. <b>4</b>
Unit Letter <b>N</b>	Section <b>7</b>	Township <b>20 South</b>	Range <b>10 West</b>	County <b>Luna</b>	
Actual Footage Location of Well: <b>1315</b> <del>1320</del> feet from the <b>south</b> line and <b>1325</b> <del>3,960</del> feet from the <b>west</b> <del>east</del> line					
Ground Level Elev. <b>5,040</b>	Producing Formation	Pool <b>Faywood</b>	Dedicated Acreage: <b>160</b> Acres		

- Outline the acreage dedicated to the subject well by colored pencil or hachure marks on the plat below.
- If more than one lease is dedicated to the well, outline each and identify the ownership thereof (both as to working interest and royalty).
- If more than one lease of different ownership is dedicated to the well, have the interests of all owners been consolidated by communitization, unitization, force-pooling, etc?

☐ Yes ☐ No If answer is "yes," type of consolidation \_\_\_\_\_

If answer is "no," list the owners and tract descriptions which have actually been consolidated. (Use reverse side of this form if necessary.) \_\_\_\_\_

No allowable will be assigned to the well until all interests have been consolidated (by communitization, unitization, forced-pooling, or otherwise) or until a non-standard unit, eliminating such interests, has been approved by the Commission.

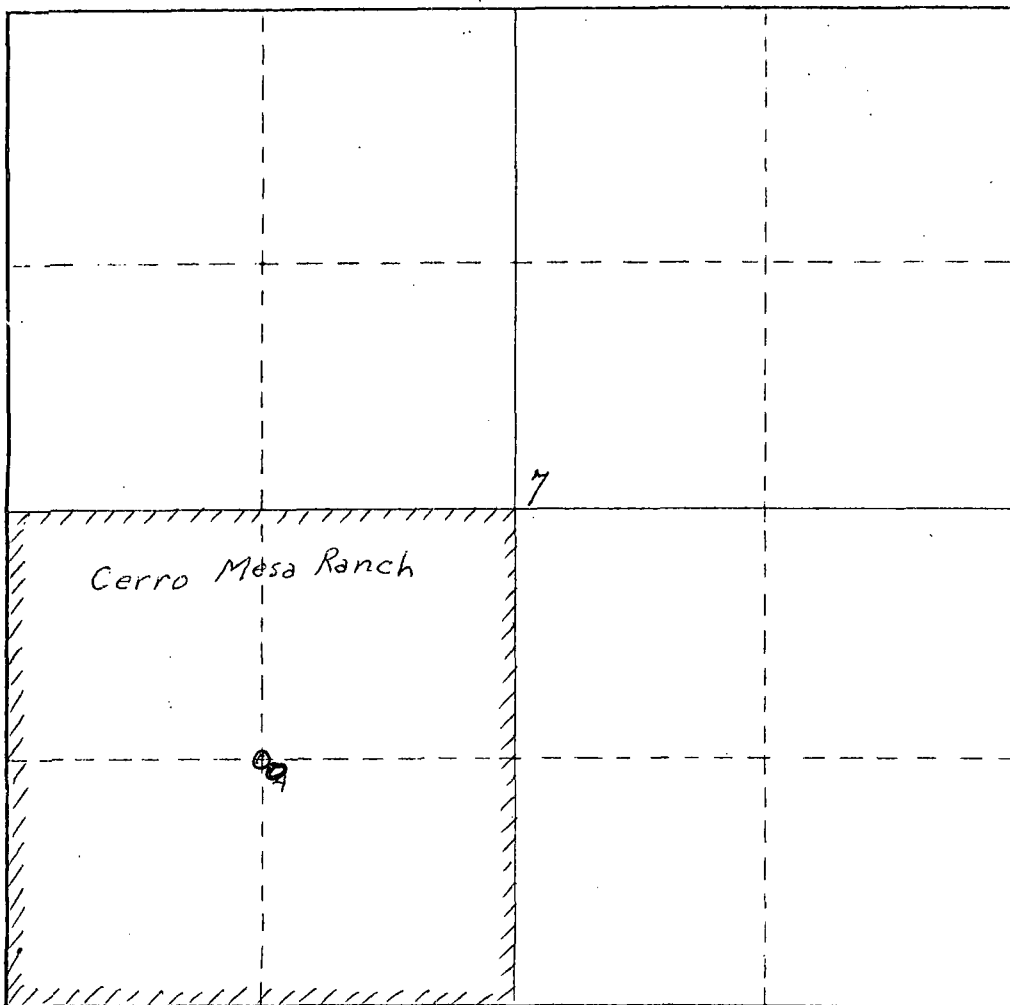

CERTIFICATION

I hereby certify that the information contained herein is true and complete to the best of my knowledge and belief.

*B. J. Wyant*

Name  
**B. J. Wyant**  
Position  
**Petroleum Engineer**  
Company  
**Occidental Geothermal, Inc.**

Date  
**August 23, 1979**

I hereby certify that the well location shown on this plat was plotted from field notes of actual surveys made by me or under my supervision, and that the same is true and correct to the best of my knowledge and belief.

Date Surveyed

Registered Professional Engineer and/or Land Surveyor

Certificate No.

RECEIVED

JAN 20 1981

NEW MEXICO OIL CONSERVATION COMMISSION  
P. O. Box 2088, Santa Fe 87501

NO. OF COPIES RECEIVED	
DISTRIBUTION	
File	/
N. M. B. M.	/
U. S. G. S.	/
Operator	/
Land Office <u>BLM</u>	/

SUNDRY NOTICES AND REPORTS  
ON  
GEOTHERMAL RESOURCES WELLS

## OIL CONSERVATION DIVISION

Indicate Type of Lease

State ☐ Fee ☒

5.a State Lease No.

Do Not Use This Form for Proposals to Drill or to Deepen or Plug Back to a Different Reservoir. Use "Application For Permit -" (Form G-101) for Such Proposals.

1. Type of well Geothermal Producer <input type="checkbox"/> Temp. Observation <input checked="" type="checkbox"/> Low-Temp Thermal <input type="checkbox"/> Injection/Disposal <input type="checkbox"/>	7. Unit Agreement Name
2. Name of Operator <u>Occidental Geothermal, Inc.</u>	8. Farm or Lease Name <u>Cerro Mesa Ranch</u>
3. Address of Operator <u>5000 Stockdale Highway, Bakersfield, California 93309</u>	9. Well No. <u>2</u>
4. Location of Well Unit Letter <u>K</u> , <u>2,635</u> Feet From The <u>South</u> Line and <u>2,635</u> Feet From The <u>West</u> Line, Section <u>30</u> Township <u>20S</u> Range <u>10W</u> NMPM.	10. Field and Pool, or Wildcat <u>Faywood</u>
15. Elevation (Show whether DF, RT, GR, etc.) <u>4,850' Ground</u>	12. County <u>Luna</u>

16. Check Appropriate Box To Indicate Nature of Notice, Report or Other Data

## NOTICE OF INTENTION TO:

PERFORM REMEDIAL WORK ☐ PLUG AND ABANDON ☐  
TEMPORARILY ABANDON ☐  
PULL OR ALTER CASING ☐ CHANGE PLANS ☐  
OTHER ☐

## SUBSEQUENT REPORT OF:

REMEDIAL WORK ☐ ALTERING CASING ☐  
COMMENCE DRILLING OPNS. ☐ PLUG & ABANDONMENT ☒  
CASING TEST AND CEMENT JOB ☐  
OTHER ☐

17. Describe Proposed or completed Operations (Clearly state all pertinent details, and give pertinent dates, including estimated date of starting any proposed work) SEE RULE 203.

## Completed Operations:

Well plugged and abandoned on December 17, 1980 by cutting off pipe 24 inches below ground level and subsequently filling the pipe with 10 feet of cement to top of pipe.

18. I hereby certify that the information above is true and complete to the best of my knowledge and belief.

SIGNED Keo E. Stiff TITLE Geologist DATE January 13, 1981APPROVED BY Carl Ulvog TITLE SENIOR PETROLEUM GEOLOGIST DATE 1-22-81

CONDITIONS OF APPROVAL, IF ANY:

NO. OF COPIES RECEIVED	
DISTRIBUTION	
File	
N.M.B.M.	
U.S.	
Operator	
Land Office	

## NEW MEXICO OIL CONSERVATION COMMISSION

P. O. Box 2088, Santa Fe 87501

APPLICATION FOR PERMIT TO DRILL, DEEPEN,  
OR PLUG BACK---GEOTHERMAL RESOURCES WELL5. Indicate Type of Lease  
STATE ☐ FEE ☒

5.a State Lease No.

--

7. Unit Agreement Name

--

8. Farm or Lease Name

Cerro Mesa Ranch

9. Well No.

2

10. Field and Pool, or Wildcat

Faywood

1a. Type of Work Drill ☒ Deepen ☐ Plug Back ☐b. Type of Well Geothermal Producer ☐ Temp Observation ☒  
Low-Temp Thermal ☐ Injection/Disposal ☐

2. Name of Operator

Occidental Geothermal, Inc.

3. Address of Operator

5000 Stockdale Highway, Bakersfield, California 93309

4. Location of Well UNIT LETTER K LOCATED 2,640 FEET FROM THE south LINE

2635

west

2635

AND 2,640 FEET FROM THE east LINE OF SEC. 30 TWP. 20 S RGE. 10 W NMPM

12. County

Luna

19. Proposed Depth

500'

19A. Formation

20. Rotary or C.T.

Rotary

21. Elevations (Show whether DF, RT, etc.)

4,850 Ground

21A. Kind &amp; Status Plug. Bond

\$10,000 Multi Well

21B. Drilling Contractor

Kachina Drilling, Inc.

22. Approx. Date Work will start

August 28, 1979

## PROPOSED CASING AND CEMENT PROGRAM

SIZE OF HOLE	SIZE OF CASING	WEIGHT PER FOOT	SETTING DEPTH	SACKS OF CEMENT	EST. TOP
6"±	1½" line pipe	--	500'	two	2' from surface

1. Drill 6"± hole to 500' using air if possible and mud if necessary.
2. Run 1½" bull plugged line pipe to within 5'± of bottom. If the hole is drilled with air, fill the annulus with mud.
3. Cement the 1½" x 6" annulus from 10'± below ground level to within 2' of the surface.
4. Fill the 1½" pipe with water and install well head cap.
5. Clean up the location.
6. Run temperature logs ten days or more after drilling.
7. Abandon the hole by placing cement from 10'± below ground level to within 2' of the surface. Cut off the pipe below ground level. Hole abandoned.

11-1 : Found loc (across rd from old school)  
Pipe not showing.

P&A 12/17/80

APPROVAL VALID FOR 90 DAYS  
PER TITLE 11-26-79  
UNLESS DRILLING UNDERWAY

ABOVE SPACE DESCRIBE PROPOSED PROGRAM: If proposal is to deepen or plug back, give data on present productive zone and proposed new productive zone. Give blowout preventer program, if any.

I hereby certify that the information above is true and complete to the best of my knowledge and belief.

By B. J. Ryan Title Petroleum Engineer Date August 23, 1979  
(This space for State Use)APPROVED BY Carl W. Wozz TITLE SENIOR PETROLEUM GEOLOGIST DATE 8/21/79  
CONDITIONS OF APPROVAL, IF ANY:

Occi. advised to send comp. G-103. (at well - cu)





STATE OF NEW MEXICO  
ENERGY AND MINERALS DEPARTMENT  
OIL CONSERVATION DIVISION

BRUCE KING  
GOVERNOR  
LARRY KEHOE  
SECRETARY

POST OFFICE BOX 2088  
STATE LAND OFFICE BUILDING  
SANTA FE, NEW MEXICO 87501  
(505) 827-2434

July 21, 1980

Occidental Geothermal, Inc.  
5000 Stockdale Highway  
Bakersfield, California 93309

*file - #2*

Attention: Mr. B. J. Wyant

Subject: Temperature Observation Wells,  
Luna and Grant Counties,  
New Mexico, all Cerro Mesa Ranch  
Lease, #1 - Section 27, Township  
20 South, Range 11 West;  
#2 - Section 30, Township 20 South,  
Range 10 West; #3 Section 1,  
Township 21 South, Range 11 West;  
#4 Section 7, Township 20 South,  
Range 10 West.

Dear Sir:

This agency's files contain only the Forms C-101 and C-102 pertaining to the above referenced wells. We are aware that the wells drilled in latter 1979, however there are no reports here to suggest that fact, nor indications (other than telephone conversations) that you have completed your bore-hole studies.

In conversations with your well-site representative, I advised of the need for this agency to be notified of plugging for abandonment. To date no such notice has been received. As you know, our regulations do not put a time limit on the duration of temperature measurements, but do specify the maximum time for which a well may be abandoned without plugging. (See Rules 301, 302 and 303).

If you have need of the subject wells for further logging or other purposes but are not now utilizing them, I suggest you apply for temporary abandonment permits in accordance with the rules.

Very truly yours,

*Carl Ulvog*

CARL ULVOG  
Geothermal Supervisor

NEW MEXICO OIL CONSERVATION COMMISSION  
P. O. Box 2088, Santa Fe 87501APPLICATION FOR PERMIT TO DRILL, DEEPEN,  
OR PLUG BACK--GEOTHERMAL RESOURCES WELL

5. Indicate Type of Lease

STATE ☐FEE ☒

5.a State Lease No.

--

7. Unit Agreement Name

--

8. Farm or Lease Name

Cerro Mesa Ranch

9. Well No.

2

10. Field and Pool, or Wildcat

Faywood

12. County

Luna

19. Proposed Depth

500'

19A. Formation

20. Rotary or C.T.

Rotary

21. Elevations (Show whether DF, RT, etc.)

4,850 Ground

21A. Kind &amp; Status Plug. Bond

\$10,000 Multi Well

21B. Drilling Contractor

Kachina Drilling, Inc.

22. Approx. Date Work will start

August 28, 1979

## PROPOSED CASING AND CEMENT PROGRAM

SIZE OF HOLE	SIZE OF CASING	WEIGHT PER FOOT	SETTING DEPTH	SACKS OF CEMENT	EST. TOP
6"+	1½" line pipe	--	500'	two	2' from surface

1. Drill 6"+ hole to 500' using air if possible and mud if necessary.
2. Run 1½" bull plugged line pipe to within 5'+ of bottom. If the hole is drilled with air, fill the annulus with mud.
3. Cement the 1½" x 6" annulus from 10'+ below ground level to within 2' of the surface.
4. Fill the 1½" pipe with water and install well head cap.
5. Clean up the location.
6. Run temperature logs ten days or more after drilling.
7. Abandon the hole by placing cement from 10'+ below ground level to within 2' of the surface. Cut off the pipe below ground level. Hole abandoned.

APPROVAL VALID FOR 90 DAYS  
PERMIT EXPIRES 11-26-79  
UNLESS DRILLING UNDERWAY

IN ABOVE SPACE DESCRIBE PROPOSED PROGRAM: If proposal is to deepen or plug back, give data on present productive zone and proposed new productive zone. Give blowout preventer program, if any.

I hereby certify that the information above is true and complete to the best of my knowledge and belief.

Signed B. J. Vigan Title Petroleum Engineer Date August 23, 1979

(This space for State Use)

APPROVED BY Carl Ueoy TITLE SENIOR PETROLEUM GEOLOGIST DATE 8/28/79

CONDITIONS OF APPROVAL, IF ANY:

GEOTHERMAL RESOURCES WELL LOCATION AND ACREAGE DEDICATION PLAT

All distances must be from the outer boundaries of the Section.

Operator <b>Occidental Geothermal, Inc.</b>			Lease <b>Cerro Mesa Ranch, Inc.</b>		Well No. <b>2</b>
Unit Letter <b>K</b>	Section <b>30</b>	Township <b>20 South</b>	Range <b>10 West</b>	County <b>Luna</b>	
Actual Footage Location of Well: <b>2635</b> feet from the <b>south</b> line and <b>2635</b> feet from the <b>west</b> line <del>2635</del> <del>2,640</del>					
Ground Level Elev. <b>4,850</b>	Producing Formation	Pool <b>Faywood</b>	Dedicated Acreage: <b>160</b> Acres		

1. Outline the acreage dedicated to the subject well by colored pencil or hachure marks on the plat below.
2. If more than one lease is dedicated to the well, outline each and identify the ownership thereof (both as to working interest and royalty).
3. If more than one lease of different ownership is dedicated to the well, have the interests of all owners been consolidated by communitization, unitization, force-pooling, etc?

☐ Yes ☐ No If answer is "yes," type of consolidation \_\_\_\_\_

If answer is "no," list the owners and tract descriptions which have actually been consolidated. (Use reverse side of this form if necessary.) \_\_\_\_\_

No allowable will be assigned to the well until all interests have been consolidated (by communitization, unitization, forced-pooling, or otherwise) or until a non-standard unit, eliminating such interests, has been approved by the Commission.

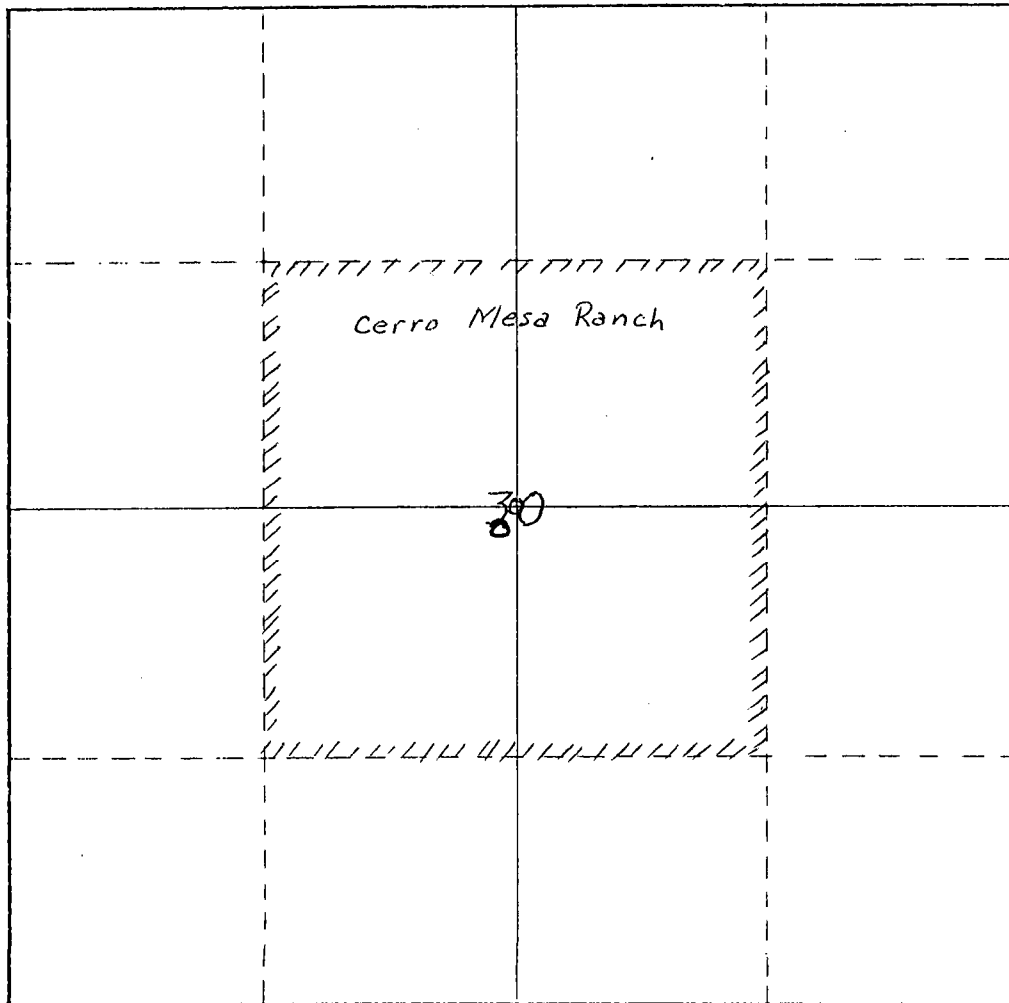

CERTIFICATION

I hereby certify that the information contained herein is true and complete to the best of my knowledge and belief.

*B. J. Wyant*

Name  
**B. J. Wyant**  
Position  
**Petroleum Engineer**  
Company  
**Occidental Geothermal, Inc.**  
Date  
**August 23, 1979**

I hereby certify that the well location shown on this plat was plotted from field notes of actual surveys made by me or under my supervision, and that the same is true and correct to the best of my knowledge and belief.

Date Surveyed  
  
Registered Professional Engineer and/or Land Surveyor  
  
Certificate No.

