

**GTLT - \_\_\_\_12\_\_\_\_**

**Occidental Geothermal, Inc.**

**1-21S-11W**

**Luna County**

**Well No. 3-0**

NO. OF COPIES RECEIVED	
DISTRIBUTION	
File	1 ✓
N. M. B. M.	1
U. S. G. S.	1
Operator	1
Land-Office	BLM 1

NEW MEXICO OIL CONSERVATION COMMISSION  
P. O. Box 2088, Santa Fe 87501

**RECEIVED** Form G-103  
JAN 20 1981  
Adopted 10/1/74  
OIL CONSERVATION DIVISION

**SUNDRY NOTICES AND REPORTS  
ON  
GEOTHERMAL RESOURCES WELLS**

5. Indicate Type of Lease  
State ☐ Fee ☒  
5.a State Lease No.

Do Not Use This Form for Proposals to Drill or to Deepen or Plug Back to a Different Reservoir. Use "Application For Permit -" (Form G-101) for Such Proposals.)

1. Type of well Geothermal Producer <input type="checkbox"/> Temp. Observation <input checked="" type="checkbox"/> Low-Temp Thermal <input type="checkbox"/> Injection/Disposal <input type="checkbox"/>	7. Unit Agreement Name
2. Name of Operator Occidental Geothermal, Inc.	8. Farm or Lease Name Cerro Mesa Ranch
3. Address of Operator 5000 Stockdale Highway, Bakersfield, California 93309	9. Well No. 3
4. Location of Well Unit Letter 528 Feet From The south Line and 2,376 Feet From The east Line, Section 1 Township 21S Range 11W NMPM.	10. Field and Pool, or Wildcat Faywood
15. Elevation (Show whether DF, RT, GR, etc.) 4,860' Ground	12. County Luna

16. Check Appropriate Box To Indicate Nature of Notice, Report or Other Data.

**NOTICE OF INTENTION TO:**

PERFORM REMEDIAL WORK ☐ PLUG AND ABANDON ☐  
TEMPORARILY ABANDON ☐  
PULL OR ALTER CASING ☐ CHANGE PLANS ☐  
OTHER ☐

**SUBSEQUENT REPORT OF:**

REMEDIAL WORK ☐ ALTERING CASING ☐  
COMMENCE DRILLING OPNS. ☐ PLUG & ABANDONMENT ☒  
CASING TEST AND CEMENT JOB ☐  
OTHER ☐

17. Describe Proposed or completed Operations (Clearly state all pertinent details, and give pertinent dates, including estimated date of starting any proposed work) SEE RULE 203.

**Completed Operations:**

Well plugged and abandoned on December 17, 1980 by cutting off pipe 24 inches below ground level and subsequently filling the pipe with 10 feet of cement to top of pipe.

18. I hereby certify that the information above is true and complete to the best of my knowledge and belief.

SIGNED George E. Stein TITLE Geologist DATE January 13, 1981

APPROVED BY Carl Ulvog TITLE SENIOR PETROLEUM GEOLOGIST DATE 1-22-81

CONDITIONS OF APPROVAL, IF ANY:

NEW MEXICO OIL CONSERVATION COMMISSION  
P. O. Box 2088, Santa Fe 87501APPLICATION FOR PERMIT TO DRILL, DEEPEN,  
OR PLUG BACK--GEOTHERMAL RESOURCES WELL

5. Indicate Type of Lease

STATE ☐FEE ☒

5.a State Lease No.

--

7. Unit Agreement Name

--

8. Farm or Lease Name

Cerro Mesa Ranch

9. Well No.

3

10. Field and Pool, or Wildcat

Faywood

12. County

Luna

NO. OF COPIES RECEIVED	
DISTRIBUTION	
File	
N.M.B.M.	
U.S.	
Operator	
Land Office	

1a. Type of Work Drill ☒ Deepen ☐ Plug Back ☐b. Type of Well Geothermal Producer ☐ Temp Observation ☒  
Low-Temp Thermal ☐ Injection/Disposal ☐2. Name of Operator  
Occidental Geothermal, Inc.3. Address of Operator  
5000 Stockdale Highway, Bakersfield, California 933094. Location of Well UNIT LETTER O LOCATED 528 FEET FROM THE south LINE  
AND 2,376 FEET FROM THE eastLINE OF SEC. 1 TWP. 21 S RGE. 11W NMPM

19. Proposed Depth

500'

19A. Formation

20. Rotary or C.T.

Rotary

21. Elevations (Show whether DF, RT, etc.)  
4,860 Ground21A. Kind & Status Plug. Bond  
\$10,000 Multi Well21B. Drilling Contractor  
Kachina Drilling, Inc.22. Approx. Date Work will start  
August 28, 1979

## PROPOSED CASING AND CEMENT PROGRAM

SIZE OF HOLE	SIZE OF CASING	WEIGHT PER FOOT	SETTING DEPTH	SACKS OF CEMENT	EST. TOP
6"±	1½" line pipe	--	500'	two	2' from surface

1. Drill 6"± hole to 500' using air if possible and mud if necessary.
2. Run 1½" bull plugged line pipe to within 5'± of bottom. If the hole is drilled with air, fill the annulus with mud.
3. Cement the 1½" x 6" annulus from 10'± below ground level to within 2' of the surface.
4. Fill the 1½" pipe with water and install well head cap.
5. Clean up the location.
6. Run temperature logs ten days or more after drilling.
7. Abandon the hole by placing cement from 10'± below ground level to within 2' of the surface. Cut off the pipe below ground level. Hole abandoned.

11-2-79: Rig on loc. Johnson Drilling Co., Las Cruces  
526-8672Quad 99  
± 20 mi NW of Deming

± 21 mi SE of Hurley

APPROVAL VALID FOR 90 DAYS  
PERMIT EXPIRES 11-26-79  
UNLESS DRILLING UNDERWAY

ON ABOVE SPACE DESCRIBE PROPOSED PROGRAM: If proposal is to deepen or plug back, give data on present productive zone and proposed new productive zone. Give blowout preventer program, if any.

I hereby certify that the information above is true and complete to the best of my knowledge and belief.

Signed B. J. Ryan Title Petroleum Engineer Date August 23, 1979

(This space for State Use)

APPROVED BY Cecil W. King TITLE SENIOR PETROLEUM GEOLOGIST DATE 8/28/79

CONDITIONS OF APPROVAL, IF ANY:

Operator advised of need for comp. G-103 (verbal at well - cu)



STATE OF NEW MEXICO  
ENERGY AND MINERALS DEPARTMENT  
OIL CONSERVATION DIVISION

BRUCE KING  
GOVERNOR  
LARRY KEHOE  
SECRETARY

POST OFFICE BOX 2088  
STATE LAND OFFICE BUILDING  
SANTA FE, NEW MEXICO 87501  
(505) 827-2434

July 21, 1980

Occidental Geothermal, Inc.  
5000 Stockdale Highway  
Bakersfield, California 93309

*File - #3*

Attention: Mr. B. J. Wyant

Subject: Temperature Observation Wells,  
Luna and Grant Counties,  
New Mexico, all Cerro Mesa Ranch  
Lease, #1 - Section 27, Township  
20 South, Range 11 West;  
#2 - Section 30, Township 20 South,  
Range 10 West; #3 Section 1,  
Township 21 South, Range 11 West;  
#4 Section 7, Township 20 South,  
Range 10 West.

Dear Sir:

This agency's files contain only the Forms C-101 and C-102 pertaining to the above referenced wells. We are aware that the wells drilled in latter 1979, however there are no reports here to suggest that fact, nor indications (other than telephone conversations) that you have completed your bore-hole studies.

In conversations with your well-site representative, I advised of the need for this agency to be notified of plugging for abandonment. To date no such notice has been received. As you know, our regulations do not put a time limit on the duration of temperature measurements, but do specify the maximum time for which a well may be abandoned without plugging. (See Rules 301, 302 and 303).

If you have need of the subject wells for further logging or other purposes but are not now utilizing them, I suggest you apply for temporary abandonment permits in accordance with the rules.

Very truly yours,

*Carl Ulvog*

CARL ULVOG  
Geothermal Supervisor

NEW MEXICO OIL CONSERVATION COMMISSION  
P. O. Box 2088, Santa Fe 87501

NO. OF COPIES RECEIVED		
DISTRIBUTION		
File	/	/
N.M.B.M.	/	
U.S.G.S.	/	
Operator	/	
Land Office		

APPLICATION FOR PERMIT TO DRILL, DEEPEN,  
OR PLUG BACK---GEOTHERMAL RESOURCES WELL

5. Indicate Type of Lease
STATE <input type="checkbox"/> FEE <input checked="" type="checkbox"/>
5.a State Lease No.
--

1a. Type of Work	Drill <input checked="" type="checkbox"/>	Deepen <input type="checkbox"/>	Plug Back <input type="checkbox"/>
b. Type of Well	Geothermal Producer <input type="checkbox"/>	Temp Observation <input checked="" type="checkbox"/>	Injection/Disposal <input type="checkbox"/>
2. Name of Operator	Occidental Geothermal, Inc.		
3. Address of Operator	5000 Stockdale Highway, Bakersfield, California 93309		
4. Location of Well	UNIT LETTER <u>O</u> LOCATED <u>528</u> FEET FROM THE <u>south</u> LINE AND <u>2,376</u> FEET FROM THE eastLINE OF SEC. <u>1</u> TWP. <u>21 S</u> RGE. <u>11W</u> NMPM		

7. Unit Agreement Name
--
8. Farm or Lease Name
Cerro Mesa Ranch
9. Well No.
<u>3</u>
10. Field and Pool, or Wildcat
Faywood
12. County
Luna

19. Proposed Depth	500'	19A. Formation	20. Rotary or C.T.
			Rotary
21. Elevations (Show whether DF, RT, etc.)	21A. Kind & Status Plug. Bond	21B. Drilling Contractor	22. Approx. Date Work will start
4,860 Ground	\$10,000 Multi Well	Kachina Drilling, Inc.	August 28, 1979

## PROPOSED CASING AND CEMENT PROGRAM

SIZE OF HOLE	SIZE OF CASING	WEIGHT PER FOOT	SETTING DEPTH	SACKS OF CEMENT	EST. TOP
6"+	1 1/4" line pipe	--	500'	two	2' from surface

1. Drill 6"+ hole to 500' using air if possible and mud if necessary.
2. Run 1 1/4" bull plugged line pipe to within 5'+ of bottom. If the hole is drilled with air, fill the annulus with mud.
3. Cement the 1 1/4" x 6" annulus from 10'+ below ground level to within 2' of the surface.
4. Fill the 1 1/4" pipe with water and install well head cap.
5. Clean up the location.
6. Run temperature logs ten days or more after drilling.
7. Abandon the hole by placing cement from 10'+ below ground level to within 2' of the surface. Cut off the pipe below ground level. Hole abandoned.

APPROVAL VALID FOR 90 DAYS  
PERMIT EXPIRES 11-26-79  
UNLESS DRILLING UNDERWAY

IN ABOVE SPACE DESCRIBE PROPOSED PROGRAM: If proposal is to deepen or plug back, give data on present productive zone and proposed new productive zone. Give blowout preventer program, if any.

I hereby certify that the information above is true and complete to the best of my knowledge and belief.

Signed B. J. Ryan Title Petroleum Engineer Date August 23, 1979  
(This space for State Use)APPROVED BY Carl Ullvog TITLE SENIOR PETROLEUM GEOLOGIST DATE 8/28/79  
CONDITIONS OF APPROVAL, IF ANY:

**GEOHERMAL RESOURCES WELL LOCATION AND ACREAGE DEDICATION PLAT**

All distances must be from the outer boundaries of the Section.

Operator <b>Occidental Geothermal, Inc.</b>		Lease <b>Cerro Mesa Ranch, Inc.</b>		Well No. <b>3</b>
Unit Letter <b>0</b>	Section <b>1</b>	Township <b>21 South</b>	Range <b>11 West</b>	County <b>Luna</b>
Actual Footage Location of Well: <b>528</b> feet from the <b>south</b> line and <b>2,376</b> feet from the <b>east</b> line				
Ground Level Elev. <b>4,860</b>	Producing Formation		Pool <b>Faywood</b>	Dedicated Acreage: <b>160</b> Acres

1. Outline the acreage dedicated to the subject well by colored pencil or hachure marks on the plat below.
2. If more than one lease is dedicated to the well, outline each and identify the ownership thereof (both as to working interest and royalty).
3. If more than one lease of different ownership is dedicated to the well, have the interests of all owners been consolidated by communitization, unitization, force-pooling, etc?

☐ Yes ☐ No If answer is "yes," type of consolidation \_\_\_\_\_

If answer is "no," list the owners and tract descriptions which have actually been consolidated. (Use reverse side of this form if necessary.) \_\_\_\_\_

No allowable will be assigned to the well until all interests have been consolidated (by communitization, unitization, forced-pooling, or otherwise) or until a non-standard unit, eliminating such interests, has been approved by the Commission.

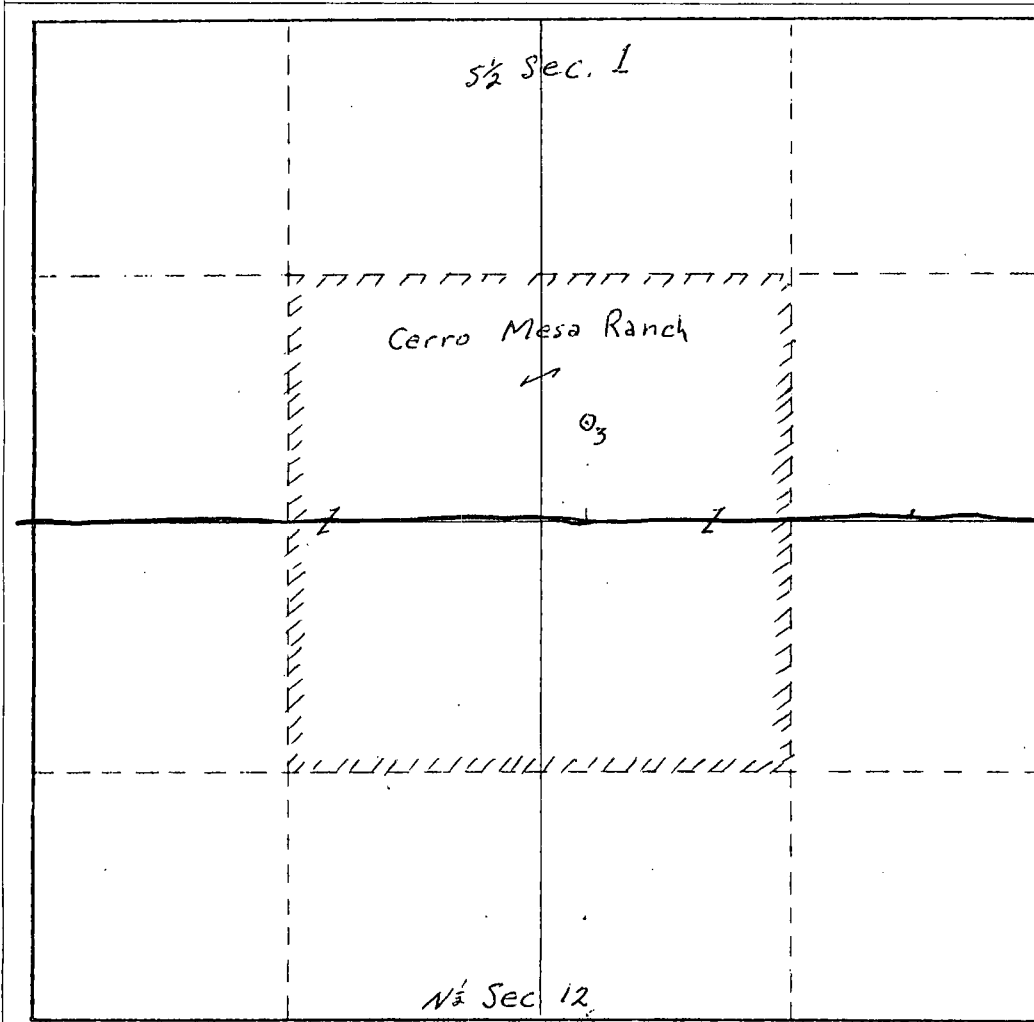

**CERTIFICATION**

I hereby certify that the information contained herein is true and complete to the best of my knowledge and belief.

*B. J. Wyant*

Name <b>B. J. Wyant</b>
Position <b>Petroleum Engineer</b>
Company <b>Occidental Geothermal, Inc.</b>
Date <b>August 23, 1979</b>

I hereby certify that the well location shown on this plat was plotted from field notes of actual surveys made by me or under my supervision, and that the same is true and correct to the best of my knowledge and belief.

Date Surveyed
Registered Professional Engineer and/or Land Surveyor

Certificate No.
-----------------

