

WOOD-McSHANE, INC.

MANAGEMENT AND OPERATIONS

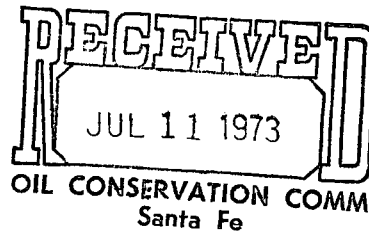

TELEPHONE 915 - 943-3092
P. O. BOX 968
MONAHANS, TEXAS 79756

July 9, 1973

NSP-924

Rec Aug 10

State of New Mexico
Oil Conservation Commission
P. O. Box 2088
Santa Fe, New Mexico 87501

Attention: Mr. A. L. Porter, Jr.

In Re: Wood, McShane & Thams 692, Ltd.
New Mexico "M" State No. 4
Salmon Eumont Gas Pool,
Lea County, New Mexico

Gentlemen:

Wood, McShane & Thams respectfully request administrative approval of New Mexico "M" State No. 4, being classified as a Eumont Gas Pool well and assigned a 160 acre non-standard gas proration unit. New Mexico "M" State No. 4 is located 660 feet from the north line and 1980 feet from the west line and in the NW/4, Section 19, T-22-S, Range 37-E, Lea County, New Mexico. Please find attached copies of Forms C-102, C-103, and a plat showing the general location.

Yours very truly,

WOOD-McSHANE, INC., For
Wood, McShane & Thams 692, Ltd.

A handwritten signature in cursive script, appearing to read "K. D. Myrick".

K. D. Myrick
Petroleum Engineer

KDM:msw
Attachments

cc: Mr. Joe D. Ramey
Oil Conservation Commission
Hobbs, New Mexico 88240

NEW MEXICO OIL CONSERVATION COMMISSION
WELL LOCATION AND ACREAGE DEDICATION PLAT

RECEIVED
JUL 11 1973
OIL CONSERVATION COMMISSION

Form C-102
Supersedes C-128
Effective 1-1-65

All distances must be from the outer boundaries of the Section.

| | | | | |
|---|---|-------------------------------|--------------------|---------------------------------|
| Operator Wood, McShane & Thams 692, Ltd. | | Lease New Mexico "M" State | | Well No. 4 |
| Unit Letter C | Section 19 | Township 22-S | Range 37-E | County Lea |
| Actual Footage Location of Well: 660 feet from the North line and 1980 feet from the West line | | | | |
| Ground Level Elev: 3414' | Producing Formation Yates, 7 Rivers, & Queen | | Pool Eumont Gas | Dedicated Acreage: 160 Acres |

1. Outline the acreage dedicated to the subject well by colored pencil or hachure marks on the plat below.
2. If more than one lease is dedicated to the well, outline each and identify the ownership thereof (both as to working interest and royalty).
3. If more than one lease of different ownership is dedicated to the well, have the interests of all owners been consolidated by communitization, unitization, force-pooling, etc?

☐ Yes ☐ No If answer is "yes," type of consolidation _____

If answer is "no," list the owners and tract descriptions which have actually been consolidated. (Use reverse side of this form if necessary.) _____

No allowable will be assigned to the well until all interests have been consolidated (by communitization, unitization, forced-pooling, or otherwise) or until a non-standard unit, eliminating such interests, has been approved by the Commission.

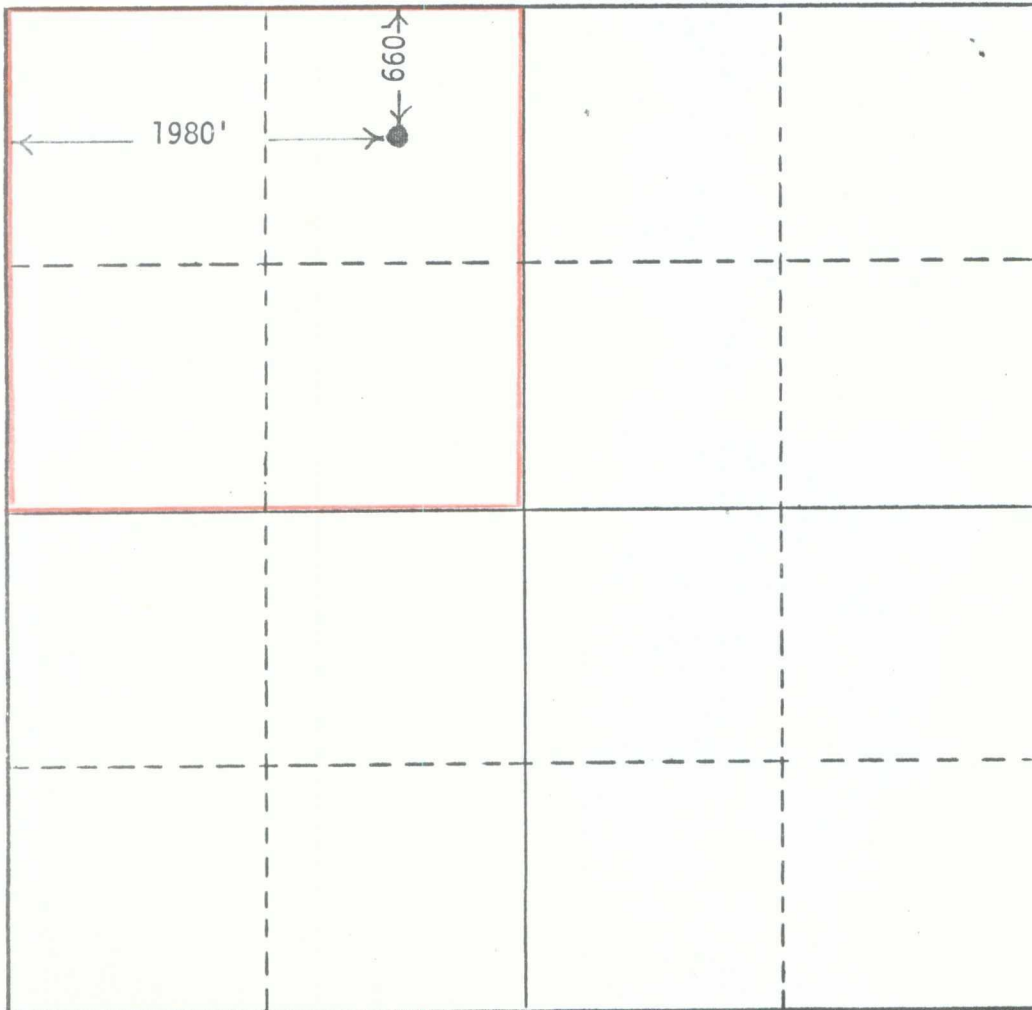

CERTIFICATION

I hereby certify that the information contained herein is true and complete to the best of my knowledge and belief.

K. D. Myrick *K. D. Myrick*

Name
Petroleum Engineer
Position
Wood, McShane & Thams
Company
July 9, 1973
Date

I hereby certify that the well location shown on this plat was plotted from field notes of actual surveys made by me or under my supervision, and that the same is true and correct to the best of my knowledge and belief.

Date Surveyed
Registered Professional Engineer
and/or Land Surveyor

Certificate No.

0 330 660 990 1320 1650 1980 2310 2640 2000 1600 1200 800 0

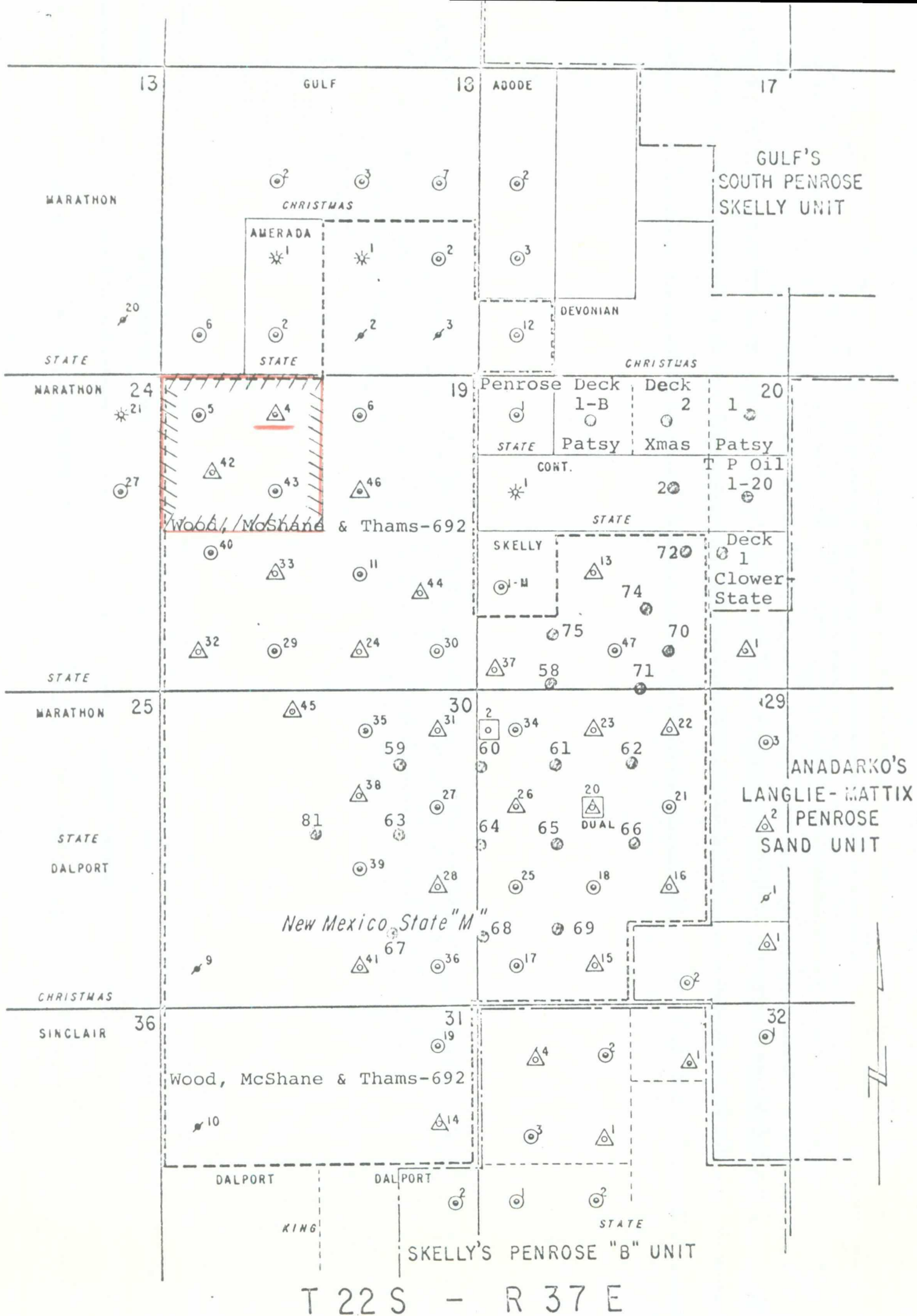

- LEGEND -

- ⊙ Producing Wells
- △ Water Injection Wells
- Water Source Wells
- * Gas Wells
- ✕ P. & A. Wells

QUEEN SAND

FLOOD PATTERN

- State "M" Lease
- Unit Lines

WOOD, McSHANE & THAMS 692, LTD.
 NEW MEXICO STATE "M" LEASE
 LANGLEIE MATTIX POOL
 LEA COUNTY, NEW MEXICO

| | | |
|------------------------|--|--|
| NO. OF COPIES RECEIVED | | |
| DISTRIBUTION | | |
| SANTA FE | | |
| FILE | | |
| U.S.G.S. | | |
| LAND OFFICE | | |
| OPERATOR | | |

NEW MEXICO OIL CONSERVATION COMMISSION

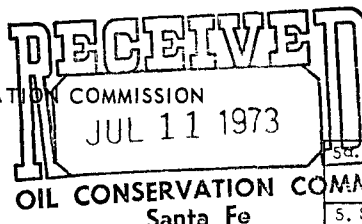

Form C-103
Supersedes Old
C-102 and C-103
Effective 1-1-65

5a. Indicate Type of Lease

State ☒ Fee ☐

5. State Oil & Gas Lease No.

B-234

SUNDRY NOTICES AND REPORTS ON WELLS

(DO NOT USE THIS FORM FOR PROPOSALS TO DRILL OR TO DEEPEN OR PLUG BACK TO A DIFFERENT RESERVOIR. USE "APPLICATION FOR PERMIT -" (FORM C-101) FOR SUCH PROPOSALS.)

| | |
|--|--------------------------------|
| 1. OIL WELL <input type="checkbox"/> GAS WELL <input checked="" type="checkbox"/> OTHER <input type="checkbox"/> | 7. Unit Agreement Name |
| 2. Name of Operator | 8. Farm or Lease Name |
| Wood, McShane & Thams-692, Limited | New Mexico "M" State |
| 3. Address of Operator | 9. Well No. |
| P. O. Box 968, Monahans, Texas 79756 | 4 |
| 4. Location of Well | 10. Field and Pool, or Wildcat |
| UNIT LETTER C 660 FEET FROM THE North LINE AND 1980 FEET FROM | Eumont |
| THE West LINE, SECTION 19 TOWNSHIP 22-S RANGE 37-E NMPM. | |
| 15. Elevation (Show whether DF, RT, GR, etc.) | 12. County |
| 3414' (GL) | Lea |

16. Check Appropriate Box To Indicate Nature of Notice, Report or Other Data
NOTICE OF INTENTION TO: SUBSEQUENT REPORT OF:

| | | | |
|---|---|--|---|
| PERFORM REMEDIAL WORK <input checked="" type="checkbox"/> | PLUG AND ABANDON <input type="checkbox"/> | REMEDIAL WORK <input type="checkbox"/> | ALTERING CASING <input type="checkbox"/> |
| TEMPORARILY ABANDON <input type="checkbox"/> | CHANGE PLANS <input type="checkbox"/> | COMMENCE DRILLING OPNS. <input type="checkbox"/> | PLUG AND ABANDONMENT <input type="checkbox"/> |
| PULL OR ALTER CASING <input type="checkbox"/> | OTHER <input checked="" type="checkbox"/> Recomplete in new reservoir | CASING TEST AND CEMENT JOBS <input type="checkbox"/> | OTHER <input type="checkbox"/> |

17. Describe Proposed or Completed Operations (Clearly state all pertinent details, and give pertinent dates, including estimated date of starting any proposed work) SEE RULE 1103.

1. Pull tubing and packer.
2. Run 2-1/2" tubing and packer and swab test.
3. Squeeze open hole 3578'-3702'.
4. Spot acid, log, and perforate Yates, 7-Rivers, & Queen.
5. Acidize perforated interval with 1500 gals.
6. Frac with 30,000 gals. gelled brine and 45,000# 20-40 sand.

18. I hereby certify that the information above is true and complete to the best of my knowledge and belief.

SIGNED K. D. Myrick K. D. Myrick TITLE Petroleum Engineer DATE 7-7-73

APPROVED BY _____ TITLE _____ DATE _____

CONDITIONS OF APPROVAL, IF ANY:

| | | |
|-----------------|--|--|
| COPIES RECEIVED | | |
| DISTRIBUTION | | |
| SANTA FE | | |
| FILE | | |
| U.S.G.S. | | |
| LAND OFFICE | | |
| OPERATOR | | |

NEW MEXICO OIL CONSERVATION COMMISSION

OIL CONSERVATION COMM
Santa Fe

Form C-103
Supersedes Old
C-102 and C-103
Effective 1-1-65

| | | |
|----------------------------|---|------------------------------|
| 5a. Indicate Type of Lease | State <input checked="" type="checkbox"/> | Fee <input type="checkbox"/> |
|----------------------------|---|------------------------------|

5. State Oil & Gas Lease No.

B-234

SUNDRY NOTICES AND REPORTS ON WELLS

(DO NOT USE THIS FORM FOR PROPOSALS TO DRILL OR TO DEEPEN OR PLUG BACK TO A DIFFERENT RESERVOIR. USE "APPLICATION FOR PERMIT -" (FORM C-101) FOR SUCH PROPOSALS.)

| | |
|--|--------------------------------|
| 1. OIL WELL <input type="checkbox"/> GAS WELL <input checked="" type="checkbox"/> OTHER <input type="checkbox"/> | 7. Unit Agreement Name |
| 2. Name of Operator | 8. Farm or Lease Name |
| Wood, McShane & Thams-692, Limited | New Mexico "M" State |
| 3. Address of Operator | 9. Well No. |
| P. O. Box 968, Monahans, Texas 79756 | 4 |
| 4. Location of Well | 10. Field and Pool, or Wildcat |
| UNIT LETTER C 660 FEET FROM THE North LINE AND 1980 FEET FROM | Eumont |
| THE West LINE, SECTION 19 TOWNSHIP 22-S RANGE 37-E NMPM. | |
| 15. Elevation (Show whether DF, RT, GR, etc.) | 12. County |
| 3414' (GL) | Lea |

Check Appropriate Box To Indicate Nature of Notice, Report or Other Data

NOTICE OF INTENTION TO:

SUBSEQUENT REPORT OF:

| | | | |
|---|---|--|---|
| PERFORM REMEDIAL WORK <input checked="" type="checkbox"/> | PLUG AND ABANDON <input type="checkbox"/> | REMEDIAL WORK <input type="checkbox"/> | ALTERING CASING <input type="checkbox"/> |
| TEMPORARILY ABANDON <input type="checkbox"/> | CHANGE PLANS <input type="checkbox"/> | COMMENCE DRILLING OPNS. <input type="checkbox"/> | PLUG AND ABANDONMENT <input type="checkbox"/> |
| PULL OR ALTER CASING <input type="checkbox"/> | OTHER <input checked="" type="checkbox"/> Recomplete in new reservoir | CASING TEST AND CEMENT JOBS <input type="checkbox"/> | OTHER <input type="checkbox"/> |

17. Describe Proposed or Completed Operations (Clearly state all pertinent details, and give pertinent dates, including estimated date of starting any proposed work) SEE RULE 1103.

1. Pull tubing and packer.
2. Run 2-1/2" tubing and packer and swab test.
3. Squeeze open hole 3578'-3702'.
4. Spot acid, log, and perforate Yates, 7-Rivers, & Queen.
5. Acidize perforated interval with 1500 gals.
6. Frac with 30,000 gals. gelled brine and 45,000# 20-40 sand.

Jalmat & Langlie Mattix zones must be tested separately and isolated in the well bore.

18. I hereby certify that the information above is true and complete to the best of my knowledge and belief.

SIGNATURE K. D. Myrick TITLE Petroleum Engineer DATE 7-7-73

APPROVED BY [Signature] TITLE SUPERVISOR DISTRICT I DATE JUL 10 1973

CONDITIONS OF APPROVAL, IF ANY: