

**El Paso** NATURAL GAS  
COMPANY

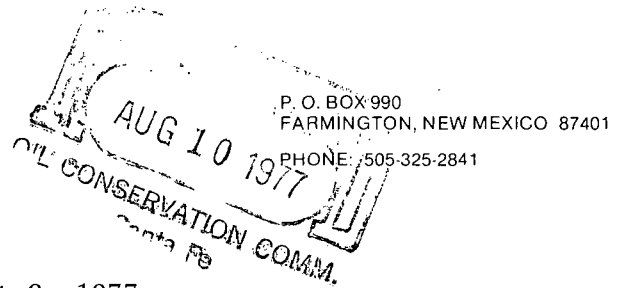

August 9, 1977

NEW MEXICO OIL CONSERVATION COMMISSION  
Attention: Mr. J. D. Ramey, Secretary-Director  
Post Office Box 2088  
Santa Fe, New Mexico 87501

Re: Non-Standard Proration Unit  
Cotton Petroleum Corporation  
Apache No. 20, Unit B, Sec. 4, T24N,  
R4W, N.M.P.M., South Blanco Pictured  
Cliffs, Rio Arriba, New Mexico  
Jicarilla Contract No. 127

Gentlemen:

This is to advise that El Paso Natural Gas Company, as an owner of offset acreage, has no objection to the referenced non-standard proration unit.

Yours very truly,

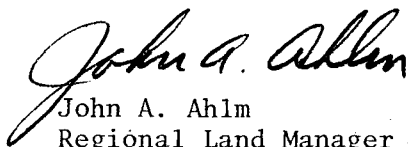
  
John A. Ahlm  
Regional Land Manager  
Energy Resource Development

JAA:ld

cc: Walsh Engineering & Production Corp.  
New Mexico Oil Conservation Commission-Aztec, NM

RECEIVED  
AUG 10 1977  
OIL CONSERVATION COMM.  
Santa Fe

NORTHWEST PRODUCTION CORPORATION

POST OFFICE BOX 1796

EL PASO, TEXAS 79949

August 5, 1977

Mr. Joe D. Ramey  
Secretary-Director  
New Mexico Oil Conservation Commission  
Santa Fe, New Mexico 87501

Re: Non-Standard Proration Unit  
Cotton Petroleum Corporation  
Apache No. 20  
Unit B, Sec. 4-24N-4W, N.M.P.M.  
South Blanco Pictured Cliffs Pool  
Rio Arriba County, New Mexico

Dear Mr. Ramey:

We have no objection to the establishment of the non-standard proration unit applied for on behalf of the operator of the captioned well by Walsh Engineering & Production Corporation.

Very truly yours,

NORTHWEST PRODUCTION CORPORATION

By: *D. Y. Conner*

RHN:sas

cc: Cotton Petroleum Corporation  
Walsh Engineering & Production Corporation  
EPNG Co. Production Dept., Farmington

PETROLEUM ENGINEERING  
RESERVOIR STUDIES  
EVALUATIONS  
GEOLOGICAL STUDIES

EWELL N. WALSH, P.E.  
President

WALSH  
ENGINEERING & PRODUCTION  
CORPORATION  
EXECUTIVE BLDG. - 413 W. MAIN  
P. O. BOX 254  
FARMINGTON, NEW MEXICO  
87401

AUG - 2  
LEASE, MANAGEMENT  
CONTRACT, PUMPING  
DRILLING, SUPERVISION  
WORKOVER, SUPERVISION  
TELEPHONE 325-8203

July 27, 1977

CERTIFIED  
RETURN RECEIPT REQUESTED

Mr. John Ahlm  
Regional Landman  
El Paso Natural Gas Co.  
P. O. Box 990  
Farmington, New Mexico 87401

Ref: Non-Standard Proration Unit  
Cotton Petroleum Corp.  
Apache No. 20  
Unit B-Sec. 4-T24N-R4W  
South Blanco Pictured Cliffs Pool  
Rio Arriba County, New Mexico

Dear Mr. Ahlm:

Attached you will find a copy of the request to the New Mexico Oil Conservation Commission for administrative approval for a Non-Standard Proration Unit for the above-referred-to well.

Without your acknowledgement to the New Mexico Oil Conservation Commission, Santa Fe, New Mexico, of your approval of the request, the Commission is required to wait 20 days before approving the request.

Your earliest possible approval of the request, to the Commission, would be greatly appreciated.

Very truly yours,



Ewell N. Walsh, P. E.  
President

ENW:ea

Enclosure

cc: Cotton Petroleum Corp., wo/encl.

Mr. J. D. Ramey, NMOCC, Santa Fe, N.M., wo/encl. ✓

PETROLEUM ENGINEERING  
RESERVOIR STUDIES  
EVALUATIONS  
GEOLOGICAL STUDIES

EWELL N. WALSH, P.E.  
President

**WALSH  
ENGINEERING & PRODUCTION  
CORPORATION**

EXECUTIVE BLDG. - 413 W. MAIN  
P. O. BOX 254  
FARMINGTON, NEW MEXICO  
87401

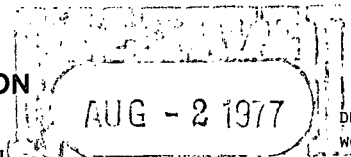

LEASE MANAGEMENT  
CONTRACT PUMPING  
DRILLING SUPERVISION  
WORKOVER SUPERVISION

OIL CONSERVATION COMM.  
Santa Fe

TELEPHONE 325-8203

July 27, 1977

~~NSP-1059~~

1040 II NWU-572

Due Sept 1

Mr. J. D. Ramey, Secretary-Director  
New Mexico Oil Conservation Commission  
P. O. Box 2088  
Santa Fe, New Mexico 87501

Ref: Non-Standard Proration Unit  
Cotton Petroleum Corp.  
Apache No. 20  
Unit B-Sec. 4-T24N-R4W N.M.P.M.  
South Blanco Pictured Cliffs  
Rio Arriba County, New Mexico  
Jicarilla Contract No. 127

Dear Mr. Ramey:

This request for administrative approval of a non-standard proration unit for the above-referred-to well is being presented on behalf of the operator, Manning Gas and Oil Company. This request is being presented in accordance with the procedure set forth in Rule No. 101.

The subject well is located 1075' from the North Line, 1450' from the East line of Section 4-T24N-R4W, Rio Arriba County, New Mexico. See attached Well Location and Acreage Dedication Plat.

Due to the configuration of Section 4 and the location of the subject well, it would be impossible to establish a 160-acre proration unit without having to exclude a portion of the Northeast Quarter of the section which is a legal subdivision.

Therefore, it is requested that the 225.54 acres included in the Northeast portion of Section 4-T24N-R4W be approved as a non-Standard Proration Unit for the above-referred-to well.

Copies of this request are being sent to the offset operators of Pictured Cliffs wells, as indicated on attached map, by Certified Mail.

Mr. J. D. Ramey

July 27, 1977

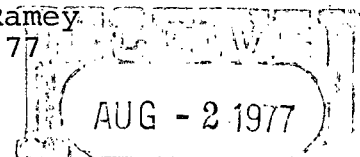

Thank you for your cooperation and consideration in this matter. OIL CONSERVATION COMM.  
7/27/77

Very truly yours,

A handwritten signature in dark ink, appearing to read "Ewell N. Walsh". The signature is fluid and cursive.

Ewell N. Walsh, P. E.  
President

ENW/ea

Enclosure

cc: Cotton Petroleum Corporation w/encl.

Mr. John Ahlm, El Paso Natural Gas Co. w/encl.

Mr. Ray Nordhausen, Northwest Production w/encl.

USGS, Durango, Colorado w/encl.

NMOCC, Aztec, N.M. w/encl.

PETROLEUM ENGINEERING  
RESERVOIR STUDIES  
EVALUATIONS  
GEOLOGICAL STUDIES

EWELL N. WALSH, P.E.  
*President*

**WALSH**  
**ENGINEERING & PRODUCTION**  
**CORPORATION**  
EXECUTIVE BLDG. - 413 W. MAIN  
P. O. BOX 254  
FARMINGTON, NEW MEXICO  
87401

LEASE MANAGEMENT  
CONTRACT PUMPING  
DRILLING SUPERVISION  
WORKOVER SUPERVISION

TELEPHONE 325-8203

July 27, 1977

CERTIFIED  
RETURN RECEIPT REQUESTED

Mr. Ray Nordhausen  
Northwest Production Corporation  
P. O. Box 1796  
El Paso, Texas 79949

Ref: Non-Standard Proration Unit  
Cotton Petroleum Corp.  
Apache No. 20  
Unit B-Sec. 4-T24N-R4W N.M.P.M.  
South Blanco Pictured Cliffs Pool  
Rio Arriba County, New Mexico

Dear Mr. Nordhausen:

Attached you will find a copy of the request to the New Mexico Oil Conservation Commission for administrative approval for a Non-Standard Proration Unit for the above-referred-to well.

Without your acknowledgment to the New Mexico Oil Conservation Commission, Santa Fe, New Mexico, of your approval of the request, the Commission is required to wait 20 days before approving the request.

Your earliest possible approval of the request, to the Commission, would be greatly appreciated.

Very truly yours,

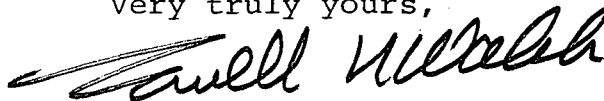

Ewell N. Walsh, P. E.  
President

ENW:ea

Enclosure

cc: Cotton Petroleum Corp., wo/encl.

Mr. J. D. Ramey, NMOCC, Santa Fe, N.M., wo/encl. —

OIL CONSERVATION COMMISSION  
Alto DISTRICT

OIL CONSERVATION COMMISSION  
BOX 2088  
SANTA FE, NEW MEXICO

*Jim Kapteina*

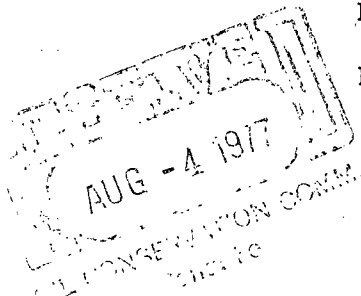

DATE August 2, 1977

RE: Proposed MC \_\_\_\_\_  
Proposed DHC \_\_\_\_\_  
Proposed NSL \_\_\_\_\_  
Proposed SWD \_\_\_\_\_  
Proposed WFX \_\_\_\_\_  
Proposed PMX \_\_\_\_\_

*HWA* ☒

Gentlemen:

I have examined the application dated 7-27-77  
for the Cotton Petroleum Corp. Apache #20 B-4-24N-4W  
Operator Lease and Well No. Unit, S-T-R

and my recommendations are as follows:

Approve  
\_\_\_\_\_  
\_\_\_\_\_  
\_\_\_\_\_  
\_\_\_\_\_  
\_\_\_\_\_

Yours very truly,

*AR Hendrick*

**NEW MEXICO OIL CONSERVATION COMMISSION  
WELL LOCATION AND ACREAGE DEDICATION PLAT**

AUG - 2 1977

Form C-102  
Supersedes C-128  
Effective 1-4-65

All distances must be from the outer boundaries of the Section.

Operator <b>Cotton Petroleum Corporation</b>			Lease <b>Apache</b>		Well No. <b>20</b>
Unit Letter <b>B</b>	Section <b>4</b>	Township <b>24N</b>	Range <b>4W</b>	County <b>Rio Arriba</b>	
Actual Footage Location of Wells <b>1075'</b> feet from the <b>North</b> line and <b>1150'</b> feet from the <b>East</b> line					
Ground Level Elev: <b>6919</b>	Producing Formation <b>Pictured Cliffs</b>	Pool <b>South Blanco-Pictured Cliffs</b>		Dedicated Acreage: <b>225.54</b>	Acres

1. Outline the acreage dedicated to the subject well by colored pencil or hachure marks on the plat below.
2. If more than one lease is dedicated to the well, outline each and identify the ownership thereof (both as to working interest and royalty).
3. If more than one lease of different ownership is dedicated to the well, have the interests of all owners been consolidated by communitization, unitization, force-pooling, etc?

☐ Yes - ☐ No If answer is "yes," type of consolidation \_\_\_\_\_

If answer is "no," list the owners and tract descriptions which have actually been consolidated. (Use reverse side of this form if necessary.) \_\_\_\_\_

No allowable will be assigned to the well until all interests have been consolidated (by communitization, unitization, forced-pooling, or otherwise) or until a non-standard unit, eliminating such interests, has been approved by the Commission.

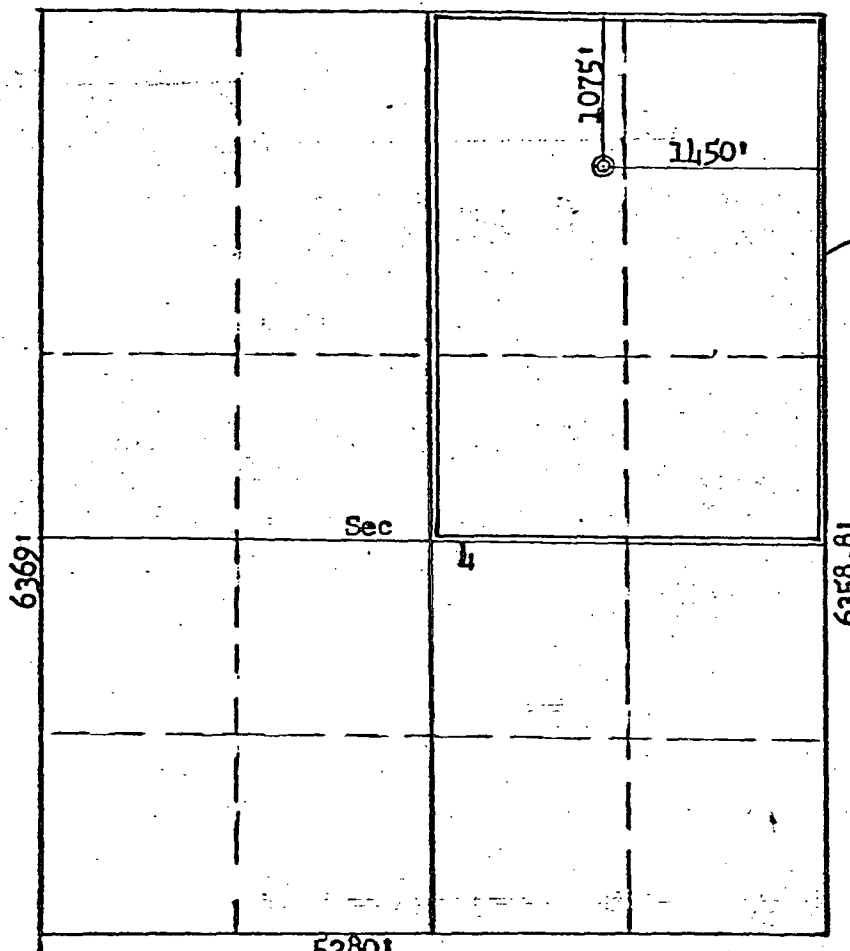

SCALE: 4 inches = 1 mile

**CERTIFICATION**

I hereby certify that the information contained herein is true and complete to the best of my knowledge and belief.

For: Cotton Petr. Corp.

Name \_\_\_\_\_  
Position **Ewell N. Walsh, P.E.**  
**President**

Company **Walsh Engineering & Production Corporation**

Date **June 17, 1977**

I hereby certify that the well location shown on this plat was plotted from field notes of actual surveys made by me or under my supervision, and that the same is true and correct to the best of my knowledge and belief.

Date Surveyed **June 13, 1977**  
Registered Professional Engineer and Land Surveyor

**Fred B. Kerr, Jr.**

Certificate No. **3950**



R-4-W

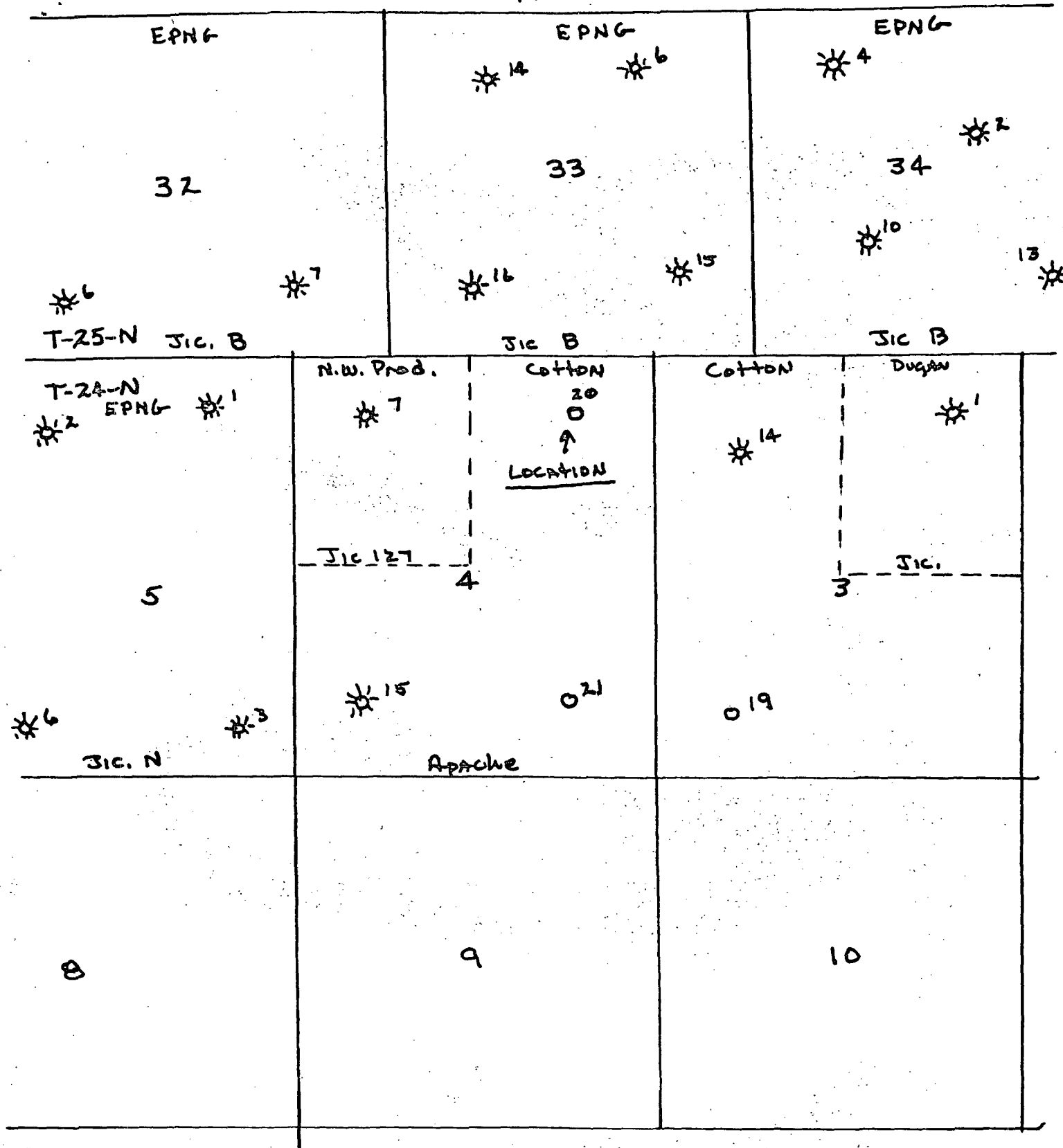

COTTON PETROLEUM CORPORATION  
 APACHE NO. 20  
 1075' FNL, 1450' FEL, Sec. 4-T24N-R4W  
 Rio Arriba County, New Mexico