

EXXON COMPANY, U.S.A.

POST OFFICE BOX 1600 • MIDLAND, TEXAS 79702

February 6, 1978

PRODUCTION DEPARTMENT
MIDCONTINENT DIVISION

L. H. BYRD
MANAGER

Non-Standard Proration Unit
Cotton Petroleum Corporation
Apache No. 106
Unit A, Sec. 1-T24N-R4W, N.M.P.M.
Lindrith Gallup-Dakota, West
Oil Pool
Rio Arriba County, New Mexico

FEB - 9 1978
CONSERVATION
SECTION

Walsh Engineering & Production Corp.
P. O. Box 254
Farmington, New Mexico 87401

Attention: Mr. Ewell N. Walsh

Gentlemen:

Exxon has an overriding royalty interest in the offset acreage to the Cotton Petroleum Corporation's Apache No. 106 to be located in Section 1-T24N-R4W, N.M.P.M., Rio Arriba County, New Mexico. We have no objection to the proposed 220.47 acre non-standard proration unit for this well. A copy of this letter is being furnished to the New Mexico Oil Conservation Commission as requested by your letter of January 19, 1978 to our Denver office.

Yours very truly,

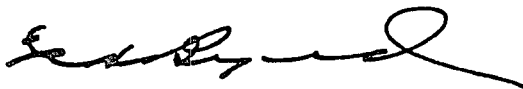
L. H. Byrd

HNR/fm

cc: New Mexico Oil Conservation Commission

OIL CONSERVATION COMMISSION
Apache DISTRICT

JAN 31 1978

OIL CONSERVATION COMMISSION
BOX 2088
SANTA FE, NEW MEXICO

DATE 1-27-78

RE: Proposed MC _____
Proposed DHC _____
Proposed NSL _____
Proposed SWD _____
Proposed WFX _____
Proposed PMX _____

NWU ☒

R. L. Stamets

Gentlemen:

I have examined the application dated 1-19-78
for the Cotton Petroleum Corp. Apache #106 A-1-24N-4W
Operator Lease and Well No. Unit, S-T-R

and my recommendations are as follows:

Approve

Yours very truly,

AR Kendrick



Southland Royalty Company

January 25, 1978

New Mexico Oil Conservation Commission
P. O. Box 2088
Santa Fe, New Mexico 87501

Attention: Mr. J. D. Ramey

Re: Non-Standard Proration Unit
Cotton Petroleum Corporation Well
Apache No. 106
Unit A Section 1, T24N, R4W
West Lindrith Gallup-Dakota Oil Pool
Rio Arriba County, New Mexico

Dear Mr. Ramey:

As an offset operator to the subject well and proration unit, we do not object to the non-standard proration unit which is proposed.

Yours truly,

L. O. Van Ryan
District Production Manager

LOVR/dg

CC: Walsh Engineering & Production
Farmington, New Mexico

BROOKS HALL OIL CORPORATION

101 PARK AVENUE BUILDING
OKLAHOMA CITY, OKLAHOMA 73102

D. M. FANKHOUSER
VICE-PRESIDENT
LAND DEPARTMENT

PHONE AREA CODE (405) 235-1471

January 23, 1978

Mr. J. D. Ramey, Secretary Director
New Mexico Oil Conservation Commission
P. O. Box 2088
Santa Fe, New Mexico 87501

Re: Non-Standard Proration Unit
Cotton Petroleum Corporation
Apache No. 106
Unit A, Sec. 1-T24N-R4W, N.M.P.M.
Lindrith Gallup-Dakota, West
Oil Pool
Rio Arriba County, New Mexico
Jicarilla Contract No. 126

Dear Mr. Ramey:

Please refer to Walsh Engineering & Production Corp.'s letter of January 19, 1978, to you requesting a Non-Standard Proration Unit in the NE/4 of Section 1-24N-4W. We wish to advise that this company has no objections to such a unit.

Yours truly,

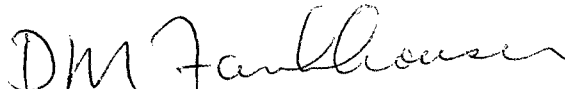
D. M. Fankhouser

DMF:1s

cc: Walsh Engineering & Production Corp.
P. O. Box 254
Farmington, New Mexico 87401

Walsh

ENGINEERING & PRODUCTION CORP.

PETROLEUM ENGINEERING
RESERVOIR STUDIES
EVALUATIONS
GEOLOGICAL STUDIES
LEASE MANAGEMENT
CONTRACT PUMPING
DRILLING SUPERVISION
WORKOVER SUPERVISION

January 19, 1978

EWELL N. WALSH, P.E.
President

Mr. J. D. Ramey, Secretary Director
New Mexico Oil Conservation Commission
P. O. Box 2088
Santa Fe, New Mexico 87501

Ref: Non-Standard Proration Unit
Cotton Petroleum Corporation
Apache No. 106
Unit A, Sec. 1-T24N-R4W, N.M.P.M.
Lindrieth Gallup-Dakota, West
Oil Pool
Rio Arriba County, New Mexico
Jicarilla Contract No. 126

Dear Mr. Ramey:

This request for administrative approval of a non-standard proration unit for the above-referred-to well is being presented on behalf of the operator, Cotton Petroleum Corporation. This request is being presented in accordance with the procedure set forth in Order R-4314.

The subject well is located 2040' from the North Line, 945' from the East Line of Section 1-T24N-R4W, Rio Arriba County, New Mexico. See attached Well Location and Acreage Dedication plat.

Due to the configuration of Section 1 and the location of the subject well it would be impossible to establish a 160-acre proration unit without having to exclude a portion of the Northeast Quarter of the section which is a legal subdivision.

Therefore, it is requested that the 220.47 acres included in the Northeast portion of Section 1-T24N-R4W be approved as a non-Standard Proration Unit for the above-referred-to well.

Copies of this request are being sent to the offset operators of Gallup-Dakota wells, as indicated on attached map, by Certified Mail.

1/
Re: Mr. J. D. Ramey
January 19, 1978
Cotton Petroleum Corporation
Apache No. 106

Thank you for your cooperation and consideration in this matter.

Very truly yours,



Ewell N. Walsh, P.E.
President

ENW:rr

cc: Cotton Petroleum Corporation/w-encl.
USGS, Durango, Colorado/w-encl.
NMOCC, Axtec, N.M./w-encl.
Mr. A.A. Phillips, Exxon Company, U.S.A./w-encl.
Mr. Larry Van Ryan, Aztec Oil & Gas Co., Farmington, N.M./w-encl.
J. Felix Hickman/w-encl.
Brooks Hall Oil Corporation/w-encl.
Mr. J. Jones, Getty Oil Company/w-encl.

Encl.

Walsh

ENGINEERING & PRODUCTION CORP.

PETROLEUM ENGINEERING
RESERVOIR STUDIES
EVALUATIONS
GEOLOGICAL STUDIES
LEASE MANAGEMENT
CONTRACT PUMPING
DRILLING SUPERVISION
WORKOVER SUPERVISION

January 19, 1978

EWELL N. WALSH, P.E.
President

CERTIFIED

RETURN RECEIPT REQUESTED

Mr. J. Felix Hickman
313 Washington S.E.
Albuquerque, New Mexico 87108

Ref: Non-Standard Proration Unit
Cotton Petroleum Corporation
Apache No. 106
Unit A, Sec. 1-T24N-R4W, N.M.P.M.
Lindrith Gallup-Dakota West
Oil Pool
Rio Arriba County, New Mexico

Dear Mr. Hickman:

Attached you will find a copy of the request to the New Mexico Oil Conservation Commission for administrative approval for a Non-Standard Proration Unit for the above-referred-to well.

Without your acknowledgement to the New Mexico Oil Conservation Commission, Santa Fe, New Mexico, of your approval of the request, the Commission is required to wait 20 days before approving the request.

Your earliest possible approval of the request, to the Commission would be greatly appreciated.

Very truly yours,

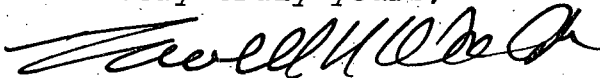

Ewell N. Walsh, P.E.
President

ENW:rr

Enclosure

cc: Cotton Petroleum Corporation w/encl.

Mr. J.D. Ramey, NMOCC, Santa Fe, N.M. w/encl.

Walsh

ENGINEERING & PRODUCTION CORP.

January 19, 1978

EWELL N. WALSH, P.E.
President

PETROLEUM ENGINEERING
RESERVOIR STUDIES
EVALUATIONS
GEOLOGICAL STUDIES
LEASE MANAGEMENT
CONTRACT PUMPING
DRILLING SUPERVISION
WORKOVER SUPERVISION

CERTIFIED
RETURN RECEIPT REQUESTED

Mr. M. J. Jones
District Exploration Manager
P. O. Box 66729
Houston, Texas 77006

Ref: Non-Standard Proration Unit
Cotton Petroleum Corporation
Apache No. 106
Unit A, Sec. 1-T24N-R-4W, N.M.P.M.
Lindrith Gallup-Dakota, West Oil Pool
Rio Arriba County, New Mexico

Dear Mr. Jones:

Attached you will find a copy of the request to the New Mexico Oil Conservation Commission for administrative approval for a Non-Standard Proration Unit for the above-referred-to well.

Without your acknowledgement to the New Mexico Oil Conservation Commission, Santa Fe, New Mexico, of your approval of the request, the Commission is required to wait 20 days before approving the request.

Your earliest possible approval of the request, to the Commission, would be greatly appreciated.

Very truly yours,

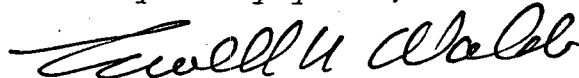

Ewell N. Walsh, P.E.
President

ENW:rr

Enclosures

cc: Cotton Petroleum Corporation w/encl.

Mr. J.D. Ramey, NMOCC, Santa Fe, N.M. w/encl.

Walsh

ENGINEERING & PRODUCTION CORP.

January 19, 1978

PETROLEUM ENGINEERING
RESERVOIR STUDIES
EVALUATIONS
GEOLOGICAL STUDIES
LEASE MANAGEMENT
CONTRACT PUMPING
DRILLING SUPERVISION
WORKOVER SUPERVISION

EWELL N. WALSH, P.E.
President

CERTIFIED
RETURN RECEIPT REQUESTED

Mr. Larry Van Ryan
District Production Manager
Aztec Oil & Gas Company
Drawer 570
Farmington, New Mexico 87401

Ref: Non-Standard Proration Unit
Cotton Petroleum Corporation
Apache No. 106
Unit A- Sec. 1-T24N-R4W, N.M.P.M.
Lindrith Gallup-Dakota, West
Oil Pool
Rio Arriba County, New Mexico

Dear Mr. Van Ryan:

Attached you will find a copy of the request to the New Mexico Oil Conservation Commission for administrative approval for a Non-Standard Proration Unit for the above-referred-to well.

Without your acknowledgement to the New Mexico Oil Conservation Commission, Santa Fe, New Mexico, of your approval of the request, the Commission is required to wait 20 days before approving the request.

Your earliest possible approval of the request, to the Commission, would be greatly appreciated.

Very truly yours,



Ewell N. Walsh, P.E.
President

ENW:rr

Enclosure

cc: Cotton Petroleum Corporation w/encl.

Mr. J.D. Ramey, NMOCC, Santa Fe, N.M. w/encl.

Walsh

ENGINEERING & PRODUCTION CORP.

January 19, 1978

EWELL N. WALSH, P.E.
President

PETROLEUM ENGINEERING
RESERVOIR STUDIES
EVALUATIONS
GEOLOGICAL STUDIES
LEASE MANAGEMENT
CONTRACT PUMPING
DRILLING SUPERVISION
WORKOVER SUPERVISION

CERTIFIED
RETURN RECEIPT REQUESTED

Mr. A. A. Phillips
Division Exploration Manager
Exon Company, U.S.A.
P. O. Box 120
Denver, Colorado 80201

Ref: Non-Standard Proration Unit
Cotton Petroleum Corporation
Apache No. 106
Unit A, Sec. 1-T24N-R4W, N.M.P.M.
Lindrith Gallup-Dakota, West
Oil Pool
Rio Arriba County, New Mexico

Dear Mr. Phillips:

Attached you will find a copy of the request to the New Mexico Oil Conservation Commission for administrative approval for a Non-Standard Proration Unit for the above-referred-to well.

Without your acknowledgement to the New Mexico Oil Conservation Commission, Santa Fe, New Mexico, of your approval of the request, the Commission is required to wait 20 days before approving the request.

Your earliest possible approval of the request, to the Commission, would be greatly appreciated.

Very truly yours,

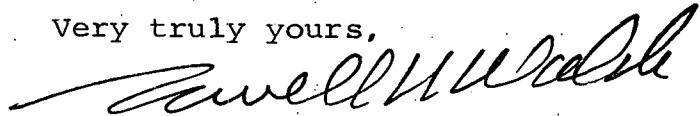

Ewell N. Walsh, P.E.
President

ENW:rr

Enclosures

cc: Cotton Petroleum Corporation w/encl.

Mr. J.D. Ramey, NMOCC, Santa Fe, N.M. w/encl.

Walsh

ENGINEERING & PRODUCTION CORP.

January 19, 1978

PETROLEUM ENGINEERING
RESERVOIR STUDIES
EVALUATIONS
GEOLOGICAL STUDIES
LEASE MANAGEMENT
CONTRACT PUMPING
DRILLING SUPERVISION
WORKOVER SUPERVISION

EWELL N. WALSH, P.E.
President

CERTIFIED
RETURN RECEIPT REQUESTED

Brooks Hall Oil Corporation
101 Park Avenue
Oklahoma City, Oklahoma 73100

Ref: Non-Standard Proration Unit
Cotton Petroleum Corporation
Apache No. 106
Unit A, Sec. 1-T24N-R4W, N.M.P.M.
Lindrith Gallup-Dakota, West
Oil Pool
Rio Arriba County, New Mexico

Dear Sir:

Attached you will find a copy of the request to the New Mexico Oil Conservation Commission for administrative approval for a Non-Standard Proration Unit for the above-referred-to well.

Without your acknowledgement to the New Mexico Oil Conservation Commission, Santa Fe, New Mexico, of your approval of the request, the Commission is required to wait 20 days before approving the request.

Your earliest possible approval of the request, to the Commission, would be greatly appreciated.

Very truly yours,

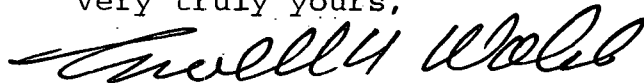

Ewell N. Walsh, P.E.
President

ENW:rr

Enclosures

cc: Cotton Petroleum Corporation w/encl.

Mr. J.D. Ramey, N.M.O.C.C., Santa Fe, N.M. w/encl.

NEW MEXICO OIL CONSERVATION COMMISSION
WELL LOCATION AND ACREAGE DEDICATION PLAT

Form C-102
 Supersedes C-128
 Effective 1-4-65

All distances must be from the outer boundaries of the Section.

Operator Cotton Petroleum Corporation			Lease Apache		Well No. 106
Unit Letter A	Section 1	Township 24N	Range 4W	County Rio Arriba	
Actual Footage Location of Well 2040 feet from the North line and 945 feet from the East line					
Ground Level Elev: 7008	Producing Formation Gallup-Dakota		Pool Lindrith Gallup-Dakota West		Dedicated Acreage 220.47 Acres

1. Outline the acreage dedicated to the subject well by colored pencil or hachure marks on the plat below.
2. If more than one lease is dedicated to the well, outline each and identify the ownership thereof (both as to working interest and royalty).
3. If more than one lease of different ownership is dedicated to the well, have the interests of all owners been consolidated by communitization, unitization, force-pooling, etc?

☐ Yes ☐ No If answer is "yes" type of consolidation _____

If answer is "no," list the owners and tract descriptions which have actually been consolidated. (Use reverse side of this form if necessary.) _____

No allowable will be assigned to the well until all interests have been consolidated (by communitization, unitization, forced-pooling, or otherwise) or until a non-standard unit, eliminating such interests, has been approved by the Commission.

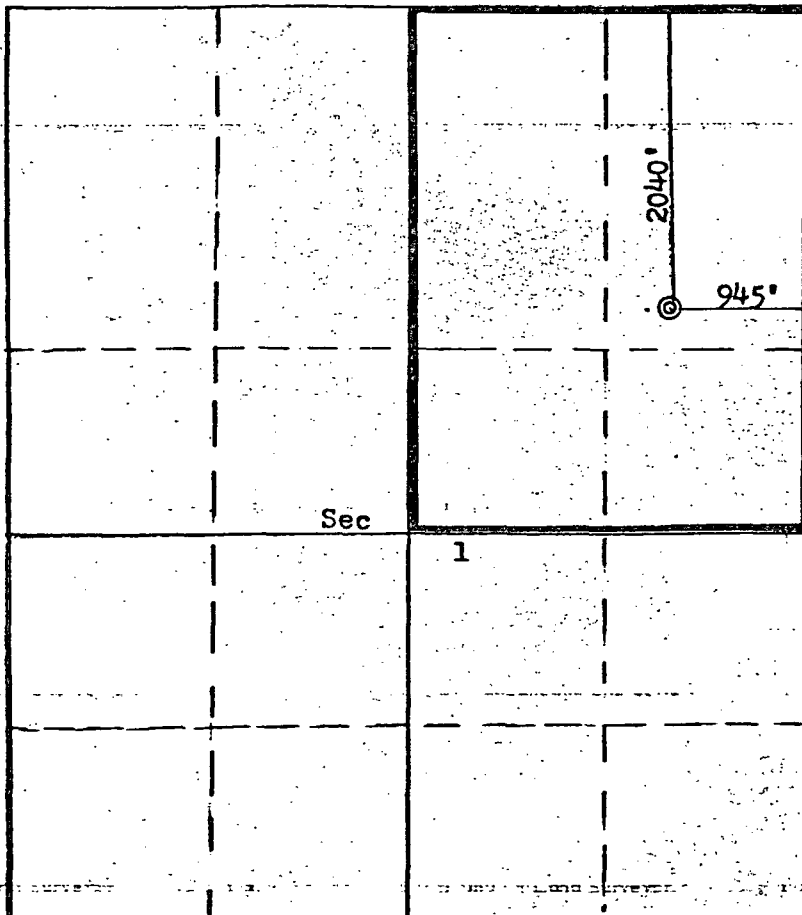

CERTIFICATION

I hereby certify that the information contained herein is true and complete to the best of my knowledge and belief.

Ewell N. Walsh

Name
Ewell N. Walsh, P.E.
 Position
President
 Company
Walsh Engr. & Prod. Corp.
 Date
11-4-77

I hereby certify that the well location shown on this plat was plotted from field notes of actual surveys made by me or under my supervision, and that the same is true and correct to the best of my knowledge and belief.

Date Surveyed
October 22, 1977
 Registered Professional Engineer and Land Surveyor
Fred B. Kerr
Fred B. Kerr
 Certificate No.
3950

SCALE: 1"=1320'

R4W

R3W

CONOCO

GETTY OIL COMPANY
✓

35

AMOCO

36

EXON ✓

AZTEC
O & G ✓

31

T25N

T24N

COTTON PETROLEUM CORP. ✓

COTTON PETROLEUM CORP. ✓

J. FELIX
HICKMAN ✓

2

NWP

1

BROOKS HALL ✓

● 106
APACHE

6

COTTON PETROLEUM CORP.

COTTON PETROLEUM CORP.

J. FELIX
HICKMAN

11

12

7

COTTON PETROLEUM CORPORATION

APACHE NO. 106

2040' FNL, 945' FEL, Sec. 1-T24N-R4W

Rio Arriba County New Mexico

Walsh

ENGINEERING & PRODUCTION CORP.