

County Eddy

Pool West Indian Basin - Morrow Gas

TOWNSHIP 21 South

Range 22 East

NMPM

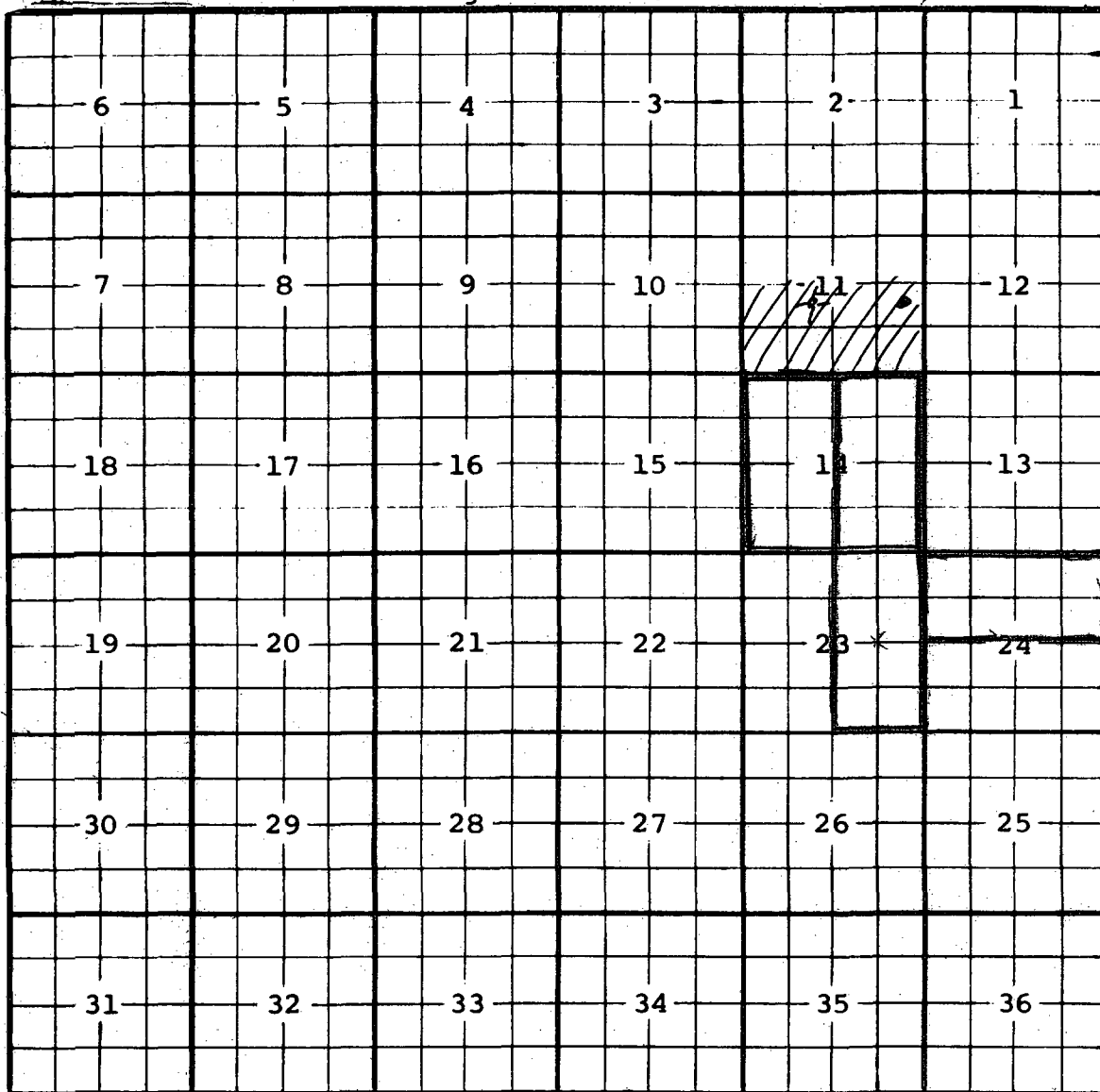

Description: $\frac{E}{2}$ Sec 14 (R-5609, 1-1-78)

Ext: $\frac{E}{2}$ Sec 23 (R-5987, 4-1-79) Ext: $\frac{W}{2}$ Sec 14 (R-6170, 11-1-79)

Ext: $\frac{N}{2}$ Sec 24 (R-6476-10-1-80)

79020

UNITED STATES
DEPARTMENT OF THE INTERIOR
GEOLOGICAL SURVEYO. C. D.
ARTESIA, OFFICE

30-015-23362

APPLICATION FOR PERMIT TO DRILL, DEEPEN, OR PLUG BACK

1a. TYPE OF WORK

DRILL ☒DEEPEN ☐PLUG BACK ☐

b. TYPE OF WELL

OIL
WELL ☐GAS
WELL ☒OTHER ☐SINGLE
ZONE ☐MULTIPLE
ZONE ☐

2. NAME OF OPERATOR

Yates Petroleum Corporation ✓

3. ADDRESS OF OPERATOR

207 South 4th Street, Artesia, New Mexico 88210

4. LOCATION OF WELL (Report location clearly and in accordance with any State requirements.)
At surface1980 FSL and 2030 FWL
At proposed prod. zone

14. DISTANCE IN MILES AND DIRECTION FROM NEAREST TOWN OR POST OFFICE*

27 miles west of Carlsbad

15. DISTANCE FROM PROPOSED*

LOCATION TO NEAREST
PROPERTY OR LEASE LINE, FT.
(Also to nearest drlg. unit line, if any)

1980'

18. DISTANCE FROM PROPOSED LOCATION*

TO NEAREST WELL, DRILLING, COMPLETED,
OR APPLIED FOR, ON THIS LEASE, FT.

16. NO. OF ACRES IN LEASE

640

17. NO. OF ACRES ASSIGNED
TO THIS WELL

320

19. PROPOSED DEPTH

approx. 9300'

20. ROTARY OR CABLE TOOLS

Rotary

21. ELEVATIONS (Show whether DF, RT, GR, etc.)

4164.0 GL

22. APPROX. DATE WORK WILL START*

ASAP

23.

PROPOSED CASING AND CEMENTING PROGRAM

SIZE OF HOLE	SIZE OF CASING	WEIGHT PER FOOT	SETTING DEPTH	QUANTITY OF CEMENT
17½"	13 3/8"	42# J-55	335'	300 sx circulate
12½"	8 9/16"	24 3/4# J-55	1126'	500 sx circulate
7 7/8"	5½ or 4½"	17 & 15.5# or 10.5 - 11.6#	9300'	390 sx

We propose to drill and test the Mississippian Lime and intermediate formations. Approximately 335' of surface casing and 1126' of intermediate casing will be set and cemented to the surface. If commercial pay is encountered, will run 5½ or 4½" casing, cement with a minimum of 600' cover, perforate and stimulate as needed for production.

MUD PROGRAM: FW gel & LCM to 1126'; fresh water to 7500' (with KCL added at 4100', flosal & drispak as needed), flosal-drispak-KCL to TD; MW 8.6-9.0, Vis 33-55, WL 14-7, FC 1/32, oil 2-4% diesel.

BOP PROGRAM: BOP's on 8 9/16" casing, tested daily. Will Yellow Jacket prior to drilling Wolfcamp.

GAS NOT DEDICATED.

IN ABOVE SPACE DESCRIBE PROPOSED PROGRAM: If proposal is to deepen or plug back, give data on present productive zone and proposed new productive zone. If proposal is to drill or deepen directionally, give pertinent data on subsurface locations and measured and true vertical depths. Give blowout preventer program, if any.

24.

SIGNED

John A. Lopez

TITLE Regulatory Coordinator

DATE May 21, 1980

(This space for Federal or State office use)

PERMIT NO.

APPROVAL DATE

June 9, 1980

APPROVED BY

TITLE

DATE

CONDITIONS OF APPROVAL, IF ANY:

NE' EXICO OIL CONSERVATION COMMISSION
WELL LOCATION AND ACREAGE DEDICATION PLAT

Form C-102
Supersedes C-128
Effective 1-1-65

All distances must be from the outer boundaries of the Section.

Operator YATES PETROLEUM CORPORATION			Lease Searle ML Federal		Well No. 1
Unit Letter K	Section 11	Township 21 South	Range 22 East	County Eddy	
Actual Footage Location of Well:					
1980 feet from the South line and		2030 feet from the West line			
Ground Level Elev. 4164.0	Producing Formation Morrow	Pool UNDES. MORROW	Dedicated Acreage: 320 Acres		

1. Outline the acreage dedicated to the subject well by colored pencil or hachure marks on the plat below.
2. If more than one lease is dedicated to the well, outline each and identify the ownership thereof (both as to working interest and royalty).
3. If more than one lease of different ownership is dedicated to the well, have the interests of all owners been consolidated by communitization, unitization, force-pooling, etc?

☐ Yes ☒ No If answer is "yes," type of consolidation _____

If answer is "no," list the owners and tract descriptions which have actually been consolidated. (Use reverse side of this form if necessary.) _____

No allowable will be assigned to the well until all interests have been consolidated (by communitization, unitization, forced-pooling, or otherwise) or until a non-standard unit, eliminating such interests, has been approved by the Commission.

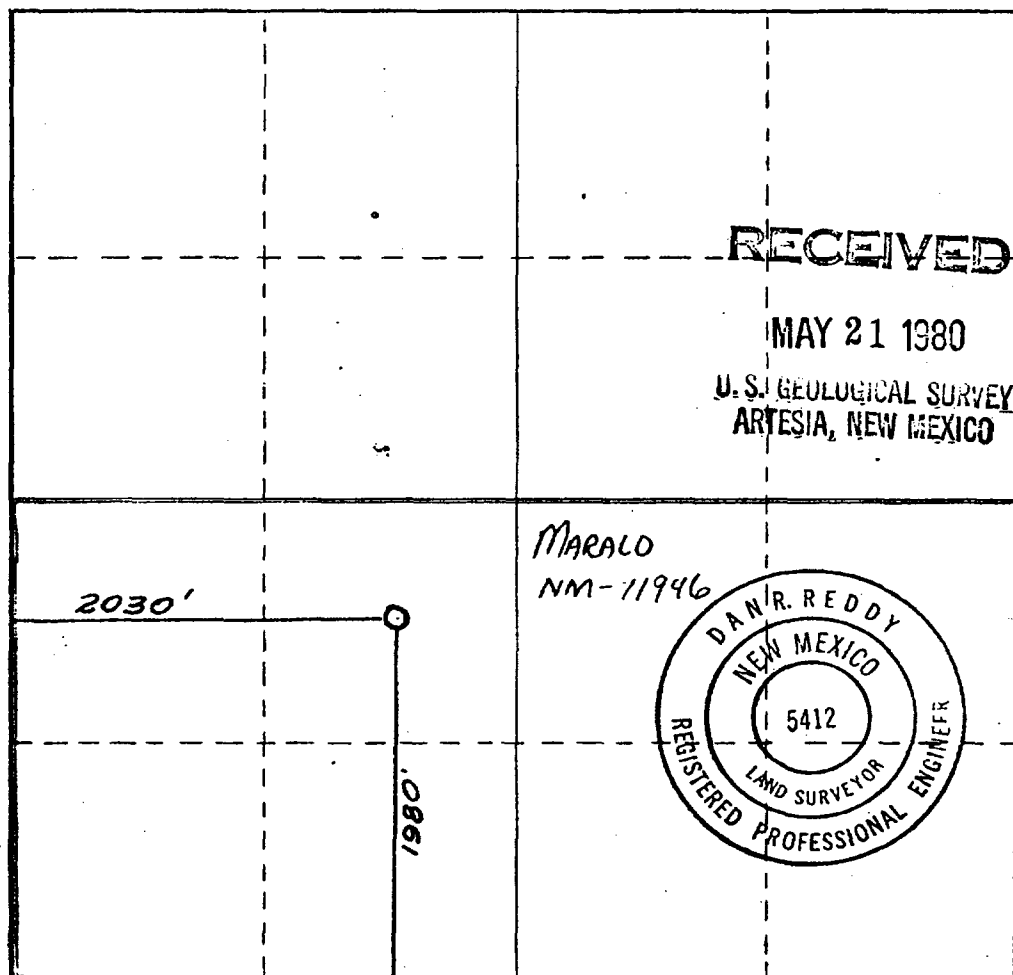

CERTIFICATION

I hereby certify that the information contained herein is true and complete to the best of my knowledge and belief.

Johnny A. Lopez
Name
JOHNNY A. LOPEZ
Position
REGULATORY COORDINATOR
Company
YATES PETROLEUM CORP.
Date
5/21/80

I hereby certify that the well location shown on this plat was plotted from field notes of actual surveys made by me or under my supervision, and that the same is true and correct to the best of my knowledge and belief.

Date Surveyed
May 8, 1980
Registered Professional Engineer and/or Land Surveyor

Dan R. Reddy
Certificate No.
NM PE&LS #5412

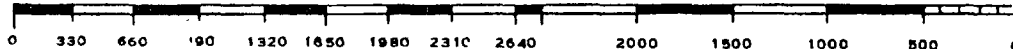



EXHIBIT A

YATES PETROLEUM CORPORATION

SEARLE ML FED. #1

SEC. 11 T21S R22E

1980' FSL - 2030' FWL

EDDY COUNTY, NM

N.M.O.C.D. COPY

UNITED STATES
DEPARTMENT OF THE INTERIOR
GEOLOGICAL SURVEYSUBMIT IN TRIPLICATE*
(Other instructions on re-
verse side)Form approved.
Budget Bureau No. 42-R1424.5. LEASE DESIGNATION AND SERIAL NO.
NM-11946

6. IF INDIAN, ALLOTTEE OR TRIBE NAME

7. UNIT AGREEMENT NAME

8. FARM OR LEASE NAME

Searle ML Federal

9. WELL NO.

1

10. FIELD AND POOL, OR WILDCAT
Und Morrow11. SEC., T., R., M., OR BLK. AND
SURVEY OR AREASec. 11-21S-22E
Unit K NMPM

12. COUNTY OR PARISH

Eddy

13. STATE

NM

SUNDRY NOTICES AND REPORTS ON WELLS

(Do not use this form for proposals to drill or to deepen or plug back to a different reservoir.
Use "APPLICATION FOR PERMIT—" for such proposals.)1. OIL WELL ☐ GAS WELL ☒ OTHER

2. NAME OF OPERATOR

Yates Petroleum Corporation

3. ADDRESS OF OPERATOR

207 South 4th Street - Artesia, NM 88210

4. LOCATION OF WELL (Report location clearly and in accordance with any State requirements.
See also space 17 below.)
At surface

1980' FSL and 2030' FWL of Section 11-21S-22E

14. PERMIT NO.

15. ELEVATIONS (Show whether DF, RT, GR, etc.)

4164' GR

O. C. D.
ARTESIA, OFFICE

16. Check Appropriate Box To Indicate Nature of Notice, Report, or Other Data

NOTICE OF INTENTION TO:

TEST WATER SHUT-OFF

FRACTURE TREAT

SHOOT OR ACIDIZE

REPAIR WELL

(Other)

PULL OR ALTER CASING

MULTIPLE COMPLETE

ABANDON*

CHANGE PLANS

SUBSEQUENT REPORT OF:

WATER SHUT-OFF

FRACTURE TREATMENT

SHOOTING OR ACIDIZING

(Other)

REPAIRING WELL

ALTERING CASING

ABANDONMENT*

(NOTE: Report results of multiple completion on Well
Completion or Recompletion Report and Log form.)17. DESCRIBE PROPOSED OR COMPLETED OPERATIONS (Clearly state all pertinent details, and give pertinent dates, including estimated date of starting any
proposed work. If well is directionally drilled, give subsurface locations and measured and true vertical depths for all markers and zones perti-
nent to this work.)*

Spudded a 17½" hole at 1:00 PM 6-30-80.

TD 565'-Ran 16 joints 13-3/8" 48# H-40 ST&C (573') of casing set at 565'.

Cemented w/600 sacks of Class C 2% CaCl. PD 10:30 PM 7-3-80. Slurry weight 14.8; 1.32 cu ft/sack. Compressive Strength at 70 degrees, 1023 psi in 12 hours. Cement did not circulate. Filled hole to surface w/4 yards of REady-Mix. WOC 12 hours, backed off, reduced hole to 12½", drilled plug, tested to 600# OK and resumed drilling.

TD 1240'-Ran 31 joints of 8-5/8" 24# J-55 ST&C (1244') of casing set at 1240'. 1-Guide shoe at 1240' and insert float at 1204'. Cemented w/200 sacks Class C 3% CaCl. 550 sacks 65-35 Poz, 8# Kolite, 1/4# celloflakes, 3% CaCl, tailed in w/150 sacks Class C 2% CaCl. PD 3:00 PM 7-6-80. Cement did not circ. Ran Temperature Survey and found top of cement at 590'. Ran 1" & tagged cement at 590', spotted 100 sacks Class C 4% CaCl. PD 9:30 PM 7-6-80. Pulled 360' of 1" to 230'. Spotted 40 sacks Class C 4% CaCl. PD 10:00 PM 7-6-80. Cement circulated. WOC 18 hours, NU and tested to 1500# OK, reduced hole to 7-7/8", drilled plug and tested to 600# OK and resumed drilling.

18. I hereby certify that the foregoing is true and correct

SIGNED

Christie L. Lomax

TITLE

Geol. Secty.

DATE

7-15-80

(This space for Federal or State office use)

APPROVED BY

CONDITIONS OF APPROVAL, IF ANY:

W. Chester

TITLE

ACTING DISTRICT ENGINEER

DATE

JUL 16 1980

UNITED STATES
DEPARTMENT OF THE INTERIOR
GEOLOGICAL SURVEYSUBMIT IN TRIP DATE*
(Other instructions on reverse side)Form approved.
Budget Bureau No. 42-R1424.

5. LEASE DESIGNATION AND SERIAL NO.

NM 11946

6. IF INDIAN, ALLOTTEE OR TRIBE NAME

7. UNIT AGREEMENT NAME

8. FARM OR LEASE NAME

Searle ML Federal

9. WELL NO.

1

10. FIELD AND POOL, OR WILDCAT

Und, Morrow

11. SEC., T., R., M., OR BLK. AND
SURVEY OR AREAUnit K
Sec. 11-T21S-R22E

12. COUNTY OR PARISH 13. STATE

Eddy

New Mex.

SUNDRY NOTICES AND REPORTS ON WELLS

(Do not use this form for proposals to drill or to deepen or plug back to a different depth.
Use "APPLICATION FOR PERMIT—" for such proposals.)1. OIL WELL ☐ GAS WELL ☐ OTHER ☒ Dry Hole AUG 11 1980

2. NAME OF OPERATOR

Yates Petroleum Corporation

3. ADDRESS OF OPERATOR

O.C.D.
ARTESIA, OFFICE

207 S. 4th St., Artesia, NM 88210

4. LOCATION OF WELL (Report location clearly and in accordance with any State requirements.*
See also space 17 below.)
At surface

1980 FSL & 2030 FWL, Sec. 11, T21S, R22E, NMPM

14. PERMIT NO.

15. ELEVATIONS (Show whether DF, RT, CR, etc.)

4164.0 GL

16. Check Appropriate Box To Indicate Nature of Notice, Report, or Other Data

NOTICE OF INTENTION TO:

TEST WATER SHUT-OFF ☐FRACTURE TREAT ☐SHOOT OR ACIDIZE ☐REPAIR WELL ☐(Other) ☐PULL OR ALTER CASING ☐MULTIPLE COMPLETE ☐ABANDON* ☒CHANGE PLANS ☐

SUBSEQUENT REPORT OF:

WATER SHUT-OFF ☐FRACTURE TREATMENT ☐SHOOTING OR ACIDIZING ☐(Other) ☐REPAIRING WELL ☐ALTERING CASING ☐ABANDONMENT* ☐(NOTE: Report results of multiple completion on Well
Completion or Recompletion Report and Log form.)17. DESCRIBE PROPOSED OR COMPLETED OPERATIONS (Clearly state all pertinent details, and give pertinent dates, including estimated date of starting any
proposed work. If well is directionally drilled, give subsurface locations and measured and true vertical depths for all markers and zones pertinent to this work.)*

T.D. 9330' Propose to plug and abandon as follows:

Plug No. 1	8935-9085'
Plug No. 2	8275-8425'
Plug No. 3	7050-7200'
Plug No. 4	5140-5240'
Plug No. 5	3970-4070'
Plug No. 6	1190-1290'
Plug No. 7	25 sack surface plug

Heavy mud will be used between plugs, regulation abandonment marker will be installed, and surface will be restored in accordance with U.S.G.S. requirements when received. Verbal approval for above plugging procedure obtained from Mr. Jim Gillham 8/4/80.

18. I hereby certify that the foregoing is true and correct

SIGNED

Albert R. Hall

TITLE Engineer

DATE 8/5/80

(This space for Federal or State office use)

APPROVED BY (Orig. Sgd.) PETER W. CHESTER

TITLE ACTING DISTRICT ENGINEER

DATE AUG 7 1980

CONDITIONS OF APPROVAL, IF ANY:

*See Instructions on Reverse Side

N.M.O.C.D. COPY

YATES PETROLEUM CORPORATION
Searle "ML" Federal #1
1980' FSL & 2030' FWL
Section 11-T21S-R22E
Eddy County, New Mexico

DST #1 4040-4222' (Abo): TO 15"; SI 60"; TO 60"; SI 120". Tool opened with weak blow. Died 10 minutes into first flow. Reopened with weak blow. Died 10 minutes into first flow. Reopened with weak blow. Died at end of blow. Recovered: 30' of drilling fluid. Sampler: 400 cc drilling fluid w/small skim of oil. No pressure and no cubic feet of gas. Pressures: HP 1803-1808; IF 96-96; ISIP 120; FFP 96-96; FSIP 191.

DST #2 8680-8770'. Misrun.

DST #3 8730-8780': TO 30"; SI 90"; TO 60"; SI 120". Tool opened w/weak blow. No GTS. No surface pressure. Reopened tool w/good blow. Decreased to weak blow in 1 minute. No GTS. Recovered: 65' drilling fluid. Sampler: 20 psi, 2200 cc drilling fluid, 200 cc formation fluid, no gas. Pressures: HP 4278-4278; IFP 64-64; ISIP 643; FFP 64-64; FSIP 643.

ACCEPTED FOR RECORD

AUG 7 1980

U.S. GEOLOGICAL SURVEY
ROSWELL, NEW MEXICO

UNITED STATES
DEPARTMENT OF THE INTERIOR
GEOLOGICAL SURVEY

SUBMIT IN DUPLICATE

(See instructions on
reverse side)Form approved.
Budget Bureau No. 42-R355.5.

WELL COMPLETION OR RECOMPLETION REPORT AND LOG *

1a. TYPE OF WELL:		OIL WELL <input type="checkbox"/>	GAS WELL <input type="checkbox"/>	DRY <input checked="" type="checkbox"/>	Other <u>RECEIVED</u>		
b. TYPE OF COMPLETION:		NEW WELL <input type="checkbox"/>	WORK OVER <input type="checkbox"/>	DEEP-EN <input type="checkbox"/>	PLUG BACK <input type="checkbox"/>	DIFF. REVR. <input type="checkbox"/>	Other <u>AUG 11 1980</u>
2. NAME OF OPERATOR Yates Petroleum Corporation						O. C. D. ARTESIA, OFFICE	
3. ADDRESS OF OPERATOR 207 So. 4th St., Artesia, NM 88210						1	
4. LOCATION OF WELL (Report location clearly and in accordance with any State requirements)* At surface 1980' FSL & 2030' FWL, Sec. 11-21S-22E. At top prod. interval reported below At total depth						10. FIELD AND POOL, OR WILDCAT Und. Morrow	
11. SEC. T., R., M., OR BLOCK AND SURVEY OR AREA Unit K Sec. 11-21S-22E						12. COUNTY OR PARISH Eddy	
13. STATE N. Mex.						14. PERMIT NO.	
15. DATE SPUDDED 6/30/80						16. DATE T.D. REACHED 8/2/80	
17. DATE COMPL. (Ready to prod.) Dry						18. ELEVATIONS (DF, RBB, RT, OR, ETC.)* 4164 GL	
20. TOTAL DEPTH, MD & TVD 9330'		21. PLUG, BACK T.D., MD & TVD 9330'		22. IF MULTIPLE COMPL., HOW MANY*		23. INTERVALS DRILLED BY X	
24. PRODUCING INTERVAL(S), OF THIS COMPLETION—TOP, BOTTOM, NAME (MD AND TVD)*						25. WAS DIRECTIONAL SURVEY MADE No	
26. TYPE ELECTRIC AND OTHER LOGS RUN						27. WAS WELL CORED No	
28. CASING RECORD (Report all strings set in well)							
CASING SIZE		WEIGHT, LB./FT.		DEPTH SET (MD)		HOLE SIZE	
13-3/8"		48#		565'		17-1/2"	
8-5/8"		24#		1240'		12-1/4"	
29. LINER RECORD							
SIZE		TOP (MD)		BOTTOM (MD)		SACKS CEMENT*	
30. TUBING RECORD							
SIZE		DEPTH SET (MD)		PACKER SET (MD)			
31. PERFORATION RECORD (Interval, size and number)							
32. ACID, SHOT, FRACTURE, CEMENT SQUEEZE, ETC.							
DEPTH INTERVAL (MD)				AMOUNT AND KIND OF MATERIAL USED			
33. AUG 7 1980 PRODUCTION							
DATE FIRST PRODUCTION		PRODUCTION METHOD (Flowing, gas lift, pumping—size and type of pump)				WELL STATUS (Producing or shut-in)	
U.S. GEOLOGICAL SURVEY						Dry	
DATE OF TEST		CHOKE SIZE		PROD'N. FOR TEST PERIOD		OIL—BBL.	
ROSWELL, NEW MEXICO						GAS—MCF.	
						WATER—BBL.	
						GAS-OIL RATIO	
FLOW, TUBING PRESS.		CASING PRESSURE		CALCULATED 24-HOUR RATE		OIL GRAVITY-API (CORR.)	
34. DISPOSITION OF GAS (Sold, used for fuel, vented, etc.)						TEST WITNESSED BY	
35. LIST OF ATTACHMENTS Deviation Survey						POSTED ID 2	
36. I hereby certify that the foregoing and attached information is complete and correct as determined from all available records							
SIGNED		TITLE				DATE	
Albert J. Hall		Engineer				8/5/80	

*(See Instructions and Spaces for Additional Data on Reverse Side)

INSTRUCTIONS

General: This form is designed for submitting a complete and correct well completion report and log on all types of lands and leases to either a Federal agency or a State agency, or both, pursuant to applicable Federal and/or State laws and regulations. Any necessary special instructions concerning the use of this form and the number of copies to be submitted, particularly with regard to local, area, or regional procedures and practices, either are shown below or will be issued by, or may be obtained from, the local Federal and/or State office. See instructions on items 22 and 24, and 33, below regarding separate reports for separate completions.

If not filed prior to the time this summary record is submitted, copies of all currently available logs (drillers, geologists, sample and core analysis, all types electric, etc.), formation and pressure tests, and directional surveys, should be attached hereto, to the extent required by applicable Federal and/or State laws and regulations. All attachments should be listed on this form, see item 35.

Item 4: If there are no applicable State requirements, locations on Federal or Indian land should be described in accordance with Federal requirements. Consult local State or Federal office for specific instructions.

Item 18: Indicate which elevation is used as reference (where not otherwise shown) for depth measurements given in other spaces on this form and in any attachments.

Items 22 and 24: If this well is completed for separate production from more than one interval zone (multiple completion), so state in item 22, and in item 24 show the producing interval, or intervals, top(s), bottom(s) and name(s) (if any) for only the interval reported in item 33. Submit a separate report (page) on this form, adequately identified, for each additional interval to be separately produced, showing the additional data pertinent to such interval.

Item 29: "Seals Cement": Attached supplemental records for this well should show the details of any multiple stage cementing and the location of the cementing tool.

Item 33: Submit a separate completion report on this form for each interval to be separately produced. (See instruction for items 22 and 24 above.)

37. SUMMARY OF POROUS ZONES: SHOW ALL IMPORTANT ZONES OF POROSITY AND CONTENTS THEREOF. CORED INTERVALS; AND ALL DRILL-STEM TESTS, INCLUDING DEPTH INTERVAL TESTED, CUSHION USED, TIME TOOL OPEN, FLOWING AND SHUT-IN PRESSURES, AND RECOVERIES			38. GEOLOGIC MARKERS			
FORMATION	TOP	BOTTOM	DESCRIPTION, CONTENTS, ETC.	NAME	MEAS. DEPTH	TRUE VERT. DEPTH
				San Andres	159	
				Glorieta	1781	
				Abo	4028	
				Wolfcamp Shale	5189	
				Lower Canyon	7128	
				Strawn	7628	
				Atoka	8352	
				Morrow Clastics	8715	
				Austin	9013	
				Mississippi Lime	9196	

RECEIVED BY

OCT 29 1985 SUNDARY NOTICES AND REPORTS ON WELLS

(Do not use this form for proposals to drill or to deepen or plug back to a different reservoir.
Use "APPLICATION FOR PERMIT—" for such proposals.)

ARTESIA, OFFICE

OTHER Dry Hole

2. NAME OF OPERATOR

Yates Petroleum Corporation

3. ADDRESS OF OPERATOR

207 S. 4th St., Artesia, NM 88210

4. LOCATION OF WELL (Report location clearly and in accordance with any State requirements.*
See also space 17 below.)

At surface

1980 FSL & 2030 FWL, Sec. 11, T21S, R22E, NMPM

14. PERMIT NO.

15. ELEVATIONS (Show whether DF, RT, OR, etc.)

4164

5. LEASE DESIGNATION AND SERIAL NO.

NM-11946

6. IF INDIAN, ALLOTTEE OR TRIBE NAME

7. UNIT AGREEMENT NAME

8. FARM OR LEASE NAME

Searle ML Federal

9. WELL NO.

1

10. FIELD AND POOL, OR WELL AT
West Indian Basin
Und. Morrow11. SEC., T., R., M., OR BLE. AND
SURVEY OR AREA

Unit K

Sec. 11-T21S-R22E

12. COUNTY OR PARISH

Eddy

13. STATE

N. Mex.

16.

Check Appropriate Box To Indicate Nature of Notice, Report, or Other Data :

NOTICE OF INTENTION TO :

TEST WATER SHUT-OFF

FRACTURE TREAT

SHOOT OR ACIDIZE

REPAIR WELL

(Other)

PULL OR ALTER CASING

MULTIPLE COMPLETE

ABANDON*

CHANGE PLANS

SUBSEQUENT REPORT OF :

WATER SHUT-OFF

FRACTURE TREATMENT

SHOOTING OR ACIDIZING

(Other)

REPAIRING WELL

ALTERING CASING

ABANDONMENT*

(NOTE: Report results of multiple completion on Well
Completion or Recompletion Report and Log form.)17. DESCRIBE PROPOSED OR COMPLETED OPERATIONS (Clearly state all pertinent details, and give pertinent dates, including estimated date of starting any
proposed work. If well is directionally drilled, give subsurface locations and measured and true vertical depths for all markers and zones pertinent
to this work.)*

Verbal approval was given by Mr. Jim Gillham, U.S.G.S., Roswell, NM, 8/4/80 to plug
well - the well was plugged as follows:

Plug #1: 9085-8935' w/35 sacks Class H cement.
Plug #2: 8425-8275' w/35 sacks Class H cement.
Plug #3: 7200-7050' w/35 sacks Class H cement.
Plug #4: 5240-5140' w/35 sacks Class H cement.
Plug #5: 4070-3970' w/35 sacks Class H cement.
Plug #6: 1290-1190' w/35 sacks Class H cement.
Plug #7: 169-0 (Surface) w/25 sacks Class H cement

Installed regulation abandonment marker. Location will be restored according to
U. S. G. S. requirements when received.

RECEIVED

AUG 12 1980

U.S. GEOLOGICAL SURVEY
ARTESIA, NEW MEXICO

18. I hereby certify that the foregoing is true and correct

SIGNED

TITLE Engineer

DATE 8/11/80

(This space for Federal or State office use)

APPROVED BY

TITLE

DATE 10-28 85

CONDITIONS OF APPROVAL, IF ANY:

*See Instructions on Reverse Side

UNITED STATES
DEPARTMENT OF THE INTERIOR
GEOLOGICAL SURVEYSUBMIT IN TRIPL
(Other instructions on re-
verse side)Form approved.
Budget Bureau No. 43-R1424.

5. LEASE DESIGNATION AND SERIAL NO.

NM-11946

6. IF INDIAN, ALLOTTED OR TRIBE NAME

7. UNIT AGREEMENT NAME

8. FARM OR LEASE NAME

Searle ML Federal

9. WELL NO.

1

10. FIELD AND POOL, OR WILDCAT

Und. Morrow

11. SEC., T., R., M., OR BLK. AND
SURVEY OR AREA

Unit K

Sec. 11-T21S-R22E

12. COUNTY OR PARISH 13. STATE

Eddy

N. Mex.

1. OIL ☐ GAS ☐ OTHER ☒ Dry Hole

RECEIVED

2. NAME OF OPERATOR

Yates Petroleum Corporation ✓

AUG 28 1980

3. ADDRESS OF OPERATOR

207 S. 4th St., Artesia, NM 88210

O. C. D.

4. LOCATION OF WELL (Report location clearly and in accordance with any State requirements.
See also space 17 below.)

At surface

ARTESIA OFFICE

1980 FSL & 2030 FWL, Sec. 11, T21S, R22E, NMPM

14. PERMIT NO.

15. ELEVATIONS (Show whether DP, RT, GR, etc.)

4164

18. Check Appropriate Box To Indicate Nature of Notice, Report, or Other Data

NOTICE OF INTENTION TO:

TEST WATER SHUT-OFF ☐FRACTURE TREAT ☐SHOOT OR ACIDIZE ☐REPAIR WELL ☐(Other) ☐PULL OR ALTER CASING ☐MULTIPLE COMPLETE ☐ABANDON* ☐CHANGE PLANS ☐

SUBSEQUENT REPORT OF:

WATER SHUT-OFF ☐FRACTURE TREATMENT ☐SHOOTING OR ACIDIZING ☐(Other) ☐REPAIRING WELL ☐ALTERING CASING ☐ABANDONMENT* ☒(NOTE: Report results of multiple completion on Well
Completion or Recompletion Report and Log form.)

17. DESCRIBE PROPOSED OR COMPLETED OPERATIONS (Clearly state all pertinent details, and give pertinent dates, including estimated date of starting any proposed work. If well is directionally drilled, give subsurface locations and measured and true vertical depths for all markers and zones pertinent to this work.)*

Verbal approval was given by Mr. Jim Gillham, U.S.G.S., Roswell, NM, 8/4/80 to plug well - the well was plugged as follows:

Plug #1: 9085-8935' w/35 sacks Class H cement.
Plug #2: 8425-8275' w/35 sacks Class H cement.
Plug #3: 7200-7050' w/35 sacks Class H cement.
Plug #4: 5240-5140' w/35 sacks Class H cement.
Plug #5: 4070-3970' w/35 sacks Class H cement.
Plug #6: 1290-1190' w/35 sacks Class H cement.
Plug #7: 169-0 (Surface) w/25 sacks Class H cement

RECEIVED
AUG 12 1980
U.S. GEOLOGICAL SURVEY
ARTESIA, NEW MEXICO

Installed regulation abandonment marker. Location will be restored according to U. S. G. S. requirements when received.

18. I hereby certify that the foregoing is true and correct

SIGNED

Albert R. Staff

TITLE

Engineer

DATE

8/11/80

(This space for Federal or State office use)

APPROVED BY

TITLE

DATE

CONDITIONS OF APPROVAL, IF ANY:

*See Instructions on Reverse Side

COUNTY **EDDY** FIELD **Indian Basin** STATE **NM**
 OPR **YATES PETROLEUM CORP.** API **30-025-23362**
 NO **1** LEASE **Searle "ML" Federal** MAP
Sec 11, T21S, R22E CO-ORD
1980 FSL, 2030 FWL of Sec **9-4-15 NM**
20 mi SW/Lakewood SPD **6-30-80** CMP **8-4-80**

CSC 13 3/8-565-600 sx 8 5/8-1240-1040 sx	WELL CLASS: INIT D FIN D LSE CODE			
	FORMATION	DATUM	FORMATION	DATUM
TD 9330 (MPLM)			PBD	

DRY & ABANDONED

OPER Moranco #9 OPRSTLEV 4164 GL PLD 9300 RT

F.R. 6-2-80
 (Morrow)
 9-27-80 AMEND FIELD: Formerly reported as Undesignated
 7-9-80 Drlg 1240
 7-15-80 Drlg 4350
 7-24-80 Drlg 7764
 7-31-80 Drlg 9138
 8-20-80 TD 9330; D&A (Hold)
 9-22-80 TD 9330; Dry & Abandoned
 LOG TOPS: San Andres 159, Glorieta 1781, Abo
 4028, Wolfcamp Shale 5189, Lower Canyon 7128,
 Strawn 7628, Atoka 8352, Morrow Clastic 8715,
 Austin 9013, Mississippian Lime 9196
 9-27-80 COMPLETION ISSUED

9-4-15 NM
 IC 30-015-70230-80

COUNTY **EDDY** FIELD **Indian Basin** STATE **NM**
 OPR **YATES PETROLEUM CORP.** API **30-015-23362**
 NO **1** LEASE **Searle "ML" Federal** MAP
 Sec **11, T21S, R22E** CO-ORD
 1980 FSL, 2030 FWL of Sec **9-4-15 NM**
 20 mi SW/Lakewood SPD **6-30-80** CMP **8-4-80**

CSC 13 3/8-565-600 sx 8 5/8-1240-1040 sx	WELL CLASS: INIT D FIN D LSE. CODE			
	FORMATION	DATUM	FORMATION	DATUM
	TD 9330 (MPLM)		PBD	

DRY & ABANDONED

CONTR **Moranco #9** OPRSELEV **4164 GL** PD **9300 RT**

F.R. 6-2-80
 (Morrow)
 9-27-80 AMEND FIELD: Formerly reported as Undesignated
 7-9-80 Drlg 1240
 7-15-80 Drlg 4350
 7-24-80 Drlg 7764
 7-31-80 Drlg 9138
 8-20-80 TD 9330; D&A (hold)
 9-22-80 TD 9330; Dry & Abandoned
 LOG TOPS: San Andres 159, Glorieta 1781, Abn
 4028, Wolfcamp Shale 5189, Lower Canyon 7128,
 Strawn 7628, Atoka 8352, Morrow Clastic 8715,
 Austin 9013, Mississippian Lime 9196
 9-27-80 COMPLETION ISSUED
 3-14-81 RE-ISSUE TO AMEND API: Formerly reported as
 30-025-23362

9-4-15 NM
 IC 30-015-70230-8