



AMOCO
1986 JUL 18 11 3 52

pc N/R
9/4

Southern

Rockies

Business

Unit

July 18, 1995

Mr. William J. LeMay, Director
New Mexico Oil Conservation Division
2040 S. Pacheco Street
P.O. Box 6429
Santa Fe, NM 87505

Application for Exception to Rule 303-A- Surface Commingling
Schwerdtfeger A LS 15A Well
915' FNL & 1770' FWL, Unit C Section 21-T27N-R8W
Blanco Mesaverde Pool
Schwerdtfeger A LS 16 Well
950' FNL & 1782' FWL, Unit D Section 21-T27N-R8W
South Blanco Pictured Cliffs Pool
San Juan County, New Mexico

Amoco Production Company hereby requests administrative approval to surface commingle production from the Schwerdtfeger A LS 15A well completed in the Mesaverde formation and the Schwerdtfeger A LS 16 well completed in the Pictured Cliffs formation. The Schwerdtfeger A LS 15A well is currently producing while the Schwerdtfeger A LS 16 well has just been drilled. If the two wells were surface commingled they could easily share common facilities. The ownership (WI, RI ORRI) of these pools is identical. Surface commingling will offer an economical method of production using a single train of production equipment to produce from both wells. The actual commercial value of the commingled production will not be less than the sum of the values of the production from each of the common sources of supply.

The Schwerdtfeger A LS 15A well (Mesaverde) is currently producing approximately 31 MCFD while the Schwerdtfeger A LS 16 Pictured Cliffs well is anticipated to produce about 320 MCFD. Since the Schwerdtfeger A LS 16 is a new well we will need to do testing to determine a stabilized rate from the Pictured Cliffs formation before commingling. We propose to test the well and use the total rate from the two wells minus the stabilized rate from the Schwerdtfeger A LS 16 well to determine the allocation percentages attributable to each formation. Once we have determined these allocations we will report them to the Aztec District office. The Pictured Cliffs formation has not historically produced condensate in this area, and as such we propose to allocate liquid production 100% to the Mesaverde. This fluid has historically exhibited an API gravity of approximately 49 degrees.

Attached to aid in your review are plats showing the location and acreage dedicated to the well by formation, historical production and recent testing information, and a schematic of the

proposed commingling installation. This spacing unit is on a federal lease SF-079319. A copy of the application will be sent to the BLM requesting their consent for the surface commingling.

Sincerely,

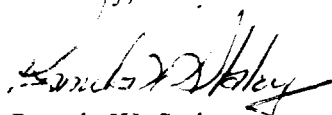
A handwritten signature in black ink, appearing to read "Pamela W. Staley", written over a horizontal line.

Pamela W. Staley

cc: Mark Rothenberg
Patty Haefle

Frank Chavez, Supervisor
NMOCD District III
1000 Rio Brazos Road
Aztec, NM 87410

Duane Spencer
Bureau of Land Management
1235 La Plata Hwy
Farmington, NM 87401

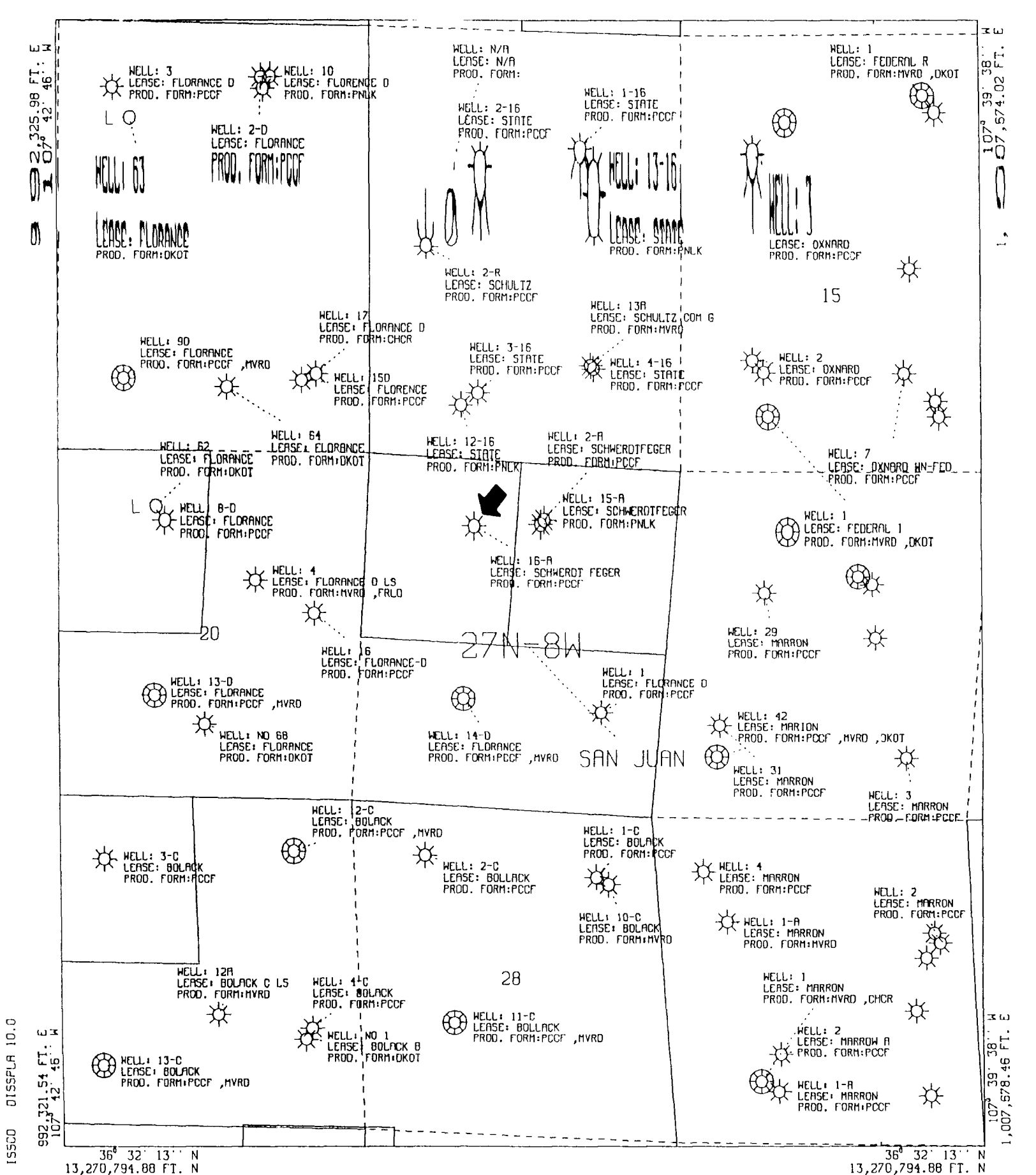

All geological and geophysical data, including the interpretation thereof, appearing on this map is the private and confidential property of Amoco Production Company. The publication or reproduction thereof without the written permission of said Company is strictly prohibited.

AMOCO PRODUCTION COMPANY
PLAT MAP

Schwerdtfeger ALS 15 A
9 - Section Plot

POLYCONIC CENTRAL MERIDIAN - 107° 41' 12'' W LONG
SPHEROID - 6

SPALF 1 IN - 2 000 ET MOD 21 1000

Well Location and Acreage Dedication Plat

Section A.

Date **JUNE 22, 1959**

Operator **EL PASO NATURAL GAS COMPANY** Lease **SCHWEDTFEGER** SF **079319**
 Well No. **16-A** Unit Letter **D** Section **21** Township **27-N** Range **8-W** NMPM
 Located **950** Feet From **NORTH** Line, **1782** Feet From **WEST** Line
 County **SAN JUAN** G. L. Elevation **6252** Dedicated Acreage **160** Acres
 Name of Producing Formation **PICTURED CLIFF** Pool **SOUTH BLANCO PICTURED CLIFF**

1. Is the Operator the only owner in the dedicated acreage outlined on the plat below?
 Yes ☒ No ☐
2. If the answer to question one is "no", have the interests of all the owners been consolidated by communitization agreement or otherwise? Yes ☐ No ☐. If answer is "yes", Type of Consolidation.
3. If the answer to question two is "no", list all the owners and their respective interests below:

Owner

Land Description

Section B.

This is to certify that the information in Section A above is true and complete to the best of my knowledge and belief.

El Paso Natural Gas Company

(Operator)

Original Signed **F. H. WOOD**

(Representative)

Box 997

(Address)

Farmington, New Mexico

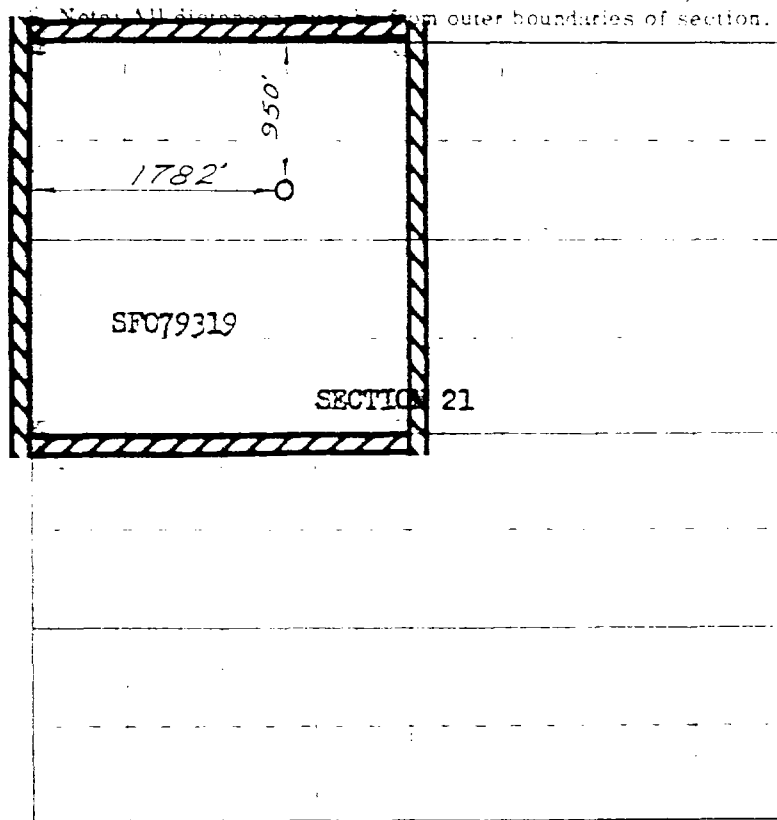

0 330 660 990 1320 1650 1980 2310 2640 2970 3300 3630 3960 4290 4620 4950 5280 5610 5940 6270 6600 6930 7260 7590 7920 8250 8580 8910 9240 9570 9900

Scale 4 inches equal 1 mile

NOTE: THIS PLAT IS RE-ISSUED TO SHOW MOVED LOCATION. 7 1 59

This is to certify that the above plat was prepared from field notes of actual surveys made by me or under my Supervision and that the same are true and correct to the best of my knowledge and belief.

(Seal)

Date Surveyed

JUNE 16, 1959

David O. Kibben
 Registered Professional Engineer, State of New Mexico

Farmington, New Mexico

District I
PO Box 1980, Hobbs, NM 88241-1980
District II
PO Drawer DD, Artesia, NM 88211-0719
District III
1000 Rte Brazos Rd., Aztec, NM 87410
District IV
PO Box 2088, Santa Fe, NM 87504-2088

State of New Mexico
Energy, Minerals & Natural Resources Department

OIL CONSERVATION DIVISION
PO Box 2088
Santa Fe, NM 87504-2088

Form C-102
Revised February 21, 1994
Instructions on back
Submit to Appropriate District Office
State Lease - 4 Copies
Fee Lease - 3 Copies

☐ AMENDED REPORT

WELL LOCATION AND ACREAGE DEDICATION PLAT

1 API Number		2 Pool Code		3 Pool Name	
4 Property Code		5 Property Name FLORANCE DLS Schwerdtfeger A 15 A			6 Well Number # 14 A
7 OGRID No.		8 Operator Name AMOCO PRODUCTION COMPANY			9 Elevation 6256

10 Surface Location

UL or lot no.	Section	Township	Range	Lot Ida	Feet from the	North/South line	Feet from the	East/West line	County
C	21	27 N	8 W		915	NORTH	1770	WEST	SAN JUAN

11 Bottom Hole Location If Different From Surface

UL or lot no.	Section	Township	Range	Lot Ida	Feet from the	North/South line	Feet from the	East/West line	County
12 Dedicated Acres		13 Joint or Infill		14 Consolidation Code		15 Order No.			

NO ALLOWABLE WILL BE ASSIGNED TO THIS COMPLETION UNTIL ALL INTERESTS HAVE BEEN CONSOLIDATED
OR A NON-STANDARD UNIT HAS BEEN APPROVED BY THE DIVISION

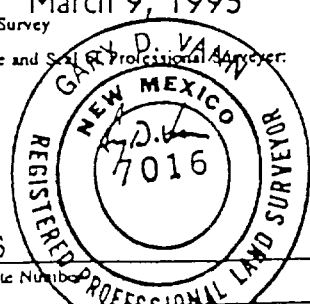
16 1290.13' 1290.14' 1336.17' 1336.17' 1770'	17 OPERATOR CERTIFICATION I hereby certify that the information contained herein is true and complete to the best of my knowledge and belief			
	Signature _____			
	Printed Name _____			
	Title _____			
Date _____				
18 SURVEYOR CERTIFICATION I hereby certify that the well location shown on this plat was plotted from field notes of actual surveys made by me or under my supervision, and that the same is true and correct to the best of my belief.				
Date of Survey March 9, 1995				
Signature and Seal of Professional Surveyor: 				
7016 Certificate Number				

Engr: zmdr16

SCHWERTFEGER A LS 16

Operator-- AMOCO PRODUCTION CO

300450639700PC C212708-016 PC

APC_WI - 0.50000000

CumG_70	--	467728
CumO_70	--	0
CumGAS	--	756718
CumOIL	--	0

Curr_Fit	
DCLN	0.072
CurrQ	26
RemRes	96319
EUR	853037
Fit_date	1993 8

New_fit

DCLN	
CurrQ	
RemRes	
EUR	
Fit_date	

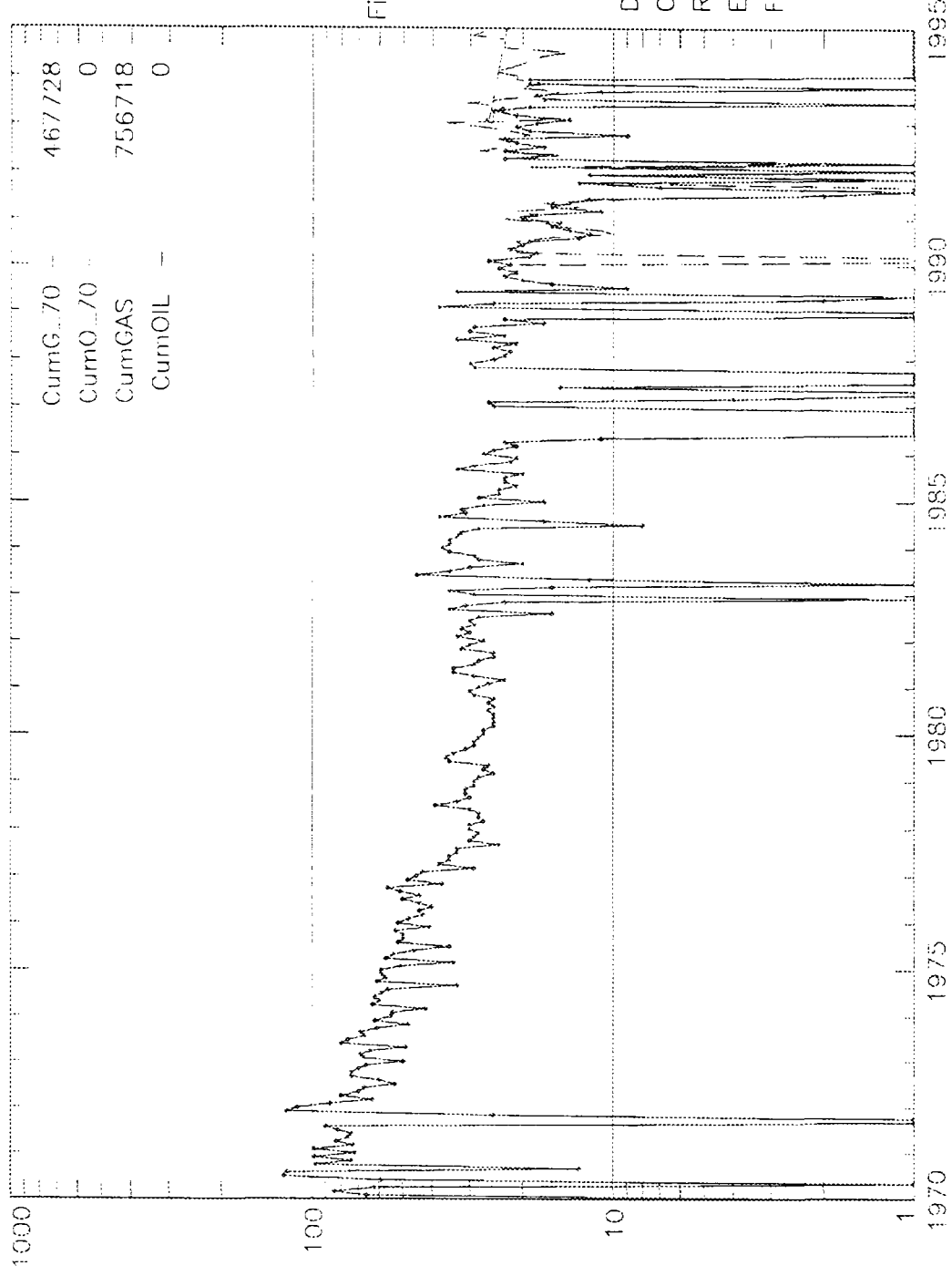
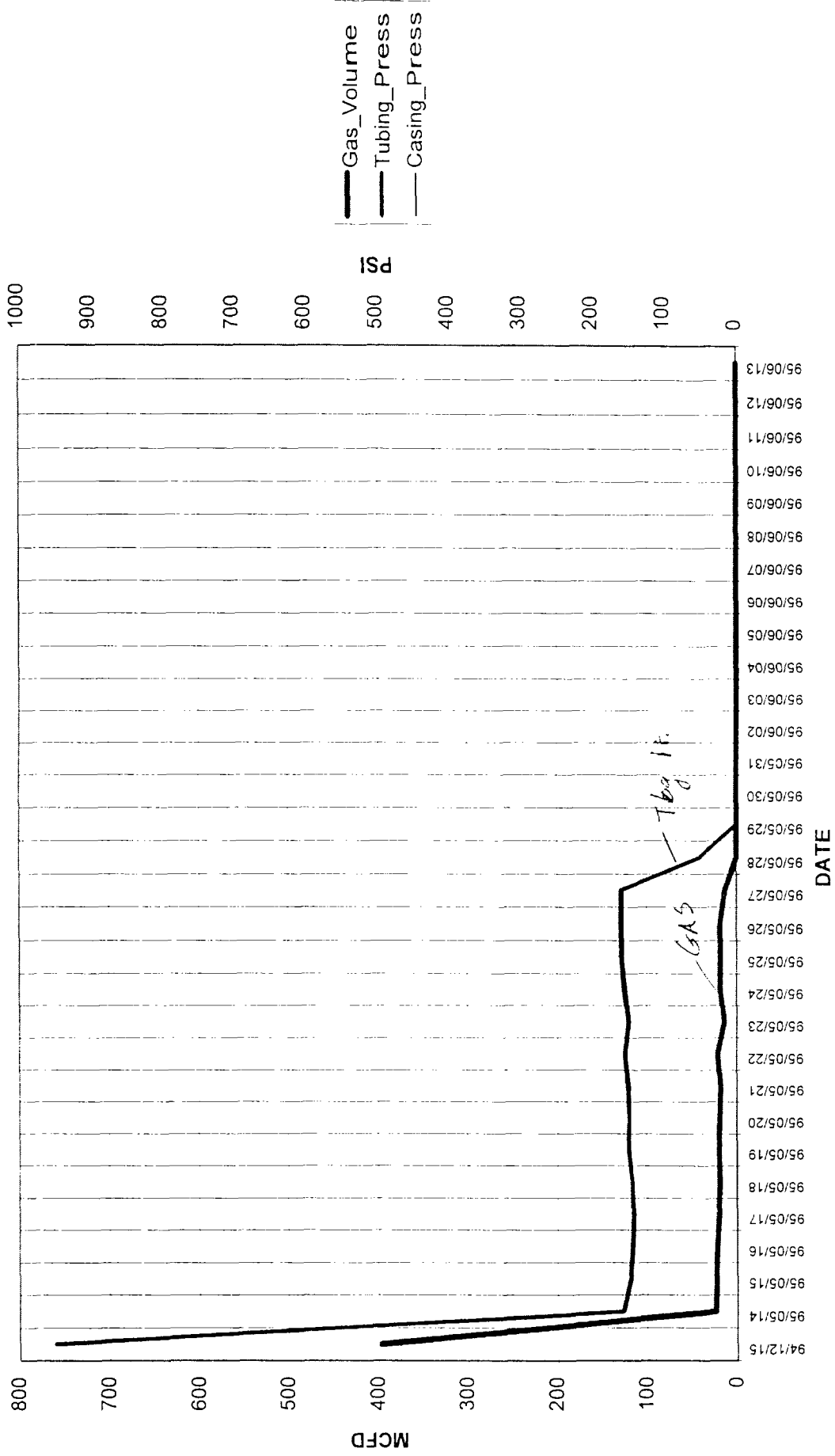

Chart1

Sch. 116
Well: AMOGO MILLER 1 (84497804)



ONSHORE FEDERAL AND INDIAN
SITE FACILITY DIAGRAM

Sealed valves are normally closed during production phase. Drain line valve to pit open to draw off water and load line valve open to sell condensate.

Date 7/14/95

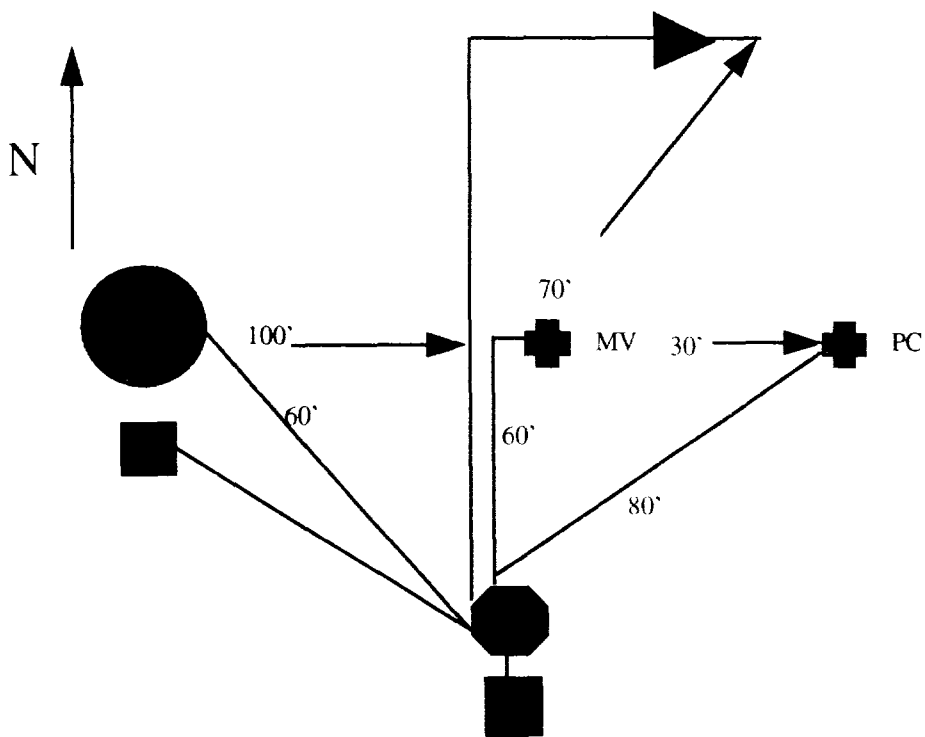

- ☆ Compressor
- ⊕ Wellhead
- □ Production Unit
- ○ Storage Tank and Number
- ○ Dehydrator
- ▲ Meter Run and Number
- □ Pit
- ✕ Sealed valves