

Lse. No. 54452
Suckeye Area

NEW MEXICO OIL CONSERVATION COMMISSION
WELL LOCATION AND ACREAGE DEDICATION PLAT

FORM C-128
Revised 5/1/57

SEE INSTRUCTIONS FOR COMPLETING THIS FORM ON THE REVERSE SIDE

SECTION A

Operator TEXACO Inc.		Lease State of New Mexico "Q"		Well No. 4
Unit Letter P	Section 25	Township 17 South	Range 34 East	County Lea
Actual Footage Location of Well: 500 feet from the South line and 760 feet from the East line Sec. 25				
Ground Level Elev. 3990	Producing Formation "see attached sheet"	Pool "see attached sheet"	Dedicated Acreage: "see attached sheet" Acres	

Depth: 12,150'

- Is the Operator the only owner in the dedicated acreage outlined on the plat below? YES ☒ NO ☐ ("Owner" means the person who has the right to drill into and to produce from any pool and to appropriate the production either for himself or for himself and another. (65-3-29 (e) NMSA 1935 Comp.)
- If the answer to question one is "no," have the interests of all the owners been consolidated by communitization agreement or otherwise? YES ☐ NO ☐ If answer is "yes," Type of Consolidation _____
- If the answer to question two is "no," list all the owners and their respective interests below:

Owner	Land Description
-------	------------------

NOTICE OF LOCATION

SECTION B

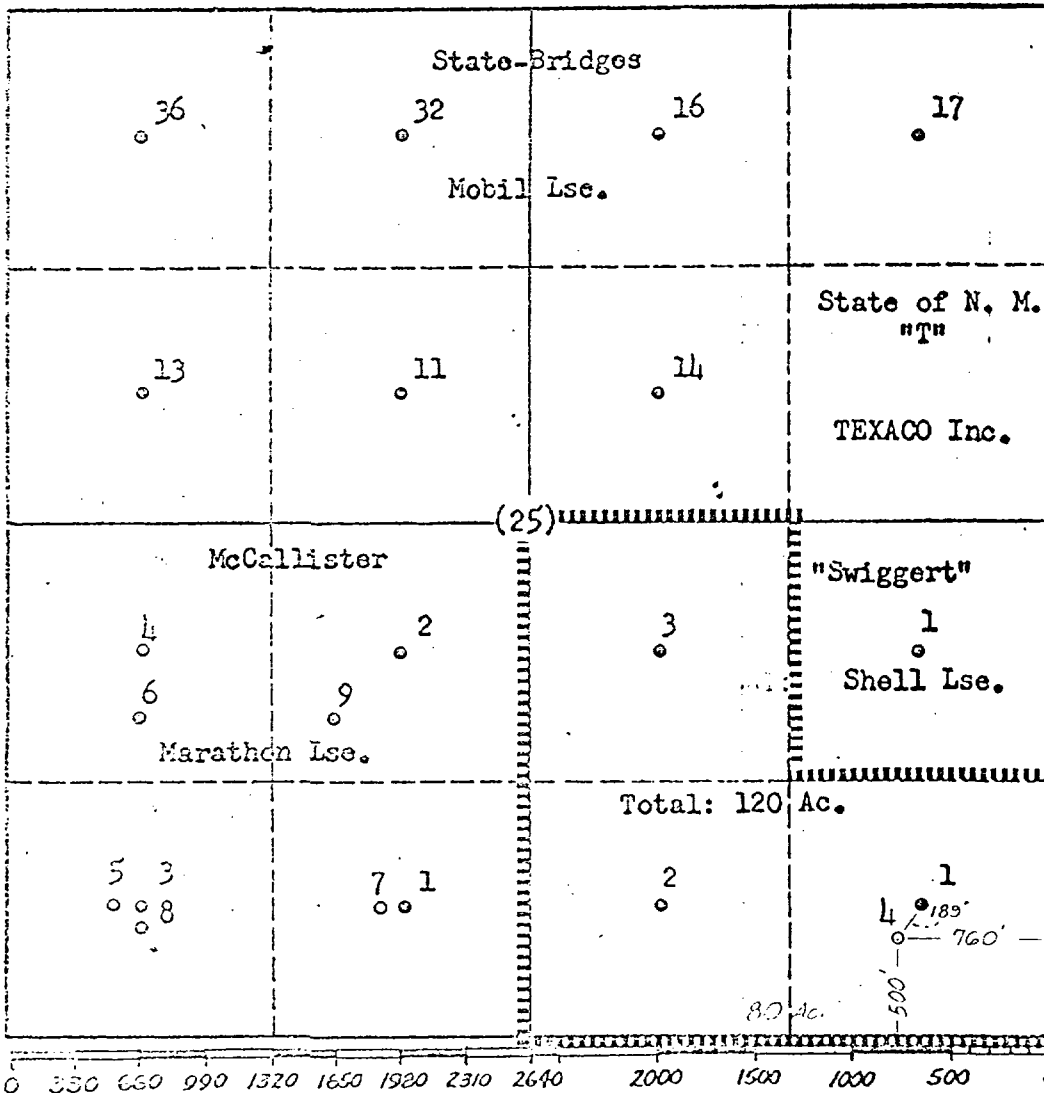

CERTIFICATION

I hereby certify that the information in SECTION A above is true and complete to the best of my knowledge and belief.

Name	J. J. Velten
Position	Division Civil Engineer
Company	TEXACO Inc.
Date	8/5/63

I hereby certify that the well location shown on the plat in SECTION B was plotted from field notes of actual surveys made by me or under my supervision, and that the same is true and correct to the best of my knowledge and belief.

Date Surveyed	7/30/63
Registered Professional Engineer and/or Land Surveyor	J. J. Velten
Certificate No.	8174

Producing Formations:

Wolfcamp
Pennsylvanian
Devonian

Pools:

Vacuum (Wolfcamp)
Vacuum (Pennsylvanian)
Vacuum (Devonian)

Dedicated Acreage:

Vacuum (Wolfcamp)	80 Acres
Vacuum (Pennsylvanian)	40 Acres
Vacuum (Devonian)	80 Acres

DISTRICT I
P.O. Box 1980, Hobbs, NM 88241-1980

DISTRICT II
P.O. Box Drawer DD, Artesia, NM 88211-0719

DISTRICT III
1000 Rio Brazos Rd., Aztec, NM 87410

DISTRICT IV
P.O. Box 2088, Santa Fe, NM 87504-2088

State of New Mexico
Energy, Minerals and Natural Resources Department

OIL CONSERVATION DIVISION

P.O. Box 2088
Santa Fe, New Mexico 87504-2088

Form C-102

Revised February 10, 1994

Instructions on back
Submit to Appropriate District Office

State Lease - 4 Copies

Fee Lease - 3 Copies

☐ AMENDED REPORT

WELL LOCATION AND ACREAGE DEDICATION PLAT

¹ API Number 30-025-33148	² Pool Code	³ Pool Name WILDCAT ATOKA
⁴ Property Code 11048	⁵ Property Name NEW MEXICO 0 STATE NCT-1	⁶ Well No. 38
⁷ OGRID Number 022351	⁸ Operator Name TEXACO EXPLORATION & PRODUCTION INC.	⁹ Elevation 3987'

¹⁰ Surface Location

UI or lot no.	Section	Township	Range	Lot.Idn	Feet From The	North/South Line	Feet From The	East/West Line	County
I	36	17-S	34-E		2085	SOUTH	710	EAST	LEA

¹¹ Bottom Hole Location If Different From Surface

UI or lot no.	Section	Township	Range	Lot.Idn	Feet From The	North/South Line	Feet From The	East/West Line	County

¹² Dedicated Acres 40	¹³ Joint or Infill No	¹⁴ Consolidation Code	¹⁵ Order No.
-------------------------------------	-------------------------------------	----------------------------------	-------------------------

NO ALLOWABLE WILL BE ASSIGNED TO THIS COMPLETION UNTIL ALL INTERESTS HAVE BEEN CONSOLIDATED
OR A NON-STANDARD UNIT HAS BEEN APPROVED BY THE DIVISION

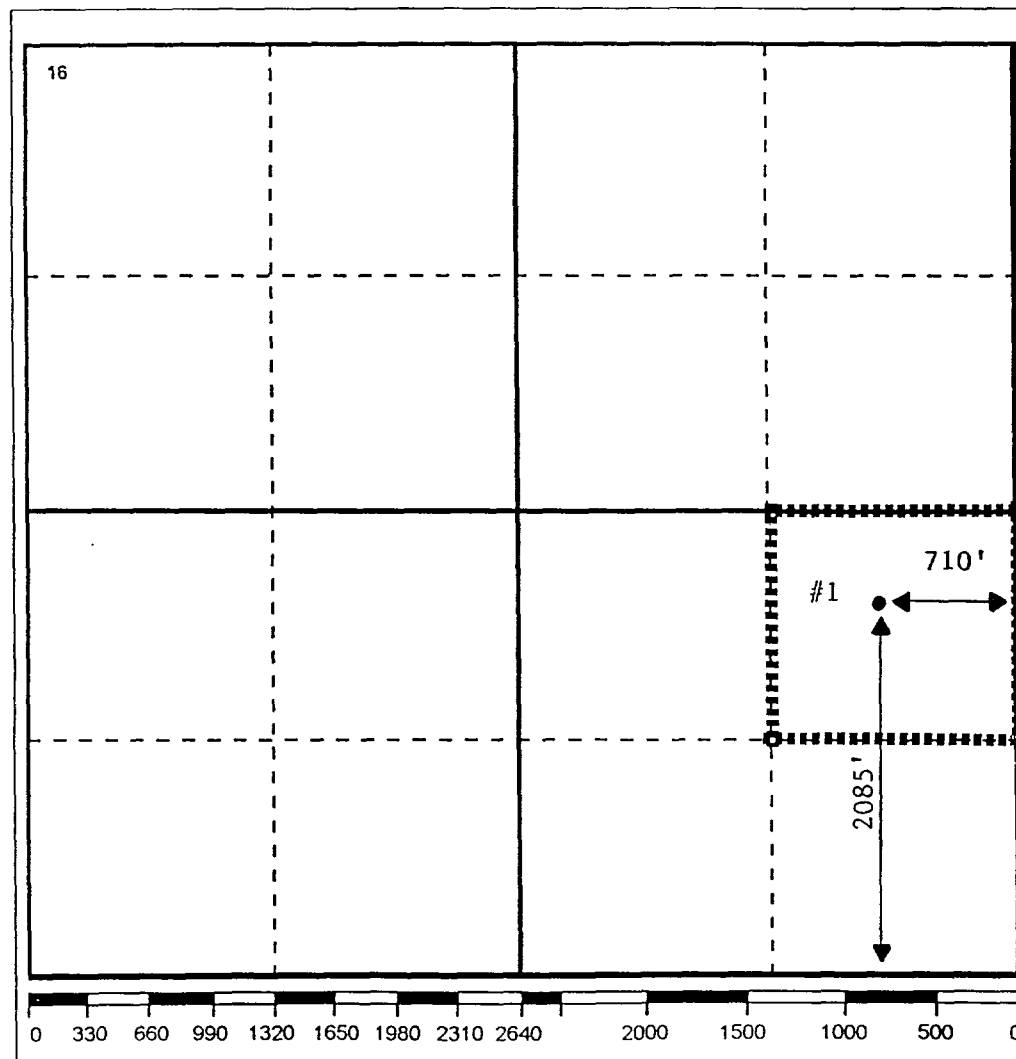

17 OPERATOR CERTIFICATION

I hereby certify that the information
contained herein is true and complete to the
best of my knowledge and belief

Signature

Monte C. Duncan

Printed Name

Monte C. Duncan

Position

Engr Asst

Date

1/2/96

18 SURVEYOR CERTIFICATION

I hereby certify that the well location shown
on this plat was plotted from field notes of
actual surveys made by me or under my
supervision, and that the same is true and
correct to the best of my knowledge and
belief.

Date Surveyed

Signature & Seal of
Professional Surveyor

Certificate No.

DISTRICT I
P. O. Box 1960, Hobbs, NM 88240

DISTRICT II
P. O. Drawer DO, Artesia, NM 88210

DISTRICT III
1000 Rio Brazos Rd., Aztec, NM 87410

DISTRICT IV
P. O. Box 2088, Santa Fe, NM 87504-2088

State of New Mexico
Energy, Minerals and Natural Resources Department

Form C-102
Revised February 10, 1994

Instructions on back

OIL CONSERVATION DIVISION
PO Box 2088
Santa Fe, NM 87504-2088

Submit to Appropriate District Office

State Lease-4 copies
Fee Lease-3 copies

☐ AMENDED REPORT

WELL LOCATION AND ACREAGE DEDICATION PLAT

1 API Number		2 Pool Code		3 Pool Name Wildcat; Atoka	
4 Property Code		5 Property Name New Mexico "N" State			6 Well Number 10
7 OGHM No.		8 Operator Name TEXACO EXPLORATION & PRODUCTION, INC.			9 Elevation 3989'

10 Surface Location									
UL or lot no. M	Section 30	Township 17-S	Range 35-E	Lat 1dn	Feet from the 800'	North/South line South	Feet from the 510'	East/West line West	County Lea
11 Bottom Hole Location If Different From Surface									
UL or lot no. M	Section 30	Township 17-S	Range 35-E	Lat 1dn	Feet from the 380'	North/South line South	Feet from the 380'	East/West line West	County Lea
12 Dedicated Acres 37.59		13 Joint or Infill		14 Consolidation Code		15 Order No.			

NO ALLOWABLE WILL BE ASSIGNED TO THIS COMPLETION UNTIL ALL INTERESTS HAVE BEEN CONSOLIDATED
OR A NON-STANDARD UNIT HAS BEEN APPROVED BY THE DIVISION.

	<p>16 OPERATOR CERTIFICATION</p> <p>I hereby certify that the information contained herein is true and complete to the best of my knowledge and belief.</p> <p>Signature <i>C. Wade Howard</i></p> <p>Printed Name C. Wade Howard</p> <p>Position Engineer's Assistant</p> <p>Company Texaco Expl. & Prod. Inc.</p> <p>Date March 1, 1996</p>
	<p>17 SURVEYOR CERTIFICATION</p> <p>I hereby certify that the well location shown on this plat was plotted from field notes of actual surveys made by me or under my supervision and that the same is true and correct to the best of my knowledge and belief.</p> <p>Date Surveyed February 13, 1996</p> <p>Signature & Seal of Professional Surveyor <i>John S. Piper</i></p> <p>Certificate No. 7254 John S. Piper</p>
	<p>Sheet</p>

○ = Staked Location ● = Producing Well = Injection Well ◇ = Water Supply Well ◆ = Plugged & Abandon Well
⊙ = Found Section Corner, 2 or 3" Iron Pipe & GLO B.C. ○ = Found 1/4 Section Corner, 1" Iron Pipe & GLO B.C.

ADDITIONAL INFORMATION ON THE LOCATION

State Plane Coordinates			
Northing 656141.33 (655720.82 BHL)		Easting 796232.83 (796107.14 BHL)	
Latitude 32°48'03.654" (32°47'59.503" BHL)		Longitude 103°30'13.600" (103°30'15.111" BHL)	
Zone	North American Datum	Combined Grid Factor	Coordinate File
East	1983	0.99979145	Buckeye.cr5
Drawing File		Field Book	

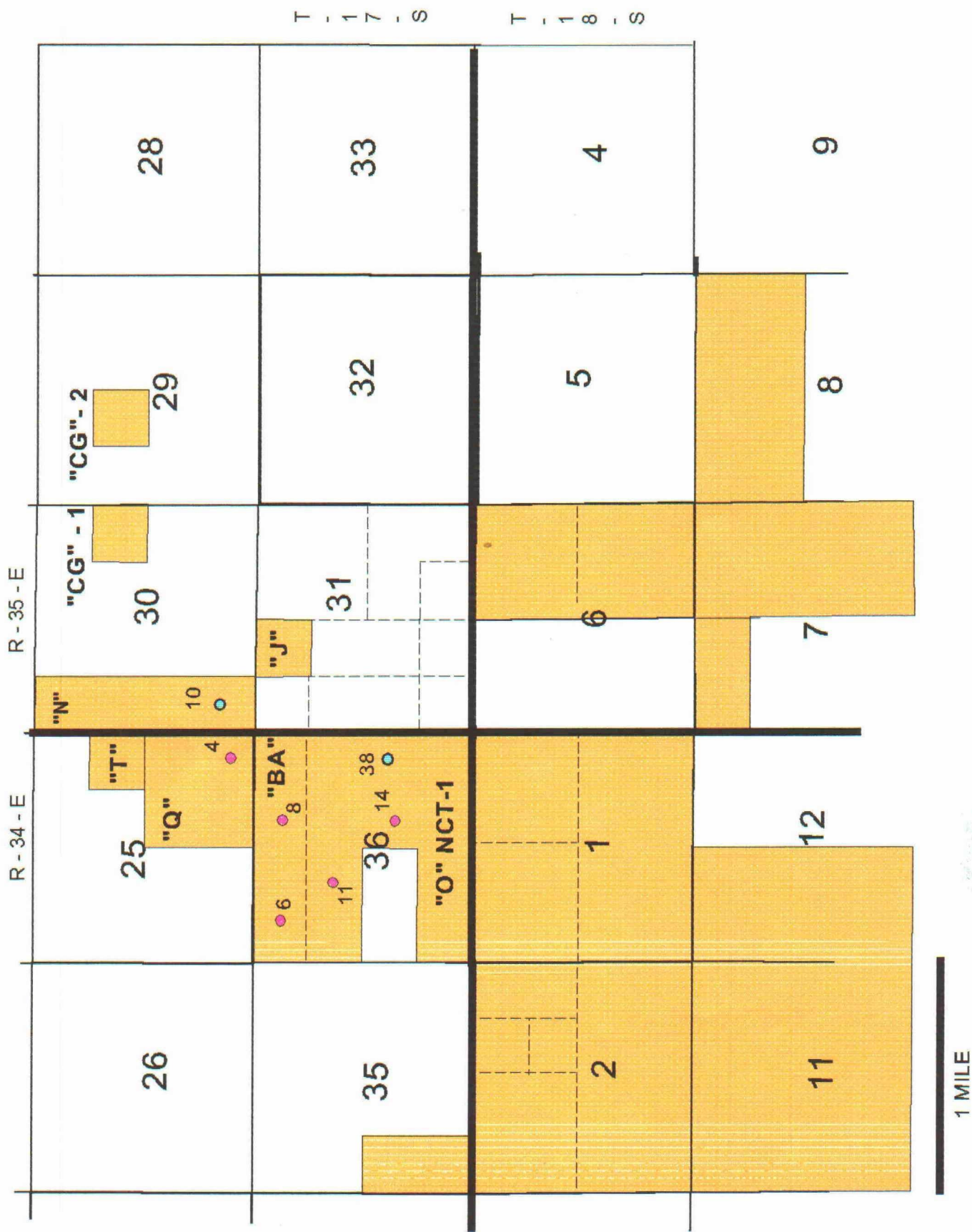

VACUUM 36 Com -1 (NM "O" NCT-1 No. 38) ATOKA

DAILY PRODUCTION

