

HARLAN PRODUCTION COMPANY

315 SOUTH ALLEN P. O. BOX 355
MONAHANS, TEXAS

June 18, 1965

117 11

214

Mr. A. L. Porter, Jr.
Secretary-Director
Oil Conservation Commission
P. O. Box 871
Santa Fe, New Mexico

Re: Case No. 2966
Order No. R-2635
HARLAN PRODUCTION COMPANY
Waterflood Project
Eddy County, New Mexico

Dear Sir:

On January 13, 1964, the above named order authorized Harlan Production Company to institute a waterflood project in the Grayburg-Jackson Pool by injection of water into the Queen formation through the following-described wells in Township 17 South, Range 30 East, NMPM Eddy County, New Mexico:

Section 16

Etz-State Well No. 2, 1980 feet from the South line and 660 feet from the West line;

Etz-State Well No. 9, 1370 feet from the North line and 660 feet from the West line;

Etz-State Well No. 10, 1370 feet from the North line and 1980 feet from the West line.

Section 17

McIntyre "D" Well No. 7, 1980 feet from the North line and 660 feet from the East line.

Active injection was commenced into the above wells July 16, 1964. Monthly progress reports (Form C-120) covering this project are on file in the commission offices.

Under the provisions of Rule 701-E-5 "Commission Rules and Regulations", Harlan Production Company requests administrative approval to expand this project by converting Etz-State No. 2-J to injection. Substantial flood response to producing well Etz-State No. 6, Unit G, Section 16, T17S, R30E, has been reported on Form C-120. This well is a direct offset to our proposed injection well Etz-State No. 2-J, Unit J, Section 16, T17S, R30E.

HARLAN PRODUCTION COMPANY

315 SOUTH ALLEN P. O. BOX 355
MONAHANS, TEXAS

June 18, 1965

JUN 21 AM 7 40

Mr. A. L. Porter, Jr.

Page 2

The following exhibits are attached:

- (1) Proposed plan to inject into Etz-State No. 2-J
- (2) Plat of the Queen sand area showing lease ownership, location of the proposed injection well and other injection or producers.
- (3) Plat of the Grayburg Jackson Pool area.
- (4) Commission Form C-116 showing well test before and after stimulation.
- (5) Copy of letter submitting copy of this application to offset operator R. D. Collier.
- (6) Copy of letter submitting copy of this application to offset operator Kersey & Company.

Yours very truly,

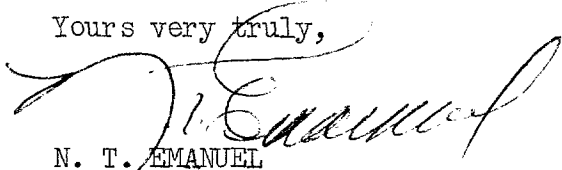
N. T. EMANUEL
Petroleum Engineer

NTE/njm
w/encl

cc: w/encl State Engineer Office
Capitol Building
Santa Fe, New Mexico

HARLAN PRODUCTION COMPANY
315 SOUTH ALLEY P. O. BOX 355
MONAHANS, TEXAS

June 18, 1965

65 JUN 21 AM 10

Mr. R. G. Collier
P. O. Box 647
Artesia, New Mexico

Dear Sir:

Attached for your consideration is a copy of our application to the New Mexico Oil Conservation Commission requesting approval to expand our Ets-State Queen Sand waterflood project by converting Ets-State No. 2-J to injection.

Yours very truly,

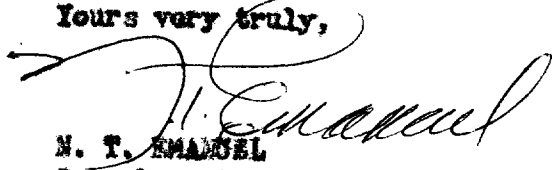
N. T. EMANUEL
Petroleum Engineer

NTE/njc

W/encl.

HARLAN PRODUCTION COMPANY

315 SOUTH ALLEN P. O. BOX 355
MONAHANS, TEXAS

June 18, 1965

65 JUN 21 AM 11

Mr. Harold Kersey
Kersey & Company
P. O. Box 316
Artesia, New Mexico

Dear Sir:

Attached for your consideration is a copy of our application to New Mexico Oil Conservation Commission requesting approval to expand our Etz-State Queen Sand waterflood project by converting Etz-State No. 2-J to injection.

Yours very truly,

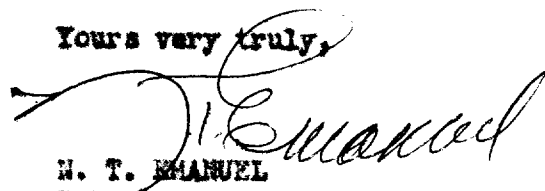
W. T. EMANUEL
Petroleum Engineer

NTE/njm

w/encl.

PROPOSED WATER INJECTION WELL

Etz-State No. 2-J
NW, SE, Sec. 17, T-17-S, R-30-E

Original Producing Well Drilled by
Etz Oil Company 6/11/41

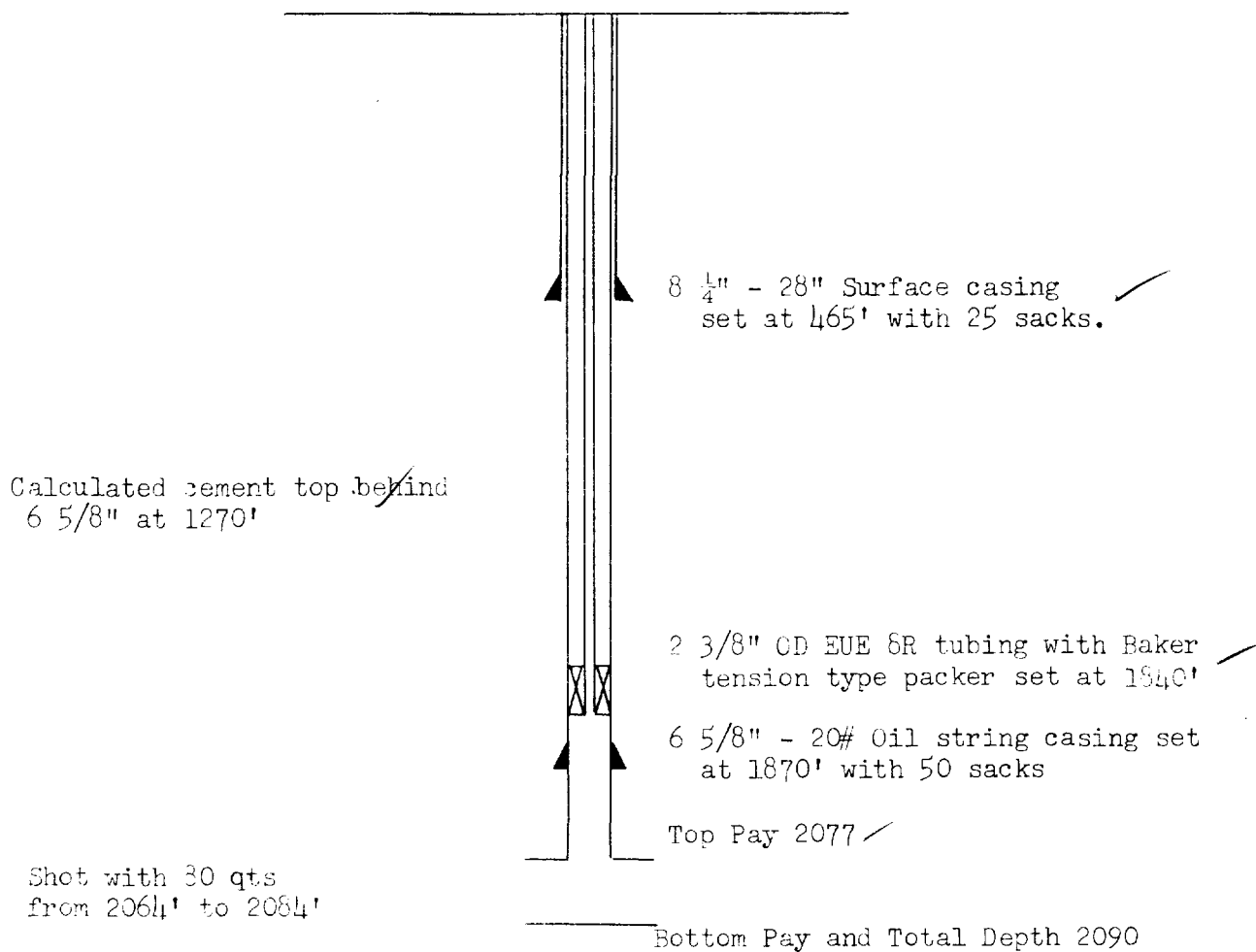

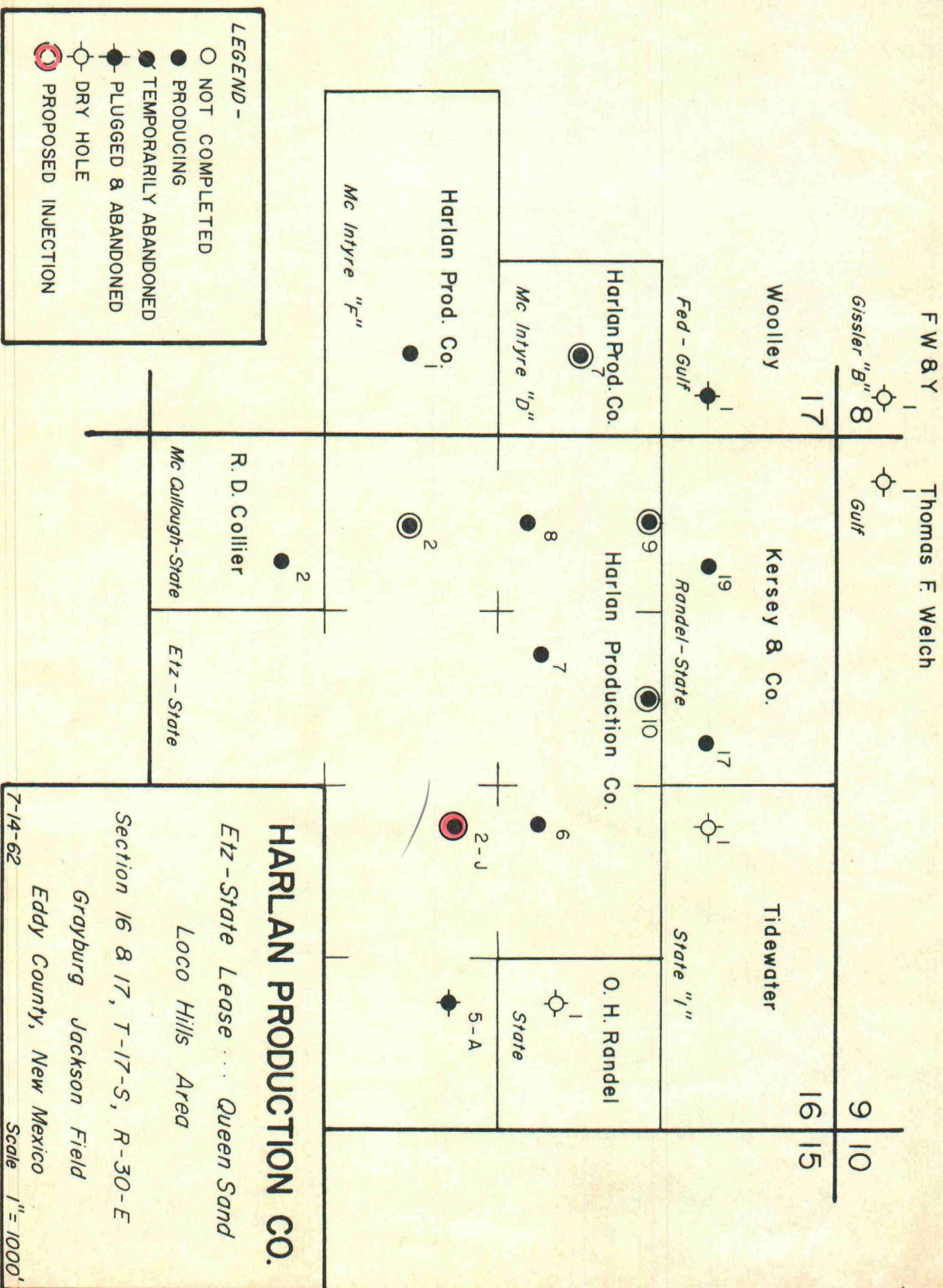
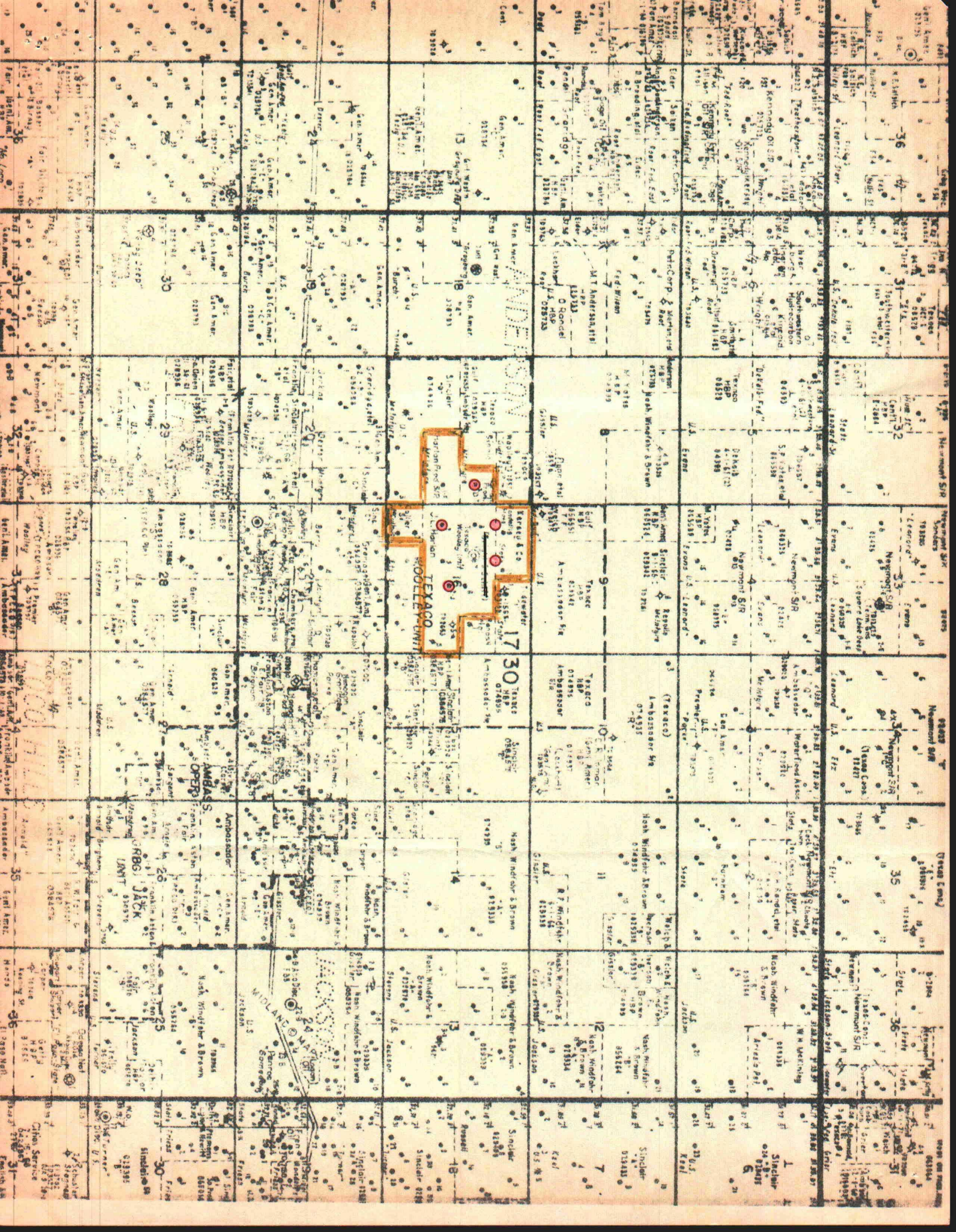

Exhibit "A"



NEW MEXICO OIL CONSERVATION COMMISSION
GAS - OIL RATIO TESTS

C-116
Revised 1-1-65

Operator HARIAN PRODUCTION COMPANY		Pool GRAYBURG JACKSON		County EDDY												
Address Box 355, Monahans, Texas		TYPE OF TEST - (X) <input checked="" type="checkbox"/> TEST - (X)		Completion <input type="checkbox"/> Scheduled <input type="checkbox"/> Special <input checked="" type="checkbox"/>												
LEASE NAME	WELL NO.	LOCATION			DATE OF TEST	STATUS	CHOKE SIZE	TBG. PRESS.	DAILY ALLOW-ABLE	LENGTH OF TEST HOURS	PROD. DURING TEST			GAS - OIL RATIO CU. FT./BBL.		
		U	S	T							R	WATER BBLs.	GRAV. OIL BBLs.		GAS M.C.F.	
Etz-State	6	G	16	17	30	6-16-64	P	-	-	5	24	0	38	3	-	TEST
TEST BEFORE STIMULATION																
JUN 21 1965																

No well will be assigned an allowable greater than the amount of oil produced on the official test.

During gas-oil ratio test, each well shall be produced at a rate not exceeding the top unit allowable for the pool in which well is located by more than 25 percent. Operator is encouraged to take advantage of this 25 percent tolerance in order that well can be assigned increased allowables when authorized by the Commission.

Gas volumes must be reported in MCF measured at a pressure base of 15.025 psia and a temperature of 60° F. Specific gravity base will be 0.60.

Report casing pressure in lieu of tubing pressure for any well producing through casing.

Mail original and one copy of this report to the district office of the New Mexico Oil Conservation Commission in accordance with Rule 301 and appropriate pool rules.

I hereby certify that the above information is true and complete to the best of my knowledge and belief.

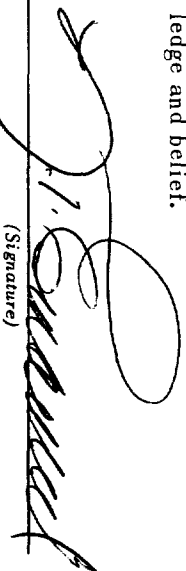
(Signature)

Petroleum Engineer

June 18, 1965

(Date)

C-116
Revised 1-1-65

(Date)

To — Jim Kap — Please — ⁸⁻¹¹⁻⁶⁵ Dwy

ILLEGIBLE

MAIN OFFICE

'65 Aug 11 AM 8