

RYDER SCOTT MANAGEMENT COMPANY

922 EIGHTH STREET
PHONE (817) 723-5313
WICHITA FALLS, TEXAS

June 9, 1967

New Mexico Oil Conservation Commission
P. O. Box 2088
Santa Fe, New Mexico 87501

Re: Application to Convert
Featherstone State
Well No. 1 to Water
Injection

Gentlemen:

Under Oil Conservation Commission Order No. R-2270 dated June 21, 1962, Water Flood Associates, Inc. was granted permission to initiate waterflood operations in Section 35, T-16-S, R-31-E, Eddy County, N.M. Water injection on this project as specified in the above order was commenced on Sept. 13, 1962. Ryder Scott Management Company became operator of this flood project on October 1, 1965 and has operated the Featherstone lease in Sec. 2 since January, 1965.

This application is made to acquire administrative approval to expand this waterflood operation by converting to water injection the Ryder Scott Management Company Featherstone State Well No. 1 located 2310' FEL and 2310' FNL, Sec. 2, T-17-S, R-31-E, Grayburg Jackson Field, Eddy County. This well is a continuation of the regular pattern and only fresh water will be injected.

Since inception of the flood water has been and is currently being injected into four wells located in Sec. 35, T-16-S, R-31-E, and Featherstone well No. 5 located in Sec. 2, T-17-S, R-31-E, Eddy County. The attached Form C-120 shows the injection and producing wells with respective pertinent data.

MAIL

'67 JUN 12 AM 8 15

New Mexico Oil Conservation Commission
June 9, 1967
Page -2-

The casing program for the proposed injection well is shown on the attached diagram. The map, also attached, shows the current injection and producing wells and lease ownership.

Yours very truly,

RYDER SCOTT
MANAGEMENT COMPANY

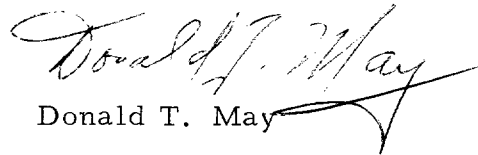
Donald T. May

DTM:jsh

Attch. (3)

cc: N. M. Oil Conservation Commission
P. O. Drawer DD - District II
Artesia, New Mexico 88210

RYDER SCOTT MANAGEMENT COMPANY

Featherstone Well No. 1

Sec. 2, T17S, R31E

9-5/8" casing set at 740'
w/300 sx. regular neat
cement. Circulated 50 sx.

Perforated w/4 bullets/ft.
in Grayburg as follows:
3538 - 52; 3560 - 62;
3566 - 78; 3596 - 3602;
3632 - 40.

5-1/2" OD J-55, 15.5# csg.
set from surface to 3675' and
cemented w/100 sx.
Total Depth 3675'

RYDER SCOTT MANAGEMENT COMPANY

922 EIGHTH STREET

PHONE (817) 723-5313

WICHITA FALLS, TEXAS



June 21, 1967

MAIL OFFICE 0000

'67 JUN 23 1 18

264
7/5

State of New Mexico
Oil Conservation Commission
P. O. Box 2088
Santa Fe, New Mexico 87501

Gentlemen:

We hereby make application for administrative approval to convert the following well to water injection:

Featherstone State Well No. 1
2310' FEL & 2310' FNL, Sec. 2
T17S, R31E, Robinson Field
(Grayburg Jackson), Eddy County, N. M.

Our six current intakes in operation are shown on the attached plat with connecting red lines. Fresh water will be injected through plastic coated tubing on a packer set at 3515 feet, which is just above the top perforation. All perforated intervals are in the Grayburg formation and are posted on the attached diagramatic sketch. The water for injection is purchased from Double Eagle Corporation of New Mexico. We will inject at a rate ranging from 200 to 300 barrels per day.

Under Oil Conservation Commission Order No. R-2270 dated June 21, 1962, Water Flood Associates, Inc. was granted permission to initiate waterflood operations in the Robinson Pool Project. Water injection on this project as specified in the above order commenced on September 13, 1962. Ryder Scott Management Company became operator of this flood project on October 1, 1966.

The attached Form C-120 shows the cumulative water injected into the six intake wells. Featherstone No. 2 is showing waterflood response. In September, 1966 it was making 2 BOPD and is currently making 4.54 BOPD. We want to convert Featherstone well No. 1 as a back up prior to Featherstone No. 3 becoming

Oil Conservation Commission
June 21, 1967
Page -2-

stimulated and in order to further stimulate Featherstone No. 2. The conversion of this well will bring about a better balanced flood on the Featherstone lease and cause a more efficient waterflood sweep.

The attached Form C-116 shows both the September, 1966 and the May, 1967, production tests on Featherstone No. 2. These are before and after resuming injection into Featherstone No. 5.

A copy of this application, complete with all attachments, has been sent to the State Engineer Office and all offset operators.

Yours very truly,

RYDER SCOTT
MANAGEMENT COMPANY

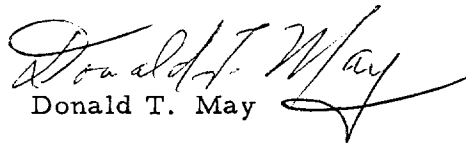

Donald T. May

DTM:jsh

cc: State Engineer Office
DOB Oil Properties, Inc.
Olen F. Featherstone
Newmont Oil Company
Sinclair Oil Company
Skelly Oil Company
Humble Oil & Refining Co.
Mid-Century Oil Company

Attch: (1) Plat
(2) Schematic drawing
(3) Form C-120
(4) Form C-116

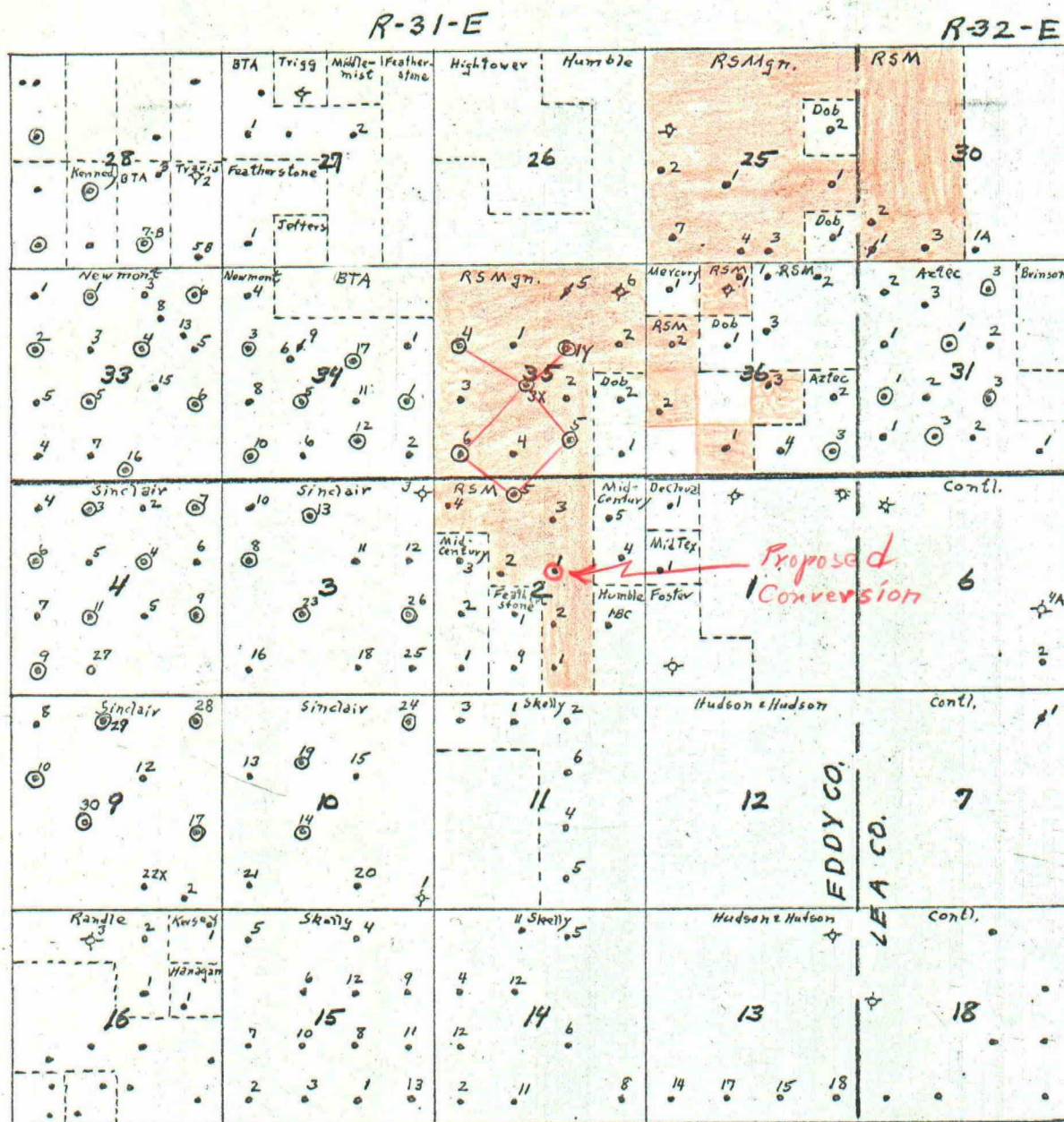
RYDER SCOTT MANAGEMENT COMPANY



LEGEND

- Oil Well
- ✕ Abandoned Oil Well
- ★ Oil & Gas Well
- ☆ Gas Well
- ☆ Dry Hole
- ⊙ Injection Well

PRODUCING ZONES

1. GRAYBURG
Metex & Premier
2. SAN ANDRES
Lorington

RYDER SCOTT MGN. CO.

ROBINSON POOL

EDDY & LEA CO'S, NEW MEXICO

One Mile

ILLEGIBLE

RYDER SCOTT MANAGEMENT CO.

Featherstone Well No. 1

2310' FEL & 2310' ENL, Seg 2, T175, R31E

Robinson Field

Eddy Co., N.M.

Will inject fresh water
through plastic coated
tubing & packer set just
above the top perforation
at 3538'

4 7/8" CS9 @ 710' w/ 300 SX.
circulated 50 SX.

2 3/8" EUE tubing, plastic coating

Baker Tension Packer @ 3515'

Perforated w/ 4 bullets / ft. in
Grayburg as follows:

3538-52'

3566-62'

3566-78'

3596-3602'

3632-40'

5 1/2" OD J-55, 15.5# CS9 set from
T.D. 3675' surface to 3675' w/ 100 SX.

NEW MEXICO OIL CONSERVATION COMMISSION

MONTHLY INJECTION REPORT 0-6 Dist. II

Form C-120
(Revised 5-1-60)

Submit this report in triplicate to the District Office, Oil Conservation Commission.

Company Ryder Scott Management Company Pool Grayburg Jackson Carper Kennedy FloodCounty Eddy Month April, 1967

INJECTION WELLS (Attach additional sheets if necessary)

LEASE	WELL NO.	LOCATION				MCF GAS INJECTED	CUMULATIVE GAS INJ.	BBLs. WATER INJECTED	CUMULATIVE WATER INJ.	AVG. INJ. PRESSURES
		UL	S	T	R					
Carper Johnson	1Y	G	35	16	31			7,634	585,992	2100
Carper Johnson	3Y	K	35	16	31			5,139	308,337	1800
KennedyJohnson	4	E	35	16	31			2,943	198,549	1900
KennedyJohnson	5	O	35	16	31			3,510	329,554	2200
KennedyJohnson	6	M	35	16	31			1,562	177,528	2200
Featherstone	5	C	2	17	31			5,291	47,761	2400
TOTAL								26,079	1,647,721	

PRODUCING WELLS (Attach additional sheets if necessary)

LEASE	WELL NO.	LOCATION				BBLs. OIL PRODUCED	MCF GAS PRODUCED	GOR	BBLs. WATER PRODUCED	% WATER PRODUCED
		UL	S	T	R					
Carper Johnson	2	H	35	16	31	391			293	43%
Carper Johnson	4	N	35	16	31	86			5,160	98
KennedyJohnson	1	F	35	16	31	458			2,290	83
KennedyJohnson	2	J	35	16	31	147			1,103	88
KennedyJohnson	3	L	35	16	31	213			3,728	95
Featherstone	1	G	2	17	31	122			-0-	
Featherstone	2	F	2	17	31	40			-0-	
Featherstone	3	B	2	17	31	85			-0-	
Featherstone	4	D	2	17	31	123			1,753	93
TOTAL						1665			14,327	

PRODUCING WELLS OUTSIDE A PRORATED WATERFLOOD PROJECT AREA WHICH ARE PRODUCING INTO COMMON FACILITIES WITH WELLS INSIDE A PRORATED WATERFLOOD PROJECT AREA (Attach additional sheets if necessary)

LEASE	WELL NO.	LOCATION				DATE OF TEST	LENGTH OF TEST	BARRELS PRODUCED	BARRELS PER DAY
		UL	S	T	R				

I hereby certify that the above information is true and complete to the best of my knowledge and belief.

Remarks: _____

NAME _____

TITLE _____

Agent

NEW MEXICO OIL CONSERVATION COMMISSION
GAS-OIL RATIO TESTS

C-116
Revised 1-1-65

Operator Ryder Scott Management Company		Pool Grayburg Jackson		County Eddy											
Address 922 - 8th Street, Wichita Falls, Texas 76301				Type of Test - (X) <input checked="" type="checkbox"/> Scheduled <input type="checkbox"/> Special <input checked="" type="checkbox"/>											
LEASE NAME	WELL NO.	LOCATION				DATE OF TEST	CHOKE SIZE	TBG. PRESS.	DAILY ALLOW-ABLE	LENGTH OF TEST HOURS	PROD. DURING TEST			GAS - OIL RATIO CU. FT./BBL.	
		U	S	T	R						WATER BBLs.	GRAV. OIL BBLs.	GAS M.C.F.		
Featherstone	2	F	2	17	31	9-28-66			2	24	0	36.3	2	1	.50
Featherstone	2	F	2	17	31	5-26-67			2	24	2.77	36.7	4.54	6	.75

No well will be assigned an allowable greater than the amount of oil produced on the official test.
During gas-oil ratio test, each well shall be produced at a rate not exceeding the top unit allowable for the pool in which well is located by more than 25 percent. Operator is encouraged to take advantage of this 25 percent tolerance in order that well can be assigned increased allowables when authorized by the Commission.

Gas volumes must be reported in MCF measured at a pressure base of 15.025 psia and a temperature of 60° F. Specific gravity base will be 0.60.

Report casing pressure in lieu of tubing pressure for any well producing through casing.
Mail original and one copy of this report to the district office of the New Mexico Oil Conservation Commission in accordance with Rule 301 and appropriate pool rules.

I hereby certify that the above information is true and complete to the best of my knowledge and belief.

Agent (Signature)

(Title)

6-21-67

(Date)

'67 JUN 13 AM 8 16

RYDER SCOTT MANAGEMENT COMPANY

922 EIGHTH STREET

PHONE (817) 723-5313

WICHITA FALLS, TEXAS

June 9, 1967

RECEIVED

JUN 12 1967

O. C. C.
ARTESIA, OFFICE

New Mexico Oil Conservation Commission
P. O. Box 2088
Santa Fe, New Mexico 87501

Re: Application to Convert
Featherstone State
Well No. 1 to Water
Injection

Gentlemen:

Under Oil Conservation Commission Order No. R-2270 dated June 21, 1962, Water Flood Associates, Inc. was granted permission to initiate waterflood operations in Section 35, T-16-S, R-31-E, Eddy County, N.M. Water injection on this project as specified in the above order was commenced on Sept. 13, 1962. Ryder Scott Management Company became operator of this flood project on October 1, 1966 and has operated the Featherstone lease in Sec. 2 since January, 1965.

This application is made to acquire administrative approval to expand this waterflood operation by converting to water injection the Ryder Scott Management Company Featherstone State Well No. 1 located 2310' FEL and 2310' FNL, Sec. 2, T-17-S, R-31-E, Grayburg Jackson Field, Eddy County. This well is a continuation of the regular pattern and only fresh water will be injected.

Since inception of the flood water has been and is currently being injected into four wells located in Sec. 35, T-16-S, R-31-E, and Featherstone well No. 5 located in Sec. 2, T-17-S, R-31-E, Eddy County. The attached Form C-120 shows the injection and producing wells with respective pertinent data.

Xerox copy to Jim Kopterman
6-12-67
Can find no objection
to this application
R. F. Starnes

OIL CONSERVATION COMMISSION

P. O. BOX 2088

SANTA FE, NEW MEXICO

June 15, 1967

C
O
P
Y

Ryder Scott Management Company
922 Eighth Street
Wichita Falls, Texas 76301

Attention: Mr. Donald T. May

Gentlemen:

Records of the New Mexico Oil Conservation Commission show Ryder Scott Management Company as operator of seven waterflood projects in the state. With that number of projects to manage, you should be familiar with the Rules and Regulations of the Oil Conservation Commission, particularly with Rule 701. If there is ever a question about the required procedures, please write or call the appropriate Commission office and assistance will be available.

One copy of your application to expand your Robinson Waterflood Project was received by this office, Rule 701 states: "submit in triplicate." Pertinent information was omitted from the schematic drawing and no indication was given that a copy of the application, complete with all attachments, has been sent to the State Engineer Office. Please revise your application.

A copy of the Rules and Regulations of the New Mexico Oil Conservation Commission, Revised June 1, 1966, is being sent under separate cover.

Very truly yours,

A. L. PORTER, Jr.
Secretary-Director

ALP/JEK/ocj

OIL CONSERVATION COMMISSION

P. O. BOX 2088

SANTA FE, NEW MEXICO

June 11, 1966

Robert Scott Management Company
122 Eighth Street
Wichita Falls, Texas 76091

Attention: Mr. Donald T. Kay

Dear Sir:

Records of the New Mexico Oil Conservation Commission show
Robert Scott Management Company as operator of seven waterflood
projects in the state. With that number of projects to manage,
you should be familiar with the Rules and Regulations of the Oil
Conservation Commission, particularly with Rule 101. If there
is ever a question about the required procedures, please write
to all the appropriate Commission office and assistance will be
available.

One copy of your application to expand your Robinson Water-
flood project was received by this office, Rule 101 states:
"submit in triplicate." Pertinent information was omitted from
the schematic drawing and no indication was given that a copy
of the application, complete with all attachments, has been
sent to the State Engineer Office. Please revise your applica-
tion.

A copy of the Rules and Regulations of the New Mexico
Oil Conservation Commission, Revised June 1, 1966, is being
sent under separate cover.

Very truly yours,

A. L. POWERS, JR.
Secretary-Director

ALP:VCK/vor

OIL CONSERVATION COMMISSION

Artesian DISTRICT II

OIL CONSERVATION COMMISSION
BOX 871
SANTA FE, NEW MEXICO

DATE 6-26-67

Re: Proposed NSP _____

Proposed NWU _____

Proposed NSL _____

Proposed NFO _____

Proposed DC _____

" WFX-264

Gentlemen:

I have examined the application dated 6-21-67
for the Ryder Scott Management Co. Featherstone State #1 6-2-17-31
Operator Lease and Well No. S-T-R

and my recommendations are as follows:

I can find no objection to this application

Yours very truly,

Bill Gressett

MAIL ROOM

67 JUN 27 AM 8 42

LARGE FORMAT
EXHIBIT HAS
BEEN REMOVED
AND IS LOCATED
IN THE NEXT FILE