

Mobil Producing Texas & New Mexico Inc.

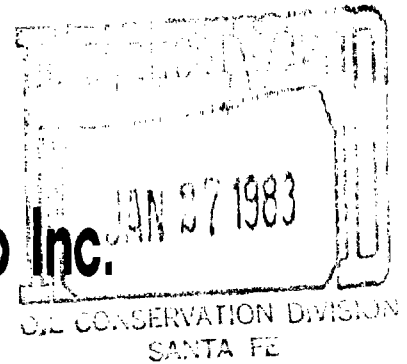

NINE GREENWAY PLAZA-SUITE 2700
HOUSTON, TEXAS 77046

January 25, 1983

Oil Conservation Division
P. O. Box 2088
Santa Fe, New Mexico 87501

Attention: J. D. Ramey

7.01
WATERFLOOD INJECTION WELL
MOBIL PRODUCING TX. & N.M. INC.
DENTON NORTH WOLFCAMP UNIT WELL #7-7
DENTON NORTH WOLFCAMP FIELD
LEA COUNTY, TEXAS

Gentlemen:

Mobil Producing Tx. & N.M. Inc. (MPTM) respectfully requests authority to inject production water down this wellbore into the Wolfcamp hydrocarbon formation and enlarge the area influenced by the waterflood in the Denton North Wolfcamp Unit. This expansion should ultimately recover more hydrocarbons than present methods.

The supporting information for this application is organized in accordance with Form C-108.

I have examined the available geological and engineering data and find no evidence of open faults or any other hydrological connection between the disposal zone and any underground source of drinking water.

Yours very truly,

A handwritten signature in cursive script, appearing to read "J. A. Morris".

J. A. Morris
Regulatory Engineering Supervisor

SDMarino:mma
Attachments

JAN 27 1983

APPLICATION FOR AUTHORIZATION TO INJECT

- I. Purpose: ☒ Secondary Recovery ☐ Pressure Maintenance ☐ Disposal ☐ Storage
Application qualifies for administrative approval? ☒ yes ☐ no

II. Operator: Mobil Producing Texas & New Mexico Inc.

Address: 9 Greenway Plaza, Suite 2700, Houston, TX 77046

Contact party: S. D. Marino Phone: 713-871-5351

III. Well data: Complete the data required on the reverse side of this form for each well proposed for injection. Additional sheets may be attached if necessary.

IV. Is this an expansion of an existing project? ☒ yes ☐ no
If yes, give the Division order number authorizing the project R 3001.

V. Attach a map that identifies all wells and leases within two miles of any proposed injection well with a one-half mile radius circle drawn around each proposed injection well. This circle identifies the well's area of review.

* VI. Attach a tabulation of data on all wells of public record within the area of review which penetrate the proposed injection zone. Such data shall include a description of each well's type, construction, date drilled, location, depth, record of completion, and a schematic of any plugged well illustrating all plugging detail.

VII. Attach data on the proposed operation, including:

1. Proposed average and maximum daily rate and volume of fluids to be injected;
2. Whether the system is open or closed;
3. Proposed average and maximum injection pressure;
4. Sources and an appropriate analysis of injection fluid and compatibility with the receiving formation if other than reinjected produced water; and
- ☒ 5. If injection is for disposal purposes into a zone not productive of oil or gas at or within one mile of the proposed well, attach a chemical analysis of the disposal zone formation water (may be measured or inferred from existing literature, studies, nearby wells, etc.).

*VIII. Attach appropriate geological data on the injection zone including appropriate lithologic detail, geological name, thickness, and depth. Give the geologic name, and depth to bottom of all underground sources of drinking water (aquifers containing waters with total dissolved solids concentrations of 10,000 mg/l or less) overlying the proposed injection zone as well as any such source known to be immediately underlying the injection interval.

IX. Describe the proposed stimulation program, if any.

* X. Attach appropriate logging and test data on the well. (If well logs have been filed with the Division they need not be resubmitted.)

* XI. Attach a chemical analysis of fresh water from two or more fresh water wells (if available and producing) within one mile of any injection or disposal well showing location of wells and dates samples were taken.

XII. Applicants for disposal wells must make an affirmative statement that they have examined available geologic and engineering data and find no evidence of open faults or any other hydrologic connection between the disposal zone and any underground source of drinking water.

XIII. Applicants must complete the "Proof of Notice" section on the reverse side of this form.

XIV. Certification

I hereby certify that the information submitted with this application is true and correct to the best of my knowledge and belief.

Name: J. A. Morris Title Reg. Engrg. Supervisor

Signature: J. A. Morris Date: January 25, 1983

* If the information required under Sections VI, VIII, X, and XI above has been previously submitted, it need not be duplicated and resubmitted. Please show the date and circumstance of the earlier submittal.

III. WELL DATA

A. The following well data must be submitted for each injection well covered by this application. The data must be both in tabular and schematic form and shall include:

- (1) Lease name; Well No.; location by Section, Township, and Range; and footage location within the section.
- (2) Each casing string used with its size, setting depth, sacks of cement used, hole size, top of cement, and how such top was determined.
- (3) A description of the tubing to be used including its size, lining material, and setting depth.
- (4) The name, model, and setting depth of the packer used or a description of any other seal system or assembly used.

Division District offices have supplies of Well Data Sheets which may be used or which may be used as models for this purpose. Applicants for several identical wells may submit a "typical data sheet" rather than submitting the data for each well.

B. The following must be submitted for each injection well covered by this application. All items must be addressed for the initial well. Responses for additional wells need be shown only when different. Information shown on schematics need not be repeated.

- (1) The name of the injection formation and, if applicable, the field or pool name.
- (2) The injection interval and whether it is perforated or open-hole.
- (3) State if the well was drilled for injection or, if not, the original purpose of the well.
- (4) Give the depths of any other perforated intervals and detail on the sacks of cement or bridge plugs used to seal off such perforations.
- (5) Give the depth to and name of the next higher and next lower oil or gas zone in the area of the well, if any.

XIV. PROOF OF NOTICE

All applicants must furnish proof that a copy of the application has been furnished, by certified or registered mail, to the owner of the surface of the land on which the well is to be located and to each leasehold operator within one-half mile of the well location.

Where an application is subject to administrative approval, a proof of publication must be submitted. Such proof shall consist of a copy of the legal advertisement which was published in the county in which the well is located. The contents of such advertisement must include:

- (1) The name, address, phone number, and contact party for the applicant;
- (2) the intended purpose of the injection well; with the exact location of single wells or the section, township, and range location of multiple wells;
- (3) the formation name and depth with expected maximum injection rates and pressures; and
- (4) a notation that interested parties must file objections or requests for hearing with the Oil Conservation Division, P. O. Box 2088, Santa Fe, New Mexico 87501 within 15 days.

NO ACTION WILL BE TAKEN ON THE APPLICATION UNTIL PROPER PROOF OF NOTICE HAS BEEN SUBMITTED.

NOTICE: Surface owners or offset operators must file any objections or requests for hearing of administrative applications within 15 days from the date this application was mailed to them.

INJECTION WELL DATA SHEET

Mobil Producing Texas & New Mexico Inc. Denton North Wolfcamp Unit
 OPERATOR LEASE
 7-7 1980'FSL & 1650'FWL 36 14S 37E
 WELL NO. FOOTAGE LOCATION SECTION TOWNSHIP RANGE

Schematic

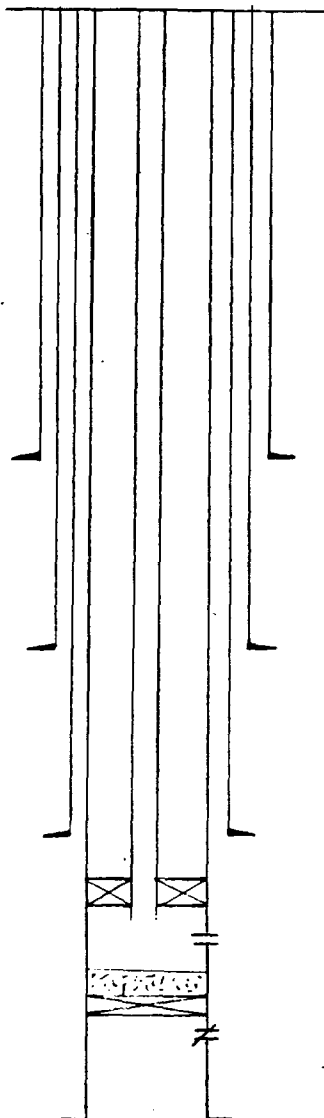

Tabular Data

Surface Casing

Size 13-3/8 " Cemented with 350 sx.
 TOC Surface feet determined by Circulation
 Hole size 17-1/4"

Intermediate Casing

Size 9-5/8 " Cemented with 2300 sx.
 TOC Surface feet determined by Circulation
 Hole size 12-3/4"

Intermediate Casing

Size 7-5/8 " Cemented with 200 sx.
 TOC 6030 feet determined by Temp. Survey
 Hole size 8-3/4"

Long String

Size 5-1/2 " Cemented with 600 sx.
 TOC 8658 feet determined by Temp. Survey
 Hole size 6-1/4"
 Total depth 12,640'

Injection Interval

9197 feet to 9286 feet
 (perforated or open-hole, indicate which)
PERFORATED

Tubing size 2-3/8" J-55 lined with Duoline PVC set in a
 (material)
5-1/2" Baker Lok Set packer at 9150 feet
 (brand and model)

(or describe any other casing-tubing seal).

Other Data

- Name of the injection formation Wolfcamp
- Name of Field or Pool (if applicable) Denton North Wolfcamp
- Is this a new well drilled for injection? ☐ Yes ☒ No

If no, for what purpose was the well originally drilled? Production from Devonian
Formation

- Has the well ever been perforated in any other zone(s)? List all such perforated intervals and give plugging detail (sacks of cement or bridge plug(s) used)
DEVONIAN: 12,317'-12,401'; 1 SPF, 20 Holes; to be isolated with CIBP @ 12,117' and
35' of class C neat cement.
- Give the depth to and name of any overlying and/or underlying oil or gas zones (pools) in this area. Devonian 12,270' oil zone

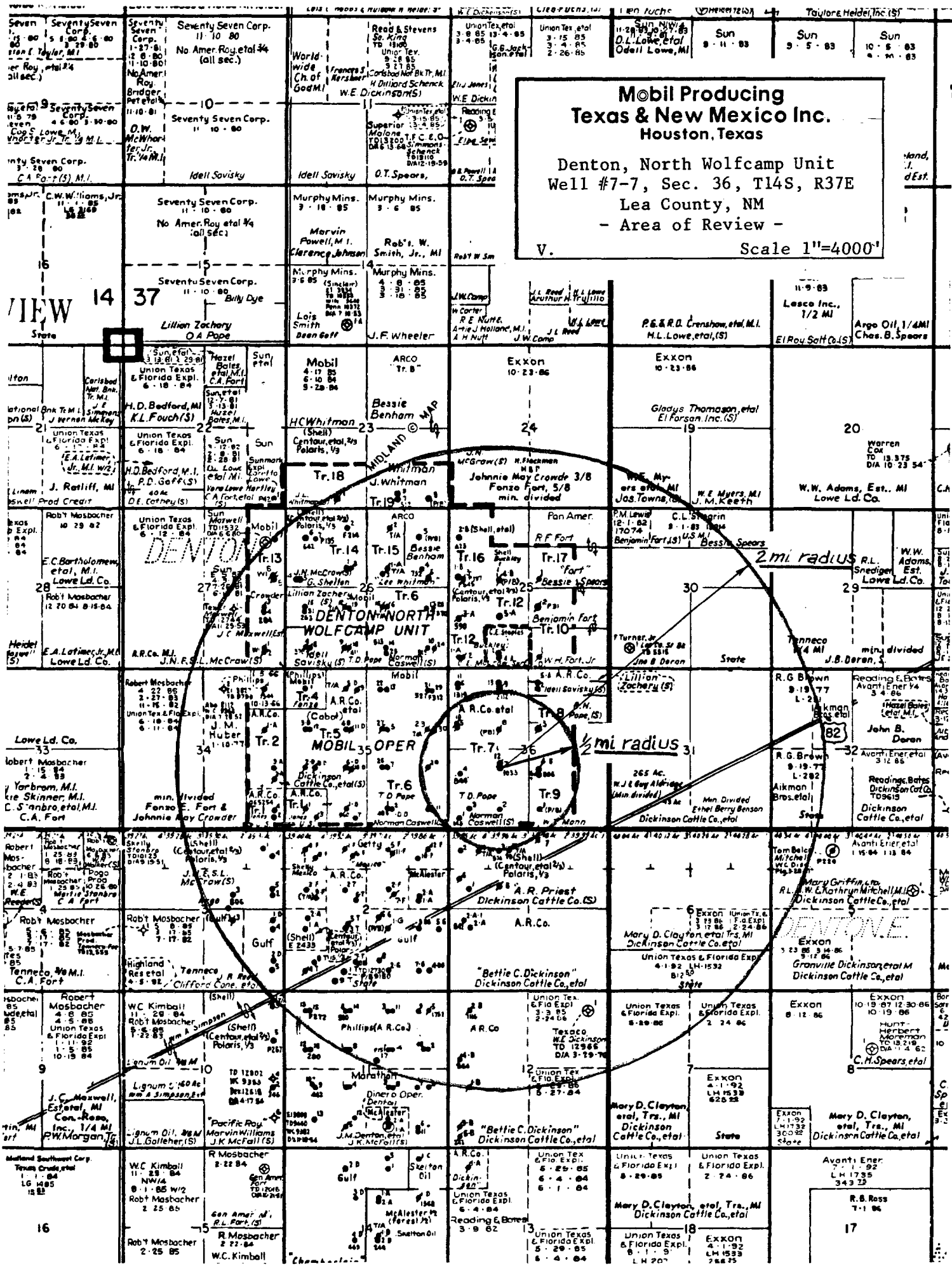

**Mobil Producing
Texas & New Mexico Inc.**
Houston, Texas

Denton, North Wolfcamp Unit
Well #7-7, Sec. 36, T14S, R37E
Lea County, NM
- Area of Review -

V. Scale 1"=4000'

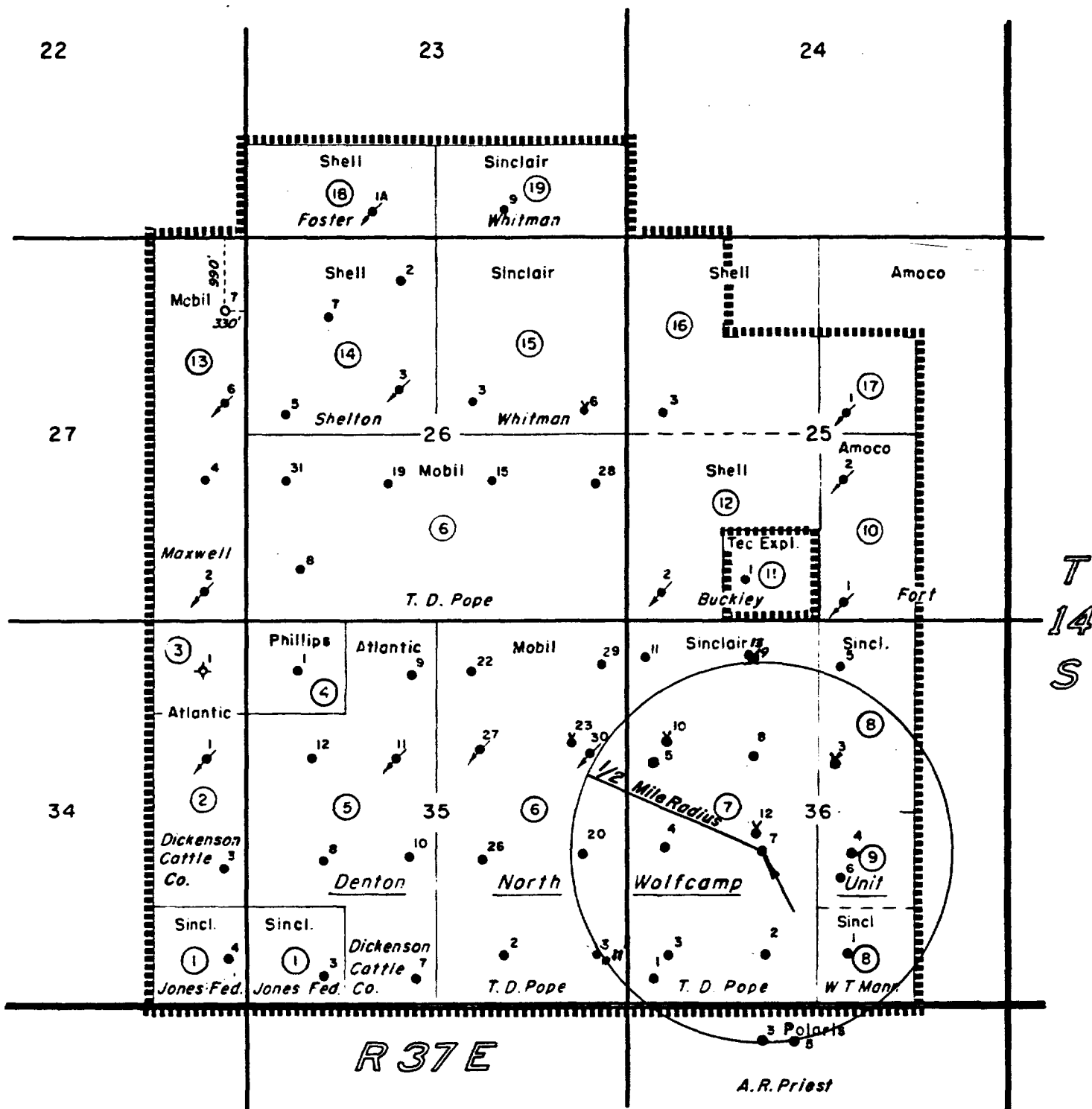

Reserve _____ Permit depth _____

Special Instructions Formerly named Arco T. D. Pope 7-7

Date work is commenced _____ 19____ Supt. _____

Location approved by _____ Plat by _____ Surveyed by _____

THE STATE OF NEW MEXICO
COUNTY OF LEA

I hereby certify that this plat truly represents conditions as they actually exist on this lease; that said plat which is drawn to the scale indicated hereon, is to the best of my knowledge true and correct; that it accurately shows said lease with all wells on same; that number and locations of said wells are as indicated hereon; and that this plat correctly reflects all pertinent and required data.

Mobil Producing Texas & New Mexico Inc.
Houston, Texas

LEASE DENTON NORTH WOLFCAMP UNIT

WELL NO. 7-7 DATE January 7, 19 83

DIVISION _____ LEASE NO. NM 623-C

TOTAL ACRES IN LEASE 2600 ACRES COVERED BY PLAT 2600

DESCRIPTION Out of Section 23, 25, 26, 27, 34, 35 & 36

T-14S R-37E

Lea County, New Mexico

DRAWN J.T. Roy
SCALE 1"=2000'

DATE 1-13-72
FILE NO. 69

FIELD DENTON-WOLFCAMP

Mobil Producing Texas & New Mexico Inc.
Denton North Wolfcamp Unit
Well No. 7-7
Sec. 36, T14S, R37E
1980' FSL & 1650' FWL

Tabulated Data of all producing wells on public record within area of review.

PRODUCING WELLS
OPERATOR

<u>WELL NO.</u>	<u>LOCATION</u>	<u>WELL TYPE</u>	<u>DATE DRILLED</u>	<u>DEPTH</u>	<u>COMPLETION INTERVAL</u>
POLARIS PRODUCTION COMPANY					
3 C	1-15S-37E	Oil	2/1/53	12,650'	Mississippian 11,670'-80'
5 C	1-15S-37E	Oil	2/18/53	9485'	Wolfcamp 9168'-9380'
ARCO					
4 J	36-14S-37E	Oil	5/28/55	12,630'	Devonian 12,499'-12,624'
6 J	36-14S-37E	Oil	9/20/55	9479'	Wolfcamp 9286'-9436'
1 M	36-14S-37E	Oil	5/3/53	12,640'	Devonian 12,278'-12,590'
5 E	36-14S-37E	Oil	12/22/53	12,643'	Devonian 12,128'-12,480'
8 F	36-14S-37E	Oil		12,640'	Wolfcamp 9212'-9450'
2 N	36-14S-37E	Oil	7/27/53	12,650'	Devonian 12,530'-12,635'
3 G	36-14S-37E	Oil	7/26/53	9313'	Wolfcamp 9185'-9274'
1 O	36-14S-37E	Oil	7/26/53	12,646'	Devonian 12,506'-12,647'
4 L	36-14S-37E	Oil	12/11/53	12,641'	Devonian 12,525'-12,615'
MOBIL PRODUCING TEXAS & NEW MEXICO INC.					
TR6 30 H	35-14S-37E	Oil	12/7/53	9370'	Wolfcamp 9179'-9209'
TR6 3 P	35-14S-37E	Oil	4/1/53	12,628'	Devonian 12,218'-12,628'
TR6 11 P	35-14S-37E	Oil	5/16/53	9263'	Wolfcamp 9179'-9217'
TR6 20 I	35-14S-37E	Oil	9/1/53	12,632'	Devonian 12,149'-12,615'

Information on construct of these wells is attached.

STATE OF NEW MEXICO
ENERGY AND MINERALS DEPARTMENT

OIL CONSERVATION DIVISION

P. O. BOX 2088

SANTA FE, NEW MEXICO 87501

WELL COMPLETION OR RECOMPLETION REPORT AND LOG

NO. OF COPIES RECEIVED	
DISTRIBUTION	
SANTA FE	
FILE	
U.S.G.S.	
LAND OFFICE	
OPERATOR	

5a. Indicate Type of Lease	
State <input type="checkbox"/>	Fee <input checked="" type="checkbox"/>
5. State Oil & Gas Lease No.	

1a. TYPE OF WELL				1b. TYPE OF COMPLETION				2. Name of Operator				3. Address of Operator				4. Location of Well				5a. Indicate Type of Lease				5. State Oil & Gas Lease No.							
<input checked="" type="checkbox"/> OIL WELL <input type="checkbox"/> GAS WELL <input type="checkbox"/> DRY <input type="checkbox"/> OTHER				<input type="checkbox"/> NEW WELL <input type="checkbox"/> WORK OVER <input type="checkbox"/> DEEPEN <input type="checkbox"/> PLUG BACK <input type="checkbox"/> DIFF. RESVR.				JAN 27 1983				Polaris Production Corp.				P.O. Box 1749, Midland, Tx. 79701				UNIT LETTER <u>C</u> LOCATED <u>660</u> FEET FROM THE <u>north</u> LINE AND <u>1650</u> FEET FROM THE <u>west</u> LINE OF SEC. <u>1</u> TWP. <u>15S</u> RGE. <u>37E</u> WMPM				7. Unit Agreement Name				8. Farm or Lease Name			
								OIL CONSERVATION DIVISION				SANTA FE								9. Well No.				10. Field and Pool, or Wildcat							
																				12. County				19. Elev. Casinghead							
15. Date Spudded				16. Date T.D. Reached				17. Date Compl. (Ready to Prod.)				18. Elevations (DF, RKB, RT, GR, etc.)				19. Elev. Casinghead															
9-28-52				2-1-53								3808 D.F.				NA															
20. Total Depth				21. Plug Back T.D.				22. If Multiple Compl., How Many				23. Intervals Drilled By				Rotary Tools				Cable Tools											
12650				12266				NA								NA				NA											
24. Producing Interval(s), of this completion - Top, Bottom, Name																25. Was Directional Survey Made															
Mississippian 11670-80																NA															
26. Type Electric and Other Log Run																27. Was Well Cored															
																NA															
28. CASING RECORD (Report all strings set in well)																															
CASING SIZE		WEIGHT LB./FT.		DEPTH SET		HOLE SIZE		CEMENTING RECORD								AMOUNT PULLED															
13 7/8		48		307		17 1/4		350 SX 7 TOC @																							
8 5/8		32		4760		11		3080 SX surface																							
5 1/2		15.5 x 17		12522		7 7/8		700 SX																							
29. LINER RECORD												30. TUBING RECORD																			
SIZE		TOP		BOTTOM		SACKS CEMENT		SCREEN		SIZE		DEPTH SET		PACKER SET																	
31. Perforation Record (Interval, size and number)												32. ACID, SHOT, FRACTURE, CEMENT SQUEEZE, ETC.																			
11670-80 45PF												DEPTH INTERVAL																			
												AMOUNT AND KIND MATERIAL USED																			
33. PRODUCTION																															
Date First Production				Production Method (Flowing, gas lift, pumping - Size and type pump)												Well Status (Prod. or Shut-in)															
Date of Test		Hours Tested		Choke Size		Prod'n. For Test Period		Oil - Bbl.		Gas - MCF		Water - Bbl.		Gas - Oil Ratio																	
Flow Tubing Press.		Casing Pressure		Calculated 24-Hour Rate		Oil - Bbl.		Gas - MCF		Water - Bbl.		Oil Gravity - API (Corr.)																			
34. Disposition of Gas (Sold, used for fuel, vented, etc.)																Test Witnessed By															
35. List of Attachments																															
36. I hereby certify that the information shown on both sides of this form is true and complete to the best of my knowledge and belief.																															
COPIED FROM HOBBS DISTRICT OFFICE																															
SIGNED				TITLE												DATE															

DATE 12-16-82 WELL NO. 3-C LEASE A.R. PRIEST FIELD DENTON (UNDESIGNATED)

LOCATION SEC. 1, T15S, R37E
660' FNL & 1650' FWL

SIGNED J. BOUBEL

G.L. NA
D.F. 3808'
K.B. NA
ZERO NA

13 3/8", 48 #/FT CSG. SET @ 307' W/ 350 SX. CMT, CIRC. TO SURFACE,
HOLE SIZE 17 1/4"

8 5/8", 32 #/FT CSG. SET @ 4760' W/ 3000 SX. CMT, CIRC. TO SURFACE,
HOLE SIZE 11"

← TOC @ 7752' (CALCULATED)

= MISSISSIPPIAN PERFS: 11670-11680, 45PF, TOTAL 40 HOLES

CIBP SET @ 12266'; CAPPED W/ 3 SX. CMT.

= DEVONIAN PERFS

5 1/2", 15.5 # & 17 #/FT CSG. SET @ 12522' W/ 700 SX, TOC @ 7752'
(CALCULATED), HOLE SIZE 7 7/8"
TD 12650'

STATE OF NEW MEXICO
ENERGY AND MINERALS DEPARTMENT

OIL CONSERVATION DIVISION

P. O. BOX 2088

SANTA FE, NEW MEXICO 87501

SANTA FE

WELL COMPLETION OR RECOMPLETION REPORT AND LOG

NO. OF COPIES RECEIVED	
DISTRIBUTION	
SANTA FE	
FILE	
U.S.G.S.	
LAND OFFICE	
OPERATOR	

5a. Indicate Type of Lease	State <input type="checkbox"/>	Fee <input checked="" type="checkbox"/>
5. State Oil & Gas Lease No.		

7. Unit Agreement Name

8. Farm or Lease Name

9. Well No.

10. Field and Pool, or Wildcat

12. County

19. Elev. Casinghead

25. Was Directional Survey Made

27. Was Well Cored

1a. TYPE OF WELL

b. TYPE OF COMPLETION

2. Name of Operator

3. Address of Operator

4. Location of Well

UNIT LETTER C LOCATED 660 FEET FROM THE north LINE AND 1980 FEET FROMTHE WEST LINE OF SEC. 1 TWP. 155 RGE. 37E NMPM

15. Date Spudded

1-24-53

16. Date T.D. Reached

3-17-53

17. Date Compl. (Ready to Prod.)

3-18-53

18. Elevations (DF, RKB, RT, GR, etc.)

3806' D.F.

20. Total Depth

9485

21. Plug Back T.D.

9413

22. If Multiple Compl., How Many

NA

23. Intervals Drilled By

NA

Rotary Tools

NA

Cable Tools

NA

24. Producing Interval(s), of this completion - Top, Bottom, Name

T.A. 12-1-81

26. Type Electric and Other Logs Run

NA

29. CASING RECORD (Report all strings set in well)

CASING SIZE	WEIGHT LB./FT.	DEPTH SET	HOLE SIZE	CEMENTING RECORD	AMOUNT PULLED
<u>13 3/8</u>	<u>48</u>	<u>355</u>	<u>17 1/4</u>	<u>350 SX</u>	
<u>8 5/8</u>	<u>32</u>	<u>4800</u>	<u>11</u>	<u>1700 SX</u>	
<u>5 1/2</u>	<u>15.5 + 17</u>	<u>9450</u>	<u>7 7/8</u>	<u>275 SX - TOC @ 8303</u>	

29. LINER RECORD

SIZE	TOP	BOTTOM	SACKS CEMENT	SCREEN

30. TUBING RECORD

SIZE	DEPTH SET	PACKER SET

31. Perforation Record (Interval, size and number)

Wolfcamp
9168-9180, 9200-9220,
9294-9320, 9365-9380
4 SPF

32. ACID, SHOT, FRACTURE, CEMENT SQUEEZE, ETC.

DEPTH INTERVAL	AMOUNT AND KIND MATERIAL USED

33. PRODUCTION

Date First Production	Production Method (Flowing, gas lift, pumping - Size and type pump)	Well Status (Prod. or Shut-in)
Date of Test	Hours Tested	Choke Size
Flow Tubing Press.	Casing Pressure	Calculated 24-Hour Rate

34. Disposition of Gas (Sold, used for fuel, vented, etc.)

Test Witnessed By

35. List of Attachments

36. I hereby certify that the information shown on both sides of this form is true and complete to the best of my knowledge and belief.

COPIED FROM HOBBS DISTRICT OFFICE

SIGNED

TITLE

DATE

DATE 12-16-82 WELL NO. 5-C LEASE A.R. PRIEST FIELD DENTON WOLFCAMP

LOCATION SEC. 1, T15S, R37E,
660' FNL & 1980' FNL

SIGNED J. BOUBEL

G.L. NA
D.F. 3806'
K.B. NA
ZERO NA

T.A.'d SINCE 12-1-81

13³/₈", 48 #/FT CSG. SET @ 355' W/ 350 SX. CMT, CIRC. TO SURFACE,
HOLE SIZE 17¹/₄"

8⁵/₈", 32 #/FT CSG. SET @ 4800' W/ 1700 SX. CMT, CIRC. TO SURFACE,
HOLE SIZE 11"

← TOC @ 8303' (TEMP. SURVEY)

WOLFCAMP: 9168-9180, 9200-9220, 9294-9320, 9365-9380,
4 SPF, TOTAL 292 HOLES

PBTD 9413'

5¹/₂", 15.5 # & 17 #/FT CSG. SET @ 9450' W/ 275 SX, TOC @ 8303' (BY
TEMP SURVEY), HOLE SIZE 7⁷/₈"

TD 9485'

STATE OF NEW MEXICO
ENERGY AND MINERALS DEPARTMENT

OIL CONSERVATION DIVISION

P. O. BOX 2088

SANTA FE, NEW MEXICO 87501

WELL COMPLETION OR RECOMPLETION REPORT AND LOG

NO. OF COPIES RECEIVED	
DISTRIBUTION	
SANTA FE	
FILE	
U.S.O.S.	
LAND OFFICE	
OPERATOR	

5a. Indicate Type of Lease	
State <input type="checkbox"/>	Fee <input checked="" type="checkbox"/>

5. State Oil & Gas Lease No.

7. Unit Agreement Name

8. Farm or Lease Name

W.T. Mann "B"

9. Well No.

10. Field and Pool, or Wildcat

Denton Devonian

12. County

Tia

1a. TYPE OF WELL

b. TYPE OF COMPLETION

NEW WELL ☐ WORK OVER ☐OIL WELL ☒GAS WELL ☐DRY ☐DEEPEN ☐PLUG BACK ☐DIFF. RESVR. ☐OTHER ☐

SANTA FE

2. Name of Operator

3. Address of Operator

4. Location of Well

UNIT LETTER J LOCATED 1980 FEET FROM THE South LINE AND 2310 FEET FROMTHE East LINE OF SEC. 36 TWP. 14S RGE. 37E NMPM

15. Date Spudded

2-4-55

16. Date T.D. Reached

5-27-55

17. Date Compl. (Ready to Prod.)

5-28-55

18. Elevations (DF, RKB, RT, GR, etc.)

3800' D.F.

19. Elev. Casinghead

20. Total Depth

12630

21. Plug Back T.D.

12625

22. If Multiple Compl., How Many

NA

23. Intervals Drilled By

NA

Rotary Tools

NA

Cable Tools

NA

24. Producing Interval(s), of this completion - Top, Bottom, Name

Devonian 12499-12624

25. Was Directional Survey Made

NA

26. Type Electric and Other Logs Run

NA

27. Was Well Cored

NA

28. CASING RECORD (Report all strings set in well)

CASING SIZE	WEIGHT LB./FT.	DEPTH SET	HOLE SIZE	CEMENTING RECORD	AMOUNT PULLED
13 3/8	48	311	17 1/4	375 SX.	
9 5/8	36 + 40	4789	12 1/4	2200 SX. - TOC @ 960'	
7	26, 29, 32	12630	8 3/4	600 SX. - @ 5641	

29. LINER RECORD

SIZE	TOP	BOTTOM	SACKS CEMENT	SCREEN

30. TUBING RECORD

SIZE	DEPTH SET	PACKER SET

31. Perforation Record (Interval, size and number)

12499-12624 - 15PF

32. ACID, SHOT, FRACTURE, CEMENT SQUEEZE, ETC.

DEPTH INTERVAL	AMOUNT AND KIND MATERIAL USED

33. PRODUCTION

Date First Production		Production Method (Flowing, gas lift, pumping - Size and type pump)				Well Status (Prod. or Shut-in)	
Date of Test	Hours Tested	Choke Size	Prod'n. Per Test Period	Oil - Bbl.	Gas - MCF	Water - Bbl.	Gas - Oil Ratio
Flow Tubing Press.	Casing Pressure	Calculated 24-Hour Rate	Oil - Bbl.	Gas - MCF	Water - Bbl.	Oil Gravity - API (Corr.)	

34. Disposition of Gas (Sold, used for fuel, vented, etc.)

Test Witnessed By

35. List of Attachments

36. I hereby certify that the information shown on both sides of this form is true and complete to the best of my knowledge and belief.

COPIED FROM HOBBS DISTRICT OFFICE

SIGNED _____ TITLE _____ DATE _____

DATE 12-16-82 WELL NO. 4-J LEASE ARCO-W.T. MANN "B" FIELD DENTON DEVONIAN

LOCATION SEC. 36, T14S, R37E,
1980' FSL & 2310' FEL

SIGNED J. BOUBEL

G.L. NA
D.F. 3800'
K.B. NA
ZERO NA

13 3/8", 48 #/FT CSG. SET @ 311' W/ 375 SX. CMT, CIRC. TO
SURFACE, HOLE SIZE 17 1/4"

← TOC @ 960' (TEMP. SURVEY)

9 5/8", 36 & 40 #/FT CSG. SET @ 4789' W/ 2200 SX. CMT, TOC
@ 960' (TEMP. SURVEY), HOLE SIZE 12 1/4"

← TOC @ 5641' (TEMP. SURVEY)

= DEVONIAN : 12499'-12624', 4 SPF, TOTAL 500 HOLES

PBTD 12625'

7", 26, 29 & 32 #/FT CSG. SET @ 12630' W/ 600 SX. CMT, TOC @ 5641'
(TEMP. SURVEY), HOLE SIZE 8 3/4"

TD 12630'

NEW MEXICO OIL CONSERVATION COMMISSION
Santa Fe, New Mexico

WELL RECORD

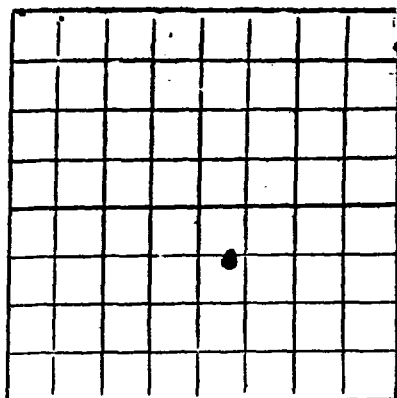

AREA 640 ACRES
LOCATE WELL CORRECTLY

Mail to District Office, Oil Conservation Commission, to which Form C-101 was sent not later than twenty days after completion of well. Follow instructions in Rules and Regulations of the Commission. Submit in QUINTUPLICATE.

Sinclair Oil & Gas Company (Company or Operator) W. T. Mann "B" (Lease)
Well No. 6, in N. 1/4 of SE 1/4, of Sec. 36, T. 14, R. 37, NMPM.
Denton Pool, Lea County.
Well is 1830 feet from South line and 2310 feet from East line of Section 36. If State Land the Oil and Gas Lease No. is
Drilling Commenced 4:00 PM, August 15, 1955. Drilling was Completed September 20, 1955.
Name of Drilling Contractor Westlund Drilling Company
Address Midland, Texas
Elevation above sea level at Top of Tubing Head 3800. The information given is to be kept confidential until 19.

OIL SANDS OR ZONES

No. 1, from 9286 to 9436 No. 4, from to
No. 2, from to No. 5, from to
No. 3, from to No. 6, from to

IMPORTANT WATER SANDS

Include data on rate of water inflow and elevation to which water rose in hole.

No. 1, from to feet.
No. 2, from to feet.
No. 3, from to feet.
No. 4, from to feet.

CASING RECORD

SIZE	WEIGHT PER FOOT	NEW OR USED	AMOUNT	KIND OF SHOE	CUT AND PULLED FROM	PERFORATIONS	PURPOSE
13 3/8	48	N	304				
9 5/8	40 & 36	N	4790	Larkin			
7	29, 26 & 23	N	9498	Halliburton		9286-9436	Oil Production
2 1/2"	6.5	N	9479				

MUDDING AND CEMENTING RECORD

SIZE OF HOLE	SIZE OF CASING	WHERE SET	NO. SACKS OF CEMENT	METHOD USED	MUD GRAVITY	AMOUNT OF MUD USED
17 1/2	13 3/8	307	515	Halliburton		
12 1/2	9 5/8	4790	2400	Halliburton		
8 3/4	7	9498	125	Halliburton		
	2 1/2"	9479				

RECORD OF PRODUCTION AND STIMULATION

(Record the Process used, No. of Qts. or Gals. used, interval treated or shot.)

9-26-55 acidized with 1000 gal. mud acid 9248-9485 by Western. 9-27-55 acidized with 3000 gal. reg. acid 9248-9485 by Western.

Result of Production Stimulation There was no natural production. Potential after acidizing was 257 B.P.D.
Depth Cleaned Out

STATE OF NEW MEXICO
ENERGY AND MINERALS DEPARTMENT

OIL CONSERVATION DIVISION

P. O. BOX 2088

SANTA FE, NEW MEXICO 87501

WELL COMPLETION OR RECOMPLETION REPORT AND LOG

NO. OF COPIES RECEIVED	
DISTRIBUTION	
SANTA FE	
FILE	
U.S.G.S.	
LAND OFFICE	
OPERATOR	

5a. Indicate Type of Lease	
State <input type="checkbox"/>	Fee <input type="checkbox"/>
5. State Oil & Gas Lease No.	

1a. TYPE OF WELL		OIL WELL <input checked="" type="checkbox"/> GAS WELL <input type="checkbox"/> DRY <input type="checkbox"/>		1b. TYPE OF COMPLETION	
				NEW WELL <input type="checkbox"/> WORK OVER <input type="checkbox"/> DEEPEN <input type="checkbox"/> PLUG BACK <input type="checkbox"/> DIFF. RESVR. <input type="checkbox"/> OTHER <input type="checkbox"/>	
2. Name of Operator <i>Arco</i>				7. Unit Agreement Name <i>OIL CONSERVATION DIVISION</i>	
3. Address of Operator				8. Farm or Lease Name <i>T.D. Pope</i>	
4. Location of Well				9. Well No. <i>1</i>	
UNIT LETTER <i>M</i> LOCATED <i>330</i> FEET FROM THE <i>South</i> LINE AND <i>330</i> FEET FROM				10. Field and Pool, or Wildcat <i>Devonian</i>	
THE <i>West</i> LINE OF SEC. <i>36</i> TWP. <i>14S</i> RGE. <i>37E</i> N14W1				12. County <i>Lea</i>	
15. Date Spudded <i>12-12-52</i>	16. Date T.D. Reached <i>4-19-53</i>	17. Date Compl. (Ready to Prod.) <i>5-3-53</i>	18. Elevations (DF, RKB, RT, GR, etc.) <i>3800' GR</i>	19. Elev. Casinghead <i>3798'</i>	
20. Total Depth <i>12640</i>	21. Plug Back T.D. <i>12603</i>	22. If Multiple Compl., How Many <i>NA</i>	23. Intervals Drilled By <i>NA</i>	Rotary Tools <i>NA</i>	Cable Tools <i>NA</i>
24. Producing Interval(s), of this completion - Top, Bottom, Name <i>Devonian 12278-12590</i>				25. Was Directional Survey Made <i>NA</i>	
26. Type Electric and Other Logs Run <i>NA</i>				27. Was Well Cored <i>NA</i>	

CASING RECORD (Report all strings set in well!)

CASING SIZE	WEIGHT LB./FT.	DEPTH SET	HOLE SIZE	CEMENTING RECORD	AMOUNT PULLED
<i>13 3/8</i>	<i>36</i>	<i>316</i>	<i>17 1/4</i>	<i>400 SX.</i>	
<i>8 5/8</i>	<i>32.429</i>	<i>4767</i>	<i>11</i>	<i>1700 SX.</i>	
<i>5 1/2</i>	<i>20.417</i>	<i>12639</i>	<i>7 7/8</i>	<i>900 SX.</i>	

29. LINER RECORD					30. TUBING RECORD		
SIZE	TOP	BOTTOM	SACKS CEMENT	SCREEN	SIZE	DEPTH SET	PACKER SET

31. Perforation Record (Interval, size and number) <i>12460-590</i> <i>12278-440</i>	32. ACID, SHOT, FRACTURE, CEMENT SQUEEZE, ETC.	
	DEPTH INTERVAL	AMOUNT AND KIND MATERIAL USED

33. PRODUCTION							
Date First Production		Production Method (Flowing, gas lift, pumping - Size and type pump)				Well Status (Prod. or Shut-in)	
Date of Test	Hours Tested	Choke Size	Prod'n. For Test Period	Oil - Bbl.	Gas - MCF	Water - Bbl.	Gas - Oil Ratio
Flow Tubing Press.	Casing Pressure	Calculated 24-Hour Rate	Oil - Bbl.	Gas - MCF	Water - Bbl.	Oil Gravity - API (Corr.)	

34. Disposition of Gas (Sold, used for fuel, vented, etc.)	Test Witnessed By
--	-------------------

35. List of Attachments

36. I hereby certify that the information shown on both sides of this form is true and complete to the best of my knowledge and belief.

COPIED FROM HARRIS DISTRICT OFFICE

SIGNED

TITLE

DATE

DATE 12-20-82 WELL NO. 1-M LEASE ARCO-T.D. POPE FIELD DENTON DEVONIAN

LOCATION SEC. 36, T14S, R37E
330' FSL & 330' FWL

SIGNED J. BOUBEL

G.L. 3800'
D.F. NA
K.B. NA
ZERO NA

13 3/8", 36 #/FT CSG. SET @ 316' W/ 400 SX. CMT, CIRC.
TO SURFACE, HOLE SIZE 17 1/4"

8 5/8", 24 & 32 #/FT CSG. SET @ 4767' W/ 1700 SX. CMT,
CIRC. TO SURFACE, HOLE SIZE 11"

← TOC @ 6133' (ESTIMATED)

= DEVONIAN: 12278'-12440', 12460'-12590', 4SPF, TOTAL 1168 HOLES

PBTD 12603'

5 1/2", 17 & 20 #/FT CSG. SET @ 12639' W/ 900 SX. CMT, TO C
@ 6133' (ESTIMATED), HOLE SIZE 7 7/8"

TD 12640'

STATE OF NEW MEXICO
ENERGY AND MINERALS DEPARTMENT

OIL CONSERVATION DIVISION

P. O. BOX 2088

SANTA FE, NEW MEXICO 87501

WELL COMPLETION OR RECOMPLETION REPORT AND LOG

NO. OF COPIES RECEIVED	
DISTRIBUTION	
SANTA FE	
FILE	
U.S.G.S.	
LAND OFFICE	
OPERATOR	

5a. Indicate Type of Lease	
State <input type="checkbox"/>	Fee <input checked="" type="checkbox"/>
5. State Oil & Gas Lease No.	

7. Unit Agreement Name

8. Farm or Lease Name

9. Well No.

10. Field and Pool, or Wildcat

12. County

15. Date Spudded

16. Date T.D. Reached

17. Date Compl. (Ready to Prod.)

18. Elevations (DF, RKB, RT, GR, etc.)

19. Elev. Casinghead

20. Total Depth

21. Plug Back T.D.

22. If Multiple Compl., How Many

23. Intervals Drilled By

24. Producing Interval(s), of this completion - Top, Bottom, Name

25. Was Directional Survey Made

26. Type Electric and Other Logs Run

27. Was Well Cored

28. CASING RECORD (Report all strings set in well)

29. LINER RECORD

30. TUBING RECORD

31. Perforation Record (Interval, size and number)

32. ACID, SHOT, FRACTURE, CEMENT SQUEEZE, ETC.

33. PRODUCTION

34. Disposition of Gas (Sold, used for fuel, vented, etc.)

35. List of Attachments

36. I hereby certify that the information shown on both sides of this form is true and complete to the best of my knowledge and belief.

SIGNED _____ TITLE _____ DATE _____

DATE 12-20-82 WELL NO. 5-E LEASE ARCO-T.D. POPE FIELD DENTON DEVONIAN

LOCATION SEC. 36, T14S, R37E,
330' FWL & 1980' FNL

SIGNED J. BOUBEL

G.L. 3803'
D.F. NA
K.B. NA
ZERO NA

13³/₈" 48 #/FT CSG. SET @ 311' W/ 350 SX. CMT, CIRC. TO
SURFACE, HOLE SIZE 17¹/₄"

9⁵/₈" 36 #/FT CSG. SET @ 4774' W/ 2454 SX., CIRC. TO
SURFACE, HOLE SIZE 12³/₄"

← TOC @ 8585' (TEMP. SURVEY)

= DEVONIAN: 12128'-203', 12430'-480', 4SPF, TOTAL 100 HOLES

PBTD 12502'

7" 29 #/FT CSG. SET @ 12642' W/ 700 SX. CMT, TOC @ 8585'
(TEMP. SURVEY), HOLE SIZE 8³/₄"

TD 12643'

COMPLETION: ARCO T.D. POPE * B DUNNAN TO MPTM DNWL * 7-B WOLFCAMP
EASE: DENTON NORTH WOLFCAMP UNIT * 7-B
FIELD: DENTON WOLFCAMP
LOCATION: 1980' FNL & 1650' FWL SECTION 36 T-14-S R-37-E
LEA COUNTY, N.M.

PRESENT COMPLETION
SKETCH

G.L. - 3801'

D.P. - 3816'

13 7/8" - 36" SET @ 314' W/ 350 SX
(CMT CIRCULATED)
HOLE SIZE - 17 1/4"

← TDC @ 2060' BY TEMP SURVEY

DOWNHOLE EQUIPMENT

9450 - 2 7/8" J-SS BRD EYE TBG

2 7/8" X 7" TBG ANCHOR

← 9 5/8" - 40 1/2" 36" SET @ 4778' W/ 2480 SX
HOLE SIZE - 12 1/4"

← TDC @ 8640' BY TEMP SURVEY

PROPOSED WOLFCAMP PERFS (FROM SIMULTANEOUS RADIATION LOG)
9212 - 9450 (99 HOLES)

TDC 9600'
CIBP SET @ 9620' - CAPPED W/ 10 SX CAL-SEAL

7" - SET @ 12640' W/ 875 SX
23" - 0 - 3803'
26" - 3803' - 6928'
29" - 6928' - 10392'
32" - 10392' - 12640'

M.L. MORRIS
10/22/81

STATE OF NEW MEXICO
ENERGY AND MINERALS DEPARTMENT

OIL CONSERVATION DIVISION

P. O. BOX 2088

SANTA FE, NEW MEXICO 87501

WELL COMPLETION OR RECOMPLETION REPORT AND LOG

NO. OF COPIES RECEIVED	
DISTRIBUTION	
SANTA FE	
FILE	
U.S.O.S.	
LAND OFFICE	
OPERATOR	

5a. Indicate Type of Lease	
State <input type="checkbox"/>	Fee <input checked="" type="checkbox"/>
5. State Oil & Gas Lease No.	

1a. TYPE OF WELL OIL WELL <input checked="" type="checkbox"/> GAS WELL <input type="checkbox"/> DRY <input type="checkbox"/> OTHER <input type="checkbox"/>										7. Unit Agreement Name	
b. TYPE OF COMPLETION NEW WELL <input type="checkbox"/> WORK OVER <input type="checkbox"/> DEEPEN <input type="checkbox"/> PLUG BACK <input type="checkbox"/> DIFF. RESVR. <input type="checkbox"/> OTHER <input type="checkbox"/>										8. Farm or Lease Name T.D. Pope	
2. Name of Operator Anco										9. Well No. 2	
3. Address of Operator										10. Field and Pool, or Wildcat Denton Devorian	
4. Location of Well UNIT LETTER <u>N</u> LOCATED <u>1650</u> FEET FROM THE <u>west</u> LINE AND <u>660</u> FEET FROM THE <u>South</u> LINE OF SEC. <u>36</u> TWP. <u>14S</u> RGE. <u>37E</u> NMPM										12. County Yea	
15. Date Spudded 1-4-53		16. Date T.D. Reached 7-26-53		17. Date Compl. (Ready to Prod.) 7-27-53		18. Elevations (DF, RKB, RT, GR, etc.) 3800' G.R.		19. Elev. Casinghead NA			
20. Total Depth 12650		21. Plug Back T.D. 12647		22. If Multiple Compl., How Many NA		23. Intervals Drilled By Rotary Tools		Cable Tools			
24. Producing Interval(s), of this completion - Top, Bottom, Name T.A. 'd since 2-18-80								25. Was Directional Survey Made			
26. Type Electric and Other Logs Run								27. Was Well Cored			
28. CASING RECORD (Report all strings set in well)											
CASING SIZE		WEIGHT LB./FT.		DEPTH SET		HOLE SIZE		CEMENTING RECORD		AMOUNT PULLED	
13 3/8		48		313		17 1/4		300 SX			
9 5/8		40, 36		4768		12 1/4		1700 SX			
7		32, 24, 26, 23		12649		8 3/4		600 SX.			
29. LINER RECORD						30. TUBING RECORD					
SIZE		TOP		BOTTOM		SACKS CEMENT		SCREEN		SIZE	
										DEPTH SET	
										PACKER SET	
31. Perforation Record (Interval, size and number) 12630-12635						32. ACID, SHOT, FRACTURE, CEMENT SQUEEZE, ETC.					
						DEPTH INTERVAL		AMOUNT AND KIND MATERIAL USED			
33. PRODUCTION											
Date First Production		Production Method (Flowing, gas lift, pumping - Size and type pump)						Well Status (Prod. or Shut-in)			
Date of Test		Hours Tested		Choke Size		Prod'n. For Test Period		Oil - Bbl.		Gas - MCF	
								Water - Bbl.		Gas - Oil Ratio	
Flow Tubing Press.		Casing Pressure		Calculated 24-Hour Rate		Oil - Bbl.		Gas - MCF		Water - Bbl.	
										Oil Gravity - API (Corr.)	
34. Disposition of Gas (Sold, used for fuel, vented, etc.)										Test Witnessed By	
35. List of Attachments											
36. I hereby certify that the information shown on both sides of this form is true and complete to the best of my knowledge and belief. COPIED FROM HOBBS DISTRICT OFFICE											
SIGNED				TITLE				DATE			

DATE 12-20-82 WELL NO. 2-N LEASE ARCO - T.D. POPE FIELD DENTON DEVONIAN

LOCATION SEC. 36, T14S, R37E
1650' FWL & 660' FSL

SIGNED J. BOUBEL

G.L. 3800'
D.F. NA
K.B. NA
ZERO NA

13 3/8", 48 #/FT CSG. SET @ 313' W/ 300 SX. CMT, CIRC.
TO SURFACE, HOLE SIZE 17 1/4"

9 5/8", 36 & 40 #/FT CSG. SET @ 4768' W/ 1700 SX. CMT, CIRC.
TO SURFACE, HOLE SIZE 12 1/4"

← TOC @ 5650' (ESTIMATED)

= DEVONIAN: 12530' - 12635', 4SPF, TOTAL 420 HOLES

PBTD 12647'

7", 23, 26, 29, & 32 #/FT CSG. SET @ 12649' W/ 600 SX. CMT, TOC
@ 5650' (ESTIMATED), HOLE SIZE 8 3/4"

TD 12650'

Grid for well location. A small dot is marked in the bottom-left corner of the grid.

NEW MEXICO OIL CONSERVATION COMMISSION
Santa Fe, New Mexico
OIL CONSERVATION COMMISSION
WELL RECORD

RECEIVED
DEC 21 1953
HOBBS-OFFICE

Mail to District Office, Oil Conservation Commission, to which Form C-101 was sent not later than twenty days after completion of well. Follow instructions in Rules and Regulations of the Commission. Submit in QUINTUPLICATE.

AREA 640 ACRES
LOCATE WELL CORRECTLY

Sinclair Oil & Gas Company

T. D. Pope

(Company or Operator)

(Lease)

Well No. 3, in SW 1/4 of SW 1/4, of Sec. 36, T. 14-S, R. 37 E, NMPM.

Denton (Wolfcamp) Pool, Lea County.

Well is 660 feet from South line and 660 feet from West line of Section 36. If State Land the Oil and Gas Lease No. is

Drilling Commenced 6-3, 1953. Drilling was Completed 7-26, 1953.

Name of Drilling Contractor: Warren Bradshaw Exploration Company

Address: Tulsa, Oklahoma

Elevation above sea level at Top of Tubing Head 3799. The information given is to be kept confidential until 19

OIL SANDS OR ZONES

No. 1, from 9185 to 9274. No. 4, from to
No. 2, from to. No. 5, from to
No. 3, from to. No. 6, from to

IMPORTANT WATER SANDS

Include data on rate of water inflow and elevation to which water rose in hole.

No. 1, from to feet.
No. 2, from to feet.
No. 3, from to feet.
No. 4, from to feet.

CASING RECORD

SIZE	WEIGHT PER FOOT	NEW OR USED	AMOUNT	KIND OF SHOE	CUT AND PULLED FROM	PERFORATIONS	PURPOSE
13 3/8	48	N	323	Larkin			
8 5/8	24-32	N	4775	"			
5 1/2	15-17	N	9313	"			
2" UE	4.7	N	7500	"			

MUDDING AND CEMENTING RECORD

SIZE OF HOLE	SIZE OF CASING	WHERE SET	NO. SACKS OF CEMENT	METHOD USED	MUD GRAVITY	AMOUNT OF MUD USED
17 1/2	13 3/8	324	350	Halliburton		
11	8 5/8	4777	2000	"		
7 7/8	5 1/2	9313	200	"		

RECORD OF PRODUCTION AND STIMULATION

(Record the Process used, No. of Qts. or Gals. used, interval treated or shot.)

Treated pay section with 22,000 gallons of acid

Result of Production Stimulation: Pumped 172 barrels of oil in 24 hours on potential test.

Orig: & Acc: OGC

Depth Cleaned Out: 9289

cc: VDA, JTR, EGC, HAM, F

NEW MEXICO OIL CONSERVATION COMMISSION

Santa Fe, New Mexico

WELL RECORD

Mail to District Office, Oil Conservation Commission, to which Form C-101 was sent not later than twenty days after completion of well. Follow instructions in Rules and Regulations of the Commission. Submit in QUINTUPLICATE.

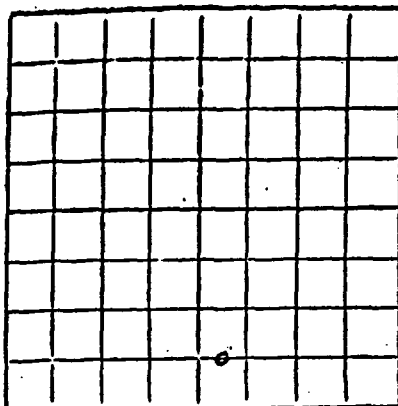

AREA 640 ACRES
LOCATE WELL CORRECTLY

Sinclair Oil & Gas Company
(Company or Operator)

H. F. Mann

(Lease)

Well No. 1, in SW $\frac{1}{4}$ of SE $\frac{1}{4}$ of Sec. 36, T. 14S, R. 37E, NMPM.

Darton

Pool,

Loca

County.

Well is 660 feet from South line and 2310 feet from East line

of Section 36. If State Land the Oil and Gas Lease No. is

Drilling Commenced 4/6/53, 19. Drilling was Completed 7/26/53, 19.

Name of Drilling Contractor Warren & Bradshaw

Address Tulsa Oklahoma

Elevation above sea level at Top of Tubing Head 3797. The information given is to be kept confidential until

19.

OIL SANDS OR ZONES

No. 1, from 12506 to 12647 No. 4, from to

No. 2, from to No. 5, from to

No. 3, from to No. 6, from to

IMPORTANT WATER SANDS

Include data on rate of water inflow and elevation to which water rose in hole.

No. 1, from None to feet.

No. 2, from to feet.

No. 3, from to feet.

No. 4, from to feet.

CASING RECORD

SIZE	WEIGHT PER FOOT	NEW OR USED	AMOUNT	KIND OF SHOE	CUT AND PULLED FROM	PERFORATIONS	PURPOSE
13 3/8	110	New	302				
9 5/8	36	New	1797	Larkin			
7"	23	New	12616	"			
2 7/8	6.5	New	12631				

MUDDING AND CEMENTING RECORD

SIZE OF HOLE	SIZE OF CASING	WHERE SET	NO. BAGS OF CEMENT	METHOD USED	MUD GRAVITY	AMOUNT OF MUD USED
17 1/2	13 3/8	305	325	Halliburton		
12 1/2	9 5/8	1799	2200	"		
8 3/4	7	12616	550	"		
8 3/4	2 7/8	12631				

RECORD OF PRODUCTION AND STIMULATION

(Record the Process used, No. of Qts. or Gals. used, interval treated or shot.)

Acidized w/1,000 Gall. of Mud acid, 3,000 Gal. of 15% Unisol, 8,000 Gal. of Dowell X-20

SEP 1 1953

Result of Production Stimulation. After 1,000 Gal. treatment flowed 124 Bbl. in 6 hrs., After 3,000 Gal. treatment flowed 725 Bbl. in 24 hrs., After 8,000 Gal. treatment flowed 153 Bbl. in 4 hrs.

Depth Cleaned Out

STATE OF NEW MEXICO
ENERGY AND MINERALS DEPARTMENT

OIL CONSERVATION DIVISION
P. O. BOX 2088
SANTA FE, NEW MEXICO 87501

Form C-105
Revised 10-1-78

NO. OF COPIES RECEIVED	
DISTRIBUTION	
SANTA FE	
FILE	
U.S.G.S.	
LAND OFFICE	
OPERATOR	

WELL COMPLETION OR RECOMPLETION REPORT AND LOG

5a. Indicate Type of Lease
State ☐ Fee ☒

5. State Oil & Gas Lease No.

1a. TYPE OF WELL
OIL WELL ☒ GAS WELL ☐ DRY ☐ OTHER ☐

b. TYPE OF COMPLETION
NEW WELL ☐ WORK OVER ☐ DEEPEN ☐ PLUG BACK ☐ DIFF. RESVR. ☐ OTHER ☐

7. Unit Agreement Name

8. Farm or Lease Name
T.D. Pope

2. Name of Operator
ARCO

3. Address of Operator

9. Well No.
4

4. Location of Well
UNIT LETTER L LOCATED 330 FEET FROM THE west LINE AND 1815 FEET FROM

10. Field and Pool or Wildcat
Denton Devonian

THE South LINE OF SEC. 36 TWP. 14S RGE. 37E NMPM

12. County
Lea

15. Date Spudded 8-29-53 16. Date T.D. Reached 12-10-53 17. Date Compl. (Ready to Prod.) 12-11-53

18. Elevations (DF, RKB, RT, GR, etc.) 3800' G.R. 19. Elev. Casinghead NA

20. Total Depth 12641 21. Plug Back T.D. 12634 22. If Multiple Compl., How Many NA

23. Intervals Drilled By Rotary Tools NA Cable Tools NA

24. Producing Interval(s), of this completion - Top, Bottom, Name
T.A.'d since 2-14-80

25. Was Directional Survey Made NA

26. Type Electric and Other Logs Run NA

27. Was Well Cored NA

28. CASING RECORD (Report all strings set in well)

CASING SIZE	WEIGHT LB./FT.	DEPTH SET	HOLE SIZE	CEMENTING RECORD	AMOUNT PULLED
13 3/8	48	317	17 1/4	350 SX	
9 5/8	36	4765	12 3/4	2816 SX	
7	32, 29, 26, 23, 35	12641	8 3/4	600 SX. - TOC @ 8660	

29. LINER RECORD				30. TUBING RECORD			
SIZE	TOP	BOTTOM	SACKS CEMENT	SCREEN	SIZE	DEPTH SET	PACKER SET

31. Perforation Record (Interval, size and number)
12525-615

32. ACID, SHOT, FRACTURE, CEMENT SQUEEZE, ETC.
DEPTH INTERVAL AMOUNT AND KIND MATERIAL USED

33. PRODUCTION
Date First Production Production Method (Flowing, gas lift, pumping - Size and type pump) Well Status (Prod. or Shut-in)

Date of Test Hours Tested Choke Size Prod'n. For Test Period Oil - Bbl. Gas - MCF Water - Bbl. Gas - Oil Ratio

Flow Tubing Press. Casing Pressure Calculated 24-Hour Rate Oil - Bbl. Gas - MCF Water - Bbl. Oil Gravity - API (Corr.)

34. Disposition of Gas (Sold, used for fuel, vented, etc.) Test Witnessed By

35. List of Attachments

36. I hereby certify that the information shown on both sides of this form is true and complete to the best of my knowledge and belief.

COPIED FROM HOBBS DISTRICT OFFICE

SIGNED TITLE DATE

DATE 12-20-82 WELL NO. 4-L LEASE ARCO - T.D. POPE FIELD DENTON DEVONIAN

LOCATION SEC. 36, T4S, R37E,
330' FWL & 1815' FSL

SIGNED J. BOUBEL

G.L. 3800'
D.F. NA
K.B. NA
ZERO NA

13 3/8", 48 #/FT CSG. SET @ 317' W/ 350 SK. CMT, CIRC. TO
SURFACE, HOLE SIZE 17 1/4"

9 5/8", 36 #/FT CSG. SET @ 4765' W/ 2816 SK. CMT, CIRC. TO
SURFACE, HOLE SIZE 12 3/4"

= DEVONIAN: 12525'-12615', 4 SPF, TOTAL 360 HOLES

PBTD 12634'

7", 23, 26, 29, 32, & 35 #/FT CSG. SET @ 12641' W/ 600 SK. CMT,
TOC @ 8660' (TEMP. SURVEY), HOLE SIZE 8 3/4"

TD 12641'

OIL CONSERVATION DIVISION

P. O. BOX 2088

SANTA FE, NEW MEXICO 87501

WELL COMPLETION OR RECOMPLETION REPORT AND LOG

NO. OF COPIES RECEIVED	
DISTRIBUTION	
SANTA FE	
FILE	
U.S.G.S.	
LAND OFFICE	
OPERATOR	

5a. Indicate Type of Lease	
State <input type="checkbox"/>	Fee <input checked="" type="checkbox"/>
5. State Oil & Gas Lease No.	

1a. TYPE OF WELL	
OIL WELL <input type="checkbox"/>	GAS WELL <input type="checkbox"/>
DRY <input type="checkbox"/>	OTHER <u>WTR. inj</u>
b. TYPE OF COMPLETION	
NEW WELL <input type="checkbox"/>	WORK OVER <input type="checkbox"/>
DEEPEN <input type="checkbox"/>	PLUG BACK <input type="checkbox"/>
DIFF. RESVR. <input type="checkbox"/>	OTHER <input type="checkbox"/>

7. Unit Agreement Name
8. Farm or Lease Name
9. Well No.

2. Name of Operator
3. Address of Operator

10. Field and Pool, or Wildcat

4. Location of Well
UNIT LETTER <u>4</u> LOCATED <u>1980</u> FEET FROM THE <u>north</u> LINE AND <u>460</u> FEET FROM

12. County

THE <u>east</u> LINE OF SEC. <u>35</u> TWP. <u>4S</u> RGE. <u>3TE</u> NMPM
--

12. County

15. Date Spudded	16. Date T.D. Reached	17. Date Compl. (Ready to Prod.)	18. Elevations (DF, RKB, RT, GR, etc.)	19. Elev. Casinghead
<u>10-13-53</u>	<u>11-30-53</u>	<u>12-7-53</u>	<u>3806' G.L.</u>	<u>NA</u>

20. Total Depth	21. Plug Back T.D.	22. If Multiple Compl., How Many	23. Intervals Drilled By	Rotary Tools	Cable Tools
<u>9370'</u>	<u>9368'</u>	<u>NA</u>	<u>NA</u>	<u>NA</u>	<u>NA</u>

24. Producing Interval(s), of this completion - Top, Bottom, Name	25. Was Directional Survey Made
<u>injecting</u> <u>Wolfcamp 9179'-9209'</u>	<u>Yes</u>

26. Type Electric and Other Logs Run	27. Was Well Cored
<u>NA</u>	<u>NA</u>

28. CASING RECORD (Report all strings set in well)					
CASING SIZE	WEIGHT LB./FT.	DEPTH SET	HOLE SIZE	CEMENTING RECORD	AMOUNT PULLED
<u>10 3/4"</u>	<u>32.75</u>	<u>459</u>	<u>15"</u>	<u>450 SX.</u>	
<u>7 5/8"</u>	<u>24 + 26.4</u>	<u>4778</u>	<u>9 7/8"</u>	<u>1927 SX.</u>	
<u>5 1/2"</u>	<u>17</u>	<u>9370</u>	<u>6 3/4"</u>	<u>625 SX.</u>	

29. LINER RECORD				30. TUBING RECORD			
SIZE	TOP	BOTTOM	SACKS CEMENT	SCREEN	SIZE	DEPTH SET	PACKER SET
<u>5 1/2"</u>	<u>4587</u>	<u>9370</u>	<u>625 SX.</u>	<u>NA</u>			

31. Perforation Record (Interval, size and number)	32. ACID, SHOT, FRACTURE, CEMENT SQUEEZE, ETC.	
	DEPTH INTERVAL	AMOUNT AND KIND MATERIAL USED

33. PRODUCTION							
Date First Production		Production Method (Flowing, gas lift, pumping - Size and type pump)				Well Status (Prod. or Shut-in)	
Date of Test	Hours Tested	Choke Size	Prod'n. For Test Period	Oil - Bbl.	Gas - MCF	Water - Bbl.	Gas - Oil Ratio
Flow Tubing Press.	Casing Pressure	Calculated 24-Hour Rate	Oil - Bbl.	Gas - MCF	Water - Bbl.	Oil Gravity - API (Corr.)	

34. Disposition of Gas (Sold, used for fuel, vented, etc.)	Test Witnessed By
--	-------------------

35. List of Attachments

36. I hereby certify that the information shown on both sides of this form is true and complete to the best of my knowledge and belief.		
<u>COPIED FROM HOBBS DISTRICT OFFICE</u>		
SIGNED	TITLE	DATE

DATE 12-21-82

WELL NO. 30

LEASE MOBILE - WOLFCAMP UNIT FIELD DENTON NORTH
DENTON WOLFCAMP

LOCATION SEC. 35, T14S, R37E,
1980' FNL & 460' FEL

SIGNED J. BOUBEL

G.L. 3806'

D.F. 3819'

K.B. N/A

ZERO N/A

$10\frac{3}{4}"$, 32.75 #/FT SET @ 459' W/ 535 SX. CMT, CIRC. TO SURFACE

TOP OF LINER @ 4587'

$7\frac{5}{8}"$, 24 #/FT CSG. SET @ 4778' W/ 2291 SX. CMT, CIRC. TO SURFACE

= WOLFCAMP : 9179' - 9326', TOTAL 180 HOLES

PBTD 9368'

$5\frac{1}{2}"$, 17 #/FT LINER SET @ 9370' W/ 475 SX. CMT, CIRC. TO TOP
OF LINER

TD 9370'

STATE OF NEW MEXICO
ENERGY AND MINERALS DEPARTMENT

OIL CONSERVATION DIVISION

P. O. BOX 2088
SANTA FE, NEW MEXICO 87501

WELL COMPLETION OR RECOMPLETION REPORT AND LOG

NO. OF COPIES RECEIVED	
DISTRIBUTION	
SANTA FE	
FILE	
U.S.G.S.	
LAND OFFICE	
OPERATOR	

5a. Indicate Type of Lease	
State <input type="checkbox"/>	Fee <input checked="" type="checkbox"/>

5. State Oil & Gas Lease No.

7. Unit Agreement Name

8. Farm or Lease Name

T.D. Pope

9. Well No.

3

10. Field and Pool, or Wildcat

Denton Devonian

12. County

Lea

1a. TYPE OF WELL

b. TYPE OF COMPLETION

NEW WELL ☐ WORK OVER ☐OIL WELL ☒GAS WELL ☐DRY ☐

OTHER

DEEPEN ☐PLUG BACK ☐DIFF. RESVR. ☐

OTHER

2. Name of Operator

Mobil

3. Address of Operator

4. Location of Well

UNIT LETTER P LOCATED 660 FEET FROM THE SOUTH LINE AND 660 FEET FROMTHE east LINE OF SEC. 35 TWP. 14S RGE. 37E NMPM

15. Date Spudded

12-4-52

16. Date T.D. Reached

3-31-53

17. Date Compl. (Ready to Prod.)

4-1-53

18. Elevations (DF, RKB, RT, GR, etc.)

3806' G.L.

19. Elev. Casinghead

NA

20. Total Depth

12628'

21. Plug Back T.D.

12628'

22. If Multiple Compl., How Many

NA

23. Intervals Drilled By

NA

Rotary Tools

NA

Cable Tools

NA

24. Producing Interval(s), of this completion - Top, Bottom, Name

Devonian 12218'-12628'

25. Was Directional Survey Made

NA

26. Type Electric and Other Logs Run

NA

27. Was Well Cored

NA

28. CASING RECORD (Report all strings set in well)

CASING SIZE	WEIGHT LB./FT.	DEPTH SET	HOLE SIZE	CEMENTING RECORD	AMOUNT PULLED
13 3/8"	35.6	450	17 1/2"	425 SX.	
8 7/8"	32	4805	11"	3600 SX.	
5 1/2"	17	12628	7 7/8"	750 SX.	

29. LINER RECORD

SIZE	TOP	BOTTOM	SACKS CEMENT	SCREEN
5 1/2"	4610'	12628'	750 SX.	NA

30. TUBING RECORD

SIZE	DEPTH SET	PACKER SET

31. Perforation Record (Interval, size and number)

12218-12628
254 feet
1016 holes

32. ACID, SHOT, FRACTURE, CEMENT SQUEEZE, ETC.

DEPTH INTERVAL	AMOUNT AND KIND MATERIAL USED

33. PRODUCTION

Date First Production	Production Method (Flowing, gas lift, pumping - Size and type pump)	Well Status (Prod. or Shut-in)
Date of Test	Hours Tested	Choke Size
Flow Tubing Press.	Casing Pressure	Calculated 24-Hour Rate
Prod'n. For Test Period	Oil - Bbl.	Gas - MCF
Water - Bbl.	Gas - Oil Ratio	
Oil - Bbl.	Gas - MCF	Water - Bbl.
Oil Gravity - API (Corr.)		

34. Disposition of Gas (Sold, used for fuel, vented, etc.)

Test Witnessed By

35. List of Attachments

36. I hereby certify that the information shown on both sides of this form is true and complete to the best of my knowledge and belief.

COPIED FROM NOBBS DISTRICT OFFICE

SIGNED

TITLE

DATE

DATE 12-21-82 WELL NO. 3 LEASE MOBIL - T.D. POPE FIELD DENTON DEVONIAN

LOCATION SEC. 35, T14S, R37E
660' FSL & 660' FEL

SIGNED J. BOUBEL

G.L. 3806'
D.F. NA
K.B. NA
ZERO NA

13 3/8", 35 1/4 #/FT CSG. SET @ 450' W/ 425 SX. CMT, CIRC.
TO SURFACE, HOLE SIZE 17 1/2"

TDP OF LINER @ 4610' SQ. W/ 250 SX. CMT.

8 5/8", 32 #/FT CSG. SET @ 4805' W/ 2200 SX. CMT., CIRC. TO SURFACE,
HOLE SIZE 11"

← TOC @ 8790' (TEMP. SURVEY)

== DEVONIAN : 12218' - 12628', TOTAL 254 FEET - 1016 HOLES

5 1/2", 17 1/2 #/FT LINER SET @ 12628' W/ 600 SX. CMT, TOC @
8790' (TEMP. SURVEY), HOLE SIZE 7 7/8"

TD 12628'

Santa Fe, New Mexico

WELL RECORD

AREA 640 ACRES
LOCATE WELL CORRECTLY

tion, to which Form C-101 was sent not
 follow instructions in Rules and Regulations

RECEIVED
 JUN 19 1953
 (Lease) INFORMATION COMMISSION
 RECORDS OFFICE

feet from _____ line

No. 1, from 6279 to 9037 No. 4, from _____ to _____
No. 2, from _____ to _____ No. 5, from _____ to _____
No. 3, from _____ to _____ No. 6, from _____ to _____

Include data on rate of water inflow and elevation to which water rose in hole.

No. 1, from 100 to 100 feet.

No. 2, from 100 to 100 feet.

No. 3, from 100 to 100 feet.

No. 4, from 100 to 100 feet.

SIZE	WEIGHT PER FOOT	NEW OR USED	AMOUNT	KIND OF SHOE	CUT AND PULLED FROM	PERFORATIONS	PURPOSE
10 1/2	5.75	NEW	4.00				1-100-1000
11 1/2	5.75	NEW	4.00				1-100-1000
5 1/2	5.75	NEW	4.00			100-1000	100-1000

SIZE OF HOLE	SIZE OF CASING	WHERE SET	NO. SACKS OF CEMENT	METHOD USED	MUD GRAVITY	AMOUNT OF MUD USED
2 1/2"	2 1/2"	4-7	40	10 1/2" x 10 1/2"		
3 1/2"	3 1/2"	4-8	40	10 1/2" x 10 1/2"		
4 1/2"	4 1/2"	4-9	40	10 1/2" x 10 1/2"		

(Record the Process used, No. of Qts. or Gals. used, interval treated or shot.)

Result of Production Stimulation.....

Depth Cleaned Out.....

OIL CONSERVATION DIVISION
P. O. BOX 2088
SANTA FE, NEW MEXICO 87501

NO. OF COPIES RECEIVED	
DISTRIBUTION	
SANTA FE	
FILE	
U.S.O.S.	
LAND OFFICE	
OPERATOR	

WELL COMPLETION OR RECOMPLETION REPORT AND LOG

5a. Indicate Type of Lease
State ☐ Fee ☐

5. State Oil & Gas Lease No.

7. Unit Agreement Name

8. Farm or Lease Name

9. Well No.

10. Field and Pool, or Wildcat

12. County

10. TYPE OF WELL

b. TYPE OF COMPLETION

2. Name of Operator

3. Address of Operator

4. Location of Well

UNIT LETTER I LOCATED 660 FEET FROM THE east LINE AND 1980 FEET FROM

THE south LINE OF SEC. 35 TWP. 14S RGE. 37E NMPM

15. Date Spudded 5-23-53 16. Date T.D. Reached 8-19-53 17. Date Compl. (Ready to Prod.) 9-1-53 18. Elevations (DF, RKB, RT, GR, etc.) 3801' G.L. 19. Elev. Casinghead NA

20. Total Depth 12632' 21. Plug Back T.D. 12630' 22. If Multiple Compl., How Many NA 23. Intervals Drilled By NA Rotary Tools NA Cable Tools NA

24. Producing Interval(s), of this completion - Top, Bottom, Name

25. Was Directional Survey Made

26. Type Electric and Other Logs Run

27. Was Well Cored

28. CASING RECORD (Report all strings set in well)

CASING SIZE	WEIGHT LB./FT.	DEPTH SET	HOLE SIZE	CEMENTING RECORD	AMOUNT PULLED
13 3/8"	48	439	17 1/2"	475 SX.	
8 5/8"	32	4850	11"	2180 SX.	
5 1/2"	17	12632	7 7/8"	1000 SX.	

29. LINER RECORD

SIZE	TOP	BOTTOM	SACKS CEMENT	SCREEN
5 1/2"	4706	12632	1000 SX	

30. TUBING RECORD

SIZE	DEPTH SET	PACKER SET

31. Perforation Record (Interval, size and number)

12149-12615, 4 SPF,
820 HOLES

32. ACID, SHOT, FRACTURE, CEMENT SQUEEZE, ETC.

DEPTH INTERVAL	AMOUNT AND KIND MATERIAL USED

33. PRODUCTION

Date First Production	Production Method (Flowing, gas lift, pumping - Size and type pump)	Well Status (Prod. or Shut-in)
Date of Test	Hours Tested	Choke Size
Prod'n. For Test Period	Oil - Bbl.	Gas - MCF
Water - Bbl.	Gas - Oil Ratio	
Flow Tubing Press.	Casing Pressure	Calculated 24-Hour Rate
Oil - Bbl.	Gas - MCF	Water - Bbl.
Oil Gravity - API (Corr.)		

34. Disposition of Gas (Sold, used for fuel, vented, etc.)

Test Witnessed By

35. List of Attachments

36. I hereby certify that the information shown on both sides of this form is true and complete to the best of my knowledge and belief.

COPIED FROM HOBBS DISTRICT OFFICE

SIGNED _____ TITLE _____ DATE _____

DATE 12-7-82

WELL NO. 20

WELL 1.0. POPE

WELL 1.0. POPE

LEA CO., N.M.

LOCATION SEC. 35, T4S, R37E

660' FEL & 1980' FSL

SIGNED J. BOUBEL

G.L. 3801'

D.F. NA

K.B. 3818'

ZERO G.L.

PRESENT COMPLETION

13³/₈" 48#/FT, H40 CSG. SET @ 439' w/ 475 SX.
CMT, CIRC. TO SURFACE, 17¹/₂" HOLE

TOP OF LINER @ 4706'. SQ. w/ 190 SX.

8⁵/₈" 32#/FT, J-55 CSG. SET @ 4850' w/ 2180 SX. CMT,
CIRC. TO SURFACE, 11" HOLE

← TOC @ 5626' (TEMP. SURVEY)

± DEVONIAN: 1249-12615 w/ 4SPF, TOTAL 820 HOLES

PBTD 12630'

5¹/₂" 17#/FT (149 JTS-5344'), 19.8#/FT (71 JTS-2546'),
20#/FT (1 JT-36'), N-80 CSG. SET @ 12632'
w/ 1000 SX. CMT, TOC (TEMP. SURVEY) @ 5626',
7⁷/₈" HOLE

17³/₈" #/FT
10050'
19.8 #/FT
12596'
20 #/FT

Mobil Producing Texas & New Mexico Inc.
Denton North Wolfcamp Unit
Well No. 7-7
Sec. 36, T14S, R37E
1980' FSL & 1650' FWL

Tabulated data of all plugged and abandoned wells on public record within area of review.

PLUGGED WELLS
OPERATOR

<u>WELL NUMBER</u>	<u>LOCATION</u>	<u>DATE DRILLED</u>	<u>DEPTH</u>
MOBIL PRODUCING TX. & N.M. INC.			
TR7 10	36-14S-37E		9370'
TR8 3 G	36-14S-37E		12,641'
ARCO			
TR8 12 K	36-14S-37E	11/21/54	9470'

Sketch & Construction Data found on attachments for these wells.

STATE OF NEW MEXICO
ENERGY AND MINERALS DEPARTMENT

OIL CONSERVATION DIVISION

P. O. BOX 2088

SANTA FE, NEW MEXICO 87501

WELL COMPLETION OR RECOMPLETION REPORT AND LOG

NO. OF COPIES RECEIVED	
DISTRIBUTION	
SANTA FE	
FILE	
U.S.G.S.	
LAND OFFICE	
OPERATOR	

5a. Indicate Type of Lease	
State <input type="checkbox"/>	Fee <input type="checkbox"/>
5. State Oil & Gas Lease No.	

1a. TYPE OF WELL										7. Unit Agreement Name									
b. TYPE OF COMPLETION										8. Farm or Lease Name									
NEW WELL <input type="checkbox"/> WORK OVER <input type="checkbox"/> DEEPEN <input type="checkbox"/> PLUG BACK <input type="checkbox"/> DIFF. RESVR. <input type="checkbox"/> OTHER <input type="checkbox"/>										Denton N. Wolfcamp Unit									
2. Name of Operator										9. Well No.									
Mobil										10 - Tract 7									
3. Address of Operator										10. Field and Pool, or Wildcat									
4. Location of Well										Denton Wolfcamp									
UNIT LETTER _____ LOCATED 1830 FEET FROM THE north LINE AND 330 FEET FROM										12. County									
THE west LINE OF SEC. 36 TWP. 14S RGE. 37E NMPM										Lea									
15. Date Spudded										16. Date T.D. Reached									
17. Date Compl. (Ready to Prod.)										18. Elevations (DF, RKB, RT, GR, etc.)									
										3805' G.L.									
20. Total Depth										21. Plug Back T.D.									
9370										9364'									
22. If Multiple Compl., How Many										23. Intervals Drilled By									
NA										NA									
24. Producing Interval(s), of this completion - Top, Bottom, Name										25. Was Directional Survey Made									
P & A										NA									
26. Type Electric and Other Logs Run										27. Was Well Cored									
NA										NA									
28. CASING RECORD (Report all strings set in well)																			
CASING SIZE		WEIGHT LB./FT.		DEPTH SET		HOLE SIZE		CEMENTING RECORD						AMOUNT PULLED					
13 3/8		35.6		319		17 1/2		350 SX.											
9 5/8		36 + 45		4759		12 1/4		2850 SX.											
7		23 + 26		9370		8 3/4		125 SX.											
29. LINER RECORD										30. TUBING RECORD									
SIZE		TOP		BOTTOM		SACKS CEMENT		SCREEN		SIZE		DEPTH SET		PACKER SET					
31. Perforation Record (Interval, size and number)										32. ACID, SHOT, FRACTURE, CEMENT SQUEEZE, ETC.									
9146-9346 P & A										DEPTH INTERVAL									
										AMOUNT AND KIND MATERIAL USED									
33. PRODUCTION																			
Date First Production				Production Method (Flowing, gas lift, pumping - Size and type pump)												Well Status (Prod. or Shut-in)			
Date of Test		Hours Tested		Choke Size		Prod'n. For Test Period		Oil - Bbl.		Gas - MCF		Water - Bbl.		Gas - Oil Ratio					
Flow Tubing Press.		Casing Pressure		Calculated 24-Hour Rate		Oil - Bbl.		Gas - MCF		Water - Bbl.		Oil Gravity - API (Corr.)							
34. Disposition of Gas (Sold, used for fuel, vented, etc.)														Test Witnessed By					
35. List of Attachments																			
36. I hereby certify that the information shown on both sides of this form is true and complete to the best of my knowledge and belief.																			
COPIED FROM MORRIS DISTRICT OFFICE																			
SIGNED _____				TITLE _____								DATE _____							

DATE 12-20-82 WELL NO. 10 LEASE DENTON NORTH WOLF CAMP FIELD DENTON WOLF CAMP
UNIT

LOCATION SEC. 36, T14S, R37E,
1830' FNL & 330' FWL

SIGNED J. BOUBEL

G.L. 3805'
D.F. 3816'
K.B. NA
ZERO NA

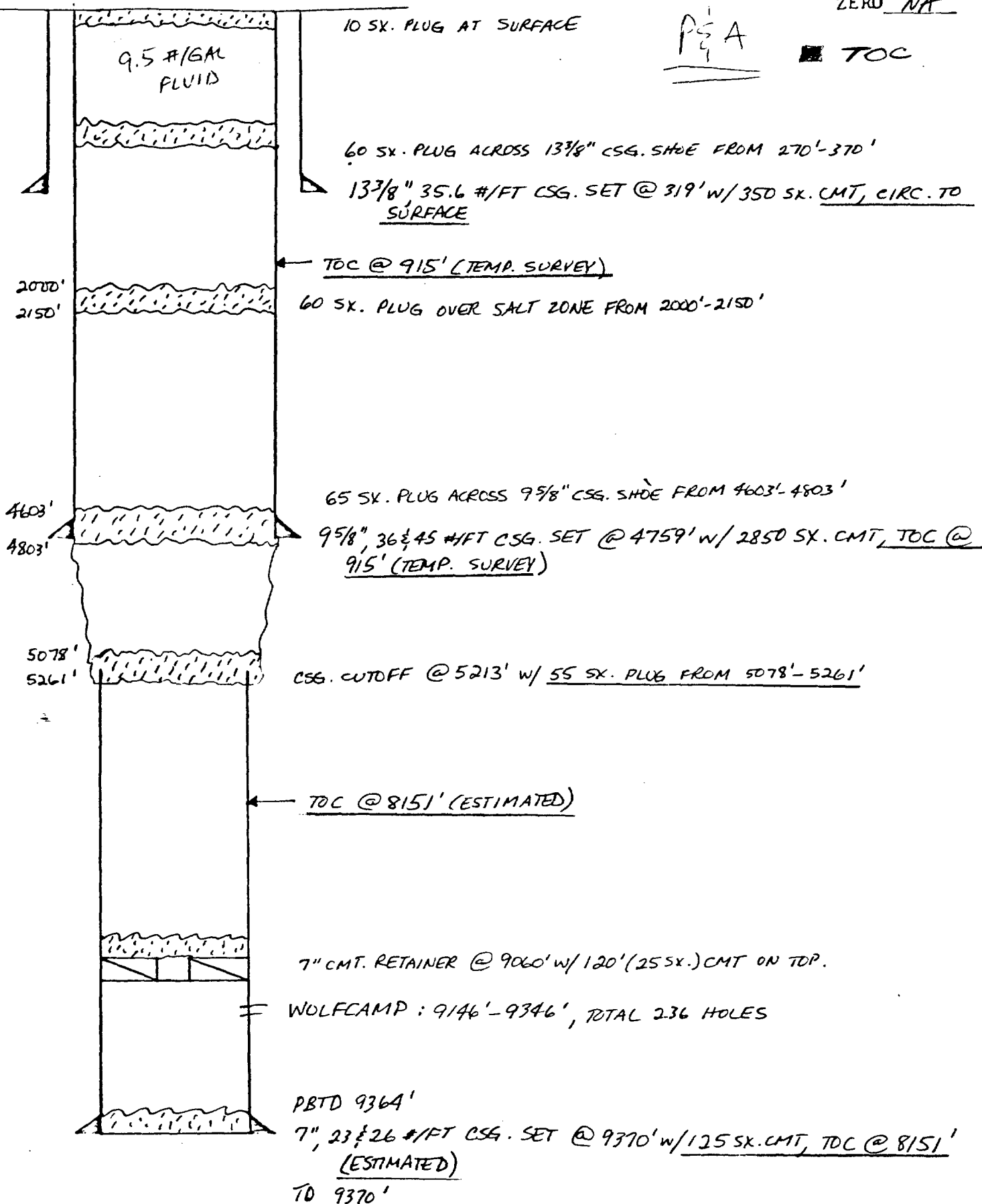

OIL CONSERVATION DIVISION

P. O. BOX 2088
SANTA FE, NEW MEXICO 87501

WELL COMPLETION OR RECOMPLETION REPORT AND LOG

NO. OF COPIES RECEIVED	
DISTRIBUTION	
SANTA FE	
FILE	
U.S.G.S.	
LAND OFFICE	
OPERATOR	

5a. Indicate Type of Lease	
State <input type="checkbox"/>	Fee <input checked="" type="checkbox"/>
5. State Oil & Gas Lease No.	

1a. TYPE OF WELL		OIL WELL <input type="checkbox"/> GAS WELL <input type="checkbox"/> DRY <input type="checkbox"/> OTHER <u>PA injector</u>	
b. TYPE OF COMPLETION		NEW WELL <input type="checkbox"/> WORK OVER <input type="checkbox"/> DEEPEN <input type="checkbox"/> PLUG BACK <input type="checkbox"/> DIFF. RESVR. <input type="checkbox"/> OTHER	
2. Name of Operator <u>Mobil</u>		7. Unit Agreement Name	
3. Address of Operator		8. Farm or Lease Name <u>Denton N. Wolfcamp Unit</u>	
4. Location of Well		9. Well No. <u>3 - Tract 8</u>	
UNIT LETTER <u>G</u> LOCATED <u>1980'</u> FEET FROM THE <u>north</u> LINE AND <u>2375'</u> FEET FROM THE <u>east</u> LINE OF SEC. <u>36</u> TWP. <u>14S</u> RGE. <u>37E</u> NMPM		10. Field and Pool, or Wildcat <u>Denton Wolfcamp</u>	
15. Date Spudded		12. County <u>Lea</u>	
16. Date T.D. Reached		18. Elevations (DF, RKB, RT, GR, etc.)	
17. Date Compl. (Ready to Prod.)		19. Elev. Casinghead	
20. Total Depth <u>12641'</u>		21. Plug Back T.D.	
22. If Multiple Compl., How Many		23. Intervals Drilled By	
24. Producing Interval(s), of this completion - Top, Bottom, Name <u>PA</u>		25. Was Directional Survey Made <u>NA</u>	
26. Type Electric and Other Logs Run <u>NA</u>		27. Was Well Cored <u>NA</u>	

CASING RECORD (Report all strings set in well)					
CASING SIZE	WEIGHT LB./FT.	DEPTH SET	HOLE SIZE	CEMENTING RECORD	AMOUNT PULLED
<u>13 3/8</u>	<u>35.6</u>	<u>318</u>	<u>17 1/2</u>	<u>375 SX.</u>	
<u>9 5/8</u>	<u>36</u>	<u>4790</u>	<u>12 7/4</u>	<u>2580 SX.</u>	
<u>7</u>	<u>29</u>	<u>12641</u>	<u>8 3/4</u>	<u>600 SX.</u>	

LINER RECORD				TUBING RECORD			
SIZE	TOP	BOTTOM	SACKS CEMENT	SCREEN	SIZE	DEPTH SET	PACKER SET

31. Perforation Record (Interval, size and number) <u>9284'-9436' SQUEEZED w/ 88 SX.</u>		32. ACID, SHOT, FRACTURE, CEMENT SQUEEZE, ETC.	
DEPTH INTERVAL		AMOUNT AND KIND MATERIAL USED	

33. PRODUCTION							
Date First Production		Production Method (Flowing, gas lift, pumping - Size and type pump)				Well Status (Prod. or Shut-in)	
Date of Test	Hours Tested	Choke Size	Prod'n. For Test Period	Oil - Bbl.	Gas - MCF	Water - Bbl.	Gas - Oil Ratio
Flow Tubing Press.	Casing Pressure	Calculated 24-Hour Rate	Oil - Bbl.	Gas - MCF	Water - Bbl.	Oil Gravity - API (Corr.)	
34. Disposition of Gas (Sold, used for fuel, vented, etc.)						Test Witnessed By	

35. List of Attachments

36. I hereby certify that the information shown on both sides of this form is true and complete to the best of my knowledge and belief.

COPIED FROM HABES DISTRICT OFFICE

SIGNED _____ TITLE _____ DATE _____

DATE 12-20-82WELL NO. 3LEASE DENTON NORTH WOLFCAMP UNIT FIELD DENTON WOLFCAMPLOCATION SEC. 36, T14S, R37E,
1980' FNL & 230' E.LSIGNED J. BOUBELG.L. 3801'D.F. 3812'K.B. NAZERO NA

10 SK. PLUG @ SURFACE

PEA

■ TOC

0.5 #/GAL
FLUID

250'

372'

40 SK. PLUG OVER 13 3/8" CSG. SHOE FROM 250'-372'

13 3/8", 35.6 #/FT CSG. SET @ 318' W/ 375 SK. CMT, CIRC. TO SURFACE

TOC @ 1030' (TEMP. SURVEY)

1900'

2093'

60 SK. PLUG OVER SALT ZONE FROM 1900'-2093'

4630'

9 5/8", 36 #/FT CSG. SET @ 4790' W/ 2500 SK. CMT, TOC @ 1030'
(TEMP. SURVEY)

4870'

CSG. CUTOFF @ 4873' W/ 75 SK. PLUG FROM 4630'-4870'

PERFS 5160'-5260' SQ. W/ 30 SK. CMT

PERFS. 5904'-6049' SQ. W/ 50 SK. CMT

TOC @ 8060' (TEMP. SURVEY)

7" BAKER MODEL "D" PKR W/ DR PLUG @ 9250'. CAPPED W/ 30 SK. CMT

WOLFCAMP: 9284'-9436' SQUEELED W/ 88 SK. CMT

7" CMT. RETAINER @ 9483'

7", 29 #/FT CSG. SET @ 12641' W/ 600 SK. CMT, TOC @ 8060' (TEMP. SURVEY)
TD 12641'

OIL CONSERVATION DIVISION

P. O. BOX 2088

SANTA FE, NEW MEXICO 87501

WELL COMPLETION OR RECOMPLETION REPORT AND LOG

NO. OF COPIES RECEIVED	
DISTRIBUTION	
SANTA FE	
FILE	
U.S.O.S.	
LAND OFFICE	
OPERATOR	

5a. Indicate Type of Lease	
State <input type="checkbox"/>	Fee <input type="checkbox"/>
5. State Oil & Gas Lease No.	

1a. TYPE OF WELL										7. Unit Agreement Name																																																	
b. TYPE OF COMPLETION										8. Farm or Lease Name																																																	
OIL WELL <input checked="" type="checkbox"/> GAS WELL <input type="checkbox"/> DRY <input type="checkbox"/> OTHER <input type="checkbox"/> NEW WELL <input type="checkbox"/> WORK OVER <input type="checkbox"/> DEEPEN <input type="checkbox"/> PLUG BACK <input type="checkbox"/> DIFF. RESVR. <input type="checkbox"/> OTHER <input type="checkbox"/>										T. D. Pope																																																	
2. Name of Operator										19. Well No.																																																	
Sinclair Oil & Gas Co. - ARCO										12																																																	
3. Address of Operator										10. Field and Pool, or Wildcat																																																	
P.O. Box 1920 Hobbs, N.M.										Denton Wolfcamp																																																	
4. Location of Well										12. County																																																	
UNIT LETTER <u>K</u> LOCATED <u>2130</u> FEET FROM THE <u>South</u> LINE AND <u>1650</u> FEET FROM THE <u>West</u> LINE OF SEC. <u>36</u> TWP. <u>14S</u> RGE. <u>37E</u> NMPM										15. Date Spudded <u>9-29-54</u> 16. Date T.D. Reached <u>11-5-54</u> 17. Date Compl. (Ready to Prod.) <u>11-21-54</u> 18. Elevations (DF, RKB, RT, GK, etc.) <u>3801' GR</u> 19. Elev. Casinghead <u>NA</u>																																																	
20. Total Depth <u>9470</u>										21. Plug Back T.D. <u>9467</u>																																																	
22. If Multiple Compl., How Many <u>NA</u>										23. Intervals Drilled By <u>NA</u>																																																	
24. Producing Interval(s), of this completion - Top, Bottom, Name										25. Was Directional Survey Made <u>NA</u>																																																	
P4A since 7-5-66										27. Was Well Cored <u>NA</u>																																																	
26. Type Electric and Other Logs Run <u>NA</u>										28. CASING RECORD (Report all strings set in well)																																																	
<table border="1"> <thead> <tr> <th>CASING SIZE</th> <th>WEIGHT LB./FT.</th> <th>DEPTH SET</th> <th>HOLE SIZE</th> <th>CEMENTING RECORD</th> <th>AMOUNT PULLED</th> </tr> </thead> <tbody> <tr> <td>13 3/8"</td> <td>35.6</td> <td>312</td> <td>17 1/2</td> <td>375 SX.</td> <td></td> </tr> <tr> <td>9 5/8"</td> <td>36</td> <td>4766</td> <td>12 1/4</td> <td>2000 DX.</td> <td>TOC @ 1890'</td> </tr> <tr> <td>7"</td> <td>26</td> <td>9467</td> <td>8 3/4</td> <td>125 AX.</td> <td>TOC Temp. Aug. 5. E. 7510'</td> </tr> </tbody> </table>										CASING SIZE	WEIGHT LB./FT.	DEPTH SET	HOLE SIZE	CEMENTING RECORD	AMOUNT PULLED	13 3/8"	35.6	312	17 1/2	375 SX.		9 5/8"	36	4766	12 1/4	2000 DX.	TOC @ 1890'	7"	26	9467	8 3/4	125 AX.	TOC Temp. Aug. 5. E. 7510'	<table border="1"> <thead> <tr> <th>SIZE</th> <th>TOP</th> <th>BOTTOM</th> <th>SACKS CEMENT</th> <th>SCREEN</th> <th>SIZE</th> <th>DEPTH SET</th> <th>PACKER SET</th> </tr> </thead> <tbody> <tr> <td></td> <td></td> <td></td> <td></td> <td></td> <td></td> <td></td> <td></td> </tr> </tbody> </table>										SIZE	TOP	BOTTOM	SACKS CEMENT	SCREEN	SIZE	DEPTH SET	PACKER SET								
CASING SIZE	WEIGHT LB./FT.	DEPTH SET	HOLE SIZE	CEMENTING RECORD	AMOUNT PULLED																																																						
13 3/8"	35.6	312	17 1/2	375 SX.																																																							
9 5/8"	36	4766	12 1/4	2000 DX.	TOC @ 1890'																																																						
7"	26	9467	8 3/4	125 AX.	TOC Temp. Aug. 5. E. 7510'																																																						
SIZE	TOP	BOTTOM	SACKS CEMENT	SCREEN	SIZE	DEPTH SET	PACKER SET																																																				
31. Perforator Record (Interval, size and number)										32. ACID, SHOT, FRACTURE, CEMENT SQUEEZE, ETC.																																																	
9232-9381 } 4 SPF 9435-9449 }										<table border="1"> <thead> <tr> <th>DEPTH INTERVAL</th> <th>AMOUNT AND KIND MATERIAL USED</th> </tr> </thead> <tbody> <tr> <td>9232-9449</td> <td>17,500 gals XLST acid</td> </tr> </tbody> </table>										DEPTH INTERVAL	AMOUNT AND KIND MATERIAL USED	9232-9449	17,500 gals XLST acid																																				
DEPTH INTERVAL	AMOUNT AND KIND MATERIAL USED																																																										
9232-9449	17,500 gals XLST acid																																																										
33. PRODUCTION										34. Disposition of Gas (Sold, used for fuel, vented, etc.)																																																	
Date First Production										Production Method (Flowing, gas lift, pumping - Size and type pump)																																																	
Date of Test										Well Status (Prod. or Shut-in)																																																	
Hours Tested										Test Witnessed By																																																	
Choke Size										35. List of Attachments																																																	
Prod'n. For Test Period										36. I hereby certify that the information shown on both sides of this form is true and complete to the best of my knowledge and belief.																																																	
Oil - Bbl.										COPIED FROM HOBBS DISTRICT OFFICE																																																	
Gas - MCF										SIGNED _____ TITLE _____ DATE _____																																																	
Water - Bbl.																																																											
Gas - Oil Ratio																																																											
Flow Tubing Press.																																																											
Casing Pressure																																																											
Calculated 24-Hour Rate																																																											
Oil - Bbl.																																																											
Gas - MCF																																																											
Water - Bbl.																																																											
Oil Gravity - API (Conn.)																																																											

DATE 12-20-82 WELL NO. 12-K LEASE ARCO-T.D. POPE FIELD DENTON WOLFCAMP

LOCATION SEC. 36, T14S, R37E,
2130' FSL & 1650' FWL --

SIGNED J. BOUREL

G.L. 3801'

D.F. NA

K.B. NA

ZERO NA

■ TOC

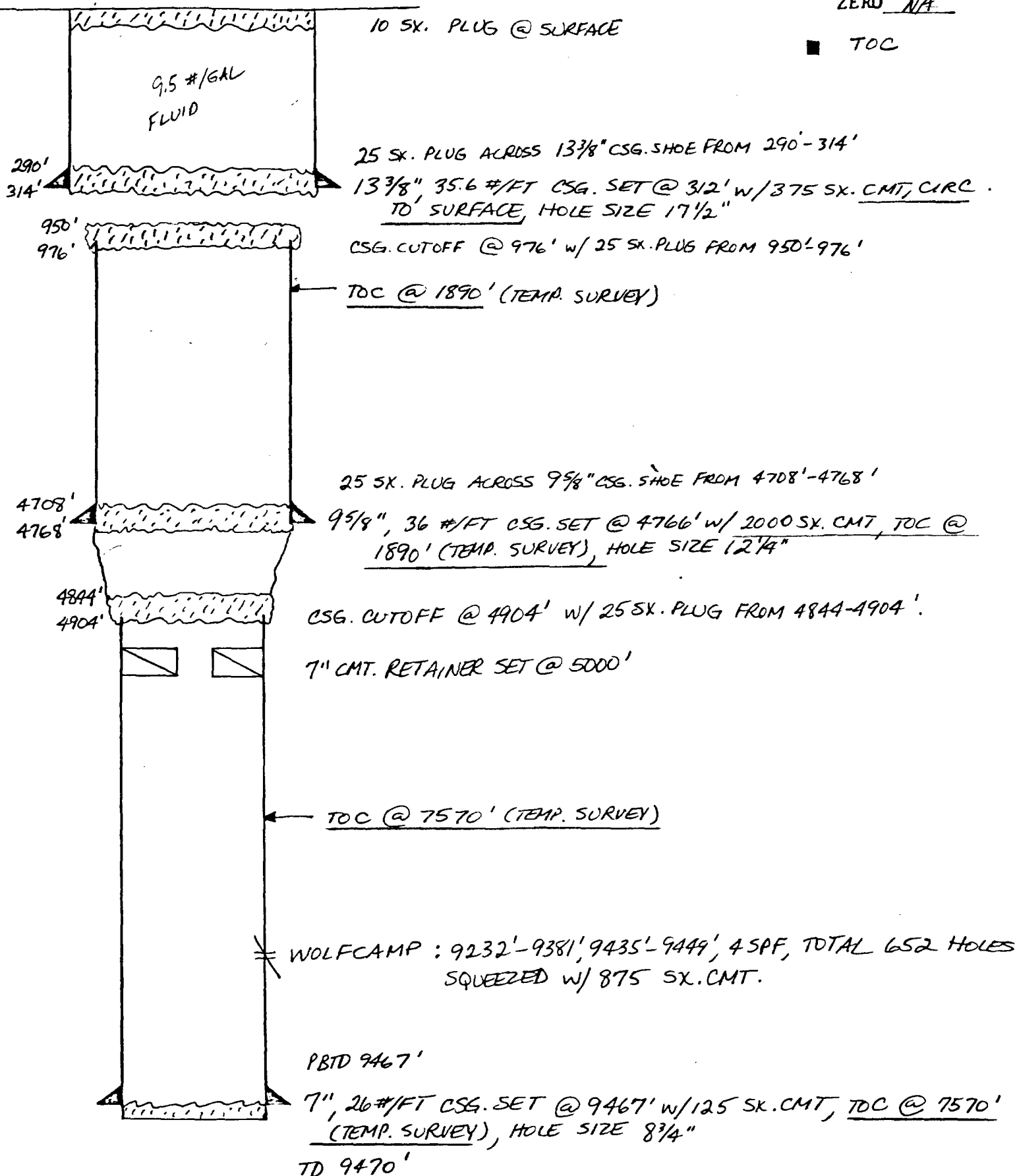

Mobil Producing Texas & New Mexico Inc.
Denton North Wolfcamp Unit
Well No. 7-7
Sec. 36, T14S, R37E
1980'FSL & 1650'FWL

DATA ON PROPOSED OPERATION

1. Avg. Daily Rate 400 BWPD
Max. Daily Rate 600 BWPD
3. Avg. Injection Pressure 2750 PSI
Max. Injection Pressure 2900 PSI
4. When the injection fluid (sample number 2) is compared to the production water (sample number 1), the water analysis indicates no evidence of incompatibility between the two water types.

731 W. INDIANA
MIDLAND, TEXAS 79701
PHONE 683-4821

LABORATORY NO. 17883
SAMPLE RECEIVED 1-11-78
RESULTS REPORTED 1-12-78

NO. 4

CHEMICAL AND PHYSICAL PROPERTIES

	NO. 1	NO. 2	NO. 3	NO. 4
Specific Gravity at 60° F.	1.0595	1.0507		
pH When Sampled				
pH When Received	6.6	7.4		
Bicarbonate as HCO ₃	549	683		
Supersaturation as CaCO ₃	15	120		
Undersaturation as CaCO ₃	—	—		
Total Hardness as CaCO ₃	10,700	9,400		
Calcium as Ca	3,080	2,820		
Magnesium as Mg	729	571		
Sodium and/or Potassium	29,214	23,532		
Sulfate as SO ₄	2,558	1,843		
Chloride as Cl	50,423	41,191		
Iron as Fe	6.9	1.3		
Barium as Ba				
Turbidity, Electric				
Color as Pt				
Total Solids, Calculated	86,553	70,640		
Temperature °F.				
Carbon Dioxide, Calculated				
Dissolved Oxygen, Winkler				
Hydrogen Sulfide				
Resistivity, ohms/m at 77° F.	150	32.5		
Suspended Oil	0.104	0.120		
Filtrable Solids as mg/l				
Volume Filtered, ml				

Results Reported As Milligrams Per Liter

Additional Determinations And Remarks A comparison of the above results shows no evidence of any incompatibility between these two waters. We show a moderate calcium carbonate scaling tendency in the Aree water, but suspect this likely was created during sampling.

Form No. 3

VII A

**Mobil Producing
Texas & New Mexico Inc.
Houston, Texas
Denton, North Wolfcamp Unit
Well #7-7, Sec. 36, T14S, R37E
Lea County, NM
Injection Fluid Compatability
with Formation Water**

Mobil Producing Texas & New Mexico Inc.
Denton North Wolfcamp Unit
Well No. 7-7
Sec. 36, T14S, R37E
1980'FSL & 1650'FWL

The Wolfcamp geological data is provided below.

LITHOLOGIC DETAIL

Composition - Limestone
 - Dolomite

Type Structure - Anticlinal

Average Porosity - 10%

Average of Permeability - 10md

GEOLOGICAL NAME

Wolfcamp

THICKNESS

Average Effective Pay - 52'

DEPTH

Average Depth to Top of Pay - 9206'

Overlying fresh water zone (aquifers containing concentrations of 10,000 mg/l or less).

GEOLOGICAL NAME	DEPTH
Ogallala	+200'

There are no fresh waters immediately underlying the injection zone.

Mobil Producing Texas & New Mexico Inc.
Denton North Wolfcamp Unit
Well No. 7-7
Sec. 36, T14S, R37E
1980'FSL & 1650'FWL

STIMULATION PROGRAM:

1. Pressure annulus to 500 psig.
2. Hook up pump truck and pump 6000 gal. 15% NEF_e stab. HCL treat at 3500 psig surface treating pressure.
3. SI well overnight. Backflow as necessary.
4. Place on injection.

Mobil Producing Texas & New Mexico Inc.
Denton North Wolfcamp Unit
Well No. 7-7
Sec. 36, T14S, R37E
1980'FSL & 1650'FWL

Logs were submitted previously when well was completed as ARCO T. D. Pope
No. 7 in June 24, 1954.

Mobil Producing Texas & New Mexico Inc.
Denton North Wolfcamp Unit
Well No. 7-7
Sec. 36, T14S, R37E
1980'FSL & 1650'FWL

Chemical analysis was conducted on two fresh water supply wells within a mile radius of the proposed injector.

UNICHEM INTERNATIONAL

601 NORTH LEECH

P.O. BOX 1499

HOBBS, NEW MEXICO 88240

COMPANY : MOBIL
DATE : 9-17-82
FIELD, LEASE & WELL : DENTON WSW#1
SAMPLING POINT:
DATE SAMPLED : 9-16-82

SPECIFIC GRAVITY = 1
TOTAL DISSOLVED SOLIDS = 820
PH = 7.7

		ME / L	MG / L
CATIONS			
CALCIUM	(CA)+2	4.5	90.1
MAGNESIUM	(MG)+2	5.2	63.8
SODIUM	(NA).CALC.	2.8	45.0
ANIONS			
BICARBONATE	(HCO3)-1	4.7	286.
CARBONATE	(CO3)-2	0	0
HYDROXIDE	(OH)-1	0	0
SULFATE	(SO4)--2	2.8	134.
CHLORIDES	(CL)-1	5.0	179.
DISSOLVED GASES			
CARBON DIOXIDE	(CO2)	NOT RUN	
HYDROGEN SULFIDE	(H2S)	NOT RUN	
OXYGEN	(O2)	NOT RUN	
IRON(TOTAL)	(FE)		.7
BARIUM	(BA)+2		.1
MANGANESE	(MN)	NOT RUN	

SCALING INDEX	TEMP
	30C
	86F
CARBONATE INDEX	3.21
CALCIUM CARBONATE SCALING	LIKELY
SULFATE INDEX	-5.8
CALCIUM SULFATE SCALING	UNLIKELY

UNICHEM INTERNATIONAL

601 NORTH LEECH

P.O. BOX 1499

HOBBS. NEW MEXICO 88240

COMPANY : MOBIL PRODUCING
DATE : 10-7-82
FIELD LEASE & WELL : DENTON
SAMPLING POINT : WSW #2
DATE SAMPLED : 10-5-82

SPECIFIC GRAVITY = 1
TOTAL DISSOLVED SOLIDS = 643
PH = 7.69

		ME / L	MG / L
CATIONS			
CALCIUM	(CA)+2	3.8	76.1
MAGNESIUM	(MG)+2	6	72.9
SODIUM	(NA).CALC.	.22	5.1
ANIONS			
BICARBONATE	(HCO3)-1	4	244.
CARBONATE	(CO3)-2	0	0
HYDROXIDE	(OH)-1	0	0
SULFATE	(SO4)-2	2.4	120
CHLORIDES	(CL)-1	3.5	124.
DISSOLVED GASES			
CARBON DIOXIDE	(CO2)	NOT RUN	
HYDROGEN SULFIDE	(H2S)	NOT RUN	
OXYGEN	(O2)	NOT RUN	
IRON(TOTAL)	(FE)		.03
BARIUM	(BA)+2		.08
MANGANESE	(MN)	NOT RUN	

SCALING INDEX	TEMP
	30C
	86F
CARBONATE INDEX	3.30
CALCIUM CARBONATE SCALING	LIKELY
	-6.7
SULFATE INDEX	UNLIKELY
CALCIUM SULFATE SCALING	

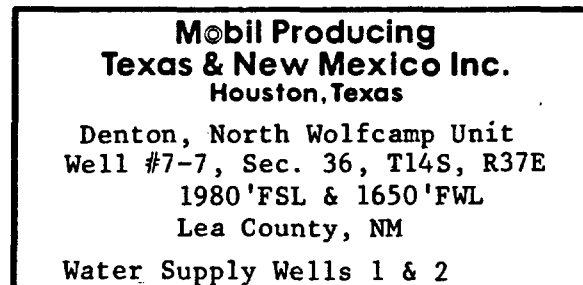

Mobil Producing Texas & New Mexico Inc.
Denton North Wolfcamp Unit
Well No. 7-7
Sec. 36, T14S, R37E
1980' FSL & 1650' FWL

This application was sent by certified mail to the surface owner of the land on which the well is located and to each lease operator within one-half mile radius of the well location.

Surface Owner:

Mr. Norman Caswell
Route 1
Meadows, Texas 79345

Offset Operators

Polaris Production Corp.
1901 First National Bank Building
Midland, Texas 79702

Arco Oil & Gas Company
Permian District Office
P.O. Box 1610
Midland, Texas 79702

Mobil Producing Texas & New Mexico Inc.

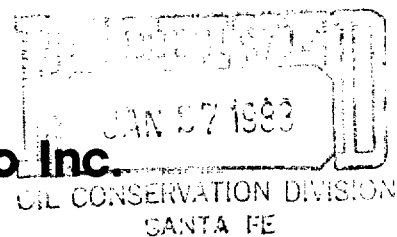

January 25, 1983

NINE GREENWAY PLAZA-SUITE 2700
HOUSTON, TEXAS 77046

Mr. Norman Caswell
Rt. 1
Meadows, Texas 79345

7.01
NOTICE OF APPLICATION FOR
WATERFLOOD INJECTION WELL
MOBIL PRODUCING TX. & N.M. INC.
WELL NO. 7-7
DENTON NORTH WOLFCAMP UNIT FIELD
LEA COUNTY, NEW MEXICO

Gentlemen:

Mobil Producing Tx. & N.M. Inc. has made application to the Oil Conservation Commission of New Mexico for authority to inject production water into a reservoir productive of oil or gas through the subject well.

A copy of this application is furnished to you for your information.

Yours very truly,

A handwritten signature in cursive script, reading "J. A. Morris". The signature is written in dark ink and is positioned above the printed name and title.

J. A. Morris
Regulatory Engineering Supervisor

SDMarino:mma
Attachments

cc: Oil Conservation Commission (w/attach.)

Mobil Producing Texas & New Mexico Inc.

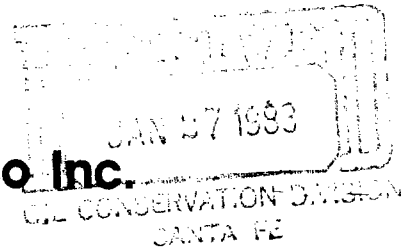

January 25, 1983

NINE GREENWAY PLAZA SUITE 2700
HOUSTON, TEXAS 77046

Polaris Production Corp.
1901 First National Bank Building
Midland, Texas 79702

7.01
NOTICE OF APPLICATION FOR
WATERFLOOD INJECTION WELL
MOBIL PRODUCING TX. & N.M. INC.
WELL NO. 7-7
DENTON NORTH WOLFCAMP UNIT FIELD
LEA COUNTY, NEW MEXICO

Gentlemen:

Mobil Producing Tx. & N.M. Inc. has made application to the Oil Conservation Commission of New Mexico for authority to inject production water into a reservoir productive of oil or gas through the subject well.

A copy of this application is furnished to you for your information.

Yours very truly,

A handwritten signature in cursive script that reads "J. A. Morris".

J. A. Morris
Regulatory Engineering Supervisor

SDMarino:mma
Attachments

cc: Oil Conservation Commission (w/attach.)

Mobil Producing Texas & New Mexico Inc.

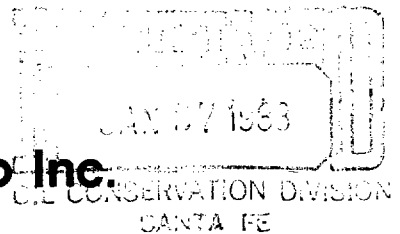

January 25, 1983

NINE GREENWAY PLAZA-SUITE 2700
HOUSTON, TEXAS 77046

Arco Oil & Gas Company
Permian District Office
P.O. Box 1610
Midland, Texas 79702

7.01
NOTICE OF APPLICATION FOR
WATERFLOOD INJECTION WELL
MOBIL PRODUCING TX. & N.M. INC.
WELL NO. 7-7
DENTON NORTH WOLFCAMP UNIT FIELD
LEA COUNTY, NEW MEXICO

Gentlemen:

Mobil Producing Tx. & N.M. Inc. has made application to the Oil Conservation Commission of New Mexico for authority to inject production water into a reservoir productive of oil or gas through the subject well.

A copy of this application is furnished to you for your information.

Yours very truly,

A handwritten signature in cursive script that reads "J. A. Morris".

J. A. Morris
Regulatory Engineering Supervisor

SDMarino:mma
Attachments

cc: Oil Conservation Commission (w/attach.)

Mobil Producing Texas & New Mexico Inc.

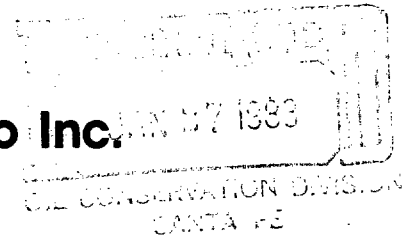

NINE GREENWAY PLAZA-SUITE 2700
HOUSTON, TEXAS 77046

January 25, 1983

County Clerk
Ms. Pat Snipes
P. O. Box 1507
Lovington, NM 88260

7.01
NOTICE OF APPLICATION FOR
WATERFLOOD INJECTION WELL
MOBIL PRODUCING TX. & N.M. INC.
DENTON NORTH WOLFCAMP UNIT FIELD
WELL NO. 7-7
LEA COUNTY, NEW MEXICO

Dear Ms. Snipes:

Mobil Producing Tx. & N.M. Inc. (MPTM) has made applicaiton to the Oil Conservation Commission of New Mexico to inject production water into a reservoir which is productive of oil or gas.

The Oil Conservation Commission requires that the enclosed application be sent to you for public information notice in the county in which the well is located. Please post the attached application as you desire.

Yours very truly,

J. A. Morris
Regulatory Engineering Supervisor

SDMarino:mma
Attachments

cc: Oil Conservation Commission

Notice of Application for Fluid Injection Well Report

APPLICANT: Mobil Producing Texas & New Mexico Inc., 9 Greenway Plaza, Suite 2700, Houston, Texas 77046 Telephone: 713-871-5351, Contact - S. D. Marino

PURPOSE: Inject fluid into the Wolfcamp Formation, Denton North Wolfcamp Unit, Well No. 7-7; Location - Section 36, Township 14S, Range 37E.

OPERATIONAL CHARACTERISTICS: Formation - Wolfcamp, Injection interval 9197'-9286'. Expected maximum injection pressure 2900 psi and rate 600 BWPD.

Interested parties may file objections or request a hearing with the Oil Conservation Division, P. O. Box 2088, Santa Fe, New Mexico 87501, within 15 days of this notice.

Mobil Producing Texas & New Mexico Inc.

January 25, 1983

RECEIVED
JAN 27 1983
CONSERVATION DIVISION
SANTA FE
NINE GREENWAY PLAZA, SUITE 2700
HOUSTON, TEXAS 77046

Lovington Daily Leader
14 West Avenue B
Lovington, NM 88260

7.01
NOTICE OF APPLICATION FOR
WATERFLOOD INJECTION WELL
MOBIL PRODUCING TX. & N.M. INC.
WELL NO. 7-7
DENTON NORTH WOLFCAMP UNIT FIELD
LEA COUNTY, NEW MEXICO

Gentlemen:

Mobil Producing Tx. & N.M. Inc. has made application to the Oil Conservation Commission of New Mexico for authority to inject production water into a reservoir productive of oil or gas through the subject well.

The Oil Conservation Commission requires that a public notice of the attached information be published in the county in which the well is located. Please publish the attached notice as soon as possible and return the completed affidavit and a copy of the printed notice in the enclosed, stamped envelope. Send the invoice to the attention of Mr. J. A. Morris.

Yours very truly,

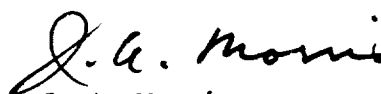

J. A. Morris
Regulatory Engineering Supervisor

SDMarino:mma
Attachments

cc: Oil Conservation Commission (w/attach.)

Notice of Application for Fluid Injection Well Report

APPLICANT: Mobil Producing Texas & New Mexico Inc., 9 Greenway Plaza, Suite 2700, Houston, Texas 77046 Telephone: 713-871-5351, Contact - S. D. Marino

PURPOSE: Inject fluid into the Wolfcamp Formation, Denton North Wolfcamp Unit, Well No. 7-7; Location - Section 36, Township 14S, Range 37E.

OPERATIONAL CHARACTERISTICS: Formation - Wolfcamp, Injection interval 9197'-9286'. Expected maximum injection pressure 2900 psi and rate 600 BWPD.

Interested parties may file objections or request a hearing with the Oil Conservation Division, P. O. Box 2088, Santa Fe, New Mexico 87501, within 15 days of this notice.

COUNTY OF _____

Notary Public in and for

County, N.M. _____

Mobil Producing Texas & New Mexico Inc.

February 15, 1983

NINE GREENWAY PLAZA-SUITE 2700
HOUSTON, TEXAS 77046

Oil Conservation Division
P.O. Box 2088
Santa Fe, N.M. 87501

7.01
WATERFLOOD INJECTION WELL
MOBIL PRODUCING TX. & N.M. INC.
DENTON NORTH WOLFCAMP UNIT
WELL #7
DENTON NORTH WOLFCAMP FIELD
LEA COUNTY, NEW MEXICO

Gentlemen:

In accordance with Statewide Rule 701, this letter encloses the legal notice for this well which was published by the Lovington Daily Leader.

Yours truly,



A.D. Bond
Regulatory Engineering Coordinator II

SDMarino/ec
Attachments

cc: Director, District 1

LEGAL NOTICE
Notice of Application for
Injection Well Report.
APPLICANT: Mobil Producing
Texas & New Mexico Inc.
Greenway Plaza, Suite 2700
Houston, Texas 77046
Telephone: 713-871-5300
Contact: S. D. Marino
PURPOSE: Inject fluid into
the Wolfcamp Formation of the
North Wolfcamp Unit, Well
#7-7; Location: Section
Township 14S, Range 37E.
OPERATIONAL
CHARACTERISTICS
Formation-Wolfcamp, Injection
Interval 9197'-9286'. Expected
maximum injection pressure
1000 psi and rate 600 BBL/D.
Interested parties may
inspect or request a copy of the
Oil Conservation Division
P.O. Box 2088, Santa Fe, New Mexico 87501, within 10
days of the date of this notice.