

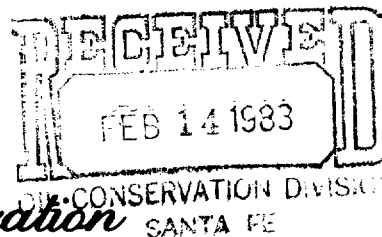

Capital Oil and Gas Corporation



214 - 983-2081

February 9, 1983

214 - 983-2082

Mr. Joe Ramey
Energy and Minerals Department
Oil Conservation Commission
P. O. Box 2088
Santa Fe, New Mexico 87501

*NSL
Paragraph 6 Order
R 4875
I'm in charge
No off sets
see Form C-102 for
location*

Re: Commission Order R-4875

Dear Mr. Ramey:

Enclosed is information needed for request of administrative approval for a nonstandard location for our SFPRR No. 82. The information enclosed is in compliance with the Operating Rules for the Waterflood Project, Miguel Creek Field, Gallup Pool, in McKinley County, New Mexico, Case No. 5321. As requested in Paragraph 6 of the Commission Order No. R-4875, we seek approval for a nonstandard location for SFPRR No. 82.

- A. A plat marked "Exhibit A" is enclosed, showing new location and the particle of acreage dedicated to this well.
- B. Enclosure marked "Exhibit B" is an aerial map of the location and offset wells. At the present time, there are no offset producers except for Capital Oil and Gas Corporation in the area.
- C. "Exhibit C" is a downhole schematic of the well.
- D. A nonstandard location is needed for this well to be in a line drive sequence for a proposed waterflood in this section of the field.
- E. To our knowledge, there are no water, oil and gas strata zones of the Gallup Hospah pay zone in this area.

This information should be satisfactory with the rules set forth in the Commission Order R-4875. If you need further information, please do not hesitate to contact me.

Yours very truly,

CAPITAL OIL AND GAS CORPORATION

By *Gary Blanks*
Gary Blanks, Vice President

GB:jh
Enclosures

Post Office Box 2130 Suite 202, Pioneer Building Kilgore, Texas 75662

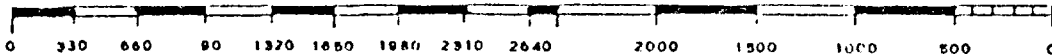

RAIOR

LEASE

82

1980' FSL & 1330' FWL

21

16N

6W

L NO.

FOOTAGE LOCATION

SECTION

TOWNSHIP

RANGE

EXHIBIT C

Schematic

Tabular Data

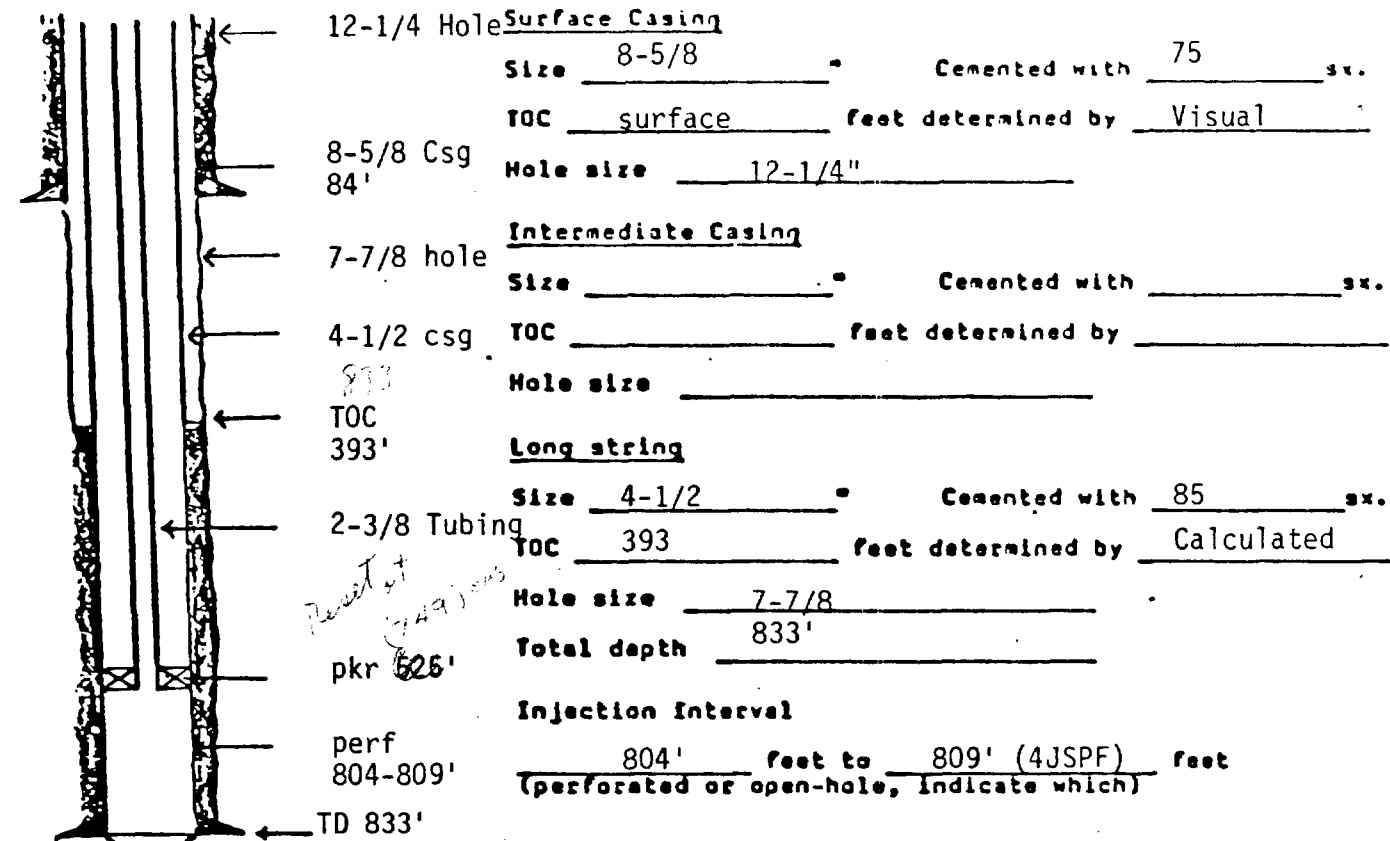

tubing size 2-3/8 lined with J-55 (material) set in a

Guiberson Uni - 1 (brand and model) packer at 525.25 feet

or describe any other casing-tubing seal).

Other Data

- Name of the Injection formation Gallup - Hospah
- Name of Field or Pool (if applicable) Miguel Creek - Gallup
- Is this a new well drilled for injection? ☒ Yes ☐ No
- If no, for what purpose was the well originally drilled?
- Has the well ever been perforated in any other zone(s)? List all such perforated intervals and give plugging detail (sacks of cement or bridge plug(s) used) No other perfs.
- Give the depth to and name of any overlying and/or underlying oil or gas zones (pools) in this area. None in this area

Chuck Pickens

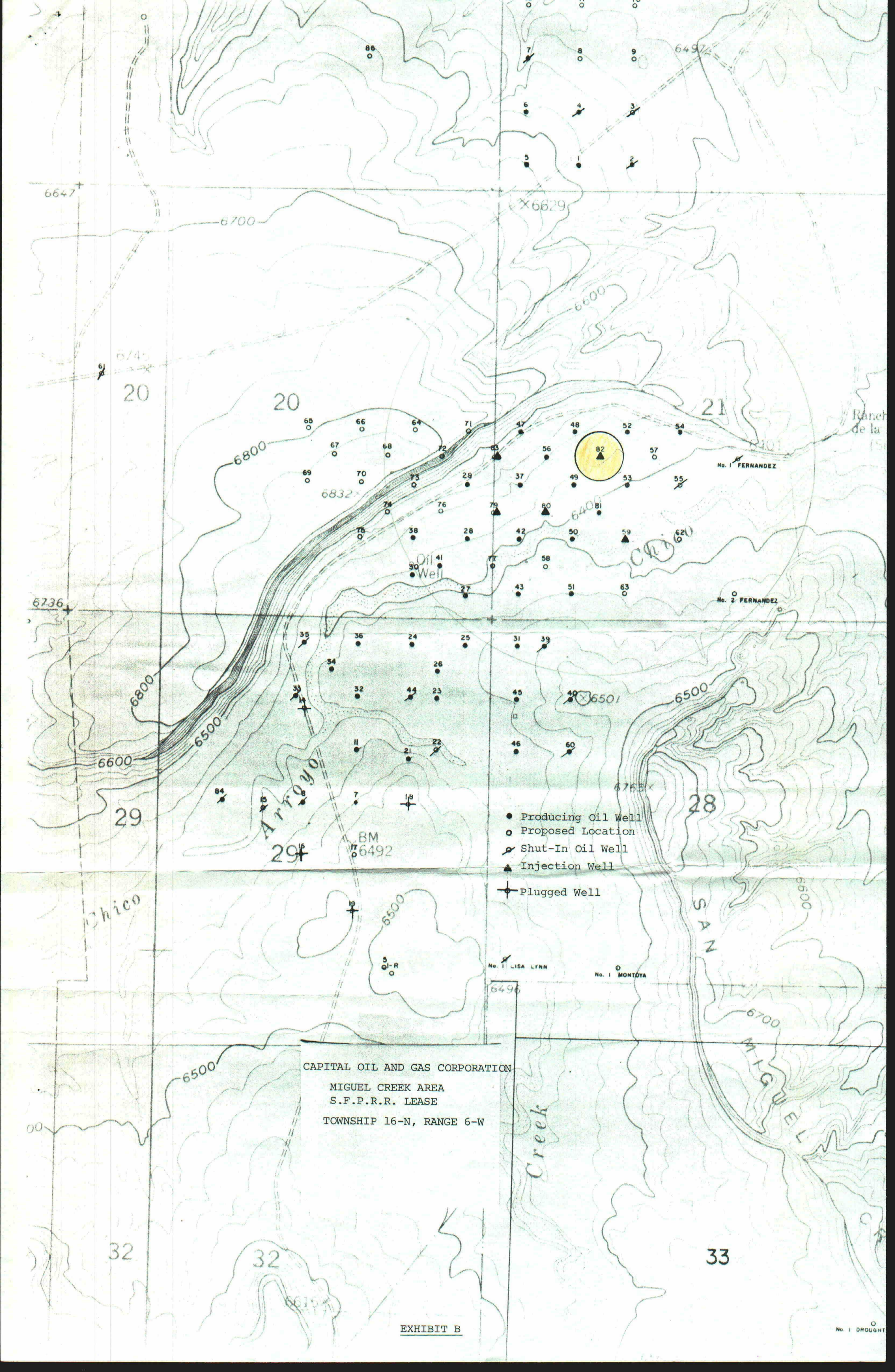

CAPITAL OIL AND GAS CORPORATION
MIGUEL CREEK AREA
S.F.P.R.R. LEASE
TOWNSHIP 16-N, RANGE 6-W