

Capital Oil and Gas Corporation

214 - 983-2081

February 17, 1983

214 - 983-2082

Mr. Joe Ramey
Energy and Minerals Department
Oil Conservation Commission
P. O. Box 2088
Santa Fe, New Mexico 87501

WFX

Re: Commission Order R-4875

Dear Mr. Ramey:

Enclosed is information needed for request of administrative approval for a nonstandard location for our SFPRR Nos. 79, 80 and 83 wells. The information enclosed is in compliance with the Operating Rules for the Waterflood Project, Miguel Creek Field, Gallup Pool, in McKinley County, New Mexico, Case No. 5321. As requested in Paragraph 6 of the Commission Order No. R-4875, we seek approval for a nonstandard location for SFPRR Nos. 79, 80 and 83.

- A. A plat marked "Exhibit A" for each well is enclosed, showing new location and the particle of acreage dedicated to the well.
- B. Enclosure for each well marked "Exhibit B" is an aerial map of each location and offset wells. At the present time, there are no offset producers except for Capital Oil and Gas Corporation in the area.
- C. "Exhibit C" is a downhole schematic of each well.
- D. "Exhibit D" is a Sundry Notice and Report on Well (Form C-103) for each well.
- E. A nonstandard location is needed for these wells to be in a line drive sequence for a proposed waterflood in this section of the field.
- F. To our knowledge, there are no water, oil and gas strata zones of the Gallup Hospah pay zone in this area.

This information should be satisfactory with the rules set forth in the Commission Order R-4875. If you need further information, please do not hesitate to contact me.

Yours very truly,

CAPITAL OIL AND GAS CORPORATION

By Gary Blanks
Gary Blanks, Vice President

GB:jh

Post Office Box 2130 Suite 202, Pioneer Building Kilgore, Texas 75662

Original
with NSK
filed
BRL

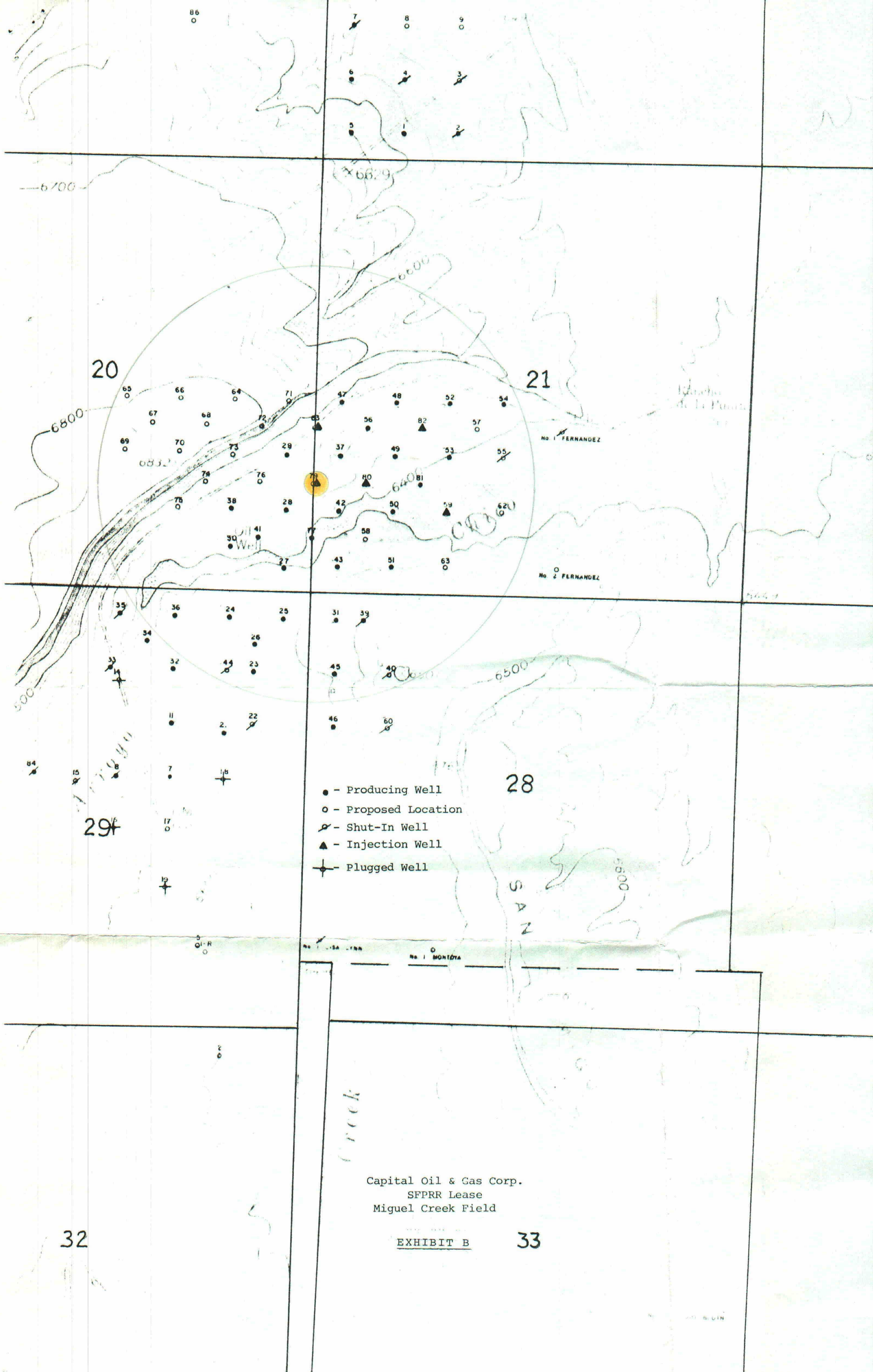

Schematic

Tabular Data

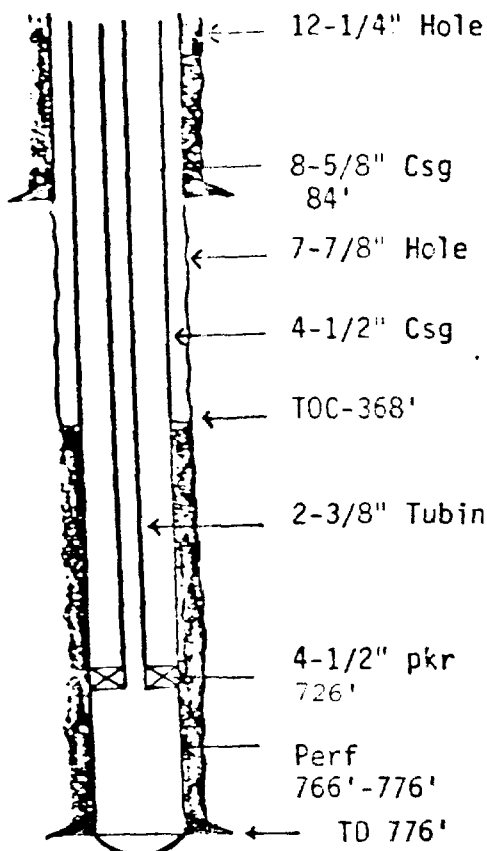

Surface Casing

Size 8-5/8 " Cemented with 75 SX sx.
 TOC Surface feet determined by Visual

Hole size 12-1/4"

Intermediate Casing

Size None " Cemented with sx.

TOC feet determined by

Hole size

Long string

Size 4-1/2" " Cemented with 85 sx.

TOC 368 feet determined by Calculation

Hole size 7-7/8"

Total depth 786'

Injection Interval

766' feet to 776' 4 JSPF feet
 (perforated or open-hole, indicate which)

Tubing size 2-3/8 lined with J-55 set in a
 (material)
Guiberson Unit - 1 packer at 726 feet
 (brand and model)

(or describe any other casing-tubing seal).

Other Data

1. Name of the injection formation Hospah-Gallup

2. Name of Field or Pool (if applicable) Miguel Creek-Gallup

3. Is this a new well drilled for injection? ☒ Yes ☐ No

If no, for what purpose was the well originally drilled?

4. Has the well ever been perforated in any other zone(s)? List all such perforated intervals and give plugging detail (sacks of cement or bridge plug(s) used)

No other perforations

5. Give the depth to and name of any overlying and/or underlying oil or gas zones (pools) in this area.

No other production in this area

1330' FSL & 660' FWL 21 16N 6W
FOOTAGE LOCATION SECTION TOWNSHIP RANGE

Schematic

Tabular Data

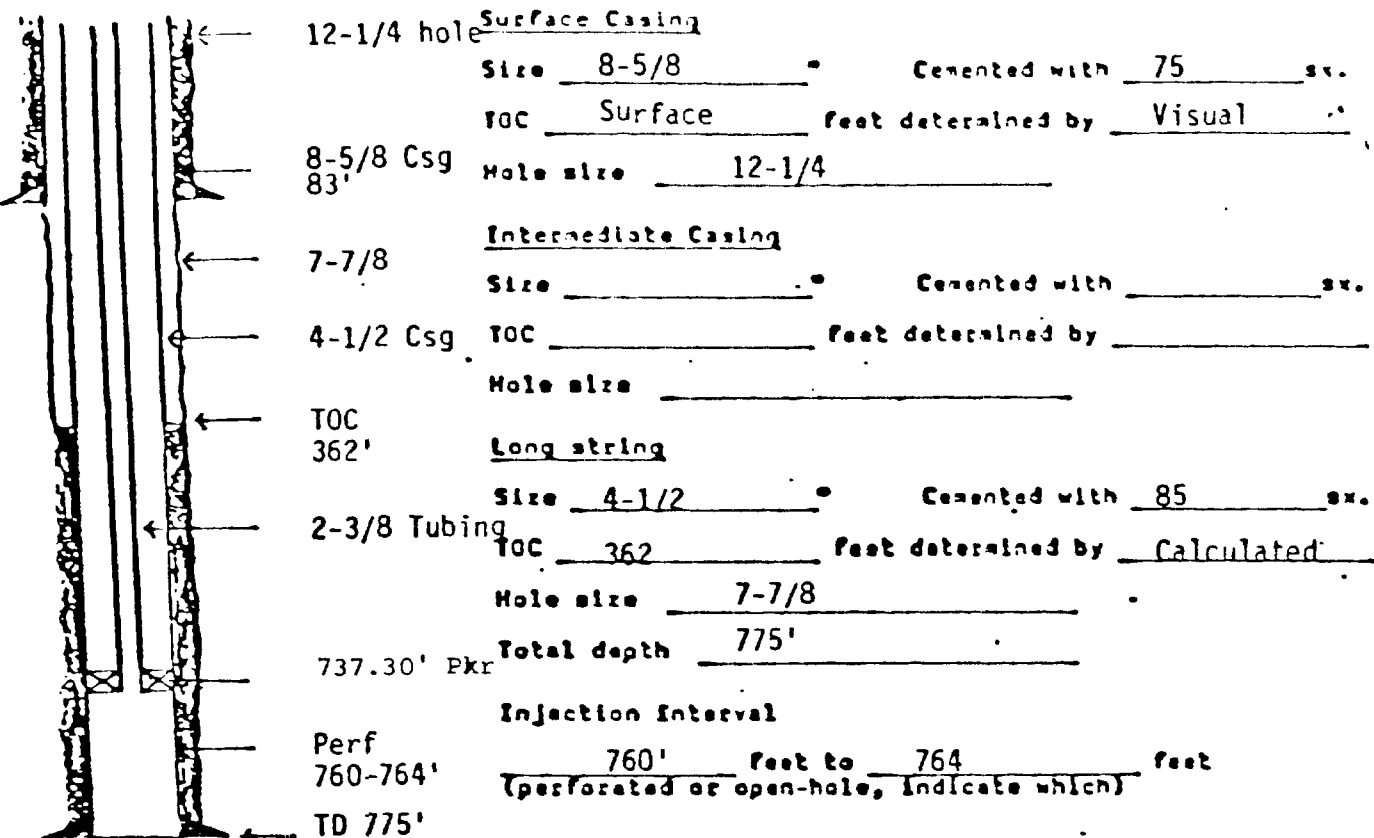

ing size 2-3/8 lined with J-55 set in a
Guiberson Uni - 1 (material)
(brand and model) packer at 737.30 feet

Describe any other casing-tubing seal).

Other Data

Name of the injection formation Gallup - Hospah

Name of Field or Pool (if applicable) Miguel Creek - Gallup

Is this a new well drilled for injection? ☒ Yes ☐ No

If no, for what purpose was the well originally drilled?

Has the well ever been perforated in any other zone(s)? List all such perforated intervals and give plugging detail (sacks of cement or bridge plug(s) used)

No other perfs.

Give the depth to and name of any overlying and/or underlying oil or gas zones (pools) in this area.

None in this area

83

1980' FSL & 10' FWL

21

16N

6W

NO.

FOOTAGE LOCATION

SECTION

TOWNSHIP

RANGE

Schematic

Tabular Data

12-1/4" hole

Surface Casing

Size 8-5/8"

Cemented with 75 %

TOC Surface

feet determined by Visual

8-5/8 Csg

Hole size 12-1/4"

83'

7-7/8 hole

Intermediate Casing

Size

Cemented with %

4-1/2 csg

TOC

feet determined by

Hole size

TOC

396'

Long string

Size 4-1/2"

Cemented with 85 %

2-3/8"

TOC 396'

feet determined by Calculated

Tubing

Hole size 7-7/8"

Total depth 839'

4-1/2 pker

767.80'

Injection Interval

perf

823-828'

823 feet to 238 (4JSPF) feet
(perforated or open-hole, indicate which)

TD 839

Casing size 2-3/8 lined with J-55 (material) set in a

Guiberson Uni - 1 (brand and model) packer at 767.80 feet

or describe any other casing-tubing seal).

Other Data

1. Name of the injection formation Gallup - Hoshah

2. Name of field or pool (if applicable) Miguel Creek - Gallup

3. Is this a new well drilled for injection? ☒ Yes ☐ No

If no, for what purpose was the well originally drilled?

4. Has the well ever been perforated in any other zone(s)? List all such perforated intervals and give plugging detail (sacks of cement or bridge plug(s) used)

No other perf.

5. Give the depth to and name of any overlying and/or underlying oil or gas zones (pools) in this area. None in this area

Memo

From
Gilbert P. Quintana
Petroleum Engineer

To Case File No. 5321

my conversation with Gary
Blanks on 4/12/83 at
3:55 p.m. indicated there
were no offset operators
in the area to ~~be~~ notified.

Gilbert Quintana