

COASTAL STATES GAS PRODUCING COMPANY

NORTH TEXAS DIVISION
WILCO BUILDING
MIDLAND, TEXAS
79701

September 13, 1968

New Mexico Oil Conservation Commission
State Land Office Building
Santa Fe, New Mexico 87501

Attn: Mr. A. L. Porter, Jr.
Secretary-Director

Re: Federal Trigg #1 Well
Proposed Salt Water Disposal Well

Dear Sir:

Coastal States Gas Producing Company respectfully requests administrative approval to utilize the abandoned Federal Trigg #1, located in the NE/4 of the NE/4 of Section 20, Township 13 South, Range 33 East, Lea County, New Mexico as a salt water disposal well. We plan to re-enter this well to dispose of produced salt water, from the Baum Penn Field, into the Devonian formation from 13,270' to 13,570'.

The well was originally drilled by the Ohio Oil Company in May, 1953, as a Devonian test. A DST from 13,505' to 13,570' in the Devonian yielded 5000' water blanket and 5440' of mud cut salt water. Therefore, the well was plugged back to the Pennsylvanian formation when a completion attempt was made in the Permo-Penn zone. After considerable difficulty the well was taken over by John H. Trigg Company and completed through perforations at 9590-9718'. The well produced 15,944 barrels of oil from the Permo-Penn zone from 1953 to 1967 at which time it was plugged and abandoned. No casing was recovered from the well when it was plugged due to the large amount of cement that was used when the well was originally drilled and completed. The cement was circulated on the 13 3/8" surface casing, the 9 5/8" intermediate and the 5 1/2" oil string.

After drilling the cement plugs, we plan to squeeze off the old perforations at 9590-9718' with 150 sacks of cement and then clean out to 13,570' and inject produced salt water down the casing into the Devonian formation.

We anticipate this zone will take up to 10,000 BPD under vacuum conditions.

The source of this water is the Baum Penn Field as shown on the attached plat. At the present time there is approximately 4000 BPD to be disposed of in this field. Several other operators in the Lazy "J" Field have expressed a desire to join this system and will be allowed to do so if satisfactory arrangements

New Mexico Oil Conservation Commission
September 13, 1968
Page 2

can be made.

Also attached is a water analysis of the Baum Penn Field produced water.

A plat is also included that shows the proposed disposal well and all wells within a two mile radius. This plat shows that only two wells have been drilled deeper than the Permo-Pennsylvanian zone within two miles of the proposed disposal well. They were the Eason Oil Company #2 Wilbo "A" located in the NE/4 of the NW/4 of Section 22, Township 13 South, Range 33 East and the Lawton Oil Company #2 State-Gulf located in the SE/4 of the SE/4 of Section 10, Township 13 South, Range 33 East. Both wells were Devonian tested and both proved to be wet in the Devonian. All other wells within two miles of the proposed disposal well produce from the Permo-Pennsylvanian formation.

Coastal States respectfully requests that the Oil Conservation Commission approve this administratively; however, if the Commission cannot do this, we request that it be set down for hearing at the next regular hearing date.

Very truly yours,

COASTAL STATES GAS PRODUCING COMPANY

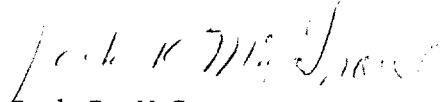
✓ Jack R. McGraw
Division Petroleum Engineer

JRMCG:sg
Attachment

cc: James N. Chambers, Box 1264, Hobbs, New Mexico
Pan American Petroleum Corporation, Box 1540, Midland, Texas
Texaco, Inc., Box 3109, Midland, Texas
Hanagan et al, Box 1737, Roswell, New Mexico
Delaware-Apache, 1720 Wilco Building, Midland, Texas
Del-Lea et al, Box 1889, Hobbs, New Mexico
United States Department of the Interior, Geological Survey
P. O. Box 1157
Hobbs, New Mexico 88240

PERTINENT INFORMATION

1. Disposal Zone - Devonian at 13,270' to 13,570'.
2. Kind of fluid to be disposed of - Produced salt water from the Baum Penn Field and the Lazy "J" Penn Field. Analysis is attached.
3. Anticipated volume - From 2000 to 10,000 BPD.
4. Anticipated injection pressure - Vacuum.

NEW MEXICO OIL CONSERVATION COMMISSION
APPLICATION TO DISPOSE OF SALT WATER BY INJECTION INTO A POROUS FORMATION

OPERATOR Coastal States Gas Producing Company		ADDRESS P. O. Box 235, Midland, Texas	
LEASE NAME Trigg Federal	WELL NO. 1	FIELD Lazy "J"	COUNTY Lea
LOCATION UNIT LETTER A ; WELL IS LOCATED 660' FEET FROM THE N LINE AND 660' FEET FROM THE East LINE, SECTION 20 TOWNSHIP 13 S RANGE 33 E NMPM.			

CASING AND TUBING DATA					
NAME OF STRING	SIZE	SETTING DEPTH	SACKS CEMENT	TOP OF CEMENT	TOP DETERMINED BY
SURFACE CASING	13 3/8"	385'	450	Circulated	Visually
INTERMEDIATE	9 5/8"	4060'	2150	Circulated	Visually
LONG STRING	5 1/2"	9780'	2162	Circulated	Visually
TUBING	None	NAME, MODEL AND DEPTH OF TUBING PACKER			
NAME OF PROPOSED INJECTION FORMATION Devonian			TOP OF FORMATION 13,270'		BOTTOM OF FORMATION 13,570'
IS INJECTION THROUGH TUBING, CASING, OR ANNULUS? 5 1/2" Casing		PERFORATIONS OR OPEN HOLE? Open Hole		PROPOSED INTERVAL(S) OF INJECTION 13,270' to 13,570'	
IS THIS A NEW WELL DRILLED FOR DISPOSAL? No		IF ANSWER IS NO, FOR WHAT PURPOSE WAS WELL ORIGINALLY DRILLED? To Test The Devonian			HAS WELL EVER BEEN PERFORATED IN ANY ZONE OTHER THAN THE PROPOSED INJECTION ZONE? Yes
LIST ALL SUCH PERFORATED INTERVALS AND SACKS OF CEMENT USED TO SEAL OFF OR SQUEEZE EACH 9590-9660'; 9673-77'; 9696-9718' Will squeeze perfs. off with 150 sack.					
DEPTH OF BOTTOM OF DEEPEST FRESH WATER ZONE IN THIS AREA 300'		DEPTH OF BOTTOM OF NEXT HIGHER OIL OR GAS ZONE IN THIS AREA Permo-Penn. @ 9720'		DEPTH OF TOP OF NEXT LOWER OIL OR GAS ZONE IN THIS AREA None	
ANTICIPATED DAILY INJECTION VOLUME (BBLs.) 2000	MINIMUM 2000	MAXIMUM 10,000	OPEN OR CLOSED TYPE SYSTEM Closed	IS INJECTION TO BE BY GRAVITY OR PRESSURE? Gravity	APPROX. PRESSURE (PSI) 0 psig.
ANSWER YES OR NO WHETHER THE FOLLOWING WATERS ARE MINERALIZED TO SUCH A DEGREE AS TO BE UNFIT FOR DOMESTIC, STOCK, IRRIGATION, OR OTHER GENERAL USE Yes		WATER TO BE DISPOSED OF Yes		NATURAL WATER IN DISPOSAL ZONE Yes	ARE WATER ANALYSES ATTACHED? Yes
NAME AND ADDRESS OF SURFACE OWNER (OR LESSEE, IF STATE OR FEDERAL LAND) James N. Chambers, Box 1264, Hobbs, New Mexico					
LIST NAMES AND ADDRESSES OF ALL OPERATORS WITHIN ONE-HALF (1/2) MILE OF THIS INJECTION WELL					
Pan American Petroleum Corporation, Box 1540, Midland, Texas 79701					
Texaco, Inc., Box 3109, Midland, Texas 79701					
Hanagan et al, Box 1737, Roswell, New Mexico 88201 60 SEP 26 1968					
Delaware-Apache, 1720 Wilco Building, Midland, Texas 79701					
Del Lea et al, Box 1889, Hobbs, New Mexico					
HAVE COPIES OF THIS APPLICATION BEEN SENT TO EACH OF THE FOLLOWING?		SURFACE OWNER Yes		EACH OPERATOR WITHIN ONE-HALF MILE OF THIS WELL Yes	
ARE THE FOLLOWING ITEMS ATTACHED TO THIS APPLICATION (SEE RULE 701-B)		PLAT OF AREA Yes		ELECTRICAL LOG Yes	
				THE NEW MEXICO STATE ENGINEER Yes	
				DIAGRAMMATIC SKETCH OF WELL Yes	

I hereby certify that the information above is true and complete to the best of my knowledge and belief.

(Signature)

Division Petroleum Engineer

(Title)

September 13, 1968

(Date)

NOTE: Should waivers from the State Engineer, the surface owner, and all operators within one-half mile of the proposed injection well not accompany this application, the New Mexico Oil Conservation Commission will hold the application for a period of 15 days from the date of receipt by the Commission's Santa Fe office. If at the end of the 15-day waiting period no protest has been received by the Santa Fe office, the application will be processed. If a protest is received, the application will be set for hearing, if the applicant so requests. SEE RULE 701.

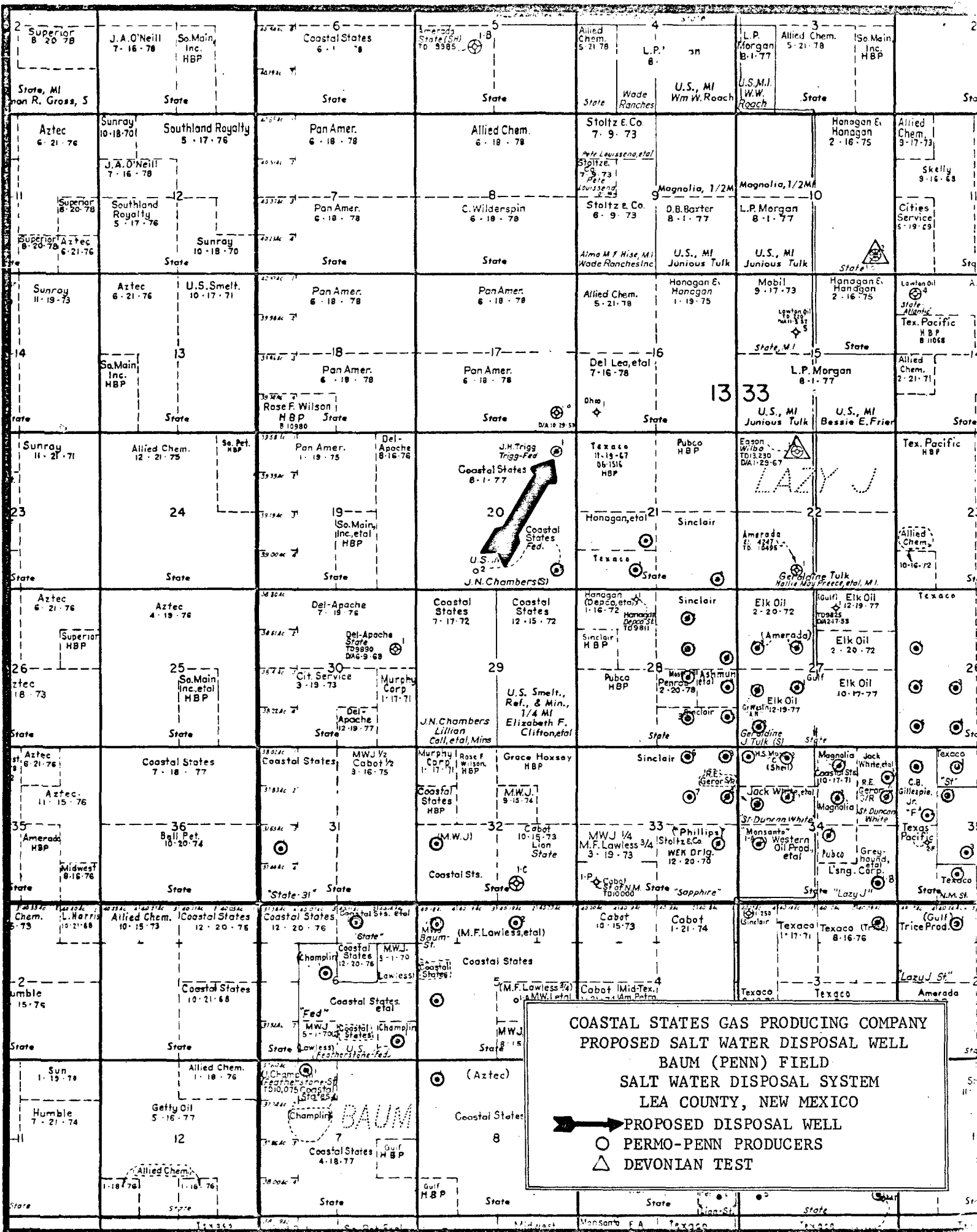

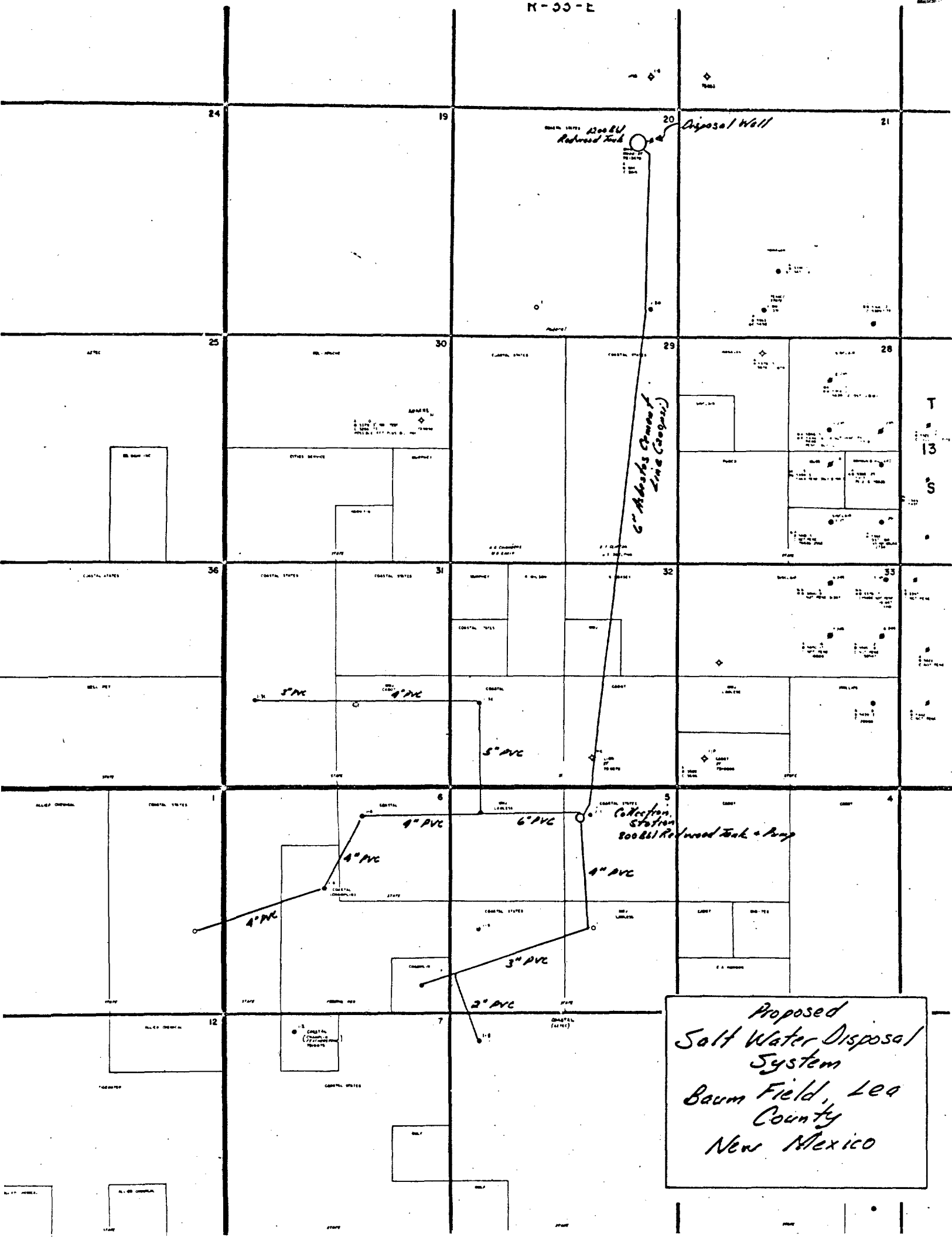

Proposed
Salt Water Disposal
System
Baum Field, Lea
County
New Mexico

Coastal States Gas Prod. Co.

Fed. Trigg #1

NE/4 of NE/4 Sec 50, T135, R33E

ILLEGIBLE

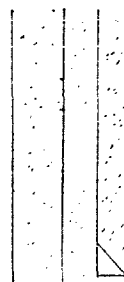
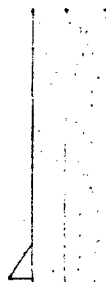

13 3/8" @ 395' w/450 sks.

9 5/8" @ 4060' w/2150 sks.

Calculated cement to

Back to surface.

Wolfcamp

Top of Permian
@ 9590

L

L

5 1/2" @ 9795' w/2162 sks.

Calculated cement to

Back to surface

Dove Permian
Limestone

Top of Wolfcamp (Perm.)
@ 12,165

Top of Permian (Perm.)
@ 12,395

Top of Permian (Perm.)
(Permian, base)
@ 12,500

Top of Permian (Perm.)
@ 12,500

Top of Permian (Perm.)
@ 12,500

TD 12,500'
7 7/8" sks.

Coastal States Gas Producing Company

P.O. Box 235

Midland, Texas 79701

2-22-68

Hobbs, N.M.

Attention: Mr. Joe Howard

State 5 Well #1

Foster Testers Test #2

7.0

1.078

72

CC-0 317 3 072

Endorse

23395

1251

53960

1520

Calicut

5800

290

305

5

Discussion

243

20

1750

36

'-323'

1994

25/05

May 1992

5/10

“*espero*”

Cc y to: Mr. Earl Oden
1231 Copper Ave.
Hobbs, N.M. 88240

W.H. Harrell