

OIL CONSERVATION COMMISSION

P. O. BOX 2088

SANTA FE, NEW MEXICO 87501

June 22, 1971

Sonny's Oil Field Service, Inc.
Box 1438
Hobbs, New Mexico

Gentlemen:

Enclosed herewith please find Administrative
Order No. SWD-121 for your Hobbs State Well No. 3
located in Unit G of Section 29, Township 18 South,
Range 38 East, NMFM, Lea County, New Mexico.

Very truly yours,

A. L. PORTER, Jr.
Secretary-Director

ALP/JEK/og

cc: Oil Conservation Commission - Hobbs
Oil & Gas Engineering Commission - Hobbs

C

O

P

Y

OIL CONSERVATION COMMISSION

P. O. BOX 2088

SANTA FE, NEW MEXICO 87501

SUBJECT: SALT WATER DISPOSAL WELL

ORDER NO. SWD-121

THE APPLICATION OF SONNY'S OIL FIELD
SERVICE, INC. FOR A SALT WATER
DISPOSAL WELL.

ADMINISTRATIVE ORDER
OF THE OIL CONSERVATION COMMISSION

Under the provisions of Rule 701 (C) Sonny's Oil Field Service, Inc., made application to the New Mexico Oil Conservation Commission on June 7, 1971, for permission to complete for salt water disposal its Hobbs State Well No. 3 located in Unit G of Section 29, Township 18 South, Range 38 East, NMPM, Lea County, New Mexico. ^B

The Secretary-Director finds:

1. That application has been duly filed under the provisions of Rule 701 (C) of the Commission Rules and Regulations;
2. That satisfactory information has been provided that all offset operators, surface owners, and the New Mexico State Engineer Office have been duly notified; and
3. That the applicant has presented satisfactory evidence that all requirements prescribed in Rule 701 (C) will be met.
4. That no objections have been received within the waiting period prescribed by said rule.

IT IS THEREFORE ORDERED:

That the applicant herein, Sonny's Oil Field Service, Inc., is hereby authorized to complete its Hobbs State Well No. 3 located in Unit G of Section 29, Township 18 South, Range 38 East, NMPM, Eddy County, New Mexico, in such a manner as to permit the injection of salt water for disposal purposes into the Lower San Andres formation at approximately 5144 feet to approximately 5170 feet through 2-1/2 inch tubing.

IT IS FURTHER ORDERED:

That jurisdiction of this cause is hereby retained by the Commission for such further order or orders as may seem necessary or convenient for the prevention of waste and/or protection of correlative rights; upon failure of applicant to comply with any requirement of this order after notice and hearing, the Commission may terminate the authority hereby granted in the interest of conservation. That applicant shall submit monthly reports of the disposal operation in accordance with Rules 704 and 1120 of the Commission Rules and Regulations.

APPROVED at Santa Fe, New Mexico, on this 22nd day
of June, 1971.

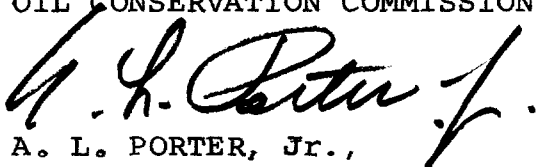
STATE OF NEW MEXICO
OIL CONSERVATION COMMISSION

A. L. PORTER, Jr.,
Secretary-Director

NEW MEXICO OIL CONSERVATION COMMISSION

APPLICATION TO DISPOSE OF SALT WATER BY INJECTION INTO A POROUS FORMATION

| | | | |
|--|----------------------|--|----------------------|
| OPERATOR Sonny's Oil Field Service, Inc. | | ADDRESS Box 1438, Hobbs, N. M. | |
| LEASE NAME HOBBS STATE | WELL NO. 3 | FIELD HOBBS | COUNTY LEA |
| LOCATION UNIT LETTER G ; WELL IS LOCATED 990 FEET FROM THE NORTH LINE AND 1830 FEET FROM THE EAST LINE, SECTION 29 TOWNSHIP 18S RANGE 38E NMPM. | | | |

CASING AND TUBING DATA

| NAME OF STRING | SIZE | SETTING DEPTH | SACKS CEMENT | TOP OF CEMENT | TOP DETERMINED BY |
|----------------|-------|---------------|--|---------------|-------------------|
| SURFACE CASING | | | | | |
| INTERMEDIATE | 9 5/8 | 350 | 200 | CIRCULATED | |
| LONG STRING | 7 | 3850 | 200 | 2300 | |
| TUBING | 4 1/2 | 6083 | 200 | 3112 | |
| | 2 1/2 | 5000 | NAME, MODEL AND DEPTH OF TUBING PACKER | | |

| | | | |
|---|--|---------------------------------|------------------------------------|
| NAME OF PROPOSED INJECTION FORMATION LOWER SAN ANDRES | | TOP OF FORMATION 3825 | BOTTOM OF FORMATION 5360 |
| IS INJECTION THROUGH TUBING, CASING, OR ANNULUS? | | PERFORATIONS OR OPEN HOLES? | PROPOSED INTERVAL(S) OF INJECTION |

| | | | | |
|--|--|---------------------|--|---|
| TUBING | | PERFORATIONS | | 5144 to 5170 |
| IS THIS A NEW WELL DRILLED FOR DISPOSAL? | IF ANSWER IS NO, FOR WHAT PURPOSE WAS WELL ORIGINALLY DRILLED? | | | HAS WELL EVER BEEN PERFORATED IN ANY ZONE OTHER THAN THE PROPOSED INJECTION ZONE? |
| NO | OIL PRODUCER-- DRY | | | YES |

LIST ALL SUCH PERFORATED INTERVALS AND SACKS OF CEMENT USED TO SEAL OFF OR SQUEEZE EACH

| | | | |
|--|--|--|---|
| 5988--5997--6002--6009--6015-- 6025--6029 | | | <i>Will Set Bridge Plug above Perf with Cement on top</i> |
| DEPTH OF BOTTOM OF DEEPEST FRESH WATER ZONE IN THIS AREA 200 | DEPTH OF BOTTOM OF NEXT HIGHER OIL OR GAS ZONE IN THIS AREA 4500 | DEPTH OF TOP OF NEXT LOWER OIL OR GAS ZONE IN THIS AREA 5900 | |

| | | | | | |
|---|-----------------------|------------------------|--|--|---|
| ANTICIPATED DAILY INJECTION VOLUME (BBLs.) 500 | MINIMUM 300 | MAXIMUM 1000 | OPEN OR CLOSED TYPE SYSTEM OPEN | IS INJECTION TO BE BY GRAVITY OR PRESSURE? GRAVITY | APPROX. PRESSURE (PSI) VACUUM |
| ANSWER YES OR NO WHETHER THE FOLLOWING WATERS ARE MINERALIZED TO SUCH A DEGREE AS TO BE UNFIT FOR DOMESTIC, STOCK, IRRIGATION, OR OTHER GENERAL USE - YES | | | WATER TO BE DISPOSED OF PRODUCED | NATURAL WATER IN DISPOSAL ZONE | ARE WATER ANALYSES ATTACHED? NO |

| | |
|--|--|
| NAME AND ADDRESS OF SURFACE OWNER (OR LESSEE, IF STATE OR FEDERAL LAND) CECIL GRIMES ESTATE Hobbs N.M. 122 W. Taylor | |
| LIST NAMES AND ADDRESSES OF ALL OPERATORS WITHIN ONE-HALF (1/2) MILE OF THIS INJECTION WELL | |

| | |
|--|--|
| ATLANTIC RICHFIELD CO, HOBBS | GULF OIL CORP., HOBBS |
| HUMBLE OIL & REF. CO, HOBBS | C. H. SWEET, HOBBS |
| SHELL OIL CO, HOBBS | RICE ENG. & OPERATING CO, HOBBS |
| CONTINENTAL OIL CO, HOBBS | |
| GETTY OIL CO, HOBBS | |

| | | | |
|---|-----------------------------|---|---|
| HAVE COPIES OF THIS APPLICATION BEEN SENT TO EACH OF THE FOLLOWING? YES | SURFACE OWNER YES | EACH OPERATOR WITHIN ONE-HALF MILE OF THIS WELL YES | 71 JUN 7 AM 9 50 |
| ARE THE FOLLOWING ITEMS ATTACHED TO THIS APPLICATION (SEE RULE 701-B) | PLAT OF AREA YES | ELECTRICAL LOG YES | DIAGRAMMATIC SKETCH OF WELL YES |

I hereby certify that the information above is true and complete to the best of my knowledge and belief.

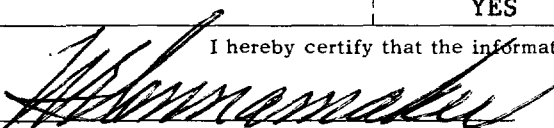
| | | |
|---|-----------------------------|-------------------------------|
|  (Signature) | PRESIDENT (Title) | JUNE 4, 1971 (Date) |
|---|-----------------------------|-------------------------------|

NOTE: Should waivers from the surface owner and all operators within one-half mile of the proposed injection well not accompany this application, the New Mexico Oil Conservation Commission will hold the application for a period of 15 days from the date of receipt by the Commission's Santa Fe office. If at the end of the 15-day waiting period no protest has been received by the Santa Fe office, the application will be processed. If a protest is received, the application will be set for hearing, if the applicant so requests. SEE RULE 701.

Hobbs State #3.
Present & Proposed Conditions

9 5/8 Set @ 350' Circulated

7" set @ 3850 Top Cement 2300

Run 2 7/8 tubing to 5000' - Set Packer @ 5000

New Perf. 5144 to 5170

Will Set Plug @ 5320 with Cement on top

Present Perf 5988 to 6029

NEW MEXICO OIL CONSERVATION COMMISSION
WELL LOCATION AND ACREAGE DEDICATION PLAT

Form C-102
Supersedes C-128
Effective 1-1-65

All distances must be from the outer boundaries of the Section.

| | | | | |
|---|--|-------------------------------------|---------------------------------------|----------------------|
| Operator Ne-O-Tex Corporation | | Lease Hobbs - State | | Well No. 3 |
| Unit Letter B | Section 29 | Township 18 S | Range 38 E | County Lea |
| Actual Footage Location of Well: | | | | |
| 990 feet from the North line and | | 1830 feet from the East line | | |
| Ground Level Elev: 3652 G.L. | Producing Formation Elinebry | Pool Hobbs | Dedicated Acreage: 40 Acres | |

1. Outline the acreage dedicated to the subject well by colored pencil or hachure marks on the plat below.
2. If more than one lease is dedicated to the well, outline each and identify the ownership thereof (both as to working interest and royalty).
3. If more than one lease of different ownership is dedicated to the well, have the interests of all owners been consolidated by communitization, unitization, force-pooling, etc?

☐ Yes ☐ No If answer is "yes," type of consolidation _____

If answer is "no," list the owners and tract descriptions which have actually been consolidated. (Use reverse side of this form if necessary.) _____

No allowable will be assigned to the well until all interests have been consolidated (by communitization, unitization, forced-pooling, or otherwise) or until a non-standard unit, eliminating such interests, has been approved by the Commission.

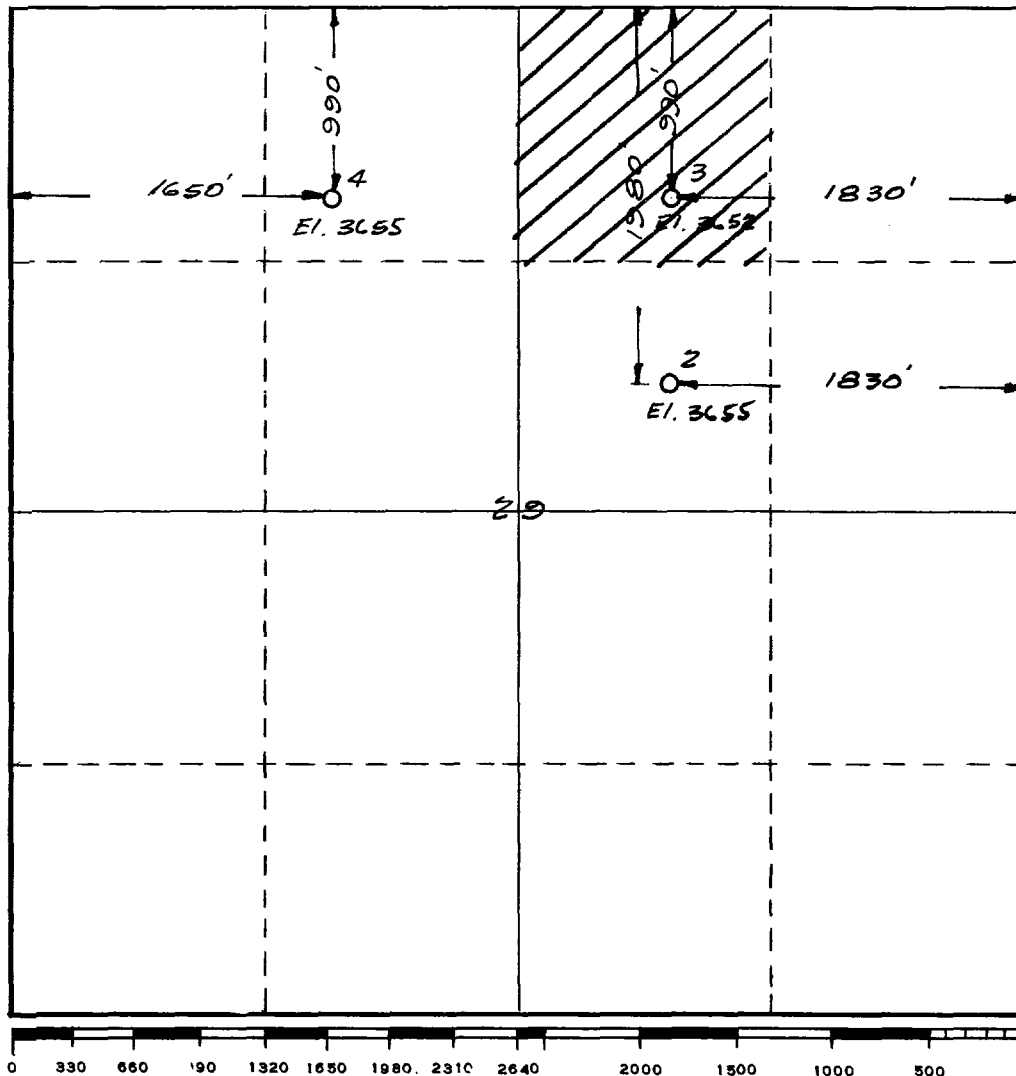

CERTIFICATION

I hereby certify that the information contained herein is true and complete to the best of my knowledge and belief.

Name **John W. Wood, Jr.**
Position **Geologist**
Company **Ne-O-Tex Corporation**
Date **November 2, 1970**

I hereby certify that the well location shown on this plat was plotted from field notes of actual surveys made by me or under my supervision, and that the same is true and correct to the best of my knowledge and belief.

Date Surveyed **Nov. 2, 1970**
Registered Professional Engineer and/or Land Surveyor

Wm. E. Shown
Certificate No. **2185**