

SWD- 174

**PETROLEUM CORPORATION OF TEXAS**

P. O. BOX 911

BRECKENRIDGE, TEXAS 76024

December 2, 1975

Dec 12/1975

State of New Mexico  
Oil Conservation Commission  
P. O. Box 2088  
Santa Fe, New Mexico 87501

Dear Sir:

Enclosed is our application to dispose of salt water in the San Andres zone of our Bate Federal No. 2 well. The water for disposal will come from two other wells on the lease (1. Bate Federal Well No. 1 and 2. Bate A Federal Well No. 3).

A copy of this application has been sent to the district office in Hobbs, New Mexico.

Very truly yours,

  
Charles Stubblefield

CDS/ab

-



**OIL CONSERVATION COMMISSION**

P. O. BOX 2088

**SANTA FE, NEW MEXICO 87501**

January 5, 1975

Petroleum Corporation of Texas  
P. O. Box 911  
Breckenridge, Texas 76024

Re: Administrative Order No. SWD-174

Gentlemen:

Enclosed herewith please find Administrative  
Order No. SWD-174 for the following described well:

Bate Federal Well No. 2  
located in Unit F of  
Section 22, Township 8  
South, Range 36 East,  
Roosevelt County, New Mexico.

Very truly yours,

JOE D. RAMEY  
Secretary-Director

JDR/CU/og

cc: Oil Conservation Commission  
Box 1980  
Hobbs, New Mexico

Oil & Gas Engineering Committee  
Box 127  
Hobbs, New Mexico

OIL CONSERVATION COMMISSION  
P. O. BOX 2088  
SANTA FE, NEW MEXICO 87501

January 1, 1978

Mr. J. Edgar Hoover  
Federal Bureau of Investigation  
Washington, D.C. 20535

Dear Mr. Hoover:

Enclosed

is a copy of a letterhead memorandum dated and captioned as above.  
The information was obtained from a confidential source.

The information was obtained from a confidential source  
and is being furnished to you for your information.  
The information is being furnished to you for your information.  
The information is being furnished to you for your information.

Very truly yours,

W. J. [Signature]  
Director

WJH: [Signature]

Oil Conservation Commission  
P. O. Box 2088  
Santa Fe, New Mexico 87501

Enclosed is a copy of a letterhead memorandum dated and captioned as above.  
The information was obtained from a confidential source.

## NEW MEXICO OIL CONSERVATION COMMISSION

## APPLICATION TO DISPOSE OF SALT WATER BY INJECTION INTO A POROUS FORMATION

OPERATOR Petroleum Corporation of Texas		ADDRESS P.O. Box 911, Breckenridge, Texas 76024	
LEASE NAME Bate Federal	WELL NO. 2	FIELD Prairie Cisco South	COUNTY Roosevelt
LOCATION UNIT LETTER <u>F</u> ; WELL IS LOCATED <u>1980'</u> FEET FROM THE <u>North</u> LINE AND <u>1980'</u> FEET FROM THE <u>West</u> LINE, SECTION <u>22</u> TOWNSHIP <u>8S</u> RANGE <u>36E</u> NMPM. <u>--</u>			

CASING AND TUBING DATA					
NAME OF STRING	SIZE	SETTING DEPTH	SACKS CEMENT	TOP OF CEMENT	TOP DETERMINED BY
SURFACE CASING					
10 3/4"	32.75# 8rd	291'	300 sx.	surface	Circ. Cement
INTERMEDIATE					
7 5/8"	24# & 26#	4115'	315	surface	Circ. Cement
LONG STRING					
4 1/2"	9.5#&11.6#	9729'	150	8643'	Calculated
TUBING			NAME, MODEL AND DEPTH OF TUBING PACKER		
2" EUE		4720'	Baker Tension (Plastic Coated) 4689'		
NAME OF PROPOSED INJECTION FORMATION			TOP OF FORMATION	BOTTOM OF FORMATION	
San Andres			4047	5430	
IS INJECTION THROUGH TUBING, CASING, OR ANNULUS?		PERF. INTERVAL(S) OF INJECTION	PROPOSED INTERVAL(S) OF INJECTION		
Tubing (Plastic Coated)		4810-24	2 shots/ft. 28holes 4801-24'		
IS THIS A NEW WELL DRILLED FOR DISPOSAL?		IF ANSWER IS NO, FOR WHAT PURPOSE WAS WELL ORIGINALLY DRILLED?		HAS WELL EVER BEEN PERFORATED IN ANY ZONE OTHER THAN THE PROPOSED INJECTION ZONE? Yes	
No		Oil Production		Yes	
LIST ALL SUCH PERFORATED INTERVALS AND SACKS OF CEMENT USED TO SEED OR SQUEEZE EACH					
Bough "C" (9678-9688) Cement Retainer @ 7884' & squeeze w/125 sx. (35 sx on top)					
CIBP @ 5000; Perf. 4925 w/4 shots, squeeze w/140 sx. (Perf. 4800, 4 shots, block squeeze w/138sx)					
DEPTH OF BOTTOM OF DEEPEST FRESH WATER ZONE IN THIS AREA		DEPTH OF BOTTOM OF NEXT HIGHER OIL OR GAS ZONE IN THIS AREA		DEPTH OF TOP OF NEXT LOWER OIL OR GAS ZONE IN THIS AREA	
Presume 250'		None		Bough "C" 9675	
ANTICIPATED DAILY INJECTION VOLUME (BBLS.)	MINIMUM	MAXIMUM	OPEN OR CLOSED TYPE SYSTEM	IS INJECTION TO BE BY GRAVITY OR PRESSURE?	APPROX. PRESSURE (PSI)
	45	100	open	pressure	800
ANSWER YES OR NO WHETHER THE FOLLOWING WATERS ARE MINERALIZED TO SUCH A DEGREE AS TO BE UNFIT FOR DOMESTIC, STOCK, IRRIGATION, OR OTHER GENERAL USE -			WATER TO BE DISPOSED OF	NATURAL WATER IN DISPOSAL ZONE	ARE WATER ANALYSES ATTACHED?
			Yes	Yes	No
NAME AND ADDRESS OF SURFACE OWNER (OR LESSEE, IF STATE OR FEDERAL LAND)					
State Land (Mr. Holmes Lovejoy; Milnesand, New Mexico)					
LIST NAMES AND ADDRESSES OF ALL OPERATORS WITHIN ONE-HALF (1/2) MILE OF THIS INJECTION WELL					
Solar Oil Co.; Box 5596; 2101 W Texas; Midland, Texas					
Dedric B. Baxter; Box 4171; 203 Central Bldg.; Midland, Texas					
Max Pray; Palmolive Bldg.; Chicago, Ill.					
Charles B. Read; Box 2126; 314 Security Nat. Bank Bldg.; Roswell, New Mexico					
Coastal States; Box 235; Wilco Bldg.; Midland, Texas					
HAVE COPIES OF THIS APPLICATION BEEN SENT TO EACH OF THE FOLLOWING?	SURFACE OWNER		EACH OPERATOR WITHIN ONE-HALF MILE OF THIS WELL		THE NEW MEXICO STATE ENGINEER
	Yes		Yes		Yes
ARE THE FOLLOWING ITEMS ATTACHED TO THIS APPLICATION (SEE RULE 701-B)	PLAT OF AREA		ELECTRICAL LOG		DIAGRAMMATIC SKETCH OF WELL
	Yes		Yes		Yes

I hereby certify that the information above is true and complete to the best of my knowledge and belief.

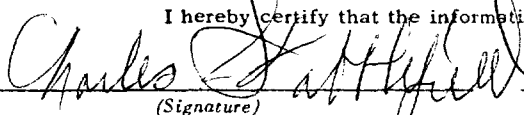

Engineer

(Signature)

(Title)

12-2-1975

(Date)

NOTE: Should waivers from the State Engineer, the surface owner, and all operators within one-half mile of the proposed injection well, not accompany this application, the New Mexico Oil Conservation Commission will hold the application for a period of 15 days from the date of receipt by the Commission's Santa Fe office. If at the end of the 15-day waiting period no protest has been received by the Santa Fe office, the application will be processed. If a protest is received, the application will be set for hearing, if the applicant so requests. SEE RULE 701.

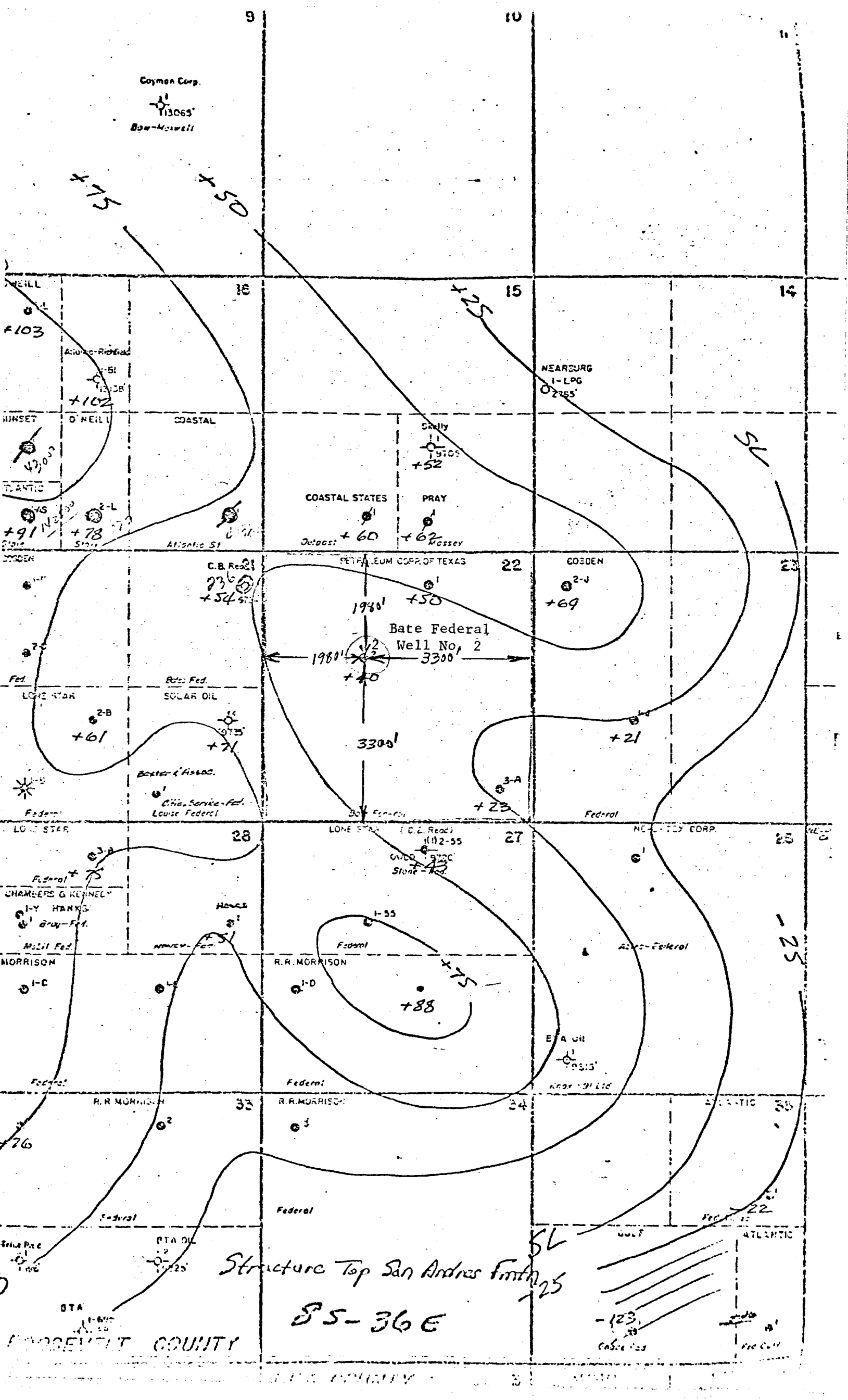

Coyman Corp.

113065'

Bow-McNeil

NEAREBURG  
1-LPG  
2755'

COASTAL STATES

PRAY

PETROLEUM CORP. OF TEXAS

COEDEN

Bate Federal  
Well No. 2

SOLAR OIL

BATE & ASSOC.

CHAMBERS & KENNEDY

R.R. MORRISON

E.A. OIL

ATLANTIC

Structure Top San Andres Fmth

85-36E

MORRISON COUNTY

COASTAL COUNTY

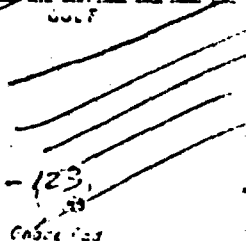

Bate Federal

Well No. 2

(The San Andres Zone is  
the only zone open.)

10 3/4" Surface casing @ 211'  
w/300 AX. cmnt. circ.

7 5/8" @ 4115' w/315 AX. cmnt. circ.

Perf. 4810-24 w/2 shots/ft  
(San Andres Zone)

CIBP @ 5030' Perforated @ 4125 w/4  
shots and cemented w/140 AX.  
Perf. w/4 shots @ 4205' and block  
squeezed w/138 AX.

Cement Retainer at 7825', squeezed  
w/125 AX and placed 35 AX cement  
on top of plug

Casing Collapsed @ 7920'

Baker TBG, ANCHOR CATCHER

20 ft 2 7/8" Tubing

S.N.

Baker Mod. O PKR @ 9623'

Perforations: 9678-9711'  
(Perf plugged on 7/75)

4 1/2" @ 9728'

Date: 11-28-75

PETROLEUM CORPORATION OF TEXAS

P. O. BOX 911

BRECKENRIDGE, TEXAS 76024

December 2, 1975

Mr. Holmes Lovejoy  
Milnesand, New Mexico

Re: Petroleum Corporation of Texas  
Bate Federal Well No. 2  
Prairie Cisco, South Field  
Roosevelt County, New Mexico

Dear Sir:

The Petroleum Corporation of Texas has made application to the New Mexico Conservation Commission to convert the No. 2 Bate Federal well (Unit letter F; 1980 feet from north line and 1980 feet from west line, Section 22, Township 8S Range 36E) to a salt water disposal well. The fluid will be injected into the San Andres zone (4810-4824 feet.)

If you have no objection to this conversion please sign and return three copies of this letter in the enclosed envelope at your earliest convenience.

Very truly yours,

*Charles Stubblefield*  
Charles Stubblefield

I have no objection to the  
granting of a permit to  
inject water into the above  
well at 4810-4824 feet.

By: \_\_\_\_\_

Date: \_\_\_\_\_



PETROLEUM CORPORATION OF TEXAS

P. O. BOX 911

BRECKENRIDGE, TEXAS 76024

December 2, 1975

State Land Commissioner  
P. O. Box 1148  
Santa Fe, New Mexico 87501

Re: Petroleum Corporation of Texas  
Bate Federal Well No. 2  
Prairie Cisco, South Field  
Roosevelt County, New Mexico

Dear Sir:

The Petroleum Corporation of Texas has made application to the New Mexico Conservation Commission to convert the No. 2 Bate Federal Well (Unit letter F; 1980 feet from north line and 1980 feet from west line, Section 22, Township 8S Range 36E) to a salt water disposal well. The fluid will be injected into the San Andres zone (4810-4824 feet.)

If you have no objections to this conversion please sign and return three copies of this letter in the enclosed envelope at your earliest convenience.

Very truly yours,

*Charles Stubblefield*  
Charles Stubblefield

I have no objection to the granting of a permit to inject water into the above well at 4810-4824 feet.

By: \_\_\_\_\_

Date: \_\_\_\_\_





PETROLEUM CORPORATION OF TEXAS

P. O. BOX 911

BRECKENRIDGE, TEXAS 76024

December 1, 1975

Solar Oil Company  
Box 5596; 2101 W Texas  
Midland, Texas

Re: Petroleum Corporation of Texas  
Bate Federal Well No. 2  
Prairie Cisco, South Field  
Roosevelt County, New Mexico

Dear Sir:

The Petroleum Corporation of Texas has made application to the New Mexico Conservation Commission to convert the No. 2 Bate Federal well (Unit letter F; 1980 feet from north line and 1980 feet from west line, Section 22, Township 8S Range 36E) to a salt water disposal well. The fluid will be injected into the San Andres zone (4810-4824 feet.)

If you have no objections to this conversion please sign and return three copies of this letter in the enclosed envelope at your earliest convenience.

Very truly yours,

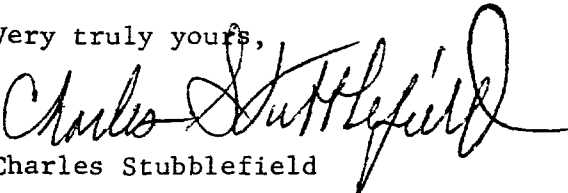
  
Charles Stubblefield

I have no objection to the  
granting of a permit to  
inject water into the above  
well at 4810-4824 feet.

By: \_\_\_\_\_

Date: \_\_\_\_\_



PETROLEUM CORPORATION OF TEXAS

P. O. BOX 911

BRECKENRIDGE, TEXAS 76024

December 1, 1975

Dedric B. Baxter  
Box 4171; 203 Central Bldg.  
Midland, Texas 79704

Re: Petroleum Corporation of Texas  
Bate Federal Well No. 2  
Prairie Cisco, South Field  
Roosevelt County, New Mexico

Dear Sir:

The Petroleum Corporation of Texas has made application to the New Mexico Conservation Commission to convert the No. 2 Bate Federal well (Unit letter F; 1980 feet from north line and 1980 feet from west line, Section 22, Township 8S Range 36E) to a salt water disposal well. The fluid will be injected into the San Andres zone (4810-4824 feet.)

If you have no objections to this conversion please sign and return three copies of this letter in the enclosed envelope at your earliest convenience.

Very truly yours,

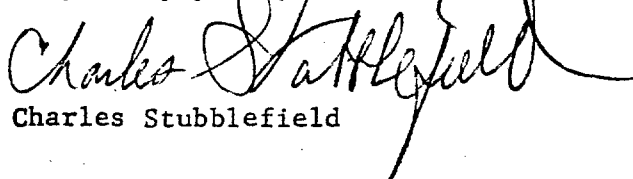
  
Charles Stubblefield

I have no objection to the  
granting of a permit to  
inject water into the above  
well at 4810-4824 feet.

By: \_\_\_\_\_

Date: \_\_\_\_\_



PETROLEUM CORPORATION OF TEXAS

P. O. BOX 911

BRECKENRIDGE, TEXAS 76024

December 1, 1975

Max Pray  
Palmolive Bldg.  
Chicago, Ill.

Re: Petroleum Corporation of Texas  
Bate Federal Well No. 2  
Prairie Cisco, South Field  
Roosevelt County, New Mexico

Dear Sir:

The Petroleum Corporation of Texas has made application to the New Mexico Conservation Commission to convert the No. 2 Bate Federal well (Unit letter F; 1980 feet from north line and 1980 feet from west line, Section 22, Township 8S Range 36E) to a salt water disposal well. The fluid will be injected into the San Andres zone (4810-4824 feet.)

If you have no objections to this conversion please sign and return three copies of this letter in the enclosed envelope at your earliest convenience.

Very truly yours,

*Charles Stubblefield*

Charles Stubblefield

I have no objection to the  
granting of a permit to  
inject water into the above  
well at 4810-4824 feet.

By: \_\_\_\_\_

Date: \_\_\_\_\_



PETROLEUM CORPORATION OF TEXAS

P. O. BOX 911

BRECKENRIDGE, TEXAS 76024

December 1, 1975

Charles B. Read  
Box 2126; 314 Security Nat. Bank Bldg.  
Roswell, New Mexico 88201

Re: Petroleum Corporation of Texas  
Bate Federal Well No. 2  
Prairie Cisco, South Field  
Roosevelt County, New Mexico

Dear Sir:

The Petroleum Corporation of Texas has made application to the New Mexico Conservation Commission to convert the No. 2 Bate Federal well (Unit letter F; 1980 feet from north line and 1980 feet from west line, Section 22, Township 8S Range 36E) to a salt water disposal well. The fluid will be injected into the San Andres zone (4810-4824 feet.)

If you have no objections to this conversion please sign and return three copies of this letter in the enclosed envelope at your earliest convenience.

Very truly yours,

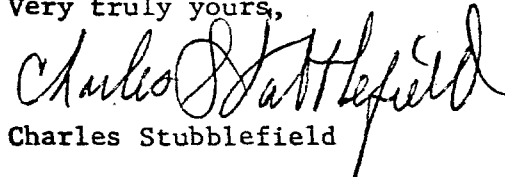
  
Charles Stubblefield

I have no objection to the  
granting of a permit to  
inject water into the above  
well at 4810-4824 feet.

By: \_\_\_\_\_

Date: \_\_\_\_\_



PETROLEUM CORPORATION OF TEXAS

P. O. BOX 911

BRECKENRIDGE, TEXAS 76024

December 1, 1975

Coastal States Gas Producing Co.  
Box 235; Wilco Bldg.  
Midland, Texas 79701

Re: Petroleum Corporation of Texas  
Bate Federal Well No. 2  
Prairie Cisco, South Field  
Roosevelt County, New Mexico

Dear Sir:

The Petroleum Corporation of Texas has made application to the New Mexico Conservation Commission to convert the No. 2 Bate Federal well (Unit letter F; 1980 feet from north line and 1980 feet from west line, Section 22, Township 8S Range 36E) to a salt water disposal well. The fluid will be injected into the San Andres zone (4810-4824 feet.)

If you have no objections to this conversion please sign and return three copies of this letter in the enclosed envelope at your earliest convenience.

Very truly yours,

*Charles Stubblefield*  
Charles Stubblefield

I have no objection to the  
granting of a permit to  
inject water into the above  
well at 4810-4824 feet.

By: \_\_\_\_\_

Date: \_\_\_\_\_



PETROLEUM CORPORATION OF TEXAS

P. O. BOX 911

BRECKENRIDGE, TEXAS 76024

December 1, 1975

State Engineers Office  
Capitol Building  
Santa Fe, New Mexico 87501

Re: Petroleum Corporation of Texas  
Bate Federal Well No. 2  
Prairie Cisco, South Field  
Roosevelt County, New Mexico

Dear Sir:

The Petroleum Corporation of Texas has made application to the New Mexico Conservation Commission to convert the No. 2 Bate Federal well (Unit letter F; 1980 feet from north line and 1980 feet from west line, Section 22, Township 8S Range 36E) to a salt water disposal well. The fluid will be injected into the San Andres zone (4810-4824 feet.)

If you have no objections to this conversion please sign and return three copies of this letter in the enclosed envelope at your earliest convenience.

Very truly yours,

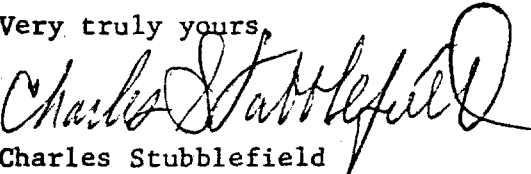
  
Charles Stubblefield

I have no objection to the  
granting of a permit to  
inject water into the above  
well at 4810-4824 feet.

By: \_\_\_\_\_

Date: \_\_\_\_\_



OIL CONSERVATION COMMISSION  
Hobbs DISTRICT

OIL CONSERVATION COMMISSION  
BOX 2088  
SANTA FE, NEW MEXICO

DATE December 8, 1975

RE: Proposed MC \_\_\_\_\_  
Proposed DHC \_\_\_\_\_  
Proposed NSL \_\_\_\_\_  
Proposed SWD X \_\_\_\_\_  
Proposed WFX \_\_\_\_\_  
Proposed PMX \_\_\_\_\_

Gentlemen:

I have examined the application dated \_\_\_\_\_  
for the Petroleum Corp. of Texas Bate Federal #2-F 22-8-36  
Operator Lease and Well No. Unit, S-T-R

and my recommendations are as follows:

O.K.----J.S.  
\_\_\_\_\_  
\_\_\_\_\_  
\_\_\_\_\_  
\_\_\_\_\_  
\_\_\_\_\_

Yours very truly,

Larry Sexton