

Union Oil Company of California
P.O. Box 2867
1001 County Road West, Odessa, Texas 79760
Telephone (915) 332-8228



April 24, 1986

New Mexico Oil Conservation Commission
P.O. Box 2088
State Land Office Building
Sante Fe, New Mexico 87501

Gentlemen:

Case 8928

SUBJECT

Union Oil Company Of California
Application for Administrative Approval
To Use the Wersell Federal No. 2
For Salt Water Disposal

Union Oil Company of California respectfully requests administrative approval to dispose of produced water into the Delaware formation on our Wersell Federal Well No. 2, Section 4, T-22-S, R-27-E, 660' FNL and 660' FWL, Eddy County, New Mexico. We propose to inject produced water from the Delaware formation into Delaware perforations from 2832' - 3794'.

In support of this application, we enclose the following:

1. Completed Form C-108.
2. A map identifying the subject well, its area of review, and all other wells within a two mile radius.
3. A table listing all wells within the area of review having penetrated the proposed SWD interval.
4. A well data form and schematic of all wells within the area of review.
5. An analysis of the injection fluid taken from the producing zone in the area. Note: This is the same zone as the proposed SWD interval.
6. A water analysis from a fresh water supply well near the proposed SWD well.
7. Copies of letters sent to offset leasehold operators.
8. Copies of letter sent to the surface owner.
9. A copy of our legal advertisement of this request published in the Carlsbad Argus.

New Mexico Oil Conservation Commission

Page 2

April 24, 1986

Wersell Federal Well No. 2

Should you need any additional information, please advise. Your early consideration of this request will be greatly appreciated.

Very truly yours,

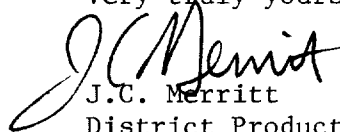
A handwritten signature in dark ink, appearing to read "J.C. Merritt". The signature is fluid and cursive, with the first letters of the first and last names being capitalized and prominent.

J.C. Merritt

District Production Superintendent

MGE;cs

Union Oil Company of California
Wersell Federal Well No. 2

III. Well Data

A. (1) Lease Name: Wersell Federal Com.
Well No.: 2
Location: 660' FNL & FWL
Section 4, T-22-S, R-27-E
Eddy County, New Mexico

(2) Casing Record:

8 5/8", 24#, K-55 set @ 420', 230 SXS, TOC surface
5 1/2", 15.5#, K-55, set @ 4650', 1950 SXS, TOC surface

(3) Tubing (Proposed)

R-7300

2 3/8", 4.7#, J-55, 8rd EUE, internally plastic coated
set @ 2700'

(4) Packer

Baker lock-set, plastic coated mandrel ID set @ 2700'

B. (1) Injection Formation:

Delaware Sand, Esperanza (Delaware) Field

(2) Injection Interval:

Perforations - 2832 - 44', 3022 - 28', 3289 - 3300',
3732 - 50', 3778 - 94'

(3) Well was drilled for oil production. However, it has been
shut-in due to uneconomical production.

(4) There are no other perforated intervals in this wellbore.

(5) There are no higher zones of potential. Depth of next
lower gas zone is 11,268 (morrow).

VI. Tabulation of wells and well data within area of review.

(1) Wersell Federal No. 1 Location: 810' FNL & 1980' FWL
Sec. 4, T-22-S, R-27-E
Eddy County, New Mexico
Type: Oil Producer (Delaware)
Date Drilled: 10/73, Recomplete to
Delaware 9/82

Casing: 13 3/8" @ 400' w/600 SXS
9 5/8" @ 5262' w/2400 SXS
cut and pulled @ 6971'.

VI. Tabulation of wells and well data within area of review (cont.)

- (1) Wersell Federal No. 1 Completion: Perf'd 11,268 - 11,505
Acidized w/ 4750 gals acid
IP 1.56 MMCFD @ 595 psi &
3/4" choke
- Recompleted: (Delaware) 9/82
Perf'd 4392 - 4466'
Acidized w/2000 gals acid
Fracture treat w/15,375 gals
gel & 24000# sand
IPP: 103 BO & 200 BW for 24 Hrs
GOR 117
Perf'd additional zones 11/83
(3267 - 4838)
Acidized w/3000 gals acid
frac w/12000 gals gel & 21000#
sand
IPP 363 BO & 185 BW - 24 Hrs
- 11/83 - Perforated 4822 - 4838'
Dually completed as a producer/
SWD.
- 2/86 - Abandoned SWD operations.

- VII. (1) Proposed avg daily injection rate - 100 - 200 BPD
Proposed maximum daily injection rate - 500 BPD
- (2) System is closed.
- (3) Proposed average injection pressure - 650 psi
Proposed maximum injection pressure - 1000 psi
- (4) Source of injection fluid is the Delaware sand formation, in
an offsetting producer. A water analysis of this fluid is
attached.
- (5) Analysis of disposal zone water is attached. Inferred to be
the same water as indicated in (4) above.

IX. Stimulation Program:

No stimulation will be performed, as the well was fracture treated in
December 1985.

X. Well logs were filed upon original completion of the well.

XI. Analysis of fresh water well attached.

XII. Available geologic and engineering data has been examined and no
evidence of open faults or other hydrologic connection exists
between the disposal zone and any underground source of drinking
water.

Case 8928

APPLICATION FOR AUTHORIZATION TO INJECT

- I. Purpose: ☐ Secondary Recovery ☐ Pressure Maintenance ☒ Disposal ☐ Storage
Application qualifies for administrative approval? ☒ yes ☐ no
- II. Operator: Union Oil Company of California
Address: P.O. Box 671 Midland, Texas 79702
Contact party: J.C. Merritt Phone: (915) 682-9731
- III. Well data: Complete the data required on the reverse side of this form for each well proposed for injection. Additional sheets may be attached if necessary.
- IV. Is this an expansion of an existing project? ☐ yes ☒ no
If yes, give the Division order number authorizing the project _____.
- V. Attach a map that identifies all wells and leases within two miles of any proposed injection well with a one-half mile radius circle drawn around each proposed injection well. This circle identifies the well's area of review.
- * VI. Attach a tabulation of data on all wells of public record within the area of review which penetrate the proposed injection zone. Such data shall include a description of each well's type, construction, date drilled, location, depth, record of completion, and a schematic of any plugged well illustrating all plugging detail.
- VII. Attach data on the proposed operation, including:
1. Proposed average and maximum daily rate and volume of fluids to be injected;
 2. Whether the system is open or closed;
 3. Proposed average and maximum injection pressure;
 4. Sources and an appropriate analysis of injection fluid and compatibility with the receiving formation if other than reinjected produced water; and
 5. If injection is for disposal purposes into a zone not productive of oil or gas at or within one mile of the proposed well, attach a chemical analysis of the disposal zone formation water (may be measured or inferred from existing literature, studies, nearby wells, etc.).
- * VIII. Attach appropriate geological data on the injection zone including appropriate lithologic detail, geological name, thickness, and depth. Give the geologic name, and depth to bottom of all underground sources of drinking water (aquifers containing waters with total dissolved solids concentrations of 10,000 mg/l or less) overlying the proposed injection zone as well as any such source known to be immediately underlying the injection interval.
- IX. Describe the proposed stimulation program, if any.
- * X. Attach appropriate logging and test data on the well. (If well logs have been filed with the Division they need not be resubmitted.)
- * XI. Attach a chemical analysis of fresh water from two or more fresh water wells (if available and producing) within one mile of any injection or disposal well showing location of wells and dates samples were taken.
- XII. Applicants for disposal wells must make an affirmative statement that they have examined available geologic and engineering data and find no evidence of open faults or any other hydrologic connection between the disposal zone and any underground source of drinking water.
- XIII. Applicants must complete the "Proof of Notice" section on the reverse side of this form.
- XIV. Certification
- I hereby certify that the information submitted with this application is true and correct to the best of my knowledge and belief.
- Name: J.C. Merritt Title District Production Supt.
Signature: J.C. Merritt Date: 4/24/86
- * If the information required under Sections VI, VIII, X, and XI above has been previously submitted, it need not be duplicated and resubmitted. Please show the date and circumstance of the earlier submittal.

III. WELL DATA

A. The following well data must be submitted for each injection well covered by this application. The data must be both in tabular and schematic form and shall include:

- (1) Lease name; Well No.; location by Section, Township, and Range; and footage location within the section.
- (2) Each casing string used with its size, setting depth, sacks of cement used, hole size, top of cement, and how such top was determined.
- (3) A description of the tubing to be used including its size, lining material, and setting depth.
- (4) The name, model, and setting depth of the packer used or a description of any other seal system or assembly used.

Division District offices have supplies of Well Data Sheets which may be used or which may be used as models for this purpose. Applicants for several identical wells may submit a "typical data sheet" rather than submitting the data for each well.

B. The following must be submitted for each injection well covered by this application. All items must be addressed for the initial well. Responses for additional wells need be shown only when different. Information shown on schematics need not be repeated.

- (1) The name of the injection formation and, if applicable, the field or pool name.
- (2) The injection interval and whether it is perforated or open-hole.
- (3) State if the well was drilled for injection or, if not, the original purpose of the well.
- (4) Give the depths of any other perforated intervals and detail on the sacks of cement or bridge plugs used to seal off such perforations.
- (5) Give the depth to and name of the next higher and next lower oil or gas zone in the area of the well, if any.

XIV. PROOF OF NOTICE

All applicants must furnish proof that a copy of the application has been furnished, by certified or registered mail, to the owner of the surface of the land on which the well is to be located and to each leasehold operator within one-half mile of the well location.

Where an application is subject to administrative approval, a proof of publication must be submitted. Such proof shall consist of a copy of the legal advertisement which was published in the county in which the well is located. The contents of such advertisement must include:

- (1) The name, address, phone number, and contact party for the applicant;
- (2) the intended purpose of the injection well; with the exact location of single wells or the section, township, and range location of multiple wells;
- (3) the formation name and depth with expected maximum injection rates and pressures; and
- (4) a notation that interested parties must file objections or requests for hearing with the Oil Conservation Division, P. O. Box 2088, Santa Fe, New Mexico 87501 within 15 days.

NO ACTION WILL BE TAKEN ON THE APPLICATION UNTIL PROPER PROOF OF NOTICE HAS BEEN SUBMITTED.

NOTICE: Surface owners or offset operators must file any objections or requests for hearing of administrative applications within 15 days from the date this application was mailed to them.

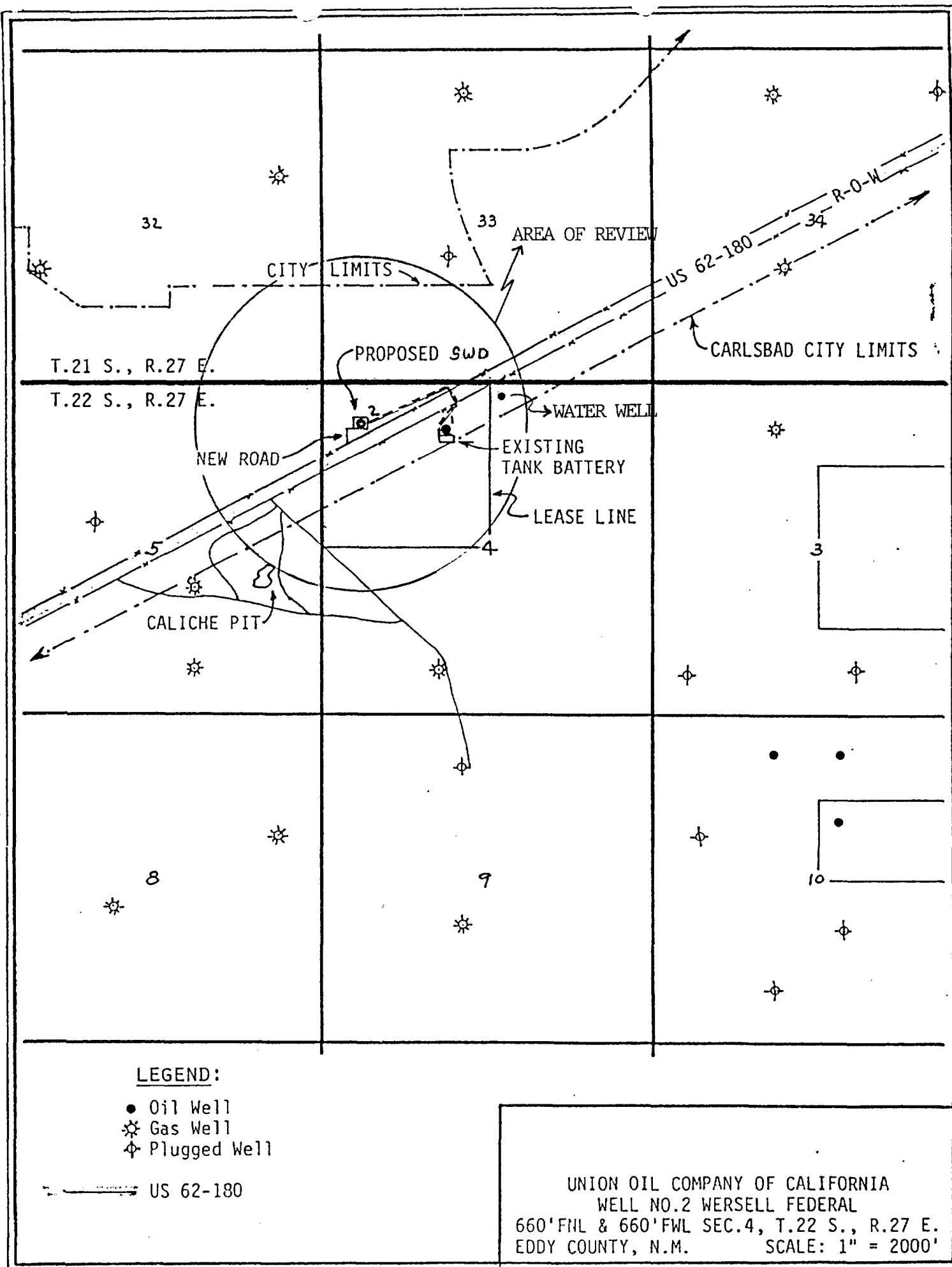

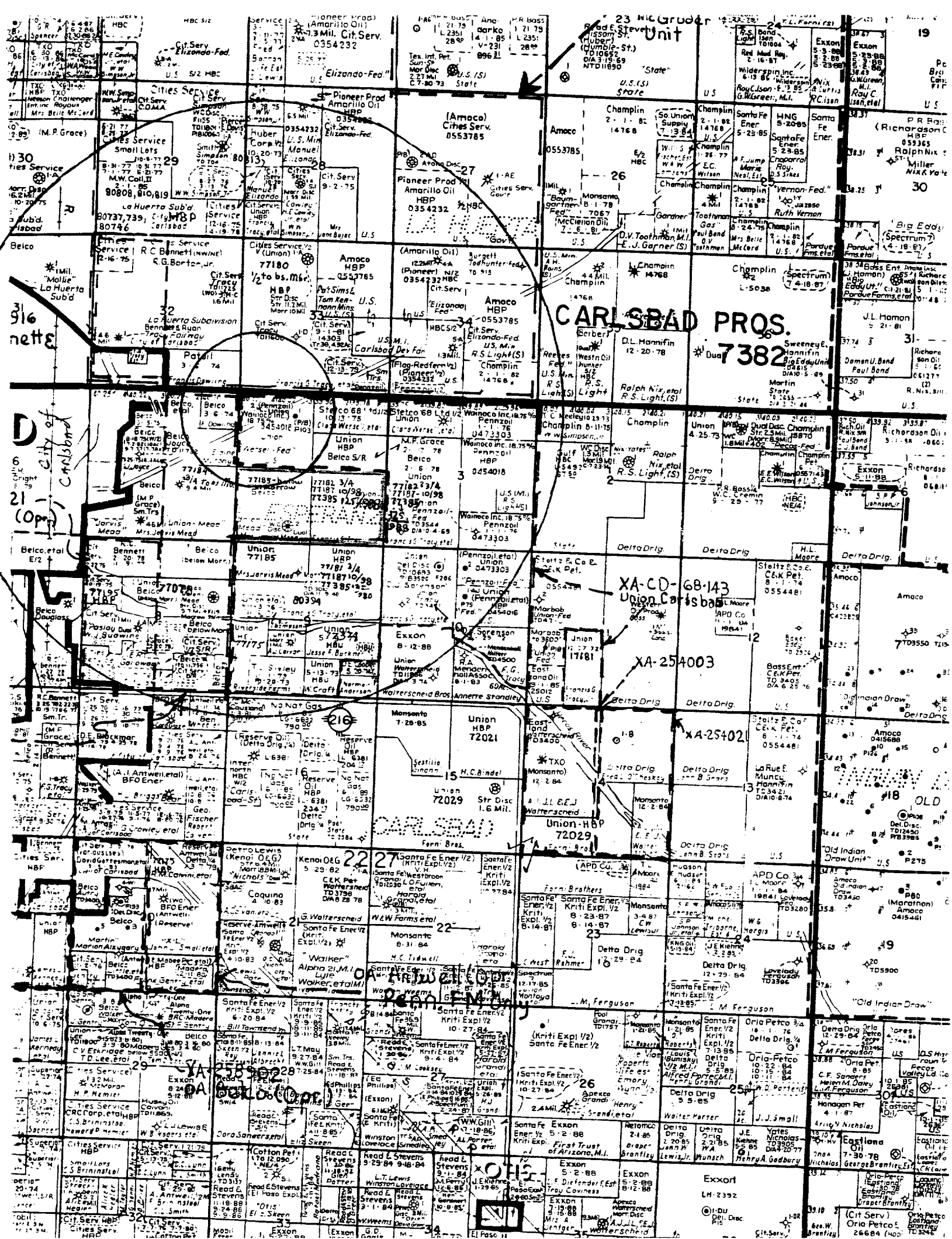

UNION OIL WERSELL FEDERAL NO. 2 GEOLOGIC SUMMARY

- VIII. The proposed injection zone in the Union Oil Wersell Federal No. 1, Section 4, T-22-S, R-27-E, Eddy County, New Mexico is in the Delaware Sand of the Guadalupian Series of Permian Age. The top of the Delaware Sand is at 1938' (+1248'). The proposed injection zone is various intervals from 2832 - 3794'. This is a basinal facies. The injection intervals are 100% tan to brown, fine- medium grained sand. An impervious shale zone overlies these intervals.

The only known possible source of drinking water in the area are at relatively shallow depths less than 1926'. These zones are the Santa Rosa and Ogallala formations of Tertiary Age. There is no evidence of faultings in the area which could cause these possible sources of drinking water to be contaminated by any injections of salt water in the proposed interval.

MGE

2 17 86

Wersell Federal No. 2

(Proposed SWD) Installation)

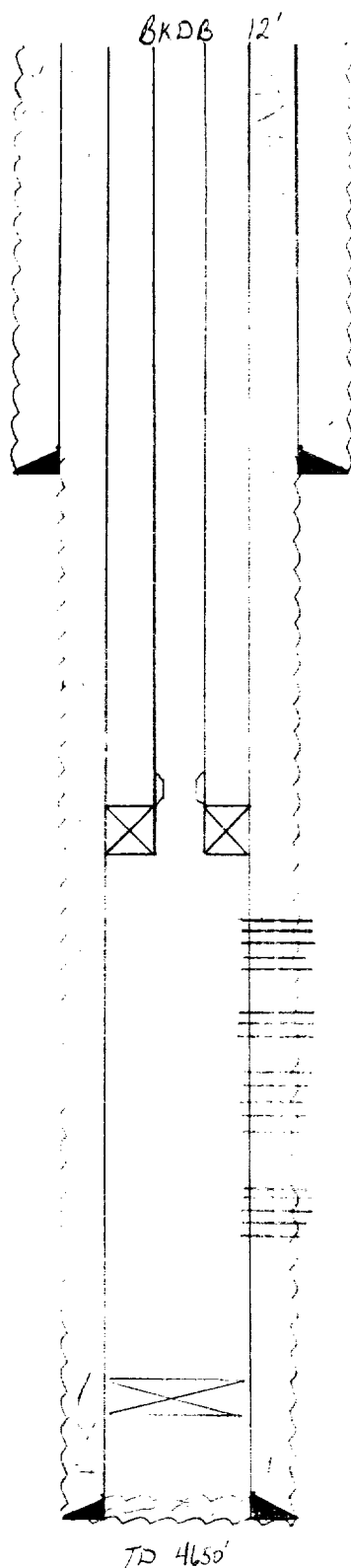

Casing: 8⁵/₈" 24# K-55, ST&C, 8rd @ 420', cmt to surf.
5¹/₆" 15.5# K-55, ST&C, 2rd @ 4650', cmt to surf

Perforations: 2832-44, 3022-28, 3287-3300',
3732-3744, 3778-3794', w/ 1 JSPP

Packer: Baker lockset @ 2700'

Tubing: 2³/₈" 4.7# 8rd ST&C, J-55. PCID Tbz
@ 2700'±

Remarks: CIBP pushed to 4407' (Not set)

Schematic: Wersell Federal Well No. 1

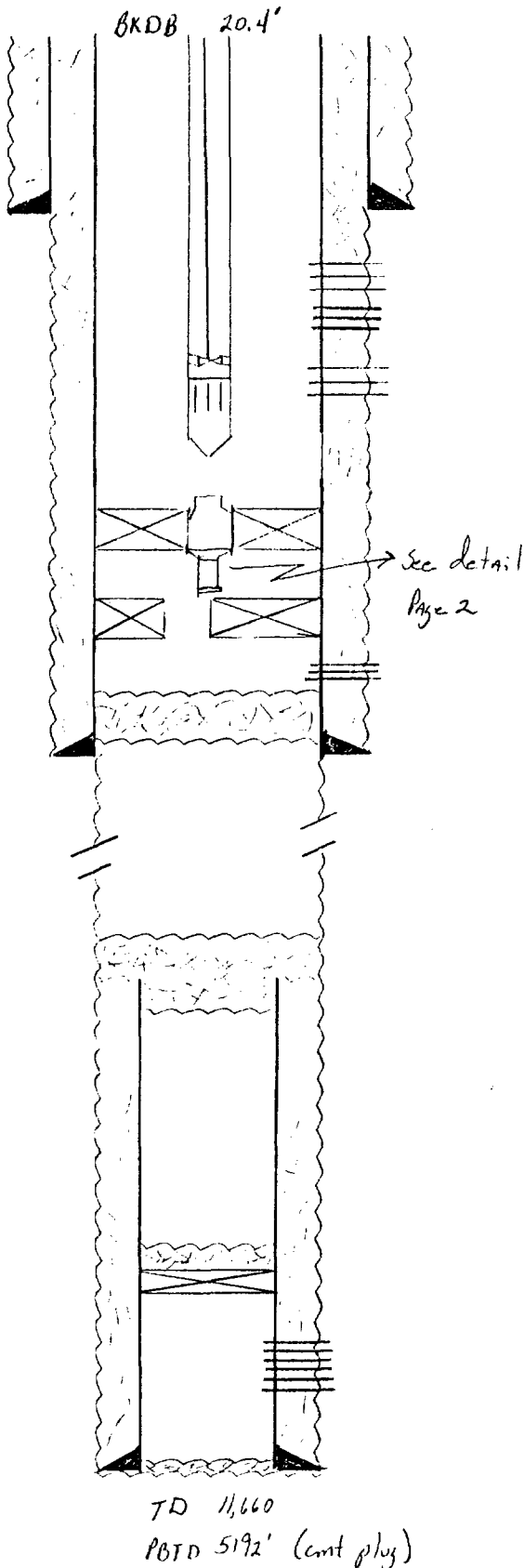

Casing: 13 $\frac{3}{8}$ ", 48#, H-40, ST+C @ 400.20', cmt to surf
 9 $\frac{5}{8}$ ", 40#, N-80, LT+C @ 526.2', cmt to surf
 5 $\frac{1}{2}$ ", 17#, K-55 & N-80, L+S+Bu#, @ 11,660'

TOC @ 8180' by survey

* (cut + pulled 223 jts + lpc, 5 $\frac{1}{2}$ ", 17#,
 N-80 + K-55, Bu#, LT+C, ST+C csg
 @ 6970.68' on Aug 17, 1982)

Perforations (Morrow) 11,248-272, 11,337-348, 11,473-477

11,501-505, (All Abandoned)

(Delaware) 4822-4838 (isolated below plug +
 blanking sub)

(Delaware) 3267-82, 3467-78, 3883-89

3896-3910, 4392-96

4458-4466

(open + producing)

PKR: Baker Model D @ 4775' (leaking Mandrel)

OTIS 9 $\frac{5}{8}$ " 29.3-53.5" WB @ 4754'

w/ blanking plug

Plugs: CIBP @ 11,090' w/ 22' cmt cap

cmt plug @ 6940' spotted 7060-7260'

cmt plug @ 5192' spotted 5334-5184'

Tubing R+L 149 jts (4726') 2 $\frac{3}{8}$ " SUS 8rd

J-55 Tbg @ 4744.48' w/ SN @ 4715.38'

+ Orange Peeled Slotted MA @ 4716.48'

Rods: 7/8-81, 3/4-100, 6-7/8" on top of pump

Pump: Hxelson KWT C 2" x 1.5" x 18'

3 cup BHP

RESULT OF WATER ANALYSES

TO: Mr. Steve Gault
P.O. Box 2867, Odessa, Texas

LABORATORY NO. 286316
SAMPLE RECEIVED 2-24-86
RESULTS REPORTED 2-26-86

COMPANY Union Oil Company of California LEASE Wersell Federal #2
FIELD OR POOL Esperanza
SECTION BLOCK SURVEY COUNTY Eddy STATE NM
SOURCE OF SAMPLE AND DATE TAKEN:

NO. 1 Produced water - taken from Wersell Federal #2.

NO. 2

NO. 3

NO. 4

REMARKS: Delaware Sand

CHEMICAL AND PHYSICAL PROPERTIES				
	NO. 1	NO. 2	NO. 3	NO. 4
Specific Gravity at 60° F.	1.1162			
pH When Sampled				
pH When Received	7.02			
Bicarbonate as HCO ₃	634			
Supersaturation as CaCO ₃				
Undersaturation as CaCO ₃				
Total Hardness as CaCO ₃	20.000			
Calcium as Ca	6.240			
Magnesium as Mg	1.069			
Sodium and/or Potassium	57.722			
Sulfate as SO ₄	1.698			
Chloride as Cl	101.557			
Iron as Fe	134			
Barium as Ba				
Turbidity, Electric				
Color as Pt				
Total Solids, Calculated	168.921			
Temperature °F.				
Carbon Dioxide, Calculated				
Dissolved Oxygen, Winkler				
Hydrogen Sulfide	650			
Resistivity, ohms/m at 77° F.	- measured	0.063		
Suspended Oil				
Filtrable Solids as mg/l				
Volume Filtered, ml				

Results Reported As Milligrams Per Liter

Additional Determinations And Remarks The above water characteristics are very similar to one of the Delaware zones we have recorded in the Burton Flat field. We also note it is very similar to the water from Wersell Federal #1 reported on laboratory #186426 (1-31-86).

709 W INDIANA
MIDLAND, TEXAS 79701
PHONE 683-4521

RESULT OF WATER ANALYSES

TO: Mr. Steve Gault
P.O. Box 2867, Odessa, Texas

LABORATORY NO. 283313

SAMPLE RECEIVED 2-15-83

RESULTS REPORTED 2-12-83

COMPANY Union Oil Company of California LEASE Wirsell Fed

FIELD OR POOL

SECTION _____ BLOCK _____ SURVEY _____ COUNTY _____ STATE _____

SOURCE OF SAMPLE AND DATE TAKEN:

NO. 1 Raw water - taken from water well, 2-14-83

NO. 2 Produced water- taken from Wirsell Fed #1. 2-14-83

NO. 3

NO. 4

REMARKS:

CHEMICAL AND PHYSICAL PROPERTIES				
	NO. 1	NO. 2	NO. 3	NO. 4
Specific Gravity at 60° F.	1.0075	1.1627		
pH When Sampled				
pH When Received	7.4	5.9		
Bicarbonate as HCO ₃	215	68		
Supersaturation as CaCO ₃				
Undersaturation as CaCO ₃				
Total Hardness as CaCO ₃	2,640	39,500		
Calcium as Ca	564	12,400		
Magnesium as Mg	238	2,066		
Sodium and/or Potassium	416	79,740		
Sulfate as SO ₄	2,198	485		
Chloride as Cl	767	150,560		
Iron as Fe	0.47	18.3		
Barium as Ba				
Turbidity, Electric				
Color as Pt				
Total Solids, Calculated	4,498	245,319		
Temperature °F.				
Carbon Dioxide, Calculated				
Dissolved Oxygen, Winkler				
Hydrogen Sulfide	0.0	0.0		
Resistivity, ohms/m at 77° F.	2.33	0.056		
Suspended Oil				
Filtrable Solids as mg/l				
Volume Filtered, ml				

Results Reported As Milligrams Per Liter

Additional Determinations And Remarks We are not familiar with the objective or the area involved herein. However, if we can be of any assistance in interpreting these results please contact us.

Affidavit of Publication

State of New Mexico,
County of Eddy, ss.

E. C. Cantwell, being first duly sworn,
on oath says:

That he is publisher of the Carlsbad Current-Argus, a newspaper published daily at the City of Carlsbad, in said county of Eddy, state of New Mexico and of general paid circulation in said county; that the same is a duly qualified newspaper under the laws of the state wherein legal notices and advertisements may be published; that the printed notice attached hereto was published in the regular and entire edition of said newspaper and not in supplement thereof on the date as follows, to wit:

April 9, , 19 86
_____, 19 ____
_____, 19 ____
_____, 19 ____

that the cost of publication is \$ 11.03 ,
and that payment thereof has been made
and will be assessed as court costs.

E. C. Cantwell

Subscribed and sworn to before me this

10 day of April , 19 86
Donella Ayer

My commission expires 6/01/88
Notary Public

April 9, 1986
NOTICE
To Whom It May Concern:
Union Oil Company of California
proposes to commence drilling follow-
ing to a salt water disposal well,
Wersell Federal Well No. 1, 680'
FWL and FWL Section at T-22-S,
R-27-E, Eddy County, New Mexi-
co.
The intended purpose of the con-

version is to dispose of Delaware
produced water into the Dela-
ware formation between
between 2832' and 3752'. The
estimated production of this
pressure is 1000 barrels per day
and 500 BPD respectively. Inter-
ested parties must file objections
or requests for hearing with the
Oil Conservation Division, P.O.
Box 2088, Santa Fe, New Mexico
87501, within 15 days of the
date of this publication. For fur-
ther information, contact John
Merritt at Union Oil Company of
California, P.O. Box 9700, El Paso,
Texas 79702, or (817) 835-1515,
682-4731.
Please send a copy of this publi-
cation, as well as your objection,
and the name of your com-
pany, to John
Merritt, Union Oil Company of California,
Texas.

John C. Merritt
District Production
Superintendent



Union Oil Company of California

P.O. Box 2867

1001 County Road West, Odessa, Texas 79760

Telephone (915) 332-8228



March 31, 1986

Carlsbad Current-Argus
620 South Main and Trust
Carlsbad, New Mexico 88220

Gentlemen:

Please publish the following in the Legal Notice section of your newspaper one day during the week of March 31, 1986.

NOTICE

To Whom It May Concern:

Union Oil Company of California proposes to convert the following to a salt water disposal well.

Wersell Federal Well No. 2, 660' FNL and FWL, Section 4, T-22-S, R-27-E, Eddy County, New Mexico

The intended purpose of the conversion is to dispose of Delaware produced water into the Delaware formation at a depth between 2832' - 3794'. The estimated maximum injection pressure and rate will be 1000 psi and 500 BPD respectively. Interested parties must file objections or requests for hearing with the Oil Conservation Division, P.O. Box 2088, Santa Fe, New Mexico 87501, within 15 days from the date of this publication. For further information, contact John Merritt at Union Oil Company of California, P.O. Box 671, Midland, Texas 79702, or telephone (915) 682-9731.

Please send a copy of this publication, an affidavit of publication, and the invoice to Union Oil Company of California, Attn: John Merritt, P.O. Box 671, Midland, Texas 79702.

Very truly yours,

A handwritten signature in black ink that reads "J.C. Merritt".

J.C. Merritt

District Production Superintendent

MGE;cs

Union Oil Company of California
P.O. Box 2867
1001 County Road West, Odessa, Texas 79760
Telephone (915) 332-8228



March 31, 1986

Paul H. Wersell
P.O. Box 666
Carlsbad, New Mexico 88220

Dear Mr. Wersell:

This is notification to you, as owner of the surface land, that Union Oil Company of California proposes to convert to salt water disposal the Wersell Federal Well No. 2; 660' FNL and FWL, Section 4, T-22-S, R-27-E, Eddy County, New Mexico. Attached are copies of the applications for authorization to inject. Any objections or requests for hearing of administrative applications must be filed with the Oil Conservation Division, P.O. Box 2088, Sante Fe, New Mexico 87501, within 15 days from the date this application was mailed to you.

Very truly yours,

A handwritten signature in dark ink, appearing to read "J.C. Merritt".

J.C. Merritt
District Production Superintendent

MGE;cs
enclosures

Union Oil Company of California
P.O. Box 2867
1001 County Road West, Odessa, Texas 79760
Telephone (915) 332-8228



March 31, 1986

Wainoco Oil & Gas Company
1200 Smith Street; Suite 1500
Houston, Texas 77002

Gentlemen:

SUBJECT

Conversion to Salt Water Disposal
Union Oil Company of California's
Wersell Federal Well No. 2
Esperanza (Delaware) Field

This is notification to you, as an offset leasehold operator within one-half mile of the subject well's location, that Union Oil Company of California proposes to convert to salt water disposal the Wersell Federal Well No. 2; 660' FNL and FWL, Section 4, T-22-S, R-27-E, Eddy County, New Mexico. Attached are copies of the applications for authorization to inject. Any objections or requests for hearing of administrative applications must be filed with the Oil Conservation Division, P.O. Box 2088, Santa Fe, New Mexico 87501, within 15 days from the date this application was mailed to you.

Very truly yours,

A handwritten signature in dark ink, appearing to read "J.C. Merritt".

J.C. Merritt
District Production Superintendent

MGE;cs

Union Oil Company of California
P.O. Box 2867
1001 County Road West, Odessa, Texas 79760
Telephone (915) 332-8228



March 31, 1986

Pennzoil Company
P.O. Drawer 1828
Midland, Texas 79702

Gentlemen:

SUBJECT

Conversion to Salt Water Disposal
Union Oil Company of California's
Wersell Federal Well No. 2
Esperanza (Delaware) Field

This is notification to you, as an offset leasehold operator within one-half mile of the subject well's location, that Union Oil Company of California proposes to convert to salt water disposal the Wersell Federal Well No. 2; 660' FNL and FWL, Section 4, T-22-S, R-27-E, Eddy County, New Mexico. Attached are copies of the applications for authorization to inject. Any objections or requests for hearing of administrative applications must be filed with the Oil Conservation Division, P.O. Box 2088, Sante Fe, New Mexico 87501, within 15 days from the date this application was mailed to you.

Very truly yours,

A handwritten signature in dark ink, appearing to read "J.C. Merritt".

J.C. Merritt

District Production Superintendent

MGE;cs

Union Oil Company of California
P.O. Box 2867
1001 County Road West, Odessa, Texas 79760
Telephone (915) 332-8228



March 31, 1986

David J. Sorenson
P.O. Box 1453
Roswell, New Mexico 88201

Gentlemen:

SUBJECT

Conversion to Salt Water Disposal
Union Oil Company of California's
Wersell Federal Well No. 2
Esperanza (Delaware) Field

This is notification to you, as an offset leasehold operator within one-half mile of the subject well's location, that Union Oil Company of California proposes to convert to salt water disposal the Wersell Federal Well No. 2; 660' FNL and FWL, Section 4, T-22-S, R-27-E, Eddy County, New Mexico. Attached are copies of the applications for authorization to inject. Any objections or requests for hearing of administrative applications must be filed with the Oil Conservation Division, P.O. Box 2088, Sante Fe, New Mexico 87501, within 15 days from the date this application was mailed to you.

Very truly yours,

A handwritten signature in dark ink, appearing to read "J.C. Merritt".

J.C. Merritt
District Production Superintendent

MGE;cs

Union Oil Company of California
P.O. Box 2867
1001 County Road West, Odessa, Texas 79760
Telephone (915) 332-8228



March 31, 1986

Belco Petroleum Corp.
411 Petroleum Building
Midland, Texas 79701

Gentlemen:

SUBJECT

Conversion to Salt Water Disposal
Union Oil Company of California's
Wersell Federal Well No. 2
Esperanza (Delaware) Field

This is notification to you, as an offset leasehold operator within one-half mile of the subject well's location, that Union Oil Company of California proposes to convert to salt water disposal the Wersell Federal Well No. 2; 660' FNL and FWL, Section 4, T-22-S, R-27-E, Eddy County, New Mexico. Attached are copies of the applications for authorization to inject. Any objections or requests for hearing of administrative applications must be filed with the Oil Conservation Division, P.O. Box 2088, Sante Fe, New Mexico 87501, within 15 days from the date this application was mailed to you.

Very truly yours,

A handwritten signature in cursive script, appearing to read "J.C. Merritt".

J.C. Merritt

District Production Superintendent

MGE;cs

Union Oil Company of California
P.O. Box 2867
1001 County Road West, Odessa, Texas 79760
Telephone (915) 332-8228



March 31, 1986

Cities Service Company
P.O. Box 1919
Midland, Texas 79702

Gentlemen:

SUBJECT

Conversion to Salt Water Disposal
Union Oil Company of California's
Wersell Federal Well No. 2
Esperanza (Delaware) Field

This is notification to you, as an offset leasehold operator within one-half mile of the subject well's location, that Union Oil Company of California proposes to convert to salt water disposal the Wersell Federal Well No. 2; 660' FNL and FWL, Section 4, T-22-S, R-27-E, Eddy County, New Mexico. Attached are copies of the applications for authorization to inject. Any objections or requests for hearing of administrative applications must be filed with the Oil Conservation Division, P.O. Box 2088, Sante Fe, New Mexico 87501, within 15 days from the date this application was mailed to you.

Very truly yours,

A handwritten signature in dark ink, appearing to read "J.C. Merritt".

J.C. Merritt
District Production Superintendent

MGE;cs

Union Oil Company of California
P.O. Box 2867
1001 County Road West, Odessa, Texas 79760
Telephone (915) 332-8228



March 31, 1986

Amoco Production Company
P.O. Box 3092
Houston, Texas 77253

Gentlemen:

SUBJECT

Conversion to Salt Water Disposal
Union Oil Company of California's
Wersell Federal Well No. 2
Esperanza (Delaware) Field

This is notification to you, as an offset leasehold operator within one-half mile of the subject well's location, that Union Oil Company of California proposes to convert to salt water disposal the Wersell Federal Well No. 2; 660' FNL and FWL, Section 4, T-22-S, R-27-E, Eddy County, New Mexico. Attached are copies of the applications for authorization to inject. Any objections or requests for hearing of administrative applications must be filed with the Oil Conservation Division, P.O. Box 2088, Sante Fe, New Mexico 87501, within 15 days from the date this application was mailed to you.

Very truly yours,

A handwritten signature in dark ink, appearing to read "J.C. Merritt".

J.C. Merritt

District Production Superintendent

MGE;cs

Union Oil Company of California
P.O. Box 2867
1001 County Road West, Odessa, Texas 79760
Telephone (915) 332-8228



March 31, 1986

Flag-Redfern Oil Company
P.O. Box 11050
Midland, Texas 79702

Gentlemen:

SUBJECT

Conversion to Salt Water Disposal
Union Oil Company of California's
Wersell Federal Well No. 2
Esperanza (Delaware) Field

This is notification to you, as an offset leasehold operator within one-half mile of the subject well's location, that Union Oil Company of California proposes to convert to salt water disposal the Wersell Federal Well No. 2; 660' FNL and FWL, Section 4, T-22-S, R-27-E, Eddy County, New Mexico. Attached are copies of the applications for authorization to inject. Any objections or requests for hearing of administrative applications must be filed with the Oil Conservation Division, P.O. Box 2088, Sante Fe, New Mexico 87501, within 15 days from the date this application was mailed to you.

Very truly yours,

A handwritten signature in dark ink, appearing to read "J.C. Merritt".

J.C. Merritt
District Production Superintendent

MGE;cs

Union Oil Company of California
P.O. Box 2867
1001 County Road West, Odessa, Texas 79760
Telephone (915) 332-8228



March 31, 1986

Pioneer Production Company
1303 First National Bank Building
Midland, Texas 79701

Gentlemen:

SUBJECT

Conversion to Salt Water Disposal
Union Oil Company of California's
Wersell Federal Well No. 2
Esperanza (Delaware) Field

This is notification to you, as an offset leasehold operator within one-half mile of the subject well's location, that Union Oil Company of California proposes to convert to salt water disposal the Wersell Federal Well No. 2; 660' FNL and FWL, Section 4, T-22-S, R-27-E, Eddy County, New Mexico. Attached are copies of the applications for authorization to inject. Any objections or requests for hearing of administrative applications must be filed with the Oil Conservation Division, P.O. Box 2088, Sante Fe, New Mexico 87501, within 15 days from the date this application was mailed to you.

Very truly yours,

A handwritten signature in cursive script, appearing to read "J.C. Merritt".

J.C. Merritt
District Production Superintendent

MGE;cs

Union Oil Company of California
P.O. Box 2867
1001 County Road West, Odessa, Texas 79760
Telephone (915) 332-8228



March 31, 1986

Champlin Petroleum Company
300 Wilco Building
Midland, Texas 79701

Gentlemen:

SUBJECT

Conversion to Salt Water Disposal
Union Oil Company of California's
Wersell Federal Well No. 2
Esperanza (Delaware) Field

This is notification to you, as an offset leasehold operator within one-half mile of the subject well's location, that Union Oil Company of California proposes to convert to salt water disposal the Wersell Federal Well No. 2; 660' FNL and FWL, Section 4, T-22-S, R-27-E, Eddy County, New Mexico. Attached are copies of the applications for authorization to inject. Any objections or requests for hearing of administrative applications must be filed with the Oil Conservation Division, P.O. Box 2088, Sante Fe, New Mexico 87501, within 15 days from the date this application was mailed to you.

Very truly yours,

A handwritten signature in dark ink, appearing to read "J.C. Merritt", written over the typed name.

J.C. Merritt
District Production Superintendent

MGE;cs

Union Oil Company of California
P.O. Box 2867
1001 County Road West, Odessa, Texas 79760
Telephone (915) 332-8228



March 31, 1986

Patoil
P.O. Box 3814
Midland, Texas 79702

Gentlemen:

SUBJECT

Conversion to Salt Water Disposal
Union Oil Company of California's
Wersell Federal Well No. 2
Esperanza (Delaware) Field

This is notification to you, as an offset leasehold operator within one-half mile of the subject well's location, that Union Oil Company of California proposes to convert to salt water disposal the Wersell Federal Well No. 2; 660' FNL and FWL, Section 4, T-22-S, R-27-E, Eddy County, New Mexico. Attached are copies of the applications for authorization to inject. Any objections or requests for hearing of administrative applications must be filed with the Oil Conservation Division, P.O. Box 2088, Sante Fe, New Mexico 87501, within 15 days from the date this application was mailed to you.

Very truly yours,

A handwritten signature in cursive script, appearing to read "J.C. Merritt".

J.C. Merritt
District Production Superintendent

MGE;cs