

V-F Petroleum Inc.

suite 580 one marienfeld place midland, texas 79701 915 683-3344 fax 915 683-3352

OIL CONSERVATION DIVISION

OCT 06 1992 PM 10 03

October 7, 1992

State of New Mexico
Oil Conservation Division
P.O. Box 2088
Santa Fe, New Mexico 87504-2088

RELEASE 10.27.92

Re: Application For Authorization
To Inject
Kathy Folk #1 Well
Lea County, New Mexico

Gentlemen:

V-F Petroleum Inc. respectfully requests authority to convert the Kathy Folk Well #1, Sec. 32, T-16-S, R-35-E, Lea County, New Mexico to a water disposal well. In support of this request, an original and one copy of the following is attached:

1. Plat identifying all wells and leases within two miles and wells within the area of review.
2. Table of wells within the area of review.
3. Form C-108 with attachments.
4. Form C-102
5. Injection well data sheet.
6. Affidavit of publication.
7. List of offset operators and surface owner.
8. Receipts showing that the application was sent to offset operators and surface owner.

Your favorable consideration of the application would be greatly appreciated. Should you have any questions regarding the above, please call me at the above number.

Very truly yours,

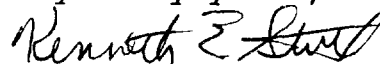

Kenneth E. Stull
Geologist
Engineering Technician

xc: Division district office--Hobbs
Surface owner and offset operators

ks/kfolk.swdltr

APPLICATION FOR AUTHORIZATION TO INJECT

- I. Purpose: ☐ Secondary Recovery ☐ Pressure Maintenance ☒ Disposal ☐ Storage
Application qualifies for administrative approval? ☐ yes ☐ no
- II. Operator: V-F PETROLEUM INC.
Address: ONE MARIENFELD PLACE, STE 580 MIDLAND, TX 79701
Contact party: WAYNE LUNA/KENNETH E. STULL Phone: 915/683-3344
- III. Well data: Complete the data required on the reverse side of this form for each well proposed for injection. Additional sheets may be attached if necessary.
- IV. Is this an expansion of an existing project? ☐ yes ☒ no
If yes, give the Division order number authorizing the project _____.
- V. Attach a map that identifies all wells and leases within two miles of any proposed injection well with a one-half mile radius circle drawn around each proposed injection well. This circle identifies the well's area of review.
- * VI. Attach a tabulation of data on all wells of public record within the area of review which penetrate the proposed injection zone. Such data shall include a description of each well's type, construction, date drilled, location, depth, record of completion, and a schematic of any plugged well illustrating all plugging detail.
- VII. Attach data on the proposed operation, including:
1. Proposed average and maximum daily rate and volume of fluids to be injected;
 2. Whether the system is open or closed;
 3. Proposed average and maximum injection pressure;
 4. Sources and an appropriate analysis of injection fluid and compatibility with the receiving formation if other than reinjected produced water; and
 5. If injection is for disposal purposes into a zone not productive of oil or gas at or within one mile of the proposed well, attach a chemical analysis of the disposal zone formation water (may be measured or inferred from existing literature, studies, nearby wells, etc.).
- *VIII. Attach appropriate geological data on the injection zone including appropriate lithologic detail, geological name, thickness, and depth. Give the geologic name, and depth to bottom of all underground sources of drinking water (aquifers containing waters with total dissolved solids concentrations of 10,000 mg/l or less) overlying the proposed injection zone as well as any such source known to be immediately underlying the injection interval.
- IX. Describe the proposed stimulation program, if any.
- * X. Attach appropriate logging and test data on the well. (If well logs have been filed with the Division they need not be resubmitted.)
- * XI. Attach a chemical analysis of fresh water from two or more fresh water wells (if available and producing) within one mile of any injection or disposal well showing location of wells and dates samples were taken.
- XII. Applicants for disposal wells must make an affirmative statement that they have examined available geologic and engineering data and find no evidence of open faults or any other hydrologic connection between the disposal zone and any underground source of drinking water.
- XIII. Applicants must complete the "Proof of Notice" section on the reverse side of this form.
- XIV. Certification

I hereby certify that the information submitted with this application is true and correct to the best of my knowledge and belief.

Name: KENNETH E. STULL

Title: GEOLOGIST / ENG. TECHNICIAN

Signature: *Kenneth E. Stull*

Date: 10/7/92

- * If the information required under Sections VI, VIII, X, and XI above has been previously submitted, it need not be duplicated and resubmitted. Please show the date and circumstance of the earlier submittal.

III. WELL DATA

A. The following well data must be submitted for each injection well covered by this application. The data must be both in tabular and schematic form and shall include:

- (1) Lease name; Well No.; location by Section, Township, and Range; and footage location within the section.
- (2) Each casing string used with its size, setting depth, sacks of cement used, hole size, top of cement, and how such top was determined.
- (3) A description of the tubing to be used including its size, lining material, and setting depth.
- (4) The name, model, and setting depth of the packer used or a description of any other seal system or assembly used.

Division District offices have supplies of Well Data Sheets which may be used or which may be used as models for this purpose. Applicants for several identical wells may submit a "typical data sheet" rather than submitting the data for each well.

B. The following must be submitted for each injection well covered by this application. All items must be addressed for the initial well. Responses for additional wells need be shown only when different. Information shown on schematics need not be repeated.

- (1) The name of the injection formation and, if applicable, the field or pool name.
- (2) The injection interval and whether it is perforated or open-hole.
- (3) State if the well was drilled for injection or, if not, the original purpose of the well.
- (4) Give the depths of any other perforated intervals and detail on the sacks of cement or bridge plugs used to seal off such perforations.
- (5) Give the depth to and name of the next higher and next lower oil or gas zone in the area of the well, if any.

XIV. PROOF OF NOTICE

All applicants must furnish proof that a copy of the application has been furnished, by certified or registered mail, to the owner of the surface of the land on which the well is to be located and to each leasehold operator within one-half mile of the well location.

Where an application is subject to administrative approval, a proof of publication must be submitted. Such proof shall consist of a copy of the legal advertisement which was published in the county in which the well is located. The contents of such advertisement must include:

- (1) The name, address, phone number, and contact party for the applicant;
- (2) the intended purpose of the injection well; with the exact location of single wells or the section, township, and range location of multiple wells;
- (3) the formation name and depth with expected maximum injection rates and pressures; and
- (4) a notation that interested parties must file objections or requests for hearing with the Oil Conservation Division, P. O. Box 2088, Santa Fe, New Mexico 87501 within 15 days.

NO ACTION WILL BE TAKEN ON THE APPLICATION UNTIL PROPER PROOF OF NOTICE HAS BEEN SUBMITTED.

NOTICE: Surface owners or offset operators must file any objections or requests for hearing of administrative applications within 15 days from the date this application was mailed to them.

INJECTION WELL DATA SHEET

V-F PETROLEUM INC.

KATHY FOLK

(WELL ORIGINALLY DRILLED BY SOUTHERN UNION)

OPERATOR	LEASE			
1	1800' FNL & 330' FEL	32	T-16-S	R-35-E
WELL NO.	FOOTAGE LOCATION	SECTION	TOWNSHIP	RANGE

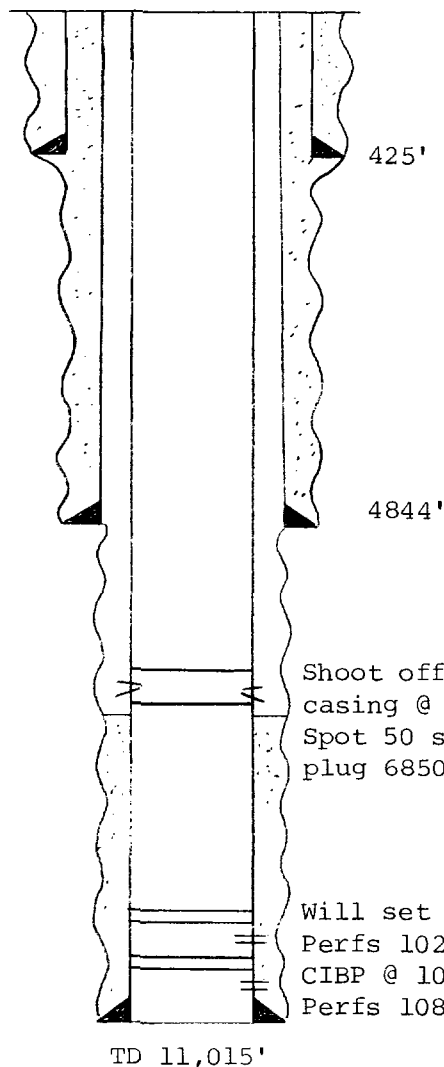
SchematicTabular DataSurface Casing

Size 13 3/8 " Cemented with 420 sx.
 TOC surface feet determined by circulated
 Hole size 17 1/2"

Intermediate Casing

Size 9 5/8 " Cemented with 1900 sx.
 TOC surface feet determined by circulated
 Hole size 12 1/4"

Long string

Size 5 1/2 " Cemented with 875 sx.
 TOC 7000 feet determined by cement bond log
 Hole size 7 7/8"
 Total depth 11,015' 10,943' PBTB

Shoot off & pull casing @ 6800'+- Injection interval
 Spot 50 sx cement 4845 feet to 6750 feet
 plug 6850'-6750' (perforated or open-hole, indicate which)

Will set CIBP @ 10190, dump 20' cement
 Perfs 10292-329
 CIBP @ 10515
 Perfs 10826-60

TD 11,015'

Tubing size 2 7/8" lined with plastic coating set in a
 (material)
Baker Lok-Set packer at 4800 feet
 (brand and model)

(or describe any other casing-tubing seal).

Other Data

- Name of the injection formation San Andres/Glorieta
- Name of Field or Pool (if applicable) N/A
- Is this a new well drilled for injection? ☐ Yes ☒ No
 If no, for what purpose was the well originally drilled? TO TEST WOLFCAMP FORMATION
- Has the well ever been perforated in any other zone(s)? List all such perforated intervals and give plugging detail (sacks of cement or bridge plug(s) used)
10,826' - 10,360' SET CIBP @ 10,515' & DUMP 20' CEMENT ON TOP
10,292' - 10,329' SET CIBP @ 10,190' & DUMP 20' CEMENT ON TOP (TO BE DONE)
- Give the depth to and name of any overlying and/or underlying oil or gas zones (pools) in this area.
Wolfcamp 10,800'

V-F PETROLEUM INC.
ONE MARIENFELD PLACE, STE 580
MIDLAND, TX 79701

DATA AND ATTACHMENTS FOR FORM C-108

- III. A. 1-4 See attached Well Data Sheet.
B. 1-5 See attached Well Data Sheet.
- V. See the attached plat.
- VI. See the attached table of wells with schematics.
- VII. 1. Average inj. rate - 20 BWPH = 480 BWPD
Maximum inj. rate - 40 BWPH = 960 BWPD
2. Closed system
3. Average inj. pressure - 800#
Maximum inj. pressure - 1300#
4. N/A
5. See attached water sample report.
- VIII. Formation: San Andres/ U. Glorieta
Thickness: S.A. - 1516', U. Glor. - 420'

Depth: S.A. 4814'-6330', U. Glor. 6330'-6750'

Lithology: San Andres, white - buff - brown, finely crystalline sucrosic dolomite with intercrystalline porosity. Glorieta - light brown - brown - tan, finely crystalline dolomite with intercrystalline porosity.

Aquifer: Ogallala
Aquifer Depth: Approximately 100' - 200'. No aquifers underlying proposed injection zone.
- IX. Stimulation Program: Spot 2000 gal 15% HCL over open hole interval. Re-acidize w/ 3000 gal 15% HCL.
- X. Logs filed by original operator in 1984.
- XI. No known producing water wells within one mile.
- XII. V-F Petroleum Inc., affirms that we have examined available geologic and engineering data and find no evidence of open faults or any other hydrologic connection between the disposal zone and underground source of drinking water.
- XIII. All offset leasehold operators and the surface owner were notified of this application by certified mail, return receipt requested. Copies of the receipts are attached hereto. Also, a copy of the legal advertisement which was published in Lea County, New Mexico, on September 25, 1992 is attached hereto.

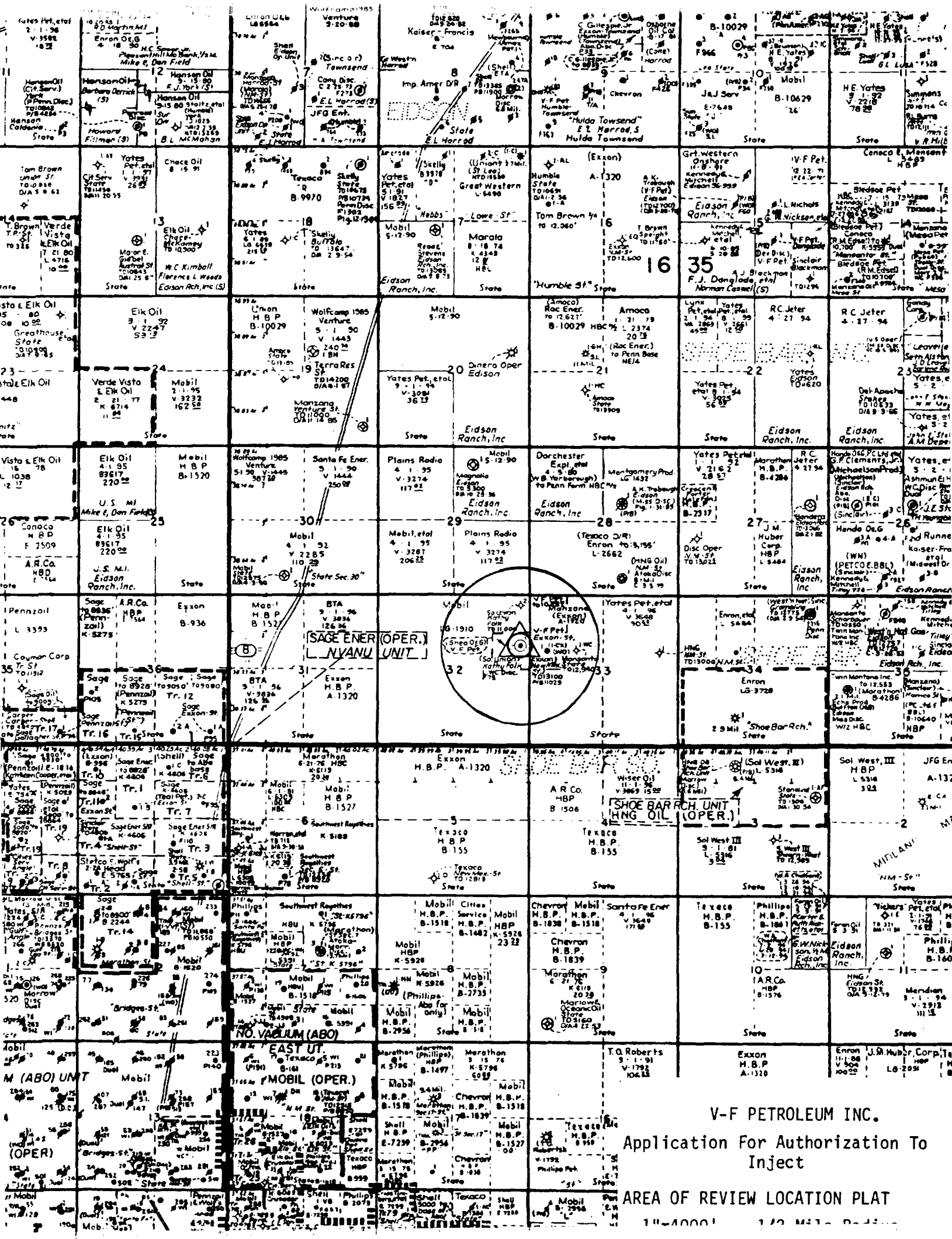

TABLE OF WELLS
WITHIN THE AREA OF REVIEW
(attached to form C-108)

1. Operator: Exxon Corp./V-F Petroleum Inc.

 Lease name & well#: New Mexico State Cx #1/Exxon State #1

 Location: 1980' FNL & 660' FWL
 Sec. 33, T16S, R35E
 Lea Co., New Mexico

 Date drilled: 3/6/80 - Re-entered by V-F 1/10/88

 Total depth: 13,100'

 Completion record: Plugged & abandoned by Exxon 5/13/80
 Re-entry IPF 88 BO, 114 MCF, 11 BW
 Perfs 10,790' - 10,807' Wolfcamp

 Present status: Producing

2. Operator: Manzano Oil Corp.

 Lease name & well#: State WC #1

 Location: 1980' FNL & 1650' FEL
 Sec. 33, T16S, R35E
 Lea Co., New Mexico

 Date drilled: 3/27/85

 Total depth: 12,940'

 Completion record: Plugged & abandoned 5/15/85
 See attached C-103 & schematic

3. Operator: Southern Union Exploration

 Lease name & well#: Kathy Folk #2

 Location: 330' FNL & 330' FEL
 Sec. 32, T16S, R35E
 Lea Co., New Mexico

 Date drilled: 8/31/84

 Total depth: 11,000'

 Completion record: Plugged & abandoned 10/2/84
 See attached C-103 & schematic

PLUGGING SCHEMATIC OF THE
MANZANO OIL CORP. #1 STATE WC
(attached to table of wells)

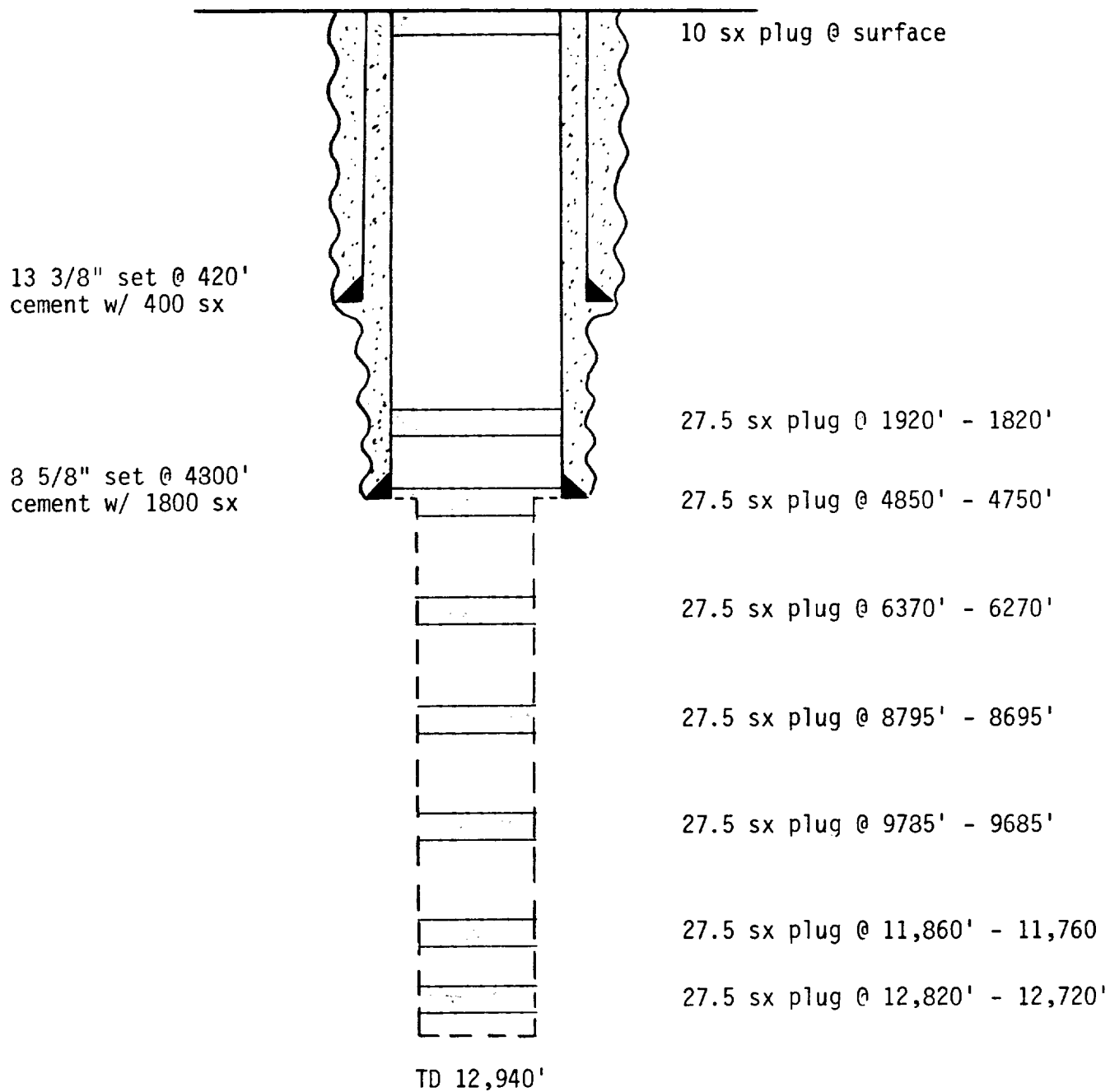

PLUGGING SCHEMATIC OF THE
SOUTHERN UNION EXPL. #2 KATHY FOLK
(attached to table of wells)

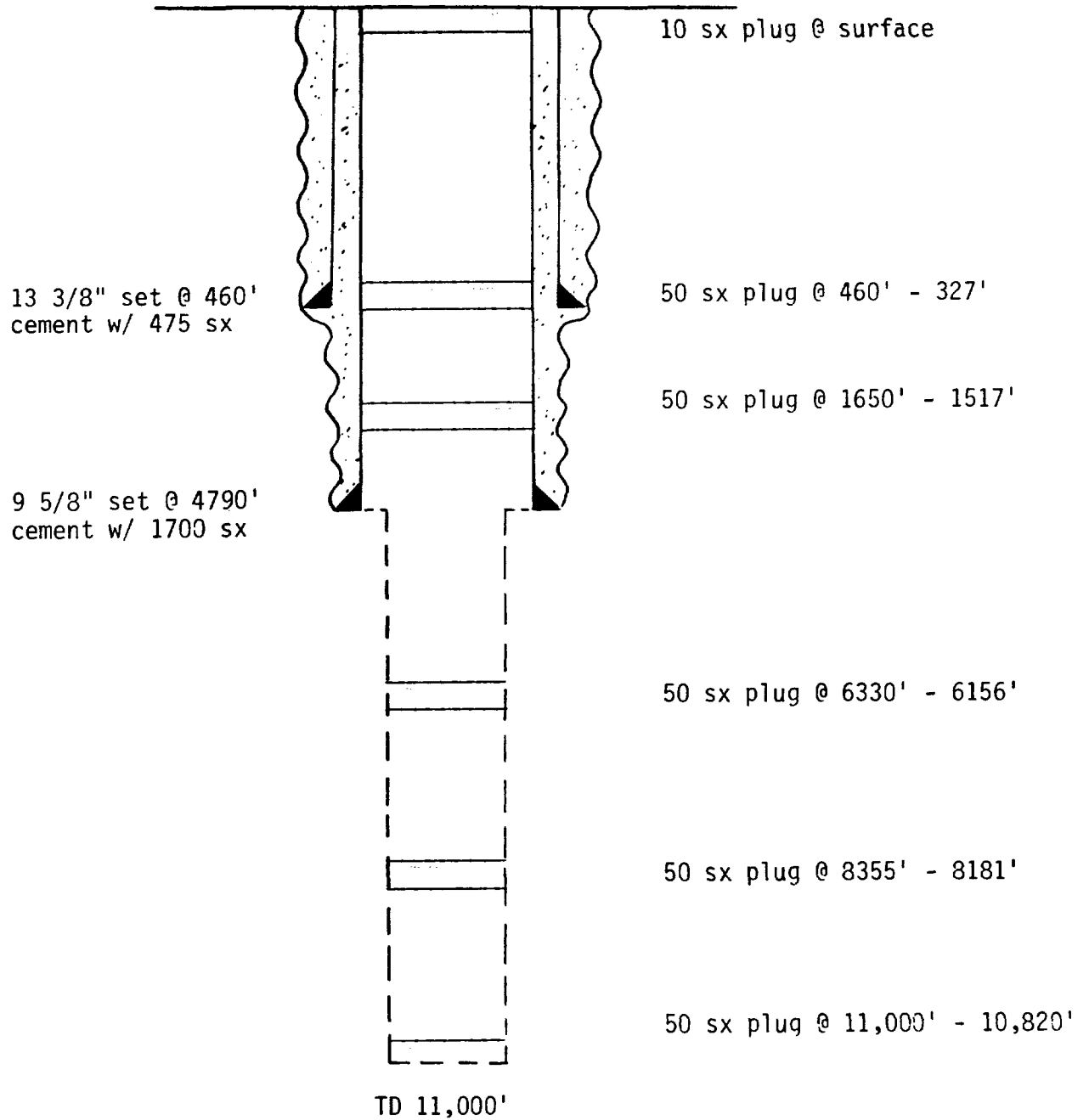

709 W. INDIANA
MIDLAND, TEXAS 79701
PHONE 683-4521

RESULT OF WATER ANALYSES

TO: <u>Mr. O. S. Sprague</u> <u>P. O. Box 727, Lovington, N. M.</u>	LABORATORY NO.	<u>765123 (DUPLICATE ORIGINAL)</u>
	SAMPLE RECEIVED	<u>7-23-65</u>
	RESULTS REPORTED	<u>8-3-65</u>

COMPANY Texaco, Inc. LEASE State of N. M. "O" Consolidated Battery
FIELD OR POOL Vacuum
SECTION BLOCK SURVEY COUNTY Lea STATE NM

SOURCE OF SAMPLE AND DATE TAKEN:

NO. 1 Produced water - taken from separator. 7-23-65

NO. 2 _____

NO. 3 _____

NO. 4 _____

REMARKS: GLORIETA WATER

CHEMICAL AND PHYSICAL PROPERTIES				
	NO. 1	NO. 2	NO. 3	NO. 4
Specific Gravity at 60° F.	1.1444			
pH When Sampled				
pH When Received	7.6			
Bicarbonate as HCO ₃	586			
Supersaturation as CaCO ₃	84			
Undersaturation as CaCO ₃	--			
Total Hardness as CaCO ₃	6,379			
Calcium as Ca	1,653			
Magnesium as Mg	546			
Sodium and/or Potassium	76,240			
Sulfate as SO ₄	3,495			
Chloride as Cl	119,151			
Iron as Fe	0.44			
Barium as Ba	0			
Turbidity, Electric	13			
Color as Pt	4			
Total Solids, Calculated	201,671			
Temperature °F.				
Carbon Dioxide, Calculated	24			
Dissolved Oxygen,	0.0			
Hydrogen Sulfide	240			
Resistivity, ohms/m at 77° F.	0.064			
Suspended Oil				
Filtrable Solids as mg/l				
Volume Filtered, ml				

Results Reported As Milligrams Per Liter

Additional Determinations And Remarks

709 W. INDIANA
MIDLAND, TEXAS 79701
PHONE 683-4521

RESULT OF WATER ANALYSES

	LABORATORY NO.	<u>96491 (DUPLICATE ORIGINAL)</u>
TO: <u>Mr. D. S. Sprague</u>	SAMPLE RECEIVED	<u>9-23-64</u>
<u>P. O. Box 727, Lovington, N. M.</u>	RESULTS REPORTED	<u>10-3-64</u>

COMPANY Texaco, Inc. LEASE West Lovington Unit (Produced Water)
FIELD OR POOL West Lovington
SECTION _____ BLOCK _____ SURVEY _____ COUNTY Lea STATE N. M.

SOURCE OF SAMPLE AND DATE TAKEN:

NO. 1 Produced water - taken from produced water storage tank. 9-23-64

NO. 2 _____

NO. 3

NO. 4 _____

REMARKS: SAN ANDRES WATER (Prior to injection)

CHEMICAL AND PHYSICAL PROPERTIES				
	NO. 1	NO. 2	NO. 3	NO. 4
Specific Gravity at 60° F.	1.0540			
pH When Sampled	7.6			
pH When Received	7.7			
Bicarbonate as HCO ₃	921			
Supersaturation as CaCO ₃	215			
Undersaturation as CaCO ₃	---			
Total Hardness as CaCO ₃	9,677			
Calcium as Ca	2,526			
Magnesium as Mg	817			
Sodium and/or Potassium	23,345			
Sulfate as SO ₄	2,372			
Chloride as Cl	42,113			
Iron as Fe	0.36			
Barium as Ba	0			
Turbidity, Electric	15			
Color as Pt	26			
Total Solids, Calculated	73,094			
Temperature °F.	89			
Carbon Dioxide, Calculated	30			
Dissolved Oxygen,	0.0			
Hydrogen Sulfide	80			
Resistivity, ohms/m at 77° F.	0.140			
Suspended Oil	12.5			
Filtrable Solids as mg/l				
Volume Filtered, ml				

Results Reported As Milligrams Per Liter

Additional Determinations And Remarks

V-F PETROLEUM INC.
ONE MARIENFELD PLACE , STE 580
MIDLAND, TEXAS 79701
915/683-3344 FAX 915/683-3352

Listing Of Offset Operators/Mineral Owners/Surface Owners

Surface Owner:

Eidson Ranch Inc.
West Star Route, Box 490
Lovington, New Mexico 88260

Offset Operators/Mineral Owners:

Mobil Exploration & Producing U.S. Inc.
P.O. Box 635
Midland, Texas 79702

Enron Oil & Gas Corp.
P.O. Box 2267
508 W. Wall St., Ste 1100
Midland, Texas 79702

Exxon Company, U.S.A.
Box 1600
Midland, Texas 79702

Plains Radio
P.O. Box 9354
Amarillo, Texas 79105

Affidavit of Publication

STATE OF NEW MEXICO)
) ss.
COUNTY OF LEA)

Joyce Clemens being first duly sworn on oath deposes and says that he is Adv. Director of THE LOVINGTON DAILY LEADER, a daily newspaper of general paid circulation published in the English language at Lovington, Lea County, New Mexico; that said newspaper has been so published in such county continuously and uninterruptedly for a period in excess of Twenty-six (26) consecutive weeks next prior to the first publication of the notice hereto attached as hereinafter shown; and that said newspaper is in all things duly qualified to publish legal notices within the meaning of Chapter 167 of the 1937 Session Laws of the State of New Mexico.

That the notice which is hereto attached, entitled
Legal Notice

XXXXXXXXXXXX and numbered XXXXXX

XXXXXXXXXXXX Court of Lea
County, New Mexico, was published in a regular and
entire issue of THE LOVINGTON DAILY LEADER and
not in any supplement thereof, XXXXXXXXXXXXXXXX on the

XXXXXXXXXXXXXXXXXXXXX, for one (1) day
same day of the week, for

XXXXXXXXXXXXXXXXXXXXX consecutive weeks, beginning with the issue of

September 25, 19 92

and ending with the issue of

September 25, 19 92

And that the cost of publishing said notice is the
sum of \$ 10.89

which sum has been (Paid) (Assessed) as Court Costs

Joyce Clemens
Subscribed and sworn to before me this 28th

day of September, 19 92

Ms Jean Lewis
Notary Public, Lea County, New Mexico

My Commission Expires Sept. 28, 19 94

LEGAL NOTICE NOTICE OF APPLICATION FOR AUTHORIZATION TO INJECT

V-F Petroleum Inc., One
Marienfeld Place, Ste 580,
Midland, TX 79702 is applying
for a permit to inject fluid into
a subsurface formation. The
applicant proposes to inject fluid
into the San Andres and U.
Glorieta formations. The
proposed fluid disposal well is
the V-F Petroleum Inc. #1 Kathy
Folk located 1800' FNL & 330'
FEL of Section 32, T-16-S, R-
35-E, Lea County, New Mexico,
located approximately 16 miles
west of Lovington, New Mexico.
Fluid will be injected into strata
in the subsurface depth interval
from 4845 - 6750 feet. The
maximum injection rates and
pressures are estimated at 960
barrels and 1300 psi, respec-
tively.

Interested parties must file
objections or requests for
hearing with the Oil Conserva-
tion Division, P.O. Box 2088,
Santa Fe, New Mexico 87501
within 15 days. Please contact
Wayne Luna or Kenneth Stull
at V-F Petroleum Inc. 915/683-
3344 for additional information.
Published in the Lovington Daily
Leader September 25, 1992.

**NEW MEXICO OIL CONSERVATION COMMISSION
WELL LOCATION AND ACREAGE DEDICATION PLAT**

Form C-102
Supersedes C-128
Effective 1-1-83

All distances must be from the outer boundaries of the Section

Operator ROBERT M. EDSSEL, INC.			Lease Kathy Folk		Well No. 1
Tract Letter H	Section 32	Township 16 SOUTH	Range 35 EAST	County LEA	
Actual Footage Location of Well: 1800 feet from the NORTH line and 330 feet from the EAST line					
Ground Level Elev. 4000.7	Producing Formation Wolfcamp		Pool Wildcat	Dedicated Acreage: 40 Acres	

- 1 Outline the acreage dedicated to the subject well by colored pencil or hachure marks on the plat below.
- 2 If more than one lease is dedicated to the well, outline each and identify the ownership thereof (both as to working interest and royalty).
- 3 If more than one lease of different ownership is dedicated to the well, have the interests of all owners been consolidated by communitization, unitization, force-pooling, etc?

☐ Yes ☐ No If answer is "yes," type of consolidation _____

If answer is "no," list the owners and tract descriptions which have actually been consolidated (by communitization, unitization, forced-pooling, or otherwise) or until a non-standard unit, eliminating such interests, has been approved by the Commission. _____

No allowable will be assigned to the well until all interests have been consolidated (by communitization, unitization, forced-pooling, or otherwise) or until a non-standard unit, eliminating such interests, has been approved by the Commission.

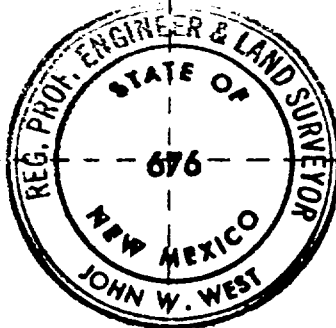
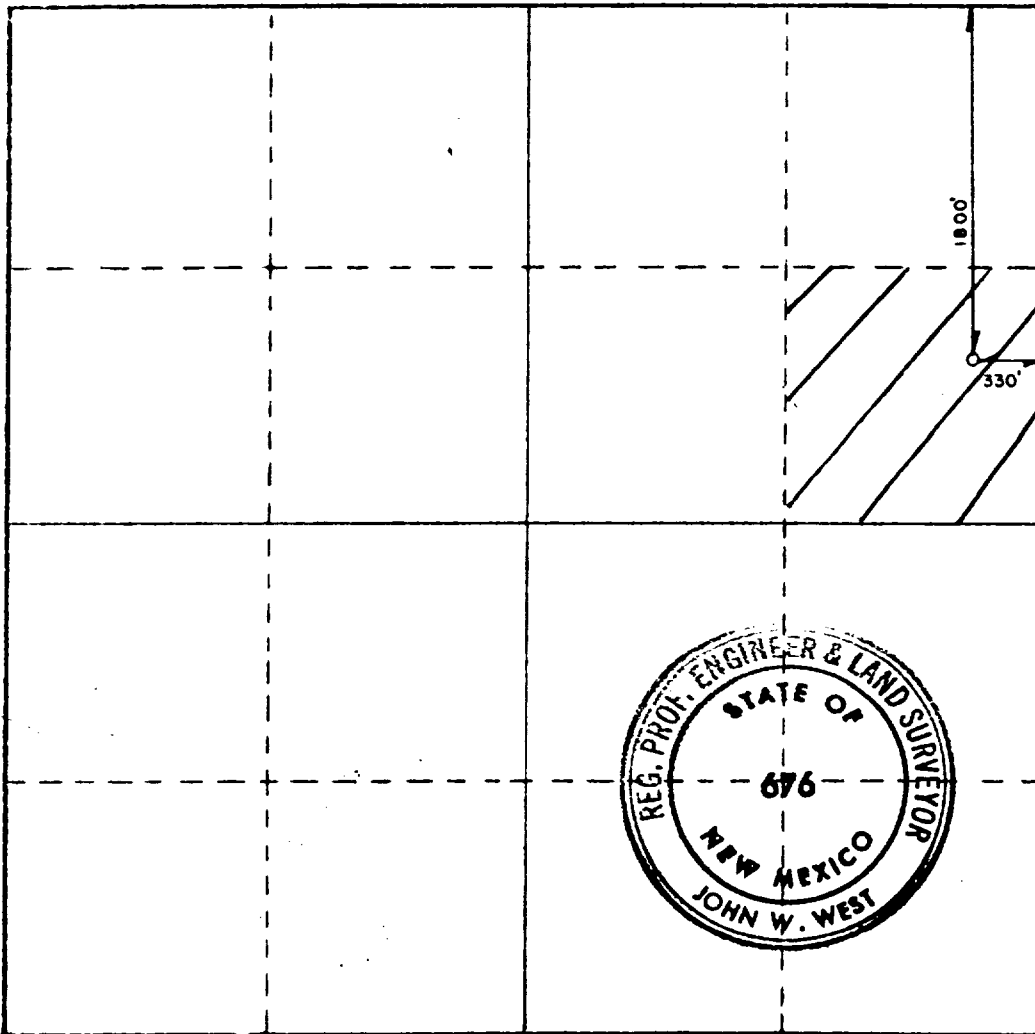
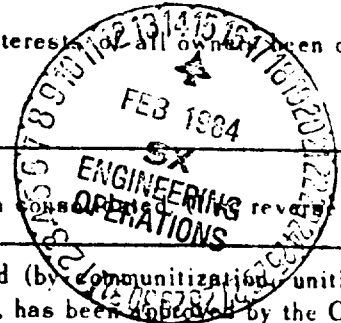

CERTIFICATION

I hereby certify that the information contained herein is true and complete to the best of my knowledge and belief.

Name
Pat G. Harrell *Pat G. Harrell*
 Position
Drilling & Prod. Engineer
 Company
Southern Union Exploration Co.
 Date
December 15, 1983

I hereby certify that the well location shown on this plat was plotted from field notes of actual surveys made by me or under my supervision, and that the same is true and correct to the best of my knowledge and belief.

Date Surveyed
DECEMBER 1, 1983
 Registered Professional Engineer and/or Land Surveyor
[Signature]

Certificate No. **JOHN W. WEST, 676**
RONALD J. EIDSON, 3239



U.S.G.P.O. 1989-234-555

PS Form 3800, June 1985

P 451 332 906

RECEIPT FOR CERTIFIED MAIL

NO INSURANCE COVERAGE PROVIDED
NOT FOR INTERNATIONAL MAIL
(See Reverse)

Sent to Exxon Company U.S.A.	
Street and No. Box 1600	
P.O. State and ZIP Code Midland, Texas 79702	
Postage	\$.52
Certified Fee	1.00
Special Delivery Fee	
Restricted Delivery Fee	
Return Receipt showing to whom and Date Delivered	1.00
Return Receipt showing to whom, Date, and Address of Delivery	
TOTAL Postage and Fees	\$ 2.52

Postmark or Date
October 7, 1992

P 451 332 907

RECEIPT FOR CERTIFIED MAIL

NO INSURANCE COVERAGE PROVIDED
NOT FOR INTERNATIONAL MAIL
(See Reverse)

U.S.G.P.O. 1989-234-555

PS Form 3800, June 1985

Sent to Plains Radio	
Street and No. P.O. Box 9354	
P.O. State and ZIP Code Amarillo, Texas 79105	
Postage	\$.52
Certified Fee	1.00
Special Delivery Fee	
Restricted Delivery Fee	
Return Receipt showing to whom and Date Delivered	1.00
Return Receipt showing to whom, Date, and Address of Delivery	
TOTAL Postage and Fees	\$ 2.52

Postmark or Date
October 7, 1992

P 451 332 909

RECEIPT FOR CERTIFIED MAIL

NO INSURANCE COVERAGE PROVIDED
NOT FOR INTERNATIONAL MAIL
(See Reverse)

Sent to Mobil Expl. & Prod. U.S.	
Street and No. P.O. Box 635	
P.O. State and ZIP Code Midland, Texas 79702	
Postage	\$.29
Certified Fee	1.00
Special Delivery Fee	
Restricted Delivery Fee	
Return Receipt showing to whom and Date Delivered	1.00
Return Receipt showing to whom, Date, and Address of Delivery	
TOTAL Postage and Fees	\$ 2.29

U.S.G.P.O. 1989-234-555

PS Form 3800, June 1985

Postmark or Date
October 7, 1992

P 451 332 908

RECEIPT FOR CERTIFIED MAIL

NO INSURANCE COVERAGE PROVIDED
NOT FOR INTERNATIONAL MAIL
(See Reverse)

Sent to Enron Oil & Gas Company	
Street and No. P.O. Box 2267	
P.O. State and ZIP Code Midland, Texas 79702	
Postage	\$.52
Certified Fee	1.00
Special Delivery Fee	
Restricted Delivery Fee	
Return Receipt showing to whom and Date Delivered	1.00
Return Receipt showing to whom, Date, and Address of Delivery	
TOTAL Postage and Fees	\$ 2.52

U.S.G.P.O. 1989-234-555

PS Form 3800, June 1985

Postmark or Date
October 7, 1992

P 451 332 905

RECEIPT FOR CERTIFIED MAIL

NO INSURANCE COVERAGE PROVIDED
NOT FOR INTERNATIONAL MAIL
(See Reverse)

Sent to Edison Ranch Inc	
Street and No. West Star Route, Box 490	
P.O. State and ZIP Code Edlington, N. 88260	
Postage	\$.52
Certified Fee	1.00
Special Delivery Fee	
Restricted Delivery Fee	
Return Receipt showing to whom and Date Delivered	1.00
Return Receipt showing to whom, Date, and Address of Delivery	
TOTAL Postage and Fees	\$ 2.52

U.S.G.P.O. 1989-234-555

PS Form 3800, June 1985

Postmark or Date
October 7, 1992



STATE OF NEW MEXICO
ENERGY, MINERALS AND NATURAL RESOURCES DEPARTMENT DIVISION

OIL CONSERVATION DIVISION
HOBBS DISTRICT OFFICE

RECEIVED

'92 OCT 15 PM 9 10

October 13, 1992

BRUCE KING
GOVERNOR

POST OFFICE BOX 1980
HOBBS, NEW MEXICO 88241-1980
(505) 393-6161

OIL CONSERVATION DIVISION
P. O. BOX 2088
SANTA FE, NEW MEXICO 87501

RE: Proposed:

MC _____
DHC _____
NSL _____
NSP _____
SWD ☒ _____
WFX _____
PMX _____

Gentlemen:

I have examined the application for the:

V-F Petroleum Inc.	Kathy Folk	#1-H,	32-16-35
Operator	Lease & Well No.	Unit	S-T-R

and my recommendations are as follows:

OK

Yours very truly,

Jerry Sexton
Jerry Sexton
Supervisor, District 1

/ed

V-F Petroleum #1 Exxon StateSec. 33, T-16-S, R-35-EOrig. Operator - Exxon - #1 New Mexico
State "CX"NEED SQ2
TO 4345'
PRIOR TO
INJECTIONTDC
5 1/2"
5600'13 3/8" 61 #
@ 470'
w/ 740 SX
TDC @ SURF.8 5/8" 32 #
@ 5020'
w/ 2450 SX
TDC @ SURF.1/2" 17.20 #
@ 11,195'
w/ 865 SX

TDC @ 5600' by bond log