

Release Date: June 30, 1987



BTA OIL PRODUCERS

104 SOUTH PECOS

MIDLAND, TEXAS 79701-9988

AC 915-682-3753

June 8, 1987

PARTNERS
CARLTON BEAL
CARLTON BEAL, JR.
BARRY BEAL
SPENCER BEAL
KELLY BEAL
BARRY BEAL, JR.

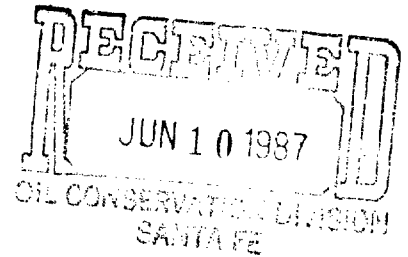

Re: Application for Off-lease Storage and Commingling
EK -A-, 8701 JV-P, Well No. 1
EK -B-, 8701 JV-P, Well No. 1
EK (Bone Springs) Pool
Lea County, New Mexico

STATE OF NEW MEXICO
Energy and Minerals Department
Oil Conservation Division
P. O. Box 2088
Santa Fe, New Mexico 87504-2088

Attention: Mr. William J. LeMay,
Division Director

Gentlemen:

BTA hereby requests administrative approval for off-lease storage and commingling of two separate leases into a common tank battery for the above referenced leases. Our application information sheet is attached, together with plats showing the location of our wells and tank battery.

Please advise if further information is necessary.

Sincerely,

A handwritten signature in cursive script that reads "Dorothy Houghton".

DOROTHY HOUGHTON
For BTA Oil Producers

DH:ss

Attachments

BTA OIL PRODUCERS
 EK -A-, 8701 JV-P
 EK -B-, 8701 JV-P
 Commingling Facility

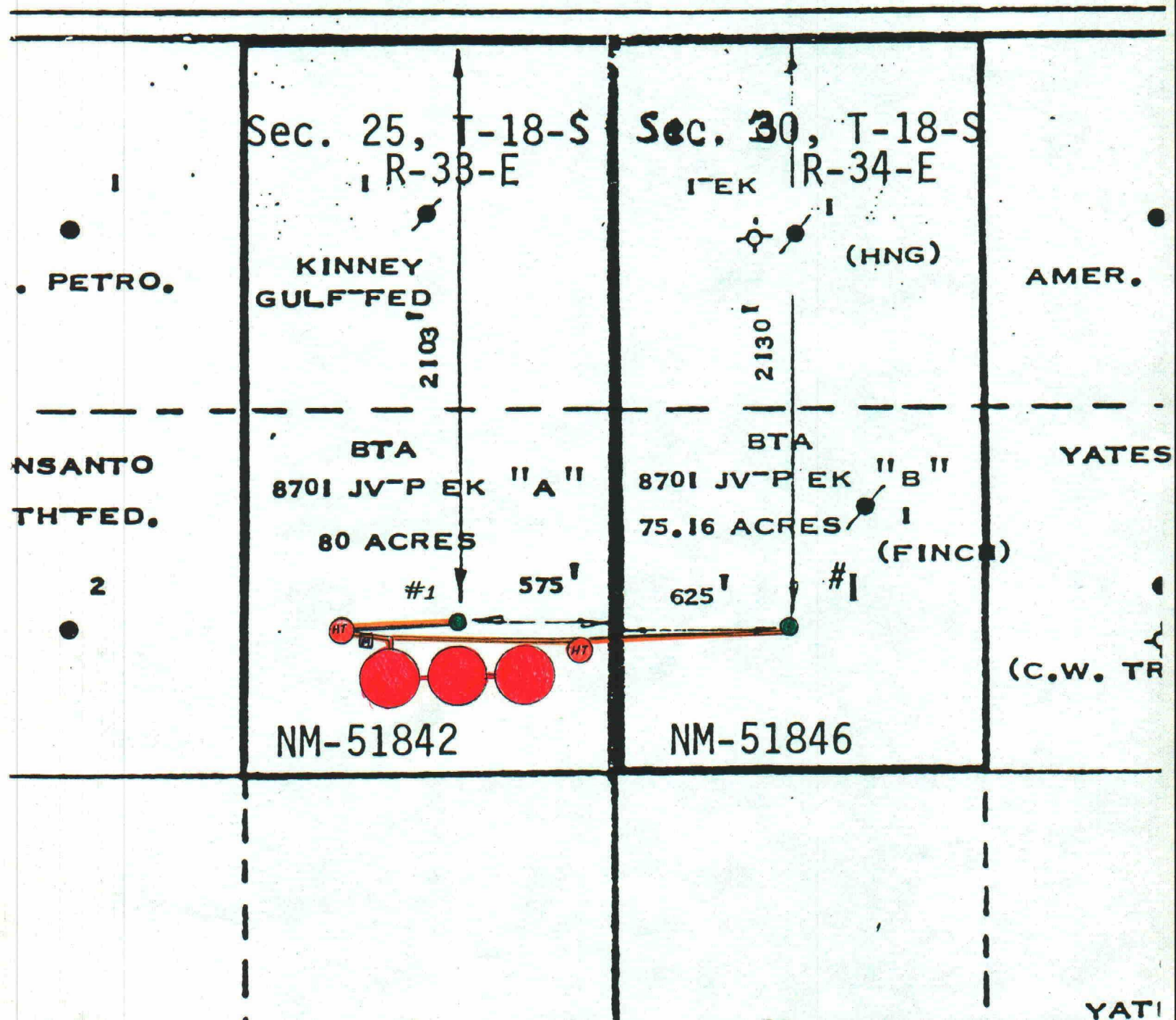



BTA OIL PRODUCERS

PARTNERS
CARLTON BEAL
CARLTON BEAL, JR.
BARRY BEAL
SPENCER BEAL
KELLY BEAL
BARRY BEAL, JR.

104 SOUTH PECOS
MIDLAND, TEXAS 79701-9988
AC 915-682-3753

JUN 15 1987 June 11, 1987

Re: Application for Off-lease Storage & Commingling
EK -A-, 8701 JV-P, Well No. 1
EK -B-, 8701 JV-P, Well No. 1
EK (Bone Springs) Pool
Lea Co., N.M.

STATE OF NEW MEXICO
Energy & Minerals Department
Oil Conservation Division
P. O. Box 2088
Santa Fe, New Mexico 87504-2088

Gentlemen:

We hereby submit copies of receipts for certified mail whereby we furnished copies of the above referenced application to Enron Oil & Gas Co.

Please advise should additional information be required.

Sincerely,

DOROTHY HOUGHTON
For BTA Oil Producers

DH:ss

Attachment

EK A P 477 957 357
 EK B

RECEIPT FOR CERTIFIED MAIL

NO POSTAGE NECESSARY IF MAILED IN THE UNITED STATES
 SEE REVERSE

PS Form 3800, June 1985

To: Enron Oil & Gas Co.	
Street and No. P. O. Box 2267	
City, State and ZIP Code Midland, TX 79702	
Postage	
Certified Fee	
Special Delivery Fee	
Restricted Delivery Fee	
Return Receipt showing to whom and Date Delivered	
Return Receipt showing to whom Date and Date of Delivery	
TOTAL Postage and Fees	\$
Postmark	



srs

PS Form 3811, July 1983 447-845

SENDER: Complete items 1, 2, 3 and 4.

Put your address in the "RETURN TO" space on the reverse side. Failure to do this will prevent this card from being returned to you. The return receipt fee will provide you the name of the person delivered to and the date of delivery. For additional fees the following services are available. Consult postmaster for fees and check box(es) for service(s) requested.

1. ☐ Show to whom, date and address of delivery.

2. ☐ Restricted Delivery.

3. Article Addressed to:
 Enron Oil & Gas Co.
 P. O. Box 2267
 Midland, TX 79702

4. Type of Service: <input type="checkbox"/> Registered <input checked="" type="checkbox"/> Certified <input type="checkbox"/> Express Mail	Article Number P 477 957 357
--	---------------------------------

Always obtain signature of addressee or agent and **DATE DELIVERED.**

5. Signature - Addressee
 X *[Signature]*

6. Signature - Agent
 X

7. Date of Delivery
 6-8-87 WTH

8. Addressee's Address (ONLY if requested and fee paid)

DOMESTIC RETURN RECEIPT