



**Amoco Production Company**

Security Life Building  
Denver, Colorado 80202  
303-292-5050

P. J. Early  
Division Production  
Manager  
H. T. Hunter  
Assistant Division  
Production Manager  
J. E. Fox, Jr.  
Drilling  
W. G. Liles  
Administration  
G. A. Ayling  
Plants

March 20, 1974

File: WGL-394-986.511

Mr. A. L. Porter, Jr. (3)  
Secretary-Director of the Commission  
New Mexico Oil Conservation Commission  
P. O. Box 2088  
Santa Fe, New Mexico 87501

Dear Sir:

Re: Commingling Condensate from Dakota, Pictured Cliffs, and Mesaverde,  
on the Surface, San Juan and Rio Arriba Counties, New Mexico.

This application to commingle the condensate production from two or more common sources of supply is being submitted for your approval in accordance with NMOCC Rule 303-B. Each lease has common Royalty and Working Interests in its separate pools. It should be noted that all locations listed have 100% Amoco working interest wells.

Exception to Rule 303-A is requested for condensate only on each of the leases listed per our Attachment 1, which provides gravities and values.

Attachments II and III show typical condensate commingling arrangement.

Attachments IV - XI show lease well locations.

Each of the leases concerned now has two tanks. Commingling will permit elimination of one 380 bbl. tank on each lease for a total of 8 tanks valued at \$19,739.

Originally, tanks were set for each horizon in order to store and accurately gauge condensate production from the different pools. On many of these locations, tanks were set adjacent to each other. In an effort to eliminate one of the tanks, we propose to commingle condensate production into a single tank. It is important to emphasize that gas production will not be commingled. Instead, gas will be produced through separate, existing facilities.

In order to maintain a record of condensate production from the separate horizons, an accurate tank gauge of production will be taken during one horizon's required

File: WGL-394-986.511

March 20, 1974

Page 2

deliverability test. During the test, the other horizon will be shut in. Condensate production from the tested horizon will then be allocated on the basis of a gas-condensate ratio. Condensate production for the remaining horizon will be determined by the difference of the tank gauge and the allocated production from the tested horizon.

The elimination of a tank on each of the proposed locations will reduce our lease investments substantially and streamline production operations. Also, by eliminating excess storage capacity, less condensate will be lost to weathering.

We will appreciate your approval of the commingling for economical reasons.

Yours very truly,

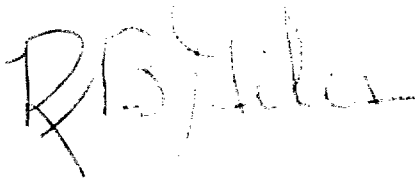
A handwritten signature in dark ink, appearing to read "R. B. Miller". The signature is written in a cursive, somewhat stylized script. The first part of the signature, "R. B.", is more distinct, while the last name "Miller" is more fluid and connected.

672 904

ATTACHMENT I

Commingling Prospects Well Names	Producing Horizon	Condensate	Pool Gravity	Value of	Expected Commingled Gravity	Value of	Decrease In Value	Lease Plat
		Production Bbls. Cond./Mo.		Production \$/Bbl.		Commingled Prod., \$/Bbl.		
W. D. Heath "A" #3-X W. D. Heath "A" #10	Blanco Mesaverde Basin Dakota	77 6	54 53	9.71 9.71	54	9.71	None	Attachment IV
Jaquez Gas Com "A" #1 Jaquez Gas Com "A" #3	Blanco Mesaverde Basin Dakota	89 48	54 53	9.71 9.71	53	9.71	"	Attachment V
Jaquez Gas Com "B" #1 Jaquez Gas Com "B" #3	Blanco Mesaverde Basin Dakota	47 16	54 53	9.71 9.71	53	9.71	"	Attachment VI
Likins Gas Com "A" #1 Likins Gas Com "A" #3	Blanco Mesaverde Basin Dakota	74 16	54 53	9.71 9.71	54	9.71	"	Attachment VII
E. E. Elliott "A" #1 E. E. Elliott "A" #3	Blanco Mesaverde Blanco Pictured Cliffs	61 9	54 52	9.71 9.71	54	9.71 9.71	"	Attachment VIII
Jicarilla Contract 146 #11 Jicarilla Contract 146 #11	Basin Dakota ) Gonzales Mesaverde) Dual	37 52	53 --	9.71 9.71	53	9.71	"	Attachment IX
Jicarilla Contract 155 #20 Jicarilla Contract 155 #20	Basin Dakota ) Gonzales Mesaverde) Dual	63 New well-not yet connected to sales line.	53 --	9.71 --	53	9.71	"	Attachment X
Jicarilla Contract 155 #22 Jicarilla Contract 155 #22	Basin Dakota ) Gonzales Mesaverde) Dual	83 New well-not yet connected to sales line.	53 --	9.71 --	53	9.71	"	Attachment XI

BLANCO MESAVRDE WELL

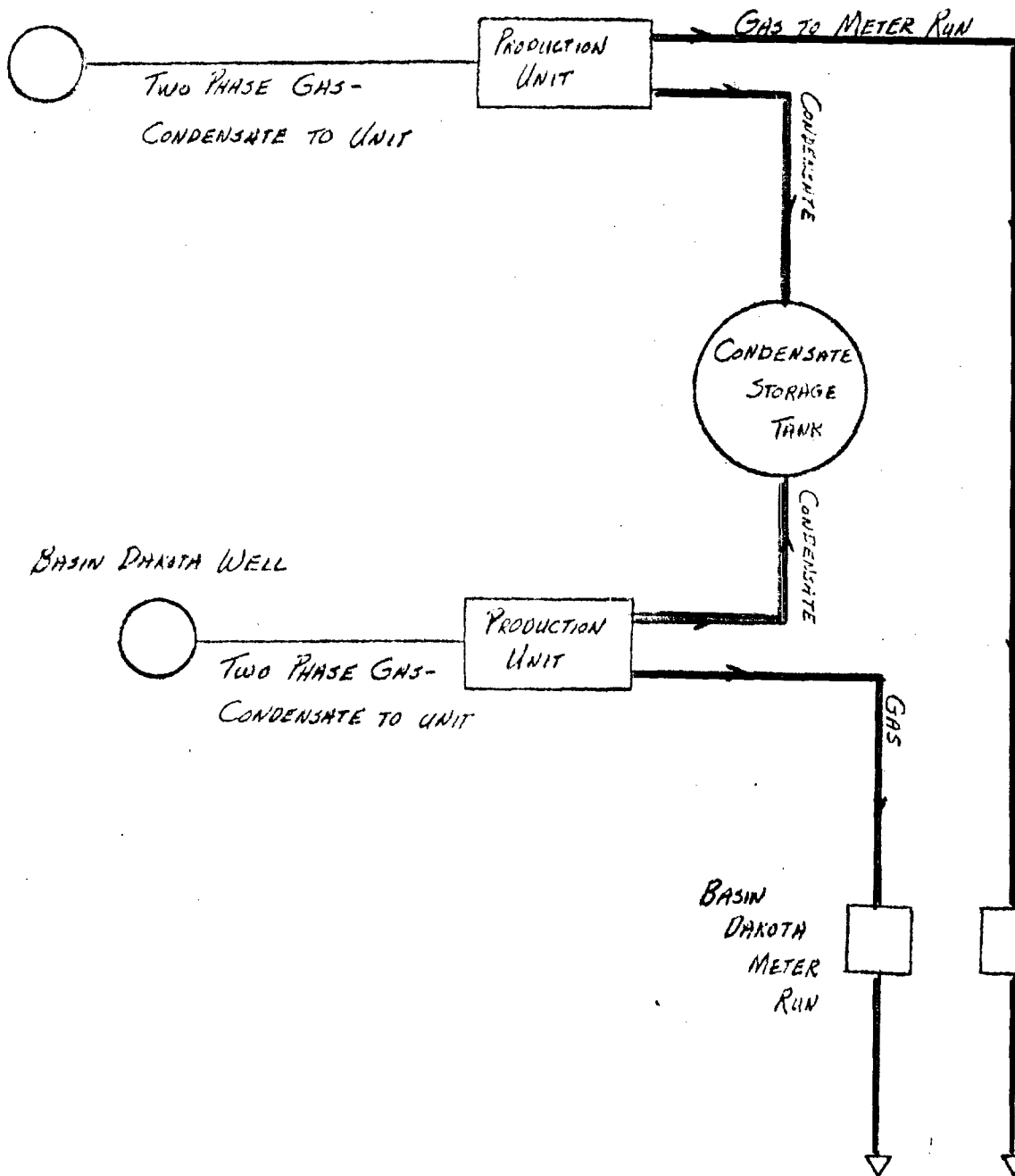

— PRODUCED CONDENSATE

— PRODUCED GAS

Amoco Production Company

SCALE: NONE

ATTACHMENT II

TYPICAL CONDENSATE HANDLING ARRANGEMENT

DRG.  
NO.

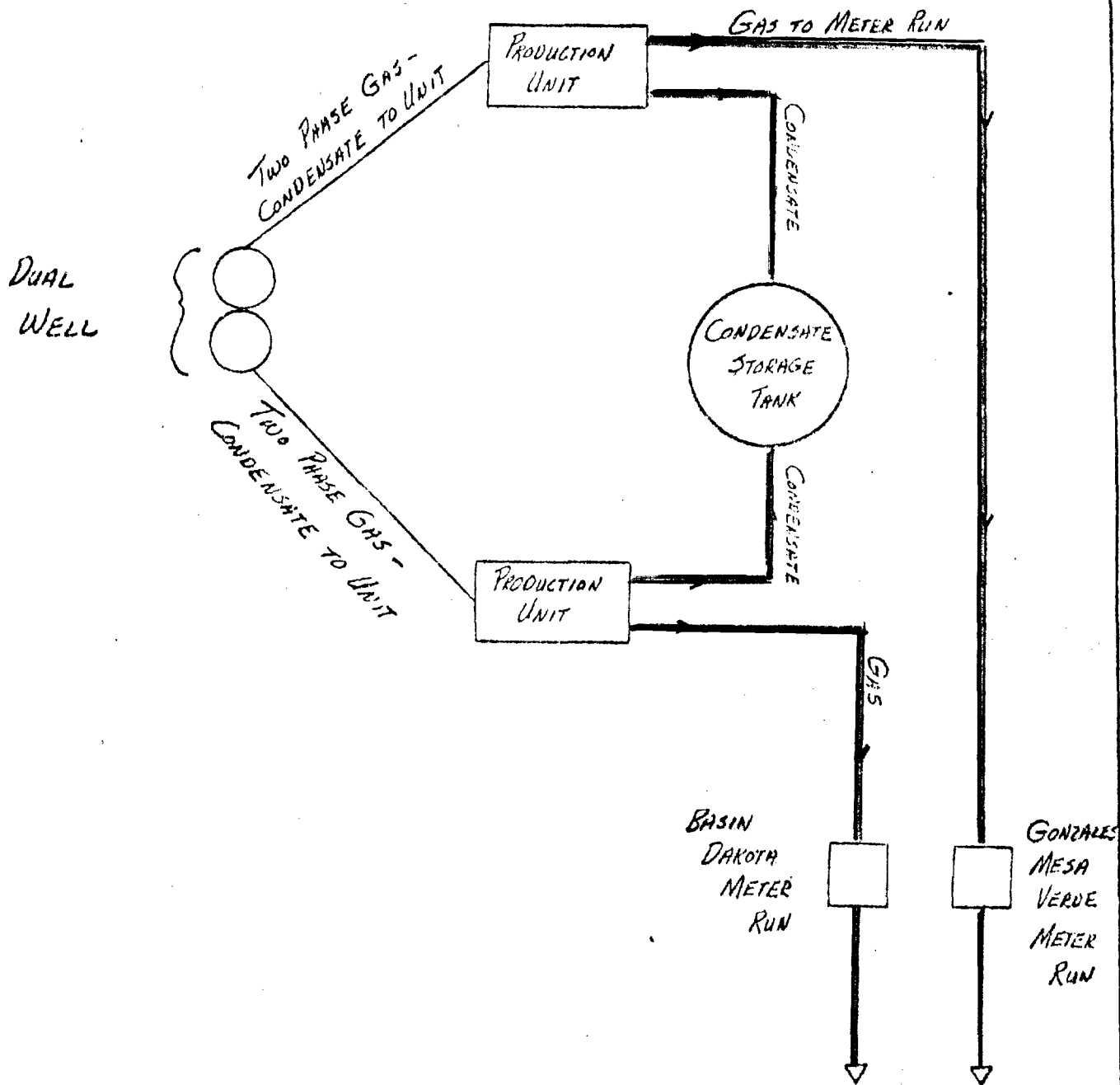

————— PRODUCED CONDENSATE  
 ————— PRODUCED GAS

Amoco Production Company

ATTACHMENT III

SCALE:

ORG.

SECTION 17-T29N-R9W

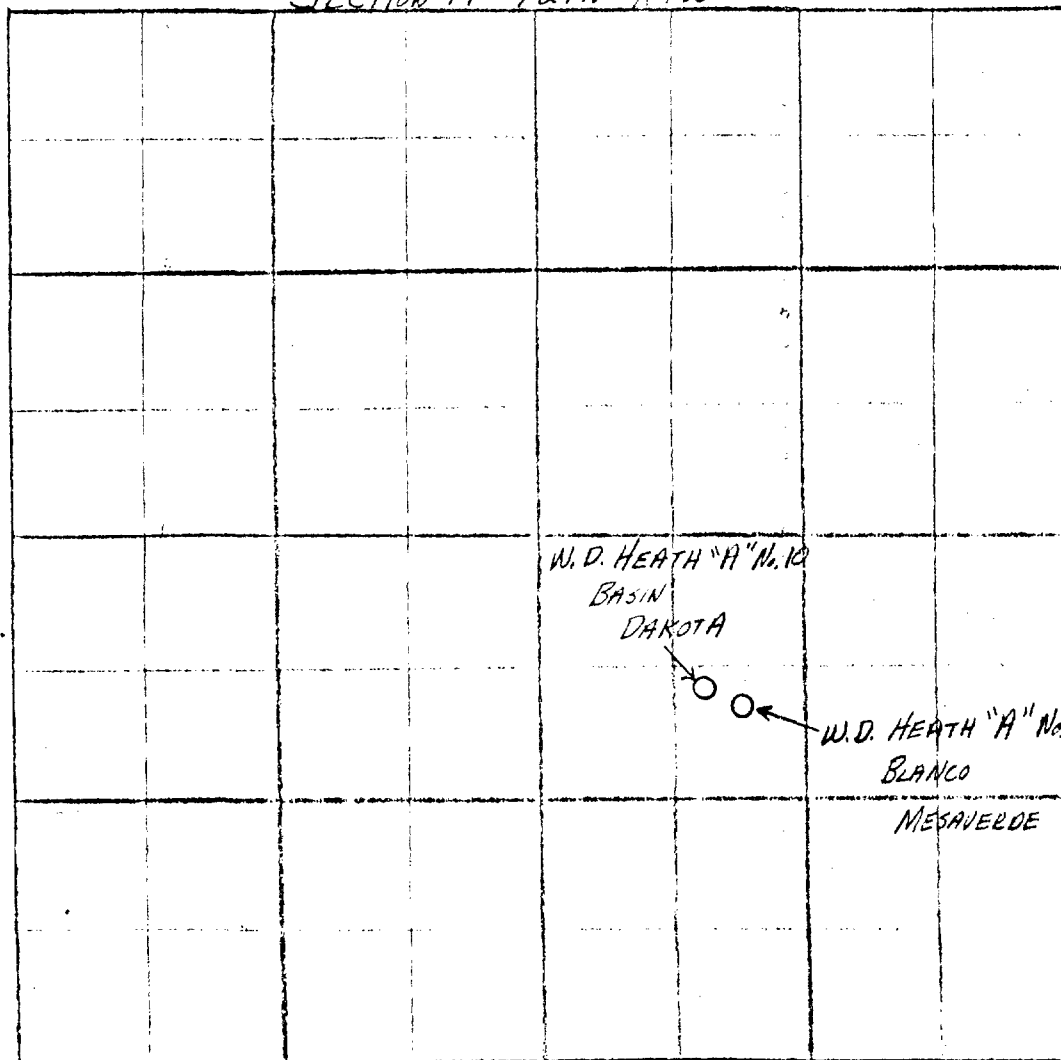

Amoco Production Company

ATTACHMENT IV

W. D. HEATH "A" LEASE

SCALE: 1"=1000'

DRC

SECTION 5-T29N-R9W

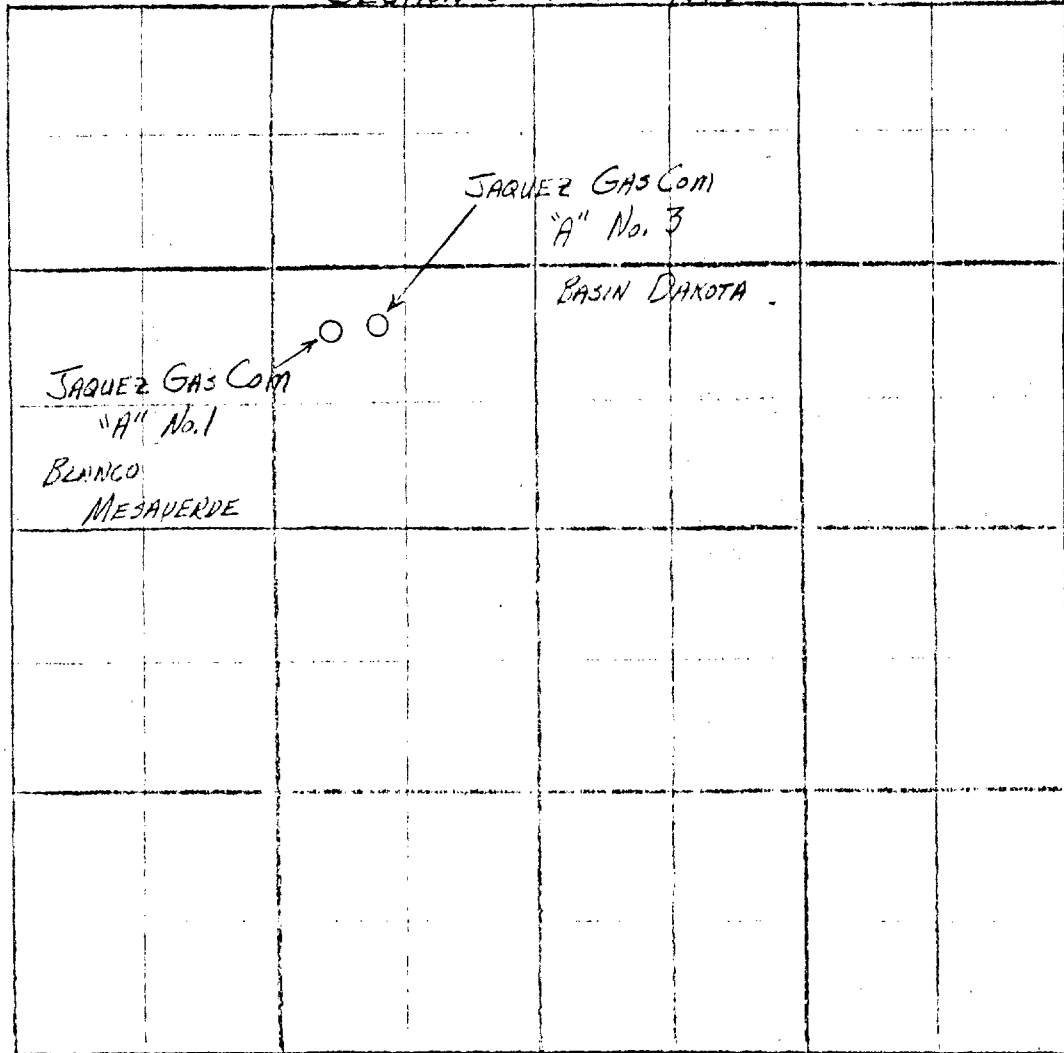

Amoco Production Company

ATTACHMENT V  
JAQUEZ GAS COM "A" LEASE

SCALE: 1"=1000'

DRG.  
11"

SECTION 4-T29N-R9W

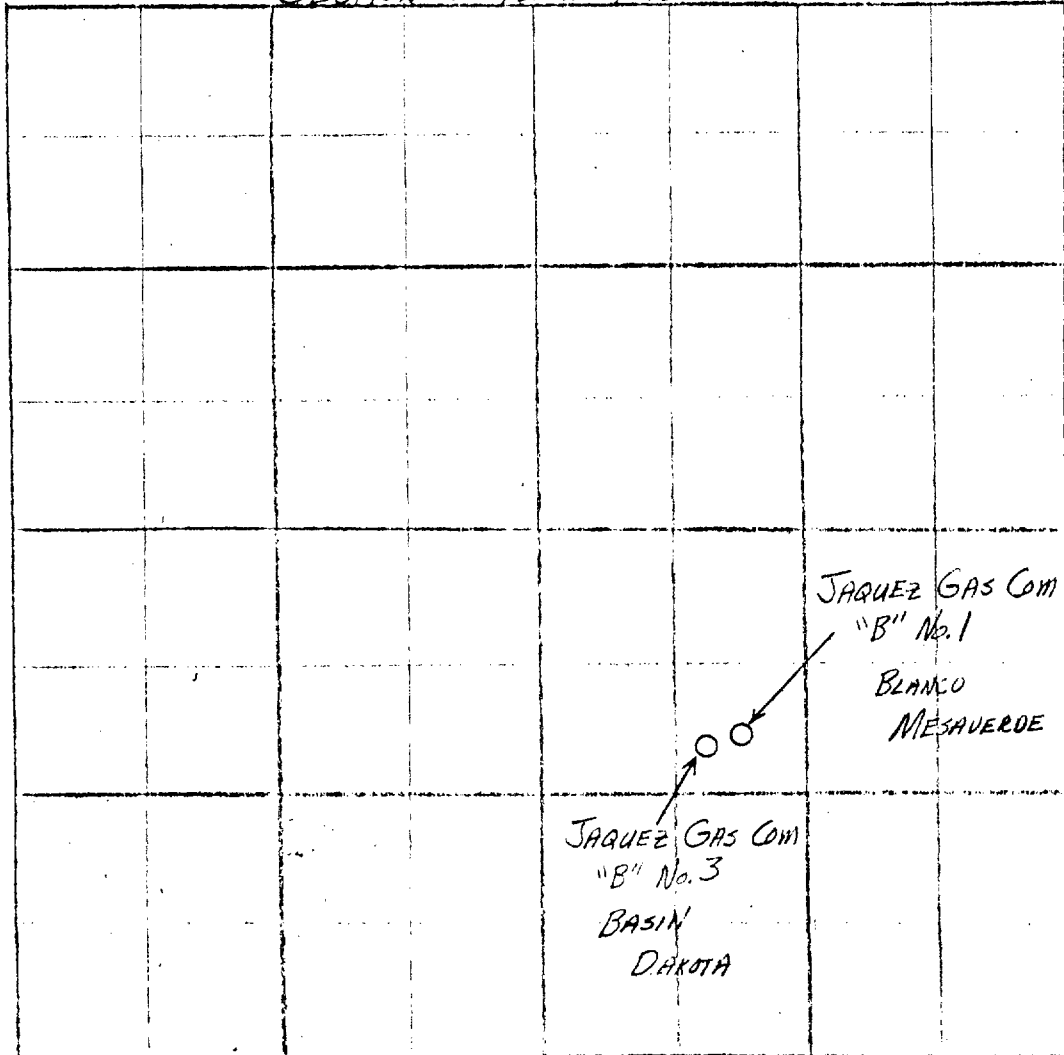

Amoco Production Company

ATTACHMENT VI  
JAQUEZ GAS COM "B" LEASE

SCALE: 1" = 100'

DRC.  
NO.

SECTION 34-T30N-R9W

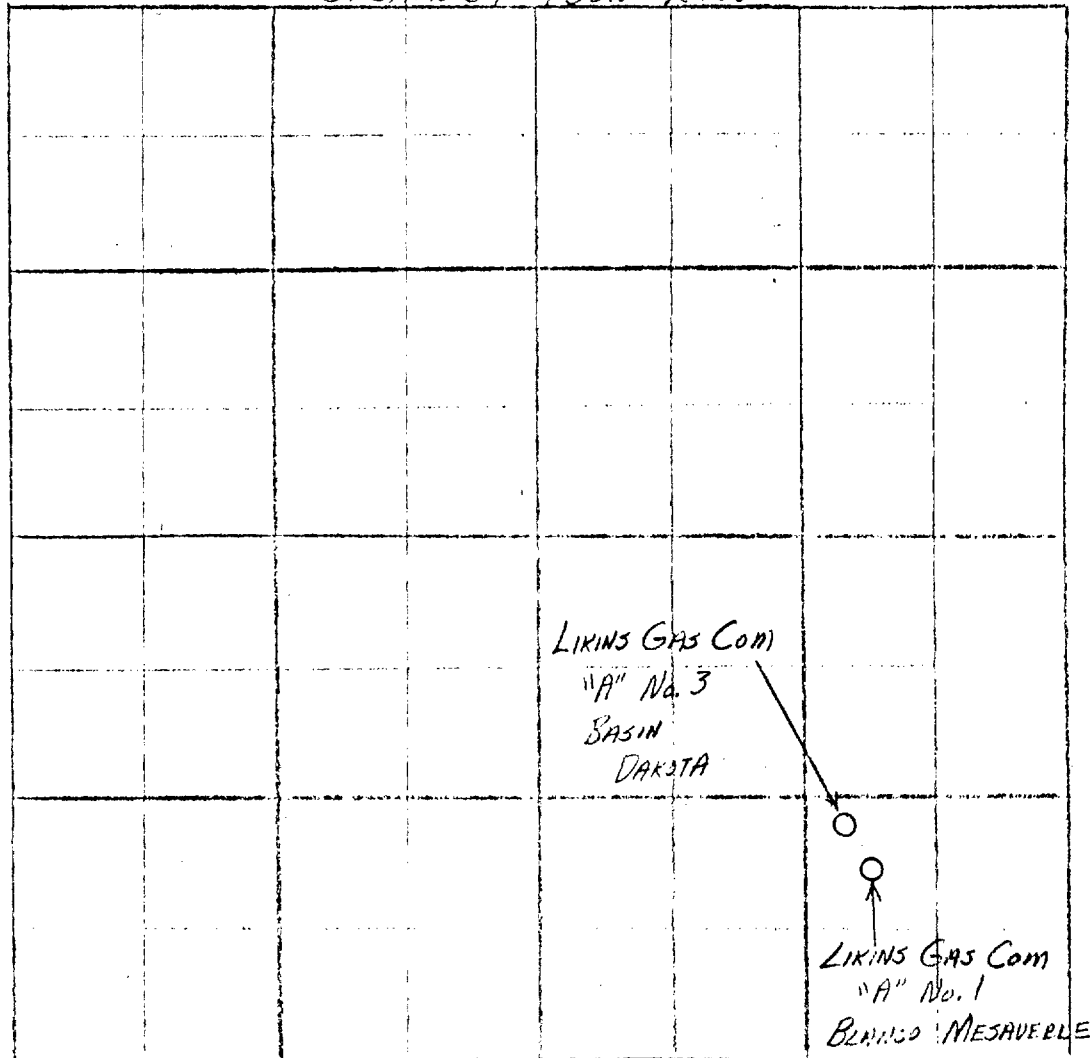

Amoco Production Company

ATTACHMENT VII  
LIKINS GAS COM "A" LEASE

SCALE:

DRG.  
110

SECTION 4-T25N-R5W

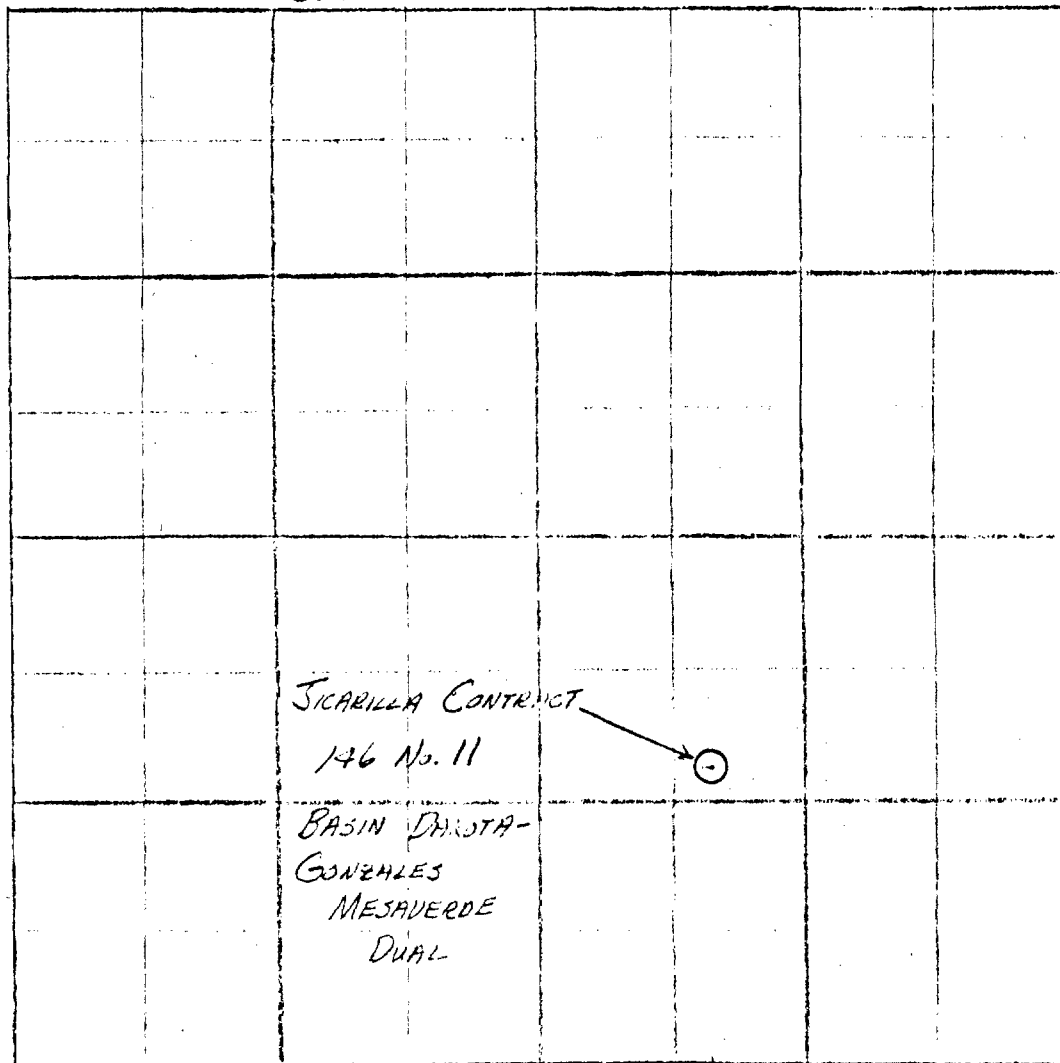

Amoco Production Company

ATTACHMENT IN  
JICARILLA CONTRACT 146 LEASE

SCALE: 1"=1000'

DRG

*Gas Wells*

NEW MEXICO OIL CONSERVATION COMMISSION  
GAS-OIL RATIO TESTS

**C V B - 253**  
C-116  
Revised 1-1-65

Operator		Pool		County											
AMOCO PRODUCTION COMPANY		Basin Dakota and Gonzales Mesaverde		San Juan											
Address		Blanco Mesaverde and Basin Dakota													
501 Airport Drive, Farmington, New Mexico 87401		TYPE OF TEST - (X)		Initial Test for Surface Commingling of Condensate											
		TEST - (X)		Scheduled <input type="checkbox"/> Completion <input type="checkbox"/> Special <input checked="" type="checkbox"/>											
LEASE NAME	WELL NO.	LOCATION				DATE OF TEST	STATS	CHOKE SIZE	TBG. PRESS.	DAILY ALLOW-ABLE	LENGTH OF TEST HOURS	PROD. DURING TEST			GAS - OIL RATIO CU.FT./BBL.
		U	S	T	R							WATER BBLs.	GRAV. OIL	OIL BBLs.	
W. D. Heath "A" (Blanco Mesaverde)	3-X	J	17	29N	9W	8/18-26 1974					192	54	21.0	3035.0	144,524
W. D. Heath "A" (Basin Dakota)	10	J	17	29N	9W	8/18-26 1974					192	53	2.0	731.0	365,500
Jaquez Gas Com "B" (Blanco Mesaverde)	1	J	4	29N	9W	8/16-24 1974					192	54	7.0	1943.0	277,571
Jaquez Gas Com "B" (Basin Dakota)	3	J	4	29N	9W	8/16-24 1974					192	53	9.0	2001.0	222,333
Jaquez Gas Com "A" (Blanco Mesaverde)	1	F	5	29N	9W	8/16-24 1974					192	54	31.0	2710.0	87,419
Jaquez Gas Com "A" (Basin Dakota)	3	F	5	29N	9W	8/16-24 1974					192	53	14.0	4091.0	292,214
Jicarilla Contract 146 (Basin Dakota)	11	J	4	25N	5W	8/22-30 1974					192	53	15	1031	68,733
Jicarilla Contract 146 (Gonzales Mesaverde)	11	J	4	25N	5W	8/22-30 1974					192	49	7	2345	335,000

## NEW MEXICO OIL CONSERVATION COMMISSION

## GAS-OIL RATIO TESTS

## Blanco Mesaverde and Blanco Pictured Cliffs

C-116  
Revised 1-1-65

Operator

AMOCO PRODUCTION COMPANY

Pool Blanco Mesaverde and Basin Dakota  
Basin Dakota and Gonzales Mesaverde

County

Rio Arriba

Address

501 Airport Drive, Farmington, New Mexico 87401

TYPE OF TEST - (X) Initial Test for Surface Commingling of Condensate  
Completion ☐ Special ☒

LEASE NAME	WELL NO.	LOCATION			DATE OF TEST	STATUS	CHOKE SIZE	TBG. PRESS.	DAILY ALLOW-ABLE	LENGTH OF TEST HOURS	PROD. DURING TEST			GAS - OIL RATIO CU. FT./BBL.
		U	S	T							WATER BBL'S.	GRAV. OIL BBL'S.	GAS M.C.F.	
Jicarilla Contract 155 (Basin Dakota)	20	0	29	26N	5W	9/9-17 1974				192	53	23	1670	72,609
Jicarilla Contract 155 (Gonzales Mesaverde)	20	0	29	26N	5W	9/9-17 1974				192	49	87	560	6,437
Jicarilla Contract 155 (Basin Dakota)	22	L	31	26N	5W	9/9-17 1974				192	53	35	2621	74,886
Jicarilla Contract 155 (Gonzales Mesaverde)	22	L	31	26N	5W	9/9-17 1974				192	49	11	1478	134,364
Likins Gas Com "A" (Blanco Mesaverde)	1	P	34	30N	9W	8/16-24 1974				192	54	20	5593	279,650
Likins Gas Com "A" (Basin Dakota)	3	P	34	30N	9W	8/16-24 1974				192	53	7	1874	267,714
E. E. Elliott "A" (Blanco Mesaverde)	1	L	15	30N	9W	8/17-25 1974				192	54	31	9901	319,387
E. E. Elliott "A" (Blanco Pictured Cliffs)	3	L	15	30N	9W	8/17-25 1974				192	52	13	881	67,769

No well will be assigned an allowable greater than the amount of oil produced on the official test.

During gas-oil ratio test, each well shall be produced at a rate not exceeding the top unit allowable for the pool in which well is located by more than 25 percent. Operator is encouraged to take advantage of this 25 percent tolerance in order that well can be assigned increased allowables when authorized by the Commission.

Gas volumes must be reported in MCF measured at a pressure base of 15.025 psia and a temperature of 60° F. Specific gravity base will be 0.60.

Report casing pressure in lieu of tubing pressure for any well producing through casing.

Mail original and one copy of this report to the district office of the New Mexico Oil Conservation Commission in accordance with Rule 301 and appropriate pool rules.

I hereby certify that the above information is true and complete to the best of my knowledge and belief.

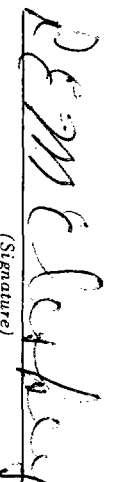

Area Engineer

(Signature)

October 15, 1974

(Date)



# OIL CONSERVATION COMMISSION

STATE OF NEW MEXICO  
1000 RIO BRAZOS ROAD - AZTEC  
87410

October 25, 1974

A. R. TRUJILLO  
CHAIRMAN

LAND COMMISSIONER  
ALEX J. ARMIJO  
MEMBER

STATE GEOLOGIST  
A. L. PORTER, JR.  
SECRETARY - DIRECTOR

Mr. L. O. Speer, Jr.  
Amoco Production Company  
501 Airport Drive  
Farmington, New Mexico

Re: CT6-253

Dear Mr. Speer:

The referenced order requires accounting by zones for each well based upon periodic tests.

Allocate liquid production to the respective zones of each well based upon the percentage produced during the tests shown on the attached Form C-116.

Annual testing for liquid allocation will be sufficient until further notice.

If there are questions, please contact us.

Yours very truly,

*AR Kendrick*  
A. R. Kendrick  
Engineer, District #3

ARK:mc

cc: (with attach.) Oil Conservation Commission  
Santa Fe, New Mexico