

**CONOCO**

L. P. Thompson  
Division Manager  
Production Department  
Hobbs Division

Western Hemisphere Petroleum Division  
Continental Oil Company  
P. O. 460  
1001 North Turner  
Hobbs, New Mexico 88240  
(505) 393-4141

February 28, 1974

New Mexico Oil Conservation Commission(3)  
P. O. Box 2088  
Santa Fe, New Mexico 87501

Attention Mr. A. L. Porter, Jr., Secretary-Director

Gentlemen:

Application for Amendment of Administrative Order PC-250

*File in PC-249 File*

*249*

Administrative Order PC-250 authorized the commingling of Tubb and Grayburg production in the Southeast Monument Unit. Subsequent amendments authorized the additional commingling of Blinbry and Brinkard production. Application is being filed concurrently with this to downhole-commingle Tubb and Blinbry production in SEMU Well No. 84. The attached schematic diagram shows the manner in which the battery will be arranged to handle the production so as to properly account for production from the various zones. Well No. 70 will still be metered separately and the production allocated in accordance with Order No. R-2180. The Weir-Blinbry production from Well No. 61 will also be metered separately. Weir-Brinkard production is gas with negligible liquid, which will be metered prior to commingling with the Monument-Tubb stream.

The attached list of wells and most recent tests thereof shows that there is no top allowable production on the lease.

It is respectfully requested that Administrative Order PC-250 be amended to authorize the commingling as shown on the attached schematic diagram.

Yours very truly,

*L. P. Thompson*

reh

Enc

CC:

AMOCO-Hobbs

USGS-Hobbs(2)

RLA: WER: JWR



Mark K. Mosley  
Division Manager  
Production Department  
Hobbs Division  
North American Production

Conoco Inc.  
P.O. Box 460  
726 E. Michigan  
Hobbs, NM 88240  
(505) 393-4141

June 15, 1982

New Mexico Oil Conservation Division  
Department of Energy and Minerals  
State of New Mexico  
P. O. Box 2088  
Santa Fe, New Mexico 87501

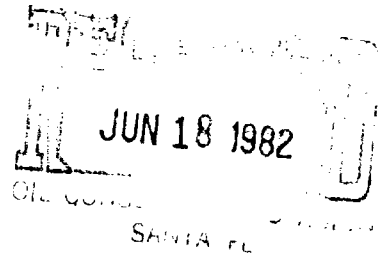

Attention: Mr. Joe D. Ramey

Dear Sir:

Application for Permission to Surface Commingle Production from SEMU No. 120,  
Unit B, Section 14, T20S, R37E, Lea County, New Mexico

---

Conoco Inc. requests administrative approval under the provisions of Rule 303-B to surface commingle Monument Tubb production from SEMU No. 120 into a commingled tank battery located NE/4 SE/4 of Section 15, T20S, R37E, Lea County, New Mexico. Administrative Order PC-249 gave approval to surface commingle Weir Drinkard, Monument Tubb and Undesignated Blinebry (later Weir Blinebry) after separately metering the production from each pool.

Ownership and working interest for all zones is common. Quality of the crude is virtually identical and commingling will not reduce the commercial value.

SEMU No. 120 is currently producing an average of 27 BOPD, 15 BWPD and 375 MCFGPD. The crude from No. 120 has a gravity of 38° and a value of \$31.96 per barrel.

A lease and battery plat are attached for your review and file. The Monument Tubb production from SEMU No. 120 will be allocated on a well test basis.

If you have any questions, please call David G. Smylie, ext. 120 of this office.

Yours very truly,

DGS:agd

Attachments

cc: Minerals Management Service  
P. O. Box 1857  
Roswell, NM 88201



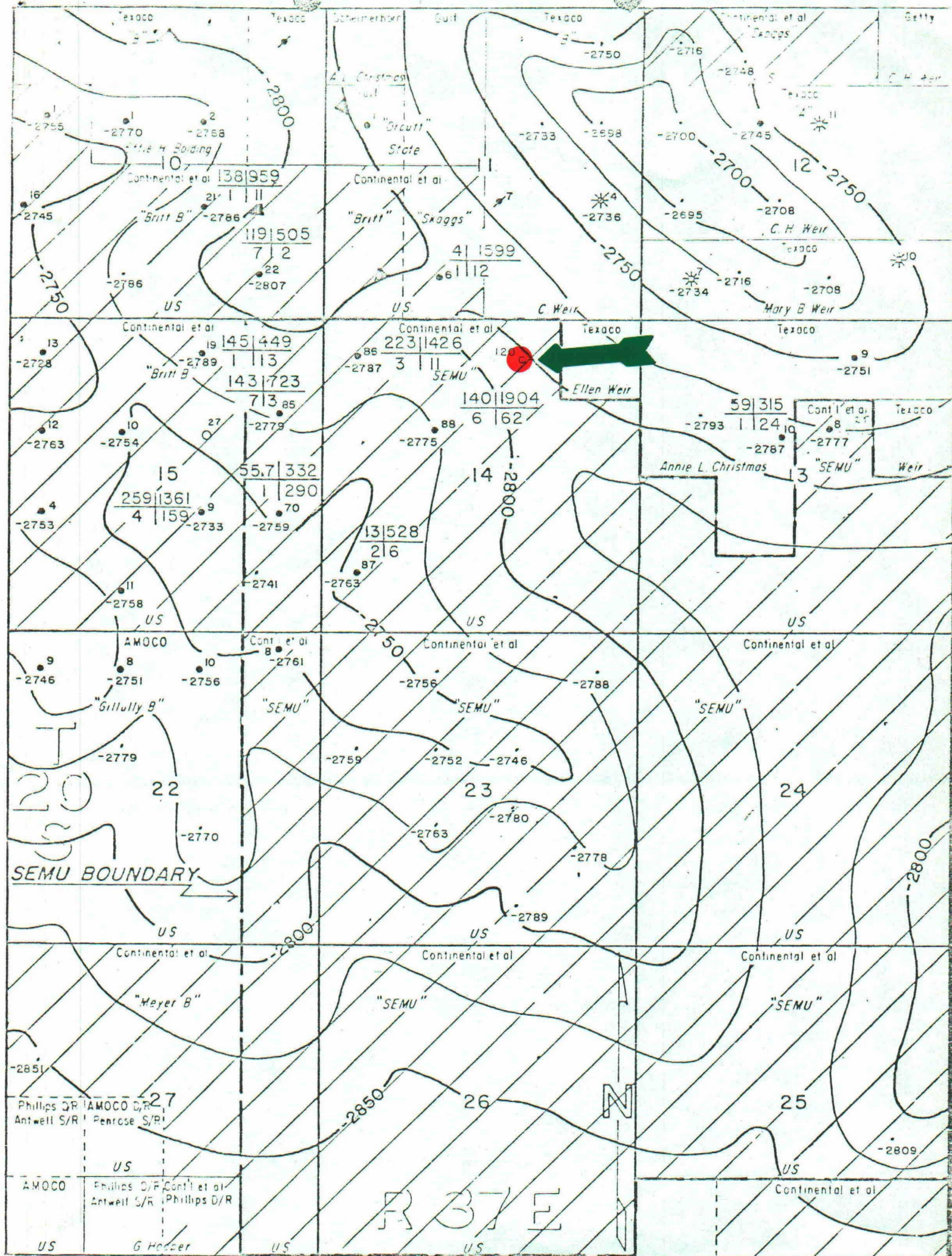

MBO | MMCF  
BOPD | MCFPD

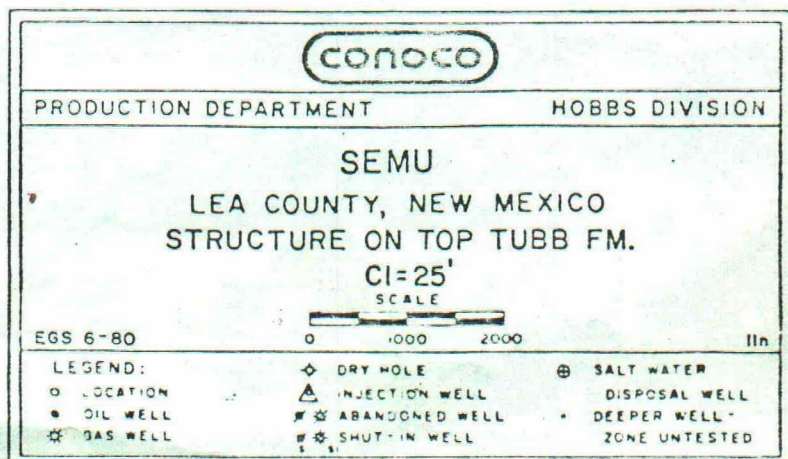



# SEMU DTB BATTERY

## PROPOSED BATTERY SCHEMATIC

