

RECEIVED
AUG 30 1976
NEW MEXICO OIL CONSERVATION COMMISSION
SANTA FE

May 13, 1976

PC -

New Mexico Oil Conservation Commission
P. O. Box 2088
Santa Fe, New Mexico 87501

Gentlemen:

Proposed Commingling - Elliott A-15 Lease

Continental Oil Company proposes to commingle the Drinkard and Penrose Skelly production from its Elliott A-15 lease. This lease is located in section 15, T-22S, R-37E, Lea County, New Mexico. The Brunson production from this lease will continue to produce into a separate battery since this production goes into a separate pipeline system.

At the present time the production from the Elliott B-15 lease is produced into separate tanks at the same battery location as the Elliott A-15 battery. It is proposed to re-vamp this entire battery location to better utilize available equipment, replace worn and unsightly equipment, conserve energy and abide by environmental protection requirements. As a result of this re-vamping we request permission to utilize a common test metering heater-treater. This vessel is to be installed with 3-way, 2-position valves with automatic control hook-up both up-stream and down stream of the vessel. This will prevent any possible mixing of lease/pool production in the test vessel.

Attached is a schematic showing proposed battery installation, plat showing wells to be served by commingled facility and letter from U.S.G.S. approving subject proposal.

Your early approval of this proposal is respectfully requested.

Yours very truly,

L. P. Thompson
Division Manager

BC:llh
Enc.



United States Department of the Interior

GEOLOGICAL SURVEY

P. O. Box 1157
Hobbs, New Mexico 88240

October 30, 1975

RECEIVED	
COBBS DIVISION	
OCT 31 '75	
975	
	Note Noted Hnd.
Div. Manager	<i>[Signature]</i>
Prod. Supt.	<i>[Signature]</i>
Div. Engr.	<i>[Signature]</i>
Div. Off. Mgr.	
Cons'v. Coord.	<i>[Signature]</i>
M. S. Supv.	
BEG	

Elliot A-15, B-15 Battery Modification

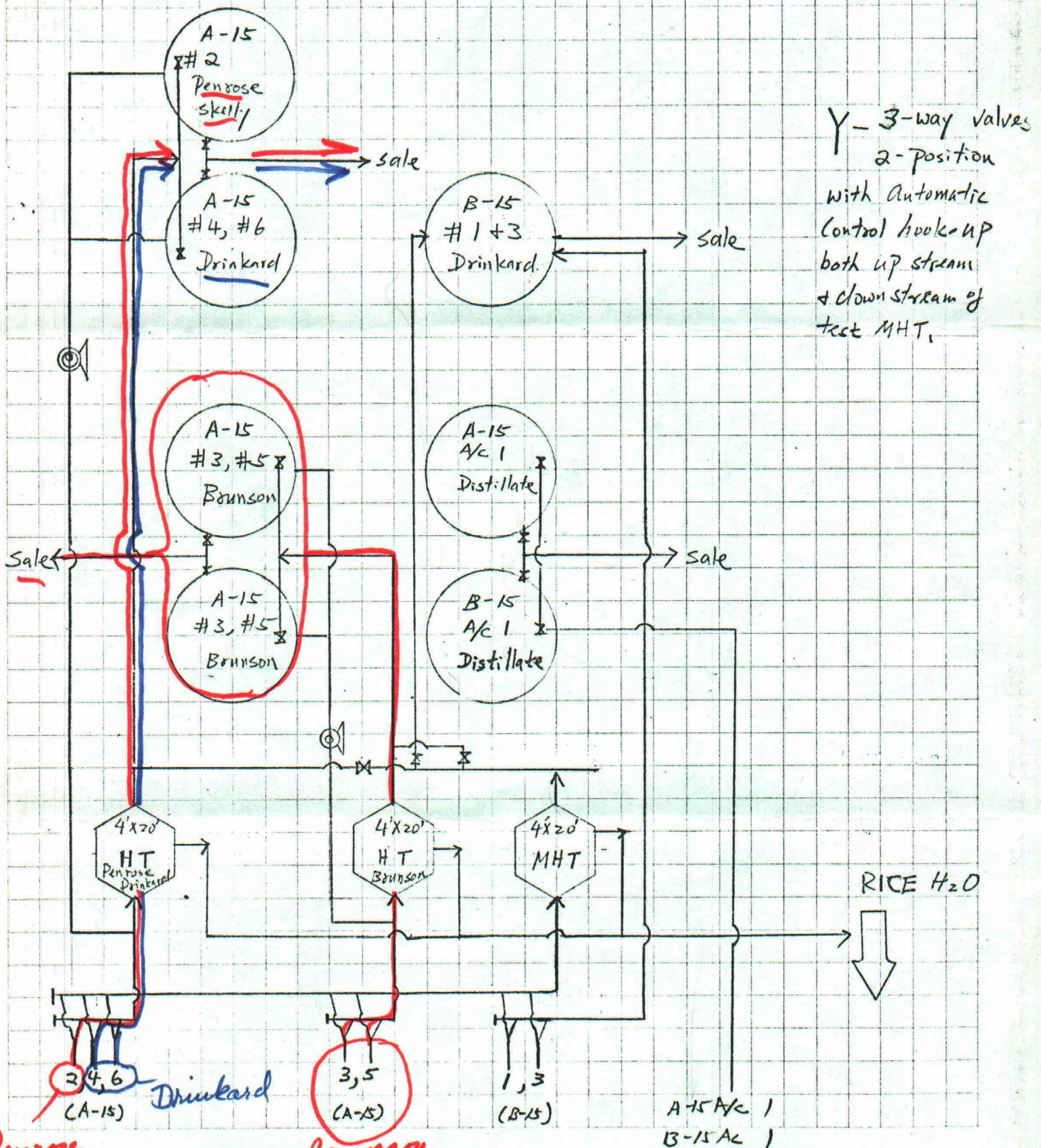

Penrose
Skelly
MADE BY JTH

Brunson

CONTINENTAL OIL COMPANY
CALCULATION SHEET

JOB No.

CHECKED BY

DATE 4-22-76

TITLE

FIELD

PAGE OF

STATE

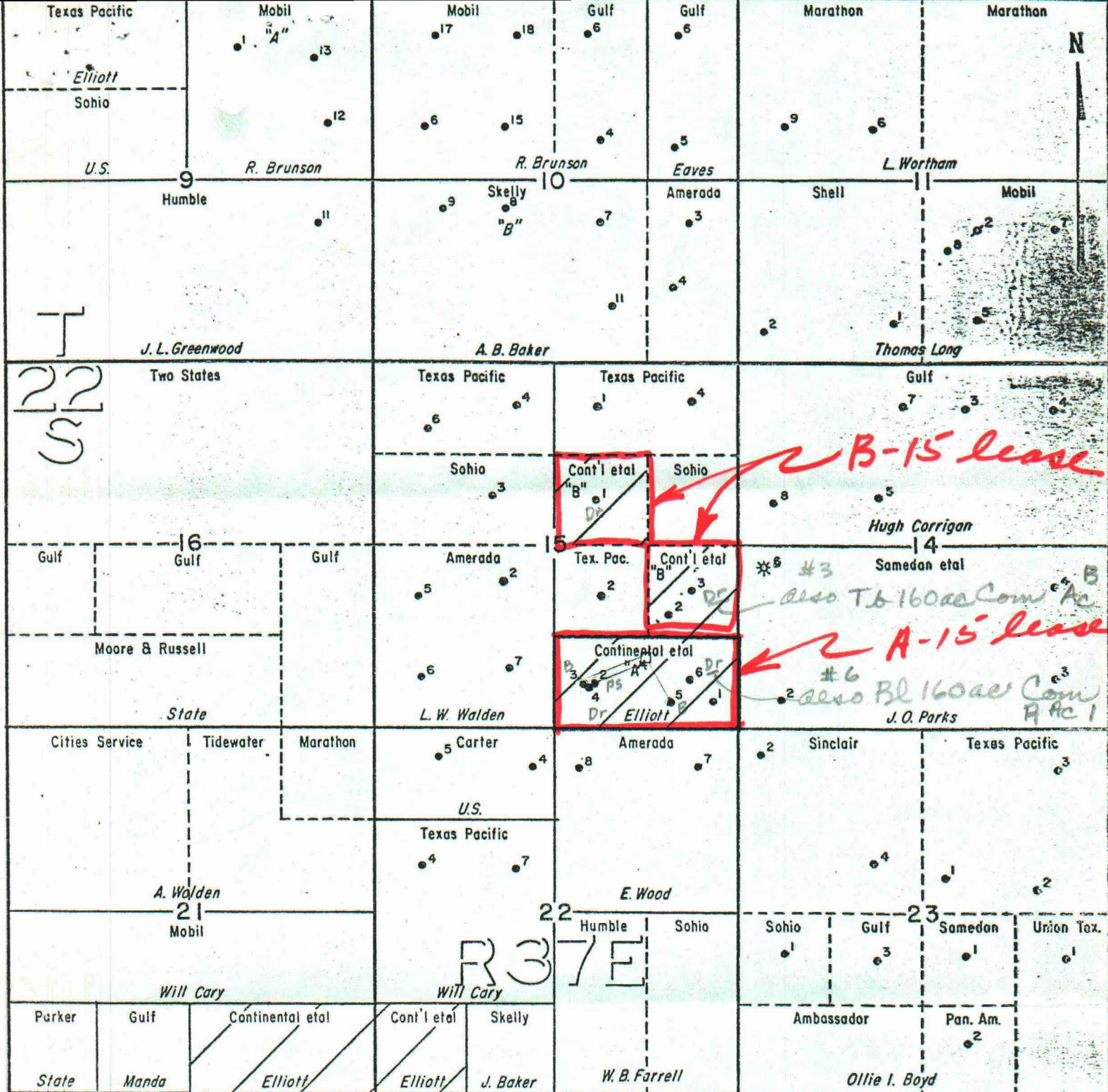

CONTINENTAL OIL COMPANY

PRODUCTION DEPARTMENT—HOBBS DISTRICT

Lea County, New Mexico

Elliott A-15

SCALE

0 1000' 2000'

BLJ