

RELEASE 5.31.93

AMAX

OIL & GAS INC.

P.O. BOX 850857 YUKON, OKLAHOMA 73085-0857

TELEPHONE (405) 354-8853

TELECOPIER (405) 354-8747

4 9 32

May 6, 1993

Bureau of Land Management
Attn: Mr. Steve Mason
1235 La Plata Hwy.
Farmington, NM 87401

New Mexico Oil Conservation Division
Attn: Mr. David Catanach
P. O. Box 2088
Santa Fe, NM 87504

Re: Lindrith #110-E
N/2 Section 10-26N-7W
Rio Arriba County, New Mexico
Santa Fe #079161

Gentlemen:

Amax Oil and Gas Inc. requests approval to surface commingle the gas production from this dually completed well. This well was completed in the Dakota and Gallup formations in April of 1983. The current production from the Dakota is 45 MCFD and 1/4 BOPD. Production from the Gallup is 15 MCFD with no oil production.

Amax will equitably allocate production between the commingled zones based on the production tests prior to commingling.

Both the Dakota and Largo formations share in the indicated spacing unit with the Lindrith #110 well. The unit's working and mineral interests are also the same for both formations.

Attached is a revised site security plan indicating the revised product flow.

We appreciate your earliest attention to this request.

Sincerely,



Dennis R. Beccue
Region Engineer

DRB:bjc

Attachments

FIGURE 1

R-7-W

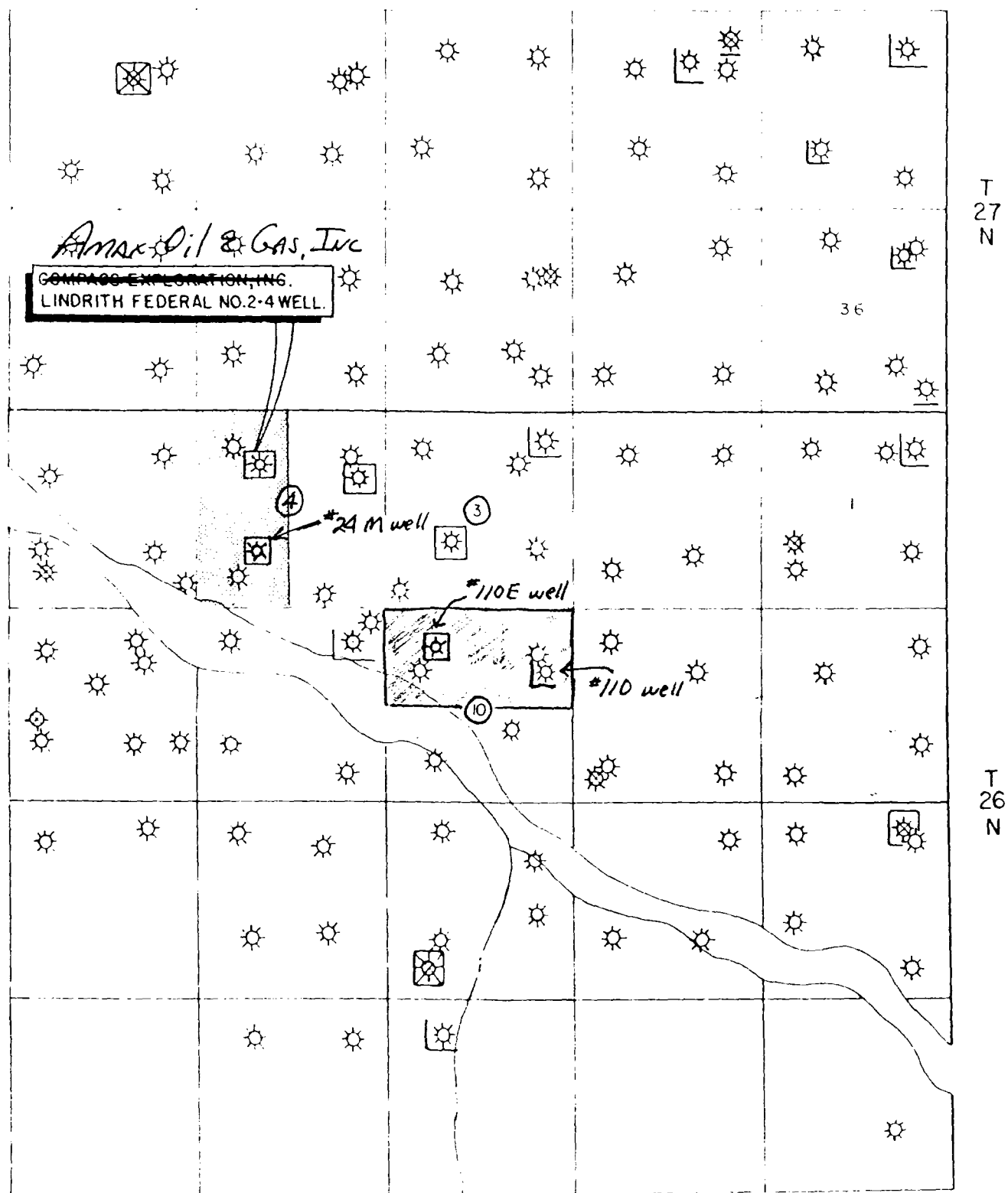

LEGEND

- ◇ Dry Hole
- ☆ Pictured Cliffs
- ✱ Mesaverde
- Dakota
- ◊ PC-MV Dual
- ◊ or ◊ Drilled to Dakota
- ◊ or ◊ Gator Dakota Dual
- ◊ MV-Dakota Dual

PORTION OF THE
BASIN DAKOTA POOL

RIO ARRIBA COUNTY, NEW MEXICO

