

ILLEGIBLE

11-28-00

Attention: Steve Hayden

Here is an application  
and draft order for your  
review. I'm waiting  
your verdict. Thanks

W. Stur

11-30

OKed by Steve over phone.

W. Stur

31238328

NSL

11/27/00

**Cross Timbers Oil Company**

November 2, 2000

NOV - 6 2000

Mr. Michael E. Stogner  
New Mexico Oil Conservation Division  
2040 South Pacheco  
Santa Fe, New Mexico 87505

CERTIFIED MAIL  
# 0368 4199

**Re: Application for Administrative Approval of Unorthodox Location  
Cross Timbers Operating Company's Chrisman Gas Com #1 Well  
2,165' FSL and 1,090 FWL of Section 11-T30N-R12W, Unit L,  
San Juan County, New Mexico  
Blanco Mesaverde Gas Pool**

Dear Mr. Stogner:

Cross Timbers Operating Company hereby requests administrative approval for an unorthodox location for the above referenced well. Attached for your reference are the following exhibits:

1. Well location plat (NMOCD Form C-102); and
2. Ownership Plat.

The Chrisman Gas Com #1 well (API # 3004509680) was spud on 7/27/65 and completed on 8/29/65 as Dakota producer on a W/2 320 acre unit. Cross Timbers Operating Company would like to temporarily abandon the Dakota formation and recompleat in the Mesaverde formation. Production from the Mesaverde formation will be from a 319.23-acre gas spacing unit comprising of the S/2 of Section 11. The current rules state that the subject well be located no closer than 660' to any outer boundary of the quarter section on which the well is located and not closer than 10' to any quarter-quarter section line or subdivision inner boundary. The existing location will not conform to the footage requirements. The current wellbore is in acceptable condition for the recompletion attempt and by moving up the hole in this well, Cross Timbers would be able to minimize environmental impact in obtaining additional production and protect correlative rights. Furthermore, a new well would not be economically feasible for just the Mesaverde formation.

The offset 320 acre Mesaverde unit to the north (N/2 of Sec. 11), towards which the requested unorthodox location encroaches, is operated by Cross Timbers Operating Company with a 100% ownership in this unit; therefore, there are no offset operators or working interest owners to notify. The working interest owners in the S/2 Mesaverde unit are Cross Timbers (75%), Conoco (17%), Burlington (7.85%) and J. Fullerton (0.15%).

Chrisman Gas Com #1 Well  
NMOCD  
November 2, 2000  
Page 2

Cross Timbers is requesting administrative approval for the unorthodox location based on the information stated above. If additional clarification or information is needed, please contact me at (817) 885-2661.

Very truly yours,

A handwritten signature in black ink, appearing to read "Tim Welch", written in a cursive style.

Tim Welch  
Senior Landman  
Cross Timbers Operating Company

Enclosures

District I

PO Box 1280, Hobbs, NM 88241-1980

District II

811 S. 1st Street, Arama, NM 88210-2834

District III

1000 Rio Brazos Rd., Aztec, NM 87110

District IV

2040 South Pacheco, Santa Fe, NM 87505

State of New Mexico  
Energy, Minerals & Natural Resources Department

OIL CONSERVATION DIVISION  
2040 South Pacheco  
Santa Fe, NM 87505

Form C-102

Revised October 18, 1997

Instructions on back

Submit to Appropriate District Office

State Lease - 4 Copies

Fee Lease - 3 Copies

**ILLEGIBLE**☐ AMENDED REPORT**WELL LOCATION AND ACREAGE DEDICATION PLAT**

<sup>1</sup> API Number 30-045-09680		<sup>2</sup> Pool Code 72319		<sup>3</sup> Pool Name Blanco Mesaverde	
<sup>4</sup> Property Code		<sup>5</sup> Property Name Christian Gas Com			<sup>6</sup> Well Number 1
<sup>7</sup> OGRID No. 167057		<sup>8</sup> Operator Name Cross Timbers Operating Company			<sup>9</sup> Elevation 5,913' GL

<sup>10</sup> Surface Location

Center lot no.	Section 11	Township 30N	Range 12W	Lot Idn	Feet from the 2,165	North/South Line S	Feet from the 1,090	East/West line W	County San Juan
----------------	---------------	-----------------	--------------	---------	------------------------	-----------------------	------------------------	---------------------	--------------------

<sup>11</sup> Bottom Hole Location If Different From Surface

Center lot no.	Section	Township	Range	Lot Idn	Feet from the	North/South Line	Feet from the	East/West line	County
----------------	---------	----------	-------	---------	---------------	------------------	---------------	----------------	--------

<sup>12</sup> Dedicated Acres 319.23 (5/2)	<sup>13</sup> Joint or Infill	<sup>14</sup> Consolidation Code	<sup>15</sup> Order No.
---	-------------------------------	----------------------------------	-------------------------

NO ALLOWABLE WILL BE ASSIGNED TO THIS COMPLETION UNTIL ALL INTERESTS I HAVE BEEN CONSOLIDATED  
OR A NON-STANDARD UNIT HAS BEEN APPROVED BY THE DIVISION

	<sup>17</sup> OPERATOR CERTIFICATION I hereby certify that the information contained herein is true and complete to the best of my knowledge and belief.   Signature Thomas DeLong Printed Name Operations Engineer Title 10/31/2000 Date		
	<sup>18</sup> SURVEYOR CERTIFICATION I hereby certify that the well location shown on this plat was plotted from field notes of actual surveys made by me or under my supervision, and that the same is true and correct to the best of my belief.  07/21/65 Date of Survey Signature and Seal of Professional Surveyor: originally signed by James P. Leese 1463 Certificate Number		

# ILLEGIBLE

Form C-12 (6-57)

NEW MEXICO OIL CONSERVATION COMMISSION

Well Location and Acreage Dedication Plat

Section A.

Date JULY 22, 1965

Operator PAN AMERICAN PETROLEUM CORPORATION Lease CHRISMAN GAS COM TE  
 Well No. 1 Unit Letter L Section 11 Township 30 NORTH Range 12 WEST N.M.M.  
 Located 2165 Feet From the SOUTH Line, 1090 Feet From the WEST Line  
 County SAN JUAN G. L. Elevation REPORT LATER Dedicated Acreage 320 Acres  
 Name of Producing Formation DAKOTA Pool BASIN DAKOTA

1. Is the Operator the only owner in the dedicated acreage outlined on the plat below?  
 Yes X No \_\_\_\_\_
2. If the answer to question one is "no", have the interests of all the owners been consolidated by communitization agreement or otherwise? Yes \_\_\_\_\_ No \_\_\_\_\_. If answer is "yes", Type of Consolidation \_\_\_\_\_
3. If the answer to question two is "no", list all the owners and their respective interests below.

Owner

Land Description

Section B.

This is to certify that the information in Section A above is true and complete to the best of my knowledge and belief.

PAN AMERICAN PETROLEUM CORP.  
R. H. Hollingsworth (Operator)  
2165 (Representative)  
P. O. Box 480  
(Address)  
Farmington, New Mexico

Note: All distances must be from outer boundaries of section.

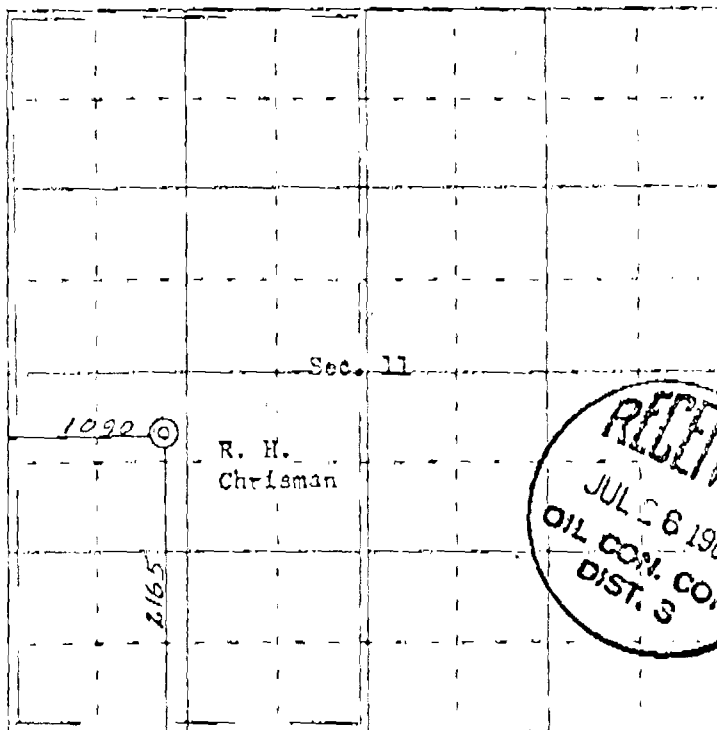

Ref: GLO plat dated April 7, 1931.

Scale 4 inches equal 1 mile

This is to certify that the above plat was prepared from field notes of actual surveys made by me or under my supervision and that the same are true and correct to the best of my knowledge and belief.

Date Surveyed July 21, 1965

James P. Leese  
 Registered Professional Engineer and/or Land Surveyor  
 James P. Leese, N.M. Reg. No. 11463

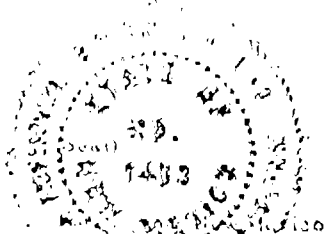



District I  
PO Box 1980, Hobbs, NM 88241-1980

District II  
811 South First, Artesia, NM 88210

District III  
1000 Rio Brazos Rd., Aztec, NM 87410

District IV  
2040 South Pacheco, Santa Fe, NM 87505

State of New Mexico  
Energy, Minerals and Natural Resources Department  
**OIL CONSERVATION DIVISION**  
2040 South Pacheco  
Santa Fe, NM 87505

Form C-104  
Revised October 18, 1994  
Instructions on back  
Submit to Appropriate District Office  
5 Copies

☐ AMENDED REPORT

**I. REQUEST FOR ALLOWABLE AND AUTHORIZATION TO TRANSPORT**

<sup>1</sup> Operator name and Address <b>CROSS TIMBERS OPERATING COMPANY</b> 6001 Highway 64 Farmington, NM 87401		<sup>2</sup> OGRID Number 167067
		<sup>3</sup> Reason for Filing Code Change of Operator <u>12/1/97</u>
<sup>4</sup> API Number 30-045-09680	<sup>5</sup> Pool Name BASIN DAKOTA	<sup>6</sup> Pool Code 71599
<sup>7</sup> Property Code	<sup>8</sup> Property Name CHRISMAN GAS COM	<sup>9</sup> Well Number 1

**II. <sup>10</sup> Surface Location**

UL or lot no. L	Section 11	Township 30N	Range 12W	Lot.Idn	Feet from the 2165	North/South Line S	Feet from the 1090	East/West line W	County SJ
--------------------	---------------	-----------------	--------------	---------	-----------------------	-----------------------	-----------------------	---------------------	--------------

**<sup>11</sup> Bottom Hole Location**

UL or lot no.	Section	Township	Range	Lot.Idn	Feet from the	North/South Line	Feet from the	East/West line	County
<sup>12</sup> Lse Code P	<sup>13</sup> Producing Method Code	<sup>14</sup> Gas Connection Date	<sup>15</sup> C-129 Permit Number	<sup>16</sup> C-129 Effective Date	<sup>17</sup> C-129 Expiration Date				

**III. Oil and Gas Transporters**

<sup>18</sup> Transporter OGRID	<sup>19</sup> Transporter Name and Address	<sup>20</sup> POD	<sup>21</sup> O/G	<sup>22</sup> POD ULSTR Location and Description

RECEIVED  
DEC 19 1997

**IV. Produced Water**

<sup>23</sup> POD	<sup>24</sup> POD ULSTR Location and Description
	OIL CON. DIV. DIST. 3

**V. Well Completion Data**

<sup>25</sup> Spud Date	<sup>26</sup> Ready Date	<sup>27</sup> TD	<sup>28</sup> PBSD	<sup>29</sup> Perforation	<sup>30</sup> DHC,DC,MC
<sup>31</sup> Hole Size	<sup>32</sup> Casing and Tubing Size	<sup>33</sup> Depth Set	<sup>34</sup> Sacks Cement		

**VI. Well Test Data**

<sup>35</sup> Date New Oil	<sup>36</sup> Gas Delivery Date	<sup>37</sup> Test Date	<sup>38</sup> Test Length	<sup>39</sup> Tbg. Pressure	<sup>40</sup> Csg. Pressure
<sup>41</sup> Choke Size	<sup>42</sup> Oil	<sup>43</sup> Water	<sup>44</sup> Gas	<sup>45</sup> AOF	<sup>46</sup> Test Method

<sup>47</sup> I hereby certify that the rules of the Oil Conservation Division have been complied with and that the information given above is true and complete to the best of my knowledge and belief. Signature: <i>Vaughn O. Vennerberg, II</i>	<b>OIL CONSERVATION DIVISIO</b> Approved by: Frank T. Chavez Title: Supervisor District #3 Approval Date:
Printed Name: Vaughn O. Vennerberg, II Title: Sr. Vice President-Land Date: December 1, 1997 Phone: (505) 632-5200	

<sup>48</sup> If this is a change of operator fill in the OGRID number and name of the previous operator <i>Gail Jefferson</i> Previous Operator Signature	Amoco Production Company Senior Administrative Staff Assistant Gail Jefferson Printed Name	OGRID# 000778 12/01/97 Title Date
--	---	--

Submit 5 Copies  
Appropriate District Office  
DISTRICT I  
P.O. Box 1980, Hobbs, NM 88240

DISTRICT II  
P.O. Drawer DD, Artesia, NM 88210

DISTRICT III  
1000 Rio Brazos Rd., Aztec, NM 87410

State of New Mexico  
Energy, Minerals and Natural Resources Department

OIL CONSERVATION DIVISION

P.O. Box 2088  
Santa Fe, New Mexico 87504-2088

Form C-104  
Revised 1-1-89  
See Instructions  
at Bottom of Page

OIL CONSERVATION DIVISION  
RECEIVED

REQUEST FOR ALLOWABLE AND AUTHORIZATION  
TO TRANSPORT OIL AND NATURAL GAS

'90 AUG 22 AM 10 53

Operator AMOCO PRODUCTION COMPANY	Well API No. 300450968000
Address P.O. BOX 800, DENVER, COLORADO 80201	
Reason(s) for Filing (Check proper box) <input type="checkbox"/> Other (Please explain)	
New Well <input type="checkbox"/>	Change in Transporter of:
Recompletion <input type="checkbox"/>	Oil <input type="checkbox"/> Dry Gas <input type="checkbox"/>
Change in Operator <input type="checkbox"/>	Casinghead Gas <input type="checkbox"/> Condensate <input checked="" type="checkbox"/>

If change of operator give name  
and address of previous operator

II. DESCRIPTION OF WELL AND LEASE

Lease Name CHRISMAN GAS COM	Well No. 1	Pool Name, including Formation BASIN DAKOTA (PRORATED GAS)	Kind of Lease State, Federal or <input checked="" type="radio"/> Fee	Lease No.
Location				
Unit Letter L	: 2165	Feet From The FSL	Line and 1090	Feet From The FWL
Section 11	Township 30N	Range 12W	NMPM,	SAN JUAN
				County

III. DESIGNATION OF TRANSPORTER OF OIL AND NATURAL GAS

Name of Authorized Transporter of Oil <input type="checkbox"/> or Condensate <input checked="" type="checkbox"/>	Address (Give address to which approved copy of this form is to be sent)
MERIDIAN OIL INC.	3535 EAST 30TH STREET, FARMINGTON, CO 87401
Name of Authorized Transporter of Casinghead Gas <input type="checkbox"/> or Dry Gas <input checked="" type="checkbox"/>	Address (Give address to which approved copy of this form is to be sent)
EL PASO NATURAL GAS COMPANY	P.O. BOX 1492, EL PASO, TX 79978
If well produces oil or liquids, give location of tanks.	Is gas actually connected? When?

If this production is commingling with that from any other lease or pool, give commingling order number:

IV. COMPLETION DATA

Designate Type of Completion - (X)	Oil Well	Gas Well	New Well	Workover	Deepen	Plug Back	Same Res'v	Diff Res'v
Date Spudded	Date Compl. Ready to Prod.		Total Depth			P.B.T.D.		
Elevations (DF, RKB, RT, GR, etc.)	Name of Producing Formation		Top Oil/Gas Pay			Tubing Depth		
Perforations						Depth Casing Shoe		
TUBING, CASING AND CEMENTING RECORD								
HOLE SIZE	CASING & TUBING SIZE		DEPTH SET			SACKS CEMENT		

V. TEST DATA AND REQUEST FOR ALLOWABLE

OIL WELL (Test must be after recovery of total volume of load oil and must be equal to or exceed top allowable for this depth or be for full 24 hours.)

Date First New Oil Run To Tank	Date of Test	Producing Method (Flow, pump, gas lift, etc.)	
Length of Test	Tubing Pressure	Casing Pressure	Choke Size
Actual Prod. During Test	Oil - Bbls.	Water - Bbls.	Gas - MCF

RECEIVED  
JUL 2 1990

GAS WELL

Actual Prod. Test - MCF/D	Length of Test	Bbls. Condensate/MMCF	Oil Con. Div.
Testing Method (pilot, back pr.)	Tubing Pressure (Shut-in)	Casing Pressure (Shut-in)	DIST. 2

VI. OPERATOR CERTIFICATE OF COMPLIANCE

I hereby certify that the rules and regulations of the Oil Conservation Division have been complied with and that the information given above is true and complete to the best of my knowledge and belief.

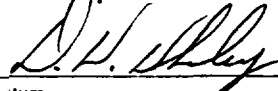
  
Signature  
Doug W. Whaley, Staff Admin. Supervisor  
Printed Name  
June 25, 1990  
Date  
303-830-4280  
Telephone No.

OIL CONSERVATION DIVISION  
JUL 2 1990

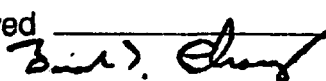
Date Approved  
By   
SUPERVISOR DISTRICT #3  
Title

INSTRUCTIONS: This form is to be filed in compliance with Rule 1104

- 1) Request for allowable for newly drilled or deepened well must be accompanied by tabulation of deviation tests taken in accordance with Rule 111.
- 2) All sections of this form must be filled out for allowable on new and recompleted wells.
- 3) Fill out only Sections I, II, III, and VI for changes of operator, well name or number, transporter, or other such changes.
- 4) Separate Form C-104 must be filed for each pool in multiply completed wells.



STATE OF NEW MEXICO  
ENERGY AND MINERALS DEPARTMENT

NO. OF COPIES RECEIVED		
DISTRIBUTION		
SANTA FE		
FILE		
U.S.G.A.		
LAND OFFICE		
TRANSPORTER	OIL	
	GAS	
OPERATOR		
PRODUCTION OFFICE		

OIL CONSERVATION DIVISION  
P. O. BOX 2088  
SANTA FE, NEW MEXICO 87501

Form C-104  
Revised 10-01-78  
Format 06-01-83  
Page 1

REQUEST FOR ALLOWABLE  
AND  
AUTHORIZATION TO TRANSPORT OIL AND NATURAL GAS

I. Operator  
Amoco Production Company

Address  
501 Airport Drive Farmington, NM 87401

Reason(s) for filing (Check proper box)  
☐ New Well  
☐ Recombination  
☐ Change in Ownership  
☐ Change in Transporter of:  
☐ Oil  
☐ Gaslinehead Gas  
☒ Dry Gas  
☒ Condensate  
 Other (Please explain)

RECEIVED  
JAN 22 1985

If change of ownership give name and address of previous owner

II. DESCRIPTION OF WELL AND LEASE

Lease Name Chrisman Gas Com	Well No. 1	Pool Name, including Formation Basin Dakota	Kind of Lease State, Federal or Fee	Lease No.
Location Unit Later L : 2165 Feet From The South Line and 1090 Feet From The West Line of Section 11 Township 30N Range 12W, NMPM, San Juan County				

III. DESIGNATION OF TRANSPORTER OF OIL AND NATURAL GAS

Name of Authorized Transporter of Oil <input type="checkbox"/> or Condensate <input checked="" type="checkbox"/> Permian Corp.	Address (Give address to which approved copy of this form is to be sent) P. O. Box 1702 Farmington, NM 87499
Name of Authorized Transporter of Gaslinehead Gas <input type="checkbox"/> or Dry Gas <input checked="" type="checkbox"/> El Paso Natural Gas Company	Address (Give address to which approved copy of this form is to be sent) P. O. Box 990 Farmington, NM 87401
If well produces oil or liquids, give location of tanks. Unit L Sec. 11 Twp. 30N Rge. 12W	Is gas actually connected? When

If this production is commingled with that from any other lease or pool, give commingling order number:

NOTE: Complete Parts IV and V on reverse side if necessary.

VI. CERTIFICATE OF COMPLIANCE

I hereby certify that the rules and regulations of the Oil Conservation Division have been complied with and that the information given is true and complete to the best of my knowledge and belief.

BDS Shaw  
(Signature)

Admin. Supervisor

(Title)

1-2-85

(Date)

OIL CONSERVATION DIVISION

APPROVED JAN 22 1985

BY Charles Sholton

TITLE DEPUTY OIL & GAS INSPECTOR, DIST. #3

This form is to be filed in compliance with RULE 1104.

If this is a request for allowable for a newly drilled or deepened well, this form must be accompanied by a tabulation of the deviation tests taken on the well in accordance with RULE 111.

All sections of this form must be filled out completely for allowable on new and recompleted wells.

Fill out only Sections I, II, III, and VI for changes of owner, well name or number, or transporter, or other such change of condition.

Separate Forms C-104 must be filed for each pool in multiply completed wells.

[illegible]

1998, 1999, 2000, 2001, 2002, 2003, 2004, 2005, 2006, 2007, 2008, 2009, 2010, 2011, 2012, 2013, 2014, 2015, 2016, 2017, 2018, 2019, 2020, 2021, 2022, 2023, 2024, 2025, 2026, 2027, 2028, 2029, 2030, 2031, 2032, 2033, 2034, 2035, 2036, 2037, 2038, 2039, 2040, 2041, 2042, 2043, 2044, 2045, 2046, 2047, 2048, 2049, 2050, 2051, 2052, 2053, 2054, 2055, 2056, 2057, 2058, 2059, 2060, 2061, 2062, 2063, 2064, 2065, 2066, 2067, 2068, 2069, 2070, 2071, 2072, 2073, 2074, 2075, 2076, 2077, 2078, 2079, 2080, 2081, 2082, 2083, 2084, 2085, 2086, 2087, 2088, 2089, 2090, 2091, 2092, 2093, 2094, 2095, 2096, 2097, 2098, 2099, 2100, 2101, 2102, 2103, 2104, 2105, 2106, 2107, 2108, 2109, 2110, 2111, 2112, 2113, 2114, 2115, 2116, 2117, 2118, 2119, 2120, 2121, 2122, 2123, 2124, 2125, 2126, 2127, 2128, 2129, 2130, 2131, 2132, 2133, 2134, 2135, 2136, 2137, 2138, 2139, 2140, 2141, 2142, 2143, 2144, 2145, 2146, 2147, 2148, 2149, 2150, 2151, 2152, 2153, 2154, 2155, 2156, 2157, 2158, 2159, 2160, 2161, 2162, 2163, 2164, 2165, 2166, 2167, 2168, 2169, 2170, 2171, 2172, 2173, 2174, 2175, 2176, 2177, 2178, 2179, 2180, 2181, 2182, 2183, 2184, 2185, 2186, 2187, 2188, 2189, 2190, 2191, 2192, 2193, 2194, 2195, 2196, 2197, 2198, 2199, 2200, 2201, 2202, 2203, 2204, 2205, 2206, 2207, 2208, 2209, 2210, 2211, 2212, 2213, 2214, 2215, 2216, 2217, 2218, 2219, 2220, 2221, 2222, 2223, 2224, 2225, 2226, 2227, 2228, 2229, 2230, 2231, 2232, 2233, 2234, 2235, 2236, 2237, 2238, 2239, 2240, 2241, 2242, 2243, 2244, 2245, 2246, 2247, 2248, 2249, 2250, 2251, 2252, 2253, 2254, 2255, 2256, 2257, 2258, 2259, 2260, 2261, 2262, 2263, 2264, 2265, 2266, 2267, 2268, 2269, 2270, 2271, 2272, 2273, 2274, 2275, 2276, 2277, 2278, 2279, 2280, 2281, 2282, 2283, 2284, 2285, 2286, 2287, 2288, 2289, 2290, 2291, 2292, 2293, 2294, 2295, 2296, 2297, 2298, 2299, 2300, 2301, 2302, 2303, 2304, 2305, 2306, 2307, 2308, 2309, 2310, 2311, 2312, 2313, 2314, 2315, 2316, 2317, 2318, 2319, 2320, 2321, 2322, 2323, 2324, 2325, 2326, 2327, 2328, 2329, 2330, 2331, 2332, 2333, 2334, 2335, 2336, 2337, 2338, 2339, 2340, 2341, 2342, 2343, 2344, 2345, 2346, 2347, 2348, 2349, 2350, 2351, 2352, 2353, 2354, 2355, 2356, 2357, 2358, 2359, 2360, 2361, 2362, 2363, 2364, 2365, 2366, 2367, 2368, 2369, 2370, 2371, 2372, 2373, 2374, 2375, 2376, 2377, 2378, 2379, 2380, 2381, 2382, 2383, 2384, 2385, 2386, 2387, 2388, 2389, 2390, 2391, 2392, 2393, 2394, 2395, 2396, 2397, 2398, 2399, 2400, 2401, 2402, 2403, 2404, 2405, 2406, 2407, 2408, 2409, 2410, 2411, 2412, 2413, 2414, 2415, 2416, 2417, 2418, 2419, 2420, 2421, 2422, 2423, 2424, 2425, 2426, 2427, 2428, 2429, 2430, 2431, 2432, 2433, 2434, 2435, 2436, 2437, 2438, 2439, 2440, 2441, 2442, 2443, 2444, 2445, 2446, 2447, 2448, 2449, 2450, 2451, 2452, 2453, 2454, 2455, 2456, 2457, 2458, 2459, 2460, 2461, 2462, 2463, 2464, 2465, 2466, 2467, 2468, 2469, 2470, 2471, 2472, 2473, 2474, 2475, 2476, 2477, 2478, 2479, 2480, 2481, 2482, 2483, 2484, 2485, 2486, 2487, 2488, 2489, 2490, 2491, 2492, 2493, 2494, 2495, 2496, 2497, 2498, 2499, 2500, 2501, 2502, 2503, 2504, 2505, 2506, 2507, 2508, 2509, 2510, 2511, 2512, 2513, 2514, 2515, 2516, 2517, 2518, 2519, 2520, 2521, 2522, 2523, 2524, 2525, 2526, 2527, 2528, 2529, 2530, 2531, 2532, 2533, 2534, 2535, 2536, 2537, 2538, 2539, 2540, 2541, 2542, 2543, 2544, 2545, 2546, 2547, 2548, 2549, 2550, 2551, 2552, 2553, 2554, 2555, 2556, 2557, 2558, 2559, 2560, 2561, 2562, 2563, 2564, 2565, 2566, 2567, 2568, 2569, 2570, 2571, 2572, 2573, 2574, 2575, 2576, 2577, 2578, 2579, 2580, 2581, 2582, 2583, 2584, 2585, 2586, 2587, 2588, 2589, 2590, 2591, 2592, 2593, 2594, 2595, 2596, 2597, 2598, 2599, 2600, 2601, 2602, 2603, 2604, 2605, 2606, 2607, 2608, 2609, 2610, 2611, 2612, 2613, 2614, 2615, 2616, 2617, 2618, 2619, 2620, 2621, 2622, 2623, 2624, 2625, 2626, 2627, 2628, 2629, 2630, 2631, 2632, 2633, 2634, 2635, 2636, 2637, 2638, 2639, 2640, 2641, 2642, 2643, 2644, 2645, 2646, 2647, 2648, 2649, 2650, 2651, 2652, 2653, 2654, 2655, 2656, 2657, 2658, 2659, 2660, 2661, 2662, 2663, 2664, 2665, 2666, 2667, 2668, 2669, 2670, 2671, 2672, 2673, 2674, 2675, 2676, 2677, 2678, 2679, 26

150

Supersede Old C-104 and C-105  
Effective 1-1-65

AUTHORIZATION TO \_\_\_\_\_ SIGNATURE \_\_\_\_\_

# Affiliati

65 OCT 11

Eff. 2-1-71,

Pan American Petro. Corp.  
has changed its name to  
AMOCO PROD. CO.

ric Petroleum Corp.

May Life Building, Denver, 2

... which proper box

Row	Row Label	Column Label	Value
1	New Work	Change in Transport Costs	100
2	Transportation	(a)	100
3	Change in Exporting	Cost/Inbound Gain	100

If change of ownership give name  
and address of previous owner

## II. 1. IDENTIFICATION OF WELL AND LEASE

Lease Name	Lease No.	Well No.	State	County
Midcon Gas Co.	1	1	North Dakota	San Juan
Location				
Start Letter	2165	Feet From The	South	1000
End Letter		Feet From The	West	
Line of Section	11	Township	30-N	Range
			12-W	San Juan
				County

### III. DESIGNING AN OIL TRANSPORTER OF OIL AND NATURAL GAS

Name of Authorized Transporter of Oil <input type="checkbox"/> or Condensate <input type="checkbox"/>					Name of Authorized Transporter of Gas <input type="checkbox"/> or Dry Gas <input checked="" type="checkbox"/>	
Plattin, Inc.					Don 100, Farmington, N. M.	
Name of Authorized Transporter of Gashead Gas <input type="checkbox"/> or Dry Gas <input checked="" type="checkbox"/>					Name of Authorized Transporter of Gas <input type="checkbox"/> or Dry Gas <input checked="" type="checkbox"/>	
El Paso Natural Gas Co.					Don 100, Farmington, N. M.	
If well produces oil or liquids, give location of tanks.	Unit	Sec.	Twp.	Range	Is gas being produced? When	
	L	11	30N	12E	No	

If this production is commingled with that from any other lease or pool, give complete order numbers:

#### IV. COMPLETION DATA

Designate Type of Completion - (X)		Oil Well	Gas Well	Water Well	Deepen	Plug Back	Same Res't.	Diff. Res't.
			X	X				
Date Spudded 7-11-65	Date Compl. Ready to Prod. 8-29-65		Total Depth 6901			P.E.T.D. 6865		
Elevations (DF, RKB, RT, GR, etc.) Basin	Name of Producing Formation Dakota		Top XII/Gas Day 5340			Tubing Depth 6765		
Perforations 6810-24; 6791-6802 with 2 shots per foot 6750-70 with 4 shots per foot						Depth Casing Shoe 6901		
TUBING, CASING, AND CEMENTING DATA								
HOLE SIZE	CASING & TUBING SIZE		DEPTH - FEET			SACKS CEMENT		
12-1/4"	6-5/8"		580'			300		
7-7/8"	4-1/2"		6901'			1600		
	2-3/8"		6765'					

## V. TEST DATA AND REQUEST FOR ALLOWABLE OIL WELL

(Test must be after recovery of total volume of load oil and must be equal to or exceed top allowable for this depth or be for full 24 hours)

Date First New Oil Run To Tanks	Date of Test	Producing Method (Flow, pump, gas lift, etc.)	
Length of Test	Tubing Pressure	Casing Pressure	Choke
Actual Prod. During Test	Oil - Bbls.	Water - Bbls.	Gas - MCF

## GAS WELL

Actual Prod. Test-MCF/D	Length of Test	Bbls. Condensate/MMCF	Gravity of Condensate
2500	3 hours	--	--
Testing Method (pitot, back pr.)	Tubing Pressure	Casing Pressure	Choke Size
Back Pn.      120	201	679	3/4"

## VI. CERTIFICATE OF COMPLIANCE

I hereby certify that the rules and regulations of the Oil Conservation Commission have been complied with and that the information given above is true and complete to the best of my knowledge and belief.

(Signature)

W. J. ... five ...

(i) (iic)

9-15-65

(Date)

OIL CONSERVATION COMMISSION

APPROVED ~~DET~~ 6 1965

Y. James E. Hendel

TITLE Supervisor Dist. # 9

This form is to be filed in compliance with RULE 1104.

to this in a frequent manner. If, for a newly drilled or deepened hole, the deviation of the deviation

is less than 0.1%, it is acceptable.

When more than 10%.

It is important to remember that the *in vitro* model used here is not intended to be a completely accurate representation of the *in vivo* situation. The model is intended to be a simplified representation of the *in vivo* situation, and the results should be interpreted with caution. The model is intended to be a simplified representation of the *in vivo* situation, and the results should be interpreted with caution.

Fill out only Sections I, II, III, and VI for changes of owner, with name or number, or transporter, or other such change of condition.

Severing Form C-104 must be filed for each pool in multiple

# MAIN OFFICE

65 OCT 11 AM 7 52

<u>DEPTH</u>	<u>DEVIATION</u>
100'	1/2°
313	1/2
775	1/2
991	1/2
1390	1/2
1799	3/4
1956	1
2359	3/4
2759	3/4
3103	1/4
3430	3/4
3740	1
3891	3/4
4032	1
4212	1
4624	3/4
4700	3/4
4998	1/2
5366	1/4
5695	1
6101	1
6410	1
6748	3/4

THIS IS TO CERTIFY that to the best of my knowledge the above tabulation details the deviation test taken on PAN AMERICAN PETROLEUM CORPORATION'S Chrisman Gas Com. Well No. 1, located 2165 FSL and 1090 FWL, Section 11, T30N, R12W, San Juan Co., New Mexico.

Signed R. H. Beers R. H. Beers  
Title Administrative Assistant

THE STATE OF COLORADO )  
 ) SS.  
COUNTY OF DENVER )

BEFORE ME, the undersigned authority, on this day personally appeared R. H. Beers known to me to be Assistant for Pan American Petroleum Corporation and to be the person whose name is subscribed to the above statement, who, being by me duly sworn on oath, states that he has knowledge of the facts stated herein and that said statement is true and correct.

SUBSCRIBED AND SWORN TO before me, a Notary Public in and for  
said County and State this 21st day of September, 1965.

Brenda L. Goulette  
Notary Public

My Commission Expires 15 Dec 1969

NO. OF COPIES RECEIVED	5
DISTRIBUTION	
SANTA FE	/
FILE	/
U.S.G.S.	/
LAND OFFICE	/
OPERATOR	/

NEW MEXICO OIL CONSERVATION COMMISSION  
WELL COMPLETION OR RECOMPLETION REPORT AND LOG

Form C-105  
Revised 1-1-65

5a. Indicate Type of Lease  
State ☐ Fee ☒  
5. State Oil & Gas Lease No.

1a. TYPE OF WELL  
OIL WELL ☐ GAS WELL ☒ DRY ☐ OTHER ☐  
b. TYPE OF COMPLETION  
NEW WELL ☒ WORK OVER ☐ DEEPEN ☐ PLUG BACK ☐ DIFF. RESVR. ☐ OTHER ☐

7. Unit Agreement Name  
8. Farm or Lease Name  
Chrisman Gas Com.  
9. Well No.

2. Name of Operator  
Pan American Petroleum Corp.  
3. Address of Operator  
Security Life Building, Denver, Colo.  
4. Location of Well

10. Field and Pool, or Wildcat  
Basin Dakota

UNIT LETTER L LOCATED 2165 FEET FROM THE South LINE AND 1090 FEET FROM THE West LINE OF SEC. 11 TWP. 30N RGE. 12W NMPL

12. County  
San Juan

15. Date Spudded 7-27-65	16. Date T.D. Reached 8-18-65	17. Date Compl. (Ready to Prod.) 8-29-65	18. Elevations (DF, RKB, RT, GR, etc.) 5927 (RDB)	19. Elev. Casinghead
20. Total Depth 6901	21. Plug Back T.D. 6865	22. If Multiple Compl., How Many	23. Intervals Drilled By Rotary Tools 0-6901	Cable Tools

24. Producing Interval(s), of this completion - Top, Bottom, Name  
6791-6824 Lower Dakota  
6756-70 Main Dakota  
25. Was Directional Survey Made  
No

26. Type Electric and Other Logs Run  
Gamma Ray Sonic  
27. Was Well Cored  
No

28. CASING RECORD (Report all strings set in well)					
CASING SIZE	WEIGHT LB./FT.	DEPTH SET	HOLE SIZE	CEMENTING RECORD	AMOUNT PULLED
8-5/8"	24#	380'	12-1/4"	300 sacks	None
4-1/2"	10.5#	6901'	7-7/8"	1600 sacks	None

29. LINER RECORD				30. TUBING RECORD		
SIZE	TOP	BOTTOM	SACKS CEMENT	SCREEN	SIZE	DEPTH SET
					2-3/8"	6765

31. Perforation Record (Interval, size and number) 6810-24, 6791-6802 with 2 shots per foot 6756-70 with 45 shots per foot	32. ACID, SHOT, FRACTURE, CEMENT SQUEEZE, ETC.	
	DEPTH INTERVAL	AMOUNT AND KIND MATERIAL USED
	6791-6824	26,628 gals water & 18150# sand
	6756-70	34,440 gals water & 30,000# sand

33. PRODUCTION  
Date First Production \_\_\_\_\_ Production Method (Flowing, gas lift, pumping - Size and type pump) \_\_\_\_\_ Well Status (Prod. or Shut-in) \_\_\_\_\_  
Flow  
Shut In  
Date of Test \_\_\_\_\_ Hours Tested \_\_\_\_\_ Choke Size \_\_\_\_\_ Prod'n. For Test Period \_\_\_\_\_ Oil - Bbl. \_\_\_\_\_ Gas - MCF \_\_\_\_\_ Water - Bbl. \_\_\_\_\_ Gas - Oil Ratio \_\_\_\_\_  
Flow Tubing Press. \_\_\_\_\_ Casing Pressure \_\_\_\_\_ Calculated 24-Hour Rate \_\_\_\_\_ Oil - Bbl. \_\_\_\_\_ Gas - MCF \_\_\_\_\_ Water - Bbl. \_\_\_\_\_ Oil - Gravity (API, Corr.) \_\_\_\_\_

34. Disposition of Gas (Sold, used for fuel, vented, etc.)  
To be sold to El Paso Natural Gas Co.  
Test Witness \_\_\_\_\_

35. List of Attachments  
None

36. I hereby certify that the information shown on both sides of this form is true and complete to the best of my knowledge and belief.

SIGNED R. H. Beers R. H. Beers TITLE Administrative Assistant DATE 9/15/65

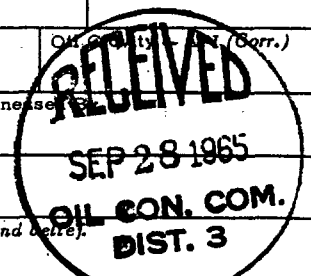

# INSTRUCTIONS

This form is to be filed with the appropriate District Office of the Commission not later than 20 days after the completion of any newly-drilled or deepened well. It shall be accompanied by one copy of all electrical and radio-activity logs run on the well and a summary of all special tests conducted, including drill stem tests. All depths reported shall be measured depths. In the case of directionally drilled wells, true vertical depths shall also be reported. For multiple completions, Items 30 through 34 shall be reported for each zone. The form is to be filed in quintuplicate except on state land, where six copies are required. See Rule 1105.

## INDICATE FORMATION TOPS IN CONFORMANCE WITH GEOGRAPHICAL SECTION OF STATE

### Southeastern New Mexico

### Northwestern New Mexico

T. Anhy	T. Canyon	T. Ojo Alamo	T. Penn. "B"
T. Salt	T. Strawn	T. Kirtland-Fruitland	T. Penn. "C"
B. Salt	T. Atoka	T. Pictured Cliffs	T. Penn. "D"
T. Yates	T. Miss	T. Cliff House	T. Leadville
T. 7 Rivers	T. Devonian	T. Menefee	T. Madison
T. Queen	T. Silurian	T. Point Lookout	T. Elbert
T. Grayburg	T. Montoya	T. Mancos	T. McCracken
T. San Andres	T. Simpson	T. Gallup	T. Ignacio Qtzte
T. Glorieta	T. McKee	Base Greenhorn	T. Granite
T. Paddock	T. Ellenburger	T. Dakota	T.
T. Blinebry	T. Gr. Wash	T. Morrison	T.
T. Tubb	T. Granite	T. Todilto	T.
T. Drinkard	T. Delaware Sand	T. Entrada	T.
T. Abo	T. Bone Springs	T. Wingate	T.
T. Wolfcamp	T.	T. Chinle	T.
T. Penn.	T.	T. Permian	T.
T. Cisco (Bough C)	T.	T. Penn. "A"	T.

## FORMATION RECORD (Attach additional sheets if necessary)

From	To	Thickness in Feet	Formation	From	To	Thickness in Feet	Formation
Log	Top						
	2205		Pictured Cliffs				Perforated Lower Dakota 6810-24, 6791-6802
	2380		Lewis Shale				with 2 shots per foot. Fracked with 26.628
	3908		Mesa Verde				gallons water containing 0.8% potassium
	4886		Mancos				chloride, 2-1/2 pounds FR-2 per 1000 gallons.
	5845		Gallup				Breakdown pressure 3000 psi. Average treatin
	6120		Base Gallup				pressure 3500 psi, average injection rate
	6580		Green Horn				38 BPM.
	6641		Graneros Shale				
	6698		Graneros Dakota				Perforated Main Dakota 6756-70 with 4 shots
	6741		Main Dakota				per foot. Fracked with 34.440 gallons water
							treated as above and 30,000 pounds sand.
							Breakdown pressure 2700 psi. Average treatin
							pressure 3500 psi. Average injection rate
							39 BPM.

NO. OF COPIES RECEIVED	
DISTRIBUTION	
SANTA FE	1
FILE	1
U.S.G.S.	
LAND OFFICE	
OPERATOR	2

# NEW MEXICO OIL CONSERVATION COMMISSION

Form C-103  
Supersedes Old  
C-102 and C-103  
Effective 1-1-65

MAILED  
65 OCT 12 AM 7 55

5a. Indicate Type of Lease

State ☐

Fee ☒

5. State Oil & Gas Lease No.

## SUNDRY NOTICES AND REPORTS ON WELLS

(DO NOT USE THIS FORM FOR PROPOSALS TO DRILL OR TO DEEPEN OR PLUG BACK TO A DIFFERENT RESERVOIR.  
USE "APPLICATION FOR PERMIT -" (FORM C-101) FOR SUCH PROPOSALS.)

1. OIL WELL <input type="checkbox"/> GAS WELL <input checked="" type="checkbox"/> OTHER- <input type="checkbox"/>	7. Unit Agreement Name
2. Name of Operator Pan American Petroleum Corporation	8. Farm or Lease Name Chrisman Gas Com
3. Address of Operator Security Life Building, Denver, Colorado	9. Well No. 1
4. Location of Well UNIT LETTER <u>L</u> <u>2165</u> FEET FROM THE <u>South</u> LINE AND <u>1090</u> FEET FROM THE <u>West</u> LINE, SECTION <u>11</u> TOWNSHIP <u>30-N</u> RANGE <u>12-W</u> NMPM.	10. Field and Pool, or Wildcat Basin Dakota
15. Elevation (Show whether DF, RT, GR, etc.) 5927 (RDB)	12. County San Juan

16. Check Appropriate Box To Indicate Nature of Notice, Report or Other Data  
NOTICE OF INTENTION TO: SUBSEQUENT REPORT OF:

PERFORM REMEDIAL WORK ☐  
TEMPORARILY ABANDON ☐  
PULL OR ALTER CASING ☐

PLUG AND ABANDON ☐  
CHANGE PLANS ☐

REMEDIAL WORK ☐  
COMMENCE DRILLING OPNS. ☐  
CASING TEST AND CEMENT JOBS ☐  
OTHER Casing Setting ☒

ALTERING CASING ☐  
PLUG AND ABANDONMENT ☐

17. Describe Proposed or Completed Operations (Clearly state all pertinent details, and give pertinent dates, including estimated date of starting any proposed work) SEE RULE 1103.

Well was spudded on 7-27-65. 8-5/8" casing set at 380' with 300 sacks with 2% calcium chloride. Cement circulated. Tested with 800 psi; OK.

Well drilled to total depth of 6901'. 4-1/2" casing set at 6901 with stage collar set at 4940. Cemented first stage with 400 sacks with 6% gel, 2 pounds tuf plug per sack followed by 100 sack neat. Cemented second stage with 1000 sacks with 6% gel, 2 pounds tuf plug per sack followed by 100 sack neat cement. Tested with 3500 psi, OK.

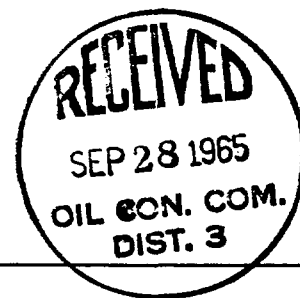

18. I hereby certify that the information above is true and complete to the best of my knowledge and belief.

SIGNED R. H. Beers R. H. Beers TITLE Administrative Assistant

DATE 9-15-65

APPROVED BY Emmy C. Covel

TITLE Supervisor Dist. # 3

DATE SEP 28 1965

CONDITIONS OF APPROVAL, IF ANY:

OIL CONSERVATION COMMISSION

BOX 697

120 EAST CHACO

AZTEC, NEW MEXICO

MAIN OFFICE

NOV 17 7 55 AM '65

NOTICE OF GAS CONNECTION

DATE November 15, 1965

THIS IS TO NOTIFY THE OIL CONSERVATION COMMISSION THAT CONNECTION FOR THE PURCHASE OF GAS FROM

THE Pan American Petroleum Corporation  
OPERATOR

Christman Gas Com. #1  
LEASE

"1"  
WELL UNIT

11-30-12  
S-T-R

Basin Dakota  
POOL

El Paso Natural Gas Company  
NAME OF PURCHASER

WAS MADE ON November 10, 1965 , FIRST DELIVERY November 11, 1965  
DATE DATE

Choke 2,500  
ACF 2,777  
INITIAL POTENTIAL

El Paso Natural Gas Company  
PURCHASER

Original Signed By W. M. Rodgers

REPRESENTATIVE

Chief Dispatcher  
TITLE

CC: TO OPERATOR Denver and Farmington  
OIL CONSERVATION COMMISSION - SANTA FE  
F. N. WOODRUFF - EL PASO  
B. D. ADAMS---

FILE

11-27-65

NO. OF COPIES RECEIVED	3
DISTRIBUTION	
SANTA FE	1
FILE	1
U.S.G.S.	2
LAND OFFICE	
OPERATOR	1

# NEW MEXICO OIL CONSERVATION COMMISSION

MAIN OFFICE 000

Form C-101  
Revised 1-1-65

5A. Indicate Type of Lease  
STATE ☐ FEE ☒  
5. State Oil & Gas Lease No.

## APPLICATION FOR PERMIT TO DRILL, DEEPEN, OR PLUG BACK

1a. Type of Work b. Type of Well OIL WELL <input type="checkbox"/> GAS WELL <input checked="" type="checkbox"/> OTHER <input type="checkbox"/> SINGLE ZONE <input checked="" type="checkbox"/> MULTIPLE ZONE <input type="checkbox"/>		7. Unit Agreement Name	
2. Name of Operator PAN AMERICAN PETROLEUM CORPORATION		8. Farm or Lease Name Chrisman Gas Com	
3. Address of Operator P. O. Box 480, Farmington, New Mexico		9. Well No. 1	
4. Location of Well UNIT LETTER <u>N</u> LOCATED <u>2165</u> FEET FROM THE <u>South</u> LINE AND <u>1090</u> FEET FROM THE <u>West</u> LINE OF SEC. <u>11</u> TWP. <u>30-N</u> RGE. <u>12-W</u> NMPM		10. Field and Pool, or Wildcat Basin Dakota	
		12. County San Juan	
		19. Proposed Depth 6700	19A. Formation Dakota
		20. Rotary or C.T. Rotary	
21. Elevations (Show whether DF, RT, etc.) Report Later	21A. Kind & Status Plug. Bond Statewide	21B. Drilling Contractor Brinkerhoff SCM	22. Approx. Date Work will start 7-24-65

23.

## PROPOSED CASING AND CEMENT PROGRAM

SIZE OF HOLE	SIZE OF CASING	WEIGHT PER FOOT	SETTING DEPTH	SACKS OF CEMENT	EST. TOP
12-1/4"	8-5/8"	24#	350	250	Surface
7-7/8"	4-1/2"	10.5#	6700	1500*	Surface*

\*Stage-cementing tool at base of Mesaverde.

Copies of location plat attached.

Copies of any logs run will be furnished upon completion of well.



Verbally approved 7-22-65, A. R. Kendrick to F. H. Hollingsworth.

IN ABOVE SPACE DESCRIBE PROPOSED PROGRAM: IF PROPOSAL IS TO DEEPEN OR PLUG BACK, GIVE DATA ON PRESENT PRODUCTIVE ZONE AND PROPOSED NEW PRODUCTIVE ZONE. GIVE BLOWOUT PREVENTER PROGRAM, IF ANY.

I hereby certify that the information above is true and complete to the best of my knowledge and belief.

Fred L. Nabors, District Engineer

Signed F. H. Hollingsworth Title District Engineer Date July 22, 1965

(This space for State Use)

APPROVED BY Ernest Howard TITLE Sup. Dist. Eng. DATE 7-26-65

CONDITIONS OF APPROVAL, IF ANY:



Well Location and Acreage Dedication Plat

Section A.

Date JULY 22, 1965

Operator PAN AMERICAN PETROLEUM CORPORATION Lease CHRISMAN GAS COM  
 Well No. 1 Unit Letter L Section 11 Township 30 NORTH Range 12 WEST NMPM  
 Located 2165 Feet From the SOUTH Line, 1090 Feet From the WEST Line  
 County SAN JUAN G. L. Elevation REPORT LATER Dedicated Acreage 320 Acres  
 Name of Producing Formation DAKOTA Pool BASIN DAKOTA

1. Is the Operator the only owner in the dedicated acreage outlined on the plat below?

Yes X No \_\_\_\_\_

2. If the answer to question one is "no", have the interests of all the owners been consolidated by communitization agreement or otherwise? Yes \_\_\_\_\_ No \_\_\_\_\_. If answer is "yes", Type of Consolidation.

3. If the answer to question two is "no", list all the owners and their respective interests below:

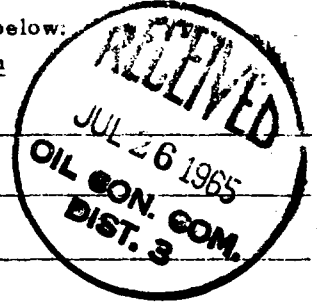
OwnerLand Description

Section B.

Note: All distances must be from outer boundaries of section.

This is to certify that the information in Section A above is true and complete to the best of my knowledge and belief.

PAN AMERICAN PETROLEUM CORP.

(Operator)

P. H. Hollingsworth

(Representative)

P. O. Box 480

(Address)

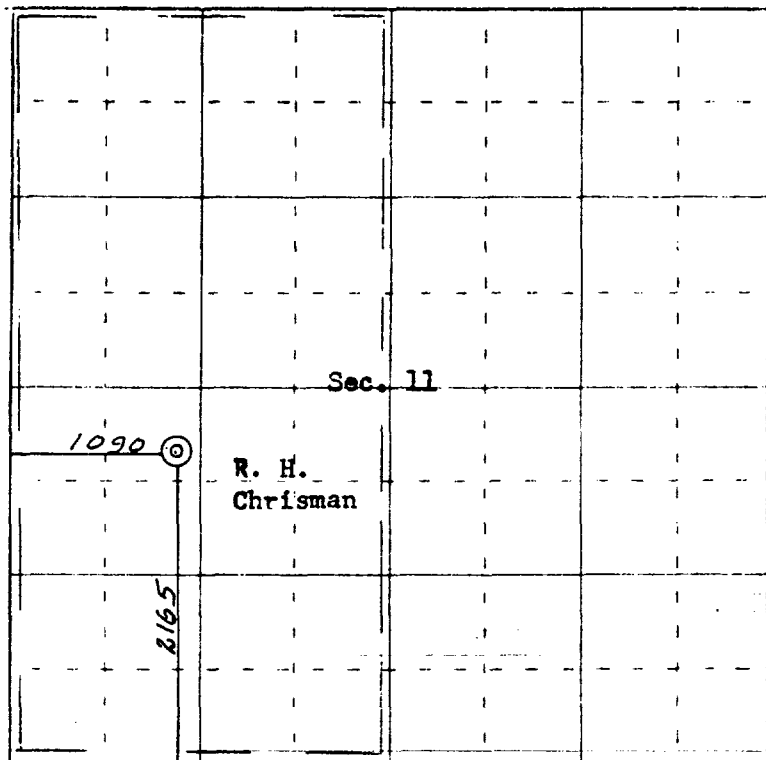
Farmington, New Mexico

Ref: GLO plat dated April 7, 1881.

0 330 660 990 1320 1650 1980 2310 2640 2000 1500 1000 500 0

Scale 4 inches equal 1 mile

This is to certify that the above plat was prepared from field notes of actual surveys made by me or under my supervision and that the same are true and correct to the best of my knowledge and belief.

Date Surveyed July 21, 1965

James P. Leese  
 Registered Professional Engineer and/or Land Surveyor  
 James P. Leese, N.Mex. Reg. No. 1463  
 San Juan Engineering Company.



CMD :  
OG5SECT

ONGARD  
INQUIRE LAND BY SECTION

11/27/00 13:42:33  
OGOMES -TPLF  
PAGE NO: 1

Sec : 11 Twp : 30N Rng : 12W Section Type : NORMAL

4 39.88  Federal owned A A	3 39.86  Federal owned	2 39.42  Federal owned A	1 39.66  Federal owned
5 39.55  Federal owned	6 39.53  Federal owned	7 39.28  Federal owned	8 39.52  Federal owned

PF01 HELP	PF02	PF03 EXIT	PF04 GoTo	PF05	PF06
PF07 BKWD	PF08 FWD	PF09 PRINT	PF10 SDIV	PF11	PF12

CMD :  
OG5SECTONGARD  
INQUIRE LAND BY SECTION11/27/00 13:42:40  
OGOMES -TPLH  
PAGE NO: 2

Sec : 11 Twp : 30N Rng : 12W Section Type : NORMAL

L 40.00	K 40.00	10 39.68	9 39.55
Fee owned A A	Fee owned	Federal owned A	Federal owned
M 40.00	N 40.00	O 40.00	P 40.00
Fee owned	Fee owned	Fee owned	Fee owned

PF01 HELP  
PF07 BKWDPF02  
PF08 FWDPF03 EXIT  
PF09 PRINTPF04 GoTo  
PF10 SDIVPF05  
PF11PF06  
PF12

39.68  
39.55  
3

CMD : ONGARD 11/27/00 13:42:57  
OG6IWCM INQUIRE WELL COMPLETIONS OGOMES -TPLF

API Well No : 30 45 9680 Eff Date : 01-01-1998 WC Status : A  
Pool Idn : 71599 BASIN DAKOTA (PRORATED GAS)  
OGRID Idn : 167067 CROSS TIMBERS OPERATING COMPANY  
Prop Idn : 22672 CHRISMAN GAS COM

Well No : 001  
GL Elevation: 5927

	U/L	Sec	Township	Range	North/South	East/West	Prop/Act (P/A)
	---	---	-----	-----	-----	-----	-----
B.H. Locn	: L	11	30N	12W	FTG 2165 F S	FTG 1090 F W	P

Lot Identifier:

Dedicated Acre: 320.00

Lease Type : P

Type of consolidation (Comm, Unit, Forced Pooling - C/U/F/O) :

M0025: Enter PF keys to scroll

PF01 HELP	PF02	PF03 EXIT	PF04 GoTo	PF05	PF06
PF07	PF08	PF09	PF10 NEXT-WC	PF11 HISTORY	PF12 NXTREC