

110936570

NSL

5/8/01

ELK OIL COMPANY

JOSEPH J. KELLY
PRESIDENT

BOX 310
ROSWELL, NEW MEXICO 88202
(505) 623-3190
April 16, 2001

Oil Conservation Division
1220 South St. Francis Drive
Santa Fe, New Mexico 87505

Attention: Michael Stogner

Re: Hi-Way State #1
2417' FSL; 2245' FEL
Section 36-T10S-R27E
Chaves County, New Mexico

Gentlemen:

Elk Oil Company respectfully requests administration approval for the unorthodox gas well location of our Hi-Way State #1 well as referenced above.

Elk is re-entering said well, plugging back to 6300' to test the Penn and Wolfcamp formations for gas.

Elk is requesting offset mineral owners to approve said unorthodox location. All offset mineral owners are exactly the same as to ownership. Elk will forward all waivers.

Elk is enclosing the following information:

- 1) State Forms C-101 and C-102
- 2) Correspondence from Primero Operating Company
- 3) Lease map outlining offset mineral owners
- 4) Plugged well report, State Form C-105 Primero Operating Co.

Please approve our request for an unorthodox location.

Yours very truly,
ELK OIL COMPANY

Joseph J. Kelly
President

JJK/jgb
Enc.

*5-7-01
Joe - is
filing waivers*

District I
1625 N. French Dr., Hobbs, NM 88240

District II
811 South First, Artesia, NM 88210

District III
1000 Rio Brazos Rd., Aztec, NM 87410

District IV
2040 South Pacheco, Santa Fe, NM 87505

State of New Mexico
Energy, Minerals & Natural Resources

OIL CONSERVATION DIVISION
2040 South Pacheco
Santa Fe, NM 87505

Form C-102
Revised March 17, 1999

Submit to Appropriate District Office
State Lease - 4 Copies
Fee Lease - 3 Copies

☐ AMENDED REPORT

WELL LOCATION AND ACREAGE DEDICATION PLAT

¹ API Number 30-005-63021	² Pool Code	³ Pool Name
⁴ Property Code	⁵ Property Name Hi-Way State	⁶ Well Number 1
⁷ OGRID No. 7147	⁸ Operator Name ELK OIL COMPANY	⁹ Elevation 3698'

¹⁰ Surface Location



UL or lot no.	Section	Township	Range	Lot Idn	Feet from the	North/South line	Feet from the	East/West line	County
J	36	10S	27E		2417	South	2245	East	Chaves

¹¹ Bottom Hole Location If Different From Surface

UL or lot no.	Section	Township	Range	Lot Idn	Feet from the	North/South line	Feet from the	East/West line	County

¹² Dedicated Acres 320	¹³ Joint or Infill	¹⁴ Consolidation Code	¹⁵ Order No.
--------------------------------------	-------------------------------	----------------------------------	-------------------------

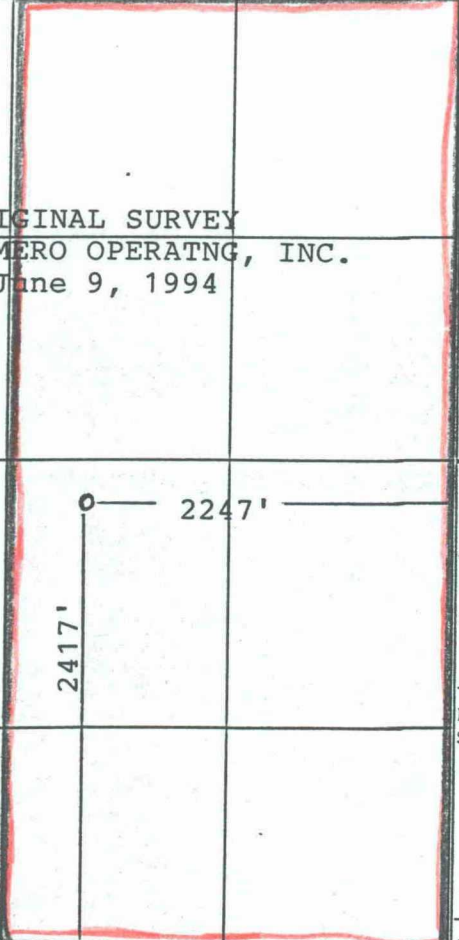
NO ALLOWABLE WILL BE ASSIGNED TO THIS COMPLETION UNTIL ALL INTERESTS HAVE BEEN CONSOLIDATED OR A NON-STANDARD UNIT HAS BEEN APPROVED BY THE DIVISION

16	SEE ORIGINAL SURVEY BY PRIMERO OPERATING, INC. DATED June 9, 1994		¹⁷ OPERATOR CERTIFICATION I hereby certify that the information contained herein is true and complete to the best of my knowledge and belief ELK OIL COMPANY Signature  Printed Name Joseph J. Kelly Title President Date March 23, 2001
			¹⁸ SURVEYOR CERTIFICATION I hereby certify that the well location shown on this plat was plotted from field notes of actual surveys made by me or under my supervision, and that the same is true and correct to the best of my belief. Date of Survey Signature and Seal of Professional Surveyer:
			Certificate Number

District I

1625 N. French Drive, Hobbs, NM 88240

District II

811 S. First Street, Artesia, NM 88210

District III

1000 Rio Brazos Rd, Artesia, NM 87410

District IV

2040 South Pacheco, Santa Fe, NM 87505

State of New Mexico

Energy, Minerals & Natural Resources Department

Form C-101

Revised March 17, 1999

Instructions On Back

OIL CONSERVATION DIVISION

2040 South Pacheco
Santa Fe, NM 87504-2088

Submit to Appropriate District Office

State Lease - 6 Copies

Fee Lease - 5 Copies

AMENDED REPORT

APPLICATION FOR PERMIT TO DRILL, RE-ENTER, DEEPEN, PLUGBACK, OR ADD A ZONE

1 Operator Name and Address ELK OIL COMPANY P.O. BOX 310 ROSWELL, NEW MEXICO 88202-0310		2 OGRID Number 7147
		3 API Number 30-005-63021
4 Property Code	5 Property Name Hi-Way State	6 Well No. 1

7 Surface Location

UL or Lot No.	Section	Township	Range	Lot Idn	Feet from the	North/South Line	Feet from the	East/West Line	County
J	36	10S	27E		2417	SOUTH	2245	EAST	CHAVES

8 Proposed Bottom Hole Location If Different From Surface

UL or Lot No.	Section	Township	Range	Lot Idn	Feet from the	North/South Line	Feet from the	East/West Line	County
9 Proposed Pool 1					10 Proposed Pool 2				

11 Work Type Code E	12 Well Type Code G	13 Cable/Rotary R	14 Lease Type Code S	15 Ground Level Elevation 3698'
16 Multiple NO	17 Proposed Depth 6300	18 Formation PENN	19 Contractor N/A	20 Spud Date 4/15/01

21 Proposed Casing and Cement Program

Hole Size	Casing Size	Casing weight/foot	Setting Depth	Sacks of Cement	Estimated TOC
17 1/4	13 3/8	48#	338'	400 SXS	CIRCULATE
12 3/4	8 5/8	24#	1557'	650 SXS	CIRCULATE
7 7/8	5 1/2	15.5#	6300'	500 SXS	4500'

22. Describe the proposed program. If this application is to DEEPEN or PLUG BACK give the data on the present productive zone and proposed new productive zone.
Describe the blowout prevention program, if any. Use additional sheets if necessary.

- (1) PROPOSE TO RE-ENTER WELL, CLEAN OUT, RUN 5 1/2" CASING TO 6300'.
(2) PERFORATE, ACIDIZE AND PRODUCTION TEST.

STANDARD BOP.

23 I hereby certify that the information given above is true and complete to the best of my knowledge and belief.

Signature:

ELK OIL COMPANY

Printed name:

JOSEPH J. KELLY

Title:

PRESIDENT

Date:

3/23/01

Phone:

505-623-3190

OIL CONSERVATION DIVISION

Approved By:

Title:

Approval Date:

Expiration Date:

Conditions of Approval:

Attached

STATE OF NEW MEXICO
ENERGY, MINERALS AND NATURAL RESOURCES DEPARTMENT
OIL CONSERVATION DIVISION

JUL 8 1994

IN THE MATTER OF THE APPLICATION OF
PRIMERO OPERATING, INC. FOR APPROVAL
OF AN UNORTHODOX OIL WELL LOCATION,
CHAVES COUNTY, NEW MEXICO

CASE: _____

APPLICATION

Comes now PRIMERO OPERATING, INC., by and through its attorneys, KELLAHIN and KELLAHIN, and applies to the New Mexico Oil Conservation Division for approval of an unorthodox oil well location for its Hi-Way State Well No. 1 which currently is being drilled at an unorthodox oil well location 2417 feet FSL and 2245 feet FEL (Unit J) Section 36 Township 10 South, Range 27 East, NMPM, Chaves County, New Mexico for possible production from the Devonian formation and to be dedicated to a standard 40 acre oil spacing unit consisting of the NW/4SE/4 of said Section 36.

In support thereof, Applicant states:

1. Applicant, Primero Operating, Inc. has 100% of the working interest in all of Section 36, T10S, R27E, N.M.P.M, Chaves County, New Mexico which constitutes a single State of New Mexico Oil & Gas Lease.

2. Due to the July 1, 1994 expiration of this lease. Primero Operating Inc. has commenced drilling of its Hi-Way State Well No. 1 at an unorthodox oil well location for possible production from the Devonian formation 2417 feet FSL and 2245 feet FEL (Unit J) Section 36,

3. It is crucial to locate any Devonian test on the absolute highest point on structure.

Primero Operating, Inc.
NMOCD Application
Page 3

4. The unorthodox well location is based upon a 3-D seismic survey which indicates that the optimum location for a well in Unit J is at a location that is 223' feet from the north boundary of its spacing unit rather than the standard 330 feet. See Exhibit "A"

5. The well is located more than one mile from the current boundaries of any Devonian Oil pool and is subject to the Division general statewide rules including well spacing of 40-acre oil spacing and 330 foot setbacks. Apparently, the closest Devonian oil pool is the Race Track-Devonian Pool located in the NE/4SE/4 of Section 13, T10S, R27E, NMPM.

6. The well only encroaches towards the SW/4NE/4 of Section 36 which has the same ownership as the subject 40-acre spacing unit.

7. Approval of the application will afford the applicant the opportunity to produce its just and equitable share of the hydrocarbons in this portion of the Devonian formation and will otherwise prevent waste and protect correlative rights.

8. In accordance with Division Rule 1207, there are no offsetting parties to whom notification is required.

WHEREFORE, Applicant requests that, after notice and hearing, this Application be approved as requested.

KELLAHIN and KELLAHIN



BY

W. Thomas Kellahin

P. O. Box 2265

Santa Fe, New Mexico 87504

(505) 982-4285

Submit to Appropriate
 District Office
 State Lease - 4 copies
 Fee Lease - 3 copies

State of New Mexico
 Geology, Mineral and Natural Resources Department

Form G-103
 Revised 1-1-89

OIL CONSERVATION DIVISION

P.O. Box 2083
 Santa Fe, New Mexico 87504-2083

ILLEGIBLE

DISTRICT I

P.O. Box 1990, Albuquerque, NM 87106

DISTRICT II

P.O. Drawer DD, Artesia, NM 88210

DISTRICT III

1000 Rio Brazos Rd., Aztec, NM 87410

WELL LOCATION AND ACREAGE DEDICATION PLAN

All Distances must be from the outer boundaries of the section

Operator Primero Operating		Highway State		Well No.	
Well Letter J	Section 36	Township 10 South	Range 27 East	County Albany	State NM
Nearest Package Location of Well: 2417 feet from the South end and 2245 feet from the East end					
Ground Level Elev. 3698		Producing Formation Devonian		Drill Bit Wildcat	
				Drill Bit Average 40 Acres	

- Outline the acreage dedicated to the subject well by colored pencil or fountain pen on the plan below.
- If more than one lease is dedicated to the well, outline each and identify the ownership thereof. (Such as to working interest and royalty).
- If more than one lease of different ownership is dedicated to the well, have the owner of all interest with consideration by appropriate certification, force-pooling, and:

☐ Yes
☐ No

 If answer is "Yes" type of consolidation:

If answer is "No" list the parties and what description of lease have actually been consolidated. Also reverse side of this form if necessary.

No allowances will be assigned to the well until all interests have been consolidated by appropriate certification, force-pooling, or otherwise, or until a pool standard and all necessary lease assignments have been submitted by the Operator.

Exhibit "A"

2417

OPERATOR CERTIFICATION

I hereby certify that the information contained herein is true and complete to the best of my knowledge and belief.

Signature _____

Printed Name _____

Position _____

Company _____

Date _____

SURVEYOR CERTIFICATION

I hereby certify that the well location on this plan was plotted from field notes, aerial surveys made by me or under supervision, and that the same is true correct to the best of my knowledge and belief.

Date Surveyed _____

Signature _____

Printed Name _____

Professional Surveyor _____

STATE OF NEW MEXICO

PROFESSIONAL SURVEYOR

2001

2002

2003

2004

2005

2006

2007

2008

2009

2010

2011

2012

2013

2014

2015

2016

2017

2018

2019

2020

2021

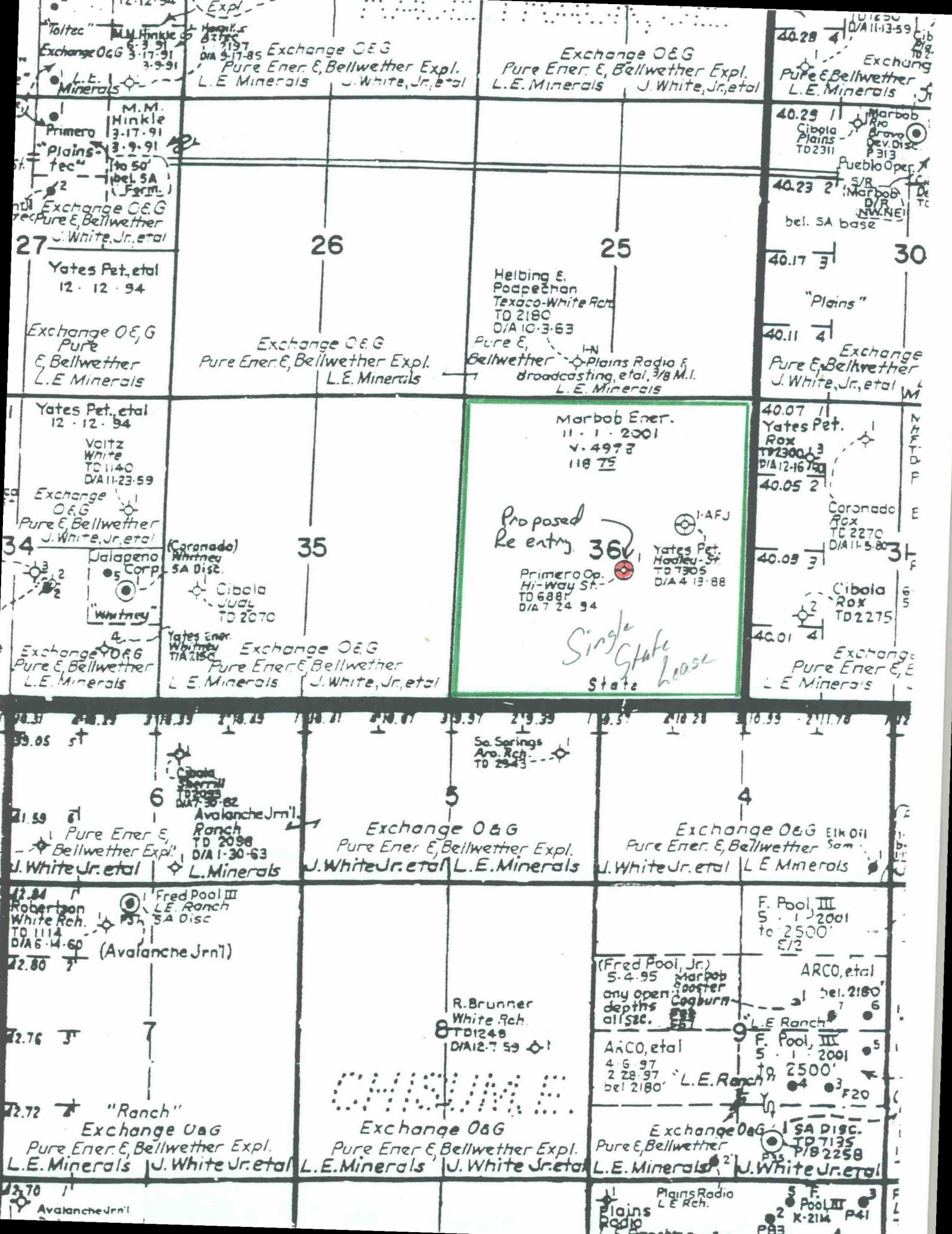

NO. OF COPIES RECEIVED	
DISTRIBUTION	
SANTA FE	
FILE	
U.S.G.S.	
LAND OFFICE	
OPERATOR	

Form C-105
Revised 11-8

NEW MEXICO OIL CONSERVATION COMMISSION WELL COMPLETION OR RECOMPLETION REPORT AND LOG

52. Initial Type of Lease	State <input checked="" type="checkbox"/>	Fee <input type="checkbox"/>
5. State Oil & Gas Lease No.	V-3008	

1. TYPE OF WELL				7. Unit Agreement Name			
OIL WELL <input type="checkbox"/> GAS WELL <input type="checkbox"/> DRY <input checked="" type="checkbox"/> OTHER <input type="checkbox"/>				8. Name of Lease Name			
2. TYPE OF COMPLETION				HI-WAY STATE			
NEW WELL <input type="checkbox"/> WORK OVER <input type="checkbox"/> DEEPEN <input type="checkbox"/> PLUG BACK <input type="checkbox"/> DIFF. RESVR. <input type="checkbox"/> OTHER <input type="checkbox"/>				9. Well No.			
2. Name of Operator				10. Field and Pool, or Wildcat			
Primero Operating, Inc.				-W/C- Devonian			
3. Address of Operator				11. County			
P. O. Box 1433, Roswell, NM 88202-1433				Chaves			
4. Location of Well				12. County			
UNIT LETTER <u>J</u> LOCATED <u>2417</u> FEET FROM THE <u>South</u> LINE AND <u>2245</u> FEET FROM				Chaves			
THE <u>East</u> LINE OF SEC. <u>36</u> TWP. <u>10-S</u> RGE. <u>27-E</u> NMPM				13. County			
15. Date Spudded		16. Date T.D. Reached		17. Date Compl. (Ready to Prod.)		18. Elevations (DF, RAB, RT, GR, etc.)	
06/30/94		07/24/94		N/A		3698 GR	
20. Total Depth		21. Plug Back T.D.		22. If Multiple Compl., How Many		23. Intervals Drilled By	
6881'		0		N/A		Rotary Tools 6881'	
24. Producing Interval(s), of this completion - Top, Bottom, Name							25. Was Directional Survey Made
None							Yes
26. Type Electric and Other Logs Run							27. Was Well Cased
CNL-LDT, DLL-MSFL							No
28. CASING RECORD (Report all strings set in well)							
CASING SIZE	WEIGHT LB./FT.	DEPTH SET	HOLE SIZE	CEMENTING RECORD		AMOUNT PULLED	
13-3/8		338	17 1/2	400 sx "C"			
8-5/8	24#	1557	12 1/4	450 sx Lite, 200 sx "C"			
29. LINER RECORD							
SIZE	TOP	BOTTOM	SACKS CEMENT	SCREEN	SIZE	DEPTH SET	PACKER SET
31. Perforation Record (Interval, size and number)				32. ACID, SHOT, FRACTURE, CEMENT SQUEEZE, ETC.			
				DEPTH INTERVAL AMOUNT AND KIND MATERIAL USED			
33. PRODUCTION							
Date First Production		Production Method (Flowing, gas lift, pumping - Size and type pump)				Well Status (Prod. or Shut-in)	
Date of Test	Hours Tested	Choke Size	Prod'n. For Test Period	Oil - Bbl.	Gas - MCF	Water - Bbl.	Gas - Oil Ratio
Flow Tubing Press.	Casing Pressure	Calculated 24-Hour Rate	Oil - Bbl.	Gas - MCF	Water - Bbl.	Oil Gravity - API (Corr.)	
34. Disposition of Gas (Sold, used for fuel, vented, etc.)						Test Witnessed By	
35. List of Attachments							

36. I hereby certify that the information shown on both sides of this form is true and complete to the best of my knowledge and belief.

SIGNED

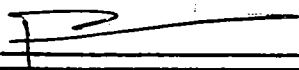

TITLE President

DATE 7/25/94

This form is to be filed with the appropriate District Office of the Commission not later than 20 days after the completion of any newly-drilled or deepened well. It shall be accompanied by one copy of all electrical and radioactivity logs on the well and a summary of all special tests conducted, including drill stem tests. All depths reported shall be measured in ft. In the case of directionally drilled wells, true vertical depths shall also be reported. For multiple completions, Items 30 through 34 shall be reported for each zone. The form is to be filed in quintuplicate except on state land, where six copies are required. See Rule 1165.

Southeastern New Mexico

T. Anhy _____	T. Canyon _____
T. Salt _____	T. Strawn _____
B. Salt _____	T. Atoka _____
T. Yates 346	T. Miss 6660
T. 7 Rivers _____	T. Devonian 6798
T. Queen 826	T. Silurian _____
T. Grayburg _____	T. Montoya _____
T. San Andres 1529	T. Simpson _____
T. Glorieta _____	T. McKee _____
T. Paddock _____	T. Ellenburger _____
T. Blinbry _____	T. Gr. Wash _____
T. Tubb _____	T. Granite _____
T. Drinkard _____	T. Delaware Sand _____
T. Abo 4986	T. Bone Springs _____
T. Wolfcamp 5832	T. _____
T. Penn. 6300	T. _____
T. Cisco (Bough C) _____	T. _____

T. Ojo Alamo _____	T. Penn. "B" _____
T. Kirtland-Fruitland _____	T. Penn. "C" _____
T. Pictured Cliffs _____	T. Penn. "D" _____
T. Cliff House _____	T. Leadville _____
T. Menefee _____	T. Madison _____
T. Point Lookout _____	T. Elbert _____
T. Mancos _____	T. McCracken _____
T. Gallup _____	T. Ignacio Qizte _____
Base Greenhorn _____	T. Granite _____
T. Dakota _____	T. _____
T. Morrison _____	T. _____
T. Todilto _____	T. _____
T. Entrada _____	T. _____
T. Wingate _____	T. _____
T. Chinle _____	T. _____
T. Permian _____	T. _____
T. Penn. "A" _____	T. _____

No. 1, from _____ to _____ No. 4, from _____ to _____
No. 2, from _____ to _____ No. 5, from _____ to _____
No. 3, from _____ to _____ No. 6, from _____ to _____

Include data on rate of water inflow and elevation to which water rose in hole.

No. 1, from _____ to _____ feet _____

No. 2, from _____ to _____ feet _____

No. 3, from _____ to _____ feet _____

No. 4, from _____ to _____ feet _____

From	To	Thickness in Feet	Formation	From	To	Thickness in Feet	Formation

To	MICHAEL STOGNER	No. of Pages	7	Today's Date	5/07/01	Time	
Company	OIL CONSERVATION DIVISION	From	JOSEPH J. KELLY				
Location	SANTA FE, NM	Company	ELK OIL COMPANY				
Fax #	505-476-3462	Location	ROSWELL, NM	Dept. Charge			
Telephone #		Fax #	505-623-5001	Telephone #	505-623-3190		
Comments	DEAR MICHAEL: AS PER OUR TELEPHONE CONVERSATION PLEASE FIND WAIVERS FOR OFFSET MINERAL OWNERS REGARDING THE UNORTHODOX LOCATION FOR THE HI-WAY STATE #1 WELL. HARD COPIES TO FOLLOW IN MAIL. THANK YOU, JK KELLY						
Original Disposition:	<input type="checkbox"/> Destroy <input type="checkbox"/> Return <input type="checkbox"/> Call for pickup						

ELK OIL COMPANY

BOX 310

JOSEPH J. KELLY
PRESIDENTROSWELL, NEW MEXICO 88202
(505) 623-3190

May 7, 2001

Oil Conservation Division
1220 South St. Francis Drive
Santa Fe, New Mexico 87505

Attention: Michael Stogner

Re: Hi-Way State #1
2417' FSL; 2245' FEL
Section 36-T10S-R27E
Chaves County, New Mexico

Gentlemen:

Enclosed please find copies of the waivers from the offset mineral owners
regarding the above referenced.

If you need additional information please advise.

Yours very truly,
ELK OIL COMPANY
Joseph J. Kelly
PresidentJJK/jgb
Enc.

ELK OIL COMPANY

JOSEPH J. KELLY
PRESIDENT

BOX 310
ROSWELL, NEW MEXICO 88202
(505) 623-3190

April 18, 2001

WAIVER

As an offset mineral owner, Pure Energy Group, Inc., has no objections to Elk Oil Company's proposed re-entry of the Hi-Way State #1 well at an unorthodox location of 2417' FSL; 2245' FEL of Section 36, Township 10 South, Range 27 East, Chaves County, New Mexico, provided the spacing unit is a stand up 320, being a E/2 dedication.

PURE ENERGY GROUP, INC.

By: 

Title

Date

4/30/01

ELK OIL COMPANY

JOSEPH J. KELLY
PRESIDENT

BOX 310
ROSWELL, NEW MEXICO 88202
(505) 623-3190

April 18, 2001

WAIVER

As an offset mineral owner, Samedan Royalty Corporation, has no objections to Elk Oil Company's proposed re-entry of the Hi-Way State #1 well at an unorthodox location of 2417' FSL; 2245' FEL of Section 36, Township 10 South, Range 27 East, Chaves County, New Mexico, provided the spacing unit is a stand up 320, being a E/2 dedication.

SAMEDAN ROYALTY CORPORATION

By:  94

Title

4/30/01
Date

ELK OIL COMPANY

BOX 310

ROSWELL, NEW MEXICO 88202

(505) 623-3190

JOSEPH J. KELLY
PRESIDENT

April 18, 2001

WAIVER

As an offset mineral owner, L.E. Minerals, Ltd., has no objections to Elk Oil Company's proposed re-entry of the Hi-Way State #1 well at an unorthodox location of 2417' FSL; 2245' FEL of Section 36, Township 10 South, Range 27 East, Chaves County, New Mexico, provided the spacing unit is a stand up 320, being a E/2 dedication.

L.E. MINERALS, LTD.

By: John Phelps White, III

General Partner
Title

4/19/01
Date

ELK OIL COMPANY

BOX 310

ROSWELL, NEW MEXICO 88202

(505) 623-3190

April 18, 2001

JOSEPH J. KELLY
PRESIDENT

WAIVER

As an offset mineral owner, Plains Radio Petroleum Company, has no objections to Elk Oil Company's proposed re-entry of the Hi-Way State #1 well at an unorthodox location of 2417' FSL; 2245' FEL of Section 36, Township 10 South, Range 27 East, Chaves County, New Mexico, provided the spacing unit is a stand up 320, being a E/2 dedication.

PLAINS RADIO
PETROLEUM COMPANY



By: D.K. BOYD

PRESIDENT

Title

4/25/01

Date

ELK OIL COMPANY

JOSEPH J. KELLY
PRESIDENT

BOX 310
ROSWELL, NEW MEXICO 88202
(505) 623-3190

April 18, 2001

WAIVER

As an offset mineral owner, J.E. & L.E. Mabee Foundation, has no objections to Elk Oil Company's proposed re-entry of the Hi-Way State #1 well at an unorthodox location of 2417' FSL; 2245' FEL of Section 36, Township 10 South, Range 27 East, Chaves County, New Mexico, provided the spacing unit is a stand up 320, being a E/2 dedication.

J.E. & L.E. MABEE FOUNDATION

John H. Conway Jr.
By:

VICE CHAIRMAN
Title

APRIL 23, 2001
Date

ELK OIL COMPANY

BOX 310

JOSEPH J. KELLY
PRESIDENT

ROSWELL, NEW MEXICO 88202

(505) 623-3190

April 18, 2001

WAIVER

As an offset mineral owner, Bellwether Exploration Company, has no objections to Elk Oil Company's proposed re-entry of the Hi-Way State #1 well at an unorthodox location of 2417' FSL; 2245' FEL of Section 36, Township 10 South, Range 27 East, Chaves County, New Mexico, provided the spacing unit is a stand up 320, being a E/2 dedication.

BELLWETHER EXPLORATION CO.

By: JAMES L. ENLOW

LANDS MANAGER
Title

4/30/01
Date

CMD : ONGARD 05/07/01 12:56:08
OG6C101 C101-APPLICATION FOR PERMIT TO DRILL OGOMES -TP2C

OGRID Idn : 7147 API Well No: 30 5 63021 APD Status(A/C/P): A
Opr Name, Addr: ELK OIL CO Aprvl/Cncl Date : 03-23-2001
PO BOX 310
ROSWELL,NM 88201

Prop Idn: 27955 HI-WAY STATE Well No: 1

	U/L	Sec	Township	Range	Lot	Idn	North/South	East/West
Surface Locn	: J	36	10S	27E			FTG 2417 F S	FTG 2245 F E
OCD U/L	: J		API County	: 5				

Work typ(N/E/D/P/A) : E Well typ(O/G/M/I/S/W/C): G Cable/Rotary (C/R) : F
Lease typ(F/S/P/N/J/U/I): S Ground Level Elevation : 3698

State Lease No: VO 4978 Multiple Comp (S/M/C) : S
Prpsd Depth : 6300 Prpsd Frmtn : WILDCAT

E0009: Enter data to modify record

PF01 HELP	PF02	PF03 EXIT	PF04 GoTo	PF05	PF06 CONFIRM
PF07	PF08	PF09 PRINT	PF10 C102	PF11 HISTORY	PF12

CMD :
OG5SECT

ONGARD
INQUIRE LAND BY SECTION

05/07/01 12:55:43
OGOMES -TP2C
PAGE NO: 1

Sec : 36 Twp : 10S Rng : 27E Section Type : NORMAL

D 40.00 CS V04978 0000 MARBOB ENERGY COR 11/01/01	C 40.00 CS V04978 0000 MARBOB ENERGY COR 11/01/01	B 40.00 CS V04978 0000 MARBOB ENERGY COR 11/01/01	A 40.00 CS V04978 0000 MARBOB ENERGY COF 11/01/01
E 40.00 CS V04978 0000 MARBOB ENERGY COR 11/01/01	F 40.00 CS V04978 0000 MARBOB ENERGY COR 11/01/01	G 40.00 CS V04978 0000 MARBOB ENERGY COR 11/01/01	H 40.00 CS V04978 0000 MARBOB ENERGY COF 11/01/01

PF01 HELP	PF02	PF03 EXIT	PF04 GoTo	PF05	PF06
PF07 BKWD	PF08 FWD	PF09 PRINT	PF10 SDIV	PF11	PF12

CMD :
OG5SECT

ONGARD
INQUIRE LAND BY SECTION

05/07/01 12:55:48
OGOMES -TP2C
PAGE NO: 2

Sec : 36 Twp : 10S Rng : 27E Section Type : NORMAL

L 40.00 CS V04978 0000 MARBOB ENERGY COR 11/01/01	K 40.00 CS V04978 0000 MARBOB ENERGY COR 11/01/01	J 40.00 CS V04978 0000 MARBOB ENERGY COR 11/01/01 A	I 40.00 CS V04978 0000 MARBOB ENERGY COF 11/01/01
M 40.00 CS V04978 0000 MARBOB ENERGY COR 11/01/01	N 40.00 CS V04978 0000 MARBOB ENERGY COR 11/01/01	O 40.00 CS V04978 0000 MARBOB ENERGY COR 11/01/01	P 40.00 CS V04978 0000 MARBOB ENERGY COF 11/01/01

PF01 HELP	PF02	PF03 EXIT	PF04 GoTo	PF05	PF06
PF07 BKWD	PF08 FWD	PF09 PRINT	PF10 SDIV	PF11	PF12

DISTRIBUTION		
SANTA FE		
FILE		
U.S.G.S.		
LAND OFFICE		
OPERATOR		

NEW MEXICO OIL CONSERVATION COMMISSION

Form O-103
Supersedes Old
C-102 and C-103
Effective 4-1-65

3a. Indicate Type of Lease
State ☒ Fee ☐
3. State Oil & Gas Lease No.
V-3008

SUNDY NOTICES AND REPORTS ON WELLS

(DO NOT USE THIS FORM FOR PROPOSALS TO DRILL OR TO RE-ENTER OR PLUG BACK TO A DIFFERENT RESERVOIR.
USE APPLICATION FOR PERMIT "A" (FORM C-101) FOR SUCH PROPOSALS.)

1. OIL WELL <input type="checkbox"/> GAS WELL <input type="checkbox"/> OTHER- <input type="checkbox"/>	RECEIVED
2. Name of Operator Primero Operating, Inc.	8. Form or Lease Name HI-WAY STATE
3. Address of Operator P. O. Box 1433, Roswell, NM 88202-1433	9. Well No. 1
4. Location of Well UNIT LETTER J 2417 FEET FROM THE South LINE AND 2245 FEET FROM THE East LINE, SECTION 36 TOWNSHIP 10-S RANGE 27-E NMPM.	10. Field and Pool, or Wildcat W/C Devonian
15. Elevation (Show whether DF, RT, GR, etc.) 3698 GR	12. County Chaves

16. Check Appropriate Box To Indicate Nature of Notice, Report or Other Data
NOTICE OF INTENTION TO: SUBSEQUENT REPORT OF:

PERFORM REMEDIAL WORK <input type="checkbox"/>	PLUG AND ABANDON <input type="checkbox"/>	REMEDIAL WORK <input type="checkbox"/>	ALTERING CASING <input type="checkbox"/>
TEMPERARILY ABANDON <input type="checkbox"/>	CHANGE PLANS <input type="checkbox"/>	COMMENCE DRILLING OPNS. <input type="checkbox"/>	PLUG AND ABANDONMENT <input type="checkbox"/>
PULL OR ALTER CASING <input type="checkbox"/>	OTHER <input type="checkbox"/>	CASING TEST AND CEMENT JOBS <input type="checkbox"/>	OTHER <input type="checkbox"/>

17. Describe Proposed or Completed Operations (Clearly state all pertinent details, and give pertinent dates, including estimated date of starting any proposed work) SEE RULE 1103.

Drilled 7-7/8" hole to 6881' and logged well. The well was determined to be dry and a plugging procedure was approved by Gary Williams of the NMOCDC. The well was plugged as follows on July 24, 1994:

- 1st plug - 35 sx Class H 6688-6588
- 2nd plug - 35 sx Class H 5770-5670
- 3rd plug - 35 sx Class H 5036-4936
- 4th plug - 35 sx Class H 2862-2762
- 5th plug - 35 sx Class H w/ 3% CaCl 1546, tagged at 1456'
- 6th plug - 35 sx Class H 414-314
- 7th plug 25 sx Class H 50' to surface

A dry hole marker will be set and the location will be cleared and levelled.

18. I hereby certify that the information above is true and complete to the best of my knowledge and belief.

SIGNED [Signature] TITLE President DATE 07/25/94

APPROVED BY [Signature] TITLE GEOLOGIST DATE 7-29-94

CONDITIONS OF APPROVAL, IF ANY:

DISTRIBUTION		
SANTA FE		
FILE		
U.S.G.S.		
LAND OFFICE		
OPERATOR		

NEW MEXICO OIL CONSERVATION COMMISSION

OIL CONSERVATION DIVISION
RECEIVED

1994 SEP 25 AM 8 52

Supersedes Old
C-102 and C-103
Effective 1-1-65

5a. Indicate Type of Lease	State <input checked="" type="checkbox"/> Fee <input type="checkbox"/>
5. State Oil & Gas Lease No.	V-3008

SUNDRY NOTICES AND REPORTS ON WELLS

1. OIL WELL <input type="checkbox"/> GAS WELL <input type="checkbox"/> OTHER <input type="checkbox"/>	2. Name of Operator Primero Operating, Inc.	3. Address of Operator P. O. Box 1433, Roswell, NM 88202-1433	4. Location of Well UNIT LETTER <u>J</u> <u>2417</u> FEET FROM THE <u>South</u> LINE AND <u>2245</u> FEET FROM THE <u>East</u> LINE, SECTION <u>36</u> TOWNSHIP <u>10-S</u> RANGE <u>27-E</u> NMPM.
15. Elevation (Show whether DF, RT, GR, etc.) 3698 GR	12. County Chaves		

7. Unit Agreement Name	8. Form or Lease Name HI-WAY STATE	9. Well No. 1	10. Field and Pool, or Wildcat W/C Devonian
------------------------	---------------------------------------	------------------	------------------------------------------------

Check Appropriate Box To Indicate Nature of Notice, Report or Other Data

NOTICE OF INTENTION TO:

SUBSEQUENT REPORT OF:

PERFORM REMEDIAL WORK <input type="checkbox"/>	PLUG AND ABANDON <input type="checkbox"/>	REMEDIAL WORK <input type="checkbox"/>	ALTERING CASING <input type="checkbox"/>
TEMPORARILY ABANDON <input type="checkbox"/>	CHANGE PLANS <input type="checkbox"/>	COMMENCE DRILLING OPNS. <input type="checkbox"/>	PLUG AND ABANDONMENT <input type="checkbox"/>
PULL OR ALTER CASING <input type="checkbox"/>	OTHER <input type="checkbox"/>	CASING TEST AND CEMENT JOBS <input type="checkbox"/>	OTHER <input type="checkbox"/>

17. Describe Proposed or Completed Operations (Clearly state all pertinent details, and give pertinent dates, including estimated date of starting any proposed work) SEE RULE 1103.

Drilled 7-7/8" hole to 6881' and logged well. The well was determined to be dry and a plugging procedure was approved by Gary Williams of the NMOC. The well was plugged as follows on July 24, 1994:

- 1st plug - 35 sx Class H 6688-6588
- 2nd plug - 35 sx Class H 5770-5670
- 3rd plug - 35 sx Class H 5036-4936
- 4th plug - 35 sx Class H 2862-2762
- 5th plug - 35 sx Class H w/ 3% CaCl 1546, tagged at 1456'
- 6th plug - 35 sx Class H 414-314
- 7th plug 25 sx Class H 50' to surface

A dry hole marker will be set and the location will be cleared and levelled.

18. I hereby certify that the information above is true and complete to the best of my knowledge and belief.

SIGNED <u>[Signature]</u>	TITLE <u>President</u>	DATE <u>07/25/94</u>
APPROVED BY <u>[Signature]</u>	TITLE <u>GEOLOGIST</u>	DATE <u>7-29-94</u>

CONDITIONS OF APPROVAL, IF ANY:

NO. OF COPIES RECEIVED	
DISTRIBUTION	
SANTA FE	
FILE	
U.S.G.S.	
LAND OFFICE	
OPERATOR	

Form C-105
Revised 11-8-88

NEW MEXICO OIL CONSERVATION COMMISSION WELL COMPLETION OR RECOMPLETION REPORT AND LOG

RECEIVED

'84 SEP 25 AM 8 52

RECEIVED

1. Initial Type of Lease	State <input checked="" type="checkbox"/> Fee <input type="checkbox"/>
2. State Oil & Gas Lease No.	V-3008
3. Unit Agreement No.	
4. Name of Lease	
5. Well No.	

1. TYPE OF WELL	
OIL WELL <input type="checkbox"/>	GAS WELL <input type="checkbox"/>
DRY <input checked="" type="checkbox"/>	OTHER <input type="checkbox"/>
2. TYPE OF COMPLETION	
NEW WELL <input type="checkbox"/>	WORK OVER <input type="checkbox"/>
DEEPEN <input type="checkbox"/>	PLUG BACK <input type="checkbox"/>
DIFF. RESVR. <input type="checkbox"/>	OTHER <input type="checkbox"/>

6. Unit Agreement No.
7. Name of Lease
8. Well No.

2. Name of Operator
Primero Operating, Inc.
ARTESIA, OFFICE

3. Address of Operator
P. O. Box 1433, Roswell, NM 88202-1433

4. Location of Well
UNIT LETTER J LOCATED 2417 FEET FROM THE South LINE AND 2245 FEET FROM

9. Well No.
1
10. Field and Pool, or Wildcat
W/C Devonian

THE East LINE OF SEC. 36 TWP. 10-S RGE. 27-E NMPM

11. County
Chaves

15. Date Spudded 06/30/94	16. Date T.D. Reached 07/24/94	17. Date Compl. (Ready to Prod.) N/A	18. Elevations (DF, RAB, RT, GR, etc.) 3698 GR	19. Elev. Casinghead N/A
------------------------------	-----------------------------------	-----------------------------------------	---------------------------------------------------	-----------------------------

20. Total Depth 6881'	21. Plug Back T.D. 0	22. If Multiple Compl., How Many N/A	23. Intervals Drilled By Rotary Tools 6881'	24. Casing Tools
--------------------------	-------------------------	-----------------------------------------	---------------------------------------------------	------------------

24. Producing Interval(s), of this completion - Top, Bottom, Name
None

25. Was Directional Survey Made
Yes

26. Type Electric and Other Logs Run
CNL-LDT, DLL-MSFL

27. Was Well Cored
No

28. CASING RECORD (Report all strings set in well)

CASING SIZE	WEIGHT LB./FT.	DEPTH SET	HOLE SIZE	CEMENTING RECORD	AMOUNT PULLED
13-3/8		338	17 1/2	400 sx "C"	
8-5/8	24#	1557	12 1/2	450 sx Lite, 200 sx "C"	

29. LINER RECORD				30. TUBING RECORD			
SIZE	TOP	BOTTOM	SACKS CEMENT	SCREEN	SIZE	DEPTH SET	PACKER SET

31. Perforation Record (Interval, size and number)			32. ACID, SHOT, FRACTURE, CEMENT SQUEEZE, ETC.	
DEPTH INTERVAL	AMOUNT AND KIND MATERIAL USED			

33. PRODUCTION

Date First Production		Production Method (Flowing, gas lift, pumping - Size and type pump)				Well Status (Prod. or Shut-in)	
Date of Test	Hours Tested	Choke Size	Prod'n. For Test Period	Oil - Bbl.	Gas - MCF	Water - Bbl.	Gas-Oil Ratio
Flow Tubing Press.	Casing Pressure	Calculated 24-Hour Rate	Oil - Bbl.	Gas - MCF	Water - Bbl.	Oil Gravity - API (Corr.)	

34. Disposition of Gas (Sold, used for fuel, vented, etc.)

Test Witnessed By

35. List of Attachments

36. I hereby certify that the information shown on both sides of this form is true and complete to the best of my knowledge and belief.

SIGNED

TITLE President

DATE 7/25/94

INSTRUCTIONS

This form is to be filed with the appropriate District Office of the Commission not later than 20 days after the completion of any newly-drilled deepened well. It shall be accompanied by one copy of all electrical and radio-activity logs run on the well and a summary of all special tests conducted, including drill stem tests. All depths reported shall be measured depths. In the case of directionally drilled wells, true vertical depths shall also be reported. For multiple completions, Items 30 through 34 shall be reported for each zone. The form is to be filed in quintuplicate except on state land, where six copies are required. See Rule 1105.

INDICATE FORMATION TOPS IN CONFORMANCE WITH GEOGRAPHICAL SECTION OF STATE

Southeastern New Mexico

Northwestern New Mexico

T. Anhy _____	T. Canyon _____	T. Ojo Alamo _____	T. Penn. "B" _____
T. Salt _____	T. Strawn _____	T. Kirtland-Fruitland _____	T. Penn. "C" _____
R. Salt _____	T. Atoka _____	T. Pictured Cliffs _____	T. Penn. "D" _____
T. Yates 346	T. Miss 6660	T. Cliff House _____	T. Leadville _____
T. 7 Rivers _____	T. Devonian 6798	T. Menefee _____	T. Madison _____
T. Queen 826	T. Silurian _____	T. Point Lookout _____	T. Elbert _____
T. Grayburg _____	T. Montoya _____	T. Mancos _____	T. McCracken _____
T. San Andres 1529	T. Simpson _____	T. Gallup _____	T. Ignacio Qtzite _____
T. Glorieta _____	T. McKee _____	Base Greenhorn _____	T. Granite _____
T. Paddock _____	T. Ellenburger _____	T. Dakota _____	T. _____
T. Blinbry _____	T. Gr. Wash _____	T. Morrison _____	T. _____
T. Tubb _____	T. Granite _____	T. Todilto _____	T. _____
T. Drinkard _____	T. Delaware Sand _____	T. Entrada _____	T. _____
T. Abo 4986	T. Bone Springs _____	T. Wingate _____	T. _____
T. Wolfcamp 5832	T. _____	T. Chinle _____	T. _____
T. Penn. 6300	T. _____	T. Permian _____	T. _____
T. Cisco (Bough C) _____	T. _____	T. Penn. "A" _____	T. _____

OIL OR GAS SANDS OR ZONES

No. 1, from _____ to _____ No. 4, from _____ to _____
 No. 2, from _____ to _____ No. 5, from _____ to _____
 No. 3, from _____ to _____ No. 6, from _____ to _____

IMPORTANT WATER SANDS

Include data on rate of water inflow and elevation to which water rose in hole.

No. 1, from _____ to _____ feet. _____

No. 2, from _____ to _____ feet. _____

No. 3, from _____ to _____ feet. _____

No. 4, from _____ to _____ feet. _____

FORMATION RECORD (Attach additional sheets if necessary)

<i>From</i>	<i>To</i>	<i>Thickness in Feet</i>	<i>Formation</i>	<i>From</i>	<i>To</i>	<i>Thickness in Feet</i>	<i>Formation</i>



KEN REYNOLDS—PRESIDENT
ARNIE NEWKIRK—VICE-PRESIDENT

DRILLING CO., INC. — OIL WELL DRILLING CONTRACTORS

P. O. Box 1498 ROSWELL, NEW MEXICO 88202-1498
505/623-5070 505/746-2719
ROSWELL, NM ARTESIA, NM

July 25, 1994

Primerio Operating, Inc.
P.O. Box 1433
Roswell, N.M. 88202

RE: Highway State #1

Gentlemen:

The following is a Deviation Survey on the above referenced well located in Chaves County, New Mexico.

338' - 1 1/4°	2318' - 3/4°	4605' - 1°
787' - 1 1/4°	2800' - 3/4°	5091' - 1°
1275' - 1 1/4°	3258' - 3/4°	5581' - 1°
1557' - 1°	3747' - 1°	5980' - 1°
2029' - 3/4°	4234' - 1°	6479' - 1°
		6810' - 1°

Sincerely,

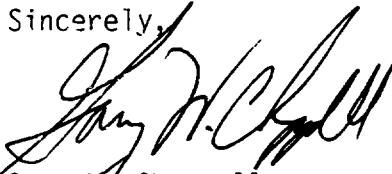

Gary W. Chappell
Contracts Manager

STATE OF NEW MEXICO }
COUNTY OF CHAVES)

The foregoing was acknowledged before me this 25th day of July 1994 by Gary W. Chappell.

MY COMMISSION EXPIRES

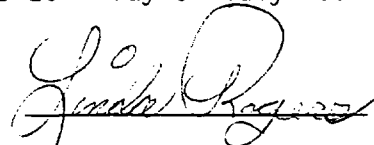
October 07, 1996

NOTARY PUBLIC

DISTRIBUTION		
SANTA FE		
FILE		
U.S.G.S.		
LAND OFFICE		
OPERATOR		

NEW MEXICO OIL CONSERVATION COMMISSION
OIL CONSERVATION DIVISION
RECEIVED
94 SEP 26 AM 8 52

Supersedes Old
C-102 and C-103
Effective 1-1-65

5a. Indicate Type of Lease
State ☒ Fee ☐
5. State Oil & Gas Lease No.
V-3008

SUNDRY NOTICES AND REPORTS ON WELLS
(DO NOT USE THIS FORM FOR PROPOSALS TO DRILL OR TO REOPEN OR PLUG BACK TO A DIFFERENT RESERVOIR.
SEE "APPLICATION FOR PERMIT TO DRILL" (FORM C-101) FOR SUCH PROPOSALS.)

1. <input type="checkbox"/> OIL WELL <input type="checkbox"/> GAS WELL <input type="checkbox"/> OTHER- 2. Name of Operator Primero Operating, Inc. 3. Address of Operator P. O. Box 1433, Roswell, NM 88202-1433 4. Location of Well UNIT LETTER <u>J</u> <u>2417</u> FEET FROM THE <u>South</u> LINE AND <u>ARTESIA, OFFICE 2245</u> FEET FROM THE <u>East</u> LINE, SECTION <u>36</u> TOWNSHIP <u>10-South</u> RANGE <u>27 East</u> N.M.P.M. 15. Elevation (Show whether DF, RT, GR, etc.) 3698 GR	RECEIVED JUL - 6 '94 O. C. D. 7. Unit Agreement Name 8. Farm or Lease Name Hi-Way State 9. Well No. 1 10. Field and Pool, or Wildcat Wildcat, Devonian 12. County Chaves
------------------------------------------------------------------------------------------------------------------------------------------------------------------------------------------------------------------------------------------------------------------------------------------------------------------------------------------------------------------------------------------------------------------------------------------------------------------------------------------------------------------------------	-----------------------------------------------------------------------------------------------------------------------------------------------------------------------------------------------------------

Check Appropriate Box To Indicate Nature of Notice, Report or Other Data
NOTICE OF INTENTION TO: SUBSEQUENT REPORT OF:

PERFORM REMEDIAL WORK <input type="checkbox"/>	PLUG AND ABANDON <input type="checkbox"/>	REMEDIAL WORK <input type="checkbox"/>	ALTERING CASING <input type="checkbox"/>
TEMPORARILY ABANDON <input type="checkbox"/>	CHANGE PLANS <input type="checkbox"/>	COMMENCE DRILLING OPNS. <input checked="" type="checkbox"/>	PLUG AND ABANDONMENT <input type="checkbox"/>
PULL OR ALTER CASING <input type="checkbox"/>	OTHER <input type="checkbox"/>	CASING TEST AND CEMENT JOBS <input checked="" type="checkbox"/>	

17. Describe Proposed or Completed Operations (Clearly state all pertinent details, and give pertinent dates, including estimated date of starting any proposed work) SEE RULE 1103.

Commenced drilling operations on 06/30/94.

Drilled a 17½" hole to 338'. Ran 8 jts. 13-3/8" csg. w/ insert float, guide shoe and two (2) centralizers. Landed csg @ TD and cemented w/ 400 sx Class C w/ 2% CaCl. Circ. 85 sx to pit. Pressured csg. to 600 psi and held 30 min. Plug down @ 11:15 on 7/1/94. WOC 18 hrs.

Drilled a 12½" hole to 1557'. Ran 35 jts. 8-5/8" 24# csg w/ float shoe, float collar and five (5) centralizers. Landed csg @ TD and cemented w/ 450 sx Lite cmt w/ ¼# flocele and 200 sx Class C w/ 2% CaCl. Circ. 150 sx to surface. Plug down at 9:10 pm on 7/3/94. Pressured csg. to 900 psi and held 30 min. NU and test BOP. WOC 18 hrs and commence drilling a 7-7/8" hole.

18. I hereby certify that the information above is true and complete to the best of my knowledge and belief.

SIGNED Phelps White TITLE President DATE 07/05/94
APPROVED BY Mark White TITLE GEOLOGIST DATE 7-29-94
CONDITIONS OF APPROVAL, IF ANY:

District I
PO Box 1980, Hobbs, NM 88241-1980

District II OIL CONSERVATION DIVISION

PO Drawer DD, Artesia, NM 88211-0719

District III

1000 Rio Brazos Rd., Aztec, NM 87410

District IV

PO Box 2088, Santa Fe, NM 87504-2088

State of New Mexico
Energy, Minerals & Natural Resources Department

OIL CONSERVATION DIVISION

PO Box 2088

50 Santa Fe, NM 87504-2088

Form C-101

Revised February 10, 1994

Instructions on back

Submit to Appropriate District Office

State Lease - 6 Copies

Fee Lease - 5 Copies

☐ AMENDED REPORT

RECEIVED
APPLICATION FOR PERMIT TO DRILL, RE-ENTER, DEEPEN, PLUGBACK, OR ADD A ZONE

Operator Name and Address: PRIMERO OPERATING, INC. P. O. BOX 1433 ROSWELL, NM 88202-1433		JUN 14 '94 O. C. D.	OGRID Number 018100 API Number 30-005-63021
Property Code 15416	Property Name HI-WAY STATE	ARTESIA, OFFICE	Well No. 1

7 Surface Location

UL or lot no.	Section	Township	Range	Lot Ida	Feet from the	North/South line	Feet from the	East/West line	County
J	36	10-S	27-E		2417	South	2245	East	Chaves

8 Proposed Bottom Hole Location If Different From Surface

UL or lot no.	Section	Township	Range	Lot Ida	Feet from the	North/South line	Feet from the	East/West line	County
Proposed Pool 1 Wildcat, Devonian					Proposed Pool 2 66101				

Work Type Code N	Well Type Code O	Cable/Rotary R	Lease Type Code S	Ground Level Elevation 3698
Multiple No	Proposed Depth 6800	Formation Devonian	Contractor Unknown	Spud Date Est. June 30, 1994

21 Proposed Casing and Cement Program

Hole Size	Casing Size	Casing weight/foot	Setting Depth	Sacks of Cement	Estimated TOC
12-1/4"	8-5/8"	24#	1550	700 sx	Surface
7-7/8"	5-1/2"	15.5 and 17#	TD	300 sx	5000'
17/2"	13 3/8"		300'		

Describe the proposed program. If this application is to DEEPEN or PLUG BACK give the data on the present productive zone and proposed new productive zone. Describe the blowout prevention program, if any. Use additional sheets if necessary.

We propose to drill a 12-1/4" hole to 1550' (Top of San Andres) and set 8-5/8" 24# API casing with 9 centralizers and float shoe. We will circulate cement. We then propose to drill a 7-7/8" hole to TD and log the well. If the well looks non-commercial, we will P&A following NMOC Rules and Regs. If the well looks commercial we plan to run 5-1/2" casing and complete the well as an oil well.

See attached BOP diagram. NSL CASE # 11046 WAS DISMISSED BECAUSE SAID WELL WAS P&A'D PRIOR TO HEARING.

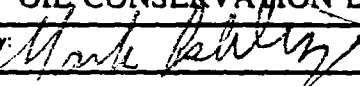
I hereby certify that the information given above is true and complete to the best of my knowledge and belief. Signature: 		OIL CONSERVATION DIVISION	
Printed name: Phelps White		Approved by: 	
Title: President		Title: GEOLOGIST	
Date: 06/13/94		Approval Date: 7-29-94	Expiration Date: 1-29-95
Phone: (505) 622-1001		Conditions of Approval: Attached <input type="checkbox"/>	

Submit to Appropriate
District Office
State Lease - 4 copies
Fee Lease - 3 copies

State of New Mexico
Energy, Minerals and Natural Resources Department

Form C-102
Revised 1-1-89

OIL CONSERVATION DIVISION

P.O. Box 2088
Santa Fe, New Mexico 87504-2088

DISTRICT I
P.O. Box 1980, Hobbs, NM 88240

DISTRICT II
P.O. Drawer DD, Artesia, NM 88210

DISTRICT III
1000 Rio Brazos Rd., Aztec, NM 87410

WELL LOCATION AND ACREAGE DEDICATION PLAT

All Distances must be from the outer boundaries of the section

Operator Primero Operating			Lease Hi-way State		Well No. 1
Unit Letter J	Section 36	Township 10 South	Range 27 East	County Chaves	
Actual Footage Location of Well: 2417 feet from the South line and 2245 feet from the East line					
Ground level Elev. 3698	Producing Formation Devonian		Pool Wildcat	Dedicated Acreage: 40 Acres	

1. Outline the acreage dedicated to the subject well by colored pencil or hatchure marks on the plat below.
2. If more than one lease is dedicated to the well, outline each and identify the ownership thereof (both as to working interest and royalty).
3. If more than one lease of different ownership is dedicated to the well, have the interest of all owners been consolidated by communitization, unitization, force-pooling, etc.?
☐ Yes ☐ No If answer is "yes" type of consolidation _____
If answer is "no" list the owners and tract descriptions which have actually been consolidated. (Use reverse side of this form if necessary). _____
No allowable will be assigned to the well until all interests have been consolidated (by communitization, unitization, forced-pooling, or otherwise) or until a non-standard unit, eliminating such interest, has been approved by the Division.

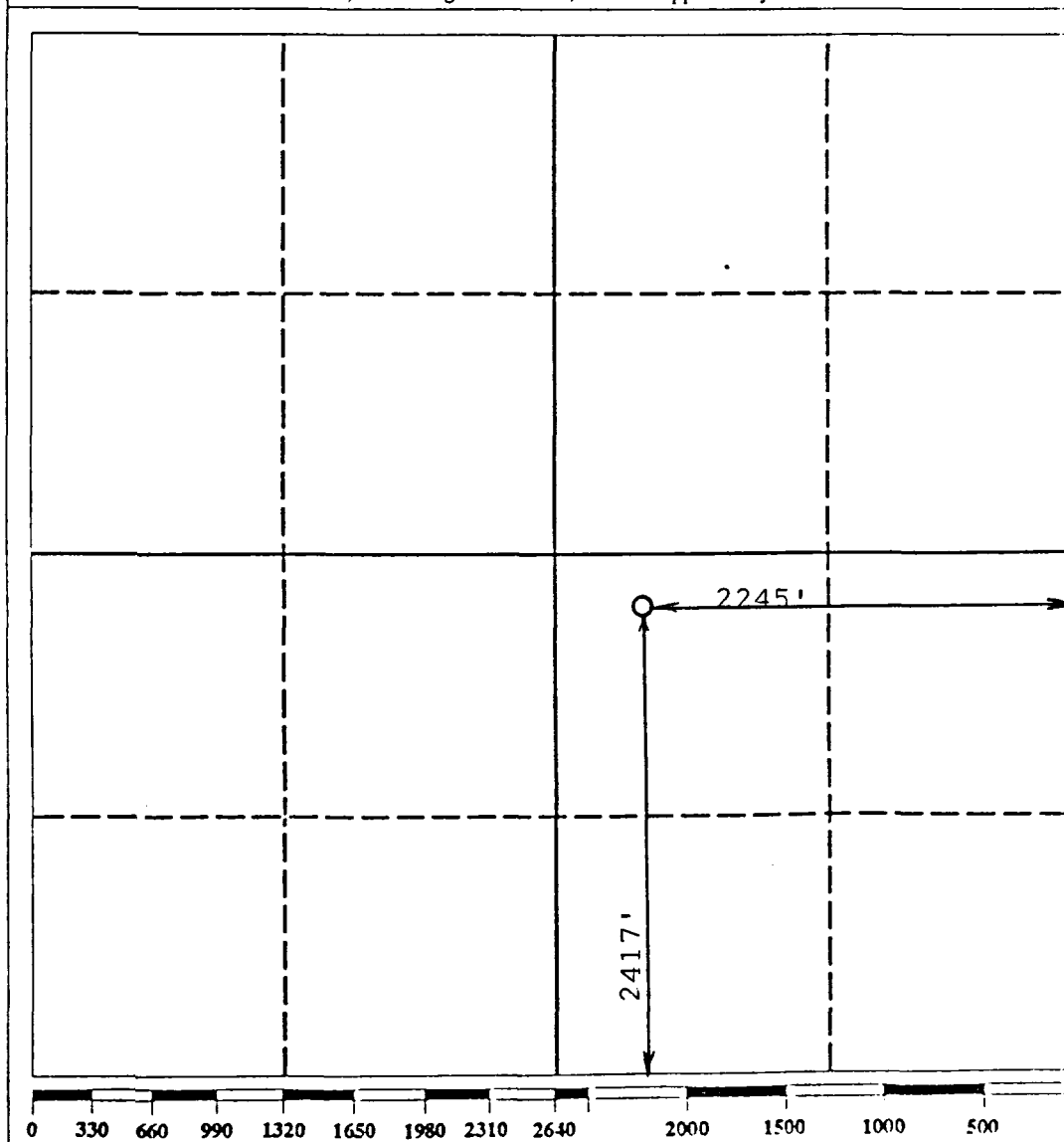

OPERATOR CERTIFICATION

I hereby certify that the information contained herein is true and complete to the best of my knowledge and belief.

Signature

Printed Name

Position

Company

Date

SURVEYOR CERTIFICATION

I hereby certify that the well location shown on this plat was plotted from field notes of actual surveys made by me or under my supervision, and that the same is true and correct to the best of my knowledge and belief.

Date Surveyed

June 9, 1994

Signature & Seal of
Professional Surveyor

P. B. Patton

Certificate No.

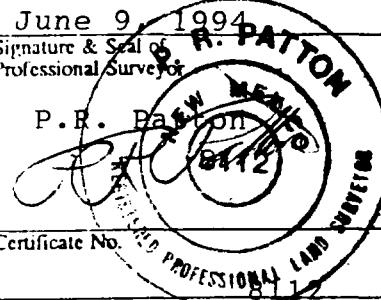

PRIMERO OPERATIONS, INC

H₁ - WAY STATE # 1

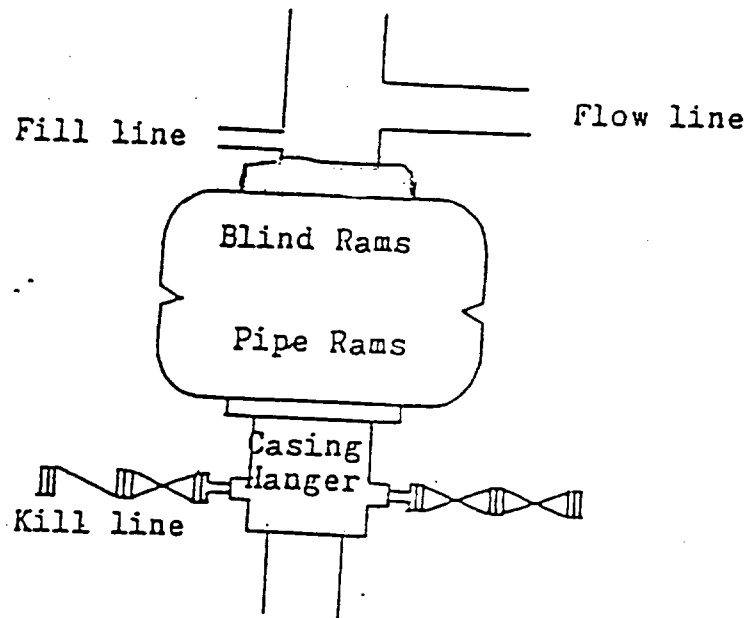

Blowout Preventer
3000 psi working pressure

WRS COMPLETION REPORTCOMPLETIONS SEC 36 TWP 10S RGE 27E
PI# 30-T-0001 08/12/94 30-005-63021-0000 PAGE 1

NMEX CHAVES * 2417FSL 2245FEL SEC NW SE
STATE COUNTY FOOTAGE SPOT
PRIMERO OPERATING WD WD
OPERATOR WELL CLASS INIT FIN
1 HI-WAY STATE
WELL NO. LEASE NAME
3709KB 3698GR WILDCAT
OPER ELEV FIELD POOL AREA
API 30-005-63021-0000
LEASE NO. PERMIT OR WELL I.D. NO.
06/30/1994 07/24/1994 ROTARY VERT D&A
SPUD DATE COMP. DATE TYPE TOOL HOLE TYPE STATUS
6800 DEVONIAN W E K DRLG 3 RIG SUB 10
PROJ. DEPTH PROJ. FORM CONTRACTOR
DTD 6881 FM/TD DEVONIAN
DRILLERS T.D. LOG T.D. PLUG BACK TD OLD T.D. FORM T.D.

LOCATION DESCRIPTION

20 MI NE DEXTER, NM
1 3/4 MI NW/2212 (SADR) OIL PROD IN CHISUM EAST FIELD

CASING/LINER DATA

CSG 13 3/8 @ 338 W/ 400 SACKS
CSG 8 5/8 @ 1557 W/ 650 SACKS
CMT PLUGS: 6588-6688 W/35 SX, 5670-5770 W/35 SX, 4936-
5036 W/35 SX, 2762-2862 W/35 SX, 1456-1546 W/35 SX,
314-414 W/35 SX, 25 SX @ SURF

TYPE	FORMATION	LTH	TOP	DEPTH/SUB	BSE	DEPTH/SUB
LOG	YATES		346	3352		
LOG	QUEEN		826	2872		
LOG	SN ANDRS		1529	2169		
LOG	ABO		4986	-1288		
LOG	WOLFCAMP		5832	-2134		
LOG	PNNSYLVN		6300	-2602		
LOG	MSSP		6660	-2962		
LOG	DEVONIAN		6798	-3100		

SUBSEA MEASUREMENTS FROM GR

FORMATION TEST DATA

DST 1
TITE

CONTINUED IC# 300057003494

COPYRIGHT 1994

 **Petroleum Information Corporation**PI-WRS-GET
Form No 187

COMPLETIONS SEC 36 TWP 10S RGE 27E
PI# 30-T-0001 08/12/94 30-005-63021-0000 PAGE 2

PRIMERO OPERATING WD WD
1 HI-WAY STATE

	LOGS AND SURVEYS /INTERVAL,TYPE/			
LOGS	CNL	LDT		DLL
LOGS	MSFL			

DRILLING PROGRESS DETAILS

	PRIMERO OPERATING
	BOX 1433
	ROSWELL, NM 88201-1433
	505-622-1001
07/06	LOC/1994/
07/06	DRLG 2600
07/12	DRLG 5260
07/18	DRLG 6700
07/27	6881 TD, HOLDING FOR DATA
	RIG REL 07/24/94
08/10	6881 TD
	COMP 7/24/94, D&A
	NO CORES, ONE DST RPTD

STATE OF NEW MEXICO
ENERGY, MINERALS AND NATURAL RESOURCES DEPARTMENT
OIL CONSERVATION DIVISION

IN THE MATTER OF THE HEARING
CALLED BY THE OIL CONSERVATION
DIVISION FOR THE PURPOSE OF
CONSIDERING:

CASE NO. 11046
ORDER NO. R-10162

**APPLICATION OF PRIMERO OPERATING, INC. FOR AN UNORTHODOX OIL
WELL LOCATION, CHAVES COUNTY, NEW MEXICO**

ORDER OF THE DIVISION

BY THE DIVISION:

This cause came on for hearing at 8:15 a.m. on August 4, 1994, at Santa Fe, New Mexico, before Examiner Michael E. Stogner.

NOW, on this 12th day of August, 1994, the Division Director, having considered the record and the recommendations of the Examiner, and being fully advised in the premises,

FINDS THAT:

(1) Due public notice having been given as required by law, the Division has jurisdiction of this cause and the subject matter thereof.

(2) The applicant, Primero Operating, Inc., seeks approval of an unorthodox oil well location for its Hi-Way State Well No. 1, which is currently being drilled 2417 feet from the South line and 2245 feet from the East line (Unit J) of Section 36, Township 10 South, Range 27 East, NMPM, Chaves County, New Mexico, to test the Devonian formation. The NW/4 SE/4 of said Section 36 is to be dedicated to said well forming a standard 40-acre oil spacing and proration unit.

(3) Prior to the hearing the applicant requested this case be dismissed.

(4) The applicant's request for dismissal should be granted.

IT IS THEREFORE ORDERED THAT:

Case No. 11046 is hereby dismissed.

Case No. 11046
Order No. R-10162
Page 2

DONE at Santa Fe, New Mexico, on the day and year hereinabove designated.

STATE OF NEW MEXICO
OIL CONSERVATION DIVISION

WILLIAM J. LEMAY
Director

S E A L

NSL-4588

ELK OIL COMPANY

JOSEPH J. KELLY
PRESIDENT

BOX 310
ROSWELL, NEW MEXICO 88202
(505) 623-3190

May 7, 2001

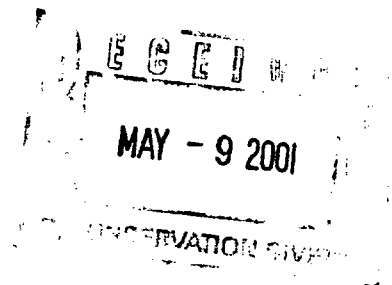

Oil Conservation Division
1220 South St. Francis Drive
Santa Fe, New Mexico 87505

Attention: Michael Stogner

Re: Hi-Way State #1
2417' FSL; 2245' FEL
Section 36-T10S-R27E
Chaves County, New Mexico

Gentlemen:

Enclosed please find copies of the waivers from the offset mineral owners regarding the above referenced.

If you need additional information please advise.

Yours very truly,
ELK OIL COMPANY



Joseph J. Kelly
President

JJK/jgb
Enc.

ELK OIL COMPANY

JOSEPH J. KELLY
PRESIDENT

BOX 310
ROSWELL, NEW MEXICO 88202
(505) 623-3190

April 18, 2001

WAIVER

As an offset mineral owner, Bellwether Exploration Company, has no objections to Elk Oil Company's proposed re-entry of the Hi-Way State #1 well at an unorthodox location of 2417' FSL; 2245' FEL of Section 36, Township 10 South, Range 27 East, Chaves County, New Mexico, provided the spacing unit is a stand up 320, being a E/2 dedication.

BELLWETHER EXPLORATION CO.

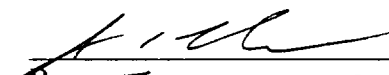
By: JAMES L. ENLOW

LANDS MANAGER
Title

4/30/01
Date

ELK OIL COMPANY

BOX 310

JOSEPH J. KELLY
PRESIDENT

ROSWELL, NEW MEXICO 88202

(505) 623-3190

April 18, 2001

WAIVER

As an offset mineral owner, L.E. Minerals, Ltd., has no objections to Elk Oil Company's proposed re-entry of the Hi-Way State #1 well at an unorthodox location of 2417' FSL; 2245' FEL of Section 36, Township 10 South, Range 27 East, Chaves County, New Mexico, provided the spacing unit is a stand up 320, being a E/2 dedication.

L.E. MINERALS, LTD.

By: 

General Partner
Title

4/17/01
Date

ELK OIL COMPANY

BOX 310

JOSEPH J. KELLY
PRESIDENT

ROSWELL, NEW MEXICO 88202

(505) 623-3190

April 18, 2001

WAIVER

As an offset mineral owner, J.E. & L.E. Mabee Foundation, has no objections to Elk Oil Company's proposed re-entry of the Hi-Way State #1 well at an unorthodox location of 2417' FSL; 2245' FEL of Section 36, Township 10 South, Range 27 East, Chaves County, New Mexico, provided the spacing unit is a stand up 320, being a E/2 dedication.

J.E. & L.E. MABEE FOUNDATION

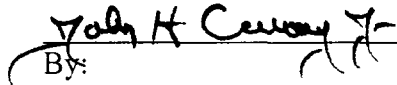
By: _____

VICE CHAIRMAN

Title

APRIL 23, 2001

Date

ELK OIL COMPANY

BOX 310

JOSEPH J. KELLY
PRESIDENT

ROSWELL, NEW MEXICO 88202

(505) 623-3190

April 18, 2001

WAIVER

As an offset mineral owner, Plains Radio Petroleum Company, has no objections to Elk Oil Company's proposed re-entry of the Hi-Way State #1 well at an unorthodox location of 2417' FSL; 2245' FEL of Section 36, Township 10 South, Range 27 East, Chaves County, New Mexico, provided the spacing unit is a stand up 320, being a E/2 dedication.

PLAINS RADIO
PETROLEUM COMPANY



By: D.K. BOYD

PRESIDENT

Title

4/25/01

Date

ELK OIL COMPANY

JOSEPH J. KELLY
PRESIDENT

BOX 310
ROSWELL, NEW MEXICO 88202
(505) 623-3190

April 18, 2001

WAIVER

As an offset mineral owner, Pure Energy Group, Inc., has no objections to Elk Oil Company's proposed re-entry of the Hi-Way State #1 well at an unorthodox location of 2417' FSL; 2245' FEL of Section 36, Township 10 South, Range 27 East, Chaves County, New Mexico, provided the spacing unit is a stand up 320, being a E/2 dedication.

PURE ENERGY GROUP, INC.

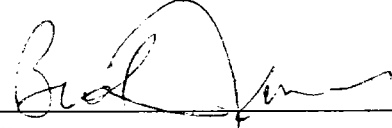
By: 

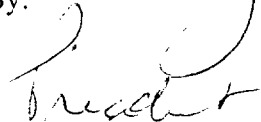

Title

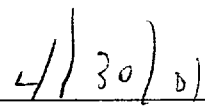

Date

ELK OIL COMPANY

BOX 310

ROSWELL, NEW MEXICO 88202

(505) 623-3190

April 18, 2001

JOSEPH J. KELLY
PRESIDENT

WAIVER

As an offset mineral owner, Samedan Royalty Corporation, has no objections to Elk Oil Company's proposed re-entry of the Hi-Way State #1 well at an unorthodox location of 2417' FSL; 2245' FEL of Section 36, Township 10 South, Range 27 East, Chaves County, New Mexico, provided the spacing unit is a stand up 320, being a E/2 dedication.

SAMEDAN ROYALTY CORPORATION

By:  94

Title

Date