

DATE IN 7/12/01	SUSPENSE 8/1/01	ENGINEER MS	LOGGED KW	TYPE NSL
--------------------	--------------------	----------------	--------------	-------------

119739466

ABOVE THIS LINE FOR DIVISION USE ONLY

**NEW MEXICO OIL CONSERVATION DIVISION**  
- Engineering Bureau -

**ADMINISTRATIVE APPLICATION COVERSHEET**

THIS COVERSHEET IS MANDATORY FOR ALL ADMINISTRATIVE APPLICATIONS FOR EXCEPTIONS TO DIVISION RULES AND REGULATIONS

**Application Acronyms:**

[NSP-Non-Standard Proration Unit] [NSL-Non-Standard Location]  
 [DD-Directional Drilling] [SD-Simultaneous Dedication]  
 [DHC-Downhole Commingling] [CTB-Lease Commingling] [PLC-Pool/Lease Commingling]  
 [PC-Pool Commingling] [OLS - Off-Lease Storage] [OLM-Off-Lease Measurement]  
 [WFX-Waterflood Expansion] [PMX-Pressure Maintenance Expansion]  
 [SWD-Salt Water Disposal] [IPI-Injection Pressure Increase]  
 [EOR-Qualified Enhanced Oil Recovery Certification] [PPR-Positive Production Response]

**[1] TYPE OF APPLICATION - Check Those Which Apply for [A]**

[A] Location - Spacing Unit - Directional Drilling  
☒ NSL    ☐ NSP    ☐ DD    ☐ SD

JUL 12 RECD /01

Check One Only for [B] and [C]

[B] Commingling - Storage - Measurement  
☐ DHC    ☐ CTB    ☐ PLC    ☐ PC    ☐ OLS    ☐ OLM

[C] Injection - Disposal - Pressure Increase - Enhanced Oil Recovery  
☐ WFX    ☐ PMX    ☐ SWD    ☐ IPI    ☐ EOR    ☐ PPR

**[2] NOTIFICATION REQUIRED TO: - Check Those Which Apply, or \_\_\_Does Not Apply**

[A] ☐ Working, Royalty or Overriding Royalty Interest Owners  
 [B] ☒ Offset Operators, Leaseholders or Surface Owner  
 [C] ☐ Application is One Which Requires Published Legal Notice  
 [D] ☐ Notification and/or Concurrent Approval by BLM or SLO  
U.S. Bureau of Land Management - Commissioner of Public Lands, State Land Office  
 [E] ☐ For all of the above, Proof of Notification or Publication is Attached, and/or,  
 [F] ☐ Waivers are Attached

**[3] INFORMATION / DATA SUBMITTED IS COMPLETE - Statement of Understanding**

I hereby certify that I, or personnel under my supervision, have read and complied with all applicable Rules and Regulations of the Oil Conservation Division. Further, I assert that the attached application for administrative approval is accurate and complete to the best of my knowledge and where applicable, verify that all interest (WI, RI, ORRI) is common. I understand that any omission of data, information or notification is cause to have the application package returned with no action taken.

Note: Statement must be completed by an individual with supervisory capacity.

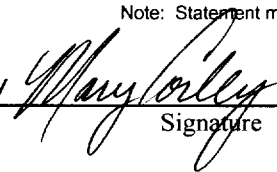
Mary Corley		Sr. Regulatory Analyst	07/11/2001
Print or Type Name	Signature	Title	Date

- Blanco MV is NSL

- Dakota is  
grandfather

---

Steve says OK

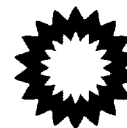

**Amoco Production Company**

A Part of the BP Amoco Group  
501 WestLake Park Blvd.  
Houston, TX 77079-3092

Phone: 281-366-4491

July 11, 2001

Mr. Michael Stogner  
New Mexico Oil Conservation Division  
1220 South St. Francis Drive  
Santa Fe, NM 87505

Application For Non-Standard Location  
Bolack Well No. 2  
2430' FNL, 1650' FEL, Section 19-T28N-R08W  
Blanco Mesaverde Pool  
San Juan County, New Mexico

Amoco Production Company hereby requests administrative approval for an non-standard well location for the Bolack well no. 2 in the Blanco Mesaverde Pool. The subject well was initially drilled and completed in 1978 by Tenneco Oil Company into the Basin Dakota Pool on a 320 acre standup acreage assignment (E/2) as reflected on the attached copy of Form C-102. It is our intent to complete into the Blanco Mesaverde Pool and commingle production downhole with the existing Dakota completion. Approval for a non-standard location is required for a completion into the Mesaverde formation due to the fact that the 312.52 acre spacing unit dedicated to this well is the N/2 (laydown), therefore the location does not conform to the Mesaverde location requirements that stipulated that a well be no closer than 660' to the outer boundary lines of a GPU.

The spacing unit for this well is the E/2 Section 19 as shown on the attached C-102. Also attached is a 9section plat with the subject well and surrounding wells identified.

Burlington Resources and Lively Exploration offset operators to our N/2 spacing unit are being furnished a copy of this application by certified mail return receipt requested.

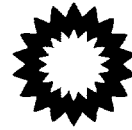

Your attention to this matter is greatly appreciated. Should you have any questions concerning this application please do not hesitate to call me at 281-366-4491.

Sincerely,

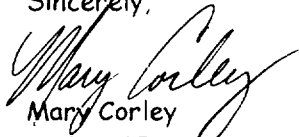
  
Mary Corley  
[corleym1@bp.com](mailto:corleym1@bp.com)

enclosures

cc: Frank Chavez, Supervisor  
NMOCD District III  
1000 Rio Brazos Road  
Aztec, NM 87410

Burlington Resources  
3535 E. 30<sup>th</sup> St.  
Farmington, NM 87401

Lively Exploration Co.  
2450 Fondren Suite 260  
Houston, TX 77063

**District I**

1625 N. French Dr., Hobbs, NM 88240

**District II**

811 South First, Artesia, NM 88210

**District III**

1000 Rio Brazos Rd., Aztec, NM 87410

**District IV**

2040 South Pacheco, Santa Fe, NM 87505

State of New Mexico  
Energy, Minerals & Natural Resources DepartmentOIL CONSERVATION DIVISION  
2040 South Pacheco  
Santa Fe, NM 87505Form C-102  
Revised August 15, 2000Submit to Appropriate District Office  
State Lease - 4 Copies  
Fee Lease - 3 Copies☐ AMENDED REPORT

## WELL LOCATION AND ACREAGE DEDICATION PLAT

<sup>1</sup> API Number <b>30-045-23257</b>	<sup>2</sup> Pool Code <b>72319</b>	<sup>3</sup> Pool Name <b>Blanco Mesaverde</b>
<sup>4</sup> Property Code <b>000323</b>	<sup>5</sup> Property Name <b>Bolack</b>	<sup>6</sup> Well Number <b>2</b>
<sup>7</sup> OGRID No. <b>000778</b>	<sup>8</sup> Operator Name <b>Amoco Production Company</b>	<sup>9</sup> Elevation <b>5703'</b>

<sup>10</sup> Surface Location

UL or lot no. <b>Unit 6</b>	Section <b>19</b>	Township <b>28N</b>	Range <b>08W</b>	Lot Idn	Feet from the <b>2430'</b>	North/South line <b>North</b>	Feet from the <b>1650'</b>	East/West line <b>East</b>	County <b>San Juan</b>
--------------------------------	----------------------	------------------------	---------------------	---------	-------------------------------	----------------------------------	-------------------------------	-------------------------------	---------------------------

<sup>11</sup> Bottom Hole Location If Different From Surface

UL or lot no.	Section	Township	Range	Lot Idn	Feet from the	North/South line	Feet from the	East/West line	County
---------------	---------	----------	-------	---------	---------------	------------------	---------------	----------------	--------

<sup>12</sup> Dedicated Acres <b>312.52</b>	<sup>13</sup> Joint or Infill	<sup>14</sup> Consolidation Code	<sup>15</sup> Order No.
--	-------------------------------	----------------------------------	-------------------------

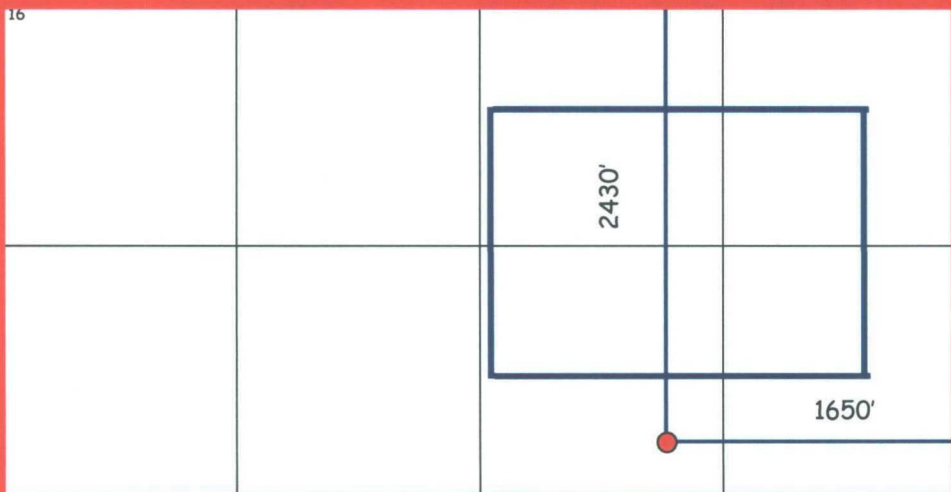
NO ALLOWABLE WILL BE ASSIGNED TO THIS COMPLETION UNTIL ALL INTERESTS HAVE BEEN CONSOLIDATED OR A  
NON-STANDARD UNIT HAS BEEN APPROVED BY THE DIVISION<sup>17</sup> OPERATOR CERTIFICATIONI hereby certify that the information contained herein  
is true and complete to the best of my knowledge and  
belief.  
SignaturePrinted Name **Mary Corley**Title **Sr. Regulatory Analyst**Date **06/27/2001**

Date

<sup>18</sup> SURVEYOR CERTIFICATIONI hereby certify that the well location shown on this plat was  
plotted from field notes of actual surveys made by me or under  
my supervision, and that the same is true and correct to the best  
of my belief.Date of Survey **09/23/1978**

Signature and Seal of Professional Surveyor:

**Fred B Kerr Jr 3950**  
Certificate Number

# WELL LOCATION AND ACREAGE DEDICATION FORM

Form  
Supervisors Only  
Effective 1-1-78

All distances must be from the outer boundaries of the Section

Operator <b>TENNECO OIL COMPANY</b>			Lease <b>BOLACK</b>		Well No. <b>2</b>
Section <b>6</b>	Section <b>19</b>	Township <b>28N</b>	Range <b>8W</b>	County <b>San Juan</b>	
Actual Footage Location of Well:					
<b>2430</b> feet from the <b>North</b> line and		<b>1650</b> feet from the <b>East</b> line			
Ground Level Elev. <b>5838</b>	Producing Formation <b>Dakota</b>	Pool <b>Basin Dakota</b>	Dedicated Acreage: <b>320</b> Acres		

1. Outline the acreage dedicated to the subject well by colored pencil or hachure marks on the plat below.
2. If more than one lease is dedicated to the well, outline each and identify the ownership thereof (both as to working interest and royalty).
3. If more than one lease of different ownership is dedicated to the well, have the interests of all owners been consolidated by communitization, unitization, force-pooling, etc?

☐ Yes ☐ No If answer is "yes" type of consolidation \_\_\_\_\_

If answer is "no," list the owners and tract descriptions which have actually been consolidated. (Use reverse side of this form if necessary.) \_\_\_\_\_

No allowable will be assigned to the well until all interests have been consolidated (by communitization, unitization, forced-pooling, or otherwise) or until a non-standard unit, eliminating such interests, has been approved by the Commission.

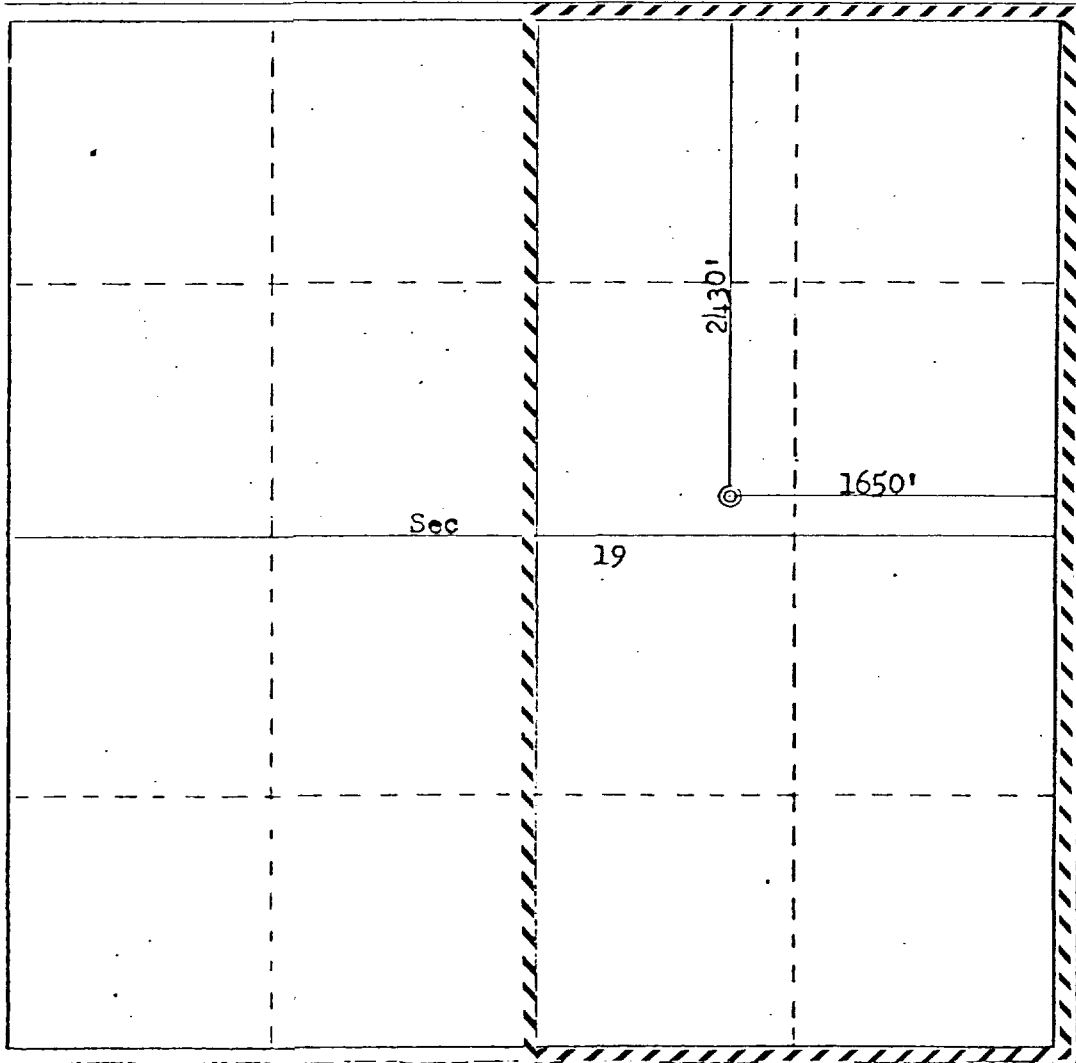

## CERTIFICATION

I hereby certify that the information contained herein is true and complete to the best of my knowledge and belief.

Name J. A. Rush  
Position Environmental Coordinator  
Company Tenneco Oil Company  
Date October 23, 1978

I hereby certify that the well location shown on this plat was plotted from field notes of actual surveys made by me or under my supervision, and that the same is true and correct to the best of my knowledge and belief.

Date Surveyed September 23, 1978  
Regulatory and Compliance  
Fred J. Venn Jr.  
Certified Surveyor  
STATE OF NEW MEXICO  
395 E. 1st St. JR.

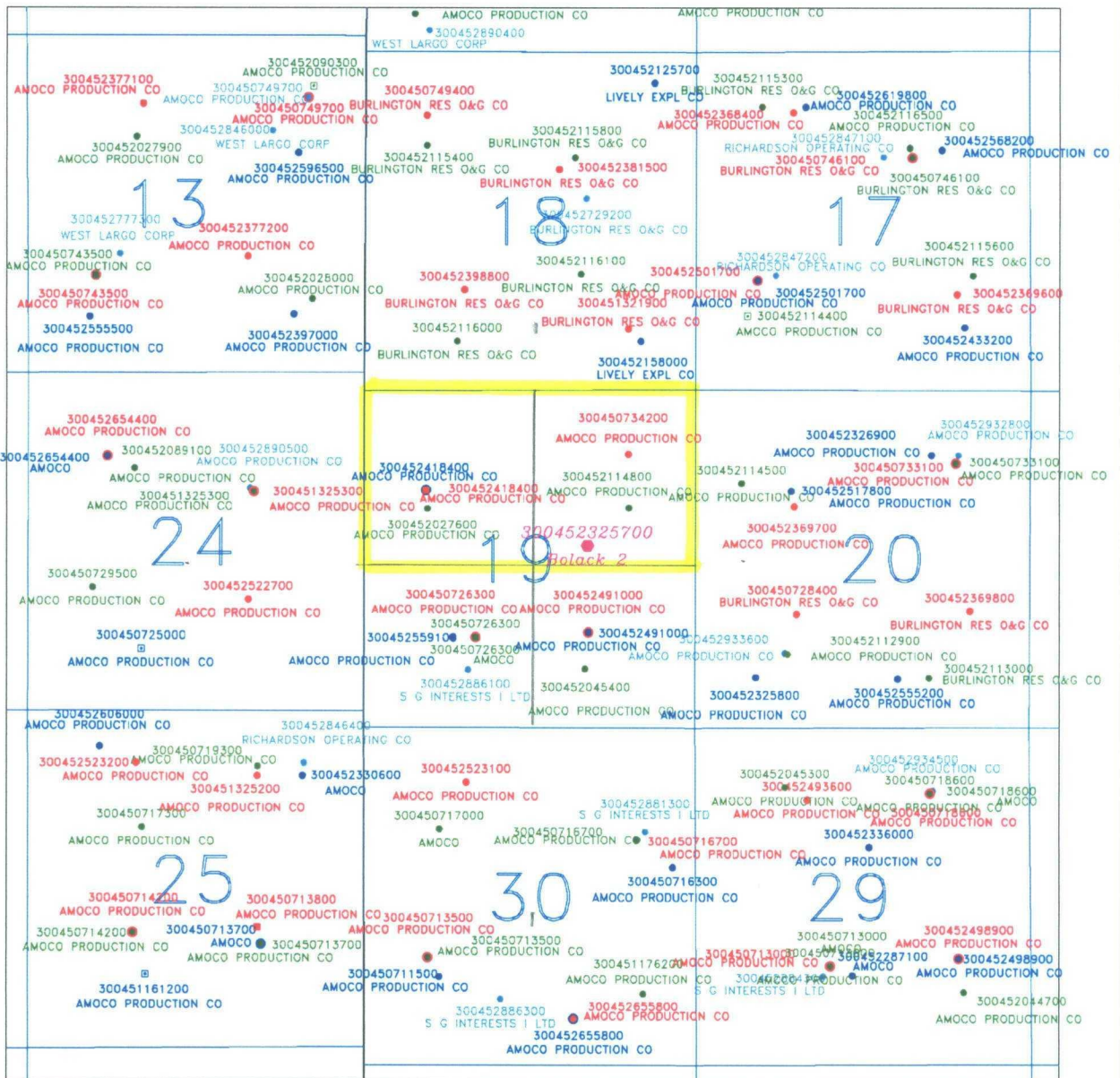

- DAKOTA ACTIVE WELL
- DAKOTA INACTIVE WELL
- MESAVARDE ACTIVE WELL
- MESAVARDE INACTIVE WELL
- FRUITLAND CORAL ACTIVE WELL
- FRUITLAND CORAL INACTIVE WELL
- PICTURED CLIFFS ACTIVE WELL
- PICTURED CLIFFS INACTIVE WELL

Amoco Production Company Houston, Texas			
San Juan Basin 9 Section Plat			
28N 8W Section 19 Bolack 2			
SCALE	DRAWN C. E. SACKETT	DATE 3-JUL-2001	
DRAWING			

CMD :  
OG5SECT

ONGARD  
INQUIRE LAND BY SECTION

08/01/01 09:07:20  
OGOMES -TQES  
PAGE NO: 1

Sec : 19 Twp : 28N Rng : 08W Section Type : NORMAL

1 36.27	C 40.00	B 40.00	A 40.00
Federal owned	Federal owned	Federal owned	Federal owned
			A
2 36.25	F 40.00	G 40.00	H 40.00
Federal owned	Federal owned	Federal owned	Federal owned
A A		A	A

PF01 HELP	PF02	PF03 EXIT	PF04 GoTo	PF05	PF06
PF07 BKWD	PF08 FWD	PF09 PRINT	PF10 SDIV	PF11	PF12

312.52



CMD :  
OG5SECTONGARD  
INQUIRE LAND BY SECTION08/01/01 09:07:26  
OGOMES -TQE9  
PAGE NO: 2

Sec : 19 Twp : 28N Rng : 08W Section Type : NORMAL

3 36.23	K 40.00	J 40.00	I 40.00
Federal owned	Federal owned A A	Federal owned A	Federal owned
4 36.21	N 40.00	O 40.00	P 40.00
Federal owned	Federal owned A	Federal owned A	Federal owned

PF01 HELP  
PF07 BKWDPF02  
PF08 FWDPF03 EXIT  
PF09 PRINTPF04 GoTo  
PF10 SDIVPF05  
PF11PF06  
PF12

CMD : ONGARD 08/01/01 09:41:10  
OG6IWCM INQUIRE WELL COMPLETIONS OGOMES -TQES

API Well No : 30 45 23257 Eff Date : 06-01-1979 WC Status : A  
Pool Idn : 71599 BASIN DAKOTA (PRORATED GAS)  
OGRID Idn : 778 AMOCO PRODUCTION CO  
Prop Idn : 323 BOLACK

Well No : 002  
GL Elevation: 5838

	U/L	Sec	Township	Range	North/South	East/West	Prop/Act (P/A)
	---	---	-----	-----	-----	-----	-----
B.H. Locn : G	19	28N	08W	FTG 2430	F N	FTG 1650	F E P

Lot Identifier:  
Dedicated Acre: 320.00  
Lease Type : F  
Type of consolidation (Comm, Unit, Forced Pooling - C/U/F/O) :

M0025: Enter PF keys to scroll

PF01 HELP	PF02	PF03 EXIT	PF04 GoTo	PF05	PF06
PF07	PF08	PF09	PF10 NEXT-WC	PF11 HISTORY	PF12 NXTREC

CMD :  
OG6ACRE

ONGARD  
C102-DEDICATE ACREAGE

08/01/01 09:41:16  
OGOMES -TQES  
Page No : 1

API Well No : 30 45 23257 Eff Date : 04-30-1991  
Pool Idn : 71599 BASIN DAKOTA (PRORATED GAS)  
Prop Idn : 323 BOLACK Well No : 002  
Spacing Unit : 32163 OCD Order : Simultaneous Dedication:  
Sect/Twp/Rng : Acreage : 320.00 Revised C102? (Y/N) :  
Dedicated Land:

S	Base	U/L	Sec	Twp	Rng	Acreage	L/W	Ownership	Lot	Idn
	A		19	28N	08W	40.00	N	FD		
	B		19	28N	08W	40.00	N	FD		
	G		19	28N	08W	40.00	N	FD		
	H		19	28N	08W	40.00	N	FD		
	I		19	28N	08W	40.00	N	FD		
	J		19	28N	08W	40.00	N	FD		
	O		19	28N	08W	40.00	N	FD		
	P		19	28N	08W	40.00	N	FD		

E0005: Enter data to modify or PF keys to scroll

PF01 HELP PF02 PF03 EXIT PF04 GoTo PF05 PF06 CONFIRM  
PF07 BKWD PF08 FWD PF09 PF10 LAND PF11 NXTSEC PF12 RECONF

CMD :  
OG6IWCM

ONGARD  
INQUIRE WELL COMPLETIONS

08/01/01 09:40:37  
OGOMES -TQES

API Well No : 30 45 24184    Eff Date : 03-16-1995    WC Status : A  
Pool Idn : 72319 BLANCO-MESAVERDE (PRORATED GAS)  
OGRID Idn : 778 AMOCO PRODUCTION CO  
Prop Idn : 526 FLORANCE C

Well No : 008M  
GL Elevation: 5771

	U/L	Sec	Township	Range	North/South	East/West	Prop/Act (P/A)
	---	---	-----	-----	-----	-----	-----
B.H. Locn : 2	19	28N	08W	FTG 1545	F N FTG 970	F W	P

Lot Identifier:  
Dedicated Acre: 312.52  
Lease Type : F  
Type of consolidation (Comm, Unit, Forced Pooling - C/U/F/O) :

PF01 HELP	PF02	PF03 EXIT	PF04 GoTo	PF05	PF06
PF07	PF08	PF09	PF10 NEXT-WC	PF11 HISTORY	PF12 NXTREC

CMD : ONGARD 08/01/01 09:40:44  
OG6ACRE C102-DEDICATE ACREAGE OGOMES -TQES  
Page No : 1

API Well No : 30 45 24184 Eff Date : 04-30-1991  
Pool Idn : 72319 BLANCO-MESAVERDE (PRORATED GAS)  
Prop Idn : 526 FLORANCE C Well No : 008M  
Spacing Unit : 32816 OCD Order : Simultaneous Dedication:  
Sect/Twp/Rng : Acreage : 312.52 Revised C102? (Y/N) :  
Dedicated Land:

S	Base	U/L	Sec	Twp	Rng	Acreage	L/W	Ownership	Lot	Idn
	A		19	28N	08W	40.00	N	FD		
	B		19	28N	08W	40.00	N	FD		
	C		19	28N	08W	40.00	N	FD		
	F		19	28N	08W	40.00	N	FD		
	G		19	28N	08W	40.00	N	FD		
	H		19	28N	08W	40.00	N	FD		
	D	1	19	28N	08W	36.27	N	FD		
	E	2	19	28N	08W	36.25	N	FD		

E0005: Enter data to modify or PF keys to scroll

PF01 HELP PF02 PF03 EXIT PF04 GoTo PF05 PF06 CONFIRM  
PF07 BKWD PF08 FWD PF09 PF10 LAND PF11 NXTSEC PF12 RECONF

CMD : ONGARD 08/01/01 09:40:54  
 OG6IPRD INQUIRE PRODUCTION BY POOL/WELL OGOMES -TQES  
 Page No: 1

OGRID Identifier : 778 AMOCO PRODUCTION CO  
 Pool Identifier : 72319 BLANCO-MESAVERDE (PRORATED GAS)  
 API Well No : 30 45 24184 Report Period - From : 01 2000 To : 06 2001

API Well No	Property Name	Prod. Days		Production Volumes			Well Stat
		MM/YY	Prod	Gas	Oil	Water	
30 45 24184	FLORANCE C	01 00	31	3194	28	40	F
30 45 24184	FLORANCE C	02 00	29	2866		30	F
30 45 24184	FLORANCE C	03 00	31	3093			F
30 45 24184	FLORANCE C	04 00	30	2992	12		F
30 45 24184	FLORANCE C	05 00	31	3034			F
30 45 24184	FLORANCE C	06 00	25	2781	7	55	F
30 45 24184	FLORANCE C	07 00	31	2944			F

Reporting Period Total (Gas, Oil) :

M0025: Enter PF keys to scroll

PF01 HELP PF02 PF03 EXIT PF04 GoTo PF05 PF06 CONFIRM  
 PF07 BKWD PF08 FWD PF09 PF10 NXTPOOL PF11 NXTOGD PF12

CMD : ONGARD 08/01/01 09:40:56  
 OG6IPRD INQUIRE PRODUCTION BY POOL/WELL OGOMES -TQES  
 Page No: 2

OGRID Identifier : 778 AMOCO PRODUCTION CO  
 Pool Identifier : 72319 BLANCO-MESAVERDE (PRORATED GAS)  
 API Well No : 30 45 24184 Report Period - From : 01 2000 To : 06 2001

API Well No	Property Name	Prodn. Days MM/YY Prod	Production Volumes Gas Oil Water	Well Stat
30 45 24184	FLORANCE C	08 00 31	2871	F
30 45 24184	FLORANCE C	09 00 30	2747 1	F
30 45 24184	FLORANCE C	10 00 31	2883 25	F
30 45 24184	FLORANCE C	11 00 30	2891 7	F
30 45 24184	FLORANCE C	12 00 31	3071 4	F
30 45 24184	FLORANCE C	01 01 31	2909 10	F
30 45 24184	FLORANCE C	02 01 28	2710 5	F

Reporting Period Total (Gas, Oil) :

E0049: User may continue scrolling.

PF01 HELP PF02 PF03 EXIT PF04 GoTo PF05 PF06 CONFIRM  
 PF07 BKWD PF08 FWD PF09 PF10 NXTPOOL PF11 NXTOGD PF12

API Well No			Property Name	Prod'n. Days		Production Volumes			Well	
				MM/YY	Prod	Gas	Oil	Water	Stat	
30	45	24184	FLORANCE C	03	01	31	2848	6		F
30	45	24184	FLORANCE C	04	01	29	2696	2	40	F
30	45	24184	FLORANCE C	05	01	5	2756	2		F

Reporting Period Total (Gas, Oil) :	49286	84	190
-------------------------------------	-------	----	-----

E0049: User may continue scrolling.

```
PF01 HELP      PF02          PF03 EXIT      PF04 GoTo      PF05          PF06 CONFIRM
PF07 BKWD      PF08 FWD      PF09          PF10 NXTPOOL PF11 NXTOGD  PF12
```



CMD : ONGARD 08/01/01 09:40:34  
OG6IWCM INQUIRE WELL COMPLETIONS OGOMES -TQES

API Well No : 30 45 24184 Eff Date : 01-12-1995 WC Status : P  
Pool Idn : 71599 BASIN DAKOTA (PRORATED GAS)  
OGRID Idn : 778 AMOCO PRODUCTION CO  
Prop Idn : 526 FLORANCE C

Well No : 008M  
GL Elevation: 5771

	U/L	Sec	Township	Range	North/South	East/West	Prop/Act (P/A)
	---	---	-----	-----	-----	-----	-----
B.H. Locn : 2	19	28N	08W	FTG 1545	F N FTG	970 F W	P
Lot Identifier:							
Dedicated Acre:							
Lease Type : F							
Type of consolidation (Comm, Unit, Forced Pooling - C/U/F/O) :							

M0025: Enter PF keys to scroll

PF01 HELP	PF02	PF03 EXIT	PF04 GoTo	PF05	PF06
PF07	PF08	PF09	PF10 NEXT-WC	PF11 HISTORY	PF12 NXTREC

CMD : ONGARD 08/01/01 09:07:40  
OG6IWCN INQUIRE WELL COMPLETIONS OGOMES -TQES

API Well No : 30 45 7342 Eff Date : 01-01-1900 WC Status : A  
Pool Idn : 72319 BLANCO-MESAVERDE (PRORATED GAS)  
OGRID Idn : 778 AMOCO PRODUCTION CO  
Prop Idn : 527 FLORANCE C LS

Well No : 001  
GL Elevation: 5800

	U/L	Sec	Township	Range	North/South	East/West	Prop/Act (P/A)
	---	---	-----	-----	-----	-----	-----
B.H. Locn : A	19	28N	08W	FTG	990 F N	FTG 990 F E	P
Lot Identifier:							
Dedicated Acre: 312.52							
Lease Type : F							
Type of consolidation (Comm, Unit, Forced Pooling - C/U/F/O) :							

M0025: Enter PF keys to scroll

PF01 HELP	PF02	PF03 EXIT	PF04 GoTo	PF05	PF06
PF07	PF08	PF09	PF10 NEXT-WC	PF11 HISTORY	PF12 NXTREC

CMD :  
OG6ACRE

ONGARD  
C102-DEDICATE ACREAGE

08/01/01 09:39:58  
OGOMES -TQES  
Page No : 1

API Well No : 30 45 7342 Eff Date : 04-30-1991  
Pool Idn : 72319 BLANCO-MESAVERDE (PRORATED GAS)  
Prop Idn : 527 FLORANCE C LS  
Spacing Unit : 32816 OCD Order :  
Sect/Twp/Rng : Acreage : 312.52  
Dedicated Land:

Well No : 001  
Simultaneous Dedication:  
Revised C102? (Y/N) :

S	Base	U/L	Sec	Twp	Rng	Acreage	L/W	Ownership	Lot	Idn
	A		19	28N	08W	40.00	N	FD		
	B		19	28N	08W	40.00	N	FD		
	C		19	28N	08W	40.00	N	FD		
	F		19	28N	08W	40.00	N	FD		
	G		19	28N	08W	40.00	N	FD		
	H		19	28N	08W	40.00	N	FD		
	D	1	19	28N	08W	36.27	N	FD		
	E	2	19	28N	08W	36.25	N	FD		

E0005: Enter data to modify or PF keys to scroll

PF01 HELP PF02 PF03 EXIT PF04 GoTo PF05 PF06 CONFIRM  
PF07 BKWD PF08 FWD PF09 PF10 LAND PF11 NXTSEC PF12 RECONF

CMD : ONGARD 08/01/01 09:40:09  
 OG6IPRD INQUIRE PRODUCTION BY POOL/WELL OGOMES -TQES  
 Page No: 1

OGRID Identifier : 778 AMOCO PRODUCTION CO  
 Pool Identifier : 72319 BLANCO-MESAVERDE (PRORATED GAS)  
 API Well No : 30 45 7342 Report Period - From : 01 2000 To : 06 2001

API Well No	Property Name	Prod. Days			Production Volumes			Well
		MM/YY	Prod		Gas	Oil	Water	
30 45 7342	FLORANCE C LS	01 00	31		3252			F
30 45 7342	FLORANCE C LS	02 00	29		5873			F
30 45 7342	FLORANCE C LS	03 00	31		7119		40	F
30 45 7342	FLORANCE C LS	04 00	30		7269		25	F
30 45 7342	FLORANCE C LS	05 00	31		7008	39	50	F
30 45 7342	FLORANCE C LS	06 00	25		2768		45	F
30 45 7342	FLORANCE C LS	07 00	31		4702	21		F

Reporting Period Total (Gas, Oil) :

M0025: Enter PF keys to scroll

PF01 HELP PF02 PF03 EXIT PF04 GoTo PF05 PF06 CONFIRM  
 PF07 BKWD PF08 FWD PF09 PF10 NXTPOOL PF11 NXTOGD PF12

CMD : ONGARD 08/01/01 09:40:11  
 OG6IPRD INQUIRE PRODUCTION BY POOL/WELL OGOMES -TQES  
 Page No: 2

OGRID Identifier : 778 AMOCO PRODUCTION CO  
 Pool Identifier : 72319 BLANCO-MESAVERDE (PRORATED GAS)  
 API Well No : 30 45 7342 Report Period - From : 01 2000 To : 06 2001

API Well No	Property Name	Prodn. Days MM/YY Prod	Production Volumes Gas Oil Water	Well Stat
30 45 7342	FLORANCE C LS	08 00 31	6289	50 F
30 45 7342	FLORANCE C LS	09 00 30	4906 10	F
30 45 7342	FLORANCE C LS	10 00 31	5816 17	F
30 45 7342	FLORANCE C LS	11 00 30	5454 7	F
30 45 7342	FLORANCE C LS	12 00 31	2236 6 80	F
30 45 7342	FLORANCE C LS	01 01 31	5125 4	F
30 45 7342	FLORANCE C LS	02 01 28	5501 40	F

Reporting Period Total (Gas, Oil) :

E0049: User may continue scrolling.

PF01 HELP PF02 PF03 EXIT PF04 GoTo PF05 PF06 CONFIRM  
 PF07 BKWD PF08 FWD PF09 PF10 NXTPOOL PF11 NXTOGD PF12

CMD :  
OG6IPRD

ONGARD  
INQUIRE PRODUCTION BY POOL/WELL

08/01/01 09:40:13  
OGOMES -TQES  
Page No: 3

OGRID Identifier :  
Pool Identifier :  
API Well No

778 AMOCO PRODUCTION CO  
72319 BLANCO-MESAVERDE (PRORATED GAS)  
: 30 45 7342 Report Period - From : 01 2000 To : 06 2001

API Well No			Property Name	Prodn. Days		Production Volumes			Well
				MM/YY	Prod	Gas	Oil	Water	Stat
30	45	7342	FLORANCE C LS	03 01	31	5941	6		F
30	45	7342	FLORANCE C LS	04 01	29	4781		35	F
30	45	7342	FLORANCE C LS	05 01	30	5496	4	30	F

Reporting Period Total (Gas, Oil) :

89536114395

E0049: User may continue scrolling.

PF01 HELP PF02 PF03 EXIT PF04 GoTo PF05 PF06 CONFIRM  
PF07 BKWD PF08 FWD PF09 PF10 NXTPOOL PF11 NXTOGD PF12

✓  
May 25, 1955

C  
El Paso Natural Gas Company  
El Paso, Texas

Attention: Mr. R. L. Hamblin

Administrative Order NWU-98

Gentlemen:

Reference is made to your application for approval of a 313.00-acre non-standard gas proration unit in the Blanco-Mesaverde Gas Pool consisting of the following acreage:

Township 28 North, Range 8 West, NMPM  
N/2 of Section 19

It is understood that this unit is to be ascribed to your Florance Well No. 1-C, located 990 feet from the North line and 990 feet from the East line of Section 19, Township 28 North, Range 8 West, NMPM, San Juan County, New Mexico.

By authority granted me under provisions of Rule 1, Section (b) of the Special Rules and Regulations for the Blanco-Mesaverde Gas Pool, as set forth in Order R-128-C, you are hereby authorized to operate the above described acreage as a non-standard gas proration unit, with allowable to be assigned thereto in accordance with pool rules, based upon the unit size of 313.00 acres.

Very truly yours,

W. B. MACZY,  
Secretary-Director

WBM/ir

District I  
PO Box 1980, Hobbs, NM 88241-1980  
District II  
PO Drawer 11D, Artesia, NM 88211-0719  
District III  
1000 Rio Brazos Rd., Aztec, NM 87410  
District IV  
PO Box 2088, Santa Fe, NM 87504-2088

State of New Mexico  
Energy, Minerals & Natural Resources  
Department

97948301  
Form C-104  
Revised February 21, 1994  
Instructions on back  
Submit to Appropriate District Office  
5 Copies

OIL CONSERVATION DIVISION

PO Box 2088  
Santa Fe, NM 87504-2088

SEP 27 1995 8 52 AM  
AMENDED REPORT

I. REQUEST FOR ALLOWABLE AND AUTHORIZATION TO TRANSPORT

<sup>1</sup> Operator name and Address  AMOCO PRODUCTION COMPANY 200 AMOCO COURT FARMINGTON, NM 87401		<sup>2</sup> OGRID Number 000778  <sup>3</sup> Reason for Filing Code CO
<sup>4</sup> API Number 300452325700	<sup>5</sup> Pool Name BASIN-DAKOTA-GAS	<sup>6</sup> Pool Code 071599
<sup>7</sup> Property Code 000323	<sup>8</sup> Property Name BOLACK 2&2M	<sup>9</sup> Well Number 2

II. <sup>10</sup>Surface Location

UI or lot no. G	Section 0019	Township 028	Range 008	Lot.Idn	Feet from the 2430	North/South Line N	Feet from the 1650	East/West Line E	County SAN JUAN
--------------------	-----------------	-----------------	--------------	---------	-----------------------	-----------------------	-----------------------	---------------------	--------------------

<sup>11</sup>Bottom Hole Location

UI or lot no.	Section	Township	Range	Lot.Idn	Feet from the	North/South Line	Feet from the	East/West Line	County
<sup>12</sup> Lse Code F	<sup>13</sup> Producing Method Code		<sup>14</sup> Gas Connection Date		<sup>15</sup> C-129 Permit Number		<sup>16</sup> C-129 Effective Date		<sup>17</sup> C-129 Expiration Date

III. Oil and Gas Transporters

<sup>18</sup> Transporter OGRID	<sup>19</sup> Transporter Name and Address	<sup>20</sup> POD	<sup>21</sup> O/G	<sup>22</sup> POD ULSTR Location and Description
9018	GIANT REFINING BOX 12999 SCOTTSDALE AZ 85267	0079610	O	
7057	EPNG P.O. BOX 4990 FARMINGTON NM 87499	0079630	G	

IV. Produced Water

<sup>23</sup> POD	<sup>24</sup> POD ULSTR Location and Description
-------------------	--

V. Well Completion Data

<sup>25</sup> Spud Date	<sup>26</sup> Ready Date	<sup>27</sup> TD	<sup>28</sup> PBTD	<sup>29</sup> Perforations
<sup>30</sup> Hole Size	<sup>31</sup> Casing & Tubing Size	<sup>32</sup> Depth Set	<sup>33</sup> Sacks Cement	

VI. Well Test Data

<sup>34</sup> Date New Oil	<sup>35</sup> Gas Delivery Date	<sup>36</sup> Test Date	<sup>37</sup> Test Length	<sup>38</sup> Tbg. Pressure	<sup>39</sup> Csg. Pressure
<sup>40</sup> Choke Size	<sup>41</sup> Oil	<sup>42</sup> Water	<sup>43</sup> Gas	<sup>44</sup> AOF	<sup>45</sup> Test Method
<sup>46</sup> I hereby certify that the rules of the Oil Conservation Division have been complied with and that the information given above is true and complete to the best of my knowledge and belief.  Signature: J. P. Shaheen Printed Name: J. P. SHAHEEN Title: SENIOR BUSINESS ANALYST Date: 9/27/95			OIL CONSERVATION DIVISION  Approved by: <i>J.P.S.</i> Title: SUPERVISOR DISTRICT #3 Approval Date: SEP 27 1995 Phone: (505) 326-9413		



DISTRICT II  
P.O. Drawer DD, Artesia, NM 88210

## OIL CONSERVATION DIVISION

P.O. Box 2088  
Santa Fe, New Mexico 87504-2088

DISTRICT III  
1000 Rio Brazos Rd., Aztec, NM 87410

### REQUEST FOR ALLOWABLE AND AUTHORIZATION TO TRANSPORT OIL AND NATURAL GAS

I.

Operator <b>AMOCO PRODUCTION COMPANY</b>	Well API No. <b>300452325700</b>
Address <b>P.O. BOX 800, DENVER, COLORADO 80201</b>	
Reason(s) for Filing (Check proper box) <input type="checkbox"/> Other (Please explain)	
New Well <input type="checkbox"/>	Change in Transporter of:
Recompletion <input type="checkbox"/>	Oil <input checked="" type="checkbox"/> Dry Gas <input type="checkbox"/>
Change in Operator <input type="checkbox"/>	Casinghead Gas <input type="checkbox"/> Condensate <input type="checkbox"/>
If change of operator give name and address of previous operator	

### II. DESCRIPTION OF WELL AND LEASE

Lease Name <b>BOLACK</b>	Well No. <b>2</b>	Pool Name, Including Formation <b>BASIN DAKOTA (PRORATED GAS)</b>	Kind of Lease State, Federal or Fee	Lease No.
Location Unit Letter <b>G</b> : <b>2430</b> Feet From The <b>FNL</b> Line and <b>1650</b> Feet From The <b>FEL</b> Line Section <b>19</b> Township <b>28N</b> Range <b>8W</b> , <b>NMPM</b> , <b>SAN JUAN</b> County				

### III. DESIGNATION OF TRANSPORTER OF OIL AND NATURAL GAS

Name of Authorized Transporter of Oil <input type="checkbox"/> or Condensate <input type="checkbox"/> <b>MERIDIAN OIL INC.</b>	Address (Give address to which approved copy of this form is to be sent) <b>3535 EAST 30TH STREET, FARMINGTON, NM 87401</b>	
Name of Authorized Transporter of Casinghead Gas <input type="checkbox"/> or Dry Gas <input type="checkbox"/> <b>EL PASO NATURAL GAS COMPANY</b>	Address (Give address to which approved copy of this form is to be sent) <b>P.O. BOX 1492, EL PASO, TX 79978</b>	
If well produces oil or liquids, give location of tanks.	Unit	Sec.
	Twp.	Rge.
		Is gas actually connected? When?

If this production is commingled with that from any other lease or pool, give commingling order number:

### IV. COMPLETION DATA

Designate Type of Completion - (X)	Oil Well	Gas Well	New Well	Workover	Deepen	Plug Back	Same Res'v	Diff Res'v
Date Spudded	Date Compl. Ready to Prod.		Total Depth		P.B.T.D.			
Elevations (DF, RKB, RT, GR, etc.)	Name of Producing Formation		Top Oil/Gas Pay		Tubing Depth			
Perforations					Depth Casing Shoe			
TUBING, CASING AND CEMENTING RECORD								
HOLE SIZE	CASING & TUBING SIZE		DEPTH SET		CEMENT			
					<b>RECEIVED</b>			
					<b>AUG 23 1990</b>			

### V. TEST DATA AND REQUEST FOR ALLOWABLE

OIL WELL (Test must be after recovery of total volume of load oil and must be equal to or exceed top all depth for full 24 hours.)

Date First New Oil Run To Tank	Date of Test	Producing Method (Flow, pump, gas lift, etc.)	
Length of Test	Tubing Pressure	Casing Pressure	Choke Size
Actual Prod. During Test	Oil - Bbls.	Water - Bbls.	Gas - MCF

### GAS WELL

Actual Prod. Test - MCF/D	Length of Test	Bbls. Condensate/MMCF	Gravity of Condensate
Testing Method (pilot, back pr.)	Tubing Pressure (Shut-in)	Casing Pressure (Shut-in)	Choke Size

### VI. OPERATOR CERTIFICATE OF COMPLIANCE

I hereby certify that the rules and regulations of the Oil Conservation Division have been complied with and that the information given above is true and complete to the best of my knowledge and belief.

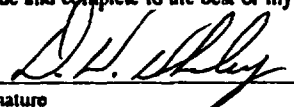
  
Signature  
**Doug W. Whaley, Staff Admin. Supervisor**  
Printed Name  
Title  
**July 5, 1990**  
Date  
**303-830-4280**  
Telephone No.

OIL CONSERVATION DIVISION  
**AUG 23 1990**

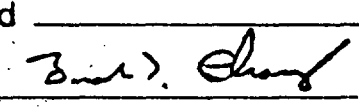
Date Approved  
By   
Title  
**SUPERVISOR DISTRICT #3**

INSTRUCTIONS: This form is to be filed in compliance with Rule 1104

- 1) Request for allowable for newly drilled or deepened well must be accompanied by tabulation of deviation tests taken in accordance with Rule 111.
- 2) All sections of this form must be filled out for allowable on new and recompleted wells.
- 3) Fill out only Sections I, II, III, and VI for changes of operator, well name or number, transporter, or other such changes.
- 4) Separate Form C-104 must be filed for each pool in multiply completed wells.

OIL CONSERVATION DIVISION

P.O. Box 2088  
Santa Fe, New Mexico 87504-2088

REQUEST FOR ALLOWABLE AND AUTHORIZATION  
TO TRANSPORT OIL AND NATURAL GAS

I.

Operator <b>Amoco Production Company</b>	Well API No. <b>3004523257</b>
Address <b>1670 Broadway, P. O. Box 800, Denver, Colorado 80201</b>	
Reason(s) for filing (Check proper box) <input type="checkbox"/> Other (Please explain)	
New Well <input type="checkbox"/>	Change in Transporter of: <input type="checkbox"/>
Recompletion <input type="checkbox"/>	Oil <input type="checkbox"/> Dry Gas <input type="checkbox"/>
Change in Operator <input checked="" type="checkbox"/>	Casinghead Gas <input type="checkbox"/> Condensate <input type="checkbox"/>
If change of operator give name and address of previous operator <b>Tenneco Oil E &amp; P, 6162 S. Willow, Englewood, Colorado 80155</b>	

**RECEIVED**  
**JUN 14 1989**  
**OIL CONSERVATION DIV.**  
**SANTA FE**

II. DESCRIPTION OF WELL AND LEASE

Lease Name <b>BOLACK</b>	Well No. <b>2</b>	Pool Name, Including Formation <b>BASIN (DAKOTA)</b>	FEDERAL	Lease No. <b>NM003549</b>
Location				
Unit Letter <b>G</b>	<b>2430</b>	Feet From The <b>FNL</b>	Line and <b>1650</b>	Feet From The <b>FEL</b>
Section <b>19</b>	Township <b>28N</b>	Range <b>8W</b>	<b>NMPM, SAN JUAN</b>	County

III. DESIGNATION OF TRANSPORTER OF OIL AND NATURAL GAS

Name of Authorized Transporter of Oil <input type="checkbox"/> or Condensate <input checked="" type="checkbox"/>	Address (Give address to which approved copy of this form is to be sent) <b>P. O. BOX 1429, BLOOMFIELD, NM 87413</b>
Name of Authorized Transporter of Casinghead Gas <input type="checkbox"/> or Dry Gas <input checked="" type="checkbox"/>	Address (Give address to which approved copy of this form is to be sent) <b>P. O. BOX 1492, EL PASO, TX 79978</b>
If well produces oil or liquids, give location of tanks.	Unit   Sec.   Twp.   Rge.   Is gas actually connected?   When ?

If this production is commingled with that from any other lease or pool, give commingling order number:

IV. COMPLETION DATA

Designate Type of Completion - (X)	Oil Well	Gas Well	New Well	Workover	Deepen	Plug Back	Same Res'v	Diff Res'v
Date Spudded	Date Compl. Ready to Prod.		Total Depth		P.B.T.D.			
Elevations (DF, RKB, RT, GR, etc.)	Name of Producing Formation		Top Oil/Gas Pay		Tubing Depth			
Perforations					Depth Casing Shoe			
TUBING, CASING AND CEMENTING RECORD								
HOLE SIZE	CASING & TUBING SIZE		DEPTH SET		SACKS CEMENT			

V. TEST DATA AND REQUEST FOR ALLOWABLE

OIL WELL (Test must be after recovery of total volume of load oil and must be equal to or exceed top allowable for this depth or be for full 24 hours.)

Date First New Oil Run To Tank	Date of Test	Producing Method (Flow, pump, gas lift, etc.)	
Length of Test	Tubing Pressure	Casing Pressure	Choke Size
Actual Prod. During Test	Oil - Bbls.	Water - Bbls.	Gas - MCF

GAS WELL

Actual Prod. Test - MCF/D	Length of Test	Bbls. Condensate/MMCF	Gravity of Condensate
Testing Method (pilot, back pr.)	Tubing Pressure (Shut-in)	Casing Pressure (Shut-in)	Choke Size

VI. OPERATOR CERTIFICATE OF COMPLIANCE

I hereby certify that the rules and regulations of the Oil Conservation Division have been complied with and that the information given above is true and complete to the best of my knowledge and belief.

*J. L. Hampton*

Signature  
**J. L. Hampton** Sr. Staff Admin. Suprv.  
Printed Name  
**Janaury 16, 1989** 303-830-5025  
Date Telephone No.

OIL CONSERVATION DIVISION

Date Approved **MAY 08 1989**  
By *[Signature]*  
Title **SUPERVISION DISTRICT #3**

INSTRUCTIONS: This form is to be filed in compliance with Rule 1104

- 1) Request for allowable for newly drilled or deepened well must be accompanied by tabulation of deviation tests taken in accordance with Rule 111.
- 2) All sections of this form must be filled out for allowable on new and recompleted wells.
- 3) Fill out only Sections I, II, III, and VI for changes of operator, well name or number, transporter, or other such changes.
- 4) Separate Form C 104 must be filed for each pool in multiply completed wells.

DISTRIBUTION		
SANTA FE		
FILE		
U.S.G.S.		
LAND OFFICE		
TRANSPORTER	OIL	
	GAS	
OPERATOR		
PRORATION OFFICE		

NEW MEXICO OIL CONSERVATION COMMISSION  
REQUEST FOR ALLOWABLE  
AND  
AUTHORIZATION TO TRANSPORT OIL AND NATURAL GAS

Form C-104  
Supersedes Old C-104 and C-  
Effective 1-1-65

1. Operator  
Tenneco Oil Company  
Address  
720 So. Colorado Blvd., Denver, Colorado 80222

Reason(s) for filing (Check proper box)  
New Well ☐  
Recompletion ☐  
Change in Ownership ☐  
Change in Transporter of:  
Oil ☐  
Casinghead Gas ☐

Other (Please explain)

If change of ownership give name  
and address of previous owner

II. DESCRIPTION OF WELL AND LEASE

\*NM 03549

Lease Name Bolack	Well No. 2	Pool Name, Including Formation Basin Dakota	Kind of Lease State, Federal or Fee Federal	Lease No. *
Location Unit Letter G ; 2430 Feet From The North Line and 1650 Feet From The East Line of Section 19 Township 28N Range 8W , NMPM, San Juan County				

III. DESIGNATION OF TRANSPORTER OF OIL AND NATURAL GAS

Name of Authorized Transporter of Oil <input type="checkbox"/> or Condensate <input checked="" type="checkbox"/> Giant Refining Co.	Address (Give address to which approved copy of this form is to be sent) Box 256, Farmington, New Mexico 87401					
Name of Authorized Transporter of Casinghead Gas <input type="checkbox"/> or Dry Gas <input type="checkbox"/> EPG	Address (Give address to which approved copy of this form is to be sent)					
If well produces oil or liquids, give location of tanks.	Unit G	Sec. 19	Twp. 28N	Rge. 8W	Is gas actually connected? Yes	When 6/25/79

If this production is commingled with that from any other lease or pool, give commingling order number:

IV. COMPLETION DATA

Designate Type of Completion - (X)	Oil Well	Gas Well	New Well	Workover	Deepen	Plug Back	Same Res'v.	Diff. Res'v.
Date Spudded	Date Compl. Ready to Prod.		Total Depth		P.B.T.D.			
Elevations (DF, RKB, RT, GR, etc.)	Name of Producing Formation		Top Oil/Gas Pay		Tubing Depth			
Perforations					Depth Casing Shoe			

TUBING, CASING, AND CEMENTING RECORD

HOLE SIZE	CASING & TUBING SIZE	DEPTH SET	SACKS CEMENT

V. TEST DATA AND REQUEST FOR ALLOWABLE OIL WELL

(Test must be after recovery of total volume of load oil and must be equal to or exceed top allowable for this depth or be for full 24 hours)

Date First New Oil Run To Tanks	Date of Test	Producing Method (Flow, pump, gas lift, etc.)	
Length of Test	Tubing Pressure	Casing Pressure	Choke Size
Actual Prod. During Test	Oil-Bbls.	Water-Bbls.	Gas-MCF

GAS WELL

Actual Prod. Test-MCF/D	Length of Test	Bbls. Condensate/MMCF	Gravity of Condensate
Testing Method (pitot, back pr.)	Tubing Pressure (Shut-in)	Casing Pressure (Shut-in)	Choke Size

VI. CERTIFICATE OF COMPLIANCE

I hereby certify that the rules and regulations of the Oil Conservation Commission have been complied with and that the information given above is true and complete to the best of my knowledge and belief.

*Curly Watkins*  
(Signature)

Administrative Supervisor  
(Title)

7/18/79  
(Date)

OIL CONSERVATION COMMISSION

APPROVED JUL 20 1979

BY *AR Kendrick*

TITLE *ADMIN. SUPERVISOR*

This form is to be filed in compliance with RULE 1104.

If this is a request for allowable for a newly drilled or deepened well, this form must be accompanied by a tabulation of the deviation tests taken on the well in accordance with RULE 111.

All sections of this form must be filled out completely for allowable on new and recompleted wells.

Fill out only Sections I, II, III, and VI for changes of owner well name or number, or transporter, or other such change of condition. Separate Forms C-104 must be filed for each pool in multiple.

EL PASO NATURAL GAS COMPANY  
POST OFFICE BOX 990  
FARMINGTON, NEW MEXICO

NOTICE OF GAS CONNECTION

DATE July 5, 1979

THIS IS TO NOTIFY THE OIL CONSERVATION COMMISSION THAT CONNECTION FOR PURCHASE OF

GAS FROM Tenneco Oil Company  
OperatorBolack #2  
Well Name90-581-01  
Meter Code22540  
Site CodeG  
Well Unit19-28-8  
S-T-RBasin Dakota  
PoolEl Paso Natural Gas Company  
Name of PurchaserWAS MADE ON June 22, 1979  
DateFIRST DELIVERY June 25, 1979  
DateAOF 2,301CHOKE 2,216El Paso Natural Gas Company  
Purchaser  
RepresentativeChief Dispatcher  
Titlecc: Operator **Houston & Denver**  
Oil Conservation Commission - 2  
Proration - El Paso

File



NO. OF COPIES RECEIVED	
DISTRIBUTION	6
SANTA FE	1
FILE	
U.S.G.S.	
LAND OFFICE	
TRANSPORTER	OIL GAS
OPERATOR	2
PRORATION OFFICE	

NEW MEXICO OIL CONSERVATION COMMISSION  
REQUEST FOR ALLOWABLE  
AND  
AUTHORIZATION TO TRANSPORT OIL AND NATURAL GAS

Form C-104  
Supersedes Old C-104 and C  
Effective 1-1-65

API 30-045-23357

I. Operator  
Tenneco Oil Company  
Address  
720 So. Colorado Blvd., Denver, Colorado 80222  
Reason(s) for filing (Check proper box)  
New Well ☒ Change in Transporter of:  
Recompletion ☐ Oil ☐ Dry Gas ☐  
Change in Ownership ☐ Casinghead Gas ☐ Condensate ☐  
Other (Please explain)  
If change of ownership give name and address of previous owner

II. DESCRIPTION OF WELL AND LEASE

OIL CONSERVATION COMMISSION  
DISTRICT 3  
\*NM 03549

Lease Name	Well No.	Pool Name, Including Formation	Kind of Lease	Lease No.
Bolack	2	Dakota	State, Federal or Fee Federal	*
Location Unit Letter G ; 2430 Feet From The North Line and 1650 Feet From The East Line of Section 19 Township 28-N Range 8-W , NMPM, San Juan County				

III. DESIGNATION OF TRANSPORTER OF OIL AND NATURAL GAS

Name of Authorized Transporter of Oil <input type="checkbox"/> or Condensate <input checked="" type="checkbox"/>	Address (Give address to which approved copy of this form is to be sent)
Permian, Corp.	1700 Broadway, Denver, Co. 80290
Name of Authorized Transporter of Casinghead Gas <input type="checkbox"/> or Dry Gas <input checked="" type="checkbox"/>	Address (Give address to which approved copy of this form is to be sent)
El Paso Natural Gas Co.	Box 990, Farmington, New Mexico 87401
If well produces oil or liquids, give location of tanks.	Unit Sec. Twp. Rge. Is gas actually connected? When
G 19 28-N 8-W	No ASAP

If this production is commingled with that from any other lease or pool, give commingling order number:

IV. COMPLETION DATA

Designate Type of Completion - (X)	Oil Well	Gas Well	New Well	Workover	Deepen	Plug Back	Same Res'v.	Diff. Res'
		X	X					
Date Spudded	Date Compl. Ready to Prod.	Total Depth	P.B.T.D.					
11/27/78	4/19/79	6717'	6700'					
Elevations (DF, RKB, RT, GR, etc.)	Name of Producing Formation	Top Oil/Gas Pay	Tubing Depth					
5838' GR	Dakota	6525'	6561'					
Perforations	Depth Casing Shoe							
25 holes from 2525'-6550'; 22 holes from 6593'-6662'								
TUBING, CASING, AND CEMENTING RECORD								
HOLE SIZE	CASING & TUBING SIZE	DEPTH SET	SACKS CEMENT					
13 3/4"	9 5/8"	281'	250					
8 3/4"	4 1/2"	6714'	1350					
8 3/4"	2 3/8"	6561'						

V. TEST DATA AND REQUEST FOR ALLOWABLE OIL WELL

(Test must be after recovery of total volume of load oil and must be equal to or exceed top allowable for this depth or be for full 24 hours)

Date First New Oil Run To Tanks	Date of Test	Producing Method (Flow, pump, gas lift, etc.)	
Length of Test	Tubing Pressure	Casing Pressure	Choke Size
Actual Prod. During Test	Oil-Bbls.	Water-Bbls.	Gas-Bbls.

GAS WELL

Actual Prod. Test-MCF/D	Length of Test	Bbls. Condensate/MMCF	Gravity of Condensate
2301	3 hrs.		
Testing Method (pilot, back pr.)	Tubing Pressure (Shut-in)	Casing Pressure (Shut-in)	Choke Size
back pressure	2100	2100	3/4"

VI. CERTIFICATE OF COMPLIANCE

I hereby certify that the rules and regulations of the Oil Conservation Commission have been complied with and that the information given above is true and complete to the best of my knowledge and belief.

Carley Shattuck  
(Signature)  
Administrative Supervisor  
(Title)  
5/28/79  
(Date)

OIL CONSERVATION COMMISSION

APPROVED MAY 29 1979

BY W. R. Rendrick  
SUPERVISOR DISTRICT 3

TITLE

This form is to be filed in compliance with RULE 1104.  
If this is a request for allowable for a newly drilled or deepened well, this form must be accompanied by a tabulation of the deviation tests taken on the well in accordance with RULE 111.  
All sections of this form must be filled out completely for allowable on new and recompleted wells.  
Fill out only Sections I, II, III, and VI for changes of owner, well name or number, or transporter, or other such change of condition.  
Separate Forms C-104 must be filed for each pool in multiple completed wells.

# INSTRUCTIONS

**General:** This form is designed for submitting a complete and correct well completion report and log on all types of lands and leases to either a Federal agency or a State agency, or both, pursuant to applicable Federal and/or State laws and regulations. Any necessary special instructions concerning the use of this form and the number of copies to be submitted, particularly with regard to local, area, or regional procedures and practices, either are shown below or will be issued by, or may be obtained from, the local Federal and/or State office. See instructions on items 22 and 24, and 33, below regarding separate reports for separate completions. If not filed prior to the time this summary record is submitted, copies of all currently available logs (drillers, geologists, sample and core analysis, all types electric, etc.), formation and pressure tests, and directional surveys, should be attached hereto, to the extent required by applicable Federal and/or State laws and regulations. All attachments should be listed on this form, see item 35.

**Item 4:** If there are no applicable State requirements, locations on Federal or Indian land should be described in accordance with Federal requirements. Consult local State or Federal office for specific instructions.

**Item 18:** Indicate which elevation is used as reference (where not otherwise shown) for depth measurements given in other spaces on this form and in any attachments. **Items 22 and 24:** If this well is completed for separate production from more than one interval zone (multiple completion), so state in item 22, and in item 24 show the producing interval, or intervals, top(s), bottom(s) and name(s) (if any) for only the interval reported in item 33. Submit a separate report (page) on this form, adequately identified, for each additional interval to be separately produced, showing the additional data pertinent to such interval.

**Item 29: "Sacks Cement":** Attached supplemental records for this well should show the details of any multiple stage cementing and the location of the cementing tool.

**Item 33:** Submit a separate completion report on this form for each interval to be separately produced. (See instruction for items 22 and 24 above.)

## 37. SUMMARY OF POROUS ZONES:

SHOW ALL IMPORTANT ZONES OF POROSITY AND CONTENTS THEREOF; CORED INTERVALS; AND ALL DRILL-STEM TESTS, INCLUDING DEPTH INTERVAL TESTED, CUSHION USED, TIME TOOL OPEN, FLOWING AND SHUT-IN PRESSURES, AND RECOVERIES

FORMATION	TOP	BOTTOM	DESCRIPTION, CONTENTS, ETC.
Pictured Cliffs	2170	2220	Gas
Cliffhouse	3830	3904	Gas
Menefee	3904	4436	Gas
Point Lookout	4436	4600	Water
Gallup	5592		
Dakota	6524		Gas

## 38. GEOLOGIC MARKERS

NAME	MEAS. DEPTH	TOP	TRUE VERT. DEPTH
Greenhorn	6336		

UNITED STATES  
DEPARTMENT OF THE INTERIOR  
GEOLOGICAL SURVEY

SUBMIT IN DUPLICATE\*

(See other in-  
structions on  
reverse side)Form approved.  
Budget Bureau No. 42-R355.5.

## WELL COMPLETION OR RECOMPLETION REPORT AND LOG \*

1a. TYPE OF WELL:		OIL WELL <input type="checkbox"/>	GAS WELL <input checked="" type="checkbox"/>	DRY <input type="checkbox"/>	Other _____		
b. TYPE OF COMPLETION:		NEW WELL <input checked="" type="checkbox"/>	WORK OVER <input type="checkbox"/>	DEEP-EN <input type="checkbox"/>	PLUG BACK <input type="checkbox"/>	DIFF. RESVR. <input type="checkbox"/>	Other _____
2. NAME OF OPERATOR Tenneco Oil Company						5. LEASE DESIGNATION AND SERIAL NO. NM 03549	
3. ADDRESS OF OPERATOR 720 So. Colorado Blvd., Denver, Colorado 80222						6. IF INDIAN, ALLOTTEE OR TRIBE NAME	
4. LOCATION OF WELL (Report location clearly and in accordance with any State requirements)* At surface 2430' FNL & 1650' FEL, Unit G At top prod. interval reported below At total depth						7. UNIT AGREEMENT NAME	
14. PERMIT NO.						DATE ISSUED	
15. DATE SPURRED 11/27/78						16. DATE T.D. REACHED 12/15/78	
17. DATE COMPL. (Ready to prod.) 4/19/79						18. ELEVATIONS (DF, REB, RT, GE, ETC.)* 5838' GR	
19. ELEV. CASINGHEAD						20. TOTAL DEPTH, MD & TVD 6717'	
21. PLUG, BACK T.D., MD & TVD 6700'						22. IF MULTIPLE COMPL., HOW MANY*	
23. INTERVALS DRILLED BY →						ROTARY TOOLS 0-TD	
24. PRODUCING INTERVAL(S), OF THIS COMPLETION—TOP, BOTTOM, NAME (MD AND TVD)* 6525-6662 (Dakota)						25. WAS DIRECTIONAL SURVEY MADE Yes	
26. TYPE ELECTRIC AND OTHER LOGS RUN Gamma Ray, Induction, SP, Density, Neutron and Caliper						27. WAS WELL CORED No	
28. CASING RECORD (Report all strings set in well)							
CASING SIZE		WEIGHT, LB./FT.		DEPTH SET (MD)		HOLE SIZE	
9 5/8"		36#		281'		13 3/4"	
4 1/2"		10.5#		6714'		8 3/4"	
29. LINER RECORD							
SIZE		TOP (MD)		BOTTOM (MD)		SACKS CEMENT*	
None							
30. TUBING RECORD							
SIZE		DEPTH SET (MD)		PACKER SET (MD)			
2 3/8"		6561'		6561'			
31. PERFORATION RECORD (Interval, size and number)							
25 holes from 6525' - 6550'							
22 holes from 6593' - 6662'							
32. ACID, SHOT, FRACTURE, CEMENT SQUEEZE, ETC.							
DEPTH INTERVAL (MD)				AMOUNT AND KIND OF MATERIAL USED			
6525-6662				1000 gal 15% HCL			
33.* PRODUCTION							
DATE FIRST PRODUCTION		PRODUCTION METHOD (Flowing, gas lift, pumping—size and type of pump) Flowing				WELL STATUS (Producing or shut-in) Shut In	
DATE OF TEST 5/2/79		HOURS TESTED 3 hrs.		CHOKE SIZE 3/4"		PROD'N. FOR TEST PERIOD →	
FLOW. TUBING PRESS. 154		CASING PRESSURE 454		CALCULATED 24-HOUR RATE →		OIL—BBL. GAS—MCF. Q=2216	
34. DISPOSITION OF GAS (Sold, used for fuel, vented, etc.) Will be sold pending hook-up		OIL—BBL. GAS—MCF. CAOF = 2301		WATER—BBL. GAS—MCF. Q=2216		WATER—BBL. GAS—MCF. Q=2216	
35. LIST OF ATTACHMENTS Two copies of electric logs forwarded by Dresser Atlas & Bluejet, Inc.							
36. I hereby certify that the foregoing and attached information is complete and correct as determined from all available records.							
SIGNED Carley Statterman		TITLE Administrative Supervisor				DATE 5/22/79	

\*(See Instructions and Spaces for Additional Data on Reverse Side)

UNITED STATES  
DEPARTMENT OF THE INTERIOR  
GEOLOGICAL SURVEY

SUBMIT IN DUPLICATE\*

(See other in-  
structions on  
reverse side)Form approved.  
Budget Bureau No. 42-R355.5.

## WELL COMPLETION OR RECOMPLETION REPORT AND LOG \*

1a. TYPE OF WELL:		OIL WELL <input type="checkbox"/>	GAS WELL <input checked="" type="checkbox"/>	DRY <input type="checkbox"/>	Other _____		
b. TYPE OF COMPLETION:		NEW WELL <input checked="" type="checkbox"/>	WORK OVER <input type="checkbox"/>	DEEP-EN <input type="checkbox"/>	PLUG BACK <input type="checkbox"/>	DIFF. RESVR. <input type="checkbox"/>	Other _____
2. NAME OF OPERATOR Tenneco Oil Company						5. LEASE DESIGNATION AND SERIAL NO. NM 03549	
3. ADDRESS OF OPERATOR 720 So. Colorado Blvd., Denver, Colorado 80222						6. IF INDIAN, ALLOTTEE OR TRIBE NAME	
4. LOCATION OF WELL (Report location clearly and in accordance with any State requirements)* At surface 2430' FNL & 1650' FEL, Unit G At top prod. interval reported below At total depth						7. UNIT AGREEMENT NAME	
14. PERMIT NO. _____ DATE ISSUED _____						8. FARM OR LEASE NAME Bolack	
15. DATE SPUDDED 11/27/78						9. WELL NO. 2	
16. DATE T.D. REACHED 12/15/78						10. FIELD AND POOL, OR WILDCAT Dakota	
17. DATE COMPL. (Ready to prod.) 4/19/79						11. SEC., T., R., M., OR BLOCK AND SURVEY OR AREA Sec. 19, T-28-N, R-8-W	
18. ELEVATIONS (DF, REB, RT, GR, ETC.)* 5838' GR						12. COUNTY OR PARISH San Juan	
19. ELEV. CASINGHEAD						13. STATE New Mexico	
20. TOTAL DEPTH, MD & TVD 6717'		21. PLUG, BACK T.D., MD & TVD 6700'		22. IF MULTIPLE COMPL., HOW MANY*		23. INTERVALS DRILLED BY O-TD	
24. PRODUCING INTERVAL(S), OF THIS COMPLETION—TOP, BOTTOM, NAME (MD AND TVD)* 6525-6662 (Dakota)						25. WAS DIRECTIONAL SURVEY MADE Yes	
26. TYPE ELECTRIC AND OTHER LOGS RUN Gamma Ray, Induction, SP, Density, Neutron and Caliper						27. WAS WELL CORED No	
28. CASING RECORD (Report all strings set in well)							
CASINO SIZE		WEIGHT, LB./FT.		DEPTH SET (MD)		HOLE SIZE	
9 5/8"		36#		281'		13 3/4"	
4 1/2"		10.5#		6714'		8 3/4"	
29. LINER RECORD							
SIZE		TOP (MD)		BOTTOM (MD)		SACKS CEMENT*	
None							
30. TUBING RECORD							
SIZE		DEPTH SET (MD)		PACKER SET (MD)			
2 3/8"		6561'		6561'			
31. PERFORATION RECORD (Interval, size and number)							
25 holes from 6525' - 6550' 22 holes from 6593' - 6662'							
32. ACID, SHOT, FRACTURE, CEMENT SQUEEZE, ETC.							
DEPTH INTERVAL (MD)				AMOUNT AND KIND OF MATERIAL USED			
6525-6662				1000 gal 15% HCL			
33. PRODUCTION							
DATE FIRST PRODUCTION		PRODUCTION METHOD (Flowing, gas lift, pumping—size and type of pump) Flowing					
DATE OF TEST 5/2/79		HOURS TESTED 3 hrs.		CHOKE SIZE 3/4"		PROD'N. FOR TEST PERIOD OIL—BBL. GAS—MCF. WATER—BBL. OIL GRAVITY-API (CORR.)	
FLOW. TUBING PRESS. 154		CASING PRESSURE 454		CALCULATED 24-HOUR RATE CAOF = 2301		GAS-OIL RATIO	
34. DISPOSITION OF GAS (Sold, used for fuel, vented, etc.) Will be sold pending hook-up							
35. LIST OF ATTACHMENTS Two copies of electric logs forwarded by Dresser Atlas & Bluejet, Inc.							
36. I hereby certify that the foregoing and attached information is complete and correct as determined from all available records.							
SIGNED Carley Statterman		TITLE Administrative Supervisor				DATE 5/22/79	

\*(See Instructions and Spaces for Additional Data on Reverse Side)

NMOC



# INSTRUCTIONS

**General:** This form is designed for submitting a complete and correct well completion report and log on all types of lands and leases to either a Federal agency or a State agency, or both, pursuant to applicable Federal and/or State laws and regulations. Any necessary special instructions concerning the use of this form and the number of copies to be submitted, particularly with regard to local, area, or regional procedures and practices, either are shown below or will be issued by, or may be obtained from, the local Federal and/or State office. See instructions on items 22 and 24, and 33, below regarding separate reports for separate completions.

If not filed prior to the time this summary record is submitted, copies of all currently available logs (drillers, geologists, sample and core analysis, all types electric, etc.), formation and pressure tests, and directional surveys, should be attached hereto, to the extent required by applicable Federal and/or State laws and regulations. All attachments should be listed on this form, see item 35.

**Item 4:** If there are no applicable State requirements, locations on Federal or Indian land should be described in accordance with Federal requirements. Consult local State or Federal office for specific instructions.

**Item 18:** Indicate which elevation is used as reference (where not otherwise shown) for depth measurements given in other spaces on this form and in any attachments.

**Items 22 and 24:** If this well is completed for separate production from more than one interval zone (multiple completion), so state in item 22, and in item 24 show the producing interval, or intervals, top(s), bottom(s) and name(s) (if any) for only the interval reported in item 33. Submit a separate report (page) on this form, adequately identified, for each additional interval to be separately produced, showing the additional data pertinent to such interval.

**Item 29: "Sacks Cement":** Attached supplemental records for this well should show the details of any multiple stage cementing and the location of the cementing tool.

**Item 33:** Submit a separate completion report on this form for each interval to be separately produced. (See instruction for items 22 and 24 above.)

37. SUMMARY OF POROUS ZONES: SHOW ALL IMPORTANT ZONES OF POROSITY AND CONTENTS THEREOF; CORED INTERVALS; AND ALL DRILL-STEM TESTS, INCLUDING DEPTH INTERVAL TESTED, CUSHION USED, TIME TOOL OPEN, FLOWING AND SHUT-IN PRESSURES, AND RECOVERIES				38. GEOLOGIC MARKERS	
FORMATION	TOP	BOTTOM	DESCRIPTION, CONTENTS, ETC.	NAME	MEAS. DEPTH TOP TRUE VERT. DEPTH
Pictured Cliffs	2170	2220		Greenhorn	6336
Cliffhouse	3830	3904	Gas		
Menefee	3904	4436	Gas		
Point Lookout	4436	4600	Gas		
Gallup	5592		Water		
Dakota	6524		Gas		

UNITED STATES  
DEPARTMENT OF THE INTERIOR  
GEOLOGICAL SURVEY

**SUNDRY NOTICES AND REPORTS ON WELLS**

(Do not use this form for proposals to drill or to deepen or plug back to a different reservoir. Use Form 9-331-C for such proposals.)

1. oil well ☐ gas well ☒ other ☐

2. NAME OF OPERATOR  
Tenneco Oil Company

3. ADDRESS OF OPERATOR  
720 So. Colo. Blvd., Denver, Co. 80222

4. LOCATION OF WELL (REPORT LOCATION CLEARLY. See space 17 below.)  
AT SURFACE: 2430' FNL & 1650' FEL, Unit G  
AT TOP PROD. INTERVAL:  
AT TOTAL DEPTH:

16. CHECK APPROPRIATE BOX TO INDICATE NATURE OF NOTICE, REPORT, OR OTHER DATA

5. LEASE  
NM 03549

6. IF INDIAN, ALLOTTEE OR TRIBE NAME

7. UNIT AGREEMENT NAME

8. FARM OR LEASE NAME  
Bolack

9. WELL NO.  
2

10. FIELD OR WILDCAT NAME  
Dakota

11. SEC., T., R., M., OR BLK. AND SURVEY OR AREA  
Sec. 19, T-28-N, R-8-W

12. COUNTY OR PARISH  
San Juan

13. STATE  
New Mexico

14. API NO.

15. ELEVATIONS (SHOW DF, KDB, AND WD)  
5838 GR

REQUEST FOR APPROVAL TO:

- TEST WATER SHUT-OFF ☐  
FRACTURE TREAT ☐  
SHOOT OR ACIDIZE ☐  
REPAIR WELL ☐  
PULL OR ALTER CASING ☐  
MULTIPLE COMPLETE ☐  
CHANGE ZONES ☐  
ABANDON\* ☐  
(other) ☐

SUBSEQUENT REPORT OF:

**RECEIVED**  
APR 30 1979  
CONSERVATION DIVISION  
SANTA FE

(NOTE: Report results of multiple completion or zone change on Form 9-330.)

17. DESCRIBE PROPOSED OR COMPLETED OPERATIONS (Clearly state all pertinent details, and give pertinent dates, including estimated date of starting any proposed work. If well is directionally drilled, give subsurface locations and measured and true vertical depths for all markers and zones pertinent to this work.)\*

4/14/79 - 4/19/79

MIRUPU. Pressure tstd 4 1/2" csq to 4000 psi for 30 min. held ok. Spotted 380 gal 7 1/2% HCL Acid. Ran electric log. Perforated the Dakota formation from 6525' - 6550' w/1 JSPF; and 6593' - 6595', 6608' - 6610', 6628' - 6630', 6657' - 6662' w/2 JSPF. Acidized w/1000 gal 15% HCL @ 36 bpm. 3000 psi. Frac well w/97,500 gal water w/11,633# J-10 & 930# 2-C & 13000# KCL, 150# Westbloc 3X, 95000# 20/40 sand, & 20050# of 10/20 sand. Max treating pressure 3500 psi. AIR-2400 psi @ 36 bpm. Used 2353 HHP. ISIP 1500 psi, 15 min SI-1250 psi. Ran 220 jts 2 3/8" tbg & set @ 6561'. NU christmas tree. Released rig.

Subsurface Safety Valve: Manu. and Type \_\_\_\_\_ Ft.

18. I hereby certify that the foregoing is true and correct

SIGNED Carolyn W. Hatten TITLE Admin. Supervisor DATE \_\_\_\_\_

(This space for Federal or State office use)

APPROVED BY \_\_\_\_\_  
CONDITIONS OF APPROVAL, IF ANY:

TITLE \_\_\_\_\_ DATE \_\_\_\_\_

UNITED STATES  
DEPARTMENT OF THE INTERIOR  
GEOLOGICAL SURVEY

**SUNDRY NOTICES AND REPORTS ON WELLS**

(Do not use this form for proposals to drill or to deepen or plug back to a different reservoir. Use Form 9-331-C for such proposals.)

1. oil well ☐ gas well ☒ other ☐

2. NAME OF OPERATOR  
Tenneco Oil Company

3. ADDRESS OF OPERATOR  
720 S. Colorado Blvd., Denver, CO 80222

4. LOCATION OF WELL (REPORT LOCATION CLEARLY. See space 17 below.)  
AT SURFACE: 2430' FNL and 1650' FEL, Unit G  
AT TOP PROD. INTERVAL:  
AT TOTAL DEPTH:

16. CHECK APPROPRIATE BOX TO INDICATE NATURE OF NOTICE, REPORT, OR OTHER DATA

REQUEST FOR APPROVAL TO:

TEST WATER SHUT-OFF ☐

FRACTURE TREAT ☐

SHOOT OR ACIDIZE ☐

REPAIR WELL ☐

PULL OR ALTER CASING ☐

MULTIPLE COMPLETE ☐

CHANGE ZONES ☐

ABANDON\* ☐

(other) ☐

SUBSEQUENT REPORT OF:

☒

☐

☐

☐

☐

☐

☐

☐

5. LEASE  
NM 03549

6. IF INDIAN, ALLOTTEE OR TRIBE NAME

7. UNIT AGREEMENT NAME

8. FARM OR LEASE NAME  
BoJack

9. WELL NO.  
2

10. FIELD OR WILDCAT NAME  
Dakota

11. SEC., T., R., M., OR BLK. AND SURVEY OR AREA  
Sec 19, T28N, R8W

12. COUNTY OR PARISH  
San Juan

13. STATE  
NM

14. API NO.

15. ELEVATIONS (SHOW DF, KDB, AND WD)  
5838 GR

(NOTE: Report results of multiple completion or zone change on Form 9-330.)

17. DESCRIBE PROPOSED OR COMPLETED OPERATIONS (Clearly state all pertinent details, and give pertinent dates, including estimated date of starting any proposed work. If well is directionally drilled, give subsurface locations and measured and true vertical depths for all markers and zones pertinent to this work.)\*

Spudded 13 3/4" hole on 11/27/78 @7:00 pm, and drilled to 285'. Set 9 5/8", 36#, k-55 casing @281'. Cemented with 250 Sx of class "B" cement w/2% CaCl and circulated to surface. Waited on cement 8 hours and tested casing & BOE with 800# for 30 minutes.

Reduced hole to 8 3/4" and continued drilling.

Subsurface Safety Valve: Manu. and Type

Set @ Ft.

18. I hereby certify that the foregoing is true and correct

SIGNED Thomas L. G. Smith TITLE Div. Admin. Supervisor DATE 1-15-79

(This space for Federal or State office use)

APPROVED BY \_\_\_\_\_ TITLE \_\_\_\_\_ DATE \_\_\_\_\_  
CONDITIONS OF APPROVAL, IF ANY:

*nmcc*

\*See Instructions on Reverse Side

UNITED STATES  
DEPARTMENT OF THE INTERIOR  
GEOLOGICAL SURVEY

SUNDRY NOTICES AND REPORTS ON WELLS

(Do not use this form for proposals to drill or to deepen or plug back to a different reservoir. Use Form 9-331-C for such proposals.)

1. oil well ☐ gas well ☒ other
2. NAME OF OPERATOR  
Tenneco Oil Company
3. ADDRESS OF OPERATOR  
720 S. Colorado Blvd., Denver, CO 80222
4. LOCATION OF WELL (REPORT LOCATION CLEARLY. See space 17 below.)  
AT SURFACE: 2430' FNL and 1650' FEL, Unit G  
AT TOP PROD. INTERVAL:  
AT TOTAL DEPTH:
16. CHECK APPROPRIATE BOX TO INDICATE NATURE OF NOTICE, REPORT, OR OTHER DATA

REQUEST FOR APPROVAL TO:		SUBSEQUENT REPORT OF:	
TEST WATER SHUT-OFF	<input type="checkbox"/>		<input checked="" type="checkbox"/>
FRACTURE TREAT	<input type="checkbox"/>		<input type="checkbox"/>
SHOOT OR ACIDIZE	<input type="checkbox"/>		<input type="checkbox"/>
REPAIR WELL	<input type="checkbox"/>		<input type="checkbox"/>
PULL OR ALTER CASING	<input type="checkbox"/>		<input type="checkbox"/>
MULTIPLE COMPLETE	<input type="checkbox"/>		<input type="checkbox"/>
CHANGE ZONES	<input type="checkbox"/>		<input type="checkbox"/>
ABANDON*	<input type="checkbox"/>		<input type="checkbox"/>
(other)	<input type="checkbox"/>		<input type="checkbox"/>

5. LEASE  
NM 03549
6. IF INDIAN, ALLOTTEE OR TRIBE NAME
7. UNIT AGREEMENT NAME
8. FARM OR LEASE NAME  
Bolack
9. WELL NO.  
2
10. FIELD OR WILDCAT NAME  
Dakota
11. SEC., T., R., M., OR BLK. AND SURVEY OR AREA  
Sec 19, T28N, R8W
12. COUNTY OR PARISH  
San Juan
13. STATE  
New Mexico
14. API NO.
15. ELEVATIONS (SHOW DF, KDB, AND WD)  
5838 GR

(NOTE: Report results of multiple completion or zone change on Form 9-330.)

17. DESCRIBE PROPOSED OR COMPLETED OPERATIONS (Clearly state all pertinent details, and give pertinent dates, including estimated date of starting any proposed work. If well is directionally drilled, give subsurface locations and measured and true vertical depths for all markers and zones pertinent to this work.)\*

12-17-78

Drilled 8 3/4 hole to T.D. of 6717'. Logged well and set 158 Jts of 4 1/2", 10#, K-55 casing at 6714'. Set DV tool @4319'. Cemented 1st stage with 550 Sx of 50/50 poz and 6% gel; plug down. Opened stage collar and circulated. Cemented 2nd stage with 800 Sx of 65/35 poz with 12% gel; plug down & released rig.

Subsurface Safety Valve: Manu. and Type

Set @ 11/15/79 Ft.

18. I hereby certify that the foregoing is true and correct

SIGNED Tenneco Oil Company TITLE Div. Admin. Supervisor DATE 1-15-79

(This space for Federal or State office use)

APPROVED BY \_\_\_\_\_ TITLE \_\_\_\_\_ DATE \_\_\_\_\_  
CONDITIONS OF APPROVAL, IF ANY:

UNITED STATES  
DEPARTMENT OF THE INTERIOR  
GEOLOGICAL SURVEY

(Other instructions on  
reverse side)

Budget Bureau No. 42-R1425.

30-045-23257

5. LEASE DESIGNATION AND SERIAL NO.

SF 079232 NM 03549

6. IF INDIAN, ALLOTTEE OR TRIBE NAME

7. UNIT AGREEMENT NAME

8. FARM OR LEASE NAME

Bolack

9. WELL NO.

2

10. FIELD AND POOL, OR WILDCAT

Dakota Basin

11. SEC., T., R., M., OR BLK.  
AND SURVEY OR AREA

Sec. 19, T28N, R8W

12. COUNTY OR PARISH 13. STATE

San Juan

New Mexico

APPLICATION FOR PERMIT TO DRILL, DEEPEN, OR PLUG BACK

1a. TYPE OF WORK

DRILL ☒

DEEPEN ☐

PLUG BACK ☐

b. TYPE OF WELL

OIL  
WELL ☐

GAS  
WELL ☒

OTHER

SINGLE  
ZONE ☐

MULTIPLE  
ZONE ☐

2. NAME OF OPERATOR

Tenneco Oil Company

3. ADDRESS OF OPERATOR

720 South Colorado Blvd., Denver, CO 80222

4. LOCATION OF WELL (Report location clearly and in accordance with any State requirements.)

At surface 2430' FNL, 1650' FEL Unit G  
At proposed prod. zone

14. DISTANCE IN MILES AND DIRECTION FROM NEAREST TOWN OR POST OFFICE\*

See Point 1b Surface Use Plan

15. DISTANCE FROM PROPOSED\*  
LOCATION TO NEAREST  
PROPERTY OR LEASE LINE, FT.  
(Also to nearest drig. unit line, if any)

16. NO. OF ACRES IN LEASE

17. NO. OF ACRES ASSIGNED  
TO THIS WELL

320

18. DISTANCE FROM PROPOSED LOCATION\*  
TO NEAREST WELL, DRILLING, COMPLETED,  
OR APPLIED FOR, ON THIS LEASE, FT.

19. PROPOSED DEPTH

6715'

20. ROTARY OR CABLE TOOLS

Rotary

21. ELEVATIONS (Show whether DF, RT, GR, etc.)

22. APPROX. DATE WORK WILL START\*

January 1979

23. PROPOSED CASING AND CEMENTING PROGRAM

SIZE OF HOLE	SIZE OF CASING	WEIGHT PER FOOT	SETTING DEPTH	QUANTITY OF CEMENT
13-3/4"	9-5/8"	36#	+ 250'	Sufficient to circulate to surface
7-7/8"	4-1/2"	10.5#	T.D.	Sufficient to circulate to surface

1. The geologic name of the surface formation is Tertiary San Jose.

2&3. Estimated Formation Tops

\*Possible oil or gas producer.

Fruitland	+ 1890'	Mancos	+ 4520'
Pictured Cliff	+ 2160'	Gallup	+ 5550'
Lewis Shale	+ 3000'	Greenhorn	+ 6360'
Mesaverde:		Graneros	+ 6425'
Cliffhouse	+ 3780'	Dakota 'A'	+ 6465'
Menefee	+ 3850'	*T.D.	+ 6715'
Point Lookout	+ 4370'		

4. Run 9-5/8" OD, K-55 new casing to 250' and circulate cement to surface. Run 4 1/2" OD, K-55 new casing to + 6715' with cement in two stages. Place DV tool (+ 4600') and cement with sufficient volume to circulate to surface. Tail in first stage with 200 SX neat. Casinghead will be API approved type (10").

5. Blowout Preventors: Hydraulic, Double ram, 10". One set of rams will be provided for each size drill pipe in the hole. One set of blind rams at all times. Fill line will be 2", Kill Line will be 2", choke relief line will be 2" with variable choke. BOP's will be installed, tested and in working order before drilling below surface casing and shall be maintained ready for use until drilling operations are completed. BOP's, drills, and tests will be recorded in the IADC Drilling report. They shall be checked every 24 hours. All rig equipment will be tested to above BOE ratings.

6. 0-250' spud mud with sufficient viscosity to clean hole and run casing. 250'-T.D. low solids weight 8.9-F.V. 30/36 - water loss 10/15. Quantities will vary as conditions vary.

7. Auxiliary Equipment

- Kelly cock will be in use at all times.
- Stabbing valve to fit drill pipe will be present on floor at all times.
- Mud monitoring will be visual, no abnormal pressures are anticipated in this area.
- Floats at bits.
- Drill string safety valve(s) to fit all pipe in the drill string will be maintained on rig floor while drilling operations are in progress.
- Rotating head will be used while drilling with gas.

8. No cores will be taken. GR-FDC-CNL-Caliper-T.D. to base of Mesa Verde. GR-Induction SP-SN T.D. to surface casing.

9. No abnormal pressures or temperatures are anticipated. See point #5 for blowout prevention equipment.

10. The drilling of this well will take approximately ten days. The gas is not yet contracted.

IN ABOVE SPACE DESCRIBE PROPOSED PROGRAM: If proposal is to deepen or plug back, give data on present productive zone and proposed new productive zone. If proposal is to drill or deepen directionally, give pertinent data on subsurface locations and measured and true vertical depths. Give blowout prevention program, if any.

SIGNED

TITLE

Div. Production Manager

DATE

(This space for Federal or State office use)

11. UNIT NO.

APPROVAL DATE

## WELL LOCATION AND ACREAGE DEDICATION PLAT

Effective 1-1-77

All distances must be from the outer boundaries of the Section

Operator <b>TENNECO OIL COMPANY</b>		Lease <b>BOLACK</b>		Well No. <b>2</b>
Grid Letter <b>G</b>	Section <b>19</b>	Township <b>28N</b>	Range <b>8W</b>	County <b>San Juan</b>
Actual Footage Location of Well:				
<b>2430</b>	feet from the <b>North</b>	line and	<b>1650</b>	feet from the <b>East</b>
Ground Level Elev. <b>5838</b>	Producing Formation <b>Dakota</b>	Pool <b>Basin Dakota</b>	Dedicated Acreage: <b>320</b> <small>Acres</small>	

1. Outline the acreage dedicated to the subject well by colored pencil or hachure marks on the plat below.
2. If more than one lease is dedicated to the well, outline each and identify the ownership thereof (both as to working interest and royalty).
3. If more than one lease of different ownership is dedicated to the well, have the interests of all owners been consolidated by communitization, unitization, force-pooling, etc?

☐ Yes ☐ No If answer is "yes," type of consolidation \_\_\_\_\_

If answer is "no," list the owners and tract descriptions which have actually been consolidated. (Use reverse side of this form if necessary.) \_\_\_\_\_

No allowable will be assigned to the well until all interests have been consolidated (by communitization, unitization, forced-pooling, or otherwise) or until a non-standard unit, eliminating such interests, has been approved by the Commission.

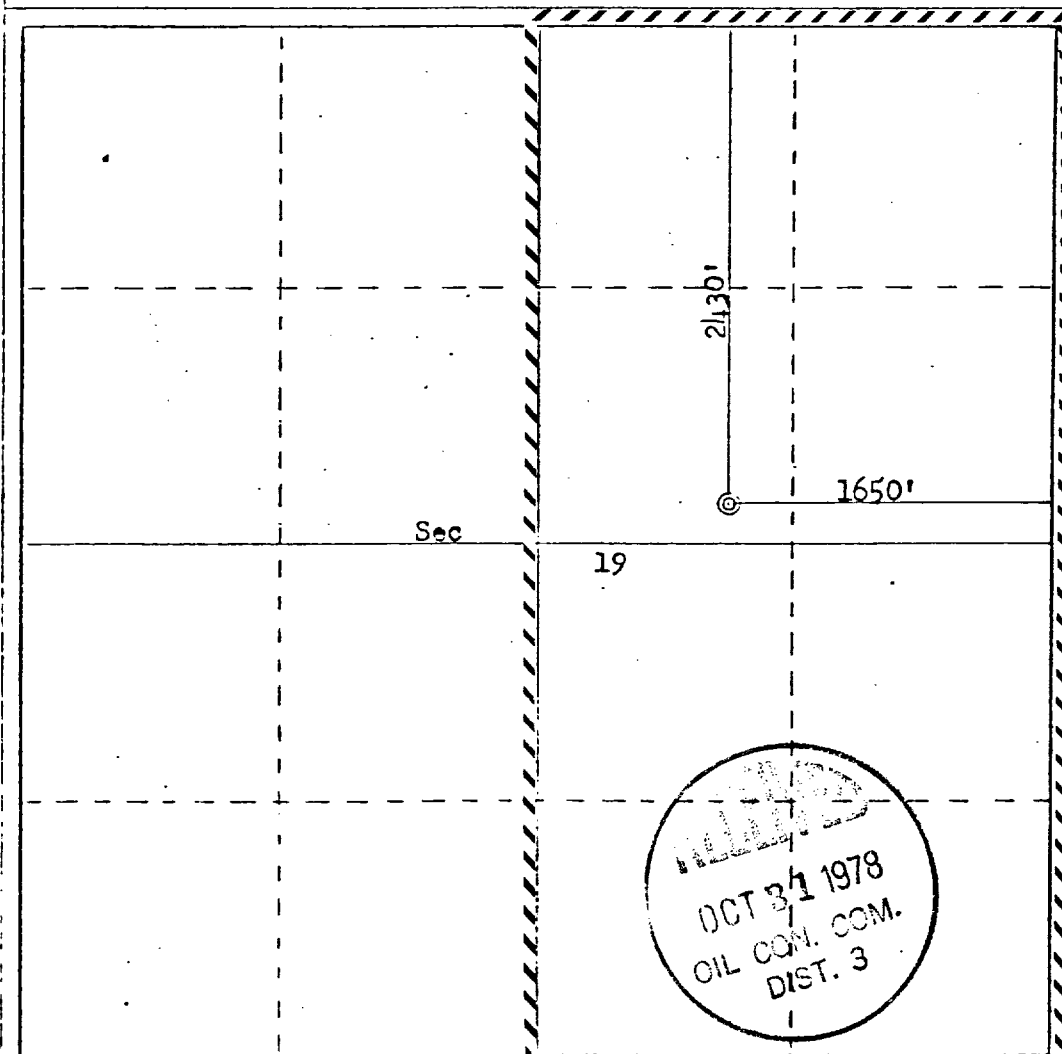

## CERTIFICATION

I hereby certify that the information contained herein is true and complete to the best of my knowledge and belief.

*J. A. Rush*  
Name  
Environmental Coordinator  
Position  
Tenneco Oil Company  
Company  
October 23, 1978  
Date

I hereby certify that the well location shown on this plat was plotted from field notes of actual surveys made by me or under my supervision, and that the same is true and correct to the best of my knowledge and belief.

Date Surveyed

September 23, 1978

Inspector, State of New Mexico

Fred J. Kern Jr.

Santa Fe, New Mexico

3955 E. 1st St. N.E.



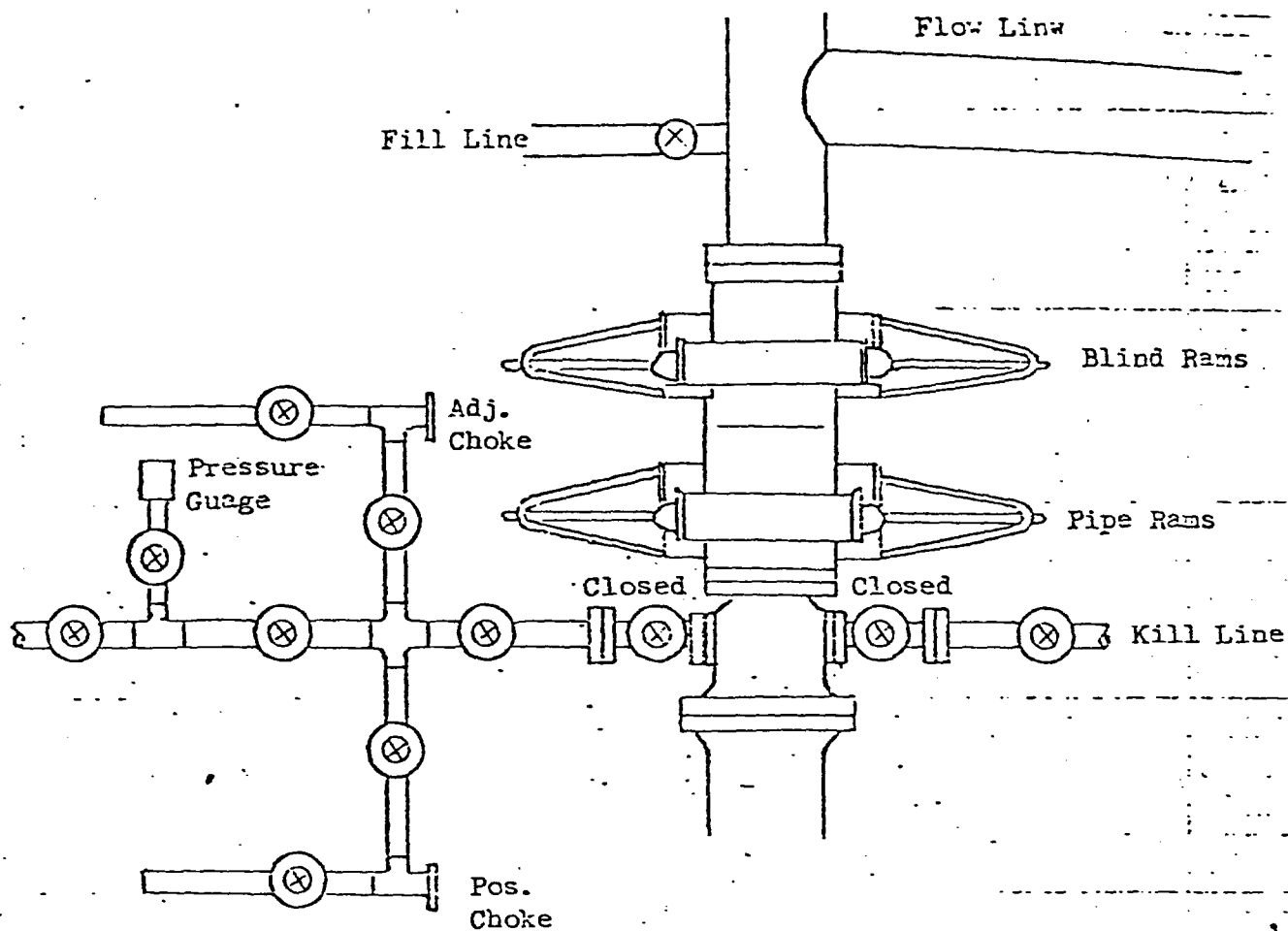

All valves 2"

All BOPs, flanges, spools, valves, & lines must be series 900 or 3000 psi working press.

Choke manifold must be at ground level and extended out from under substructure.

TENNECO OIL COMPANY

REQUIRED MINIMUM BLOWOUT PREVENTOR

HOOKUP

Denver, Colorado

Petroleum Information  
Corporation  
GEO-FICHE™

28N-8W-19- 07 (SW NE)  
NEW MEXICO NM

WELL: BOLACK-FEDERAL 2  
OPER: TENNECO OIL  
CNTY: SAN JUAN

API: 30-045-2322  
ISSUE: A07/86  
CARD: 1+

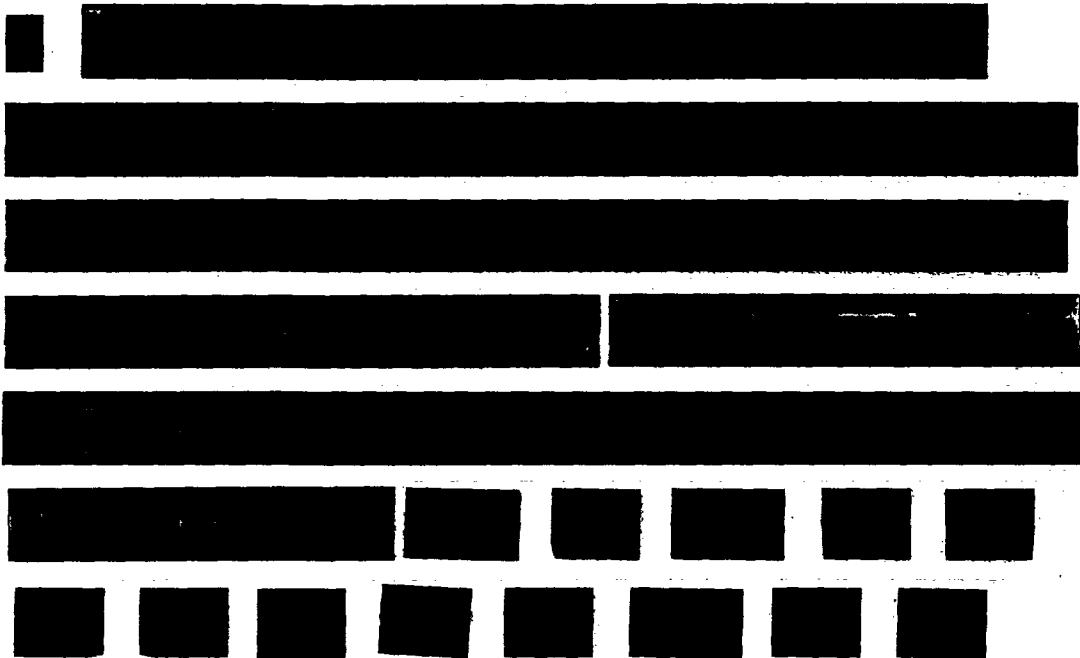

\*Copyright Petroleum InformationCorp 1987 - Reproduction Prohibited

Petroleum Information  
Corporation  
GEO-FICHE™

28N-8W-19- 07 (SW NE)  
NEW MEXICO NM

WELL: BOLACK-FEDERAL 2  
OPER: TENNECO OIL  
CNTY: SAN JUAN

API: 30-045-23257  
ISSUE: A07/86  
CARD: 2



\*Copyright Petroleum InformationCorp 1987 - Reproduction Prohibited