

NSL-4677  
December 7, 2001

Mike Stogner  
NM Oil Conservation Div.  
P. O. Box 6429  
Santa Fe, NM 87505

Dear Mike,

The NSL application for Elm Ridge's State of New Mexico 16-21 (16-23n-8w, San Juan County) omitted one piece of information regarding a well shown on the USGS topo map. The well is in the SWSE 16-23n-8w. There was no record of the well in OCD's Santa Fe files nor in Ongard.

I visited the well yesterday. It was plugged and abandoned long ago judging by the vegetation on the pad. The P&A marker said "GWD Chaco Unit #2". I have revised the topo map to show this additional information.

Please call me if you have any questions.

Sincerely,

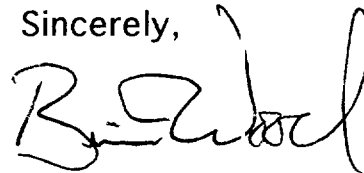

Brian Wood

cc: Aztec OCD  
Clark  
Endsley

DEC 11 2001

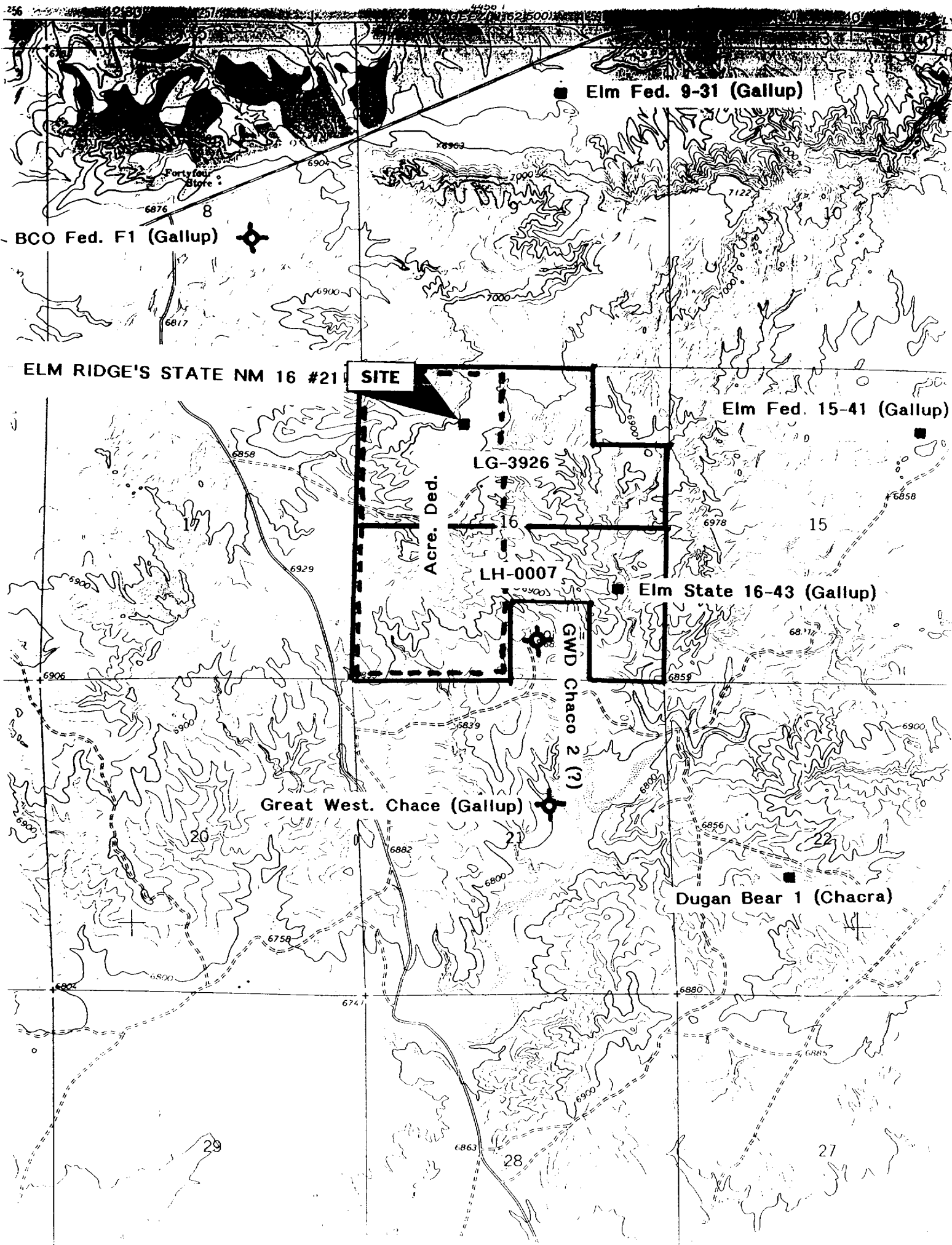



SUSPENSE 12/23/01	ENGINEER MS	LOGGED IN KV	TYPE NSL	APP NO 0133937927
----------------------	----------------	-----------------	-------------	----------------------

# NEW MEXICO OIL CONSERVATION DIVISION

- Engineering Bureau -

1220 South St. Francis Drive, Santa Fe, NM 87505

ABOVE THIS LINE FOR DIVISION USE ONLY

## ADMINISTRATIVE APPLICATION CHECKLIST

THIS CHECKLIST IS MANDATORY FOR ALL ADMINISTRATIVE APPLICATIONS FOR EXCEPTIONS TO DIVISION RULES AND REGULATIONS WHICH REQUIRE PROCESSING AT THE DIVISION LEVEL IN SANTA FE

### Application Acronyms:

[NSL-Non-Standard Location] [NSP-Non-Standard Proration Unit] [SD-Simultaneous Dedication]  
 [DHC-Downhole Commingling] [CTB-Lease Commingling] [PLC-Pool/Lease Commingling]  
 [PC-Pool Commingling] [OLS - Off-Lease Storage] [OLM-Off-Lease Measurement]  
 [WFX-Waterflood Expansion] [PMX-Pressure Maintenance Expansion]  
 [SWD-Salt Water Disposal] [IPI-Injection Pressure Increase]  
 [EOR-Qualified Enhanced Oil Recovery Certification] [PPR-Positive Production Response]

### [1] TYPE OF APPLICATION - Check Those Which Apply for [A]

[A] Location - Spacing Unit - Simultaneous Dedication  
 (NSL) NSP SD

Check One Only for [B] or [C]

[B] Commingling - Storage - Measurement  
 DHC CTB PLC PC OLS OLM

[C] Injection - Disposal - Pressure Increase - Enhanced Oil Recovery  
 WFX PMX SWD IPI EOR PPR

[D] Other: Specify

### [2] NOTIFICATION REQUIRED TO: - Check Those Which Apply, or Does Not Apply

(A) Working, Royalty or Overriding Royalty Interest Owners

(B) Offset Operators, Leaseholders or Surface Owner

[C] Application is One Which Requires Published Legal Notice

(D) Notification and/or Concurrent Approval by BLM or SLO  
 U.S. Bureau of Land Management - Commissioner of Public Lands, State Land Office

(E) For all of the above, Proof of Notification or Publication is Attached, and/or,

[F] Waivers are Attached

### [3] SUBMIT ACCURATE AND COMPLETE INFORMATION REQUIRED TO PROCESS THE TYPE OF APPLICATION INDICATED ABOVE.

[4] **CERTIFICATION:** I hereby certify that the information submitted with this application for administrative approval is **accurate and complete** to the best of my knowledge. I also understand that **no action** will be taken on this application until the required information and notifications are submitted to the Division.

**Note:** Statement must be completed by an individual with managerial and/or supervisory capacity.

Print or Type Name

Signature

Title

Date

BRIAN WOOD  
 (505) 466-8120  
 FAX 466-9682

*Brian Wood*

CONSULTANT

12-3-01

e-mail Address

brian@permitswest.com

REQUEST FOR ADMINISTRATIVE APPROVAL FOR NON-STANDARD LOCATION  
FOR ELM RIDGE RESOURCES, INC.  
STATE OF NEW MEXICO 16 #21 WELL  
BASIN FRUITLAND FIELD & POOL  
890' FNL & 1920' FWL SEC. 16, T. 23 N., R. 8 W., SAN JUAN COUNTY, NM

I. The well is on BLM surface and a State oil and gas lease (LG-3926). The proposed location is non-standard for the Fruitland. A standard Fruitland location is in the southwest quarter or the northeast quarter. This well is in the northwest quarter to take advantage of an existing well bore which is no longer productive in its original (Gallup) zone. Elm Ridge has no plans now to drill a Fruitland well in the southwest quarter. The APD is attached.

II. A Form C-102 showing the well location and proration unit (W2 for the Fruitland) is attached. Two state leases will be communitized. The well is on LG-3926 which comprises 280 acres in the NW4, W2NE4, and SENE Sec. 16. It will be communitized with state lease LH-0007/V-5960 which comprises 280 acres in the SW4, N2SE4, and SESE Sec. 16. Both leases (solid lines) and the communitized acreage dedication (dashed lines) are shown on the attached copy of the Lybrook NW USGS topo map.

III. According to NM Oil Conservation Division records reviewed in their Santa Fe office on December 1, 2001; the closest producer is Elm Ridge's State of New Mexico 16-43. It is a Gallup oil well which is 3,793' southeast at 1600' FSL & 790' FEL 16-23n-8w. There are no existing or proposed Fruitland wells in Section 16, in the 8 surrounding sections which touch Section 16, nor in at least a 6,170' radius.

A copy of the Lybrook NW 7.5' USGS map is attached. The map shows the well site, proposed Fruitland acreage dedication (dashed line including all of west half of Sec. 16), leases (solid lines), and other existing well bores within a one mile radius (0 Fruitland + 1 Chacra + 2 P&A + 2 Gallup = 5). There is only one lease within a minimum 890' radius. Elm Ridge is the operator of the Fruitland rights in the two state leases to be communitized.

Registered letters were sent on December 3, 2001 to all offset interest owners. Copies of all the letters and postal receipts are attached.



**PERMITS WEST**, INC.  
PROVIDING PERMITS for LAND USERS

Operator <b>ELM RIDGE RESOURCES, INC.</b>		Lease <b>STATE OF NEW MEXICO-16</b>		Well No. <b>21</b>
Unit Letter <b>C</b>	Section <b>16</b>	Township <b>23N</b>	Range <b>8W</b>	County <b>San Juan</b>
Actual Footage Location of Well: <b>890</b> feet from the <b>North</b> line and <b>1920</b> feet from the <b>West</b> line				
Ground Level Elev. <b>7013</b>	Producing Formation <b>FRUITLAND COAL</b>	Pool <b>BASIN FRUITLAND</b>	Dedicated Acreage <b>320</b> Acres	

1. Outline the acreage dedicated to the subject well by colored pencil or hachure marks on the plat below.
2. If more than one lease is dedicated to the well, outline each and identify the ownership thereof (both as to working interest and royalty).
3. If more than one lease of different ownership is dedicated to the well, have the interests of all owners been consolidated by communitization, unitization, force-pooling, etc?

☒ Yes ☐ No If answer is "yes," type of consolidation \_\_\_\_\_

If answer is "no," list the owners and tract descriptions which have actually been consolidated. (Use reverse side of this form if necessary.) \_\_\_\_\_

No allowable will be assigned to the well until all interests have been consolidated (by communitization, unitization, forced-pooling, or otherwise) or until a non-standard unit, eliminating such interests, has been approved by the Commission.

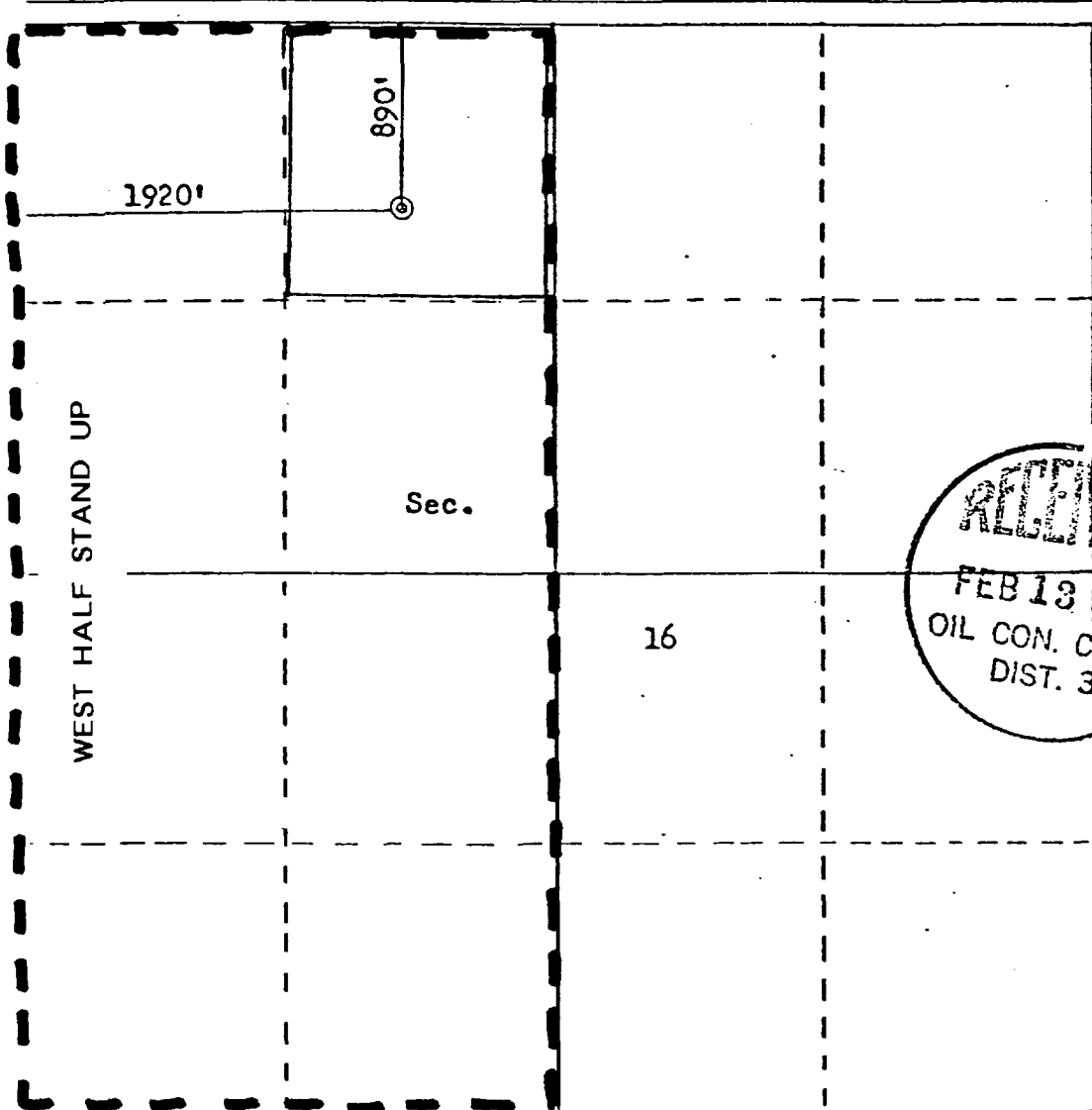

## CERTIFICATION

I hereby certify that the information contained herein is true and complete to the best of my knowledge and belief.

*Brian Wood*

Name **BRIAN WOOD**

Position **CONSULTANT**

Company **ELM RIDGE RESOURCES, INC.**

Date **12-3-01**

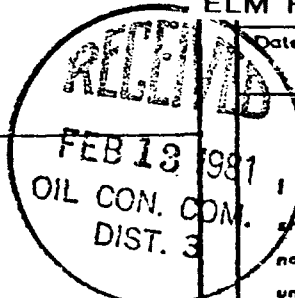

I hereby certify that the well location shown on this plat was plotted from the notes of actual surveys made by me under my supervision, and that the same is true and correct to the best of my knowledge and belief.

Date Surveyed

**October 10, 1980**

Registered Professional Engineer and Land Surveyor

*Fred B. [Signature]*  
Fred B. [Signature]

Certification No. \_\_\_\_\_

1980

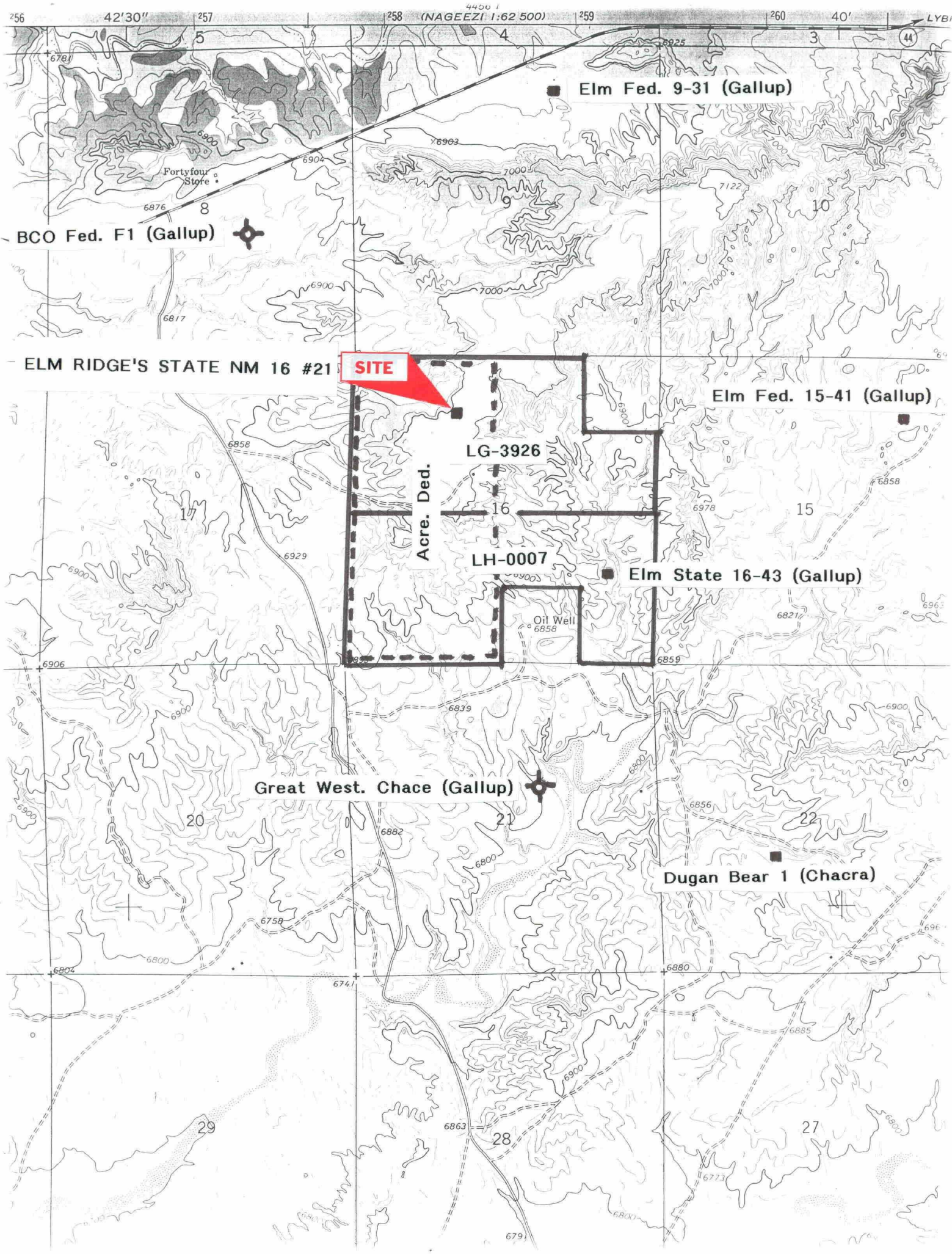

**PERMITS WEST, INC.**  
PROVIDING PERMITS for the ENERGY INDUSTRY  
17 Verano Loop, Santa Fe, New Mexico 87505 (505) 444-8120  
466

December 3, 2001

Cherry Hlava  
BP Amoco  
P. O. Box 3092  
Houston, Tx. 77253

Dear Cherry,

As required by New Mexico Oil Conservation Division Rules, I am notifying you of the following non-standard location (NSL) for a well. This letter is a notice only. No action is needed unless you have questions or objections.

Elm Ridge Resources, Inc. is applying to reenter and develop the Fruitland coal zone in its State of NM 16 #21 (currently a TSI Gallup oil well). Standard Fruitland coal wells are located in the northeast or southwest quarter of each section. Thus, this is a non-standard location. It is 890' from the closest lease boundary. It is 3,793' from the closest producing well.

Well Name: State of New Mexico 16 #21 Total Depth: 5,508'  
Proposed NSL Producing Zone: Fruitland coal  
NSL Acreage Dedication: 320.00 ac. (W2 Sec. 16) to Fruitland  
Location: 890' FNL & 1920' FWL Sec. 16, T. 23 N., R. 8 W.,  
San Juan County, NM on state lease LG-3926  
Approximate Location: ~3 air miles southeast of Nageezi, NM  
Applicant Name: Elm Ridge Resources, Inc. (505) 632-3476  
Applicant's Address: P. O. Box 189, Farmington, NM 87499

Submittal Information: Application for a non-standard location will be filed with the NM Oil Conservation Division. If they determine the application regulations, then it will be approved. The New address is 1220 South St. Francis Dr. Santa Fe, NM 87505. Phone number is (505) 476-3440.

questions.

Sincerely,

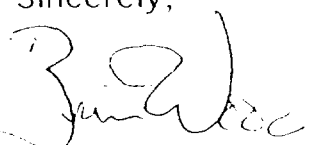
  
Brian Wood

U.S. Postal Service  
**CERTIFIED MAIL RECEIPT**  
(Domestic Mail Only; No Insurance Coverage Provided)

466 0012 5356 8704

Postmark	34
Postage	310
Postage & Fees	150
Total Postage & Fees	\$ 374
BP Amoco	
PO Box 3092	
Houston, TX 77253	

1002 11 11 2001

**PERMITS WEST**, INC.  
PROVIDING PERMITS for the ENERGY INDUSTRY  
47 Merano Loop, Santa Fe, New Mexico 87505 (505) 984-8120

466

December 3, 2001

BLM  
1235 LaPlata Highway  
Farmington, NM 87401

As required by New Mexico Oil Conservation Division Rules, I am notifying you of the following non-standard location (NSL) for a well. This letter is a notice only. No action is needed unless you have questions or objections.

Elm Ridge Resources, Inc. is applying to reenter and develop the Fruitland coal zone in its State of NM 16 #21 (currently a TSI Gallup oil well). Standard Fruitland coal wells are located in the northeast or southwest quarter of each section. Thus, this is a non-standard location. It is 890' from the closest lease boundary. It is 3,793' from the closest producing well.

Well Name: State of New Mexico 16 #21 Total Depth: 5,508'

Proposed NSL Producing Zone: Fruitland coal

NSL Acreage Dedication: 320.00 ac. (W2 Sec. 16) to Fruitland

Location: 890' FNL & 1920' FWL Sec. 16, T. 23 N., R. 8 W.,

San Juan County, NM on state lease LG-3926

Approximate Location: ≈3 air miles southeast of Nageezi, NM

Applicant Name: Elm Ridge Resources, Inc. (505) 632-3476

Applicant's Address: P. O. Box 189, Farmington, NM 87499

Submittal Information: Application for a non-standard location will be filed with the NM Oil Conservation Division. If they determine the application complies with the applicable regulations, then it will be approved. The New Mexico Oil Conservation Division address is 1220 South St. Francis Dr. Santa Fe, NM 87505. Phone number is (505) 476-3440.

questions.

Sincerely,

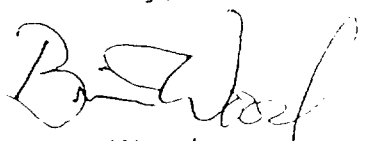
  
Brian Wood

U.S. Postal Service  
**CERTIFIED MAIL RECEIPT**  
(Domestic Mail Only; No Insurance Coverage Provided)

7000 1670 0012 6355 8681

Postage \$ .34  
Fees \$ 2.10  
Total Postage & Fees \$ 2.44  
Total Postage & Fees \$ 3.74  
BLM  
1235 LaPlata Hwy  
Farmington, NM 87401



**PERMITS WEST**, INC.  
PROVIDING PERMITS for the ENERGY INDUSTRY  
37 Verano Loop, Santa Fe, New Mexico 87505 (505) 984-8120

466

December 3, 2001

Dave Pogue  
Dugan Production Corp.  
P. O. Box 420  
Farmington, NM 87499

Dear Dave,

As required by New Mexico Oil Conservation Division Rules, I am notifying you of the following non-standard location (NSL) for a well. This letter is a notice only. No action is needed unless you have questions or objections.

Elm Ridge Resources, Inc. is applying to reenter and develop the Fruitland coal zone in its State of NM 16 #21 (currently a TSI Gallup oil well). Standard Fruitland coal wells are located in the northeast or southwest quarter of each section. Thus, this is a non-standard location. It is 890' from the closest lease boundary. It is 3,793' from the closest producing well.

Well Name: State of New Mexico 16 #21 Total Depth: 5,508'

Proposed NSL Producing Zone: Fruitland coal

NSL Acreage Dedication: 320.00 ac. (W2 Sec. 16) to Fruitland

Location: 890' FNL & 1920' FWL Sec. 16, T. 23 N., R. 8 W.,

San Juan County, NM on state lease LG-3926

Approximate Location: ≈3 air miles southeast of Nageezi, NM

Applicant Name: Elm Ridge Resources, Inc. (505) 632-3476

Applicant's Address: P. O. Box 189, Farmington, NM 87499

Submittal Information: Application for a non-standard location will be filed with the NM Oil Conservation Division. If they determine the application complies with the regulations, then it will be approved. The New Mexico Oil Conservation Division's address is 1220 South St. Francis Dr. Santa Fe, NM 87505. Their phone number is (505) 476-3440.

**U.S. Postal Service**  
**CERTIFIED MAIL RECEIPT**  
(Domestic Mail Only; No Insurance Coverage Provided)

Postage	\$ 34
Postage & Fees	\$ 210
Postage & Fees	\$ 150
Total Postage & Fees	\$ 394

DEC 04 2001  
QUICK RESPONSE UNIT  
SAN JUAN COUNTY, NM

Dugan  
PO Box 420  
Farmington, NM 87499

questions.

Sincerely,

*Brian Wood*  
Brian Wood

**PERMITS WEST, INC.**  
PROVIDING PERMITS for the ENERGY INDUSTRY  
47 Verano Loop, Santa Fe, New Mexico 87505 (505) 464-8120  
466

December 3, 2001

Jeff Albers  
NM State Land Office  
P. O. Box 1148  
Santa Fe, NM 87504-1148

As required by New Mexico Oil Conservation Division Rules, I am notifying you of the following non-standard location (NSL) for a well. This letter is a notice only. No action is needed unless you have questions or objections.

Elm Ridge Resources, Inc. is applying to reenter and develop the Fruitland coal zone in its State of NM 16 #21 (currently a TSI Gallup oil well). Standard Fruitland coal wells are located in the northeast or southwest quarter of each section. Thus, this is a non-standard location. It is 890' from the closest lease boundary. It is 3,793' from the closest producing well.

Well Name: State of New Mexico 16 #21 Total Depth: 5,508'

Proposed NSL Producing Zone: Fruitland coal

NSL Acreage Dedication: 320.00 ac. (W2 Sec. 16) to Fruitland

Location: 890' FNL & 1920' FWL Sec. 16, T. 23 N., R. 8 W.,  
San Juan County, NM on state lease LG-3926

Approximate Location: ≈3 air miles southeast of Nageezi, NM

Applicant Name: Elm Ridge Resources, Inc. (505) 632-3476

Applicant's Address: P. O. Box 189, Farmington, NM 87499

Submittal Information: Application for a non-standard location will be filed with the NM Oil Conservation Division. If they determine the application complies with the applicable regulations, then it will be approved. The New Mexico address is 1220 South St. Francis Dr. Santa Fe, NM 87505. Phone number is (505) 476-3440.

questions.

Sincerely,

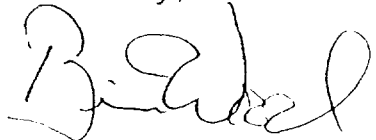
  
Brian Wood

**U.S. Postal Service  
CERTIFIED MAIL RECEIPT**

(Domestic Mail Only; No Insurance Coverage Provided)

Postage	\$ 34
Certified Fee	210
Return Receipt Fee (Endorsement Required)	150
Restricted Delivery Fee (Endorsement Required)	
Total Postage & Fees	\$ 394



Sent to: State Land  
Post Office: PO Box 1148  
City: Santa Fe NM 87504

District I  
1625 N. French Dr., Hobbs, NM 88240  
District II  
811 South First, Artesia, NM 88210  
District III  
1000 Rio Brazos Road, Aztec, NM 87410  
District IV  
1220 S. St. Francis Dr., Santa Fe, NM 87505

State of New Mexico  
Energy Minerals and Natural Resources

Oil Conservation Division  
1220 South St. Francis Dr.  
Santa Fe, NM 87505

Form C-101  
Revised March 17, 1999

Submit to appropriate District Office  
State Lease - 6 Copies  
Fee Lease - 5 Copies

☐ AMENDED REPORT

**APPLICATION FOR PERMIT TO DRILL, RE-ENTER, DEEPEN, PLUGBACK, OR ADD A ZONE**

<sup>1</sup> Operator Name and Address <b>Elm Ridge Resources, Inc.</b> P. O. Box 189, Farmington, NM 87499		<sup>2</sup> OGRID Number <b>149052</b>
		<sup>3</sup> API Number 30 - <b>045-24861</b>
<sup>4</sup> Property Code -	<sup>5</sup> Property Name <b>State of NM 16</b>	<sup>6</sup> Well No. <b>21</b>

<sup>7</sup> Surface Location

UL or lot no.	Section	Township	Range	Lot Idn	Feet from the	North/South line	Feet from the	East/West line	County
<b>C</b>	<b>16</b>	<b>23n</b>	<b>8w</b>		<b>890</b>	<b>North</b>	<b>1920</b>	<b>West</b>	<b>SJ</b>

<sup>8</sup> Proposed Bottom Hole Location If Different From Surface

UL or lot no.	Section	Township	Range	Lot Idn	Feet from the	North/South line	Feet from the	East/West line	County

<sup>9</sup> Proposed Pool 1 <b>Basin Fruitland Coal</b>	<sup>10</sup> Proposed Pool 2 .
---	------------------------------------

<sup>11</sup> Work Type Code <b>A</b>	<sup>12</sup> Well Type Code <b>G</b>	<sup>13</sup> Cable/Rotary <b>R</b>	<sup>14</sup> Lease Type Code <b>S</b>	<sup>15</sup> Ground Level Elevation <b>7,013'</b>
<sup>16</sup> Multiple <b>No</b>	<sup>17</sup> Proposed Depth <b>1,600'</b>	<sup>18</sup> Formation <b>Fruitland</b>	<sup>19</sup> Contractor .	<sup>20</sup> Spud Date <b>1-2-02</b>

<sup>21</sup> Proposed Casing and Cement Program

Hole Size	Casing Size	Casing weight/foot	Setting Depth	Sacks of Cement	Estimated TOC
<b>12-1 1/4"</b>	<b>8-5/8"</b>	<b>23</b>	<b>259'</b>	<b>275 sx</b>	<b>Surface</b>
<b>7-7/8"</b>	<b>5-1/2"</b>	<b>14</b>	<b>5,508'</b>	<b>1125 sx</b>	<b>Surface</b>

<sup>22</sup> Describe the proposed program. If this application is to DEEPEN or PLUG BACK, give the data on the present productive zone and proposed new productive zone.  
Describe the blowout prevention program, if any. Use additional sheets if necessary.

Well was originally spudded & completed in 1981 as a Gallup oil well.  
Elm Ridge has recently been unsuccessful in returning Gallup to production.  
Elm Ridge will set a CIBP at  $\approx 1,750'$  and attempt to complete & produce from Fruitland.

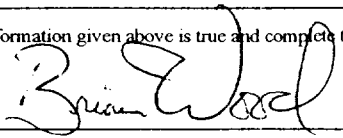
<sup>23</sup> I hereby certify that the information given above is true and complete to the best of my knowledge and belief. Signature: 		<b>OIL CONSERVATION DIVISION</b>	
Printed name: <b>Brian Wood</b>		Approved by:	
Title: <b>Consultant</b>		Title:	
Date: <b>December 3, 2001</b>		Approval Date:	Expiration Date:
Phone: <b>(505) 466-8120</b>		Conditions of Approval: Attached <input type="checkbox"/>	

Operator <b>ELM RIDGE RESOURCES, INC.</b>		Lease <b>STATE OF NEW MEXICO -16</b>		Well No. <b>21</b>
Unit Letter <b>C</b>	Section <b>16</b>	Township <b>23N</b>	Range <b>8W</b>	County <b>San Juan</b>
Actual Footage Location of Well:				
890 feet from the North line and		1920 feet from the West line		
Ground Level Elev. <b>7013</b>	Producing Formation <b>FRUITLAND COAL</b>	Pool <b>BASIN FRUITLAND</b>	Dedicated Acreage: <b>320</b> Acres	

- Outline the acreage dedicated to the subject well by colored pencil or hatchure marks on the plat below.
- If more than one lease is dedicated to the well, outline each and identify the ownership thereof (both as to work interest and royalty).
- If more than one lease of different ownership is dedicated to the well, have the interests of all owners been consolidated by communitization, unitization, force-pooling, etc?
 

☒ Yes    ☐ No    If answer is "yes," type of consolidation \_\_\_\_\_

If answer is "no," list the owners and tract descriptions which have actually been consolidated. (Use reverse side of this form if necessary.) \_\_\_\_\_

No allowable will be assigned to the well until all interests have been consolidated (by communitization, unitization, forced-pooling, or otherwise) or until a non-standard unit, eliminating such interests, has been approved by the Commission.

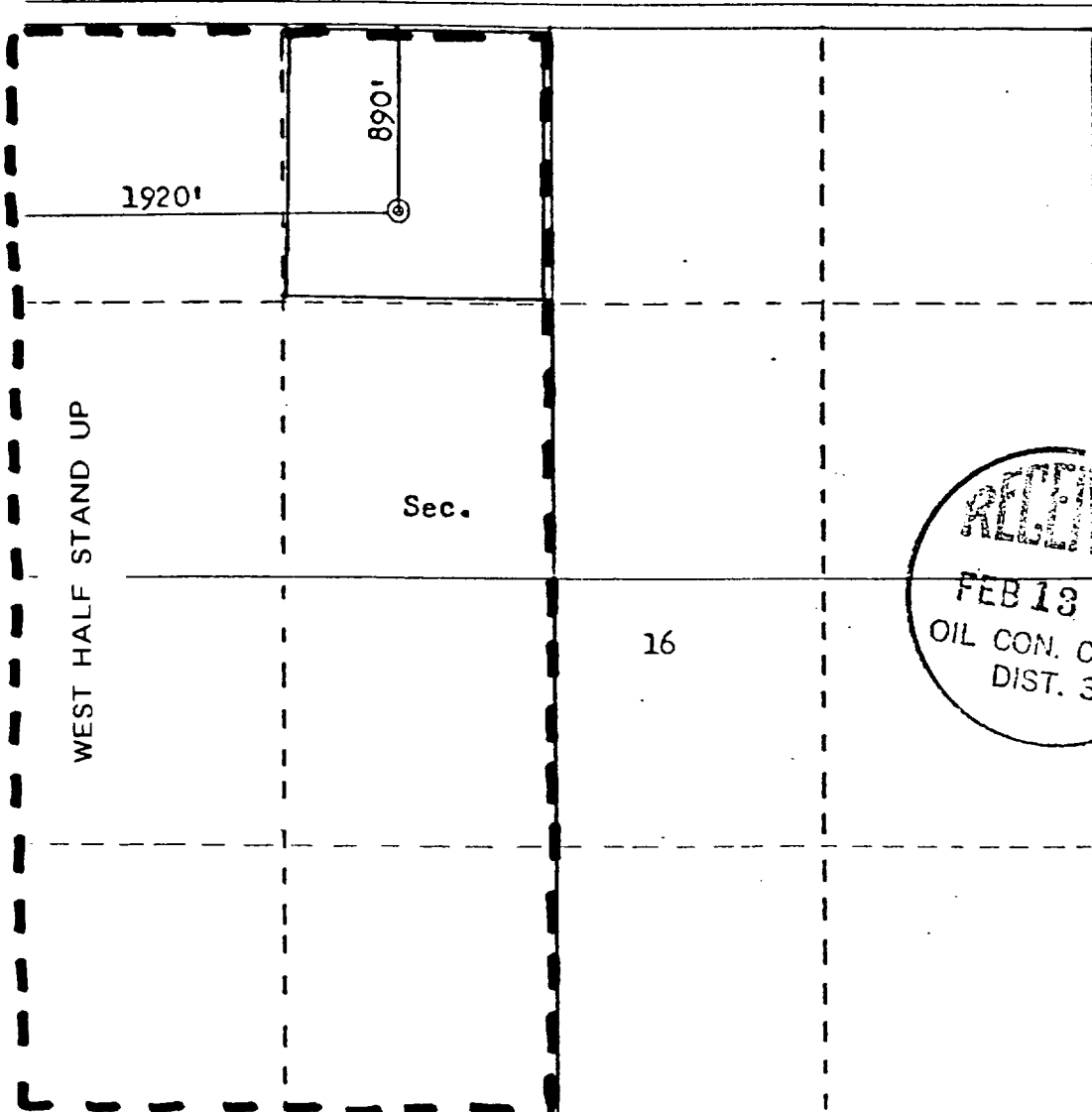

## CERTIFICATION

I hereby certify that the information contained herein is true and complete to the best of my knowledge and belief.

*Brian Wood*

Name  
**BRIAN WOOD**

Position  
**CONSULTANT**

Company  
**ELM RIDGE RESOURCES, INC.**

Date  
**12-3-01**

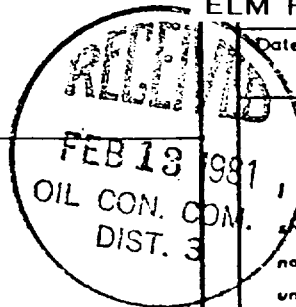

I hereby certify that the well location shown on this plat was plotted from the notes of actual surveys made by me under my supervision, and that the same is true and correct to the best of my knowledge and belief.

Date Surveyed  
**October 10, 1980**

Registered Professional Engineer and Land Surveyor

*Fred B. [Signature]*

Certification No. \_\_\_\_\_

**Stogner, Michael**

---

**From:** Hayden, Steven  
**Sent:** Thursday, December 06, 2001 1:59 PM  
**To:** Stogner, Michael  
**Subject:** Scott Federal 27-11-23 #1

Mike, this application has some small problems:

The well name should contain the 23, not the well number- thus the Scott Fed 27-11-23 #1  
There is an available flat area in O.

This is about the only place to put a well in the NE/4, so I don't have any strong objections.

**The other two applications** from Elm Ridge have really poor topo maps, so I may be forced to go out and field check them next week. Darn!!!



Steve Hayden  
NM OCD District III  
1000 Rio Brazos Rd.  
Aztec, NM 87410

[shayden@state.nm.us](mailto:shayden@state.nm.us)  
(505) 334-6178 Ext. 14  
Fax: (505) 334-6170

**DISTRICT I**

P.O. Box 1980, Hobbs, NM 88240

**OIL CONSERVATION DIVISION**

2040 Pacheco St.

Santa Fe, NM 87505

**DISTRICT II**

P.O. Drawer DD, Artesia, NM 88210

**DISTRICT III**

1000 Rio Brazos Rd., Aztec, NM 87410

WELL APINO.

30-045-24861

5. Indicate Type of Lease

STATE ☒

FEE ☐

6. State Oil & Gas Lease No.

LG-3926

7. Lease Name or Unit Agreement Name

State of NM 16

8. Well No.

21

9. Pool name or Wildcat

Nageezi-Gallup

**SUNDRY NOTICES AND REPORTS ON WELLS**

(DO NOT USE THIS FORM FOR PROPOSALS TO DRILL OR TO DEEPEN OR PLUG BACK TO A DIFFERENT RESERVOIR. USE "APPLICATION FOR PERMIT" (FORM C-101) FOR SUCH PROPOSALS)

1. Type of Well:

OIL  
WELL ☒

GAS  
WELL ☐

OTHER

2. Name of Operator

Elm Ridge Resources, Inc.

3. Address of Operator

PO Box 189 Farmington, NM 87499

4. Well Location

Unit Letter C 890 Feet From Th North Line and 1920 Feet From Th West Line  
Section 16 Townshi 23N Range 8W NMPM San Juan County

10. Elevation (Show whether DF, RKB, RT, GR, etc.)  
7013 GL

**Check Appropriate Box to Indicate Nature of Notice, Report, or Other Data**

**11. NOTICE OF INTENTION TO:**

PERFORM REMEDIAL WORK ☒ PLUG AND ABANDON ☐

TEMPORARILY ABANDON ☐ CHANGE PLANS ☐

PULL OR ALTER CASING ☐

OTHER: ☐

**SUBSEQUENT REPORT OF:**

REMEDIAL WORK ☐ ALTERING CASING ☐

COMMENCE DRILLING OPNS. ☐ PLUG AND ABANDONMENT ☐

CASING TEST AND CEMENT JO ☐

OTHER: ☐

12. Describe Proposed or Completed Operations (Clearly state all pertinent details, and give pertinent date, including estimated date of starting any proposed work) SEE RULE 1103.

Elm Ridge Resources, Inc plans to move a rig on the State of New Mexico 16 #21 before the end of the year 2001. At that time, we will determine what the problem is and return the well to production.

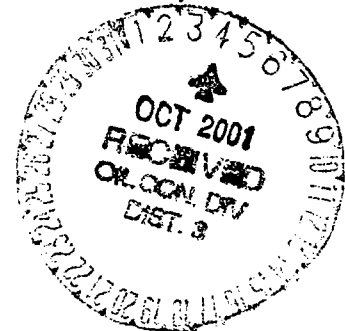

Certified Return Receipt # 7000 1670 0010 0494 0353

P SIGNATURE Trudy Grubelnik TITLE Production Technician DATE 10/03/01  
TYPE OR PRINT NAME Trudy Grubelnik TELEPHONE NO. 505-632-3476 ext. 201

(This space for State Use)

APPROVED BY Chad RL TITLE DEPUTY OIL & GAS INSPECTOR, DIST. 3 DATE OCT - 4 2001

CONDITIONS OF APPROVAL, IF ANY:

District I  
P O Box 1980, Hobbs, NM 88241-1980

District II

P O Drawer DD, Artesia, NM 88211-0719

District III

1000 Rio Brazos Rd., Aztec, MN 87410

District IV

P O Box 2088, Santa Fe, NM 87504-2088

State of New Mexico  
Energy, Minerals & Natural Resources Department

OIL CONSERVATION DIVISION

P O Box 2088  
Santa Fe, NM 87504-2088

Revis

Submit to Appr

I. REQUEST FOR ALLOWABLE AND AUTHORIZATION TO TRANSPORT

<sup>1</sup> Operator name and Address  Elm Ridge Resources, Inc. P. O. Box 601299 Dallas, Texas 75360-1299		<sup>2</sup> OGRID Number 149
<sup>4</sup> API Number 30-045-24861	<sup>5</sup> Pool Name NAGEEZI -GALLUP	<sup>6</sup> Pool Code
<sup>7</sup> Property Code 17574 2 4 1 4 11	<sup>8</sup> Property Name STATE OF NM 16	<sup>9</sup> Well Number

II. <sup>10</sup> Surface Location

UL or lot no. C	Section 16	Township 23N	Range 8W	Lot Idn	Feet from the 890	North/South Line NORTH	Feet from the 1920	East/West Line WEST	County San
--------------------	---------------	-----------------	-------------	---------	----------------------	---------------------------	-----------------------	------------------------	---------------

<sup>11</sup> Bottom Hole Location

UL or lot no.	Section	Township	Range	Lot Idn	Feet from the	North/South Line	Feet from the	East/West Line	County
<sup>12</sup> Lot Code	<sup>13</sup> Producing Method Code	<sup>14</sup> Gas Connection Date	<sup>15</sup> C-129 Permit Number	<sup>16</sup> C-129 Effective Date	<sup>17</sup> C-1				

III. Oil and Gas Transporters

<sup>18</sup> Transporter OGRID	<sup>19</sup> Transporter Name and Address	<sup>20</sup> POD	<sup>21</sup> O/G	<sup>22</sup> POD ULSTR Location and Description
9018	Giant Refining Co. 5764 US HWY 65 Farmington, NM 87401	1023910	O	C 16 - T2
25244	Williams Gas Processing Blanco, Inc. PO BOX 58900 Salt Lake City, UT 84158	1023930	G	C 16 - T2

RECEIVED  
JAN 19 1999  
OIL CONSERVATION DIVISION

IV. Produced Water

<sup>23</sup> POD 1023910	<sup>24</sup> POD ULSTR Location and Description C-16-T23N-R8W
------------------------------	---

V. Well Completion Data

<sup>25</sup> Spud Date	<sup>26</sup> Ready Date	<sup>27</sup> TD	<sup>28</sup> PBTD	<sup>29</sup> Perforation
<sup>30</sup> Hole Size	<sup>31</sup> Casing & Tubing Size	<sup>32</sup> Depth Set	<sup>33</sup> Sacks	

VI. Well Test Data

<sup>34</sup> Date New Oil	<sup>35</sup> Gas Delivery Date	<sup>36</sup> Test Date	<sup>37</sup> Test Length	<sup>38</sup> Tubing Pressure	<sup>39</sup> Casing Pressure
<sup>40</sup> Choke Size	<sup>41</sup> Oil	<sup>42</sup> Water	<sup>43</sup> Gas	<sup>44</sup> AOF	<sup>45</sup> T

<sup>46</sup> I hereby certify that the rules of the Oil Conservation Division have been complied with and that the information given above is true and complete to the best of my knowledge and belief.

Signature: James M. Clark Jr.  
Printed Name: James M. Clark Jr.  
Title: President  
Date: January 12 1999  
Phone: (214) 696-8090

Approved by: 32.8  
Title: SUPERVISOR DISTRICT  
Approval Date: JAN 19 1999

<sup>47</sup> If this is a change of operator fill in the OGRID number and name of the previous operator.  
Paul C. Thompson  
Previous Operator Signature: Paul Thompson  
OGRID #037581  
Printed Name: Paul Thompson  
Title: President

State of New Mexico  
Energy, Minerals and Natural Resources Department  
**OIL CONSERVATION DIVISION**

PO Box 2088

Santa Fe, New Mexico 87504-2088

**SUNDRY NOTICES AND REPORTS ON WELLS**

Do not use this form for proposals to drill or to deepen or reentry to a different reservoir. Use "APPLICATION FOR PERMIT—" for such proposals

FORM APPROVED  
Form C-103  
Revised 1-1-89

5. Lease Designation and Serial No.  
**LG-3926**

6. If Indian, Allottee or Tribe Name

SUBMIT IN TRIPLICATE

7. If Unit or CA, Agreement Designation

1. Type of Well  
☒ Oil Well ☐ Gas Well ☐ Other

8. Well Name and No.  
**State of New Mexico #16-21**

2. Name of Operator  
**Thompson Engineering & Production Corp**

9. API Well No.  
**30-045-24861**

3. Address and Telephone No.  
**7415 East Main Farmington, NM 87402 505-327-4892**

10. Field and Pool, or Exploratory Area  
**Nageezi Gallup**

4. Location of Well (Footage, Sec., T., R., M., or Survey Description)  
**890' FNL & 1920' FWL, Sec. 16, T23N, R8W, Unit C**

11. County or Parish, State  
**San Juan County, NM.**

CHECK APPROPRIATE BOX(S) TO INDICATE NATURE OF NOTICE, REPORT, OR OTHER DATA

TYPE OF SUBMISSION

- ☐ Notice of Intent  
☒ Subsequent Report  
☐ Final Abandonment

TYPE OF ACTION

- ☐ Abandonment  
☒ Recompletion  
☐ Plugging Back  
☐ Casing Repair  
☐ Altering Casing  
☐ Other \_\_\_\_\_

- ☐ Change of Plans  
☐ New Construction  
☐ Non-Routine Fracturing  
☐ Water Shut-Off  
☐ Conversion to Injection  
☐ Dispose Water

(Note: Report results of multiple completion on Well Completion or Recompletion Report and Log form.)

13. Describe Proposed or Completed Operations (Clearly state all pertinent details, and give pertinent dates, including estimated date of starting any proposed work. If well is directionally drilled, give subsurface locations and measured and true vertical depths for all markers and zones pertinent to this work.)\*

This well is currently being evaluated for up hole re-completion potential. In the event that the economics prove to be unfavorable the well will be plugged and abandoned according to the attached procedure.

RECEIVED  
JUL 1 3 1997  
OIL CON. DIV.  
PAGE 3

14. I hereby certify that the foregoing is true and correct

Signed John C. Thompson (John C. Thompson) Title Agent/Engineer Date 06/16/97

(This space for Federal or State office use)

Approved by Johnny Robinson Title \_\_\_\_\_ Date \_\_\_\_\_  
Conditions of approval, if any:

X Reopen completion prior to 9-16-97

**Thompson Engineering & Production Corp.  
State of New Mexico #16-21**

**P&A Procedure**

Location: 16/23N/8W  
San Juan County, New Mexico

Date: July 3, 1997

Field: Lybrook Gallup

Elev: GL 7013'

---

***Prior to Move in:***

1. Make sure all anchors are in place.
2. Dig reserve pit.

***Procedure:***

1. MOL and RU pulling unit. Hold safety meeting. Blow well down and kill with 2% KCl water, if necessary.
2. ND horse head & bridle. Unseat pump & lay down 4 full rods.
3. RU Hot oilers & pump hot oil down tbg. to clean rods & tbg.
4. TOH (laying down) rods & pump.
5. ND WH & NU BOP.
6. Unseat tubing anchor & TOH w/ tubing. Lay down tubing anchor, seating nipple, perf. sub & mud anchor. Pick up cement retainer & TIH. Set retainer at 5021'.

**Plug #1**

6. Sting into retainer & establish rate w/ water. Mix & pump 55 sx. (65 cu.ft.) of Class "B" cement. Sting out of retainer leaving 1 bbl of cement on top of retainer. Reverse tbg. clean & pull up to 4225'.

**Plug #2 (4225' - 3084')**

8. Mix & pump 129 sx (152 cu.ft.) of Class "B" cement w/ 4%  $\text{CaCl}_2$  in a balanced plug to cover Mesa Verde interval. Pull up & reverse tbg. clean. WOC. TIH & confirm plug top.

**Plug #3 (1137'-937')**

9. Pull up to 1137'. Mix and pump 24 sx (28 cu.ft.) of Class "B" cement w/ 4%  $\text{CaCl}_2$ . Pull up & reverse tubing clean. WOC. TIH to confirm plug top.

**Plug #4 (50' - surface)**

10. Pull up to 50'. Mix & pump 6 sx (7 cu.ft.) or until cement circulates to surface. TOH (washing cement of tubing on way out). Top off casing with cement.
11. Cut off well head and anchors. Install P & A marker and restore location per NMOCD requirements.

John C. Thompson

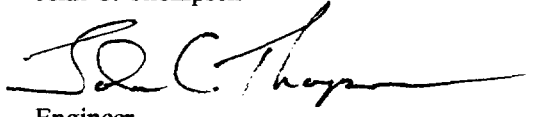

Engineer

## Thompson Engineering & Production Corp.

State of New Mexico 16 #21

Sec 16 T23N R8W

San Juan County, New Mexico

revised: 7/3/97 jct

### Formation Tops

Ojo Alamo	937'
Pictured Cliffs	1649'
Cliff House	3134'
Point Lookout	4019'
Mancos	4225'
Gallup	5069'

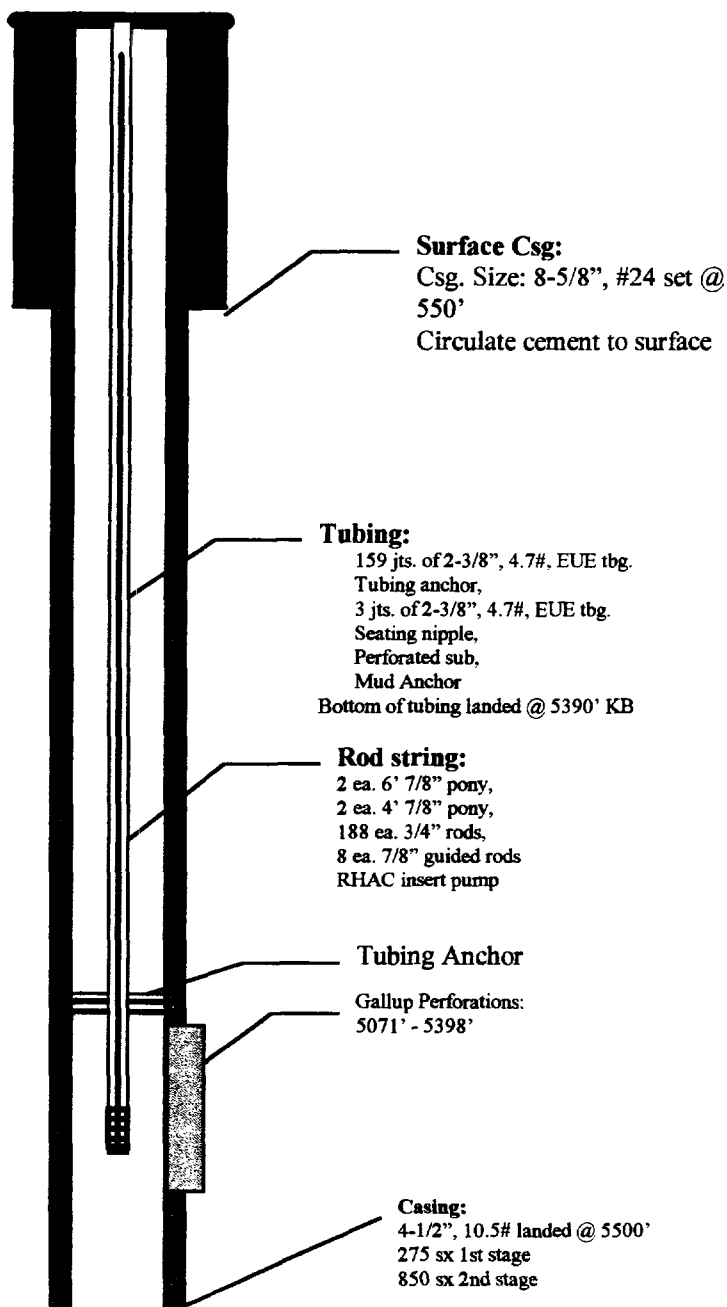

## Thompson Engineering & Production Corp.

State of New Mexico 16 #21

Sec 16 T23N R8W

San Juan County, New Mexico

revised: 7/3/97 jct

### P & A Status

Formation Tops	
Ojo Alamo	937'
Pictured Cliffs	1649'
Cliff House	3134'
Point Lookout	4019'
Mancos	4225'
Gallup	5069'

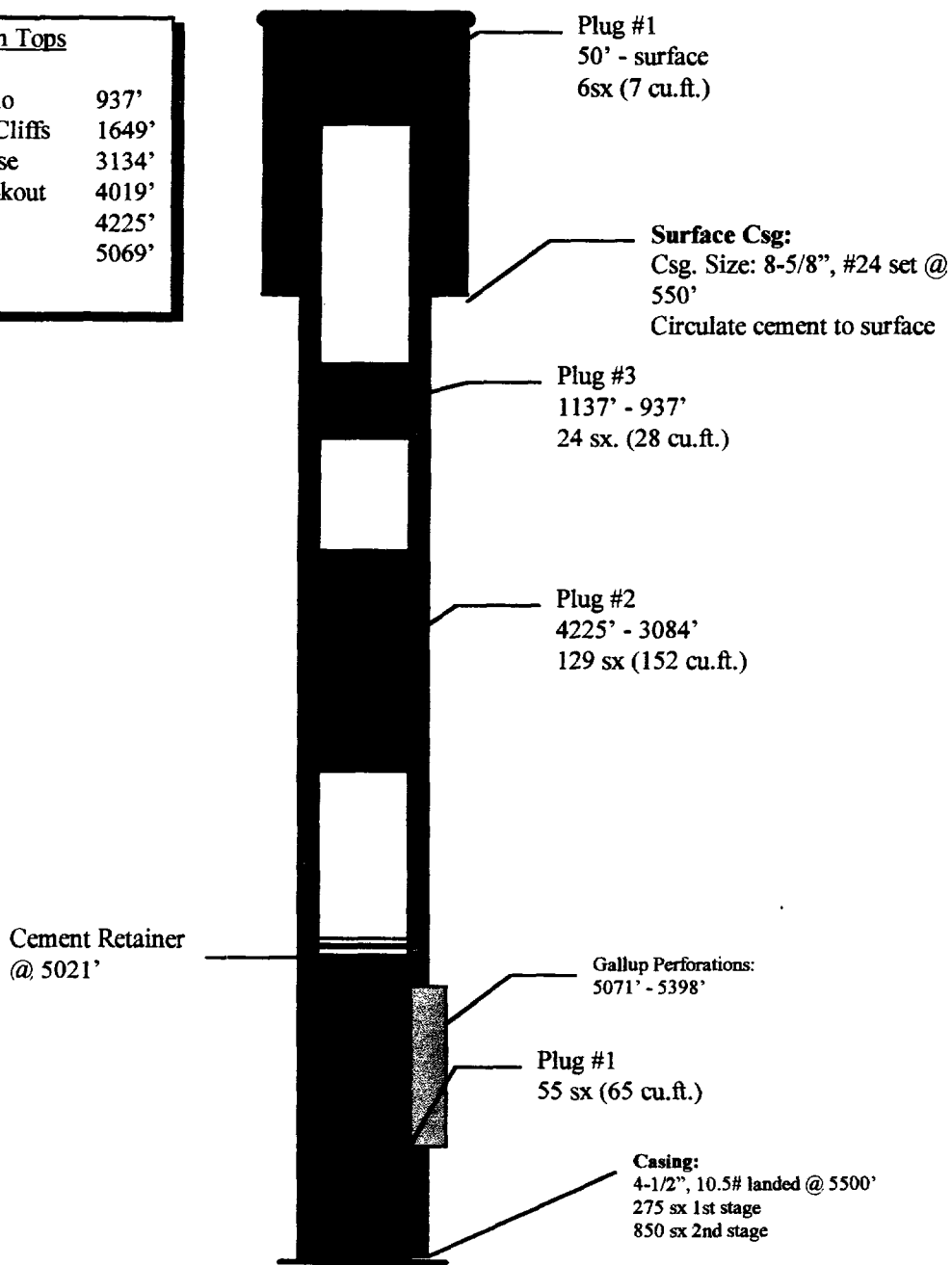

Submit 5 Copies  
Appropriate District Office  
**DISTRICT I**  
P.O. Box 1980, Hobbs, NM 88240

State of New Mexico  
Energy, Minerals and Natural Resources Department

Submit to Appropriate

**DISTRICT II**  
P.O. Drawer DD, Artesia, NM 88210

**OIL CONSERVATION DIVISION**

P.O. Box 2088

Santa Fe, New Mexico 87504-2088

**DISTRICT III**  
1000 Rio Brazos Rd., Aztec, NM 87410

**I. REQUEST FOR ALLOWABLE AND AUTHORIZATION TO TRANSPORT**

1. Operator Name and Address THOMPSON ENGINEERING & PRODUCTION CORP 7415 East Main Street, Farmington, New Mexico 87402		2. OGRID Number 037581
Effective 8-1-95		Oper Name Chg - from Meridian
30-045-24861	5. Pool Name Nageezi Gallup	6. Pool Code 47540
7. Property Code 17574	8. Property Name State of New Mexico 16	9. Well Number 21

**II. 10. Surface Location**

UI or lot no. C	Section 16	Township 23N	Range 8W	Lot Idn	Feet from the 890	North/South line North	Feet from the 1920	East/West line West
--------------------	---------------	-----------------	-------------	---------	----------------------	---------------------------	-----------------------	------------------------

**III. 11. Bottom Hole Location**

UI or lot no.	Section	Township	Range	Lot Idn	Feet from the	North/South line	Feet from the	East/West line
12. Iso Code S	13. Producing Method Code Flowing	14. Gas Connection Date	15. C-129 Permit Number	16. C-129 Effective Date				

**III. Oil and Gas Transporters**

18. Transporter OGRID	19. Transporter Name and Address	20. POD	21. O/G	22. POD ULSTR Location and Description
008471	Gary Williams Energy Corp.	102 3570	O	
1587	Bannon Energy Corp.	102 3530	G	
9018	GIANT REFINING COMPANY P.O. BOX 12999 SCOTTSDALE, AZ 85267			

**IV. Produced Water**

23. POD 102 3550	24. POD ULSTR Location and Description
---------------------	--

**V. Well Completion Data**

25. Spud Date	26. Ready Date	27. TD	28. PBTB	29. Perforation
30. Hole Size	31. Casing & Tubing Size	32. Depth Set	33. Sacks Cement	

**VI. Well Test Data**

34. Date New Oil	36. Test Date	37. Test Length	38. Tbg. Pressure
40. Choke Size	41. Oil	42. Water	43. Gas
44. AOF			

46. I hereby certify that the rules and regulations of the Oil Conservation Division have been complied with and that the information given above is true and complete to the best of my knowledge and belief.

**OIL CONSERVATION**

Approved by:

SUPERVISOR DISTRICT

Signature

Paul C. Thompson

Title:

Printed Name

PAUL C. THOMPSON

Approval Date:

AUG 22 1995

Title:

PRESIDENT

Telephone (505) 327-4892

47. If this is a change of operator fill in the OGRID number and name of the previous Meridian Oil Inc

Previous Operator Signature

Peggy Bradfield

Regulatory Administrator

8/1/95

Printed Name

Title

Date

Submit 5 Copies  
Appropriate District Office  
**DISTRICT I**  
P.O. Box 1980, Hobbs, NM 88240

State of New Mexico  
Energy, Minerals and Natural Resources Department

Form  
Rev  
See I  
at Bo

**DISTRICT II**  
P.O. Drawer DD, Artesia, NM 88210

## OIL CONSERVATION DIVISION

P.O. Box 2088  
Santa Fe, New Mexico 8750004-2088

**DISTRICT III**  
1000 Rio Brazos Rd., Aztec, NM 87410

### REQUEST FOR ALLOWABLE AND AUTHORIZATION TO TRANSPORT OIL AND NATURAL GAS

I. **DATE** 10/10/94

Operator <b>Meridian Oil Inc.</b>	Well API No. <b>30-045-24</b>
Address <b>P.O. Box 4289, Farmington, New Mexico 87499</b>	
Reason(s) for Filing (Check proper box) New Well <input type="checkbox"/> Change in Transporter of: <input type="checkbox"/> Effective Date 2-1-94 Recompletion <input type="checkbox"/> Oil <input type="checkbox"/> Dry Gas <input checked="" type="checkbox"/> Change in Operator <input checked="" type="checkbox"/> Casinghead Gas <input type="checkbox"/> Condensate <input type="checkbox"/>	

If change of operator give name

and address of previous operator **P & P Production Inc., P.O. Box 3178, Midland, Texas 79702-3178**

### II. DESCRIPTION OF WELL AND LEASE

Lease Name <b>State of New Mexico 16</b>	Well No. <b>21</b>	Pool Name, Including Formation <b>Nageezi Gallup</b>	Kind of Lease <b>(State) Federal or Fee</b>	Lease <b>639</b>
Location Unit Letter <b>C</b> <b>890</b> Feet from the <b>North</b> Line and <b>1920</b> Feet From The <b>West</b> Section <b>16</b> Township <b>23 North</b> Range <b>8 West</b> NMPM, <b>San Juan</b>				

### III. DESIGNATION OF TRANSPORTER OF OIL AND NATURAL GAS

Name of Authorized Transporter of Oil <b>Meridian Oil Inc 1023510</b>	or Condensate <input checked="" type="checkbox"/>	Address (Give address to which approved copy of this form) <b>P.O. Box 4289, Farmington, NM 87499</b>				
Name of Authorized Transporter of Casinghead Gas <b>Bannon Energy Corp. 1023530</b>	or Dry Gas <input type="checkbox"/>	Address (Give address to which approved copy of this form) <b>3934 FM 1960 West #240, Houston, TX 7706</b>				
If well produces oil or liquids, give location of tanks.	Unit <b>C</b>	Sec. <b>16</b>	Twp. <b>23N</b>	Rge. <b>8W</b>	Is gas actually connected?	When ?

If this production is commingled with that from any other lease or pool, give commingling order number:

### IV. COMPLETION DATA

Designate Type of Completion - (X)	Oil Well	Gas Well	New Well	Workover	Deepen	Plug Back	Same Res
Date Spudded	Date Compl. Ready to Prod.		Total Depth		P.B.T.D.		
Elevations (DF, RKB, RT, GR, etc.)	Name of Producing Formation			Top Oil/Gas Pay		Tubing Depth	
Perforations						Depth Casing Shoe	

### TUBING, CASING AND CEMENTING RECORD

HOLE SIZE	CASING & TUBING SIZE	DEPTH SET

### V. TEST DATA AND REQUEST FOR ALLOWABLE

**OIL WELL** (Test must be after recovery of total volume of load oil & must be equal to or exceed top allowable for this depth or for full 24 hours.)

Date First New Oil Run To Tank	Date of Test	Producing Method (Flow, pump, gas lift, etc.)	
Length of Test	Tubing Pressure	Casing Pressure	Choke Size
Actual Prod. During Test	Oil - Bbls.	Water - Bbls.	Gas - MCF

### GAS WELL

Actual Prod. Test - MCF/D	Length of Test	Bbls. Condensate/MMCF	Gravity of Condensate
Testing Method (pitot, back pr.)	Tubing Pressure (Shut-in)	Casing Pressure (Shut-in)	Choke Size

### VI. OPERATOR CERTIFICATE OF COMPLIANCE

I hereby certify that the rules and regulations of the Oil Conservation Division have been complied with and that the information given above is true and complete to the best of my knowledge and belief.

Signature <b>Shannon McMorris</b>	Production Assistant
Printed Name <b>2/1/94</b>	Title <b>505-326-9526</b>
Date	Telephone No.

### OIL CONSERVATION DIVISION

Date Approved <b>FEB 0 2 1994</b>
By <b>Supervisor</b>
Title <b>SUPERVISOR DISTRICT</b>

**INSTRUCTIONS:** This form is to be filed in compliance with Rule 1104

- 1) Request for allowable for newly drilled or deepened well must be accompanied by tabulation of deviation tests in accordance with Rule 111.
- 2) All sections of this form must be filled out for allowable on new and recompleted wells.
- 3) Fill out only Sections I, II, III, and VI for changes of operator, well name or number, transporter, or other such.
- 4) Separate Form C-104 must be filed for each pool in multiply completed wells.

Submittal 5 Copies  
Appropriate District Office  
DISTRICT I  
P.O. Box 1980, Hobbs, NM 88240

DISTRICT II  
P.O. Drawer DD, Artesia, NM 88210

DISTRICT III  
1000 Rio Brazos Rd., Aztec, NM 87410

State of New Mexico  
Energy, Minerals and Natural Resources Department

OIL CONSERVATION DIVISION  
P.O. Box 2088  
Santa Fe, New Mexico 87504-2088

Form C-104  
Revised  
See Instructions  
in Back

REQUEST FOR ALLOWABLE AND AUTHORIZATION  
TO TRANSPORT OIL AND NATURAL GAS

Operator <b>P &amp; P Producing, Inc.</b>	Well API No. <b>30-045-1</b>
Address <b>P.O. Box 3178, Midland, TX 79702-3178</b>	
Reason(s) for Filing (Check proper box) <input type="checkbox"/> Other (Please explain)	
New Well <input type="checkbox"/>	Change in Transporter of: <input type="checkbox"/> Oil <input type="checkbox"/> Dry Gas <input type="checkbox"/>
Recompletion <input type="checkbox"/>	Casinghead Gas <input type="checkbox"/> Condensate <input type="checkbox"/>
Change in Operator <input checked="" type="checkbox"/>	
If change of operator give name and address of previous operator <b>Graham Royalty, Ltd.</b>	

EFF. 11/1/93

II. DESCRIPTION OF WELL AND LEASE

Lease Name <b>State of New Mexico 16</b>	Well No. <b>21</b>	Pool Name, including Formation <b>Nageezi-Gallup</b>	Kind of Lease <b>State</b>
Location Unit Letter <b>C</b> : <b>890</b> Feet From The <b>North</b> Line and <b>1920</b> Feet From The <b>West</b> Line Section <b>16</b> Township <b>23N</b> Range <b>8W</b> NMPM <b>San Juan</b>			

III. DESIGNATION OF TRANSPORTER OF OIL AND NATURAL GAS

Name of Authorized Transporter of Oil <input checked="" type="checkbox"/> or Condensate <input type="checkbox"/> <b>Giant Refining Co.</b>	Address (Give address to which approved copy of this form is to be sent) <b>23733 N. Scottsdale Rd. Scottsdale, AZ</b>	
Name of Authorized Transporter of Casinghead Gas <input checked="" type="checkbox"/> or Dry Gas <input type="checkbox"/> <b>Bannon Energy Corp.</b>	Address (Give address to which approved copy of this form is to be sent) <b>3934 FM 1960 West #240, Houston, TX</b>	
Well produces oil or liquids, <input type="checkbox"/> or gas only <input type="checkbox"/> Location of tanks	Unit <b>C</b> Sec. <b>16</b> Twp. <b>23N</b> Rge. <b>8W</b>	Is gas actually connected? <b>YES</b> When? <b>Unknown</b>
If production is commingled with that from any other lease or pool, give commingling order number.		

IV. COMPLETION DATA

Designate Type of Completion - (X)	Oil Well	Gas Well	New Well	Workover	Deepen	Plug Back	Same Res v
Date Spudded	Date Compl. Ready to Prod.		Total Depth		P.B.T.D.		
Elevations (D.F., R.A.B., RT., GR., etc.)	Name of Producing Formation		Top Oil/Gas Pay		Tubing Depth		
Perforations				Depth Casing Shoe			

TUBING, CASING AND CEMENTING RECORD

MOLE SIZE	CASING & TUBING SIZE	DEPTH SET	SACKS CEM

V. TEST DATA AND REQUEST FOR ALLOWABLE  
OIL WELL (Test must be after recovery of total volume of load oil and must be equal to or exceed top allowable for this depth or be for full 24 hr)

Date First New Oil Run To Tank	Date of Test	Producing Method (Flow, pump, gas lift, etc.)	
Length of Test	Tubing Pressure	Casing Pressure	Choke Size
Actual Prod. During Test	Oil - Bbls.	Water - Bbls.	Gas - MCF

GAS WELL

Actual Prod. Test - MCF/D	Length of Test	Bbls. Condensate/MMCF	Gravity of Condensate
Testing Method (water, back pr.)	Tubing Pressure (Sust.-in)	Casing Pressure (Sust.-in)	Choke Size

VI. OPERATOR CERTIFICATE OF COMPLIANCE

I hereby certify that the rules and regulations of the Oil Conservation Division have been complied with and that the information given above is true and complete to the best of my knowledge and belief.

*Larry R. Boren*

Signature  
**Larry R. Boren** Manager/Operations Accounting  
Printed Name  
**9/29/93** **915-686-4062**  
Date Telephone No

OIL CONSERVATION DIVISION

Date Approved **NOV 12 1993**

By *[Signature]*  
Title **SUPERVISOR DISTRICT**

INSTRUCTIONS: This form is to be filed in compliance with Rule 1104

- 1) Request for allowable for newly drilled or deepened well must be accompanied by tabulation of deviation tests taken with Rule 111.
- 2) All sections of this form must be filled out for allowable on new and recompleted wells.
- 3) Fill out only Sections I, II, III, and VI for changes of operator, well name or number, transporter, or other such change.
- 4) Separate Form C-104 must be filed for each pool in multiply completed wells.

Submit 3 Copies  
Appropriate District Office  
DISTRICT I  
P.O. Box 1980, Hobbs, NM 88240

DISTRICT II  
P.O. Drawer DD, Artesia, NM 88210

DISTRICT III  
1000 Rio Blanco Rd., Alamo, NM 87410

State of New Mexico  
Energy, Minerals and Natural Resources Department

## OIL CONSERVATION DIVISION

P.O. Box 2088  
Santa Fe, New Mexico 87501

RECEIVED

Form 1  
Rev. 10-80  
See Instructions

NOV 26 1990

### REQUEST FOR ALLOWABLE AND AUTHORIZATION TO TRANSPORT OIL AND NATURAL GAS

I. Operator Graham Royalty, Ltd. Well APN No. \_\_\_\_\_

Address 1675 Larimer, #400, Denver, CO 80202

Reason(s) for Filing (Check proper box)

New Well ☐ Change in Transporter of ☐ Other (Please explain) eff. 12/1/90  
Recompletion ☐ Oil ☒ Dry Gas ☐  
Change in Operator ☐ Casaghead Gas ☐ Condensate ☐

If change of operator give name and address of previous operator \_\_\_\_\_

### II. DESCRIPTION OF WELL AND LEASE

Lease Name <u>State of New Mexico 16</u>	Well No. <u>21</u>	Pool Name, including Formation <u>Nageezi-Gallup</u>	Kind of Lease State, Federal or Private	State <u>1630</u>
Location Unit Layer <u>C</u> <u>890</u> Feet From The <u>North</u> Line and <u>1920</u> Feet From The <u>West</u> Line Section <u>16</u> Township <u>23N</u> Range <u>8W</u> <u>NMTPM</u> San Juan				

### III. DESIGNATION OF TRANSPORTER OF OIL AND NATURAL GAS

Name of Authorized Transporter of Oil <input checked="" type="checkbox"/> or Condensate <input type="checkbox"/> <u>Giant Refining Co.</u>	Address (Give address to which approved copy of this form is to be sent) <u>23733 N. Scottsdale Rd., Scottsdale</u>
Name of Authorized Transporter of Casaghead Gas <input checked="" type="checkbox"/> or Dry Gas <input type="checkbox"/> <u>Bannon Energy Corp.</u>	Address (Give address to which approved copy of this form is to be sent) <u>3934 FM 1960 West, #240, Houston</u>
If well produces oil or liquids, give location of tanks	Unit <u>C</u> Sec. <u>16</u> Twp. <u>23N</u> Rge. <u>8W</u> Is gas actually collected? <u>Yes</u> When? <u>NA</u>

If this production is commingled with that from any other lease or pool, give commingling order number \_\_\_\_\_

### IV. COMPLETION DATA

Designate Type of Completion - (X)	Oil Well	Gas Well	Flow Well	Workover	Deepen	Plug Back	Stimulus
Design Spudded	Date Complet. Ready to Prod.		Total Depth		P.B.T.D.		
Extractions (DF, RLL, RT, GR, etc.)	Name of Producing Formation		Top Oil/Gas Pay		Tubing Depth		
Perforations					Depth Casing Shoe		

### TUBING CASING AND CEMENTING RECORD

HOLE SIZE	CASING & TUBING SIZE	DEPTH SET	SACKS CEMENT
-----------	----------------------	-----------	--------------

### V. TEST DATA AND REQUEST FOR ALLOWABLE

OIL WELL (This must be after recovery of lower viscous oil and must be equal to or exceed 100 allowable for this depth or be for full 24 hr.)

Date First Pure Oil Run To Tank	Date of Test	Producing Method (Flow, pump, gas lift, etc.)	
Length of Test	Tubing Pressure	Casing Pressure	Choke Size
Actual Prod. During Test	Oil - Bbls.	Water - Bbls.	Gas - MCF

### GAS WELL

Actual Prod. Test - MCF/D	Length of Test	Bbls. Condensate/MCF/D	Gravity of Condensate
Testing Method (plug back, etc.)	Tubing Pressure (Shut-in)	Casing Pressure (Shut-in)	Choke Size

### VI. OPERATOR CERTIFICATE OF COMPLIANCE

I hereby certify that the rules and regulations of the Oil Conservation Division have been compared with and that the information given above is true and correct to the best of my knowledge and belief.

Signature C. C. Robbins Reg. Affairs Super.  
Printed Name \_\_\_\_\_ Title \_\_\_\_\_  
Date 11/21/90 Telephone No. 303-629-1736

### OIL CONSERVATION DIVISION

NOV 26 1990

Date Approved \_\_\_\_\_

By Brian J. Chang

SUPERVISOR DISTRICT

Title \_\_\_\_\_

INSTRUCTIONS: This form is to be filed in compliance with Rule 1104

- 1) Request for allowable for newly drilled or deepened well must be accompanied by tabulation of completion tests taken with Rule 111
- 2) All sections of this form must be filled out for allowable on new and recompleted wells
- 3) Fill out only Sections I, II, III, and VI for changes of operator, well name or number, transporter, or other such changes
- 4) Separate Form C-104 must be filed for each pool in multiply completed wells

RECEIVED

NOV 26 1990

OIL CON

DIST

Submit 5 Copies  
Appropriate District Office  
DISTRICT I  
P.O. Box 1980, Hobbs, NM 88240

DISTRICT II  
P.O. Drawer DD, Artesia, NM 88210

DISTRICT III  
1000 Rio Brazos Rd., Aztec, NM 87410

State of New Mexico  
Energy, Minerals and Natural Resources Department

OIL CONSERVATION DIVISION

P.O. Box 2088  
Santa Fe, New Mexico 87504-2088

Form C-104  
Revised 1-88  
See Instructions  
on Back

REQUEST FOR ALLOWABLE AND AUTHORIZATION  
TO TRANSPORT OIL AND NATURAL GAS

Operator Graham Royalty, Ltd.		Well API No.
Address 1675 Larimer, #400, Denver, CO 80202		
Reason(s) for Filing (Check proper box) <input type="checkbox"/> Other (Please explain)		
New Well <input type="checkbox"/>	Change in Transporter of:	
Recompletion <input type="checkbox"/>	Oil <input type="checkbox"/>	<input checked="" type="checkbox"/> Dry Gas <input type="checkbox"/>
Change in Operator <input type="checkbox"/>	Casehead Gas <input checked="" type="checkbox"/>	Condensate <input type="checkbox"/>
If change of operator give name and address of previous operator		

II. DESCRIPTION OF WELL AND LEASE

Lease Name State of New Mexico	Well No. 16	Pool Name, Including Formation Nageezi-Gallup	Kind of Lease State, Federal or Fee	State NM
Location Unit Letter <u>C</u> : <u>890</u> Feet From The <u>North</u> Line and <u>1920</u> Feet From The <u>West</u> Line Section <u>16</u> Township <u>23N</u> Range <u>8W</u> , <u>NMPM</u> San Juan				

III. DESIGNATION OF TRANSPORTER OF OIL AND NATURAL GAS

Name of Authorized Transporter of Oil <input checked="" type="checkbox"/> or Condensate <input type="checkbox"/> Gary-Williams Energy Corp.	Address (Give address to which approved copy of this form is to be sent) 370 17th, Suite 5300, Denver, CO					
Name of Authorized Transporter of Casehead Gas <input checked="" type="checkbox"/> or Dry Gas <input type="checkbox"/> Bannon Energy Corp.	Address (Give address to which approved copy of this form is to be sent) 3934 FM 1960 West, #240, Houston, TX					
If well produces oil or liquids, give location of tanks.	Unit C	Sec. 16	Twp. 23N	Rge. 8W	Is gas actually connected? Yes	When? NA

If this production is commingled with that from any other lease or pool, give commingling order number:

IV. COMPLETION DATA

Designate Type of Completion - (X)	Oil Well	Gas Well	New Well	Workover	Deepen	Plug Back	Same Res.
Date Spudded	Date Compl. Ready to Prod.		Total Depth		P.B.T.D.		
Elevations (DF, RKB, RT, GR, etc.)	Name of Producing Formation		Top Oil/Gas Pay		Tubing Depth		
Perforations						Depth Casing Shoe	

TUBING, CASING AND CEMENTING RECORD

HOLE SIZE	CASING & TUBING SIZE	DEPTH SET	SACKS CEMENT

V. TEST DATA AND REQUEST FOR ALLOWABLE

OIL WELL (Test must be after recovery of total volume of load oil and must be equal to or exceed top allowable for this depth or be for full 24 hours)

Date First New Oil Run To Tank	Date of Test	Producing Method (Flow, pump, gas lift, etc.)
Length of Test	Tubing Pressure	Casing Pressure
Actual Prod. During Test	Oil - Bbls.	Water - Bbls.

GAS WELL

Actual Prod. Test - MCF/D	Length of Test	Bbls. Condensate/MCF	Gravity of Condensate
Testing Method (pump, back pr.)	Tubing Pressure (Shut-in)	Casing Pressure (Shut-in)	Choke Size

VI. OPERATOR CERTIFICATE OF COMPLIANCE

I hereby certify that the rules and regulations of the Oil Conservation Division have been complied with and that the information given above is true and complete to the best of my knowledge and belief.

Signature C. C. Robbins Reg. Affairs Super.  
Printed Name C. C. Robbins Title Reg. Affairs Super.  
Date 6/12/90 Telephone No. 303-629-1736

OIL CONSERVATION DIVISION

JUN 14 1990

Date Approved \_\_\_\_\_  
By James J. Chang  
Title SUPERVISOR DISTRICT

INSTRUCTIONS: This form is to be filed in compliance with Rule 1104

- 1) Request for allowable for newly drilled or deepened well must be accompanied by tabulation of deviation tests taken with Rule 111.
- 2) All sections of this form must be filled out for allowable on new and recompleted wells.
- 3) Fill out only Sections I, II, III, and VI for changes of operator, well name or number, transporter, or other such changes.
- 4) Separate Form C-104 must be filed for each pool in multiply completed wells.

REQUEST FOR ALLOWABLE  
AND  
AUTHORIZATION TO TRANSPORT OIL AND NATURAL GAS

NO. OF COPIES DESIRED	
DISTRICT	
SANTA FE	
FILE	
U.S.D.S.	
LAND OFFICE	
TRANSPORTER	OIL
	GAS
OPERATOR	
PROMOTION OFFICE	

1. Operator  
Graham Royalty, Ltd.

Address  
One Barclay Plaza 1675 Larimer Street, Suite 400; Denver, CO 80202

Reason(s) for filing (Check proper box)  
New Well ☐  
Recompletion ☐  
Change in Ownership ☒

Change in Transporter of:  
Oil ☐  
Casinghead Gas ☐  
Dry Gas ☐  
Condensate ☐

Other (Please explain)

If change of ownership give name and address of previous owner Petro-Lewis Corp. P.O. Box 16200 Lubbock Tx 794

## II. DESCRIPTION OF WELL AND LEASE

Lease Name St. of New Mexico 16	Well No. 21	Pool Name, Including Formation Nageezi Gallup	Kind of Lease State, Federal or Fee State
Location Unit Letter C : 890 Feet From The North Line and 1920 Feet From The West Line of Section 16 Township 23N Range 8W, NMPM, San Juan			

## III. DESIGNATION OF TRANSPORTER OF OIL AND NATURAL GAS

Name of Authorized Transporter of Oil <input checked="" type="checkbox"/> or Condensate <input type="checkbox"/> Permian Corp.	Address (Give address to which approved copy of this form) P.O. Box 1183 Houston, TX.		
Name of Authorized Transporter of Casinghead Gas <input checked="" type="checkbox"/> or Dry Gas <input type="checkbox"/> Gas co. of New Mexico	Address (Give address to which approved copy of this form) 1800 1st International Bldg. Dallas		
If well produces oil or liquids, give location of tanks.	Unit C	Sec. 16	Twp. 23N
			Rge. 8W
			Is gas actually connected? Yes
			When NA

If this production is commingled with that from any other lease or pool, give commingling order number:

## IV. COMPLETION DATA

Designate Type of Completion - (X)	Oil Well	Gas Well	New Well	Workover	Deepen	Plug Back	San
Date Spudded	Date Compl. Ready to Prod.		Total Depth		P.B.T.D.		
Elevations (OF, RKB, RT, GR, etc.)	Name of Producing Formation		Top Oil/Gas Pay		Tubing Depth		
Perforations					Depth Casing Sh		
TUBING, CASING, AND CEMENTING RECORD							
HOLE SIZE	CASING & TUBING SIZE		DEPTH SET		SACKS		

## V. TEST DATA AND REQUEST FOR ALLOWABLE OIL WELL

(Test must be after recovery of total volume of load oil and must be equal to or greater than the volume of gas produced for this depth or be for full 24 hours)

Date First New Oil Run To Tanks	Date of Test	Producing Method (Flow, pump, gas lift, etc.)	
Length of Test	Tubing Pressure	Casing Pressure	Choke Size
Actual Prod. During Test	Oil-Bbls.	Water-Bbls.	Gas-MCF

MAY 25 1984

## GAS WELL

Actual Prod. Test-MCF/D	Length of Test	Bbls. Condensate/MM	Gravity of Cond.
Testing Method (pilot, back pr.)	Tubing Pressure (Shut-in)	Casing Pressure (Shut-in)	Choke Size

## I. CERTIFICATE OF COMPLIANCE

I hereby certify that the rules and regulations of the Oil Conservation Division have been complied with and that the information given above is true and complete to the best of my knowledge and belief.

Sandra B. Jenkins; (Signature)  
Engr. Assistant - Operation Department

6-1-84

(Date)

## OIL CONSERVATION DIVISION

APPROVED

MAY 25 1984

BY

TITLE

This form is to be filed in compliance with

If this is a request for allowable for a newly drilled well, this form must be accompanied by a tabular log taken on the well in accordance with NUL

All sections of this form must be filled out and filed on new and recompleted wells.

Fill out only Sections I, II, III, and VI for well name or number, or transporter, or other such

Separate Forms C-104 must be filed for oil

## OIL CONSERVATION DIVISION

P. O. BOX 2088  
SANTA FE, NEW MEXICO 87501REQUEST FOR ALLOWABLE  
AND  
AUTHORIZATION TO TRANSPORT OIL AND NATURAL GAS

NO. OF COPIES RECEIVED	
DISTRIBUTION	
SANTA FE	
FILE	
U.S.D.	
LAND OFFICE	
TRANSPORTER	OIL
	GAS
OPERATOR	
PROMOTION OFFICE	

I. OPERATOR  
Petro-Lewis CorporationAddress  
P.O. Box 16200

Reason(s) for filing (Check proper box)

New Well ☐Recompletion ☐Change In Ownership ☐

Change In Transporter of:

Oil ☒Dry Gas ☐Casinghead Gas ☐Condensate ☐

Other (Please explain)

MAR 05 1984

OIL CON. DIV.  
DIST. 3If change of ownership give name  
and address of previous owner

## II. DESCRIPTION OF WELL AND LEASE

Lease Name	Well No.	Pool Name, Including Formation	Kind of Lease
St. of New Mexico 16	21	Nageezi-Gallup	State, Federal or Fee St
Location			
Unit Letter C	890	Feet From The North	Line and 1920
Feet From The		West	
Line of Section 16	Township 23N	Range 8W	NMPM, San Juan

## III. DESIGNATION OF TRANSPORTER OF OIL AND NATURAL GAS

Name of Authorized Transporter of Oil <input checked="" type="checkbox"/> or Condensate <input type="checkbox"/>	Address (Give address to which approved copy of th
Permian Corporation	P.O. Box 1183 Houston, TX
Name of Authorized Transporter of Casinghead Gas <input type="checkbox"/> or Dry Gas <input checked="" type="checkbox"/>	Address (Give address to which approved copy of th
Gas Co. of New Mexico	1800 1st International Bldg. Dal
If well produces oil or liquids, give location of tanks.	Unit Sec. Twp. Rge.
C 16 23N 8W	Is gas actually connected? When
yes	NA

If this production is commingled with that from any other lease or pool, give commingling order number:

## IV. COMPLETION DATA

Designate Type of Completion - (X)	Oil Well	Gas Well	New Well	Workover	Deepen	Plug Back
Date Spudded	Date Compl. Ready to Prod.	Total Depth	P.B.T.D.			
Elevations (DF, RKB, RT, GR, etc.)	Name of Producing Formation	Top Oil/Gas Pay	Tubing Dep			
Perforations			Depth Casing			
TUBING, CASING, AND CEMENTING RECORD						
HOLE SIZE	CASING & TUBING SIZE	DEPTH SET				

V. TEST DATA AND REQUEST FOR ALLOWABLE  
OIL WELL(Test must be after recovery of total volume of load oil and must be e  
able for this depth or be for full 24 hours)

Date First New Oil Run To Tanks	Date of Test	Producing Method (Flow, pump, gas lift, etc.)	
Length of Test	Tubing Pressure	Casing Pressure	Choke Size
Actual Prod. During Test	Oil - Bbls.	Water - Bbls.	Gas - MCF

## GAS WELL

Actual Prod. Test - MCF/D	Length of Test	Bbls. Condensate/MCF	Gravity of C
Testing Method (pilot, back pr.)	Tubing Pressure (Shut-in)	Casing Pressure (Shut-in)	Choke Size

## VI. CERTIFICATE OF COMPLIANCE

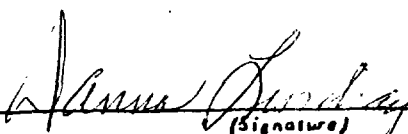
I hereby certify that the rules and regulations of the Oil Conservation  
Division have been complied with and that the information given  
above is true and complete to the best of my knowledge and belief.  
(Signature)Production/Revenue Supervisor  
(Title)

2-28-84

(Date)

## OIL CONSERVATION DIVISION

APPROVED

MAR 05 1984

BY

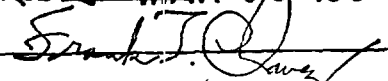

TITLE

SUPERVISOR DISTRICT #3

This form is to be filed in compliance with

If this is a request for allowable for a new  
well, this form must be accompanied by a test  
logs taken on the well in accordance withAll sections of this form must be filled o  
able on new and recompleted wells.Fill out only Sections I, II, III, and IV  
well name or number, or transporter, or other s

OIL CONSERVATION DIVISION  
P. O. BOX 2088  
SANTA FE, NEW MEXICO 87501REQUEST FOR ALLOWABLE  
AND  
AUTHORIZATION TO TRANSPORT OIL AND NATURAL GAS

1.

Operator  
Petro-Lewis Corporation  
Address  
Box 16200 Lubbock, Texas 79490

Reason(s) for filing (Check proper box)

New Well ☐Recompletion ☐Change In Ownership ☐

Change In Transporter of:

Oil ☒Casinghead Gas ☐Dry Gas ☐Condensate ☐

Other (Please explain)

FEB 10 1983

OIL CONSERVATION DIVISION

SANTA FE

If change of ownership give name  
and address of previous owner \_\_\_\_\_

## I. DESCRIPTION OF WELL AND LEASE

Lease Name State of New Mexico 16	Well No. 21	Pool Name, including Formation Nageezi-Gallup	Kind of Lease <del>State</del> Federal or <del>State</del> <input checked="" type="checkbox"/> <del>State</del>
Location Unit Letter <u>C</u> : <u>890</u> Feet From The <u>North</u> Line and <u>1920</u> Feet From The <u>West</u> Line of Section <u>16</u> Township <u>23N</u> Range <u>8W</u> , NMPM, San Juan			

## II. DESIGNATION OF TRANSPORTER OF OIL AND NATURAL GAS

Name of Authorized Transporter of Oil <input checked="" type="checkbox"/> or Condensate <input type="checkbox"/> Giant Refining Company	Address (Give address to which approved copy of this form) 7227 N. 16th St. Phoenix, Ar		
Name of Authorized Transporter of Casinghead Gas <input checked="" type="checkbox"/> or Dry Gas <input type="checkbox"/> Gas Co. of N.M. (Div of Southern Union)	Address (Give address to which approved copy of this form) 1800 1st International Bldg.		
If well produces oil or liquids, give location of tanks.	Unit <u>C</u>	Sec. <u>16</u>	Twp. <u>23N</u>
	Rge. <u>8W</u>	Is gas actually connected? <u>yes</u> When <u>Unknown</u>	

If this production is commingled with that from any other lease or pool, give commingling order number: \_\_\_\_\_

## V. COMPLETION DATA

Designate Type of Completion - (X)	Oil Well	Gas Well	New Well	Workover	Deepen	Plug Back	Sal
Date Spudded	Date Compl. Ready to Prod.		Total Depth		P.B.T.D.		
Elevations (DF, RKB, RT, GR, etc.)	Name of Producing Formation		Top Oil/Gas Pay		Tubing Depth		
Perforations		Depth Casing St					
TUBING, CASING, AND CEMENTING RECORD							
HOLE SIZE	CASING & TUBING SIZE		DEPTH SET		SACK		

VI. TEST DATA AND REQUEST FOR ALLOWABLE  
OIL WELL(Test must be after recovery of total volume of load oil and must be equal  
able for this depth or be for full 24 hours)

Date First New Oil Run To Tanks	Date of Test	Producing Method (Flow, pump, gas lift, etc.)	
Length of Test	Tubing Pressure	Casing Pressure	Casing Size
Actual Prod. During Test	Oil - Bbls.	Water - Bbls.	Gas - MCF

RECEIVED  
FEB 3 - 1983

## GAS WELL

Actual Prod. Test - MCF/D	Length of Test	Bbls. Condensate/Mcf	Gravity of Cond
Testing Method (pilot, back pr.)	Tubing Pressure (shut-in)	Casing Pressure (shut-in)	Choke Size

OIL CON. DIV.

DIST. 3

## I. CERTIFICATE OF COMPLIANCE

I hereby certify that the rules and regulations of the Oil Conservation  
Division have been complied with and that the information given  
above is true and complete to the best of my knowledge and belief.  
(Signature)Production/Revenue Supervisor  
(Title)1-28-83  
(Date)

OIL CONSERVATION DIVISION

FEB 3 - 1983

APPROVED

BY

DEPUTY COMMISSIONER

TITLE

This form is to be filed in compliance with  
If this is a request for allowable for a new  
well, this form must be accompanied by a tabul  
tests taken on the well in accordance with RU  
All sections of this form must be filled out  
able on new and recompleted wells.  
Fill out only Sections I, II, III, and VI f  
well name or number, or transporter, or other such  
Separate Form C-104 must be filed for

## OIL CONSERVATION DIVISION

P. O. BOX 2088

SANTA FE, NEW MEXICO 87501

NO. OF COPIES RECEIVED	
DISTRIBUTION	
SANTA FE	
FILE	
U.S.O.B.	
LAND OFFICE	
TRANSPORTER	OIL
	GAS
OPERATION	
PRODUCTION OFFICE	

REQUEST FOR ALLOWABLE  
AND  
AUTHORIZATION TO TRANSPORT OIL AND NATURAL GAS

I. OPERATOR	Petro Lewis Corporation		
Address	Box 16200 Lubbock, Texas 79400		
Reason(s) for filing (Check proper box)	OIL		
New Well	<input type="checkbox"/>	Change In Transporter of:	
Recompletion	<input type="checkbox"/>	Oil	<input type="checkbox"/>
Change In Ownership	<input checked="" type="checkbox"/>	Casinghead Gas	<input type="checkbox"/>
		Dry Gas	<input type="checkbox"/>
		Condensate	<input type="checkbox"/>

If change of ownership give name and address of previous owner Kenai Oil & Gas Inc. 717 17th Street Suite 2000 Denver Col

## II. DESCRIPTION OF WELL AND LEASE

Lease Name	well No.	Pool Name, Including Formation	Kind of Lease
State of New Mexico 16	21	Nageezi-Gallup	State, <del>XXXXXX</del>
Location			
Unit Letter <u>C</u>	<u>890</u>	Feet From The <u>North</u> Line and <u>1920</u>	Feet From The <u>West</u>
Line of Section <u>16</u>	Township <u>23N</u>	Range <u>8W</u>	, NMPM, <u>San Juan</u>

## III. DESIGNATION OF TRANSPORTER OF OIL AND NATURAL GAS

Name of Authorized Transporter of Oil <input checked="" type="checkbox"/> or Condensate <input type="checkbox"/>	Address (Give address to which approved copy of this form)		
Plateau Inc.	4775 Indian School Road NE Albuquerque		
Name of Authorized Transporter of Casinghead Gas <input checked="" type="checkbox"/> or Dry Gas <input type="checkbox"/>	Address (Give address to which approved copy of this form)		
Gas Company of NM (Div of Southern Union)	1800 1st International Bldg. Dallas		
If well produces oil or liquids, give location of tanks.	Unit	Sec.	Twp.
	C	16	23N
			Rge.
			8W
Is gas actually connected?	When		
yes	Unknown		

If this production is commingled with that from any other lease or pool, give commingling order number:

## V. COMPLETION DATA

Designate Type of Completion - (X)	Oil Well	Gas Well	New Well	Workover	Deepen	Plug Back	San
Date Spudded	Date Compl. Ready to Prod.	Total Depth	P.B.T.D.				
Elevations (DF, RKB, RT, CR, etc.)	Name of Producing Formation	Top Oil/Gas Pay	Tubing Depth				
Perforations					Depth Casing Sh		
TUBING, CASING, AND CEMENTING RECORD							
HOLE SIZE	CASING & TUBING SIZE	DEPTH SET	SACKS				

## V. TEST DATA AND REQUEST FOR ALLOWABLE OIL WELL (Test must be after recovery of total volume of load oil and must be equal able for this depth or be for full 24 hours)

Date First New Oil Run To Tanks	Date of Test	Producing Method (Flow, pump, gas lift, etc.)	
Length of Test	Tubing Pressure	Casing Pressure	Choke Size
Actual Prod. During Test	Oil-Bbls.	Water-Bbls.	Gas-MCF

## GAS WELL

Actual Prod. Test-MCF/D	Length of Test	Bbls. Condensate/MMCF	Gravity of Cond
Testing Method (pilot, back pr.)	Tubing Pressure (Shut-in)	Casing Pressure (Shut-in)	Choke Size

## VI. CERTIFICATE OF COMPLIANCE

I hereby certify that the rules and regulations of the Oil Conservation Division have been complied with and that the information given above is true and complete to the best of my knowledge and belief.

*James D. Smith*  
(Signature)  
Production/Revenue Supervisor  
(Title)  
11/1/82  
(Date)

## OIL CONSERVATION DIVISION

APPROVED NOV 12 1982  
BY *Charles Sholen*  
TITLE DEPUTY OIL & GAS INSPECTOR, DIST. #3

This form is to be filed in compliance with  
If this is a request for allowable for a newly well, this form must be accompanied by a tubular tests taken on the well in accordance with RUL  
All sections of this form must be filled out c able on new and recompleted wells.  
Fill out only Sections I, II, III, and VI for well name or number, or transporter, or other such  
Separate Forms C-104 must be filed for or

NO. OF COPIES RECEIVED		
DISTRIBUTION		
SANTA FE		
FILE		
U.S.G.S.		
LAND OFFICE		
TRANSPORTER	OIL	
	GAS	
OPERATOR		
PRORATION OFFICE		

NEW MEXICO OIL CONSERVATION COMMISSION  
REQUEST FOR ALLOWABLE  
AND  
AUTHORIZATION TO TRANSPORT OIL AND NATURAL GAS

Form C-104  
Supersedes Old C-104  
Effective 1-1-65

I. Operator  
Kenai Oil and Gas Inc.  
Address  
717 17th Street, Ste. 2000, Denver, CO 80202-3373  
Reason(s) for filing (Check proper box)  
New Well ☒ Change in Transporter of:  
Recompletion ☐ Oil ☐ Dry Gas ☐  
Change in Ownership ☐ Casinghead Gas ☐ Condensate ☐  
Other (Please explain)  
If change of ownership give name and address of previous owner

II. DESCRIPTION OF WELL AND LEASE

Lease Name	Well No.	Pool Name, Including Formation	Kind of Lease	Lease
State of New Mexico-16	21	Nageezi-Gallup Ext.	State, <del>NEW MEXICO</del>	LG-39
Location Unit Letter C ; 890 Feet From The North Line and 1920 Feet From The West Line of Section 16 Township 23N Range 8W , NMPM, San Juan				

III. DESIGNATION OF TRANSPORTER OF OIL AND NATURAL GAS

Name of Authorized Transporter of Oil <input checked="" type="checkbox"/> or Condensate <input type="checkbox"/>	Address (Give address to which approved copy of this form is to be sent)
Plateau, Inc.	4775 Indian School Rd., NE, Albuquerque, NM
Name of Authorized Transporter of Casinghead Gas <input checked="" type="checkbox"/> or Dry Gas <input type="checkbox"/>	Address (Give address to which approved copy of this form is to be sent)
Gas Company of N.M. (Div of Southern Union)	1800 1st International Bldg., Dallas, TX 7
If well produces oil or liquids, give location of tanks.	Unit Sec. Twp. Rge. Is gas actually connected? When
	C 16 23N 8W

If this production is commingled with that from any other lease or pool, give commingling order number:

IV. COMPLETION DATA

Designate Type of Completion - (X)	Oil Well	Gas Well	New Well	Workover	Deepen	Plug Back	Same Res'v.	Diff.
X	X		X					
Date Spudded	Date Compl. Ready to Prod.	Total Depth	P.B.T.D.					
4/30/81	6/17/81	5508'KB	5463'KB					
Elevations (DF, RKB, RT, GR, etc.)	Name of Producing Formation	Top Oil/Gas Pay	Tubing Depth					
7013'GL; 7026'KB	Lower & Upper Gallup	5398-5216'; 5178-5071'	5407.03'KB					
Perforations	5398-5312' (25 holes); 5281-16' (13 holes); 5178-06' (30 holes); 5095-71' (12 holes).	Depth Casing Shoe	5508'KB					
TUBING, CASING, AND CEMENTING RECORD								
HOLE SIZE	CASING & TUBING SIZE	DEPTH SET	SACKS CEMENT					
12-1/4"	8-5/8"	259'KB	275 SXS					
7-7/8"	5-1/2"	5508'KB	1125 SXS					
	2-3/8"	5407.03'KB						

V. TEST DATA AND REQUEST FOR ALLOWABLE OIL WELL

(Test must be after recovery of total volume of load oil and must be equal to or exceed top able for this depth or be for full 24 hours)

Date First New Oil Run To Tanks	Date of Test	Producing Method (Flow, pump, gas lift, etc.)	
6/10/81	6/16/81	Flow and swab.	
Length of Test	Tubing Pressure	Casing Pressure	Choke Size
12 hrs.		290 psi.	
Actual Prod. During Test	Oil-Bbls.	Water-Bbls.	Gas-MCF
	(63) 126	42	400

GAS WELL

Actual Prod. Test-MCF/D	Length of Test	Bbls. Condensate/MMCF	Gravity of Condensate
Testing Method (pilot, back pr.)	Tubing Pressure (shut-in)	Casing Pressure (shut-in)	Choke Size

VI. CERTIFICATE OF COMPLIANCE

I hereby certify that the rules and regulations of the Oil Conservation Commission have been complied with and that the information given above is true and complete to the best of my knowledge and belief.

*D. Shook*  
(Signature)

Manager of Operations  
(Title)

10/29/81  
(Date)

APPROVED

BY *Sam I. Long*

TITLE *SUPERVISOR DISTRICT #3*

OIL CONSERVATION COMMISSION  
NOV 5 - 1981  
This form is to be filed in compliance with RULE 1104.  
If this is a request for allowable for a newly drilled or deep well, this form must be accompanied by a tabulation of the dev tests taken on the well in accordance with RULE 111.  
All sections of this form must be filled out completely for able on new and recompleted wells.  
Fill out only Sections I, II, III, and VI for changes of well name or number, or transporter, or other such change of con  
Separate Forms C-104 must be filed for each pool in m completed wells.

CONTRIBUTION		
A FE		
OFFICE		
OPERATOR		

# NEW MEXICO OIL CONSERVATION COMMISSION WELL COMPLETION OR RECOMPLETION REPORT AND LOG

Revised 1-1-65

5a. Indicate Type of Lease	
State <u>21</u>	Fee <input type="checkbox"/>
5. State Oil & Gas Lease No. LG-3926	

1a. TYPE OF WELL		OIL WELL <input checked="" type="checkbox"/> GAS WELL <input type="checkbox"/> DRY <input type="checkbox"/> OTHER <input type="checkbox"/>		7. Unit Agreement Name None	
b. TYPE OF COMPLETION		NEW WELL <input checked="" type="checkbox"/> WORK OVER <input type="checkbox"/> DEEPEN <input type="checkbox"/> PLUG BACK <input type="checkbox"/> DIFF. RESVR. <input type="checkbox"/> OTHER <input type="checkbox"/>		8. Farm or Lease Name State of New Mexico-16	
2. Name of Operator Kenai Oil and Gas Inc.				9. Well No. #21	
3. Address of Operator 717 17th Street, Suite 2000, Denver, CO 80202				10. Field and Pool, or Wildcat Nageezi-Gallup Ext.	
4. Location of Well					
UNIT LETTER <u>C</u> LOCATED <u>890</u> FEET FROM THE <u>North</u> LINE AND <u>1920</u> FEET FROM <u>West</u> LINE OF SEC. <u>16</u> TWP. <u>23N</u> RGE. <u>8W</u> NMPM				12. County San Juan	
15. Date Spudded 4/30/81	16. Date T.D. Reached 5/9/81	17. Date Compl. (Ready to Prod.) 6/17/81	18. Elevations (DF, RKB, RT, GR, etc.) 7013'GL; 7026'KB	19. Elev. Casinghead ---	
20. Total Depth 5508'KB	21. Plug Back T.D. 5463'	22. If Multiple Compl., How Many None	23. Intervals Drilled By Rotary Tools Yes	Cable Tools No	
24. Producing Interval(s), of this completion - Top, Bottom, Name Lower Gallup: 5398-5216' Upper Gallup: 5178-5071'				25. Was Directional Survey Made No	
26. Type Electric and Other Logs Run DIFL/GR; CDL/CN/GR				27. Was Well Cored No	
28. CASING RECORD (Report all strings set in well)					
CASING SIZE	WEIGHT LB./FT.	DEPTH SET	HOLE SIZE	CEMENTING RECORD	AMOUNT PULLED
8-5/8"	23#	259'KB	12-1/4"	275 sxs	----
5-1/2"	14#	5508'KB	7-7/8"	1st stage; 275 sxs	----
				2nd stage; 850 sxs	----
29. LINER RECORD					
SIZE	TOP	BOTTOM	SACKS CEMENT	SCREEN	PACKER SET
	NONE				
30. TUBING RECORD			SIZE DEPTH SET		
			2-3/8" 5407.03'KB		
31. Perforation Record (Interval, size and number) SEE ATTACHED COMPLETION HISTORY NOV 25 1981			32. ACID, SHOT, FRACTURE, CEMENT SQUEEZE, ETC. DEPTH INTERVAL AMOUNT AND KIND MATERIAL USED SEE ATTACHED COMPLETION HISTORY NOV 5 - 1981 OIL CON. COM. DIST. 3		
33. DIVERTED PRODUCTION					
Date First Production 6/10/81		Production Method (Flowing, gas lift, pumping - Size and type pump) Swabbing and flowing.		Well Status (Flowing or Shut-in) Shut in	
Date of Test 6/16/81	Hours Tested 12	Choke Size	Prod'n. For Test Period 126	Oil - Bbl. 63	Gas - MCF 400
Flow Tubing Press.	Casing Pressure 290 psi.	Calculated 24-Hour Rate	Oil - Bbl. 126	Gas - MCF 800	Water - Bbl. 84
34. Disposition of Gas (Sold, used for fuel, vented, etc.) Will be sold when connected to gas pipeline.				Test Witnessed By Dave Howell	
35. List of Attachments Completion History, Wellsite Geologic Report					
36. I hereby certify that the information shown on both sides of this form is true and complete to the best of my knowledge and belief.					
SIGNED <u>D. S. Shoop</u>		TITLE <u>Manager of Operations</u>		DATE <u>10/30/81</u>	



NO. OF COPIES RECEIVED	
DISTRIBUTION	
SANTA FE	
FILE	
U.S.G.S.	
LAND OFFICE	
OPERATOR	

# NEW MEXICO OIL CONSERVATION COMMISSION

Form C-103  
Supersedes Old  
C-102 and C-103  
Effective 1-1-65

5a. Indicate Type of Lease
State <input checked="" type="checkbox"/> Fee <input type="checkbox"/>
5. State Oil & Gas Lease No. LG-3926

**SUNDRY NOTICES AND REPORTS ON WELLS**  
(DO NOT USE THIS FORM FOR PROPOSALS TO DRILL OR TO DEEPEN OR PLUG BACK TO A DIFFERENT RESERVOIR.  
USE "APPLICATION FOR PERMIT -" (FORM C-101) FOR SUCH PROPOSALS.)

1. OIL WELL <input checked="" type="checkbox"/> GAS WELL <input type="checkbox"/> OTHER- <input type="checkbox"/>	7. Unit Agreement Name NONE
2. Name of Operator Kenai Oil and Gas Inc.	8. Farm or Lease Name St. of New Mexico-16
3. Address of Operator 717 17th Street, Ste. 2000, Denver, CO 80202	9. Well No. #21
4. Location of Well UNIT LETTER C 890 FEET FROM THE North LINE AND 1920 FEET FROM THE West LINE, SECTION 16 TOWNSHIP 23N RANGE 8W NMPM.	10. Field and Pool, or Wildcat Nageezi-Gallup Ext.
15. Elevation (Show whether DF, RT, GR, etc.) 7013' GR	12. County San Juan

16. Check Appropriate Box To Indicate Nature of Notice, Report or Other Data  
NOTICE OF INTENTION TO: SUBSEQUENT REPORT OF:

PERFORM REMEDIAL WORK <input type="checkbox"/>	PLUG AND ABANDON <input type="checkbox"/>	REMEDIAL WORK <input type="checkbox"/>	ALTERING CASING <input type="checkbox"/>
TEMPORARILY ABANDON <input type="checkbox"/>	CHANGE PLANS <input type="checkbox"/>	COMMENCE DRILLING OPNS. <input type="checkbox"/>	PLUG AND ABANDONMENT <input type="checkbox"/>
PULL OR ALTER CASING <input type="checkbox"/>	OTHER <input type="checkbox"/>	CASING TEST AND CEMENT JOB <input type="checkbox"/>	OTHER <input checked="" type="checkbox"/> Well Status

17. Describe Proposed or Completed Operations (Clearly state all pertinent details, and give pertinent dates, including estimated date of starting any proposed work) SEE RULE 1103.

This well was spudded 4/30/81. Surface casing: ran 6 jts, 8-5/8", 23# casing and landed @ 259'KB. Cemented with 275 sxs cement plus 2% CaCl. Circulated 70 sxs cement to surface. Plug down @ 11 p.m., 4/30/81.

Production casing was run on 5/10 and 5/11/81 as follows: 138 jts, 5 1/2", 14# casing & was set at 5508'KB. 1st stage: cmt w/10 bbls mud flush and 25 bbls Spacer 3000, plus 275 sxs 50/50 Pozmix w/Class B cmt and 10% salt, 2% gel, and 0.6% flo-seal. Plug down @ 12 a.m., 5/11. 2nd stage: cmt w/10 bbls mud flush, 25 bbls Spacer 3000 and 800 sxs 65/35 Pozmix, plus 12% gel and tailed in with 50 sxs Class A cmt. Closed tool at 2:30 a.m., 5/11. From 1st stage; 25 bbls cmt circ to surface after stage collar opened. From 2nd stage; 155 bbls cmt circ to surface. Full returns throughout job.

Rig was released at 4 a.m., 5/11/81. Presently waiting on completion rig.

275  
800  
50  
1125

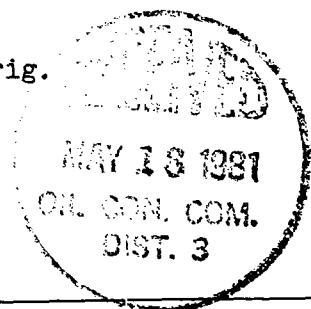

18. I hereby certify that the information above is true and complete to the best of my knowledge and belief.

SIGNED <u>George B. Judd</u>	TITLE <u>Manager - Drilling and Production</u>	DATE <u>5/11/81</u>
APPROVED BY <u>Frank J. [Signature]</u>	TITLE <u>SUPERVISOR DISTRICT # 3</u>	DATE <u>MAY 18 1981</u>
CONDITIONS OF APPROVAL, IF ANY:		

NO. OF COPIES RECEIVED	
DISTRIBUTION	
SANTA FE	
FILE	
U.S.G.S.	
LAND OFFICE	
OPERATOR	

P. O. BOX 2088  
SANTA FE, NEW MEXICO 87501

Form 1-101  
Revised 10-1-78

3A. Indicate Type of Lease  
STATE ☒ FEE ☐  
3. State Oil & Gas Lease No.  
LG 3926

APPLICATION FOR PERMIT TO DRILL, DEEPEN, OR PLUG BACK

1a. Type of Work  
b. Type of Well DRILL ☒ DEEPEN ☐ PLUG BACK ☐  
OIL WELL ☒ GAS WELL ☐ OTHER ☐ SINGLE ZONE ☒ MULTIPLE ZONE ☐

2. Name of Operator  
Kenai Oil & Gas, Inc.

3. Address of Operator  
2000 Energy Center One, 717-17th St., Denver, Colo. 80202

4. Location of Well UNIT LETTER C LOCATED 890' FEET FROM THE North LINE  
AND 1920' FEET FROM THE West LINE OF SEC. 16 TWP. 23N RGE. 8W NMPM

7. Well Agreement Name  
8. Farm or Lease Name  
State of New Mex.  
9. Well No.  
21

10. Field and Pool, or Wildcat  
Indesignated Gall

11. County  
San Juan

19. Proposed Depth  
5500'

19A. Formation  
Gallup

20. Rotary or C.T.  
Rotary

21. Elevations (Show whether DF, RT, etc.)  
7013 GL

21A. Kind & Status Plug. Band  
Blanket

21B. Drilling Contractor  
Westwind

22. Approx. Date Work will start  
12-10-80

23.

PROPOSED CASING AND CEMENT PROGRAM

SIZE OF HOLE	SIZE OF CASING	WEIGHT PER FOOT	SETTING DEPTH	SACKS OF CEMENT	EST. TOP
12 1/4	8 5/8	24#	550'	300sx	circulate
7 7/8	4 1/2	10.5 #	5500'	815sx	Ojo Alamo

Selectively test, perforate, and sandwater fracture the Gallup formation. A 3000 psi WP and 6000 psi test double gate preventer with blind and pipe rams will be used for blowout prevention.

The NENW of Section 16 is dedicated to this well.

APPROVAL VALID  
FOR 90 DAYS UNLESS  
DRILLING COMMENCED,

EXPIRES 8-13-81

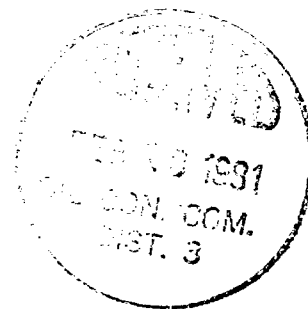

IN ABOVE SPACE DESCRIBE PROPOSED PROGRAM: IF PROPOSAL IS TO DEEPEN OR PLUG BACK, GIVE DATA ON PRESENT PRODUCTIVE ZONE AND PROPOSED NEW PRODUCTIVE ZONE. GIVE BLOWOUT PREVENTER PROGRAM, IF ANY.

I hereby certify that the information above is true and complete to the best of my knowledge and belief.

Signed [Signature] Title Agent/Kenai Oil & Gas, Inc Date 10-13-80

(This space for State Use)

APPROVED BY [Signature] TITLE SUPERVISOR DISTRICT # 3 DATE FEB 13 1981

CONDITIONS OF APPROVAL, IF ANY:

Operator <b>KENAI OIL &amp; GAS COMPANY</b>			Lease <b>STATE OF NEW MEXICO-16</b>		Well No. <b>21</b>
Unit Letter <b>C</b>	Section <b>16</b>	Township <b>23N</b>	Range <b>8W</b>	County <b>San Juan</b>	
Actual Footage Location of Wells: <b>890</b> feet from the <b>North</b> line and <b>1920</b> feet from the <b>West</b> line Ground Level Elev: <b>7013</b> Producing Formation <b>Gallup</b> Pool <b>40. Naguigi E.M.</b> Dedicated Acreage <b>40</b> Acres					

1. Outline the acreage dedicated to the subject well by colored pencil or hatchure marks on the plat below.
2. If more than one lease is dedicated to the well, outline each and identify the ownership thereof (both as to working interest and royalty).
3. If more than one lease of different ownership is dedicated to the well, have the interests of all owners been consolidated by communitization, unitization, force-pooling, etc?

☐ Yes ☐ No If answer is "yes," type of consolidation \_\_\_\_\_

If answer is "no," list the owners and tract descriptions which have actually been consolidated. (Use reverse side of this form if necessary.) \_\_\_\_\_

No allowable will be assigned to the well until all interests have been consolidated (by communitization, unitization, forced-pooling, or otherwise) or until a non-standard unit, eliminating such interests, has been approved by the Commission.

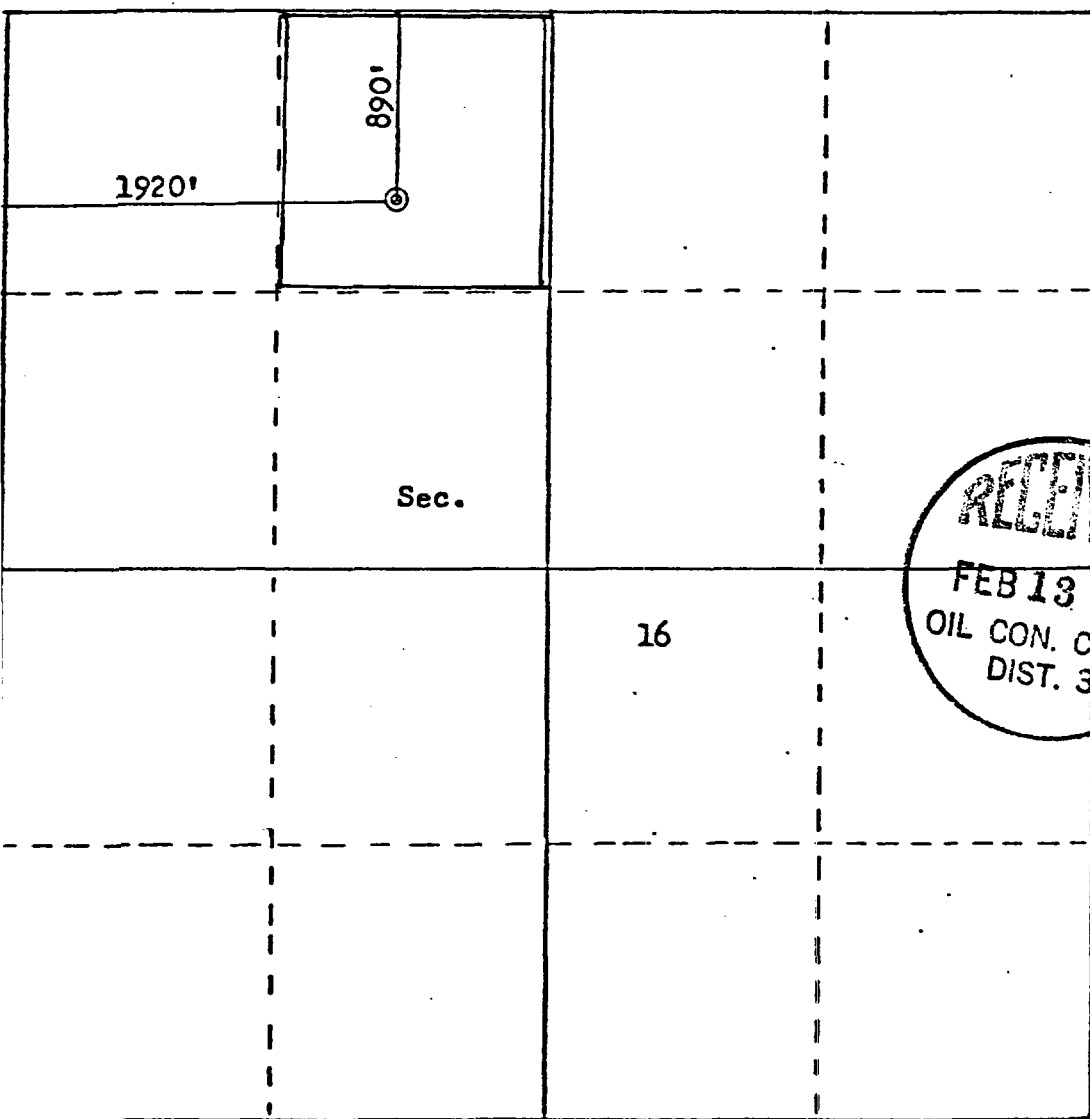

#### CERTIFICATION

I hereby certify that the information contained herein is true and complete to the best of my knowledge and belief.

Name

Position

Agent

Company

Kenai Oil & Gas

Date

10-15-80

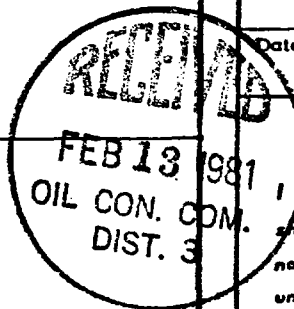

I hereby certify that the well location shown on this plat was plotted from field notes of actual surveys made by me or under my supervision, and that the same is true and correct to the best of my knowledge and belief.

Date Surveyed

October 10, 1980

Registered Professional Engineer and Land Surveyor

Fred B. Herrick Jr.

Certificate No. 2050

Scale: 1"=1000'

CMD :  
OG5SECT

ONGARD  
INQUIRE LAND BY SECTION

12/24/01 10:40:  
OGOMES -TP  
PAGE NO:

Sec : 16 Twp : 23N Rng : 08W Section Type : NORMAL

D 40.00 CS LG3926 0001 ERC INDUSTRIES IN 12/01/86	C 40.00 CS LG3926 0001 ERC INDUSTRIES IN 12/01/86 A	B 40.00 CS LG3926 0001 ERC INDUSTRIES IN 12/01/86	A 40.00 CS E08057 0009 AMOCO PROD CO & 04/13/6
E 40.00 CS LG3926 0001 ERC INDUSTRIES IN 12/01/86	F 40.00 CS LG3926 0001 ERC INDUSTRIES IN 12/01/86	G 40.00 CS LG3926 0001 ERC INDUSTRIES IN 12/01/86	H 40.00 CS LG3926 0001 ERC INDUSTRIES 12/01/8

PF01 HELP	PF02	PF03 EXIT	PF04 GoTo	PF05	PF06
PF07 BKWD	PF08 FWD	PF09 PRINT	PF10 SDIV	PF11	PF12

CMD :  
OG5SECT

ONGARD  
INQUIRE LAND BY SECTION

12/24/01 10:40:  
OGOMES -TP  
PAGE NO:

Sec : 16 Twp : 23N Rng : 08W Section Type : NORMAL

L 40.00 CS V05960 0000 ELM RIDGE EXPLORA 09/01/05	K 40.00 CS V05960 0000 ELM RIDGE EXPLORA 09/01/05	J 40.00 CS V05960 0000 ELM RIDGE EXPLORA 09/01/05	I 40.00 CS V05960 0000 ELM RIDGE EXPLO 09/01/0 A
M 40.00 CS V05960 0000 ELM RIDGE EXPLORA 09/01/05	N 40.00 CS V05960 0000 ELM RIDGE EXPLORA 09/01/05	O 40.00 CS E08057 0009 AMOCO PROD CO & C 04/13/64	P 40.00 CS V05960 0000 ELM RIDGE EXPLO 09/01/0

PF01 HELP	PF02	PF03 EXIT	PF04 GoTo	PF05	PF06
PF07 BKWD	PF08 FWD	PF09 PRINT	PF10 SDIV	PF11	PF12

CMD :  
OG6IWCM

ONGARD  
INQUIRE WELL COMPLETIONS

12/24/01 10:40:  
OGOMES -TP

API Well No : 30 45 24861 Eff Date : 09-01-1998 WC Status : A  
Pool Idn : 47540 NAGEEZI GALLUP  
OGRID Idn : 149052 ELM RIDGE RESOURCES INC  
Prop Idn : 24140 STATE OF NEW MEXICO 16

Well No : 021  
GL Elevation: 7013

	U/L	Sec	Township	Range	North/South	East/West	Prop/Act (P/
	---	---	-----	-----	-----	-----	-----
B.H. Locn : C	16	23N	08W	FTG	890 F N	FTG 1920 F W	P
Lot Identifier:							
Dedicated Acre: 40.00							
Lease Type : S							
Type of consolidation (Comm, Unit, Forced Pooling - C/U/F/O) :							

M0025: Enter PF keys to scroll

PF01 HELP	PF02	PF03 EXIT	PF04 GoTo	PF05	PF06
PF07	PF08	PF09	PF10 NEXT-WC	PF11 HISTORY	PF12 NXTREC

CMD : ONGARD 12/24/01 10:40:  
OG6ACRE C102-DEDICATE ACREAGE OGOMES -TP  
Page No :

API Well No : 30 45 24861 Eff Date : 04-30-1991  
Pool Idn : 47540 NAGEEZI GALLUP  
Prop Idn : 24140 STATE OF NEW MEXICO 16 Well No : 02  
Spacing Unit : 1237 OCD Order : Simultaneous Dedication:  
Sect/Twp/Rng : Acreage : 40.00 Revised C102? (Y/N) :  
Dedicated Land:

-----  
S Base U/L Sec Twp Rng Acreage L/W Ownership Lot Idn  
-----  
C 16 23N 08W 40.00 N ST  
-----

E0005: Enter data to modify or PF keys to scroll

PF01 HELP PF02 PF03 EXIT PF04 GoTo PF05 PF06 CONFIRM  
PF07 BKWD PF08 FWD PF09 PF10 LAND PF11 NXTSEC PF12 RECONF