

DATE 3/1/02	SUSPENSE 3/21/02	ENGINEER MS	LOGGED IN KN	TYPE NSL	APP NO 206051433
----------------	---------------------	----------------	-----------------	-------------	---------------------

ABOVE THIS LINE FOR DIVISION USE ONLY

NEW MEXICO OIL CONSERVATION DIVISION

- Engineering Bureau -

1220 South St. Francis Drive, Santa Fe, NM 87505



ADMINISTRATIVE APPLICATION CHECKLIST

THIS CHECKLIST IS MANDATORY FOR ALL ADMINISTRATIVE APPLICATIONS FOR EXCEPTIONS TO DIVISION RULES AND REGULATIONS WHICH REQUIRE PROCESSING AT THE DIVISION LEVEL IN SANTA FE

Application Acronyms:

[NSL-Non-Standard Location] [NSP-Non-Standard Proration Unit] [SD-Simultaneous Dedication]
 [DHC-Downhole Commingling] [CTB-Lease Commingling] [PLC-Pool/Lease Commingling]
 [PC-Pool Commingling] [OLS - Off-Lease Storage] [OLM-Off-Lease Measurement]
 [WFX-Waterflood Expansion] [PMX-Pressure Maintenance Expansion]
 [SWD-Salt Water Disposal] [IPI-Injection Pressure Increase]
 [EOR-Qualified Enhanced Oil Recovery Certification] [PPR-Positive Production Response]

[1] TYPE OF APPLICATION - Check Those Which Apply for [A]

[A] Location - Spacing Unit - Simultaneous Dedication

☒ NSL ☐ NSP ☐ SD

Check One Only for [B] or [C]

[B] Commingling - Storage - Measurement

☐ DHC ☐ CTB ☐ PLC ☐ PC ☐ OLS ☐ OLM

[C] Injection - Disposal - Pressure Increase - Enhanced Oil Recovery

☐ WFX ☐ PMX ☐ SWD ☐ IPI ☐ EOR ☐ PPR

[D] Other: Specify _____

[2] NOTIFICATION REQUIRED TO: - Check Those Which Apply, or Does Not Apply

[A] ☐ Working, Royalty or Overriding Royalty Interest Owners

[B] ☐ Offset Operators, Leaseholders or Surface Owner

[C] ☐ Application is One Which Requires Published Legal Notice

[D] ☐ Notification and/or Concurrent Approval by BLM or SLO
 U.S. Bureau of Land Management - Commissioner of Public Lands, State Land Office

[E] ☐ For all of the above, Proof of Notification or Publication is Attached, and/or,

[F] ☐ Waivers are Attached

[3] SUBMIT ACCURATE AND COMPLETE INFORMATION REQUIRED TO PROCESS THE TYPE OF APPLICATION INDICATED ABOVE.

[4] **CERTIFICATION:** I hereby certify that the information submitted with this application for administrative approval is **accurate and complete** to the best of my knowledge. I also understand that **no action** will be taken on this application until the required information and notifications are submitted to the Division.

Note: Statement must be completed by an individual with managerial and/or supervisory capacity.

Robert Bullock
 Print or Type Name

Robert Bullock
 Signature

Landman
 Title

2-26-02
 Date

e-mail Address

MARTIN YATES, III
1912 - 1985
FRANK W. YATES
1936 - 1986



105 SOUTH FOURTH STREET
ARTESIA, NEW MEXICO 88210-2118
TELEPHONE (505) 748-1471

S. P. YATES
CHAIRMAN OF THE BOARD
JOHN A. YATES
PRESIDENT
PEYTON YATES
EXECUTIVE VICE PRESIDENT
RANDY G. PATTERSON
SECRETARY
DENNIS G. KINSEY
TREASURER

February 26, 2002

Mr. Michael Stogner
New Mexico Oil Conservation Division
1220 South St. Francis Drive
Santa Fe, New Mexico 87505

CERTIFIED MAIL
Return Receipt Requested

7004 8
(Oil) cat Abo
C.H.S.

RE: Non-Standard Location
Grande Mike AZK St. #1
Township 16 South, Range 29 East
Section 2: 1650' FSL & 1550' FWL
Eddy County, New Mexico

Dear Mr. Stogner:

Yates Petroleum Corporation hereby requests administrative approval for a non-standard Abo oil well location, the Grande Mike AZK St. #1. This well is located on State of New Mexico minerals at a location of 1650' FSL and 1550' FWL of Section 2, Township 16 South, Range 29 East, Eddy County, New Mexico.

Yates permitted and drilled this well to the Morrow formation reaching total depth of 10,700' on November 30, 2001. Failed completion attempts were made in the Chester, Austin, Morrow, Atoka and Cisco formations. The well was completed on February 1, 2002 as an ABO oil well at the non-standard location. No notification is required in this application as Yates owns the spacing units to the north, west and south of Lot S. There are no overriding royalty owners.

Please find enclosed a land plat, C-101, C-102, C-105 and administrative application checklist.

Please advise me if additional information is needed by calling me at (505) 748-4351.

Thank you.

Very truly yours,

YATES PETROLEUM CORPORATION

Robert Bullock
Landman

RB:bn
enclosure(s)

Yates Petroleum Corporation
Grand Mike AZK St. #1
1650' FSL & 1550' FWL
Section 2-T16S-R29E
Eddy County, New Mexico

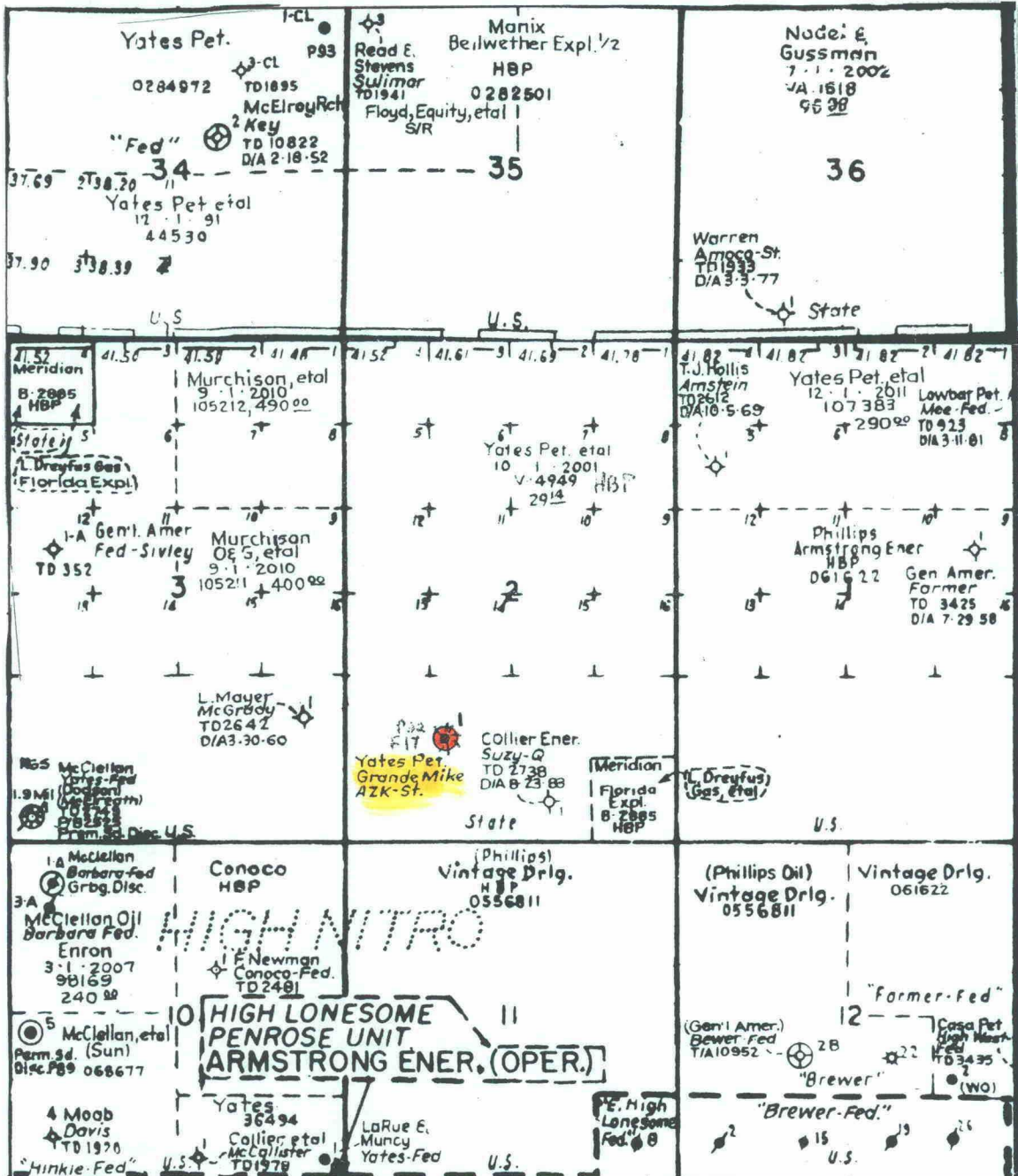

District I
1625 N. French Dr., Hobbs, NM 88240

District II
811 South First, Artesia, NM 88210

District III
1000 Rio Brazos Rd., Aztec, NM 87410

District IV
1220 S. St. Francis Dr., Santa Fe, NM 87505

State of New Mexico
Energy, Minerals & Natural Resources Department

OIL CONSERVATION DIVISION
1220 South St. Francis Dr.
Santa Fe, NM 87505

Form C-102
Revised August 15, 2000

Submit to Appropriate District Office
State Lease - 4 Copies
Fee Lease - 3 Copies

☐ AMENDED REPORT

WELL LOCATION AND ACREAGE DEDICATION PLAT

¹ API Number 30-015-31941	² Pool Code 96048	³ Pool Name Wildcat Abo
⁴ Property Code 28584	⁵ Property Name Grande Mike AZK State	⁶ Well Number #1
⁷ OGRID No. 025575	⁸ Operator Name Yates Petroleum Corporation	⁹ Elevation 3733' GR

¹⁰ Surface Location

UL or lot no.	Section	Township	Range	Lot Idn	Feet from the	North/South line	Feet from the	East/West line	County
S	2	16S	29E		1650	South	1550	West	Eddy

¹¹ Bottom Hole Location If Different From Surface

UL or lot no.	Section	Township	Range	Lot Idn	Feet from the	North/South line	Feet from the	East/West line	County

¹² Dedicated Acres 40	¹³ Joint or Infill	¹⁴ Consolidation Code	¹⁵ Order No.

NO ALLOWABLE WILL BE ASSIGNED TO THIS COMPLETION UNTIL ALL INTERESTS HAVE BEEN CONSOLIDATED OR A NON-STANDARD UNIT HAS BEEN APPROVED BY THE DIVISION

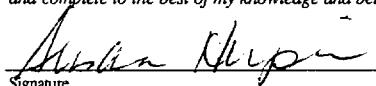
¹⁶ L	K	J	I	¹⁷ OPERATOR CERTIFICATION <i>I hereby certify that the information contained herein is true and complete to the best of my knowledge and belief.</i>  Signature Susan Herpin Printed Name Engineering Technician Title February 22, 2002 Date
M	N	O	P	
T 1550'	VO-4949 S	R	Q	¹⁸ SURVEYOR CERTIFICATION <i>I hereby certify that the well location shown on this plat was plotted from field notes of actual surveys made by me or under my supervision, and that the same is true and correct to the best of my belief.</i> Date of Survey Signature and Seal of Professional Surveyor: See Original Plat Certificate Number
U	1650' V	W	X	

COPY

DISTRICT I
1625 N. French Dr., Hobbs, NM 88240

DISTRICT II
811 South First, Artesia, NM 88210

DISTRICT III
1000 Rio Brazos Rd., Aztec, NM 87410

DISTRICT IV
2040 South Pacheco, Santa Fe, NM 87501

State of New Mexico
Energy, Minerals and Natural Resources Department

OIL CONSERVATION DIVISION
PO BOX 2088
Santa Fe, NM 87504-2088

Form C-101

Revised March 17, 1999

Submit to appropriate District Office
Instructions on back

Lease - 6 Copies

Free Lease - 5 Copies

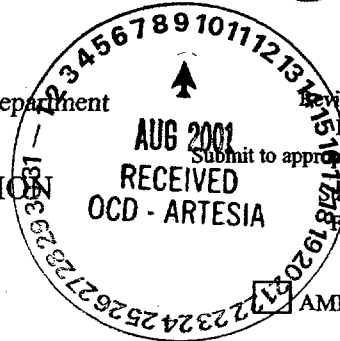

AMENDED REPORT

APPLICATION FOR PERMIT TO DRILL, RE-ENTER, DEEPEN, PLUGBACK, OR ADD A ZONE

¹ Operator Name and Address Yates Petroleum Corporation 105 South Fourth Street Artesia, New Mexico 88210		² OGRID Number 025575
		³ API Number 30- 015- 31941
⁴ Property Code 28584	⁵ Property Name Grande Mike AZK State	⁶ Well No. 1

⁷ Surface Location

UL or lot no.	Section	Township	Range	Lot Idn	Feet from the	North/South Line	Feet from the	East/West Line	County
S	2	16S	29E		1650'	South	1550'	West	Eddy

⁸ Proposed Bottom Hole Location If Different From Surface

UL or lot no.	Section	Township	Range	Lot Idn	Feet from the	North/South Line	Feet from the	East/West Line	County
⁹ Proposed Pool 1 Wildcat Mississippian						¹⁰ Proposed Pool 2			

¹¹ Work Type Code N	¹² Well Type Code G	¹³ Cable/Rotary R	¹⁴ Lease Type Code S	¹⁵ Ground Level Elevation 3733'
¹⁶ Multiple N	¹⁷ Proposed Depth 10800'	¹⁸ Formation Mississippian	¹⁹ Contractor Not Determined	²⁰ Spud Date ASAP

²¹ Proposed Casing and Cement Program

Hole Size	Casing Size	Casing weight/feet	Setting Depth	Sacks of Cement	Estimated TOC
14 3/4"	11 3/4"	42#	400'	600 sx	Surface
11"	8 5/8"	32#	2800'	1700 sx	Surface
7 7/8"	5 1/2"	17#	10800'	700 sx	TOC-6800'

²² Describe the proposed program. If this application is to DEEPEN or PLUG BACK give the data on the present productive zone and proposed new productive zone. Describe the blowout prevention program, if any. Use additional sheets if necessary.

Yates Petroleum Corporation proposes to drill and test the Mississippian and intermediate formations. Approximately 400' of surface casing will be set and cement circulated to shut off gravel and cavings. If commercial, production casing will be run and cemented, will perforate and stimulate as needed for production.

MUD PROGRAM: 0-400' FWGel/Paper; 400'-2700' Brine; 2700'-10000' Cut Brine; 10000'-10800' Salt Gel/Starch/Driscap.

BOPE PROGRAM: A 5000# BOPE will be installed on the 8 5/8" casing and tested daily.

²³ I hereby certify that the information given above is true and complete to the best of my knowledge and belief. Signature: <i>Cy Cowan</i>		OIL CONSERVATION DIVISION Approved by: ORIGINAL SIGNED BY TIM W. GUM Title: DISTRICT II SUPERVISOR	
Printed name: Cy Cowan		Title: Regulatory Agent	
Date: 08/08/01		Approval Date: AUG 09 2001 Expiration Date: AUG 09 2002	
Phone: (505) 748-1471		Conditions of Approval Attached <input type="checkbox"/>	

TRICT I

J. French Dr., Hobbs, NM 88240

DISTRICT H

811 South First, Artesia, NM 88210

DISTRICT III

1000 Rio Brazos Rd., Aztec, NM 87410

DISTRICT IV

2048 South Pacheco, Santa Fe, NM 87505

State of New Mexico

Energy, Minerals and Natural Resources Department

Form C-102

Revised March 17, 1999

Instructions on back

Submit to Appropriate District Office

State Lease - 4 Copies

Fee Lease - 3 Copies

OIL CONSERVATION DIVISION

P.O. Box 2088

Santa Fe, New Mexico 87504-2088

☐ AMENDED REPORT

WELL LOCATION AND ACREAGE DEDICATION PLAT

API Number	Pool Code	Pool Name Wildcat Mississippian
Property Code	Property Name GRANDE MIKE "AZK" STATE	Well Number 1
OGHD No. 025575	Operator Name YATES PETROLEUM CORPORATION	Elevation 3733

Surface Location

UL or lot No.	Section	Township	Range	Lot Idn	Feet from the	North/South line	Feet from the	East/West line	County
S	2	16S	29E		1650	SOUTH	1550	WEST	EDDY

Bottom Hole Location If Different From Surface

UL or lot No.	Section	Township	Range	Lot Idn	Feet from the	North/South line	Feet from the	East/West line	County
Dedicated Acres 320	Joint or Infill	Consolidation Code	Order No.						

NO ALLOWABLE WILL BE ASSIGNED TO THIS COMPLETION UNTIL ALL INTERESTS HAVE BEEN CONSOLIDATED
OR A NON-STANDARD UNIT HAS BEEN APPROVED BY THE DIVISION

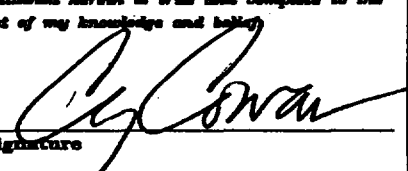
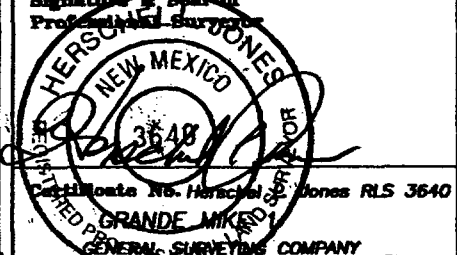
L	K	J	I	OPERATOR CERTIFICATION I hereby certify the the information contained herein to true and complete to the best of my knowledge and belief.  Signature Cy Cowan Printed Name Regulatory Agent Title August 8, 2001 Date
M	N	O	P	
VO-4949 T	N.32°56'52.8" W.104°02'58.6"	R	Q	SURVEYOR CERTIFICATION I hereby certify that the well location shown on this plat was plotted from field notes of actual surveys made by me or under my supervision, and that the same is true and correct to the best of my belief. 8/07/2001 Date Surveyed Signature of Registered Professional Surveyor  Herschel Jones RLS 3640 GRANDE MIKE GENERAL SURVEYING COMPANY
1550' U	1650' V	W	X	

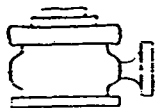

Yates Petroleum Corporation

BOP-4

Typical 5,000 psi Pressure System Schematic Annular with Double Ram Preventer Stack

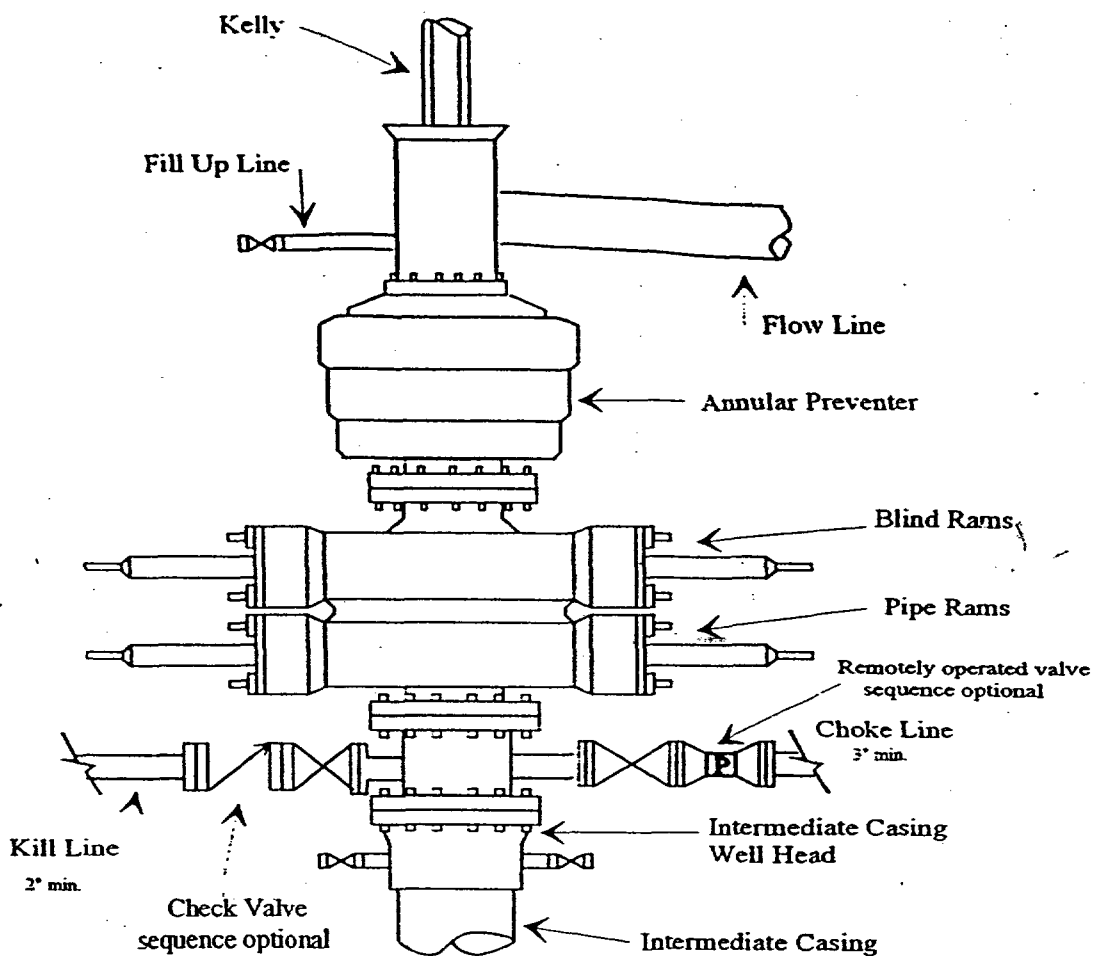

Typical 5,000 psi choke manifold assembly with at least these minimum features

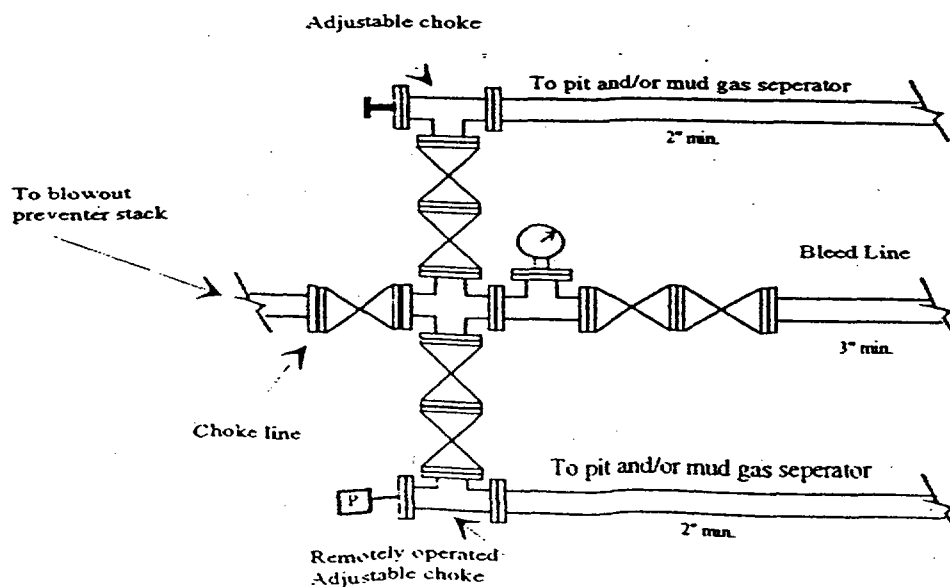

Submit To Appropriate District Office
State Lease - 6 copies
Fee Lease - 5 copies
CONDITIONS OF APPROVAL, IF ANY:
1625 N. French Dr., Hobbs, NM 88240
District II
811 South First, Artesia, NM 88210
District III
1000 Rio Brazos Rd., Aztec, NM 87410
District IV
1220 S. St. Francis Dr., Santa Fe, NM 87505

State of New Mexico
Energy, Minerals and Natural Resources

Form C-105
Revised March 25, 1999

Oil Conservation Division
1220 South St. Francis Dr.
Santa Fe, NM 87505

WELL API NO.

30-015-31941

5. Indicate Type of Lease

STATE ☒ FEE ☐

State Oil & Gas Lease No.

VO-4949

WELL COMPLETION OR RECOMPLETION REPORT AND LOG

1a. Type of Well:

OIL WELL ☒ GAS WELL ☐ DRY ☐ OTHER ☐

b. Type of Completion:

NEW WORK PLUG DIFF.
WELL ☒ OVER ☐ DEEPEN ☐ BACK ☐ RESVR. ☐ OTHER ☐

2. Name of Operator

Yates Petroleum Corporation

3. Address of Operator

105 South 4th St., Artesia, NM 88210

7. Lease Name or Unit Agreement Name

Grande Mike AZK State

8. Well No.

#1

Pool name or Wildcat

Wildcat Abo

4. Well Location

Unit Letter : 1650 Feet From The South Line and 1550 Feet From The West Line
Section 2 Township 16S Range 29E NMPM Eddy County

10. Date Spudded

RH - 10/1/01

RT - 10/25/01

11. Date T.D. Reached

11/30/01

12. Date Compl. (Ready to Prod.)

2/1/02

13. Elevations (DF & RKB, RT, GR, etc.)

3733' GR

14. Elev. Casinghead

15. Total Depth

10,700'

16. Plug Back T.D.

8555'

17. If Multiple Compl. How Many Zones?

18. Intervals Drilled By

Rotary Tools

Cable Tools

40-10,700'

19. Producing Interval(s), of this completion - Top, Bottom, Name

7240-7280' Abo

20. Was Directional Survey Made

No

21. Type Electric and Other Logs Run

CNL/LDC, Laterolog, Sonic

22. Was Well Cored

No

23. CASING RECORD (Report all strings set in well)

CASING SIZE	WEIGHT LB./FT.	DEPTH SET	HOLE SIZE	CEMENTING RECORD	AMOUNT PULLED
16"		40'	20"	Cement to surface	
11-3/4"	42#	385'	14-3/4"	300 sxs circ	
8-5/8"	32#	2625'	11"	925 sxs circ	
5-1/2"	17#	10,700'	7-7/8"	650 sxs	

24. LINER RECORD

SIZE	TOP	BOTTOM	SACKS CEMENT	SCREEN

25. TUBING RECORD

SIZE	DEPTH SET	PACKER SET
2-7/8"	7532'	None

26. Perforation record (interval, size, and number)

Abo 7240-7280' 41 holes .42"

27. ACID, SHOT, FRACTURE, CEMENT, SQUEEZE, ETC.

DEPTH INTERVAL AMOUNT AND KIND MATERIAL USED

7240-7280' 3000 gals 20% gelled IC HCL

28. PRODUCTION

Date First Production		Production Method (Flowing, gas lift, pumping - Size and type pump)			Well Status (Prod. or Shut-in)		
2/1/02		Pumping			Producing		
Date of Test	Hours Tested	Choke Size	Prod'n For Test Period	Oil - Bbl	Gas - MCF	Water - Bbl.	Gas - Oil Ratio
2/8/02	24			32	17	3	
Flow Tubing Press.	Casing Pressure	Calculated 24-Hour Rate	Oil - Bbl.	Gas - MCF	Water - Bbl.	Oil Gravity - API - (Corr.)	
50#	50 #		32	17	3		

29. Disposition of Gas (Sold, used for fuel, vented, etc.)

Vented

Test Witnessed By

Dan Dolan

30. List Attachments

Logs, deviation survey

31. I hereby certify that the information shown on both sides of this form as true and complete to the best of my knowledge and belief

Signature  Printed Name Susan Herpin Title Engineering Tech. Date February 15, 2002

10

This form is to be filed with the appropriate District Office of the Division not later than 20 days after the completion of any newly-drilled or deepened well. It shall be accompanied by one copy of all electrical and radio-activity logs run on the well and a summary of all special tests conducted, including drill stem tests. All depths reported shall be measured depths. In the case of directionally drilled wells, true vertical depths shall also be reported. For multiple completions, items 25 through 29 shall be reported for each zone. The form is to be filed in quintuplicate except on state land, where six copies are required. See Rule 1105.

INDICATE FORMATION TOPS IN CONFORMANCE WITH GEOGRAPHICAL SECTION OF STATE

Southeastern New Mexico			Northwestern New Mexico		
T. Anhy		T. Canyon	T. Ojo Alamo		T. Penn. "B"
T. Salt		T. Strawn 9390'	T. Kirtland-Fruitland		T. Penn. "C"
B. Salt		T. Atoka 9918'	T. Pictured Cliffs		T. Penn. "D"
T. Yates		T. Miss	T. Cliff House		T. Leadville
T. 7 Rivers		T. Devonian	T. Menefee		T. Madison
T. Queen		T. Silurian	T. Point Lookout		T. Elbert
T. Grayburg		T. Montoya	T. Mancos		T. McCracken
T. San Andres		T. Simpson	T. Gallup		T. Ignacio (Otzte
T. Glorieta		T. McKee	Base Greenhorn		T. Granite
T. Paddock		T. Ellenburger	T. Dakota		T. _____
T. Blinebry		T. Gr. Wash	T. Morrison		T. _____
T. Tubb		T. Delaware Sand	T. Todilto		T. _____
T. Drinkard		T. Bone Springs	T. Entrada		T. _____
T. Abo 6022'		T. Yeso	T. Wingate		T. _____
T. Wolfcamp 7350'		T. Ordovician	T. Chinle		T. _____
T. Penn. Clastics		T. Morrow 10,227'	T. Permian		T. _____
T. Cisco 8156'		T. Austin 10,352'	T. Penn. "A"		T. _____
		T. Chester 10,593'			

OIL OR GAS SANDS
OR ZONES

No. 1, from.....to.....
No. 2, from.....to.....
No. 3, from.....to.....
No. 4, from.....to.....

IMPORTANT WATER SANDS

Include data on rate of water inflow and elevation to which water rose in hole.

No. 1, from.....to.....feet.....
 No. 2, from.....to.....feet.....
 No. 3, from.....to.....feet.....

LITHOLOGY RECORD (Attach additional sheet if necessary)

From	To	Thickness In Feet	Lithology

From	To	Thickness In Feet	Lithology

Yates Petroleum Corporation
Grande Mike AZK State #1
API - 30-015-31941
Section 2 T16S-R29E
Eddy County, NM

Results of DST #1 7230-7292' (Wolfcamp)

Recovery: 20' of mud
Sampler: 2600 cc mud
Pressures:
IHP 3380
IFP 27-58
ISIP 1881
FFP 66-60
FSIP 1757
FHP 3383
Times: 15", 60", 60", 120"

Results of DST #2 7738-7790' (Wolfcamp)

Recovery: 112 bbls water (jetted) and 66 bbls water (drill pipe)
Sampler: 2600 cc water
Pressures:
IHP 3584
IFP 1122-1959
ISIP 2788
2nd FP 2112-2588
2nd SIP 2910
FFP jetting
FHP 3560
Times: 15", 60", 90", 454", 400"

District I
PO Box 1980, Hobbs, NM 88241-1980
District II
PO Drawer DD, Artesia, NM 88211-0719
District III
1000 Rio Brazos Rd., Aztec, NM 87410
District IV
PO Box 2088, Santa Fe, NM 87504-2088

State of New Mexico
Energy, Minerals & Natural Resources Department

OIL CONSERVATION DIVISION
PO Box 2088
Santa Fe, NM 87504-2088

Form C-104
Revised February 10, 1994
Instructions on back
Submit to Appropriate District Office
5 Copies

☐ AMENDED REPORT

I. REQUEST FOR ALLOWABLE AND AUTHORIZATION TO TRANSPORT

1. Operator Name and Address Yates Petroleum Corporation 104 South 4th St. Artesia, NM 88210 505-748-1471		2. OGRID Number 25575
		3. Reason for Filing Code RT TO TEST ABO PERFS 7240-7280' FOR FEB, 2002 = 2240 BO, 2520 MCF-(flared)
4. API Number 30-015-31941	5. Pool Name UNDESIGNATED ABO	6. Pool Code 96048
7. Property Code 28584	8. Property Name GRANDE MIKE AZK STATE	9. Well Number 1

II. 10. Surface Location

UL or lot no. SR	Section 2	Township 16S	Range 29E	Lot Idn.	Feet From the 1650	North/South Line S	Feet From the 1550	East/West Line W	County EDDY
---------------------	--------------	-----------------	--------------	----------	-----------------------	-----------------------	-----------------------	---------------------	----------------

11. Bottom Hole Location

UL or lot no.	Section	Township	Range	Lot Idn.	Feet From the	North/South Line	Feet From the	East/West Line	County
12. Lee Code S	13. Producing Method Code F	14. Gas Connection Date	15. C-129 Permit Number	16. C-129 Effective Date	17. C-129 Expiration Date				

III. Oil and Gas Transporters

18. Transporter OGRID 138648	19. Transporter Name and Address AMOCO P/L INTL TRUCKING 502 N WEST AVENUE LEVELLAND, TX 79336	20. POD 2821162	21. OIG O	22. POD ULSTR Location and Description

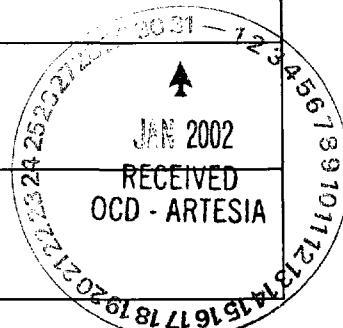

IV. Produced Water

23. POD	24. POD ULSTR Location and Description

V. Well Completion Data

25. Spud Date	26. Ready Date	27. TD	28. PBTD	29. Perforations
30. Hole Size	31. Casing & Tubing Size	32. Depth Set	33. Sacks Cement	

VI. Well Test Data

34. Date New Oil	35. Gas Delivery Date	36. Test Date	37. Test Length	38. Tbg. Pressure	39. Csg. Pressure
40. Choke Size	41. Oil	42. Water	43. Gas	44. AOF	45. Test Method

46. I hereby certify that the rules of the Oil Conservation Division have been complied with and that the information given above is true and complete to the best of my knowledge and belief.

Signature: *Donna Clack*

Printed Name: Donna Clack
Title: Operations Technician
Date: 31-Jan-02 Phone: 505-748-1471

Approved By: *[Signature]*

Title:

Approval Date

OIL CONSERVATION DIVISION
HONOR TESTING
FOR 30 DAYS ONLY
TRANSPORTER'S DIVISION
FEB 05 2002

47. If this is a change of operator fill in OGRID number and name of the previous operator.

Previous Operator Signature	Printed Name	Title	Date

SF

DISTRICT I
1625 N. French Dr., Hobbs, NM 88240

State of New Mexico
Energy, Minerals and Natural Resources Department

Form C-101
Revised March 17, 1999
Instructions on back
Submit to appropriate District Office
State Lease - 6 Copies
Fee Lease - 5 Copies

DISTRICT II
811 South First, Artesia, NM 88210

OIL CONSERVATION DIVISION
PO BOX 2088
Santa Fe, NM 87504-2088

DISTRICT III
1000 Rio Brazos Rd., Aztec, NM 87410

DISTRICT IV
2040 South Pacheco, Santa Re, NM 8750.

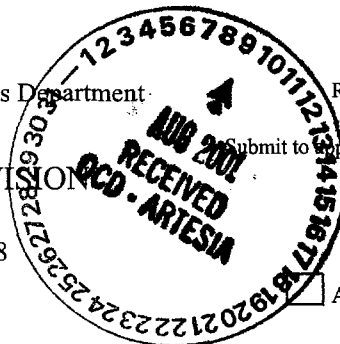

AMENDED REPORT

APPLICATION FOR PERMIT TO DRILL, RE-ENTER, DEEPEN, PLUGBACK, OR ADD A ZONE

¹ Operator Name and Address Yates Petroleum Corporation 105 South Fourth Street Artesia, New Mexico 88210		² OGRID Number 025575
		³ API Number 30- 015 - 31941
⁴ Property Code 28584	⁵ Property Name Grande Mike AZK State	⁶ Well No. 1

⁷ Surface Location

UL or lot no.	Section	Township	Range	Lot Idn	Feet from the	North/South Line	Feet from the	East/West Line	County
5	2	16S	29E		1650'	South	1550'	West	Eddy

⁸ Proposed Bottom Hole Location If Different From Surface

UL or lot no.	Section	Township	Range	Lot Idn	Feet from the	North/South Line	Feet from the	East/West Line	County
⁹ Proposed Pool 1 Wildcat Mississippian					¹⁰ Proposed Pool 2				

¹¹ Work Type Code N	¹² Well Type Code G	¹³ Cable/Rotary R	¹⁴ Lease Type Code S	¹⁵ Ground Level Elevation 3733'
¹⁶ Multiple N	¹⁷ Proposed Depth 10800'	¹⁸ Formation Mississippian	¹⁹ Contractor Not Determined	²⁰ Spud Date ASAP

²¹ Proposed Casing and Cement Program

Hole Size	Casing Size	Casing weight/feet	Setting Depth	Sacks of Cement	Estimated TOC
14 3/4"	11 3/4"	42#	400'	600 sx	Surface
11"	8 5/8"	32#	2800'	1700 sx	Surface
7 7/8"	5 1/2"	17#	10800'	700 sx	TOC-6800'

²² Describe the proposed program. If this application is to DEEPEN or PLUG BACK give the data on the present productive zone and proposed new production. Describe the blowout prevention program, if any. Use additional sheets if necessary.

Yates Petroleum Corporation proposes to drill and test the Mississippian and intermediate formations. Approximately 400' of surface casing will be set and cement circulated to shut off gravel and cavings. If commercial, production casing will be run and cemented, will perforate and stimulate as needed for production.

MUD PROGRAM: 0-400' FWGel/Paper; 400'-2700' Brine; 2700'-10000' Cut Brine; 10000'-10800' Salt Gel/Starch/Driscac.

BOPE PROGRAM: A 5000# BOPE will be installed on the 8 5/8" casing and tested daily.

²³ I hereby certify that the information given above is true and complete to the best of my knowledge and belief. Signature: <i>Cy Cowan</i>		OIL CONSERVATION DIVISION Approved by: <i>Jim W. Brown</i> Title: <i>District Supervisor</i>	
Printed name: Cy Cowan		Title: District Supervisor	
Title: Regulatory Agent		Approval Date: AUG 09 2001	
Date: 08/08/01	Phone: (505) 748-1471	Expiration Date: AUG 09 2002	
		Conditions of Approval ... Attached <input type="checkbox"/>	

STRICT I
85 N. French Dr., Hobbs, NM 88240

STRICT II
1 South First, Artesia, NM 88210

STRICT III
00 Rio Brazos Rd., Artesia, NM 87410

STRICT IV
48 South Pacheco, Santa Fe, NM 87506

State of New Mexico
Energy, Minerals and Natural Resources Department

Form C-102
Revised March 17, 1999
Instruction on back
Submit to Appropriate District Office
State Lease - 4 Copies
Fee Lease - 3 Copies

OIL CONSERVATION DIVISION
P.O. Box 2088
Santa Fe, New Mexico 87504-2088

☐ AMENDED REPORT

WELL LOCATION AND ACREAGE DEDICATION PLAT

API Number	Pool Code	Pool Name
		Wildcat Mississippian
Property Code	Property Name	Well Number
	GRANDE MIKE "AZK" STATE	1
OGED No.	Operator Name	Elevation
025575	YATES PETROLEUM CORPORATION	3733

Surface Location

UL or lot No.	Section	Township	Range	Lot Idn	Feet from the	North/South line	Feet from the	East/West line	County
S	2	16S	29E		1650	SOUTH	1550	WEST	EDDY

Bottom Hole Location If Different From Surface

UL or lot No.	Section	Township	Range	Lot Idn	Feet from the	North/South line	Feet from the	East/West line	County

Dedicated Acres	Joint or Infill	Consolidation Code	Order No.
320			

NO ALLOWABLE WILL BE ASSIGNED TO THIS COMPLETION UNTIL ALL INTERESTS HAVE BEEN CONSOLIDATED
OR A NON-STANDARD UNIT HAS BEEN APPROVED BY THE DIVISION

L	K	J	I
M	N	O	P
T 1550'	N.32°56'52.8" W.104°02'56.8" 1650'	R	Q
U	V	W	X

OPERATOR CERTIFICATION

I hereby certify that the information contained herein is true and complete to the best of my knowledge and belief.

Cy Cowan

Signature

Cy Cowan

Printed Name

Regulatory Agent

Title

August 8, 2001

Date

SURVEYOR CERTIFICATION

I hereby certify that the well location shown on this plat was plotted from field notes of actual surveys made by me or under my supervision, and that the same is true and correct to the best of my belief.

8/07/2001

Date Surveyed

Signature of State of Professional Surveyor

HERSCHEL JONES

3648

Certification No. Herschel Jones RLS 3640

GRANDE MIKE

GENERAL SURVEYING COMPANY

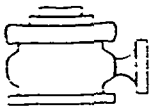

Yates Petroleum Corporation

BOP-4

Typical 5,000 psi Pressure System Schematic Annular with Double Ram Preventer Stack

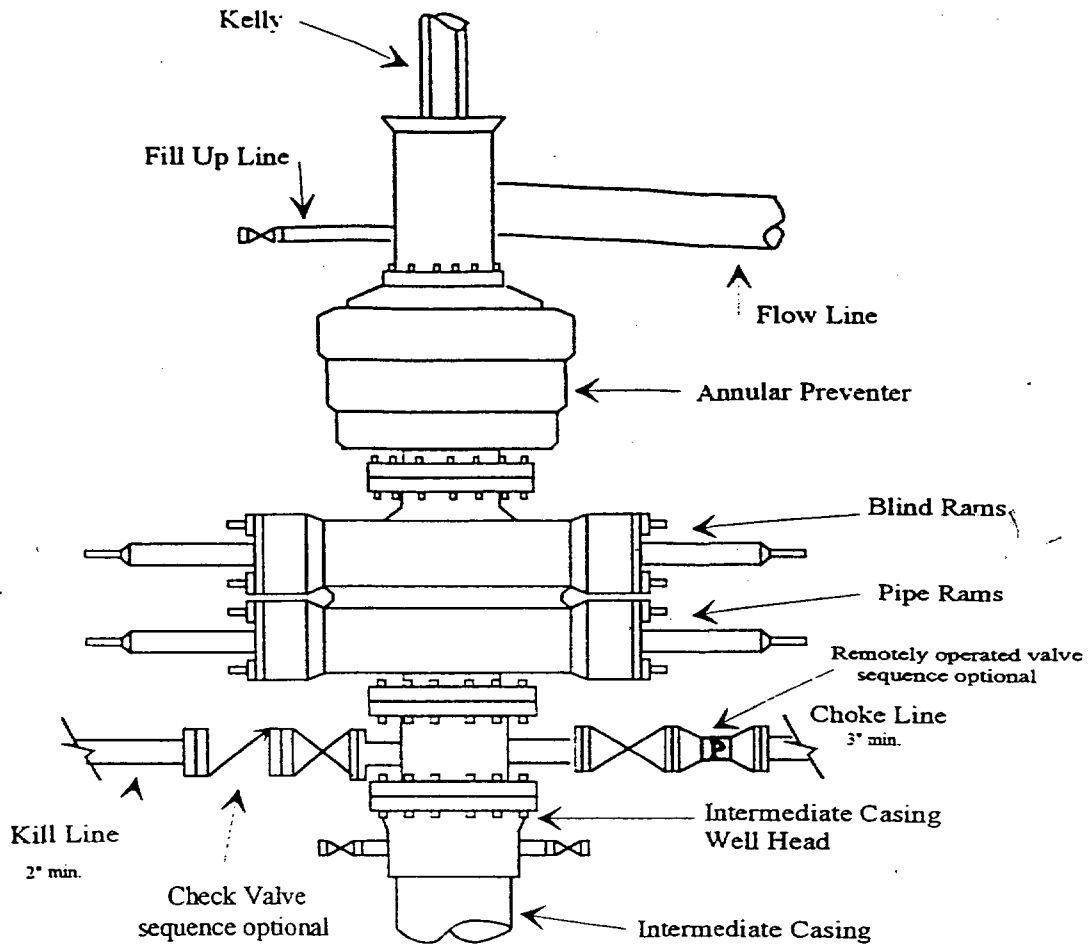

Typical 5,000 psi choke manifold assembly with at least these minimum features

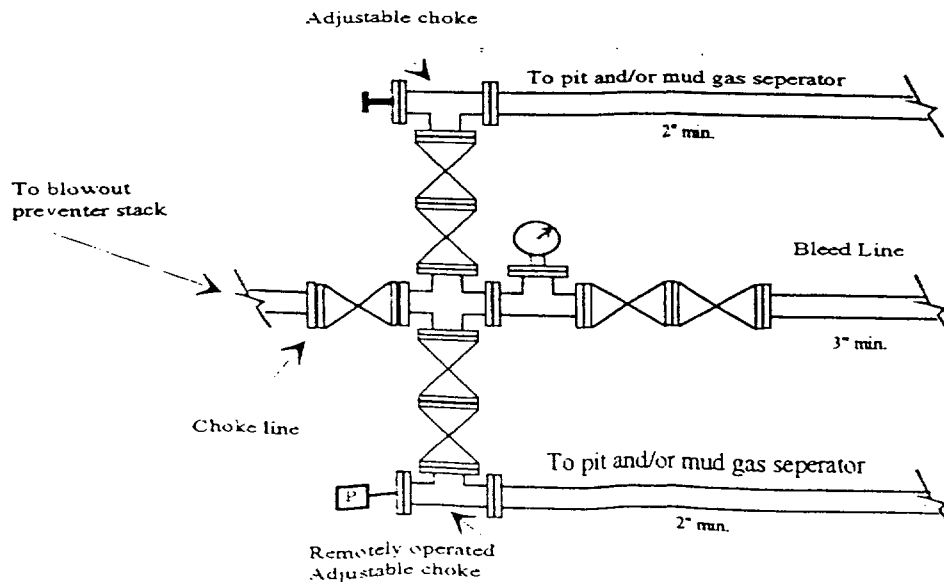

5F

DISTRICT I
1625 N. French Dr., Hobbs, NM 88240

DISTRICT II
811 South First, Artesia, NM 88210

DISTRICT III
1000 Rio Brazos Rd., Aztec, NM 87410

DISTRICT IV
2040 South Pacheco, Santa Re, NM 8750:

State of New Mexico
Energy, Minerals and Natural Resources Department

OIL CONSERVATION DIVISION
PO BOX 2088
Santa Fe, NM 87504-2088

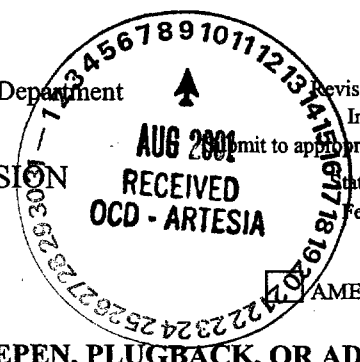

Form C-101
Revised March 17, 1999
Instructions on back
Submit to appropriate District Office
State Lease - 6 Copies
Fee Lease - 5 Copies
AMENDED REPORT

APPLICATION FOR PERMIT TO DRILL, RE-ENTER, DEEPEN, PLUGBACK, OR ADD A ZONE

¹ Operator Name and Address Yates Petroleum Corporation 105 South Fourth Street Artesia, New Mexico 88210		² OGRID Number 025575
		³ API Number 30- 015 - 31941
⁴ Property Code 28584	⁵ Property Name Grande Mike AZK State	⁶ Well No. 1

7 Surface Location

UL or lot no.	Section	Township	Range	Lot Idn	Feet from the	North/South Line	Feet from the	East/West Line	County
8	2	16S	29E		1650'	South	1550'	West	Eddy

8 Proposed Bottom Hole Location If Different From Surface

UL or lot no.	Section	Township	Range	Lot Idn	Feet from the	North/South Line	Feet from the	East/West Line	County
⁹ Proposed Pool 1 Wildcat Mississippian					¹⁰ Proposed Pool 2				

¹¹ Work Type Code N	¹² Well Type Code G	¹³ Cable/Rotary R	¹⁴ Lease Type Code S	¹⁵ Ground Level Elevation 3733'
¹⁶ Multiple N	¹⁷ Proposed Depth 10800'	¹⁸ Formation Mississippian	¹⁹ Contractor Not Determined	²⁰ Spud Date ASAP

21 Proposed Casing and Cement Program

Hole Size	Casing Size	Casing weight/feet	Setting Depth	Sacks of Cement	Estimated TOC
14 3/4"	11 3/4"	42#	400'	600 sx	Surface
11"	8 5/8"	32#	2800'	1700 sx	Surface
7 7/8"	5 1/2"	17#	10800'	700 sx	TOC-6800'

²² Describe the proposed program. If this application is to DEEPEN or PLUG BACK give the data on the present productive zone and proposed new productiv
Describe the blowout prevention program, if any. Use additional sheets if necessary.

Yates Petroleum Corporation proposes to drill and test the Mississippian and intermediate formations. Approximately 400' of surface casing will be set and cement circulated to shut off gravel and cavings. If commercial, production casing will be run and cemented, will perforate and stimulate as needed for production.

MUD PROGRAM: 0-400' FWGel/Paper; 400'-2700' Brine; 2700'-10000' Cut Brine; 10000'-10800' Salt Gel/Starch/Drispac.

BOPE PROGRAM: A 5000# BOPE will be installed on the 8 5/8" casing and tested daily.

²³ I hereby certify that the information given above is true and complete to the best of my knowledge and belief. Signature: <i>Cy Cowan</i>		OIL CONSERVATION DIVISION	
Printed name: Cy Cowan		Approved by: ORIGINAL SIGNED BY TIM W. GUM	
Title: Regulatory Agent		Title: DISTRICT II SUPERVISOR	
Date: 08/08/01	Phone: (505) 748-1471	Approval Date: AUG 09 2001	Expiration Date: AUG 09 2002
		Conditions of Approval Attached <input type="checkbox"/>	

DISTRICT I
225 W. French Dr., Hobbs, NM 88240
DISTRICT II
11 South First, Artesia, NM 88210
DISTRICT III
200 Rio Brazos Rd., Artesia, NM 87410
DISTRICT IV
949 South Pacheco, Santa Fe, NM 87505

State of New Mexico
Energy, Minerals and Natural Resources Department

Form C-102
Revised March 17, 1999
Instruction on back
Submit to Appropriate District Office
State Lease - 4 Copies
Fee Lease - 3 Copies

OIL CONSERVATION DIVISION
P.O. Box 2088
Santa Fe, New Mexico 87504-2088

☐ AMENDED REPORT

WELL LOCATION AND ACREAGE DEDICATION PLAT

API Number	Pool Code	Pool Name
		Wildcat Mississippian
Property Code	Property Name	Well Number
	GRANDE MIKE "AZK" STATE	1
OGRID No.	Operator Name	Elevation
025575	YATES PETROLEUM CORPORATION	3733

Surface Location

UL or lot No.	Section	Township	Range	Lot 1/4	Feet from the	North/South line	Feet from the	East/West line	County
S	2	16S	29E		1650	SOUTH	1550	WEST	EDDY

Bottom Hole Location If Different From Surface

UL or lot No.	Section	Township	Range	Lot 1/4	Feet from the	North/South line	Feet from the	East/West line	County

Dedicated Acres	Joint or Infill	Consolidation Code	Order No.
320			

NO ALLOWABLE WILL BE ASSIGNED TO THIS COMPLETION UNTIL ALL INTERESTS HAVE BEEN CONSOLIDATED
OR A NON-STANDARD UNIT HAS BEEN APPROVED BY THE DIVISION

L	K	J	I
M	N	O	P
T 1550'	N.32°56'52.8" W.104°02'56.6" 1850'	R	Q
U	V	W	X

OPERATOR CERTIFICATION

I hereby certify that the information contained herein is true and complete to the best of my knowledge and belief.

Cy Cowan
Signature
Cy Cowan
Printed Name
Regulatory Agent
Title
August 8, 2001
Date

SURVEYOR CERTIFICATION

I hereby certify that the well location shown on this plat was plotted from field notes of actual surveys made by me or under my supervision, and that the same is true and correct to the best of my belief.

8/07/2001
Date Surveyed
Signature of State of Professional Surveyor
HERSCHEL JONES
Certification No. Herschel Jones RLS 3640
GRANDE MIKE
GENERAL SURVEYING COMPANY

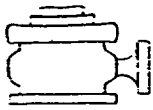

Yates Petroleum Corporation

BOP-4

Typical 5,000 psi Pressure System Schematic Annular with Double Ram Preventer Stack

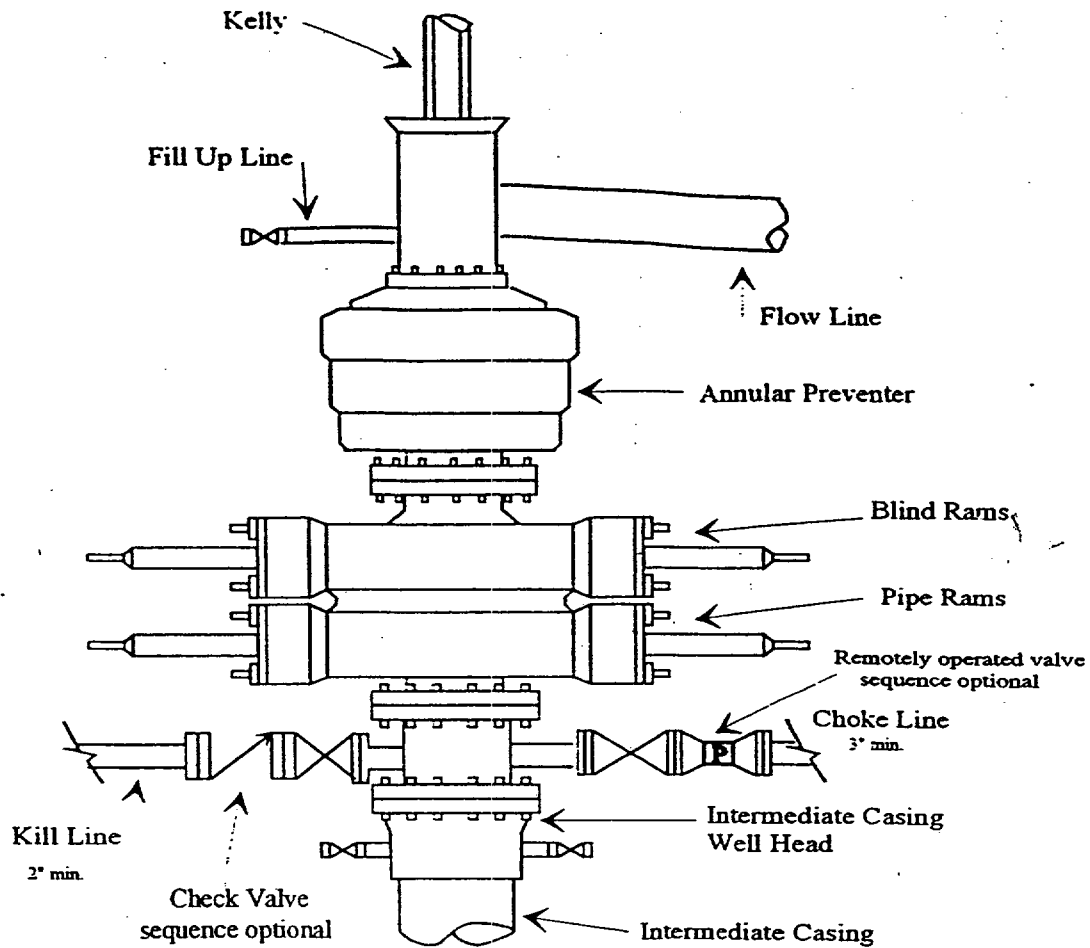

Typical 5,000 psi choke manifold assembly with at least these minimum features

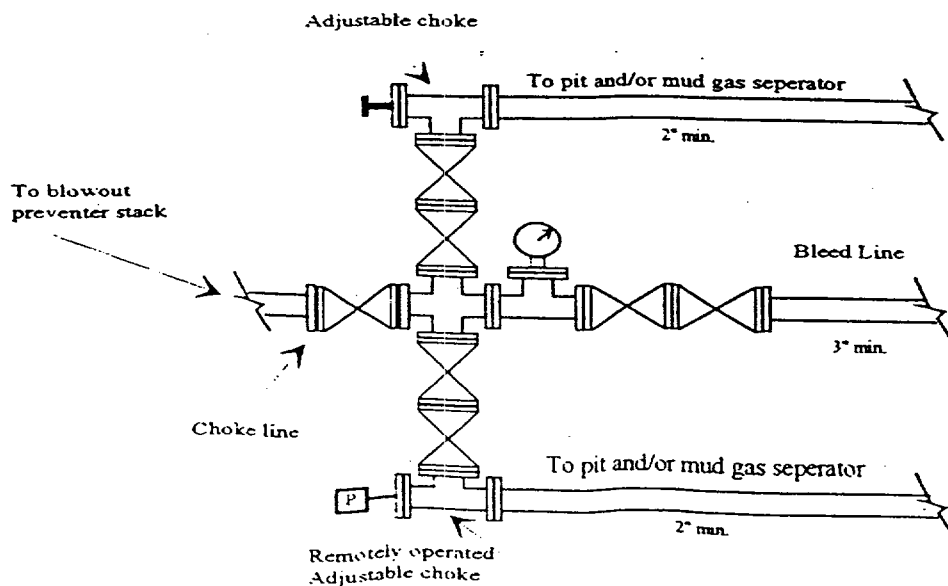

Submit 3 copies
to Appropriate
District Office

Form C-103
Revised 1-1-89

SP

State of New Mexico
Energy, Minerals and Natural Resources Department

OIL CONSERVATION DIVISION
P.O. Box 2088
Santa Fe, New Mexico 87504-2088

DISTRICT I
P.O. Box 1980, Hobbs NM 88240
DISTRICT II
P.O. Drawer DD, Artesia NM 88210
DISTRICT III
000 Rio Brazos Rd., Aztec NM 87410

WELL API NO.
30-015-31941

5. Indicate Type of Lease
State ☒ FEE ☐

6. Lease Name or Unit Agreement Name
Grande Mike "AZK" State

8. Well No
#1

9. Pool Name or Wildcat
Wildcat Mississippian

SUNDRY NOTICES AND REPORTS ON WELLS
(DO NOT USE THIS FORM FOR PROPOSALS TO DRILL OR TO DEEPEN OR PLUG BACK OR TO
DIFFERENT RESERVOIR. USE "APPLICATION FOR PERMIT"
(FORM C-101) FOR SUCH PROPOSALS.)

1. Type of Well:
OIL ☐ GAS ☐
WELL ☐ WELL ☒ OTHER ☐

2. Name of Operator
Yates Petroleum Corporation

3. Address of Operator
105 South 4th., Artesia, NM 88210

4. Well Location
Unit Letter **S** : **1650'** Feet From The **South** Line and **1550'** Feet From The **West** Line
Section **2** Township **16S** Range **29E** NMPM **Eddy** COUNTY

10. Elevation (Show whether DF, RKB, RT, GR, etc.)
3733' GL

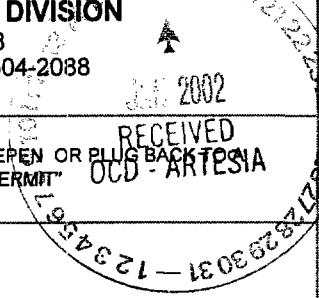

11. Check Appropriate Box to Indicate Nature of Notice, Report, or Other Data

NOTICE OF INTENTION TO:	SUBSEQUENT REPORT OF:
PERFORM REMEDIAL WORK <input type="checkbox"/>	REMEDIAL WORK <input type="checkbox"/>
TEMPORARILY ABANDON <input type="checkbox"/>	ALTERING CASING <input type="checkbox"/>
PULL OR ALTER CASING <input type="checkbox"/>	COMMENCE DRILLING OPNS. <input type="checkbox"/>
OTHER <input type="checkbox"/>	PLUG AND ABANDONMENT <input type="checkbox"/>
	CASING TEST AND CEMENT JOB <input type="checkbox"/>
	OTHER <input checked="" type="checkbox"/> Spud, conductor, resume drilling, surface casing & cement

12. Describe Proposed or Completed Operations (Clearly state all pertinent details, and give pertinent dates, including estimated date of starting any proposed work) SEE RULE 1103.

10-02-01-TD 10'. Spudded at 10:00 AM 10-01-01. Notified Van Barton with Artesia OCD. 10-16-01 Waiting on rotary tools. Finished building location. 10-18-01-TD 40' Made 30'. Resumed drilling at 3:00 PM 10-17-01. Drilled to 40' and set 40' of 16" conductor. Notified Van with OCD in Artesia of continuous operation and conductor setting. 10/25/01-Drilled 300' Redbed. Made 260' in 4 hours, 65'/hr. Rigged up rotary tools resumed drilling at 1:45 AM 10-25-01. 1-26-01-TD 385' surface. Made 85' in 1-1/4 hours, 68'/hr. TD 14-3/4" hole at 7:15 am 10-25-01. Rigged up and ran 9 joints 11-3/4" 42" 42# H-5 casing, set at 385'. Cemented with 300 sacks Class "C" with 2% CaC12. PD at 10:45 AM 10-25-01. Circulated 171 sacks. WOC Drilling 2066' salt and anhydrite. Made 751' in 23-3/4 hours, 31.62'/hr. Drilling 2621' anhydrite. Made 555' in 23-1/2 hours, 23.62'/hr. 10-30-01-TD 2625' anhydrite. Test BOP. Made 4' in 1/4 hour. 16'/hr.

Resubmit & note WOC Time BA

I hereby certify that the information above is true and complete to the best of my knowledge and belief.

SIGNATURE Erma Vazquez TITLE Operations Technician DATE January 15, 2002

TYPE OR PRINT NAME Erma Vazquez TELEPHONE NO 505-748-1471

(This space)
APPROVED _____ DATE JAN 28 2002
CONDITION _____

FOR RECORD ONLY

SE

State of New Mexico
Energy, Minerals and Natural Resources Department

OIL CONSERVATION DIVISION
P.O. Box 2088
Santa Fe, New Mexico 87504-2088

DISTRICT I
P.O. Box 1980, Hobbs NM 88240
DISTRICT II
P.O. Drawer DD, Artesia NM 88210
DISTRICT III
1000 Rio Brazos Rd., Aztec NM 87410

WELL APN NO.	
30-015-31941	
5. Indicate Type of Lease	
State <input checked="" type="checkbox"/>	FEE <input type="checkbox"/>
7. Lease Name or Unit Agreement Name	
Grande Mike "AZK" State	
8. Well No	
#1	
9. Pool Name or Wildcat	
Wildcat Mississippian	

SUNDY NOTICES AND REPORTS ON WELLS
(DO NOT USE THIS FORM FOR PROPOSALS TO DRILL OR TO DEEPEN OR PLUG BACK TO A DIFFERENT RESERVOIR. USE "APPLICATION FOR PERMIT (FORM C-101) FOR SUCH PROPOSALS.)

1. Type of Well:
OIL ☐ GAS ☐
WELL ☐ WELL ☒ OTHER ☐

2. Name of Operator
Yates Petroleum Corporation

3. Address of Operator
105 South 4th., Artesia, NM 88210

4. Well Location
Unit Letter S : 1650' Feet From The South Line and 1550' Feet From The West Line
Section 2 Township 16S Range 29E NMPM Eddy COUNTY

10. Elevation (Show whether DF, RKB, RT, GR, etc.)
3733' GL

11. Check Appropriate Box to Indicate Nature of Notice, Report, or Other Data

NOTICE OF INTENTION TO:	SUBSEQUENT REPORT OF:
PERFORM REMEDIAL WORK <input type="checkbox"/>	REMEDIAL WORK <input type="checkbox"/>
TEMPORARILY ABANDON <input type="checkbox"/>	ALTERING CASING <input type="checkbox"/>
PULL OR ALTER CASING <input type="checkbox"/>	COMMENCE DRILLING OPNS. <input type="checkbox"/>
OTHER <input type="checkbox"/>	PLUG AND ABANDONMENT <input type="checkbox"/>
	CASING TEST AND CEMENT JOB <input type="checkbox"/>
	OTHER <input type="checkbox"/>
	Perforate, acidize & frac <input checked="" type="checkbox"/>

12. Describe Proposed or Completed Operations (Clearly state all pertinent details, and give pertinent dates, including estimated date of starting any proposed work) SEE RULE 1103.

12/12/01-Moved in and rigged up pulling unit. Tagged at 10,665'. Rigged up. Pickled tubing with 1000 gals 15% HCL. Displaced hole with 7% KCL with surfactants. Logged GR/CBL from 10,66-6200' with 1500 psi. Shut in. TIH with 4" casing. Loaded 1 JSPF. Spot Chester Lime 10,594-10,610' with 17-.42" holes and Austin Cycle 10,372-10,378' with 7-.42" holes. TIH with packer and RBP. Set RBP at 10,603. Spotted 2 bbls 15% gelled IC HCL at 10,615'. Pulled up to 10,561'. Set packer. Broke down Chester perms at 7240 psi. Acidized 10,594-10,610' with 2000 gals 15% gelled HCL. Rigged up swab. Swabbed back 30 bbls. 12/17/01 swabbed dry and recovered 44 bbls. Shut in. 12/18/01-Moved tools and straddle Austin Cycle. Tested RBP to 1000#. Spotted 1 bbl acid. Pulled up and set packer. Broke down perms 10,372-78' at 6015 psi. Acidized with 1000 gal 15% gelled IC HCL. 12/18/01-Released packer and RBP. Set 5-1/2" CIBP at 10,365'. Perforated Morrow Sand 6 JSPF at 10,306-10' (30), 10,314-28' (90), 10,338-44' (42). Total 162 .42 holes TUH. 12-21-01 straddle 10,338-44'. Spotted 150 gals 7-1/2% Morrow acid. Pumped 7 bbls 2 BPM @ 3400 psi. 1-9-01-TIH with 5-1/2" Arrow packer with 2.25 tool to 10,234'. 1/10/02-Acidized Morrow 10,300-44' with 1750 gals 7-1/2% Morrow acid with 1000 SCF N2/bbl.

I hereby certify that the information above is a true and complete to the best of my knowledge and belief.

SIGNATURE Erma Vazquez TITLE Drilling Technician DATE January 15, 2002
TYPE OR PRINT NAME Erma Vazquez TELEPHONE NO 505-748-1471

(This space for State Use)

APPROVED BY ORIGINAL SIGNED BY TIM W. GUM DATE JAN 28 2002
CONDITIONS OF APPROVAL DISTRICT II SUPERVISOR

SP

DISTRICT I
P.O. Box 1980, Hobbs NM 88240
DISTRICT II
P.O. Drawer DD, Artesia NM 88210
DISTRICT III
1000 Rio Brazos Rd., Aztec NM 87410

State of New Mexico
Energy, Minerals and Natural Resources Department

OIL CONSERVATION DIVISION

P.O. Box 2088
Santa Fe, New Mexico 87504-2088

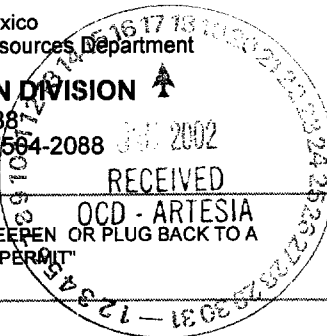

WELL APNO.	30-015-31941
5. Indicate Type of Lease	State <input checked="" type="checkbox"/> FEE <input type="checkbox"/>
7. Lease Name or Unit Agreement Name	Grande Mike "AZK" State
8. Well No	#1
9. Pool Name or Wildcat	Wildcat Mississippian

SUNDRY NOTICES AND REPORTS ON WELLS
(DO NOT USE THIS FORM FOR PROPOSALS TO DRILL OR TO DEEPEN OR PLUG BACK TO A DIFFERENT RESERVOIR. USE "APPLICATION FOR PERMIT" (FORM C-101) FOR SUCH PROPOSALS.)

1. Type of Well:
OIL ☐ GAS ☐
WELL ☐ WELL ☒ OTHER ☐

2. Name of Operator
Yates Petroleum Corporation

3. Address of Operator
105 South 4th., Artesia, NM 88210

4. Well Location
Unit Letter S : 1650' Feet From The South Line and 1550' Feet From The West Line
Section 2 Township 16S Range 29E NMPM Eddy COUNTY

10. Elevation (Show whether DF, RKB, RT, GR, etc.)
3733' GL

11. Check Appropriate Box to Indicate Nature of Notice, Report, or Other Data

NOTICE OF INTENTION TO:	SUBSEQUENT REPORT OF:
PERFORM REMEDIAL WORK <input type="checkbox"/>	REMEDIAL WORK <input type="checkbox"/>
TEMPORARILY ABANDON <input type="checkbox"/>	ALTERING CASING <input type="checkbox"/>
PULL OR ALTER CASING <input type="checkbox"/>	COMMENCE DRILLING OPNS. <input type="checkbox"/>
OTHER <input type="checkbox"/>	CASING TEST AND CEMENT JOB <input type="checkbox"/>
	OTHER <u>Intermediate casing & cement</u> <input checked="" type="checkbox"/>

12. Describe Proposed or Completed Operations (Clearly state all pertinent details, and give pertinent dates, including estimated date of starting any proposed work) SEE RULE 1103.

TD 11" hole at 6:15 am 10-29-01. Pumped sweep and circulate. Strap out of hole and lay down 8" drill collars. Rigged up and ran 63 joints 8-5/8" 32# J-55 casing. Pumped 725 sacks of Class "C" Lite (35:65:6 with .25#/sx celloflake + 5% LCM-1 + 6% bentonite (yld 1.95, wt 12.5). Tailed in with 200 sacks Class "C" with 1% CaCl2 (yld 1.34, wt 14.8). PD at 2:45 PM 10-29-01. Circulated 116 sacks to pit. WOC. 10-31-01-Drilling 2740' dolomite and anhydrite. Maded 115' in 3-3/4 hours, 30.67'/hr. Tested BOP, choke manifold, kelly to 5000# for 30 mins, OK. TIH and picked up 9-6" drill collars. Tagged cement at 2565'. Tested casing to 1000#, OK. Drilled out at 2:15 AM 10-31-01. WOC 35 hours 30 mins. Reduced hole to 7-7/8" and resumed drilling. Drilling 4268' sand and dolomite. Made 667' in 22-1/2 hours, 29.64'/hr. 11-3-01- Drilling 4869' dolomite and sand. Made 601' in 22-3/4 hours, 26.42'/hr. 10-4-01-Drilling 5480' dolomite. Made 611' in 23 1/4 hours, 26.28'/hr. 11-5-01-'TD 6045' dolomite. Trip for bit. Made 565' in 19 hours, 29.74'/hr. 11-6-01- 'TD 6105' shale, dolomite and anhydrite. TOH and layed down junk basket. Maded 60' in 9-3/4 hours, 6.15'/hr. 11/7/01-Drilled 6365' shale, dolomite and anhydrite. Maded

CONTINUE ON NEXT PAGE Missing 2nd Page

I hereby certify that the information above a true and complete to the best of my knowledge and belief.

SIGNATURE Erma Vazquez TITLE Drilling Technician DATE January 15, 2002

TYPE OR PRINT NAME Erma Vazquez TELEPHONE NO 505-748-1471

APPROVED BY _____ DATE JAN 28 2002

CONDITIONS OF _____

DISTRICT I
P.O. Box 1980, Hobbs, NM 88240

DISTRICT II
P.O. Drawer DD, Artesia, NM 88210

DISTRICT III
1000 Rio Brazos Rd., Aztec, NM 87410

OIL CONSERVATION DIVISION
2040 Pacheco St.
Santa Fe, NM 87505

WELL API NO. 30-015-31941
5. Indicate Type of Lease STATE <input checked="" type="checkbox"/> FEE <input type="checkbox"/>
6. State Oil & Gas Lease No. V-4949

SUNDRY NOTICES AND REPORTS ON WELLS
(DO NOT USE THIS FORM FOR PROPOSALS TO DRILL OR TO DEEPEN OR PLUG BACK TO A
DIFFERENT RESERVOIR. USE "APPLICATION FOR PERMIT"
(FORM C-101) FOR SUCH PROPOSALS)

1. Type of Well:
OIL WELL ☐ GAS WELL ☒ OTHER

2. Name of Operator
Yates Petroleum Corporation

3. Address of Operator
105 S. 4th Street, Artesia, NM 88210

4. Well Location
Unit Letter _____ : 1,650 Feet From The South Line and 1,550 Feet From The West Line
Section 2 Township 16S Range 29E NMPM Eddy County

7. Lease Name or Unit Agreement Name
Grande Mike AZK State

8. Well No.
1

9. Pool name or Wildcat
Wildcat Mississippian

10. Elevation (Show whether DF, RKB, RT, GR, etc.)
3,516'

Check Appropriate Box to Indicate Nature of Notice, Report, or Other Data			
11. NOTICE OF INTENTION TO:		SUBSEQUENT REPORT OF:	
PERFORM REMEDIAL WORK <input type="checkbox"/>	PLUG AND ABANDON <input type="checkbox"/>	REMEDIAL WORK <input type="checkbox"/>	ALTERING CASING <input type="checkbox"/>
TEMPORARILY ABANDON <input type="checkbox"/>	CHANGE PLANS <input checked="" type="checkbox"/>	COMMENCE DRILLING OPNS. <input type="checkbox"/>	PLUG AND ABANDONMENT <input type="checkbox"/>
PULL OR ALTER CASING <input type="checkbox"/>		CASING TEST AND CEMENT JOB <input type="checkbox"/>	
OTHER: _____ <input type="checkbox"/>		OTHER: _____ <input type="checkbox"/>	

12. Describe Proposed or Completed Operations (Clearly state all pertinent details, and give pertinent date, including estimated date of starting any proposed work) SEE RULE 1103.

Yates Petroleum Corporation respectfully requests permission to make the following changes to the APD for this well.
Change 8 5/8" setting depth from 2,800' to 2,650'. The casing shoe will still be 50' into the San Andres formation at this setting depth. The 8 5/8" will be cemented with approximately 1,500 sx cement.

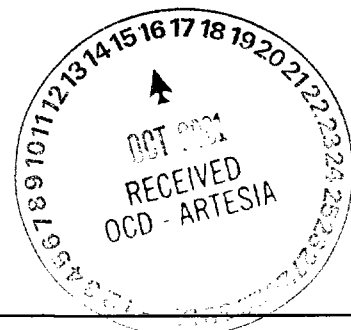

Thank you,

I hereby certify that the information above is true and complete to the best of my knowledge and belief.

SIGNATURE Cory Frederick TITLE Asst. Drilling Engineer DATE 10/15/01
TYPE OR PRINT NAME Cory Frederick TELEPHONE NO. (505)-748-4214

(This space for State Use) Jim W. Skum **SUPERVISOR, DISTRICT II** **NOV 04 2001**
APPROVED BY _____ TITLE _____ DATE _____
CONDITIONS OF APPROVAL, IF ANY:

CMD :
OG6POOL

ONGARD
MAINTAIN POOL

03/05/02 14:09:
OGOMES -TQ

Pool Code : 96048 Pool Name : WILDCAT;ABO (GAS)
OCD Order No : R 0
Pool Type : G (O/G/A) Pool Creation Date : 01-01-1900
Pool Region : S (N/S) Last Updation Date : 01-01-1900

Special Pool Rules :

Oil Well Spacing : (Acres) Gas Well Spacing : 160 (Acres)
Orthodox Well Locn : 660 (Ft from end line) 660 (Ft from side line)
(Ft from nearest well) 330 (Ft from Q/Q line)
Top Unit Allowable : (BOPD)
Casinghead Gas Limit : (MCFD)
Gas-Oil Limit :
Depth Bracket : (Feet)

Prorated Gas (Y/N) : N Acre Basis : 100.00 (in %)
Deliv Basis : (in %)
Simultaneous Dedication Allowed (Y/N) : N

E0043: Record found; Authority denied to MODIFY/ADD

PF01 HELP	PF02	PF03 EXIT	PF04 GoTo	PF05	PF06 CONFIRM
PF07	PF08	PF09 COMMENT	PF10	PF11	PF12

12	4	5	11	3	6	10	2	7	1	8	9
40.00	41.52	40.00	40.00	41.61	40.00	40.00	41.69	40.00	41.78	40.00	40.
CS	CS	CS	CS	CS	CS	CS	CS	CS	CS	CS	CS
V04949	0000		V04949	0000		V04949	0000		V04949	0000	
YATES PETROLEUM C			YATES PETROLEUM C			YATES PETROLEUM C			YATES PETROLEUM		
10/01/01			10/01/01			10/01/01			10/01/0		
13			14			15			16		
40.00			40.00			40.00			40.00		
CS			CS			CS			CS		
V04949	0000		V04949	0000		V04949	0000		V04949	0000	
YATES PETROLEUM C			YATES PETROLEUM C			YATES PETROLEUM C			YATES PETROLEUM		
10/01/01			10/01/01			10/01/01			10/01/0		

PF01 HELP PF02 PF03 EXIT PF04 GOTO PF05 PF06
 PF07 BKWD PF08 FWD PF09 PRINT PF10 SDIV PF11 PF12

L	K	J	I
40.00	40.00	40.00	40.00
CS	CS	CS	CS
V04949 0000	V04949 0000	V04949 0000	V04949 0000
YATES PETROLEUM C	YATES PETROLEUM C	YATES PETROLEUM C	YATES PETROLEUM
10/01/01	10/01/01	10/01/01	10/01/0
A			
M	N	O	P
40.00	40.00	40.00	40.00
CS	CS	CS	CS
V04949 0000	V04949 0000	V04949 0000	B02885 0011
YATES PETROLEUM C	YATES PETROLEUM C	YATES PETROLEUM C	ENRON OIL & GAS
10/01/01	10/01/01	10/01/01	05/10/4

PF01 HELP PF02 PF03 EXIT PF04 GOTO PF05 PF06
 PF07 BKWD PF08 FWD PF09 PRINT PF10 SDIV PF11 PF12

Sec : 02 Twp : 16S Rng : 29E UL: 1 Lot-Idn :
Acreage : 41.78 Bene Grp : CS Seismic Permit :
Lease Number : V04949 0 Expr Dte : 10/01/2001
Lessee : 123807 YATES PETROLEUM CORPORATION
Comm Agr Names :

Unit Agr Names :

0000

0000

S	API Num	Status
---	---------	--------

M5005: Header data found. No well data found

PF01 HELP PF02 PF03 EXIT PF04 GOTO PF05 PF06
PF07 BKWD PF08 FWD PF09 PF10 PF11 PF12

Sec : 02 Twp : 16S Rng : 29E UL: 2 Lot-Idn :
Acreage : 41.69 Bene Grp : CS Seismic Permit :
Lease Number : V04949 0 Expr Dte : 10/01/2001
Lessee : 123807 YATES PETROLEUM CORPORATION
Comm Agr Names :

Unit Agr Names :

0000

0000

S	API Num	Status
---	---------	--------

M5005: Header data found. No well data found
PF01 HELP PF02 PF03 EXIT PF04 GoTo PF05 PF06
PF07 BKWD PF08 FWD PF09 PF10 PF11 PF12

Sec : 02 Twp : 16S Rng : 29E UL: 3 Lot-Idn :
Acreage : 41.61 Bene Grp : CS Seismic Permit :
Lease Number : V04949 0 Expr Dte : 10/01/2001
Lessee : 123807 YATES PETROLEUM CORPORATION
Comm Agr Names :

Unit Agr Names :

0000
0000

S	API Num	Status
---	---------	--------

M5005: Header data found. No well data found

PF01 HELP	PF02	PF03 EXIT	PF04 GOTO	PF05	PF06
PF07 BKWD	PF08 FWD	PF09	PF10	PF11	PF12

Sec : 02 Twp : 16S Rng : 29E UL: 4 Lot-Idn :
Acreage : 41.52 Bene Grp : CS Seismic Permit :
Lease Number : V04949 0 Expr Dte : 10/01/2001
Lessee : 123807 YATES PETROLEUM CORPORATION
Comm Agr Names :

Unit Agr Names :

0000

0000

S	API Num	Status
---	---------	--------

M5005: Header data found. No well data found
PF01 HELP PF02 PF03 EXIT PF04 GoTo PF05 PF06
PF07 BKWD PF08 FWD PF09 PF10 PF11 PF12

CMD : ONGARD 03/06/02 09:01:
OG5ULST INQUIRE ULSTR PRODUCTION AND AGREEMENT DATA OGOMES -TQ
PAGE NO:

Sec : 02 Twp : 16S Rng : 29E UL: 5 Lot-Idn :
Acreage : 40.00 Bene Grp : CS Seismic Permit :
Lease Number : V04949 0 Expr Dte : 10/01/2001
Lessee : 123807 YATES PETROLEUM CORPORATION
Comm Agr Names :

0000

Unit Agr Names :

0000

S	API Num	Status
---	---------	--------

M5005: Header data found. No well data found

PF01 HELP	PF02	PF03 EXIT	PF04 GoTo	PF05	PF06
PF07 BKWD	PF08 FWD	PF09	PF10	PF11	PF12

CMD : ONGARD 03/06/02 09:01:
OG5ULST INQUIRE ULSTR PRODUCTION AND AGREEMENT DATA OGOMES -TQ
PAGE NO:

Sec : 02 Twp : 16S Rng : 29E UL: 6 Lot-Idn :
Acreage : 40.00 Bene Grp : CS Seismic Permit :
Lease Number : V04949 0 Expr Dte : 10/01/2001
Lessee : 123807 YATES PETROLEUM CORPORATION
Comm Agr Names :

Unit Agr Names : 0000

0000

S	API Num	Status
---	---------	--------

M5005: Header data found. No well data found

PF01 HELP	PF02	PF03 EXIT	PF04 GoTo	PF05	PF06
PF07 BKWD	PF08 FWD	PF09	PF10	PF11	PF12

CMD : ONGARD 03/06/02 09:01:
OG5ULST INQUIRE ULSTR PRODUCTION AND AGREEMENT DATA OGOMES -TQ
PAGE NO:

Sec : 02 Twp : 16S Rng : 29E UL: 7 Lot-Idn :
Acreage : 40.00 Bene Grp : CS Seismic Permit :
Lease Number : V04949 0 Expr Dte : 10/01/2001
Lessee : 123807 YATES PETROLEUM CORPORATION
Comm Agr Names :

Unit Agr Names : 0000

0000

S	API Num	Status
---	---------	--------

M5005: Header data found. No well data found

PF01 HELP	PF02	PF03 EXIT	PF04 GoTo	PF05	PF06
PF07 BKWD	PF08 FWD	PF09	PF10	PF11	PF12

CMD : ONGARD 03/06/02 09:01:
OG5ULST INQUIRE ULSTR PRODUCTION AND AGREEMENT DATA OGOMES -TQ
PAGE NO:

Sec : 02 Twp : 16S Rng : 29E UL: 8 Lot-Idn :
Acreage : 40.00 Bene Grp : CS Seismic Permit :
Lease Number : V04949 0 Expr Dte : 10/01/2001
Lessee : 123807 YATES PETROLEUM CORPORATION
Comm Agr Names :

Unit Agr Names : 0000

0000

S	API Num	Status
---	---------	--------

M5005: Header data found. No well data found

PF01 HELP	PF02	PF03 EXIT	PF04 GoTo	PF05	PF06
PF07 BKWD	PF08 FWD	PF09	PF10	PF11	PF12