

DATE IN 7/12/02	SUBMITTED 8/1/02	ENGINEER MS	LOGGED IN RW	TYPE NSL	APP NO 219635524
-----------------	------------------	-------------	--------------	----------	------------------

ABOVE THIS LINE FOR DIVISION USE ONLY

## NEW MEXICO OIL CONSERVATION DIVISION

- Engineering Bureau -

1220 South St. Francis Drive, Santa Fe, NM 87505



### ADMINISTRATIVE APPLICATION CHECKLIST

THIS CHECKLIST IS MANDATORY FOR ALL ADMINISTRATIVE APPLICATIONS FOR EXCEPTIONS TO DIVISION RULES AND REGULATIONS WHICH REQUIRE PROCESSING AT THE DIVISION LEVEL IN SANTA FE

#### Application Acronyms:

**[NSL-Non-Standard Location]** **[NSP-Non-Standard Proration Unit]** **[SD-Simultaneous Dedication]**  
**[DHC-Downhole Commingling]** **[CTB-Lease Commingling]** **[PLC-Pool/Lease Commingling]**  
**[PC-Pool Commingling]** **[OLS - Off-Lease Storage]** **[OLM-Off-Lease Measurement]**  
**[WFX-Waterflood Expansion]** **[PMX-Pressure Maintenance Expansion]**  
**[SWD-Salt Water Disposal]** **[IPI-Injection Pressure Increase]**  
**[EOR-Qualified Enhanced Oil Recovery Certification]** **[PPR-Positive Production Response]**

#### [1] TYPE OF APPLICATION - Check Those Which Apply for [A]

[A] Location - Spacing Unit - Simultaneous Dedication  
☒ NSL ☐ NSP ☐ SD

Check One Only for [B] or [C]

[B] Commingling - Storage - Measurement  
☐ DHC ☐ CTB ☐ PLC ☐ PC ☐ OLS ☐ OLM

[C] Injection - Disposal - Pressure Increase - Enhanced Oil Recovery  
☐ WFX ☐ PMX ☐ SWD ☐ IPI ☐ EOR ☐ PPR

[D] Other: Specify \_\_\_\_\_

#### [2] NOTIFICATION REQUIRED TO: - Check Those Which Apply, or Does Not Apply

- [A] ☐ Working, Royalty or Overriding Royalty Interest Owners  
 [B] ☐ Offset Operators, Leaseholders or Surface Owner  
 [C] ☐ Application is One Which Requires Published Legal Notice  
 [D] ☐ Notification and/or Concurrent Approval by BLM or SLO  
U.S. Bureau of Land Management - Commissioner of Public Lands, State Land Office  
 [E] ☐ For all of the above, Proof of Notification or Publication is Attached, and/or,  
 [F] ☐ Waivers are Attached

#### [3] SUBMIT ACCURATE AND COMPLETE INFORMATION REQUIRED TO PROCESS THE TYPE OF APPLICATION INDICATED ABOVE.

[4] **CERTIFICATION:** I hereby certify that the information submitted with this application for administrative approval is **accurate** and **complete** to the best of my knowledge. I also understand that **no action** will be taken on this application until the required information and notifications are submitted to the Division.

Note: Statement must be completed by an individual with managerial and/or supervisory capacity.

Robert Bullock  
Print or Type Name

Robert Bullock  
Signature

Landman  
Title

7-10-02  
Date

\_\_\_\_\_  
e-mail Address

MARTIN YATES, III  
1912 - 1985  
FRANK W. YATES  
1936 - 1986



105 SOUTH FOURTH STREET  
ARTESIA, NEW MEXICO 88210-2118  
TELEPHONE (505) 748-1471

S. P. YATES  
CHAIRMAN OF THE BOARD  
JOHN A. YATES  
PRESIDENT  
PEYTON YATES  
EXECUTIVE VICE PRESIDENT  
RANDY G. PATTERSON  
SECRETARY  
DENNIS G. KINSEY  
TREASURER

July 10, 2002

Mr. Michael Stogner  
New Mexico Oil Conservation Division  
1220 South St. Francis Drive  
Santa Fe, New Mexico 87505

**CERTIFIED MAIL**  
***Return Receipt Requested***

RE: Non-Standard Location  
Big Bear ATN #1  
Township 15 South, Range 35 East  
Section 29: 1980' FSL & 1120' FEL  
Lea County, New Mexico

Dear Mr. Stogner:

Yates Petroleum Corporation requests administrative approval for a non-standard Wolfcamp oil well.

This well was originally permitted by Yates Petroleum Corporation as a 13,255' Mississippian test, spudded February 17, 2000, completed as a dry hole April 20, 2000 and subsequently plugged and abandoned. On July 5, 2001 Yates re-entered the wellbore and attempted unsuccessful completions in the Atoka and Strawn formations. On December 6, 2001 the well was completed as a Wolfcamp gas well and subsequently re-designated a Wolfcamp oil well on February 28, 2002. This well is subject to the Townsend Perma Upper Penn Pool Rules.

Yates Petroleum Corporation and its partners own all the working interest in the S/2 of Section 29 and the fee mineral ownership is an undivided ownership throughout the S/2 therefore encroachment or loss of correlative rights is not an issue in this application and no notice has been given to any parties.

Please find enclosed a land plat, C-101, C-102, C-103, C-104, C-105 and administrative application checklist.

If you need additional information please call me at (505) 748-4351.

Thank you.

Very truly yours,

**YATES PETROLEUM CORPORATION**

Robert Bullock  
Landman

RB:bn  
enclosure(s)

File

DISTRICT I  
1625 N. French Dr., Hobbs, NM 88240

State of New Mexico  
Energy, Minerals and Natural Resources Department

Form C-101  
Revised March 17, 1999  
Instructions on back

DISTRICT II  
811 South First, Artesia, NM 88210

# OIL CONSERVATION DIVISION

Submit to appropriate District Office

DISTRICT III  
1000 Rio Brazos Rd., Aztec, NM 87410

PO BOX 2088  
Santa Fe, NM 87504-2088

State Lease - 6 Copies  
Fee Lease - 5 Copies

DISTRICT IV  
2040 South Pacheco, Santa Fe, NM 87501

☐ AMENDED REPORT

## APPLICATION FOR PERMIT TO DRILL, RE-ENTER, DEEPEN, PLUGBACK, OR ADD A ZONE

<sup>1</sup> Operator Name and Address Yates Petroleum Corporation 105 South Fourth Street Artesia, New Mexico 88210		<sup>2</sup> OGRID Number 025575
		<sup>3</sup> API Number 30- 025-34908
<sup>4</sup> Property Code 25300	<sup>5</sup> Property Name Big Bear "ATN"	<sup>6</sup> Well No. 1

## <sup>7</sup> Surface Location

UL or lot no.	Section	Township	Range	Lot Idn	Feet from the	North/South Line	Feet from the	East/West Line	County
I	29	15S	35E		1980	South	1120	East	Lea

## <sup>8</sup> Proposed Bottom Hole Location If Different From Surface

UL or lot no.	Section	Township	Range	Lot Idn	Feet from the	North/South Line	Feet from the	East/West Line	County
<sup>9</sup> Proposed Pool 1 Wildcat Atoka						<sup>10</sup> Proposed Pool 2			

<sup>11</sup> Work Type Code E	<sup>12</sup> Well Type Code G	<sup>13</sup> Cable/Rotary R	<sup>14</sup> Lease Type Code P	<sup>15</sup> Ground Level Elevation 4001'
<sup>16</sup> Multiple No	<sup>17</sup> Proposed Depth 13,155'	<sup>18</sup> Formation Atoka	<sup>19</sup> Contractor Not Determined	<sup>20</sup> Spud Date ASAP

## <sup>21</sup> Proposed Casing and Cement Program

Hole Size	Casing Size	Casing weight/feet	Setting Depth	Sacks of Cement	Estimated TOC
17 1/2"	13 3/8	48#	402'-in place	500 sx	Circulate
12 1/4"	9 5/8"	36# & 40#	4695'-in place	1600 sx	Circulate
7 7/8"	5 1/2"	17# & 20#	0-13,155'	1500 sx	TOC-4000'

<sup>22</sup> Describe the proposed program. If this application is to DEEPEN or PLUG BACK give the data on the present productive zone and proposed new production. Describe the blowout prevention program, if any. Use additional sheets if necessary.

See Attached Sheet

Permit Expires 1 Year From Approval  
Date Unless Drilling Underway

Re Entry

<sup>23</sup> I hereby certify that the information given above is true and complete to the best of my knowledge and belief. Signature: <i>Clinton R. May</i>		OIL CONSERVATION DIVISION	
Printed name: Clinton R. May		Approved by: <i>Clinton R. May</i>	
Title: Regulatory Agent		Title: Geologist	
Date: 06/08/01	Phone: (505) 748-1471	Approval Date: JUN 25 2001	Expiration Date:
		Conditions of Approval Attached <input type="checkbox"/>	

District I  
1625 N. French Dr., Hobbs, NM 88240

District II  
811 South First, Artesia, NM 88210

District III  
1000 Rio Brazos Rd., Aztec, NM 87410

District IV  
1220 S. St. Francis Dr., Santa Fe, NM 87505

State of New Mexico  
Energy, Minerals & Natural Resources Department

OIL CONSERVATION DIVISION  
1220 South St. Francis Dr.  
Santa Fe, NM 87505

Form C-102  
Revised August 15, 2000

Submit to Appropriate District Office  
State Lease - 4 Copies  
Fee Lease - 3 Copies

☐ AMENDED REPORT

WELL LOCATION AND ACREAGE DEDICATION PLAT

<sup>1</sup> API Number <b>30-025-34908</b>	<sup>2</sup> Pool Code <b>59847</b>	<sup>3</sup> Pool Name <b>Townsend Permo Upper Penn</b>
<sup>4</sup> Property Code <b>25300</b>	<sup>5</sup> Property Name <b>Big Bear ATN</b>	<sup>6</sup> Well Number <b>#1</b>
<sup>7</sup> OGRID No. <b>025575</b>	<sup>8</sup> Operator Name <b>Yates Petroleum Corporation</b>	<sup>9</sup> Elevation <b>4001'</b>

<sup>10</sup> Surface Location									
UL or lot no.	Section	Township	Range	Lot Idn	Feet from the	North/South line	Feet from the	East/West line	County
<b>1</b>	<b>29</b>	<b>15S</b>	<b>35E</b>		<b>1980</b>	<b>South</b>	<b>1120</b>	<b>East</b>	<b>Lea</b>

<sup>11</sup> Bottom Hole Location If Different From Surface									
UL or lot no.	Section	Township	Range	Lot Idn	Feet from the	North/South line	Feet from the	East/West line	County

<sup>12</sup> Dedicated Acres <b>.40</b>	<sup>13</sup> Joint or Infill	<sup>14</sup> Consolidation Code	<sup>15</sup> Order No.
---	-------------------------------	----------------------------------	-------------------------

NO ALLOWABLE WILL BE ASSIGNED TO THIS COMPLETION UNTIL ALL INTERESTS HAVE BEEN CONSOLIDATED OR A NON-STANDARD UNIT HAS BEEN APPROVED BY THE DIVISION

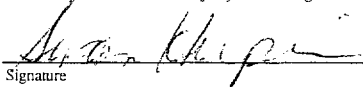
<sup>16</sup>					<div><div><div>1120'</div><div>1980'</div></div></div>	<sup>17</sup> OPERATOR CERTIFICATION <i>I hereby certify that the information contained herein is true and complete to the best of my knowledge and belief.</i>  Signature <b>Susan Herpin</b> Printed Name <b>Engineering Technician</b> Title <b>February 28, 2002</b> Date
						<sup>18</sup> SURVEYOR CERTIFICATION <i>I hereby certify that the well location shown on this plat was plotted from field notes of actual surveys made by me or under my supervision, and that the same is true and correct to the best of my belief.</i> Date of Survey Signature and Seal of Professional Surveyor:  <b>See Original Plat</b> Certificate Number

DISTRICT I  
P.O. Box 1980, Hobbs NM 88240  
DISTRICT II  
P.O. Drawer DD, Artesia NM 88210  
DISTRICT III  
1000 Rio Brazos Rd., Aztec NM 87410

State of New Mexico  
Energy, Minerals and Natural Resources Department  
**OIL CONSERVATION DIVISION**  
P.O. Box 2088  
Santa Fe, New Mexico 87504-2088

WELL APNO:  
**30-025-34908**

5. Indicate Type of Lease  
State ☐ FEE ☒

SUNDRY NOTICES AND REPORTS ON WELLS  
(DO NOT USE THIS FORM FOR PROPOSALS TO DRILL OR TO DEEPEN OR PLUG BACK TO A  
DIFFERENT RESERVOIR. USE "APPLICATION FOR PERMIT"  
(FORM C-101) FOR SUCH PROPOSALS.)

7. Lease Name or Unit Agreement Name

**BIG BEAR ATN**

1. Type of Well:  
OIL ☐ GAS ☐  
WELL ☐ WELL ☒ OTHER ☐

8. Well No.  
**1**

2. Name of Operator  
**Yates Petroleum Corporation**

3. Address of Operator  
**105 South 4th., Artesia, NM 88210**

9. Pool Name or Wildcat  
**Townsend Perma Upper Perm**

4. Well Location  
Unit Letter **SI**: **1980** Feet From The **South** Line and **1120** Feet From The **East** Line  
Section **29** Township **T15S** Rang **R35E** NMPM **Lea** COUNTY

10. Elevation (Show whether DF, RKB, RT, GR, etc.)  
**4001' GL**

11. Check Appropriate Box to Indicate Nature of Notice, Report, or Other Data

NOTICE OF INTENTION TO:

PERFORM REMEDIAL WORK ☐ PLUG AND ABANDON ☐  
TEMPORARILY ABANDON ☐ CHANGE PLANS ☐  
PULL OR ALTER CASING ☐  
OTHER ☐

SUBSEQUENT REPORT OF:

REMEDIAL WORK ☐ ALTERING CASING ☐  
COMMENCE DRILLING OPNS. ☐ PLUG AND ABANDONMENT ☐  
CASING TEST AND CEMENT JOB ☐  
OTHER Re-entry ☐

12. Describe Proposed or Completed Operations (Clearly state all pertinent details, and give pertinent dates, including estimated date of starting any proposed work) SEE RULE 1103.

7-25-01- MIRT. Notified Debbie w/ the FAA of intent to MIRT. Notified Bill Gatchall, manager @ Zip Franklin Memorial airport @ 8:15 am 7-25-01.

7-27-01- Drilled cement to 40'. Picked up drill pipe & drill collars. Drilled cement. PU drill pipe. Start drilling cement @ 2:00 pm 7-27-01.

7-28-01- Washing to bottom. Circ clean hole. Tagged cement @ 4540'. Drilled cement to 7930'-6230'.

7-30-01- Drilled cement from 9740-9860'.

7-31-01- circ & condition , heaving shale.

8-1-01- Wash & ream thru shale.

8-2-01- Wash & ream. Trip- remove jets. SLM.

8-11-01- Wash & ream. Circ @ 12,103'. TD 8-1/4" hole @ 4:30 am 8-11-01.

8-13-01- Lay down drill pipe.

8-14-01- ND & jet pits. LD DP & DC. Rigged up & run 287 jts (12,165') casing, set as follows:

23 jts 5-1/2" 20# P110 SB (957.95')

14 jts 5-1/2" 17# HCP110 SB (554.28')

25 jts 5-1/2" 17# P110 varn (\*070.97')

I hereby certify that the information above is true and complete to the best of my knowledge and belief

continued on next page

SIGNATURE Donna Clark

TITLE Operations Technician

DATE 11/12/01

TYPE OR PRINT NAME Donna Clark

TELEPHONE NO 505-748-1471

(THIS SPACE FOR STATE USE)

APPROVED BY \_\_\_\_\_ TITLE \_\_\_\_\_

DATE \_\_\_\_\_

CONDITIONS OF APPROVAL, IF ANY

**FEB 20 2002**

State of New Mexico  
Energy, Minerals and Natural Resources Department

DISTRICT I  
P.O. Box 1980, Hobbs NM 88240  
DISTRICT II  
P.O. Drawer DD, Artesia NM 88210  
DISTRICT III  
1000 Rio Brazos Rd., Aztec NM 87410

OIL CONSERVATION DIVISION  
P.O. Box 2088  
Santa Fe, New Mexico 87504-2088

WELL API NO  
30-025-34908

5. Indicate Type of Lease  
State ☐ FEE ☒

SUNDRY NOTICES AND REPORTS ON WELLS  
(DO NOT USE THIS FORM FOR PROPOSALS TO DRILL OR TO DEEPEN OR PLUG BACK TO A  
DIFFERENT RESERVOIR. USE " APPLICATION FOR PERMIT"  
(FORM C-101) FOR SUCH PROPOSALS.)

7. Lease Name or Unit Agreement Name

BIG BEAR ATN

1. Type of Well:  
OIL GAS  
WELL ☐ WELL ☒ OTHER

8. Well No. 1

2. Name of Operator Yates Petroleum Corporation

3. Address of Operator 100 South 4th, Artesia, NM 88210

9. Pool Name or Wildcat Townsend Perma Upper Penn

4. Well Location  
Unit Letter 8 I: 1980 Feet From The South Line and 1120 Feet From The East Line  
Section 29 Township T15S Rang R35E NMPM Lea COUNTY

10. Elevation (Show whether DF, RKB, RT, GR, etc.)  
4001' GL

11. Check Appropriate Box to Indicate Nature of Notice, Report, or Other Data

NOTICE OF INTENTION TO:

PERFORM REMEDIAL WORK ☐ PLUG AND ABANDON ☐  
TEMPORARILY ABANDON ☐ CHANGE PLANS ☐  
PULL OR ALTER CASING ☐  
OTHER ☐

SUBSEQUENT REPORT OF:

REMEDIAL WORK ☐ ALTERING CASING ☐  
COMMENCE DRILLING OPNS. ☐ PLUG AND ABANDONMENT ☐  
CASING TEST AND CEMENT JOB ☐  
OTHER Re-entry ☐

12. Describe Proposed or Completed Operations (Clearly state all pertinent details, and give pertinent dates, including estimated date of starting any proposed work) SEE RULE 1103.

8-21-01- miru PULLING UNIT. Tag PBTD @ 12,054'. SI.

8-23-01- Rig up wireline. TIH w/4" casing guns. Perforated Atoka Sand 11,796-820' 6 JSPF = 84 .42" holes.  
Rig down wireline. Spot 5 bbls 7-1/2% Morrow Acid.

8-24-01- Rig up acid equipment. Acidized Atoka Sand w/ 1000 gal 7-1/2% Morrow Acid w/1500 SCF N2/bbl.

11-6-01- Released packer. ND tree & NU BOP. TOH & RU wireline. TIH; TOH. TIH w/5-1/2" C, set @ 11,750'.

Cap w/ 35' cement. TIH w/ 4" casing gun. Correlated & perforated Strawn Lime 11,536-653' (2JSPF) w/ 28 .42" holes. SI.

11-8-01- Acidized w/ 2000 gals 15% IC HCL w/ 15 bbls acid in formation.

11-13-01- TOH w/ packer. Rig up wireline. TIH w/ 5-1/2" CIBP, set @ 11,495'. Cap w/ 35' cement. TIH w/ 4" casing gu

11-14-01- TIH w/ packer & RBP @ 11,223'. Acidized w/ 2000 gal 15% IC HCL w/ 10 bbls acid in formation.

11-19-01- Released packer & RBP. TOH. TIH w/ production string. ND BOP. Rig down.

I hereby certify that the information above is true and complete to the best of my knowledge and belief

SIGNATURE Donna Clack TITLE Operations Technician DATE 1/25/02  
TYPE OR PRINT NAME Donna Clack TELEPHONE NO 505-748-1471

(THIS SPACE IS FOR SIGNATURE USE)

APPROVED BY \_\_\_\_\_ TITLE \_\_\_\_\_ DATE \_\_\_\_\_

CONDITIONS OF APPROVAL, IF ANY

*Corrected*

I. REQUEST FOR ALLOWABLE AND AUTHORIZATION TO TRANSPORT

<sup>1</sup> Operator name and Address  Yates Petroleum Corporation 105 South Fourth Street Artesia NM 88210					<sup>2</sup> OGRID Number  025575				
					<sup>3</sup> Reason for Filing Code/ Effective Date  Re-entry				
<sup>4</sup> API Number 30-025-34908		<sup>5</sup> Pool Name Townsend Permo Upper Penn				<sup>6</sup> Pool Code 59847			
<sup>7</sup> Property Code 25300		<sup>8</sup> Property Name Big Bear ATN				<sup>9</sup> Well Number #1			

II. <sup>10</sup> Surface Location

UL or lot no. I	Section 29	Township 15S	Range 35E	Lot Idn	Feet from the 1980	North/South Line South	Feet from the 1120	East/West line East	County Lea
--------------------	---------------	-----------------	--------------	---------	-----------------------	---------------------------	-----------------------	------------------------	---------------

<sup>11</sup> Bottom Hole Location

UL or lot no.	Section	Township	Range	Lot Idn	Feet from the	North/South line	Feet from the	East/West line	County

<sup>12</sup> Use Code P	<sup>13</sup> Producing Method Code F	<sup>14</sup> Gas Connection Date 12/6/01	<sup>15</sup> C-129 Permit Number	<sup>16</sup> C-129 Effective Date	<sup>17</sup> C-129 Expiration Date
-----------------------------	--	--	-----------------------------------	------------------------------------	-------------------------------------

III. Oil and Gas Transporters

<sup>18</sup> Transporter OGRID	<sup>19</sup> Transporter Name & Address	<sup>20</sup> POD	<sup>21</sup> O/G	<sup>22</sup> POD ULSTR Location and Description
209700	BP Pipeline NA Inc.	2831316	O	
147831	Agave Energy Company	2831317	G	

IV. Produced Water

<sup>23</sup> POD 2831319	<sup>24</sup> POD ULSTR Location and Description
------------------------------	--

V. Well Completion Data

<sup>25</sup> Spud Date Re-entry: 7/25/01	<sup>26</sup> Ready Date 12/6/01	<sup>27</sup> TD Re-entry: 12,103'	<sup>28</sup> PBTD 11,460'	<sup>29</sup> Perforations Wolfcamp 10936-11188'	<sup>30</sup> DIHC, MC
<sup>31</sup> Hole Size 26"	<sup>32</sup> Casing & Tubing Size 20"	<sup>33</sup> Depth Set 40'	<sup>34</sup> Sacks Cement In place		
17-1/2"	13-3/8"	402'	In place		
12-1/4"	9-5/8"	4695'	In place		
8-3/4"	5-1/2"	12,103'	1025 sxs		
	2-7/8"	10,675'			

VI. Well Test Data

<sup>35</sup> Date New Oil 12/8/01	<sup>36</sup> Gas Delivery Date 12/6/01	<sup>37</sup> Test Date 12/13/01	<sup>38</sup> Test Length 24 hrs.	<sup>39</sup> Tbg. Pressure 600#	<sup>40</sup> Csg. Pressure 100#
<sup>41</sup> Choke Size 64/64"	<sup>42</sup> Oil 39	<sup>43</sup> Water 48	<sup>44</sup> Gas 427	<sup>45</sup> AOF	<sup>46</sup> Test Method Flowing

<sup>47</sup> I hereby certify that the rules of the Oil Conservation Division have been complied with and that the information given above is true and complete to the best of my knowledge and belief.

Signature: *Susan Herpin*

Printed name:  
Susan Herpin

Title:  
Engineering Technician

Date:  
February 28, 2002

Phone:  
505-748-1471

OIL CONSERVATION DIVISION

Approved by:

Title:

Approval Date:

DISTRICT I  
P.O. Box 1980, Hobbs NM 88240

State of New Mexico  
Energy, Minerals and Natural Resources Department

DISTRICT II

P.O. Drawer DD, Artesia NM 88210

DISTRICT III  
1000 Ric Brazos Rd., Aztec NM 87410

OIL CONSERVATION DIVISION

P.O. Box 2088  
Santa Fe, New Mexico 87504-2088

WELL API#  
30-025-34908

5. Indicate Type of Lease  
State ☐ FEE ☒

6. State Oil & Gas Lease No

WELL COMPLETION OR RECOMPLETION REPORT AND LOG

1a. Type of Well: OIL WELL ☐ GAS WELL ☒ DRY ☐ OTHER ☐ Re-entry  
7. Lease Name or Unit Agreement Name  
BIG BEAR ATN

2. Name of Operator  
YATES PETROLEUM CORPORATION  
8. Well No.  
1

3. Address of Operator  
105 S 4th STREET, ARTESIA, NM 88210  
9. Pool Name or Wildcat  
Townsend Perma Upper Penn

4. Well Location  
Unit Letter I J : 1980 Feet From The SOUTH Line and 1120 Feet From The EAST Line  
Section 29 Township R15S Range R35E NMPM LEA County

10. Date Spudded  
Re-entered 7-25-01  
11. Date T.D. Reached  
8/14/01  
12. Date Completed (Ready to Prod)  
12/6/01  
13. Elevations (DF & RKB, RT, GR, etc.)  
4001' GR  
14. Elev. Casinghead

15. Total Depth  
12,103'  
16. Plug Back T.D.  
12,054'  
17. If Multiple Compl. How Many Zones?  
18. Intervals Drilled by  
Rotary Tools  
0-12,103'  
Cable Tools

19. Producing Interval (s), of this completion - Top, Bottom, Name  
10,936-11,188' WOLFCAMP  
20. Was Directional Survey Made  
No

21. Type Electric and Other Logs Run  
none for re-entry  
22. Was Well Cored  
No

23. CASING RECORD (Report all strings set in well)

CASING SIZE	WEIGHT LB/FT.	DEPTH SET	HOLE SIZE	CEMENTING RECORD	AMOUNT PULLED
5-1/2"	17&20#	12,103'	8-1/4"	1025 SX	

24. LINER RECORD					25. TUBING RECORD		
SIZE	TOP	BOTTOM	SACKS CEMENT	SCREEN	SIZE	DEPTH SET	PACKER SET
					5-1/2"	12,103'	12,103'

26. PERFORATION RECORD (INTERVAL, SIZE, AND NUMBER)				27. ACID, SHOT, FRACTURE, CEMENT, SQUEEZE, ETC.	
11796-820' - 6 jsf = 84 .42" HOLES	CIBP @ 11750	DEPTH INTERVAL	AMOUNT AND KIND MATERIAL USED		
11536-653' - 2 jsf = 28 .42" HOLES	CIBP @ 11495	11796-820'	1000 GAL Morrow acid w/ 1500 SCF N2/bbl		
10936-11188' - 1 jsf = 24 .42" HOLES		11536-653'	2000 gal 15% IC HCL w/15 bbl acid		
		10936-11188'	2000 gal 15% IC HCL w/10 bbl acid		

28. PRODUCTION

Date First Production		Production Method (Flowing, gas lift, pumping - Size and type pump)				Well Status (Prod. Or Shut-in)	
12/8/01		F				P	
Date of Test	Hours Tested	Choke Size	Prod. for Test Period	Oil - Bbl	Gas - MCF	Water - bbl	Gas - Oil Ratio
12/13/01	24			39	427	48	
Flow Tubing Press.	Casing Pressure	Calculated 21-Hour Rate	Oil - Bbl	Gas - MCF	Water - Bbl	Oil Gravity - API	
600#	100#		3	465			

29. Disposition of Gas (Sold, used for fuel, vented, etc.)  
Sold  
Tested Witnessed By  
Rocky Harper

30. List Attachments  
None for re-entry

31. I hereby certify that the information shown on both sides of this form is true and complete to the best of my knowledge and belief  
Signature Donna Clack Printed Name Donna Clack Title Operations Technician  
Date 1/25/02



Submit 3 Copies To Appropriate District  
Office  
District I  
1625 N. French Dr., Hobbs, NM 88240  
District II  
811 South First, Artesia, NM 88210  
District III  
1000 Rio Brazos Rd., Aztec, NM 87410  
District IV  
1220 S. St. Francis Dr., Santa Fe, NM  
87505

State of New Mexico  
Energy, Minerals and Natural Resources

OIL CONSERVATION DIVISION  
1220 South St. Francis Dr.  
Santa Fe, NM 87505

Form C-103  
Revised March 25, 1999

WELL API NO.

**30-025-34908**

5. Indicate Type of Lease

STATE ☐ FEE ☒

6. State Oil & Gas Lease No.

7. Lease Name or Unit Agreement Name:

**Big Bear ATN**

7. Well No.

**#1**

8. Pool name or Wildcat

**Townsend Permo Upper Penn**

SUNDRY NOTICES AND REPORTS ON WELLS

(DO NOT USE THIS FORM FOR PROPOSALS TO DRILL OR TO DEEPEN OR PLUG BACK TO A DIFFERENT RESERVOIR. USE "APPLICATION FOR PERMIT" (FORM C-101) FOR SUCH PROPOSALS.)

1. Type of Well:

Oil Well ☒ Gas Well ☐ Other ☐

2. Name of Operator

**Yates Petroleum Corporation**

3. Address of Operator

**105 S. 4<sup>th</sup> Street Artesia, NM 88210**

4. Well Location

Unit Letter **I** : **1980** feet from the **South** line and **1120** feet from the **East** line

Section **29** Township **15S** Range **35E** NMPM **Lea** County

10. Elevation (Show whether DR, RKB, RT, GR, etc.)

**' GR**

11. Check Appropriate Box to Indicate Nature of Notice, Report or Other Data

NOTICE OF INTENTION TO:

PERFORM REMEDIAL WORK ☐

PLUG AND ABANDON ☐

TEMPORARILY ABANDON ☐

CHANGE PLANS ☐

PULL OR ALTER CASING ☐

MULTIPLE COMPLETION ☐

OTHER: ☐

SUBSEQUENT REPORT OF:

REMEDIAL WORK ☐

ALTERING CASING ☐

COMMENCE DRILLING OPNS. ☐

PLUG AND ABANDONMENT ☐

CASING TEST AND CEMENT JOB ☐

OTHER: ☒

Describe proposed or completed operations. (Clearly state all pertinent details, and give pertinent dates, including estimated date of starting any proposed work). SEE RULE 1103. For Multiple Completions: Attach wellbore diagram of proposed completion or recompletion.

Effective February 22, 2002 well is shut in waiting on Non Standard Location approval.

I hereby certify that the information above is true and complete to the best of my knowledge and belief.

SIGNATURE

*Susan Herpin*

TITLE

**Engineering Technician** DATE **February 28, 2002**

Type or print name

**Susan Herpin**

Telephone No.

**505-748-1471**

(This space for State use)

APPROVED BY

TITLE

DATE

Conditions of approval, if any:







CMD : ONGARD  
OGSSECT INQUIRE LAND BY SECTION

07/24/02 13:37:59  
OGOMES -TPIG  
PAGE NO: 1

Sec : 29 Twp : 15S Rng : 35E Section Type : NORMAL

<p>D</p> <p>40.00</p> <p>MI</p> <p>VA1000 0000</p> <p>YATES PETROLEUM C</p> <p>08/01/98</p>	<p>C</p> <p>40.00</p> <p>MI</p> <p>VA1000 0000</p> <p>YATES PETROLEUM C</p> <p>08/01/98</p> <p>A</p>	<p>B</p> <p>40.00</p> <p>MI</p> <p>VA1000 0000</p> <p>YATES PETROLEUM C</p> <p>08/01/98</p>	<p>A</p> <p>40.00</p> <p>MI</p> <p>VA1000 0000</p> <p>YATES PETROLEUM C</p> <p>08/01/98</p>
<p>E</p> <p>40.00</p> <p>MI</p> <p>VA1000 0000</p> <p>YATES PETROLEUM C</p> <p>08/01/98</p>	<p>F</p> <p>40.00</p> <p>MI</p> <p>VA1000 0000</p> <p>YATES PETROLEUM C</p> <p>08/01/98</p>	<p>G</p> <p>40.00</p> <p>MI</p> <p>VA1000 0000</p> <p>YATES PETROLEUM C</p> <p>08/01/98</p>	<p>H</p> <p>40.00</p> <p>MI</p> <p>VA1000 0000</p> <p>YATES PETROLEUM C</p> <p>08/01/98</p>

PF01 HELP PF02 PF03 EXIT PF04 GoTo PF05 PF06  
PF07 BKWD PF08 FWD PF09 PRINT PF10 SDIV PF11 PF12

CMD : ONGARD  
OG5SECT INQUIRE LAND BY SECTION

07/24/02 13:38:04  
OGOMES -TPIG  
PAGE NO: 2

Sec : 29 Twp : 15S Rng : 35E Section Type : NORMAL

L	K	J	I
40.00	40.00	40.00	40.00
Fee owned	Fee owned	Fee owned	Fee owned
A			A
M	N	O	P
40.00	40.00	40.00	40.00
Fee owned	Fee owned	Fee owned	Fee owned
	A		A

PF01 HELP PF02 PF03 EXIT PF04 GOTO PF05 PF06  
PF07 BKWD PF08 FWD PF09 PRINT PF10 SDIV PF11 PF12

CMD :  
OG6IWCM

ONGARD  
INQUIRE WELL COMPLETIONS

07/24/02 13:38:15  
OGOMES -TPIG

API Well No : 30 25 34908 Eff Date : 04-15-2000 WC Status : D  
Pool Idn : 96838 DRY & ABANDONED  
OGRID Idn : 25575 YATES PETROLEUM CORPORATION  
Prop Idn : 25300 BIG BEAR ATN

Well No : 001  
GL Elevation: 4001

U/L Sec Township Range North/South East/West Prop/Act (P/A)  
-----  
B.H. Locn : I 29 15S 35E FTG 1980 F S FTG 1120 F E A  
Lot Identifier:  
Dedicated Acre:  
Lease Type : P  
Type of consolidation (Comm, Unit, Forced Pooling - C/U/F/O) :

M0025: Enter PF keys to scroll  
PF01 HELP PF02 PF03 EXIT PF04 GOTO PF05 PF06  
PF07 PF08 PF09 PF10 NEXT-WC PF11 HISTORY PF12 NXTREC

DISTRICT I  
P.O. Box 1980, Hobbs NM 88240

State of New Mexico  
Energy, Minerals and Natural Resources Department

DISTRICT II

P.O. Drawer DD, Artesia NM 88210

DISTRICT III

1000 Ric Brazos Rd., Aztec NM 87410

OIL CONSERVATION DIVISION

P.O. Box 2088  
Santa Fe, New Mexico 87504-2088

WELL API N	30-025-34908
5. Indicate Type of Lease	
State <input type="checkbox"/>	FEE <input checked="" type="checkbox"/>
6. State Oil & Gas Lease No.	

WELL COMPLETION OR RECOMPLETION REPORT AND LOG

1a. Type of Well: OIL WELL <input type="checkbox"/> GAS WELL <input checked="" type="checkbox"/> DRY <input type="checkbox"/> OTHER <u>Re-entry</u>		7. Lease Name or Unit Agreement Name <b>BIG BEAR ATN</b>	
2. Name of Operator <b>YATES PETROLEUM CORPORATION</b>		8. Well No. <b>1</b>	
3. Address of Operator <b>105 S 4th STREET, ARTESIA, NM 88210</b>		9. Pool Name or Wildcat <b>Townsend Perma Upper Penn</b>	
4. Well Location Unit Letter <u>IX</u> : <u>1980</u> Feet From The <u>SOUTH</u> Line and <u>1120</u> Feet From The <u>EAST</u> Line Section <u>29</u> Township <u>R15S</u> Range <u>R35E</u> NMPM <u>LEA</u> County			
10. Date Spudded <b>Re-entered 7-25-01</b>	11. Date T.D. Reached <b>8/14/01</b>	12. Date Completed (Ready to Prod) <b>12/6/01</b>	13. Elevations (DF & RKB, RT, GR, etc.) <b>4001' GR</b>
14. Elev. Casinghead			
15. Total Depth <b>12,103'</b>	16. Plug Back T.D. <b>12,054'</b>	17. If Multiple Compl. How Many Zones?	18. Intervals Drilled by <b>0-12,103'</b>
19. Producing Interval (s), of this completion - Top, Bottom, Name <b>10,936-11,188' WOLFCAMP</b>		20. Was Directional Survey Made <b>No</b>	
21. Type Electric and Other Logs Run <b>none for re-entry</b>		22. Was Well Cored <b>No</b>	

23 CASING RECORD (Report all strings set in well)

CASING SIZE	WEIGHT LB/FT.	DEPTH SET	HOLE SIZE	CEMENTING RECORD	AMOUNT PULLED
5-1/2"	17&20#	12,103'	8-1/4"	1025 SX	

24 LINER RECORD					25 TUBING RECORD		
SIZE	TOP	BOTTOM	SACKS CEMENT	SCREEN	SIZE	DEPTH SET	PACKER SET
					5-1/2"	12,103'	12,103'

26 PERFORATION RECORD (INTERVAL, SIZE, AND NUMBER)	27. ACID, SHOT, FRACTURE, CEMENT, SQUEEZE, ETC.
11796-820' - 6 jsf = 84 .42" HOLES <b>CIBP @ 11750</b>	DEPTH INTERVAL
11536-653' - 2 jsf = 28 .42" HOLES <b>CIBP @ 11495</b>	AMOUNT AND KIND MATERIAL USED
10936-11188' - 1 jsf = 24 .42" HOLES	11796-820' 1000 GAL Morrow acid w/ 1500 SCF N2/bbl
	11536-653' 2000 gal 15% IC HCL w/15 bbl acid
	10936-11188 2000 gal 15% IC HCL w/10 bbl acid

28 PRODUCTION

Date First Production <b>12/8/01</b>	Production Method (Flowing, gas lift, pumping - Size and type pump) <b>F</b>		Well Status (Prod. Or Shut-in) <b>P</b>	
Date of Test <b>12/13/01</b>	Hours Tested <b>24</b>	Choke Size	Prod'n for Test Period	Oil - Bbl <b>39</b>
Flow Tubing Press. <b>600#</b>	Casing Pressure <b>100#</b>	Calculated 21-Hour Rate	Oil - Bbl <b>3</b>	Gas-MCF <b>427</b>
Water-Bbl <b>48</b>		Gas - Oil Ratio		

29. Disposition of Gas (Sold, used for fuel, vented, etc.) <b>Sold</b>	Tested Witnessed By <b>Rocky Harper</b>
---	--

30. List Attachments <b>None for re-entry</b>
--

31. I hereby certify that the information shown on both sides of this form is true and complete to the best of my knowledge and belief			
Signature <u>Donna Clack</u>	Printed Name <u>Donna Clack</u>	Title <u>Operations Technician</u>	Date <u>1/25/02</u>

## INSTRUCTIONS

This form is to be filed with the appropriate District Office of the Division not later than 20 days after the completion of any newly-drilled or deepened well. It shall be accompanied by one copy of all electrical and radio-activity logs run on the well and a summary of all special tests conducted, including drill stem tests. All depths reported shall be measured depths. In the case of directionally drilled wells, true vertical depths shall also be reported. For multiple completions, Items 25 through 29 shall be reported for each zone. The form is to be filed in quintuplicate except on state land, where six copies are required. See Rule 1105.

INDICATE FORMATION TOPS IN CONFORMANCE WITH GEOGRAPHICAL SECTION OF STATE

## Southeastern New Mexico

## Northwestern New Mexico

Anhy _____	T. Canyon _____	T. Ojo Alamo _____	T. Penn. "B" _____
Salt _____	T. Strawn _____	T. Kirtland-Fruitland _____	T. Penn. "C" _____
Salt _____	T. Atoka _____	T. Pictured Cliffs _____	T. Penn. "D" _____
Yates _____	T. Miss _____	T. Cliff House _____	T. Leadville _____
7 Rivers _____	T. Devonian _____	T. Menefee _____	T. Madison _____
Queen _____	T. Silurian _____	T. Point Lookout _____	T. Elbert _____
Grayburg _____	T. Montoya _____	T. Mancos _____	T. McCracken _____
San Andres _____	T. Simpson _____	T. Gallup _____	T. Ignacio Otzte _____
Glorieta _____	T. McKee _____	Base Greenhorn _____	T. Granite _____
Paddock _____	T. Ellenburger _____	T. Dakota _____	T. _____
Blinebry _____	T. Gr. Wash _____	T. Morrison _____	T. _____
Tubb _____	T. Delaware Sand _____	T. Todilto _____	T. _____
Drinkard _____	T. Bone Springs _____	T. Entrada _____	T. _____
Abo _____	T. _____	T. Wingate _____	T. _____
Wolfcamp _____	T. _____	T. Chinle _____	T. _____
Penn _____	T. _____	T. Permian _____	T. _____
Cisco (Bough C) _____	T. _____	T. Penn "A" _____	T. _____

## OIL OR GAS SANDS OR ZONES

o. 1, from.....to..... No. 3, from.....to.....  
o. 2, from.....to..... No. 4, from.....to.....

## IMPORTANT WATER SANDS

include data on rate of water inflow and elevation to which water rose in hole.

lo. 1, from.....to.....feet.....  
 lo. 2, from.....to.....feet.....  
 lo. 3, from.....to.....feet.....

## LITHOLOGY RECORD (Attach additional sheet if necessary)

From	To	Thickness in Feet	Lithology
			(REFER TO ORIGINAL LOGS)

From	To	Thickness in Feet	Lithology

DISTRICT I  
P.O. Box 1980, Hobbs NM 88240

DISTRICT II  
P.O. Drawer DD, Artesia NM 88210

DISTRICT III  
1000 Rio Brazos Rd., Aztec NM 87410

State of New Mexico  
Energy, Minerals and Natural Resources Department

OIL CONSERVATION DIVISION  
P.O. Box 2088  
Santa Fe, New Mexico 87504-2088

WELL API NO.  
**30-025-34908**

5. Indicate Type of Lease  
State ☐ FEE ☒

7. Lease Name or Unit Agreement Name  
**BIG BEAR ATN**

8. Well No.  
**1**

9. Pool Name or Wildcat  
**Townsend Perma Upper Perm**

SUNDRY NOTICES AND REPORTS ON WELLS  
(DO NOT USE THIS FORM FOR PROPOSALS TO DRILL OR TO DEEPEN OR PLUG BACK TO A  
DIFFERENT RESERVOIR. USE " APPLICATION FOR PERMIT"  
(FORM C-101) FOR SUCH PROPOSALS.)

1. Type of Well:  
OIL ☐ GAS  
WELL ☐ WELL ☒ OTHER

2. Name of Operator  
**Yates Petroleum Corporation**

3. Address of Operator  
**105 South 4th., Artesia, NM 88210**

4. Well Location  
Unit Letter **SI** : **1980** Feet From The **South** Line and **1120** Feet From The **East** Line  
Section **29** Township **T15S** Rang **R35E** NMPM **Lea** COUNTY

10. Elevation (Show whether DF, RKB, RT, GR, etc.)  
**4001' GL**

11. Check Appropriate Box to Indicate Nature of Notice, Report, or Other Data

NOTICE OF INTENTION TO:  
PERFORM REMEDIAL WORK ☐ PLUG AND ABANDON ☐  
TEMPORARILY ABANDON ☐ CHANGE PLANS ☐  
PULL OR ALTER CASING ☐  
OTHER ☐

SUBSEQUENT REPORT OF:  
REMEDIAL WORK ☐ ALTERING CASING ☐  
COMMENCE DRILLING OPNS. ☐ PLUG AND ABANDONMENT ☐  
CASING TEST AND CEMENT JOB ☐  
OTHER Re-entry ☐

12. Describe Proposed or Completed Operations (Clearly state all pertinent details, and give pertinent dates, including estimated date of starting any proposed work) SEE RULE 1103.  
7-25-01- MIRT. Notified Debbie w/ the FAA of intent to MIRT. Notified Bill Gatchall, manager @ Zip Franklin Memorial airport @ 8:15 am 7-25-01.  
7-27-01- Drilled cement to 40'. Picked up drill pipe & drill collars. Drilled cement. PU drill pipe. Start drilling cement @ 2:00 pm 7-27-01.  
7-28-01- Washing to bottom. Circ clean hole. Tagged cement @ 4540'. Drilled cement to 7930'-6230'.  
7-30-01- Drilled cement from 9740-9860'.  
7-31-01- circ & condition , heaving shale.  
8-1-01- Wash & ream thru shale.  
8-2-01- Wash & ream. Trip- remove jets. SLM.  
8-11-01- Wash & ream. Circ @ 12,103'. TD 8-1/4" hole @ 4:30 am 8-11-01.  
8-13-01- Lay down drill pipe.  
8-14-01- ND & jet pits. LD DP & DC. Rigged up & run 287 jts (12,165') casing, set as follows:  
23 jts 5-1/2" 20# P110 SB (957.95')  
14 jts 5-1/2" 17# HCP110 SB (554.28')  
25 jts 5-1/2" 17# P110 varn (1070.97')

I hereby certify that the information above is true and complete to the best of my knowledge and belief.

SIGNATURE Donna Clack TITLE Operations Technician DATE 11/12/01

TYPE OR PRINT NAME Donna Clack TELEPHONE NO 505-748-1471

(This space for State Use)

APPROVED BY [Signature] TITLE PETROLEUM ENGINEER DATE FEB 26 2002

CONDITIONS OF APPROVAL, IF ANY:



YATES PETROLEUM CORPORATION  
BIG BEAR 'ATN' #1  
Section 29-15S-35E  
Lea County, New Mexico

222 jts 5-1/2" 17# L-80 varn (9453.17')

3 jts 5-1/2" 20# P110 varn (129.53')

Float shoe srt @ 12,103'. Float collar set @ 12,103. Bpttom marker @ 11,167', top marker @ 10,613'. Cemented w/ 1025 sx PVL + 1#/sx D44 + 4# /sx D24 + 0.2% D65 + 0.3% D167 + 0.2% D46 + 0.7% D800 + 0.05% gal/sx D801 (yld 1.36, wt 13.5). PD @ 11:45 pm 8-13-01. Bumped plug to 2000 psi for 2 min, float & casing held OK. 8-14-01- iting on completion unit. Rig down. Set slips & cut off. Rig released @ 8:00 am 8-14-01.

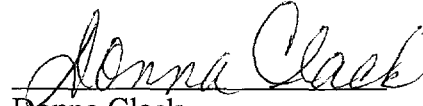

Donna Clack  
Operations Technician  
January 25, 2002



State of New Mexico  
Energy, Minerals and Natural Resources Department

OIL CONSERVATION DIVISION

P.O. Box 2088  
Santa Fe, New Mexico 87504-2088

DISTRICT I  
P.O. Box 1980, Hobbs NM 88240

DISTRICT II  
P.O. Drawer DD, Artesia NM 88210

DISTRICT III  
1000 Rio Brazos Rd., Aztec NM 87410

WELL APT NO.
30-025-34908
5. Indicate Type of Lease State <input type="checkbox"/> FEE <input checked="" type="checkbox"/>
7. Lease Name or Unit Agreement Name  BIG BEAR ATN
8. Well No. 1
9. Pool Name or Wildcat Townsend Perma Upper Penn

SUNDRY NOTICES AND REPORTS ON WELLS  
(DO NOT USE THIS FORM FOR PROPOSALS TO DRILL OR TO DEEPEN OR PLUG BACK TO A  
DIFFERENT RESERVOIR. USE "APPLICATION FOR PERMIT"  
(FORM C-101) FOR SUCH PROPOSALS.)

1. Type of Well:  
OIL ☐ GAS  
WELL ☐ WELL ☒ OTHER

2. Name of Operator  
Yates Petroleum Corporation

3. Address of Operator  
105 South 4th., Artesia, NM 88210

4. Well Location  
Unit Letter SI : 1980 Feet From The South Line and 1120 Feet From The East Line  
Section 29 Township T15S Rang R35E NMPM Lea COUNTY

10. Elevation (Show whether DF, RKB, RT, GR, etc.)  
4001' GL

11. Check Appropriate Box to Indicate Nature of Notice, Report, or Other Data

NOTICE OF INTENTION TO:  
PERFORM REMEDIAL WORK ☐ PLUG AND ABANDON ☐  
TEMPORARILY ABANDON ☐ CHANGE PLANS ☐  
PULL OR ALTER CASING ☐  
OTHER ☐

SUBSEQUENT REPORT OF:  
REMEDIAL WORK ☐ ALTERING CASING ☐  
COMMENCE DRILLING OPNS. ☐ PLUG AND ABANDONMENT ☐  
CASING TEST AND CEMENT JOB ☐  
OTHER Re-entry ☐

12. Describe Proposed or Completed Operations (Clearly state all pertinent details, and give pertinent dates, including estimated date of starting any proposed work) SEE RULE 1103.

8-21-01- miru PULLING UNIT. Tag PBTD @ 12,054'. SI.

8-23-01- Rig up wireline. TIH w/4" casing guns. Perforated Atoka Sand 11,796-820' 6 JSPF = 84 .42" holes.

Rig down wireline. Spot 5 bbls 7-1/2% Morrow Acid.

8-24-01- Rig up acid equipment. Acidized Atoka Sand w/ 1000 gal 7-1/2% Morrow Acid w/1500 SCF N2/bbl.

11-6-01- Released packer. ND tree & NU BOP. TOH & RU wireline. TIH; TOH. TIH w/5-1/2" C, set @ 11,750'.

Cap w/ 35' cement. TIH w/ 4" casing gun. Correlated & perforated Strawn Lime 11,536-653' (2JSPF) w/ 28 .42" holes. SI.

11-8-01- Acidized w/ 2000 gals 15% IC HCL w/ 15 bbls acid in formation.

11-13-01- TOH w/ packer. Rig up wireline. TIH w/ 5-1/2" CIBP, set @ 11,495'. Cap w/ 35' cement. TIH w/ 4" casing gu

11-14-01- TIH w/ packer & RBP @ 11,223'. Acidized w/ 2000 gal 15% IC HCL w/ 10 bbls acid in formation.

11-19-01- Released packer & RBP. TOH. TIH w/ production string. ND BOP. Rig down.

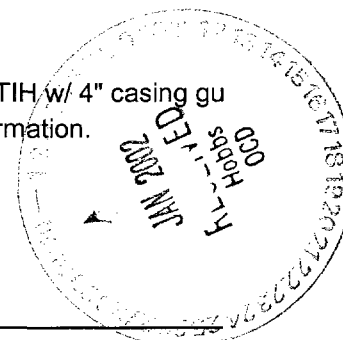

I hereby certify that the information above is a true and complete to the best of my knowledge and belief.

SIGNATURE Donna Clack TITLE Operations Technician DATE 1/25/02

TYPE OR PRINT NAME Donna Clack TELEPHONE NO 505-748-1471

(This space for State Use)

APPROVED BY [Signature] TITLE PETROLEUM ENGINEER DATE FEB 26 2002

CONDITIONS OF APPROVAL, IF ANY:

Submit to Appropriate  
District Office  
State Lease - 6 copies  
Fee Lease - 5 copies  
DISTRICT I  
P.O. Box 1980, Hobbs, NM 88240

DISTRICT II  
P.O. Drawer DD, Artesia, NM 88210

DISTRICT III  
1000 Rio Brazos Rd., Aztec, NM 87410

State of New Mexico  
Energy, Minerals and Natural Resources Department

OIL CONSERVATION DIVISION  
P.O. Box 2088  
Santa Fe, New Mexico 87504-2088

Form C-105  
Revised 1-1-89

WELL API NO. 30-025-34908
5. Indicate Type of Lease STATE <input type="checkbox"/> FEE <input checked="" type="checkbox"/>
6. State Oil & Gas Lease No.

WELL COMPLETION OR RECOMPLETION REPORT AND LOG

1a. Type of Well: OIL WELL <input type="checkbox"/> GAS WELL <input type="checkbox"/> DRY <input checked="" type="checkbox"/> OTHER _____		7. Lease Name or Unit Agreement Name  Big Bear ATN	
b. Type of Completion: NEW WELL <input checked="" type="checkbox"/> WORK OVER <input type="checkbox"/> DEEPEN <input type="checkbox"/> PLUG BACK <input type="checkbox"/> DIFF RESVR <input type="checkbox"/> OTHER _____		8. Well No. 1	
2. Name of Operator YATES PETROLEUM CORPORATION (505) 748-1471		9. Pool name or Wildcat Wildcat	
3. Address of Operator 105 South 4th St., Artesia, NM 88210			
4. Well Location Unit Letter J : 1980 Feet From The South Line and 1120 Feet From The East Line Section 29 Township 15S Range 35E NMPM Lea County			
10. Date Spudded RT 2-16-2000 RT 2-24-2000	11. Date T.D. Reached 4-15-2000	12. Date Compl. (Ready to Prod.) P & A 4-20-2000	13. Elevations (DF & RKB, RT, GR, etc.) 4001' GR
14. Elev. Casinghead			
15. Total Depth 13255'	16. Plug Back T.D.	17. If Multiple Compl. How Many Zones?	18. Intervals Drilled By Rotary Tools 40-13255'
19. Producing Interval(s), of this completion - Top, Bottom, Name Dry - P & A 4-20-2000			20. Was Directional Survey Made No
21. Type Electric and Other Logs Run Neutron, Sonic & Laterolog			22. Was Well Cored No

CASING RECORD (Report all strings set in well)

CASING SIZE	WEIGHT LB/FT.	DEPTH SET	HOLE SIZE	CEMENTING RECORD	AMOUNT PULLED
20"		40'	26"	Cement to surface	
13-3/8"	48#	402'	17-1/2"	500 sx - circulate	
9-5/8"	36# & 40#	4695'	12-1/4"	1600 sx - circulate	
			8-3/4"		

24. LINER RECORD					25. TUBING RECORD		
SIZE	TOP	BOTTOM	SACKS CEMENT	SCREEN	SIZE	DEPTH SET	PACKER SET

26. Perforation record (interval, size, and number) N/A	27. ACID, SHOT, FRACTURE, CEMENT, SQUEEZE, ETC.	
	DEPTH INTERVAL	AMOUNT AND KIND MATERIAL USED

28. PRODUCTION							
Date First Production		Production Method (Flowing, gas lift, pumping - Size and type pump) P & A 4-20-2000				Well Status (Prod. or Shut-in) Dry	
Date of Test	Hours Tested	Choke Size	Prod'n For Test Period	Oil - Bbl.	Gas - MCF	Water - Bbl.	Gas - Oil Ratio
Flow Tubing Press.	Casing Pressure	Calculated 24-Hour Rate	Oil - Bbl.	Gas - MCF	Water - Bbl.	Oil Gravity - API - (Corr.)	

29. Disposition of Gas (Sold, used for fuel, vented, etc.)	Test Witnessed By
--	-------------------

30. List Attachments Drill Stem Tests, Deviation Survey & Logs
---

31. I hereby certify that the information shown on both sides of this form is true and complete to the best of my knowledge and belief

Signature Rusty Klein Printed Name Rusty Klein Title Operations Tech. Date 6-21-2001

# INSTRUCTIONS

This form is to be filed with the appropriate District Office of the Division not later than 20 days after the completion of any newly-drilled deepened well. It shall be accompanied by one copy of all electrical and radio-activity logs run on the well and a summary of all special tests conducted, including drill stem tests. All depths reported shall be measured depths. In the case of directionally drilled wells, true vertical depths shall also be reported. For multiple completions, Items 25 through 29 shall be reported for each zone. The form is to be filed in quintuplicate except on state land, where six copies are required. See Rule 1105.

## INDICATE FORMATION TOPS IN CONFORMANCE WITH GEOGRAPHICAL SECTION OF STATE

### Southeastern New Mexico

Anhy \_\_\_\_\_ T. Canyon \_\_\_\_\_  
 Salt \_\_\_\_\_ 1967' T. Strawn \_\_\_\_\_ 11578'  
 Salt \_\_\_\_\_ T. Atoka \_\_\_\_\_ 11866'  
 Yates \_\_\_\_\_ 3040' T. Miss \_\_\_\_\_  
 7 Rivers \_\_\_\_\_ T. Devonian \_\_\_\_\_  
 Queen \_\_\_\_\_ T. Silurian \_\_\_\_\_  
 Grayburg \_\_\_\_\_ T. Montoya \_\_\_\_\_  
 San Andres \_\_\_\_\_ 4908' T. Simpson \_\_\_\_\_  
 Glorieta \_\_\_\_\_ 6142' T. McKee \_\_\_\_\_  
 Paddock \_\_\_\_\_ T. Ellenburger \_\_\_\_\_  
 Blinberry \_\_\_\_\_ T. Gr. Wash \_\_\_\_\_  
 Tubb \_\_\_\_\_ 7336' T. Delaware Sand \_\_\_\_\_  
 Drinkard \_\_\_\_\_ T. Bone Springs \_\_\_\_\_  
 Abo \_\_\_\_\_ 7974' T. Rustler \_\_\_\_\_ 1866'  
 Wolfcamp \_\_\_\_\_ 9766' T. Morrow Lime \_\_\_\_\_ 11492'  
 Penn \_\_\_\_\_ T. Austin \_\_\_\_\_ 12721'  
 Cisco (Bough C) \_\_\_\_\_ T. Chester \_\_\_\_\_ 13034'

### Northwestern New Mexico

T. Ojo Alamo \_\_\_\_\_ T. Penn. "B" \_\_\_\_\_  
 T. Kirtland-Fruitland \_\_\_\_\_ T. Penn. "C" \_\_\_\_\_  
 T. Pictured Cliffs \_\_\_\_\_ T. Penn. "D" \_\_\_\_\_  
 T. Cliff House \_\_\_\_\_ T. Leadville \_\_\_\_\_  
 T. Menefee \_\_\_\_\_ T. Madison \_\_\_\_\_  
 T. Point Lookout \_\_\_\_\_ T. Elbert \_\_\_\_\_  
 T. Mancos \_\_\_\_\_ T. McCracken \_\_\_\_\_  
 T. Gallup \_\_\_\_\_ T. Ignacio Otzte \_\_\_\_\_  
 Base Greenhorn \_\_\_\_\_ T. Granite \_\_\_\_\_  
 T. Dakota \_\_\_\_\_ T. \_\_\_\_\_  
 T. Morrison \_\_\_\_\_ T. \_\_\_\_\_  
 T. Todilto \_\_\_\_\_ T. \_\_\_\_\_  
 T. Entrada \_\_\_\_\_ T. \_\_\_\_\_  
 T. Wingate \_\_\_\_\_ T. \_\_\_\_\_  
 T. Chinle \_\_\_\_\_ T. \_\_\_\_\_  
 T. Permian \_\_\_\_\_ T. \_\_\_\_\_  
 T. Penn "A" \_\_\_\_\_ T. \_\_\_\_\_

### OIL OR GAS SANDS OR ZONES

No. 1, from \_\_\_\_\_ to \_\_\_\_\_ No. 3, from \_\_\_\_\_ to \_\_\_\_\_  
 No. 2, from \_\_\_\_\_ to \_\_\_\_\_ No. 4, from \_\_\_\_\_ to \_\_\_\_\_

### IMPORTANT WATER SANDS

Include data on rate of water inflow and elevation to which water rose in hole.

No. 1, from \_\_\_\_\_ to \_\_\_\_\_ feet \_\_\_\_\_  
 No. 2, from \_\_\_\_\_ to \_\_\_\_\_ feet \_\_\_\_\_  
 No. 3, from \_\_\_\_\_ to \_\_\_\_\_ feet \_\_\_\_\_

### LITHOLOGY RECORD (Attach additional sheet if necessary)

From	To	Thickness in Feet	Lithology	From	To	Thickness in Feet	Lithology
0	160	160	Surface	9790	10064	274	Lime & dolomite
160	1511	1351	Redbed	10064	12088	2024	Lime & shale
1511	1958	447	Redbed & anhydrite	12088	12220	132	Lime, shale & sand
1958	4254	2296	Anhydrite	12220	13255	1035	Lime & shale
4254	4315	61	Shale, dolo & anhydrite				
4315	4695	380	Dolomite & anhydrite				
4695	4933	238	Dolomite & lime				
4933	5442	509	Shale, anhydrite & dolo				
5442	6799	1357	Shale & dolomite				
6799	7077	278	Shale, sand & dolomite				
7077	8213	1136	Dolomite & sand				
8213	8545	332	Shale, dolo & anhydrite				
8545	8688	143	Shale & dolomite				
8688	8960	272	Lime, shale & anhydrite				
8960	9790	830	Lime & shale				

RECEIVED  
 JUN 10 1960

YATES PETROLEUM CORPORATION  
Big Bear ATN #1  
Section 29-T15S-R35E  
Lea County, New Mexico

DRILL STEM TEST RESULTS:

DST #1: Misrun

DST #2 11128-11204' (Wolfcamp): TIMES: TO 15"; SI 60"; TO 60"; SI 180". RECOVERY:  
3578' of oil. SAMPLER: 5.94 cfg & 1000 cc of oil. PRESSURES: IHP 5549; IFP 384-513;  
ISIP 4210; 2nd FP 528-1373; FSIP 3947; FHP 5555

DST #3 11624-11685' (Canyon): TIMES: TO 15"; SI 60;; TO 60"; SI 120". RECOVERY:  
698' of fresh water cushion and 506' of gas cut mud. SAMPLER: .45 CFG and 2300 cc  
mud. PRESSURES: IHP 5961; IFP 466-491; ISIP 2310; 2nd FP 513-522; FSIP 1852;  
FHP 5966

OPERATOR: Yates Petroleum  
WELL/LEASE: Big Bear ANT #1  
COUNTY: Lea

STATE OF NEW MEXICO  
DEVIATION REPORT

190	1/4	7,576	1/2
402	1/2	8,068	1/2
901	1	8,544	3/4
1,400	3/4	9,040	1
1,899	1 1/4	9,535	1
2,398	2	9,635	3/4
2,641	1 3/4	10,134	1/2
2,897	1 1/4	10,618	1
3,352	1 3/4	10,973	3/4
3,850	3	11,204	1 1/4
3,970	3 1/2	11,703	4
4,050	3 1/2	11,825	3 1/2
4,115	3 1/2	11,913	3
4,179	3 3/4	12,163	2
4,210	4	12,446	1 3/4
4,243	3 3/4	12,917	1 3/4
4,275	3 1/4	13,154	1 1/2
4,305	3 1/2		
4,338	3		
4,418	3		
4,431	2 3/4		
4,495	2 3/4		
4,580	3 1/4		
4,788	3 3/4		
4,850	3 1/4		
4,903	3 1/4		
4,977	3 1/4		
5,070	3		
5,264	3		
5,521	2 1/2		
6,001	1 1/4		
6,500	3/4		
6,985	1/2		
7,077	3/4		

By: \_\_\_\_\_

*Ray Peterson*

STATE OF TEXAS

COUNTY OF MIDLAND

The foregoing instrument was acknowledged before me on this 25th day of April, 2000, by  
Ray Peterson on behalf of UTI Drilling L.P.

My Commission Expires: 3/31/2003

*Joni D. Hodges*  
Notary Public for Midland County, Texas

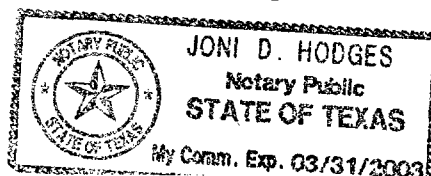

OPERATOR: Yates Petroleum  
WELL/LEASE: Big Bear ANT #1  
COUNTY: Lea

STATE OF NEW MEXICO  
DEVIATION REPORT

190	1/4	7,576	1/2
402	1/2	8,068	1/2
901	1	8,544	3/4
1,400	3/4	9,040	1
1,899	1 1/4	9,535	1
2,398	2	9,635	3/4
2,641	1 3/4	10,134	1/2
2,897	1 1/4	10,618	1
3,352	1 3/4	10,973	3/4
3,850	3	11,204	1 1/4
3,970	3 1/2	11,703	4
4,050	3 1/2	11,825	3 1/2
4,115	3 1/2	11,913	3
4,179	3 3/4	12,163	2
4,210	4	12,446	1 3/4
4,243	3 3/4	12,917	1 3/4
4,275	3 1/4	13,154	1 1/2
4,305	3 1/2		
4,338	3		
4,418	3		
4,431	2 3/4		
4,495	2 3/4		
4,580	3 1/4		
4,788	3 3/4		
4,850	3 1/4		
4,903	3 1/4		
4,977	3 1/4		
5,070	3		
5,264	3		
5,521	2 1/2		
6,001	1 1/4		
6,500	3/4		
6,985	1/2		
7,077	3/4		

By: *Ray Peterson*

STATE OF TEXAS

COUNTY OF MIDLAND

The foregoing instrument was acknowledged before me on this 25th day of April, 2000, by  
Ray Peterson on behalf of UTI Drilling L.P.

My Commission Expires: 3/31/2003

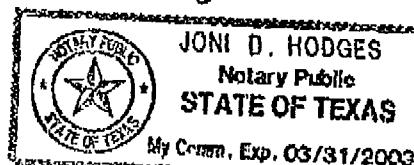
*Joni D. Hodges*  
Notary Public for Midland County, Texas

Submit 3 Copies  
to Appropriate  
District Office

State of New Mexico  
Energy, Minerals and Natural Resources Department

Form C-103  
Revised 1-1-89

DISTRICT I  
P.O. Box 1980, Hobbs, NM 88240

DISTRICT II  
P.O. Drawer DD, Artesia, NM 88210

DISTRICT III  
1000 Rio Brazos Rd., Aztec, NM 87410

OIL CONSERVATION DIVISION

P.O. Box 2088  
Santa Fe, New Mexico 87504-2088

WELL API NO. 30-025-34908
5. Indicate Type of Lease STATE <input type="checkbox"/> FEDERAL <input checked="" type="checkbox"/>
6. State Oil & Gas Lease No.
7. Lease Name or Unit Agreement Name Big Bear ATN
8. Well No. 1
9. Pool name or Wildcat Wildcat Mississippian

SUNDRY NOTICES AND REPORTS ON WELLS (DO NOT USE THIS FORM FOR PROPOSALS TO DRILL OR TO DEEPEN OR PLUG BACK TO A DIFFERENT RESERVOIR. USE "APPLICATION FOR PERMIT" (FORM C-101) FOR SUCH PROPOSALS.)	
1. Type of Well: OIL WELL <input type="checkbox"/> GAS WELL <input checked="" type="checkbox"/> OTHER	
2. Name of Operator YATES PETROLEUM CORPORATION	
3. Address of Operator 105 South 4th St., Artesia, NM 88210	
4. Well Location Unit Letter J : 1980 Feet From The South Line and 1120 Feet From The East Line Section 29 Township 15S Range 35E NMPLM Lea County	
10. Elevation (Show whether DP, RKB, RT, GR, etc.) 4001' GR	

11. Check Appropriate Box to Indicate Nature of Notice, Report, or Other Data	
NOTICE OF INTENTION TO:	SUBSEQUENT REPORT OF:
PERFORM REMEDIAL WORK <input type="checkbox"/>	REMEDIAL WORK <input type="checkbox"/>
TEMPORARILY ABANDON <input type="checkbox"/>	ALTERING CASING <input type="checkbox"/>
PULL OR ALTER CASING <input type="checkbox"/>	COMMENCE DRILLING OPNS. <input type="checkbox"/>
OTHER: <input type="checkbox"/>	PLUG AND ABANDONMENT <input checked="" type="checkbox"/>
	CASING TEST AND CEMENT JOB <input type="checkbox"/>
	OTHER: <input type="checkbox"/>

12. Describe Proposed or Completed Operations (Clearly state all pertinent details, and give pertinent dates, including estimated date of starting any proposed work) SEE RULE 1103.  
TD 13255'. Reached TD at 7:00 AM 4-15-2000. Tim Bussell, Drilling Foreman for Yates Petroleum Corporation received verbal permission from Paul Kautz w/OCD-Hobbs to plug and abandon well. Well was plugged and abandoned as follows:

Plug #1: 13255-13155' - 35 sacks Premium Plus with 1% HR-10 (weight 15.6)  
Plug #2: 11628-11528' - 60 sacks Premium Plus with 1% HR-10 (weight 15.6)  
Plug #3: 9810-9710' - 55 sacks Premium Plus (weight 15.6)  
Plug #4: 8020-7920' - 60 sacks Premium Plus (weight 15.6)  
Plug #5: 6191-6091' - 45 sacks Premium Plus (weight 14.8)  
Plug #6: 4745-4645' - 70 sacks Premium Plus (weight 14.8)  
Plug #7: 2470-2370' - 35 sacks Premium Plus (weight 14.8)  
Plug #8: 1917-1817' - 35 sacks Premium Plus (weight 14.8)  
Plug #9: 452-352' - 35 sacks Premium Plus (weight 14.8)  
Plug #10: 40' to surface - 10 sacks Premium Plus (weight 14.8)

Cleaned location and installed regulation abandonment marker.

I hereby certify that the information above is true and complete to the best of my knowledge and belief. **PLUGGED AND ABANDONED - FINAL REPORT.** Plugging completed 4-20-2000.

SIGNATURE Rusty Klein TITLE Operations Technician DATE June 21, 2001

TYPE OR PRINT NAME Rusty Klein

TELEPHONE NO. 505/748-147

(This space for State Use)

APPROVED BY Paul B. Canty TITLE Geologist DATE JUN 25 2001

CONDITIONS OF APPROVAL, IF ANY:



Submit 3 Copies  
to Appropriate  
District Office

State of New Mexico  
Energy, Minerals and Natural Resources Department

Form C-103  
Revised 1-1-89

DISTRICT I  
P.O. Box 1980, Hobbs, NM 88240

DISTRICT II  
P.O. Drawer DD, Artesia, NM 88210

DISTRICT III  
1000 Rio Brazos Rd., Aztec, NM 87410

OIL CONSERVATION DIVISION  
P.O. Box 2088  
Santa Fe, New Mexico 87504-2088

WELL API NO.	30-025-34908
5. Indicate Type of Lease	STATE <input type="checkbox"/> FEE <input checked="" type="checkbox"/>
6. State Oil & Gas Lease No.	
7. Lease Name or Unit Agreement Name	Big Bear ATN
8. Well No.	1
9. Pool name or Wildcat	Wildcat Mississippian

SUNDRY NOTICES AND REPORTS ON WELLS  
(DO NOT USE THIS FORM FOR PROPOSALS TO DRILL OR TO DEEPEN OR PLUG BACK TO A  
DIFFERENT RESERVOIR. USE "APPLICATION FOR PERMIT"  
(FORM C-101) FOR SUCH PROPOSALS.)

1. Type of Well: Oil Well <input type="checkbox"/> GAS WELL <input checked="" type="checkbox"/> OTHER	2. Name of Operator YATES PETROLEUM CORPORATION
3. Address of Operator 105 South 4th St., Artesia, NM 88210	4. Well Location Unit Letter J : 1980 Feet From The South Line and 1120 Feet From The East Line Section 29 Township 15S Range 35E NMMP Lea County
10. Elevation (Show whether DF, RKB, RT, GR, etc.) 4001' GR	

11. Check Appropriate Box to Indicate Nature of Notice, Report, or Other Data	
NOTICE OF INTENTION TO:	SUBSEQUENT REPORT OF:
PERFORM REMEDIAL WORK <input type="checkbox"/>	REMEDIAL WORK <input type="checkbox"/>
TEMPORARILY ABANDON <input type="checkbox"/>	ALTERING CASING <input type="checkbox"/>
PULL OR ALTER CASING <input type="checkbox"/>	COMMENCE DRILLING OPNS. <input type="checkbox"/>
OTHER: <input type="checkbox"/>	PLUG AND ABANDONMENT <input type="checkbox"/>
	CASING TEST AND CEMENT JOB <input type="checkbox"/>
	OTHER: <input type="checkbox"/>

12. Describe Proposed or Completed Operations (Clearly state all pertinent details, and give pertinent dates, including estimated date of starting any proposed work) SEE RULE 1103.

TD 13255'. Reached TD at 7:00 AM 4-15-2000. Tim Russell, Drilling Foreman for Yates Petroleum Corporation received verbal permission from Paul Kautz w/OCD-Hobbs to plug and abandon well as follows:

Plug #1: 13255-13155' - 35 sacks  
Plug #2: 11628-11528' - 60 sacks  
Plug #3: 9810-9710' - 55 sacks  
Plug #4: 8020-7920' - 60 sacks  
Plug #5: 6191-6091' - 45 sacks  
Plug #6: 4745-4645' - 70 sacks  
Plug #7: 2470-2370' - 35 sacks  
Plug #8: 1917-1817' - 35 sacks  
Plug #9: 452-352' - 35 sacks  
Plug #10: 40-0' - 10 sacks

All cement used will be Premium Plus cement. Location will be cleaned and regulation abandonment marker installed.

I hereby certify that the information above is true and complete to the best of my knowledge and belief.

SIGNATURE Rusty Klein TITLE Operations Technician DATE June 21, 2001  
TYPE OR PRINT NAME Rusty Klein TELEPHONE NO. 505/748-147

(This space for State Use)

APPROVED BY Paul Kautz TITLE Geologist DATE JUN 25 2001  
CONDITIONS OF APPROVAL, IF ANY:

Submit to Appropriate  
District Office  
State Lease - 6 copies  
Fee Lease - 3 copies  
DISTRICT I  
P.O. Box 1980, Hobbs, NM 88240

State of New Mexico  
Energy, Minerals and Natural Resources Department

Form C-105  
Revised 1-1-89

OIL CONSERVATION DIVISION

DISTRICT II  
P.O. Drawer DD, Artesia, NM 88210

P.O. Box 2088  
Santa Fe, New Mexico 87504-2088

DISTRICT III  
1000 Rio Brazos Rd., Aztec, NM 87410

WELL API NO.	30-025-34908
5. Indicate Type of Lease	STATE <input type="checkbox"/> FEE <input checked="" type="checkbox"/>
6. State Oil & Gas Lease No.	
7. Lease Name or Unit Agreement Name	Big Bear ATN
8. Well No.	1
9. Pool name or Wildcat	Wildcat

WELL COMPLETION OR RECOMPLETION REPORT AND LOG										
1. Type of Well: OIL WELL <input type="checkbox"/> GAS WELL <input type="checkbox"/> DRY <input checked="" type="checkbox"/> OTHER <input type="checkbox"/>										
5. Type of Completion: NEW WELL <input checked="" type="checkbox"/> WORK OVER <input type="checkbox"/> DEEPEN <input type="checkbox"/> PLUG BACK <input type="checkbox"/> DRY RESVR <input type="checkbox"/> OTHER <input type="checkbox"/>										
2. Name of Operator YATES PETROLEUM CORPORATION (505) 748-1471										
3. Address of Operator 105 South 4th St., Artesia, NM 88210										
4. Well Location Unit Letter J : 1980 Feet From The South Line and 1120 Feet From The East Line Section 29 Township 15S Range 35E NMPM Lea County										
10. Date Spudded RT 2-24-2000		11. Date T.D. Reached 4-15-2000		12. Date Compl. (Ready to Prod.) P & A 4-20-2000		13. Elevations (DF& RKB, RT, GR, etc.) 4001' GR		14. Elev. Casinghead		
15. Total Depth 13255'		16. Plug Back T.D.		17. If Multiple Compl. How Many Zones?		18. Intervals Drilled By Rotary Tools 40-13255'		Cable Tools		
19. Producing Interval(s), of this completion - Top, Bottom, Name Dry - P & A 4-20-2000								20. Was Directional Survey Made No		
21. Type Electric and Other Logs Run Neutron, Sonic & Laterolog								22. Was Well Cored No		
23. CASING RECORD (Report all strings set in well)										
CASING SIZE		WEIGHT LB/FT.		DEPTH SET		HOLE SIZE		CEMENTING RECORD		AMOUNT PULLED
20"				40'		26"		Cement to surface		
13-3/8"		48#		402'		17-1/2"		500 sx - circulate		
9-5/8"		36# & 40#		4695'		12-1/4"		1600 sx - circulate		
						8-3/4"				
24. LINER RECORD										25. TUBING RECORD
SIZE		TOP		BOTTOM		SACKS CEMENT		SCREEN		
26. Perforation record (interval, size, and number) N/A						27. ACID, SHOT, FRACTURE, CEMENT, SQUEEZE, ETC.				
						DEPTH INTERVAL		AMOUNT AND KIND MATERIAL USED		
28. PRODUCTION										
Date First Production		Production Method (Flowing, gas lift, pumping - Size and type pump) P & A 4-20-2000						Well Status (Prod. or Shut-in) Dry		
Date of Test		Hours Tested		Choke Size		Prod'n For Test Period		Oil - Bbl.		Gas - MCF
										Water - Bbl.
										Gas - Oil Ratio
Flow Tubing Press.		Casing Pressure		Calculated 24-Hour Rate		Oil - Bbl.		Gas - MCF		Water - Bbl.
										Oil Gravity - API - (Corr.)
29. Disposition of Gas (Sold, used for fuel, vented, etc.)								Test Witnessed By		
30. List Attachments Drill Stem Tests, Deviation Survey & Logs										
31. I hereby certify that the information shown on both sides of this form is true and complete to the best of my knowledge and belief										
Signature		Printed Name		Rusty Klein		Title		Operations Tech.		Date 6-21-2000

YATES PETROLEUM CORPORATION  
Big Bear ATN #1  
Section 29-T15S-R35E  
Lea County, New Mexico

DRILL STEM TEST RESULTS:

DST #1: Misrun

DST #2 11128-11204' (Wolfcamp): TIMES: TO 15"; SI 60"; TO 60"; SI 180". RECOVERY:  
3578' of oil. SAMPLER: 5.94 cfg & 1000 cc of oil. PRESSURES: IHP 5549; IFP 384-513;  
ISIP 4210; 2nd FP 528-1373; FSIP 3947; FHP 5555

DST #3 11624-11685' (Canyon): TIMES: TO 15"; SI 60"; TO 60"; SI 120". RECOVERY:  
698' of fresh water cushion and 506' of gas cut mud. SAMPLER: .45 CFG and 2300 cc  
mud. PRESSURES: IHP 5961; IFP 466-491; ISIP 2310; 2nd FP 513-522; FSIP 1852;  
FHP 5966

# INSTRUCTIONS

This form is to be filed with the appropriate District Office of the Division not later than 20 days after the completion of any newly-drilled or deepened well. It shall be accompanied by one copy of all electrical and radio-activity logs run on the well and a summary of all special tests conducted, including drill stem tests. All depths reported shall be measured depths. In the case of directionally drilled wells, true vertical depths shall also be reported. For multiple completions, Items 25 through 29 shall be reported for each zone. The form is to be filed in quintuplicate except on state land, where six copies are required. See Rule 1105.

## INDICATE FORMATION TOPS IN CONFORMANCE WITH GEOGRAPHICAL SECTION OF STATE

### Southeastern New Mexico

### Northwestern New Mexico

T. Anhy	T. Canyon	T. Ojo Alamo	T. Penn. "B"
T. Salt 1967'	T. Strawn 11578'	T. Kirtland-Fruitland	T. Penn. "C"
T. Salt	T. Atoka 11866'	T. Pictured Cliffs	T. Penn. "D"
T. Yates 3040'	T. Miss	T. Cliff House	T. Leadville
T. 7 Rivers	T. Devonian	T. Menefee	T. Madison
T. Queen	T. Silurian	T. Point Lookout	T. Elbert
T. Grayburg	T. Montoya	T. Mancos	T. McCracken
T. San Andres 4908'	T. Simpson	T. Gallup	T. Ignacio Otzie
T. Glorieta 6142'	T. McKee	Base Greenhorn	T. Granite
T. Paddock	T. Ellenburger	T. Dakota	T.
T. Blinberry	T. Gr. Wash	T. Morrison	T.
T. Tubb 7336'	T. Delaware Sand	T. Todilto	T.
T. Drinkard	T. Bone Springs	T. Entrada	T.
T. Abo 7974'	T. Rustler 1866'	T. Wingate	T.
T. Wolfcamp 9766'	T. Morrow Lime 11492'	T. Chinle	T.
T. Penn	T. Austin 12721'	T. Permian	T.
T. Cisco (Bough C)	T. Chester 13034'	T. Penn "A"	T.

### OIL OR GAS SANDS OR ZONES

No. 1, from.....to..... No. 3, from.....to.....  
No. 2, from.....to..... No. 4, from.....to.....

### IMPORTANT WATER SANDS

Include data on rate of water inflow and elevation to which water rose in hole.

No. 1, from.....to.....feet.....  
No. 2, from.....to.....feet.....  
No. 3, from.....to.....feet.....

### LITHOLOGY RECORD (Attach additional sheet if necessary)

From	To	Thickness in Feet	Lithology	From	To	Thickness in Feet	Lithology
0	160	160	Surface	9790	10064	274	Lime & dolomite
160	1511	1351	Redbed	10064	12088	2024	Lime & shale
1511	1958	447	Redbed & anhydrite	12088	12220	132	Lime, shale & sand
1958	4254	2296	Anhydrite	12220	13255	1035	Lime & shale
4254	4315	61	Shale, dolo & anhydrite				
4315	4695	380	Dolomite & anhydrite				
4695	4933	238	Dolomite & lime				
4933	5442	509	Shale, anhydrite & dolo				
5442	6799	1357	Shale & dolomite				
6799	7077	278	Shale, sand & dolomite				
7077	8213	1136	Dolomite & sand				
8213	8545	332	Shale, dolo & anhydrite				
8545	8688	143	Shale & dolomite				
8688	8960	272	Lime, shale & anhydrite				
8960	9790	830	Lime & shale				

DISTRICT I  
1625 N. French Dr., Hobbs, NM 88240

State of New Mexico  
Energy, Minerals and Natural Resources Department

Form C-101  
Revised March 17, 1999  
Instructions on back

DISTRICT II  
811 South First, Artesia, NM 88210

OIL CONSERVATION DIVISION

Submit to appropriate District Office

DISTRICT III  
1000 Rio Brazos Rd., Aztec, NM 87410

PO BOX 2088  
Santa Fe, NM 87504-2088

State Lease - 6 Copies  
Fee Lease - 5 Copies

DISTRICT IV  
2040 South Pacheco, Santa Fe, NM 87501

☐ AMENDED REPORT

APPLICATION FOR PERMIT TO DRILL, RE-ENTER, DEEPEN, PLUGBACK, OR ADD A ZONE

<sup>1</sup> Operator Name and Address Yates Petroleum Corporation 105 South Fourth Street Artesia, New Mexico 88210		<sup>2</sup> OGRID Number 025575
		<sup>3</sup> API Number 30- 025-34908
<sup>4</sup> Property Code 25300	<sup>5</sup> Property Name Big Bear "ATN"	<sup>6</sup> Well No. 1

<sup>7</sup> Surface Location

UL or lot no.	Section	Township	Range	Lot Idn	Feet from the	North/South Line	Feet from the	East/West Line	County
I	29	15S	35E		1980	South	1120	East	Lea

<sup>8</sup> Proposed Bottom Hole Location If Different From Surface

UL or lot no.	Section	Township	Range	Lot Idn	Feet from the	North/South Line	Feet from the	East/West Line	County
<sup>9</sup> Proposed Pool 1 Wildcat Atoka					<sup>10</sup> Proposed Pool 2				

<sup>11</sup> Work Type Code E	<sup>12</sup> Well Type Code G	<sup>13</sup> Cable/Rotary R	<sup>14</sup> Lease Type Code P	<sup>15</sup> Ground Level Elevation 4001'
<sup>16</sup> Multiple No	<sup>17</sup> Proposed Depth 13,155'	<sup>18</sup> Formation Atoka	<sup>19</sup> Contractor Not Determined	<sup>20</sup> Spud Date ASAP

<sup>21</sup> Proposed Casing and Cement Program

Hole Size	Casing Size	Casing weight/feet	Setting Depth	Sacks of Cement	Estimated TOC
17 1/2"	13 3/8	48#	402'-in place	500 sx	Circulate
12 1/4"	9 5/8"	36# & 40#	4695'-in place	1600 sx	Circulate
7 7/8"	5 1/2"	17# & 20#	0-13,155'	1500 sx	TOC-4000'

<sup>22</sup> Describe the proposed program. If this application is to DEEPEN or PLUG BACK give the data on the present productive zone and proposed new productivity. Describe the blowout prevention program, if any. Use additional sheets if necessary.

See Attached Sheet

Permit Expires 1 Year From Approval  
Date Unless Drilling Underway

Re-Entry

<sup>23</sup> I hereby certify that the information given above is true and complete to the best of my knowledge and belief. Signature: <i>Clifton R. May</i>		OIL CONSERVATION DIVISION	
Printed name: Clifton R. May		Approved by: <i>[Signature]</i>	
Title: Regulatory Agent		Title: <i>[Signature]</i>	
Date: 06/08/01	Phone: (505) 748-1471	Approval Date: JUN 25 2001	Expiration Date:
		Conditions of Approval Attached <input type="checkbox"/>	

# **YATES PETROLEUM CORPORATION**

**Big Bear "ATN" #1 Re-entry**

**1980' FSL & 1120' FEL**

**Section 29-T15S-R35E**

**Lea County, New Mexico**

**Fee Lease**

**Drilling Plans:** Yates Petroleum Corporation plans to re-enter this well bore using a drilling rig to drill out the cement plugs in the 9 5/9" casing which was set at 4695' and cemented with 1600 sacks. The casing shoe will be tested and the open hole plugs will be drilled out to the plug at 13,155' with an 8 5/8" bit. No open hole logs will be ran. Yates will run 5 1/2" production casing to TD and will be cemented with approximately 1500 sacks of cement to bring the cement top up into the 9 5/8" casing (estimated TOC at 4000'). The mud program to be used will be 9.4 -10.2 ppg salt gel system with a 34-40 viscosities and approximately 12 water loss. A 5000# BOPE will be installed on the 9 5/8" casing.

**The well will be completed using a pulling unit. The Atoka and Wolfcamp formations will be the main target.**

WELL NAME: Big Bear ATN #1 FIELD: \_\_\_\_\_  
LOCATION: 1980'FSL & 1120'FEL Sec 29-15S-35E Lea County  
GL: \_\_\_\_\_ ZERO: \_\_\_\_\_ KB: \_\_\_\_\_  
SPUD DATE: \_\_\_\_\_ COMPLETION DATE: \_\_\_\_\_  
COMMENTS: \_\_\_\_\_  
\_\_\_\_\_  
\_\_\_\_\_

CASING PROGRAM

13-3/8" 48# H40	402'
9-5/8" 36# & 40# J55	4695'

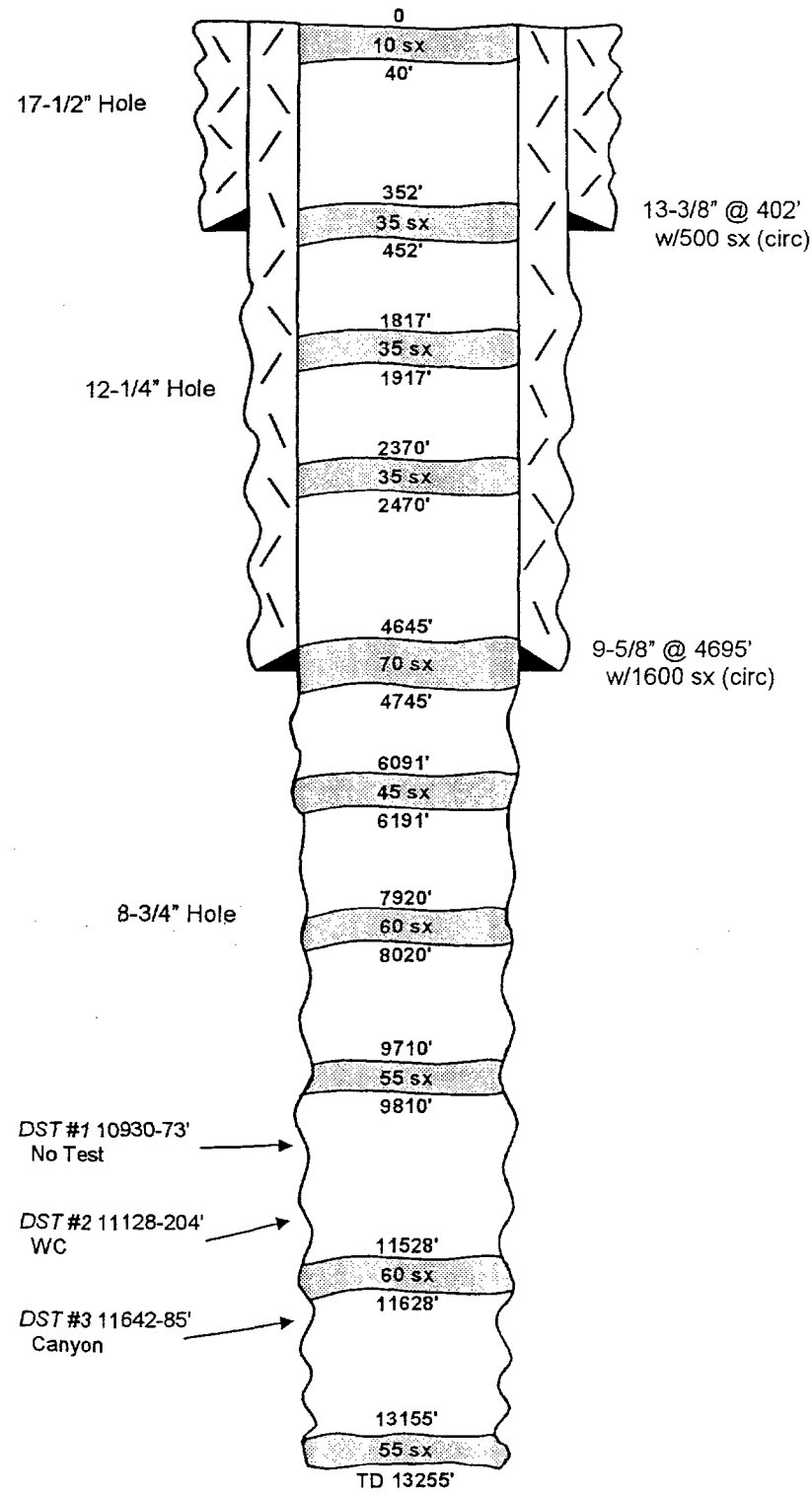

Before

WELL NAME: Big Bear ATN #1

FIELD:

LOCATION: 1980'FSL & 1120'FEL Sec 29-15S-35E

Lea County

GL: ZERO: KB:

SPUD DATE: COMPLETION DATE:

COMMENTS:

CASING PROGRAM	
13-3/8" 48# H40	402'
9-5/8" 36# & 40# J55	4695'
5-1/2"	13155'

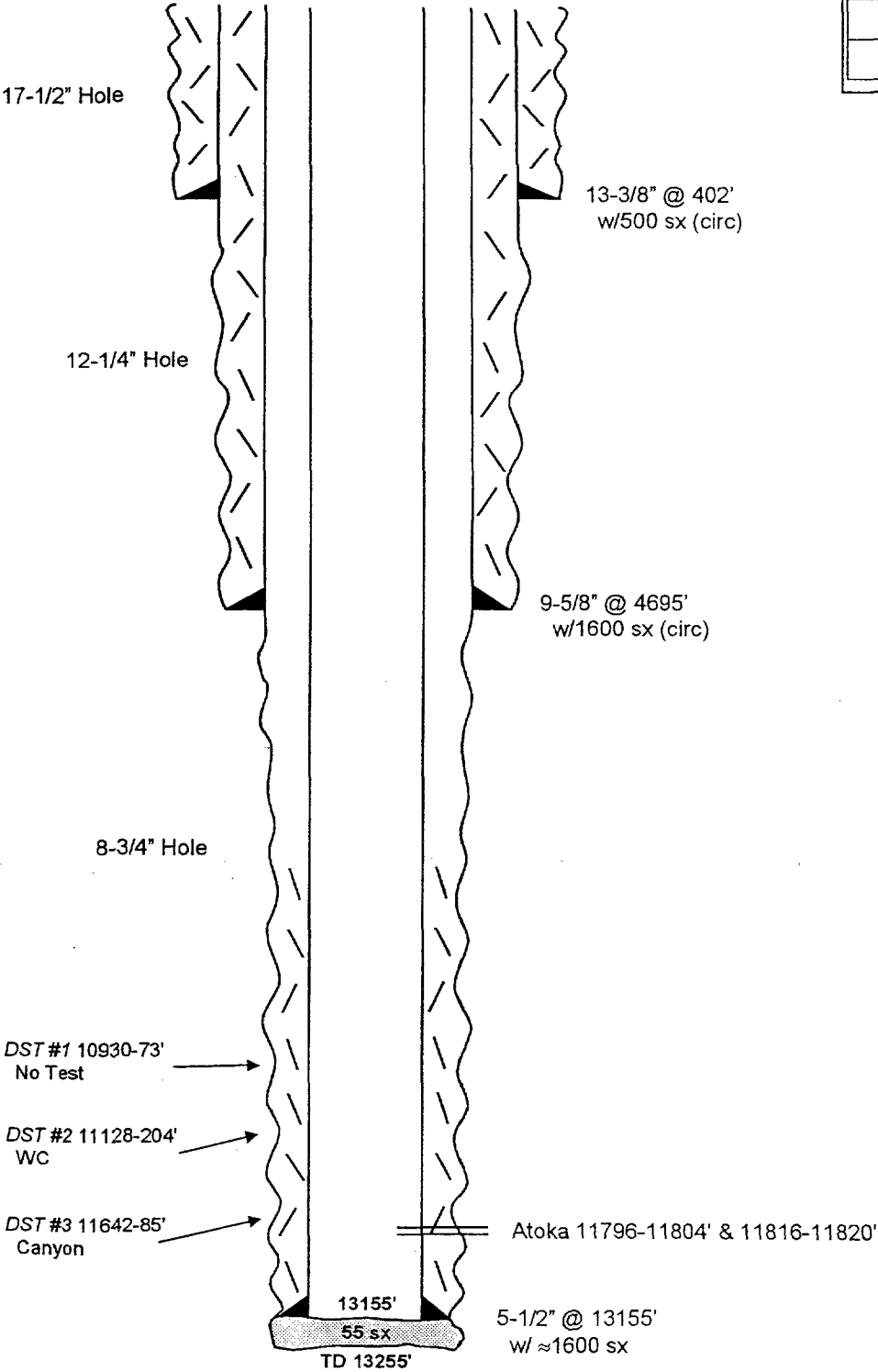

After



DISTRICT I  
P.O. Box 1980, Hobbs, NM 88240

State of New Mexico  
Energy, Minerals and Natural Resources Department

Form C-102  
Revised February 10, 1994  
Instruction on back  
Submit to Appropriate District Office  
State Lease - 4 Copies  
Fee Lease - 3 Copies

DISTRICT II  
P.O. Drawer DD, Artesia, NM 88210

OIL CONSERVATION DIVISION

DISTRICT III  
600 Rio Brazos Rd., Aztec, NM 87410

P.O. Box 2088  
Santa Fe, New Mexico 87504-2088

☐ AMENDED REPORT

WELL LOCATION AND ACREAGE DEDICATION PLAT

API Number 30-025-34908	Pool Code	Pool Name Wildcat Atoka
Property Code 25300	Property Name BIG BEAR "ATN"	Well Number 1
OGED No. 025575	Operator Name YATES PETROLEUM CORPORATION	Elevation 4001

Surface Location

UL or lot No. 1	Section 29	Township 15S	Range 35E	Lot Idn	Feet from the 1980	North/South line SOUTH	Feet from the 1120	East/West line EAST	County LEA
--------------------	---------------	-----------------	--------------	---------	-----------------------	---------------------------	-----------------------	------------------------	---------------

Bottom Hole Location If Different From Surface

UL or lot No.	Section	Township	Range	Lot Idn	Feet from the	North/South line	Feet from the	East/West line	County
---------------	---------	----------	-------	---------	---------------	------------------	---------------	----------------	--------

Dedicated Acres 320	Joint or Infill	Consolidation Code	Order No.
------------------------	-----------------	--------------------	-----------

NO ALLOWABLE WILL BE ASSIGNED TO THIS COMPLETION UNTIL ALL INTERESTS HAVE BEEN CONSOLIDATED  
OR A NON-STANDARD UNIT HAS BEEN APPROVED BY THE DIVISION

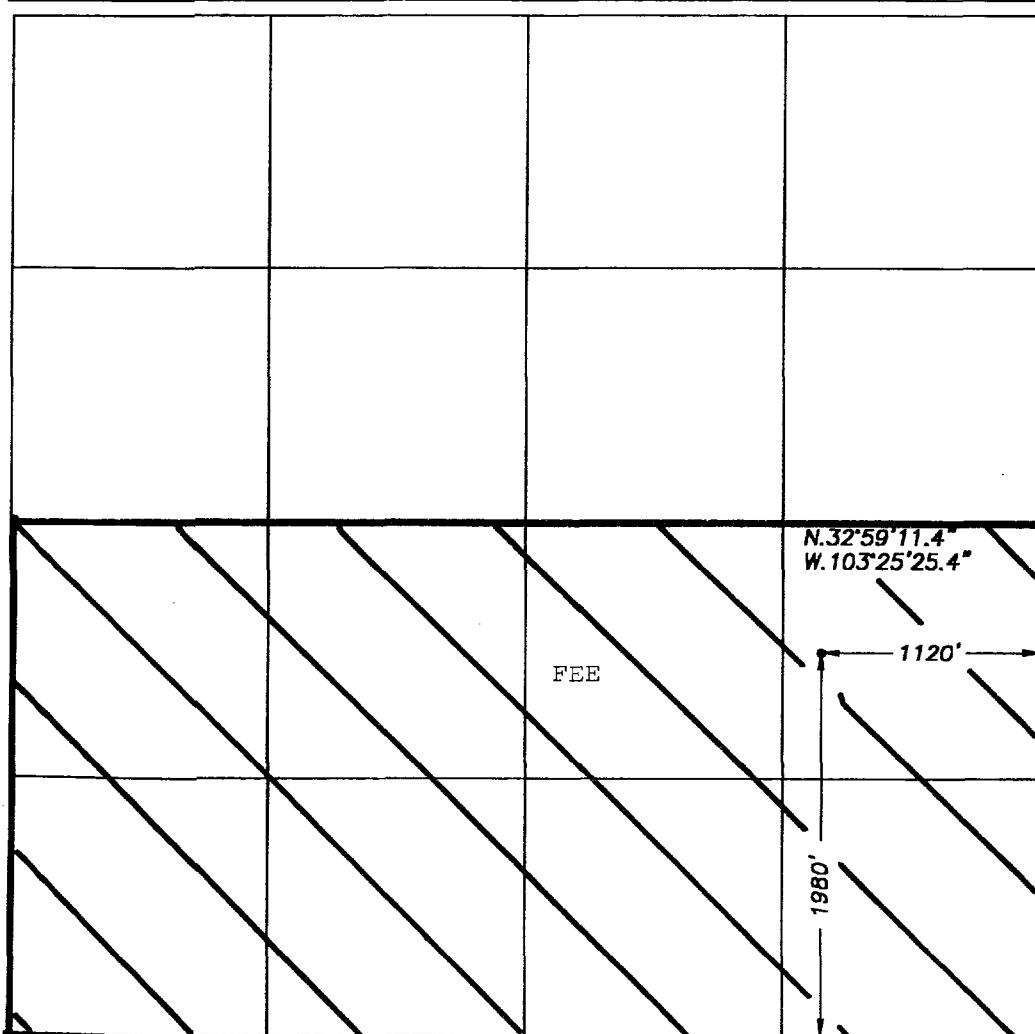

OPERATOR CERTIFICATION

I hereby certify that the information  
contained herein is true and complete to the  
best of my knowledge and belief.

*Clifton R. May*  
Signature

Clifton R. May

Printed Name

Regulatory Agent

Title

June 8, 2001

Date

SURVEYOR CERTIFICATION

I hereby certify that the well location shown  
on this plat was plotted from field notes of  
actual surveys made by me or under my  
supervision, and that the same is true and  
correct to the best of my belief.

12/28/1999

Date Surveyed

*Michael L. Jones*  
Signature & Seal of  
Professional Surveyor

NEW MEXICO  
3640  
REGISTERED PROFESSIONAL SURVEYOR

Certificate No. *Michael L. Jones* RLS 3640

BIG BEAR  
DISK 20  
GENERAL SURVEYING COMPANY

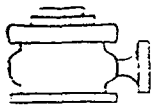

# Yates Petroleum Corporation

BOP-4

## Typical 5,000 psi Pressure System Schematic Annular with Double Ram Preventer Stack

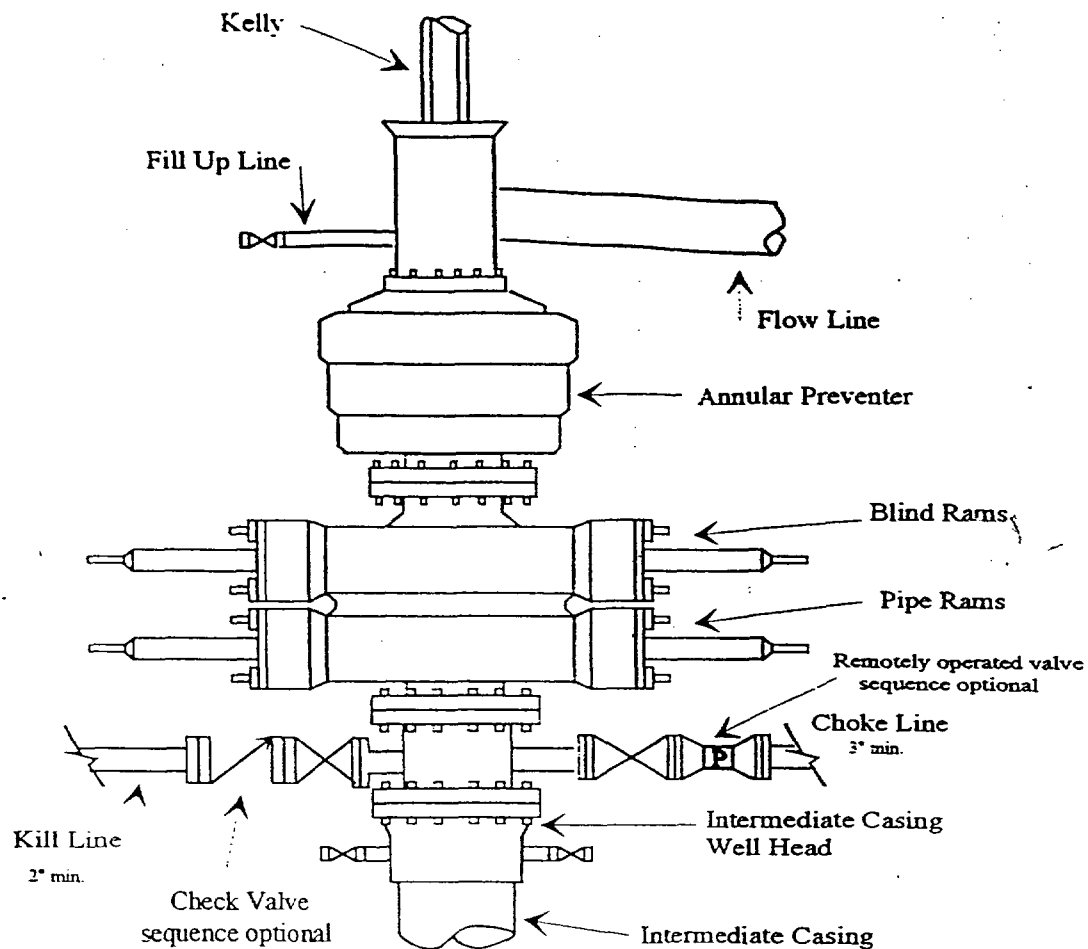

Typical 5,000 psi choke manifold assembly with at least these minimum features

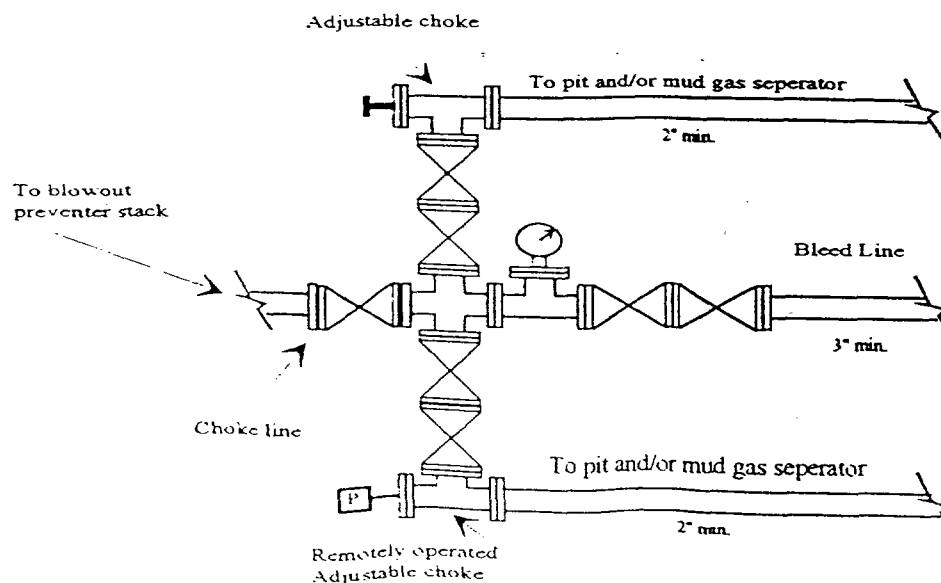

DISTRICT I  
P.O. Box 1980, Hobbs, NM 88240

DISTRICT II  
P.O. Drawer DD, Artesia, NM 88210

DISTRICT III  
1000 Rio Brazos Rd., Aztec, NM 87410

OIL CONSERVATION DIVISION  
P.O. Box 2088  
Santa Fe, New Mexico 87504-2088

WELL API NO. 30-025-34908
5. Indicate Type of Lease STATE <input type="checkbox"/> FEE <input checked="" type="checkbox"/>
6. State Oil & Gas Lease No.
7. Lease Name or Unit Agreement Name Big Bear ATN
8. Well No. 1
9. Pool name or Wildcat Wildcat Mississippian
10. Elevation (Show whether DF, RKB, RT, GR, etc.) 4001' GR

SUNDRY NOTICES AND REPORTS ON WELLS

(DO NOT USE THIS FORM FOR PROPOSALS TO DRILL OR TO DEEPEN OR PLUG BACK TO A DIFFERENT RESERVOIR. USE "APPLICATION FOR PERMIT" (FORM C-101) FOR SUCH PROPOSALS.)

1. Type of Well: OIL WELL <input type="checkbox"/> GAS WELL <input checked="" type="checkbox"/> OTHER	2. Name of Operator YATES PETROLEUM CORPORATION
3. Address of Operator 105 South 4th St., Artesia, NM 88210	4. Well Location Unit Letter J : 1980 Feet From The South Line and 1120 Feet From The East Line Section 29 Township 15S Range 35E NMPM Lea County
10. Elevation (Show whether DF, RKB, RT, GR, etc.) 4001' GR	

11. Check Appropriate Box to Indicate Nature of Notice, Report, or Other Data	
NOTICE OF INTENTION TO:	SUBSEQUENT REPORT OF:
PERFORM REMEDIAL WORK <input type="checkbox"/>	REMEDIAL WORK <input type="checkbox"/>
TEMPORARILY ABANDON <input type="checkbox"/>	ALTERING CASING <input type="checkbox"/>
PULL OR ALTER CASING <input type="checkbox"/>	COMMENCE DRILLING OPNS. <input type="checkbox"/>
OTHER: <input type="checkbox"/>	PLUG AND ABANDONMENT <input type="checkbox"/>
	CASING TEST AND CEMENT JOB <input type="checkbox"/>
	OTHER: Resume drilling, surface casing & cement <input checked="" type="checkbox"/>

12. Describe Proposed or Completed Operations (Clearly state all pertinent details, and give pertinent dates, including estimated date of starting any proposed work) SEE RULE 1103.

Resumed drilling a 17-1/2" hole with rotary tools at 5:00 AM 2-24-2000.

TD 402'. Reached TD at 9:15 AM 2-24-2000. Ran 9 joints of 13-3/8" 48# H-40 (406.33') of casing set at 402'. 1-Texas Pattern notched guide shoe set at 402'. Insert float set at 360'. Cemented with 500 sacks Class C and 2% CaCl2 (yield 1.34, weight 14.8). PD 3:15 PM 2-24-2000. Bumped plug to 400 psi, OK. Circulated 21 sacks. WOC. Cut off and welded on flow nipple. Drilled out at 12:15 PM 2-25-2000. WOC 21 hours. Reduced hole to 12-1/4". Resumed drilling.

I hereby certify that the information above is true and complete to the best of my knowledge and belief.

SIGNATURE Rusty Klein TITLE Operations Technician DATE March 17, 2000

TYPE OR PRINT NAME Rusty Klein TELEPHONE NO. 505/748-1471

(This space for State Use)

APPROVED BY Chris Williams TITLE DISTRICT SUPERVISOR DATE MAR 2

CONDITIONS OF APPROVAL, IF ANY:

Submit 3 Copies  
to Appropriate  
District Office

State of New Mexico  
Energy, Minerals and Natural Resources Department

Form C-103  
Revised 1-1-89

DISTRICT I  
P.O. Box 1980, Hobbs, NM 88240

DISTRICT II  
P.O. Drawer DD, Artesia, NM 88210

DISTRICT III  
1000 Rio Brazos Rd., Aztec, NM 87410

OIL CONSERVATION DIVISION  
P.O. Box 2088  
Santa Fe, New Mexico 87504-2088

WELL API NO. 30-025-34908
5. Indicate Type of Lease STATE <input type="checkbox"/> FEE <input checked="" type="checkbox"/>
6. State Oil & Gas Lease No.
7. Lease Name or Unit Agreement Name Big Bear ATN
8. Well No. 1
9. Pool name or Wildcat Wildcat Mississippian

SUNDRY NOTICES AND REPORTS ON WELLS

(DO NOT USE THIS FORM FOR PROPOSALS TO DRILL OR TO DEEPEN OR PLUG BACK TO A DIFFERENT RESERVOIR. USE "APPLICATION FOR PERMIT" (FORM C-101) FOR SUCH PROPOSALS.)

1. Type of Well: OIL WELL <input type="checkbox"/> GAS WELL <input checked="" type="checkbox"/> OTHER	2. Name of Operator YATES PETROLEUM CORPORATION
3. Address of Operator 105 South 4th St., Artesia, NM 88210	4. Well Location Unit Letter J : 1980 Feet From The South Line and 1120 Feet From The East Line Section 29 Township 15S Range 35E NMPM Lea County
10. Elevation (Show whether DF, RKB, RT, GR, etc.) 4001' GR	

11. Check Appropriate Box to Indicate Nature of Notice, Report, or Other Data	
NOTICE OF INTENTION TO:	SUBSEQUENT REPORT OF:
PERFORM REMEDIAL WORK <input type="checkbox"/>	REMEDIAL WORK <input type="checkbox"/>
TEMPORARILY ABANDON <input type="checkbox"/>	ALTERING CASING <input type="checkbox"/>
PULL OR ALTER CASING <input type="checkbox"/>	COMMENCE DRILLING OPNS. <input type="checkbox"/>
OTHER: <input type="checkbox"/>	PLUG AND ABANDONMENT <input type="checkbox"/>
	CASING TEST AND CEMENT JOB <input type="checkbox"/>
	OTHER: Intermediate casing & cement <input checked="" type="checkbox"/>

12. Describe Proposed or Completed Operations (Clearly state all pertinent details, and give pertinent dates, including estimated date of starting any proposed work) SEE RULE 1103.

TD 4695'. Reached TD at 2:00 PM 3-5-2000. Ran 105 joints of 9-5/8" 36# & 40# J-55 (4699.81') of casing set at 4695'. 1-Texas Pattern notched guide shoe set at 4695'. Float collar set at 4651'. Cemented with 1400 sacks of Interfill C, 1/4#/sack flocele and 5#/sack gilsonite (yield 2.48, weight 11.9). Tailed in with 200 sacks of Premium Plus C and 2% CaCl2 (yield 1.34, weight 14.8). PD 7:30 AM 3-6-2000. Bumped plug to 1400 psi, OK. Circulated 194 sacks. WOC. Nipped up and tested to 1000 psi for 15 minutes. Drilled out at 6:00 PM 3-7-2000. WOC 34-1/2 hours. Reduced hole to 8-3/4". Resumed drilling.

I hereby certify that the information above is true and complete to the best of my knowledge and belief.

SIGNATURE Rusty Klein TITLE Operations Technician DATE March 17, 2000

TYPE OR PRINT NAME Rusty Klein TELEPHONE NO. 505/748-1471

(This space for State Use)

APPROVED BY Chris Williams TITLE Supervisor DATE MAR 24 2000

CONDITIONS OF APPROVAL, IF ANY:

DISTRICT 1 SUPERVISOR

DISTRICT I  
P.O. Box 1980, Hobbs, NM 88240

DISTRICT II  
P.O. Drawer DD, Artesia, NM 88210

DISTRICT III  
1000 Rio Brazos Rd., Aztec, NM 87410

OIL CONSERVATION DIVISION  
P.O. Box 2088  
Santa Fe, New Mexico 87504-2088

WELL API NO. 30-025-34908
5. Indicate Type of Lease STATE <input type="checkbox"/> FEE <input checked="" type="checkbox"/>
6. State Oil & Gas Lease No.

SUNDRY NOTICES AND REPORTS ON WELLS (DO NOT USE THIS FORM FOR PROPOSALS TO DRILL OR TO DEEPEN OR PLUG BACK TO A DIFFERENT RESERVOIR. USE "APPLICATION FOR PERMIT" (FORM C-101) FOR SUCH PROPOSALS.)		7. Lease Name or Unit Agreement Name  Big Bear ATN	
1. Type of Well: OIL WELL <input type="checkbox"/> GAS WELL <input checked="" type="checkbox"/> OTHER			
2. Name of Operator YATES PETROLEUM CORPORATION		8. Well No. 1	
3. Address of Operator 105 South 4th St., Artesia, NM 88210		9. Pool name or Wildcat Wildcat Mississippian	
4. Well Location Unit Letter <u>SI</u> : 1980 Feet From The South Line and 1120 Feet From The East Line Section 29 Township 15S Range 35E NMPM Lea County			
10. Elevation (Show whether DF, RKB, RT, GR, etc.) 4001' GR			

11. Check Appropriate Box to Indicate Nature of Notice, Report, or Other Data			
NOTICE OF INTENTION TO:		SUBSEQUENT REPORT OF:	
PERFORM REMEDIAL WORK <input type="checkbox"/>	PLUG AND ABANDON <input type="checkbox"/>	REMEDIAL WORK <input type="checkbox"/>	ALTERING CASING <input type="checkbox"/>
TEMPORARILY ABANDON <input type="checkbox"/>	CHANGE PLANS <input type="checkbox"/>	COMMENCE DRILLING OPNS. <input type="checkbox"/>	PLUG AND ABANDONMENT <input type="checkbox"/>
PULL OR ALTER CASING <input type="checkbox"/>		CASING TEST AND CEMENT JOB <input type="checkbox"/>	
OTHER: <input type="checkbox"/>		OTHER: Spud & conductor <input checked="" type="checkbox"/>	

12. Describe Proposed or Completed Operations (Clearly state all pertinent details, and give pertinent dates, including estimated date of starting any proposed work) SEE RULE 1103.

Spudded a 26" hole with rathole machine at 2:00 PM 2-16-2000. Set 40' of 20" conductor pipe. Cemented to surface. NOTE: Notified Sylvia w/OCD-Hobbs of spud.

TD 40'. Moving in and rigging up rotary tools.

I hereby certify that the information above is true and complete to the best of my knowledge and belief.

SIGNATURE Rusty Klein TITLE Operations Technician DATE Feb. 24, 2000

TYPE OR PRINT NAME Rusty Klein TELEPHONE NO. 505/748-1471

(This space for State Use)

APPROVED BY Gary W. Wink TITLE FIELD REPRESENTATIVE II DATE MAR 14 2000

CONDITIONS OF APPROVAL, IF ANY:

District I  
1625 N. French Dr., Hobbs, NM 88240  
District II  
811 South First, Artesia, NM 88210  
District III  
1000 Rio Brazos Road, Aztec, NM 87410  
District IV  
2040 South Pacheco, Santa Fe, NM 87505

State of New Mexico  
Energy Minerals and Natural Resources

Oil Conservation Division  
2040 South Pacheco  
Santa Fe, NM 87505

Form C-101  
Revised March 17, 1999

Submit to appropriate District Office  
State Lease - 6 Copies  
Fee Lease - 5 Copies

☐ AMENDED REPORT

APPLICATION FOR PERMIT TO DRILL, RE-ENTER, DEEPEN, PLUGBACK, OR ADD A ZONE

<sup>1</sup> Operator Name and Address Yates Petroleum Corporation 105 South Fourth Street Artesia, New Mexico 88210		<sup>2</sup> OGRID Number 025575
		<sup>3</sup> APINumber 30-025-34908
<sup>4</sup> Property Code 25300	<sup>5</sup> Property Name Big Bear "ATN"	<sup>6</sup> Well No. 1

<sup>7</sup>Surface Location

UL or lot no.	Section	Township	Range	Lot Idn	Feet from the	North/South line	Feet from the	East/West line	County
1/5	29	15-S	35-E		1980'	South	1120'	East	Lea

<sup>8</sup>Proposed Bottom Hole Location If Different From Surface

UL or lot no.	Section	Township	Range	Lot Idn	Feet from the	North/South line	Feet from the	East/West line	County

<sup>9</sup>Proposed Pool 1

Wildcat Mississippian

<sup>10</sup>Proposed Pool 2

<sup>11</sup> Work Type Code N	<sup>12</sup> Well Type Code G	<sup>13</sup> Cable/Rotary Rotary	<sup>14</sup> Lease Type Code P	<sup>15</sup> Ground Level Elevation 4001'
<sup>16</sup> Multiple No	<sup>17</sup> Proposed Depth 13,150'	<sup>18</sup> Formation Mississippian	<sup>19</sup> Contractor Not determined	<sup>20</sup> Spud Date ASAP

<sup>21</sup>Proposed Casing and Cement Program

Hole Size	Casing Size	Casing weight/foot	Setting Depth	Sacks of Cement	Estimated TOC
17 1/2"	13 3/8"	48 #	400'	400 sx	circulated
12 1/4"	9 5/8"	36 & 40 #	4650'	1400 sx	circulated
8 3/4"	7"	26 #	13,150'	700 sx	TOC - 9500'

<sup>22</sup> Describe the proposed program. If this application is to DEEPEN or PLUG BACK, give the data on the present productive zone and proposed new productive zone.

Describe the blowout prevention program, if any. Use additional sheets if necessary.

Yates Petroleum Corporation proposes to drill and test the Mississippian and intermediate formations. Approximately 400' of surface casing will be set and cement circulated. If commercial, production casing will be run and cemented back to approximately 9500', perforated and stimulated as needed for production.

**MUD PROGRAM:** 0-400' FW/gel/paper; 400-4650' FW going to brine; 4650-11600' cut brine w/sweeps; 11600'-13150' salt gel/starch/driscap.

**BOPE PROGRAM:** 5000# BOPE will be installed on the 9 5/8" casing and tested daily.

<sup>23</sup> I hereby certify that the information given above is true and complete to the best of my knowledge and belief.

Signature: 

Printed name: Ken Beardemph1

Title: Landman

Date:  
January 31, 2000

Phone:  
(505) 748-1471

OIL CONSERVATION DIVISION

Approved by:



Title: DISTRICT 1 SUPERVISOR

Approval Date: FEB 03 2000 Expiration Date:

Conditions of Approval:

Attached ☐

Permit Expires 1 Year From Approval  
Date Unless Drilling Underway

DISTRICT II  
P.O. Drawer DD, Artesia, NM 86210

**DISTRICT III**  
**000 Rio Bronson Rd., Artec, NM 87410**

## OIL CONSERVATION DIVISION

**P.O. Box 2088**  
**Santa Fe, New Mexico 87504-2088**

☐ AMENDED REPORT

## WELL LOCATION AND ACREAGE DEDICATION PLAT

API Number 30-025-34908	Pool Code ✓	Pool Name Wildcat Mississippian
Property Code 25300	Property Name BIG BEAR "ATN"	Well Number 1
OGED No. 025575	Operator Name YATES PETROLEUM CORPORATION	Elevation 4001

### Surface Location

UL or lot No.	Section	Township	Range	Lot Idn	Feet from the	North/South line	Feet from the	East/West line	County
1 J	29	15S	35E		1980	SOUTH	1120	EAST	LEA

## Bottom Hole Location If Different From Surface

UL or lot No.	Section	Township	Range	Lot Idn	Feet from the	North/South line	Feet from the	East/West line	County
---------------	---------	----------	-------	---------	---------------	------------------	---------------	----------------	--------

Dedicated Acres	Joint or Infill	Consolidation Code	Order No.
320			

**NO ALLOWABLE WILL BE ASSIGNED TO THIS COMPLETION UNTIL ALL INTERESTS HAVE BEEN CONSOLIDATED  
OR A NON-STANDARD UNIT HAS BEEN APPROVED BY THE DIVISION**

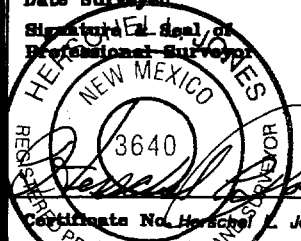
				<p><b>OPERATOR CERTIFICATION</b></p> <p><i>I hereby certify the the information contained herein is true and complete to the best of my knowledge and belief.</i></p> <p>Signature <u>Ken Beardemphl</u></p> <p>Printed Name <u>Ken Beardemphl</u></p> <p>Title <u>Landman</u></p> <p>Date <u>January 31, 2000</u></p>
				<p><b>SURVEYOR CERTIFICATION</b></p> <p><i>I hereby certify that the well location shown on this plat was plotted from field notes of actual surveys made by me or under my supervision, and that the same is true and correct to the best of my belief.</i></p> <p>Date Surveyed <u>12/28/1999</u></p> <p>Signature <u>Herschel L. Jones</u></p> <p>Professional Surveyor</p> <p>  </p> <p>Certificate No. <u>Herschel L. Jones RLS 3640</u></p> <p><b>BIG BEAR LAND SURVEYING COMPANY</b></p>

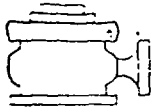

# Yates Petroleum Corporation

BOP-4

## Typical 5,000 psi Pressure System Schematic Annular with Double Ram Preventer Stack

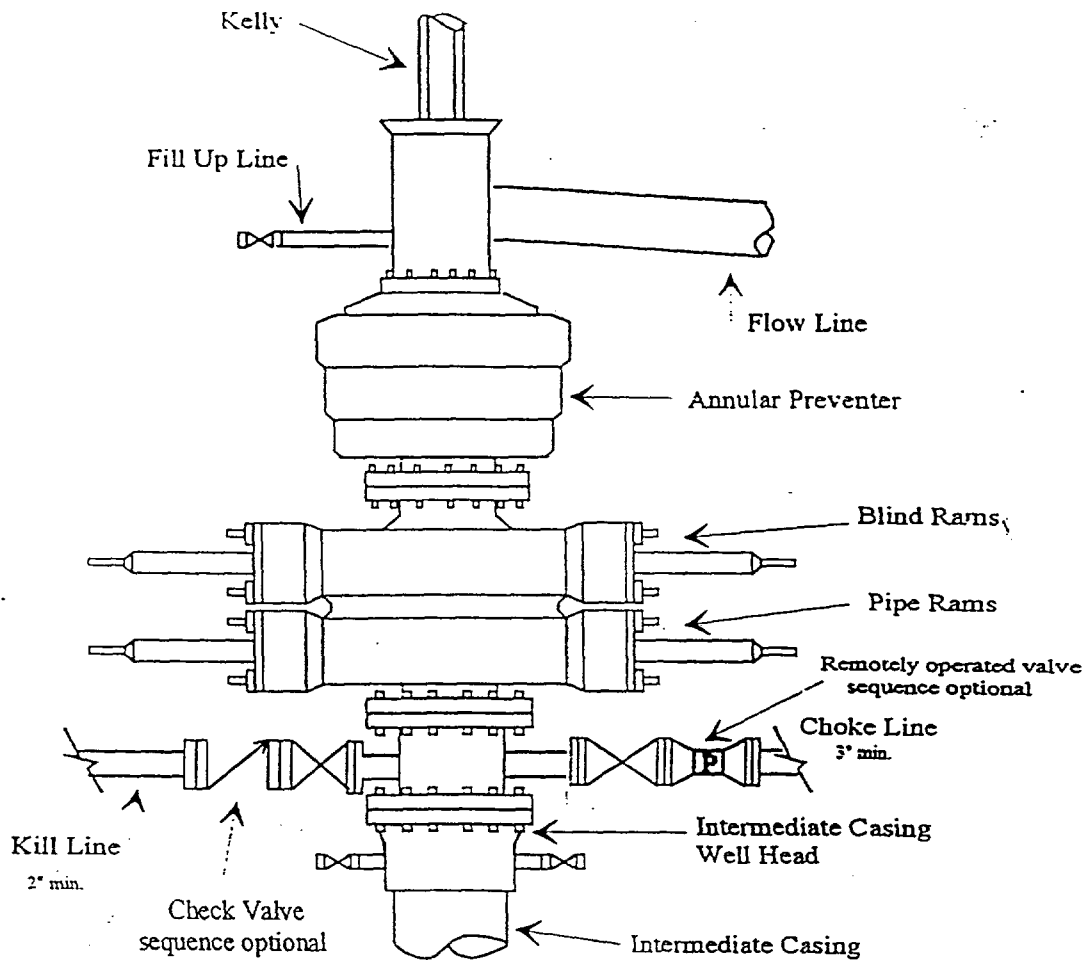

Typical 5,000 psi choke manifold assembly with at least these minimum features

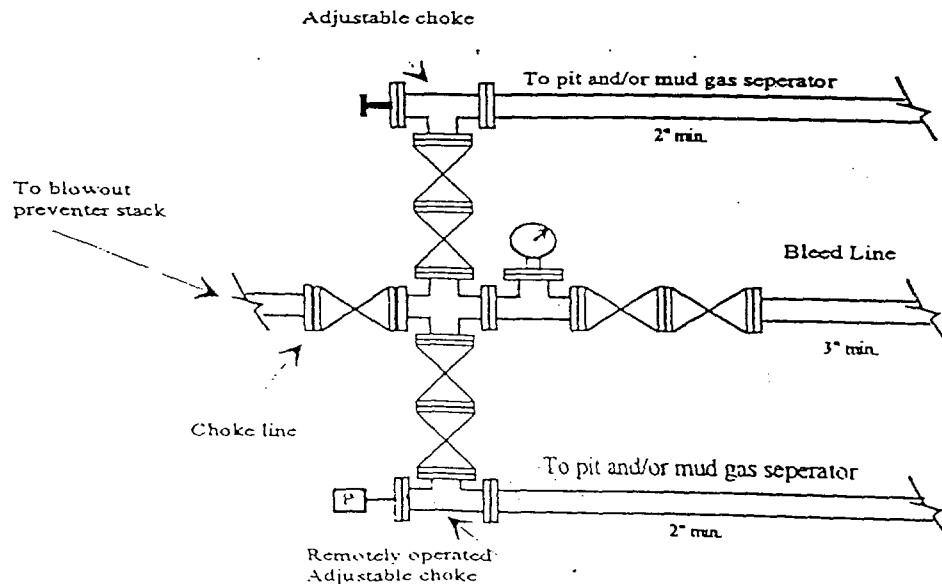



COUNTY LeaPOOL Townsend - Permo Upper PennsylvanianTOWNSHIP 15 SouthRANGE 34 East

NMFM

6	5	4	3	2	1
7	8	9	10	11	12
18	17	16	15	14	13
19	20	21	22	23	24
30	29	28	27	26	25
31	32	33	34	35	36

Description:  $\frac{S}{2} \frac{S}{2}$  Sec. 36 (R-787, 4-16-56)

Ext:  $\frac{N}{2} \frac{N}{2} \frac{S}{2}$  Sec. 36 (R-812, 6-8-56)

Ext: Sec. 35, SE 1/4 (R-7193, 1-28-83)

Extend vertical limits to include Upper Pennsylvanian formation  
and redesignate as Townsend - Permo Upper Pennsylvanian (R-7222, 2-25-83)

EXT:  $\frac{E}{2}$  SEC. 25 (R-8584, 11/1/88)

COUNTY LeaPOOL Townsend - Permo Upper PennsylvanianTOWNSHIP 15 SouthRANGE 35 East

NMPM

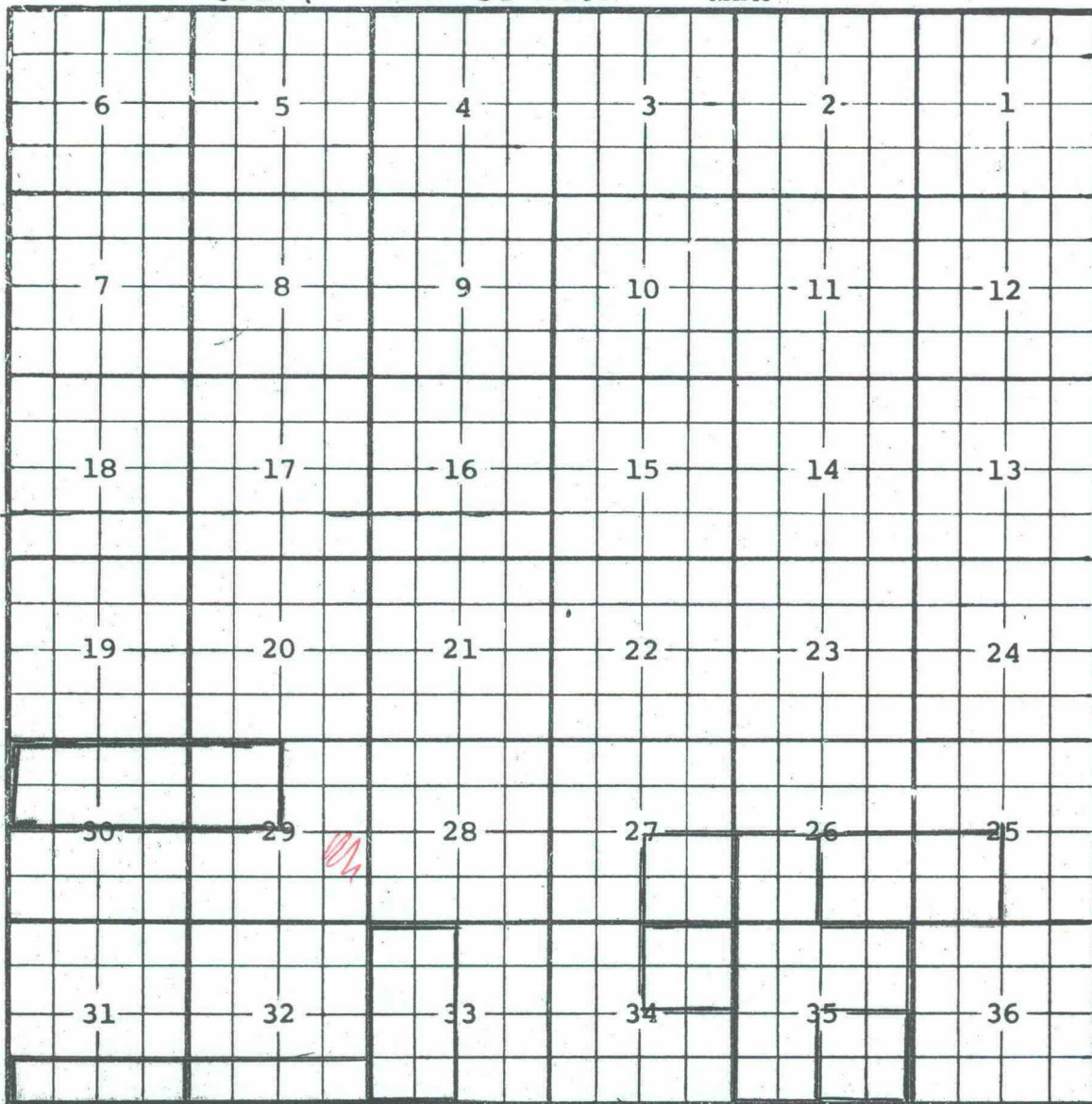

Ext:  $\frac{W}{2}$  Sec. 33 (R-745, 1-20-56) -  $\frac{S}{2}$   $\frac{S}{2}$  Sec. 31 (R-812, 6-8-56)

-  $\frac{S}{2}$   $\frac{S}{2}$  Sec. 32 (R-877, 4-13-56) Ext:  $\frac{NE}{4}$  Sec. 34 (R-5102, 10-1-75)

Ext:  $\frac{SE}{4}$  Sec. 27 (R-5626, 2-1-78) Ext: SW  $\frac{1}{4}$  Sec. 25, SE  $\frac{1}{4}$  Sec. 26 (R-6005, 6-1-79)

Extend vertical limits to include Upper Pennsylvanian formation

and redesignate as Townsend-Permo Upper Pennsylvanian Pool (R-7222, 2-25-83)

Ext:  $\frac{SE}{4}$  Sec. 35 (R-7214, 11-7-84) Ext:  $\frac{NW}{4}$  Sec. 29,  $\frac{N}{2}$  Sec. 30 (R-11116, 1-7-99)

COUNTY Lea

POOL

Townsend-Permo Upper Pennsylvanian

TOWNSHIP

16 South

RANGE

34 East

NMPM

6	5	4	3	2	1
7	8	9	10	11	12
18	17	16	15	14	13
19	20	21	22	23	24
30	29	28	27	26	25
31	32	33	34	35	36

Ext: Sec. 12 S/2 (Q-7222-2325-83)

COUNTY LeaPOOL Townsend - Permian Upper PennsylvanianTOWNSHIP 16 SouthRANGE 35 East

NMPM

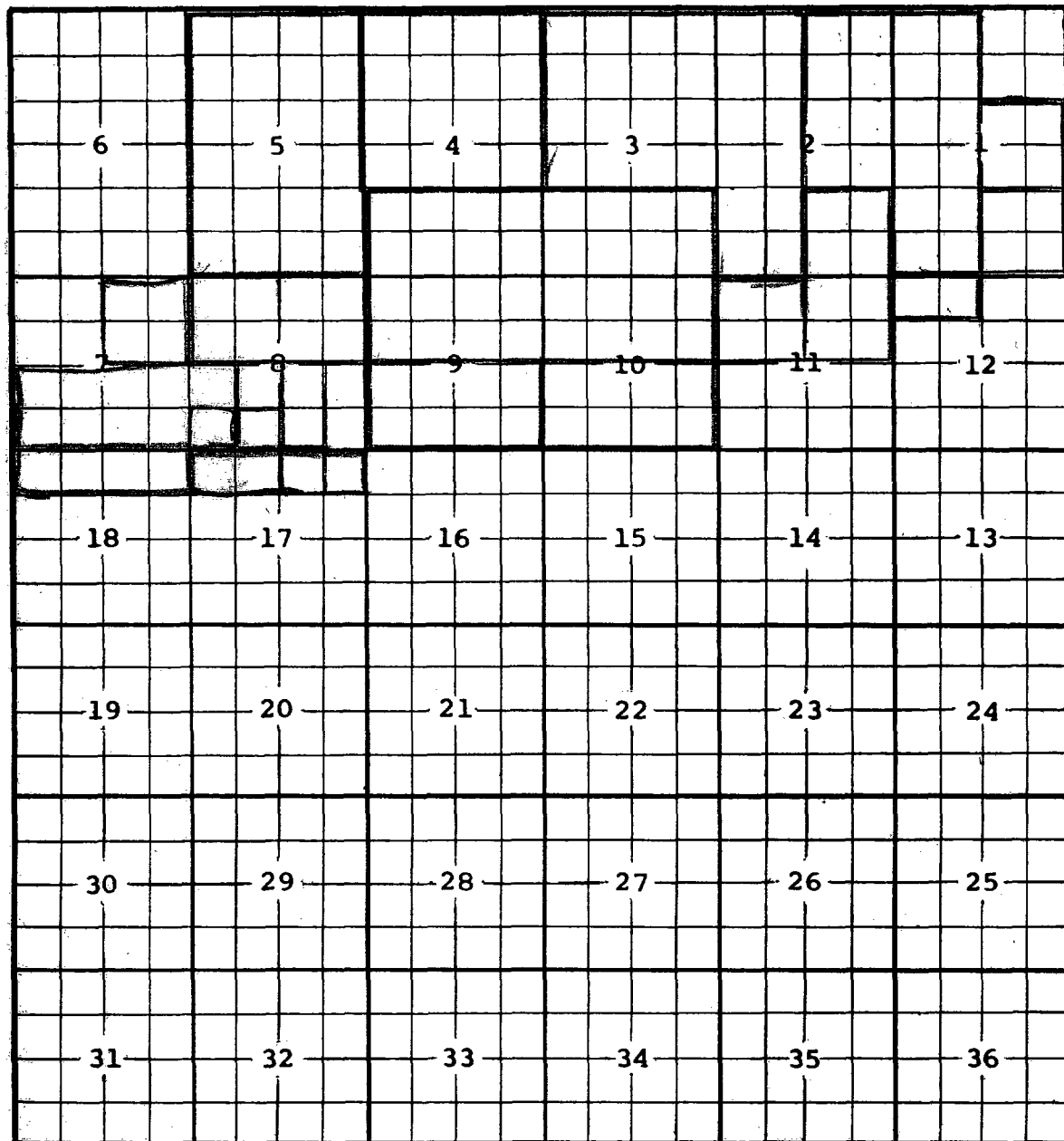

Description:  $\frac{S}{2}$  Sec. 3;  $\frac{S}{2}$  Sec. 4;  $\frac{N}{2}$  Sec. 9;  $\frac{N}{2}$  Sec. 10 (R-170, 7-16-52)  
Ext: All Sec. 5 (R-512, 7-21-54) -  $\frac{N}{2}$  Sec. 8 (R-526, 10-4-54) -  $\frac{S}{2}$  Sec. 9;  $\frac{NW}{4}$  Sec. 11 (R-561, 12-16-54)  
-  $\frac{S}{2}$  Sec. 10 (R-584, 2-16-55) -  $\frac{W}{2}$  Sec. 2; Lots 1 thru 16 Sec. 3 (R-623, 4-20-55)  
-  $\frac{SE}{4}$  Sec. 2;  $\frac{NE}{4}$  Sec. 11 (R-667, 7-25-55) -  $\frac{E}{2}$   $\frac{SE}{4}$  Sec. 8;  $\frac{NE}{4}$   $\frac{NE}{4}$  Sec. 17 (R-713, 11-10-55)  
-  $\frac{W}{2}$  Sec. 1;  $\frac{SE}{4}$   $\frac{SE}{4}$   $\frac{SW}{4}$   $\frac{SW}{4}$  Sec. 2 (R-745, 1-20-56) - Lots 1 thru 16 Sec. 4;  $\frac{W}{2}$   $\frac{SE}{4}$  Sec. 8 (R-787, 4-16-56)  
-  $\frac{SE}{4}$  Sec. 1;  $\frac{SE}{4}$   $\frac{SW}{4}$   $\frac{SW}{4}$   $\frac{SW}{4}$  Sec. 8;  $\frac{N}{2}$   $\frac{NW}{4}$   $\frac{NW}{4}$   $\frac{NE}{4}$   $\frac{NE}{4}$  Sec. 17 (R-877, 9-13-56) - Lots 9, 10, 15, 16 Sec. 1;  
-  $\frac{NE}{4}$   $\frac{SW}{4}$   $\frac{SW}{4}$   $\frac{SW}{4}$  Sec. 8 (R-928, 12-13-56) Sec. 7  $\frac{NE}{4}$   $\frac{SE}{4}$   $\frac{SE}{4}$   $\frac{SE}{4}$  Sec. 8 W  $\frac{1}{2}$  SW  $\frac{1}{4}$  Sec. 17 N  $\frac{1}{2}$  NW  $\frac{1}{4}$ ;  
Sec. 18 N  $\frac{1}{2}$  N  $\frac{1}{2}$  and extend vertical limits to include Upper Pennsylvanian  
formation and redesignate as Townsend - Permian Upper Pennsylvanian  
Pool (R-7222, 2-25-83)

COUNTY LeaPOOL Townsend - Permo Upper PennsylvanianTOWNSHIP 16 SouthRANGE 36 East

NMPM

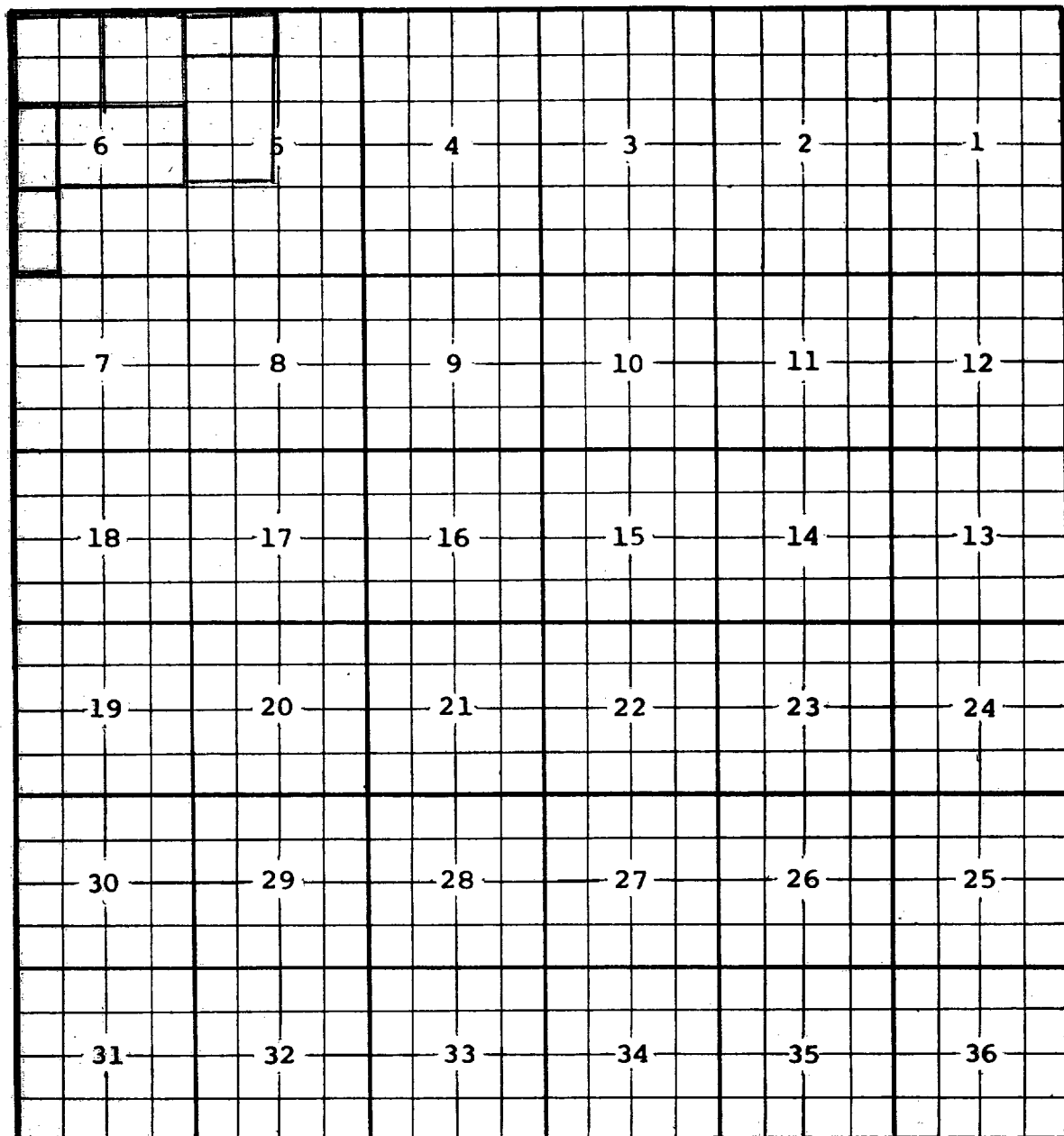

Ext:  $\frac{W}{2} \frac{SW}{4}$  Sec. 6 (R-1023, 7-30-57) - Lots 12, 13 Sec. 6 (R-1089, 11-27-57)  
- Lots 9, 10, 11, 14, 15 & 16 Sec. 6 (R-1143, 3-25-58) - Lots 1, 2, 7, & 8 Sec. 6 (R-1179, 5-26-58)  
- Lots 3 & 4 Sec. 5; Lots 3, 4, 5, & 6 Sec. 6 (R-1248, 10-1-58)

Extend vertical limits to include Upper Pennsylvanian Formation  
and redesignate as Townsend-Permo Upper Pennsylvanian Pool (R-7222, 2-25-83)

Ext: Lots 5, 6, 11, 12, 13, and 14 Sec 5 (R-7917, 5-13-85)