

DATE <u>10/30/02</u>	SUBJECT <u>11/19/02</u>	ENGINEER	LOGGED IN <u>KV</u>	TYPE <u>NSL</u>	APP NO. <u>230453601</u>
----------------------	-------------------------	----------	---------------------	-----------------	--------------------------

ABOVE THIS LINE FOR DIVISION USE ONLY

NEW MEXICO OIL CONSERVATION DIVISION

- Engineering Bureau -

1220 South St. Francis Drive, Santa Fe, NM 87505



4808

ADMINISTRATIVE APPLICATION CHECKLIST

THIS CHECKLIST IS MANDATORY FOR ALL ADMINISTRATIVE APPLICATIONS FOR EXCEPTIONS TO DIVISION RULES AND REGULATIONS WHICH REQUIRE PROCESSING AT THE DIVISION LEVEL IN SANTA FE

Application Acronyms:

[NSL-Non-Standard Location] [NSP-Non-Standard Proration Unit] [SD-Simultaneous Dedication]
 [DHC-Downhole Commingling] [CTB-Lease Commingling] [PLC-Pool/Lease Commingling]
 [PC-Pool Commingling] [OLS - Off-Lease Storage] [OLM-Off-Lease Measurement]
 [WFX-Waterflood Expansion] [PMX-Pressure Maintenance Expansion]
 [SWD-Salt Water Disposal] [IPI-Injection Pressure Increase]
 [EOR-Qualified Enhanced Oil Recovery Certification] [PPR-Positive Production Response]

- [1] **TYPE OF APPLICATION** - Check Those Which Apply for [A]
 [A] Location - Spacing Unit - Simultaneous Dedication
☒ NSL ☐ NSP ☐ SD
- Check One Only for [B] or [C]
 [B] Commingling - Storage - Measurement
☐ DHC ☐ CTB ☐ PLC ☐ PC ☐ OLS ☐ OLM
- [C] Injection - Disposal - Pressure Increase - Enhanced Oil Recovery
☐ WFX ☐ PMX ☐ SWD ☐ IPI ☐ EOR ☐ PPR
- [D] Other: Specify _____
- [2] **NOTIFICATION REQUIRED TO:** - Check Those Which Apply, or Does Not Apply
 [A] ☐ Working, Royalty or Overriding Royalty Interest Owners
 [B] ☒ Offset Operators, Leaseholders or Surface Owner
 [C] ☐ Application is One Which Requires Published Legal Notice
 [D] ☐ Notification and/or Concurrent Approval by BLM or SLO
U.S. Bureau of Land Management - Commissioner of Public Lands, State Land Office
 [E] ☐ For all of the above, Proof of Notification or Publication is Attached, and/or,
 [F] ☐ Waivers are Attached

- [3] **SUBMIT ACCURATE AND COMPLETE INFORMATION REQUIRED TO PROCESS THE TYPE OF APPLICATION INDICATED ABOVE.**

[4] **CERTIFICATION:** I hereby certify that the information submitted with this application for administrative approval is accurate and complete to the best of my knowledge. I also understand that no action will be taken on this application until the required information and notifications are submitted to the Division.

Note: Statement must be completed by an individual with managerial and/or supervisory capacity.

Cy Cowan
 Print or Type Name

Cy Cowan
 Signature

Regulatory Agent
 Title

10/30/02
 Date

 e-mail Address

DATE IN	SUSPENSE	ENGINEER	LOGGED IN	TYPE	APP NO.
---------	----------	----------	-----------	------	---------

ABOVE THIS LINE FOR DIVISION USE ONLY

NEW MEXICO OIL CONSERVATION DIVISION

- Engineering Bureau -

1220 South St. Francis Drive, Santa Fe, NM 87505



ADMINISTRATIVE APPLICATION CHECKLIST

THIS CHECKLIST IS MANDATORY FOR ALL ADMINISTRATIVE APPLICATIONS FOR EXCEPTIONS TO DIVISION RULES AND REGULATIONS WHICH REQUIRE PROCESSING AT THE DIVISION LEVEL IN SANTA FE

Application Acronyms:

[NSL-Non-Standard Location] [NSP-Non-Standard Proration Unit] [SD-Simultaneous Dedication]
 [DHC-Downhole Commingling] [CTB-Lease Commingling] [PLC-Pool/Lease Commingling]
 [PC-Pool Commingling] [OLS - Off-Lease Storage] [OLM-Off-Lease Measurement]
 [WFX-Waterflood Expansion] [PMX-Pressure Maintenance Expansion]
 [SWD-Salt Water Disposal] [IPI-Injection Pressure Increase]
 [EOR-Qualified Enhanced Oil Recovery Certification] [PPR-Positive Production Response]

[1] TYPE OF APPLICATION - Check Those Which Apply for [A]

[A] Location - Spacing Unit - Simultaneous Dedication

☒ NSL ☐ NSP ☐ SD

Check One Only for [B] or [C]

[B] Commingling - Storage - Measurement

☐ DHC ☐ CTB ☐ PLC ☐ PC ☐ OLS ☐ OLM

[C] Injection - Disposal - Pressure Increase - Enhanced Oil Recovery

☐ WFX ☐ PMX ☐ SWD ☐ IPI ☐ EOR ☐ PPR

[D] Other: Specify _____

[2] NOTIFICATION REQUIRED TO: - Check Those Which Apply, or Does Not Apply

[A] ☐ Working, Royalty or Overriding Royalty Interest Owners

[B] ☒ Offset Operators, Leaseholders or Surface Owner

[C] ☐ Application is One Which Requires Published Legal Notice

[D] ☐ Notification and/or Concurrent Approval by BLM or SLO
 U.S. Bureau of Land Management - Commissioner of Public Lands, State Land Office

[E] ☐ For all of the above, Proof of Notification or Publication is Attached, and/or,

[F] ☐ Waivers are Attached

[3] SUBMIT ACCURATE AND COMPLETE INFORMATION REQUIRED TO PROCESS THE TYPE OF APPLICATION INDICATED ABOVE.

[4] **CERTIFICATION:** I hereby certify that the information submitted with this application for administrative approval is **accurate** and **complete** to the best of my knowledge. I also understand that **no action** will be taken on this application until the required information and notifications are submitted to the Division.

Note: Statement must be completed by an individual with managerial and/or supervisory capacity.

Cy Cowan
 Print or Type Name

Signature

Regulatory Agent
 Title

10/30/02
 Date

 e-mail Address

MARTIN YATES, III
1912 - 1985
FRANK W. YATES
1936 - 1986



105 SOUTH FOURTH STREET
ARTESIA, NEW MEXICO 88210-2118
TELEPHONE (505) 748-1471

S. P. YATES
CHAIRMAN OF THE BOARD
JOHN A. YATES
PRESIDENT
PEYTON YATES
EXECUTIVE VICE PRESIDENT
RANDY G. PATTERSON
SECRETARY
DENNIS G. KINSEY
TREASURER

October 30, 2002

Mr. Michael Stogner
New Mexico Oil Conservation Division
1220 South Saint Francis Drive
Santa Fe, New Mexico 87505

Certified Mail
Return Receipt Request

RE: Application for Unorthodox Location
Tortise ASB Com. #1
1980' FNL and 2250' FEL
Section 29, T23S-R24E
Eddy County, New Mexico

(30-015-10490)

Dear Mr. Stogner:

Yates Petroleum Corporation respectfully requests administrative approval for the captioned well located in the Undesignated Crooked Creek Morrow Pool.

This well was originally drilled by Shell Oil Company as the China Canyon Unit, spudded on February 14, 1965 and was plugged and abandoned on May 6, 1965. Yates Petroleum Corporation is proposing to re-enter and test the Morrow and intermediate formations.

Yates Petroleum Corporation is the offset operator to the west therefore Yates requests administrative approval for this unorthodox location at your earliest convenience. Please be advised our lease is due to expire January 20, 2002. We wish your approval to cover the following formations being the Undesignated Wooten Ranch Atoka, Wildcat Strawn, Wildcat Canyon, and Wildcat Penn.

Enclosed please find our Administrative Application Checklist and supporting information. Should you need anything further please advise.

Thank you,

Very truly yours,

YATES PETROLEUM CORPORATION

Cy Cowan
Regulatory Agent
/cyc

NEW MEXICO OIL CONSERVATION DIVISION

SUBMITTAL GUIDELINES FOR ADMINISTRATIVE APPROVAL OF NON-STANDARD LOCATION APPLICATIONS

- I. If the well is located on Federal or Indian Lands, the Federal Surface Management Agency must be notified and an on-site inspection conducted prior to filing the application. If an Application for Permit to drill or a Notice of Staking has been prepared, a copy must be submitted.
N/A
- II. Completed C-102 showing the well location, proration unit, leases within the unit and other required information.
ATTACHED
- III. Land plat showing offset operators and working interest owners and any offsetting wells producing from the same pool or formation.
 - A. This information may be shown on the topo map if it does not impair the readability of the map. *ATTACHED*
 - B. The operator should certify that the information is current and correct. *THIS INFORMATION IS CORRECT.*
- IV. Original or clear copy of topographic map, preferably 7.5 minute quad, showing contours and other mapped features impacting the location, with the following information marked thereon (In order to be able to adequately show all of the necessary surface conditions it may be necessary to enlarge the relevant portion of the topo map to provide room for detail):
 - A. The proposed well location and proration unit;
ATTACHED A II+II - A+B
 - B. An outline of the orthodox drilling windows as provided in the applicable rules for the subject application;
 - C. The location of any wells to any formation within the area of the proration unit and a statement as to whether an existing pad can be used to drill the proposed well; *EXISTING WELL PAD WILL BE USED FOR RE-ENTRY.*
- V. An enlargement of the topo map showing the subject area with the applicable additional information:
 - A. Terrain features not shown on the map which make an orthodox location unusable; *N/A*
 - B. Proposed access roads and pipelines if they affect the location selection; *N/A*
 - C. The location of any surface uses which prevent use of a legal location;
Re-entry of existing well bore is now located in an unorthodox location AT this time.

- D. The location of any archeological sites identified in the archeological survey; *N/A*
- E. The location and nature of any other surface conditions which prevent the use of an orthodox location. *Refer to IV-C + V-C.*
- VI. If archeological sites are a reason for the unorthodox location request, a copy of the archeological survey, or a summary, identifying sites which cannot be disturbed or which must have any disturbance mitigated. In addition, the location of such areas should be marked on the enlarged topo so they can be clearly identified. *N/A*
- VII. A narrative report of any on-site inspection of the potential locations. If such on-site has resulted in elimination of legal locations due to surface conditions, such information should also be noted on the enlarged topo. *N/A*
- VIII. A statement of why directional drilling to reach a legal bottom-hole location is not feasible. *N/A*
- IX. An affidavit that notice has been sent to all parties entitled thereto, under the Divisions Rules and Regulations with return receipt cards showing date of receipt of notice.

*This re-entry is unorthodox to the west.
Yates Petroleum Corporation is the
offset Lease holder in the W/2 of
Section 29, T23S-R24E. See
ATTACHED PLAT # III.*

Thank You.

DISTRICT I
1625 N. French Dr., Hobbs, NM 88240

DISTRICT II
811 South First, Artesia, NM 88210

DISTRICT III
1000 Rio Brazos Rd., Aztec, NM 87410

DISTRICT IV
2040 South Pacheco, Santa Re, NM 8750.

State of New Mexico
Energy, Minerals and Natural Resources Department

OIL CONSERVATION DIVISION
PO BOX 2088

Santa Re, NM 87501-2088

FILE COPY

Form C-101
Revised March 17, 1999
Instructions on back
Submit to appropriate District Office
State Lease - 6 Copies
Fee Lease - 5 Copies

☐ AMENDED REPORT

APPLICATION FOR PERMIT TO DRILL, RE-ENTER, DEEPEN, PLUGBACK, OR ADD A ZONE

¹ Operator Name and Address Yates Petroleum Corporation 105 South Fourth Street Artesia, New Mexico 88210		² OGRID Number 025575
		³ API Number 30-
⁴ Property Code	⁵ Property Name Tortoise ASB Com.	⁶ Well No. 1

⁷ Surface Location

UL or lot no.	Section	Township	Range	Lot Idn	Feet from the	North/South Line	Feet from the	East/West Line	County
G	29	23S	24E		1980'	North	2250'	East	Eddy

⁸ Proposed Bottom Hole Location If Different From Surface

UL or lot no.	Section	Township	Range	Lot Idn	Feet from the	North/South Line	Feet from the	East/West Line	County
⁹ Proposed Pool 1 Wildcat Morrow					¹⁰ Proposed Pool 2				

¹¹ Work Type Code E	¹² Well Type Code G	¹³ Cable/Rotary R	¹⁴ Lease Type Code P	¹⁵ Ground Level Elevation 3956'
¹⁶ Multiple N	¹⁷ Proposed Depth 11,300'	¹⁸ Formation Morrow	¹⁹ Contractor Not Determined	²⁰ Spud Date ASAP

²¹ Proposed Casing and Cement Program

Hole Size	Casing Size	Casing weight/feet	Setting Depth	Sacks of Cement	Estimated TOC
17 1/2"	13 3/8"	48#	200'	200 sx	In Place
12 1/4"	9 5/8"	36#	3500'	900 sx	In Place
8 3/4"	5 1/2"	17#	11300'	As warranted	As warranted

²² Describe the proposed program. If this application is to DEEPEN or PLUG BACK give the data on the present productive zone and proposed new productivity. Describe the blowout prevention program, if any. Use additional sheets if necessary.

Yates Petroleum Corporation proposes to re-enter the captioned well which was P/A'd by Shell Oil Company on May 6, 1965. We will clean out to the original TD of 11,300', run 5 1/2" casing and cement it to 6,500' with adequate cement. Will test the Morrow and all intermediate potential zones.

BOPE PROGRAM: BOPE will be installed on the 9 5/8" casing and tested daily.

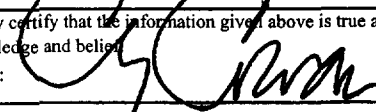
²³ I hereby certify that the information given above is true and complete to the best of my knowledge and belief. Signature: 		OIL CONSERVATION DIVISION	
Printed name: Cy Cowan		Approved by:	
Title: Regulatory Agent		Title:	
Date: 07/03/02	Phone: (505) 748-1471	Approval Date:	Expiration Date:
		Conditions of Approval Attached <input type="checkbox"/>	

FILE COPY

District I
1625 N. French Dr., Hobbs, NM 88240
District II
1301 W. Grand Avenue, Artesia, NM 88210
District III
1000 Rio Brazos Rd., Aztec, NM 87410
District IV
1220 S. St. Francis Dr., Santa Fe, NM 87505

State of New Mexico
Energy, Minerals & Natural Resources Department
OIL CONSERVATION DIVISION
1220 South St. Francis Dr.
Santa Fe, NM 87505

Form C-102
Revised August 15, 2000
Submit to Appropriate District Office
State Lease - 4 Copies
Fee Lease - 3 Copies

☐ AMENDED REPORT

WELL LOCATION AND ACREAGE DEDICATION PLAT

¹ API Number		² Pool Code	³ Pool Name Wildcat Morrow
⁴ Property Code	⁵ Property Name Tortoise ASB Com.		⁶ Well Number 1
⁷ OGRID No. 025575	⁸ Operator Name YATES PETROLEUM CORPORATION		⁹ Elevation 3956'

¹⁰ Surface Location

UL or lot no.	Section	Township	Range	Lot Idn	Feet from the	North/South line	Feet from the	East/West line	County
G	29	23S	24E		1980'	North	2250'	East	Eddy

¹¹ Bottom Hole Location If Different From Surface

UL or lot no.	Section	Township	Range	Lot Idn	Feet from the	North/South line	Feet from the	East/West line	County

¹² Dedicated Acres 320	¹³ Joint or Infill	¹⁴ Consolidation Code	¹⁵ Order No.
--------------------------------------	-------------------------------	----------------------------------	-------------------------

NO ALLOWABLE WILL BE ASSIGNED TO THIS COMPLETION UNTIL ALL INTERESTS HAVE BEEN CONSOLIDATED OR A NON-STANDARD UNIT HAS BEEN APPROVED BY THE DIVISION

¹⁶	¹⁷ OPERATOR CERTIFICATION I hereby certify that the information contained herein is true and complete to the best of my knowledge and belief.	
	Signature Printed Name Cy Cowan	
	Title Regulatory Agent	
	Date October 30, 2002	
¹⁸ SURVEYOR CERTIFICATION I hereby certify that the well location shown on this plat was plotted from field notes of actual surveys made by me or under my supervision, and that the same is true and correct to the best of my belief.		
REFER TO ORIGINAL PLAT Date of Survey Signature and Seal of Professional Surveyor:		
Certificate Number		

MEXICO OIL CONSERVATION COMMISSION
WELL LOCATION AND ACREAGE DEDICATION PLAT

Form C-102
 Supersedes C-121
 Effective 1-1-65

All distances must be from the outer boundaries of the Section.

Operator Shell Oil Company			Lease China Canyon Unit		Well No. 1
Unit Letter G	Section 29	Township 23S	Range 24E	County Eddy	
Actual Footage Location of Well: 1980 feet from the north line and 2250 feet from the east line					
Ground Level Elev: not available	Producing Formation Devonian		Pool Wildcat		Dedicated Acreage 40 Acres

1. Outline the acreage dedicated to the subject well by colored pencil or hachure marks on the plat below.
2. If more than one lease is dedicated to the well, outline each and identify the ownership thereof (both as to working interest and royalty).
3. If more than one lease of different ownership is dedicated to the well, have the interests of all owners been consolidated by communitization, unitization, force-pooling, etc?

☒ Yes ☐ No If answer is "yes," type of consolidation Unitization **FEB 16 1965**

If answer is "no," list the owners and tract descriptions which have actually been consolidated. (Use reverse side of this form if necessary.) U. C. C.

ARTESIA OFFICE

No allowable will be assigned to the well until all interests have been consolidated (by communitization, unitization, forced-pooling, or otherwise) or until a non-standard unit, eliminating such interests, has been approved by the Commission.

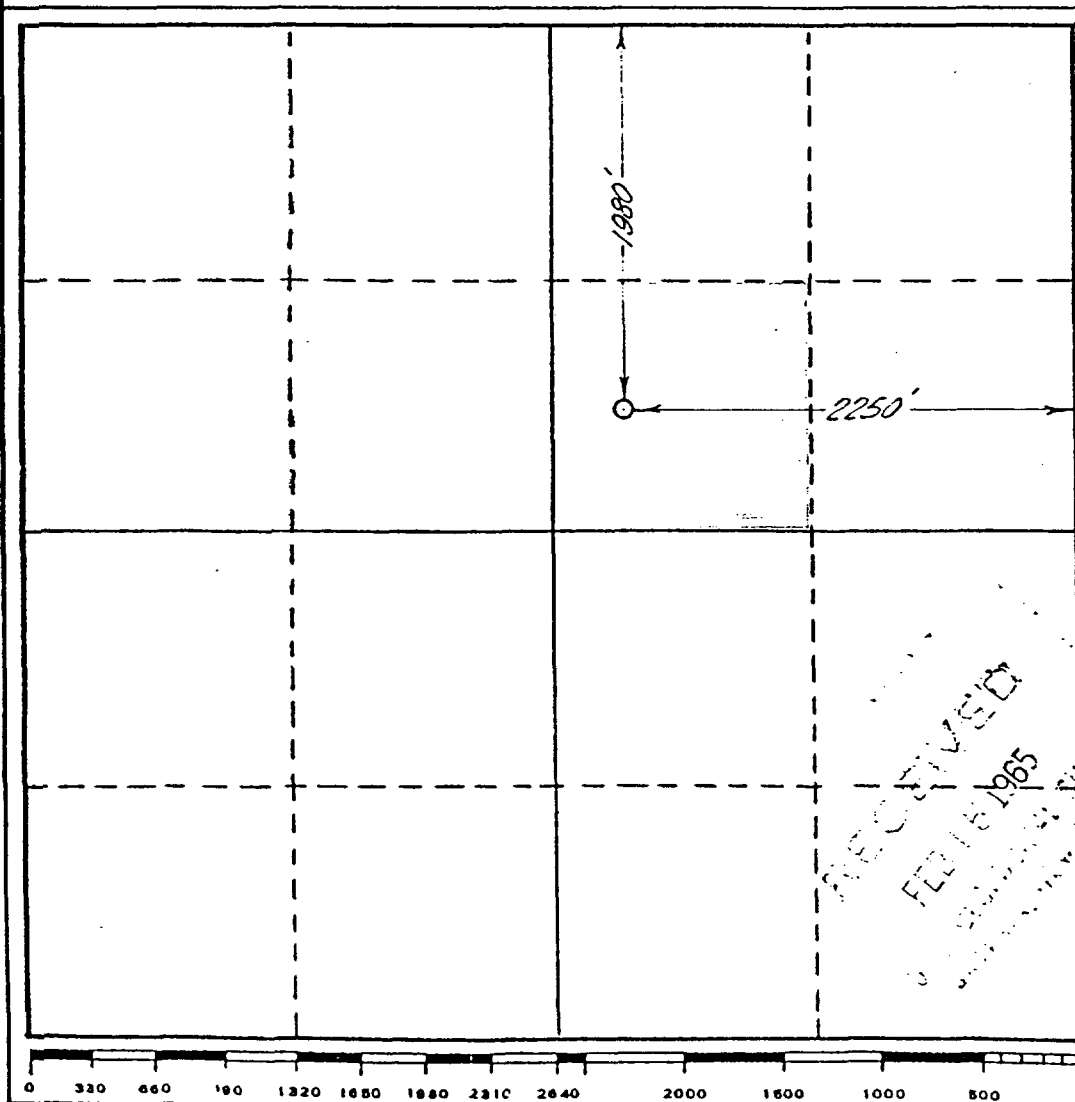

CERTIFICATION

I hereby certify that the information contained herein is true and complete to the best of my knowledge and belief.

Name V. L. King
 Position Acting District
Exploitation Engineer
 Company Shell Oil Company
 Date February 12, 1965

I hereby certify that the well location shown on this plat was plotted from field notes of actual surveys made by me or under my supervision, and that the same is true and correct to the best of my knowledge and belief.

Date Surveyed Feb. 9, 1965
T. J. Chapman, Jr., Chief Surveyor
Shell Oil Company

RECEIVED
 FEB 16 1965



Typical 3,000 psi Pressure System
Schematic
Annular with Double Ram Preventer Stack

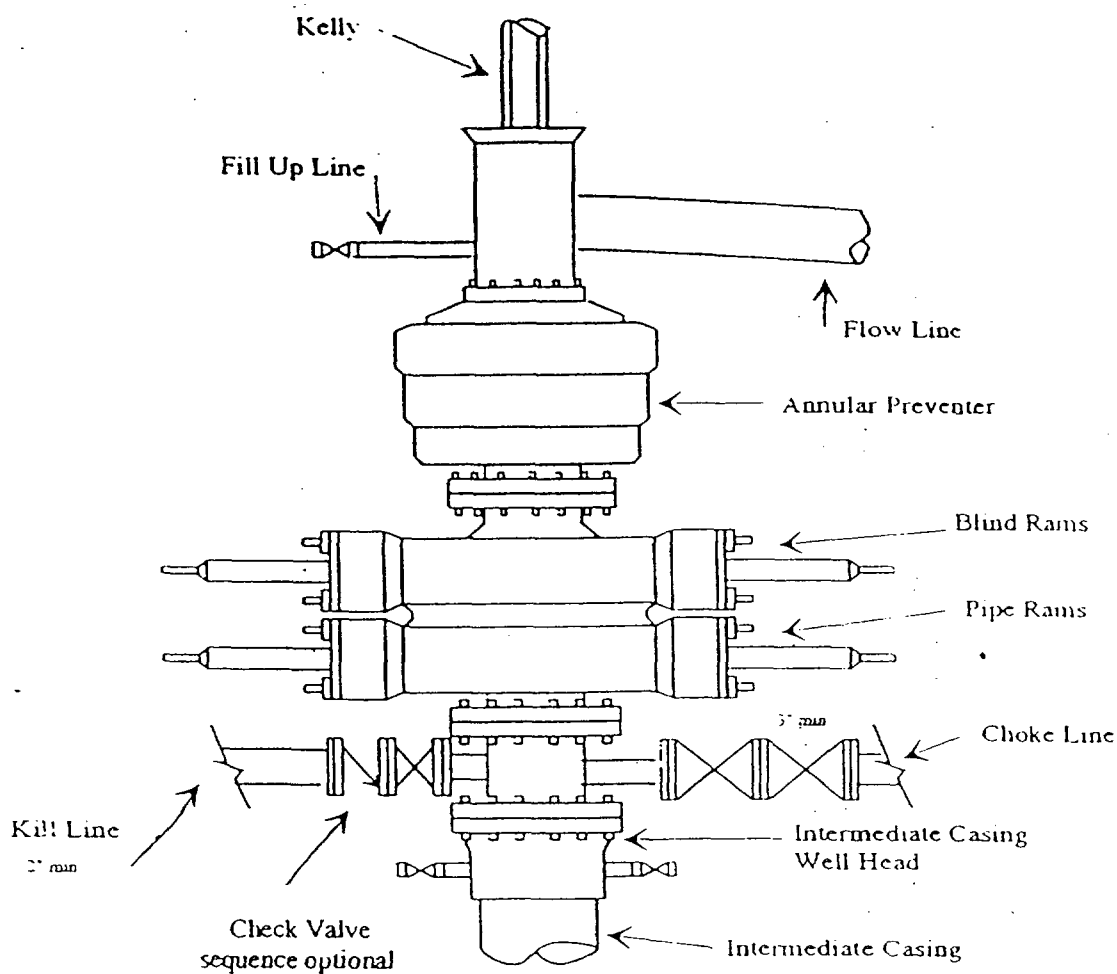

Typical 3,000 psi choke manifold assembly with at least these minimum features

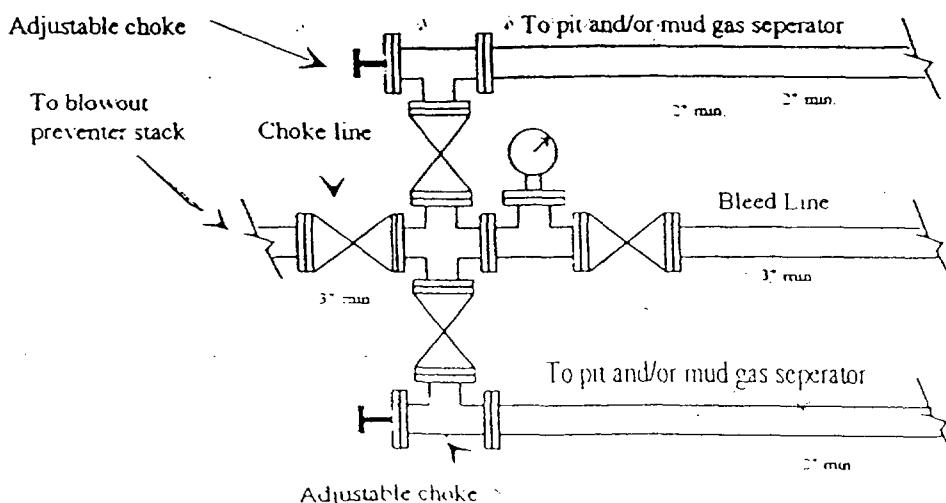

NO. OF COPIES RECEIVED	4
DISTRIBUTION	
SANTA FE	1
FILE	1
U.S.G.S.	
LAND OFFICE	
OPERATOR	2

NEW MEXICO OIL CONSERVATION COMMISSION

Form C-103
Supersedes Old
C-102 and C-103
Effective 1-1-65

5a. Indicate Type of Lease
State <input type="checkbox"/> Fee <input checked="" type="checkbox"/>
5. State Oil & Gas Lease No.

SUNDRY NOTICES AND REPORTS ON WELLS

(DO NOT USE THIS FORM FOR PROPOSALS TO DRILL OR TO DEEPEN OR PLUG BACK TO A DIFFERENT RESERVOIR.
USE "APPLICATION FOR PERMIT -" (FORM C-101) FOR SUCH PROPOSALS.)

1. OIL WELL <input checked="" type="checkbox"/> GAS WELL <input type="checkbox"/> OTHER <input type="checkbox"/>	7. Unit Agreement Name China Canyon Unit
2. Name of Operator Shell Oil Company	8. Farm or Lease Name China Canyon Unit
3. Address of Operator Box 1858 Roswell, New Mexico	9. Well No. 1
4. Location of Well UNIT LETTER G , 1980 FEET FROM THE north LINE AND 2250 FEET FROM THE east LINE, SECTION 29 TOWNSHIP 23-S RANGE 24-E NMPM.	10. Field and Pool, or Wildcat Wildcat
15. Elevation (Show whether DF, RT, GR, etc.) 3956' df	12. County Eddy

Check Appropriate Box To Indicate Nature of Notice, Report or Other Data

NOTICE OF INTENTION TO:

PERFORM REMEDIAL WORK <input type="checkbox"/>	PLUG AND ABANDON <input type="checkbox"/>
TEMPORARILY ABANDON <input type="checkbox"/>	CHANGE PLANS <input type="checkbox"/>
PULL OR ALTER CASING <input type="checkbox"/>	OTHER <input type="checkbox"/>

SUBSEQUENT REPORT OF:

REMEDIAL WORK <input type="checkbox"/>	ALTERING CASING <input type="checkbox"/>
COMMENCE DRILLING OPNS. <input type="checkbox"/>	PLUG AND ABANDONMENT <input type="checkbox"/>
CASING TEST AND CEMENT JOB <input checked="" type="checkbox"/>	OTHER <input type="checkbox"/>

17. Describe Proposed or Completed Operations (Clearly state all pertinent details, and give pertinent dates, including estimated date of starting any proposed work) SEE RULE 1103.

Spudded at 2:30 p.m. (MST), February 14, 1965, with Cable Tools.
Ran 206' of 13-3/8" (48#, H-40) casing and cemented at 209' with
100 sacks Class C Incor plus 2% CaCl₂ plus 100 sacks Class C Incor
plus 6% CaCl₂. Plug down at 1:30 p.m. (MST), February 22, 1965.
Circulated 5 sacks cement. After WOC 120 hours, tested with 800
psi for 30 minutes - no pressure drop.

RECEIVED
MAR 11 1965
O. C. C.
ARTESIA, OFFICE

18. I hereby certify that the information above is true and complete to the best of my knowledge and belief.

Original Signed By SIGNED R. J. Doubek	TITLE Division Mechanical Engr.	DATE 3-9-65
APPROVED BY M. L. Armstrong	TITLE OIL AND GAS INSPECTOR	DATE MAR 11 1965
CONDITIONS OF APPROVAL, IF ANY:		

District I
1625 N. French Dr., Hobbs, NM 88240

District II
811 South First, Artesia, NM 88210

District III
1000 Rio Brazos Rd., Aztec, NM 87410

District IV
1220 S. St. Francis Dr., Santa Fe, NM 87505

State of New Mexico
Energy, Minerals & Natural Resources Department

Form C-102
Revised August 15, 2000

OIL CONSERVATION DIVISION
1220 South St. Francis Dr.
Santa Fe, NM 87505

Submit to Appropriate District Office
State Lease - 4 Copies
Fee Lease - 3 Copies

☐ AMENDED REPORT

WELL LOCATION AND ACREAGE DEDICATION PLAT

¹ API Number 30-	² Pool Code	³ Pool Name Undesignated Wooten Ranch Atoka
⁴ Property Code	⁵ Property Name TORTOISE "ABS" COM.	⁶ Well Number 1
⁷ OGRID No. 025575	⁸ Operator Name Yates Petroleum Corporation	⁹ Elevation 3956'

¹⁰ Surface Location

UL or lot no. G	Section 29	Township 23S	Range 24E	Lot Idn	Feet from the 1980'	North/South line North	Feet from the 2250	East/West line East	County Eddy
---------------------------	----------------------	------------------------	---------------------	---------	-------------------------------	----------------------------------	------------------------------	-------------------------------	-----------------------

¹¹ Bottom Hole Location If Different From Surface

UL or lot no.	Section	Township	Range	Lot Idn	Feet from the	North/South line	Feet from the	East/West line	County
¹² Dedicated Acres 320	¹³ Joint or Infill	¹⁴ Consolidation Code	¹⁵ Order No.						

NO ALLOWABLE WILL BE ASSIGNED TO THIS COMPLETION UNTIL ALL INTERESTS HAVE BEEN CONSOLIDATED OR A NON-STANDARD UNIT HAS BEEN APPROVED BY THE DIVISION

¹⁶			<p>¹⁷ OPERATOR CERTIFICATION</p> <p><i>I hereby certify that the information contained herein is true and complete to the best of my knowledge and belief.</i></p> <p>Signature Cy Cowan</p> <p>Printed Name Regulatory Agent</p> <p>Title 10/30/2002</p> <p>Date</p>
			<p>¹⁸ SURVEYOR CERTIFICATION</p> <p><i>I hereby certify that the well location shown on this plat was plotted from field notes of actual surveys made by me or under my supervision, and that the same is true and correct to the best of my belief.</i></p> <p>REFER TO ORIGINAL PLAT</p> <p>Date of Survey</p> <p>Signature and Seal of Professional Surveyor:</p>
			Certificate Number

16		<div style="border: 2px solid blue; padding: 5px; margin-bottom: 5px;"> <div style="display: flex; justify-content: space-between; align-items: center;"> <div style="writing-mode: vertical-rl; transform: rotate(180deg);">1980'</div> <div>NM-96815</div> </div> </div> <div style="border: 2px solid green; padding: 5px; margin-bottom: 5px;"> <div style="display: flex; align-items: center; justify-content: center;"> <div style="border: 1px solid black; border-radius: 50%; width: 20px; height: 20px; margin-right: 10px;"></div> <div style="display: flex; flex-direction: column; align-items: center;"> <div style="writing-mode: vertical-rl; transform: rotate(180deg);">2250'</div> <div style="width: 200px; height: 2px; background-color: black;"></div> </div> </div> </div> <div style="border: 2px solid blue; padding: 5px;"> <div style="text-align: center;">FEE</div> </div>	<div>17</div> <div>OPERATOR CERTIFICATION</div> <div><i>I hereby certify that the information contained herein is true and complete to the best of my knowledge and belief.</i></div> <div>Signature</div> <div>Cy Cowan</div> <div>Printed Name</div> <div>Regulatory Agent</div> <div>Title</div> <div>10/30/2002</div> <div>Date</div>
		<div style="border: 2px solid blue; padding: 5px; margin-bottom: 5px;"> <div style="text-align: center;">NM-96815</div> </div>	<div>18</div> <div>SURVEYOR CERTIFICATION</div> <div><i>I hereby certify that the well location shown on this plat was plotted from field notes of actual surveys made by me or under my supervision, and that the same is true and correct to the best of my belief.</i></div> <div>REFER TO ORIGNAL PLAT</div> <div>Date of Survey</div> <div>Signature and Seal of Professional Surveyor:</div> <div style="border-top: 1px solid black; height: 20px; margin-top: 10px;"></div> <div>Certificate Number</div>

District II
811 South First, Artesia, NM 88210

District III
1000 Rio Brazos Rd., Aztec, NM 87410

District IV
1220 S. St. Francis Dr., Santa Fe, NM 87505

State of New Mexico
Energy, Minerals & Natural Resources Department

Form C-102
Revised August 15, 2000

OIL CONSERVATION DIVISION
1220 South St. Francis Dr
Santa Fe, NM 87505

Submit to Appropriate District Office
State Lease - 4 Copies
Fee Lease - 3 Copies

AMENDED REPORT

WELL LOCATION AND ACREAGE DEDICATION PLAT

¹ API Number 30-		² Pool Code	³ Pool Name Wildcat Canyon
⁴ Property Code	⁵ Property Name TORTOISE "ABS" COM.		⁶ Well Number 1
⁷ OGRID No. 025575	⁸ Operator Name Yates Petroleum Corporation		⁹ Elevation 3956'

10 Surface Location

UL or lot no.	Section	Township	Range	Lot Idn	Feet from the	North/South line	Feet from the	East/West line	County
G	29	23S	24E		1980'	North	2250	East	Eddy

¹¹ Bottom Hole Location If Different From Surface

Bottom Hole Location is Different from Surface									
UL or lot no.	Section	Township	Range	Lot Idn	Feet from the	North/South line	Feet from the	East/West line	County

¹² Dedicated Acres 320	¹³ Joint or Infill	¹⁴ Consolidation Code	¹⁵ Order No.
---	-------------------------------	----------------------------------	-------------------------

NO ALLOWABLE WILL BE ASSIGNED TO THIS COMPLETION UNTIL ALL INTERESTS HAVE BEEN CONSOLIDATED OR A NON-STANDARD UNIT HAS BEEN APPROVED BY THE DIVISION

16			17 OPERATOR CERTIFICATION I hereby certify that the information contained herein is true and complete to the best of my knowledge and belief.
			Signature Cy Cowan Printed Name Regulatory Agent Title 10/30/2002 Date
			18 SURVEYOR CERTIFICATION I hereby certify that the well location shown on this plat was plotted from field notes of actual surveys made by me or under my supervision, and that the same is true and correct to the best of my belief. REFER TO ORIGNAL PLAT
			Date of Survey Signature and Seal of Professional Surveyor: Certificate Number

District I
1625 N. French Dr., Hobbs, NM 88240

District II
811 South First, Artesia, NM 88210

District III
1000 Rio Brazos Rd., Aztec, NM 87410

District IV
1220 S. St. Francis Dr., Santa Fe, NM 87505

State of New Mexico
Energy, Minerals & Natural Resources Department

Form C-102
Revised August 15, 2000

OIL CONSERVATION DIVISION
1220 South St Francis Dr
Santa Fe, NM 87505

Submit to Appropriate District Office
State Lease - 4 Copies
Fee Lease - 3 Copies

☐ AMENDED REPORT

WELL LOCATION AND ACREAGE DEDICATION PLAT

¹ API Number 30-	² Pool Code	³ Pool Name Wildcat Penn
⁴ Property Code	⁵ Property Name TORTOISE "ABS" COM.	⁶ Well Number 1
⁷ OGRID No. 025575	⁸ Operator Name Yates Petroleum Corporation	⁹ Elevation 3956'

¹⁰ Surface Location

UL or lot no.	Section	Township	Range	Lot Idn	Feet from the	North/South line	Feet from the	East/West line	County
G	29	23S	24E		1980'	North	2250	East	Eddy

¹¹ Bottom Hole Location If Different From Surface

UL or lot no.	Section	Township	Range	Lot Idn	Feet from the	North/South line	Feet from the	East/West line	County

¹² Dedicated Acres 320	¹³ Joint or Infill	¹⁴ Consolidation Code	¹⁵ Order No.
---	-------------------------------	----------------------------------	-------------------------

NO ALLOWABLE WILL BE ASSIGNED TO THIS COMPLETION UNTIL ALL INTERESTS HAVE BEEN CONSOLIDATED OR A NON-STANDARD UNIT HAS BEEN APPROVED BY THE DIVISION

16		1980'	NM-96815	¹⁷ OPERATOR CERTIFICATION <i>I hereby certify that the information contained herein is true and complete to the best of my knowledge and belief.</i> Signature Cy Cowan Printed Name Regulatory Agent Title 10/30/2002 Date ¹⁸ SURVEYOR CERTIFICATION <i>I hereby certify that the well location shown on this plat was plotted from field notes of actual surveys made by me or under my supervision, and that the same is true and correct to the best of my belief.</i> REFER TO ORIGNAL PLAT Date of Survey Signature and Seal of Professional Surveyor: Certificate Number

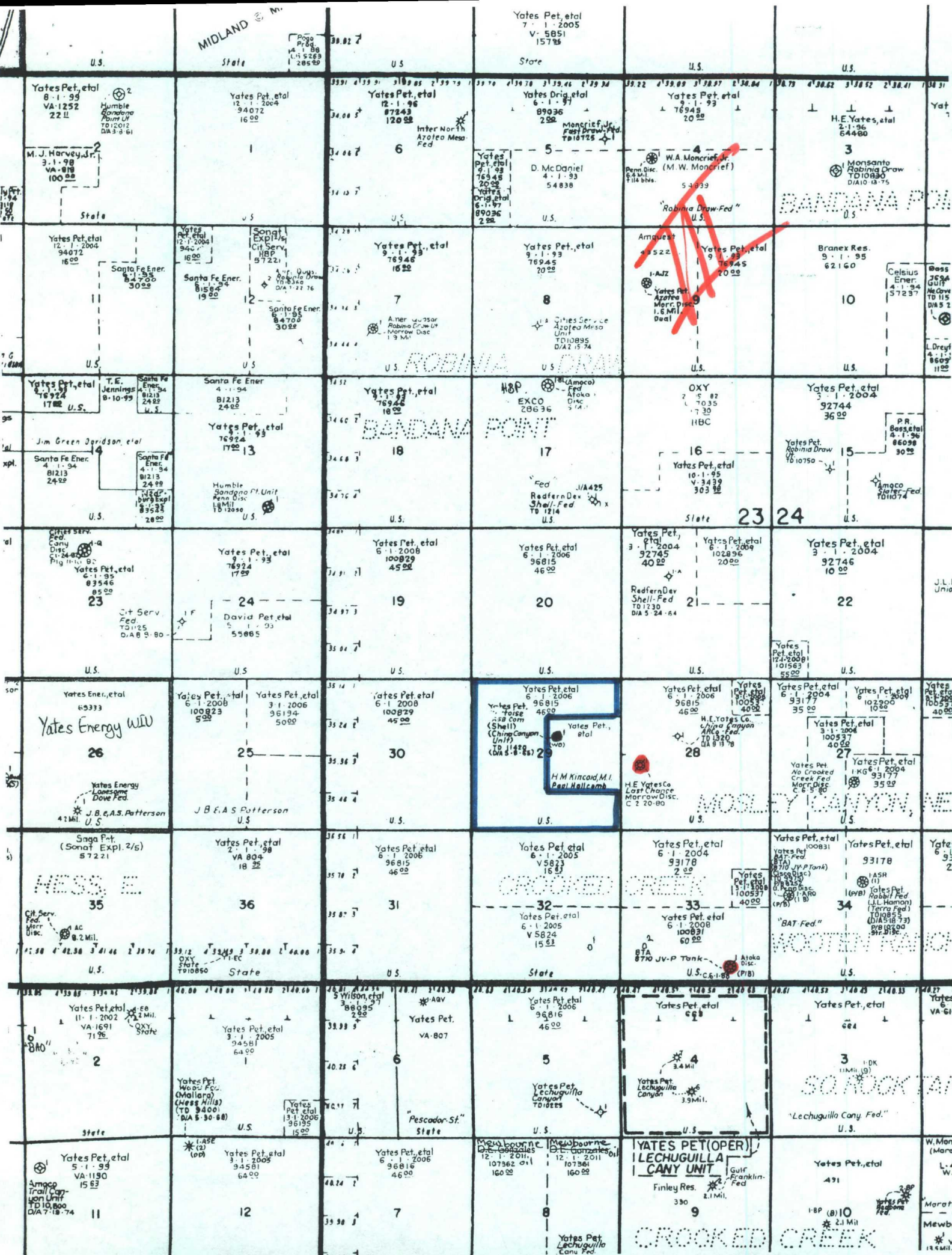

These 2 wells drilled to Morrow
No Longer Producing.

EDDY NM
TANK 8710 JV-P 001
BTA OIL PRODUCERS
ACTIVE

Production Report

Lease Name:	TANK 8710 JV-P	Well Number:	001
Lease Number:	823409	Cum Oil:	36
Operator Name:	BTA OIL PRODUCERS	Cum Gas:	31,625
State:	NEW MEXICO	Cum Water:	
County:	EDDY	First Production Date:	MAR 1988
Field:	CROOKED CREEK	Last Production Date:	JUN 1988
Sec Twn Rng:	33 23S 24E	Spot:	SE SE
Latitude/Longitude:		Lat/Long Source:	
Regulatory #:	823409	Completion Date:	DEC 09, 1987
API:	30015258220000	Total Depth:	9950
Production ID:	2300220152582275400	Upper Perforation:	
Reservoir Name:	MORROW	Lower Perforation:	
Prod Zone:	MORROW	Gas Gravity:	0.60
Prod Zone Code:	402MRRW	Oil Gravity:	
Basin Name:	PERMIAN BASIN	Temp Gradient:	1.082
Gas Gatherer:		N Factor:	0.727
Liquid Gatherer:		GOR:	
Status:	ACTIVE		

Annual Production

Year	Oil BBLs	Gas MCF	Water BBLs
Beginning			
Cum:			
1988	36	31,625	
Totals:	36	31,625	

Monthly Production

Date MO/YR	Oil BBLs	Gas MCF	Water BBLs	Cond Yld BBLs/MCF	% Water	# of Wells	Days on
MAR 1988	36	18,213		1.98		1	0
APR 1988	0	2,505				1	29
MAY 1988	0	5,749				1	24
JUN 1988	0	5,158				1	25
Totals:							
1988	36	31,625					

Production Report

*ALL
 Cont*

Lease Name:	LAST CHANCE	Well Number:	001
Lease Number:	411200	Cum Oil:	
Operator Name:	YATES HARVEY E COMPANY	Cum Gas:	2,463
State:	NEW MEXICO	Cum Water:	3,793
County:	EDDY	First Production Date:	MAY 1980
Field:	EDDY	Last Production Date:	SEP 1980
Sec Twn Rng:	28 23S 24E	Spot:	
Latitude/Longitude:		Lat/Long Source:	
Regulatory #:	411200	Completion Date:	
API:	30015231030000	Total Depth:	10775
Production ID:	2300220152310390622	Upper Perforation:	
Reservoir Name:	MORROW	Lower Perforation:	
Prod Zone:	MORROW	Gas Gravity:	
Prod Zone Code:	402MRRW	Oil Gravity:	
Basin Name:	PERMIAN BASIN	Temp Gradient:	1.082
Gas Gatherer:		N Factor:	
Liquid Gatherer:		GOR:	
Status:	ACTIVE		GAS

Annual Production

Year	Oil BBLs	Gas MCF	Water BBLs
Beginning			
Cum:			
1980		2,463	3,793
Totals:		2,463	3,793

Monthly Production

Date MO/YR	Oil BBLs	Gas MCF	Water BBLs	Cond Yld BBLs/MCF	% Water	# of Wells	Days on
MAY 1980		1,159	951			1	14
JUN 1980		1,253	778			1	18
JUL 1980		39	0			1	5
AUG 1980		0	1,372			0	0
SEP 1980		12	692			1	15
Totals:							
1980		2,463	3,793				

Lease number: NM 401 3358

NM-96815, YPC

Owner#	WI owner name
5000	ABO PETROLEUM CORPORATION
640010	MYCO INDUSTRIES, INC.
994100	YATES DRILLING COMPANY
999900	YATES PETROLEUM CORPORATION

Working int	Other co lse
.20000000	
.20000000	
.20000000	
.40000000	

~~III~~ cont.

Working Interest owners for
NM-96815 w/2 Section 29, T23S-R24E

More...

1.00000000

F3=Exit F4=Ident F5=Spec/Well F6=MIN OWNR F7=Legal Desc F8=Remarks
F12=Prompt F13=Critical F14=Rental F15=Payees F16=Pay Hist F17=Contracts

[illegible]

Affected Pools

[Crooked Creek - Morrow Co. Pool
Upstem Ranch - Atoka Co. Pool - 87770
Crooked Creek Upper Pennsylvanian Co. Pool - 96922]